

Figure 5.1-1. TA-03 site map

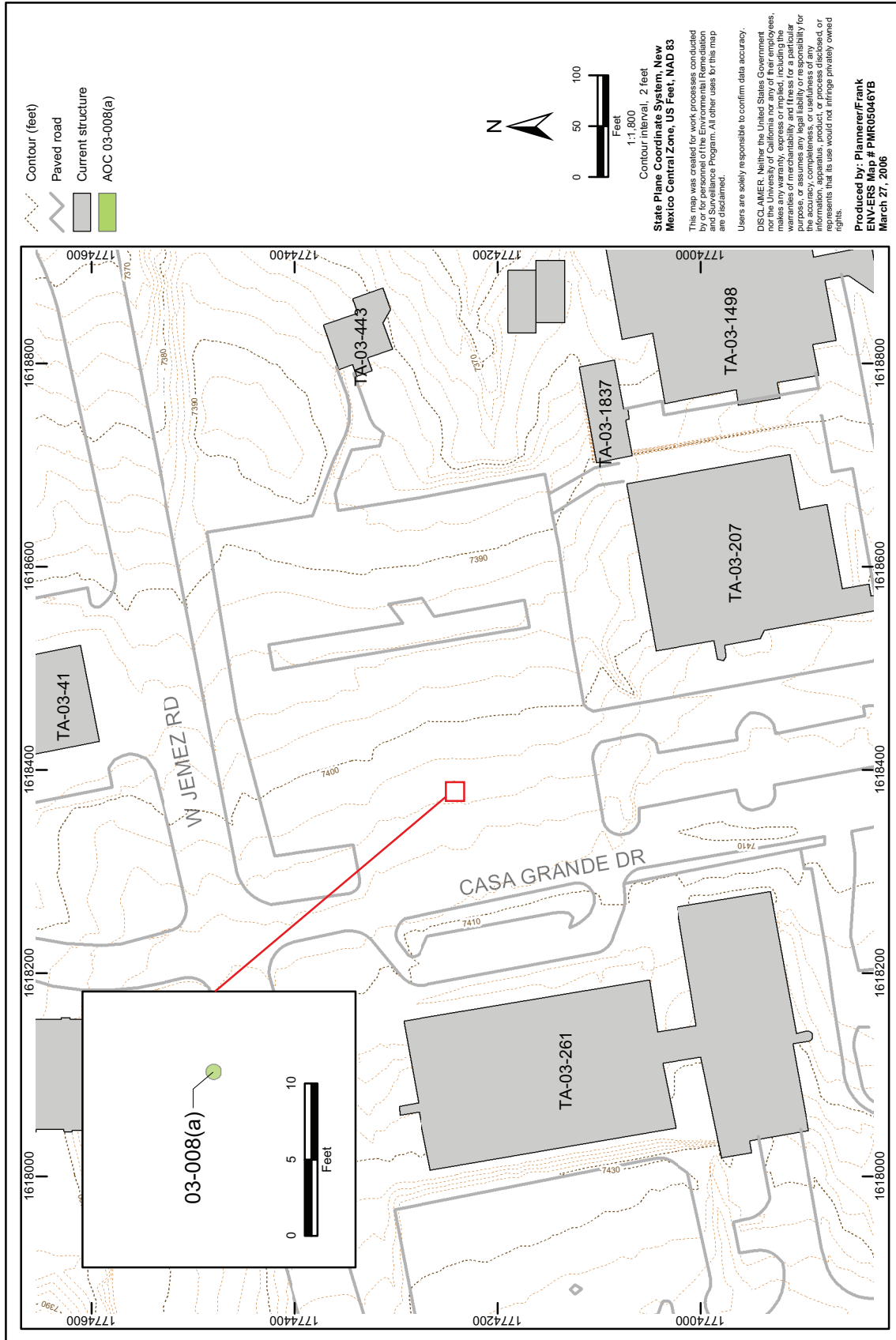

Figure 5.2-1. AOC 03-008(a) site map



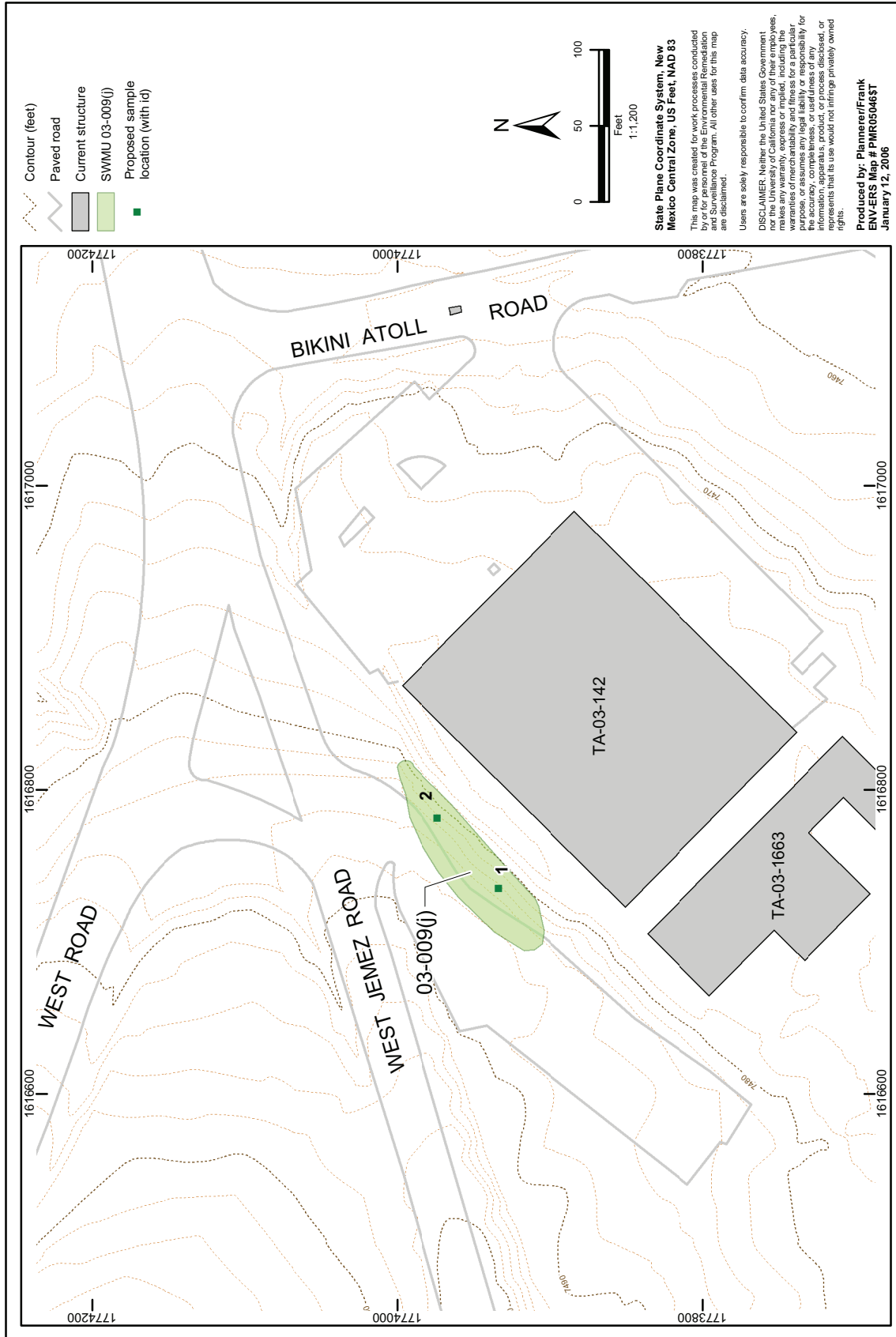

Figure 5.3-1. SWMU 03-009(j) site map and proposed sample locations



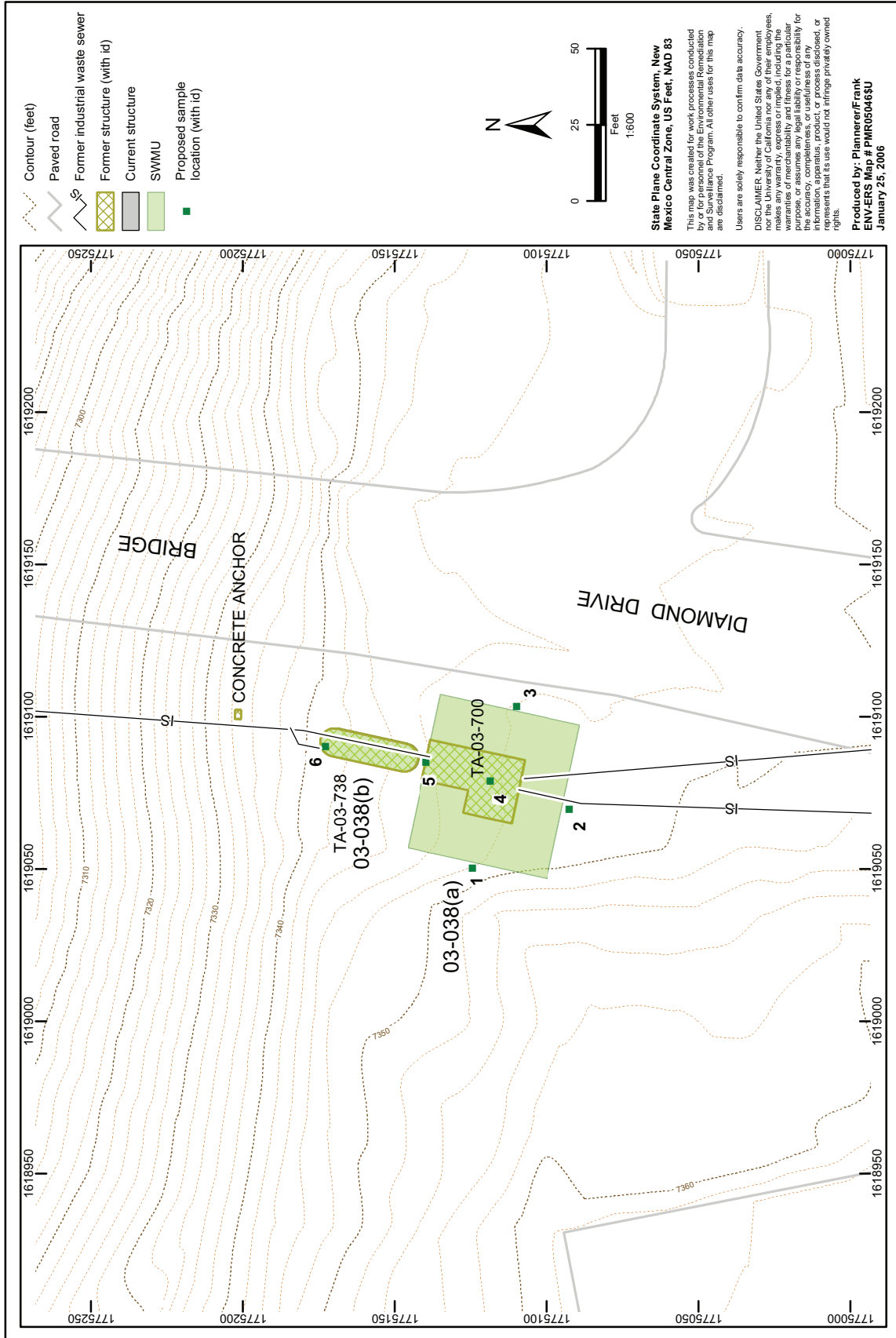

Figure 5.4-1. SWMUs 03-038(a,b) site map and proposed sample locations

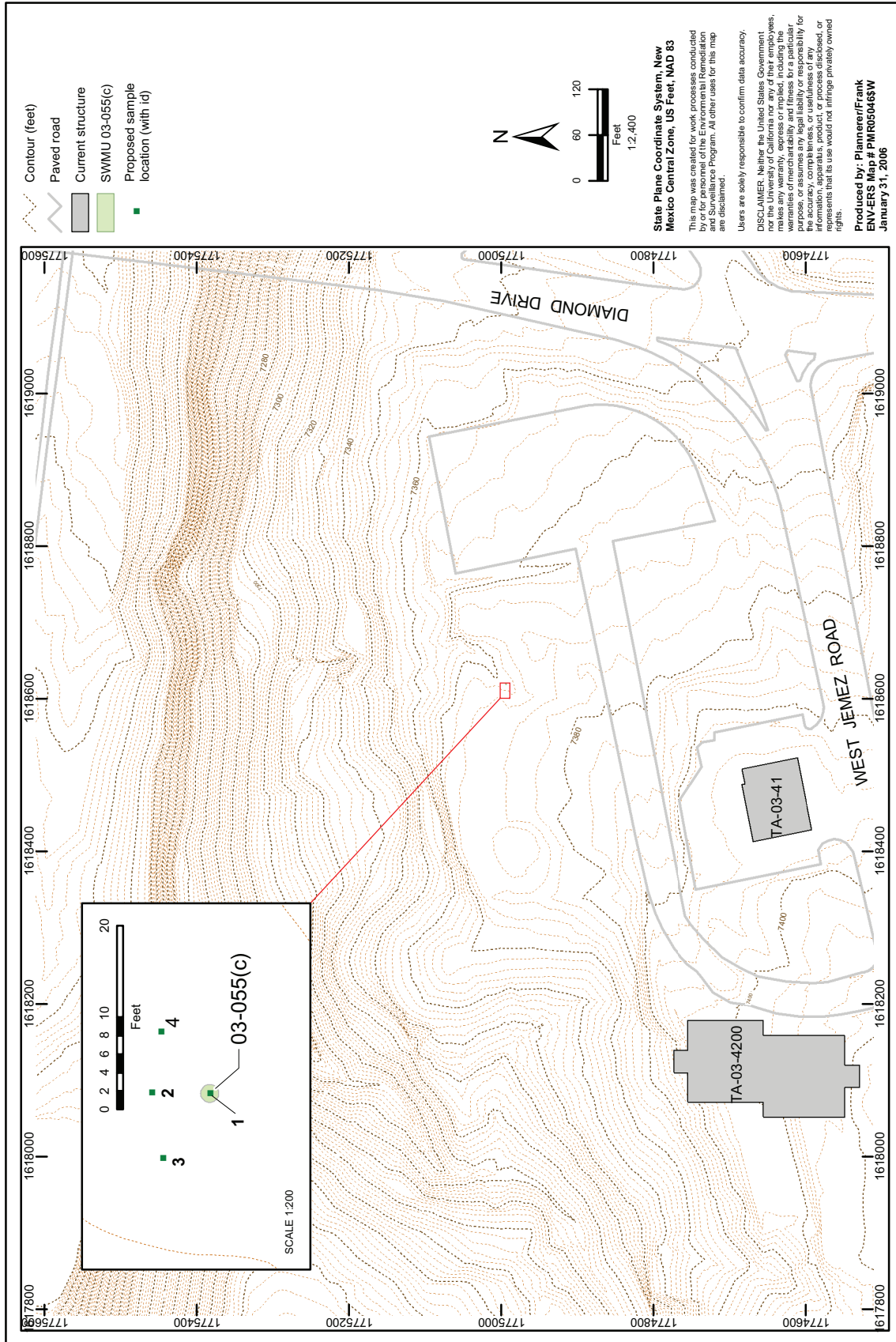

Figure 5.5-1. SWMU 03-055(c) site map and proposed sample locations

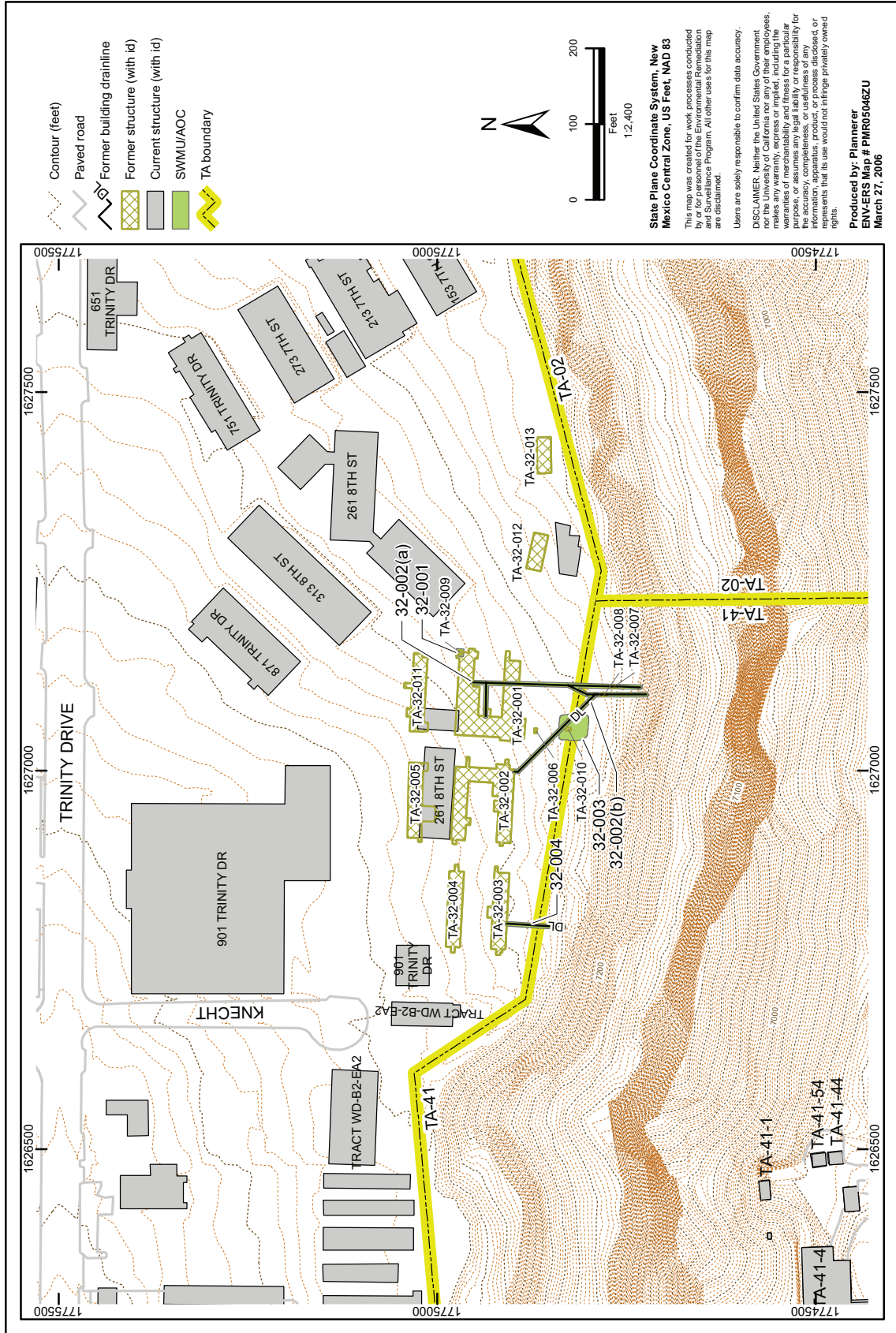

Figure 6.1-1. TA-32 site map



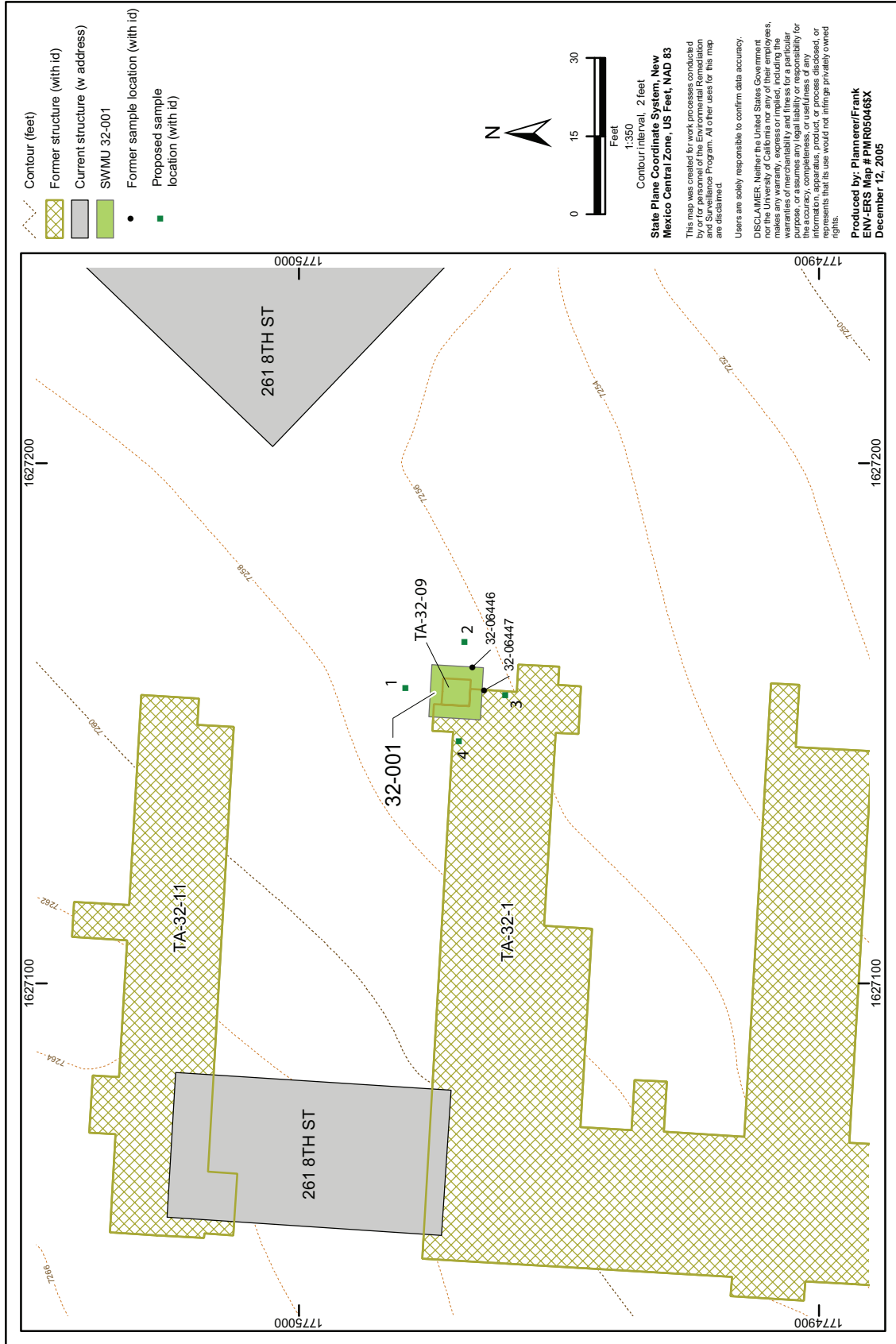

Figure 6.2-1. SWMU 32-001 site map and proposed sample locations

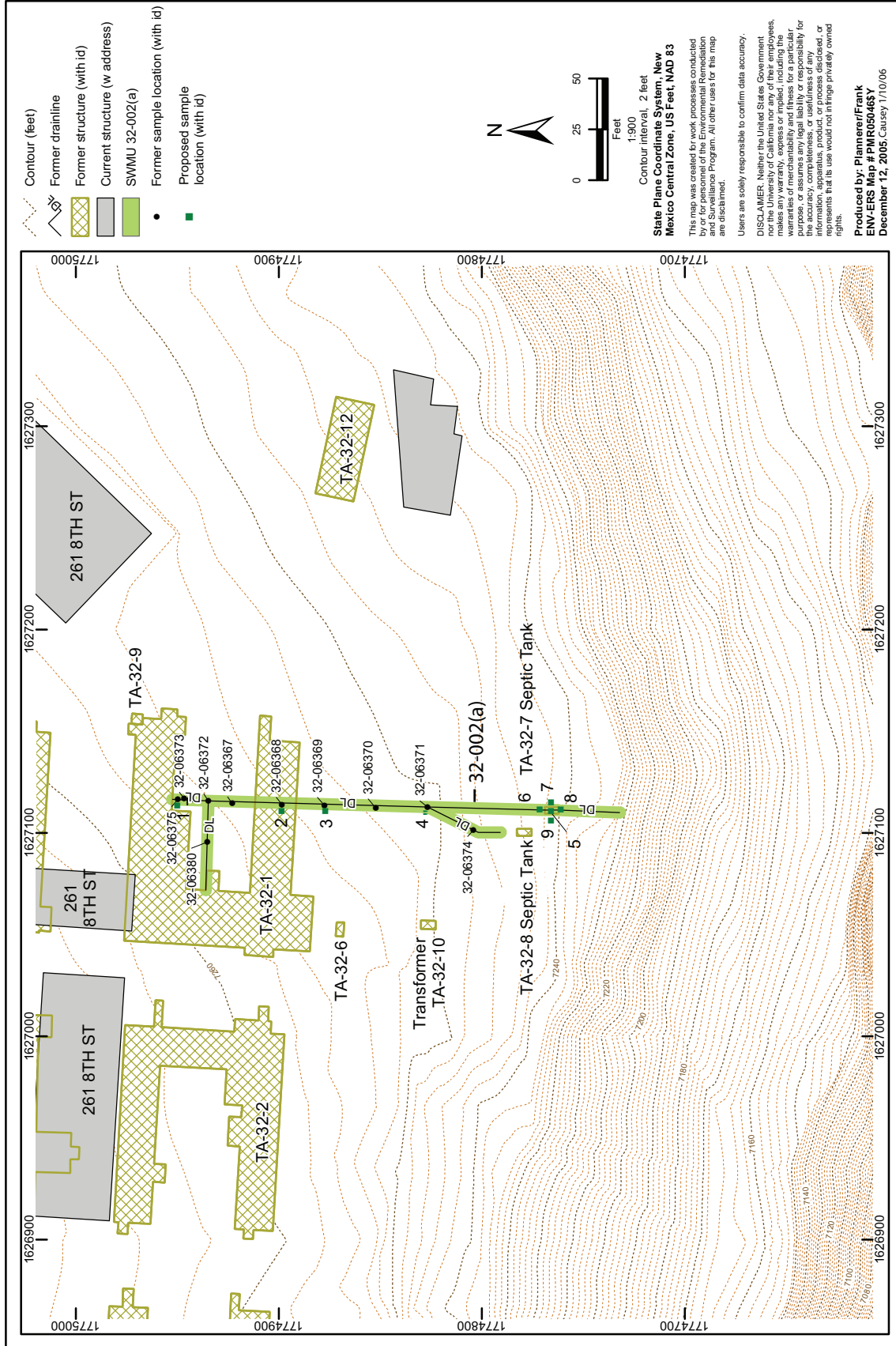

Figure 6.3-1. SWMU 32-002(a) site map and proposed sample locations

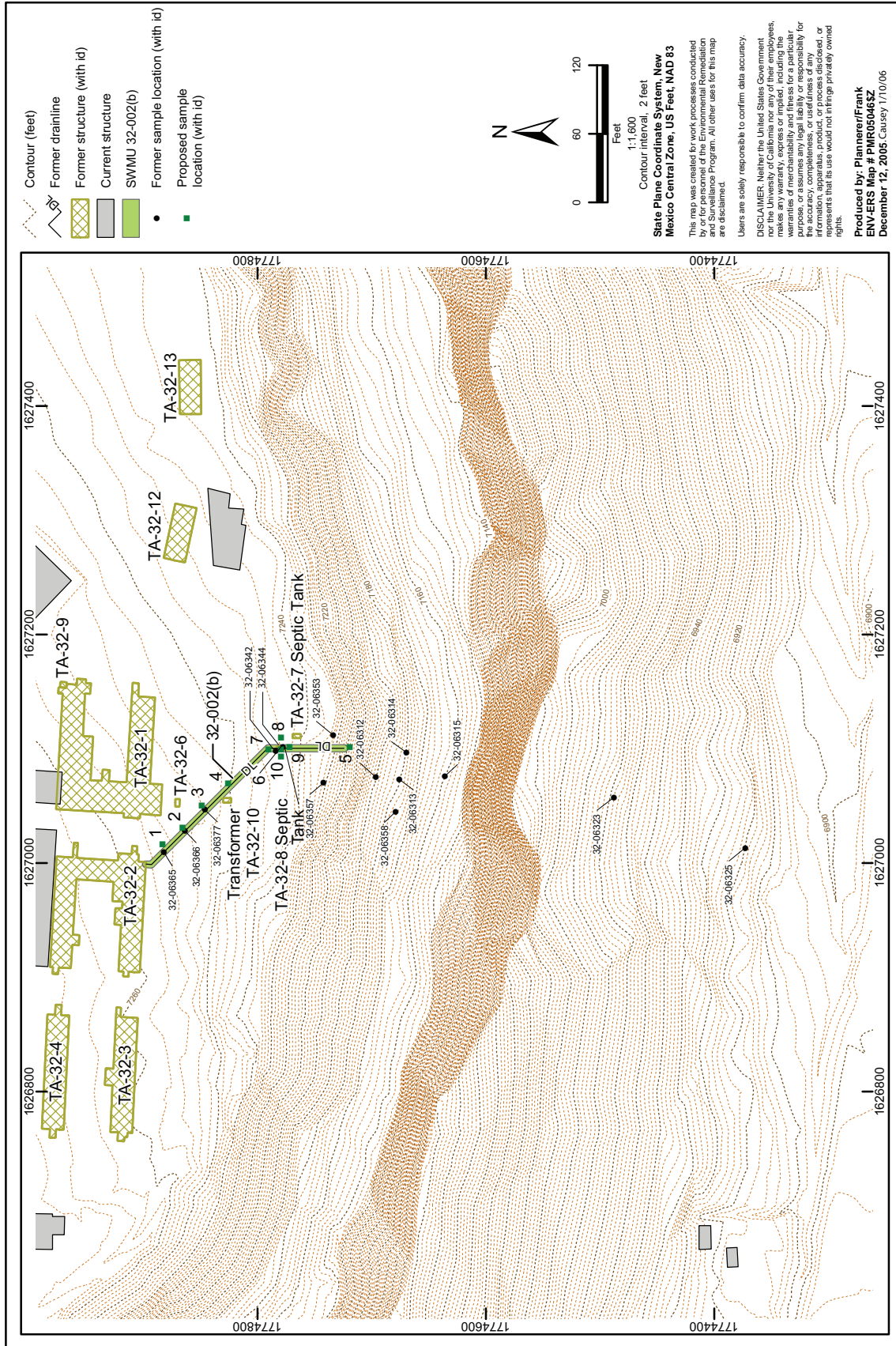

Figure 6.4-1. SWMU 32-002(b) site map and proposed sample locations



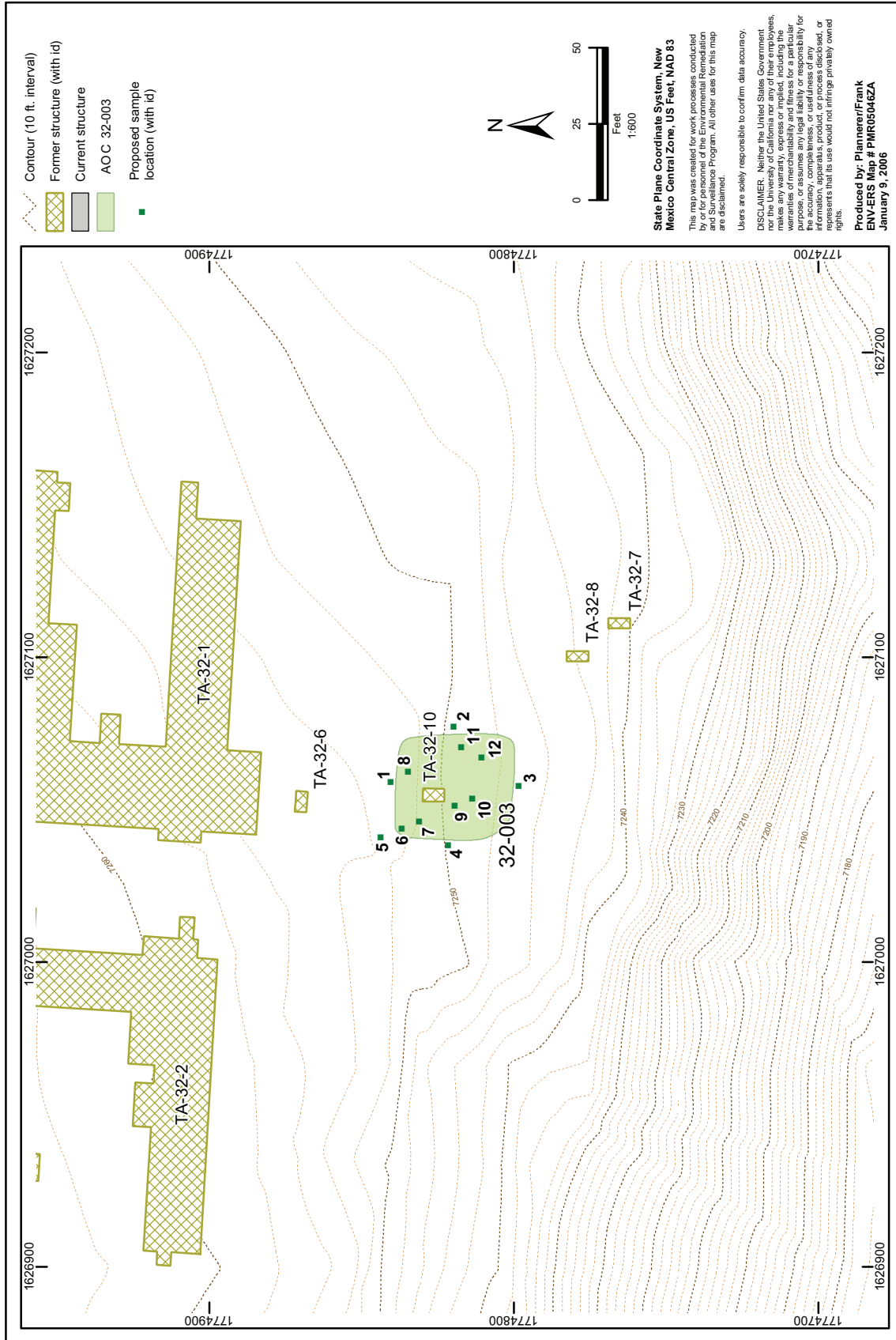

Figure 6.5-1. AOC 32-003 site map and proposed sample locations

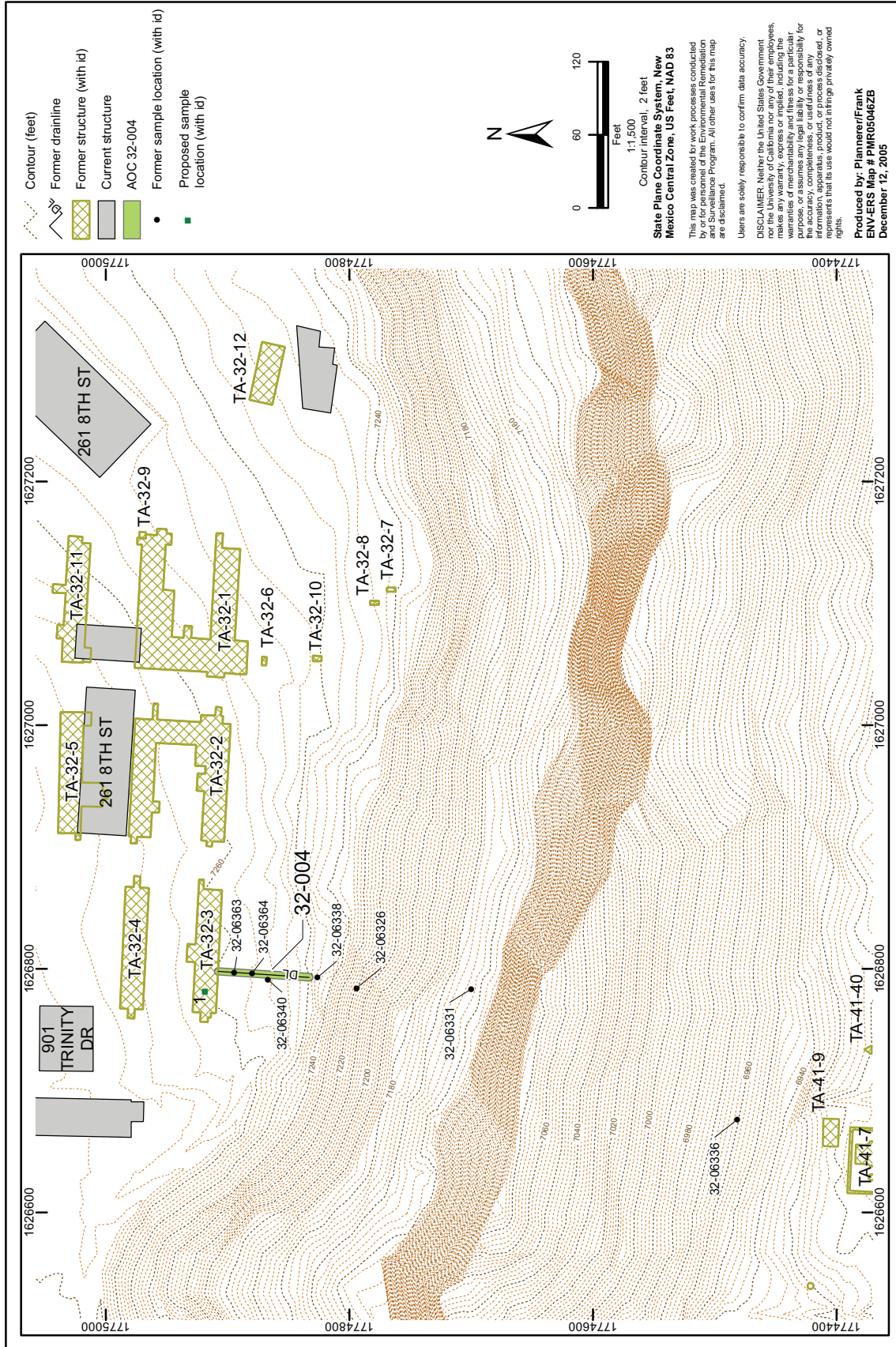

Figure 6.6-1. AOC 32-004 site map and proposed sample locations

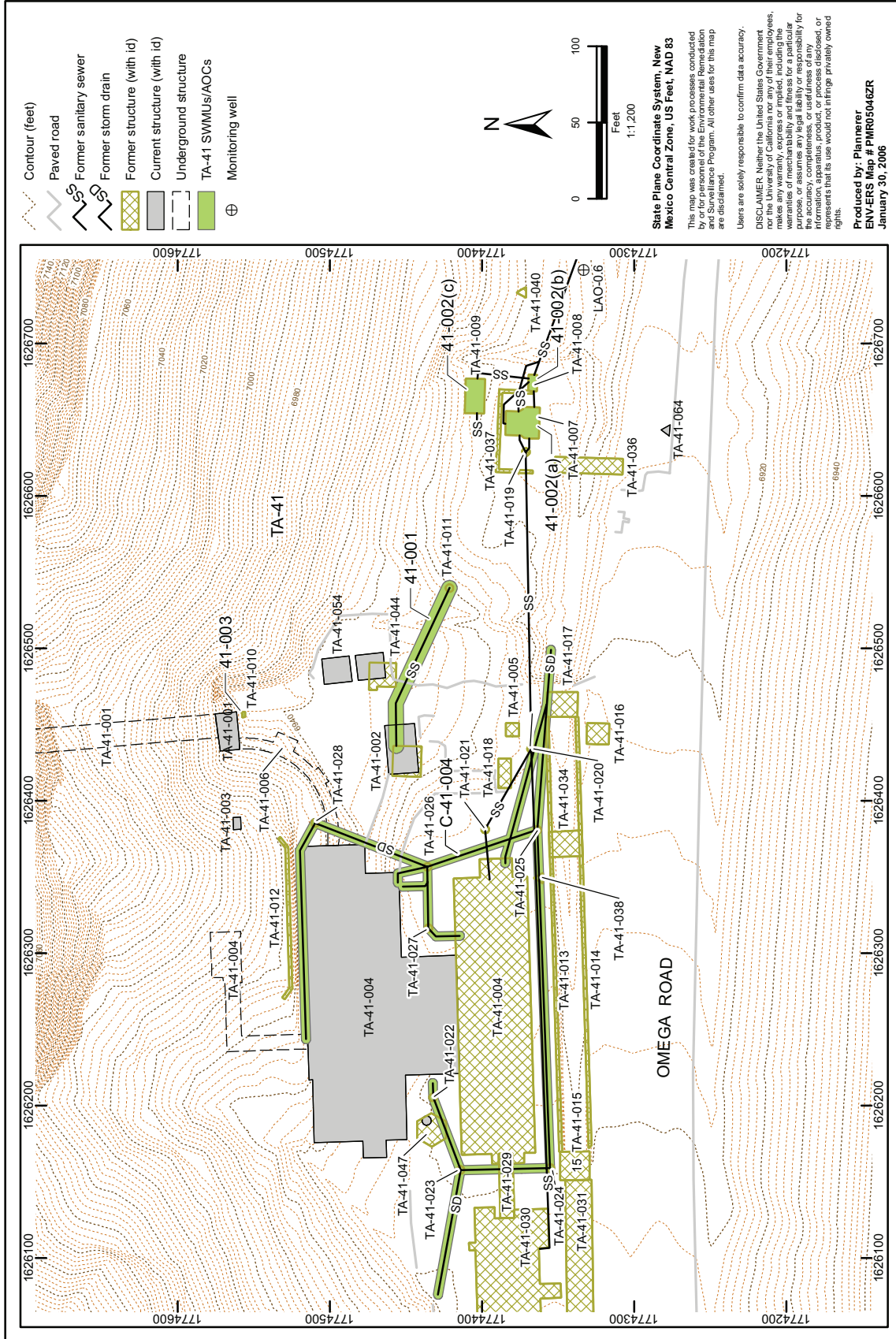

Figure 7.1-1. TA-41 site map



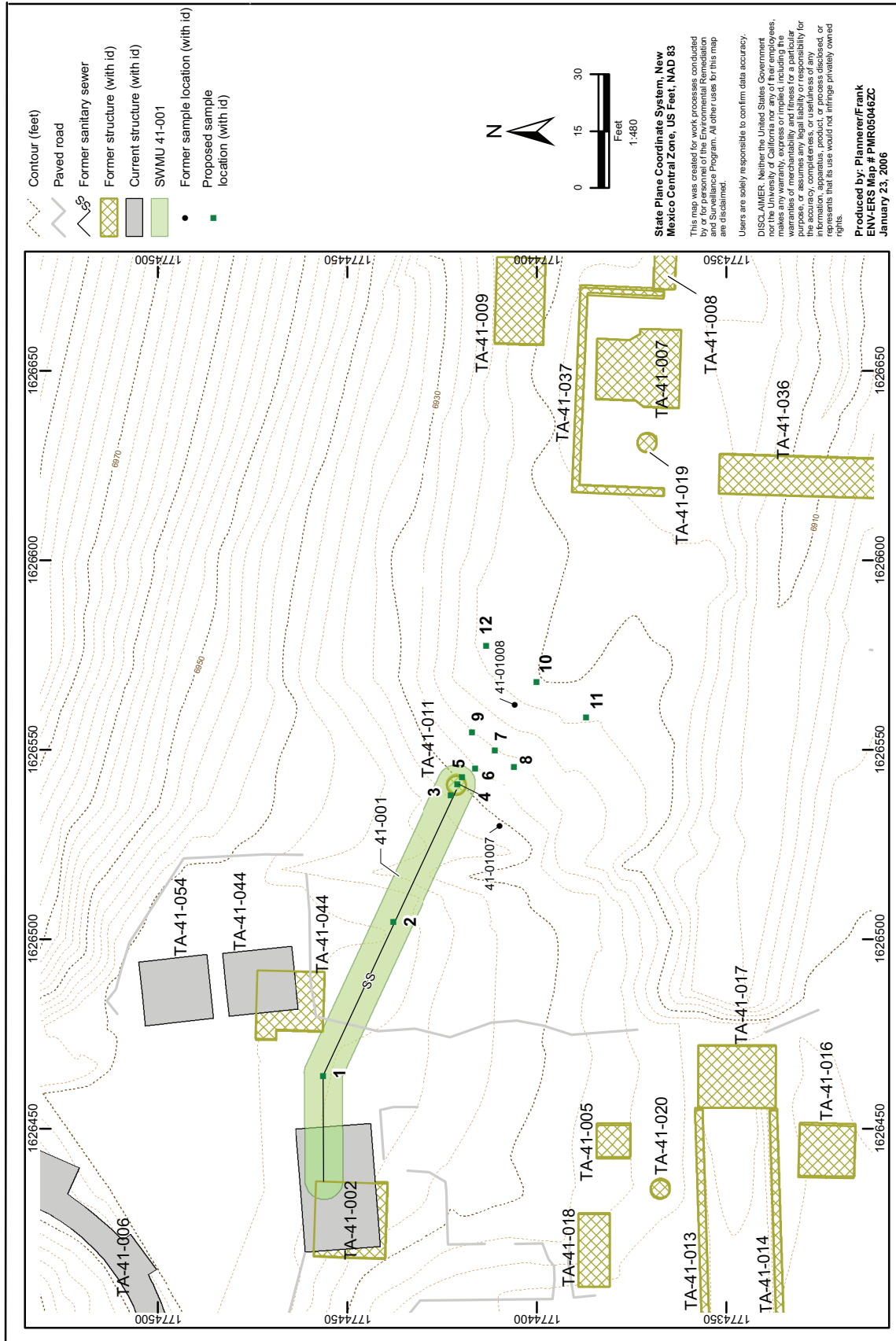

Figure 7.2-1. SWMU 41-001 site map and proposed sample locations

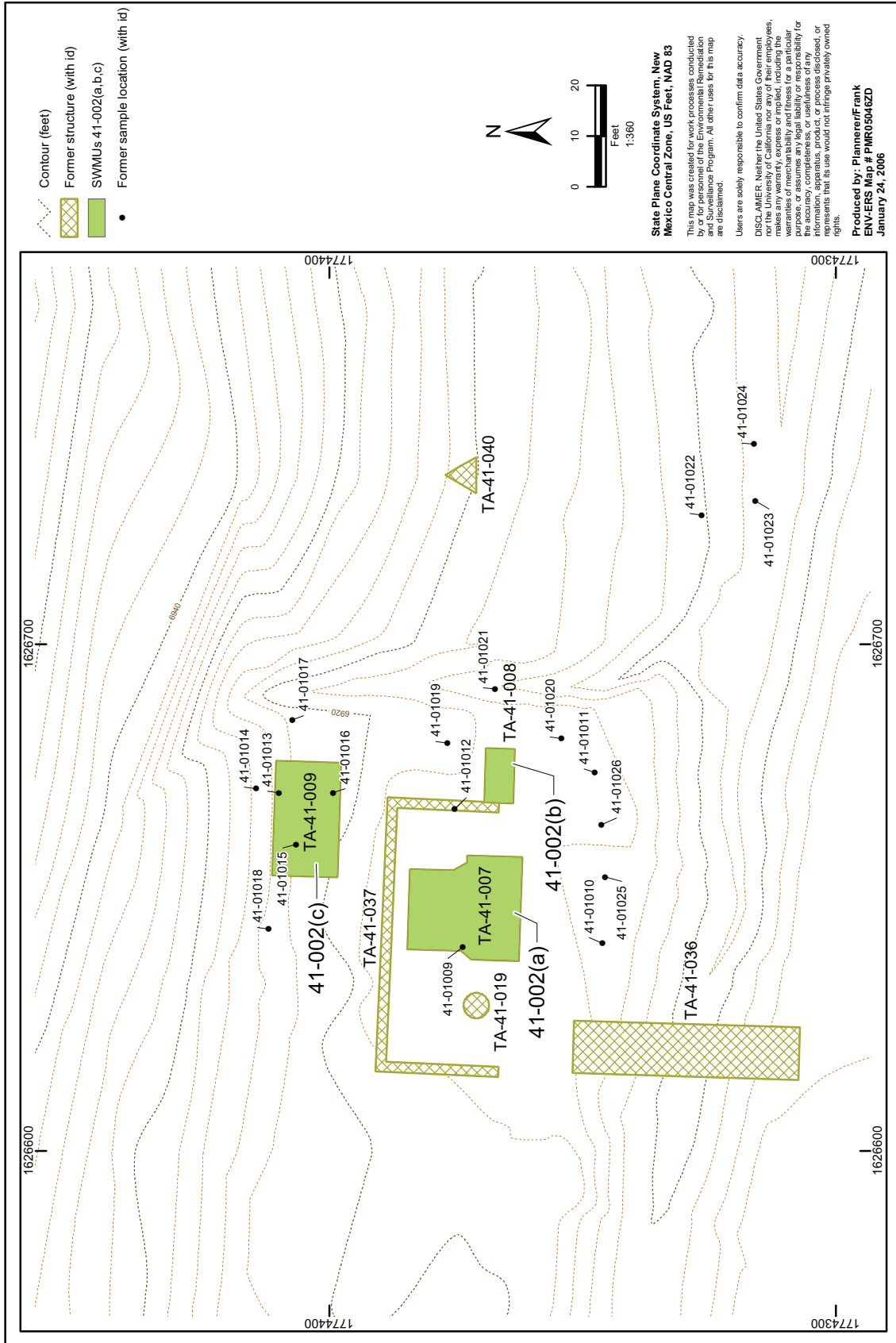

Figure 7.3-1. SWMUs 41-002(a,b,c) site map

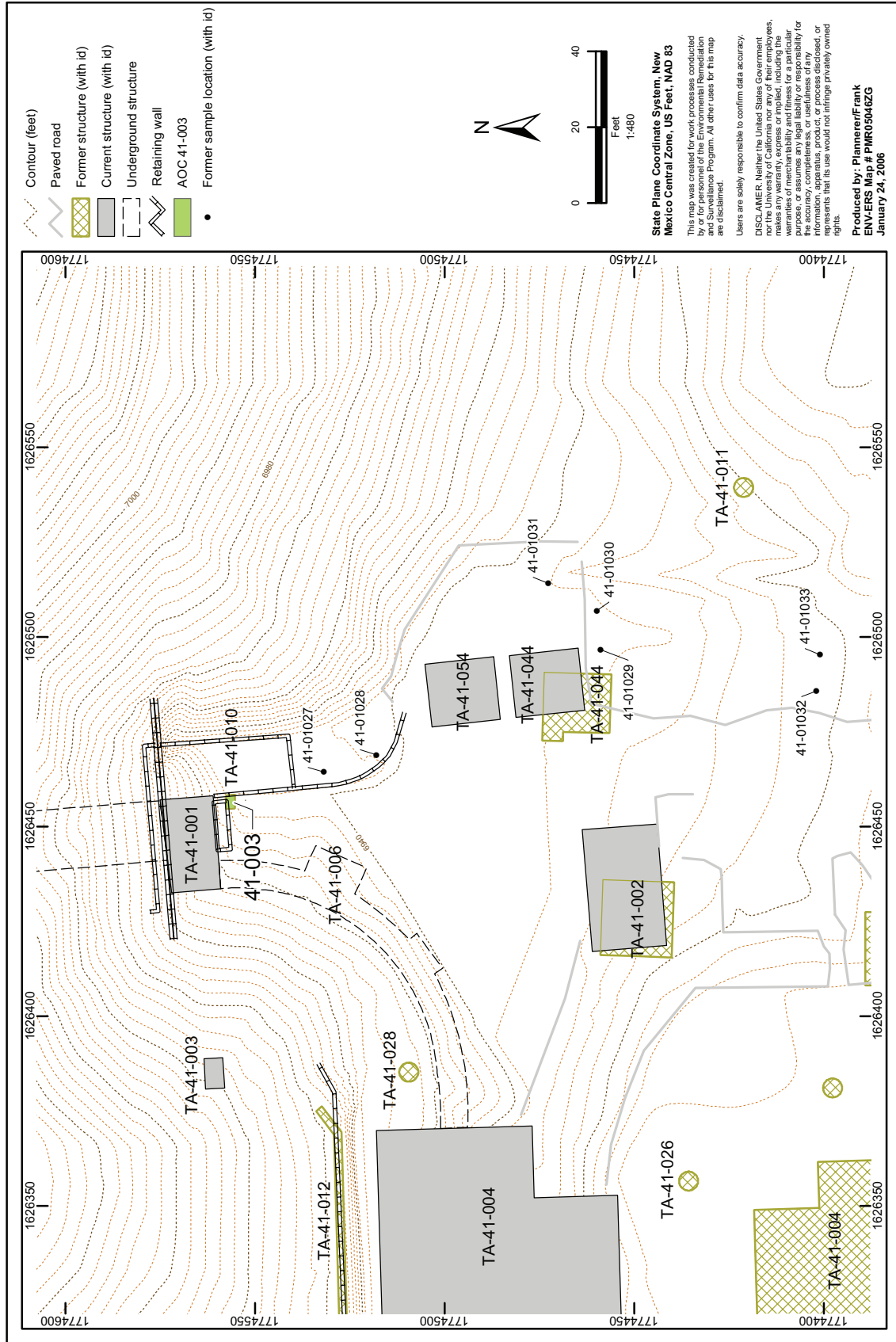

Figure 7.4-1. AOC 41-003 site map



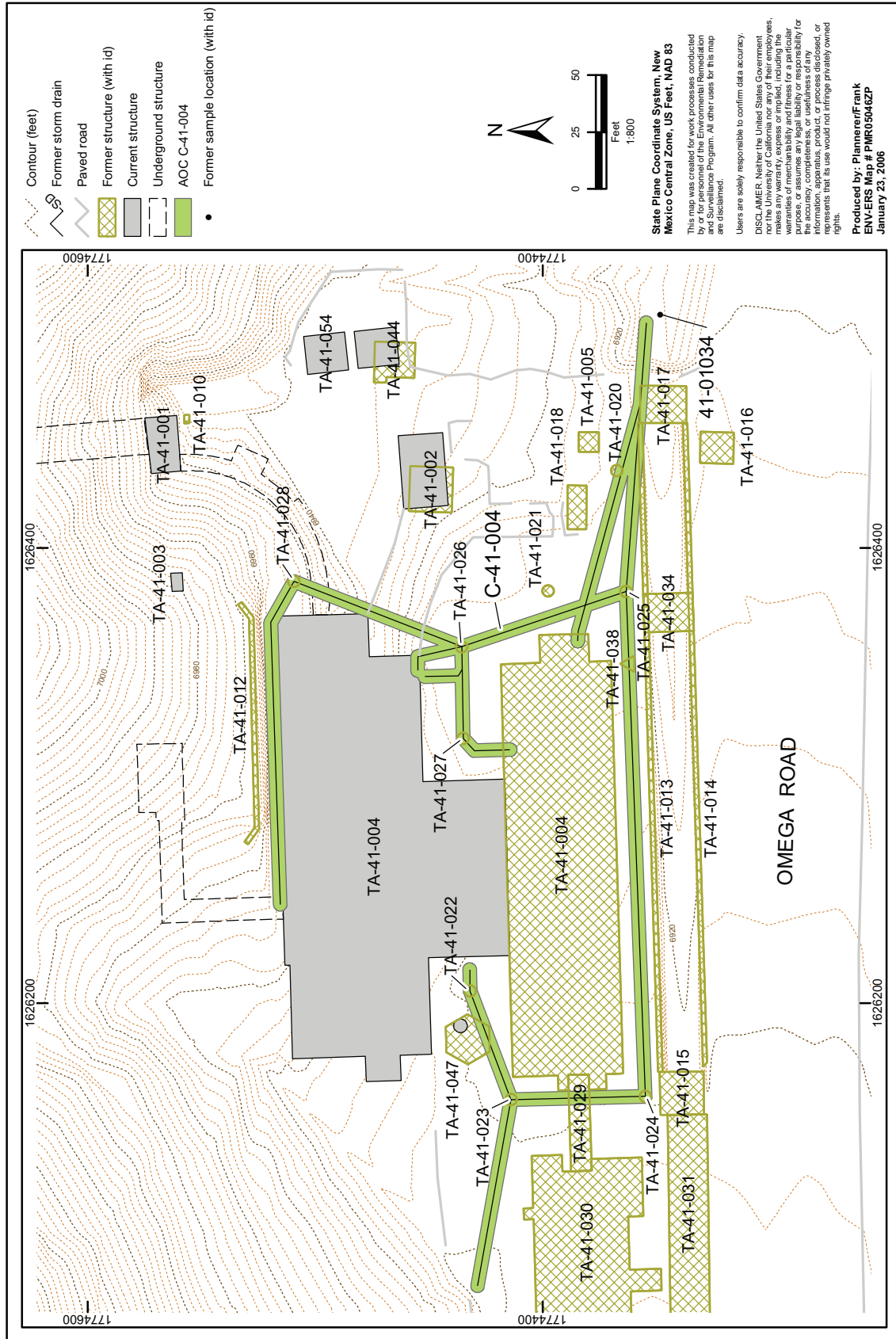

Figure 7.5-1. AOC C-41-004 site map



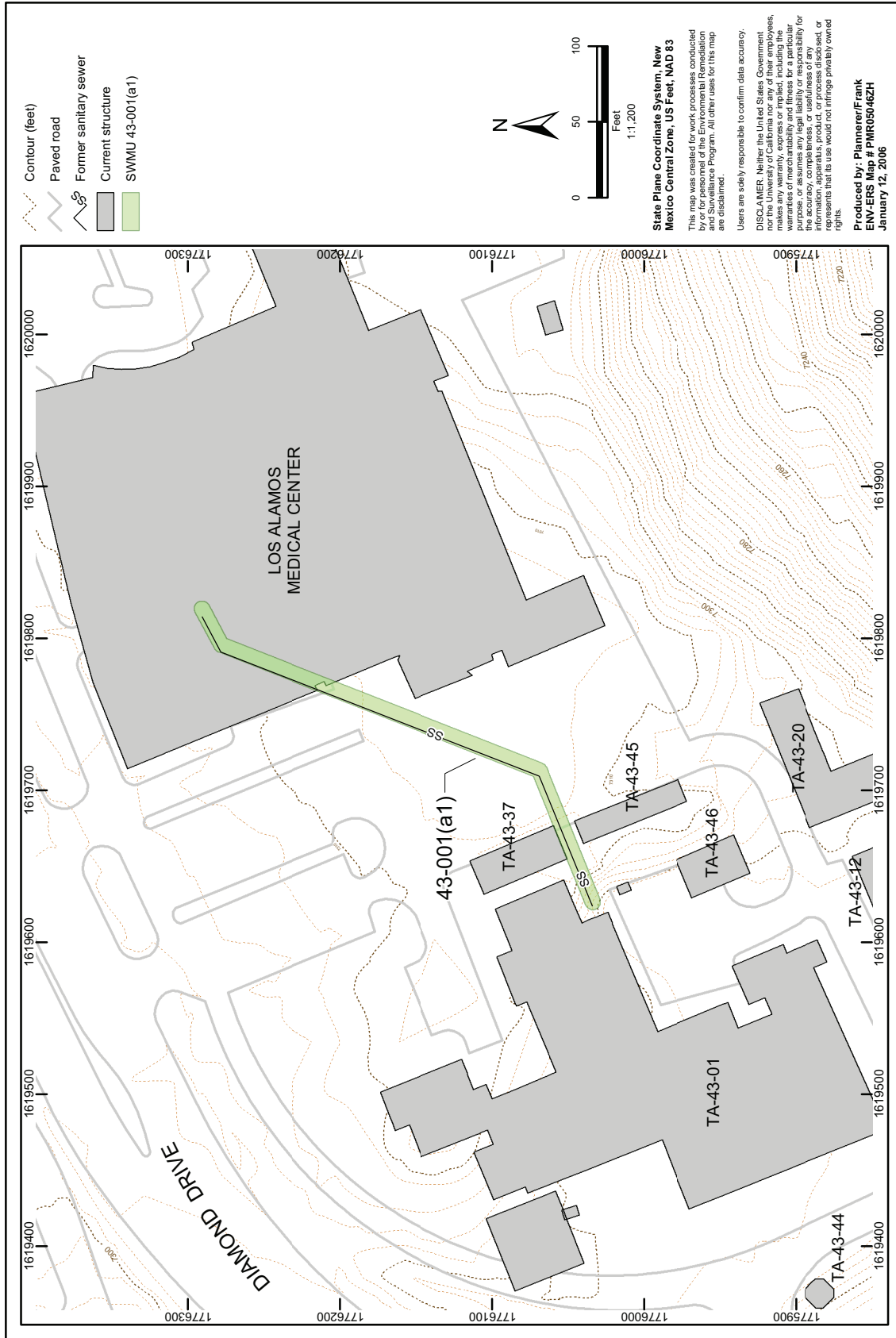

Figure 8.2-1. SWMU 43-001(a1) site map



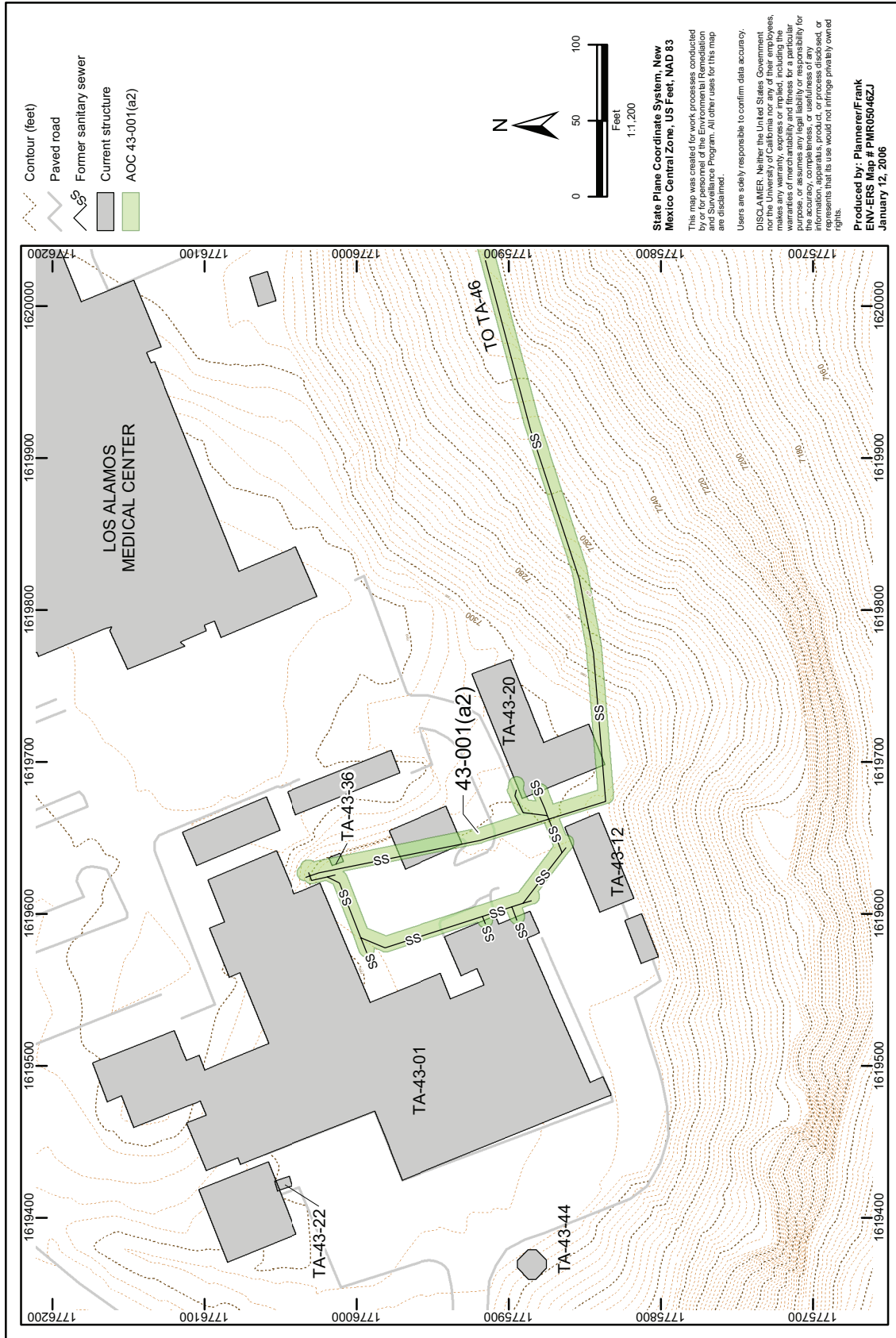
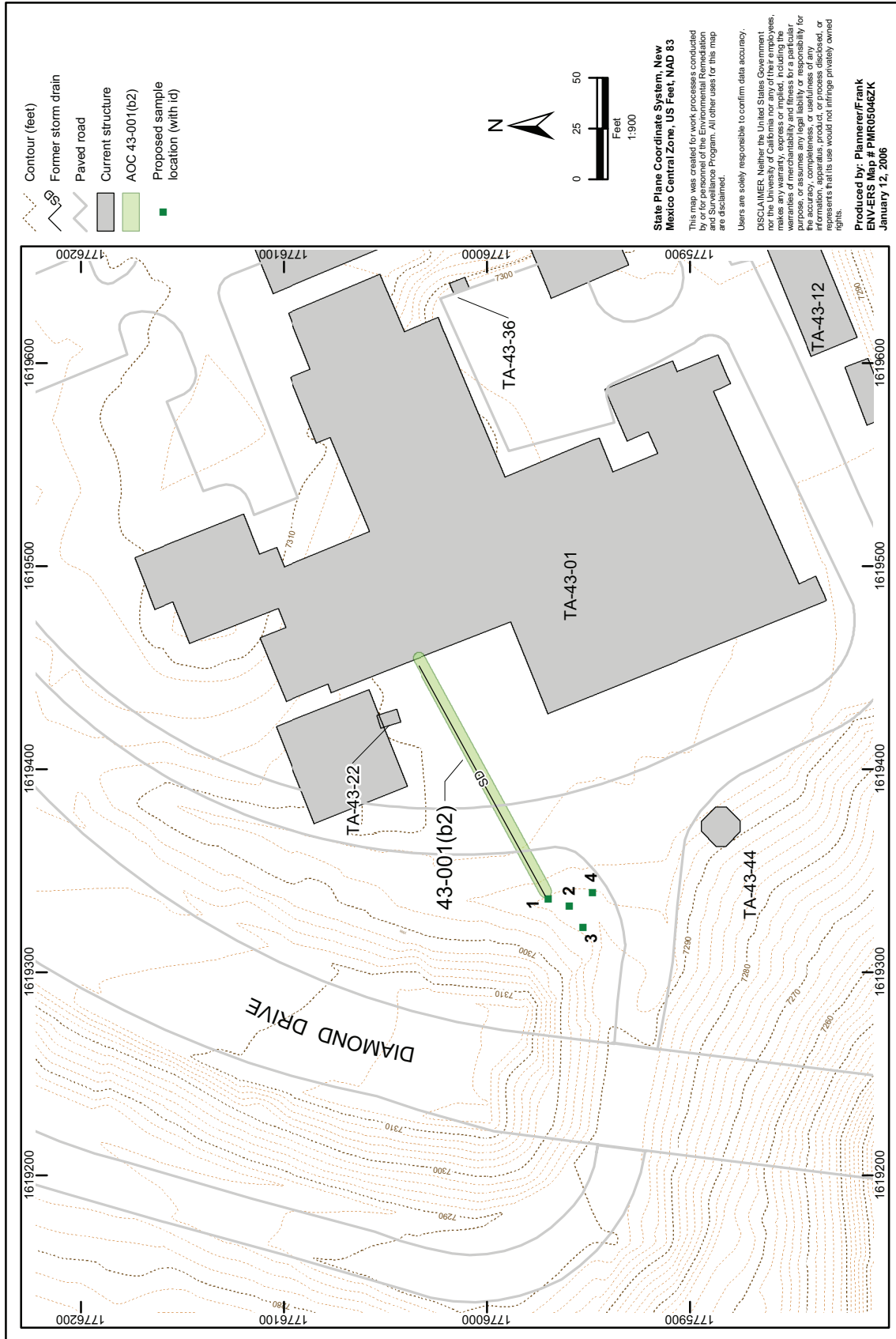

Figure 8.3-1. AOC 43-001(a2) site map



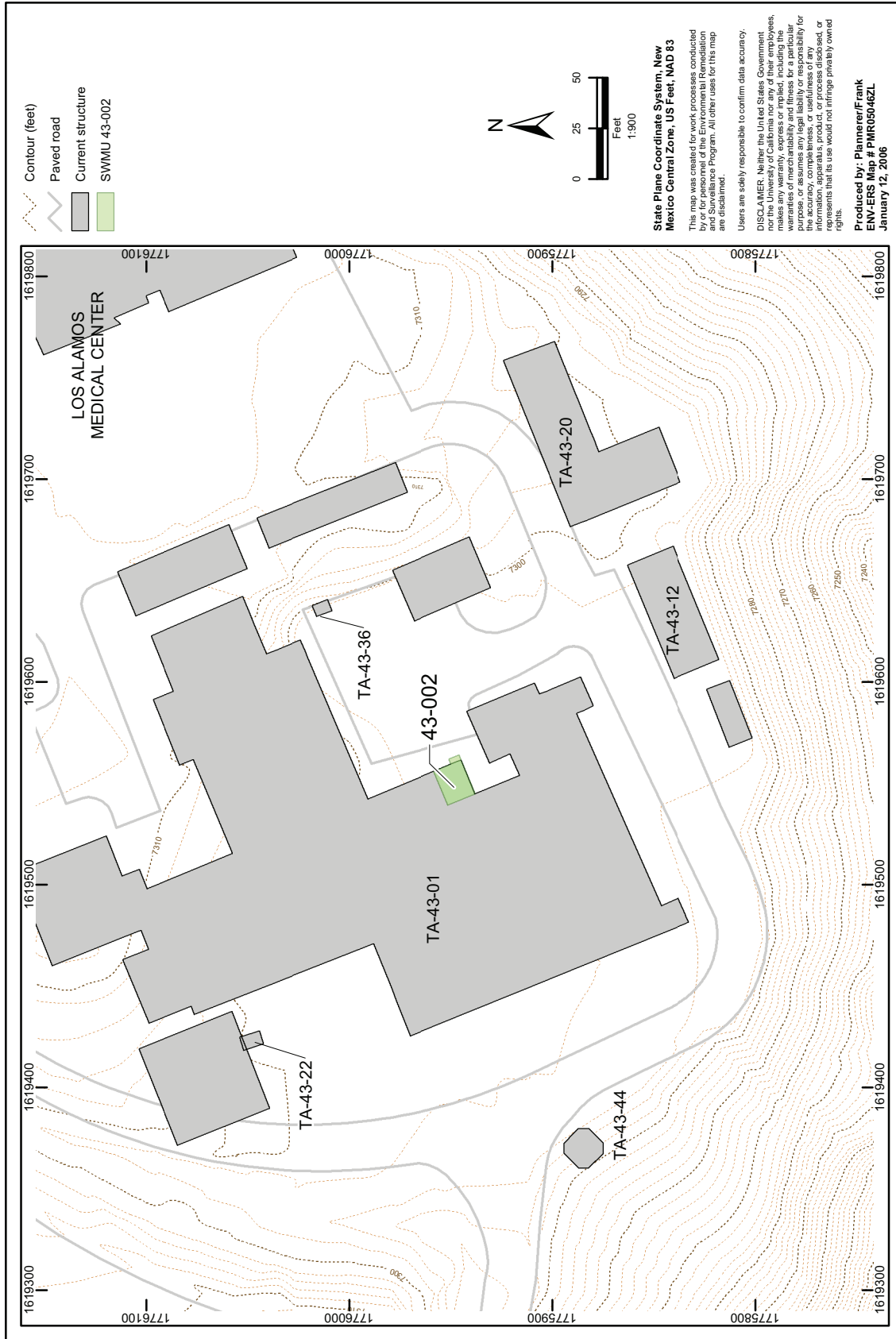

Figure 8.5-1. SWMU 43-002 site map



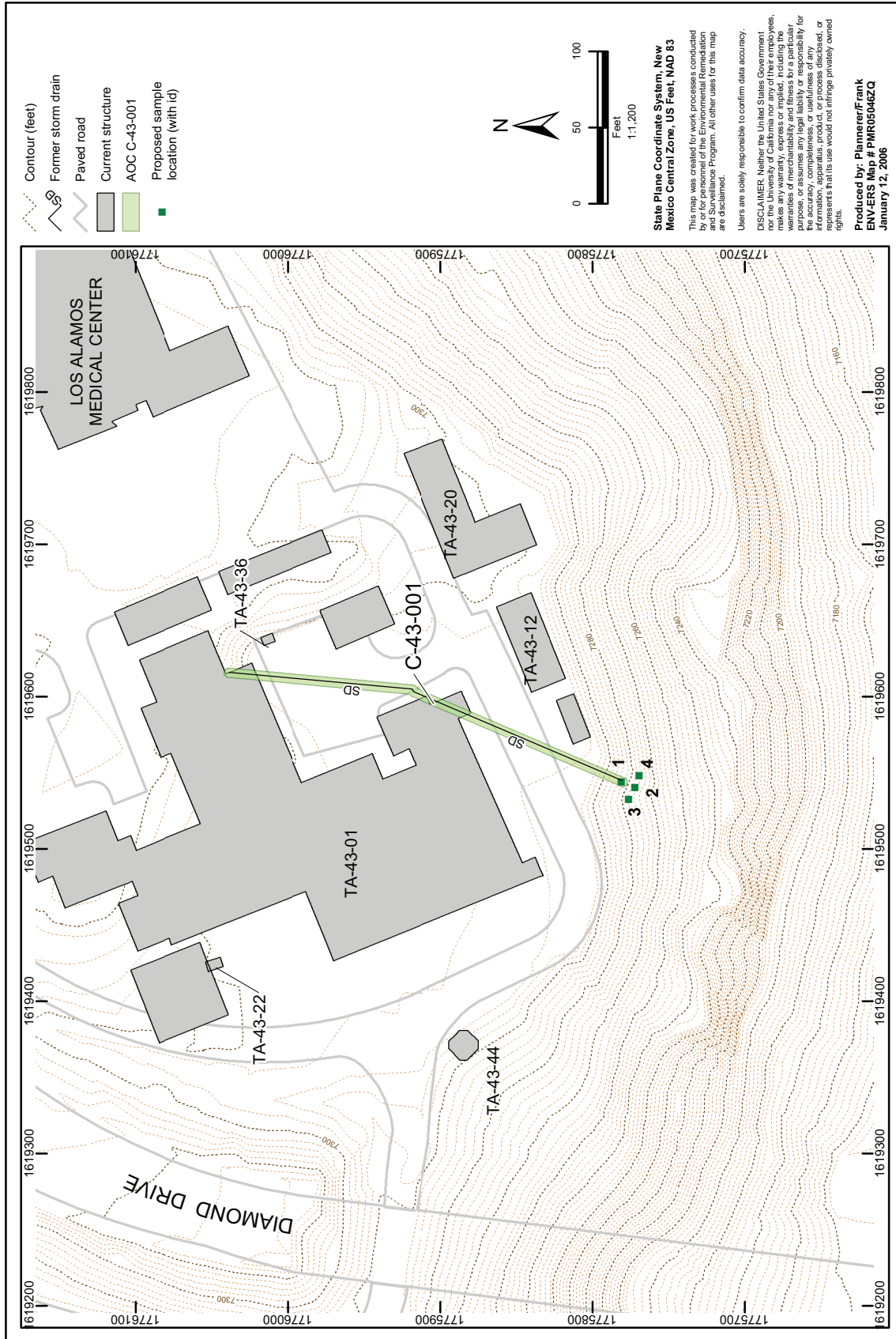

Figure 8.6-1. AOC C-43-001 site map and proposed sample locations

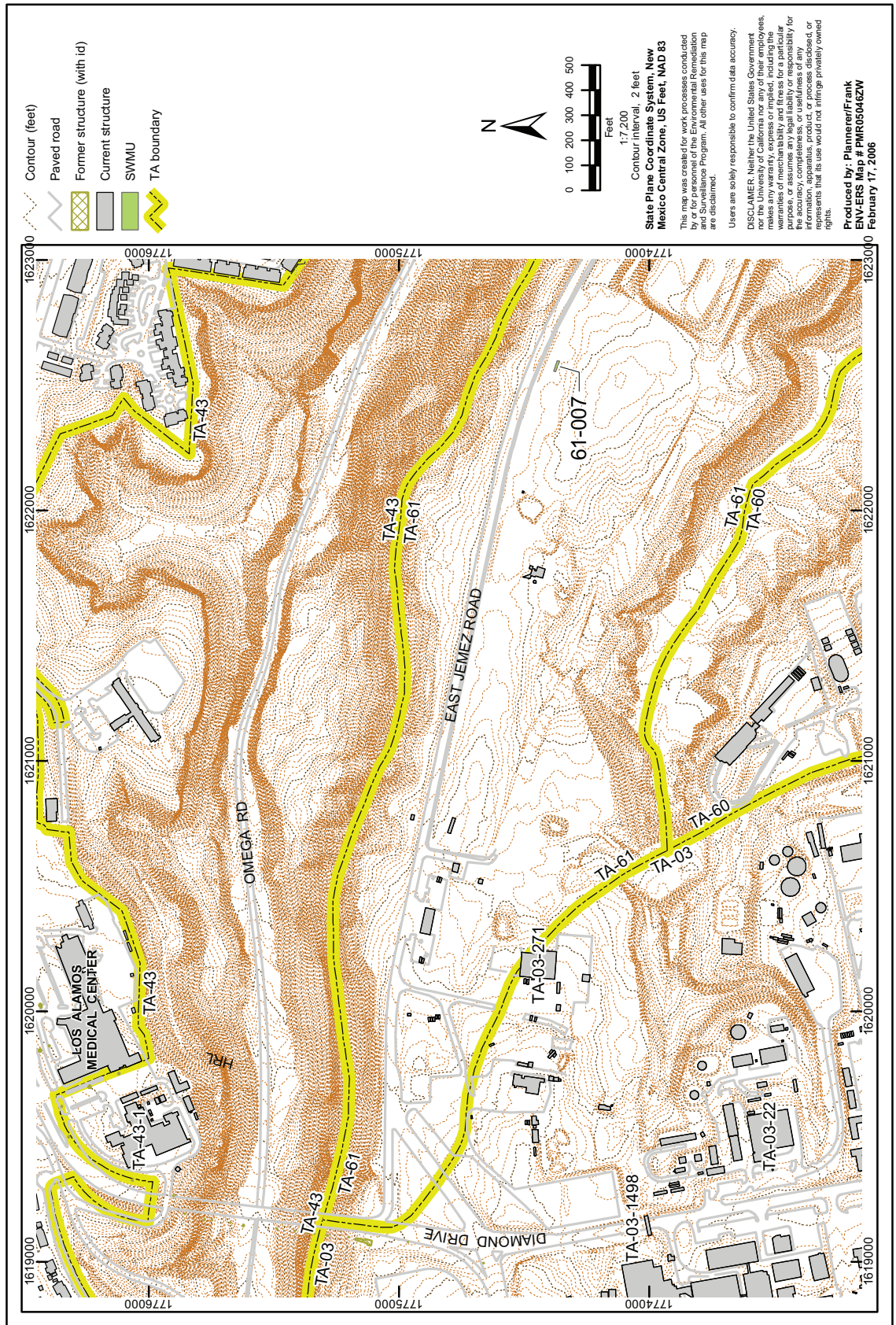

Figure 9.1-1. TA-61 site map



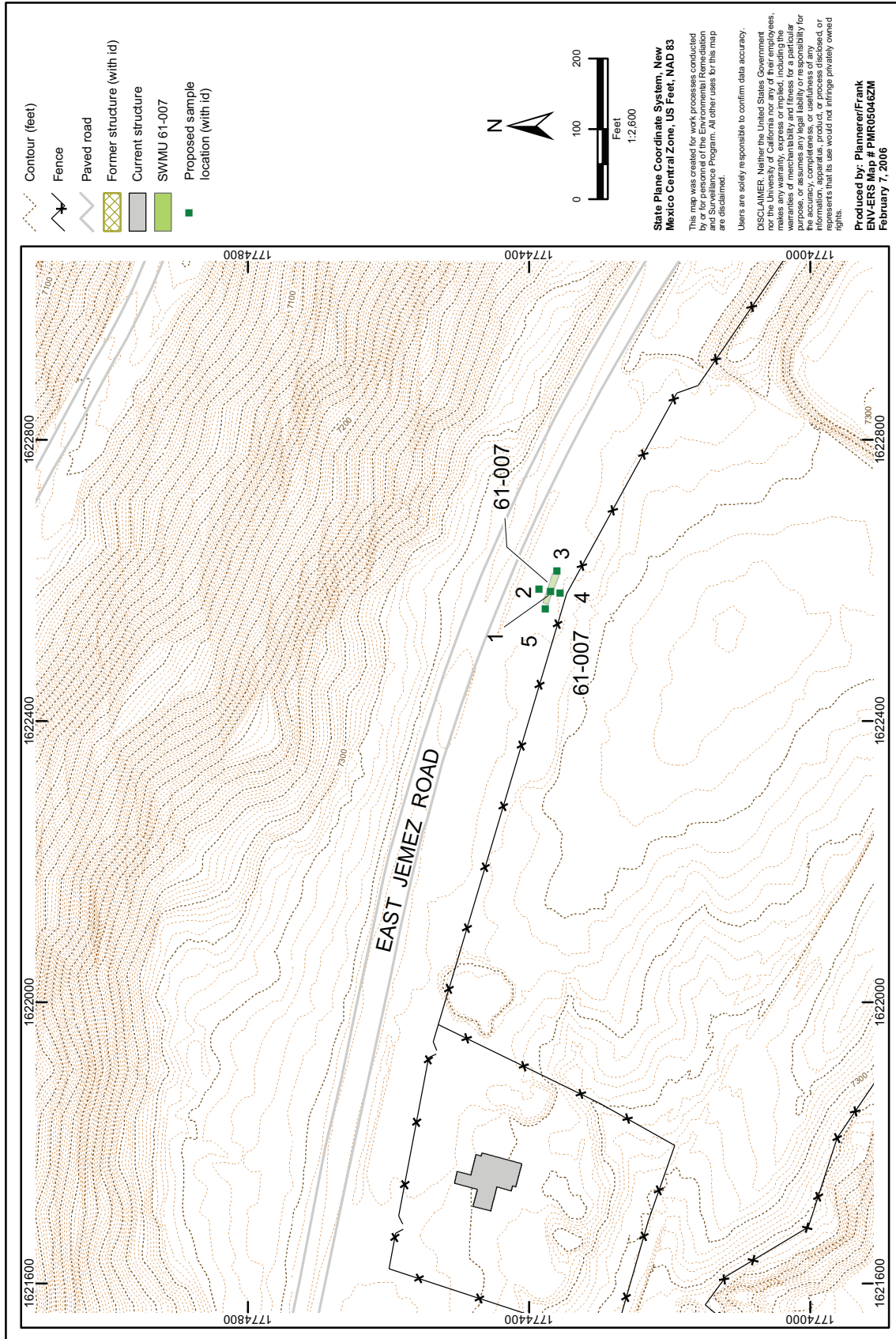

Figure 9.2-1. SWMU 61-007 site map and proposed sample locations



This page intentionally left blank.