



the National Weather Center

The National Weather Center houses a unique confederation of University of Oklahoma, National Oceanic and Atmospheric Administration and state organizations that work together in partnership to improve understanding of events occurring in Earth's atmosphere over a wide range of time and space scales.

NWC Facts

- ❖ The National Weather Center sits on a 22-acre site on the NE corner of Jenkins and Highway 9 in Norman, Oklahoma.
- ❖ The building was designed by Beck – LAN/Daly, a joint venture between Beck Associates Architects and LAN/Daly. Oscar J. Boldt Company was the general contractor. Burns & MacDonnell Architects assisted in the development of NOAA program and facility requirements and construction oversight.
- ❖ Ground breaking was held in November 2002 and bids were taken in early Spring 2003. Construction began August 2003. The building opened in summer 2006, with building dedication on September 29, 2006.
- ❖ The NWC is an OU building with NOAA as the primary tenant. OU and NOAA have expended a total of \$69 million to construct and occupy the building.
- ❖ The building is 244,000 square feet with five stories plus a rooftop outdoor classroom and enclosed weather observation deck.
- ❖ The exterior is made up of face brick, architectural cast stone, metal-faced composite panels, and glass curtain walls.
- ❖ The NWC houses about 550 people. This includes research scientists, operational meteorologists and climatologists, engineers and technicians, support staff, and graduate and undergraduate students.



Building Configuration

1st Floor - Administration, Visitors Center, Food Court, Research Vehicle/Equipment Bay, Auditorium

2nd Floor - Operations, Administration

3rd Floor - Computing, Research, Training, Administration

4th Floor - Research, Academics, Training

5th Floor - Academics

Rooftop Outdoor Classroom

Enclosed Weather Observation Deck

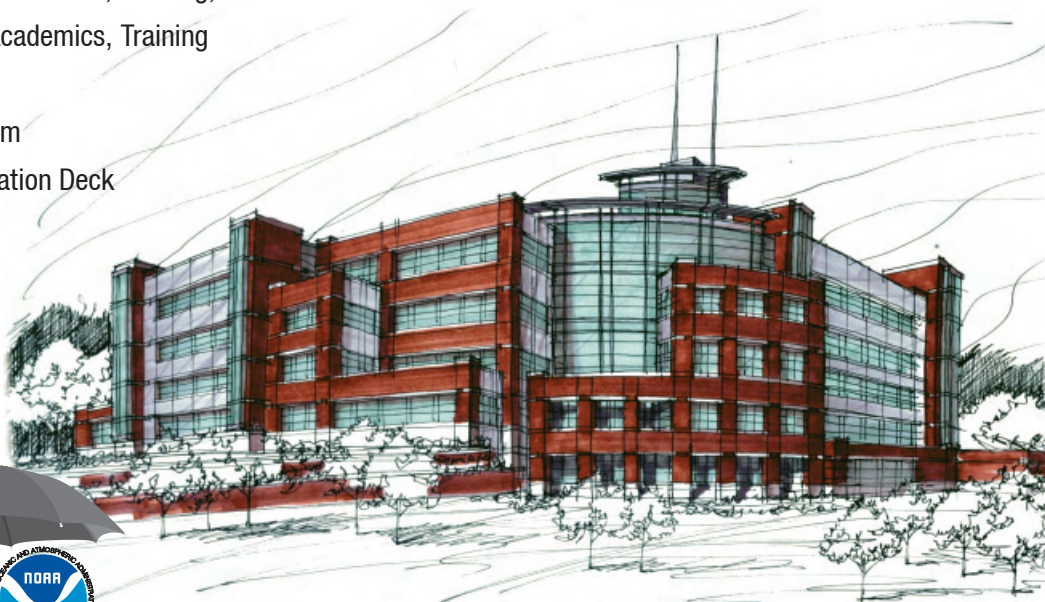
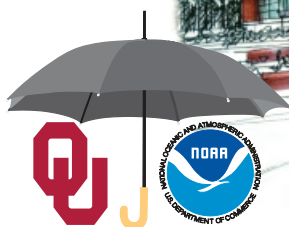

NWC Tenants

NOAA Weather Partners (www.norman.noaa.gov)

National Severe Storms Laboratory (www.nssl.noaa.gov)

National Weather Service Norman Forecast Office (www.srh.noaa.gov/oun)

Radar Operations Center Applications Branch (www.roc.noaa.gov)

Storm Prediction Center (www.spc.noaa.gov)

Warning Decision Training Branch (www.wdtb.noaa.gov)

University Weather and Climate Programs

College of Atmospheric & Geographic Sciences (ags.ou.edu)

School of Meteorology (weather.ou.edu)

Center for Analysis and Prediction of Storms (www.caps.ou.edu)

Center for Spatial Analysis (www.csa.ou.edu)

Cooperative Institute for Mesoscale Meteorological Studies (www.cimms.ou.edu)

Center for Natural Hazard and Disaster Research (nhdr.ou.edu)

Oklahoma Climatological Survey (www.ocs.ou.edu)

For more information contact:

Sarah Swift, OU College of Atmospheric and Geographic Sciences, (405) 325-1819, sswift@ou.edu

Keli Tarp, NOAA Public Affairs, (405) 325-6933, keli.tarp@noaa.gov

National Weather Center
120 David L. Boren Blvd.
Norman, OK 73072
<http://www.nwc.ou.edu/>



September 2006