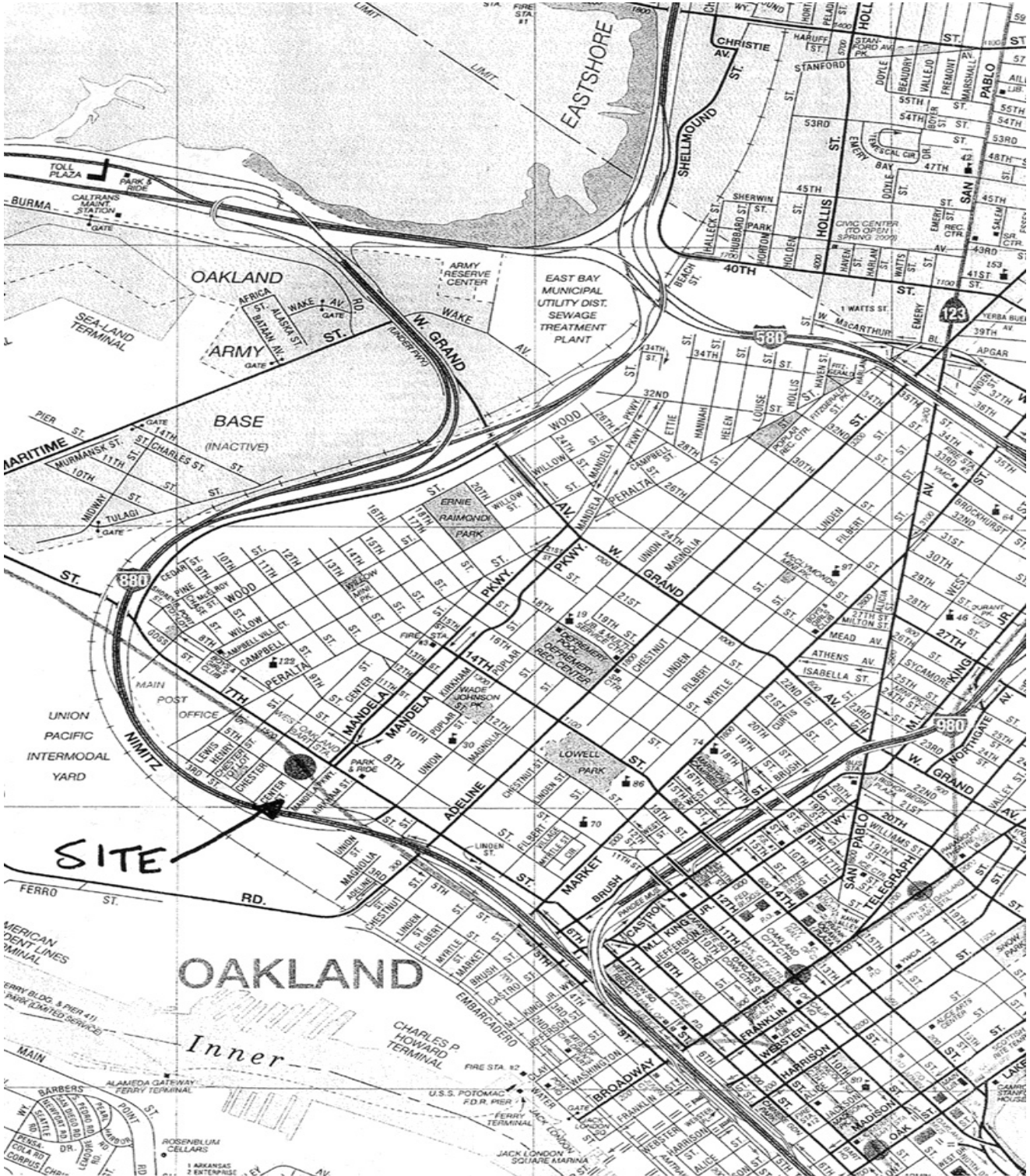


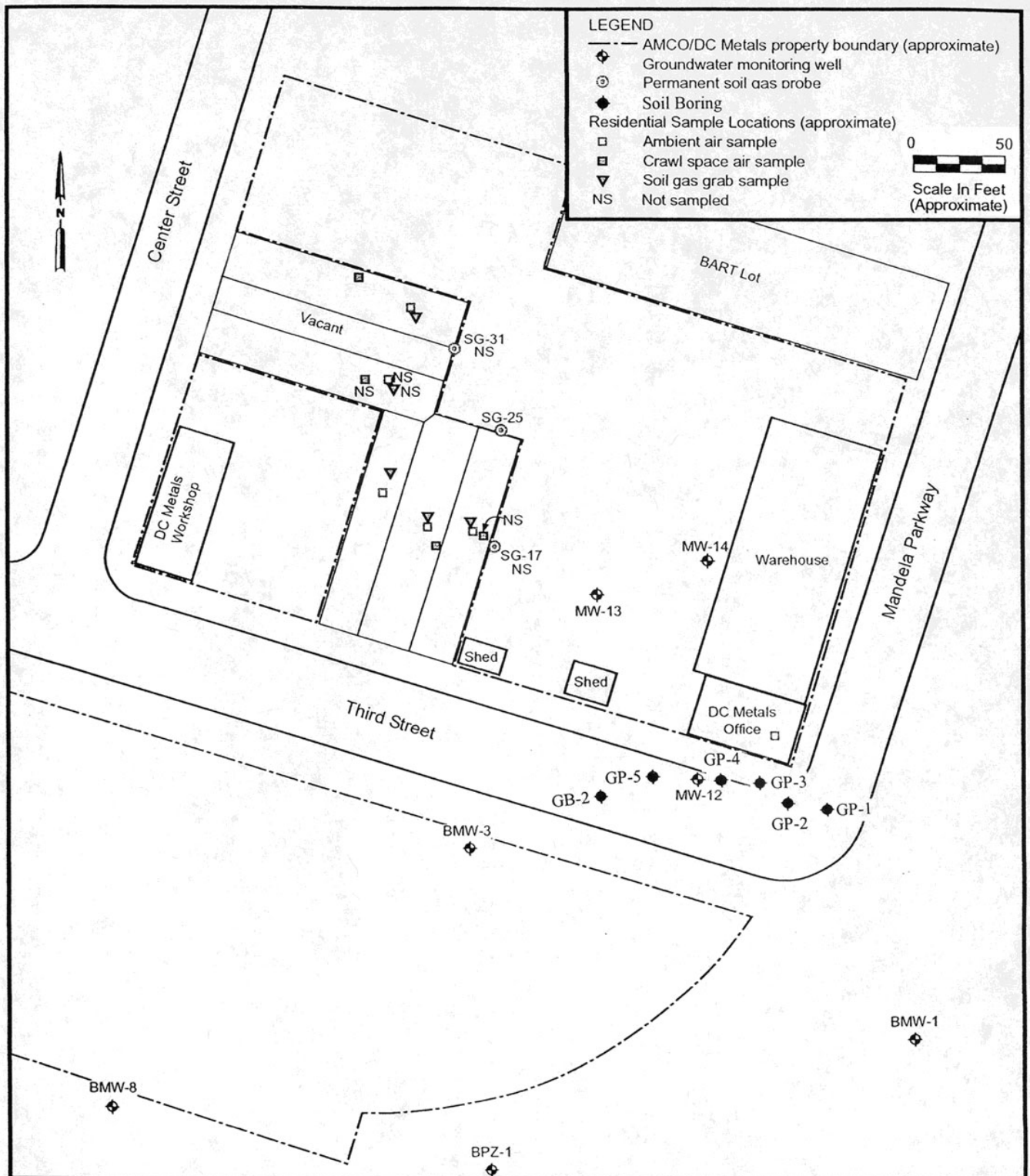
## **Appendix A—Figures**

**Figure 1. Amco Chemical Site, 1414 Third Street, Oakland, California**  
(Source: American Automobile Association)

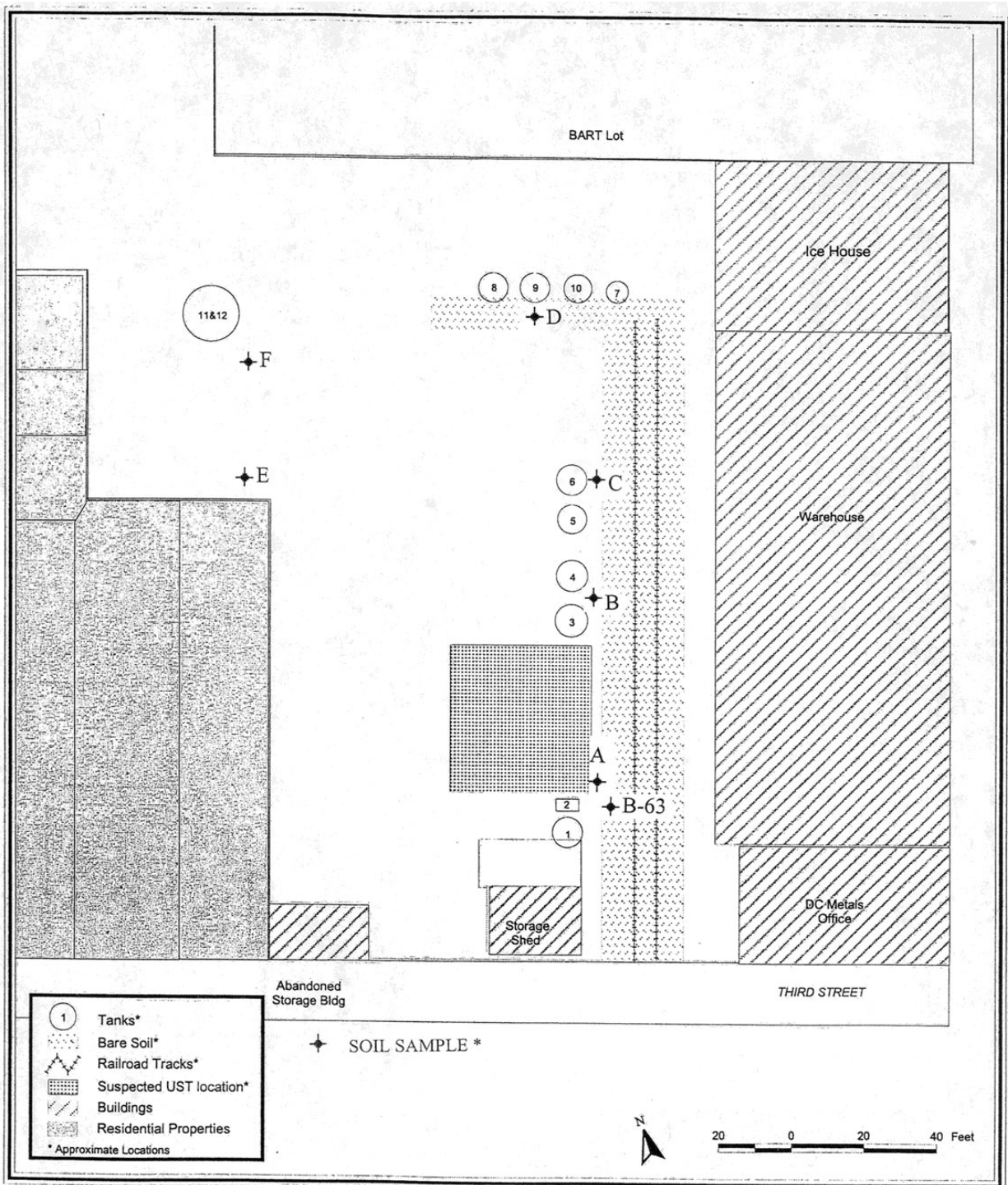


**Figure 2. Amco Chemical Site Map with Sampling Locations, Oakland, California**

(Source: U.S. Environmental Protection Agency 2002 Data Evaluation Report)



**Figure 3. Amco Chemical Site Map Circa 1986 with Sampling Locations, Oakland, California** (Source: Ecology & Environment, Inc. Preliminary Assessment/Site Investigation Report, August 2001)



**Figure 4. Amco Chemical Site Subsurface Soil Sampling Locations, 1999, Oakland, California**  
(Source: Ecology & Environment, Inc. Preliminary Assessment/Site Investigation Report, August 2001)

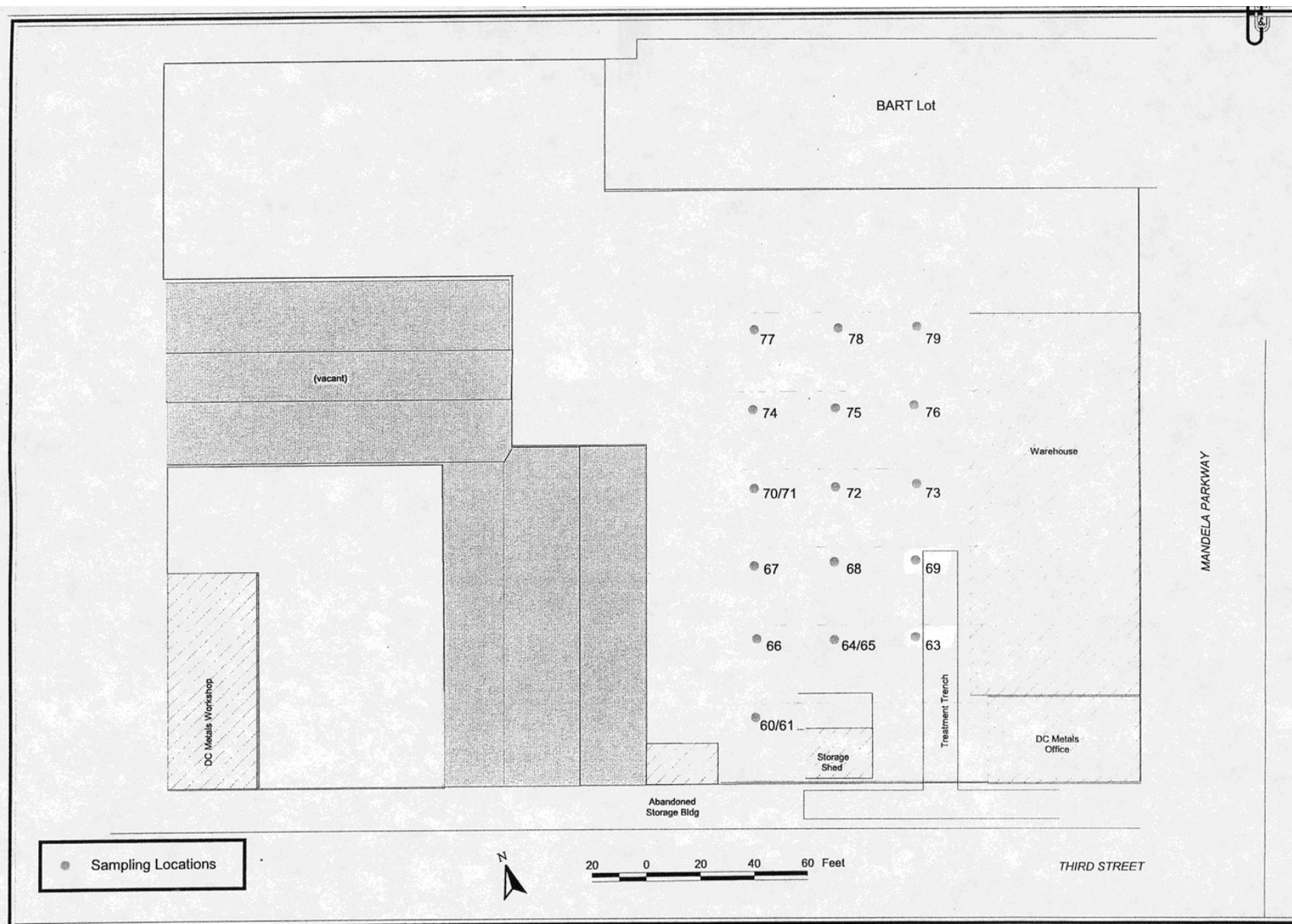
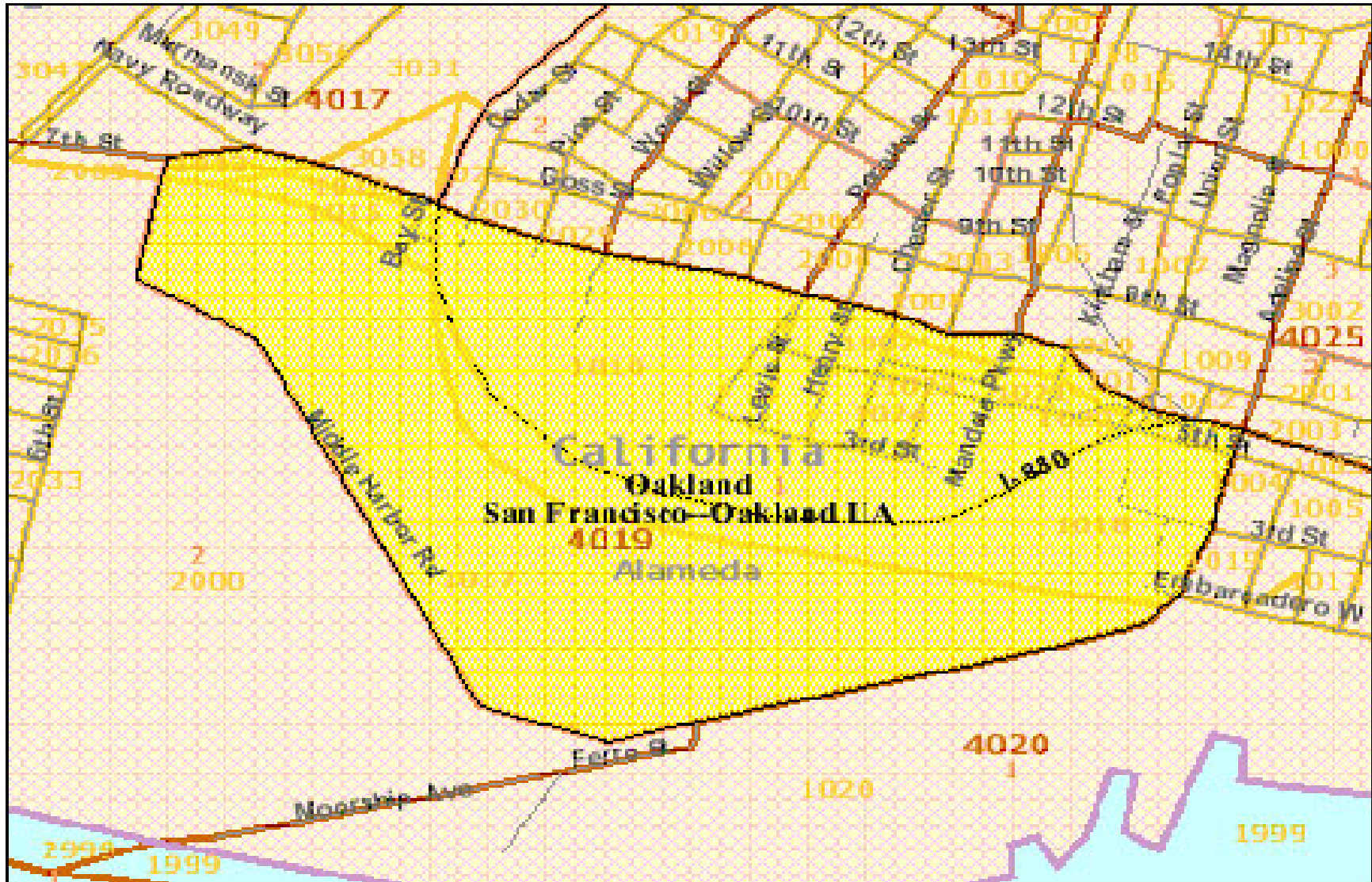
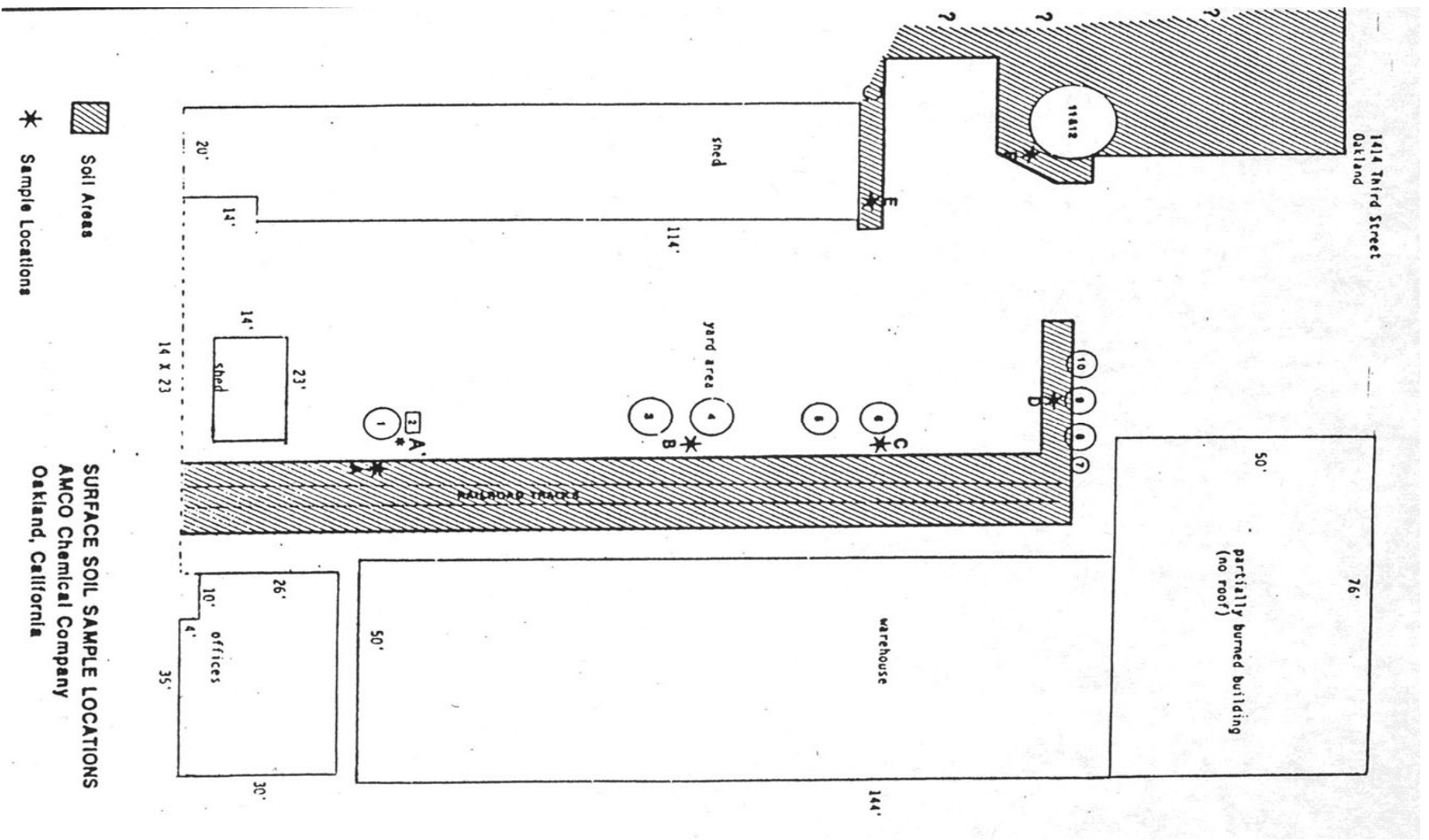


Figure 5. Block Group 1, Census Tract 4019, Alameda County, Oakland, California

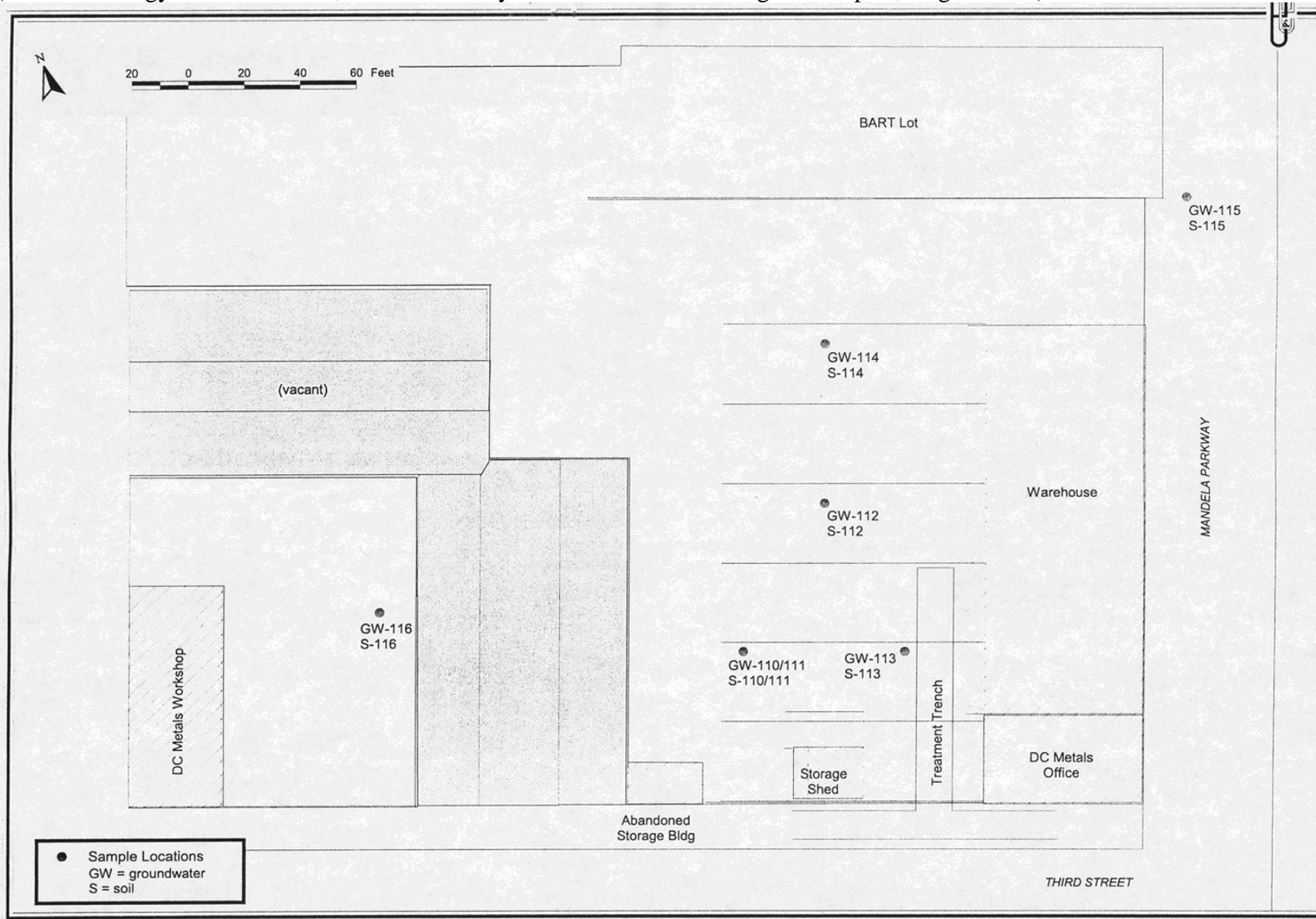
(Source: [http://factfinder.census.gov/servlet/MapItDrawServlet?geo\\_id=15000US060014019001&t...](http://factfinder.census.gov/servlet/MapItDrawServlet?geo_id=15000US060014019001&t...))



**Figure 6. Amco Chemical Site Surface Soil Sampling Locations, Oakland, California**  
 (Source: Engineering-Science Site Investigation and Soil Sampling Report, 1986)



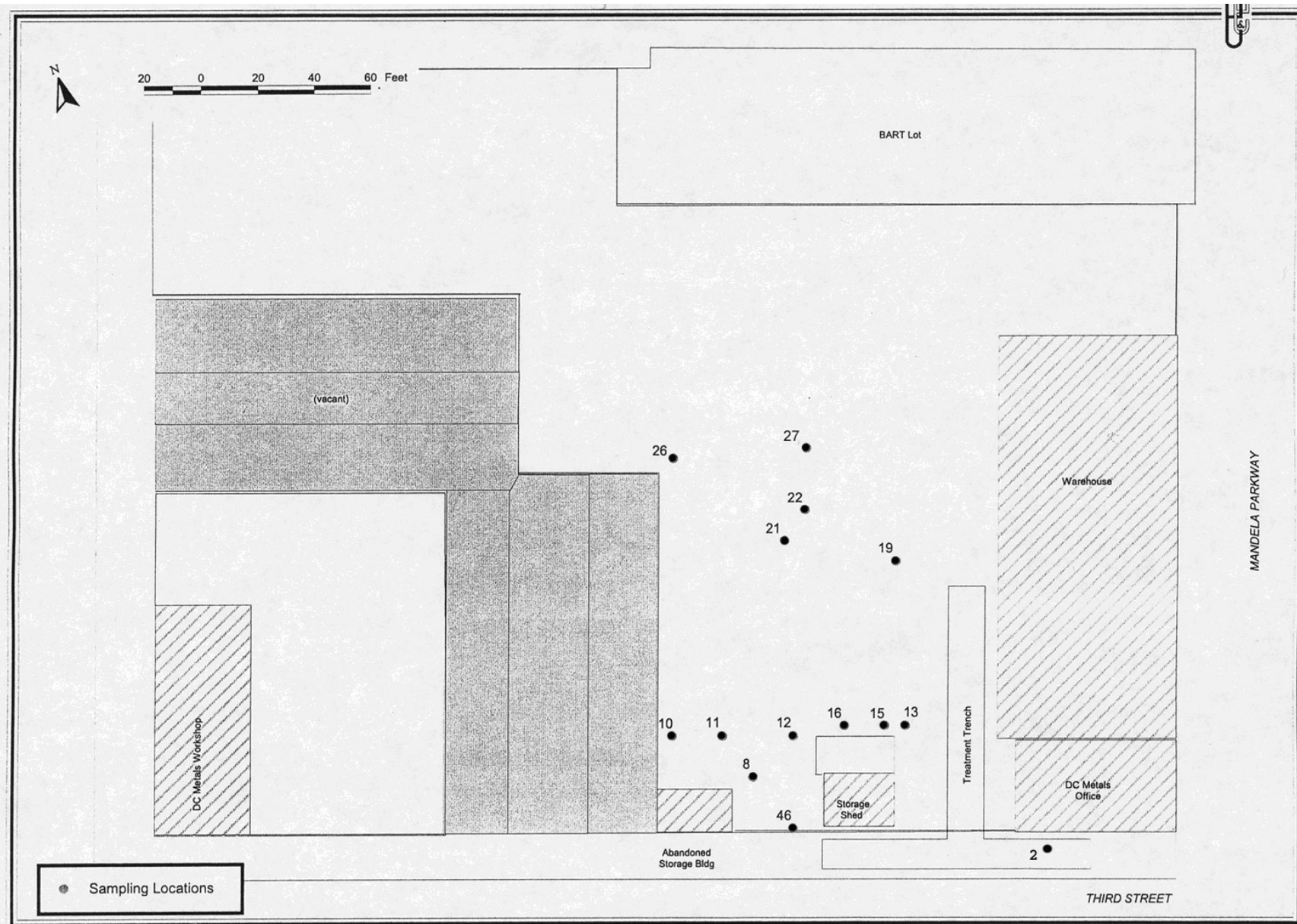
**Figure 7. Amco Chemical Site Subsurface Soil and Groundwater Sampling Locations, 2000, Oakland, California**  
 (Source: Ecology & Environment, Inc. Preliminary Assessment/Site Investigation Report, August 2001)





**Figure 8. Amco Chemical Site Soil Gas Sampling Locations, 1997, Oakland, California**

(Source: Ecology & Environment, Inc. Preliminary Assessment/Site Investigation Report, August 2001)



**Figure 9. Amco Chemical Site Groundwater Monitoring Locations, 2000, Oakland, California**  
(Source: Ecology & Environment, Inc. Preliminary Assessment/Site Investigation Report, August 2001)

