

Appendix C - Figures and Tables

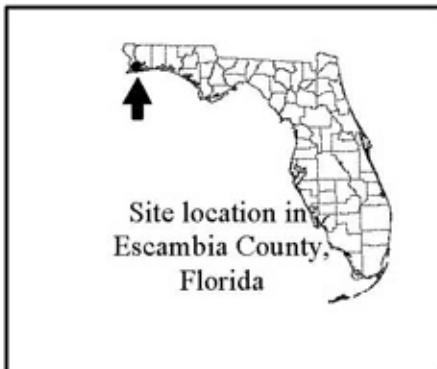
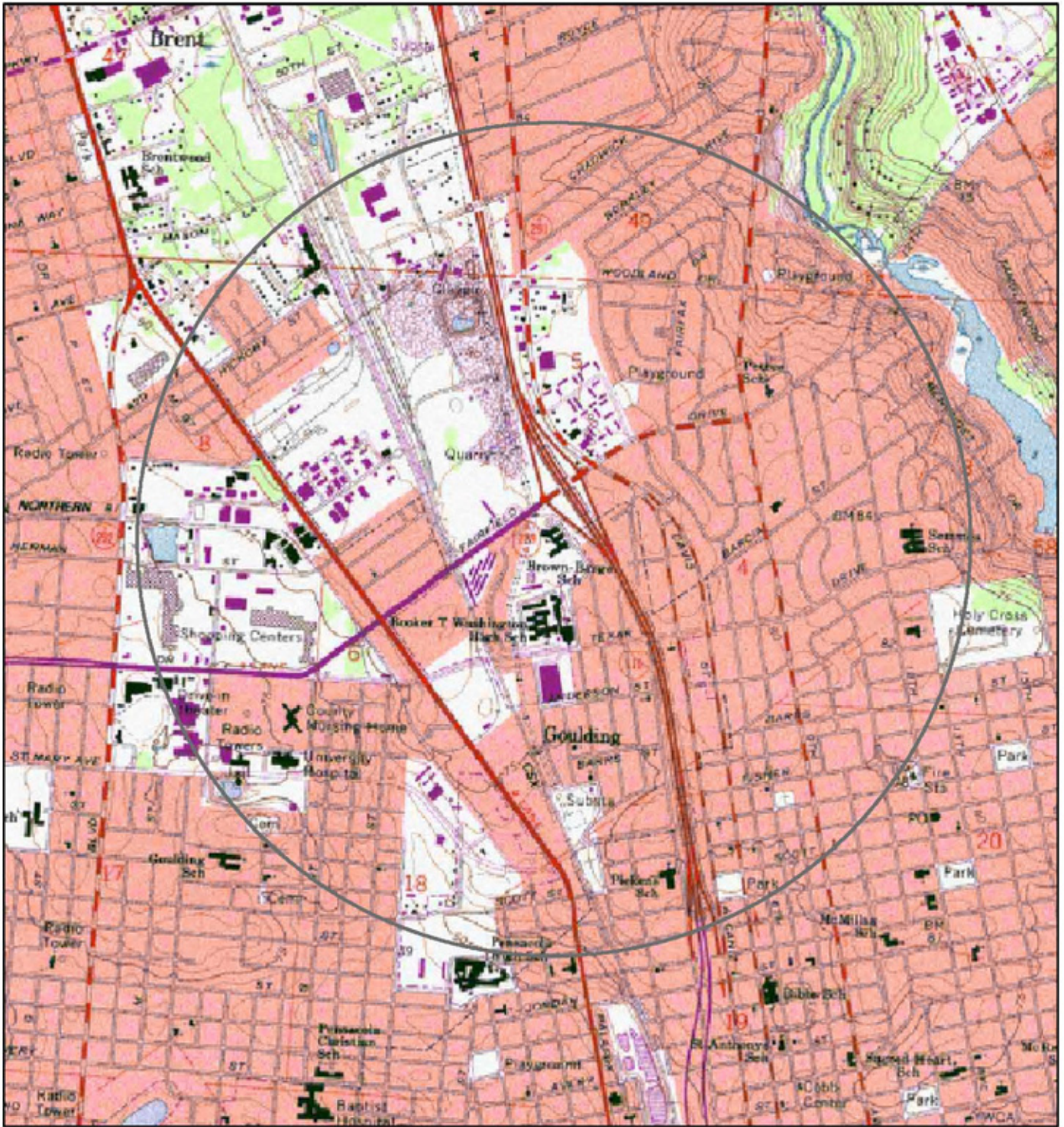
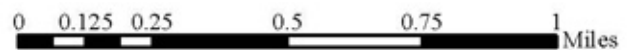

Figure 1: 1 Mile Radius from Brown Barge Middle School



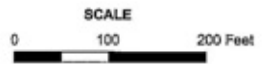
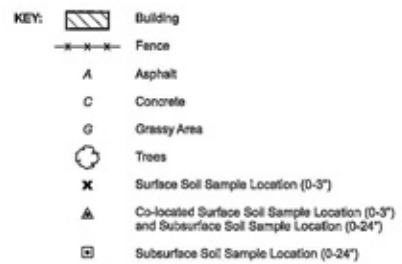
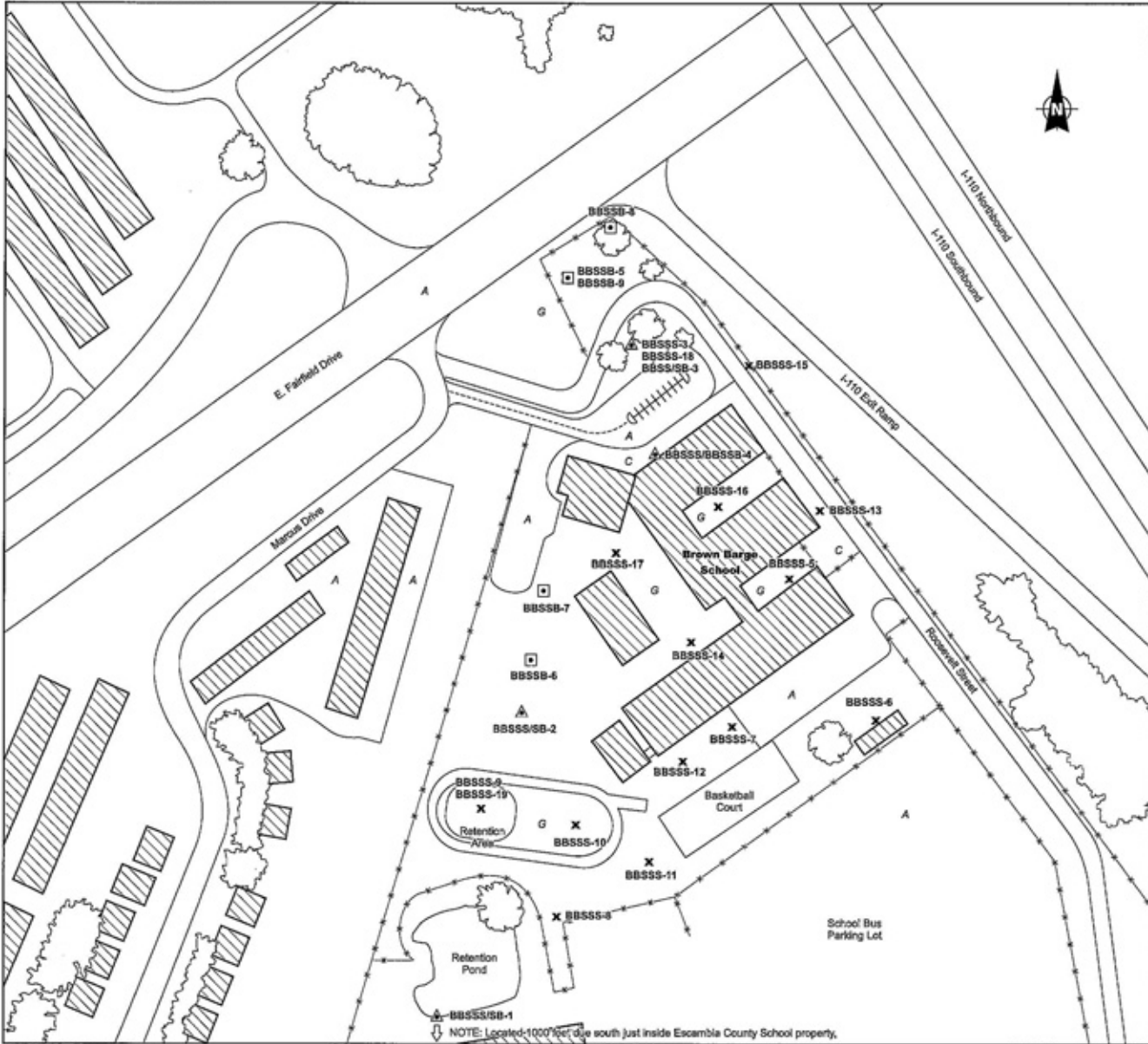
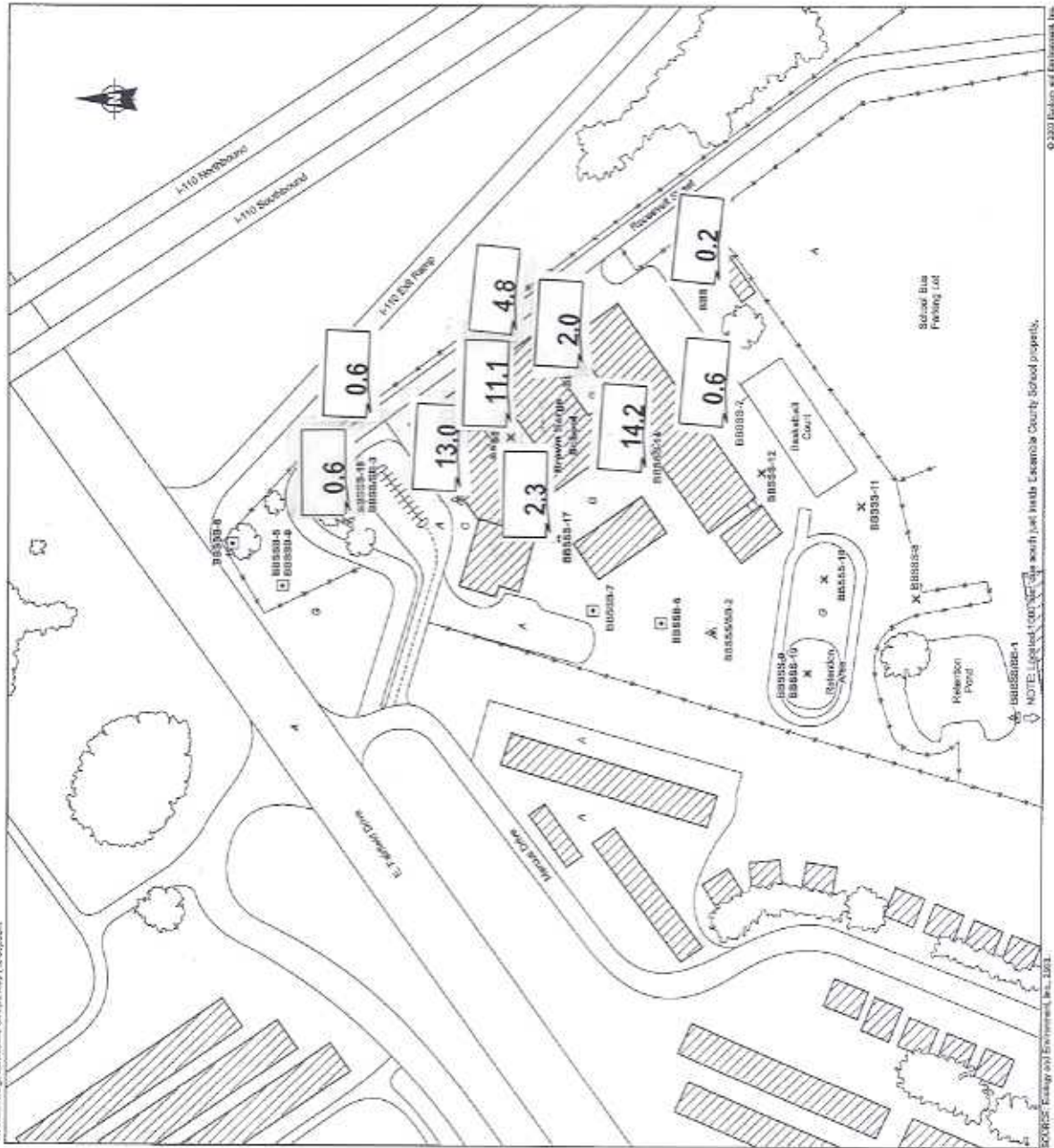

Figure 2 SOIL SAMPLE LOCATION MAP -- BROWN BARGE SCHOOL, PENSACOLA ESCAMBIA COUNTY, FLORIDA



© 2008 Lockwood Greene & Associates, Inc.

NOTE: Lockwood Greene & Associates, Inc. is not responsible for the accuracy of the information shown on this map. The information shown on this map is for informational purposes only and does not constitute an offer of insurance or any other financial product. For more information, please contact your agent.

Figure 3 PAHS ABOVE SCREENING VALUE, BY SAMPLE LOCATIONS GIVEN ON FIGURE 2 (MG/KG VALUES ROUNDED TO ONE SIGNIFICANT FIGURE) ALL OTHERS BELOW SCREENING VALUE OR SUBSURFACE SOIL

