

APPENDIX A

Because of the size, the maps had to be divided into sections in order to display all the relevant information at a scale that would be readily available to most users.

When viewing the maps on the attached CD, use the map reference below to help determine which map corresponds to the area of interest. When the map is open, you may search for a route by entering the route number in the space on the tool bar with the word “find”. Some overlap routes may occur on more than one map.

Grant/Quinn 1

Grant/Quinn 2

Grant/Quinn 3

Grant/Quinn 4

Moriah 1

Moriah 2

Moriah 3

Schell 1

Schell 2

Schell 3

Schell 4

Schell 5

Ward

White Pine 1

White Pine 2

White Pine 3

White Pine 4

White Pine 5

White Pine 6

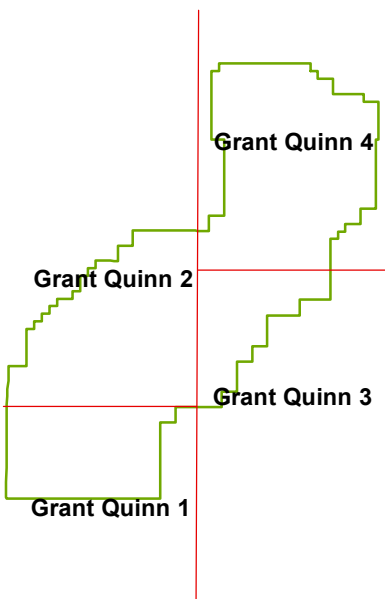
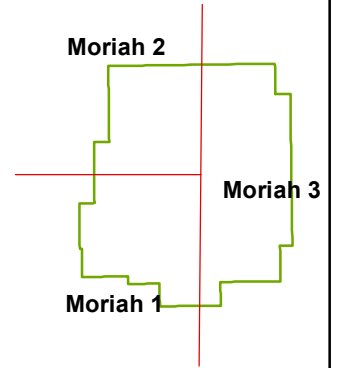
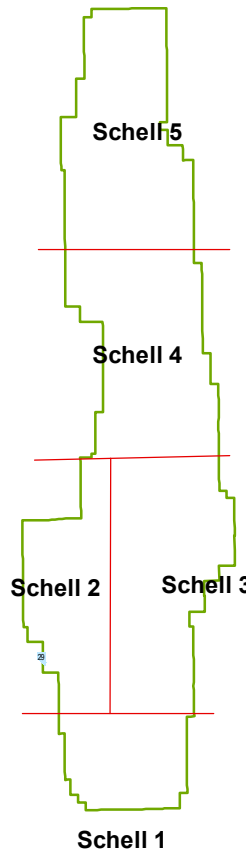
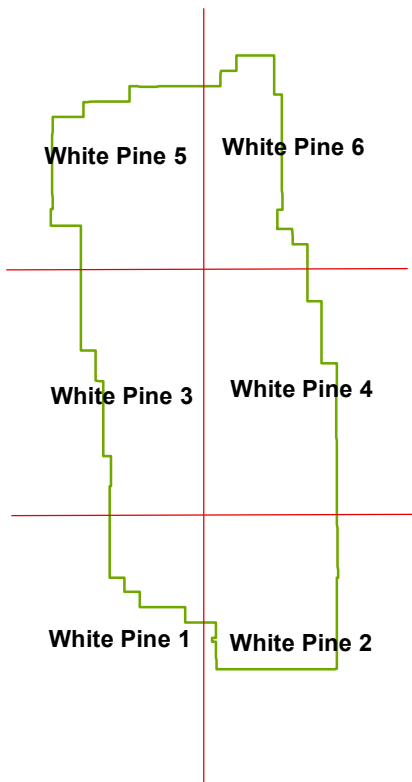

**Locator Map for Designated Routes
Ely Ranger District**

0 5 10 20 Miles

Humboldt-Toiyabe National Forest
U.S. DEPARTMENT OF AGRICULTURE

Humboldt-Toiyabe National Forest maps were compiled from various sources and may not meet the U.S. National Mapping Standards of the Office of Management and Budget. The data has no warranty as to content or accuracy, and is provided for reference only. Other than those intended by the Humboldt-Toiyabe National Forest.