

# NWP WOODARD CREEK TEMPORARY EROSION PROTECTION DESIGN STEVENSON, WASHINGTON JULY, 2007

<u>DRAWING NO.</u>	<u>SHEET TITLE</u>
1000	COVER
1010	PLAN AND PROFILE
1020	SITE PLAN VIEW
1030	TYPICAL PIPELINE CROSSING SECTION
1040	DETAILS
1050	SPECIFICATIONS

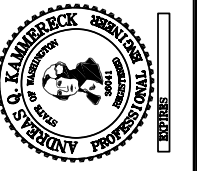

REV	DATE	DES	CHK	RW	REVISION DESCRIPTION
△ 07/30/07		AQK			NWP INPUT
△ 07/23/07		AQK			DRAFT
			ACF		CADD
			AQK		CHK
			MLB		RW



PROJECT  
 NWP/WOODARD  
 CREEK/WA

TITLE  
 COVER

PROJECT No. 073-93337.000		
FILE No. 07393337000C01		
REV. 2	SCALE	AS SHOWN
DESIGN	AQK	07/23/07
CADD	ACF	07/23/07
CHECK	AQK	07/23/07
REVIEW	MLB	07/23/07

**DRAWING  
1000**



REV	DATE	DES	REVISION DESCRIPTION	CADD	CHK	RW
07/30/07		AKK	NMP INPUT			
07/23/07		AKK	DRAFT			

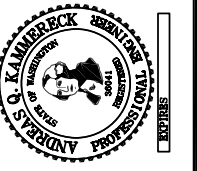

PROJECT  
**NWP/WOODARD CREEK/WA**

TITLE  
**SITE PLAN VIEW**

PROJECT No.	073-93337.000
FILE No.	07393337000C01
REV. 2	SCALE AS SHOWN
DESIGN	AKK 07/23/07
CADD	ACF 07/23/07
CHECK	AKK 07/23/07
REVIEW	MLB 07/23/07

**DRAWING 1020**

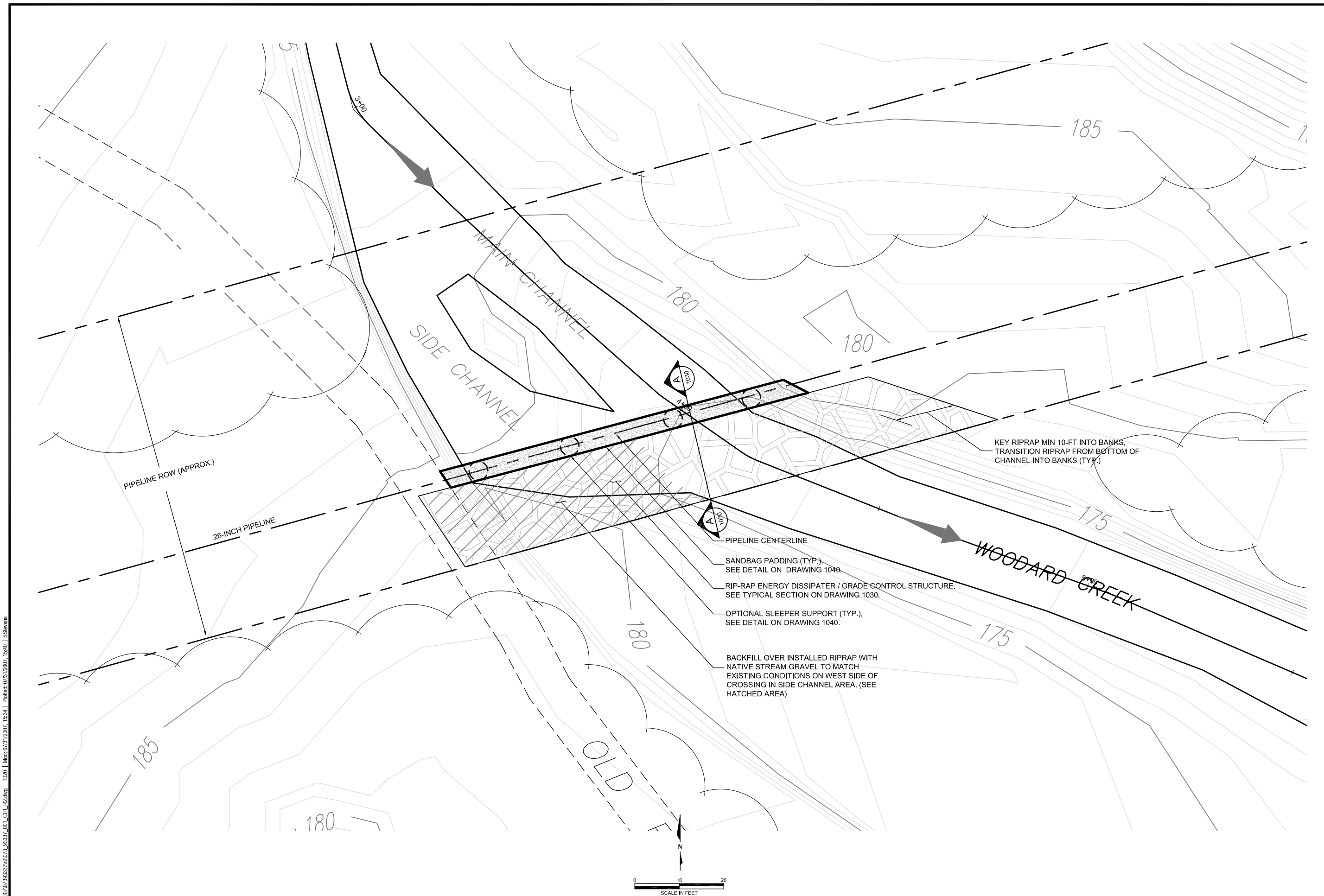

NOTE:  
 1. FINAL LOCATION AND CONFIGURATION OF STRUCTURES TO BE DETERMINED AT THE TIME OF CONSTRUCTION, BASED ON CONDITIONS ENCOUNTERED.

I:\CADD\Projects\2007\07393337\1020\_01\_R2.dwg | 1020 | Mod: 07/21/2007, 16:34 | Plotted: 07/21/2007, 15:40 | S:Stevens

REV	DATE	DES	CHK	FW
△	07/30/07	AKK	AKK	MLB
△	07/23/07	AKK	AKK	MLB
			CADD	CHK
				FW

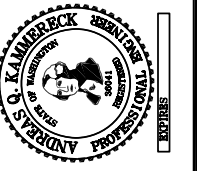

PROJECT  
**NWP/WOODARD CREEK/WA**

TITLE  
**TYPICAL PIPELINE CROSSING SECTION**

PROJECT No.	073-93337.000
FILE No.	07393337000C01
REV. 2	SCALE AS SHOWN
DESIGN	AKK 07/23/07
CADD	ACF 07/23/07
CHECK	AKK 07/23/07
REVIEW	MLB 07/23/07

**DRAWING 1030**

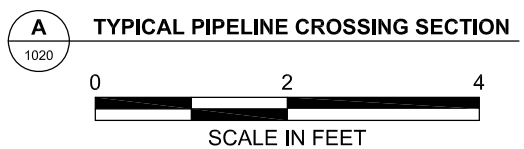
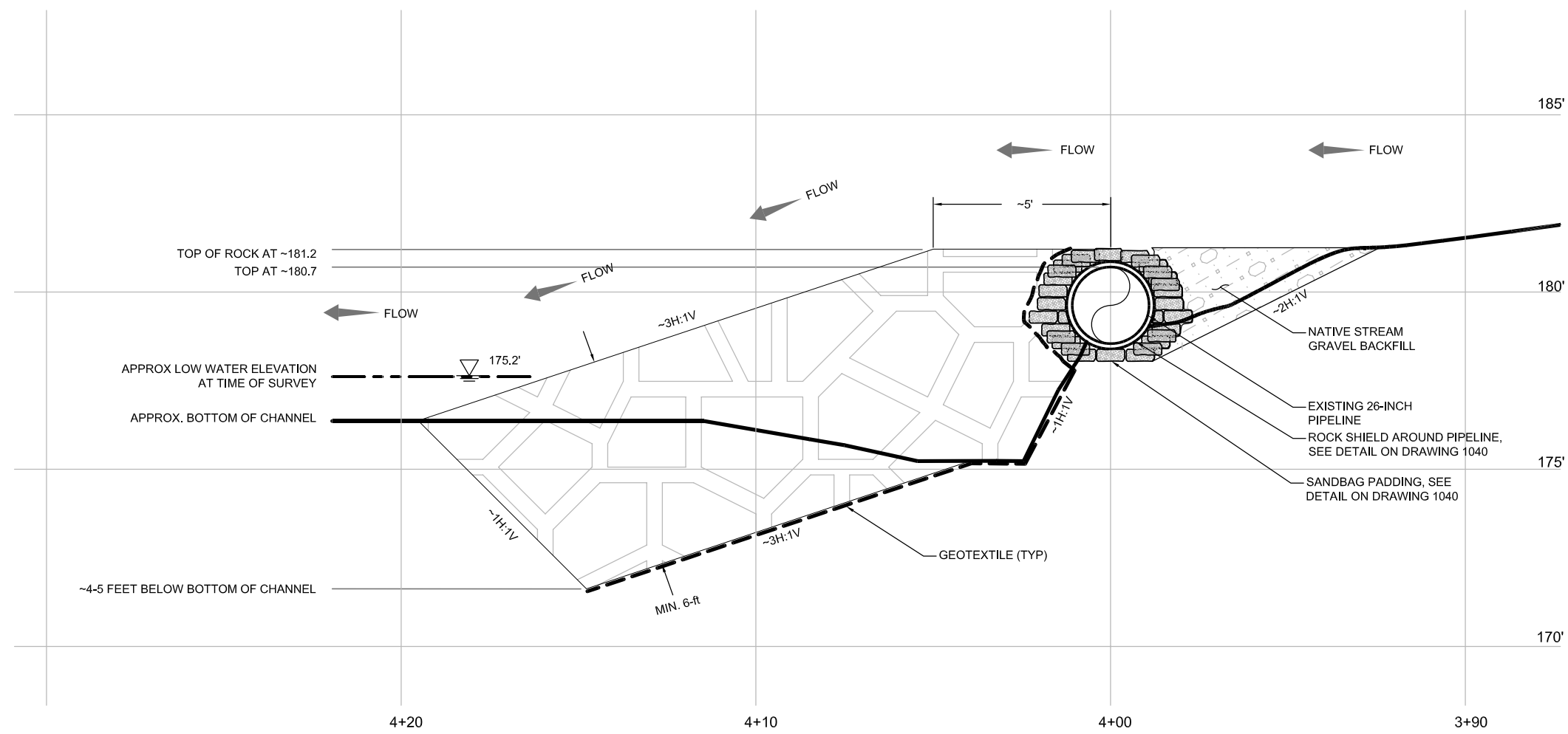

NOTE:  
 1. CHANNEL ELEVATION AS PIPELINE CROSSING BASED ON SITE SURVEY FROM 7/16/07, AND TOPO SURVEY PROVIDED BY NWP (JULY, 2007).  
 2. FINAL LOCATION AND CONFIGURATION OF STRUCTURES TO BE DETERMINED AT THE TIME OF CONSTRUCTION, BASED ON CONDITIONS ENCOUNTERED.



