



Date: April 03, 2007

CD-06-15-S—Angel's Rest Trail Relocation

**DECISION MEMO and CONSISTENCY DETERMINATION for the  
RELOCATION OF ANGEL'S REST TRAIL**

**USDA Forest Service, CRGNSA NATIONAL SCENIC AREA**

Sue Baker, Project Manager

---

**PROPOSED ACTION**

The Columbia River Gorge National Scenic Area is proposing to spend federal dollars for a 1,000 foot reroute and rehabilitation of Angels Rest Trail #415 on a portion of the trail located in Bridal Veil State Park. The rerouted section work would include grubbing, clearing and construction of tread. The rehabilitation section work includes installing water bars or check dams, covering with dead branches, stems and leaves and planting native vegetation on the old trail bed. No trees greater than 12 inches will be cut.

**LOCATION**

The project is located in T1N, R5E, Sec 14, SE/SW, Taxlot 200 on Oregon State Park land.

**PURPOSE AND NEED**

The purpose of the project is to protect the natural resources in the area and to improve the quality of the trail. The trail is currently eroding in this section.

**DECISION**

I have decided to approve the proposed action with the implementation requirements described on starting on page two of this document. The rationale for my decision is based on: 1) the proposed action fully meeting the purpose and need; 2) consistency with the Mt. Hood NF Forest Plan and the CRGNSA Management Plan; 3) review of the enclosed findings-of-fact; 5) review of the public comments on the project, and 6) review of the scenic, cultural, natural, and recreation specialist input to the project.

**SCOPING AND PUBLIC INVOLVEMENT**

This project has appeared on the CRGNSA Schedule of Proposed Actions (SOPA) since 2005. A notice to interested parties was sent on March 23, 2007 for a 10-day comment period. One comment letter was received and was considered during the consistency review process. The enclosed findings of fact respond to public comment.

**REASONS FOR CATEGORICAL EXCLUSION**

It is my determination that this action may be categorically excluded from documentation in an EA or EIS as it is within December 8, 2006 Forest Service Handbook (FSH) 1909.15, Section 31.124 concerning the repair and maintenance of trails.

**EXTRAORDINARY CIRCUMSTANCES**

I have determined that there are no extraordinary circumstances that indicate a presence of possible significant effects as supported by the enclosed findings of fact as well as biological and cultural evaluations.

**MT. HOOD NF LAND AND RESOURCE MANAGEMENT PLAN and the  
COLUMBIA RIVER GORGE NATIONAL SCENIC AREA ACT AND MANAGEMENT PLAN and  
OTHER APPLICABLE LAWS.**

Based on the enclosed Findings of Fact, I also find that this project is consistent with applicable laws, the Columbia River Gorge National Scenic Area Act and Management Plan and the Mt. Hood National Forest Plan as amended by the Northwest Forest Plan provided that it is implemented as described in the enclosed CRGNSA Consistency Determination Findings of Fact, referenced as CD-06-15-S, and that the following conditions are applied:

1. The project shall not commence until the project Manager has received a land use decision or letter of agreement from Multnomah County.
2. Should any historic or prehistoric cultural resources be uncovered during project activities, the applicant shall cease work and immediately notify the CRGNSA office and the Oregon Office of Archeology and Historical Preservation. The applicant should also notify the Indian Tribal governments within 24 hours if the resources are prehistoric or otherwise associated with Native American Indians.
3. Hand sawing or machine operations shall be done outside of March 1 to August 31. Activities that do not raise noise levels above the ambient level do not require a restriction.
4. Disturbed soil shall be seeded with native species and erosion shall be controlled until plants are established.

**Implementation Date:** This project may begin immediately as long as it complies with the conditions as described in item 1-4 above. This decision expires on April 3, 2009. If implementation has not commenced before that date, a new consistency review or extension shall be required.

**Appeal Opportunities:** A written request for review of the Consistency Determination, with reasons to support the request, must be received within 20 days of the date shown with the Area Manager signature below. Requests for review are addressed to: Request for Review, Regional Forester, P.O. Box 3623, Portland, OR 97208.

**Contact Person:** The Columbia River Gorge National Scenic Area staff prepared an analysis file in conjunction with this project. For further information, contact Diana Ross at the Columbia River Gorge National Scenic Area, 541.308.1716, e-mail: [dlross@fs.fed.us](mailto:dlross@fs.fed.us).

DANIEL T. HARKENRIDER  
Area Manager

Date: April 03, 2007

cc: Jill Arens, Director, Columbia River Gorge Commission  
Nathan Baker, Rick Till, Friends of the Columbia Gorge

## FINDINGS OF FACT

<b>LANDOWNER:</b>	Oregon State Parks
<b>PROPOSED ACTION:</b>	Re-route a 1,000 ft. section of the Angel's Rest Trail #415.
<b>LOCATION:</b>	Multnomah, Washington. Township T1N, R5E, Sec 14, SE/SW Taxlot: 200 UTM: 565744 5045536
<b>NATIONAL SCENIC AREA DESIGNATION:</b>	Special Management Area (SMA)
<b>LAND USE DESIGNATION:</b>	Open Space
<b>LANDSCAPE SETTING:</b>	Gorge Walls, Canyonlands, and Wildlands

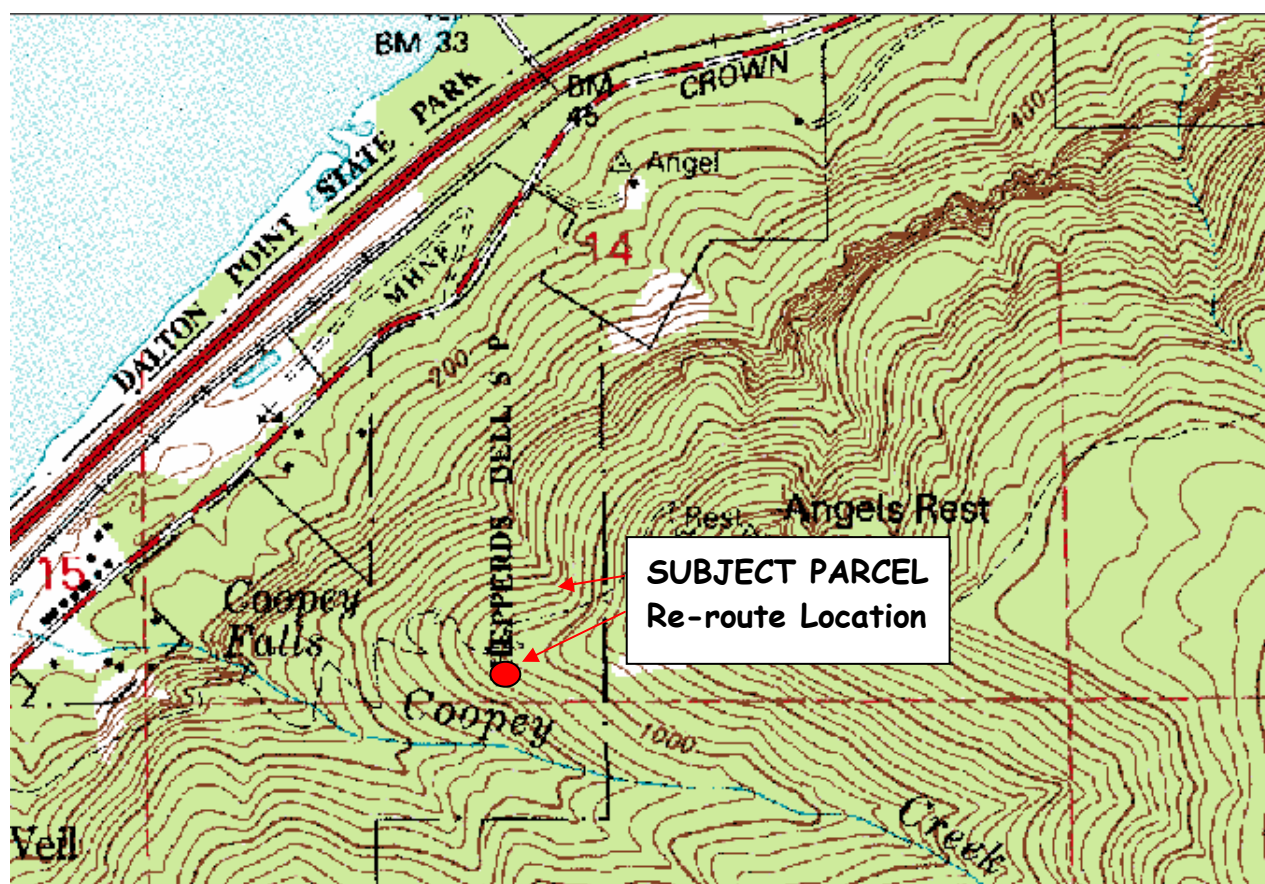

## FINDINGS OF FACT:

The following findings of fact contain the applicable standards and guidelines from the Revised CRGNSA Management Plan. The Management Plan, as revised and adopted in 2004, is in effect. The CRGNSA Management Plan standards and guidelines are displayed in **bold type**. The findings are displayed in regular type.

### *A. Project Proposal*

The Columbia River Gorge National Scenic Area is proposing a 1,000 foot reroute and rehabilitation of Angels Rest Trail #415. The rerouted section work would include grubbing, clearing and construction of tread. The rehabilitation section work includes installing water bars or check dams, covering with dead branches, stems and leaves and planting native vegetation on the old trail bed. No trees greater than 12 inches will be cut.

### *B. Land Use Designations*

1. The Management Plan, Part II, Chapter 7 (General Policies and Guidelines), states:

#### GMA/SMA Guidelines

##### **Development Eligible for Expedited Review**

##### **1. O. Trail reconstruction up to 1,000 feet of trail re-route.**

**Finding:** The proposed trail re-route is 1,000 feet in length. Therefore the project is eligible for expedited review subject to the following guidelines:

### *C. Expedited Review*

#### *Resource and Treaty Rights Protection Guidelines*

##### **A. Scenic**

- (1) **In the General Management Area, the scenic resource protection guidelines shall not apply to woven-wire fences for agricultural use that would enclose 80 acres or less.**

#### **Finding:**

- Guideline does not apply to the project because no fences are involved.  
 Project as described meets guideline  
 Project requires the following condition to meet this guideline

- (2) **The colors of structures topographically visible from key viewing areas shall be dark earth-tones found at the specific site or the surrounding landscape. The specific colors or list of acceptable colors shall be included as a condition of approval. This guideline shall not apply to additions, which may match the color of existing buildings.**

#### **Finding:**

- Guideline does not apply to the project

- Project as described meets guideline
- Project requires the following condition to meet this guideline

The trail will be natural-surfaced. The existing soil is a dark earth-tone..

**(3) Structures topographically visible from key viewing areas shall use low or non-reflective building materials, including roofing, gutters, vents, and chimneys.**

**Finding:**

- Guideline does not apply to the project because no structures are proposed.
- Project as described meets guideline
- Project requires the following condition to meet this guideline

**(4) Outdoor lights shall be directed downward and sited, hooded, and shielded such that they are not highly visible from key viewing areas. Shielding and hooding materials shall be composed of non-reflective, opaque materials.**

**Finding:**

- Guideline does not apply to the project because no lighting is proposed.
- Project as described meets guideline
- Project requires the following condition to meet this guideline

**(5) Signs shall comply with the applicable sign guidelines in the Management Plan (GMA guidelines on pages I-27 through I-29 and SMA guidelines on pages II-160 through II-163).**

**Finding:**

- Guideline does not apply to the project because no signs are proposed.
- Project as described meets guideline
- Project requires the following condition to meet this guideline

**(6) Structures within 1/2-mile of a key viewing area and topographically visible from the key viewing area shall be sited, screened and/or designed to achieve the applicable scenic standard (e.g., visual subordination, not visually evident).**

**Finding:**

- Guideline does not apply to the project because no structures are proposed.
- Project as described meets guideline
- Project requires the following condition to meet this guideline

**B. Cultural**

**(1) The expedited development review process shall only be used to review proposed development that does not require a reconnaissance survey or historic survey. The cultural resources policies in the current Management Plan (Policy 6 on pages I-51 through I-53 and Policy 7 on page I-53) shall be used to determine if a reconnaissance and/or historic survey is required for a proposed development.**

**Finding:**

- Guideline does not apply to the project
- Project as described meets guideline according to a report by Marge Dryden, CRGNSA archeologist on June 12, 2006.
- Project requires the following condition to meet this guideline

**(2) The GMA guidelines in the current Management Plan that protect cultural resources and human remains discovered during construction (see Guideline 1 on pages I-66 through I-68 and Guideline 1 on page I-68, respectively) shall be applied as conditions of approval for all development approved under the expedited development review process.**

**Finding:**

- Guideline does not apply to the project
- Project as described meets guideline
- Project requires the following condition to meet this guideline

If any historic or prehistoric cultural resources are uncovered during project activities, work shall cease and the CRGNSA archeologist shall be notified. The Forest Service shall also notify the Washington State Historic Preservation Office and the Indian Tribal Governments within 24 hours if the resources are prehistoric or otherwise associated with Native American Indians.

**C. Recreation**

**(1) The development shall not detract from the use and enjoyment of established recreation sites on adjacent parcels.**

**Finding:**

- Guideline does not apply to the project
- Project as described meets guideline because it will improve the trail.
- Project requires the following condition to meet this guideline

**D. Natural**

**(1) Wetlands, Streams, Rivers, Ponds, and Lakes**

**(a) The development is outside buffer zones for wetlands, streams, rivers, ponds, and lakes. This guideline shall not apply to lot line adjustments or development located inside road, utility or railroad rights-of-way or easements that have been previously disturbed and regularly maintained.**

**Finding:**

- Guideline does not apply to the project.
- Project as described meets guideline because the project is outside of the buffer of Coopey Cr.
- Project requires the following condition to meet this guideline

**(2) Sensitive Wildlife and Sensitive Plants**

**(a) The development meets one of the following:**

**(i) The development is at least 1,000 feet from known sensitive wildlife areas or sites (excluding sensitive aquatic species, deer winter range, and turkey habitat) and known sensitive plants; or**

**Finding:**

- Guideline does not apply to the project (also meets iii below)
- Project as described meets guideline because the CRGNSA wildlife biologist found that the project is more than 1,000 feet from any mapped sensitive areas, species locations, or riparian area.
- Project requires the following condition to meet this guideline

**(ii) The development does not disturb the ground or is inside road, utility or railroad rights-of-way or easements or other areas that have been previously disturbed and regularly maintained; or**

**Finding:**

- Guideline does not apply to the project (meets iii below).
- Project as described meets guideline
- Project requires the following condition to meet this guideline

**(iii) For sensitive wildlife, the development is within 1,000 feet of known sensitive wildlife areas or sites (excluding sensitive aquatic species, deer winter range and turkey habitat), but an appropriate federal or state wildlife agency determines (1) the sensitive wildlife area or site is not active or (2) the proposed development would not compromise the integrity of the wildlife area or site or occur during the time of the year when wildlife species are sensitive to disturbance.**

**Finding:**

- Guideline does not apply to the project

- Project as described meets guideline because the CRGNSA wildlife biologist and botanist ecologist reviewed the project and found that the project would not compromise the integrity of the area if hand sawing or machine operations are done outside of March 1 to August 31. Activities that do not raise noise levels above the ambient level do not require a restriction.
- Project requires the above condition to meet this guideline.

**(iii) For sensitive plants, the development is within 1,000 feet of known sensitive plants, but the Oregon or Washington Natural Heritage Program or a person with recognized expertise in botany or plant ecology hired by the applicant has determined that the development would be at least 200 feet from the sensitive plants.**

**Finding:**

- Guideline does not apply to the project
- Project as described meets guideline because it is outside of 200 ft of known sensitive plants and is not likely to cause any adverse effects as reviewed by CRGNSA botanist.
- Project requires the following condition to meet this guideline

**(b) Development eligible for expedited review shall be exempt from the field surveys for sensitive wildlife or sensitive plants (see GMA Guidelines 1 and 2 on pages I-63 and I-70, respectively, of the Management Plan).**

**Finding:**

- Guideline does not apply to the project (SMA)
- Project as described meets guideline
- Project requires the following condition to meet this guideline

- 2. Proposed developments reviewed using the expedited review process shall comply with the following treaty rights protection guidelines:**
- A. Proposed developments shall not affect or modify any treaty or other rights of any Indian tribe.**

**Finding:**

- Guideline does not apply to the project
- Project as described meets guideline according to Marge Dryden, CRGNSA archeologist.
- Project requires the following condition to meet this guideline

**B. The expedited development review process shall cease and the proposed development shall be reviewed using the full development review process if an Indian tribe submits substantive written comments during the comment period that identify the treaty rights that exist in the project vicinity and explain how they would be affected or modified by the proposed development.**

**Finding:**

- Guideline does not apply to the project



Project as described and noticed meets guideline—no comment was received from the tribes.

Project requires the following condition to meet this guideline

**C. Except as provided in 2.B above, the GMA and SMA treaty rights and consultation goals, policies and guidelines in Chapter 3, Section IV of the Management Plan shall not apply to proposed developments reviewed under the expedited review process.**

**Finding:**

Guideline does not apply to the project

Project as described meets guideline according to Marge Dryden, CRGNSA archeologist.

Project requires the following condition to meet this guideline

***D. Conclusion***

The proposed trail re-route as described above for the Columbia River Gorge National Scenic Area, is consistent with the National Scenic Area Management Plan Policy and Guidelines provided they meet the criteria and conditions listed in the Findings of Fact and Consistency Determination.