

CANADA

Area of Detail

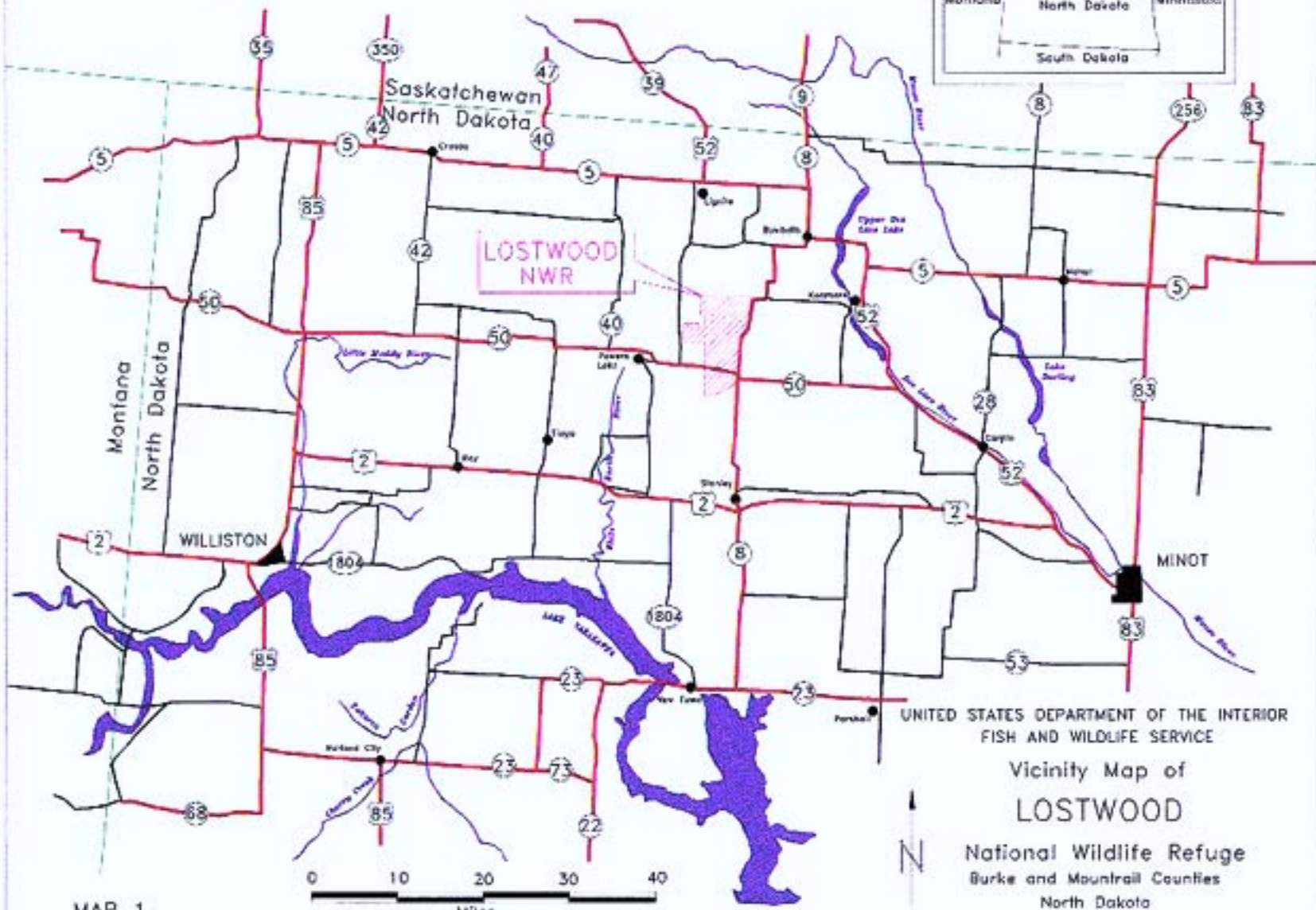
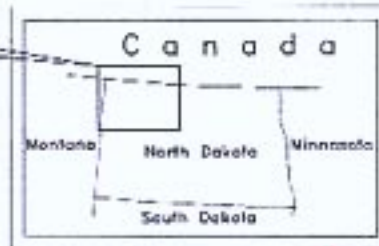

UNITED STATES DEPARTMENT OF THE INTERIOR
FISH AND WILDLIFE SERVICE

Vicinity Map of
LOSTWOOD

National Wildlife Refuge
Burke and Mountrail Counties
North Dakota

MAP 1

BY 11/15/57, FROM MAP
FILE WWS - 102718

United States Department of Interior
Fish and Wildlife Service

*Lostwood
National Wildlife Refuge
Base Map*

Burke and Mauntrail Counties,
North Dakota

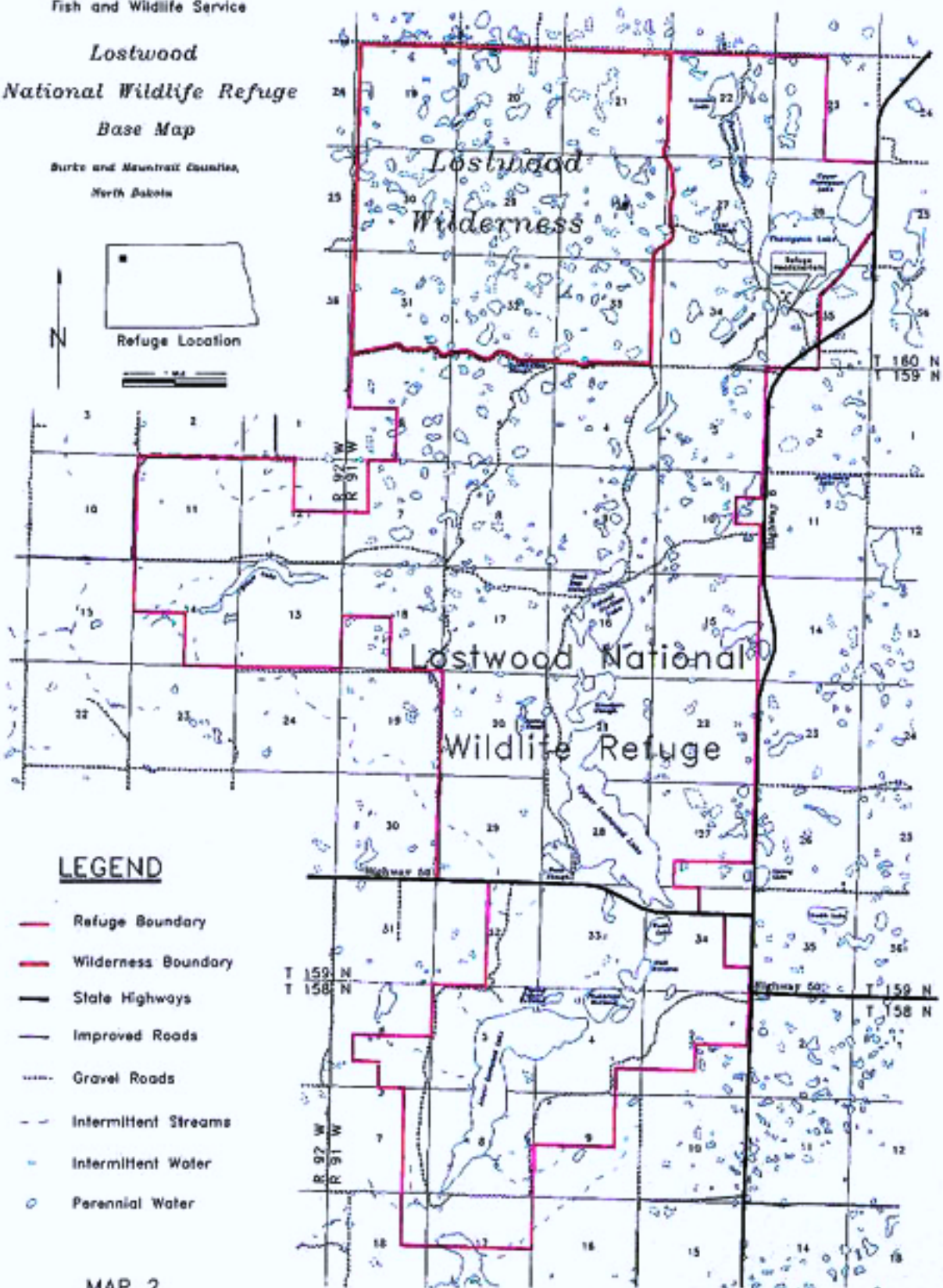

LEGEND

-  Refuge Boundary
-  Wilderness Boundary
-  State Highways
-  Improved Roads
-  Gravel Roads
-  Intermittent Streams
-  Intermittent Water
-  Perennial Water

MAP 2

United States Department of Interior

Fish and Wildlife Service

Lostwood National Wildlife Refuge

Deer and Mountrail Counties,
North Dakota

— Refuge Boundary

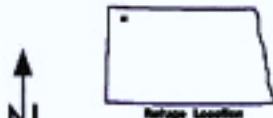

1 Mile 1 Mile

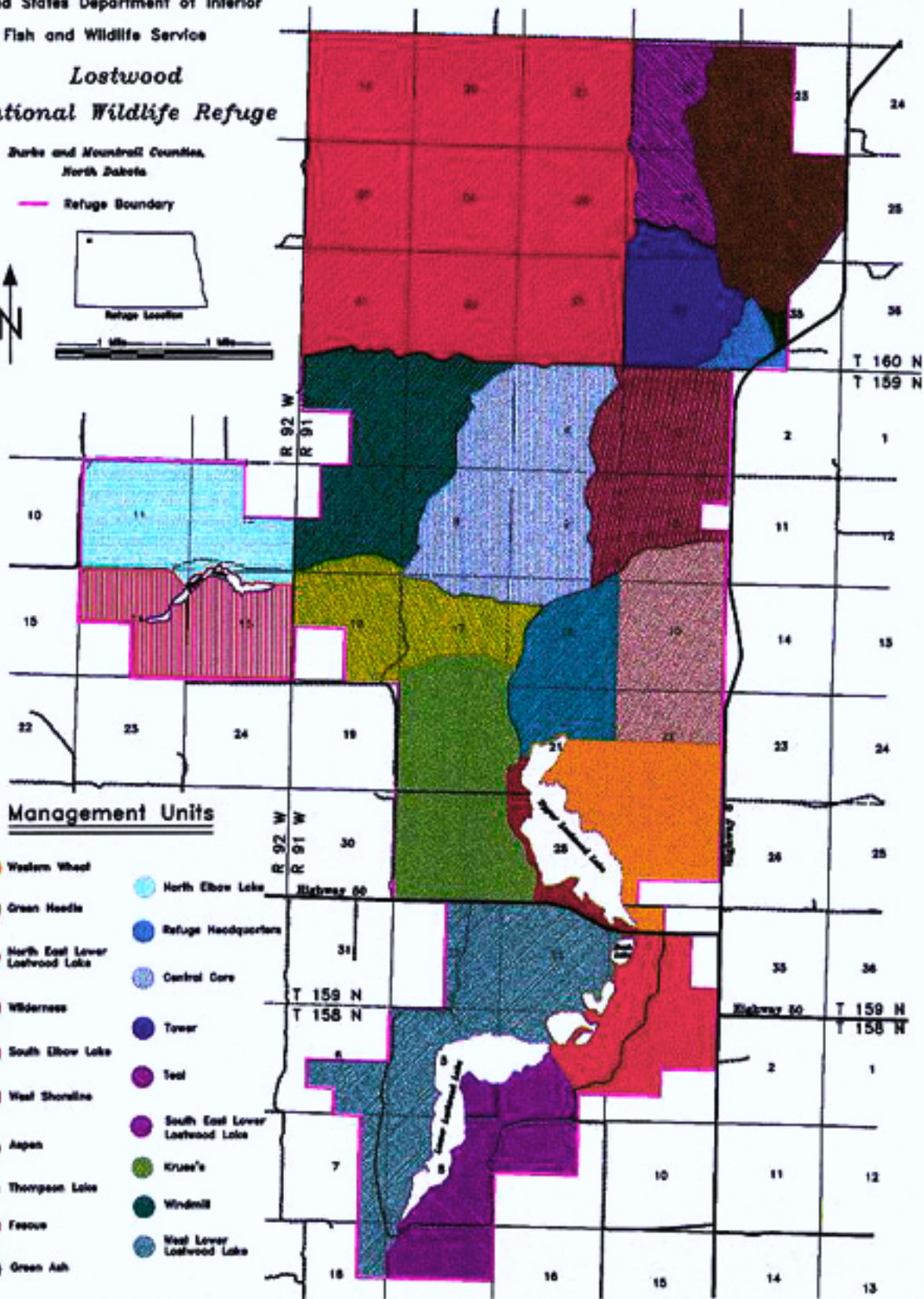

MAP 3

United States Department of Interior
 Fish and Wildlife Service
Lostwood
 National Wildlife Refuge
 Potential Refuge Expansions
 Burke and Mountain Counties,
 North Dakota

MAP 4

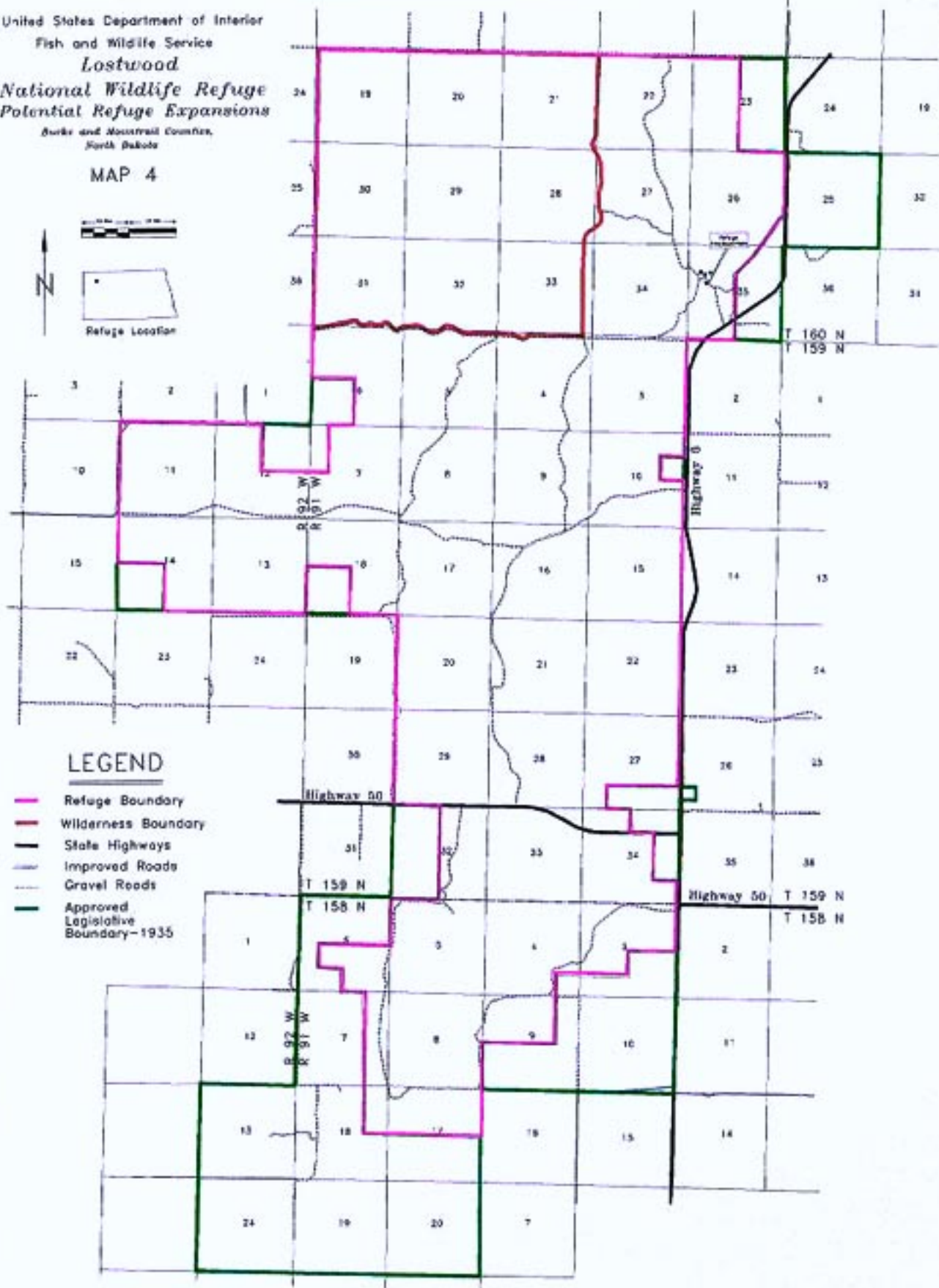
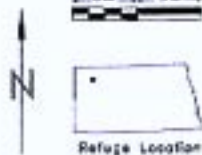

LEGEND

- Refuge Boundary
- Wilderness Boundary
- State Highways
- Improved Roads
- Gravel Roads
- Approved Legislative Boundary-1935

United States Department of Interior
Fish and Wildlife Service

Lostwood
National Wildlife Refuge
Roads and Legal Sections

Burke and Mountrail Counties,
North Dakota

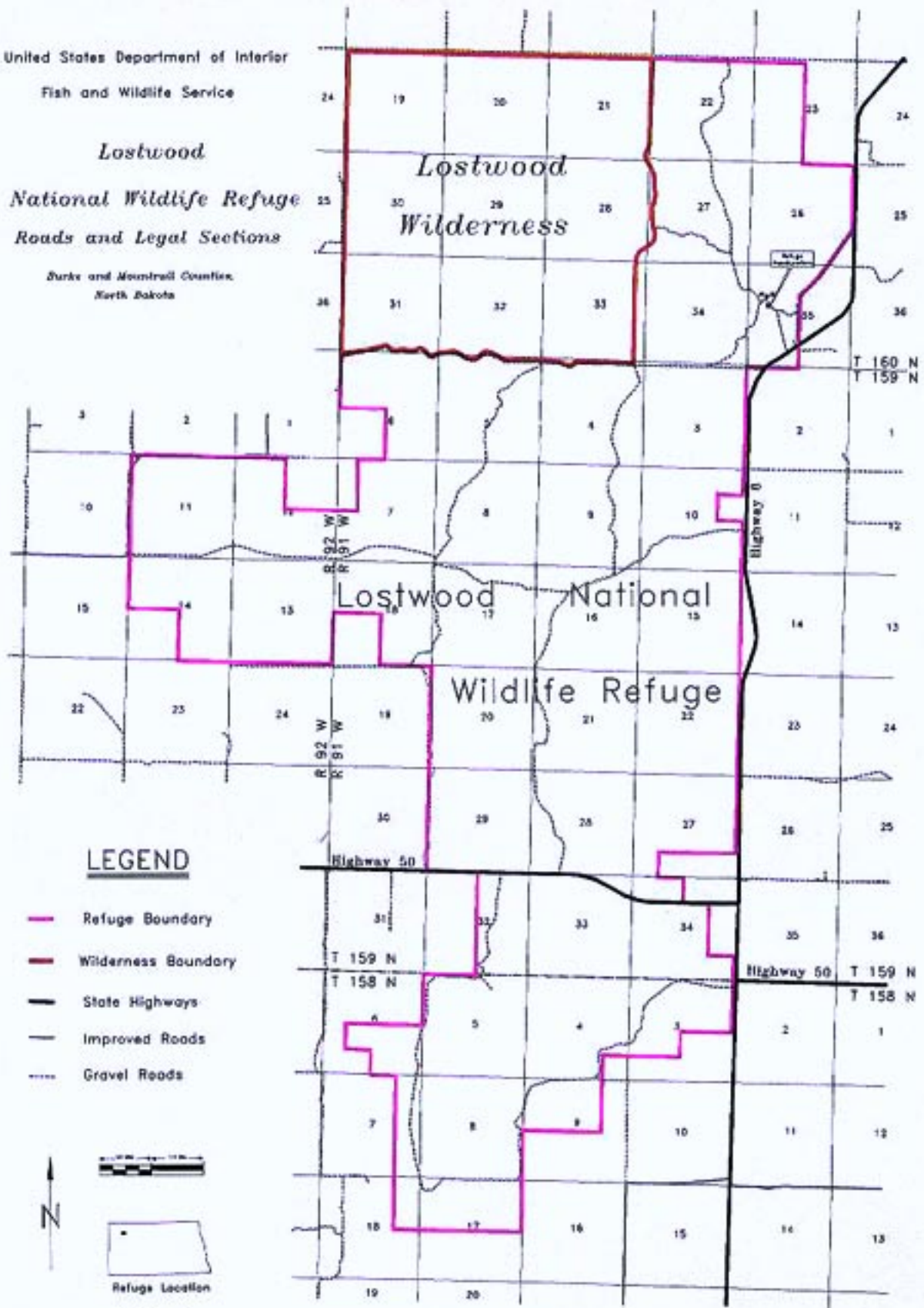

LEGEND

-  Refuge Boundary
-  Wilderness Boundary
-  State Highways
-  Improved Roads
-  Gravel Roads

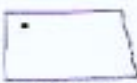

Refuge Location

MAP 5

