

VOLVO

Construction Equipment North America

ALERT

Release Date: December 9, 2003

Subject: L50D, L60E, L70E, L90E, L110E, L120E, L150E, L180E, L220E, L330E
Obstruction of Air at Inlet Side of Air Cleaner Cap

- Certain job applications, involving wood chips, waste handling, and other airborne particles, introduce an environment where debris can stick to the engine air intake cap. This debris, can then restrict the passage of air in the normal manner. If this occurs, the possibility exists of hot exhaust gases being drawn in from the ejector hose, (connected to the muffler).
- This presents a potential for heat deterioration of the air filter elements, potentially resulting in combustion. In machine applications where airborne debris is present, we recommend the removal of the ejector hose and plugging of the hose ends. The modification will eliminate the transfer of hot gases to the air cleaner canister.
- The parts listed below are required to make this modification.

Description	Part Number	Qty
Hose	P/n 952975	2pcs
Rubber bushing	P/n 4932563	2pcs
Hose clamp	P/n 943477	4pcs

WARNING:

 Please follow all safety precautions indicated in the Service and Operators Manuals for the model to be repaired. Please follow all proper repair procedures as indicated in the Service Manual for the models to be updated. Volvo Construction Equipment North America is not responsible for damage resulting from the failure to follow these instructions.

See picture regarding installation on the following page.

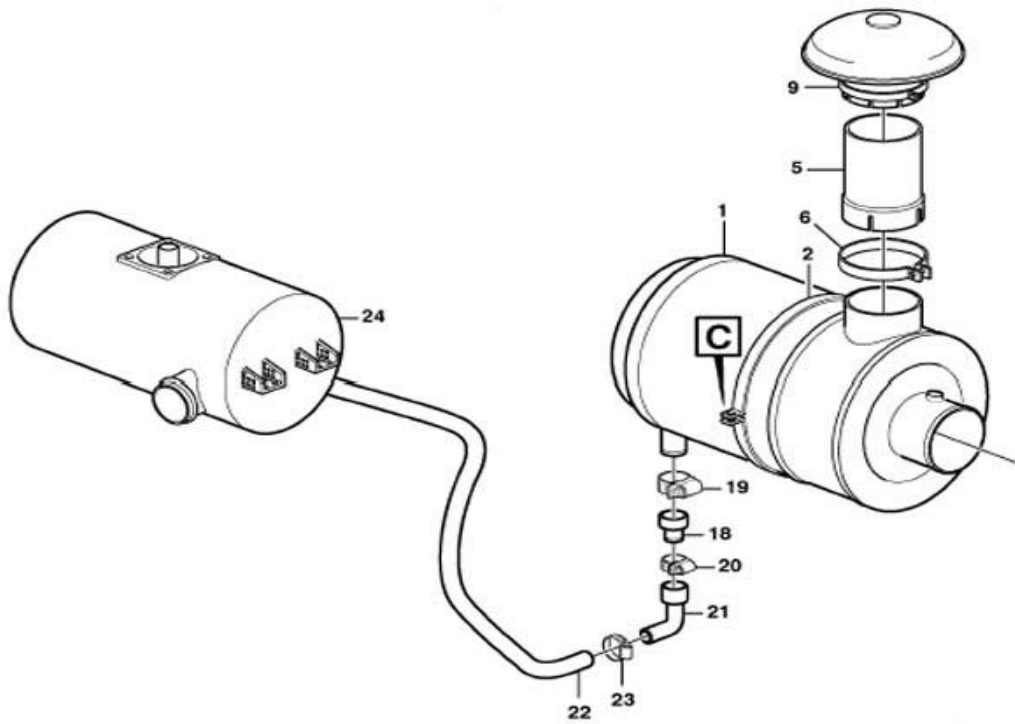

Fig. 1

Elimination of ejector hose between the muffer and air cleaner canister.

If you have a machine that could be affected by this alert, please contact your local Volvo dealer. Find your closest dealer with the Dealer Locator on www.volvoce.com. If you have any questions or concerns, contact Volvo at techsupport.vcesna@volvo.com or 828-650-2001, option 2.