

## **2006 KMI Mine Rescue Contest**

Sept.7, 2006

### **STATEMENT**

**I am \_\_\_\_\_, Superintendent of the Knotthole No.2 Mine. Thank you for answering our call for help.**

**Early this morning, (Five) 5 men entered the cut-thru entries from the 5 left panel to run coal. At 5:00 am, a loud explosion was heard and power to the mines was knocked. All five miners are still missing. All of the mine has been explored except for the cut-thru entries.**

**Two mine rescue teams have explored the 4 left panel and the 5 left panel. The team in the 4 left panel was blocked by unsafe roof going toward the cut-thru entries. Temporary stoppings have been built on both sides of the unsafe roof.**

**The team in the 5 left panel has established a fresh air base in this entry (In which you are located)**

**The areas explored by both teams have been mapped and will be provided to you after the clock is started.**

**Ventilation is provided by a blowing fan on the surface. The fan is on, but can be reversed by asking the superintendent.**

**All electrical circuits going to the cut-thru entries have been de-energized, locked out and guarded.**

**Both of the mine rescue teams will serve as back-up while you are working. You may request assistance from them through the superintendent in the areas they have explored. Work by the team(s) is limited to building or removing stoppings. Work by outby team(s) will take 2 minutes to complete for each map submitted.**

**Written instructions and the following maps will be provided when the clock is started.**

- 1. Two blanks maps**
- 2. Two maps indicating the ventilation prior to the incident.**
- 3. Two maps indicating the ventilation after the incident and the area explored by the mine rescue teams.**
- 4. Mine maps are not up-to-date.**

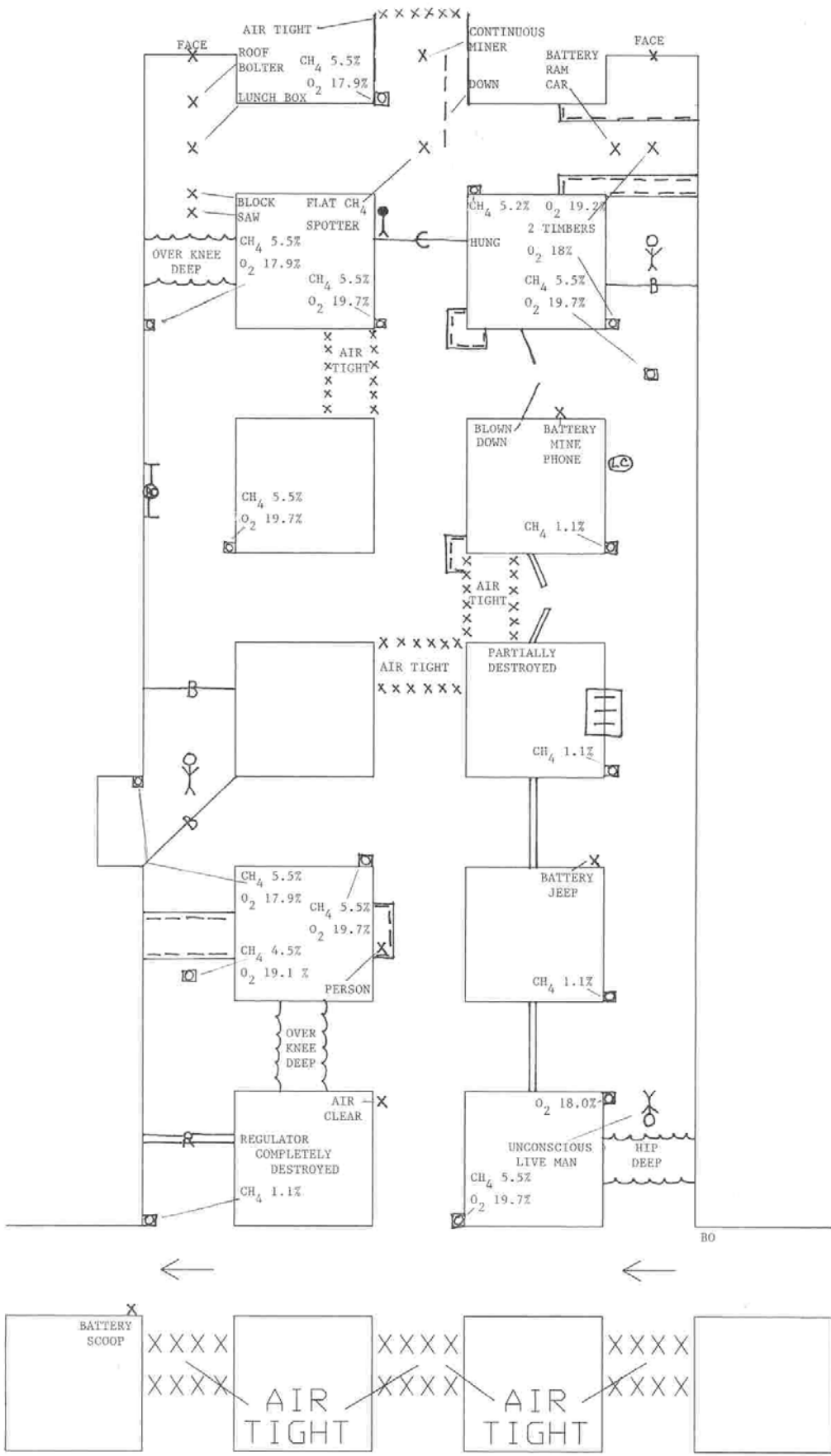

VENTILATION PRIOR TO THE INCIDENT

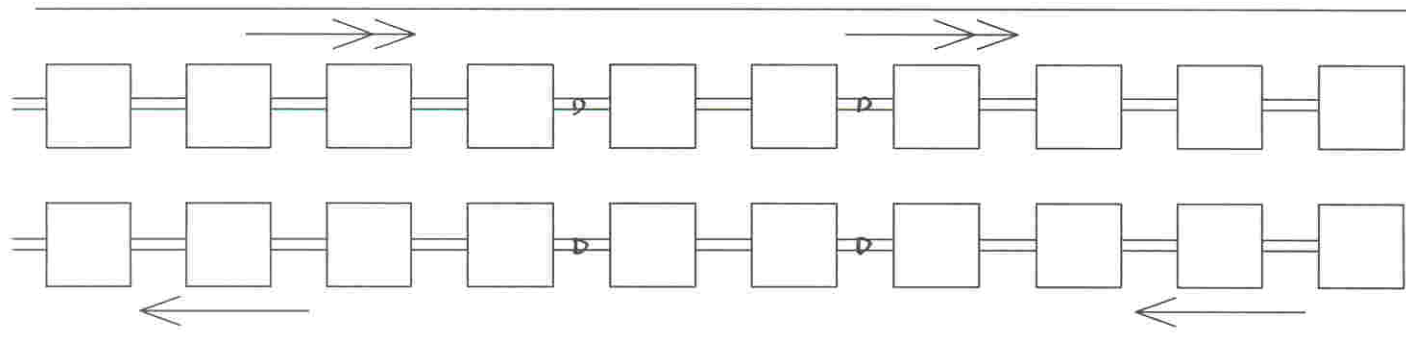

4 LEFT PANEL

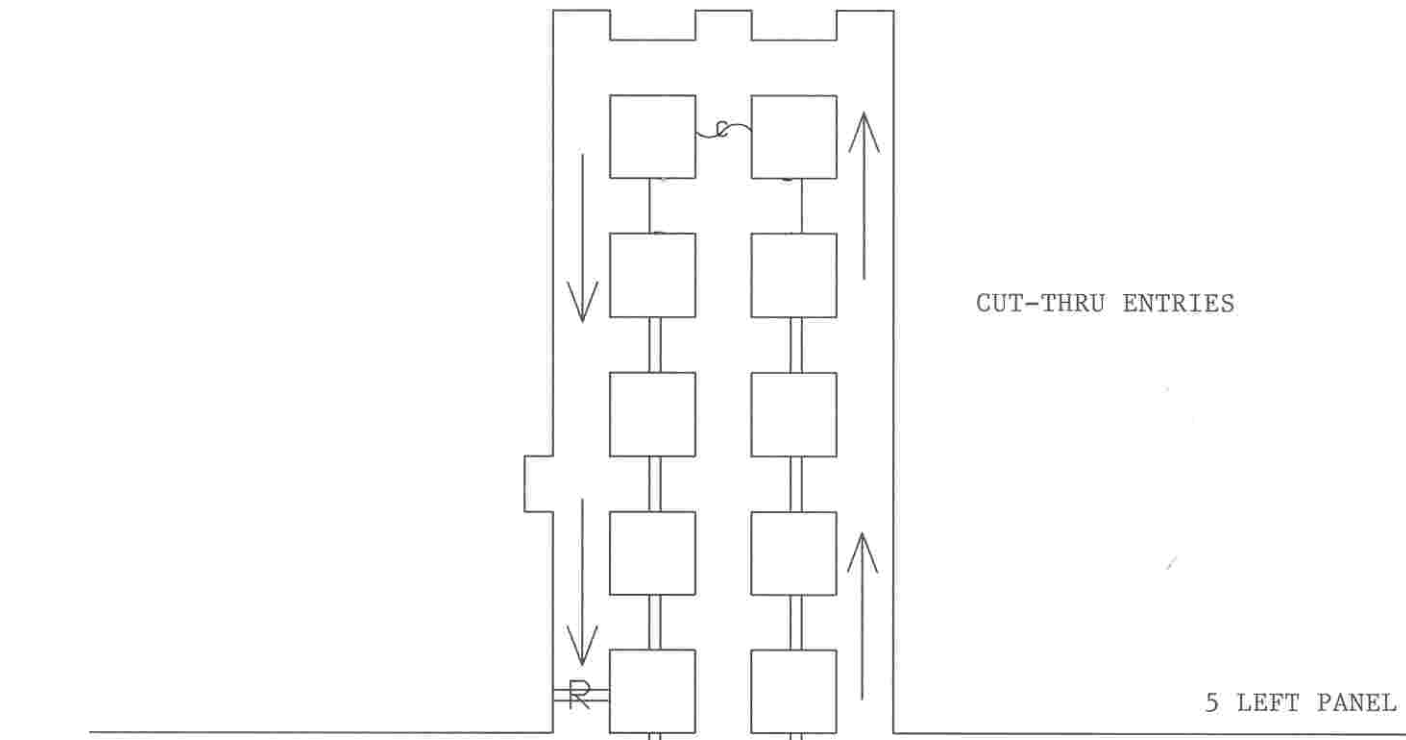

5 LEFT PANEL

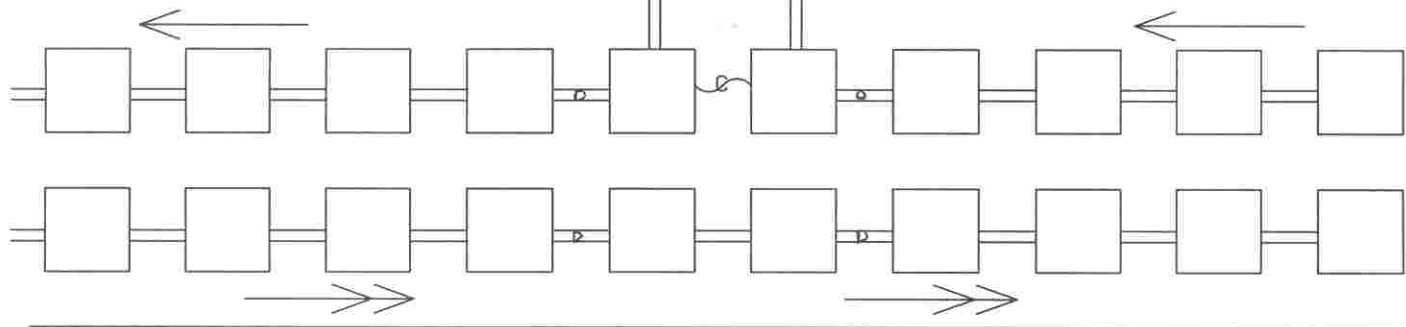

VENTILATION AFTER THE INCIDENT  
AND AREAS EXPLORED

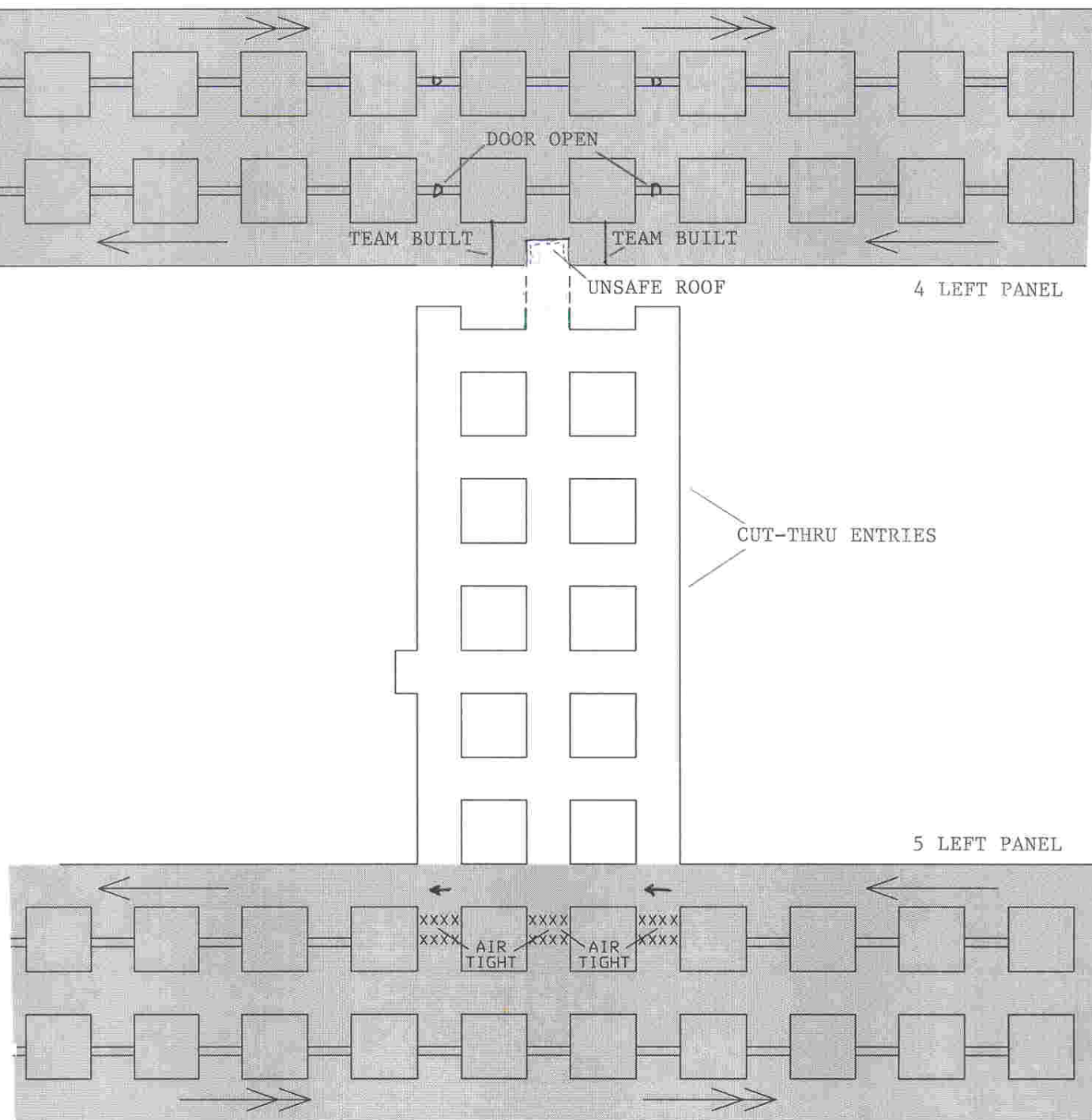

# KMI Mine Rescue Contest

## Problem

(Written Instructions)

ACCOUNT FOR ALL MISSING  
PERSONS

EXPLORE THE ENTIRE MINE IF IT  
CAN BE DONE SAFELY

THE FAN CAN BE REVERSED

Possible Team STOPS

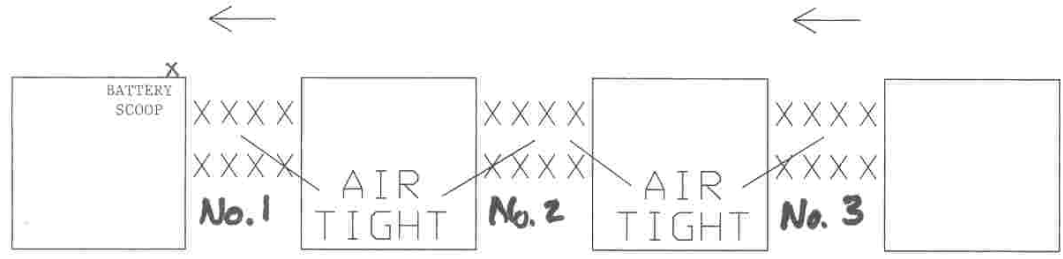
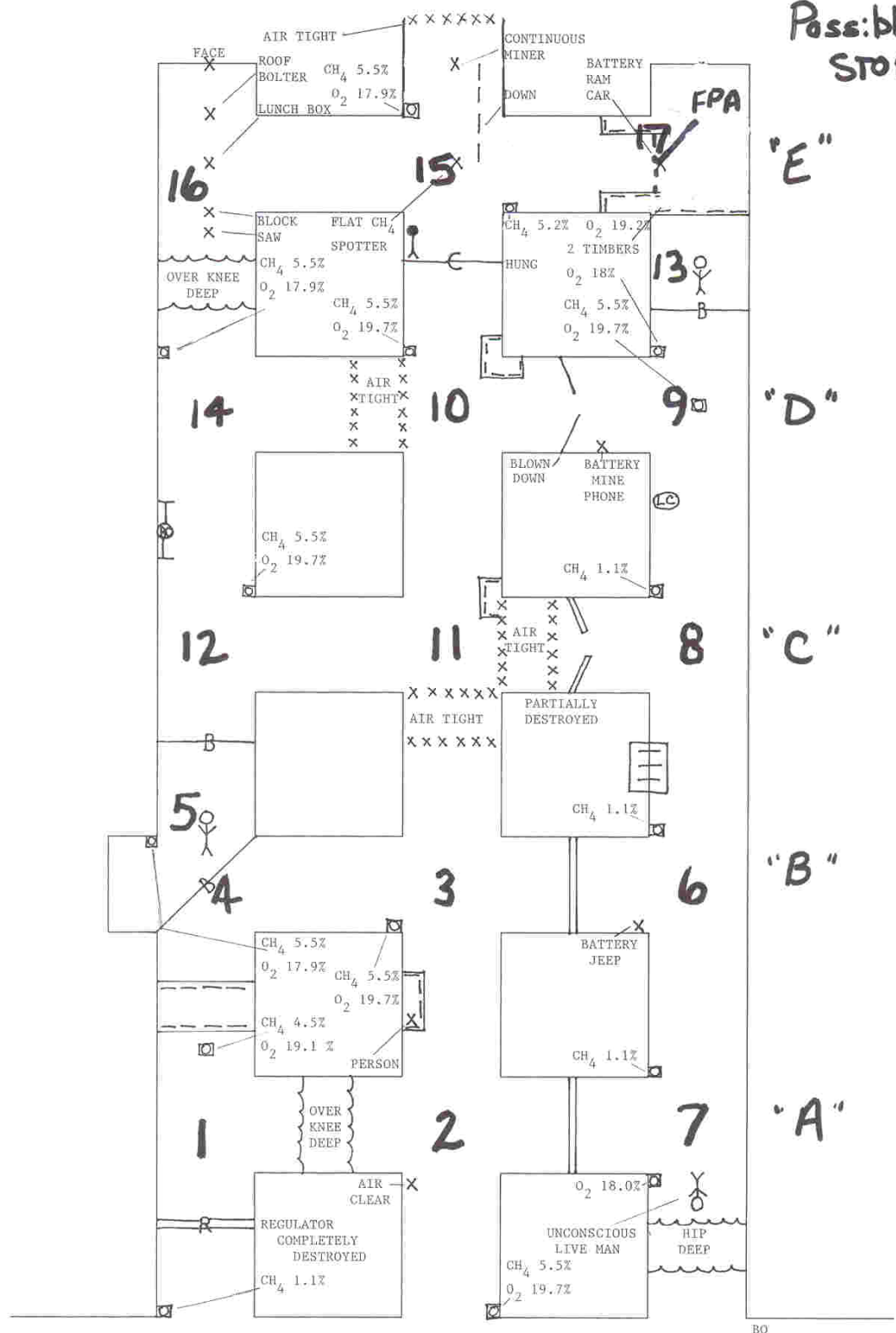

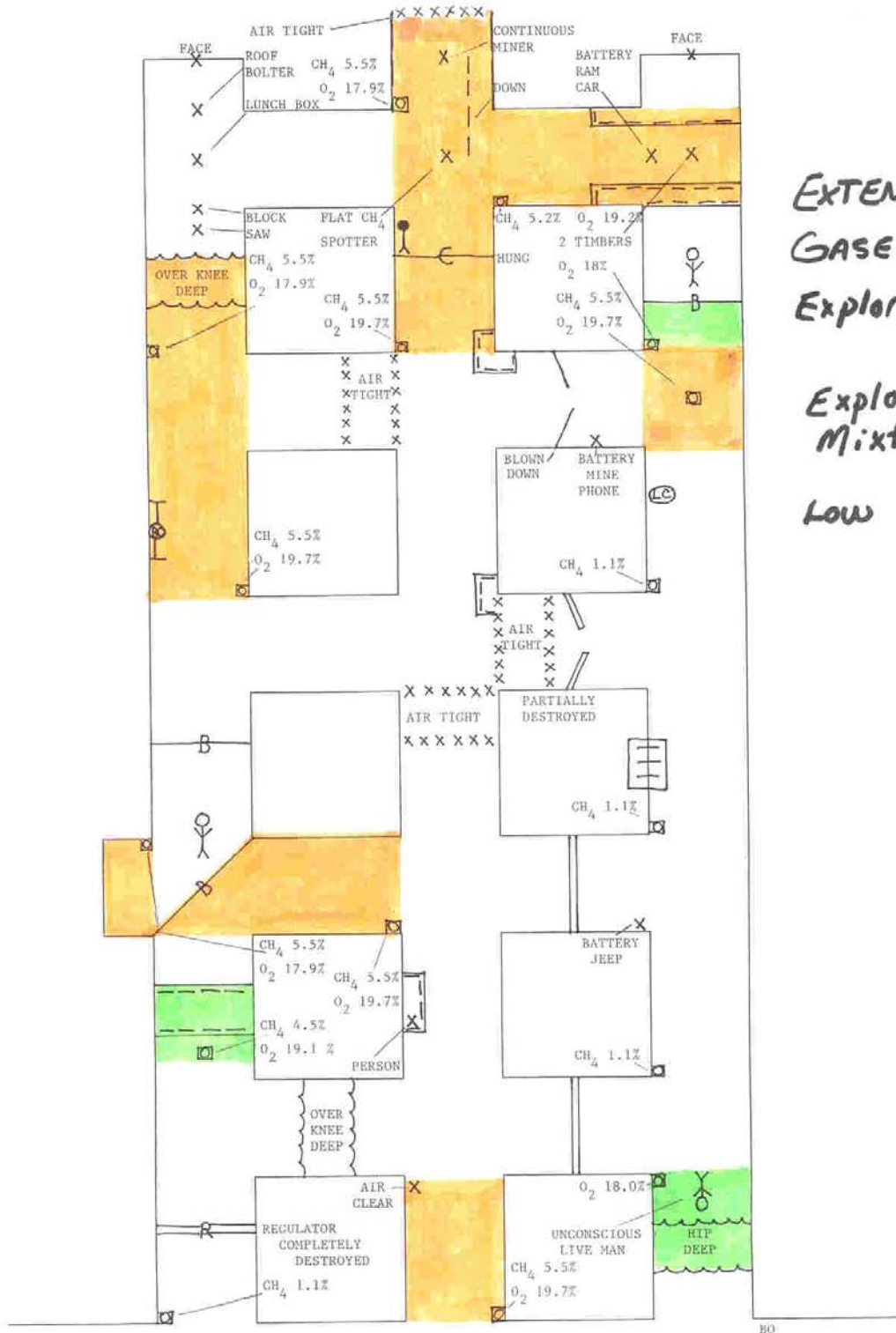

EXTENT OF GASES DURING Exploration

Explosive Mixture

Low O<sub>2</sub>

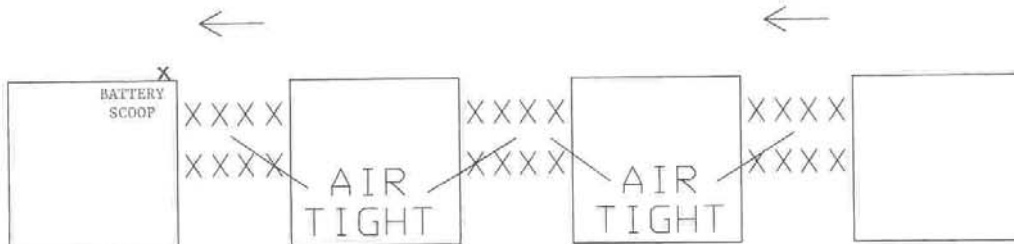



1st VENT.

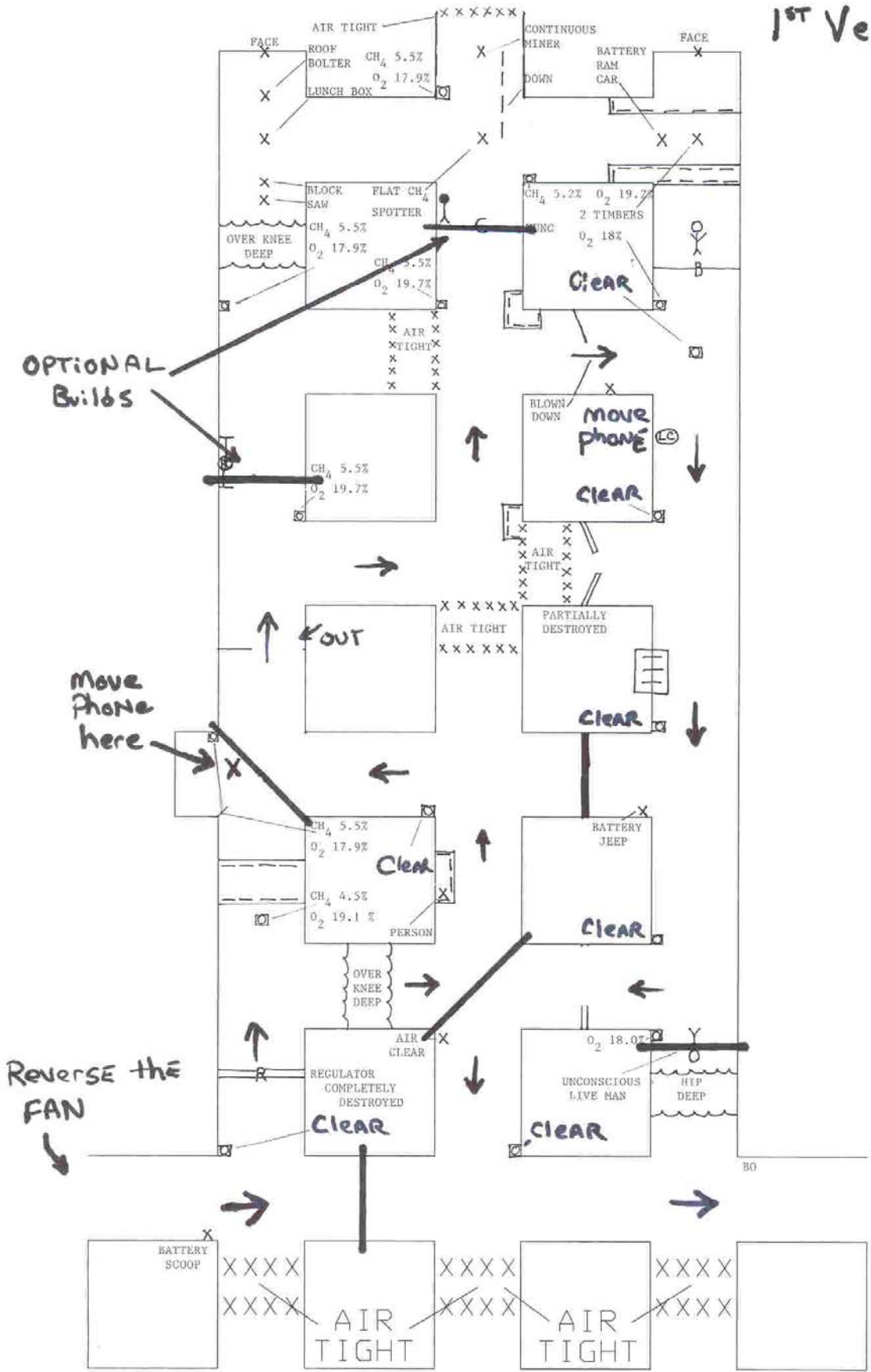

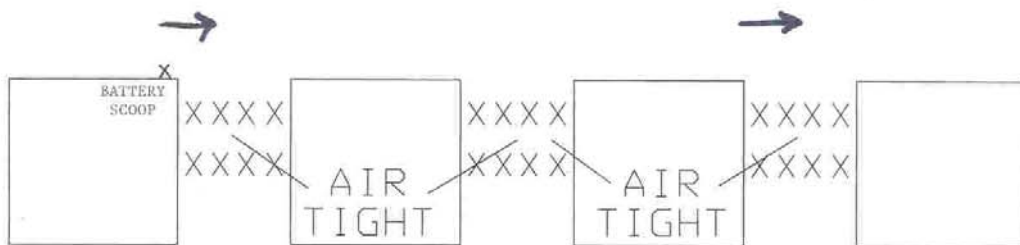
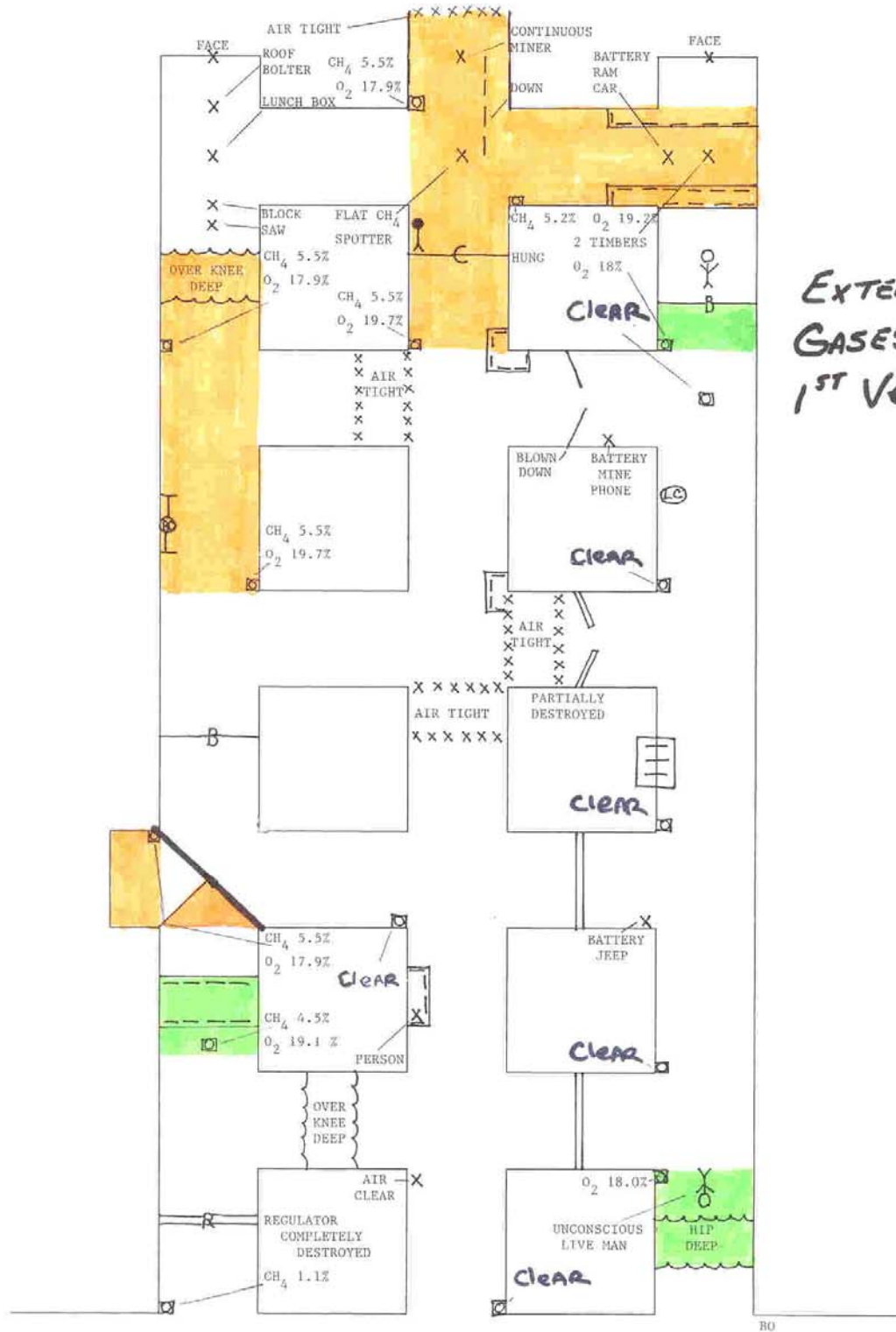



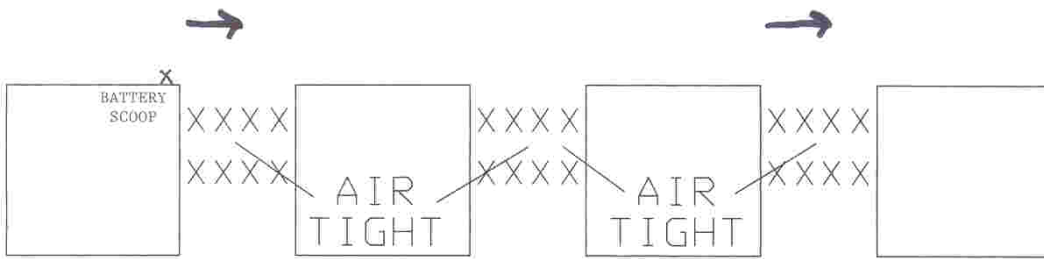
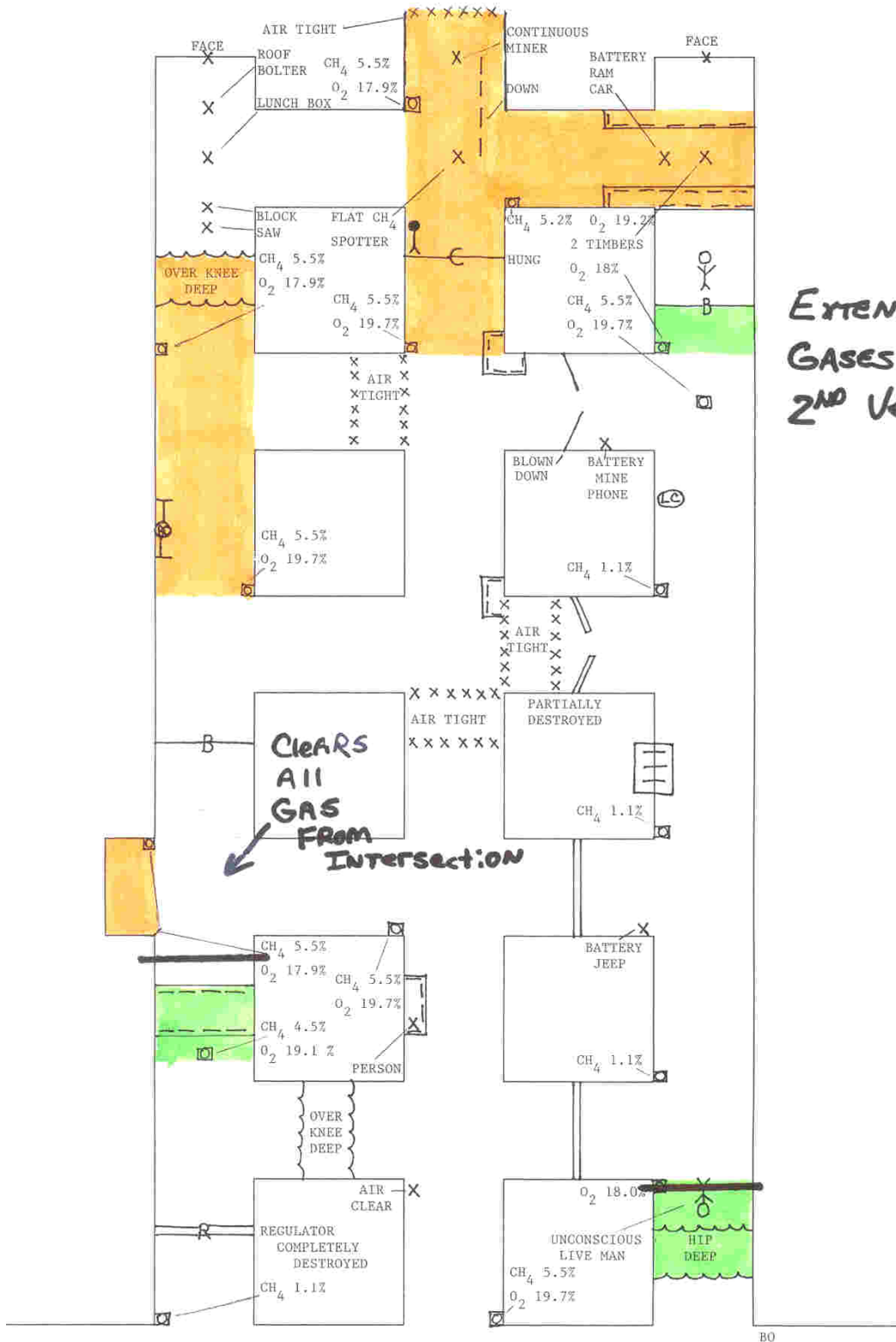



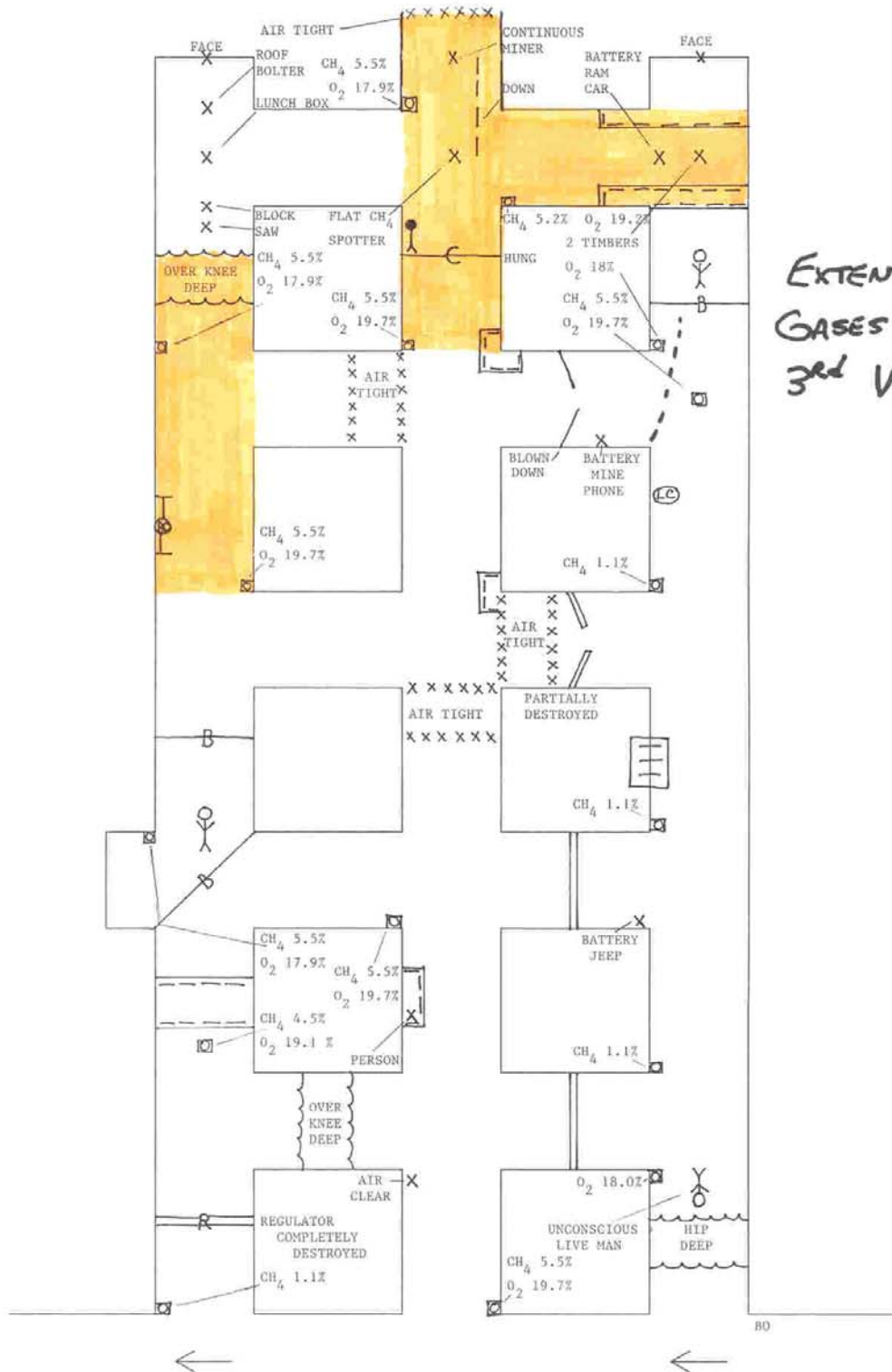

EXTENT OF GASES AFTER 3rd VENTILATION

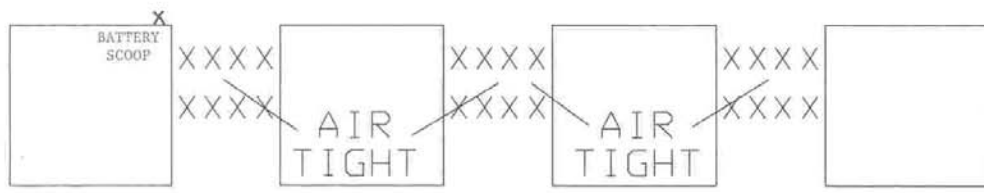

# PATIENT STATEMENT

(1<sup>ST</sup> Patient)

Help ! Get me out ! The  
area is airtight !

# PATIENT STATEMENT

(2nd Patient)

**Help! Get Me Out !**