

# Belfield, Louisiana, United States

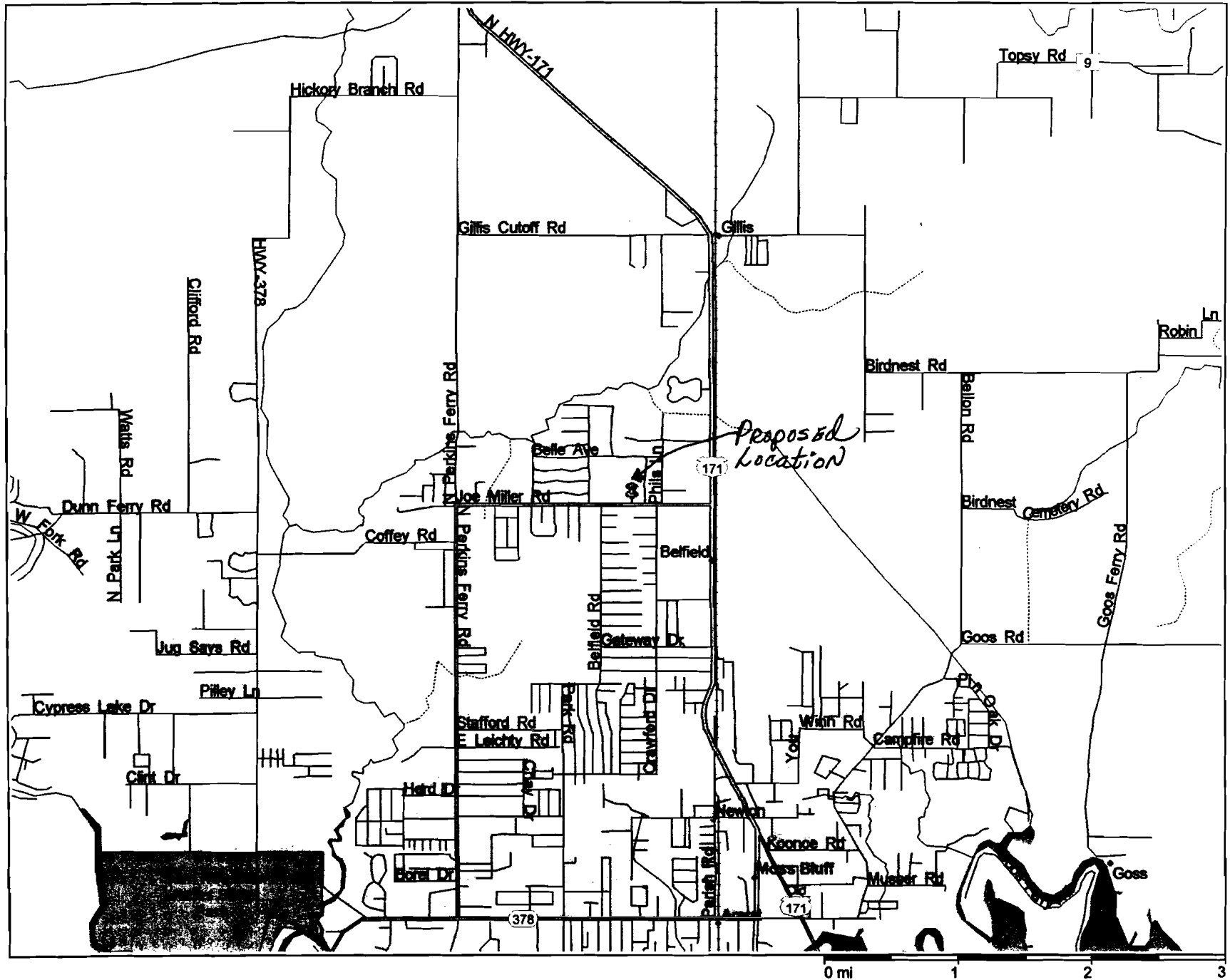

Louisiana, United States, North America

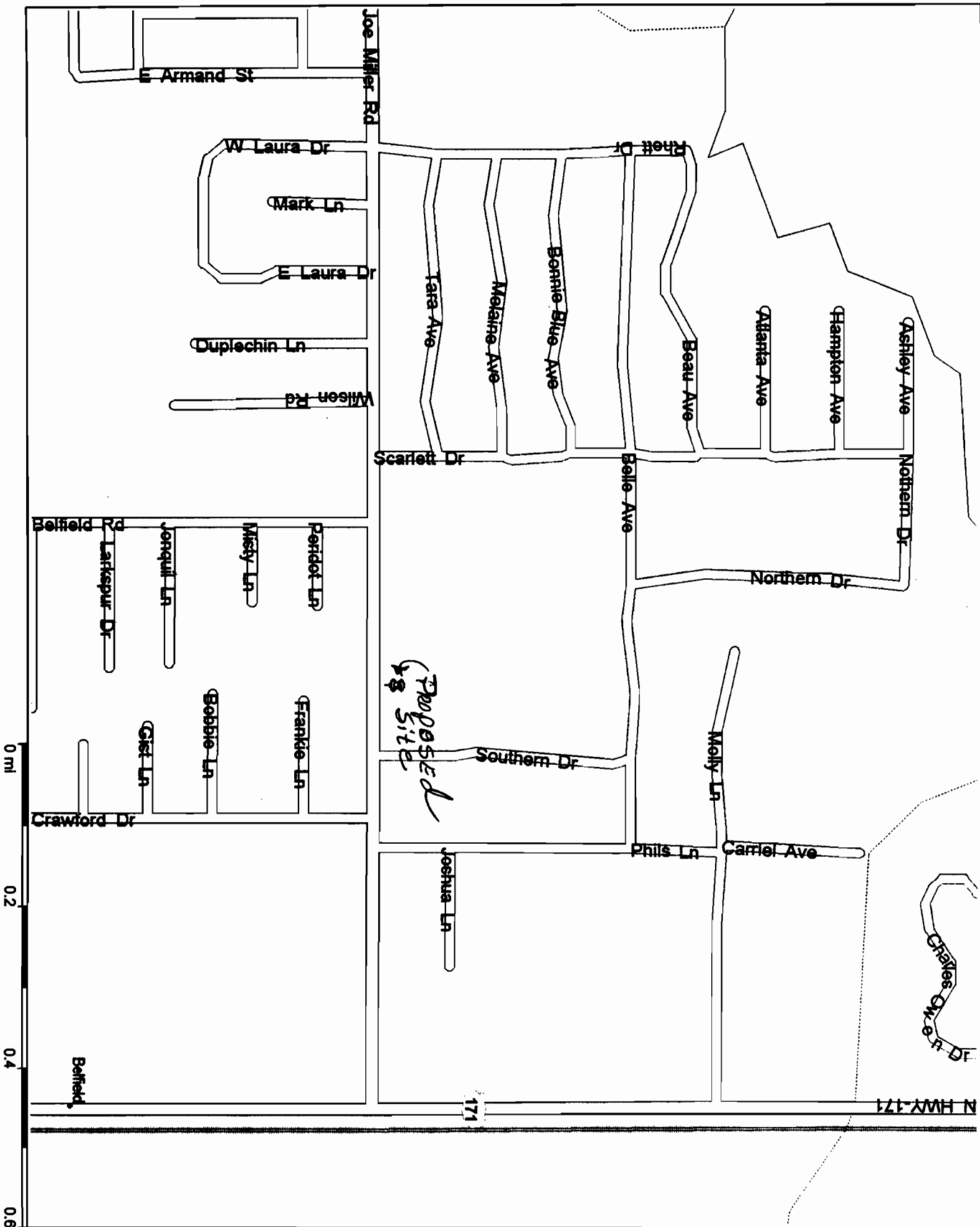



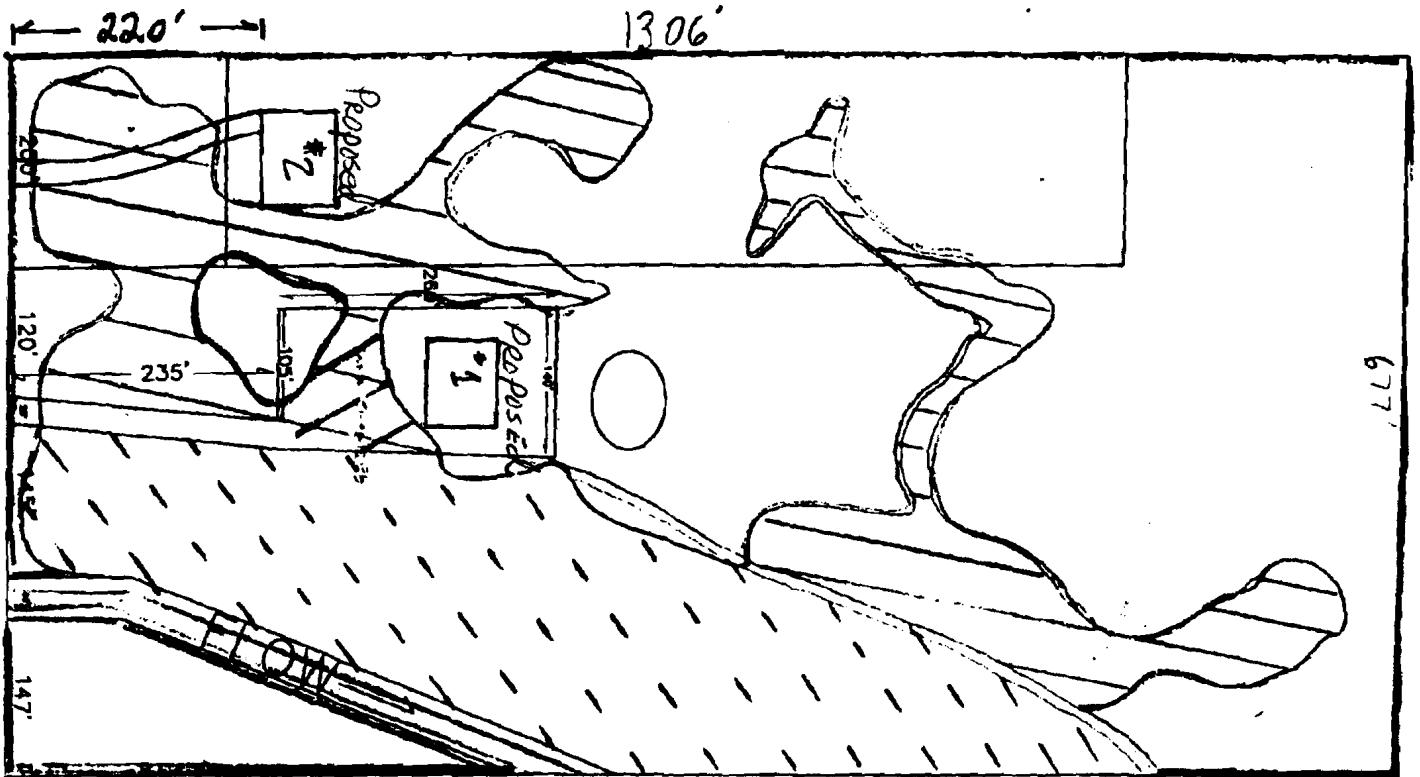

#2

DUSTIN & STACY FULLER  
337-368-3078

# PROPOSED HOUSE SITES



-  = Sec. 404 WETLAND (100%)
-  = Sec. 404 MIXED WETLANDS (45% wetland, 55% nonwet)
-  = NON WETLAND
-  = Sec. 404 WATER (Transition to Little Indian Bayou)
-  = UNAUTHORIZED ACTIVITY IN WETLANDS (Mechanically Landscaped)

USACE  
 ACCOUNT # MVN-2009-02534-X  
 FOR D. FULLER  
 LMT 30.346 Lower - 93.212  
 Section, Township Range S20, T85, R81W  
 Property # 041501515  
 LRS# Date: 10-1-09 0-1

## DRAFT

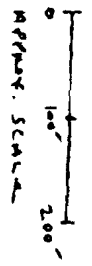

# PROPOSED PLAN VIEW

DUSTIN FULLER  
337-807-9713  
337-368-3078

#3

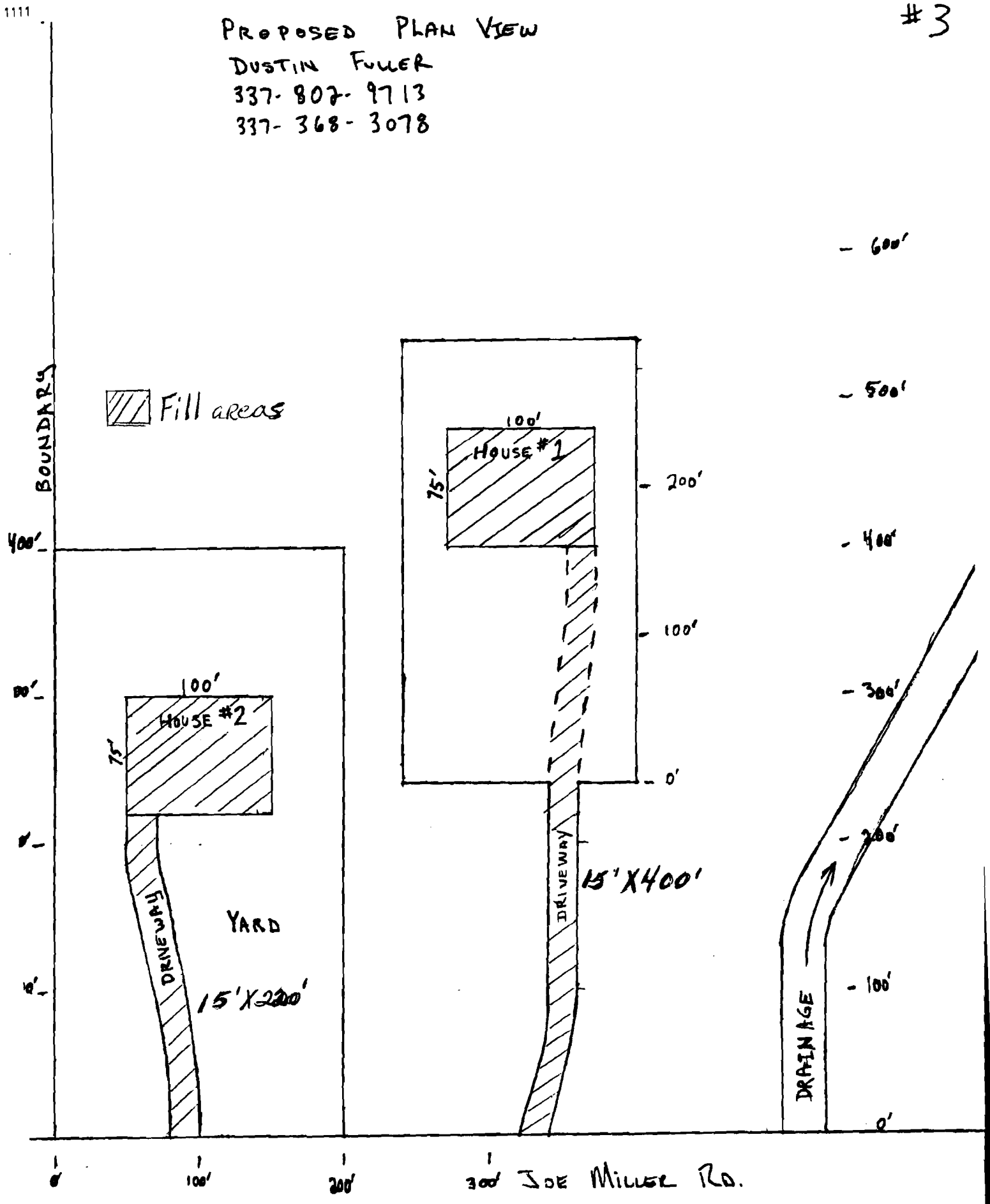

# PROPOSED HOUSE PAD / SLAB SECTION VIEW

DUSTIN FURER 337-368-3078

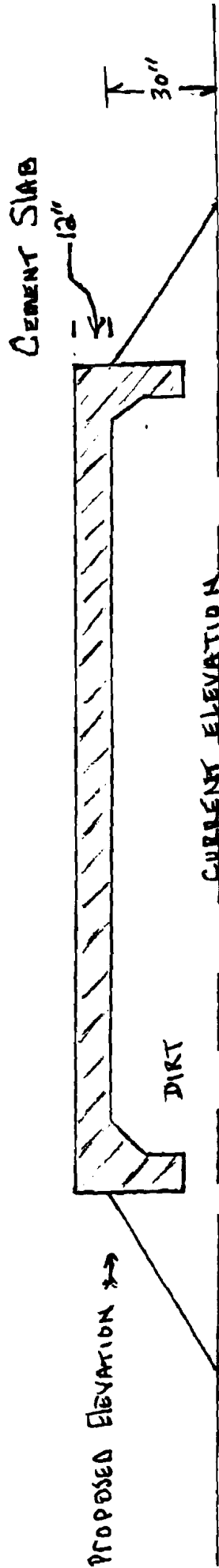

30" OF FILL DIRT FOR HOUSE PAD #1 AND #2. WIDTH OF FILL IS 100'  
 DEPTH OF FILL IS 75' FOR EACH HOUSE PAD, #1 AND #2.

100 X 75 X 2.5' ÷ 27 = 695 CU. YARDS OF FILL MATERIAL FOR HOUSE PAD #1  
 695 CU. YARDS OF FILL MATERIAL FOR HOUSE PAD #2

# 1

PROPOSED DRIVEWAY SECTION VIEW  
FOR HOUSE #1 AND #2

#5

DUSTIN FULLER  
337-368-3078

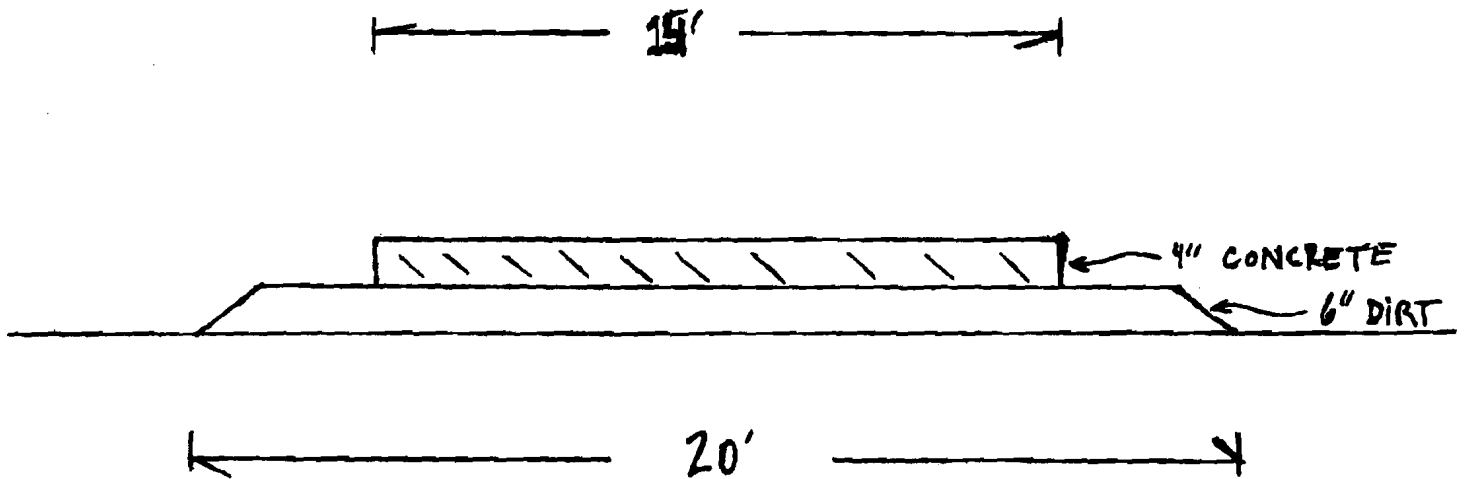

$$\text{HOUSE \#1} - 20 \times 450 \times .5' \div 27 = 166 \text{ cu. YARDS}$$

$$\text{HOUSE \#2} - 20 \times 240 \times .5' \div 27 = 89 \text{ cu. YARDS}$$