



Legend

-  Project Area (14.53 Acres)
-  Flow Direction

Note

Direction of flow is south-southeast.

Reference

Base map comprised of U.S.G.S. 7.5 minute topographic map, "Weeks, LA" dated 1963, photorevised 1980.

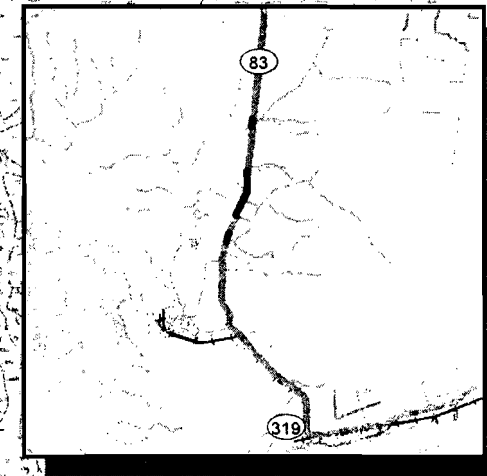

Vicinity Map
Weeks Island Bridges
 Coastal Use Permit
 SPN 240-03-0027/FAP BR-309-1(007)
 Iberia Parish, Louisiana

Louisiana
 Department of Transportation and Development



PROVIDENCE

Drawn By	LMM	09/17/08
Checked By	DRA	09/17/08
Approved By	RPC	09/17/08

Project Number	040-007
Drawing Number	040-007-A343

1
Figure

1. Excavated material (1066.7 yd³) will consist of pavement stripping at the contractor's discretion. Based on the information found within the Louisiana Standard Specifications for Roads and Bridges, State of Louisiana Department of Transportation and Development (Blue Book), it is the ultimate responsibility of the contractor to provide the disposal area or ultimate placement of excavated material within a non-wetland area. Contact information for the contractor and proposed disposal areas will be provided to the CMD upon letting of the project. At present, a contractor agreement has not been let for the proposed project.
2. Marsh Island National Wildlife Refuge is located approximately 18 miles south of the proposed project area, Marsh Island National Wildlife Management Area is located approximately 15 miles south of the proposed project area, Attakapas Island Wildlife Management Area is located approximately 22 miles east of the proposed project area, Bayou Tech National Wildlife Refuge is located approximately 13 miles west of the proposed project area, Palmetto Island State Park is located approximately 21 miles west of the proposed project area, Cypremont Point State Park is located approximately 7 miles southwest of the proposed project area, and no historical or archaeological sites are identified within the project area.
3. Properties adjacent to the proposed project area and the respective landowner information are attached to the application.
4. Fender System: All timber shall be southern pine or Douglas fir and treated according to the standard specifications and/or special provisions. All piles shall have coastal treatment. Use of ogee washers under bolt heads and nuts except for channel face of washers, where 1" diameter seal tite bolts with ogee washers under nuts shall be used. All bolts for channel face of fenders shall be countersunk so the heads of the bolts will not protrude beyond the face of the whalers. Drift bolts shall have square heads and ogee washers. All hardware shall be hot dipped and galvanized. All pile heads, cuts, trimming and bolt holes shall be treated according to the standard specifications. Pile lengths shown are order lengths. Walking surface timber for access walkway shall be rough on the walking surface side.
5. No falsework or temporary structures will be utilized.
6. Bayou Warehouse bridge construction has already commenced under emergency authorization 08-031. Plats within this joint permit application are specifically for after-the-fact compliance.
7. Use of waterborne equipment will be utilized upon contractor's discretion. All waterborne equipment used will draft no deeper than 0.61 ft if utilized at mean low water (MLW) or 2ft if utilized at mean high water (MHW). Draft depths will exceed 0.5 ft of canal bottom.

General Notes

Coastal Use Permit
Iberia Parish, Louisiana

Louisiana
Department of Transportation and Development



PROVIDENCE

Drawn By	LMM	09/22/08	
Checked By	DRA	09/22/08	
Approved By			
Project Number		2 Figure	
040-007			
Drawing Number			
040-007-A358			

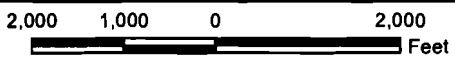
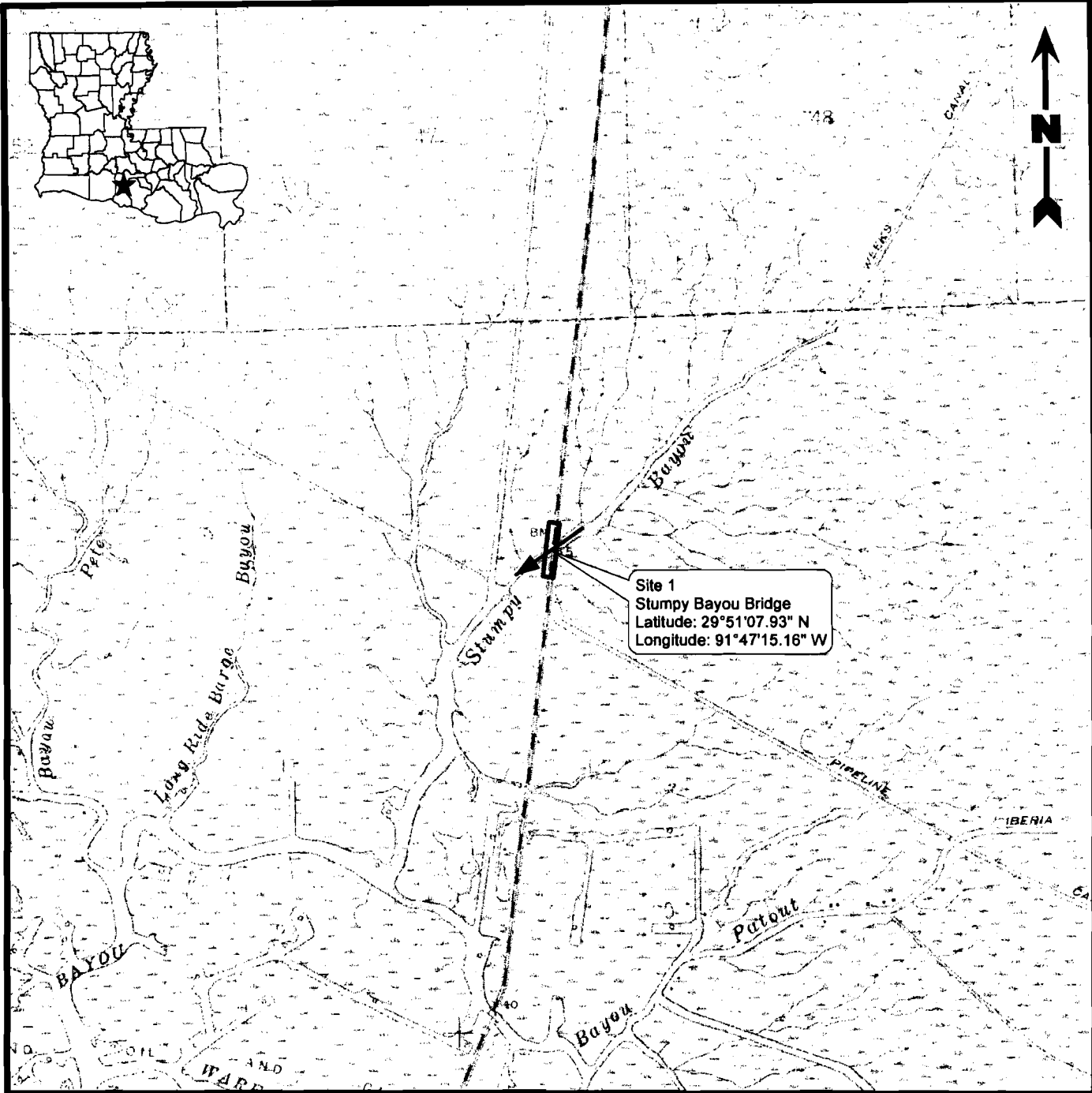

Legend

-  Project Area (2.68 Acres)
-  Flow Direction

Reference

Base map comprised of U.S.G.S. 7.5 minute topographic map, "Weeks, LA" dated 1963, photorevised 1980.

Site Location Map
Site 1 - Stumpy Bayou Bridge

Coastal Use Permit
 SPN 240-03-0027/FAP BR-309-1(007)
 Iberia Parish, Louisiana

Louisiana
 Department of Transportation and Development



PROVIDENCE

Drawn By	LMM	09/17/08
Checked By	DRA	09/17/08
Approved By	RPC	09/17/08

Project Number	040-007
Drawing Number	040-007-A344

3a
Figure

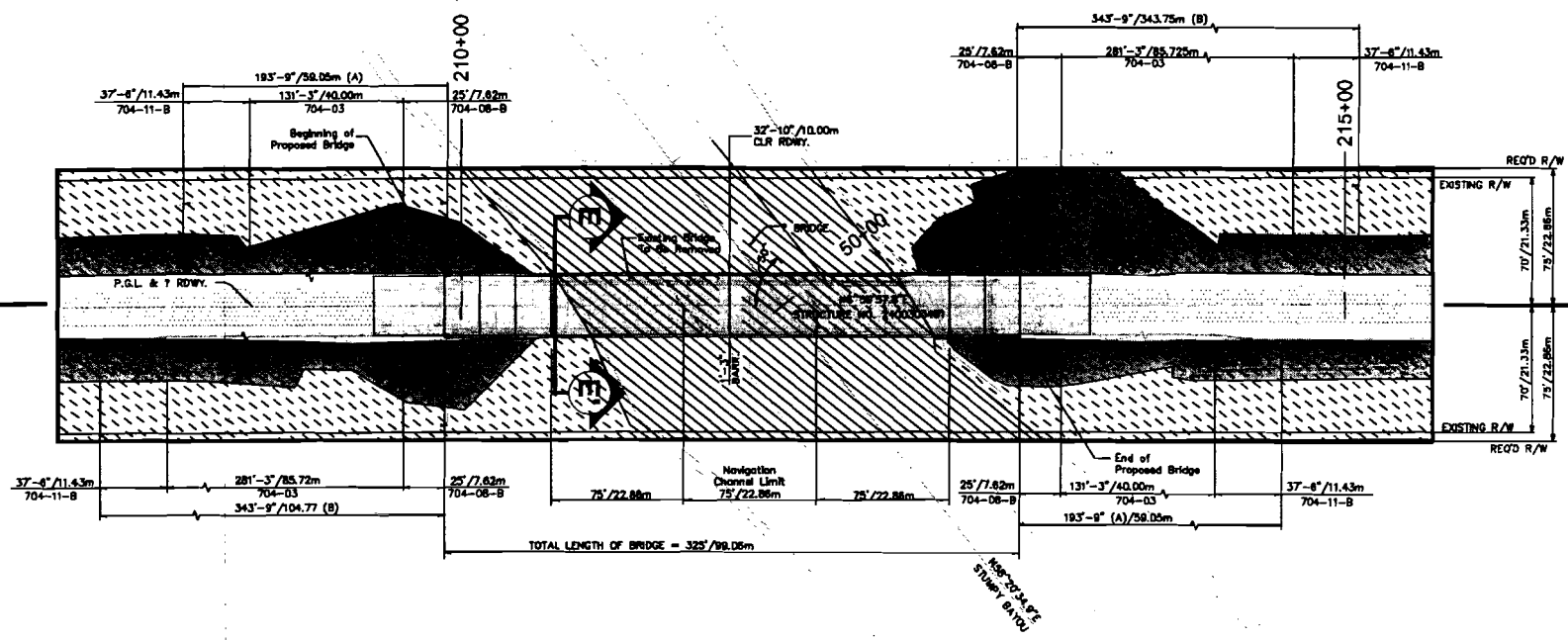

Legend

- Project Area (2.68 Acres)
- Potential Other Waters of the U.S. (0.69 Acre)
- Potential Jurisdictional Wetlands (1.50 Acres)
- Proposed Bridge
- Proposed Approach
- Limits of Fill (0.65 Acre)

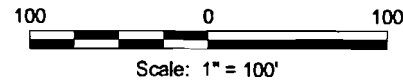

Reference

Base drawing provided by client.

Site Plan
Site 1 - Stumpy Bayou Bridge
 Coastal Use Permit
 SPN 240-03-0027/FAP BR-309-1(007)
 Iberia Parish, Louisiana

Louisiana
Department of Transportation and Development



PROVIDENCE

Drawn By	LMM	09/17/08
Checked By	DRA	09/17/08
Approved By	RPC	09/17/08

Project Number	040-007
Drawing Number	040-007-A345

3b
Figure

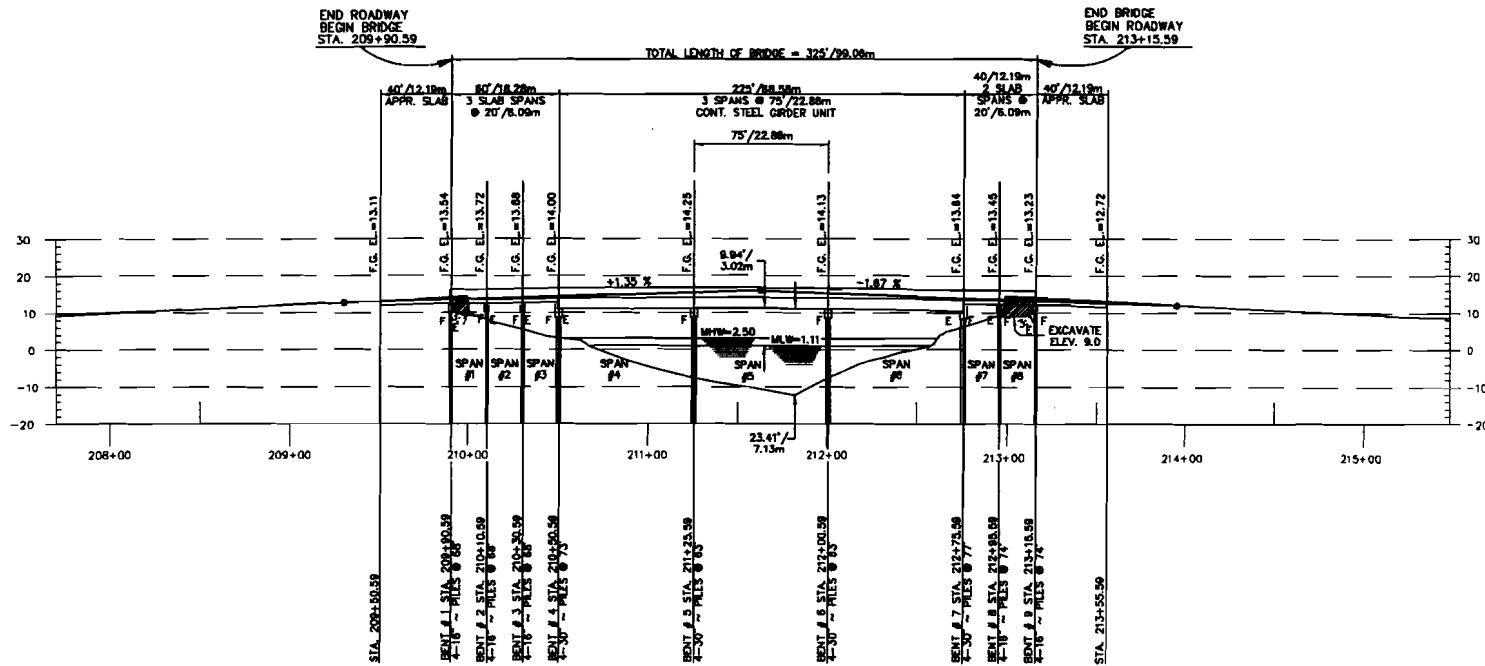

Section A-A'
 Horizontal Scale: 1" = 100'
 Vertical Scale: 1" = 50'

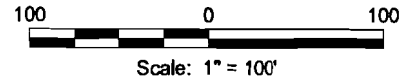

Note

Average Water Level = 1.72 ft

Cross Section A-A'
Site 1 - Stumpy Bayou Bridge
 Coastal Use Permit
 SPN 240-03-0027/FAP BR-309-1(007)
 Iberia Parish, Louisiana

Louisiana
Department of Transportation and Development



Drawn By	LMM	09/17/08
Checked By	DRA	09/17/08
Approved By	RPC	09/17/08

Project Number
040-007
 Drawing Number
040-007-A346

3c
Figure

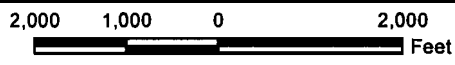
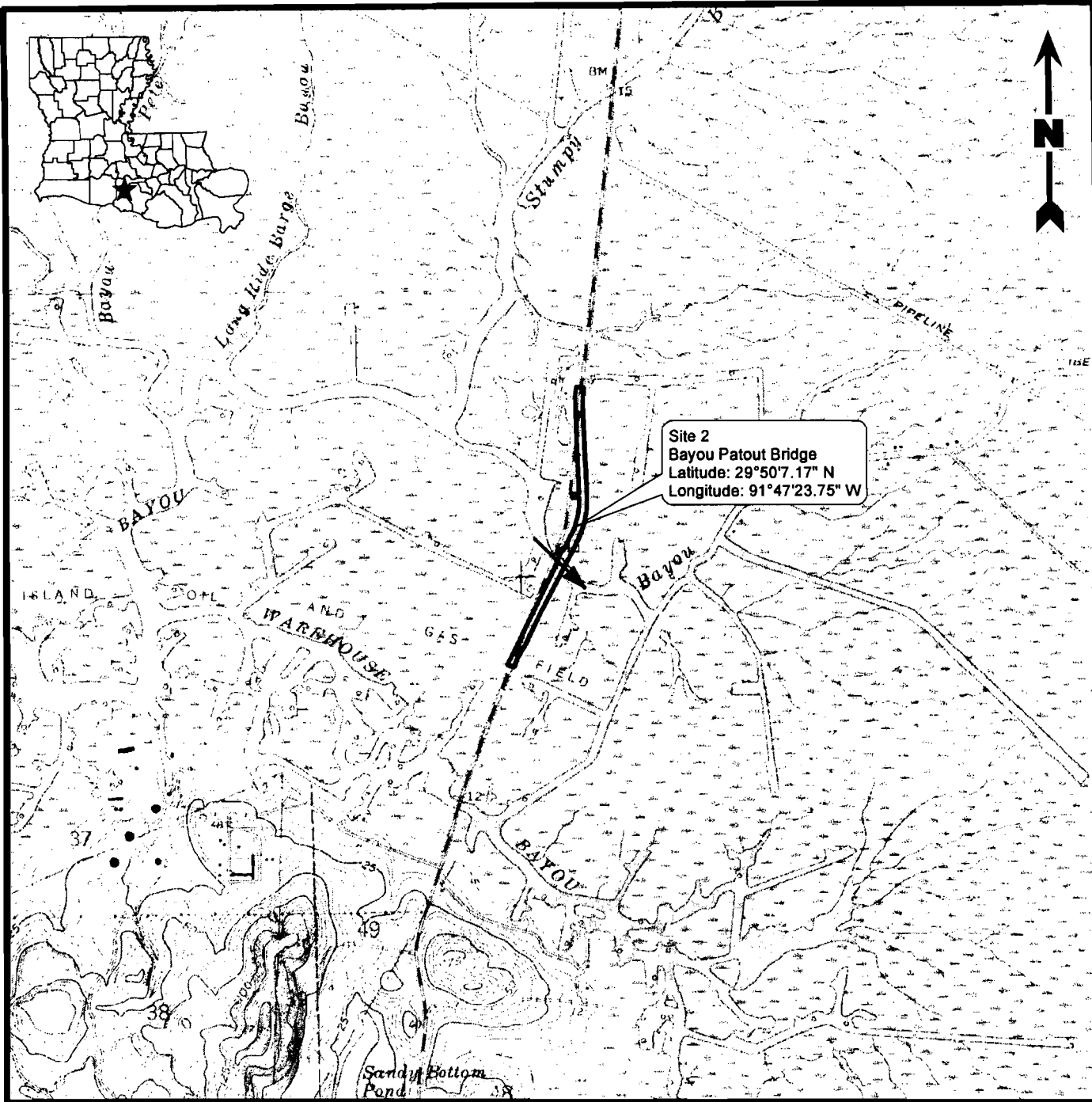

Legend

- Project Area (10.09 Acres)
- Flow Direction

Reference

Base map comprised of U.S.G.S. 7.5 minute topographic map, "Weeks, LA" dated 1963, photorevised 1980.

Site Location Map
Site 2 - Bayou Patout Bridge

Coastal Use Permit
 SPN 240-03-0027/FAP BR-309-1(007)
 Iberia Parish, Louisiana

Louisiana
 Department of Transportation and Development



PROVIDENCE

Drawn By	LMH	09/17/08
Checked By	DRA	09/17/08
Approved By	RPC	09/17/08
Project Number 040-007		4a Figure
Drawing Number 040-007-A347		

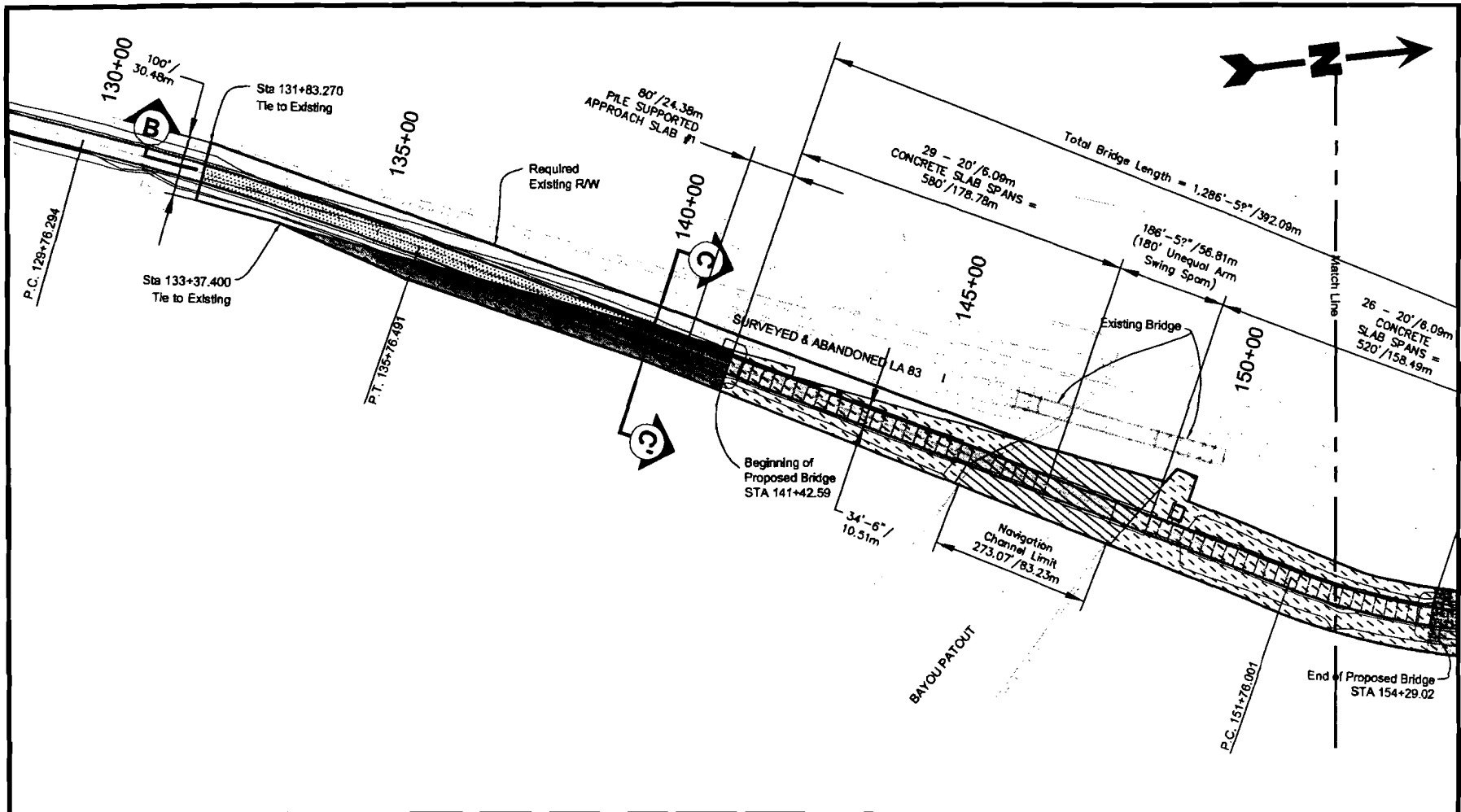

Legend

- Project Area (10.09 Acres)
- Potential Other Waters of the U.S. (0.76 Acre)
- Potential Jurisdictional Wetlands (6.57 Acres)
- Proposed Bridge
- Proposed Approach
- Limits of Fill (4.21 Acres)

Reference

Base drawing provided by client.

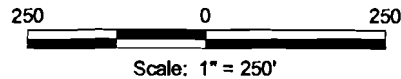

**Site Plan
Site 2 - Bayou Patout Bridge**

Coastal Use Permit
SPN 240-03-0027/FAP BR 309-1(007)
Iberia Parish, Louisiana

Louisiana
Department of Transportation and Development



PROVIDENCE





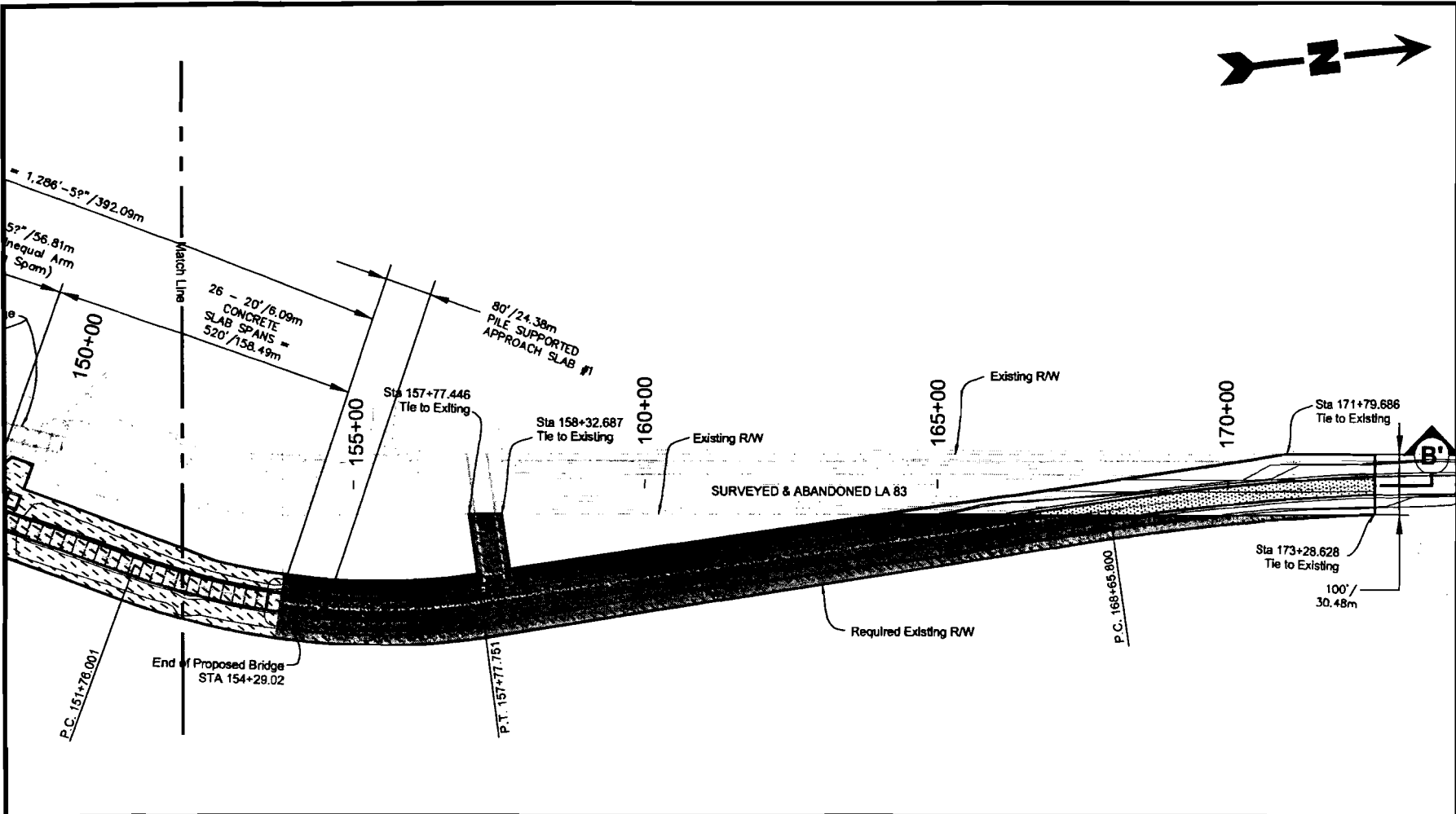

Drawn By	LMM	08/20/08
Checked By	DRA	08/20/08
Approved By	RPC	08/20/08

Project Number	040-007
Drawing Number	040-007-A348

4b
Figure

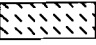

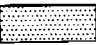
Legend

-  Project Area (10.09 Acres)
-  Potential Other Waters of the U.S. (0.76 Acre)
-  Potential Jurisdictional Wetlands (6.57 Acres)
-  Proposed Bridge
-  Proposed Approach
-  Limits of Fill (4.21 Acres)

Reference

Base drawing provided by client.

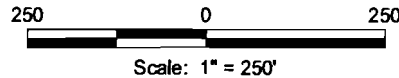

**Site Plan
Site 2 - Bayou Patout Bridge**

Coastal Use Permit
SPN 240-03-0027/FAP BR 309-1(007)
Iberia Parish, Louisiana

Louisiana
Department of Transportation and Development



PROVIDENCE

Drawn By	LMM	08/20/08
Checked By	DRA	08/20/08
Approved By	RPC	08/20/08

Project Number	040-007
Drawing Number	040-007-A349

4c
Figure

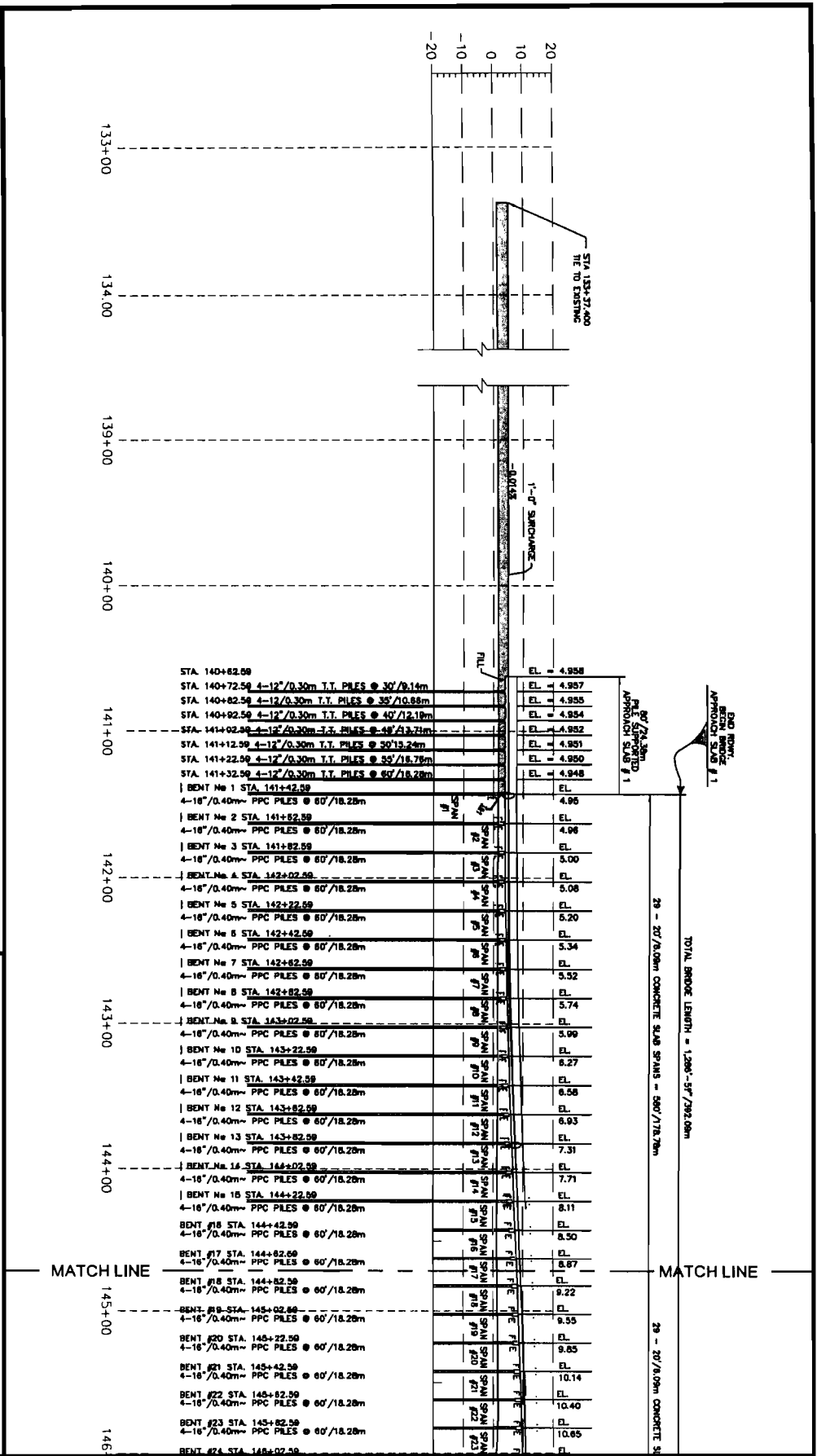

Legend

Fill Area

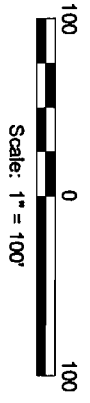

Reference

Base drawing provided by client.

Cross Section B-B'
Site 2 - Bayou Patout Bridge
 Coastal Use Permit
 SPN 240-03-0027/FAP BR-309-1(007)
 Iberia Parish, Louisiana

Department of Transportation and Development
LOUISIANA

PROVIDENCE

Project Number	040-007	
Drawing Number	040-007-A350	Figure
Drawn By	LMN	09/17/08
Checked By	DRA	09/17/08
Approved By	RPC	09/17/08

4d

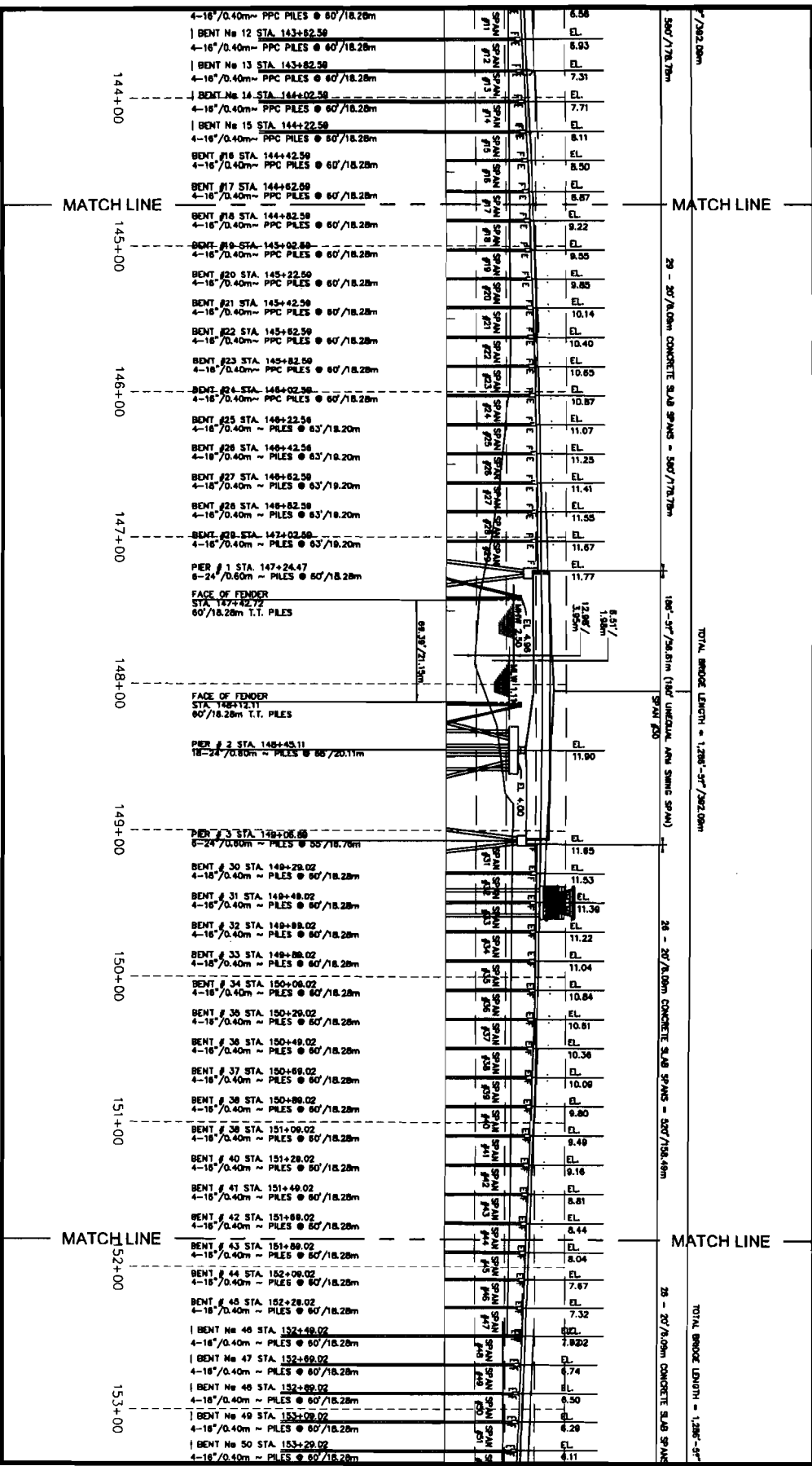

Note
Average Water Level = 1.72 ft

Reference

Base drawing provided by client.

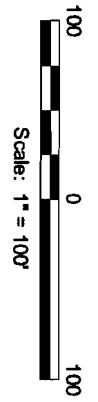

Cross Section B-B'
Site 2 - Bayou Patout Bridge
 Coastal Use Permit
 SPN 240-03-0027/FAP BR-309-1(007)
 Iberia Parish, Louisiana

Louisiana
 Department of Transportation and Development



PROVIDENCE

Drawn By	LMIM	09/17/08
Checked By	DRA	09/17/08
Approved By	RPC	09/17/08
Project Number	040-007	
Drawing Number	040-007-A354	
Figure	4e	

MATCH LINE

TOTAL BRIDGE LENGTH = 1,280'-9" / 390.28m

20' - 20' / 6.09m CONCRETE SLAB SPANS = 520' / 158.48m

END BRIDGE
FROM POINT
STA. 155+00.00

PILE CAPMENTS
APPROXIMATE STA. 2

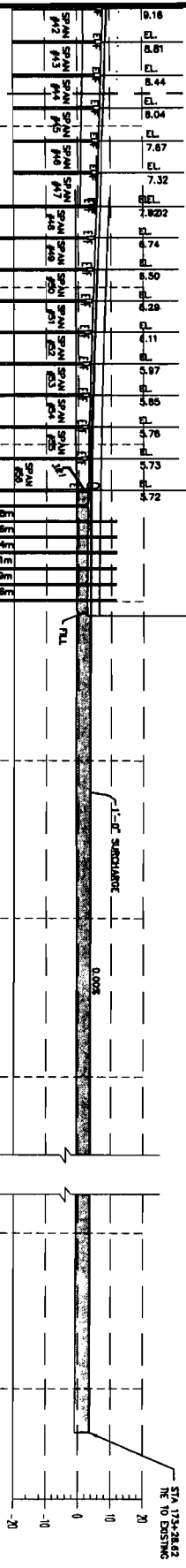

- 4-18" / 0.40m ~ PILES @ 60' / 18.28m
- BENT # 41 STA. 151+48.02
- 4-18" / 0.40m ~ PILES @ 60' / 18.28m
- BENT # 42 STA. 151+89.02
- 4-18" / 0.40m ~ PILES @ 60' / 18.28m
- BENT # 43 STA. 151+89.02
- 4-18" / 0.40m ~ PILES @ 60' / 18.28m
- BENT # 44 STA. 152+09.02
- 4-18" / 0.40m ~ PILES @ 60' / 18.28m
- BENT # 45 STA. 152+29.02
- 4-18" / 0.40m ~ PILES @ 60' / 18.28m
- BENT No 46 STA. 152+49.02
- 4-18" / 0.40m ~ PILES @ 60' / 18.28m
- BENT No 47 STA. 152+69.02
- 4-18" / 0.40m ~ PILES @ 60' / 18.28m
- BENT No 48 STA. 152+89.02
- 4-18" / 0.40m ~ PILES @ 60' / 18.28m
- BENT No 49 STA. 153+09.02
- 4-18" / 0.40m ~ PILES @ 60' / 18.28m
- BENT No 50 STA. 153+29.02
- 4-18" / 0.40m ~ PILES @ 60' / 18.28m
- BENT No 51 STA. 153+49.02
- 4-18" / 0.40m ~ PILES @ 60' / 18.28m
- BENT No 52 STA. 153+69.02
- 4-18" / 0.40m ~ PILES @ 60' / 18.28m
- BENT No 53 STA. 153+89.02
- 4-18" / 0.40m ~ PILES @ 60' / 18.28m
- BENT No 54 STA. 154+09.02
- 4-18" / 0.40m ~ PILES @ 60' / 18.28m
- BENT No 55 STA. 154+29.02
- 4-18" / 0.40m ~ PILES @ 60' / 18.28m
- STA. 154+39.02 4-12" / 0.30m T.T. PILES @ 60' / 18.28m
- STA. 154+49.02 4-12" / 0.30m T.T. PILES @ 55' / 16.76m
- STA. 154+59.02 4-12" / 0.30m T.T. PILES @ 50' / 15.24m
- STA. 154+69.02 4-12" / 0.30m T.T. PILES @ 45' / 13.71m
- STA. 154+79.02 4-12" / 0.30m T.T. PILES @ 40' / 12.19m
- STA. 154+89.02 4-12" / 0.30m T.T. PILES @ 35' / 10.66m
- STA. 154+99.02 4-12" / 0.30m T.T. PILES @ 30' / 9.14m
- STA. 155+09.02

MATCH LINE

Legend

Fill Area

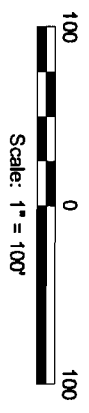

Reference

Base drawing provided by client.

Cross Section B-B'

Site 2 - Bayou Patout Bridge

Coastal Use Permit
SPN 240-03-0027/FAP BR-309-1(007)
Iberia Parish, Louisiana

Louisiana
Department of Transportation and Development



PROVIDENCE

Drawn By	LMM	09/17/08
Checked By	DPA	09/17/08
Approved By	RPC	09/17/08
Project Number	040-007	
Drawing Number	040-007-A355	

4f
Figure

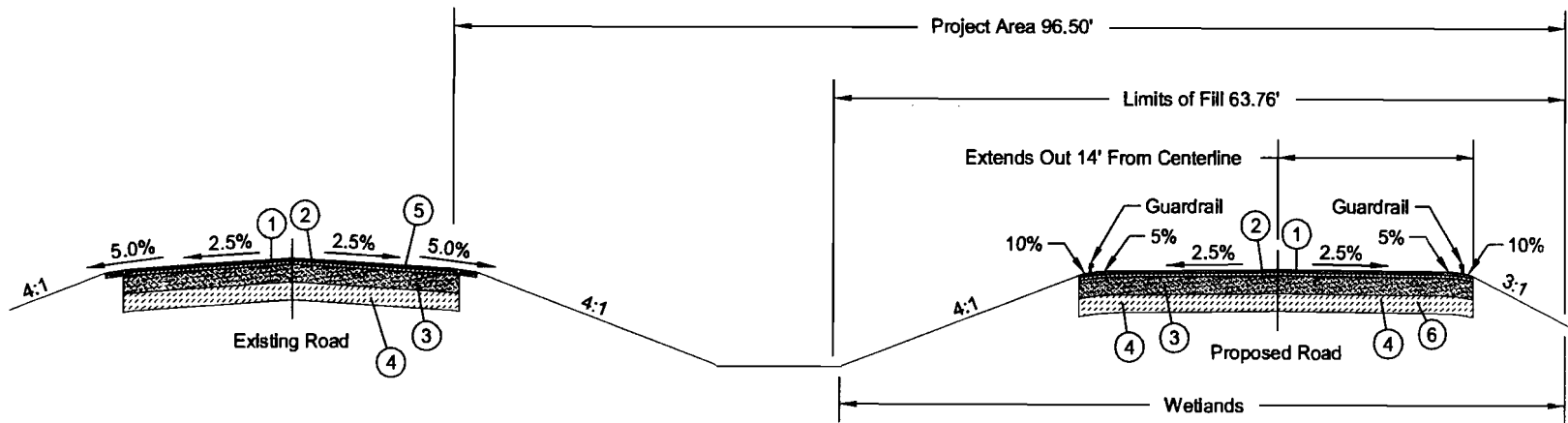

Section

Horizontal Scale: 1" = 15'
Vertical Scale: 1" = 10'

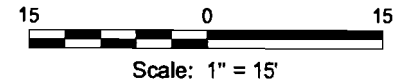

Legend

- ① 2" Superpave Asphaltic Concrete Wearing Course, Level 1 (995.885 yds³ for Entire Project)
- ② 2" Superpave Asphaltic Concrete Binder Course, Level 1 (995.885 yds³ for Entire Project)
- ③ 12" Cement Treated Base Course (4,789.026 yds³ for Entire Project)
- ④ 12" Type 'E' Lime Treatment, 9% By Volume, As Directed By The Project Engineer
- ⑤ Pavement Striping (1,066.7 yds³ for Entire Project)
- ⑥ 12" Topsoil/Dirt (17,323.034 yds³ for Entire Project)

**Typical Approach Cross Section
Site 2 - Bayou Patout Bridge**

Coastal Use Permit
SPN 240-03-0027/FAP BR-309-1(007)
Iberia Parish, Louisiana

**Louisiana
Department of Transportation and Development**



PROVIDENCE

Drawn By	LMM	08/25/08
Checked By	DRA	08/25/08
Approved By	RPC	08/25/08

Project Number	040-007
Drawing Number	040-007-A356

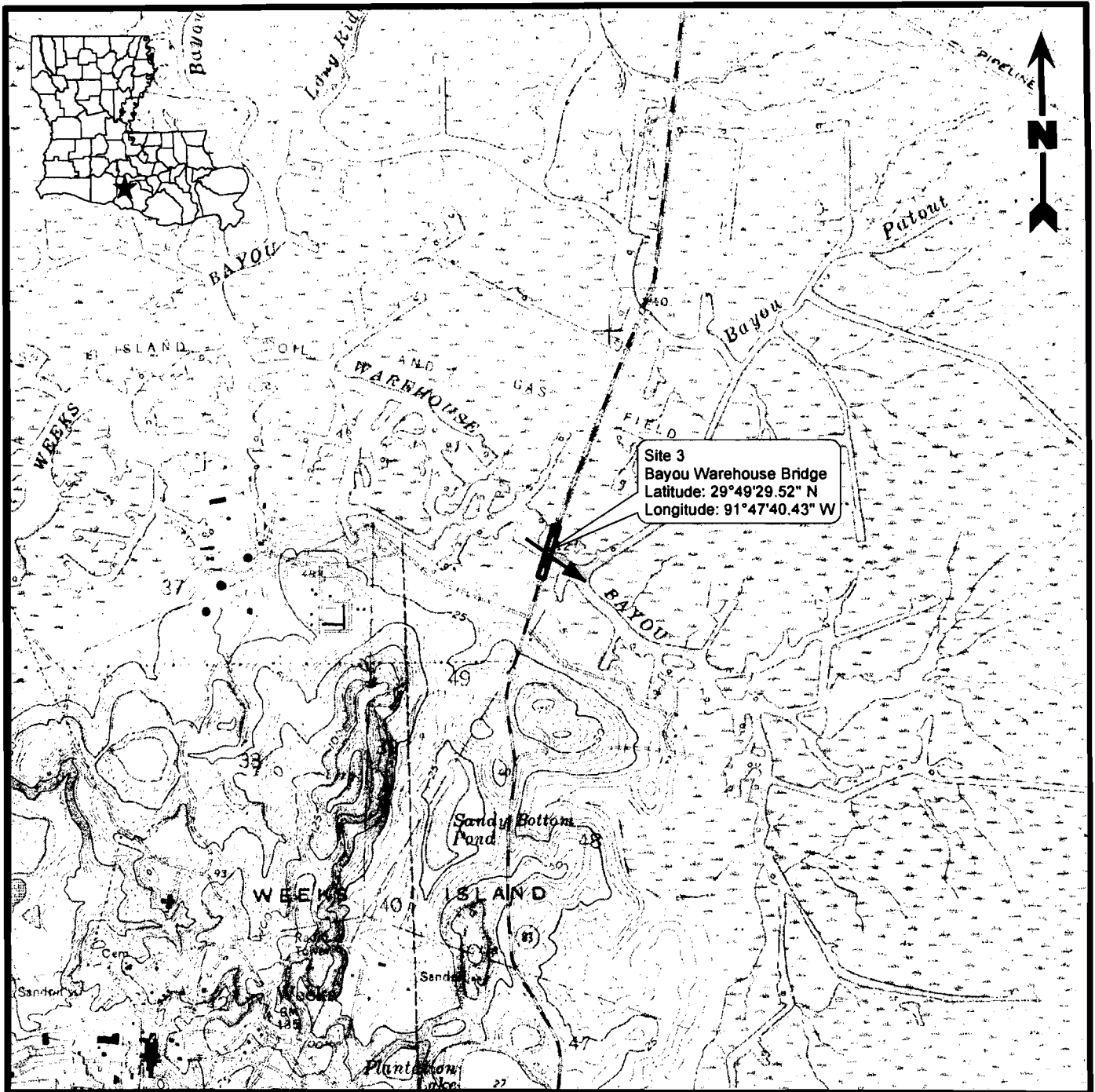

4g
Figure

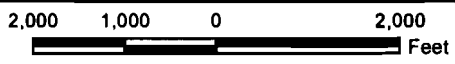

Site 3
 Bayou Warehouse Bridge
 Latitude: 29°49'29.52" N
 Longitude: 91°47'40.43" W



Legend

-  Project Area (1.76 Acres)
-  Flow Direction

Reference

Base map comprised of U.S.G.S. 7.5 minute topographic map, "Weeks, LA" dated 1963, photorevised 1980.

Site Location Map
Site 3 - Bayou Warehouse Bridge

Coastal Use Permit
 SPN 240-03-0027/FAP BR-309-1(007)
 Iberia Parish, Louisiana

Louisiana
 Department of Transportation and Development



PROVIDENCE

Drawn By	LMH	09/17/08
Checked By	DRA	09/17/08
Approved By	RPC	09/17/08

Project Number
 040-007

Drawing Number
 040-007-A351

5a

Figure

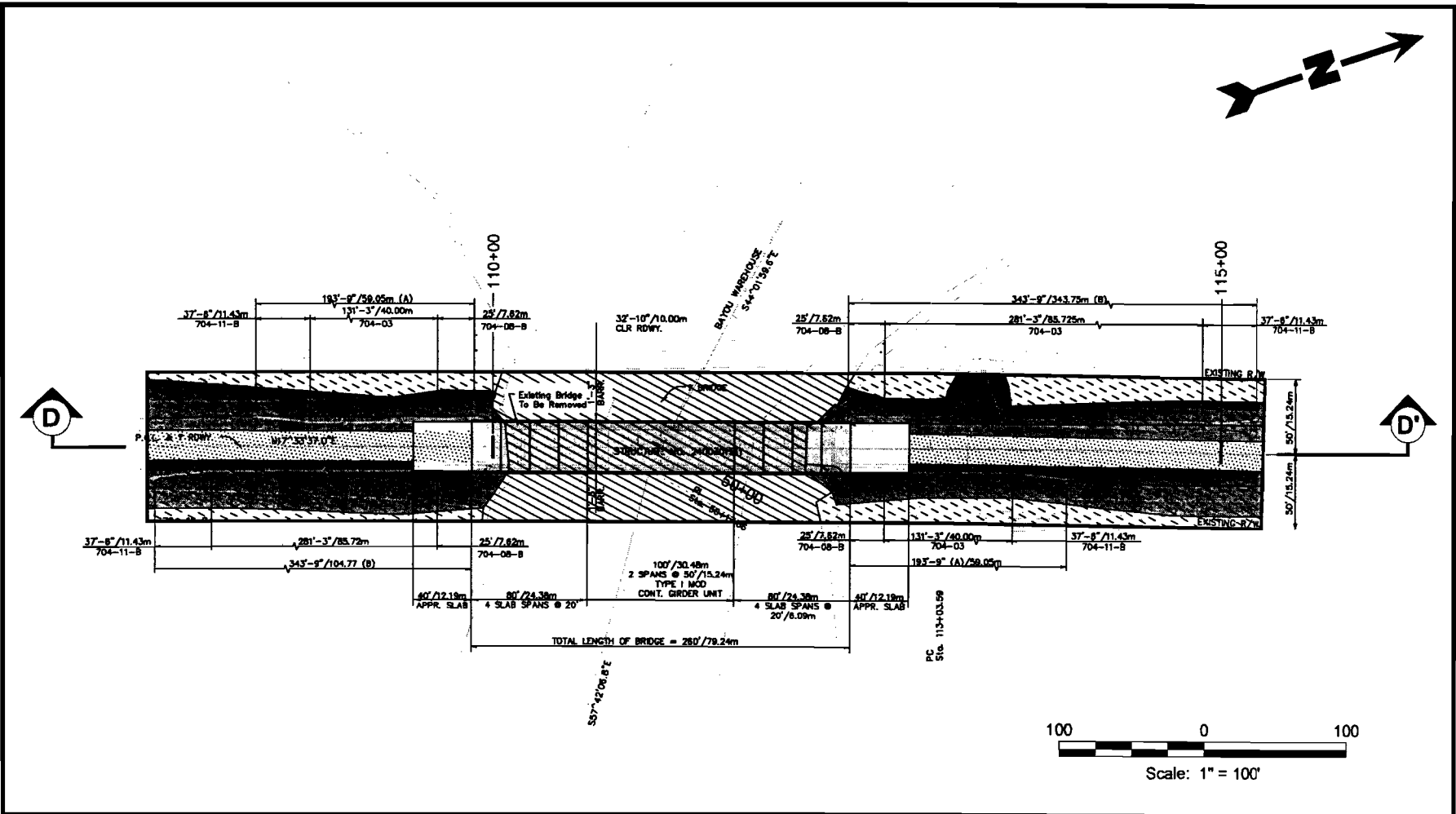

Legend

- Project Area (1.76 Acres)
- Potential Other Waters of the U.S. (0.51 Acre)
- Potential Jurisdictional Wetlands (0.78 Acre)
- Proposed Bridge
- Proposed Approach
- Limits of Fill (0.66 Acre)

Reference

Base drawing provided by client.

**Site Plan
Site 3 - Bayou Warehouse Bridge**

Coastal Use Permit
SPN 240-03-0027/FAP BR-309-1(007)
Iberia Parish, Louisiana

Louisiana
Department of Transportation and Development



PROVIDENCE

Drawn By	LMH	09/17/08
Checked By	DRA	09/17/08
Approved By	RPC	09/17/08

Project Number	040-007
Drawing Number	040-007-A352

5b
Figure

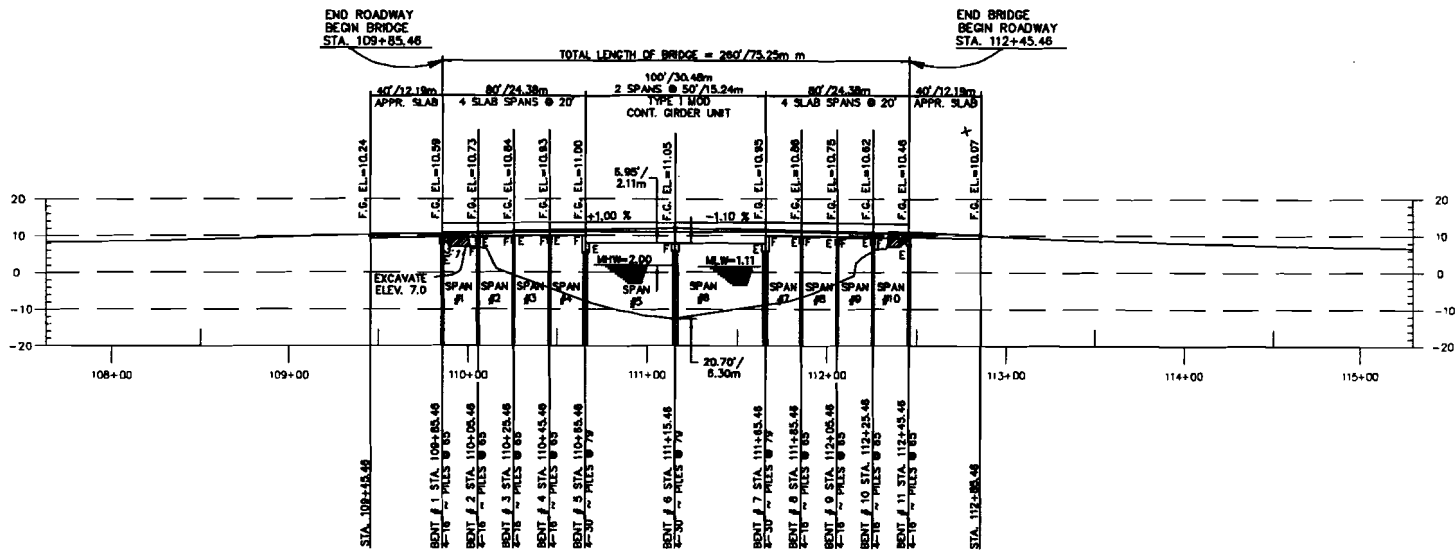

Section D-D'
 Horizontal Scale: 1" = 100'
 Vertical Scale: 1" = 50'

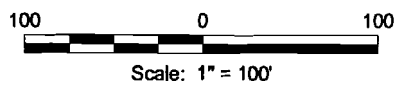

Note

Average Water Level = 1.72 ft

Cross Section D-D'
Site 3 - Warehouse Bayou Bridge
 Coastal Use Permit
 SPN 240-03-0027/FAP BR-309-1(007)
 Iberia Parish, Louisiana

Louisiana
 Department of Transportation and Development

Drawn By	LMM	09/17/08
Checked By	DRA	09/17/08
Approved By	RPC	09/17/08



Project Number
 040-007
 Drawing Number
 040-007-A353

5c
 Figure

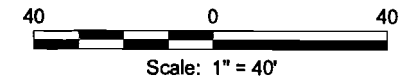
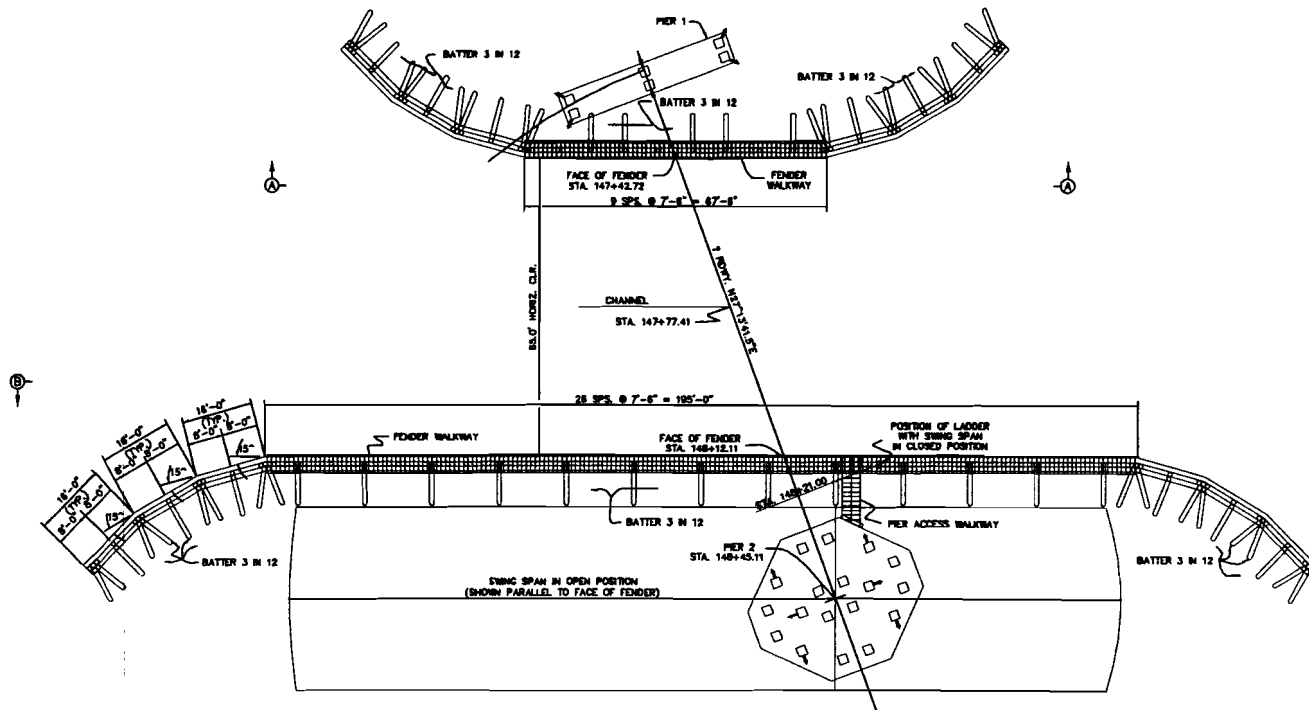

Note

Contractor may adjust placement of fender piles to avoid conflict with 24" pier piles, as approved by the project engineer.

Reference

Base drawing provided by client.

Fender System Layout Site 2 - Bayou Patout Bridge

Coastal Use Permit
SPN 240-03-0027/FAP BR-309-1(007)
Iberia Parish, Louisiana

Louisiana
Department of Transportation and Development



PROVIDENCE

Drawn By	LMM	09/17/08
Checked By	DRA	09/17/08
Approved By	RPC	09/17/08

Project Number	040-007
Drawing Number	040-007-A360

6a
Figure



FILE COVER DETAIL

NOTE: ALL TIMBER PILES TO BE IN ACCORDANCE WITH SUBSECTION 012.08

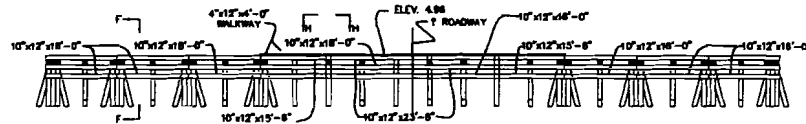

VIEW A-A

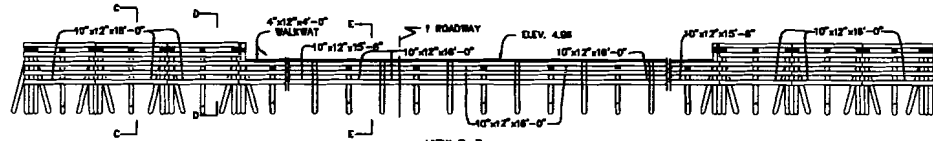

VIEW B-B

ESTIMATED QUANTITIES	
TREATED TIMBER	= 28.81 M.F.B.M.
TREATED TIMBER PILES (135 @ 80')	= 8300 L.M. FT.

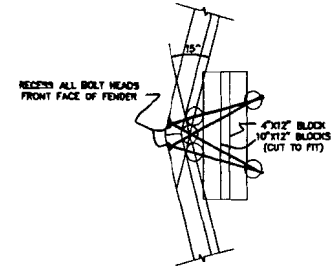

SECTION G-G

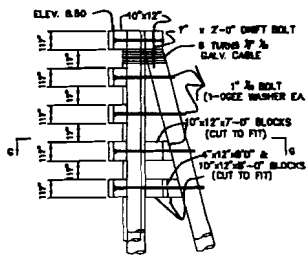

SECTION C-C

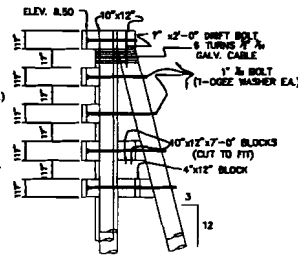

SECTION D-D

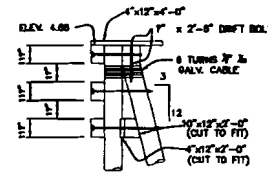

SECTION E-E

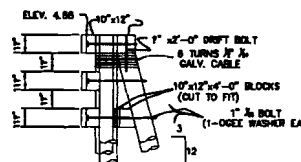

SECTION F-F

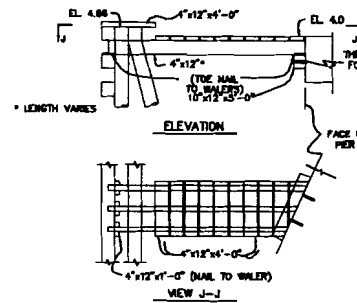

PIER 2 ACCESS WALKWAY DETAILS

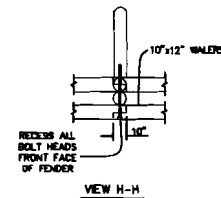

VIEW H-H

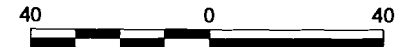

Scale: 1" = 40'

Fender System Elevations Site 2 - Bayou Patout Bridge

Coastal Use Permit
SPN 240-03-0027/FAP BR-309-1(007)
Iberia Parish, Louisiana

Louisiana
Department of Transportation and Development



PROVIDENCE

Drawn By	LMM	09/17/08
Checked By	DRA	09/17/08
Approved By	RPC	09/17/08

Project Number
040-007
Drawing Number
040-007-A359

6b
Figure

Reference

Base drawing provided by client.