

VICINITY MAP FOR SAINT TAMMANY PARISH SCHOOL BOARD

VICINITY MAP

SCALE: 1" = 4000'

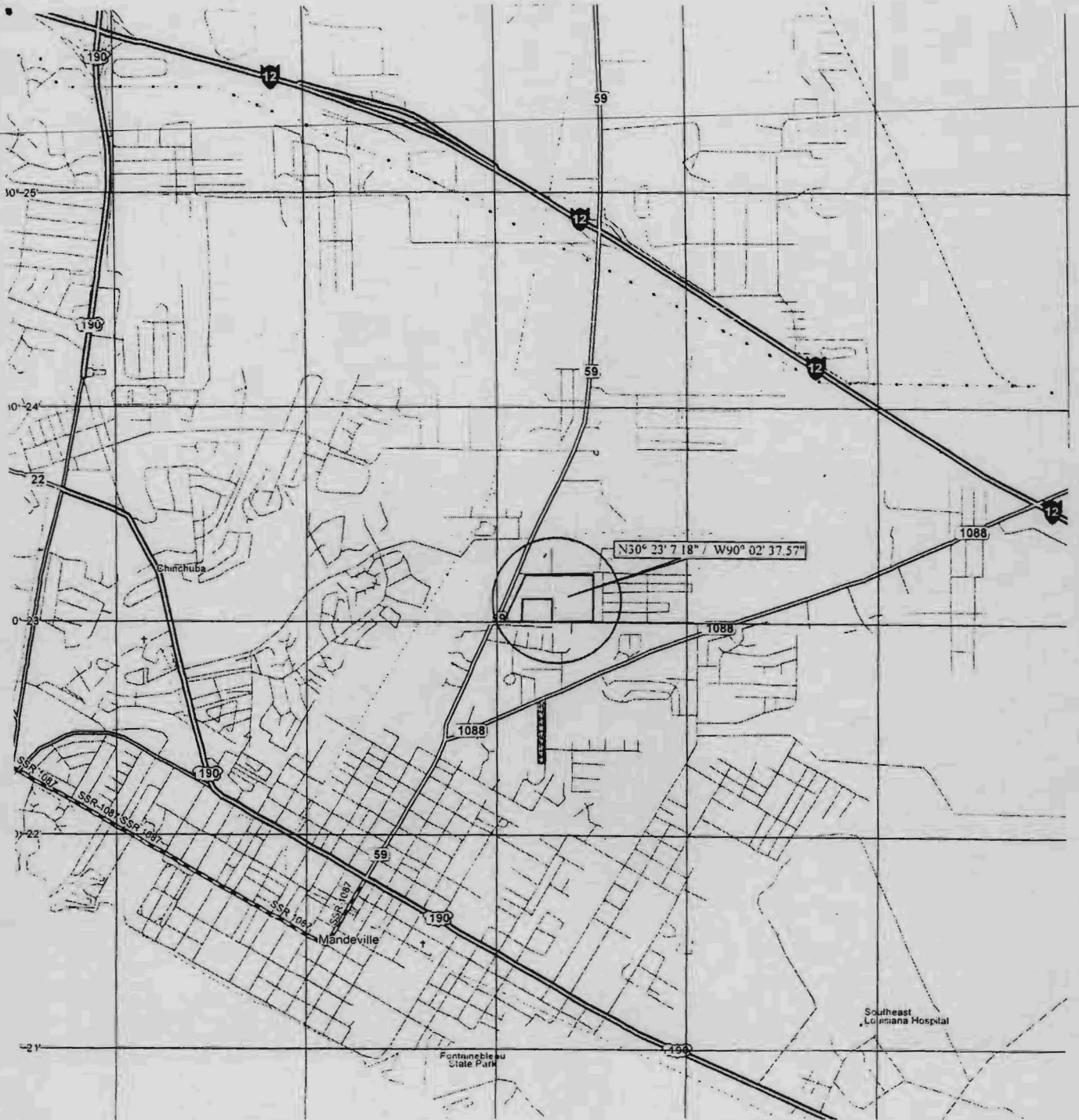
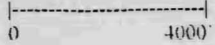

**PROJECT LOCATION: LOCATED IN SEC. 1-T8S-R11E,
CITY OF MANDEVILLE, ST. TAMMANY PARISH, LA.
LATITUDE: N30° 23' 7.18" / LONGITUDE: W90° 02' 37.57"**

J.V. BURKES & ASSOCIATES, INC.

1805 HWY 190 EAST - FREMAUX AVE, SLIDELL, LA 70461 / (985) 649-0075 / FAX: (985) 649-0154

VICINITY MAP FOR SAINT TAMMANY PARISH SCHOOL BOARD

VICINITY MAP

SCALE: 1" = 2000'

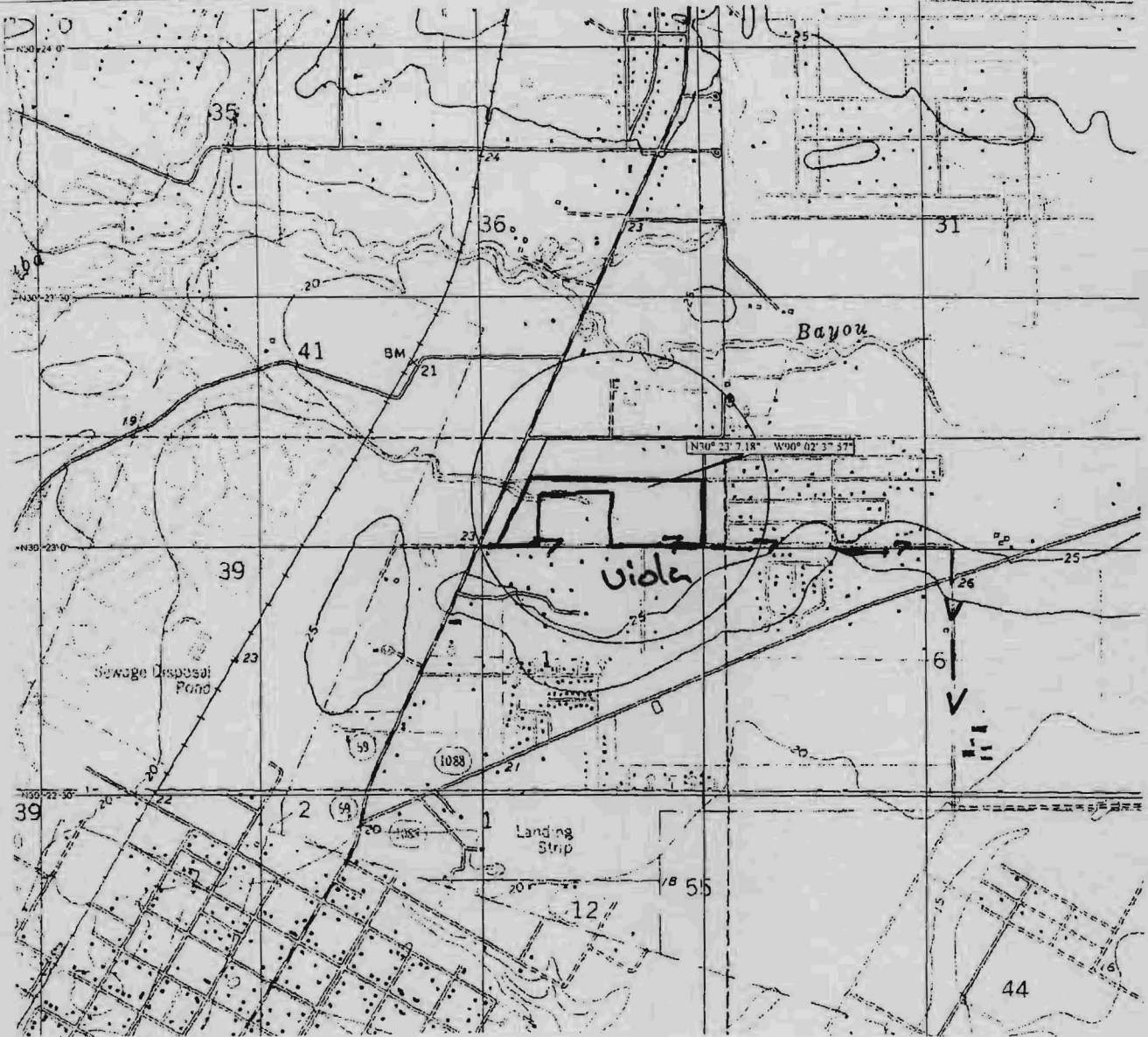
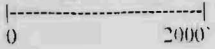

PROJECT LOCATION: LOCATED IN SEC. 1-T8S-R11E,
CITY OF MANDEVILLE, ST. TAMMANY PARISH, LA.
LATITUDE: N30° 23' 7.18" / LONGITUDE: W90° 02' 37.57"

J.V. BURKES & ASSOCIATES, INC.

1805 HWY 190 EAST - FREMAUX AVE, SLIDELL, LA 70461 / (985) 649-0075 / FAX: (985) 649-0154

WETLAND MAP FOR SAINT TAMMANY PARISH SCHOOL BOARD - VIOLA STREET: +/- 24 ACRES

VICINTY MAP

SCALE: 1" = 400'

0 400'

USACE

14-9-11-06
 Burkes
 FOR BURKES
 (# 2006-3142-ST)

 = WETLAND
 = NON-WETLAND

APPROVED
 JURISDICTIONAL DETERMINATION

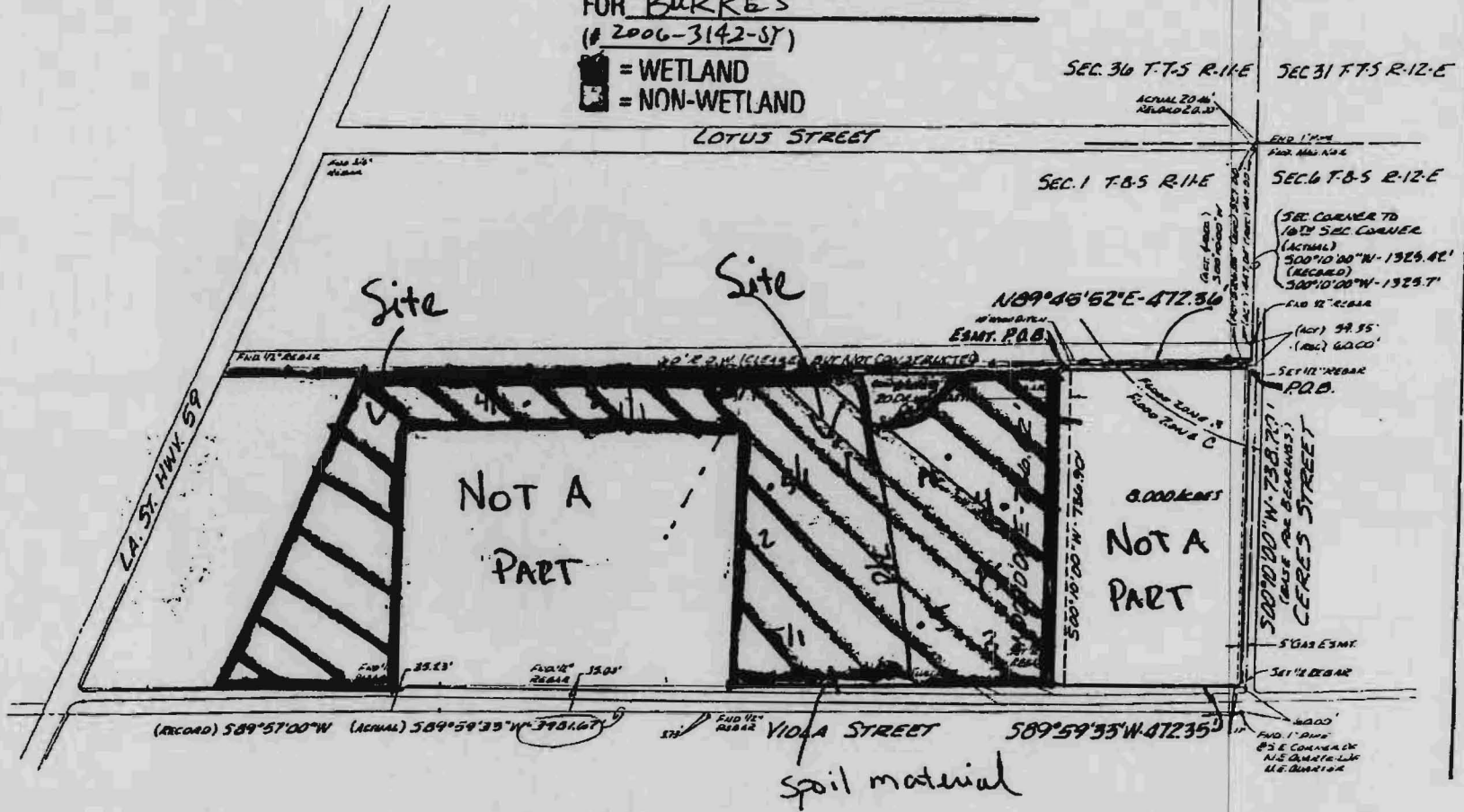

WETLAND AREAS

Project Located on Viola Street and Highway 59, in Section 1- T8S - R11E
 Mandeville, St. Tammany Parish, LA LATITUDE: N30° 23' 7.18" / LONGITUDE: W90° 02' 37.57"

J.V. BURKES & ASSOCIATES, INC.
 1805 HWY 190 EAST - FREMAUX AVE, SLIDELL, LA 70461 / (985) 649-0075 / FAX: (985) 649-0154

REVISED SITE PLAN FOR ST. TAMMANY PARISH SCHOOL BOARD: VIOLA K-1
 +/- 23.66-ACRE PARCEL LOCATED IN ST. TAMMANY PARISH: SEC.1, T8S, R11E
 LATITUDE: N30° 23' 7.18" / LONGITUDE: W90° 02' 37.57"

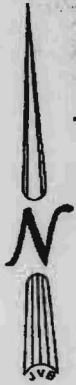

GRAPHIC SCALE

SCALE: 1" = 300'
 0 300'

PERMITS:

USACE: MVN 2007-349-EKK / CUP: P20070070 / DEQ: BB 070125-04

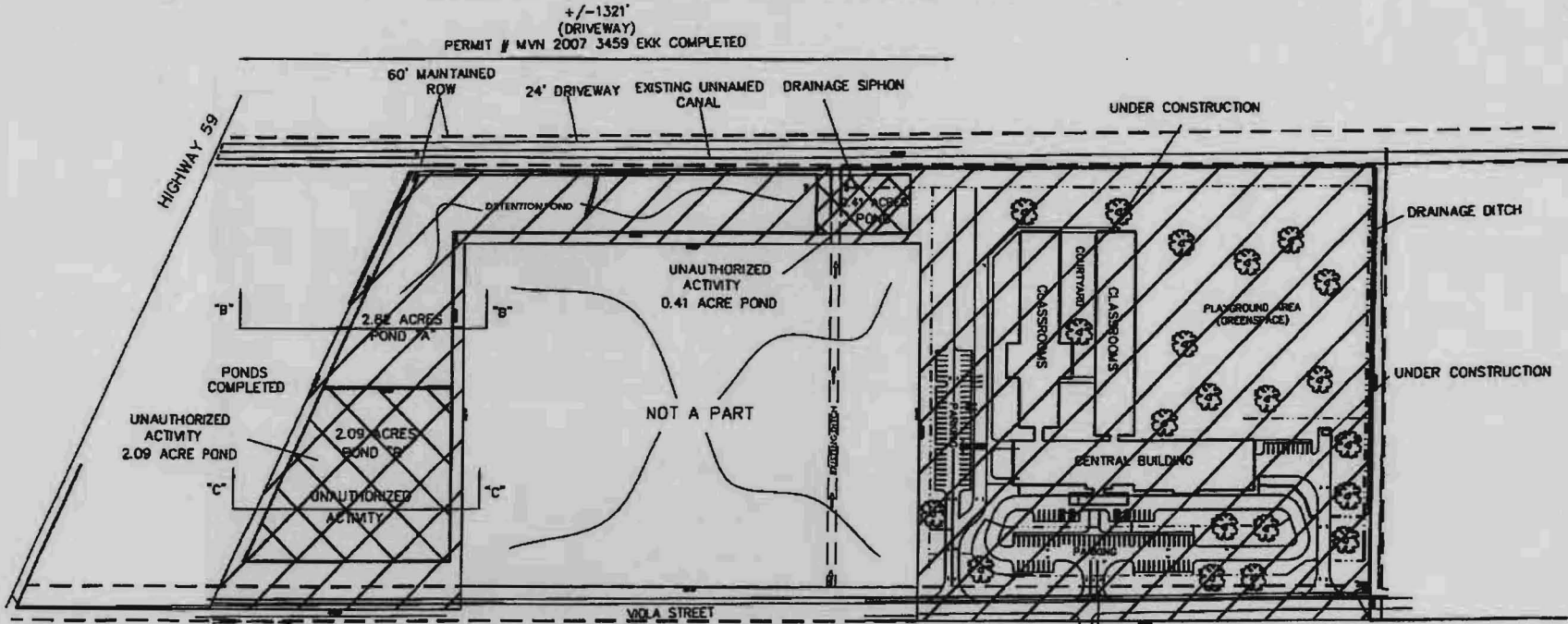

WETLAND AREAS



UNAUTHORIZED ACTIVITY
 PONDS COMPLETED

UNAUTHORIZED ACTIVITY; COMPLETED: 3.08 ACRES TOTAL / +/- 5356 c.y. additional onsite soils excavated to create 2.09 acre detention pond "B" (1' average depth) AND to create .41 acre expansion of detention pond "A", that now totals 3.23 acres (3' average depth) and used as back fill for site (if necessary).

SITE OVERVIEW/ REVISED 8/15/2008	
TOTAL ACREAGE:	± 23.66-ACRES
WETLANDS IMPACTED:	± 23.11-ACRES
NON-WETLANDS:	± 0.55-ACRES
UNAUTHORIZED ACTIVITY	± 3.08-ACRES

+/- 85,958 c.y. onsite (from excavation) or commercial soils hauled in to be used as base fill for project area including buildings, parking, road, and other site features.

+/- 5068 c.y. concrete hauled in for base pad for buildings, parking, driveways and other site features.

CROSS SECTION FOR ST. TAMMANY PARISH SCHOOL BOARD:

+/- 23.66-ACRE PARCEL LOCATED IN ST.TAMMANY PARISH: SEC.1, T8S, R11E
 LATITUDE: N30° 23' 7.18"/ LONGITUDE: W90° 02' 37.57"

TYPICAL PROFILE - SECTION A-A

HORIZONTAL SCALE: 1" = 100'
 VERTICAL SCALE: NTS

DATE: 09/08/2006; REVISED
 6/22/07; REVISED 8/15/2008

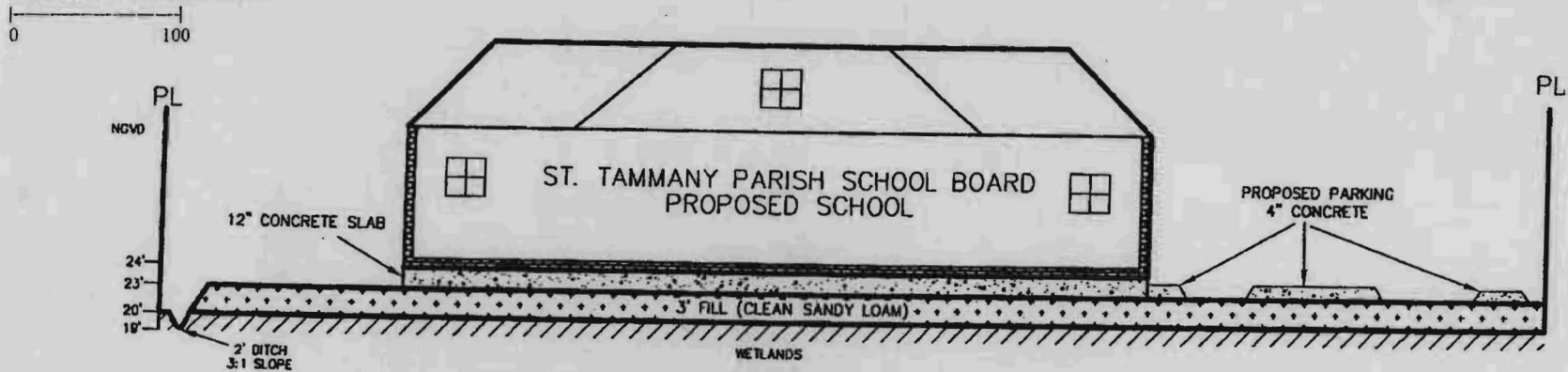

+/- 85,958 c.y. onsite (from excavation) or commercial soils hauled in to be used as base fill for project area including buildings, parking, road, and other site features.

+/- 5068 c.y. concrete hauled in for base pad for buildings, parking, driveways and other site features.

TYPICAL PROFILE - SECTION B-B - DETENTION POND

HORIZONTAL SCALE: 1" = 40'
 VERTICAL SCALE: NTS

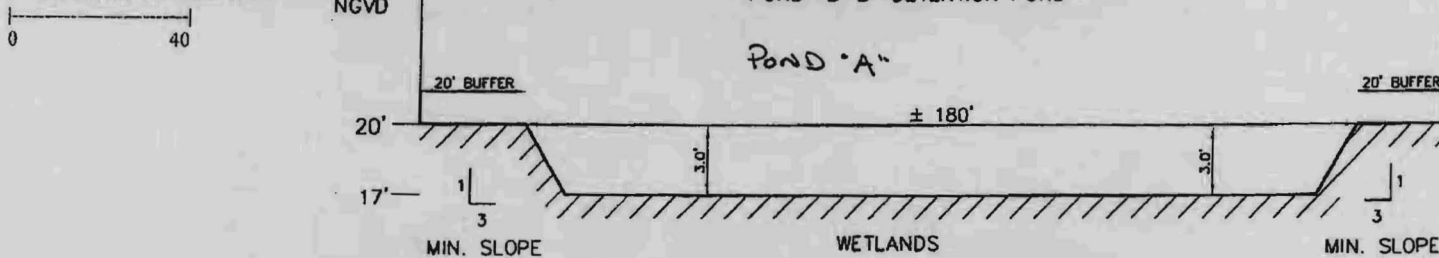

AS PER DRAINAGE MASTER PLAN
 RETENTION POND = 2.82 ACRES + 0.41 ACRES

UNAUTHORIZED ACTIVITY; COMPLETED: 3.08 ACRES TOTAL / +/- 5356 c.y. additional onsite soils excavated to create 2.09 acre detention pond "B" (1' average depth) AND to create .41 acre expansion of detention pond "A", that now totals 3.23 acres (3' average depth) and used as back fill for site (if necessary).

J.V. BURKES & ASSOCIATES, INC.

2990 GAUSE BLVD. EAST, STE. B SLIDELL, LA 70461 / (985) 649-0075 / FAX: (985) 649-0154

CROSS SECTION FOR ST. TAMMANY PARISH SCHOOL BOARD:
 +/- 23.66-ACRE PARCEL LOCATED IN ST. TAMMANY PARISH: SEC. 1, T8S, R11E
 LATITUDE: N30° 23' 7.18" / LONGITUDE: W90° 02' 37.57"

TYPICAL PROFILE – SECTION C-C – DETENTION POND

HORIZONTAL SCALE: 1" = 40'

VERTICAL SCALE: NTS

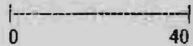

REVISED: 08/15/2008

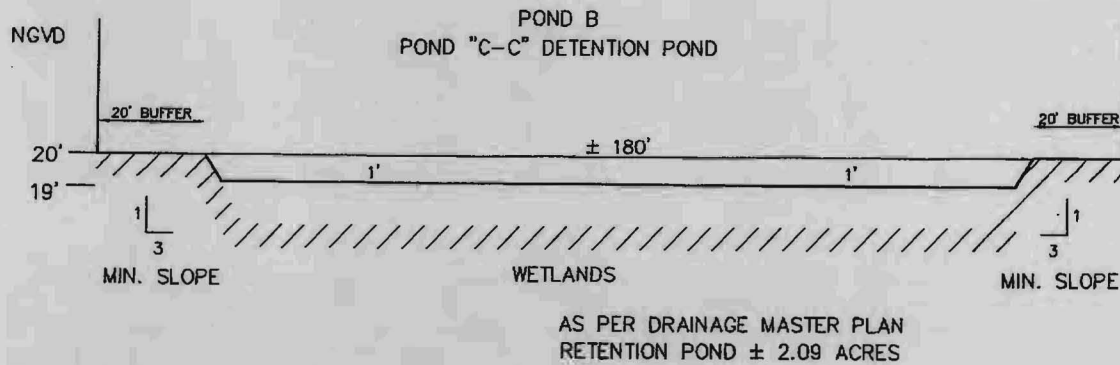

COMPLETED: +/- 19,005 c.y. onsite soils excavated to create detention ponds (1-3' average depth) and used as back fill for site (if necessary). Remainder will be hauled off-site to a non-wetland location.

UNAUTHORIZED ACTIVITY; COMPLETED: 3.08 ACRES TOTAL / +/- 5356 c.y. additional onsite soils excavated to create 2.09 acre detention pond "B" (1' average depth) AND to create .41 acre expansion of detention pond "A", that now totals 3.23 acres (3' average depth) and used as back fill for site (if necessary).

J.V. BURKES & ASSOCIATES, INC.

2990 GAUSE BLVD. EAST, STE. B SLIDELL, LA 70461 / (985) 649-0075 / FAX: (985) 649-0154