



# PUBLIC NOTICE

**US Army Corps  
of Engineers**  
Rock Island District

Applicants: Virgil Hamm and  
Sheila Krider

Date: March 17, 2004  
Expires: April 15, 2004

CEMVR-OD-P-2003-1170

Section 10/404

---

**Joint Public Notice  
US Army Corps of Engineers  
Illinois Environmental Protection Agency  
Illinois Department of Natural Resources/Office of Water Resources**

1. Applicants. Mr. Virgil Hamm and Ms. Sheila Krider, 4074 E. Heitz Road, Vermont, Illinois 61484-9662.
2. Project Location. Sections 8 & 18, Township 19 North, Range 11 West, Cass County, Illinois; in backwater areas of the Illinois River.
3. Project Description. To construct earthen closing structures on both Batch Slough and Pluckamet Slough, and rehabilitate a degraded levee along Sangamon Bay. The purpose of the project is to increase water depths throughout the Treadway Lake backwater area and Sangamon Bay during the fall waterfowl migration.
  - a. Closing Structures. Earthen closing structures will be constructed on both Batch Slough and Pluckamet Slough. Fill material for the structures will be excavated from the islands adjacent to each structure location. Each structure will be approximately 50 feet long, with 3H:1V sideslopes and an 8-foot-wide top. Boat "pull-overs" will be installed on these structures to maintain public access from the Illinois River to Treadway Lake. Approximately 200 cubic yards of fill will be required for each structure. These new structures, in conjunction with other existing structures, will create an estimated 2-foot increase in water depth over approximately 3700-acres in Treadway Lake and surrounding backwaters.
  - b. Levee rehabilitation. An existing 6500-foot long earthen levee on the south and east sides of Sangamon Bay will also be rehabilitated. Soil will be excavated immediately adjacent to the levee alignment to use for the repair work. Top elevation of the levee will be approximately 3-4 feet above the surrounding ground elevation. This levee will allow improved water level management within Sangamon Bay.
4. Agency Review.
  - a. Department of the Army, Corps of Engineers. The Department of the Army application is being processed under the provisions of Section 10 of the Rivers and Harbors Act of 1899 (33 U.S.C. 403) and Section 404 of the Clean Water Act (33 U.S.C. 1344).
  - b. State of Illinois.
    - (1) The applicant has applied to the Illinois Environmental Protection Agency (IEPA) for water quality certification, or waiver thereof, for the proposed activity in accordance with Section 401 of the Clean Water Act. Certification or waiver indicates that IEPA believes the activity will not violate applicable water quality standards. The review by the IEPA is conducted in accordance with the Illinois water quality standards under 35 Illinois Administrative Code Subtitle C. The water quality standards provide for the IEPA to review individual projects by providing an antidegradation assessment, which includes an evaluation of alternatives to any proposed increase in pollutant loading that may result from this activity. The "Fact Sheet" containing the antidegradation assessment for this proposed project may be found on the IEPA's web site, at [www.epa.state.il.us/public-notices/](http://www.epa.state.il.us/public-notices/). In the event that the IEPA is unable to publish the "Fact Sheet" corresponding to the timeframe of this Joint Public Notice, a separate public notice and "Fact Sheet" will be published by the IEPA at the web site identified above. You may also obtain a copy of the "Fact Sheet" by contacting the IEPA at the address or telephone number shown below. Written comments specifically concerning possible impacts to water quality should be addressed to: Illinois Environmental Protection Agency, Bureau of Water, Watershed Management Section, 1021 N. Grand Avenue East, P.O. Box 19276, Springfield, Illinois 62794-9276. A copy of the written comments should be provided to the Corps of Engineers. If you have any questions please contact IEPA at (217) 782-3362."
    - (2) The Illinois Department of Natural Resources, Office of Natural Resources (IDNR/OWR), application is being processed pursuant to an Act in Relation to the Regulation of the Rivers, Lakes and Streams of the State of Illinois, Chapter 615, ILCS 5 (Illinois Compiled Statutes (1994)). Comments concerning the IDNR/OWR permit should be addressed to the Illinois Department of Natural Resources, Office of Water Resources, One Natural Resources Way, Springfield, Illinois 62702-1271, with a copy provided to the Corps of Engineers (see paragraph 11. of this public notice for address). Mr. Mike Diedrichsen, IDNR/OWR (217/782-3863), may be contacted for additional information.

5. Historical/Archaeological. The Corps consulted with the District geographic information systems (GIS) archeological site and survey databases current as of August 2003. The query determined that there were no previously recorded archeological sites in the permit area and that the area had not been surveyed. The permit area is located between Illinois Waterway River Miles 95 and 97 and involves berm construction and levee repair. All work will be confined to recent alluvium and land previously disturbed by levee construction. The Corps has determined that no historic properties are affected by issuance of this permit because "the nature, scope, and magnitude of the work, and/or structures to be permitted are such that there is little likelihood that a historic property exists or may be affected" (33 CFR Part 325, Appendix C.3.b).

6. Endangered Species. District staff have performed a preliminary review of this application for the potential impact on threatened or endangered species pursuant to Section 7 of the Endangered Species Act as amended. Our preliminary determination is that the proposed activity is not likely to adversely affect any listed species or critical habitat. Therefore, no formal consultation has been initiated with the United States Fish and Wildlife Service at this time. However, this preliminary determination is subject to change should further information become available.

7. Dredge/Fill Material Guidelines. The evaluation of the impact of the proposed activity on the public interest will also include application of the guidelines promulgated by the Administrator of the United States Environmental Protection Agency under authority of Section 404(b) of the Clean Water Act (40 CFR Part 230).

8. Public Interest Review. The decision whether to issue the Corps permit will be based on an evaluation of the probable impact including cumulative impacts of the proposed activity on the public interest. That decision will reflect the national concern for both protection and utilization of important resources. The benefit which reasonably may be expected to accrue from the proposal must be balanced against its reasonably foreseeable detriments. All factors which may be relevant to the proposal will be considered including the cumulative effects thereof; among those are conservation, economics, aesthetics, general environmental concerns, wetlands, cultural values, fish and wildlife values, flood hazards, floodplain values, land use, navigation, shoreline erosion and accretion, recreation, water supply and conservation, water quality, energy needs, safety, food production and, in general, the needs and welfare of the people.

9. Who Should Reply. The Corps of Engineers is soliciting comments from the public; Federal, state, and local agencies and officials; Indian Tribes; and other interested parties in order to consider and evaluate the impacts of this proposed activity. Any comments received will be considered by the Corps of Engineers to determine whether to issue, modify, condition or deny a permit for this proposal. To make this decision, comments are used to assess impacts on endangered species, historic properties, water quality, general environmental effects, and the other public interest factors listed above. Comments are used in the preparation of an Environmental Assessment and/or an Environmental Impact Statement pursuant to the National Environmental Policy Act. Comments are also used to determine the need for a public hearing and to determine the overall public interest of the proposed activity. These statements should be submitted on or before the expiration date specified at the top of page 1. These statements should bear upon the adequacy of plans and suitability of locations and should, if appropriate, suggest any changes considered desirable.

10. Public Hearing Requests. Any person may request, in writing, within the comment period specified in this notice, that a public hearing be held to consider this application. Requests for public hearings shall state, with particularity, the reasons for holding a public hearing. A request may be denied if substantive reasons for holding a hearing are not provided.

11. Reply to the Corps. Comments concerning the Corps permit should be addressed to the District Engineer, US Army Corps of Engineers, Rock Island District, ATTN: OD-P, Clock Tower Building - Post Office Box 2004, Rock Island, Illinois 61204-2004. **Mr. Jon Klingman (309/794-5329)** may be contacted for additional information.

Attach  
Plan

Jon A. Klingman  
Project Manager  
Regulatory Branch

REQUEST TO POSTMASTERS: Please post this notice conspicuously and continuously until the expiration date specified at the top of page 1.

NOTICE TO EDITORS: This notice is provided as background information for your use in formatting news stories. This notice is not a contract for classified display advertising.

SUBJECT: CEMVR-OD-P-2003-1170

KLINGMAN  
OD-PP

APPLE  
OD-PP

ZEMO/  
OD-PP

KLINGMAN  
OD-PP

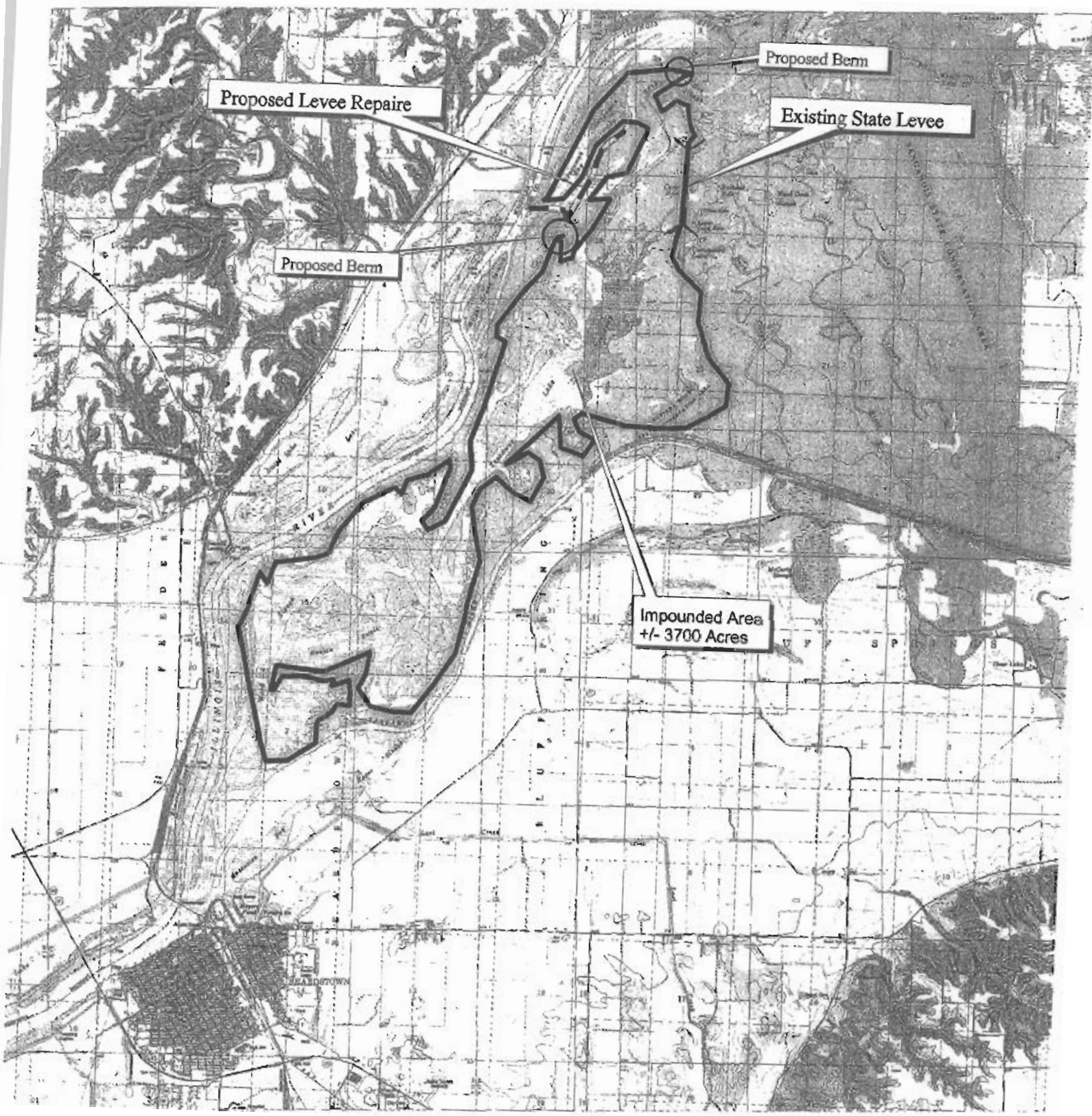

CEMVR-0D-P-2003-1170  
Sheet 1 of 4  
Project Area

Profile  
 cross section  
 + section  
 Richard Kridger

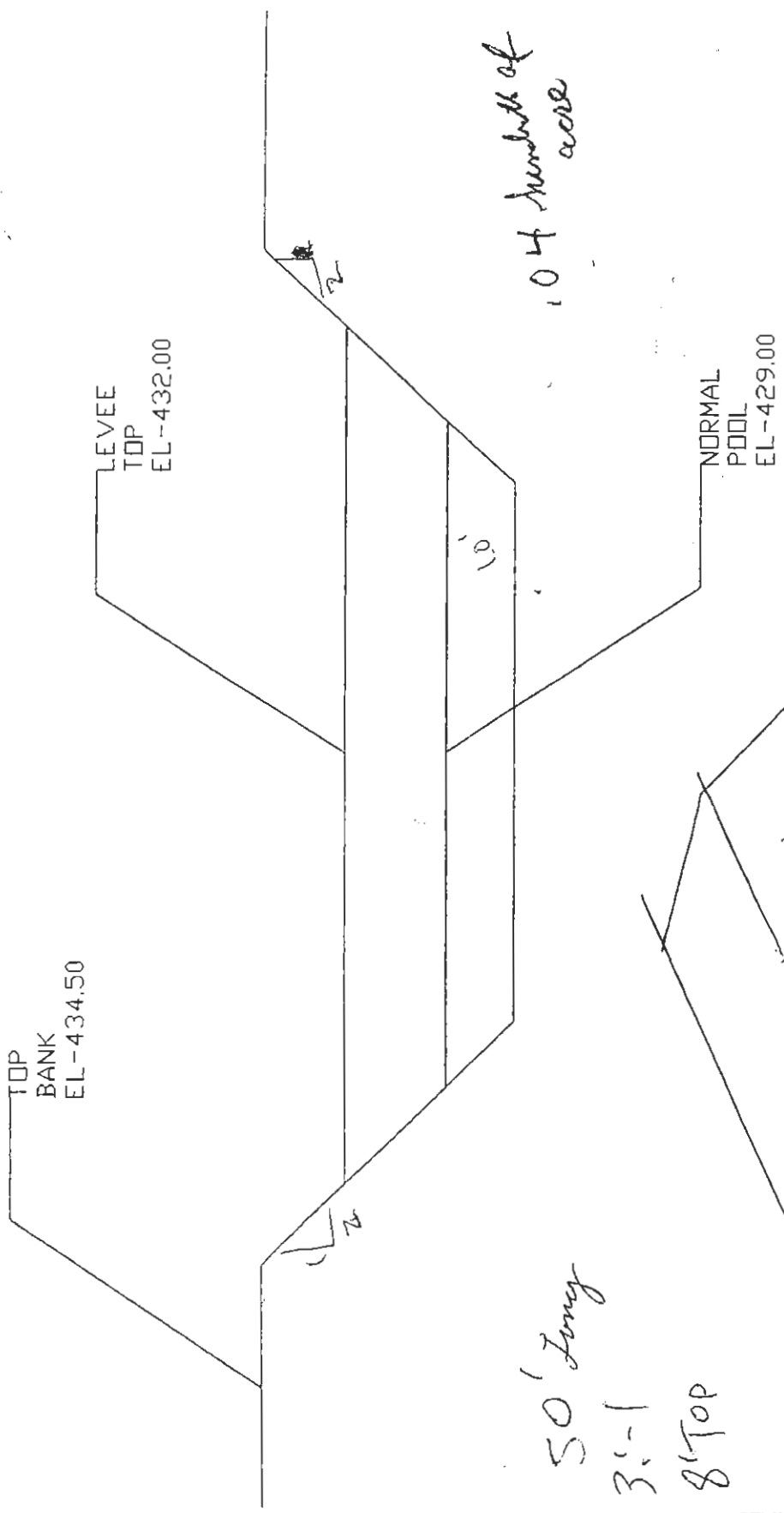

104 number of  
 acre

50' Long  
 3'-1  
 8' Top

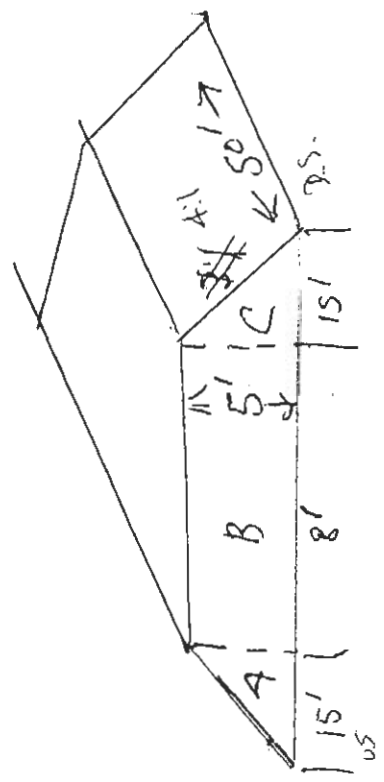

$$A + C = 5 \times 15 \times 50 = 3750 \div 27 = 138 \text{ cu yd}$$

$$B = 8 \times 5 \times 50 = 2000 \div 27 = 74 \text{ cu yd}$$

$$\underline{\underline{212 \text{ cu yd}}}$$

The pull-overs for the boats will be a simple design, but they do work and they conform to the slopes of berms.

I will use 3/4 poly rope threaded thru 3 to 5 inch x 6 feet native posts, such as maple, cottonwood, etc.

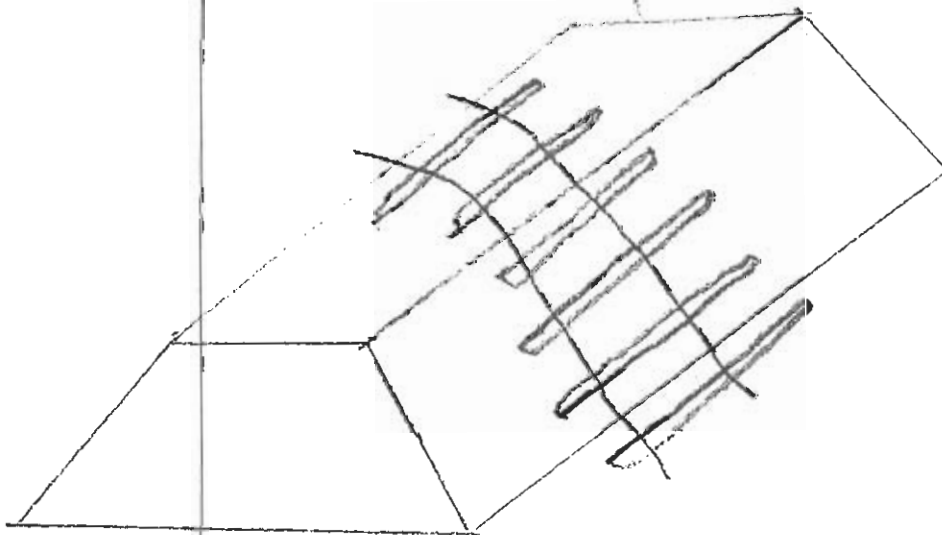
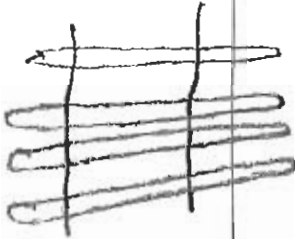



95.0

85.0

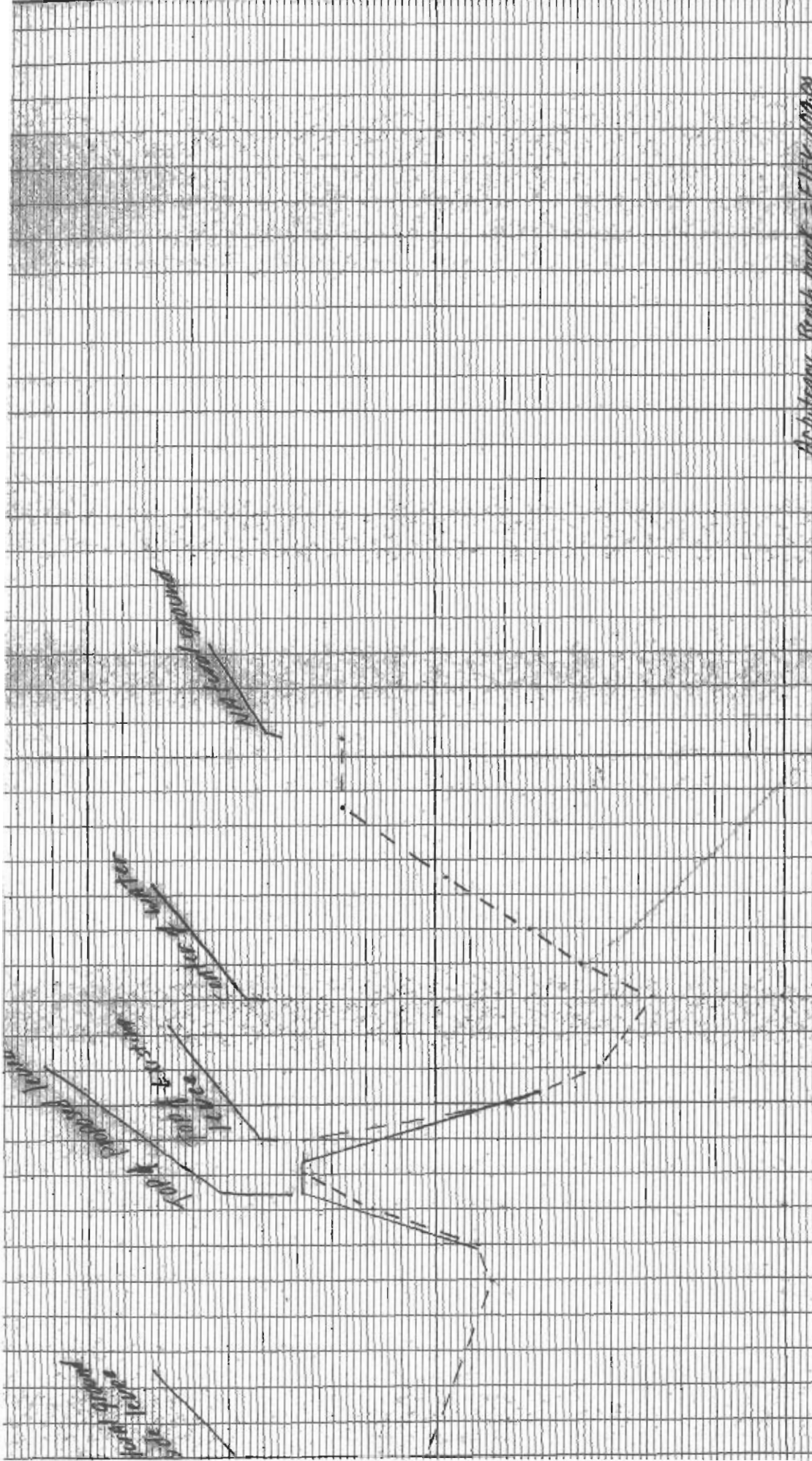

Designed	Date	Approved by	Title
Drawn: L. Herzberger	10/12		
Traced	6CT		
Checked			