



**US Army Corps  
of Engineers** ®  
New England District

# PUBLIC NOTICE

696 Virginia Road  
Concord, MA 01742-2751

**Date:** January 9, 2007  
**Comment Period Ends:** February 9, 2007  
**File Number:** NAE-2006-4175  
**In Reply Refer To:** William J. Mullen  
**Or by e-mail:** william.j.mullen@usace.army.mil

The District Engineer has received a permit application from the applicant below to **conduct work in waters of the United States** as described below. The Corps is soliciting comments on both the project itself and the range of issues to be addressed in the environmental documentation.

## **APPLICANT Town of Woodbury, Connecticut**

### **ACTIVITY**

A detailed description and plans of the applicant's activity are attached.

### **WATERWAY AND LOCATION OF THE PROPOSED WORK**

This work is proposed in and along the Pomperaug River in the town of Woodbury, Connecticut. The proposed location on the USGS Woodbury quadrangle sheet is at UTM coordinates 4600995 N and 18648710 E.

### **AUTHORITY**

Permits are required pursuant to:

- Section 10 of the Rivers and Harbors Act of 1899  
 Section 404 of the Clean Water Act  
 Section 103 of the Marine Protection, Research and Sanctuaries Act).

The decision whether to issue a permit will be based on an evaluation of the probable impact of the proposed activity on the public interest. That decision will reflect the national concern for both protection and utilization of important resources. The benefit which may reasonably accrue from the proposal must be balanced against its reasonably foreseeable detriments. All factors which may be relevant to the proposal will be considered, including the cumulative effects thereof; among those are: conservation, economics, aesthetics, general environmental concerns, wetlands, cultural value, fish and wildlife values, flood hazards, flood plain value, land use, navigation, shoreline erosion and accretion, recreation, water supply and conservation, water quality, energy needs, safety, food production and, in general, the needs and welfare of the people.

The Corps of Engineers is soliciting comments from the public; Federal, state, and local agencies and officials; Indian Tribes; and other interested parties in order to consider and evaluate the impacts of this proposed activity. Any comments received will be considered by the Corps of Engineers to determine whether to issue, modify, condition or deny a permit for this proposal. To make this decision, comments are used to assess impacts on endangered species, historic properties, water quality, general environmental effects, and the other public interest factors listed above. Comments are used in the preparation of an Environmental Assessment and/or an Environmental Impact Statement pursuant to the National Environmental Policy Act. Comments are

**CENAE-R**  
**FILE NO. NAE-2006-4175**

also used to determine the need for a public hearing and to determine the overall public interest of the proposed activity.

Where the activity involves the discharge of dredged or fill material into waters of the United States or the transportation of dredged material for the purpose of disposing it in ocean waters, the evaluation of the impact of the activity in the public interest will also include application of the guidelines promulgated by the Administrator, U.S Environmental Protection Agency, under authority of Section 404(b) of the Clean Water Act, and/or Section 103 of the Marine Protection Research and Sanctuaries Act of 1972 as amended.

Based on his initial review, the District Engineer has determined that the proposed work may impact properties listed in, or eligible for listing in, the National Register of Historic Places. Additional review and consultation to fulfill requirements under Section 106 of the National Historic Preservation Act of 1966, as amended, will be ongoing as part of the permit review process.

Pursuant to the **Endangered Species Act**, the District Engineer is hereby requesting that the appropriate Federal Agency provide comments regarding the presence of and potential impacts to listed species or its critical habitat.

The following authorizations have been applied for, or have been, or will be obtained:

- (x ) Permit, License or Assent from State.
- (x ) Permit from Local Wetland Agency or Conservation Commission.
- (x ) Water Quality Certification in accordance with Section 401 of the Clean Water Act.

In order to properly evaluate the proposal, we are seeking public comment. Anyone wishing to comment is encouraged to do so. **Comments should be submitted in writing by the above date.** If you have any questions, please contact William J. Mullen at (978) 318-8559, (800) 343-4789 or (800) 362-4367, if calling from within Massachusetts.

Any person may request, in writing, within the comment period specified in this notice, that a public hearing be held to consider the application. Requests for a public hearing shall specifically state the reasons for holding a public hearing. The Corps holds public hearings for the purpose of obtaining public comments when that is the best means for understanding a wide variety of concerns from a diverse segment of the public.

The initial determinations made herein will be reviewed in light of facts submitted in response to this notice. All comments will be considered a matter of public record. Copies of letters of objection will be forwarded to the applicant who will normally be requested to contact objectors directly in an effort to reach an understanding.

For more information on the New England District Corps of Engineers programs, visit our website at <http://www.nae.usace.army.mil>.

**THIS NOTICE IS NOT AN AUTHORIZATION TO DO ANY WORK.**

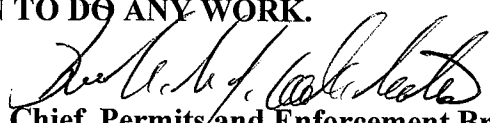
  
**Chief, Permits and Enforcement Branch**  
**Regulatory Division**

**CENAE-R**  
**FILE NO. NAE-2006-4175**

If you would prefer not to continue receiving Public Notices, please contact Ms. Tina Chaisson at (978) 318-8058 or e-mail her at [bettina.m.chaisson@usace.army.mil](mailto:bettina.m.chaisson@usace.army.mil). You may also check here ( ) and return this portion of the Public Notice to: Bettina Chaisson, Regulatory Division, U.S. Army Corps of Engineers, 696 Virginia Road, Concord, MA 01742-2751.

NAME: \_\_\_\_\_

ADDRESS: \_\_\_\_\_

**PROPOSED WORK AND PURPOSE**

The work includes the installation of boulder revetments, log revetments and J-vanes on the lower portion of the eastern bank of an approximately 250-LF eroded reach of the Pomeraug River, and live slope grating on the upper portion of the bank. The eroded bank is located just downstream of Judson Ave, at #6 and #10 Orton Lane, in the Town of Woodbury, Connecticut. Purpose of the project is to halt the severe erosion of the 30-foot high sand/clay river bank in this area. The exact location of revetments and J-vanes is to be determined by a consulting engineer shortly before the start of construction, since further river bank collapse and erosion is expected to change conditions right up to the end.

A similar volume of fill shall be excavated across the river on town-owned land for flood conveyance compensation purposes. About 120 LF of the bank will need to be excavated. A hydraulic model shall be utilized to demonstrate no increase in flood elevations associated with the filling and excavation work, which will take place within the floodway as identified by the Federal Emergency Management Agency. Excavated material shall be removed from the wetlands/waters of the United States.

The work shall primarily be done from the opposite (western) bank on the town-owned land. Boulders will be placed using an excavator, drag line, or crane from the western bank, and, if necessary, from the eastern bank from above all wetlands and waters. Existing fallen trees already in the river will be relocated as necessary using similar equipment or manually with winches and hand tools. Pads, using logs to provide a solid base, will be used for equipment staging on the western river bank. The pads shall extend no more than 10 feet into the watercourse for a length not exceeding 60 feet.

The work is described on the enclosed plans entitled "Pomperaug River Streambank Stabilization and Project" on 8 sheets, and dated "December 2006".

## Pomperaug River Stream Bank Stabilization and Fish Habitat Restoration Project

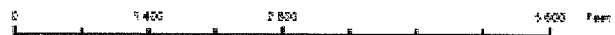
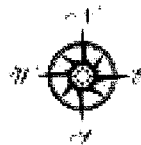
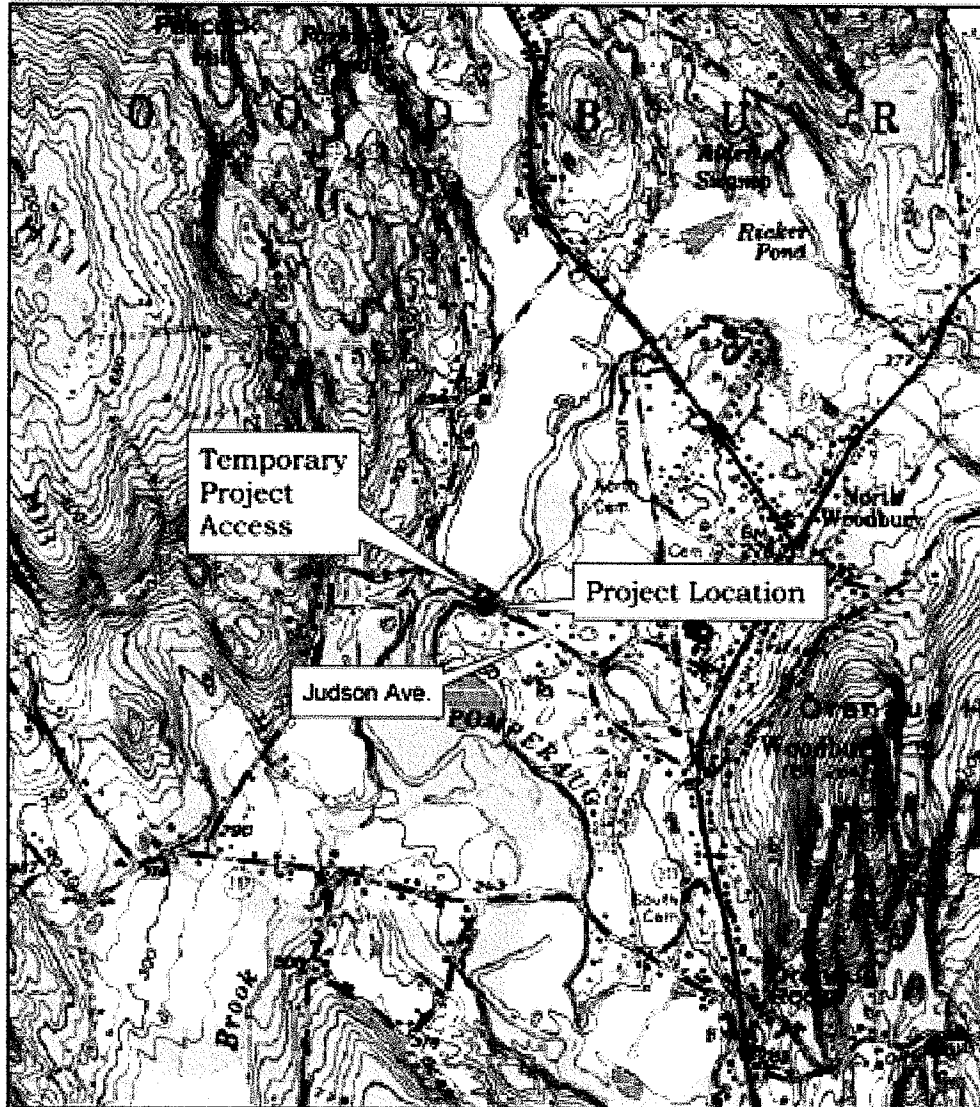

Produced by the Northwest Conservation District  
For CT DEP Flood Certification February 7, 2006

### Project Description

The project is located just south of the Judson Avenue bridge crossing in Woodbury CT. The river is eroding the eastern bank for 200 ft in this location.

### Data Source:

Connecticut Department of Environmental Protection  
Environmental Geographic Information Center (EGIC)  
USGS 7.5 Minute Topographical Quadrangle  
Woodbury CT map #63

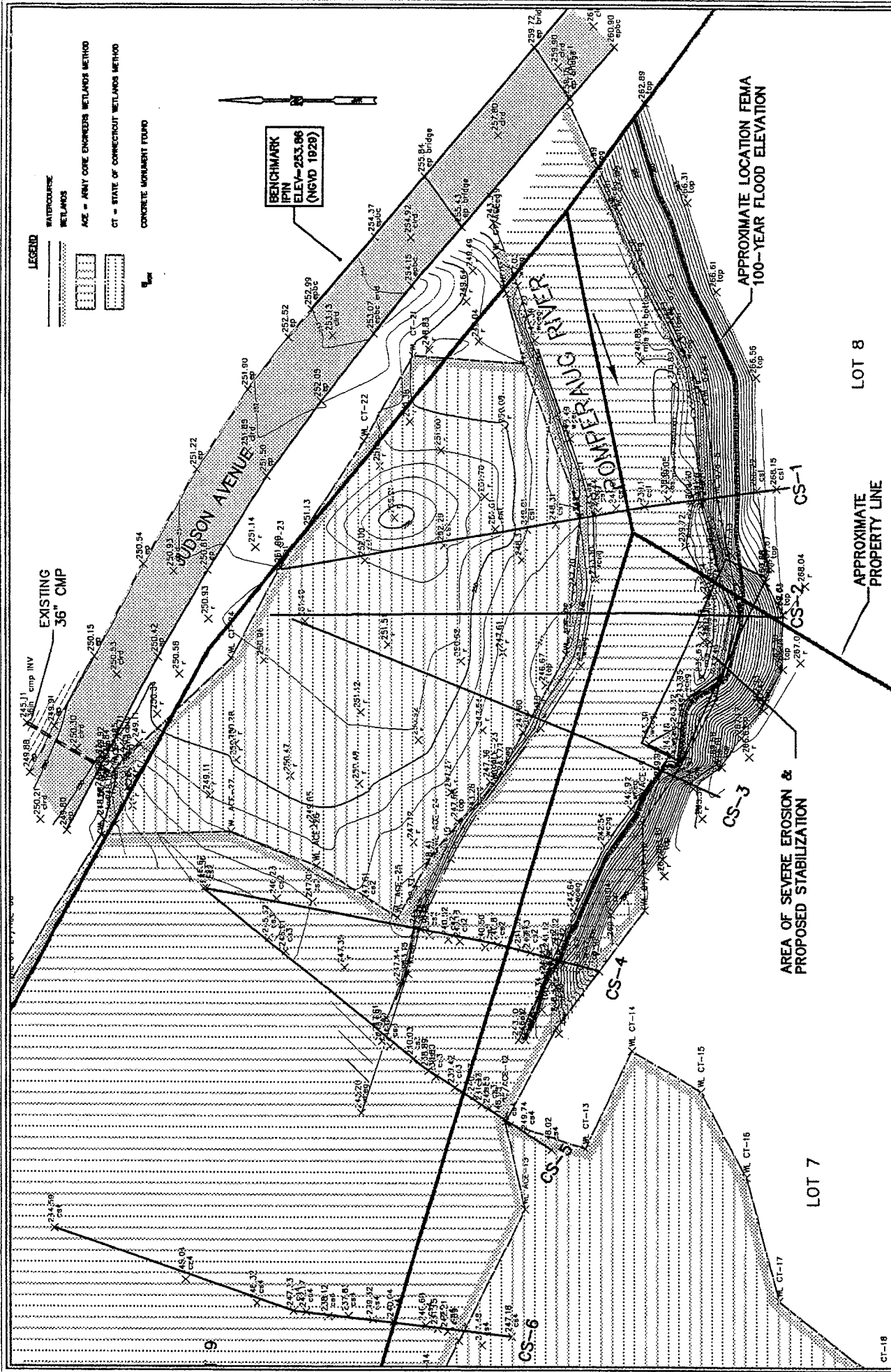

**LEGEND**

WATERCOURSE  
 WETLANDS  
 AGE - ARMY CORP ENGINEERS WETLANDS METHOD  
 CT - STATE OF CONNECTICUT WETLANDS METHOD  
 CONCRETE MONUMENT FOUND

BENCHMARK  
 IPIN  
 ELEV. = 253.66  
 (NGVD 1929)

<b>MILONE &amp; MACBROOM, INC.</b> Civil, Water Resource and Transportation Engineering • Landscape Architecture Surveying • Planning 716 South Main Street • Cheshire, Connecticut 06410 (203) 271-1773 • FAX (203) 272-9733	DATE: <b>AUGUST 7, 2003</b> SCALE: <b>1" = 60'</b>	SHEET: <b>FIGURE 1</b>
	<b>POMPERAUG RIVER</b> <b>OVERALL PLAN</b>	

Town of Woodbury CT  
 Pomperaug River Streambank  
 Stabilization and Restoration Project  
 December 2006  
**USACOE APPLICATION-SITE PLAN**

AREA OF SEVERE EROSION & PROPOSED STABILIZATION

APPROXIMATE LOCATION FEMA 100-YEAR FLOOD ELEVATION

LOT 8

LOT 7

APPROXIMATE PROPERTY LINE

CT-18

NOTE: CROSS SECTIONS ARE ORIENTED  
LOOKING UPSTREAM. SEE  
FIGURE 1 FOR CROSS SECTION  
LOCATIONAL.

PROJECT NO.	2358-01
DATE	AUGUST 7, 2008
SCALE	V. 1" = 12'
H. 1" = 60'	
DRAWN BY	DAK

CROSS SECTIONS 1-6 - EXISTING CONDITIONS  
POMPERAUG RIVER  
JUDSON AVENUE  
WOODBURY, CONNECTICUT

NO.	DATE	DESCRIPTION

MILONE & MACBROOM®  
Hydrologic, Hydraulic, and Environmental Design  
716 South Main Street  
Cheshire, Connecticut 06410  
(203) 271-1773 Fax (203) 272-9733

FIGURE 2  
SHEET 15

CROSS SECTION 5

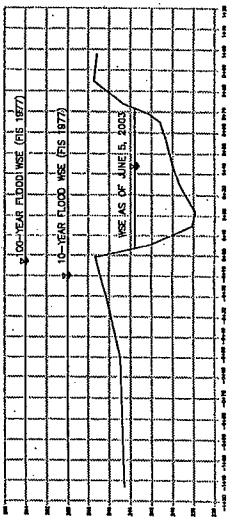

CROSS SECTION 6

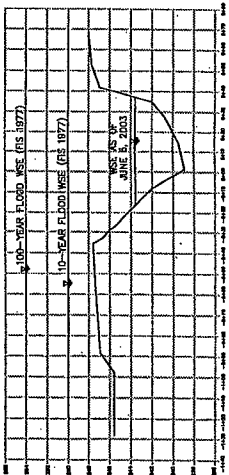

CROSS SECTION 3

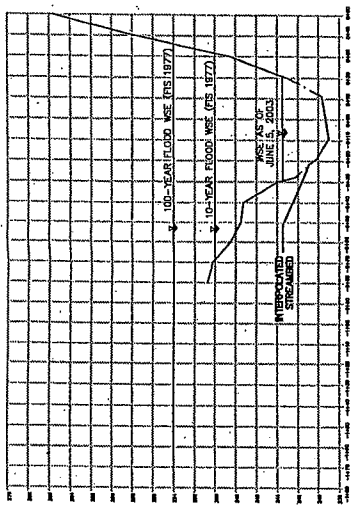

CROSS SECTION 2

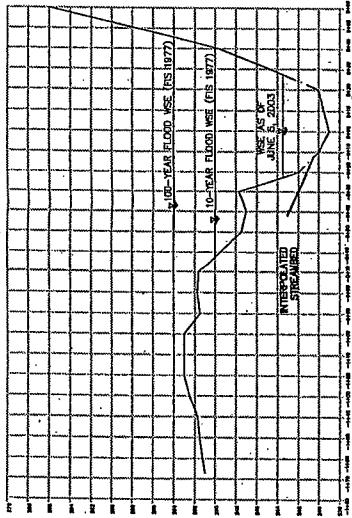

CROSS SECTION 1

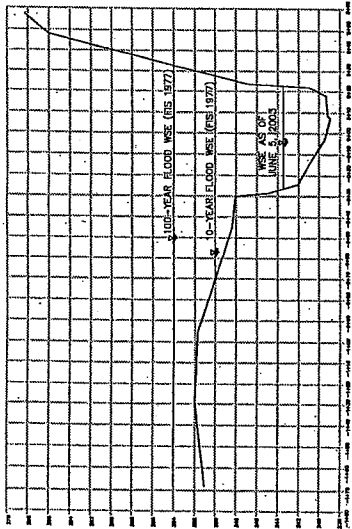

CROSS SECTION 4

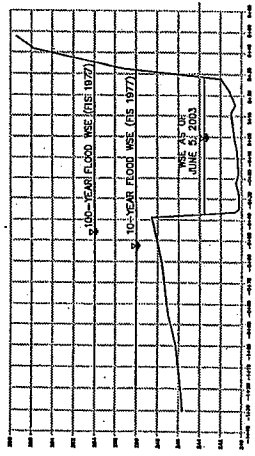

Town of Woodbury CT  
Pomperaug River Streambank  
Stabilization and Restoration Project  
December 2006

MILONE & MACBROOM  
 716 South Main Street  
 Shelton, Connecticut 06484  
 (203) 271-1773 Fax (203) 271-9733  
 www.miloneandmacbroom.com

REVISIONS

CROSS SECTION 1 - 15:10 SLOPE FROM TOE OF BANK  
 POMPERAUG RIVER  
 JUDSON AVENUE  
 WOODBURY, CONNECTICUT

DATE	8-07-03
SCALE	H: 1" = 20'
PROJECT NO.	2858-01
FIGURE NO.	3.1

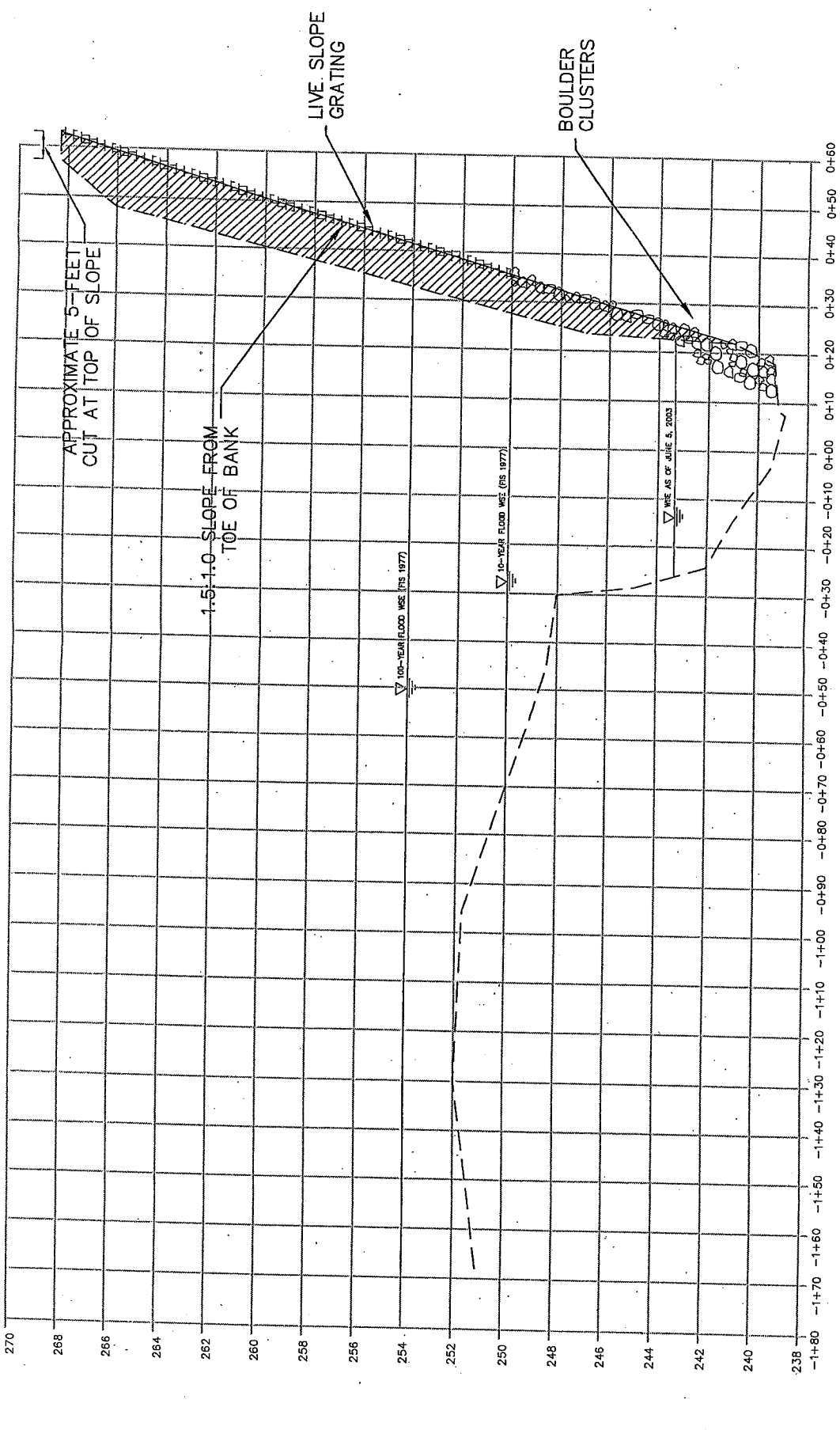

**CROSS SECTION 1**

CUT = 220.8 SF  
 FILL = 21.2 SF

EXISTING GRADE --- CUT HATCH  
 PROPOSED GRADE ——— SLOPE GRATING

Town of Woodbury CT  
 Pomperaug River Streambank  
 Stabilization and Restoration Project  
 December 2006



NO.	DESCRIPTION	DATE

DATE	8-07-03
PROJECT NO.	2358-01
DRAWN BY	
CHECKED BY	
SCALE	H: V = 1" = 20'
DATE	8-07-03

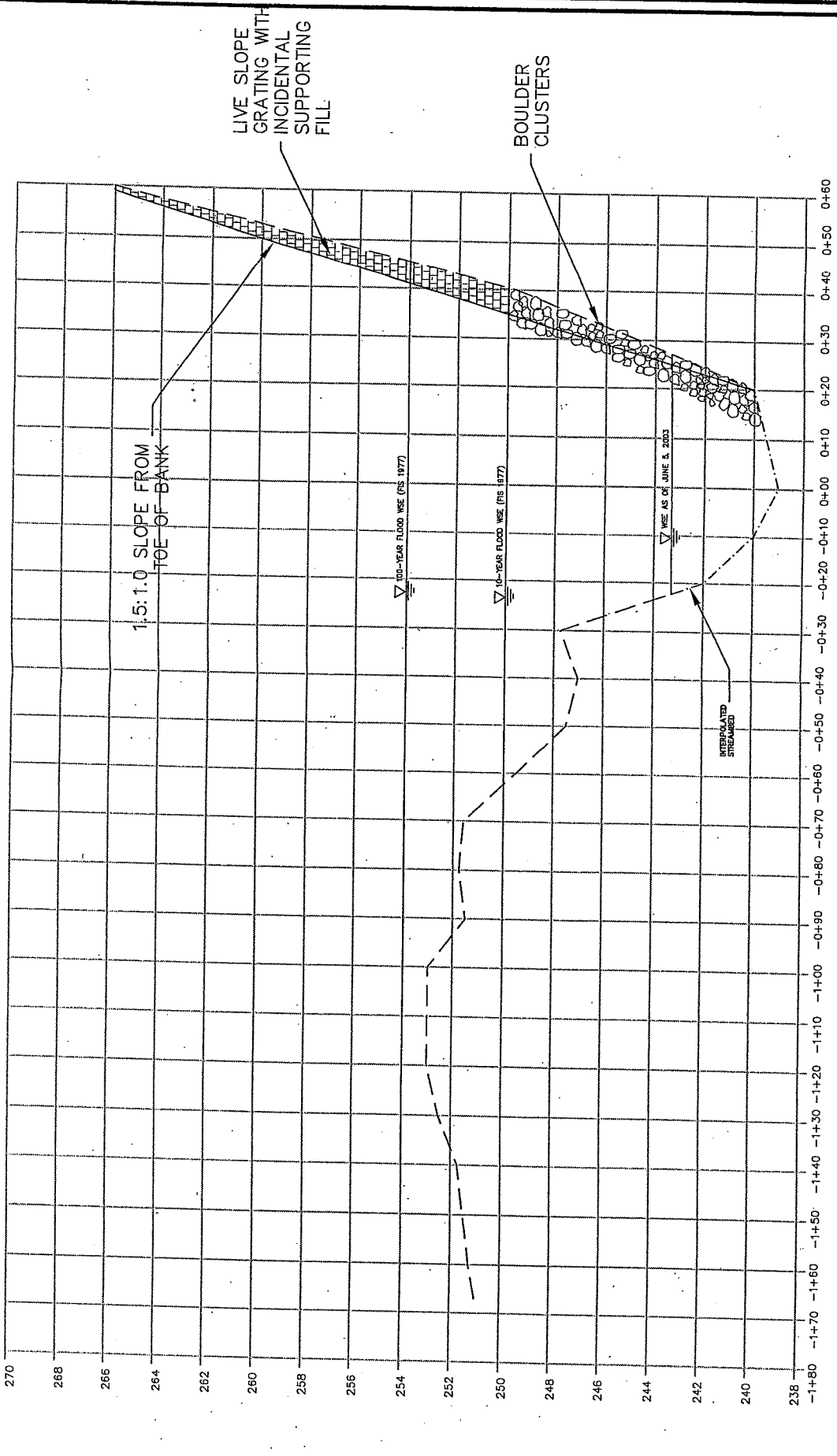

CUT = 0 SF  
 FILL = 116.4 SF

**CROSS SECTION 2**

--- EXISTING GRADE  
 — PROPOSED GRADE  
 [Hatched Box] SLOPE GRATING

Town of Woodbury CT  
 Pomperaug River Streambank  
 Stabilization and Restoration Project  
 December 2006

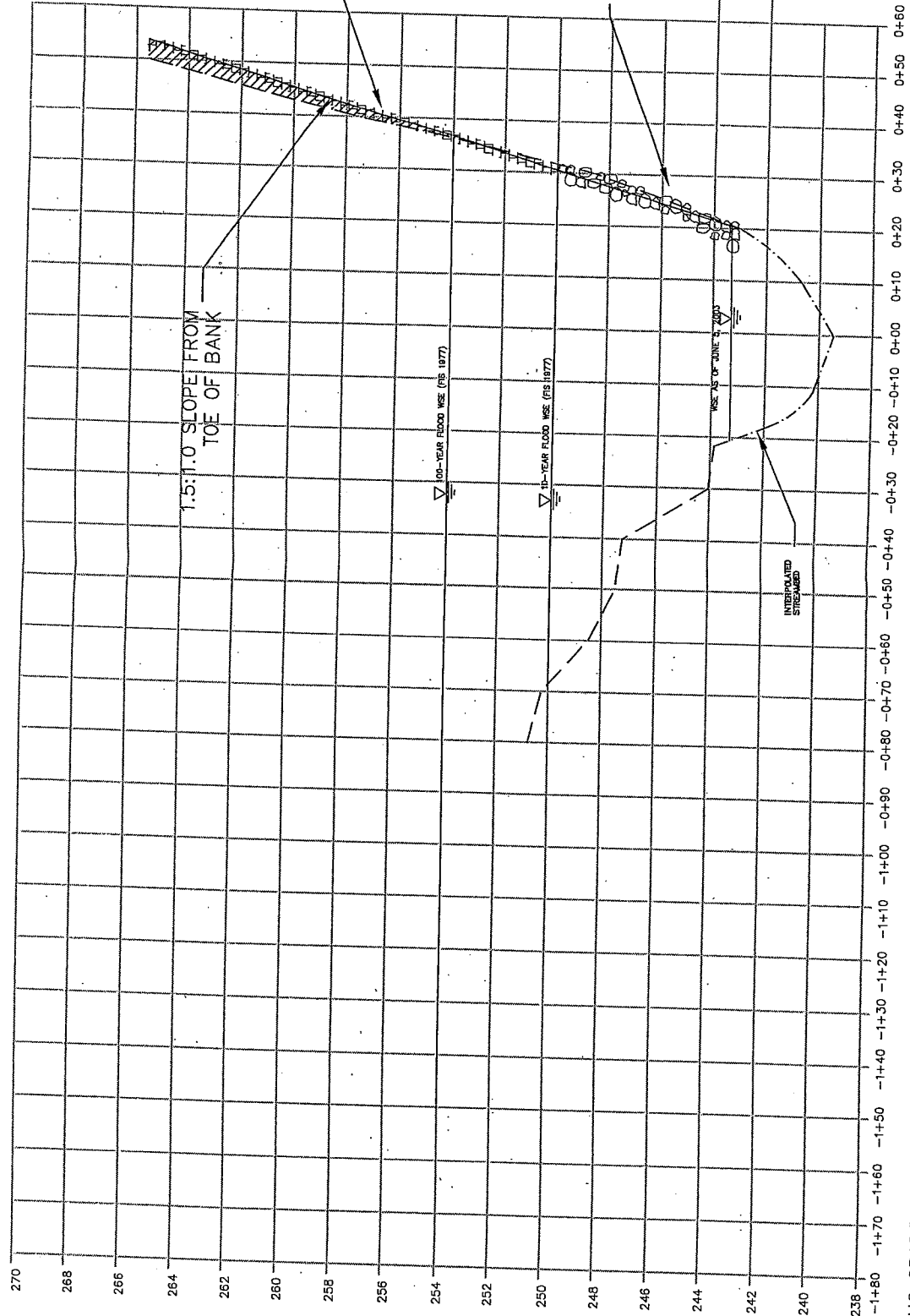

CROSS SECTION 3  
 CUT = 26.6 SF  
 FILL = 30.4 SF

EXISTING GRADE    - - -    CUT HATCH  
 PROPOSED GRADE    - - -    SLOPE GRATING

MILONE & MACBROOM®  
 716 South Main Street  
 Shelton, Connecticut 06410  
 (203) 271-1773 Fax (203) 272-9733  
 www.miloneandmacbroom.com

NO.	DESCRIPTION	DATE

CROSS SECTION 3 - 1.5:1.0 SLOPE FROM TOE OF BANK  
 POMPERAUG RIVER  
 WOODSON AVENUE  
 WOODBURY, CONNECTICUT

DATE: 8-07-03  
 PROJECT NO.: 2358-01  
 SHEET NO.: 3.3  
 FIGURE 3.3

Town of Woodbury CT  
 Pomperaug River Streambank  
 Stabilization and Restoration Project  
 December 2006



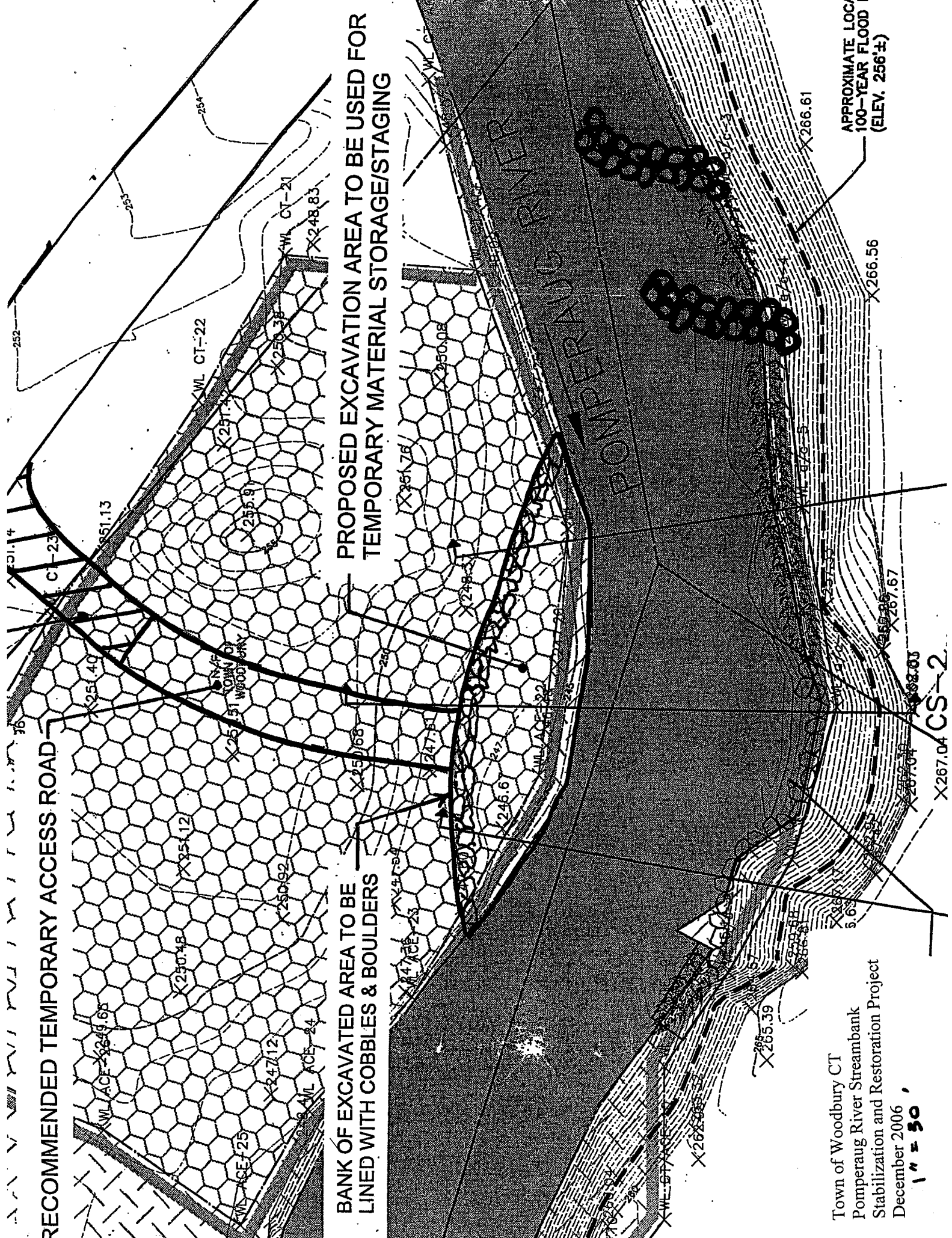

RECOMMENDED TEMPORARY ACCESS ROAD

BANK OF EXCAVATED AREA TO BE LINED WITH COBBLES & BOULDERS

PROPOSED EXCAVATION AREA TO BE USED FOR TEMPORARY MATERIAL STORAGE/STAGING

Town of Woodbury CT  
 Pomperaug River Streambank  
 Stabilization and Restoration Project  
 December 2006  
 1" = 50'

APPROXIMATE LOCA  
 100-YEAR FLOOD E  
 (ELEV. 256'±)

CS-2