

US Army Corps of Engineers
Charleston District

- NOTES:
1. SOUNDINGS ARE IN FEET AND TENTHS AND REFER TO MEAN LOWER LOW WATER (M.L.L.W.).
 2. HORIZONTAL DATUM IS SCSPC NAD 1983.
 3. VERTICAL DATUM FOR TOPOGRAPHY IS NAVD 1988.
 4. MAPPING PREPARED FROM AERIAL PHOTOGRAPHY FLOWN APRIL 2005 AT SCALE 1" = 600'.
 5. THE CONDITION SURVEY DEPICTED ON THIS DRAWING IS NOT INTENDED TO REPLACE NAUTICAL CHARTS PUBLISHED BY NATIONAL OCEAN SERVICE, U.S. COAST GUARD AIDS TO NAVIGATION, OR U.S. COAST GUARD NOTICES TO MARINERS. THE SOUNDINGS ON THIS DRAWING ONLY INDICATE THE GENERAL CONDITION OF THE CHANNEL ON THE DATE OF THE SURVEY, AND ARE NOT INTENDED TO BE USED FOR NAVIGATIONAL PURPOSES.
 6. DATE OF SURVEY: 8 AUG. 2008 CONDITION

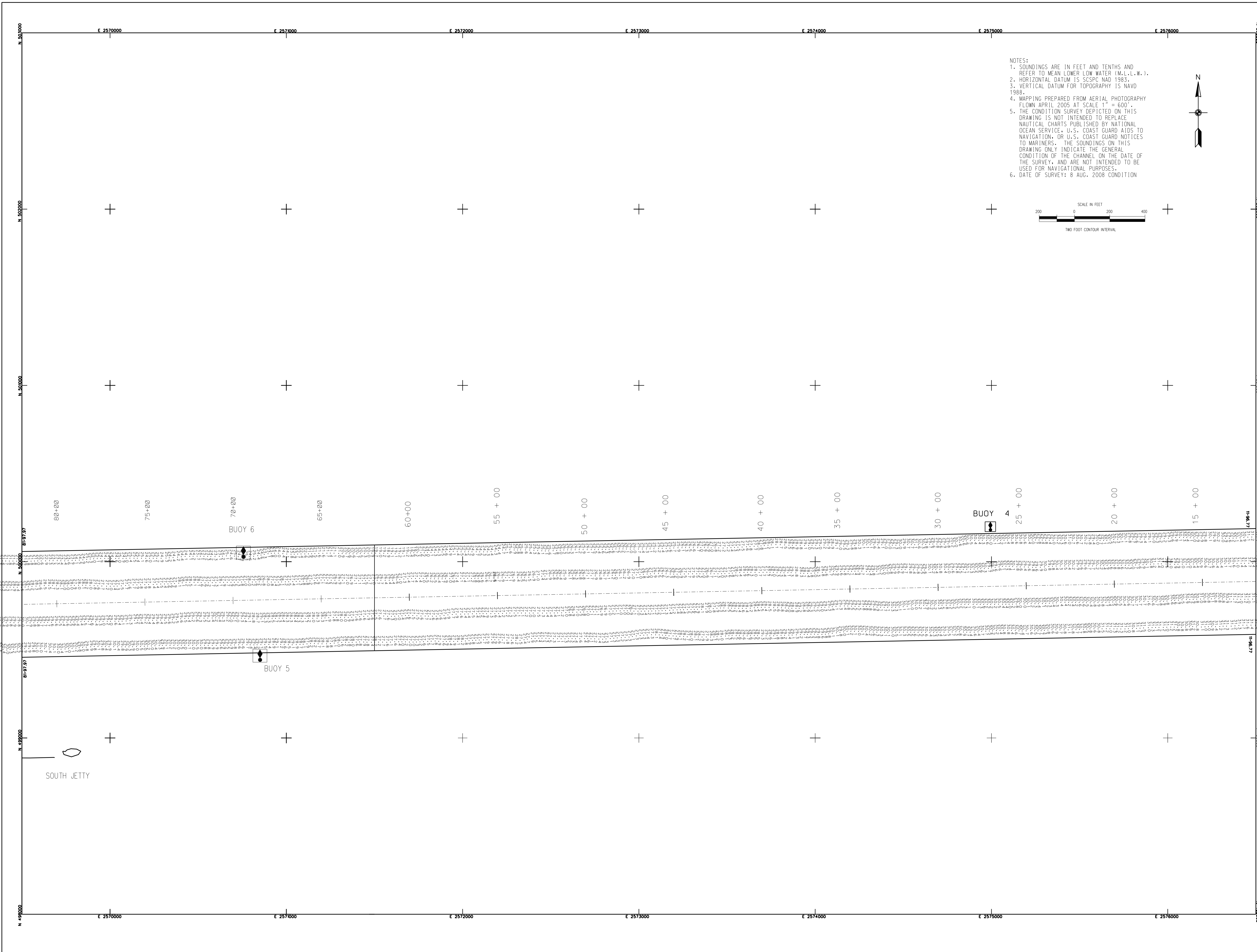
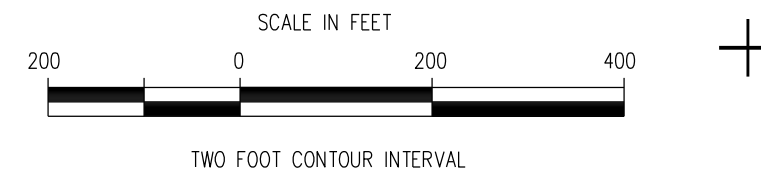
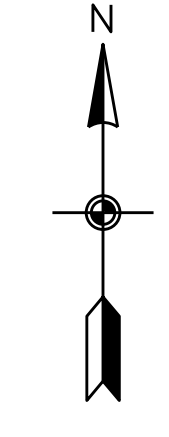

DATE	APPROV.	DESCRIPTION

Designed by	MRV	Drawn by	
Checked by		Reviewed by	
Date	Aug 18	Scale	1" = 200'
Drawn file no.			

U.S. ARMY ENGINEER DISTRICT
CHARLESTON, SOUTH CAROLINA

GEORGETOWN HARBOR
MAIN CHANNEL
GEORGETOWN, SC
CONDITION SURVEY
STA. 11+96.77 TO STA. 81+97.97
9232
GEORGETOWN COUNTY SOUTH CAROLINA

SHEET
REFERENCE
NUMBER
SHEET 3 OF 16