

MAIN CREEK (INNER CHANNEL B) CENTERLINE DESCRIPTION			
POINT	STATION	NORTHING	EASTING
PI	112+82.18	629322.96	2602029.33
TANGENT: N 35°25'08.01" W 1208.22 FT.			
PI	124+90.40	630307.59	2601329.10
TANGENT: N 2°48'28.46" E 405.44 FT.			
PI	128+95.84	630712.54	2601348.97
TANGENT: N 66°38'59.62" E 1426.44 FT.			
PI	143+22.28	631277.91	2602658.58
TANGENT: N 38°48'36.60" E 263.12 FT.			
PI	145+85.39	631482.93	2602823.49
TANGENT: N 8°28'49.58" W 611.57 FT.			
PI	151+96.97	632087.82	2602733.30
TANGENT: N 41°12'17.97" W 265.71 FT.			
PI	154+62.68	632287.73	2602558.26
TANGENT: N 69°27'47.67" W 427.14 FT.			
PI	158+89.82	632437.58	2602158.27
TANGENT: S 76°12'44.19" W 777.22 FT.			
PI	166+67.04	632252.34	2601403.44
TANGENT: S 37°35'11.05" W 933.95 FT.			
PI	176+00.98	631512.25	2600833.78
TANGENT: S 84°08'27.55" W 442.23 FT.			
PI	180+43.21	631467.11	2600393.86
TANGENT: N 60°57'52.31" W 308.82 FT.			
PI	183+52.03	631617.00	2600123.85
TANGENT: N 18°27'14.23" W 221.33 FT.			
PI	185+73.36	631826.94	2600053.79
TANGENT: N 19°56'31.28" E 1127.60 FT.			
PDE	197+00.96	632886.93	2600438.37

CHANNEL RANGE LINES			
POINT	X-COORD.	Y-COORD.	STATION
W	2601374.81	630320.96	
X	2601392.54	630682.34	
Y	2602686.66	631241.01	
Z	2602870.90	631470.08	
AA	2602775.86	632107.52	
AB	2602584.65	632325.90	
AC	2602161.04	632484.59	
AD	2601377.40	632292.29	
AE	2600809.92	631555.04	
AF	2600403.33	631513.32	
AG	2600160.99	631647.85	
AH	2600101.43	631826.33	
AI	2600480.68	632871.58	
AJ	2601283.39	630294.22	
AK	2601305.39	630742.74	
AL	2602630.51	631314.80	
AM	2602776.07	631495.79	
AN	2602690.74	632068.12	
AO	2602531.86	632249.57	
AP	2602155.49	632390.56	
AQ	2601429.48	632212.40	
AR	2600857.63	631469.46	
AS	2600384.38	631420.90	
AT	2600086.70	631586.15	
AU	2600006.14	631827.56	
AV	2600293.75	632620.26	194+00.96
AW	2600254.40	632687.73	194+50.96
AX	2600339.67	632922.74	

- NOTES:
- SOUNDINGS ARE IN FEET AND TENTHS AND REFER TO MEAN LOW WATER.
  - HORIZONTAL DATUM IS NAD 1983.
  - THE CONDITION SURVEY DEPICTED ON THIS DRAWING IS NOT INTENDED TO REPLACE NAUTICAL CHARTS PUBLISHED BY NATIONAL OCEAN SERVICE, U.S. COAST GUARD AIDS TO NAVIGATION, OR U.S. COAST GUARD NOTICES TO MARINERS. THE SOUNDINGS ON THIS DRAWING ONLY INDICATE THE GENERAL CONDITION OF THE CHANNEL ON THE DATE OF SURVEY, AND ARE NOT INTENDED TO BE USED FOR NAVIGATION PURPOSES.
  - DATE OF SURVEY: 3 OCT. 2008 CONDITION

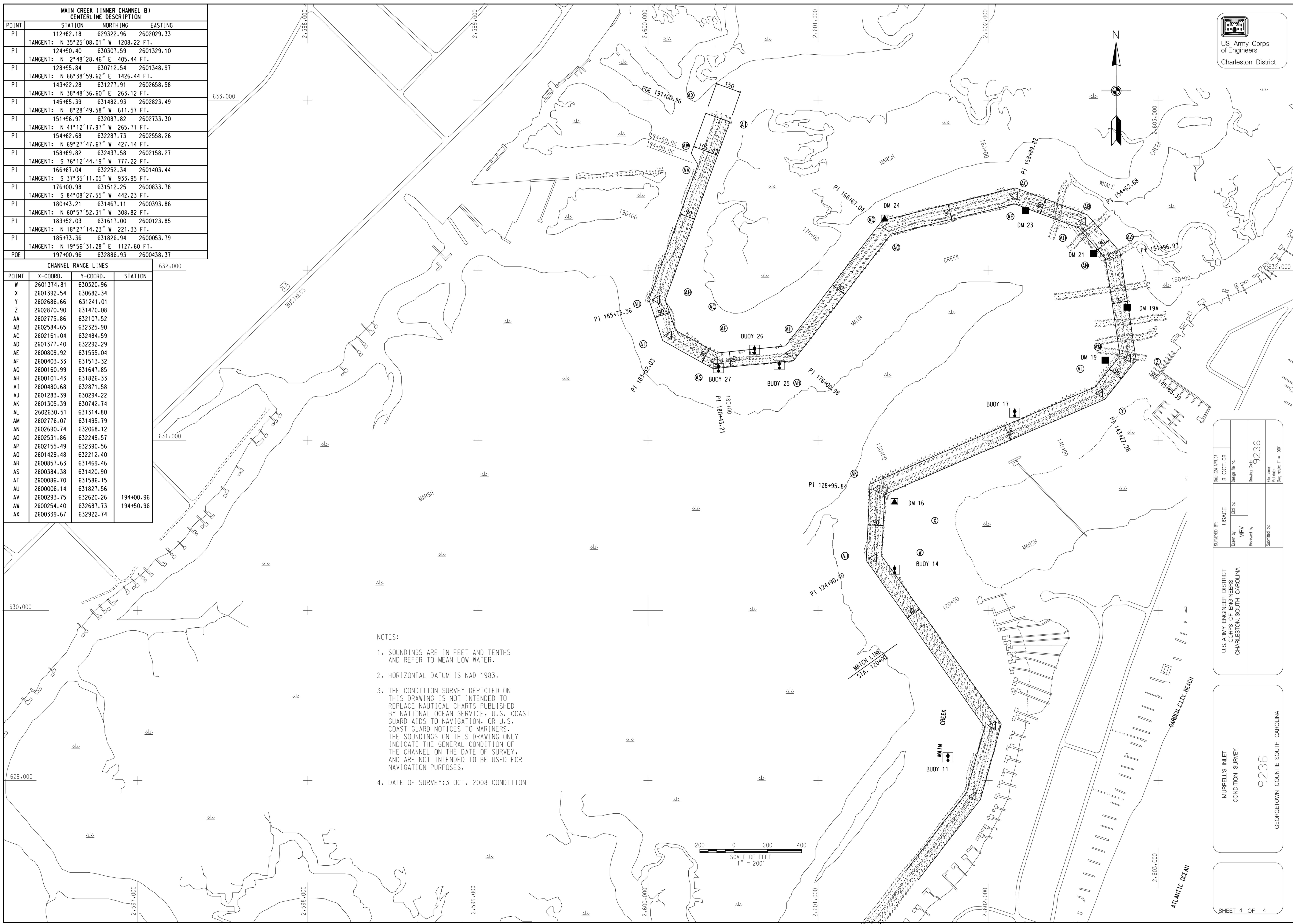
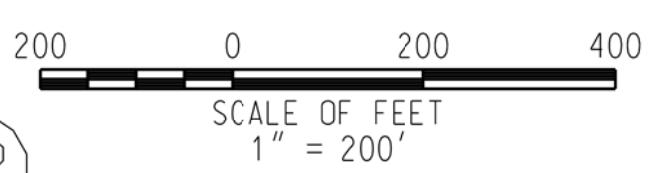

DESIGNED BY: USACE	DATE: 24 APR 07
DRAWN BY: MRY	DATE: 08 OCT 08
CHECKED BY:	DESIGN NO.:
APPROVED BY:	DRAWING CODE: 9236
	FILE NAME:
	DWG SCALE: 1" = 200'

U.S. ARMY ENGINEER DISTRICT  
CORPS OF ENGINEERS  
CHARLESTON, SOUTH CAROLINA

MURRELLS INLET  
CONDITION SURVEY  
9236  
GEORGETOWN, SOUTH CAROLINA