

JOINT
PUBLIC NOTICE

CHARLESTON DISTRICT, CORPS OF ENGINEERS
69A Hagood Avenue
Charleston, South Carolina 29403-5107

and

THE S. C. DEPARTMENT OF HEALTH AND ENVIRONMENTAL CONTROL
Office of Environmental Quality Control
Water Quality Certification and Wetlands Programs Section
2600 Bull Street
Columbia, South Carolina 29201

REGULATORY DIVISION
Refer to: P/N #SAC-2008-1176-2ID

8 August 2008

Pursuant to Section 10 of the Rivers and Harbors Act of 1899 (33 U.S.C. 403), and the S.C. Construction in Navigable Waters Permit Program (R. 19-450, et. Seq., 1976 S.C. Code of Laws, as amended), an application has been submitted to the Department of the Army and the State of South Carolina by

SUMTER COUNTY
RECREATION DEPARTMENT
c/o MR. GARY MIXON
13 EAST CANAL STREET
SUMTER, SOUTH CAROLINA 29150

for a permit to install a floating dock in

LAKE MARION

at the existing Rimini Public Boat Launching Facility, located at Pack's Landing in Sumter County, South Carolina.

In order to give all interested parties an opportunity to express their views

NOTICE

is hereby given that written statements regarding the proposed work will be received by both of the above mentioned offices until

12 O'CLOCK NOON, MONDAY, 8 SEPTEMBER 2008

from those interested in the activity and whose interests may be affected by the proposed work.

The proposed work consists of installing a floating courtesy dock. In detail, the work consists of attaching a 26' long gangway and an 8' x 40' floating dock to the end of an existing fixed pier. The purpose of this work is to provide a safe and accessible loading and unloading dock for the users of the existing public boat landing facility.

NOTE: Plans depicting the work described in this notice are available and will be provided, upon receipt of a written request, to anyone that is interested in obtaining a copy of the plans for the specific project. The request must identify the project of interest by public notice number and a self-addressed stamped envelope must also be provided for mailing the drawings to you. Your request for drawings should be addressed to the

**U.S. Army Corps of Engineers
ATTN: REGULATORY DIVISION
69A Hagood Avenue
Charleston, South Carolina 29403-5107**

The work shown on this application must be determined consistent with applicable provisions of the South Carolina Construction in Navigable Waters Permit Program. The applicant is hereby advised that supplemental information may be required by the State to facilitate the review. Persons wishing to comment or object to State navigable waters permit must submit all comments in writing to the S.C. Department of Health and Environmental Control at the above address within thirty (30) days of the date of this notice.

This notice initiates the Essential Fish Habitat (EFH) consultation requirements of the Magnuson-Stevens Fishery Conservation and Management Act. Implementation of the proposed project would impact approximately 0.007 acres of freshwater habitat, associated with downstream estuarine substrates and emergent wetlands utilized by various life stages of species comprising the red drum, shrimp, and snapper-grouper management complexes. Our initial determination is that the proposed action would not have a substantial individual or cumulative adverse impact on EFH or fisheries managed by the South Atlantic Fishery Management Council and the National Marine Fisheries Service (NMFS). Our final determination relative to project impacts and the need for mitigation measures is subject to review by and coordination with the NMFS.

The District Engineer has consulted the most recently available information and has determined that the project will have no effect on any Federally endangered, threatened, or proposed species and will not result in the destruction or adverse modification of designated or proposed critical habitat. This public notice serves as a request to the U.S. Fish and Wildlife Service and the National Marine Fisheries Service for any additional information they may have on whether any listed or proposed endangered or threatened species or designated or proposed critical habitat may be present in the area which would be affected by the activity, pursuant to Section 7(c) of the Endangered Species Act of 1973 (as amended).

Pursuant to Section 106 of the National Historic Preservation Act (NHPA), this public notice also constitutes a request to Indian Tribes to notify the District Engineer of any historic properties of religious and cultural significance to them that may be affected by the proposed undertaking.

In accordance with the NHPA, the District Engineer has also consulted the latest published version of the National Register of Historic Places for the presence or absence of registered properties, or properties listed as being eligible for inclusion therein, and this worksite is not included as a registered property or property listed as being eligible for inclusion in the Register. To insure that other cultural resources that the District Engineer is not aware of are not overlooked, this public notice also serves as a request to the State Historic Preservation Office to provide any information it may have with regard to historic and cultural resources.

Any person may request, in writing, within the comment period specified in this notice, that a public hearing be held to consider this application. Requests for a public hearing shall state, with particularity, the reasons for holding a public hearing.

The decision whether to issue a permit will be based on an evaluation of the probable impact including cumulative impacts of the activity on the public interest. That decision will reflect the national concern for both protection and utilization of important resources. The benefit which reasonably may be expected to accrue from the project must be balanced against its reasonably foreseeable detriments. All factors which may be relevant to the project will be considered including the cumulative effects thereof; among those are conservation, economics, aesthetics, general environmental concerns, wetlands, historic properties, fish and wildlife values, flood hazards, flood plain values, land use, navigation, shoreline erosion and accretion, recreation, water supply and conservation, water quality, energy needs, safety, food and fiber production and, in general, the needs and welfare of the people. A permit will be granted unless the District Engineer determines that it would be contrary to the public interest. In cases of conflicting property rights, the Corps of Engineers cannot undertake to adjudicate rival claims.

The Corps of Engineers is soliciting comments from the public; Federal, state, and local agencies and officials; Indian Tribes; and other interested parties in order to consider and evaluate the impacts of this activity. Any comments received will be considered by the Corps of Engineers to determine whether to issue, modify, condition or deny a permit for this project. To make this decision, comments are used to assess impacts on endangered species, historic properties, water quality, general environmental effects, and the other public interest factors listed above. Comments are used in the preparation of an Environmental Assessment and/or an Environmental Impact Statement pursuant to the National Environmental Policy Act. Comments are also used to determine the need for a public hearing and to determine the overall public interest of the activity.

If there are any questions concerning this public notice, please contact Mr. Dean Herndon at 843-329-8044 or toll free at 1-866-329-8187.

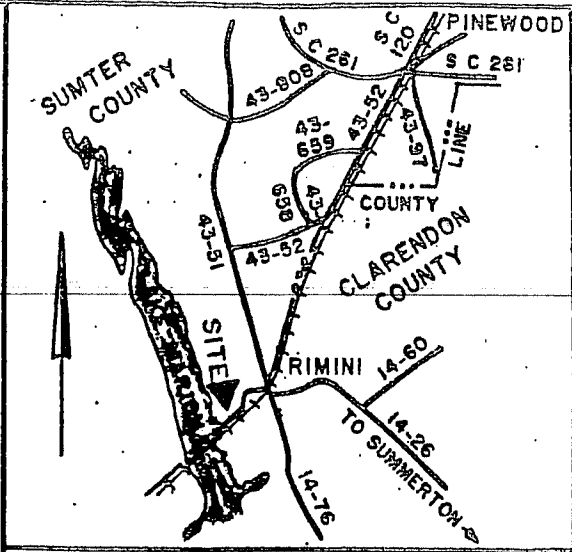

VICINITY MAP

NOT TO SCALE

SOUTH CAROLINA
STATE PLANE
COORDINATE SYSTEM
(NORTH ZONE)
N=665,459.740
E=2,147,181.322

SANTEE-COOPER
PUBLIC SERVICE AUTHORITY

S.C.D.H.P.T.

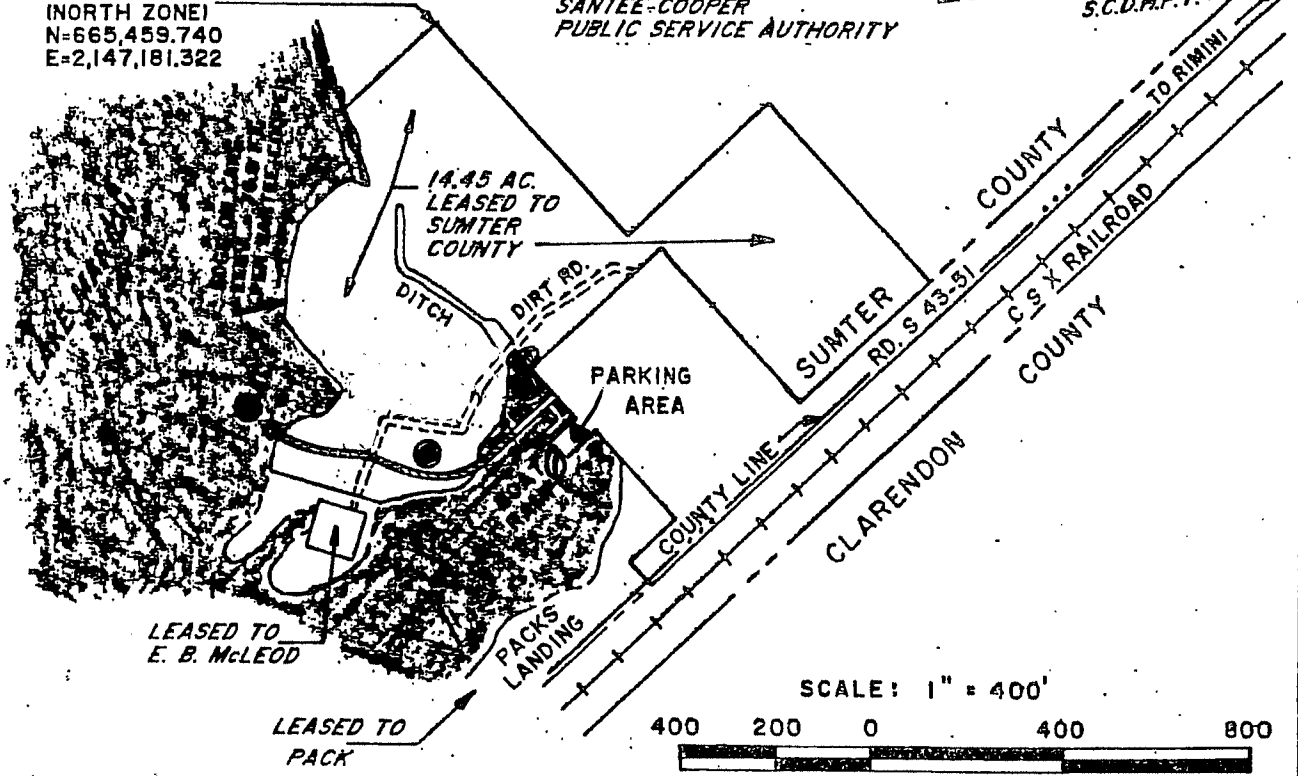

Proposed: ① Floating Dock with Gangway

Purpose: Adjacent property owners

IN: Lake MARION

AT: Packs LANDING

Rimini, Sumter County, S

Sh. 1 of 3
7-7-08

APPLICATION By: Santee Cooper
for County of Sumter.

Lake MARION

E.B. McLeod

WOODED AREA

Pack's Landing Lease

Existing Boat house

Fixed wooden piers
Wood Retaining wall

Water Line (76.8)

Picnic Shelter

Fixed dock
Existing Ramp
Fixed dock shed

Proposed floating Dock

Proposed Aluminum Gangway

Dock
Existing
Gangway

WOOD BOARD

Pack's LANDING STORE (Lease)

Rimini, S.P.

Existing wood wall

Existing Ramp

EDGE OF PARKING

PITCH

Leased to Sumter County

Proposed: ① Floating Dock with Gangway

IN: LAKE MARION

AT: Pack's LANDING
Rimini, Sumter County, S

APPLICATION By: Santee Cooper

PARKING

Sh. 2 of 3
7-7-08

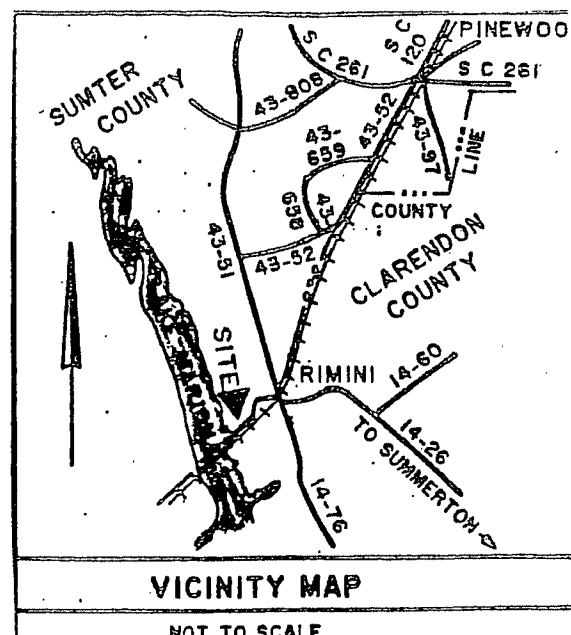
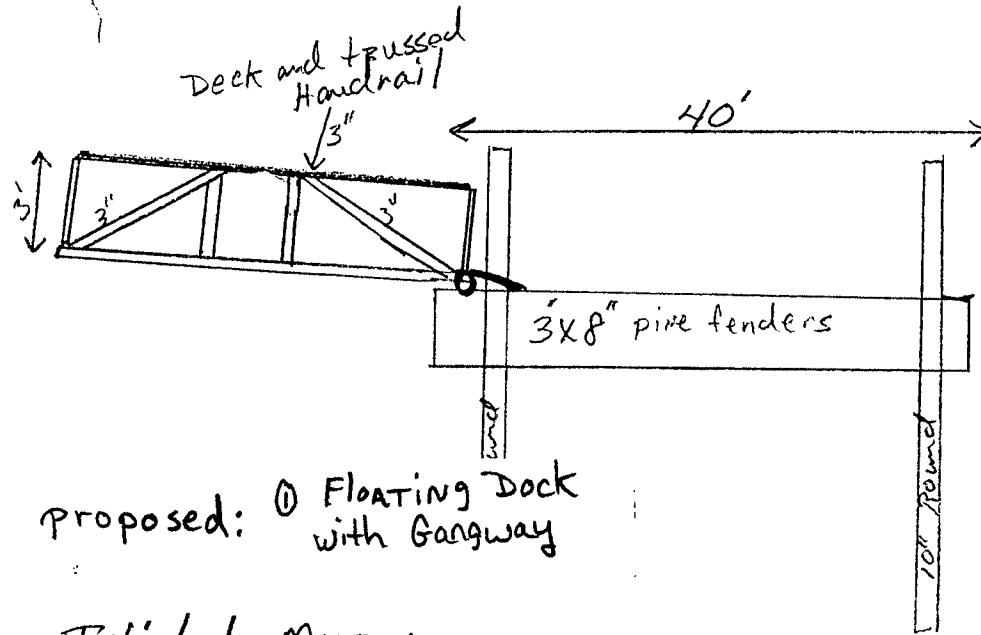
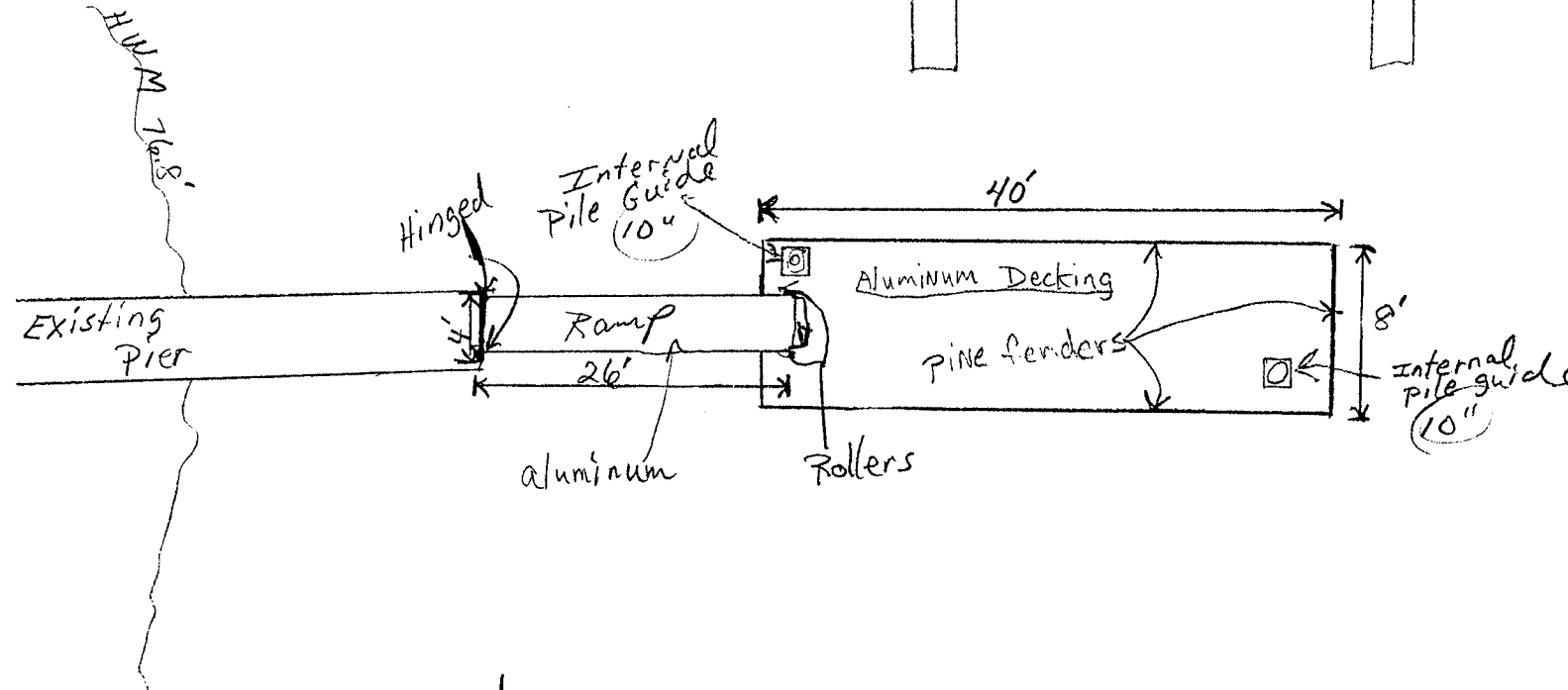
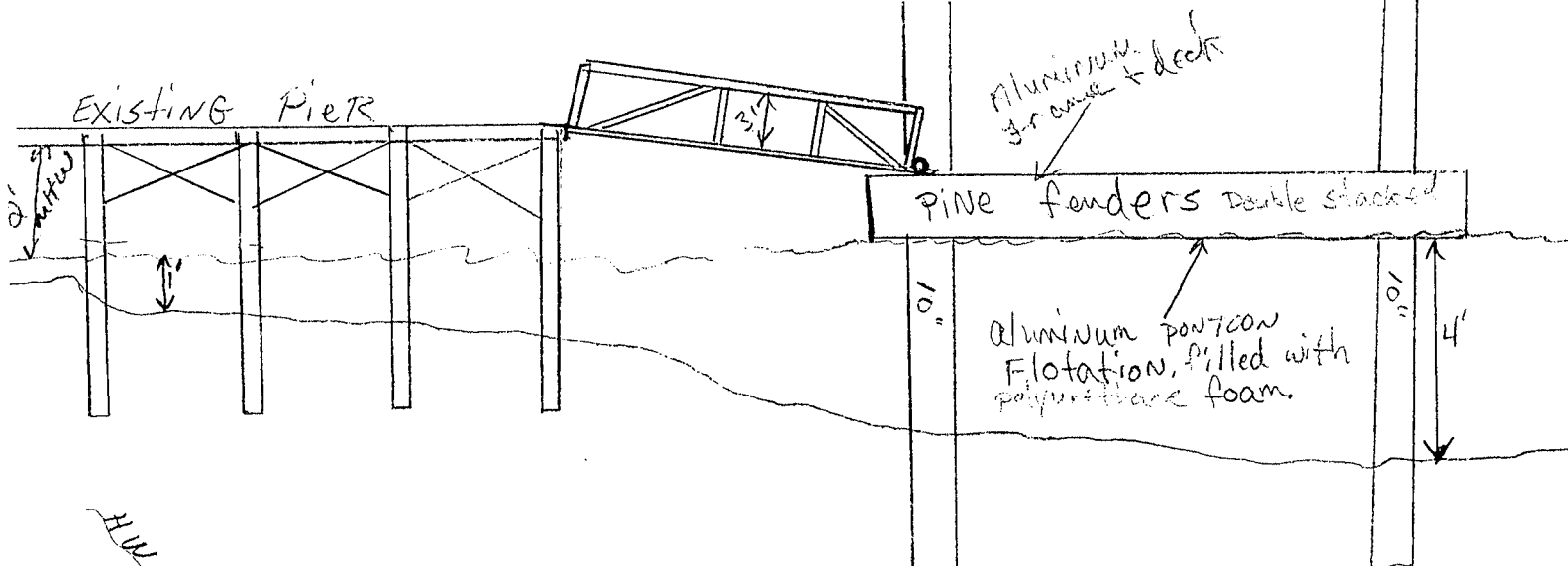

Proposed: ① Floating Dock with Gangway

IN: Lake MARION

AT: Packer LANDING

Rimini, Sumter County, S

APPLICATION By: Santee Cooper for County of Sumter.

Sh. 3 of 3
7-7-08