

**JOINT**  
**PUBLIC NOTICE**

**CHARLESTON DISTRICT, CORPS OF ENGINEERS**  
**69A Hagood Avenue**  
**Charleston, South Carolina 29403-5107**  
**and**

**THE S.C. DEPARTMENT OF HEALTH AND ENVIRONMENTAL CONTROL**  
**Office of Environmental Quality Control**  
**Water Quality Certification and Wetlands Programs Section**  
**2600 Bull Street**  
**Columbia, South Carolina 29201**

REGULATORY DIVISION

Refer to: P/N # SAC 1996-10849-3IB

May 23, 2008

Pursuant to Section 10 of the Rivers and Harbors Act of 1899 (33 U.S.C. 403), Sections 401 and 404 of the Clean Water Act (33 U.S.C. 1344), and the South Carolina Coastal Zone Management Act (48-39-10 et.seq.) an application has been submitted to the Department of the Army and the S.C. Department of Health and Environmental Control by

**STEVE GOSNELL**  
**HORRY COUNTY PARKS AND RECREATION**  
**C/O JEFF BOYER**  
**SOUTH CAROLINA DEPARTMENT OF NATURAL RESOURCES**  
**P.O. BOX 167**  
**COLUMBIA, SOUTH CAROLINA 29202**

for a permit to construct a floating dock and a concrete dock pad and pilings, excavation, and relocating existing rip-rap in the

**WACCAMAW RIVER**

located at the Reaves Ferry Boat Landing on Reaves Ferry Road north of the City of Conway, Horry County, South Carolina (Latitude 33.85070°N; Longitude -78.89844°W).

In order to give all interested parties an opportunity to express their views

**NOTICE**

is hereby given that written statements regarding the proposed work will be received by both of the above mentioned offices until

**12 O'CLOCK NOON, MONDAY, JUNE 23, 2008**

from those interested in the activity and whose interests may be affected by the proposed work.

The proposed work consists of constructing a floating dock and a concrete dock pad and pilings, excavation, and relocating existing rip-rap. In detail, the work consists of constructing an 8' x 65' aluminum ground-out floating courtesy dock with an 8' x 4" x 40' concrete dock pad. Approximately 12.0 cubic yards of concrete will be used to construct the concrete dock pad, with only 2.8 cubic yards of that placed below Ordinary High Water. Approximately 5.2 cubic yards of material will be excavated for the construction of the concrete dock pad and will be disposed of in the county landfill. 3.0 cubic yards of existing rip-rap will be moved from the edge of the existing boat ramp to the edge of the proposed dock/concrete pad. An additional 3.0 cubic yards of new rip-rap will also be placed below Ordinary High Water along the edge of the proposed dock/concrete pad. The project purpose is for public recreational use.

**NOTE:** Plans depicting the work described in this notice are available and will be provided, upon receipt of a written request, to anyone that is interested in obtaining a copy of the plans for the specific project. The request must identify the project of interest by public notice number and a self-addressed stamped envelope must also be provided for mailing the drawings to you. Your request for drawings should be addressed to the

**U.S. Army Corps of Engineers  
ATTN: REGULATORY DIVISION  
1949 Industrial Park Road, Room 140  
Conway, South Carolina 29526**

The District Engineer has concluded that the discharges associated with this project, both direct and indirect, should be reviewed by the South Carolina Department of Health and Environmental Control in accordance with provisions of Section 401 of the Clean Water Act. As such, this notice constitutes a request, on behalf of the applicant, for certification that this project will comply with applicable effluent limitations and water quality standards. The work shown on this application must also be certified as consistent with applicable provisions of the South Carolina Coastal Zone Management Act (15 CFR 930). The District Engineer will not process this application to a conclusion until such certifications are received. The applicant is hereby advised that supplemental information may be required by the State to facilitate the review. Persons wishing to comment or object to State certification must submit all comments in writing to the S.C. Department of Health and Environmental Control at the above address within thirty (30) days of the date of this notice.

This notice initiates the Essential Fish Habitat (EFH) consultation requirements of the Magnuson-Stevens Fishery Conservation and Management Act. Implementation of the proposed project would impact approximately 0.01 acre of waters upstream of estuarine substrates and emergent wetlands utilized by various life stages of species comprising the red drum, shrimp, and snapper-grouper management complexes. Our initial determination is that the proposed action would not have a substantial individual or cumulative adverse impact on EFH or fisheries managed by the South Atlantic Fishery Management Council and the National Marine Fisheries Service (NMFS). Our final determination relative to project impacts and the need for mitigation measures is subject to review by and coordination with the NMFS.

The District Engineer has consulted the most recently available information and has determined that the project will have no effect on any Federally endangered, threatened, or proposed species and will not result in the destruction or adverse modification of designated or proposed critical habitat. This public notice serves as a request to the U.S. Fish and Wildlife Service and the National Marine Fisheries Service for any additional information they may have on whether any listed or proposed endangered or threatened species or designated or proposed critical habitat may be present in the area which would be affected by the activity, pursuant to Section 7(c) of the Endangered Species Act of 1973 (as amended).

Pursuant to Section 106 of the National Historic Preservation Act (NHPA), this public notice also constitutes a request to Indian Tribes to notify the District Engineer of any historic properties of religious and cultural significance to them that may be affected by the proposed undertaking.

In accordance with the NHPA, the District Engineer has also consulted the latest published version of the National Register of Historic Places for the presence or absence of registered properties, or properties listed as being eligible for inclusion therein, and this worksite is not included as a registered property or property listed as being eligible for inclusion in the Register. To insure that other cultural resources that the District Engineer is not aware of are not overlooked, this public notice also serves as a request to the State Historic Preservation Office to provide any information it may have with regard to historic and cultural resources.

Any person may request, in writing, within the comment period specified in this notice, that a public hearing be held to consider this application. Requests for a public hearing shall state, with particularity, the reasons for holding a public hearing.

The decision whether to issue a permit will be based on an evaluation of the probable impact including cumulative impacts of the activity on the public interest. That decision will reflect the national concern for both protection and utilization of important resources. The benefit which reasonably may be expected to accrue from the project must be balanced against its reasonably foreseeable detriments. All factors which may be relevant to the project will be considered including the cumulative effects thereof; among those are conservation, economics, aesthetics, general environmental concerns, wetlands, historic properties, fish and wildlife values, flood hazards, flood plain values, land use, navigation, shoreline erosion and accretion, recreation, water supply and conservation, water quality, energy needs, safety, food and fiber production and, in general, the needs and welfare of the people. A permit will be granted unless the District Engineer determines that it would be contrary to the public interest. In cases of conflicting property rights, the Corps of Engineers cannot undertake to adjudicate rival claims.

The Corps of Engineers is soliciting comments from the public; Federal, state, and local agencies and officials; Indian Tribes; and other interested parties in order to consider and evaluate the impacts of this activity. Any comments received will be considered by the Corps of Engineers to determine whether to issue, modify, condition or deny a permit for this project. To make this decision, comments are used to assess impacts on endangered species, historic properties, water quality, general environmental effects, and the other public interest factors listed above. Comments are used in the preparation of an Environmental Assessment and/or an Environmental Impact Statement pursuant to the National Environmental Policy Act. Comments are also used to determine the need for a public hearing and to determine the overall public interest of the activity.

If there are any questions concerning this public notice, please contact Wiley Bracey at 843-365-1707.

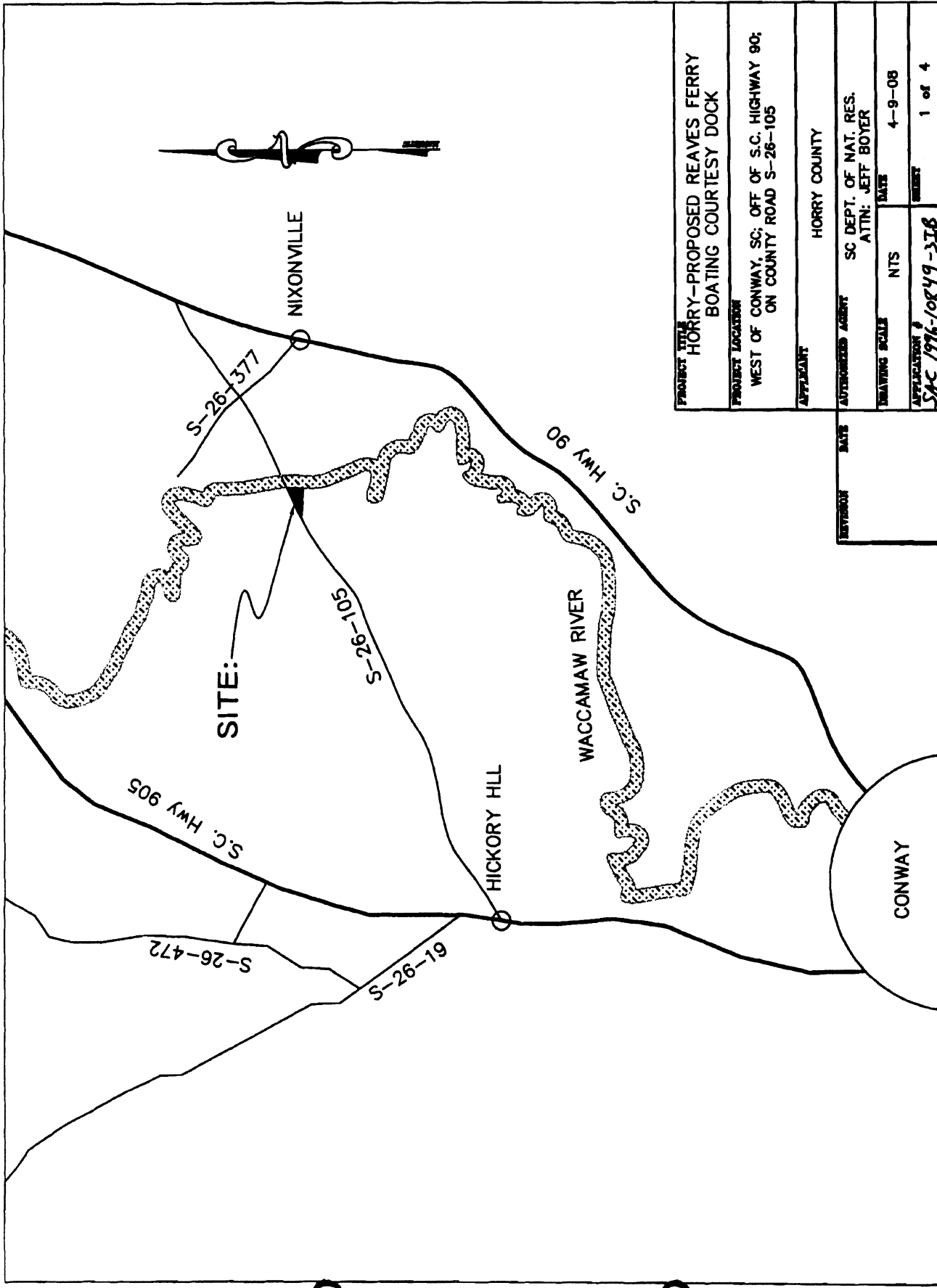

<b>PROJECT TITLE</b> HORRY-PROPOSED REAVES FERRY BOATING COURTESY DOCK	
<b>PROJECT LOCATION</b> WEST OF CONWAY, SC; OFF OF S.C. HIGHWAY 90; ON COUNTY ROAD S-26-105	
<b>APPLICANT</b> HORRY COUNTY	
<b>APPROVED DATE</b>	<b>AUTHORIZED AGENT</b> SC DEPT. OF NAT. RES. ATTN: JEFF BOYER
<b>DRAWING SCALE</b> NTS	<b>DATE</b> 4-9-08
<b>APPLICATION #</b> SAC 1976-10849-31B	<b>SHEET</b> 1 of 4

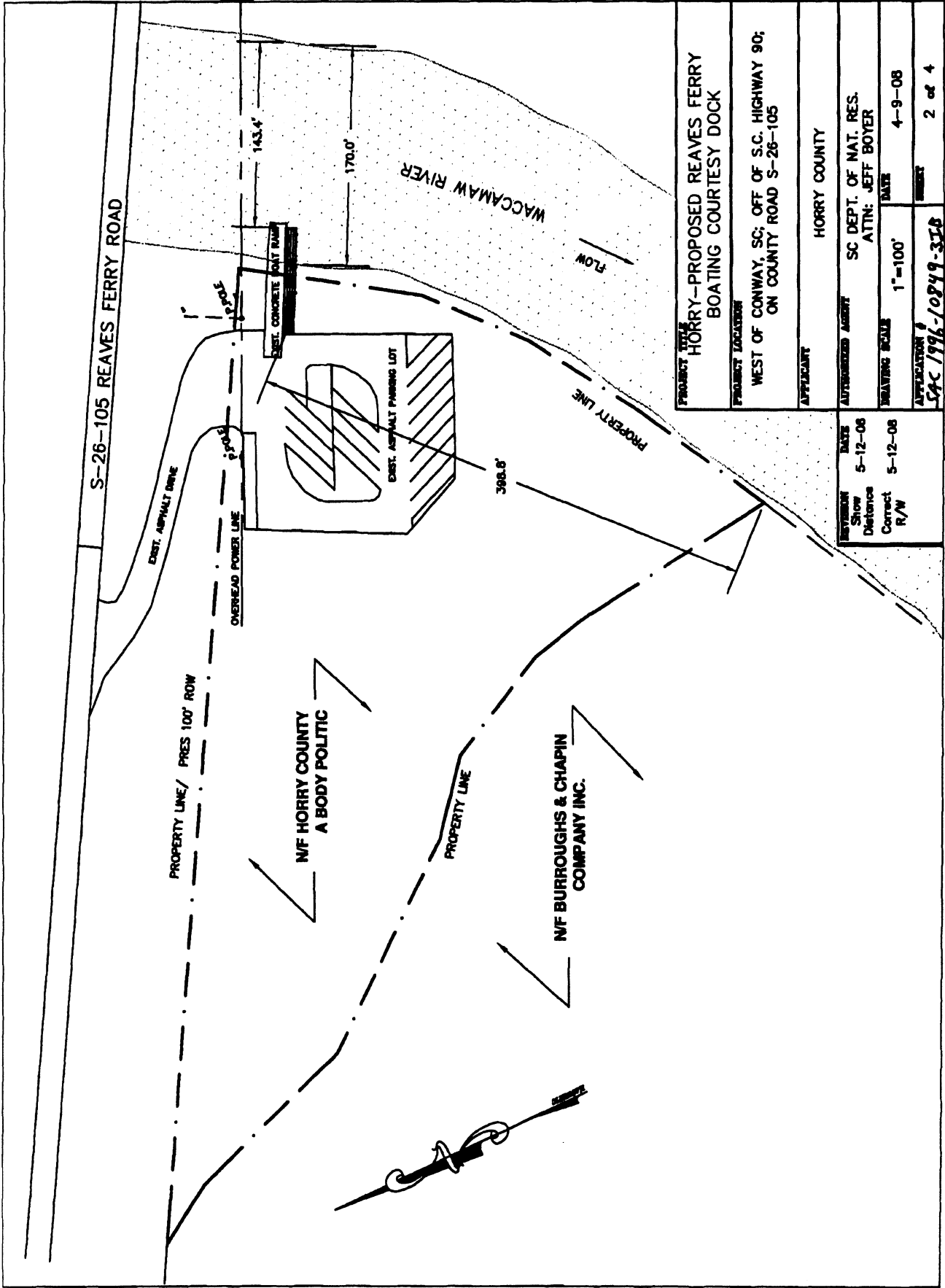

PROJECT TITLE	HORRY-PROPOSED REAVES FERRY BOATING COURTESY DOCK		
PROJECT LOCATION	WEST OF CONWAY, SC; OFF OF S.C. HIGHWAY 90; ON COUNTY ROAD S-26-105		
APPLICANT	HORRY COUNTY		
AUTHORIZED AGENT	SC DEPT. OF NAT. RES. ATTN: JEFF BOYER		
DRAWING SCALE	1"=100'	DATE	4-9-08
APPLICATION #	SAC 1996-10849-31B		
SHEET	2 of 4		

REVISION	DATE
Show Distance Correct R/W	5-12-08
	5-12-08

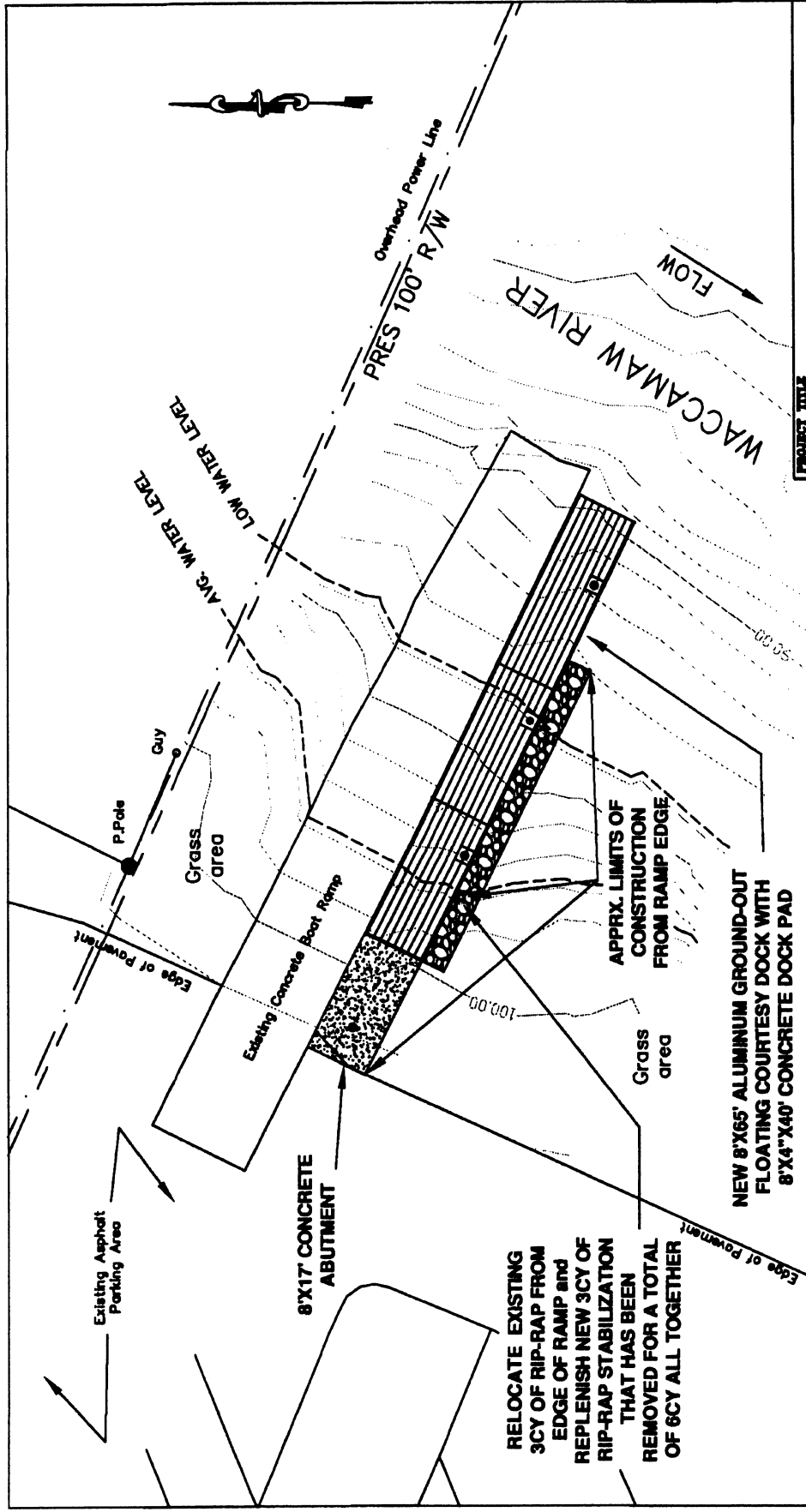

<b>PROJECT TITLE</b>	HORRY- PROPOSED REAVES FERRY BOATING COURTESY DOCK
<b>PROJECT LOCATION</b>	WEST OF CONWAY, S.C., OFF OF S.C. HWY 90, ON COUNTY ROAD S-26-105
<b>APPLICANT</b>	HORRY COUNTY
<b>APPROVED AGENT</b>	S.C. DEPT. OF NAT. RES. ATTN: JEFF BOYER
<b>DRAWING SCALE</b>	1"=20'
<b>DATE</b>	4-9-08
<b>APPRECIATION #</b>	5AC 1998-10849-3IB
<b>REVISION</b>	DATE
Show Limits	5-12-08
Correct R/W	5-12-08
SHEET 3 of 4	

\*THERE WILL BE APPROX. 5.2 CUBIC YARDS OF MATERIAL REMOVED FROM WITHIN THE DOCK AREA. (APPROX. 0.6 CY ARE FROM BELOW THE AVG WATER LINE.) THIS MATERIAL WILL BE REMOVED FROM THE SITE AND DISPOSED OF IN THE COUNTY LANDFILL LOCATED AT 1886 HWY 90. DREDGING PERFORMED BY MECHANICAL MEANS.

\*THERE WILL BE APPROX. 12.0 CUBIC YARDS OF CONCRETE PLACED TO CONSTRUCT THE NEW DOCK SYSTEM. (APPROX. 2.8 CY ARE BELOW THE AVG WATER LINE.)

\*STANDARD SILT FENCES WILL BE USED TO CONTROL STORM WATER RUN-OFF DURING CONSTRUCTION.

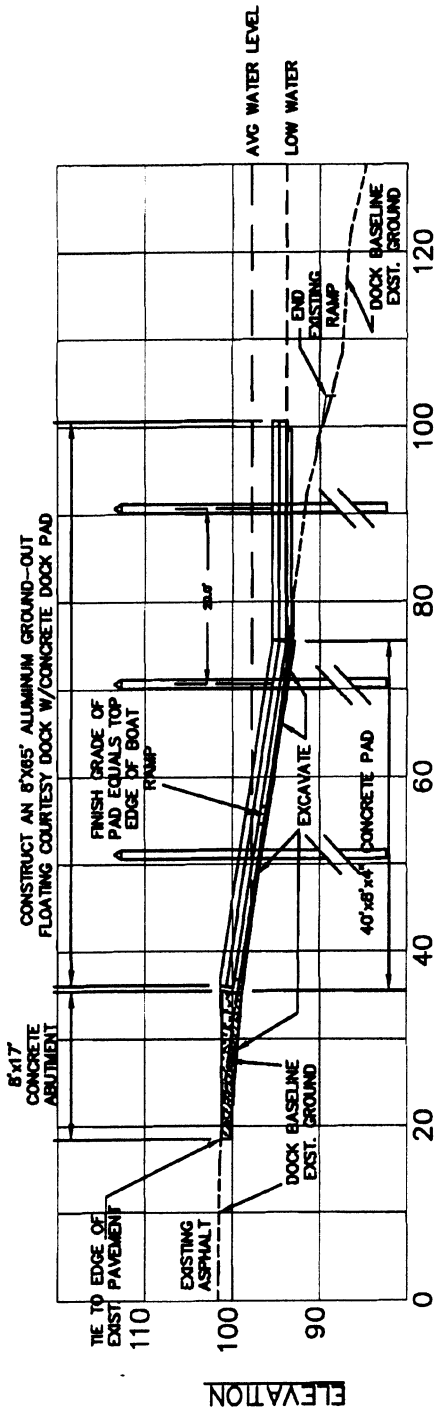

STABILIZATION SHALL BE ONE-MAN SIZED STONE PLACE OVER FILTER FABRIC (1FT THICK)

DISTANCE

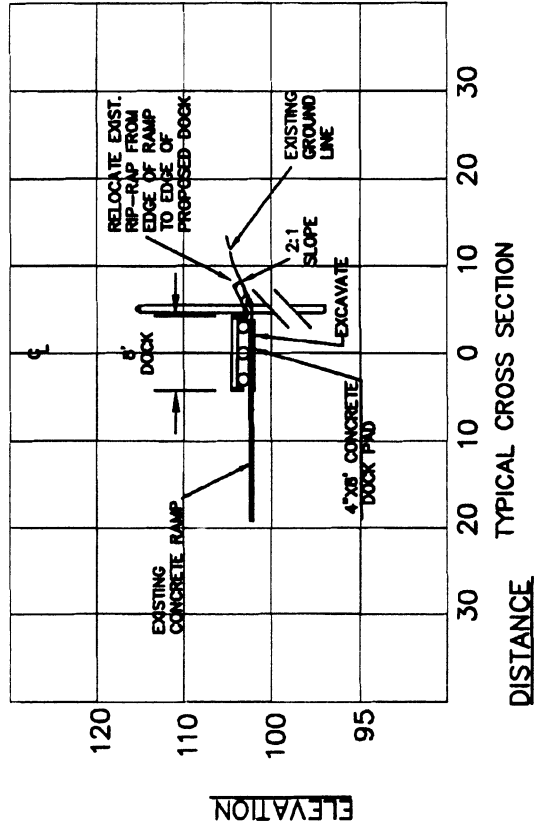

DISTANCE

- \*THERE WILL BE APPROX. 5.2 CUBIC YARDS OF MATERIAL REMOVED FROM WITHIN THE DOCK AREA. (APPROX. 0.6 CY ARE FROM BELOW THE AVG WATER LINE.) THIS MATERIAL WILL BE REMOVED FROM THE SITE AND DISPOSED OF IN THE COUNTY LANDFILL LOCATED AT 1886 HWY 90. DREDGING PERFORMED BY MECHANICAL MEANS.
- \*THERE WILL BE APPROX. 12 CUBIC YARDS OF CONCRETE PLACED TO CONSTRUCT THE NEW DOCK SYSTEM. (APPROX. 2.8 CY ARE BELOW THE AVG WATER LINE.)
- \*STANDARD SILT FENCES WILL BE USED TO CONTROL STORM WATER RUN-OFF DURING CONSTRUCTION.

PROJECT TITLE HORRY-PROPOSED REAVES FERRY BOATING COURTESY DOCK
PROJECT LOCATION WEST OF CONWAY, SC; OFF OF S.C. HIGHWAY 90; ON COUNTY ROAD 5-26-105
APPLICANT HORRY COUNTY
AUTHORIZED AGENT SC DEPT. OF NAT. RES. ATTN: JEFF BOYER
DRAWING SCALE 1"=20'
DATE 4-9-08
APPROPRIATION # SAC 1996-10849-JIB
SHEET 4 of 4

REVISION DATE  
Delinquent Excavation Areas  
5/12/08