

PT. NO.	STATION W/OFFSET	COORDINATES			
		NAD 27		NAD 83	
		EAST (X)	NORTHING (Y)	EAST (X)	NORTHING (Y)
	538+00S 300R	2,401,436.65	387,173.36	2,401,469.42	387,316.73
	551+00S 300R	2,400,892.35	385,992.80	2,400,925.39	386,136.09
	564+73.17S 300R	2,400,336.72	384,787.70	2,400,370.03	384,930.92
	564+73.17S 370L	2,400,901.21	384,411.91	2,400,934.60	384,555.26
	578+00S 380R	2,399,412.34	383,898.99	2,399,445.86	384,042.04
	578+00S 300L	2,399,913.27	383,439.15	2,399,946.88	383,582.32

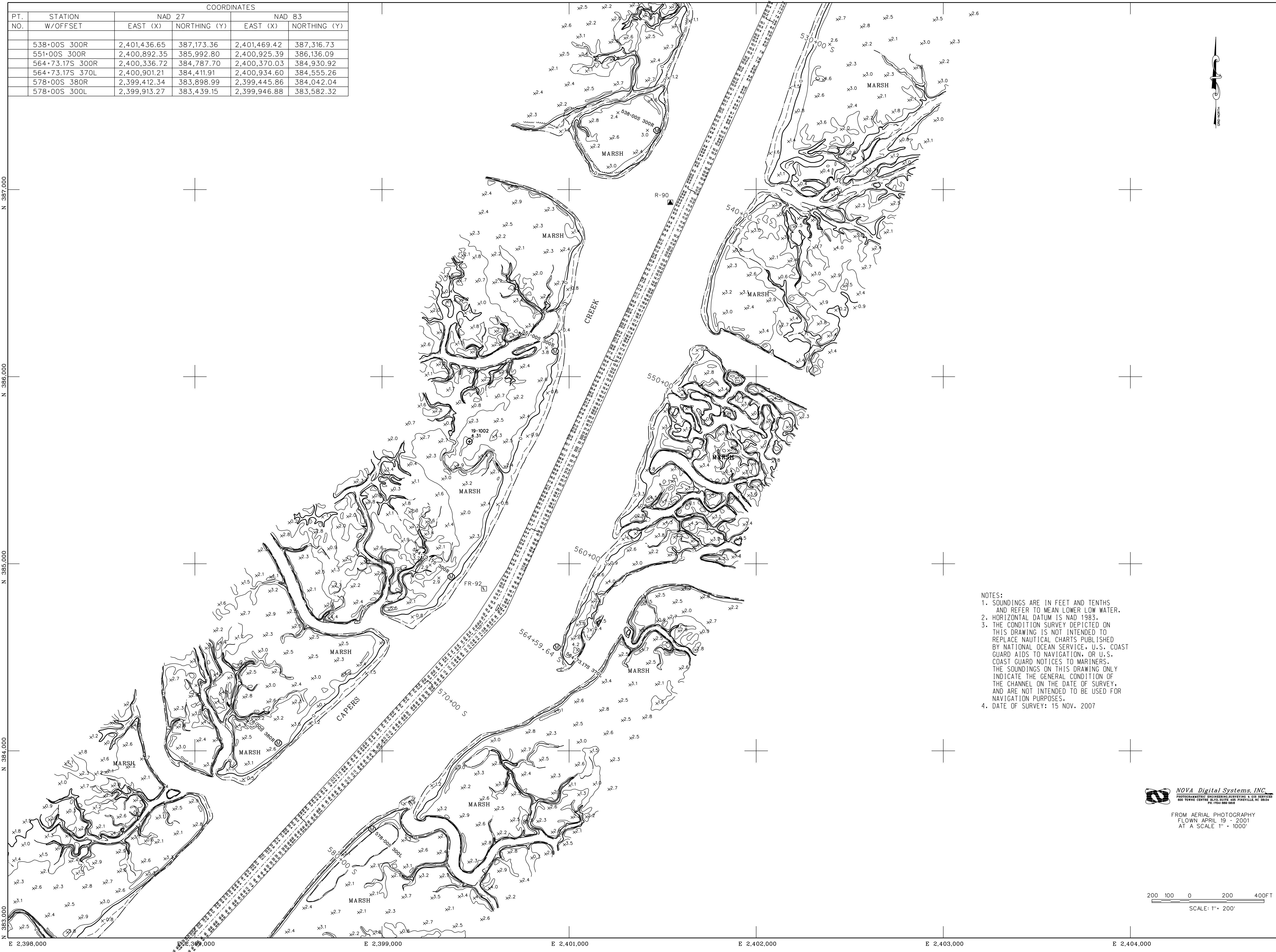

NOTES:
 1. SOUNDINGS ARE IN FEET AND TENTHS AND REFER TO MEAN LOWER LOW WATER.
 2. HORIZONTAL DATUM IS NAD 1983.
 3. THE CONDITION SURVEY DEPICTED ON THIS DRAWING IS NOT INTENDED TO REPLACE NAUTICAL CHARTS PUBLISHED BY NATIONAL OCEAN SERVICE, U.S. COAST GUARD AIDS TO NAVIGATION, OR U.S. COAST GUARD NOTICES TO MARINERS. THE SOUNDINGS ON THIS DRAWING ONLY INDICATE THE GENERAL CONDITION OF THE CHANNEL ON THE DATE OF SURVEY, AND ARE NOT INTENDED TO BE USED FOR NAVIGATION PURPOSES.
 4. DATE OF SURVEY: 15 NOV. 2007

NOVA Digital Systems, INC.
 PHOTOGRAMMETRIC ENGINEERING, SURVEYING & GIS SERVICES
 4401 STATE STREET, SUITE 200, CHARLOTTE, NC 28226
 PH: 704.366.5818

FROM AERIAL PHOTOGRAPHY
 FLOWN APRIL 19 - 2001
 AT A SCALE 1" = 1000'

SCALE: 1" = 200'

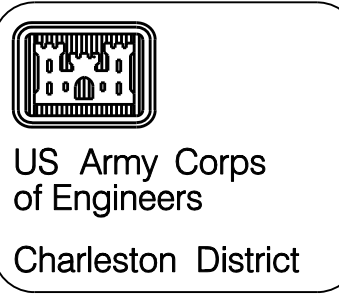

DATE	APPROV.	DESCRIPTION

Designed By:	NOV. 07
Drawn By:	9191
Checked By:	
Reviewed By:	
Submitted By:	
By whom:	
Day Month Year:	

U.S. ARMY ENGINEER DISTRICT
 CORPS OF ENGINEERS
 CHARLESTON SOUTH CAROLINA

AWW, WINYAH BAY TO CHARLESTON
 STA. 528+95S TO STA. 588+52S
 9191
 GEORGETOWN, CHARLESTON COUNTIES, SOUTH CAROLINA

SHEET
 REFERENCE
 NUMBER

SHEET 45 OF 62