

SHEET INDEX

CP-74	CP-72	CP-69	CP-66	CP-63	CP-60
CP-75	CP-73	CP-70	CP-67	CP-64	CP-61
CP-76	CP-71	CP-68	CP-65	CP-62	
CP-77					
CP-78	CP-79				
CP-81	CP-80				
CP-83	CP-82				
CP-84					
CP-85					

NOTES:
 1. SOUNDINGS ARE IN FEET AND TENTHS AND REFER TO MEAN LOWER LOW WATER.
 2. HORIZONTAL DATUM IS NAD 1983.
 3. THE CONDITION SURVEY DEPICTED ON THIS DRAWING IS NOT INTENDED TO REPLACE NAUTICAL CHARTS PUBLISHED BY NATIONAL OCEAN SERVICE, U.S. COAST GUARD AIDS TO NAVIGATION, OR U.S. COAST GUARD NOTICES TO MARINERS. THE SOUNDINGS ON THIS DRAWING ONLY INDICATE THE GENERAL CONDITION OF THE CHANNEL ON THE DATE OF SURVEY, AND ARE NOT INTENDED TO BE USED FOR NAVIGATION PURPOSES.
 4. DATE OF SURVEY: 5 JUNE 2008

72

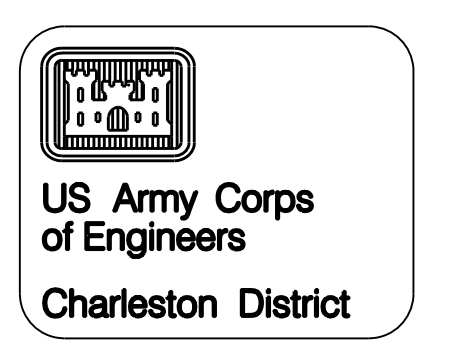
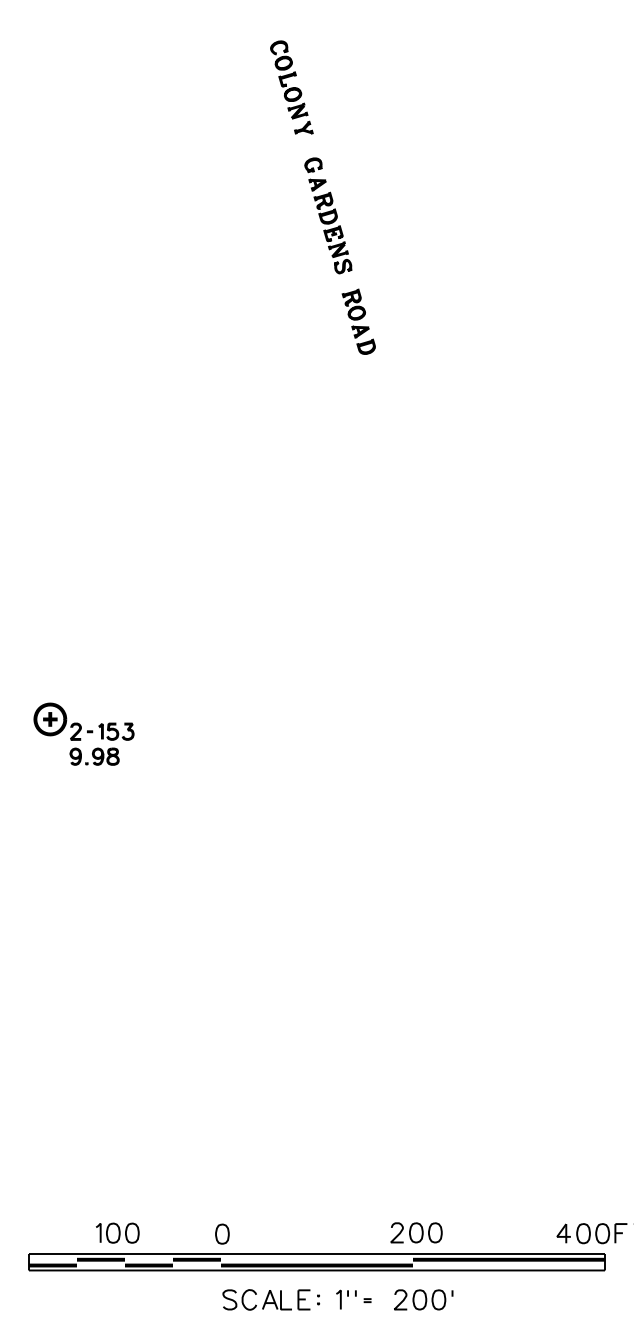

No.	Issue Book Description	DATE	APPROV.	DESCRIPTION
No. 1				
No. 2				
No. 3				
No. 4				
No. 5				
No. 6				
No. 7				
No. 8				
No. 9				
No. 10				
No. 11				
No. 12				
No. 13				
No. 14				
No. 15				
No. 16				
No. 17				
No. 18				
No. 19				
No. 20				

Designed by: **JUN E 08**
 Drawn by: **MJV**
 Checked by: **MJV**
 Date by: **9200**
 Drawing Code: **9200**
 File Name: **9200**
 Plot Scale: **1" = 200'**

U.S. ARMY ENGINEER DISTRICT
 CORPS OF ENGINEERS
 CHARLESTON, SOUTH CAROLINA

ATLANTIC INTRACOASTAL WATERWAY
 CHARLESTON TO PORT ROYAL
 9200
 STA. 3377 +06 TO STA. 3435 +52
 CHARLESTON, COLLETON, AND BEAUFORT COUNTIES
 SOUTH CAROLINA

SHEET REFERENCE NUMBER
 SHEET 65 OF 68