

PT. NO.	STATION W/OFFSET	COORDINATES			
		NAD 27		NAD 83	
		EAST (X)	NORTHING (Y)	EAST (X)	NORTHING (Y)
	1835+98.25 220L	2,191,509.75	285,519.99	2,191,560.98	285,630.87
	1859+25.45 350L	2,189,395.86	284,943.37	2,189,447.13	285,054.03
	1859+25.45 400L	2,189,426.05	284,898.62	2,189,477.33	285,009.29
	1867+15.90 600L	2,189,340.72	284,401.26	2,189,392.05	284,511.92
	1874+91.29 600L	2,189,309.58	283,792.95	2,189,360.97	283,903.61
	1882+91.29 1700R	2,186,971.70	283,111.56	2,187,023.14	283,221.98
	1890+43.94 1700R	2,186,951.87	282,724.30	2,187,003.35	282,834.72

NOTES:  
 1. SOUNDINGS ARE IN FEET AND TENTHS AND REFER TO MEAN LOWER LOW WATER.  
 2. HORIZONTAL DATUM IS NAD 1983.  
 3. THE CONDITION SURVEY DEPICTED ON THIS DRAWING IS NOT INTENDED TO REPLACE NAUTICAL CHARTS PUBLISHED BY NATIONAL OCEAN SERVICE, U.S. COAST GUARD AIDS TO NAVIGATION, OR U.S. COAST GUARD NOTICES TO MARINERS. THE SOUNDINGS ON THIS DRAWING ONLY INDICATE THE GENERAL CONDITION OF THE CHANNEL ON THE DATE OF SURVEY, AND ARE NOT INTENDED TO BE USED FOR NAVIGATION PURPOSES.  
 4. DATE OF SURVEY: 17 DEC. 2007 CONDITION

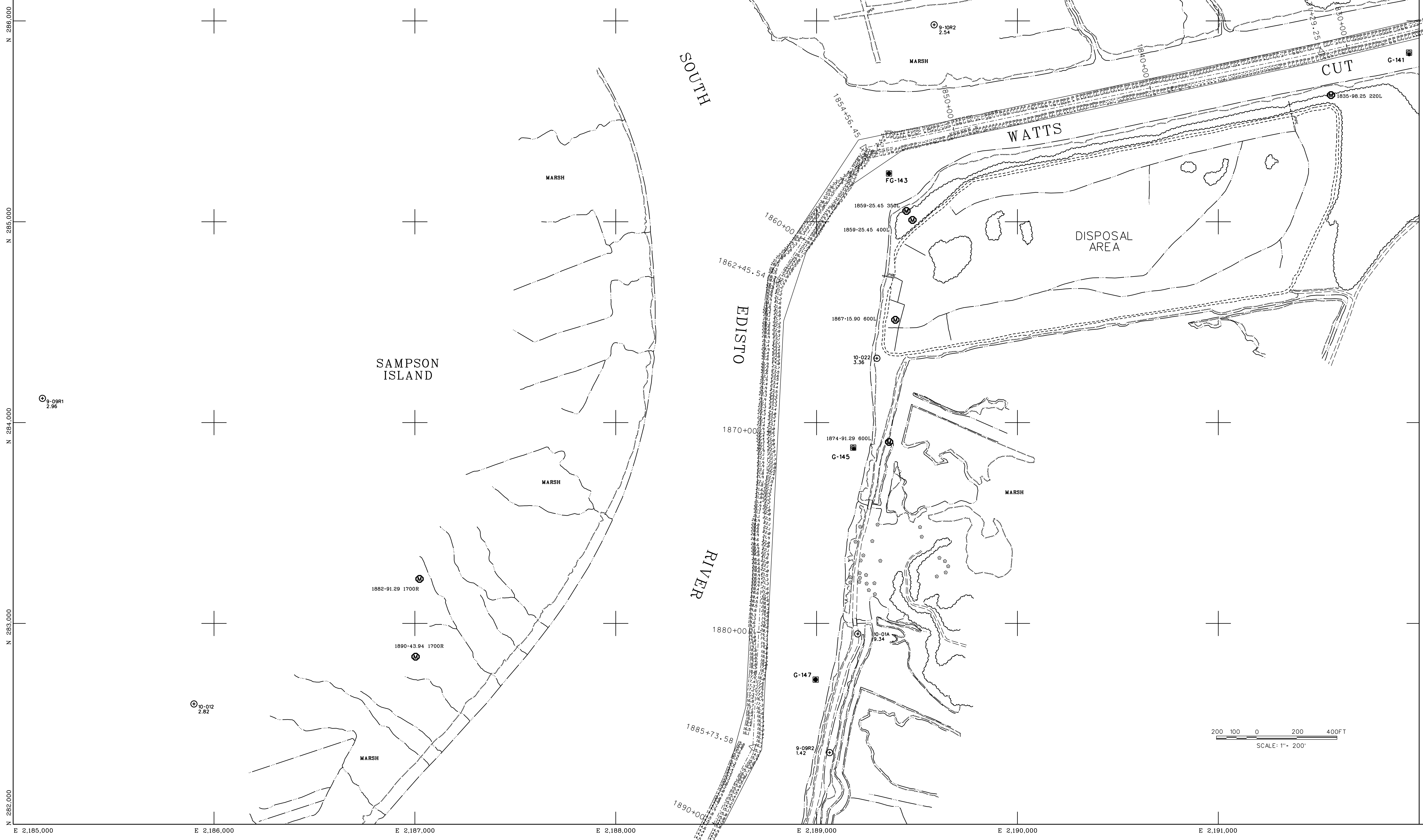
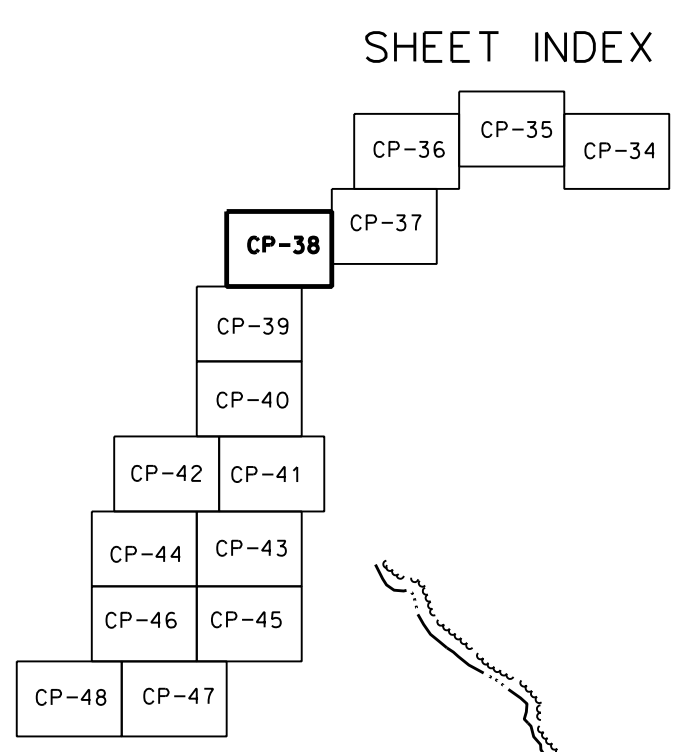

N 286.000  
N 285.000  
N 284.000  
N 283.000  
N 282.000

E 2,185.000  
E 2,186.000  
E 2,187.000  
E 2,188.000  
E 2,189.000  
E 2,190.000  
E 2,191.000

NO.	DATE	APPROV.	DESCRIPTION
1	17 DEC 2007		CONDITION

DESIGNED BY: MRY  
 CHECKED BY: MRY  
 DATE: JAN 08  
 DESIGN IN INCHES: 9200  
 DRAWING CODE: 9200  
 SHEET NUMBER: 37 OF 68

ATLANTIC INTRACOASTAL WATERWAY  
 CHARLESTON TO PORT ROYAL  
 9200  
 STA. 1826+29 TO STA. 1890+05  
 CHARLESTON, COLLETON, AND BEAUFORT COUNTIES  
 SOUTH CAROLINA

SHEET REFERENCE NUMBER  
 SHEET 37 OF 68