

NO.	DATE	DESCRIPTION	DATE	APPROV.	DESCRIPTION
1	11/28/07	Issue Book Description 1			
2					
3					
4					
5					
6					
7					
8					
9					
10					
11					
12					
13					
14					
15					
16					
17					
18					
19					
20					

Designed by:	MHV	Checked by:	MHV
Date:	DEC 07	Design in file:	9200
Drawn by:	MHV	Drawing Code:	
Revised by:		File name:	15-033
Submitted by:		Drawn scale:	1" = 200'

ATLANTIC INTRACOASTAL WATERWAY
CHARLESTON TO PORT ROYAL
9200
STA. 542+69 TO STA. 602+58
CHARLESTON COLLETON AND BEAUFORT COUNTIES
SOUTH CAROLINA

SHEET REFERENCE NUMBER
SHEET 12 OF 68

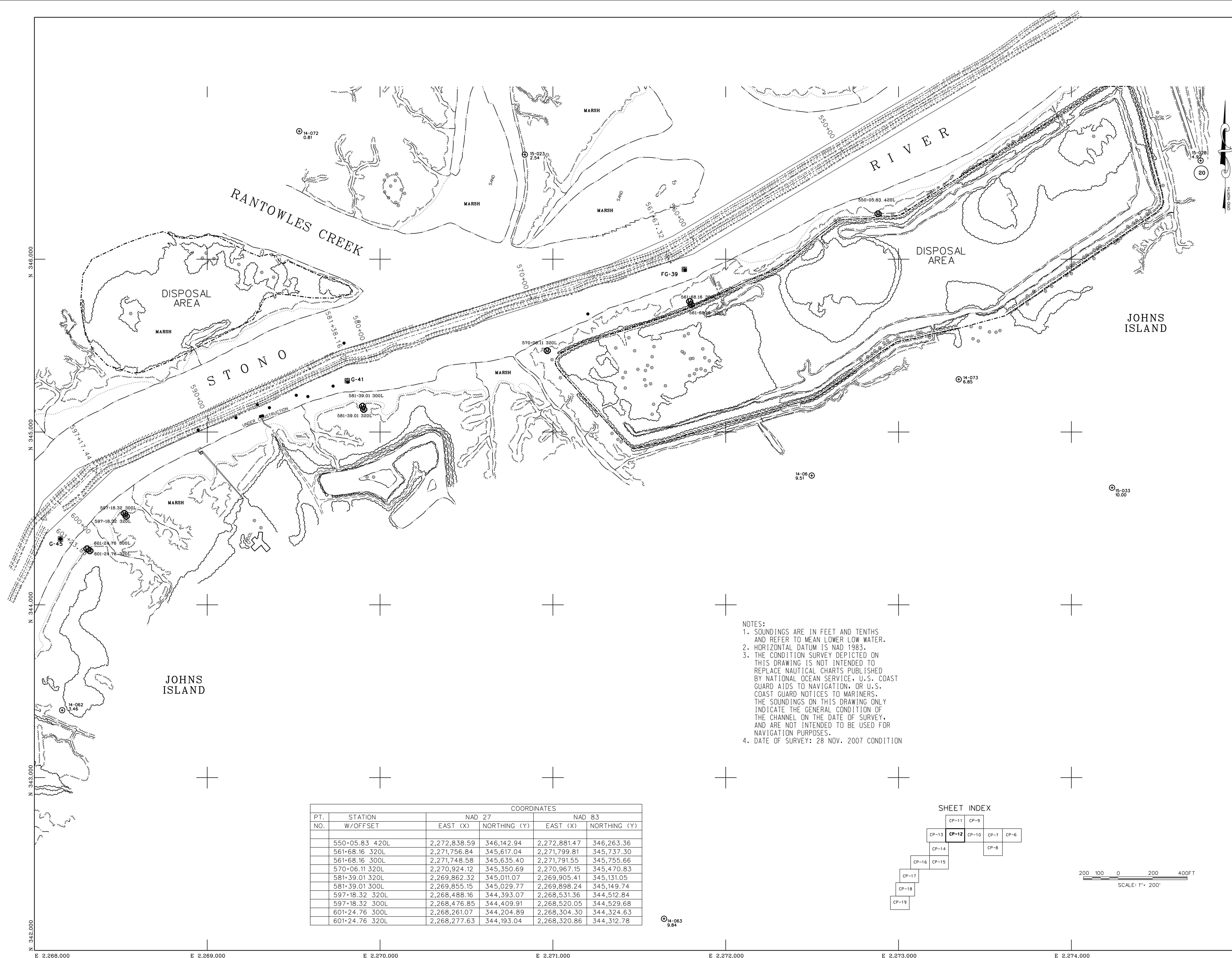

NOTES:
1. SOUNDINGS ARE IN FEET AND TENTHS AND REFER TO MEAN LOWER LOW WATER.
2. HORIZONTAL DATUM IS NAD 1983.
3. THE CONDITION SURVEY DEPICTED ON THIS DRAWING IS NOT INTENDED TO REPLACE NAUTICAL CHARTS PUBLISHED BY NATIONAL OCEAN SERVICE, U.S. COAST GUARD AIDS TO NAVIGATION, OR U.S. COAST GUARD NOTICES TO MARINERS. THE SOUNDINGS ON THIS DRAWING ONLY INDICATE THE GENERAL CONDITION OF THE CHANNEL ON THE DATE OF SURVEY, AND ARE NOT INTENDED TO BE USED FOR NAVIGATION PURPOSES.
4. DATE OF SURVEY: 28 NOV. 2007 CONDITION

PT. NO.	STATION W/OFFSET	COORDINATES			
		NAD 27		NAD 83	
		EAST (X)	NORTHING (Y)	EAST (X)	NORTHING (Y)
	550+05.83 420L	2,272,838.59	346,142.94	2,272,881.47	346,263.36
	561+68.16 320L	2,271,756.84	345,617.04	2,271,799.81	345,737.30
	561+68.16 300L	2,271,748.58	345,635.40	2,271,791.55	345,755.66
	570+06.11 320L	2,270,924.12	345,350.69	2,270,967.15	345,470.83
	581+39.01 320L	2,269,862.32	345,011.07	2,269,905.41	345,131.05
	581+39.01 300L	2,269,855.15	345,029.77	2,269,898.24	345,149.74
	597+18.32 320L	2,268,488.16	344,393.07	2,268,531.36	344,512.84
	597+18.32 300L	2,268,476.85	344,409.91	2,268,520.05	344,529.68
	601+24.76 300L	2,268,261.07	344,204.89	2,268,304.30	344,324.63
	601+24.76 320L	2,268,277.63	344,193.04	2,268,320.86	344,312.78

