

**JOINT**  
**PUBLIC NOTICE**

**CHARLESTON DISTRICT, CORPS OF ENGINEERS**  
**69A Hagood Avenue**  
**Charleston, South Carolina 29403-5107**  
**and the**  
**S.C. DEPARTMENT OF HEALTH AND ENVIRONMENTAL CONTROL**  
**OFFICE OF OCEAN AND COASTAL RESOURCE MANAGEMENT**  
**1362 McMillan Avenue, Suite 400**  
**Charleston, South Carolina 29405**

REGULATORY DIVISION  
Refer to: P/N # SAC-2008-360-2IG

9 MAY 2008

Pursuant to Section 10 of the Rivers and Harbors Act of 1899 (33 U.S.C. 403) and the South Carolina Coastal Zone Management Act (48-39-10 et.seq.) an application has been submitted to the Department of the Army and the S.C. Department of Health and Environmental Control by

**THE POINT COMPANY**  
**C/O JOHN E. WADE, JR.**  
**POST OFFICE BOX 686**  
**ISLE OF PALMS, SOUTH CAROLINA 29451**

for a permit to construct a fixed pierhead and floating dock in the

**ATLANTIC INTRACOASTAL WATERWAY (AIWW)**

at a location, Lot D, Hagerty Point, Sullivan's Island, Charleston County, South Carolina.  
(Latitude 32.767272° - Longitude -79.86442°)

In order to give all interested parties an opportunity to express their views

**NOTICE**

is hereby given that written statements regarding the proposed work will be received by both of the above mentioned offices until

**12 O'CLOCK NOON, MONDAY, JUNE 9, 2008**

from those interested in the activity and whose interests may be affected by the proposed work.

The proposed work consists of constructing a fixed covered pierhead, floating dock and four-pile boatlift. In detail, the applicant proposes to construct a 14' x 16' covered fixed pierhead with benches and a fish cleaning station attached to high ground by a 4' x 75' fixed pier with hand rails. In addition, the applicant proposes to construct an 8' x 20' floating dock installed at the channelward end of the pierhead and attached by a 3' x 16' ramp. The applicant will also install a 12' x 12' four- pile boat lift on the upstream side of the fixed pier. The purpose of the proposed work is for the private recreational use of the future lot owner of Lot D, Hagerty Point.

**NOTE: Plans depicting the work described in this notice are available and will be provided, upon receipt of a written request, to anyone that is interested in obtaining a copy of the plans for the specific project. The request must identify the project of interest by public notice number and a self-addressed stamped envelope must also be provided for mailing the drawings to you. Your request for drawings should be addressed to the**

**U.S. Army Corps of Engineers  
ATTN: REGULATORY DIVISION  
69A Hagood Avenue  
Charleston, South Carolina 29403-5107**

The District Engineer has concluded that the discharges associated with this project, both direct and indirect, should be reviewed by the South Carolina Department of Health and Environmental Control in accordance with provisions of Section 401 of the Clean Water Act. As such, this notice constitutes a request, on behalf of the applicant, for certification that this project will comply with applicable effluent limitations and water quality standards. The work shown on this application must also be certified as consistent with applicable provisions the Coastal Zone Management Program (15 CFR 930). The District Engineer will not process this application to a conclusion until such certifications are received. The applicant is hereby advised that supplemental information may be required by the State to facilitate the review.

This notice initiates the Essential Fish Habitat (EFH) consultation requirements of the Magnuson-Stevens Fishery Conservation and Management Act. Implementation of the proposed project should not impact acres of estuarine substrates and emergent wetlands utilized by various life stages of species comprising the red drum, shrimp, and snapper-grouper management complexes. Our initial determination is that the proposed action would not have a substantial individual or cumulative adverse impact on EFH or fisheries managed by the South Atlantic Fishery Management Council and the National Marine Fisheries Service (NMFS). Our final determination relative to project impacts and the need for mitigation measures is subject to review by and coordination with the NMFS.

Pursuant to Section 106 of the National Historic Preservation Act (NHPA), this public notice also constitutes a request to Indian Tribes to notify the District Engineer of any historic properties of religious and cultural significance to them that may be affected by the proposed undertaking.

In accordance with the NHPA, the District Engineer has also consulted the latest published version of the National Register of Historic Places for the presence or absence of registered properties, or properties listed as being eligible for inclusion therein, and this worksite is not included as a registered property or property listed as being eligible for inclusion in the Register. To insure that other cultural resources that the District Engineer is not aware of are not overlooked, this public notice also serves as a request to the State Historic Preservation Office to provide any information it may have with regard to historic and cultural resources.

Any person may request, in writing, within the comment period specified in this notice, that a public hearing be held to consider this application. Requests for a public hearing shall state, with particularity, the reasons for holding a public hearing.

The decision whether to issue a permit will be based on an evaluation of the probable impact including cumulative impacts of the activity on the public interest. That decision will reflect the national concern for both protection and utilization of important resources. The benefit which reasonably may be expected to accrue from the project must be balanced against its reasonably foreseeable detriments. All factors which may be relevant to the project will be considered including the cumulative effects thereof; among those are conservation, economics, aesthetics, general environmental concerns, wetlands, historic properties, fish and wildlife values, flood hazards, flood plain values, land use, navigation, shoreline erosion and accretion, recreation, water supply and conservation, water quality, energy needs, safety, food and fiber production and, in general, the needs and welfare of the people. A permit will be granted unless the District Engineer determines that it would be contrary to the public interest. In cases of conflicting property rights, the Corps of Engineers cannot undertake to adjudicate rival claims.

The Corps of Engineers is soliciting comments from the public; Federal, state, and local agencies and officials; Indian Tribes; and other interested parties in order to consider and evaluate the impacts of this activity. Any comments received will be considered by the Corps of Engineers to determine whether to issue, modify, condition or deny a permit for this project. To make this decision, comments are used to assess impacts on endangered species, historic properties, water quality, general environmental effects, and the other public interest factors listed above. Comments are used in the preparation of an Environmental Assessment and/or an Environmental Impact Statement pursuant to the National Environmental Policy Act. Comments are also used to determine the need for a public hearing and to determine the overall public interest of the activity.

If there are any questions concerning this public notice, please contact Mary Hope Glenn at 843-329-8044 or toll free at 1-866-329-8187.

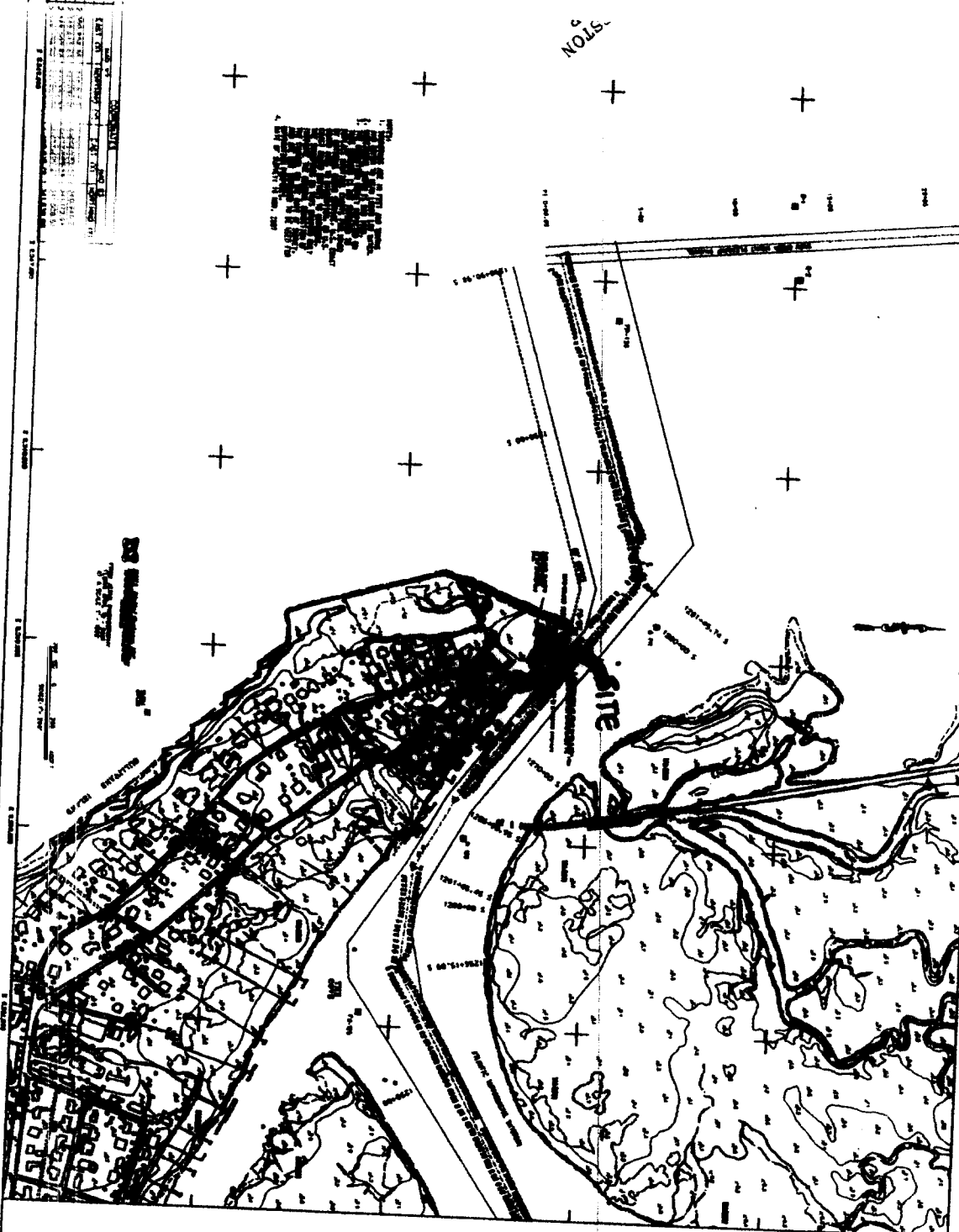

1221-075 TO 1220-075  
 0001  
 1221-075 TO 1220-075  
 0001

NO. 1	NO. 2	NO. 3	NO. 4	NO. 5	NO. 6	NO. 7	NO. 8	NO. 9	NO. 10

APPLICANT: THE POINT CO.  
 LOT D HAGERTY POINT  
 SULLIVANS ISLAND  
 CHARLESTON COUNTY  
 TMS# 523-08-00-078  
 INTRACOASTAL WATERWAY  
 SAC 2008-360-21G  
 FILE #263-96D

Sheet 1 of 3  
 PRIVATE  
 RECREATIONAL  
 DOCK  
 DATE: FEBRUARY 11, 2008  
 NO SCALE

EBB COVE INLET CL OF CHANNEL FLOOD

EDGE OF CHANNEL 45'

N341792.28 E2348990.05 N341784.45 E2349008.45

MEAN LOW WATER THE LINE

USACE VARIANCE LINE

PROP LINE 20'

PROP LINE 23'

80' O/S

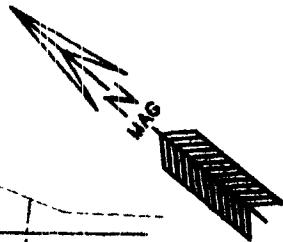

MHW

CONCRETE WALL & CRITICAL LINE

CONCRETE WALL

MERLE J. TYROLER TMS NO. 523-06-00-030

LOT F

LOT E

LOT D

LOT C

DOCK CONSISTS OF:  
4'x75' WALKWAY WITH HANDRAILS  
14'x16' COVERED PIERHEAD WITH BENCHES & FISH CLEANING STATION  
3'x16' RAMP TO 8'x20' FLOAT AND 12'x12' 4 POLE BOATLIFT

STAR OF THE WEST 30' R/W MIDDLE STREET 40' R/W

APPLICANT: THE POINT CO.  
LOT D HAGERTY POINT  
SULLIVANS ISLAND  
CHARLESTON COUNTY  
TMS# 523-06-00-078  
INTRACOASTAL WATERWAY

SAC 2008-360-21G

FILE #263-96D

Sheet 2 of 3

PRIVATE RECREATIONAL DOCK

REVISED: 4/23/08  
DATE: FEBRUARY 11, 2008  
SCALE: 1" = 60'



60 0 60

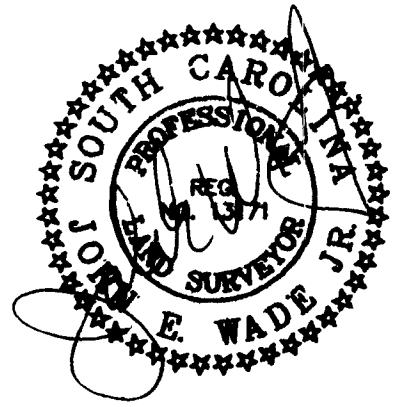

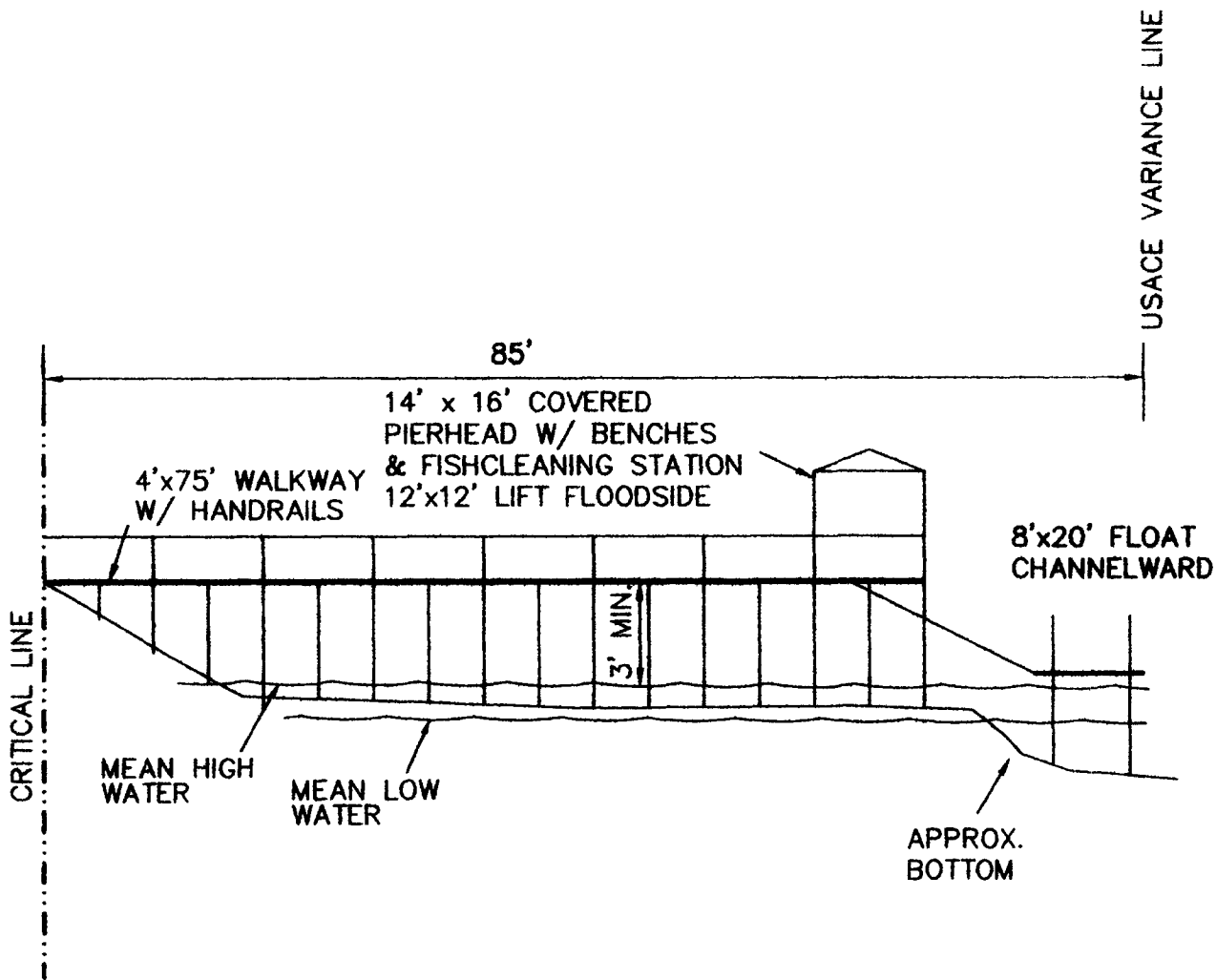

APPLICANT: THE POINT CO.  
LOT D HAGERTY POINT  
SULLIVANS ISLAND  
CHARLESTON COUNTY  
TMS# 523-06-00-078  
INTRACOASTAL WATERWAY

SAC 2008-360-2 IG

FILE #263-96D

Sheet 3 of 3

PRIVATE  
RECREATIONAL  
DOCK

DATE: FEBRUARY 11, 2008  
NO SCALE

