

JOINT
PUBLIC NOTICE

CHARLESTON DISTRICT, CORPS OF ENGINEERS
1949 Industrial Park Road, Room 140
Conway, South Carolina 29526

and

THE S.C. DEPARTMENT OF HEALTH AND ENVIRONMENTAL CONTROL
Office of Ocean and Coastal Resource Management
1362 McMillan Avenue, Suite 400
Charleston, South Carolina 29405

REGULATORY DIVISION

Refer to: P/N # 1997-11142-3IB REVISED (fka 1997-1E-130)

January 18, 2008

Pursuant to Section 10 of the Rivers and Harbors Act of 1899 (33 U.S.C. 403), and the South Carolina Coastal Zone Management Act (48-39-10 et. seq.) a letter has been submitted to the Department of the Army and the South Carolina Department of Health and Environmental Control by

**CRYSTAL POINTE HOA
C/O BEAM & ASSOCIATES
PO BOX 11863
COLUMBIA, SOUTH CAROLINA 29211-1863**

for a permit to construct a docking facility in the

ATLANTIC INTRACOASTAL WATERWAY

located at the end of Landing Road, Little River, Horry County, South Carolina (Latitude: 33.8650°N; Longitude 78.6192°W).

In order to give all interested parties an opportunity to express their views

NOTICE

is hereby given that written statements regarding the proposed work will be received by both of the above mentioned offices until

12 O'CLOCK NOON, MONDAY, FEBRUARY 4, 2008

from those interested in the activity and whose interests may be affected by the proposed work.

The proposed work consists of modifying an existing docking facility. A public notice was originally published on June 29, 2007 as PN # 1997-1E-130. After an on-site inspection it was determined that the existing structure was out of compliance with the specifications that were originally permitted. Therefore after-the-fact authorization is required for the non-compliant portions of the structure, as well as new authorization for the proposed modifications to the structure. The existing structure was authorized to be constructed with the following dimensions: a 5' wide walkway leading to a 10' x 25' fixed pierhead, attached to a 10' x 16' floating dock by a 3' x 12' hinged ramp. The most waterward edge of the structure was required to be at least 200' from the centerline of the AIWW. The existing structure actually consists of a 141' walkway that varies in width from 4' to 7.5', leading to a 27' x 16' fixed pierhead, attached to a 10' x 16' floating dock and a 9' x 5' floating jet-ski dock by a 4' x 24' hinged ramp. The proposed new addition consists of a 5' x 170' wooden walkway extending

REGULATORY DIVISION

Refer to: P/N # 1997-11142-3IB REVISED (fka 1997-1E-130)

January 18, 2008

perpendicular to the existing walkway. Ten 12' x 20' boat lifts will be attached to the walkway by five 3' x 20' walkways. The most waterward edge of the structure will remain at least 200' from the centerline of the AIWW. The purpose of the docking facility is for joint private recreational use.

NOTE: Plans depicting the work described in this notice are available and will be provided, upon receipt of a written request, to anyone that is interested in obtaining a copy of the plans for the specific project. The request must identify the project of interest by public notice number and a self-addressed stamped envelope must also be provided for mailing the drawings to you. Your request for drawings should be addressed to the

**U.S. Army Corps of Engineers
ATTN: REGULATORY DIVISION
1949 Industrial Park Road, Room 140
Conway, South Carolina 29526**

The work shown on this application must also be certified as consistent with applicable provisions of the Coastal Zone Management Program (15 CFR 930). The District Engineer will not process this application to a conclusion until such certification is received. The applicant is hereby advised that supplemental information may be required by the State to facilitate the review. Persons wishing to comment or object to State certification must submit all comments in writing to the South Carolina Department of Health and Environmental Control at the above address within thirty (15) days of the date of this notice.

This initiates the Essential Fish Habitat (EFH) consultation requirements of the Magnuson-Stevens Fishery Conservation and Management Act. Implementation of the proposed project would impact approximately 0.13 acre of estuarine substrates and emergent wetlands utilized by various life stages of species comprising the red drum, shrimp, and snapper-grouper management complexes. Our initial determination is that the proposed action would not have a substantial individual or cumulative adverse impact on EFH or fisheries managed by the South Atlantic Fishery Management Council and the National Marine Fisheries Service (NMFS). Our final determination relative to project impacts and the need for mitigation measures is subject to review by and coordination with the NMFS.

The District Engineer has consulted the most recently available information and has determined that the project will have no effect on any Federally endangered, threatened, or proposed species and will not result in the destruction or adverse modification of designated or proposed critical habitat. This public notice serves as a request to the U.S. Fish and Wildlife Service and the National Marine Fisheries Service for any additional information they may have on whether any listed or proposed endangered or threatened species or designated or proposed critical habitat may be present in the area which would be affected by the activity, pursuant to Section 7(c) of the Endangered Species Act of 1973 (as amended).

Pursuant to Section 106 of the National Historic Preservation Act (NHPA), this public notice also constitutes a request to Indian Tribes to notify the District Engineer of any historic properties of religious and cultural significance to them that may be affected by the proposed undertaking.

In accordance with the NHPA, the District Engineer has also consulted the latest published version of the National Register of Historic Places for the presence or absence of registered properties, or properties listed as being eligible for inclusion therein, and this worksite is not included as a registered property or property listed as being eligible for inclusion in the Register. To insure that other cultural resources that the District Engineer is not aware of are not overlooked, this public notice also serves as a request to the State Historic Preservation Office to provide any information it may have with regard to historic and cultural resources.

Any person may request, in writing, within the comment period specified in this notice, that a public hearing be held to consider this application. Requests for a public hearing shall state, with particularity, the reasons for holding a public hearing.

The decision whether to issue a permit will be based on an evaluation of the probable impact including cumulative impacts of the activity on the public interest. That decision will reflect the national concern for both protection and utilization of important resources. The benefit which reasonably may be expected to accrue from the project must be balanced against its reasonably foreseeable detriments. All factors which may be relevant to the project will be considered including the cumulative effects thereof; among those are conservation, economics, aesthetics, general environmental concerns, wetlands, historic properties, fish and wildlife values, flood hazards, flood plain values, land use, navigation, shoreline erosion and accretion, recreation, water supply and conservation, water quality, energy needs, safety, food and fiber production and, in general, the needs and welfare of the people. A permit will be granted unless the District Engineer determines that it would be contrary to the public interest. In cases of conflicting property rights, the Corps of Engineers cannot undertake to adjudicate rival claims.

The Corps of Engineers is soliciting comments from the public; Federal, state, and local agencies and officials; Indian Tribes; and other interested parties in order to consider and evaluate the impacts of this activity. Any comments received will be considered by the Corps of Engineers to determine whether to issue, modify, condition or deny a permit for this project. To make this decision, comments are used to assess impacts on endangered species, historic properties, water quality, general environmental effects, and the other public interest factors listed above. Comments are used in the preparation of an Environmental Assessment and/or an Environmental Impact Statement pursuant to the National Environmental Policy Act. Comments are also used to determine the need for a public hearing and to determine the overall public interest of the activity.

If there are any questions concerning this public notice, please contact Wiley Bracey at 843-365-1707.

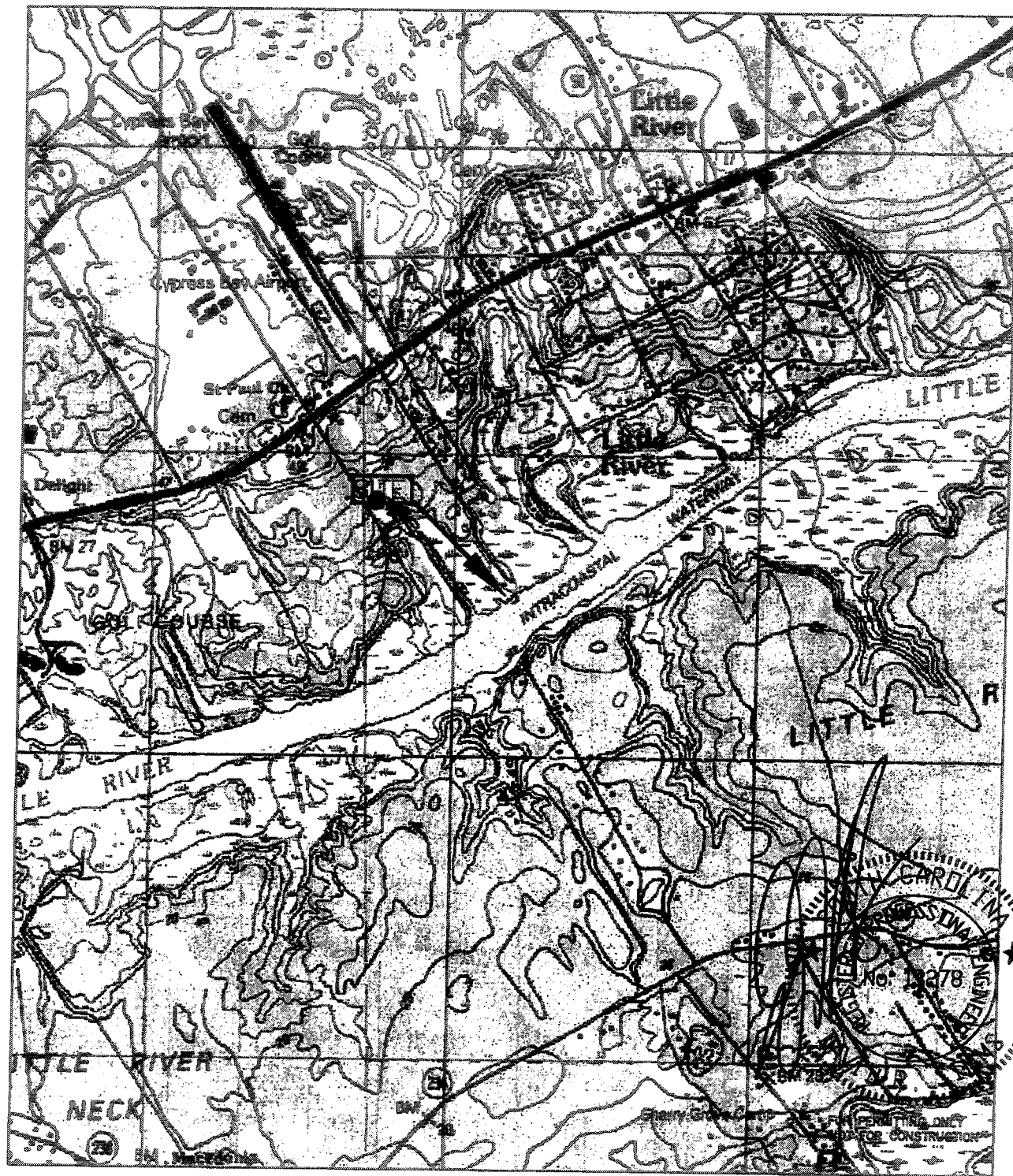

LOCATION MAP

WAMPEE QUADRANGLE
USGS 7.5 MINUTE SERIES
1:24,000

APPLICANT: CRYSTAL POINTE HOA

LOCATION: Little River Township

ACTIVITY: PERMIT MODIFICATION
ADD WALKWAY/BOAT LIFTS

INTRACOASTAL WATERWAY

P/N# 97-1E-130

COUNTY: Horry

DATE: 5/3/2007

SHEET 1 OF 4

NAD 83 STATE PLANE COORDINATES

	EAST	NORTH
POINT A	2722400.90	747394.93
POINT B	2722493.38	747456.31

- 27 ft. X 16.67 ft. Pier Head
- 4 ft. X 24 ft. Ramp
- 16 ft. X 10.5 ft. Float
- 9 ft. X 5 ft. Jet Ski Float
- 141.67 ft. Wooden Walkway
(See details below)

USACOE MONUMENT
STA. 259+83.35
349.92' O/S

USACOE MONUMENT
STA. 259+83.35
249.98' O/S

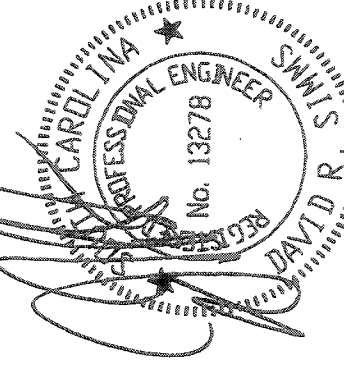
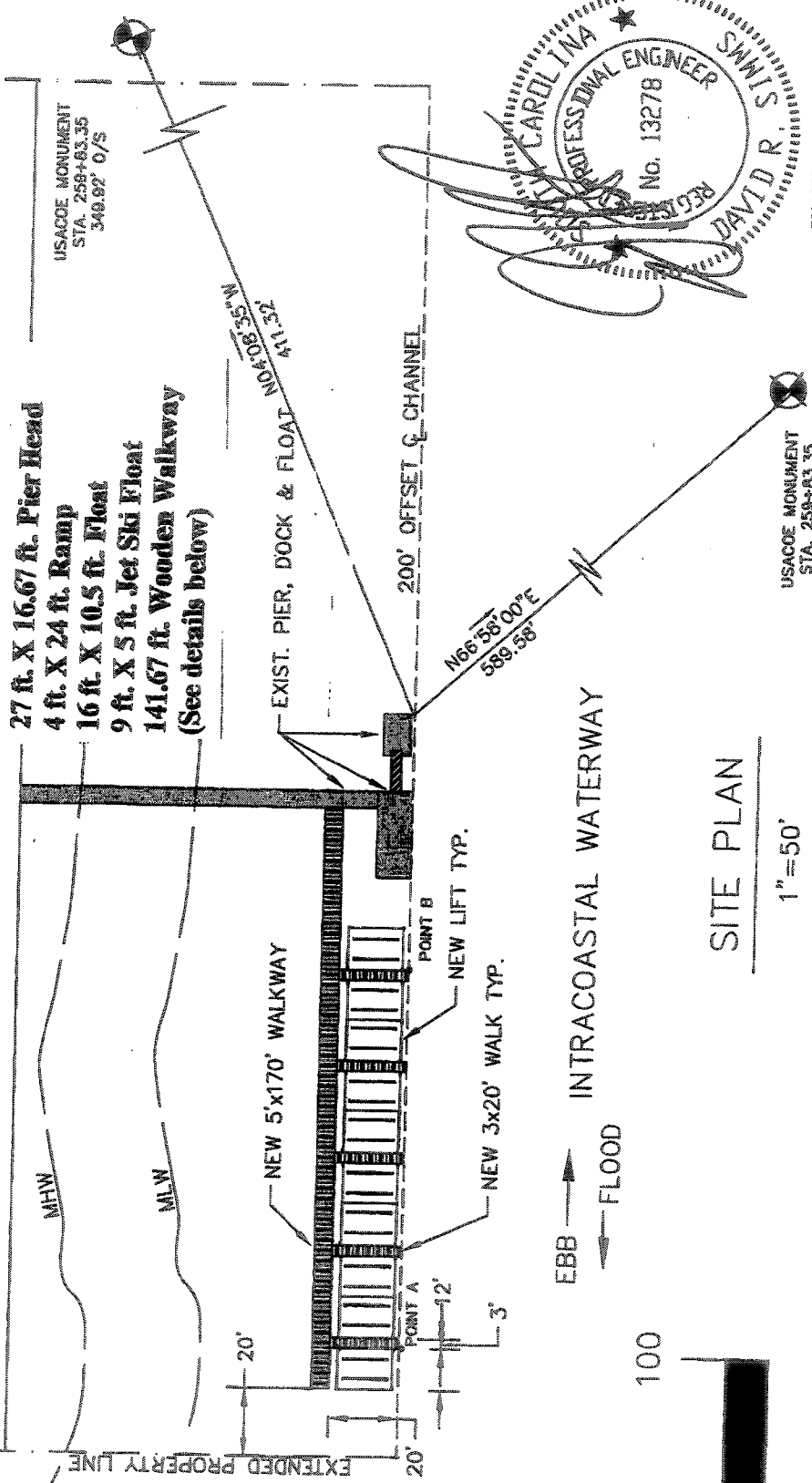

FOR PERMITTING ONLY
NOT FOR CONSTRUCTION

SITE PLAN

1" = 50'

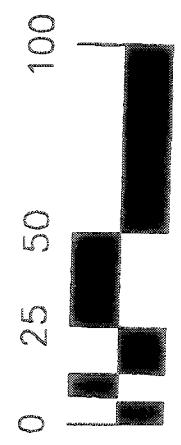
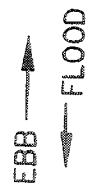

1" = 50'

<p>APPLICANT: CRYSTAL POINTE HOA</p> <p>ACTIVITY: PERMIT MODIFICATION ADD WALKWAY/BOAT LIFTS</p> <p>P/N# 1997-11142-31B (fka 97-1E-130)</p>	<p>LOCATION: Little River Township -- AICWW</p> <p>COUNTY: Horry</p> <p>DATE: 5/3/2007</p>	<p>Details of 141.67 ft. Wooden Walkway Measured from Uplands: First 44 ft is 4.34 Ft in Width Next 28.67 ft. is 6.5 ft. in Width Last 69 ft. is 7.5 ft. in Width</p>
---	--	---

NOTE: NO GUARD RAIL ON WALKOUTS
2X10 RAIL CAP

BOAT LIFT SIDE

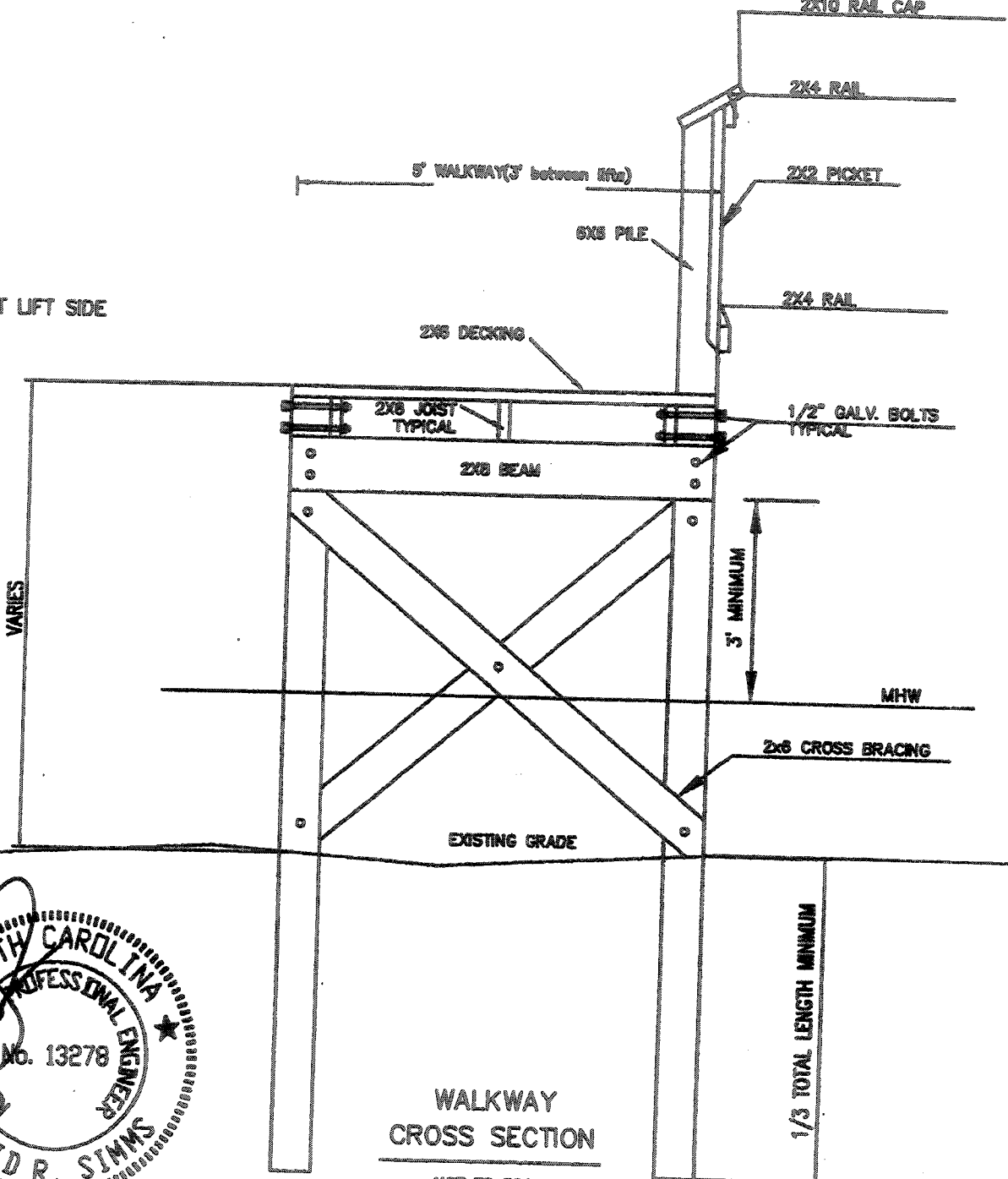

WALKWAY
CROSS SECTION

NOT TO SCALE

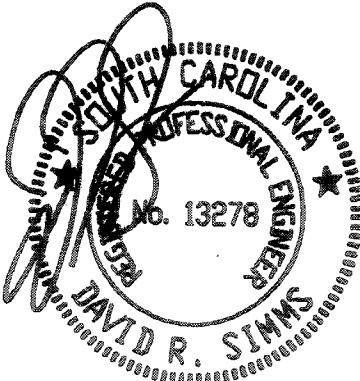

FOR PERMITTING ONLY
NOT FOR CONSTRUCTION

<p>APPLICANT: CRYSTAL POINTE HOA</p> <p>ACTIVITY: PERMIT MODIFICATION ADD WALKWAY/BOAT LIFTS</p> <p>P/N# 97-1E-130-</p>	<p>LOCATION: Little River Township - AICWW</p> <p>COUNTY: HORRY</p> <p>DATE: 5/3/2007</p>	<p>SHEET 3 of 4</p>
---	---	---------------------

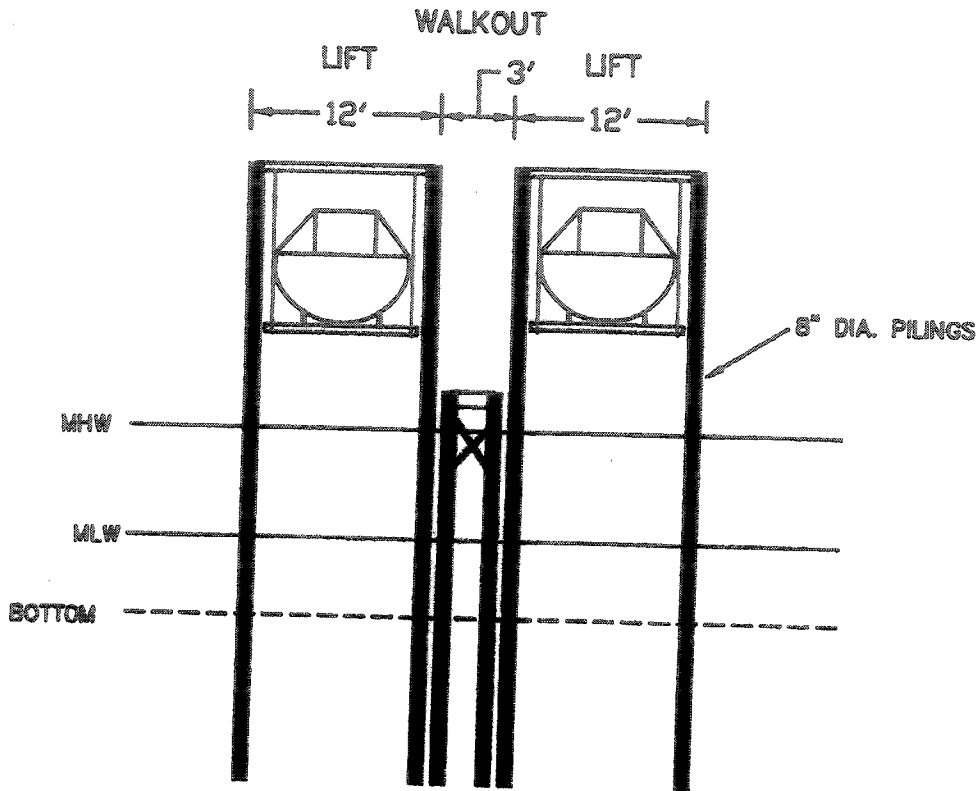

SECTION - LIFT / WALKOUT
NTS

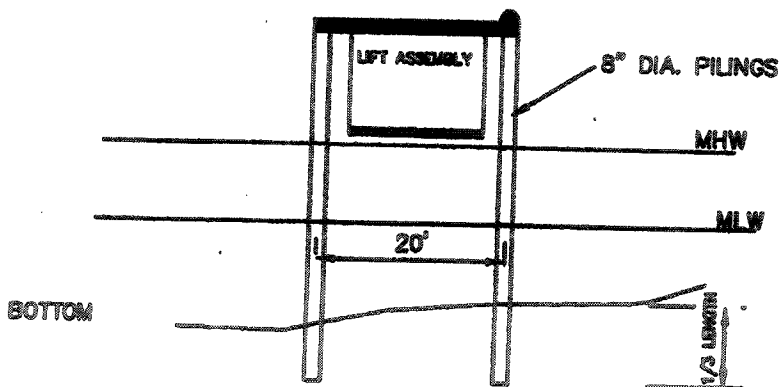

SECTION - BOAT LIFT
NTS

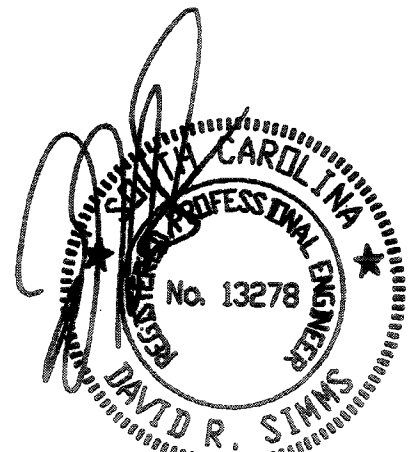

FOR PERMITTING ONLY
NOT FOR CONSTRUCTION

APPLICANT:
CRYSTAL POINTE HOA
ACTIVITY:
PERMIT MODIFICATION
ADD WALKWAY/BOAT LIFTS
97-1E-130-

LOCATION: Little River
Township - AICWW

COUNTY: HORRY
DATE: 5/3/2007