



REPLY TO
ATTENTION OF

DEPARTMENT OF THE ARMY
CHARLESTON DISTRICT, CORPS OF ENGINEERS
69-A Hagood Avenue
CHARLESTON, SOUTH CAROLINA 29403-5107

REGULATORY DIVISION

Refer to: P/N SAC 2007-1724-2IV (Modified)

November 30, 2007

BILL McKENZIE
DANIEL ISLAND ASSOCIATES
230 SEVEN FARMS DRIVE, SUITE 201
CHARLESTON, SOUTH CAROLINA 29401

To construct a pier and floating dock in the Wando River, Berkeley County, South Carolina.

Following the public notice for this project the applicant has made modifications to the originally proposed project. The modifications include increasing the length of the fixed timber walkway to be 4' x 142' (originally noticed as 4' x 125'), which will move the floating dock and pier head further channel ward. Additionally, two (2) 10' x 12' boat lifts have been proposed, one associated with each proposed floating dock, which will be located landward of the proposed floating docks. The attached drawings represent the revisions requested by the applicant.

In order to give all interested parties an opportunity to express their views

NOTICE

is hereby given that written statements regarding the proposed work will be received by both of the above mentioned offices until

12 O'CLOCK NOON, MONDAY, DECEMBER 17, 2007

All other information regarding the public notice remains the same. If there are any questions concerning this public notice, please contact Robert Vega at 843-329-8044 or toll free at 1-866-329-8187.

Daniel Island Associates Dock
 Lot 0-15 and 0-16
 SAC 2007-1724-2IV
 July 31, 2007
 Sheet 1 - 7

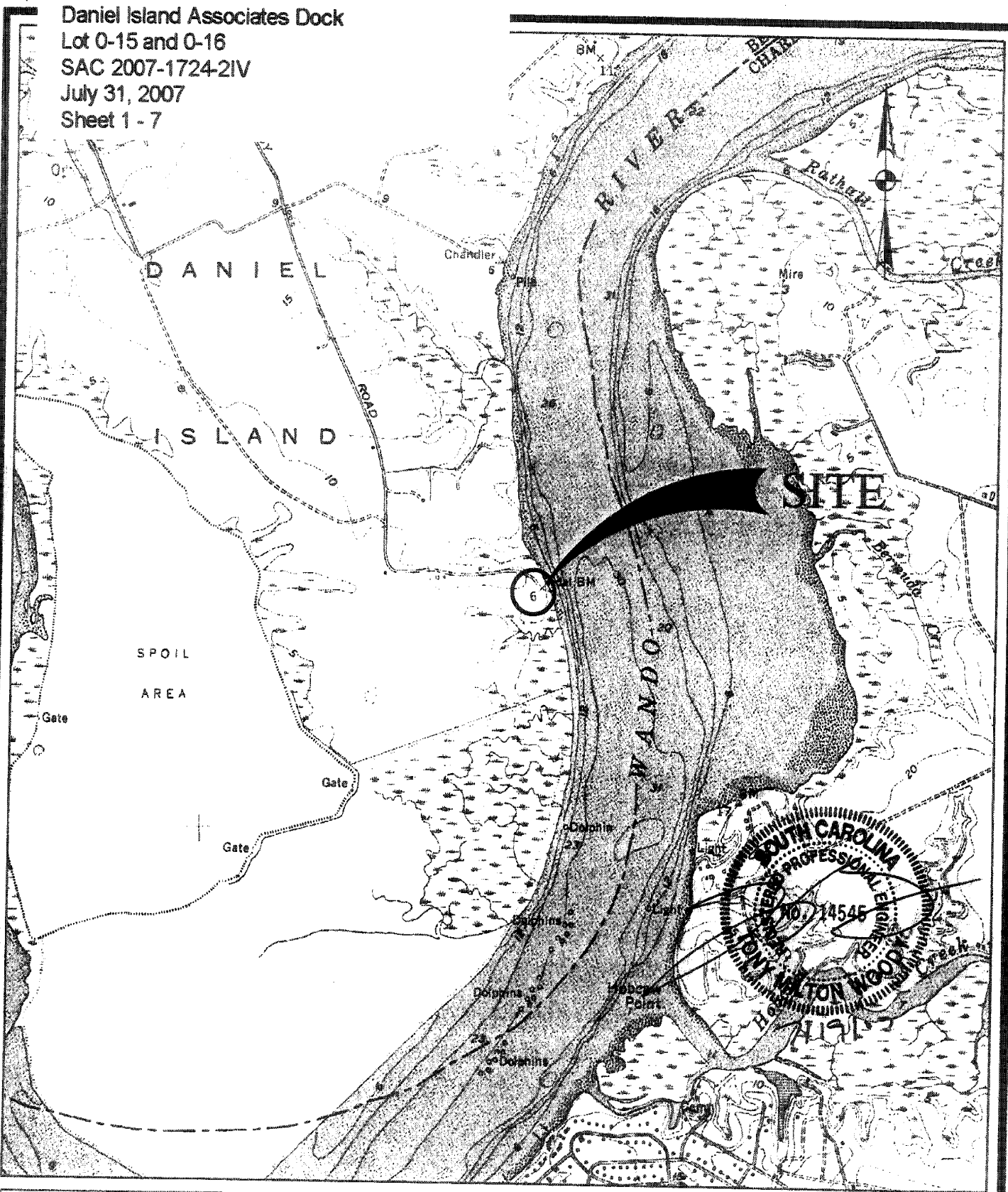

CHARLESTON
 QUAD MAP

SCALE: 1" = 2000'
 0 1000 2000



PROJECT: CONSTRUCT PRIVATE DOCK
 COUNTY: BERKELEY
 LOCATION: LOT 0-15-16 SMYTHE ST.
 DANIEL ISLAND, SC
 APPLICANT: DANIEL ISLAND ASSOCIATES

APRIL 2007

SHEET 1 OF 7

SOUTH CAROLINA
 PROFESSIONAL ENGINEER
 No. 714545
 TONY WOODRUFF

Daniel Island Associates Dock
Lot 0-15 and 0-16
SAC 2007-1724-2IV
July 31, 2007
Sheet 2 - 7

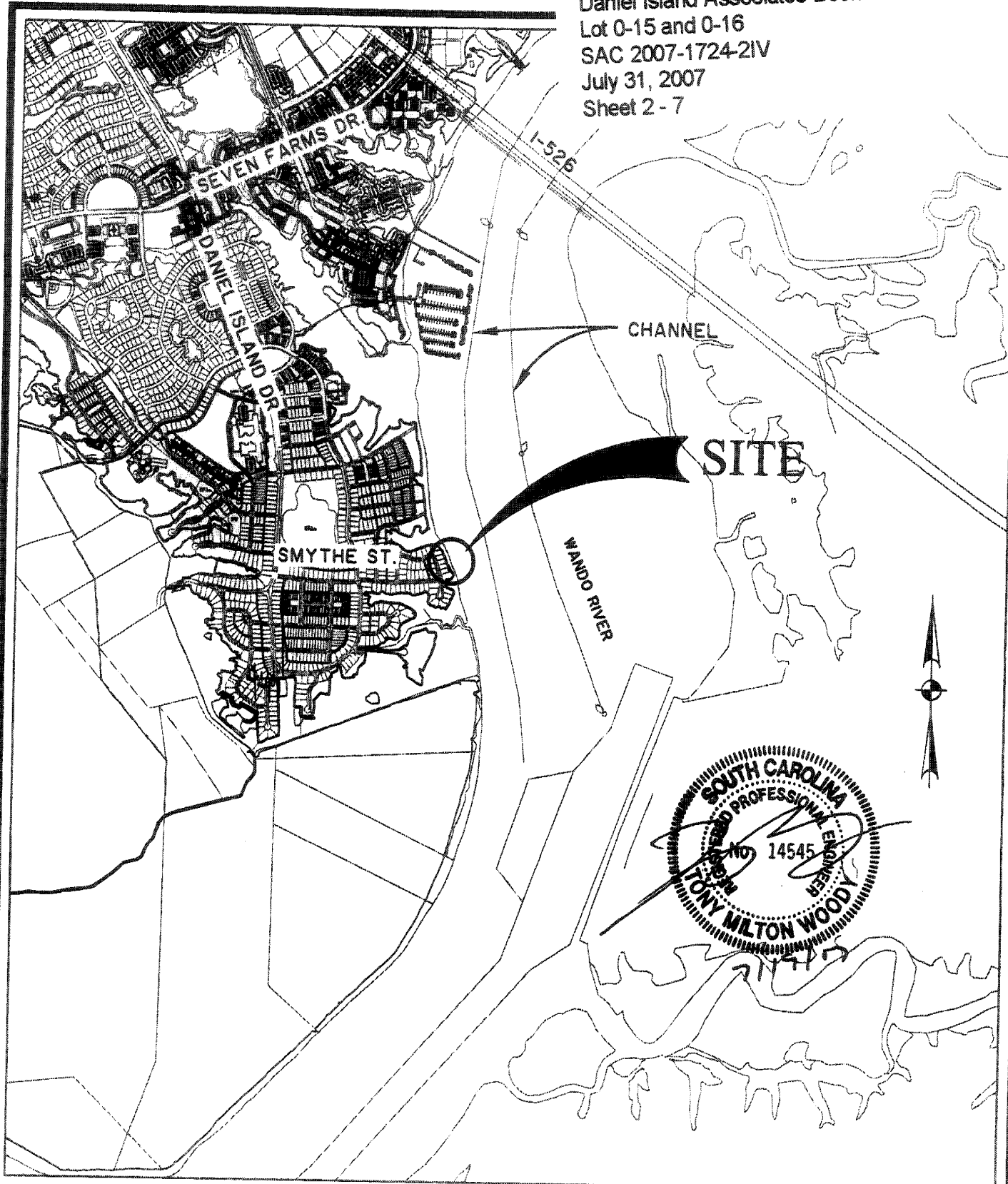

PARCEL Z PHASE 5
AT DANIEL ISLAND
LOCATION MAP

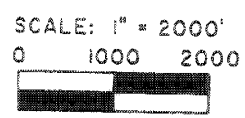

PROJECT: CONSTRUCT PRIVATE DOCK
COUNTY: BERKELEY
LOCATION: LOT 0-15-16 SMYTHE ST.
DANIEL ISLAND, SC
APPLICANT: DANIEL ISLAND ASSOCIATES

APRIL 2007

SHEET 2 OF 7

Daniel Island Associates Dock
Lot 0-15 and 0-16
SAC 2007-1724-2IV
July 31, 2007
Sheet 3 - 7

CHANNEL

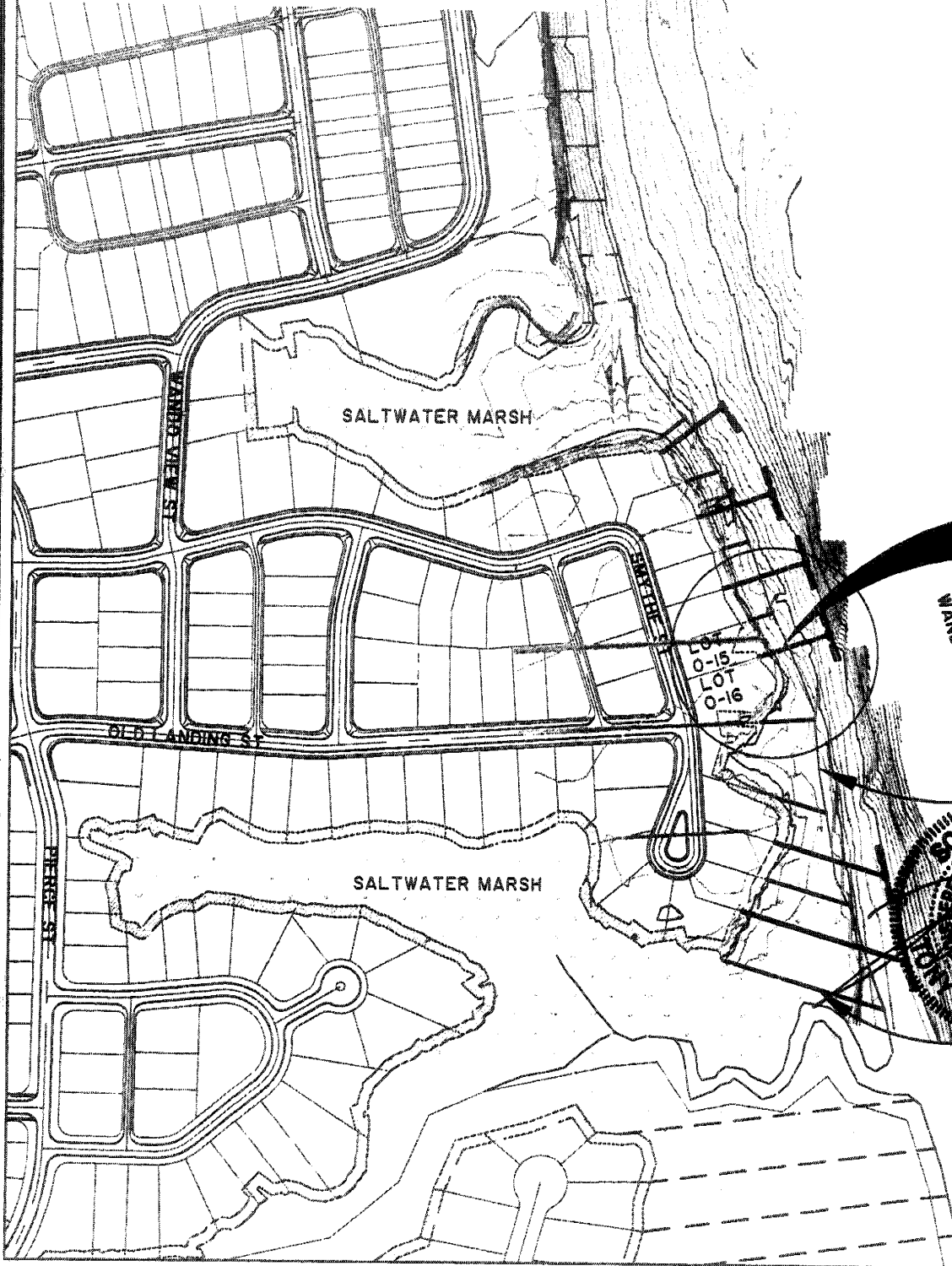

SITE

WANDA RIVER

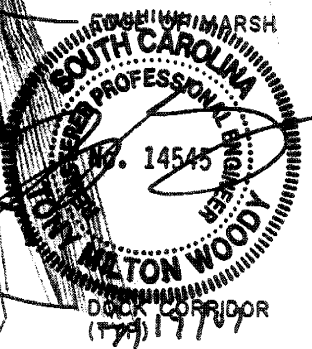

PARCEL Z PHASE 5
AT DANIEL ISLAND
LOCATION MAP

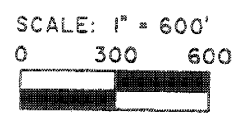

PROJECT: CONSTRUCT PRIVATE DOCK
COUNTY: BERKELEY
LOCATION: LOT 0-15-16 SMYTHE ST
DANIEL ISLAND, SC
APPLICANT: DANIEL ISLAND ASSOCIATES

APRIL 2007

SHEET 3 OF 7

Daniel Island Associates Docks
 Lot 0-15 and Lot 0-16
 SAC 2007-1724-2IV
 July 31, 2007
 Sheet 4-7

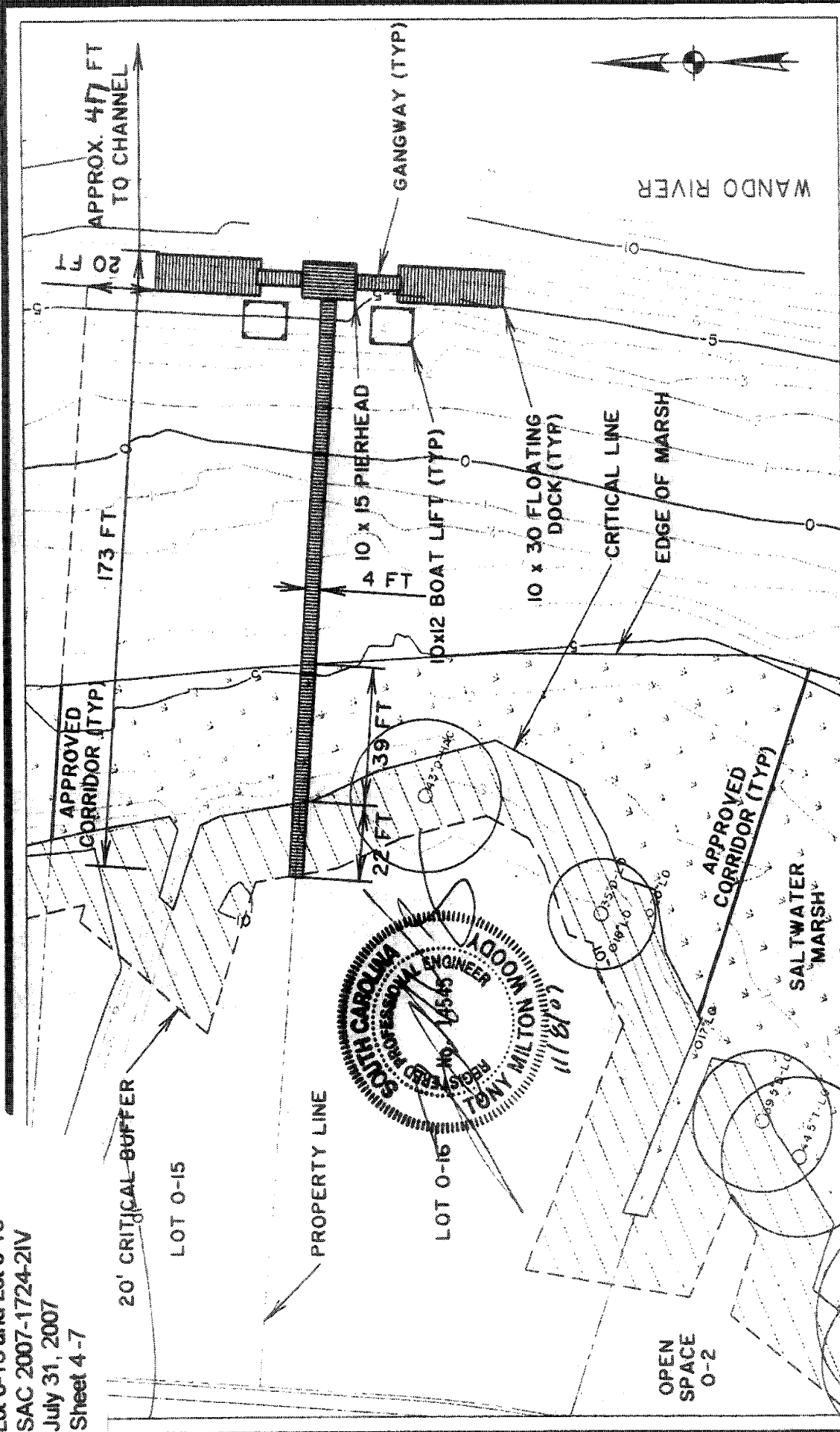

PARCEL Z PHASE 5
 AT DANIEL ISLAND
 PLAN VIEW

APRIL 2007
 REVISED: NOVEMBER 7, 2007

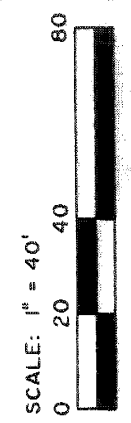

SHEET 4 OF 7

PROJECT: CONSTRUCT PRIVATE DOCK
 COUNTY: BERKELEY
 LOCATION: LOT 0-15-16 SMYTHE ST
 DANIEL ISLAND, SC
 APPLICANT: DANIEL ISLAND ASSOCIATES

Daniel Island Associates Docks
 Lot 0-15 and Lot 0-16
 SAC 2007-1724-2IV
 July 31, 2007
 Sheet 5-7

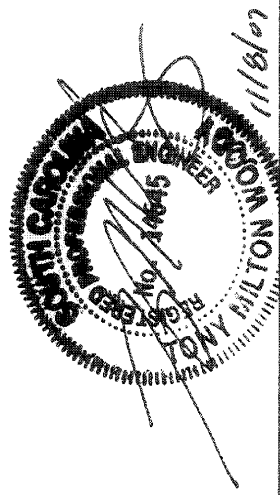
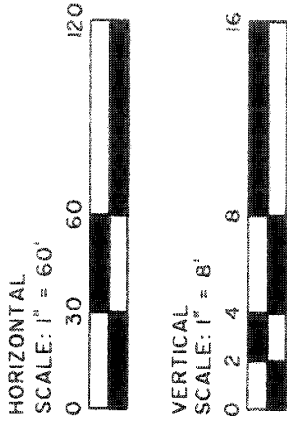
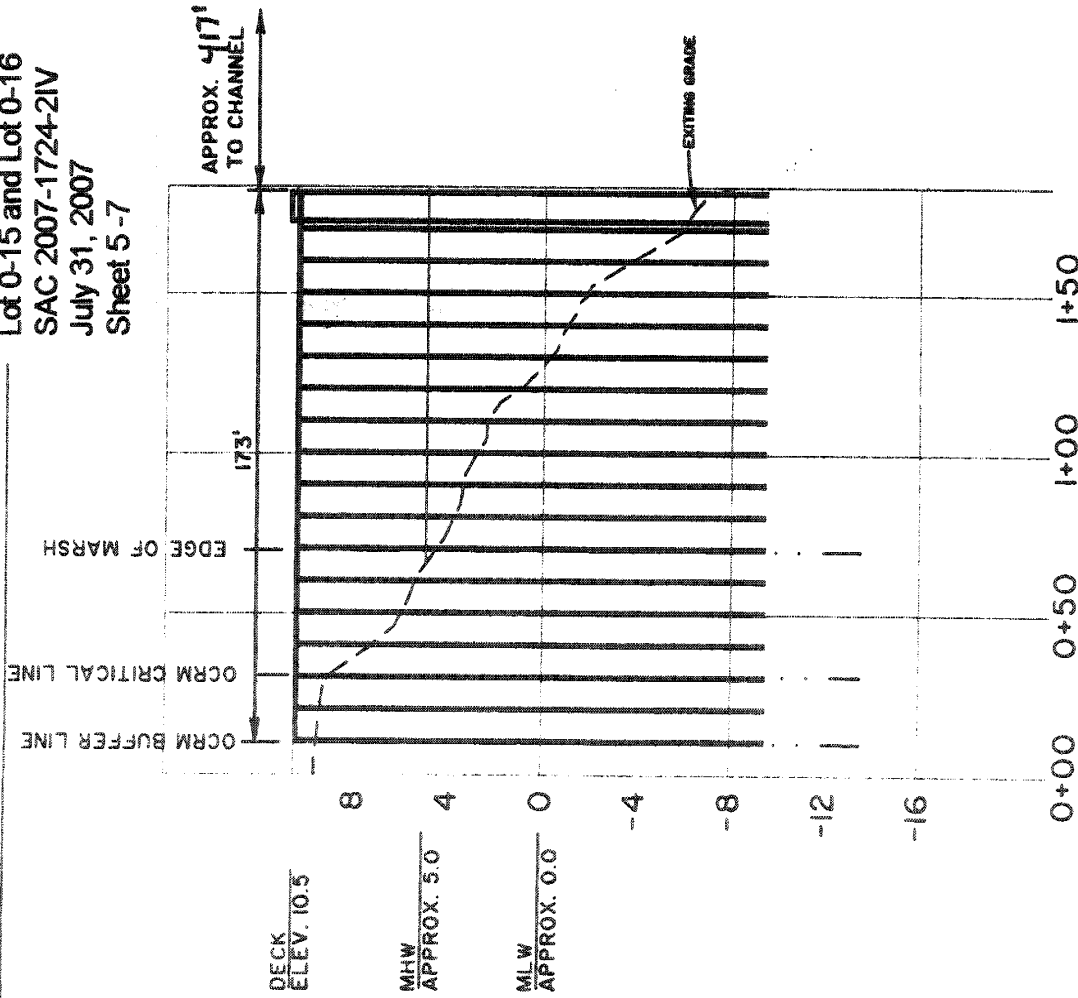

**PARCEL Z PHASE 5
 AT DANIEL ISLAND
 PROFILE**

APRIL 2007
 REVISED: NOVEMBER 7, 2007

PROJECT: CONSTRUCT PRIVATE DOCK
 COUNTY: BERKELEY
 LOCATION: LOT 0-15-16 SMITHE ST.
 DANIEL ISLAND, SC
 APPLICANT: DANIEL ISLAND ASSOCIATES

SHEET 5 OF 7

Daniel Island Associates Dock
 Lot 0-15 and 0-16
 SAC 2007-1724-2IV
 July 31, 2007
 Sheet 6 - 7

LONGITUDINAL BRACING
 TO BE LOCATED BETWEEN
 PILES AS INDICATED (TYP)

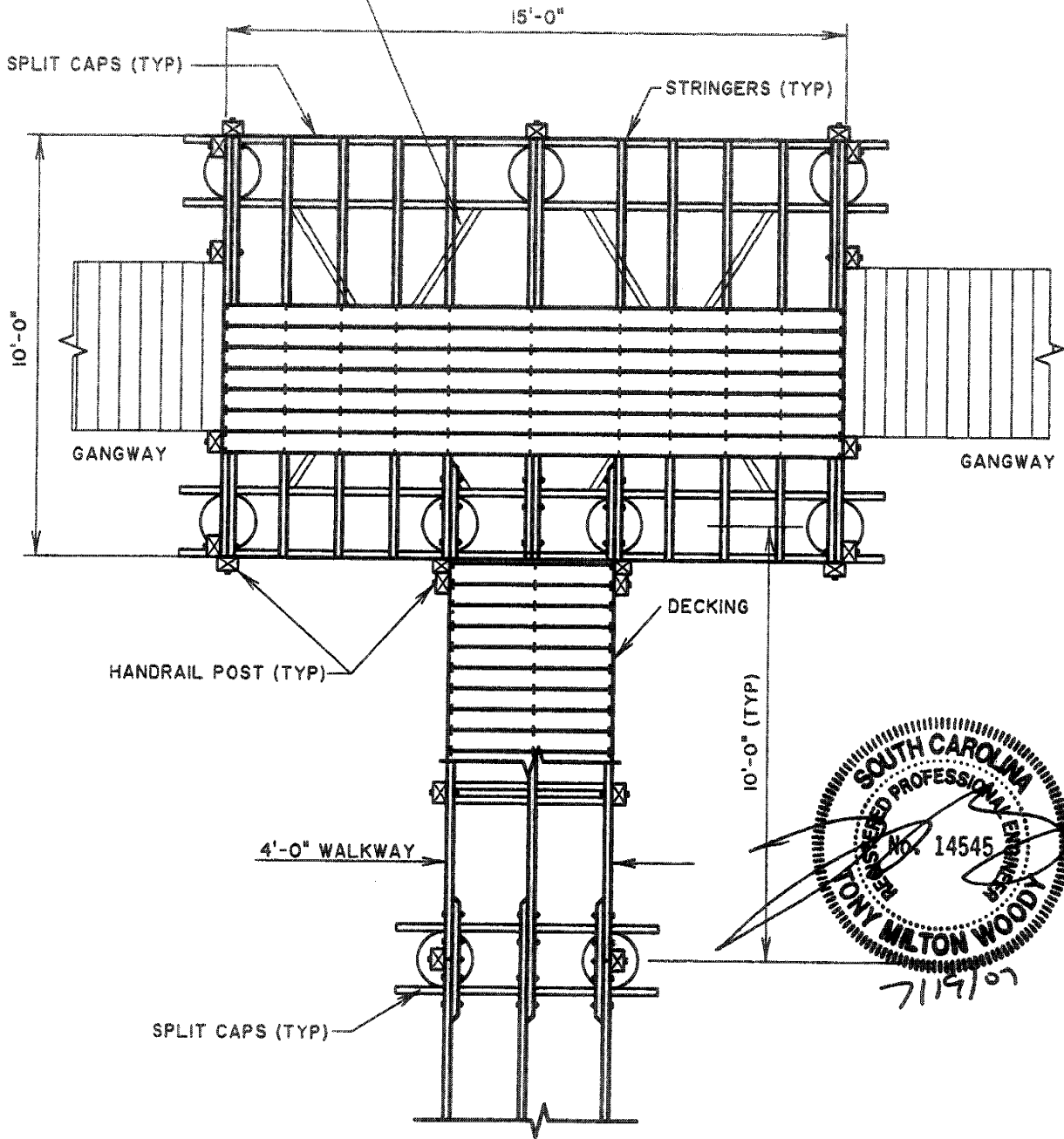

**PARCEL Z PHASE 5
 AT DANIEL ISLAND
 10' X 15' PIERHEAD PLAN**

APRIL 2007

SHEET 6 OF 7

PROJECT: CONSTRUCT PRIVATE DOCK
 COUNTY: BERKELEY
 LOCATION: LOT 0-15-16 SMYTHE ST
 DANIEL ISLAND, SC
 APPLICANT: DANIEL ISLAND ASSOCIATES

Daniel Island Associates Dock
 Lot 0-15 and 0-16
 SAC 2007-1724-2IV
 July 31, 2007
 Sheet 7 - 7

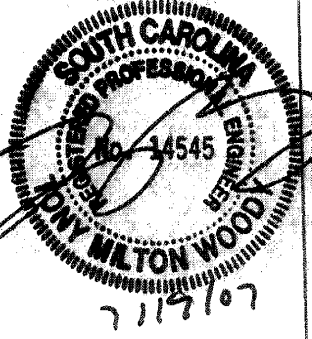
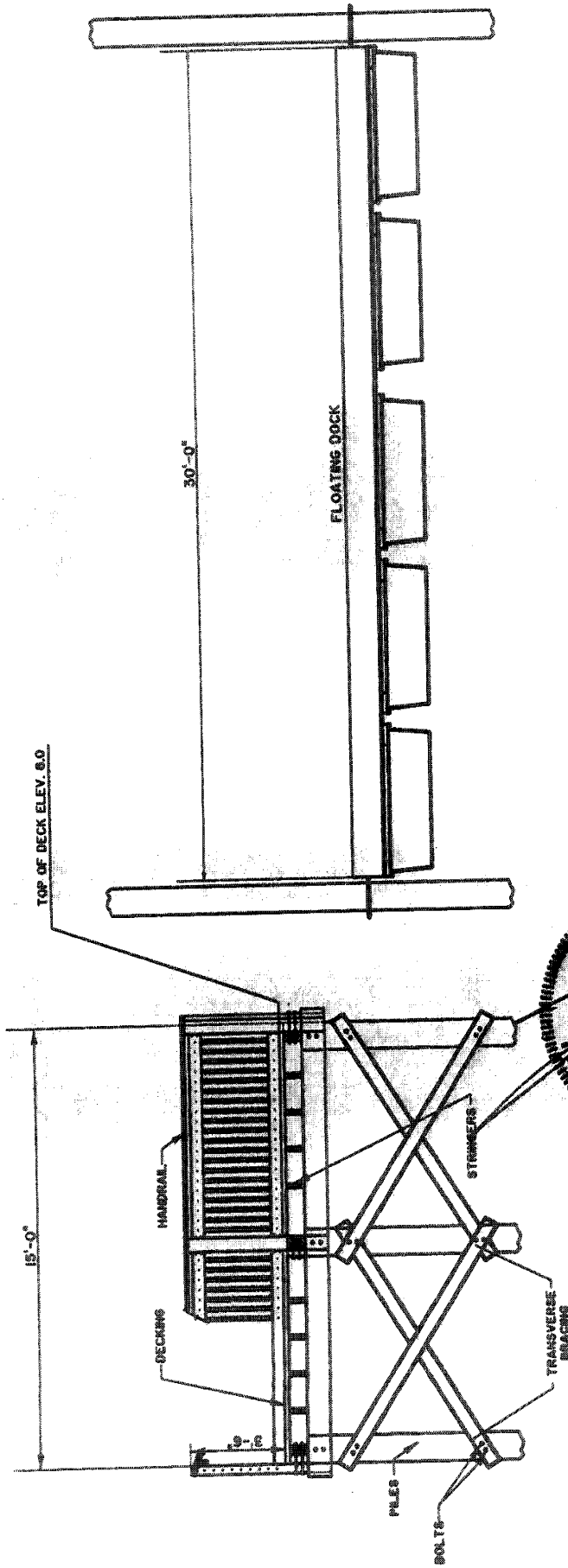

CROSS SECTION
 PIER HEAD AND FLOATING DOCK SECTION

PROJECT: CONSTRUCT PRIVATE DOCK
 COUNTY: BERKELEY
 LOCATION: LOT 0-15-16 SMYTHE ST
 DANIEL ISLAND
 APPLICANT: DANIEL ISLAND ASSOCIATES

SHEET 7 OF 7

APRIL 2007