



REPLY TO  
ATTENTION OF

**DEPARTMENT OF THE ARMY**  
CHARLESTON DISTRICT, CORPS OF ENGINEERS  
69-A Hagood Avenue  
CHARLESTON, SOUTH CAROLINA 29403-5107

REGULATORY DIVISION

Refer to: P/N SAC 2007-1723-2IV (Modified)

November 30, 2007

**BILL McKENZIE**  
**DANIEL ISLAND ASSOCIATES**  
**230 SEVEN FARMS DRIVE, SUITE 201**  
**CHARLESTON, SOUTH CAROLINA 29401**

To construct a pier and floating dock in the Wando River, Berkeley County, South Carolina.

Following the public notice for this project the applicant has made modifications to the originally proposed project. The modifications include increasing the size of the fixed timber walkway to be 4' x 160' (originally noticed as 4' x 137'), which will move the floating dock and pier head further channel ward. Additionally, two (2) 10' x 12' boat lift has been proposed, one associated with each proposed floating dock, which are located landward of the floating docks. The attached drawings represent the revisions requested by the applicant.

In order to give all interested parties an opportunity to express their views

**NOTICE**

is hereby given that written statements regarding the proposed work will be received by both of the above mentioned offices until

**12 O'CLOCK NOON, MONDAY, DECEMBER 17, 2007**

All other information regarding the public notice remains the same. If there are any questions concerning this public notice, please contact Robert Vega at 843-329-8044 or toll free at 1-866-329-8187.

Daniel Island Associates Dock  
 Lot 0-13 and 0-14  
 SAC 2007-1723-2IV  
 July 31, 2007  
 Sheet 1 - 7

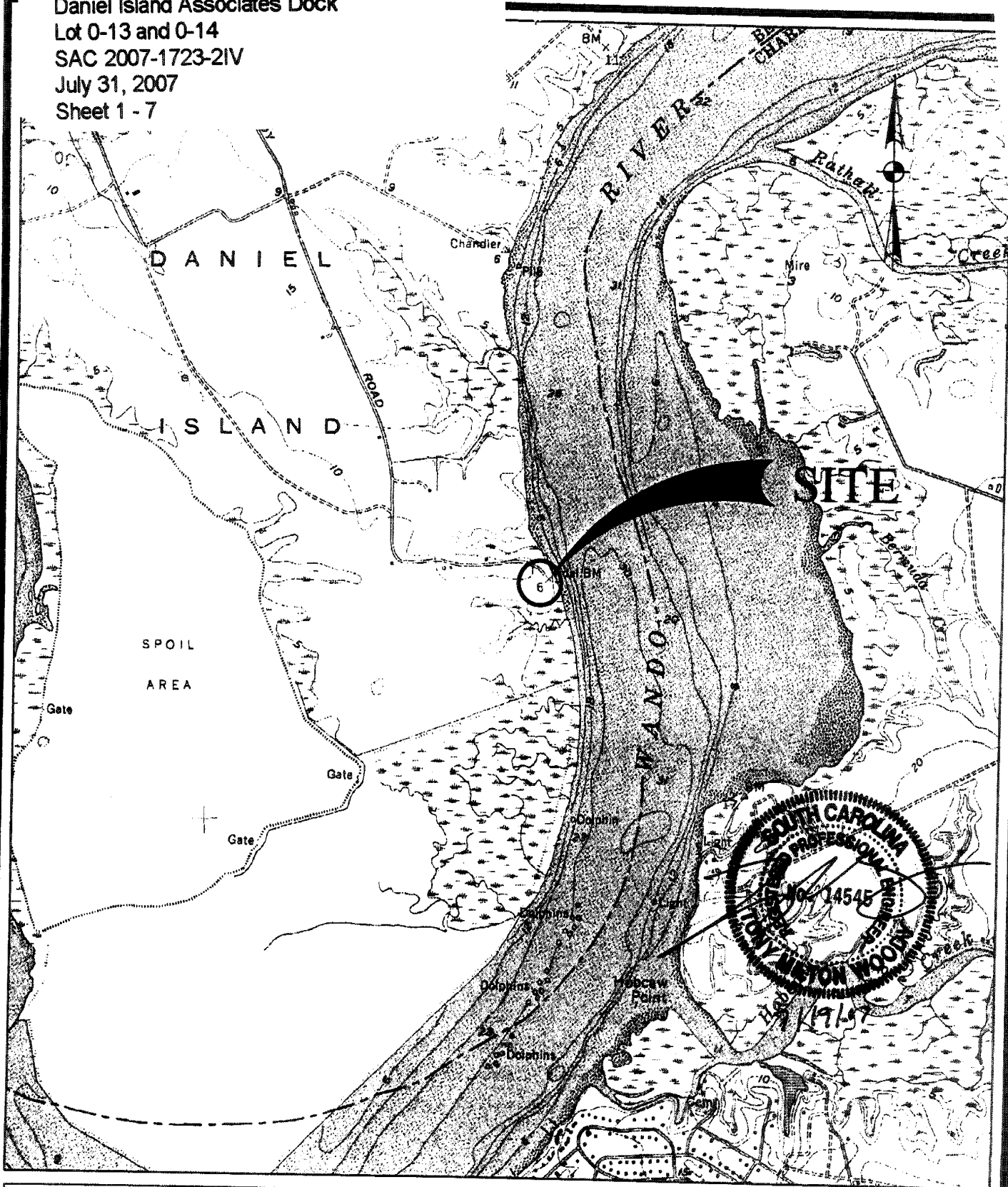

CHARLESTON  
 QUAD MAP

SCALE: 1" = 2000'  
 0 1000 2000



PROJECT: CONSTRUCT PRIVATE DOCK  
 COUNTY: BERKELEY  
 LOCATION: LOT 0-13-14 SMYTHE ST.  
 DANIEL ISLAND, SC  
 APPLICANT: DANIEL ISLAND ASSOCIATES

APRIL 2007

SHEET 1 OF 7

Daniel Island Associates Dock  
Lot 0-13 and 0-14  
SAC 2007-1723-2IV  
July 31, 2007  
Sheet 2 - 7

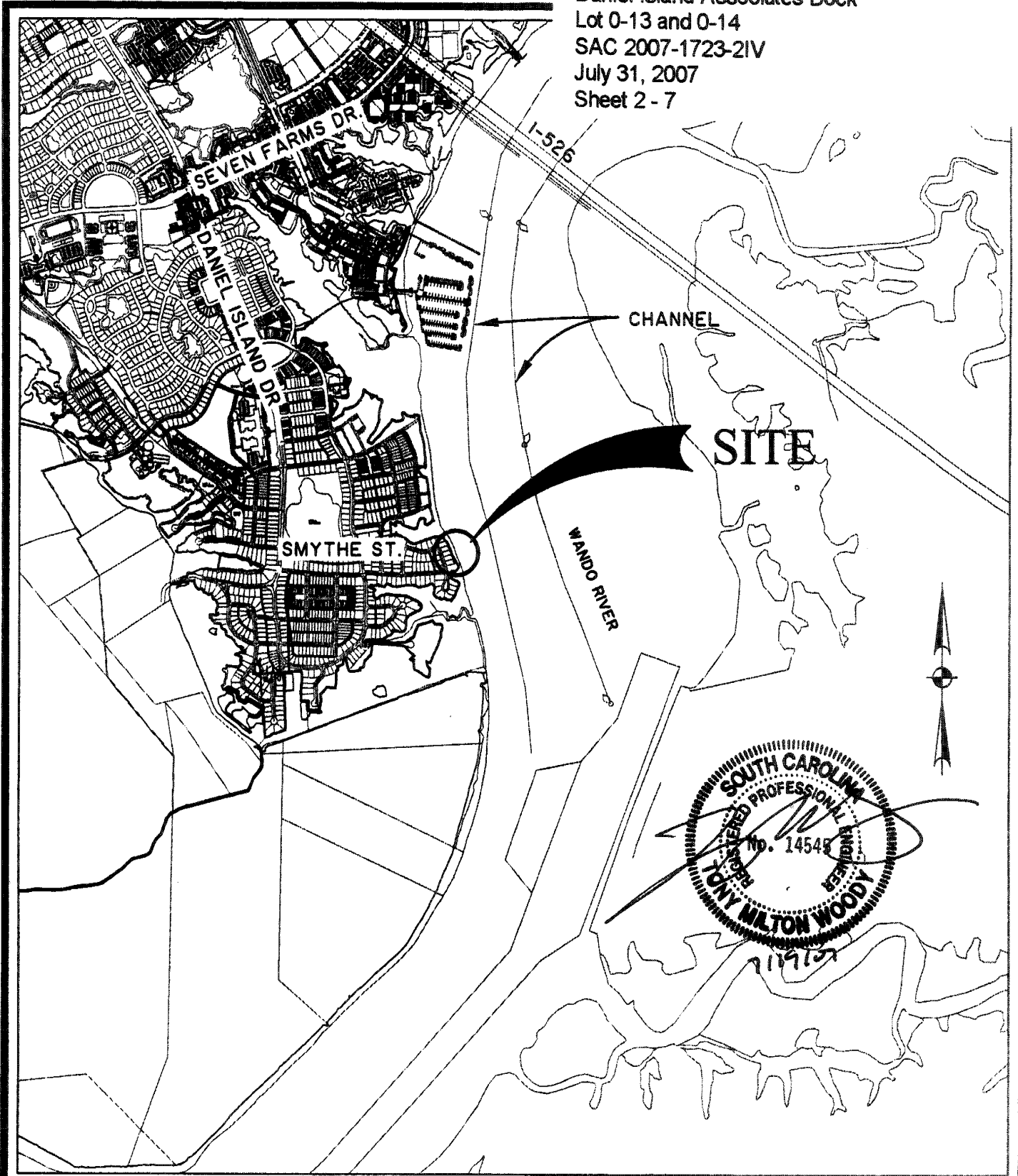

PARCEL Z PHASE 5  
AT DANIEL ISLAND  
LOCATION MAP

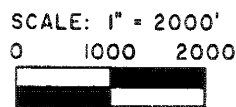

PROJECT: CONSTRUCT PRIVATE DOCK  
COUNTY: BERKELEY  
LOCATION: LOT 0-13-14 SMYTHE ST.  
DANIEL ISLAND, SC  
APPLICANT: DANIEL ISLAND ASSOCIATES

APRIL 2007

SHEET 2 OF 7

Lot 0-13 and 0-14  
SAC 2007-1723-2IV  
July 31, 2007  
Sheet 3 - 7

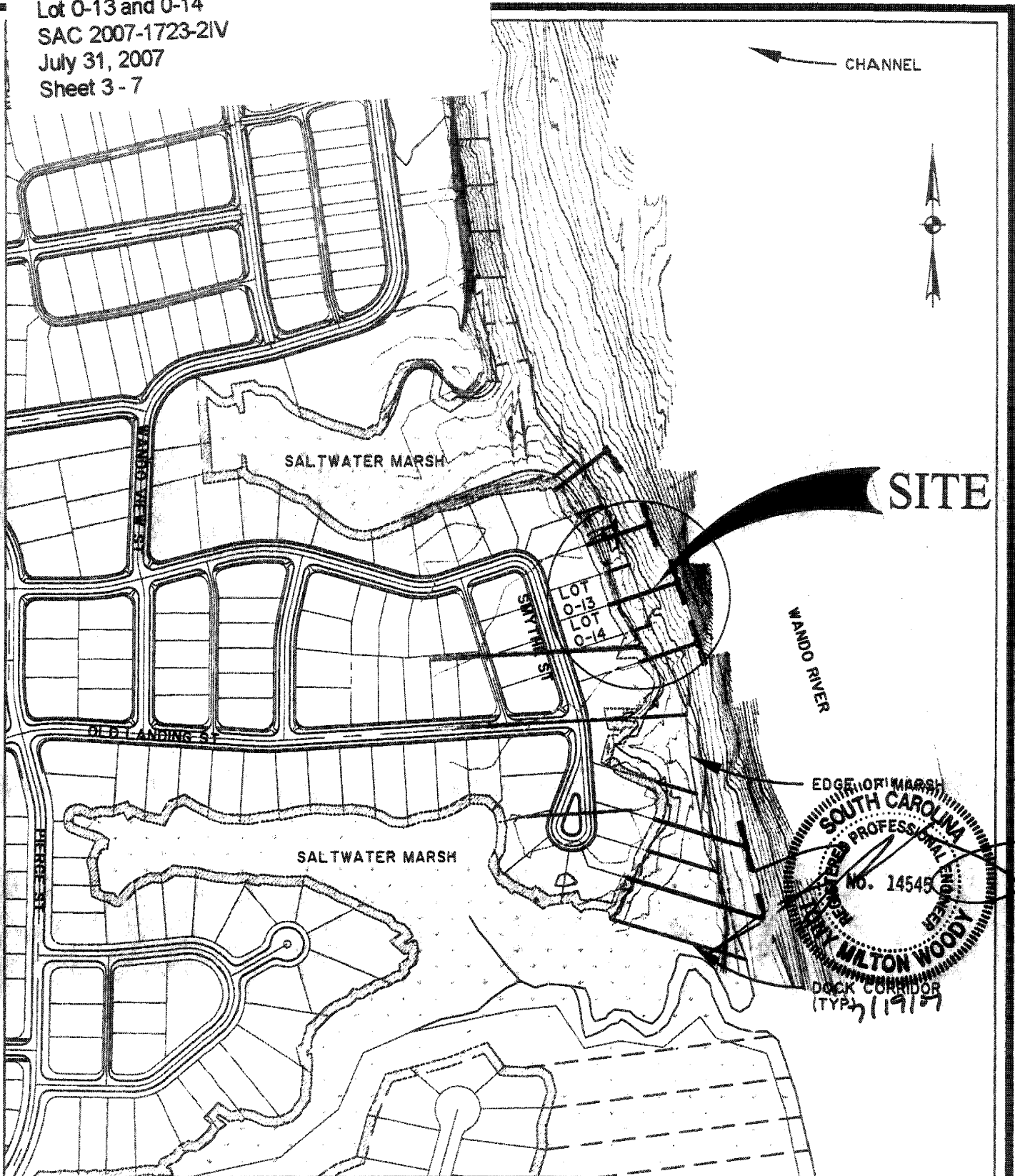

PARCEL Z PHASE 5  
AT DANIEL ISLAND  
LOCATION MAP

APRIL 2007



SHEET 3 OF 7

PROJECT: CONSTRUCT PRIVATE DOCK  
COUNTY: BERKELEY  
LOCATION: LOT 0-13-14 SMYTHE ST  
DANIEL ISLAND, SC  
APPLICANT: DANIEL ISLAND ASSOCIATES

Daniel Island Associates Dock  
 0-13 and 0-14  
 SAC 2007-1723-2IV  
 July 31, 2007  
 Sheet 4 - 7

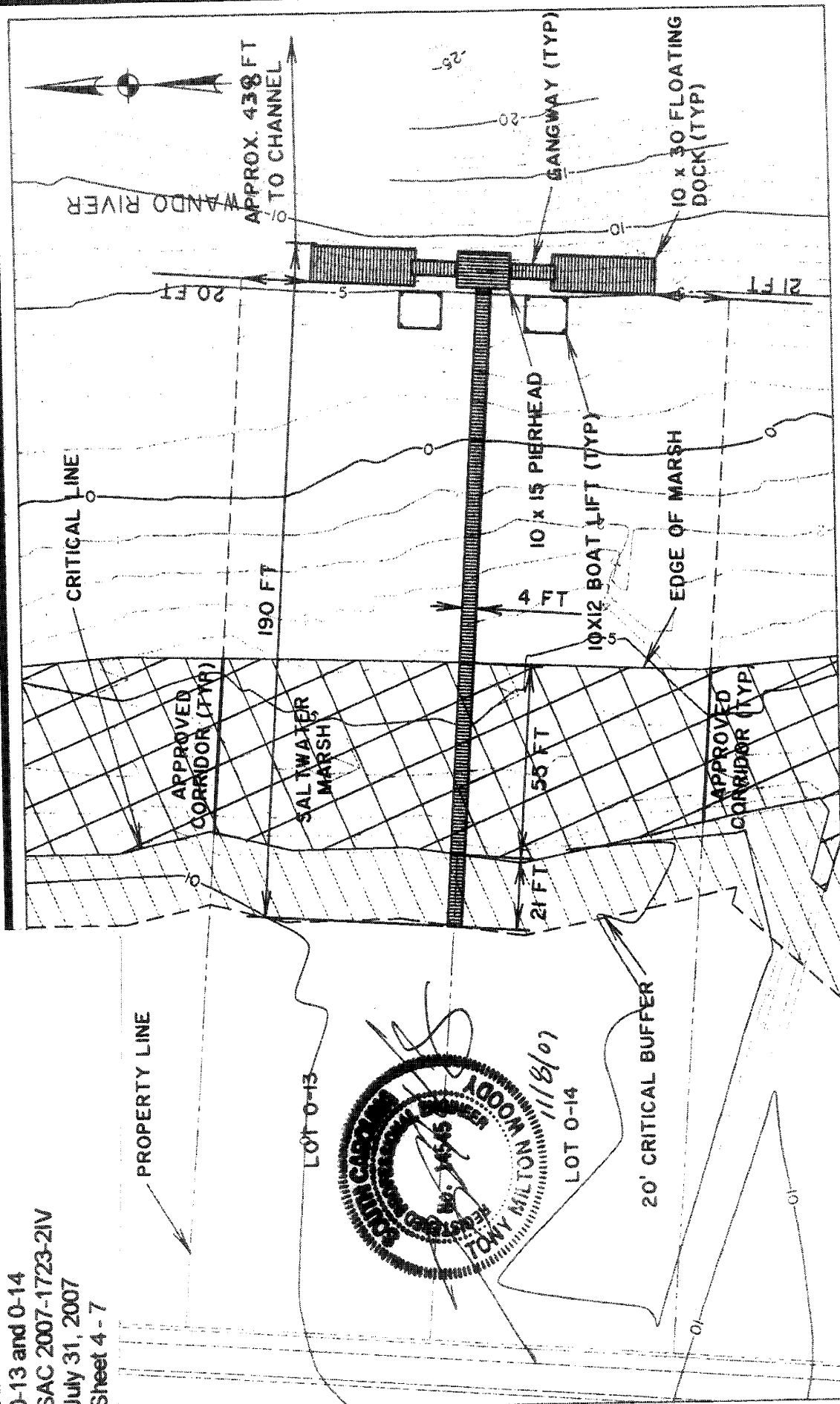

PARCEL Z PHASE 5  
 AT DANIEL ISLAND  
 PLAN VIEW

APRIL 2007  
 REVISED: NOVEMBER 7, 2007



SHEET 4 OF 7

PROJECT: CONSTRUCT PRIVATE DOCK  
 COUNTY: BERKELEY  
 LOCATION: LOT 0-13-14, SMYTHE ST  
 DANIEL ISLAND, SC  
 APPLICANT: DANIEL ISLAND ASSOCIATES

Daniel Island Associates Dock  
 0-13 and 0-14  
 SAC 2007-1723-2IV  
 July 31, 2007  
 Sheet 5 - 7

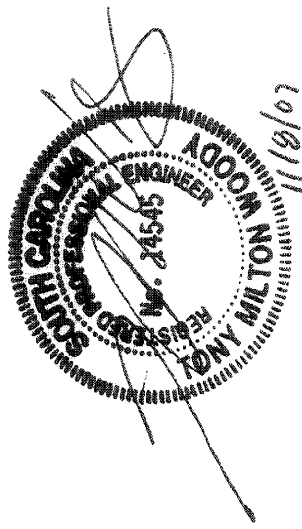
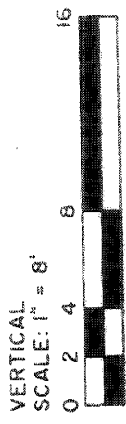
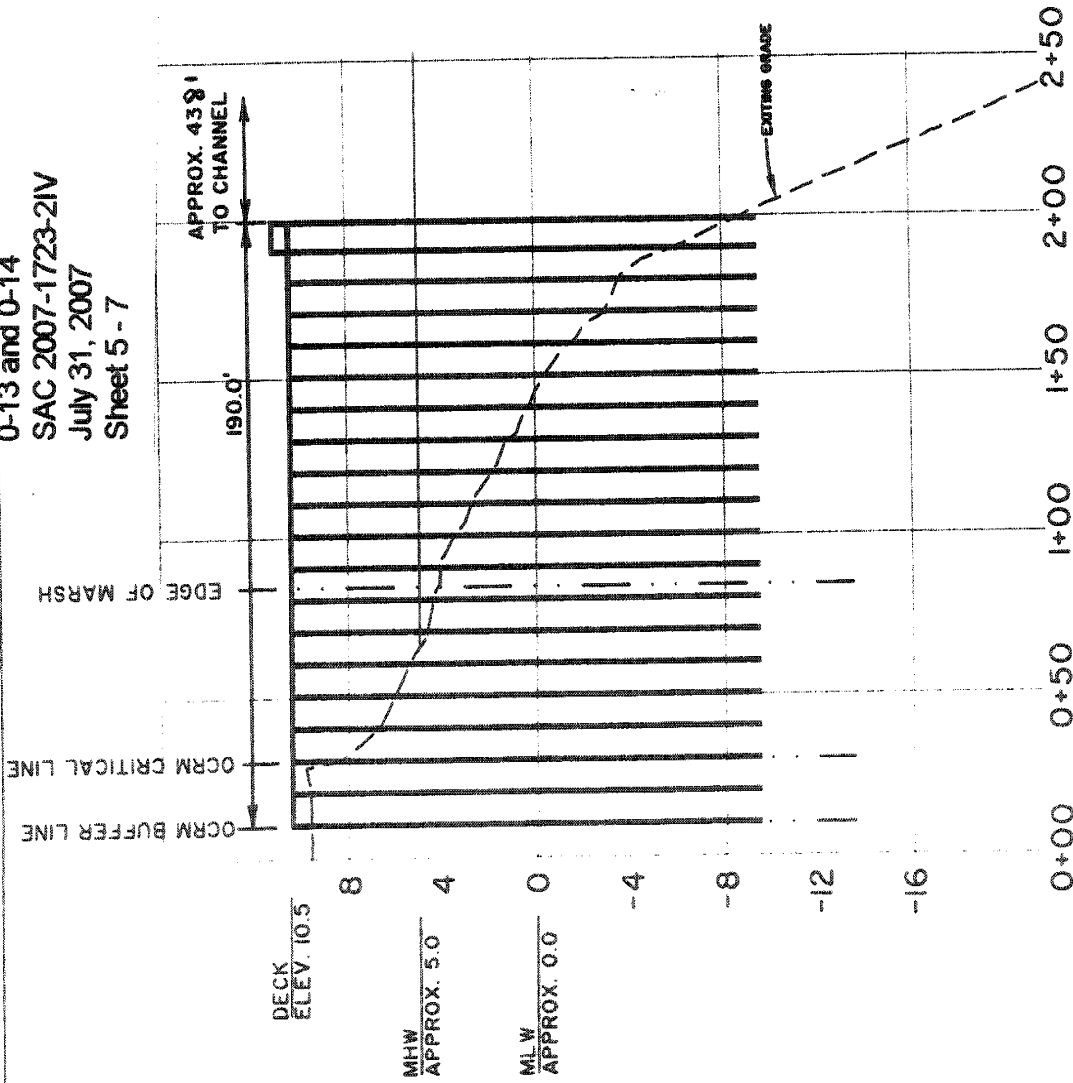

**PARCEL Z PHASE 5  
 AT DANIEL ISLAND  
 PROFILE**

APRIL 2007  
 REVISED: NOVEMBER 7, 2007

SHEET 5 OF 7

PROJECT: CONSTRUCT PRIVATE DOCK  
 COUNTY: BERKELEY  
 LOCATION: LOT 0-13-14 SMTHYE ST.  
 DANIEL ISLAND, SC  
 APPLICANT: DANIEL ISLAND ASSOCIATES

Daniel Island Associates Dock  
Lot 0-13 and 0-14  
SAC 2007-1723-2IV  
July 31, 2007  
Sheet 6 - 7

LONGITUDINAL BRACING  
TO BE LOCATED BETWEEN  
PILES AS INDICATED (TYP)

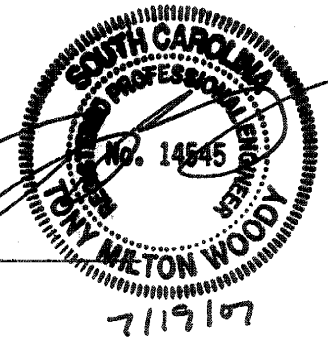
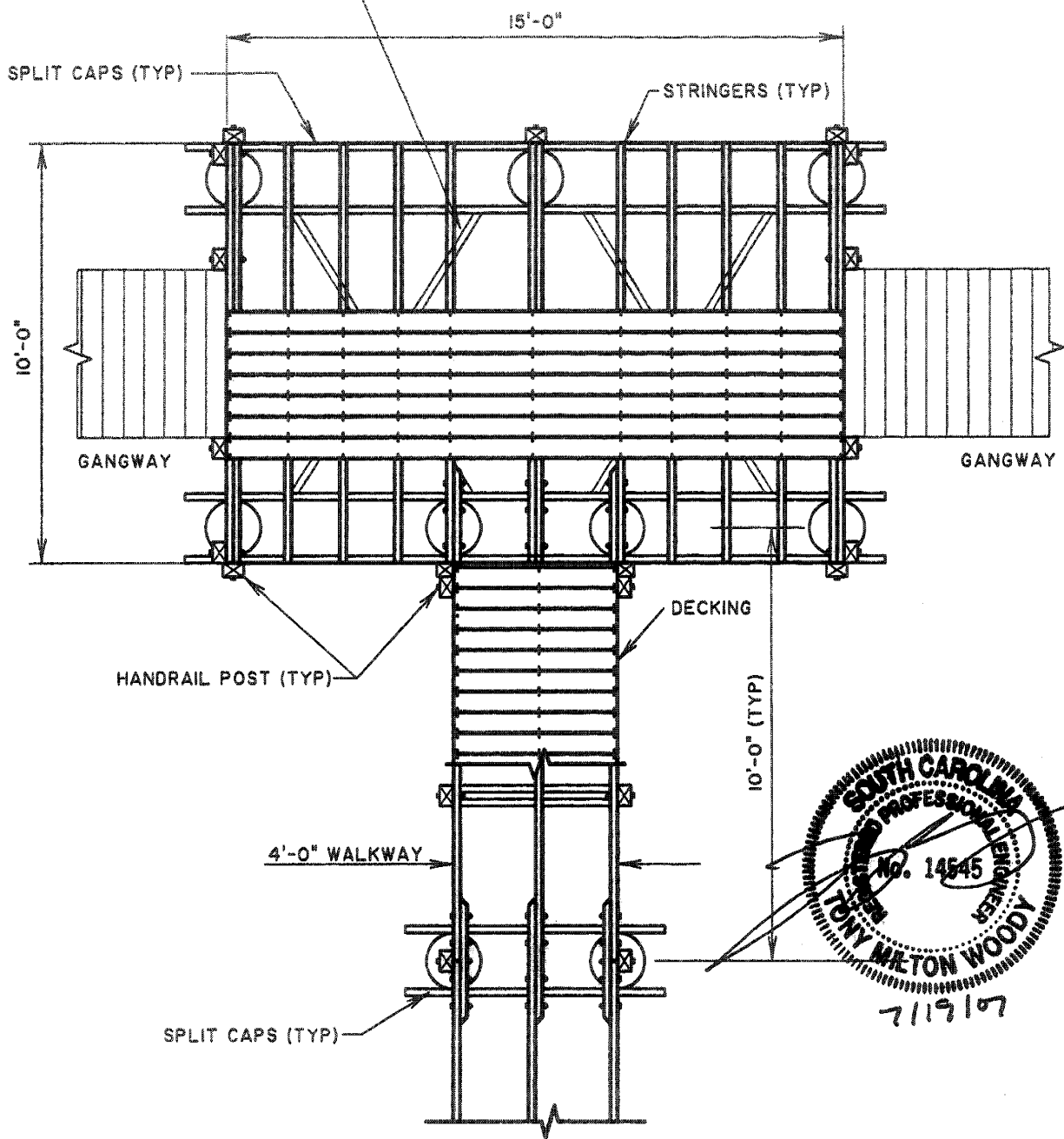

**PARCEL Z PHASE 5  
AT DANIEL ISLAND  
10' X 15' PIERHEAD PLAN**

APRIL 2007

SHEET 6 OF 7

PROJECT: CONSTRUCT PRIVATE DOCK  
COUNTY: BERKELEY  
LOCATION: LOT 0-13-14 SMYTHE ST  
DANIEL ISLAND, SC  
APPLICANT: DANIEL ISLAND ASSOCIATES

Daniel Island Associates Dock  
 Lot 0-13 and 0-14  
 SAC 2007-1723-2IV  
 July 31, 2007  
 Sheet 7 - 7

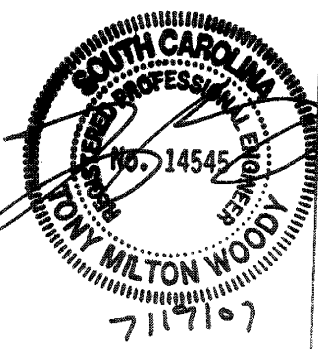
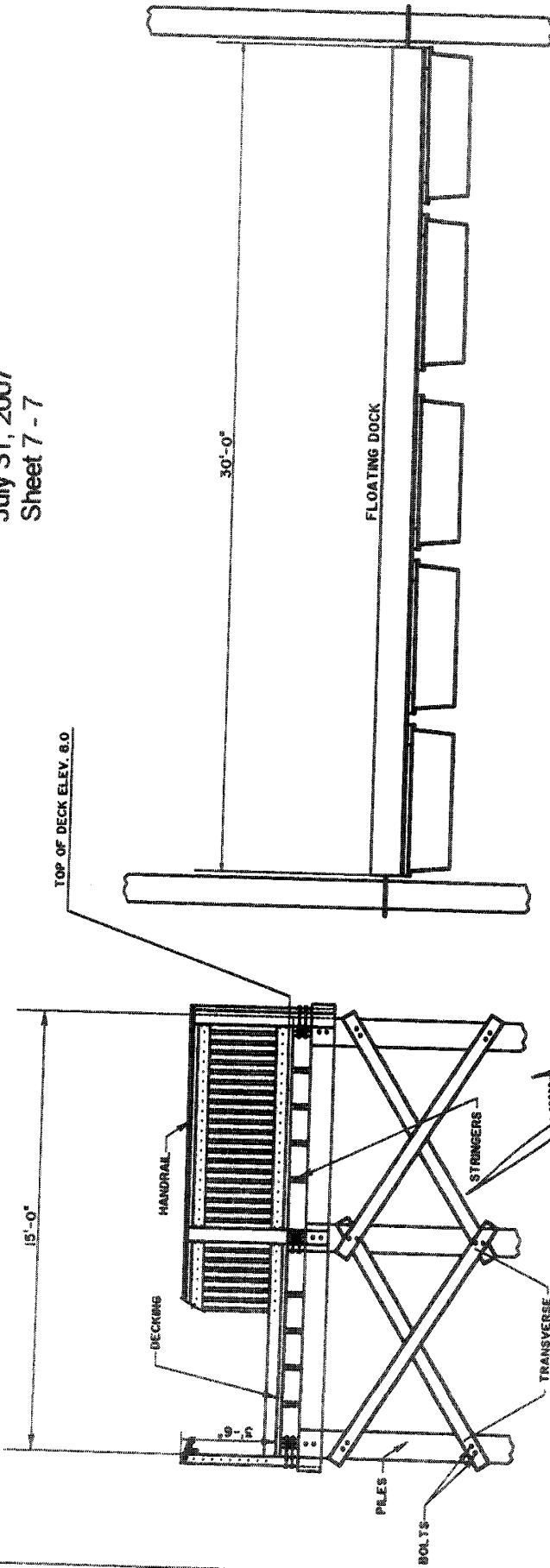

**CROSS SECTION**  
 PIER HEAD AND FLOATING DOCK SECTION

APRIL 2007

SHEET 7 OF 7

PROJECT: CONSTRUCT PRIVATE DOCK  
 COUNTY: BERKELEY  
 LOCATION: LOT 0-13-14 SMYTHE ST  
 DANIEL ISLAND  
 APPLICANT: DANIEL ISLAND ASSOCIATES