



DEPARTMENT OF THE ARMY
CHARLESTON DISTRICT, CORPS OF ENGINEERS
69-A Hagood Avenue
CHARLESTON, SOUTH CAROLINA 29403-5107

REPLY TO
ATTENTION OF

REGULATORY DIVISION

Refer to: P/N SAC 2007-1721-2IV (Modified)

November 30, 2007

BILL McKENZIE
DANIEL ISLAND ASSOCIATES
230 SEVEN FARMS DRIVE, SUITE 201
CHARLESTON, SOUTH CAROLINA 29401

To construct a pier and floating dock in the Wando River, Berkeley County, South Carolina.

Following the public notice for this project the applicant has made modifications to the originally proposed project. The modifications include increasing the size of the fixed timber walkway to be 4' x 340' (originally noticed as 4' x 291'), which will move the floating dock and pier head further channel ward. Additionally, two (2) 10' x 12' boat lift has been proposed, one associated with each proposed floating dock and located landward of the floating docks. The attached drawings represent the revisions requested by the applicant.

In order to give all interested parties an opportunity to express their views

NOTICE

is hereby given that written statements regarding the proposed work will be received by both of the above mentioned offices until

12 O'CLOCK NOON, MONDAY, DECEMBER 17, 2007

All other information regarding the public notice remains the same. If there are any questions concerning this public notice, please contact Robert Vega at 843-329-8044 or toll free at 1-866-329-8187.

Daniel Island Associates Dock
 Lot U-18 and U-19
 SAC 2007-1721-2IV
 July 31, 2007
 Sheet 1 - 7

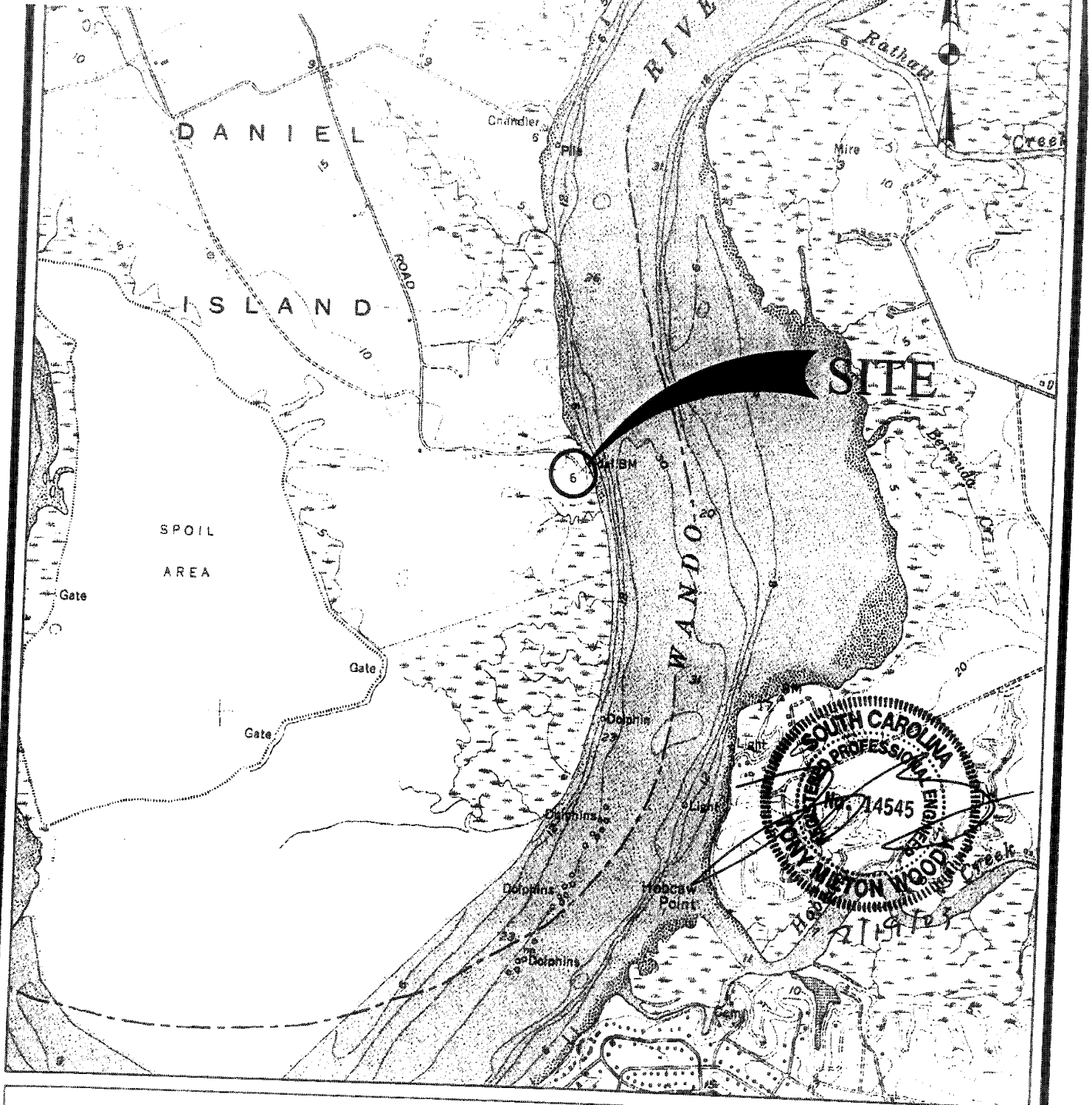

CHARLESTON
 QUAD MAP

SCALE: 1" = 2000'
 0 1000 2000



PROJECT: CONSTRUCT PRIVATE DOCK
 COUNTY: BERKELEY
 LOCATION: LOT U-18-19 SMYTHE ST.
 DANIEL ISLAND, SC
 APPLICANT: DANIEL ISLAND ASSOCIATES

APRIL 2007

SHEET 1 OF 7

Daniel Island Associates Dock
Lot U-18 and U-19
SAC 2007-1721-2IV
July 31, 2007
Sheet 2 - 7

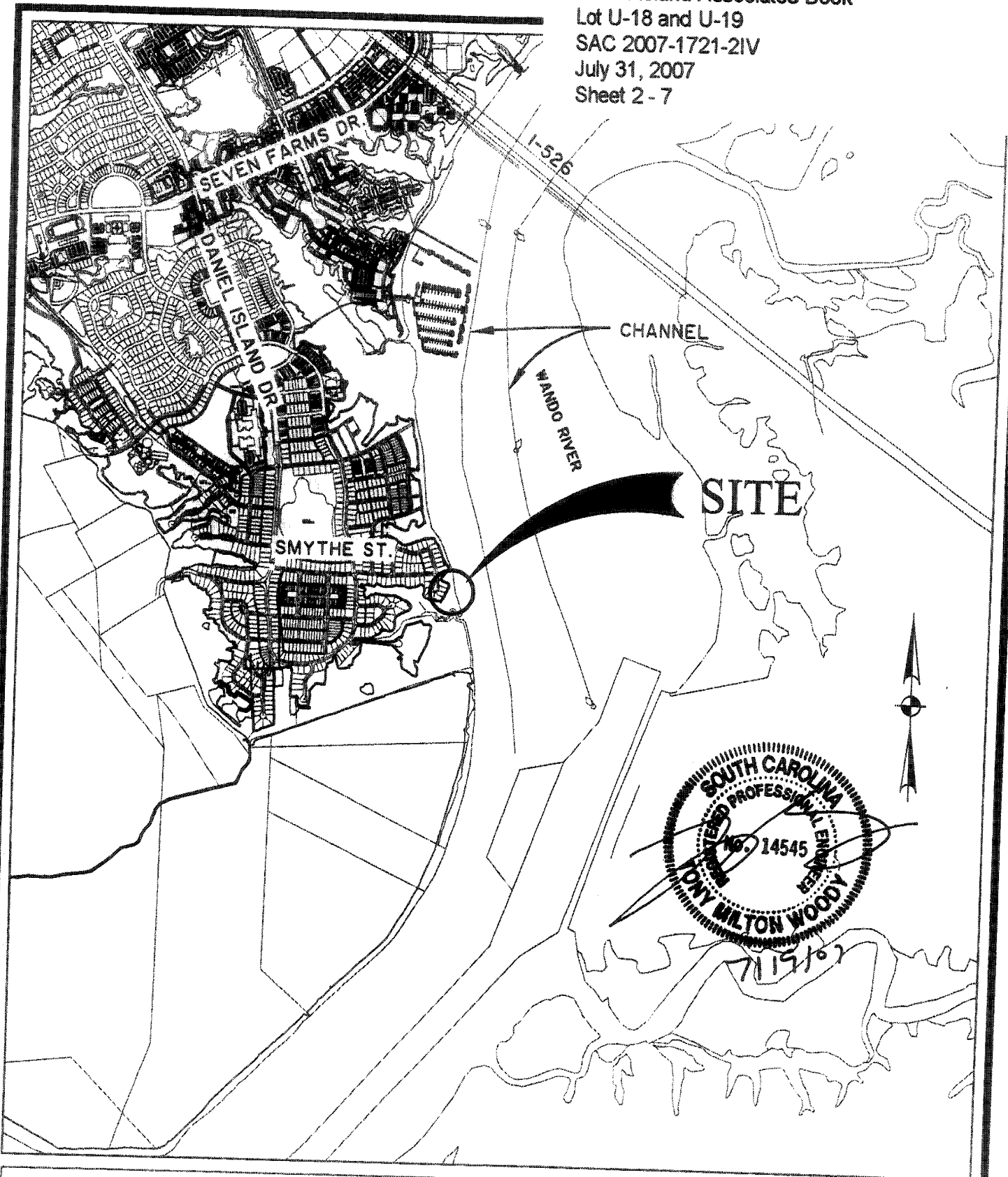

PARCEL Z PHASE 5
AT DANIEL ISLAND
LOCATION MAP

SCALE: 1" = 2000'
0 1000 2000



PROJECT: CONSTRUCT PRIVATE DOCK
COUNTY: BERKELEY
LOCATION: LOT U-18-19 SMYTHE ST.
DANIEL ISLAND, SC
APPLICANT: DANIEL ISLAND ASSOCIATES

APRIL 2007

SHEET 2 OF 7

Lot U-18 and U-19
 SAC 2007-1721-2IV
 July 31, 2007
 Sheet 3 - 7

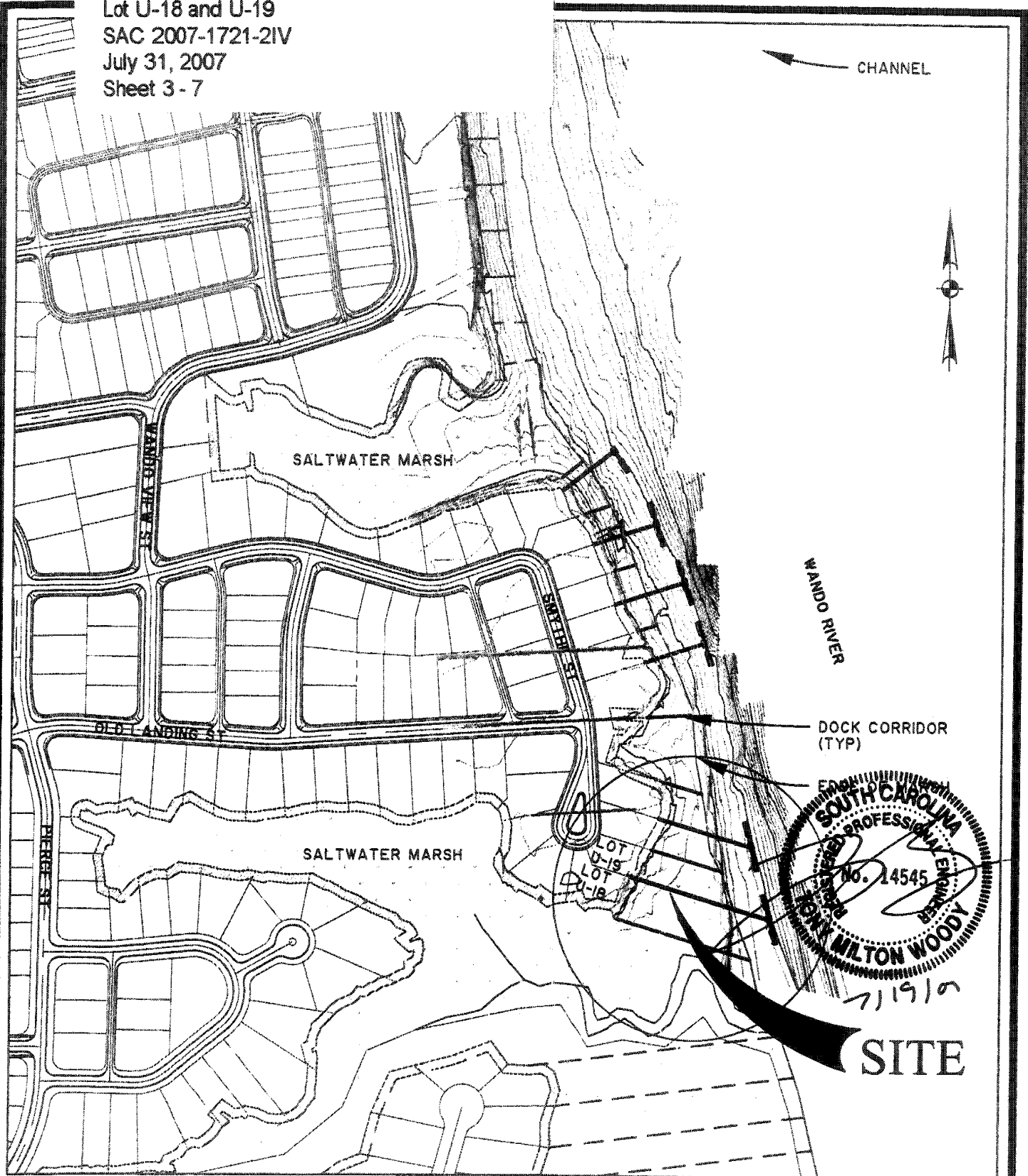

PARCEL Z PHASE 5
 AT DANIEL ISLAND
 LOCATION MAP

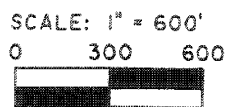

PROJECT: CONSTRUCT PRIVATE DOCK
 COUNTY: BERKELEY
 LOCATION: LOT U-18-19 SMYTHE ST
 DANIEL ISLAND, SC
 APPLICANT: DANIEL ISLAND ASSOCIATES

APRIL 2007

SHEET 3 OF 7

Daniel Island Associates Dock
 Lot U-18 and U-19
 SAC 2007-1721-2IV
 July 31, 2007
 Sheet 4 - 7

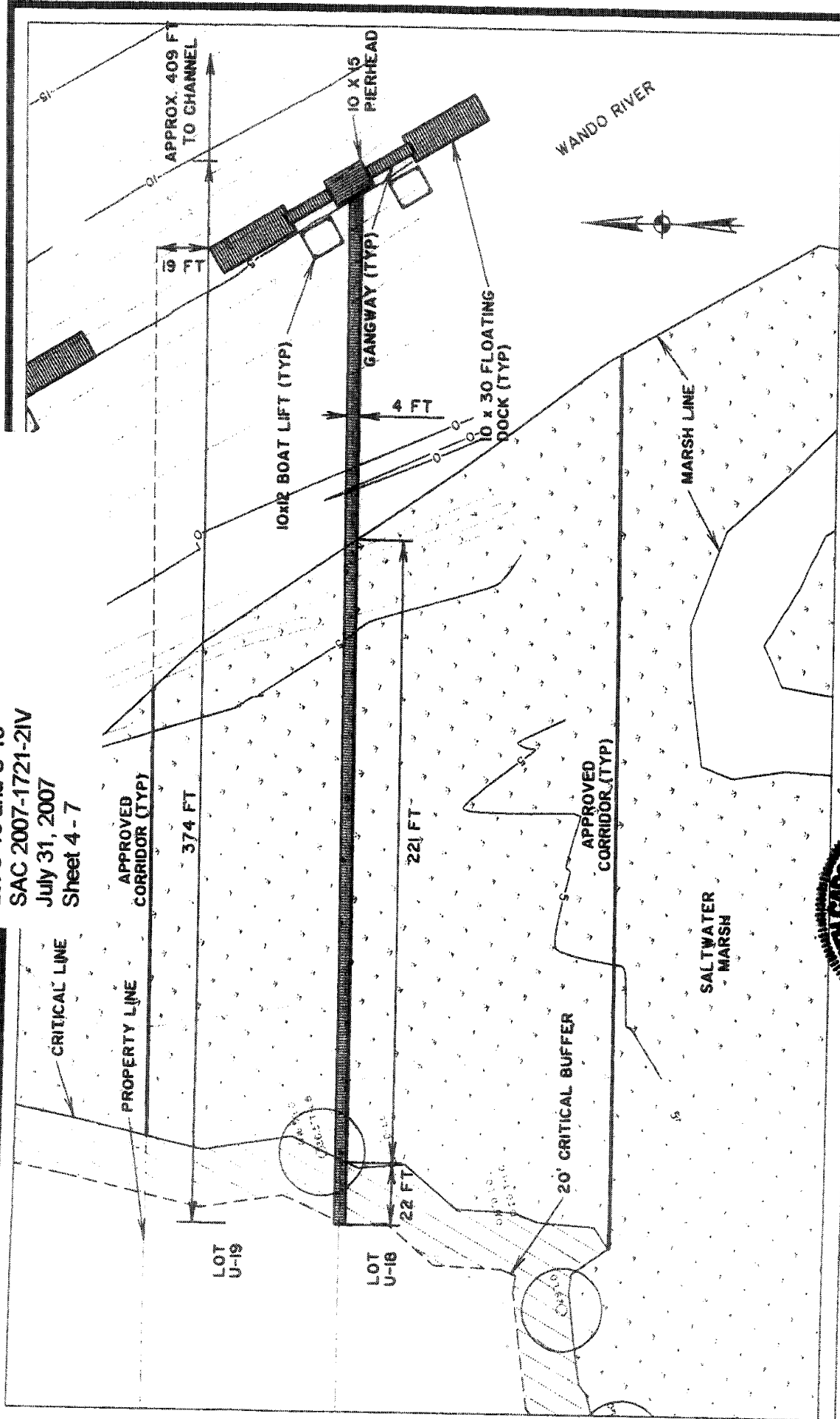

PROJECT: CONSTRUCT PRIVATE DOCK
 COUNTY: BERKELEY
 LOCATION: LOT U-18-19 SMYTHE ST
 DANIEL ISLAND, SC
 APPLICANT: DANIEL ISLAND ASSOCIATES

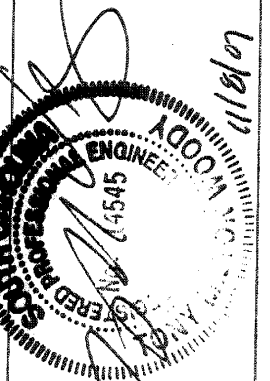
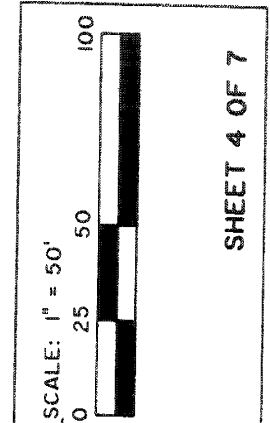

PARCEL Z PHASE 5
 AT DANIEL ISLAND
 PLAN VIEW
 APRIL 2007
 REVISED: NOVEMBER 7, 2007

Daniel Island Associates Dock
 Lot U-18 and U-19
 SAC 2007-1721-2IV
 July 31, 2007
 Sheet 5 - 7

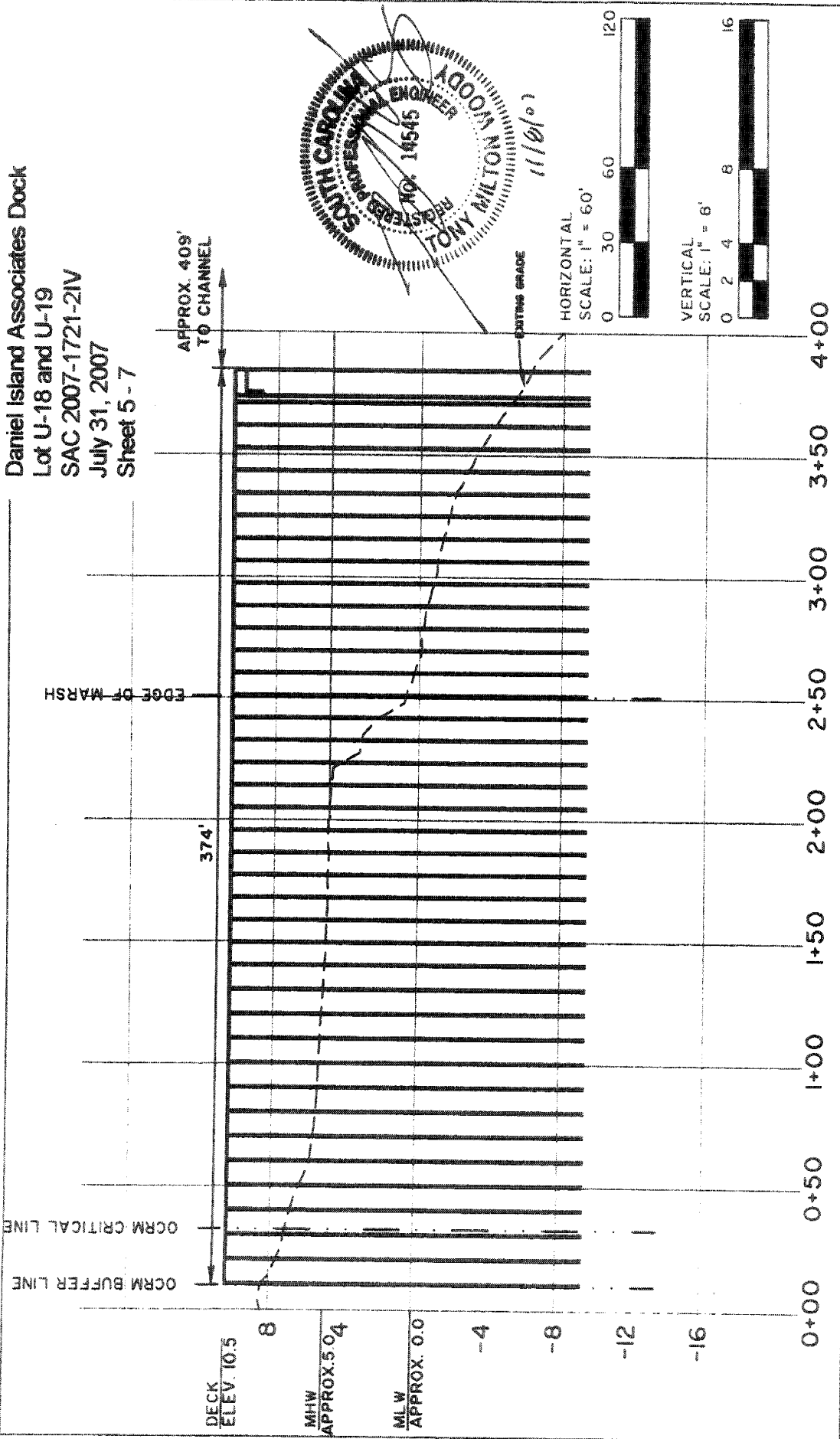

**PARCEL Z PHASE 5
 AT DANIEL ISLAND
 PROFILE**

APRIL 2007
 REVISED: NOVEMBER 7, 2007

SHEET 5 OF 7

PROJECT: CONSTRUCT PRIVATE DOCK
 COUNTY: BERKELEY
 LOCATION: LOT U-18-19 SMTHYE ST.
 DANIEL ISLAND, SC
 APPLICANT: DANIEL ISLAND ASSOCIATES

Daniel Island Associates Dock
Lot U-18 and U-19
SAC 2007-1721-2IV
July 31, 2007
Sheet 6 - 7

LONGITUDINAL BRACING
TO BE LOCATED BETWEEN
PILES AS INDICATED (TYP)

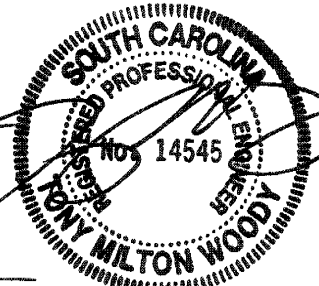
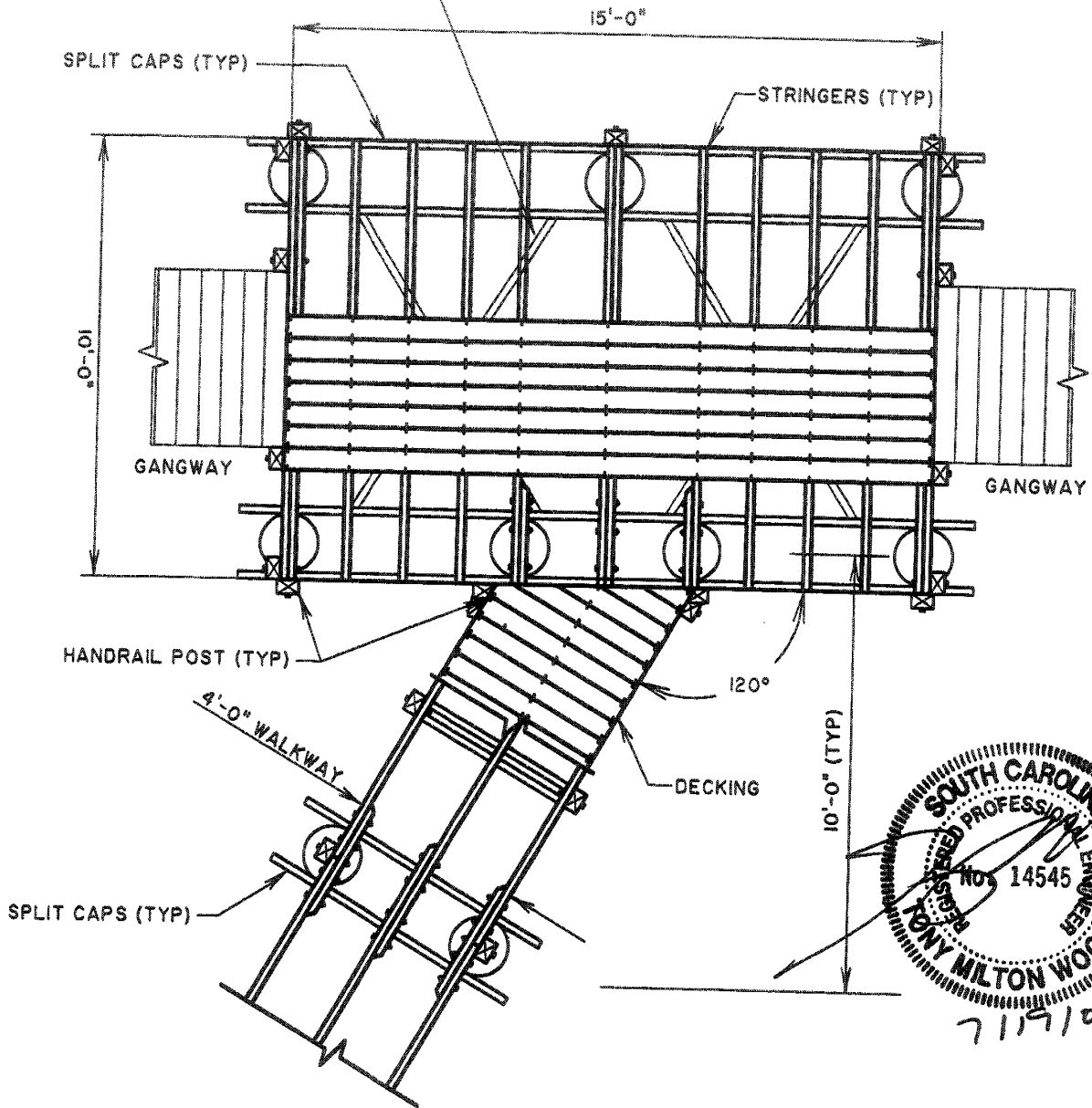

7/19/07

**PARCEL Z PHASE 5
AT DANIEL ISLAND
10' X 15' PIERHEAD PLAN**

APRIL 2007

SHEET 6 OF 7

PROJECT: CONSTRUCT PRIVATE DOCK
COUNTY: BERKELEY
LOCATION: LOT U-18-19 SMYTHE ST
DANIEL ISLAND, SC
APPLICANT: DANIEL ISLAND ASSOCIATES

Daniel Island Associates Dock
 Lot U-18 and U-19
 SAC 2007-1721-2IV
 July 31, 2007
 Sheet 7 - 7

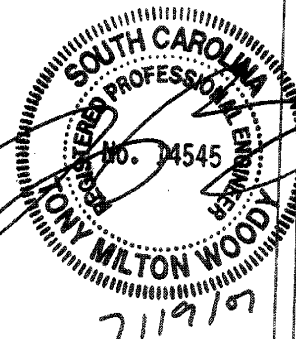
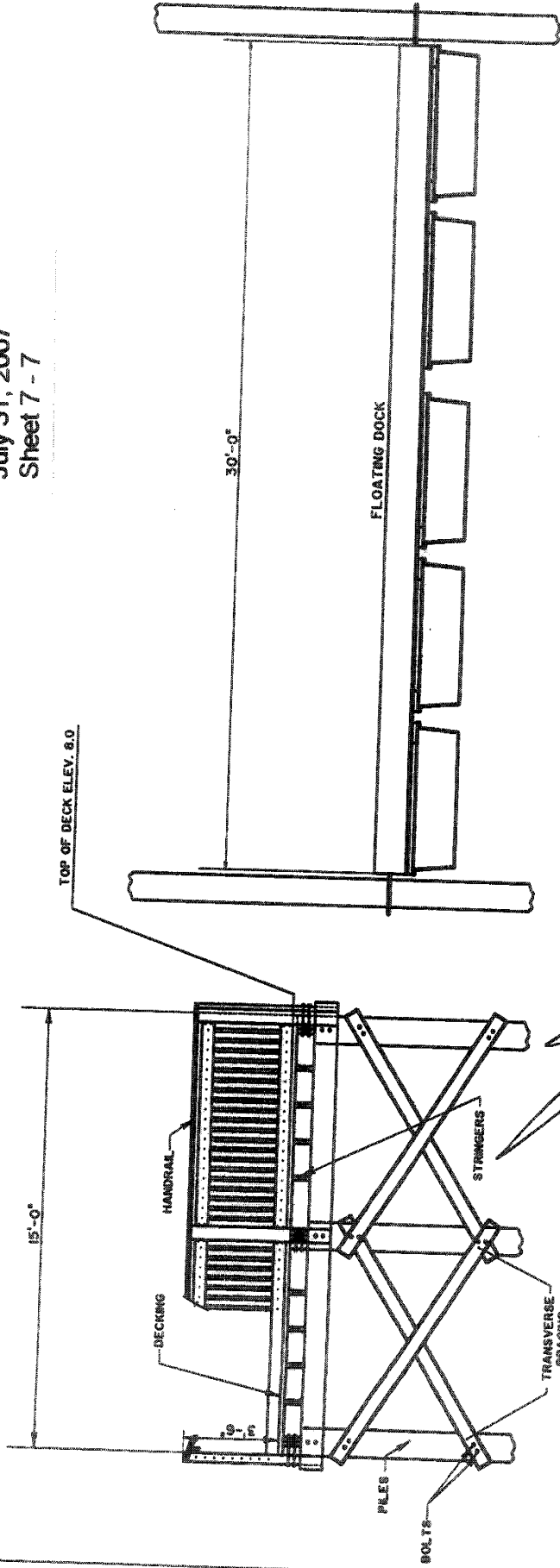

CROSS SECTION

PIER HEAD AND FLOATING DOCK SECTION

APRIL 2007

SHEET 7 OF 7

PROJECT: CONSTRUCT PRIVATE DOCK
 COUNTY: BERKELEY
 LOCATION: LOT U-18-19 SMYTHE ST
 DANIEL ISLAND
 APPLICANT: DANIEL ISLAND ASSOCIATES