

JOINT
PUBLIC NOTICE

CHARLESTON DISTRICT, CORPS OF ENGINEERS
69A Hagood Avenue
Charleston, South Carolina 29403-5107
and the
S.C. DEPARTMENT OF HEALTH AND ENVIRONMENTAL CONTROL
OFFICE OF OCEAN AND COASTAL RESOURCE MANAGEMENT
1362 McMillan Avenue, Suite 400
Charleston, South Carolina 29405

REGULATORY DIVISION
Refer to: P/N #2007-01306-3IB

August 3, 2007

Pursuant to Section 10 of the Rivers and Harbors Act of 1899 (33 U.S.C. 403), Sections 401 and 404 of the Clean Water Act (33 U.S.C. 1344), and the South Carolina Coastal Zone Management Act (48-39-10 et seq.) an application has been submitted to the Department of the Army and the S.C. Department of Health and Environmental Control by

COLONY POINTE HOMEOWNERS ASSOCIATION
C/O BEAM & ASSOCIATES
PO BOX 11863
COLUMBIA, SOUTH CAROLINA 29211-1863

for a permit to dredge in the

COLONY POINTE CHANNEL

located off Colony Pointe Drive in Debordieu Colony east of Highway 17, Georgetown County, South Carolina (Latitude: 33.36563°N; Longitude -79.16993°W).

In order to give all interested parties an opportunity to express their views

NOTICE

is hereby given that written statements regarding the proposed work will be received by both of the above mentioned offices until

12 O'CLOCK NOON, TUESDAY, SEPTEMBER 4, 2007

from those interested in the activity and whose interests may be affected by the proposed work.

The proposed work consists of dredging approximately 2,800 cubic yards of material with a hydraulic cutterhead dredge from the Colony Pointe Channel. The dredge material will be transported by pipeline from the dredge to the Debordieu Homeowners Association disposal basin. The overall project purpose is to provide personal watercrafts access to coastal waters.

August 3, 2007

NOTE: Plans depicting the work described in this notice are available and will be provided, upon receipt of a written request, to anyone that is interested in obtaining a copy of the plans for the specific project. The request must identify the project of interest by public notice number and a self-addressed stamped envelope must also be provided for mailing the drawings to you. Your request for drawings should be addressed to the

**U.S. Army Corps of Engineers
ATTN: REGULATORY DIVISION
1949 Industrial Park Road, Room 140
Conway, South Carolina 29526**

The District Engineer has concluded that the discharges associated with this project, both direct and indirect, should be reviewed by the South Carolina Department of Health and Environmental Control in accordance with provisions of Section 401 of the Clean Water Act. As such, this notice constitutes a request, on behalf of the applicant, for certification that this project will comply with applicable effluent limitations and water quality standards. The work shown on this application must also be certified as consistent with applicable provisions the Coastal Zone Management Program (15 CFR 930). The District Engineer will not process this application to a conclusion until such certifications are received. The applicant is hereby advised that supplemental information may be required by the State to facilitate the review.

This notice initiates the Essential Fish Habitat (EFH) consultation requirements of the Magnuson-Stevens Fishery Conservation and Management Act. Implementation of the proposed project would impact 0.75 acre of estuarine substrates utilized by various life stages of species comprising the red drum, shrimp, and snapper-grouper management complexes. Our initial determination is that the proposed action would not have a substantial individual or cumulative adverse impact on EFH or fisheries managed by the South Atlantic Fishery Management Council and the National Marine Fisheries Service (NMFS). Our final determination relative to project impacts and the need for mitigation measures is subject to review by and coordination with the NMFS.

The District Engineer has consulted the most recently available information and has determined that the project will have no effect on any Federally endangered, threatened, or proposed species and will not result in the destruction or adverse modification of designated or proposed critical habitat. This public notice serves as a request to the U.S. Fish and Wildlife Service and the National Marine Fisheries Service for any additional information they may have on whether any listed or proposed endangered or threatened species or designated or proposed critical habitat may be present in the area which would be affected by the activity, pursuant to Section 7(c) of the Endangered Species Act of 1973 (as amended).

Pursuant to Section 106 of the National Historic Preservation Act (NHPA), this public notice also constitutes a request to Indian Tribes to notify the District Engineer of any historic properties of religious and cultural significance to them that may be affected by the proposed undertaking.

In accordance with the NHPA, the District Engineer has also consulted the latest published version of the National Register of Historic Places for the presence or absence of registered properties, or properties listed as being eligible for inclusion therein, and this worksite is not included as a registered property or property listed as being eligible for inclusion in the Register. To insure that other cultural resources that the District Engineer is not aware of are not overlooked, this public notice also serves as a request to the State Historic Preservation Office to provide any information it may have with regard to historic and cultural resources.

August 3, 2007

Any person may request, in writing, within the comment period specified in this notice, that a public hearing be held to consider this application. Requests for a public hearing shall state, with particularity, the reasons for holding a public hearing.

The decision whether to issue a permit will be based on an evaluation of the probable impact including cumulative impacts of the activity on the public interest. That decision will reflect the national concern for both protection and utilization of important resources. The benefit which reasonably may be expected to accrue from the project must be balanced against its reasonably foreseeable detriments. All factors which may be relevant to the project will be considered including the cumulative effects thereof; among those are conservation, economics, aesthetics, general environmental concerns, wetlands, historic properties, fish and wildlife values, flood hazards, flood plain values, land use, navigation, shoreline erosion and accretion, recreation, water supply and conservation, water quality, energy needs, safety, food and fiber production and, in general, the needs and welfare of the people. A permit will be granted unless the District Engineer determines that it would be contrary to the public interest. In cases of conflicting property rights, the Corps of Engineers cannot undertake to adjudicate rival claims.

The Corps of Engineers is soliciting comments from the public; Federal, state, and local agencies and officials; Indian Tribes; and other interested parties in order to consider and evaluate the impacts of this activity. Any comments received will be considered by the Corps of Engineers to determine whether to issue, modify, condition or deny a permit for this project. To make this decision, comments are used to assess impacts on endangered species, historic properties, water quality, general environmental effects, and the other public interest factors listed above. Comments are used in the preparation of an Environmental Assessment and/or an Environmental Impact Statement pursuant to the National Environmental Policy Act. Comments are also used to determine the need for a public hearing and to determine the overall public interest of the activity.

If there are any questions concerning this public notice, please contact Wiley Bracey at 843-365-1707.

FOR PERMITTING ONLY - DO NOT USE FOR CONSTRUCTION

HWY 17
TO MYRTLE BEACH

LONG
RAY

PROJECT SITE



O C E A N

L A N T I C

NOT TO SCALE

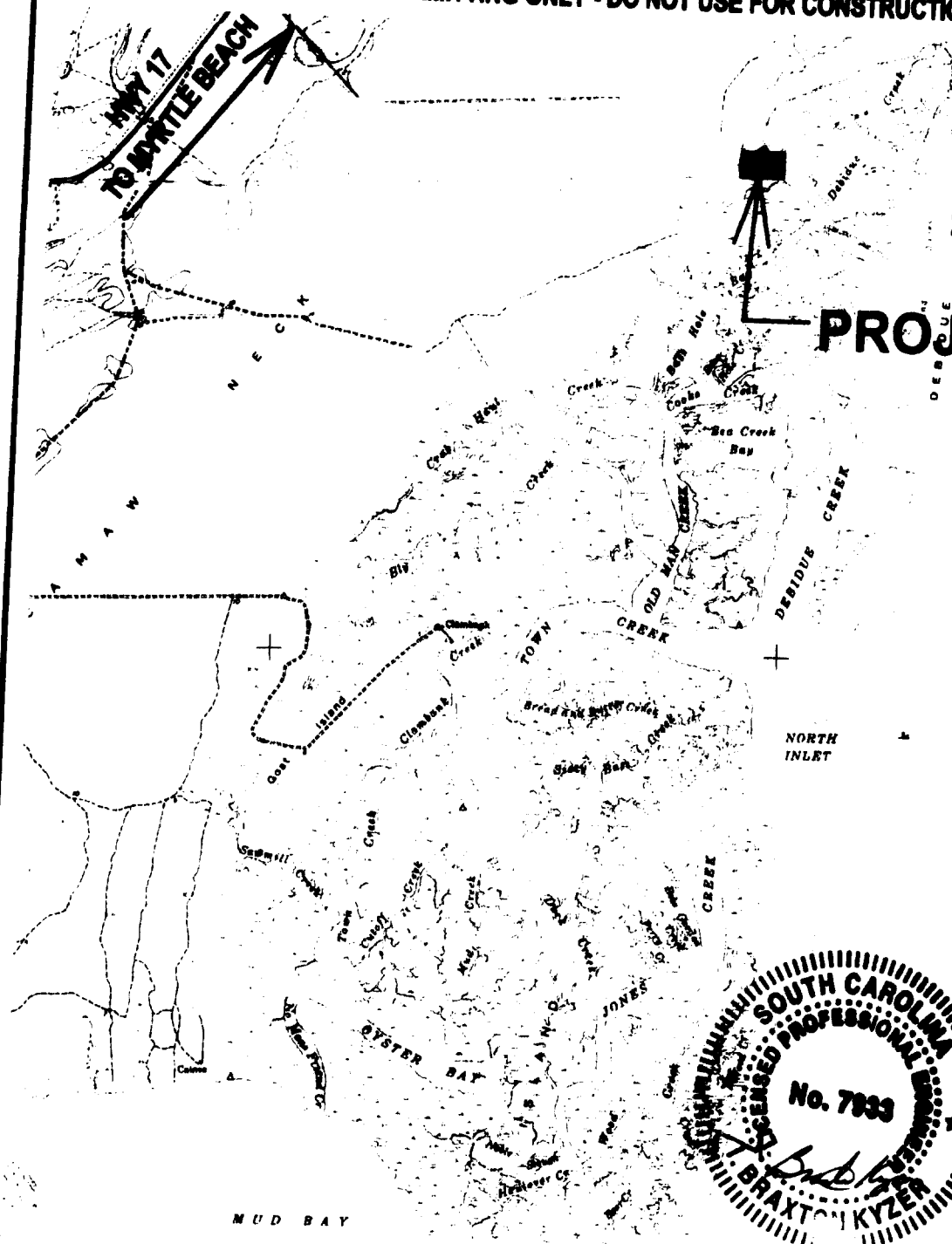
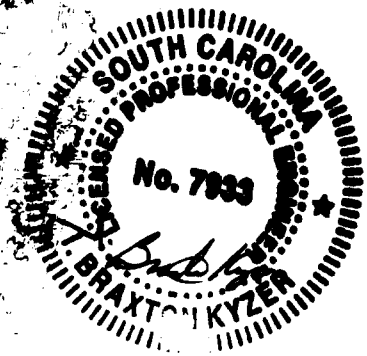

LATITUDE: 33° 22' 0.12" N
LONGITUDE: 79° 10' 11.78" W

USGS QUAD SHEET

PROJECT NAME- COLONY POINT H.O.A.	PROPOSED ACTIVITY - DREDGE CREEK TO -2.5' MLW TO PROVIDE ADJACENT PROPERTY OWNERS WITH IMPROVED ACCESS TO NAVIGABLE WATERS.	OWNER - COLONY POINT H.O.A. AGENT - BEAM & ASSOCIATES P.O. BOX 11863 COLUMBIA, SC 29211-1863 PHONE: (803) 931-0805
CITY/TOWN- DEBORDIEU COLONY RIVER/WATER BODY- DEBORDIEU CREEK COUNTY- GEORGETOWN STATE- S.C.	DATE- 11/08/06	PAGE- 1 OF 13
		NO SCALE

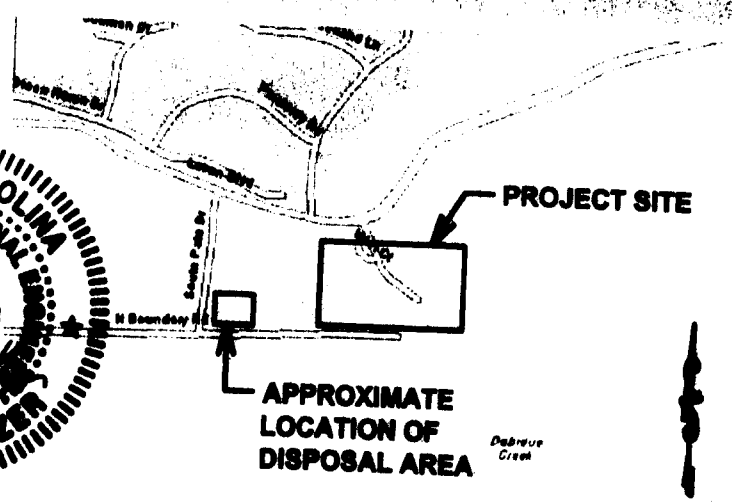
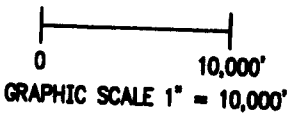
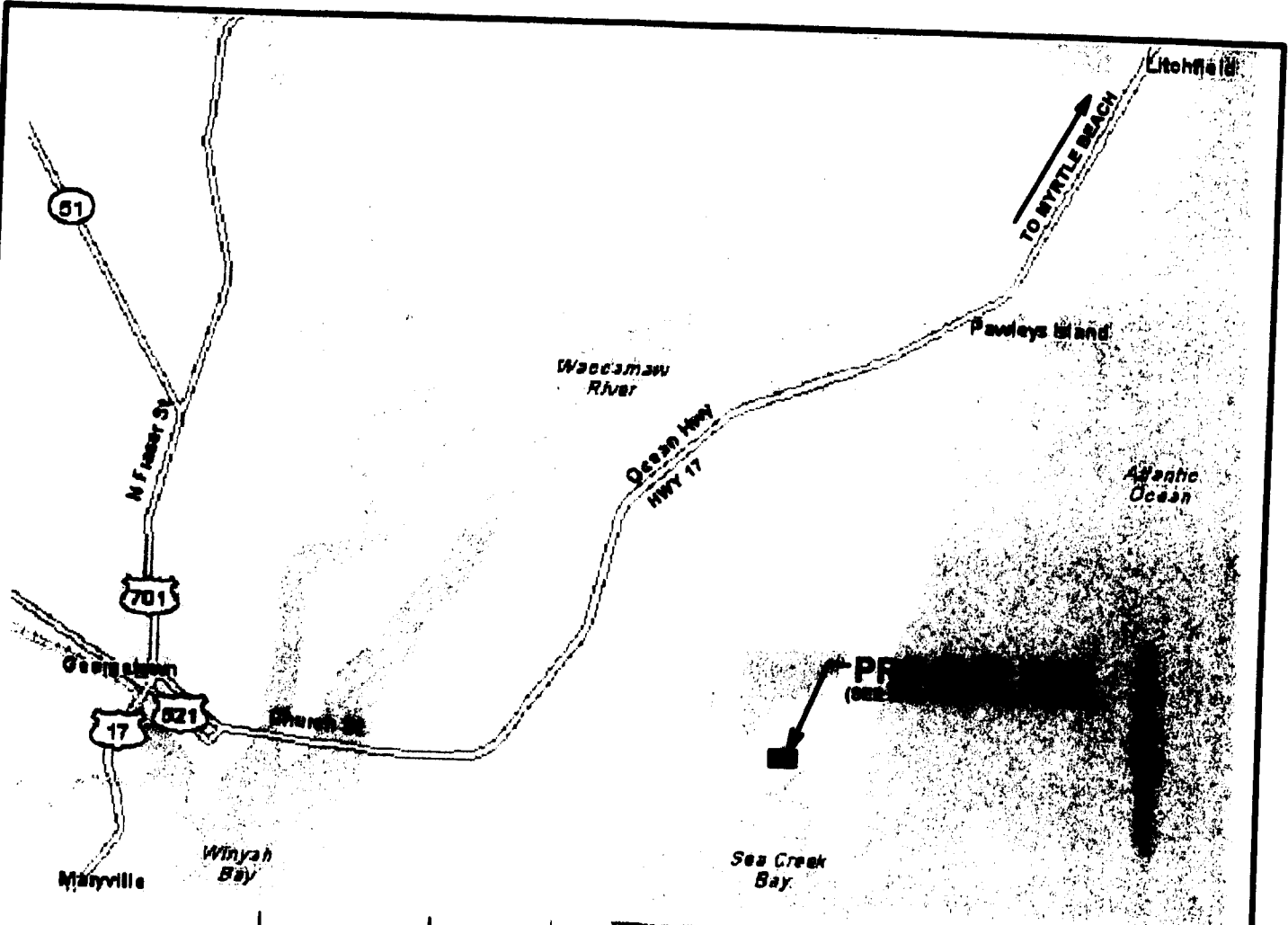

FOR PERMITTING ONLY
DO NOT USE
FOR CONSTRUCTION

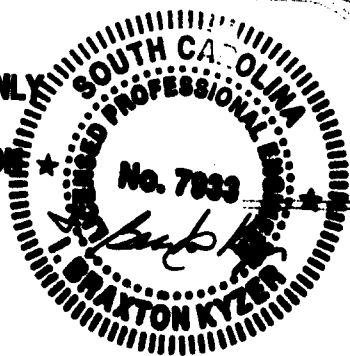

LATITUDE: 33° 22' 0.12" N
LONGITUDE: 79° 10' 11.78" W

LOCATION MAP

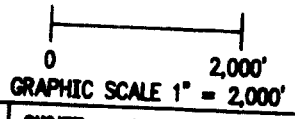

<p>PROJECT NAME- COLONY POINT H.O.A. CITY/TOWN- DEBORDIEU COLONY RIVER/WATER BODY- DEBORDIEU CREEK COUNTY- GEORGETOWN STATE- S.C.</p>	<p>PROPOSED ACTIVITY - DREDGE CREEK TO -2.5' MLW TO PROVIDE ADJACENT PROPERTY OWNERS WITH IMPROVED ACCESS TO NAVIGABLE WATERS.</p>	<p>OWNER - COLONY POINT H.O.A. AGENT - BEAM & ASSOCIATES P.O. BOX 11863 COLUMBIA, SC 29211-1863 PHONE: (803) 931-0805</p>
<p>DATE- 11/08/06</p>	<p>PAGE- 2 OF 13</p>	<p>SCALE: AS SHOWN</p>

FOR PERMITTING ONLY - DO NOT USE FOR CONSTRUCTION

SEE ENLARGED VIEW #1 - PAGE 5

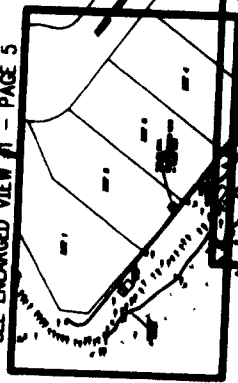

SEE ENLARGED VIEW #2 - PAGE 6



SEE ENLARGED VIEW #3 - PAGE 7



SEE ENLARGED VIEW #4 - PAGE 8

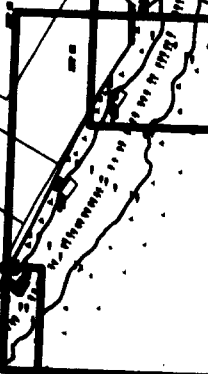

SEE ENLARGED VIEW #5 - PAGE 9

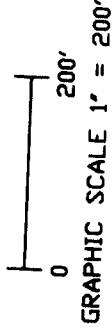

EXISTING CONDITIONS OVERALL SITE PLAN

LATITUDE: 33° 22' 0.12" N

LONGITUDE: 79° 10' 11.78" W

PROJECT NAME - COLONY POINT H.O.A.

CITY/TOWN - DEBORDEU COLONY

RIVER/WATER BODY - DEBORDEU CREEK

COUNTY - GEORGETOWN

STATE - S.C.

DATE - 11/08/06

PAGE - 3 OF 13

SCALE - 1" = 200'

PROPOSED ACTIVITY -
DREDGE CREEK TO -2.5' MLW TO PROVIDE
ADJACENT PROPERTY OWNERS WITH IMPROVED
ACCESS TO NAVIGABLE WATERS.

OWNER - COLONY POINT H.O.A.
AGENT -
BEAM & ASSOCIATES
P.O. BOX 11863
COLUMBIA, SC 29211-1863
PHONE: (803) 931-0805

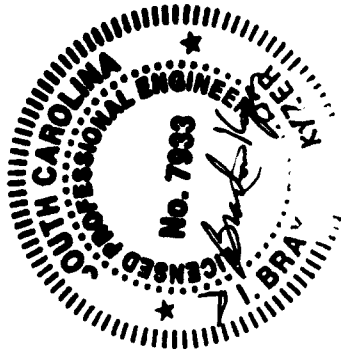
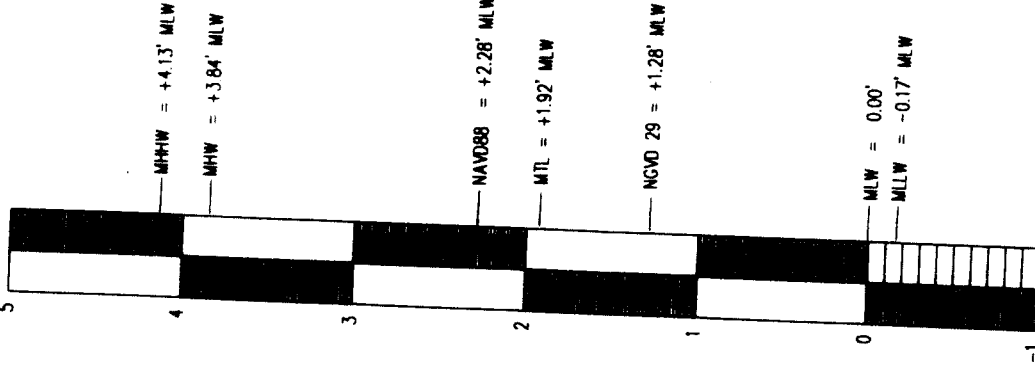

FOR PERMITTING ONLY - DO NOT USE FOR CONSTRUCTION

SEE ENLARGED VIEW #5 - PAGE 9

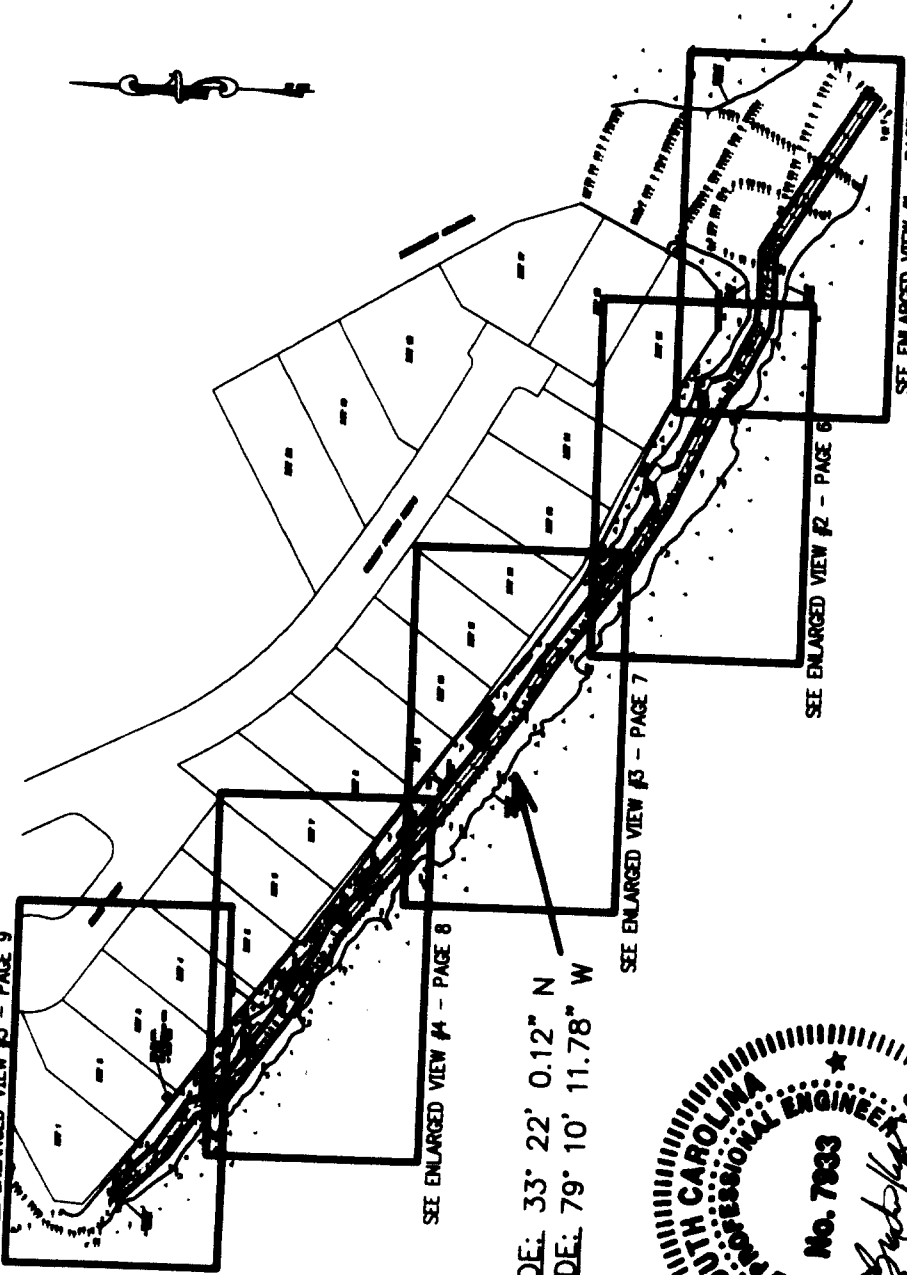

LATITUDE: 33° 22' 0.12" N
 LONGITUDE: 79° 10' 11.78" W

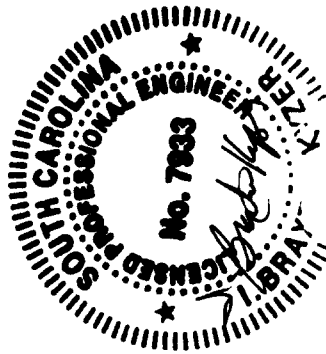

GRAPHIC SCALE 1" = 200'

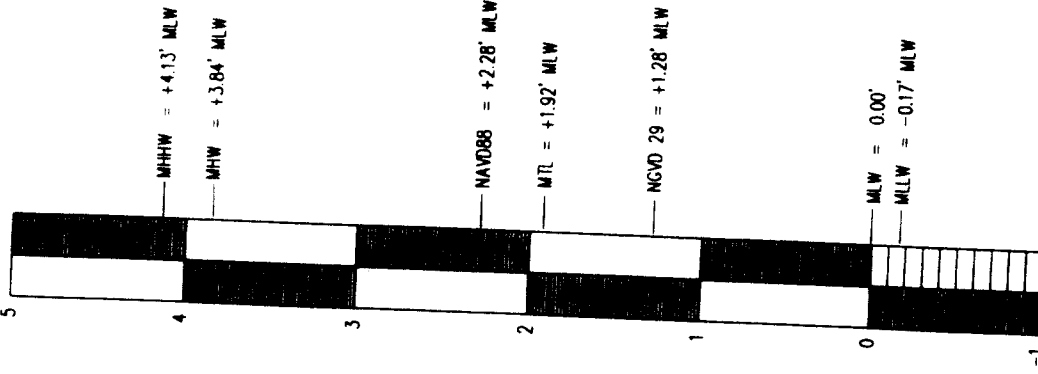

DATUM RELATIONSHIPS

PROPOSED NEW CHANNEL LAYOUT SITE PLAN & KEY SHEET

PROJECT NAME: COLONY POINT H.O.A.

CITY/TOWN: DEBORDEU COLONY

RIVER/WATER BODY: DEBORDEU CREEK

COUNTY: GEORGETOWN

STATE: S.C.

DATE: 11/08/06

PROPOSED ACTIVITY:

DREDGE CREEK TO -2.5' MLW TO PROVIDE ADJACENT PROPERTY OWNERS WITH IMPROVED ACCESS TO NAVIGABLE WATERS.

OWNER: COLONY POINT H.O.A.

AGENT:

BEAM & ASSOCIATES

P.O. BOX 11863

COLUMBIA, SC 29211-1863

PHONE: (803) 931-0805

PAGE: 4 OF 13

SCALE: 1" = 200'

FOR PERMITTING ONLY - DO NOT USE FOR CONSTRUCTION

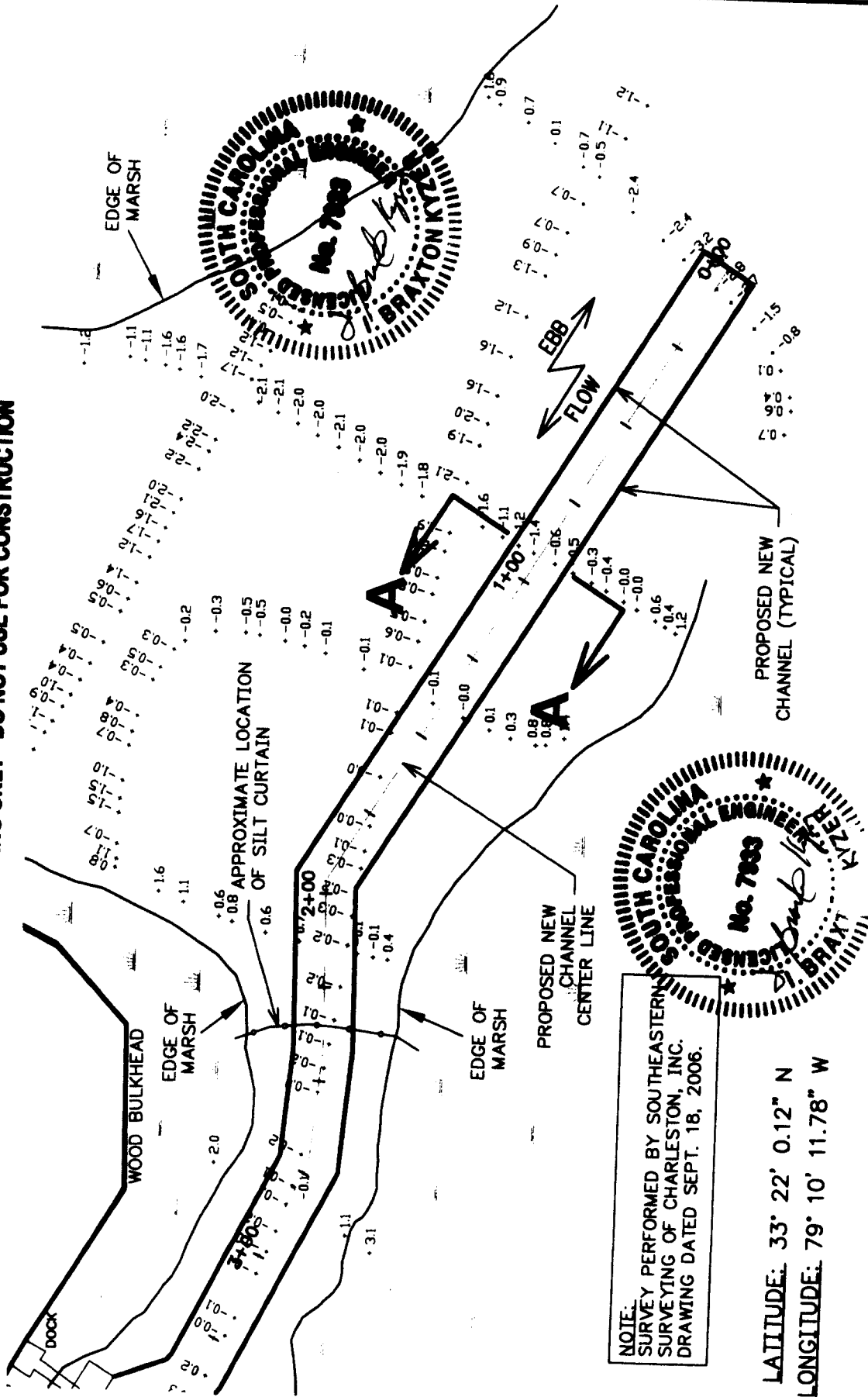

ENLARGED VIEW #1

PROPOSED NEW CHANNEL LAYOUT PLAN

GRAPHIC SCALE 1" = 40'

NOTE:
 SURVEY PERFORMED BY SOUTHEASTERN
 SURVEYING OF CHARLESTON, INC.
 DRAWING DATED SEPT. 18, 2006.

LATITUDE: 33° 22' 0.12" N
 LONGITUDE: 79° 10' 11.78" W

PROJECT NAME - COLONY POINT H.O.A.		OWNER - COLONY POINT H.O.A.	
CITY/TOWN - DEBORDEU COLONY		AGENT -	
RIVER/WATER BODY - DEBORDEU CREEK		BEAM & ASSOCIATES	
COUNTY - GEORGETOWN		P.O. BOX 11863	
STATE - S.C.		COLUMBIA, SC 29211-1863	
DATE - 11/08/06		PHONE: (803) 931-0805	
PAGE - 5 OF 13		SCALE - 1" = 40'	
PROPOSED ACTIVITY -		PROPOSED ACTIVITY -	
DREDGE CREEK TO -2.5' MLW TO PROVIDE		DREDGE CREEK TO -2.5' MLW TO PROVIDE	
ADJACENT PROPERTY OWNERS WITH IMPROVED		ADJACENT PROPERTY OWNERS WITH IMPROVED	
ACCESS TO NAVIGABLE WATERS.		ACCESS TO NAVIGABLE WATERS.	

FOR PERMITTING ONLY - DO NOT USE FOR CONSTRUCTION

LOT 16

LOT 15

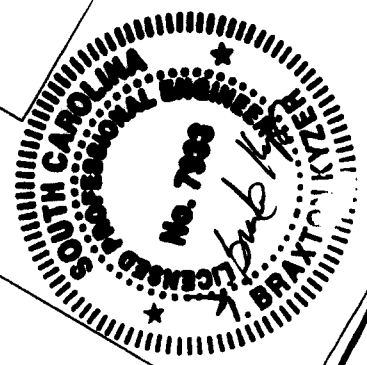
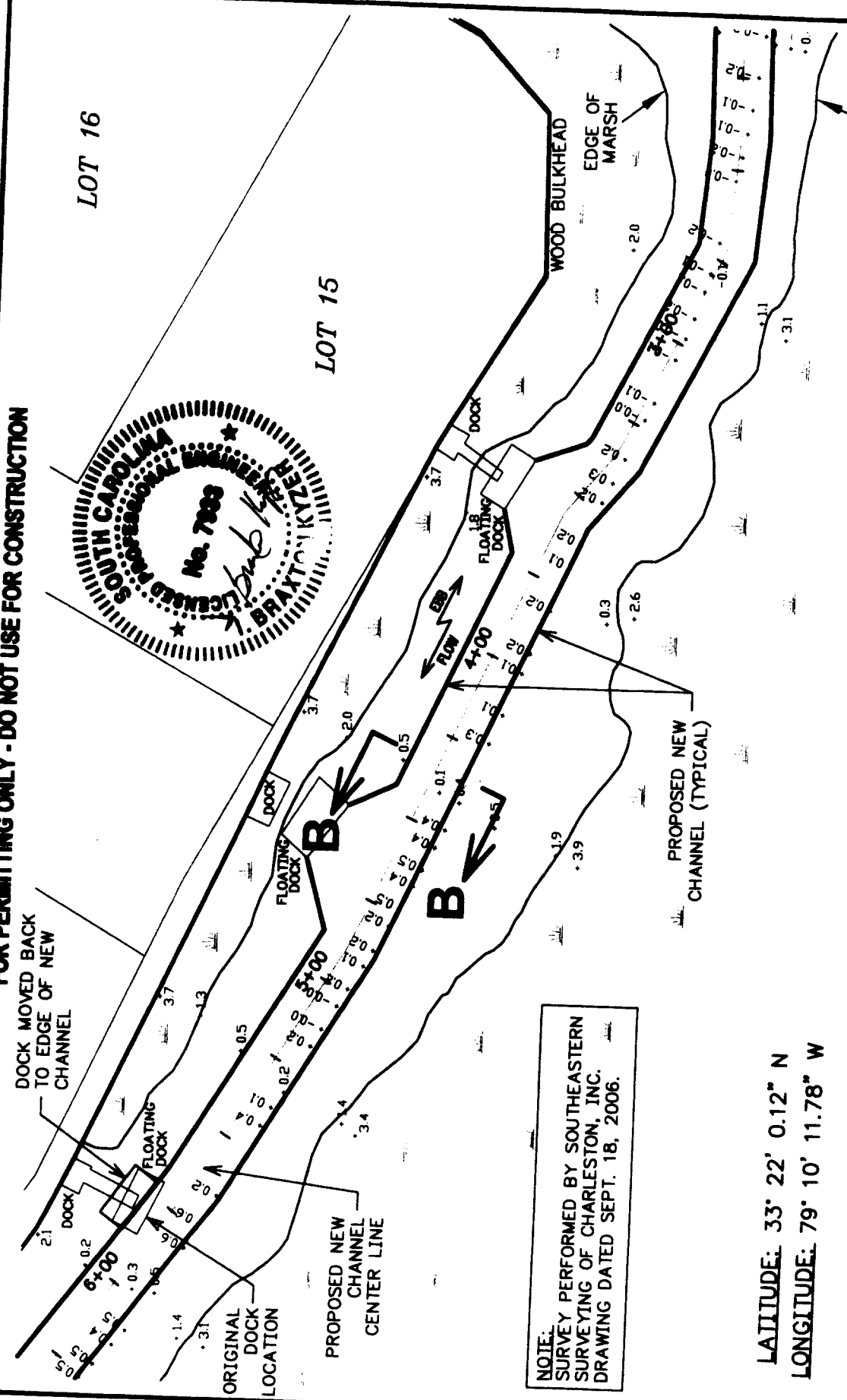

NOTE:
 SURVEY PERFORMED BY SOUTHEASTERN
 SURVEYING OF CHARLESTON, INC.
 DRAWING DATED SEPT. 18, 2006.

LATITUDE: 33° 22' 0.12" N
 LONGITUDE: 79° 10' 11.78" W

ENLARGED VIEW #2

PROPOSED NEW CHANNEL LAYOUT PLAN



PROJECT NAME - COLONY POINT H.O.A.		OWNER - COLONY POINT H.O.A.	
CITY/TOWN - DEBORJIEU COLONY		AGENT -	
RIVER/WATER BODY - DEBORJIEU CREEK		BEAM & ASSOCIATES	
DATE - 11/08/06		P.O. BOX 11863	
COUNTRY - GEORGETOWN		COLUMBIA, SC 29211-1863	
STATE - S.C.		PHONE: (803) 931-0805	
PAGE - 6 OF 13		SCALE - 1" = 40'	
PROPOSED ACTIVITY - DREDGE CREEK TO -2.5' MLW TO PROVIDE ADJACENT PROPERTY OWNERS WITH IMPROVED ACCESS TO NAVIGABLE WATERS.			

FOR PERMITTING ONLY - DO NOT USE FOR CONSTRUCTION



LOT 9

LOT 10

LOT 11

LOT 12

LOT 13

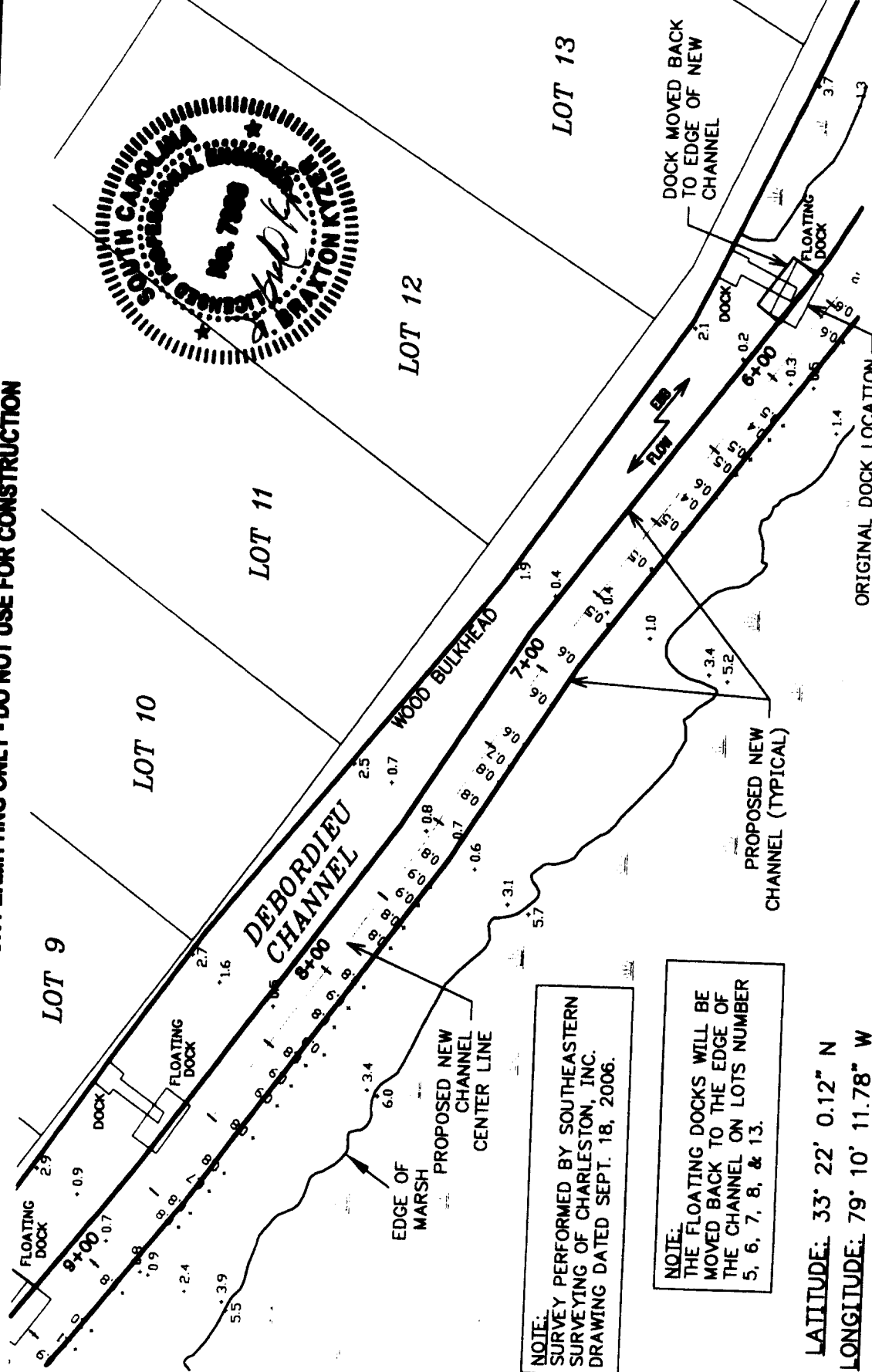

NOTE: SURVEY PERFORMED BY SOUTHEASTERN SURVEYING OF CHARLESTON, INC. DRAWING DATED SEPT. 18, 2006.

NOTE: THE FLOATING DOCKS WILL BE MOVED BACK TO THE EDGE OF THE CHANNEL ON LOTS NUMBER 5, 6, 7, 8, & 13.

LATITUDE: 33° 22' 0.12" N
LONGITUDE: 79° 10' 11.78" W

ENLARGED VIEW #3
PROPOSED NEW CHANNEL LAYOUT PLAN

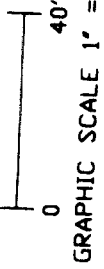

PROJECT NAME - COLONY POINT H.O.A.		OWNER - COLONY POINT H.O.A.	
CITY/TOWN - DEBORDIEU COLONY		AGENT -	
RIVER/WATER BODY - DEBORDIEU CREEK		BEAM & ASSOCIATES	
COUNTY - GEORGETOWN		P.O. BOX 11863	
STATE - S.C.		COLUMBIA, SC 29211-1863	
DATE - 11/08/06		PHONE - (803) 931-0805	
PROPOSED ACTIVITY - DREDGE CREEK TO -2.5' MLW TO PROVIDE ADJACENT PROPERTY OWNERS WITH IMPROVED ACCESS TO NAVIGABLE WATERS.		SCALE - 1" = 40'	
PAGE - 7 OF 13		GRAPHIC SCALE 1" = 40'	

FOR PERMITTING ONLY - DO NOT USE FOR CONSTRUCTION

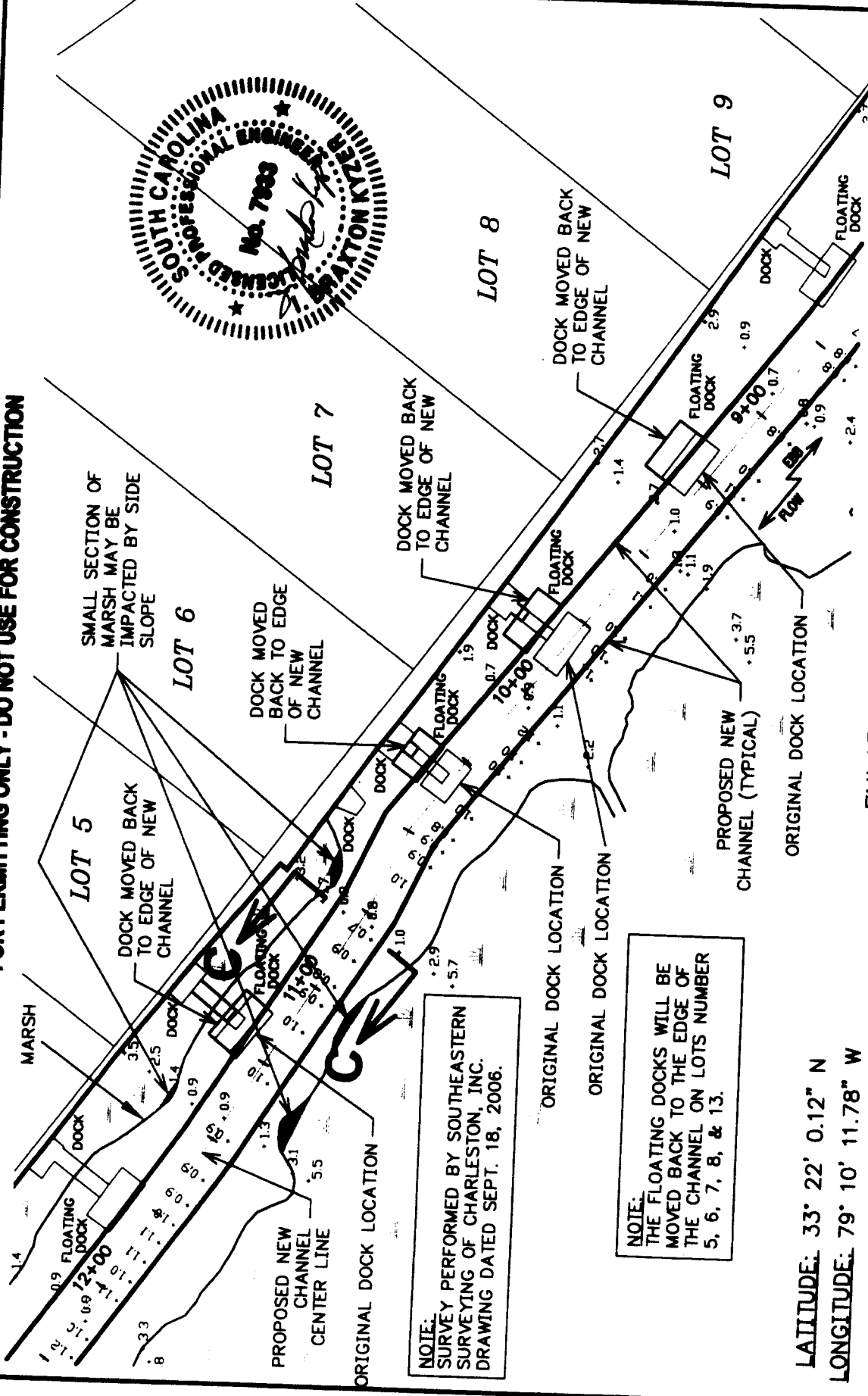
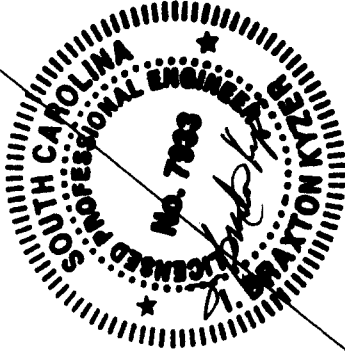

ENLARGED VIEW #4

PROPOSED NEW CHANNEL LAYOUT PLAN

LATITUDE: 33° 22' 0.12" N
LONGITUDE: 79° 10' 11.78" W

NOTE:
SURVEY PERFORMED BY SOUTHEASTERN SURVEYING OF CHARLESTON, INC. DRAWING DATED SEPT. 18, 2006.

NOTE:
THE FLOATING DOCKS WILL BE MOVED BACK TO THE EDGE OF THE CHANNEL ON LOTS NUMBER 5, 6, 7, 8, & 13.

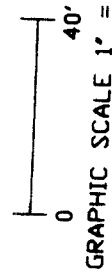

PROJECT NAME - COLONY POINT H.O.A.		OWNER - COLONY POINT H.O.A.	
CITY/TOWN - DEBORDEU COLONY		AGENT - BEAM & ASSOCIATES	
RIVER/WATER BODY - DEBORDEU CREEK		P.O. BOX 11863	
COUNTY - GEORGETOWN		COLUMBIA, SC 29211-1863	
DATE - 11/08/06		PHONE: (803) 931-0805	
PROPOSED ACTIVITY - DREDGE CREEK TO -2.5' MLW TO PROVIDE ADJACENT PROPERTY OWNERS WITH IMPROVED ACCESS TO NAVIGABLE WATERS.		SCALE - 1" = 40'	
STATE - S.C.		PAGE - 8 OF 13	

FOR PERMITTING ONLY - DO NOT USE FOR CONSTRUCTION

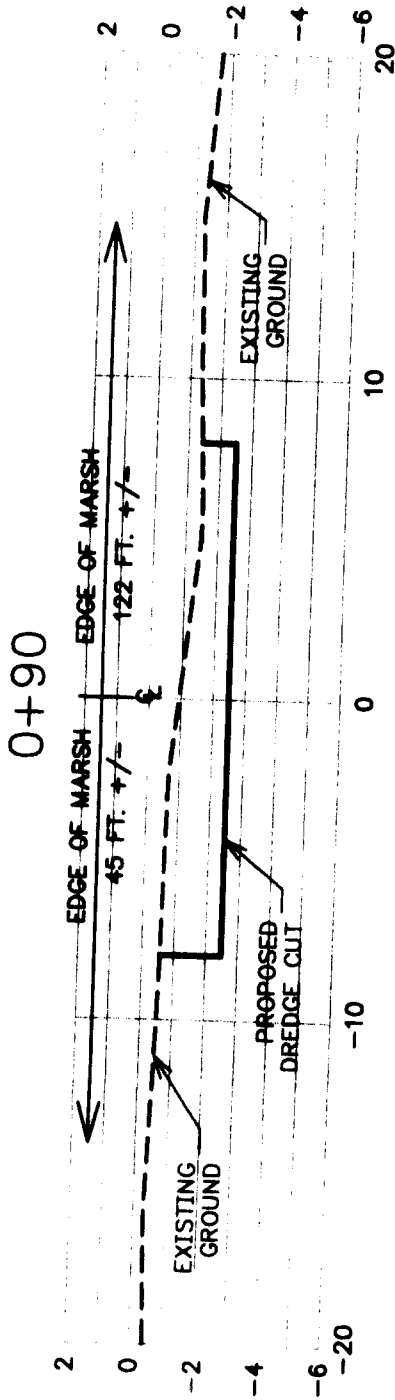

SECTION A-A

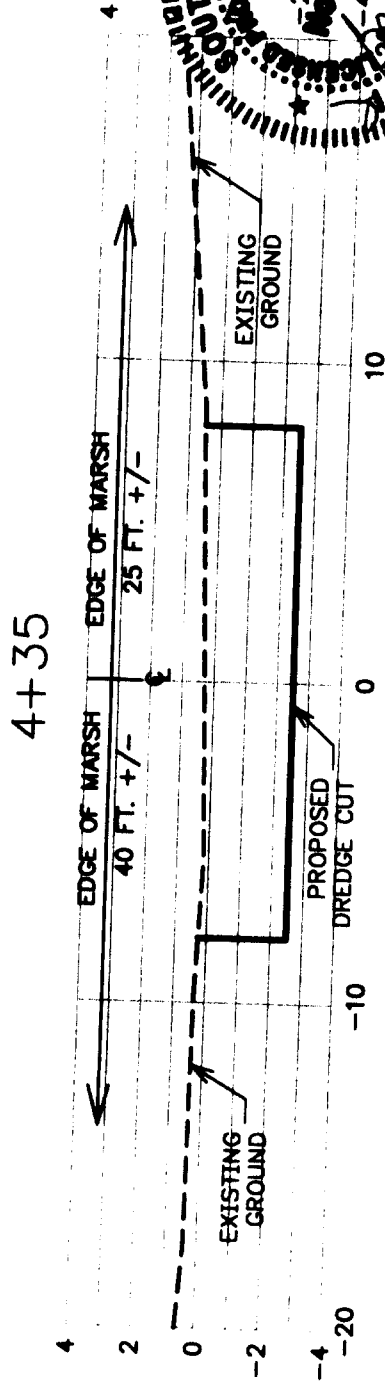

SECTION B-B

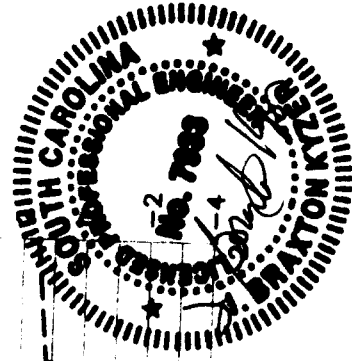

PROPOSED NEW CHANNEL SECTIONS

LATITUDE: 33° 22' 0.12" N
 LONGITUDE: 79° 10' 11.78" W

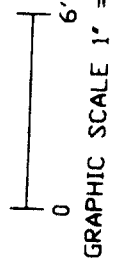

PROJECT NAME: COLONY POINT H.O.A.

CITY/TOWN: DEBORDEU COLONY

RIVER/WATER BODY: DEBORDEU CREEK

COUNTY: GEORGETOWN

STATE: S.C.

PROPOSED ACTIVITY:

DREDGE CREEK TO -2.5' MLW TO PROVIDE
 ADJACENT PROPERTY OWNERS WITH IMPROVED
 ACCESS TO NAVIGABLE WATERS.

OWNER: COLONY POINT H.O.A.

AGENT:

BEAM & ASSOCIATES

P.O. BOX 11863

COLUMBIA, SC 29211-1863

PHONE: (803) 931-0805

DATE: 11/08/06

PAGE: 10 OF 13

SCALE: 1" = 6'

FOR PERMITTING ONLY - DO NOT USE FOR CONSTRUCTION

10+75

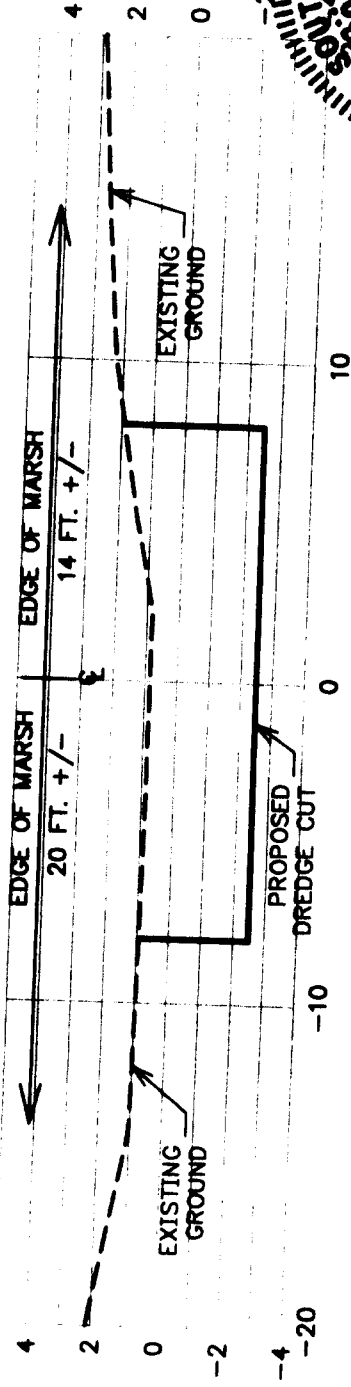

SECTION C-C

13+50

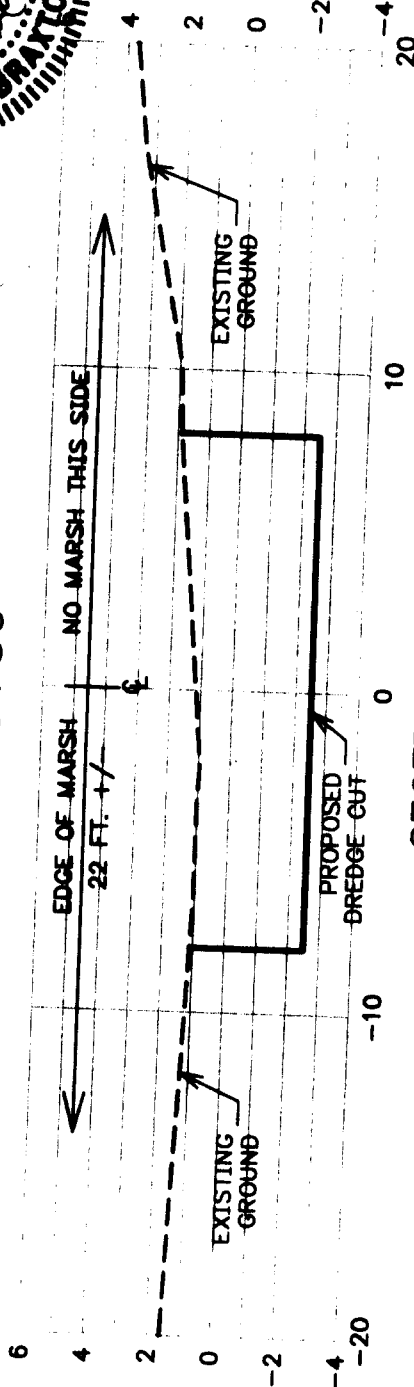

SECTION D-D

PROPOSED NEW CHANNEL SECTIONS

LATITUDE: 33° 22' 0.12" N
LONGITUDE: 79° 10' 11.78" W

PROJECT NAME: COLONY POINT H.O.A.

CITY/TOWN: DEBORDEU COLONY

RIVER/WATER BODY: DEBORDEU CREEK

COUNTY: GEORGETOWN

STATE: S.C.

DATE: 11/08/06

PROPOSED ACTIVITY: DREDGE CREEK TO -2.5' MLW TO PROVIDE ADJACENT PROPERTY OWNERS WITH IMPROVED ACCESS TO NAVIGABLE WATERS.

PAGE: 11 OF 13

SCALE: 1" = 6'

OWNER: COLONY POINT H.O.A.

AGENT: BEAM & ASSOCIATES

P.O. BOX 11863

COLUMBIA, SC 29211-1863

PHONE: (803) 931-0805

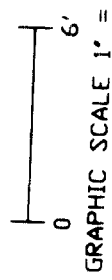
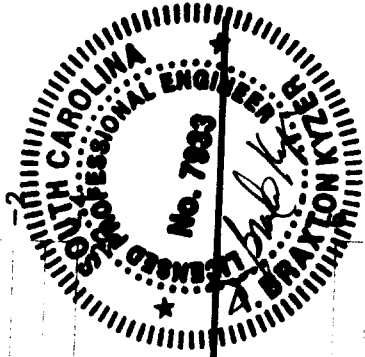

FOR PERMITTING ONLY - DO NOT USE FOR CONSTRUCTION

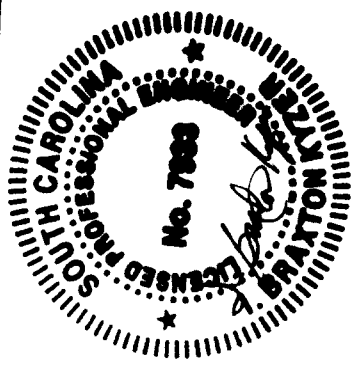

TYPICAL SECTION

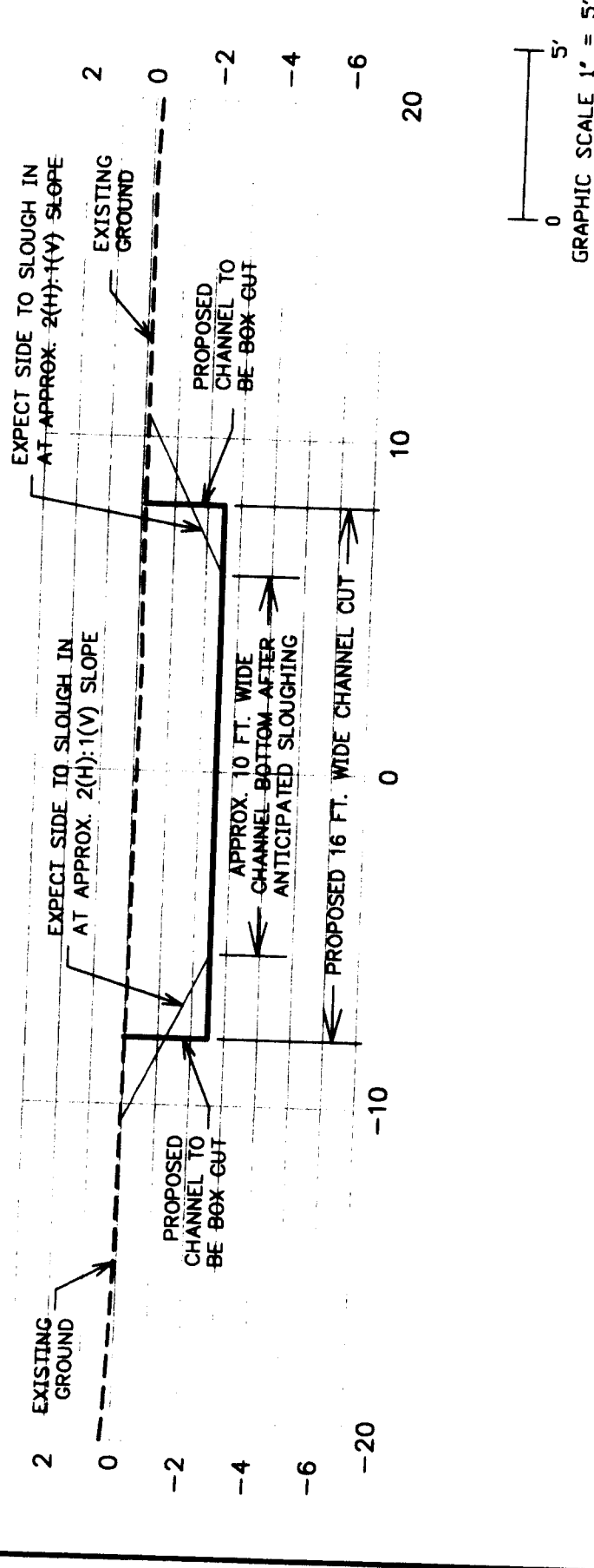

PROPOSED NEW CHANNEL TYPICAL SECTION

LATITUDE: 33° 22' 0.12" N
 LONGITUDE: 79° 10' 11.78" W

PROJECT NAME - COLONY POINT H.O.A.
 CITY/TOWN - DEBORDEU COLONY
 RIVER/WATER BODY - DEBORDEU CREEK COUNTY - GEORGETOWN STATE - S.C.
 DATE - 11/08/06

PROPOSED ACTIVITY -
 DREDGE CREEK TO -2.5' MLW TO PROVIDE
 ADJACENT PROPERTY OWNERS WITH IMPROVED
 ACCESS TO NAVIGABLE WATERS.
 PAGE - 12 OF 13 SCALE - 1" = 5'

OWNER - COLONY POINT H.O.A.
 AGENT -
 BEAM & ASSOCIATES
 P.O. BOX 11863
 COLUMBIA, SC 29211-1863
 PHONE: (803) 931-0805

FOR PERMITTING ONLY - DO NOT USE FOR CONSTRUCTION

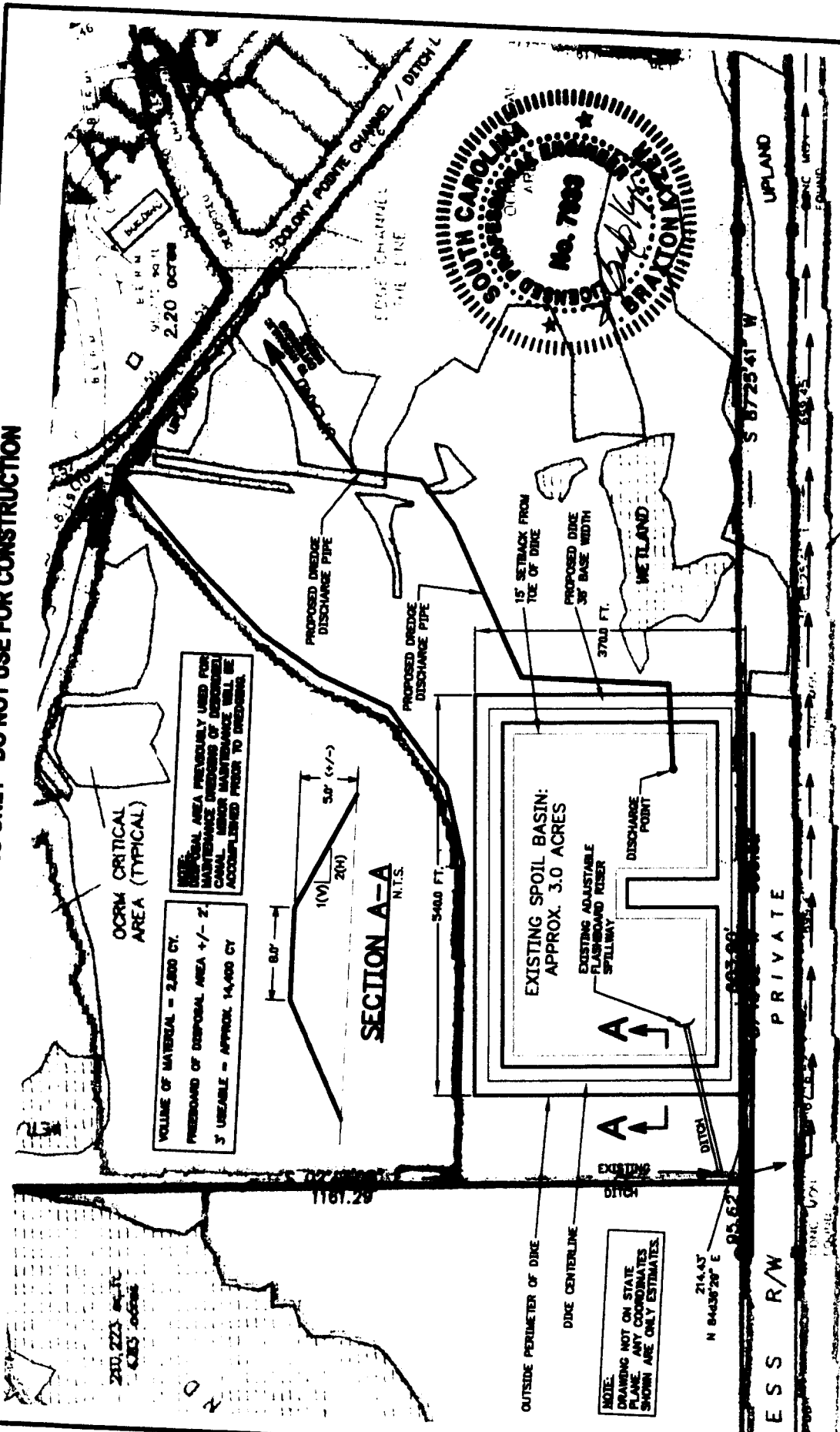

VOLUME OF MATERIAL = 2,800 CY.
 FREEDOM OF DISPOSAL AREA +/- 2'.
 5' USABLE = APPROX 14,400 CY.

CRITICAL AREA PREVIOUSLY USED FOR MAINTENANCE OPERATIONS OF DEBRIDED CANAL. MINOR MAINTENANCE WILL BE ACCOMPLISHED PRIOR TO DREDGING.

SECTION A-A
 N.T.S.

NOTE:
 DRAWING NOT ON STATE PLANE. ANY COORDINATES SHOWN ARE ONLY ESTIMATES.

PROPOSED DREDGE MATERIAL DISPOSAL AREA

LATITUDE: 33° 22' 0.12" N
 LONGITUDE: 79° 10' 11.78" W

PROJECT NAME: COLONY POINT H.O.A.

CITY/TOWN: DEBORDEU COLONY
 RIVER/WATER BODY: DEBORDEU CREEK

COUNTY: GEORGETOWN STATE: S.C.

DATE: 11/08/06

PROPOSED ACTIVITY -
 DREDGE CREEK TO -2.5' MLW TO PROVIDE ADJACENT PROPERTY OWNERS WITH IMPROVED ACCESS TO NAVIGABLE WATERS.

OWNER: COLONY POINT H.O.A.
 AGENT: BEAM & ASSOCIATES
 P.O. BOX 11863
 COLUMBIA, SC 29211-1863
 PHONE: (803) 931-0805

PAGE: 13 OF 13 SCALE: 1" = 200'