

JOINT
PUBLIC NOTICE

CHARLESTON DISTRICT, CORPS OF ENGINEERS
69A Hagood Avenue
Charleston, South Carolina 29403-5107

and

THE S.C. DEPARTMENT OF HEALTH AND ENVIRONMENTAL CONTROL
Office of Environmental Quality Control
Water Quality Certification and Wetlands Programs Section
2600 Bull Street
Columbia, South Carolina 29201

REGULATORY DIVISION

Refer to: P/N # SAC 2007-1528-DIR

July 20, 2007

Pursuant to Sections 401 and 404 of the Clean Water Act (33 U.S.C. 1344), and the South Carolina Coastal Zone Management Act (48-39-10 et.seq.), an application has been submitted to the Department of the Army and the S.C. Department of Health and Environmental Control by

SOUTH CAROLINA DEPARTMENT OF TRANSPORTATION
P.O. BOX 191
COLUMBIA, SOUTH CAROLINA 29202

for a permit to place fill material in wetlands adjacent and contiguous to

Drayton Swamp and Edisto River

along S-163 (Summers Road) and S-137 (Parkers Ferry Road) in Dorchester County, South Carolina (Latitude 32.8678° N, Longitude 80.3850).

In order to give all interested parties an opportunity to express their views

NOTICE

is hereby given that written statements regarding the proposed work will be received by both of the above mentioned offices until

12 O'CLOCK NOON, MONDAY, AUGUST 20, 2007

from those interested in the activity and whose interests may be affected by the proposed work.

The proposed work consists of improving the safety of 3.629 miles of the existing two lane roadway by paving two 11-foot-wide travel lanes and adding 2-foot-wide paved and 4-foot-wide grassed shoulders on each side. In detail, the proposed project requires permanent impacts to a total of 5.529 acres of wetlands by a volume of 12,938 cubic yards of fill. Roadway embankment side slopes are shown as typically 4:1 along the length of the project, including in the areas of wetland crossings. The applicant maintains that the use of steeper side slopes would require that the slopes be widened (pushed out) to accommodate the installation of guardrail for safety reasons related to fill slope height. Mitigation for impacts will be provided within the Black River Mitigation Bank. The project purpose, as stated by the applicant, is to improve safety on S-137 (Parkers Ferry Road) from the intersection of S-10-17 to the currently paved portion of S163 (Summers Road) near S-861 in Dorchester County.

REGULATORY DIVISION

Refer to: P/N # SAC 2007-1528-DIR

July 20, 2007

NOTE: Plans depicting the work described in this notice are available and will be provided, upon receipt of a written request, to anyone that is interested in obtaining a copy of the plans for the specific project. The request must identify the project of interest by public notice number and a self-addressed stamped envelope must also be provided for mailing the drawings to you. Your request for drawings should be addressed to the

**U.S. Army Corps of Engineers
ATTN: REGULATORY DIVISION
69A Hagood Avenue
Charleston, South Carolina 29403-5107.**

The District Engineer has concluded that the discharges associated with this project, both direct and indirect, should be reviewed by the South Carolina Department of Health and Environmental Control in accordance with provisions of Section 401 of the Clean Water Act. As such, this notice constitutes a request, on behalf of the applicant, for certification that this project will comply with applicable effluent limitations and water quality standards. The work shown on this application must also be certified as consistent with applicable provisions of the South Carolina Coastal Zone Management Act (15 CFR 930). The District Engineer will not process this application to a conclusion until such certifications are received. The applicant is hereby advised that supplemental information may be required by the State to facilitate the review. Persons wishing to comment or object to State certification must submit all comments in writing to the S.C. Department of Health and Environmental Control at the above address within thirty (30) days of the date of this notice.

This notice initiates the Essential Fish Habitat (EFH) consultation requirements of the Magnuson-Stevens Fishery Conservation and Management Act. Implementation of the proposed project would impact 5.4 acres of estuarine substrates and emergent wetlands utilized by various life stages of species comprising the red drum, shrimp, and snapper-grouper management complexes. Our initial determination is that the proposed action would not have a substantial individual or cumulative adverse impact on EFH or fisheries managed by the South Atlantic Fishery Management Council and the National Marine Fisheries Service (NMFS). Our final determination relative to project impacts and the need for mitigation measures is subject to review by and coordination with the NMFS.

The District Engineer has consulted the most recently available information and has determined that the proposed work is not likely to adversely affect Federally endangered, threatened, or proposed species. This public notice serves as a request to the U.S. Fish and Wildlife Service and the National Marine Fisheries Service for any additional information they may have on whether any listed or proposed endangered or threatened species and/or designated or proposed critical habitat may be present in the area which would be affected by the activity, pursuant to Section 7(c) of the Endangered Species Act of 1973 (as amended).

The District Engineer has consulted the latest published version of the National Register of Historic Places for the presence or absence of registered properties, or properties listed as being eligible for inclusion therein, and this worksite is not included as a registered property or property listed as being eligible for inclusion in the Register. Consultation of the National register constitutes the extent of cultural resource investigations by the District Engineer, and he is otherwise unaware of the presence of such resources. Presently unknown archaeological, scientific, prehistorical, or historical data may be lost or destroyed by the work to be accomplished under the requested permit.

Any person may request, in writing, within the comment period specified in this notice, that a public hearing be held to consider this application. Requests for a public hearing shall state, with particularity, the reasons for holding a public hearing.

The decision whether to issue a permit will be based on an evaluation of the probable impact including cumulative impacts of the activity on the public interest and will include application of the guidelines promulgated by the Administrator, Environmental Protection Agency (EPA), under authority of Section 404(b) of the Clean Water Act and, as appropriate, the criteria established under authority of Section 102 of the Marine Protection, Research and Sanctuaries Act of 1972, as amended. That decision will reflect the national concern for both protection and utilization of important resources. The benefit which reasonably may be expected to accrue from the project must be balanced against its reasonably foreseeable detriments. All factors which may be relevant to the project will be considered including the cumulative effects thereof; among those are conservation, economics, aesthetics, general environmental concerns, wetlands, historic properties, fish and wildlife values, flood hazards, flood plain values, land use, navigation, shoreline erosion and accretion, recreation, water supply and conservation, water quality, energy needs, safety, food and fiber production and, in general, the needs and welfare of the people. A permit will be granted unless the District Engineer determines that it would be contrary to the public interest. In cases of conflicting property rights, the Corps of Engineers cannot undertake to adjudicate rival claims.

The Corps of Engineers is soliciting comments from the public; Federal, state, and local agencies and officials; Indian tribes; and other interested parties in order to consider and evaluate the impacts of this activity. Any comments received will be considered by the Corps of Engineers to determine whether to issue, modify, condition or deny a permit for this project. To make this decision, comments are used to assess impacts on endangered species, historic properties, water quality, general environmental effects, and the other public interest factors listed above. Comments are used in the preparation of an Environmental Assessment and/or an Environmental Impact Statement pursuant to the National Environmental Policy Act. Comments are also used to determine the need for a public hearing and to determine the overall public interest of the activity.

If there are any questions concerning this public notice, please contact Richard Darden at 843-329-8044 or toll free at 1-866-329-8187.

VICINITY MAP

FROM: DORCHESTER COUNTY MAP 1969

APPROXIMATE LOCATION OF PROJECT IS:
LATITUDE 32° 52' 04" N
LONGITUDE 80° 23' 06" W

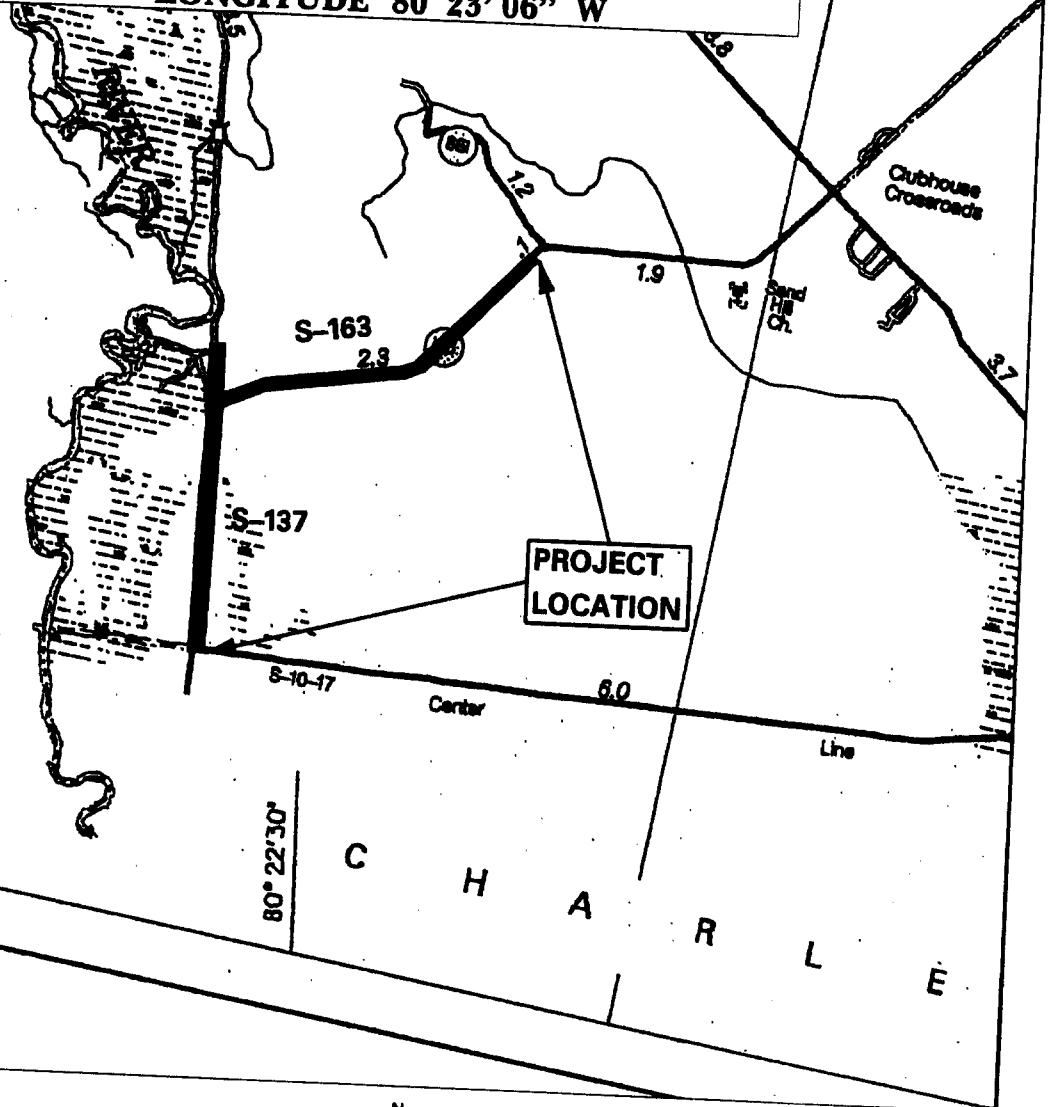

SHADED AREA INDICATES COUNTY LOCATON IN SC

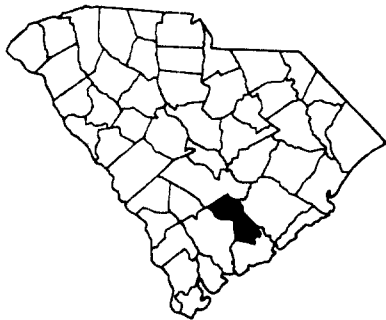

0 6000
SCALE  FEET

PIN 36090_SP01
PROPOSED WETLAND IMPACTS
S-137 PARKERS FERRY ROAD
S-163 SUMMERS ROAD
DORCHESTER COUNTY, SC
APPLICATION BY SCDOT
ELIGIBLE FOR FEDERAL FUNDS
DATE FEBRUARY 28, 2007
SHEET 1 OF 39

VICINITY MAP

FROM: USGS QUAD MAPS
CLUBC (1979) & COTTA (1980) & JACKB (1979) & OSBOR (1979)

APPROXIMATE LOCATION OF PROJECT IS:

LATITUDE $32^{\circ}52'04''$ N
LONGITUDE $80^{\circ}21'06''$ W

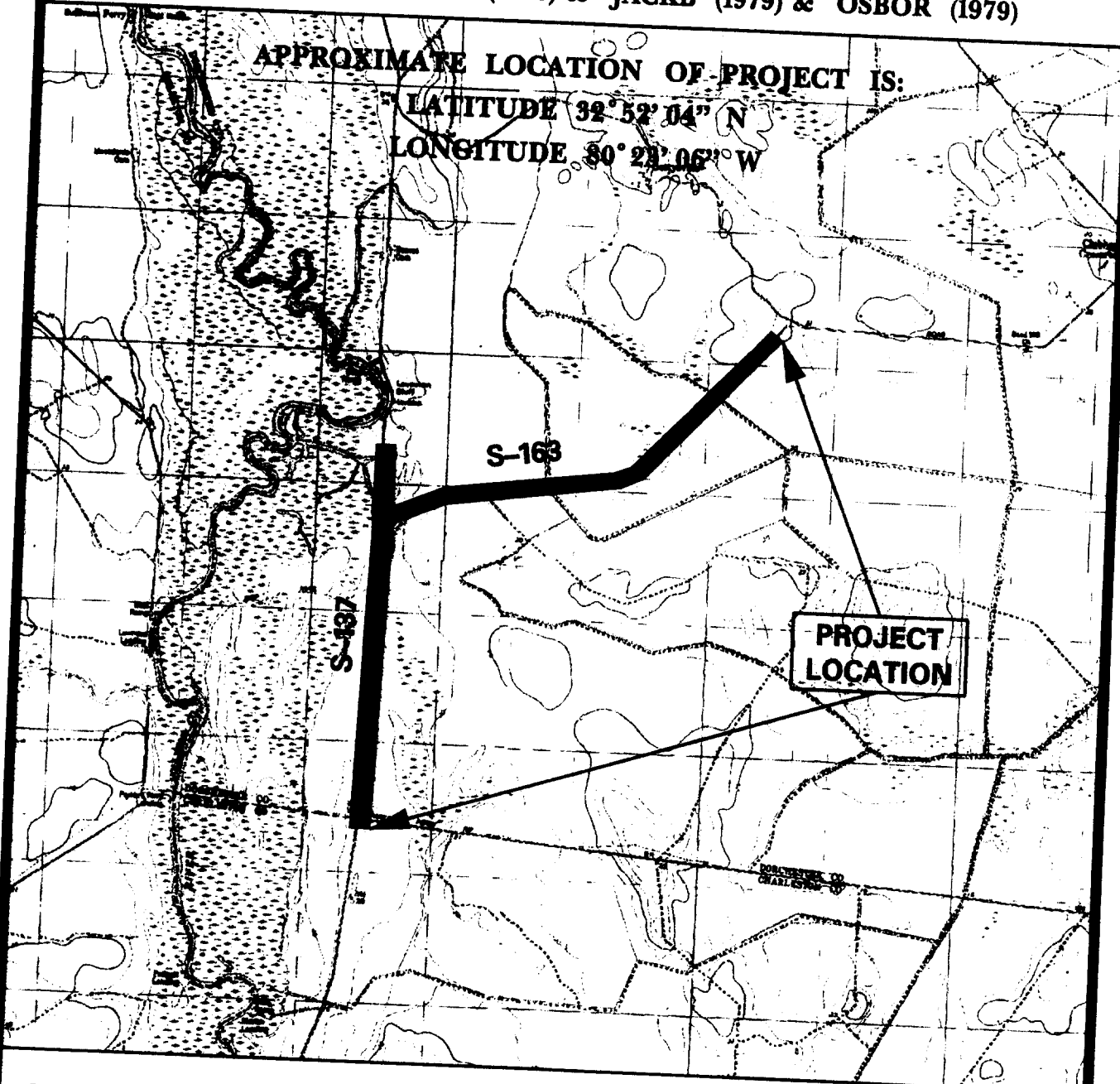

SHADED AREA INDICATES
COUNTY LOCATION IN SC

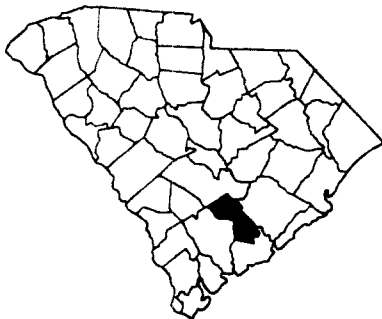

PIN 36090_SP01
PROPOSED WETLAND IMPACTS
S-137 PARKERS FERRY ROAD
S-163 SUMMERS ROAD
DORCHESTER COUNTY, SC
APPLICATION BY SCDOT
ELIGIBLE FOR FEDERAL FUNDS
DATE FEBRUARY 28, 2007
SHEET 2 OF 39

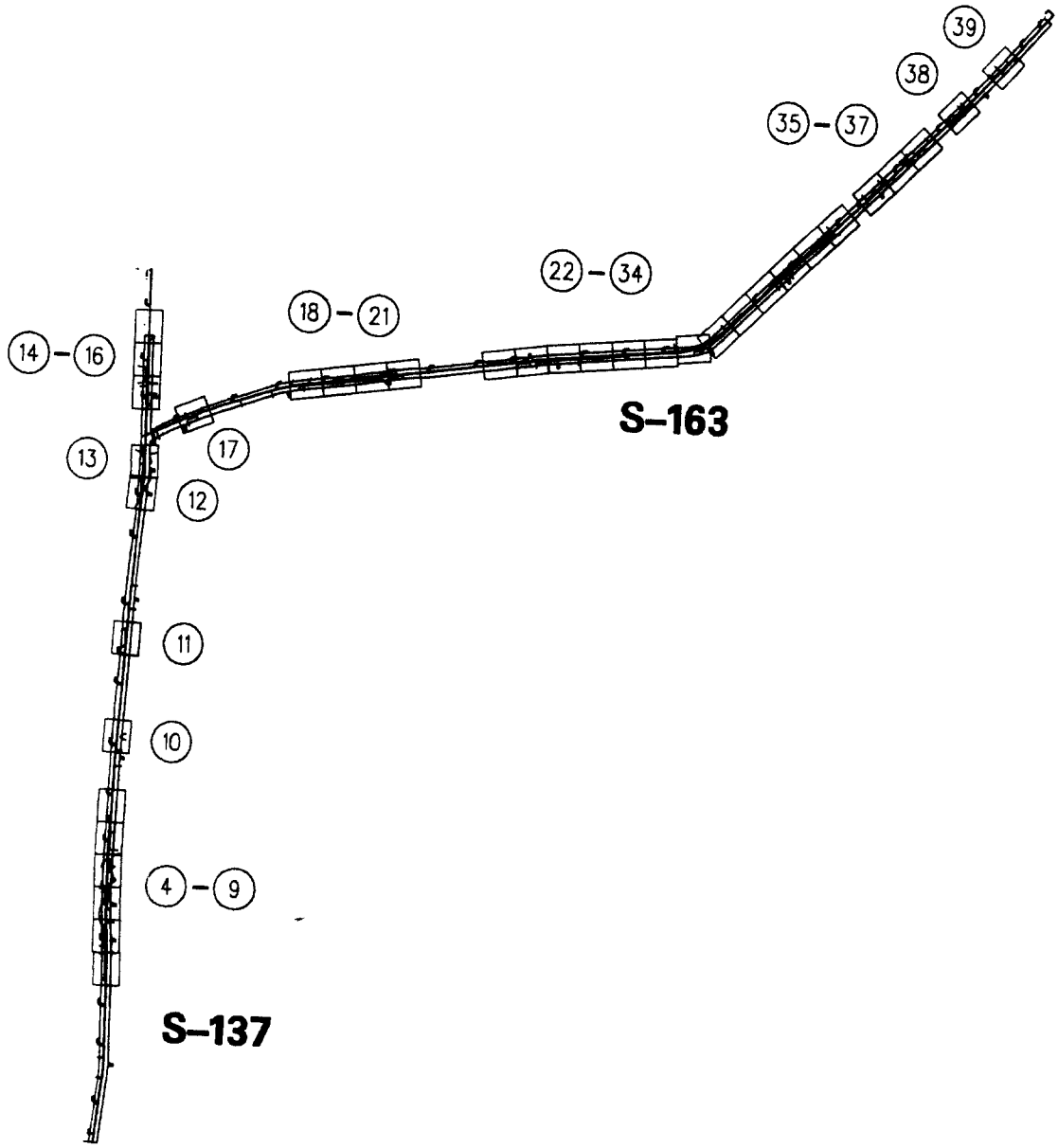

S-163

S-137



**PIN 36090_SP01
PROPOSED WETLAND IMPACTS
S-137 PARKERS FERRY ROAD
S-163 SUMMERS ROAD
DORCHESTER COUNTY, SC
APPLICATION BY SCDOT
ELIGIBLE FOR FEDERAL FUNDS
DATE FEBRUARY 28, 2007
SHEET 3 OF 39**

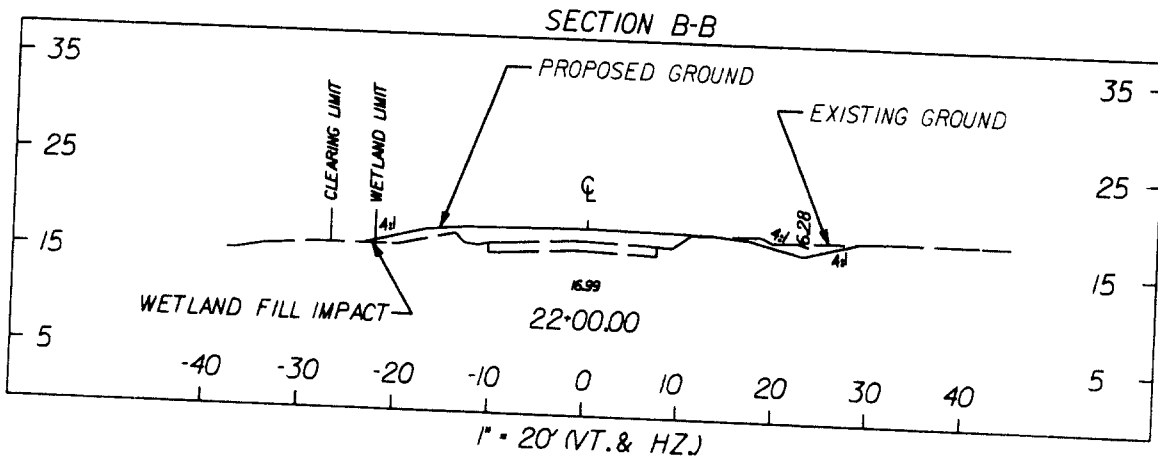
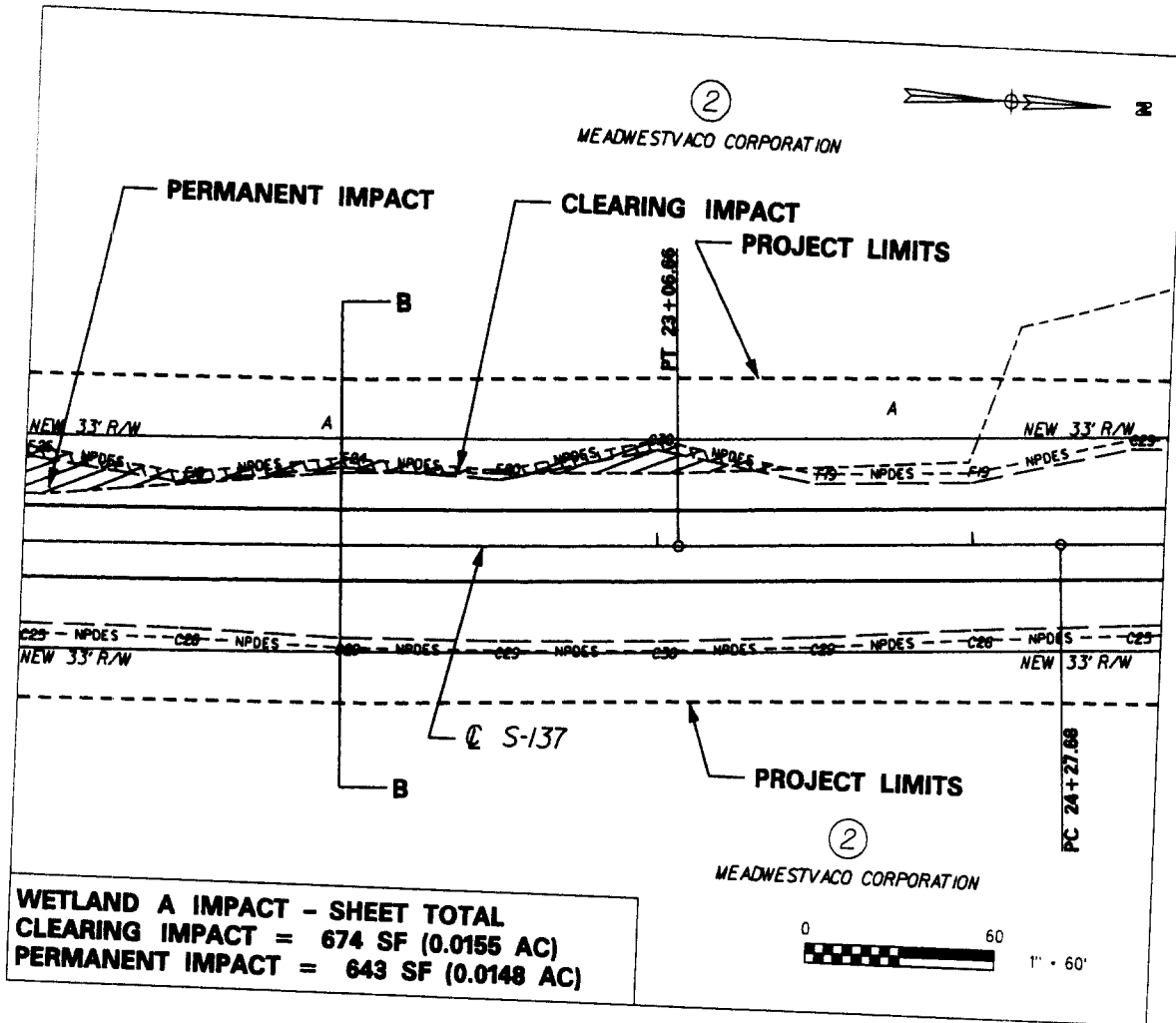

LEGEND

- WETLANDS LIMITS
- WETLANDS FILL IMPACT (TEMPORARY BETWEEN TOE OF SLOPE & NPDES)
- WETLANDS FILL IMPACT (PERMANENT)

TOTAL VOLUME OF IMPACT:
WETLAND "A" SEE SHEET 4

PIN 36090_SP01
WETLAND A
S-137 PARKERS FERRY ROAD
DORCHESTER COUNTY, SC
APPLICATION BY SCDOT
ELIGIBLE FOR FEDERAL FUNDS
DATE FEBRUARY 28, 2007
SHEET 5 OF 39

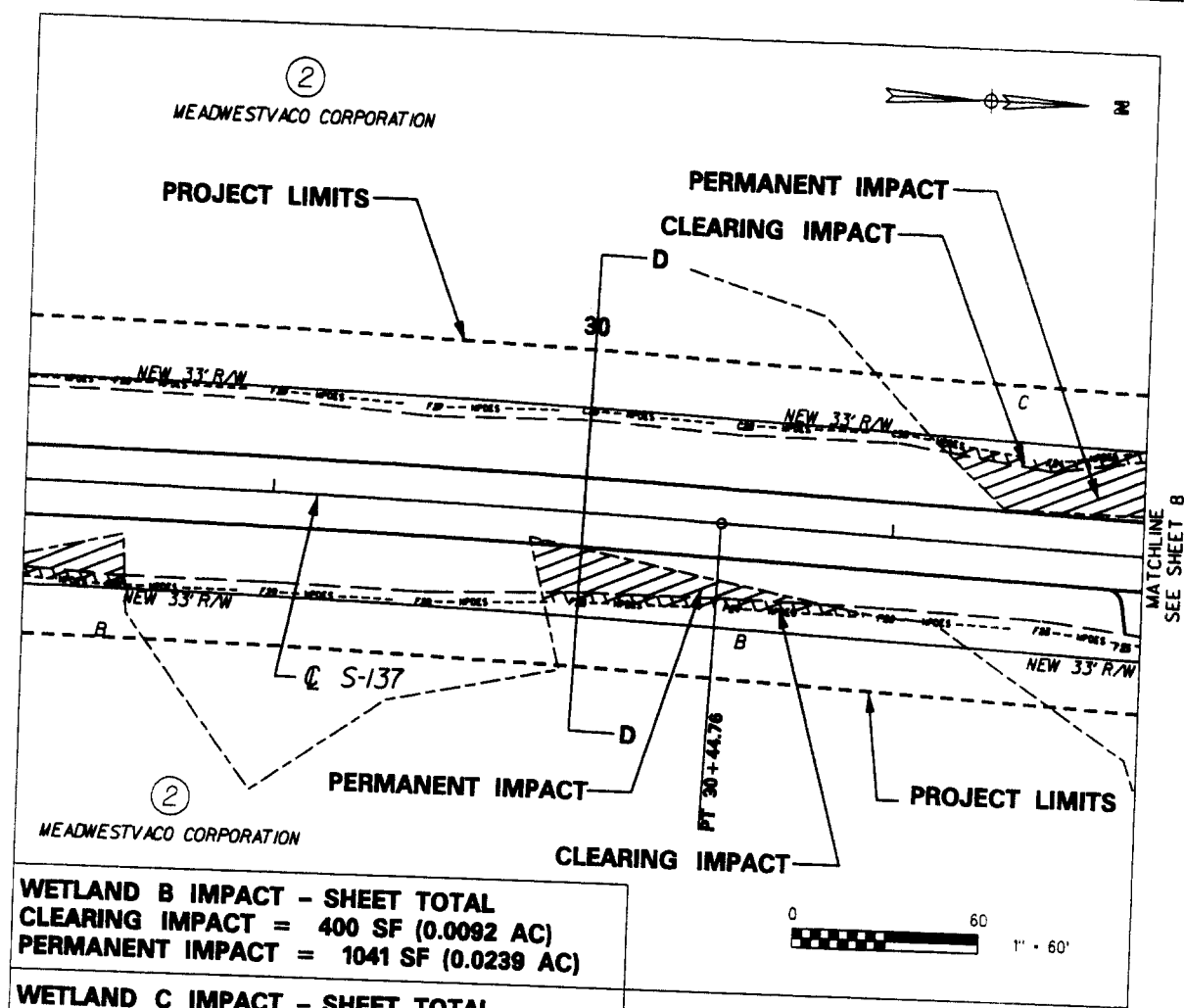

MATCHLINE
SEE SHEET B

WETLAND B IMPACT - SHEET TOTAL CLEARING IMPACT = 400 SF (0.0092 AC) PERMANENT IMPACT = 1041 SF (0.0239 AC)
WETLAND C IMPACT - SHEET TOTAL CLEARING IMPACT = 200 SF (0.0046 AC) PERMANENT IMPACT = 794 SF (0.0182 AC)

SECTION D-D

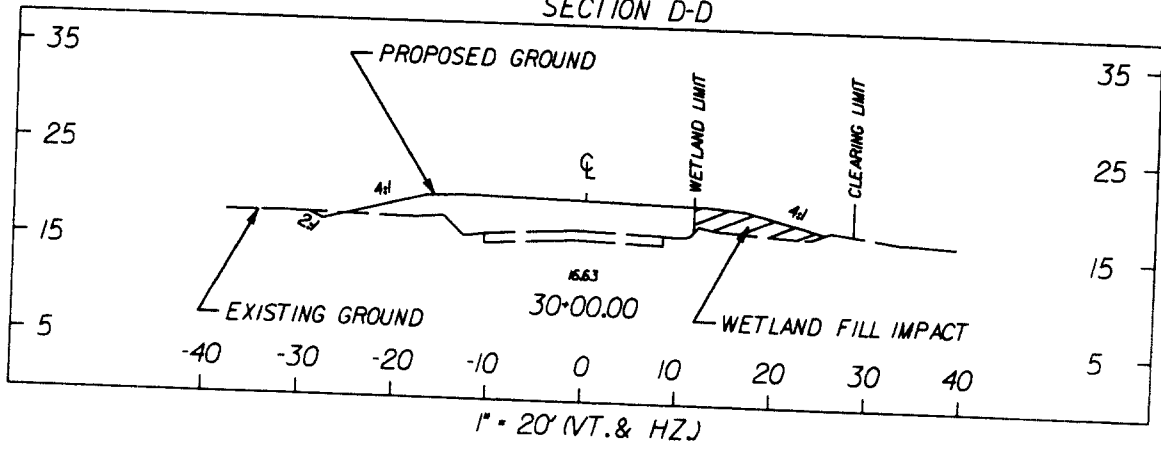

LEGEND

- WETLANDS LIMITS
- WETLANDS FILL IMPACT (TEMPORARY BETWEEN TOE OF SLOPE & NPDES)
- WETLANDS FILL IMPACT (PERMANENT)

TOTAL VOLUME OF IMPACT:
 WETLAND "B" SEE SHEET 6
 WETLAND "C" 419 CY FILL, 1 CY CUT

PIN 36090_SP01
WETLAND "B, C"
S-137 PARKERS FERRY ROAD
DORCHESTER COUNTY, SC
APPLICATION BY SCDOT
ELIGIBLE FOR FEDERAL FUNDS
DATE FEBRUARY 28, 2007
SHEET 7 OF 39

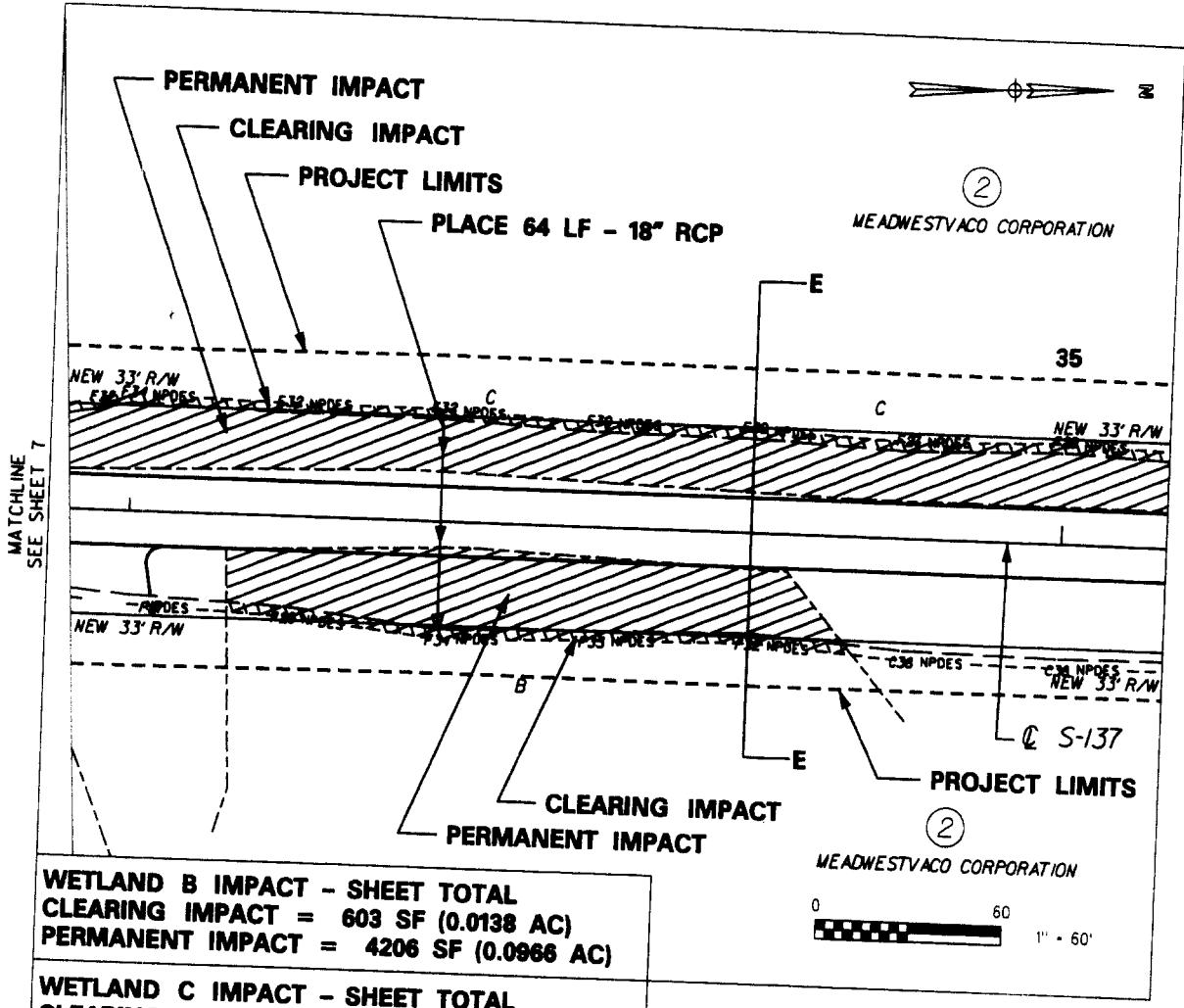

WETLAND B IMPACT - SHEET TOTAL
CLEARING IMPACT = 603 SF (0.0138 AC)
PERMANENT IMPACT = 4206 SF (0.0966 AC)
WETLAND C IMPACT - SHEET TOTAL
CLEARING IMPACT = 1065 SF (0.0244 AC)
PERMANENT IMPACT = 6013 SF (0.138 AC)

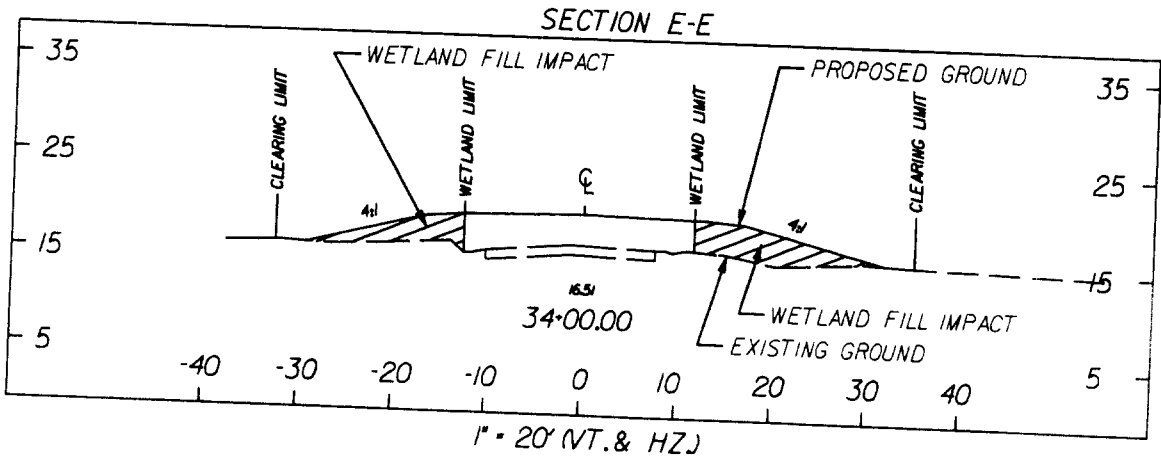
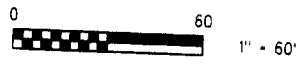

LEGEND

- WETLANDS LIMITS
- WETLANDS FILL IMPACT (TEMPORARY BETWEEN TOE OF SLOPE & NPDES)
- WETLANDS FILL IMPACT (PERMANENT)

TOTAL VOLUME OF IMPACT:
 WETLAND "B" SEE SHEET 6
 WETLAND "C" SEE SHEET 7

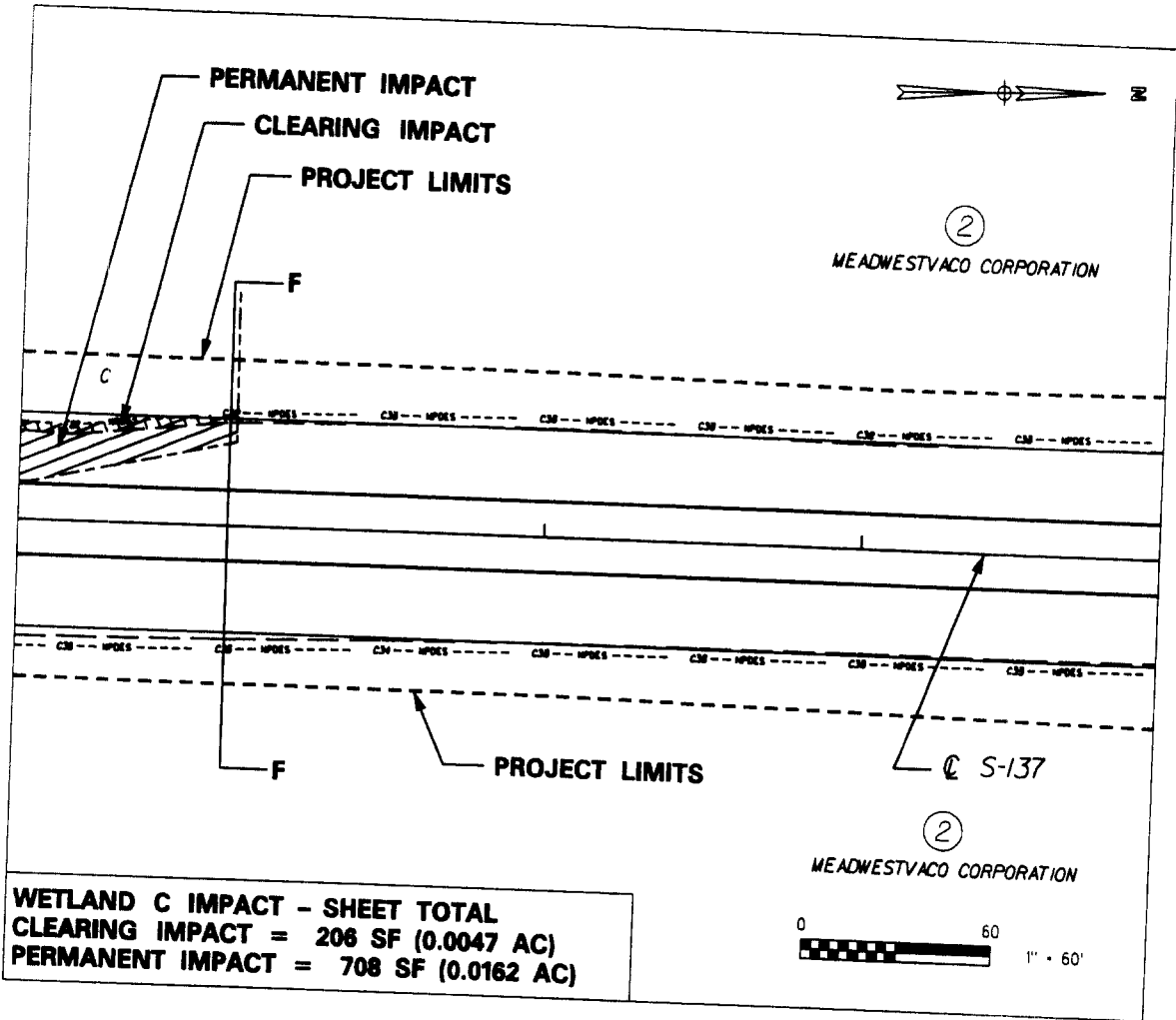

PIN 36090 SP01
WETLAND B, C
S-137 PARKERS FERRY ROAD
DORCHESTER COUNTY, SC
APPLICATION BY SCDOT
ELIGIBLE FOR FEDERAL FUNDS
DATE FEBRUARY 28, 2007
SHEET 8 OF 39

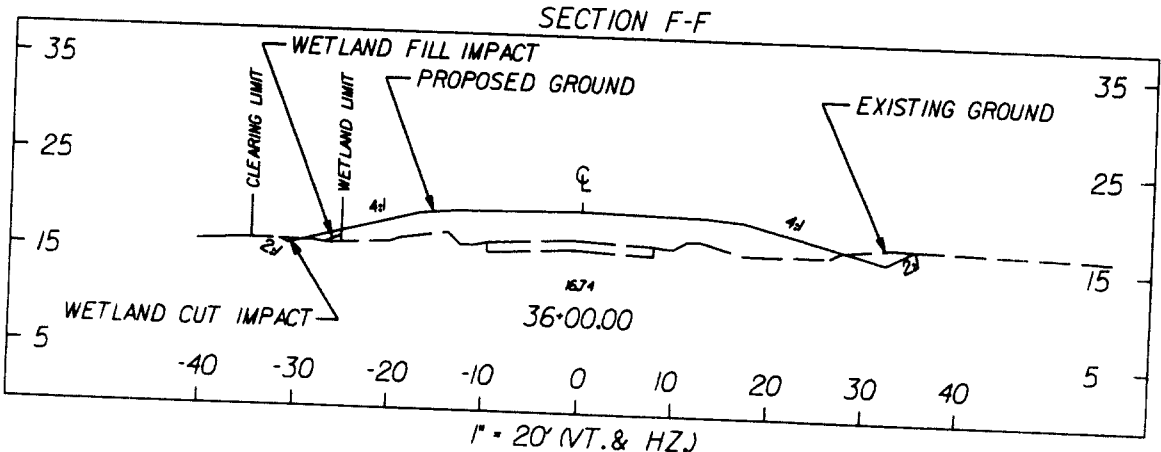

WETLAND C IMPACT - SHEET TOTAL
CLEARING IMPACT = 206 SF (0.0047 AC)
PERMANENT IMPACT = 708 SF (0.0162 AC)



LEGEND

- WETLANDS LIMITS
-  WETLANDS FILL IMPACT (TEMPORARY BETWEEN TOE OF SLOPE & NPDES)
-  WETLANDS FILL IMPACT (PERMANENT)

TOTAL VOLUME OF IMPACT:
 WETLAND 'C' SEE SHEET 7

PIN 36090_SP01
WETLAND C
S-137 PARKERS FERRY ROAD
DORCHESTER COUNTY, SC
APPLICATION BY SCDOT
ELIGIBLE FOR FEDERAL FUNDS
DATE FEBRUARY 28, 2007
SHEET 9 OF 39

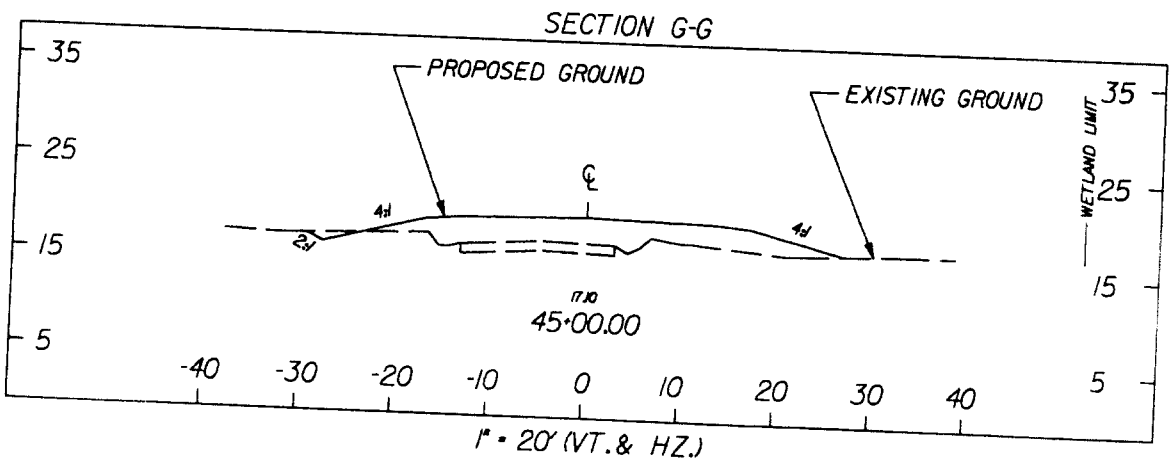
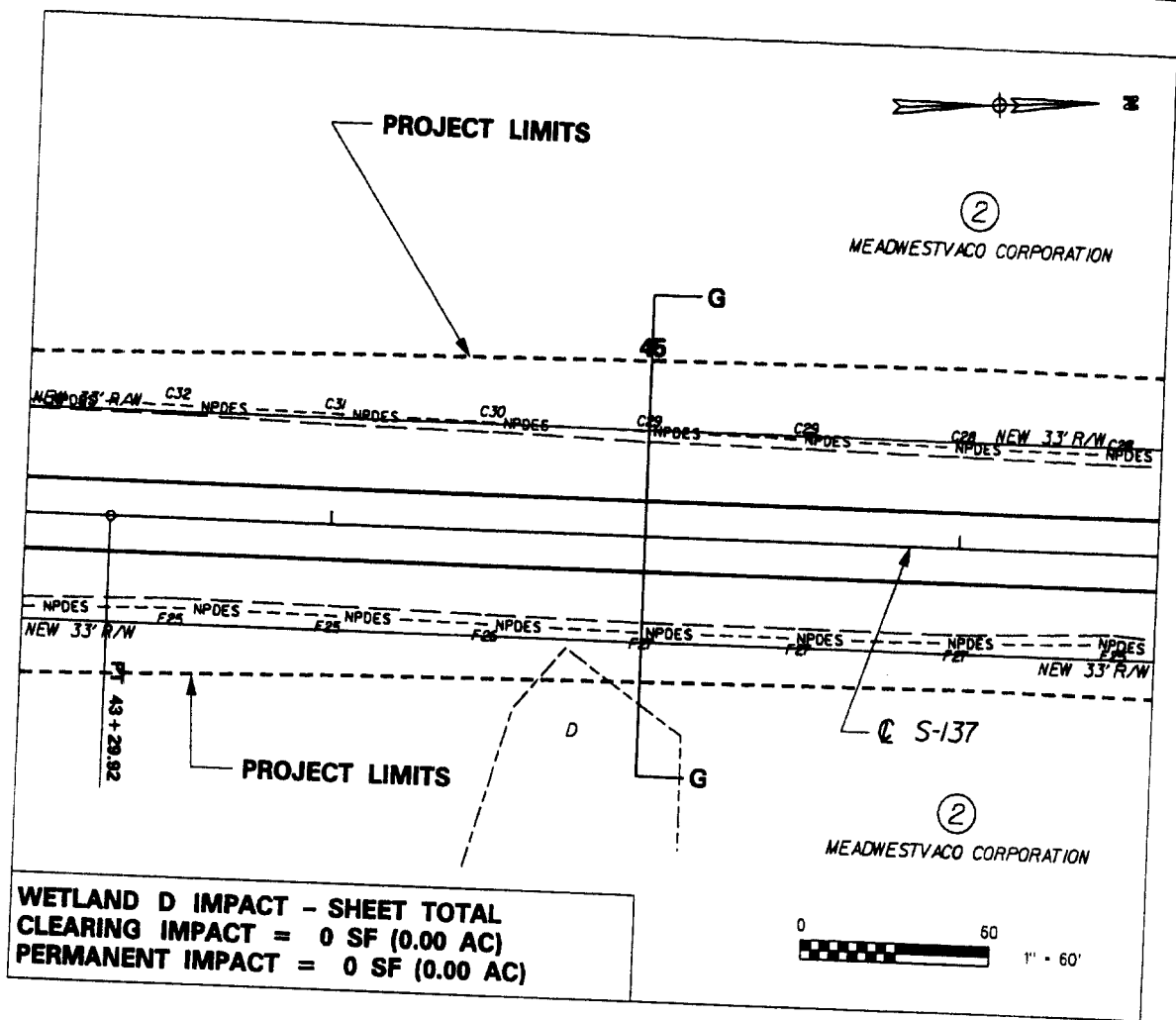

LEGEND

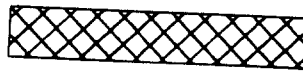
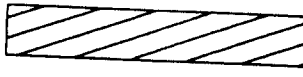
- WETLANDS LIMITS
-  WETLANDS FILL IMPACT (TEMPORARY BETWEEN TOE OF SLOPE & NPDES)
-  WETLANDS FILL IMPACT (PERMANENT)

TOTAL VOLUME OF IMPACT:
WETLAND "D" 0 CY

PIN 36090_SP01
WETLAND D
S-137 PARKERS FERRY ROAD
DORCHESTER COUNTY, SC
APPLICATION BY SCDOT
ELIGIBLE FOR FEDERAL FUNDS
DATE FEBRUARY 28, 2007
SHEET 10 OF 39

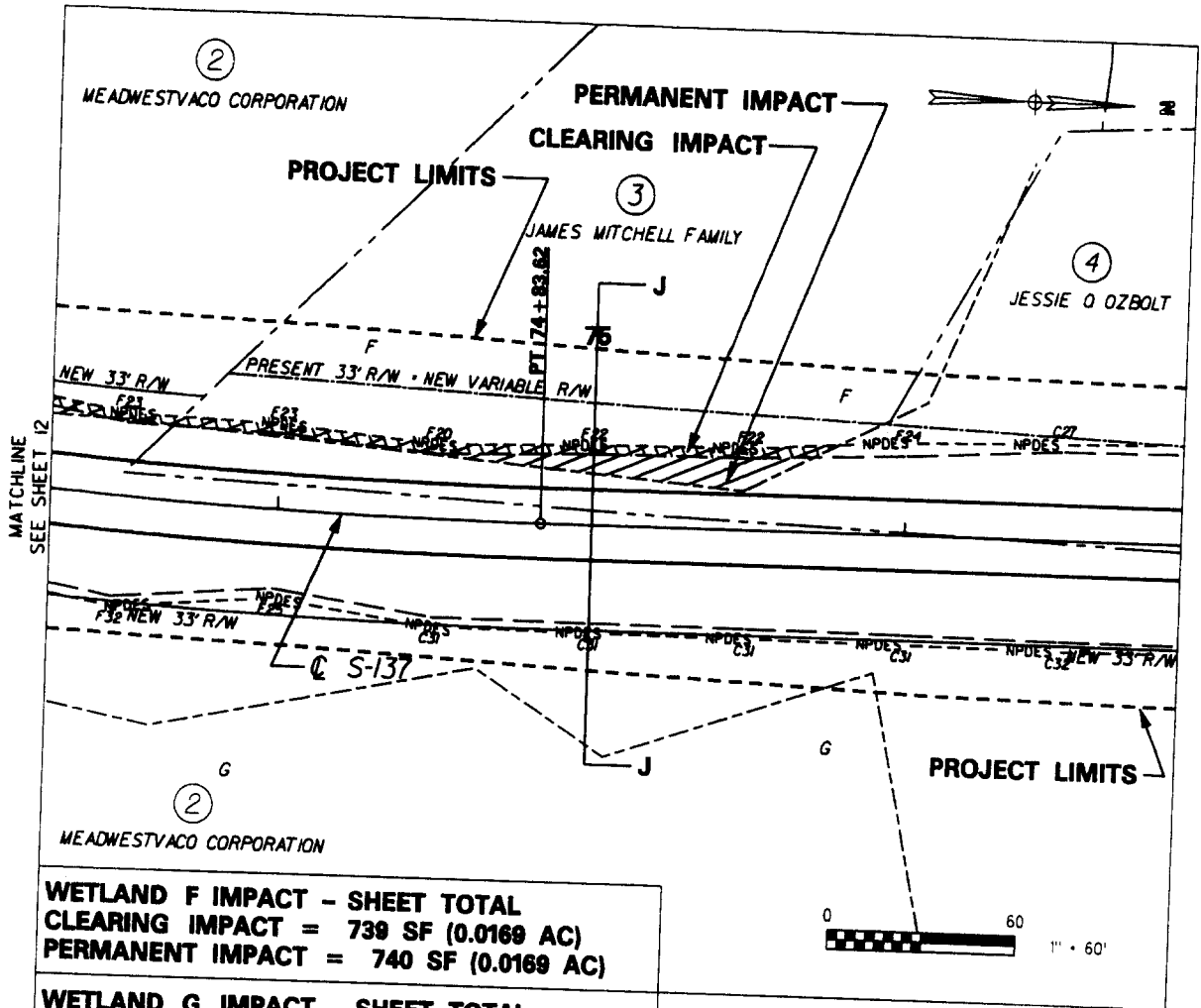

WETLAND F IMPACT - SHEET TOTAL CLEARING IMPACT = 739 SF (0.0169 AC) PERMANENT IMPACT = 740 SF (0.0169 AC)
WETLAND G IMPACT - SHEET TOTAL CLEARING IMPACT = 0 SF (0.00 AC) PERMANENT IMPACT = 0 SF (0.00 AC)

SECTION J-J

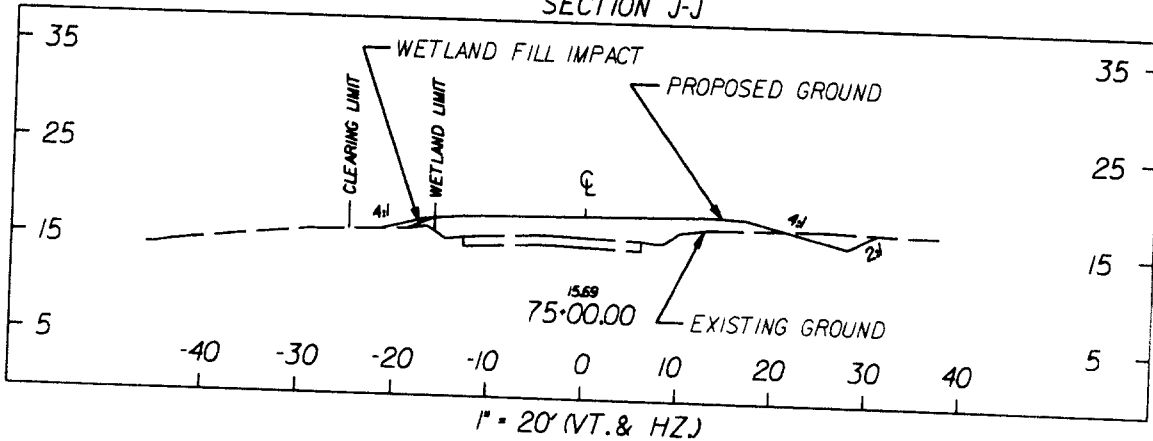

LEGEND

- WETLANDS LIMITS
- WETLANDS FILL IMPACT (TEMPORARY BETWEEN TOE OF SLOPE & NPDES)
- WETLANDS FILL IMPACT (PERMANENT)

TOTAL VOLUME OF IMPACT:
 WETLAND 'F' SEE SHEET 12
 WETLAND 'G' SEE SHEET 12

PIN 36090_SP01
WETLAND F, G
S-137 PARKERS FERRY ROAD
DORCHESTER COUNTY, SC
APPLICATION BY SCDOT
ELIGIBLE FOR FEDERAL FUNDS
DATE FEBRUARY 28, 2007
SHEET 13 OF 39

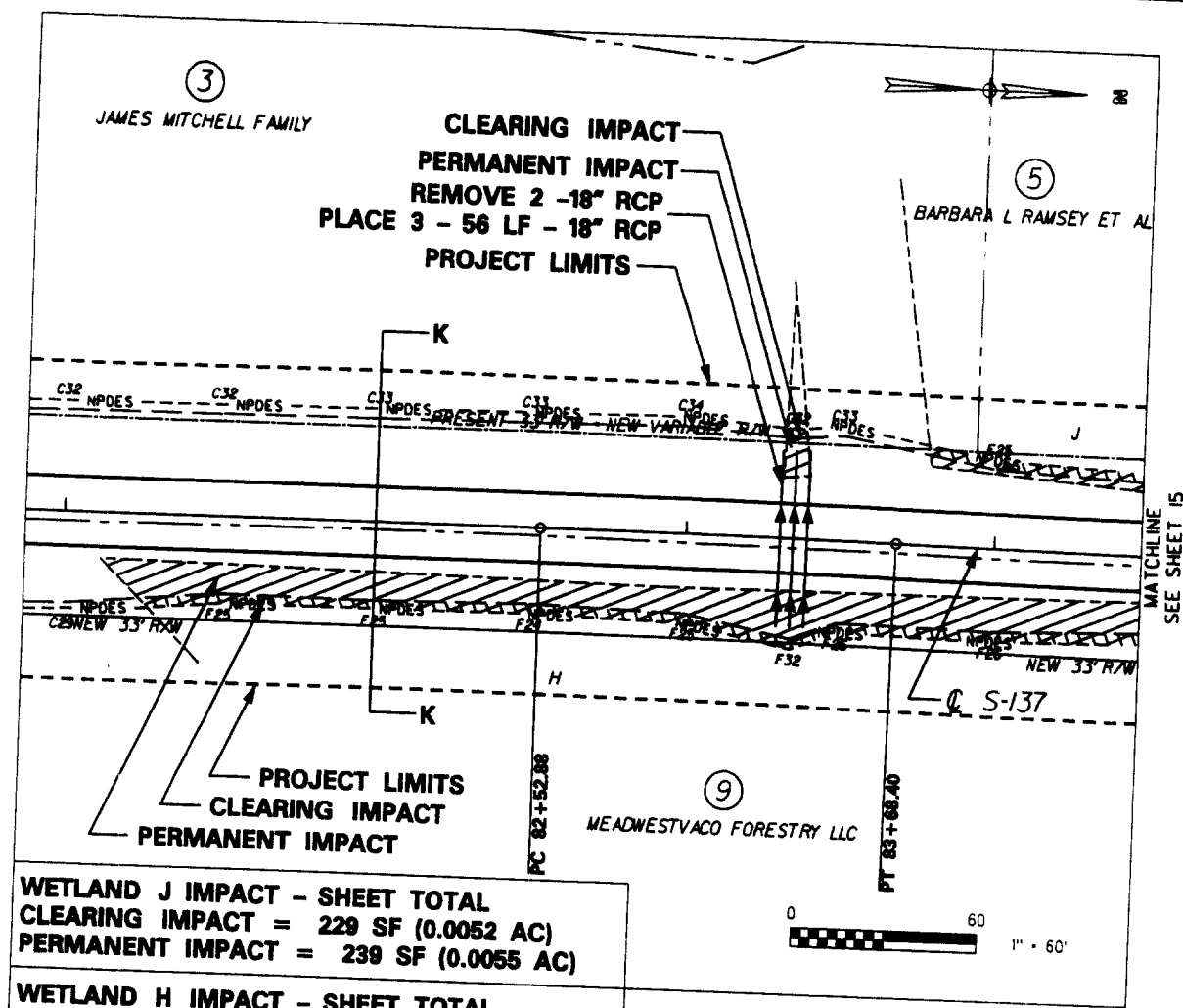

WETLAND J IMPACT - SHEET TOTAL
CLEARING IMPACT = 229 SF (0.0052 AC)
PERMANENT IMPACT = 239 SF (0.0055 AC)

WETLAND H IMPACT - SHEET TOTAL
CLEARING IMPACT = 953 SF (0.0218 AC)
PERMANENT IMPACT = 3211 SF (0.0737 AC)

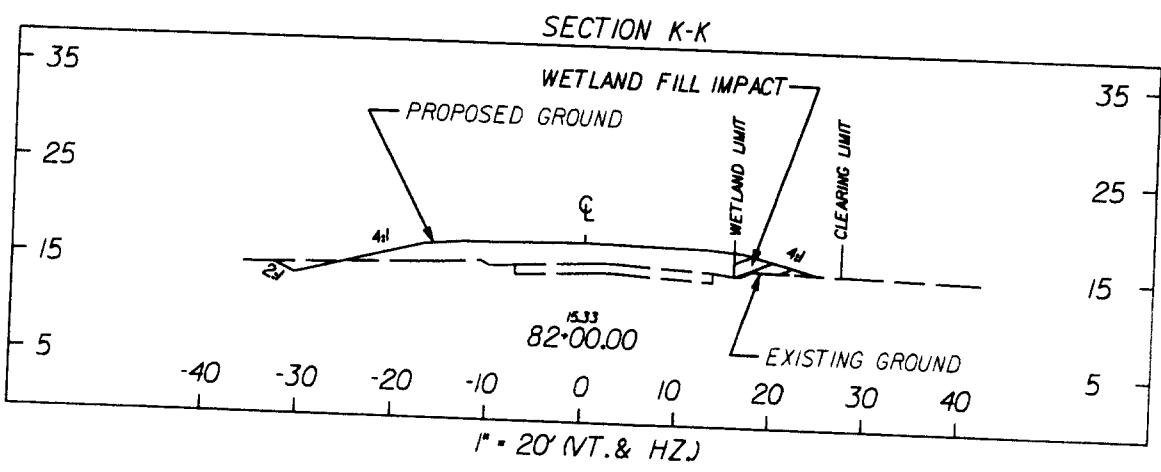

LEGEND

- WETLANDS LIMITS
- WETLANDS FILL IMPACT (TEMPORARY BETWEEN TOE OF SLOPE & NPDES)
- WETLANDS FILL IMPACT (PERMANENT)

TOTAL VOLUME OF IMPACT:
 WETLAND "J" 12 CY
 WETLAND "H" 266 CY

PIN 36090_SP01
WETLAND J, H
S-137 PARKERS FERRY ROAD
DORCHESTER COUNTY, SC
APPLICATION BY SCDOT
ELIGIBLE FOR FEDERAL FUNDS
DATE FEBRUARY 28, 2007
SHEET 14 OF 39

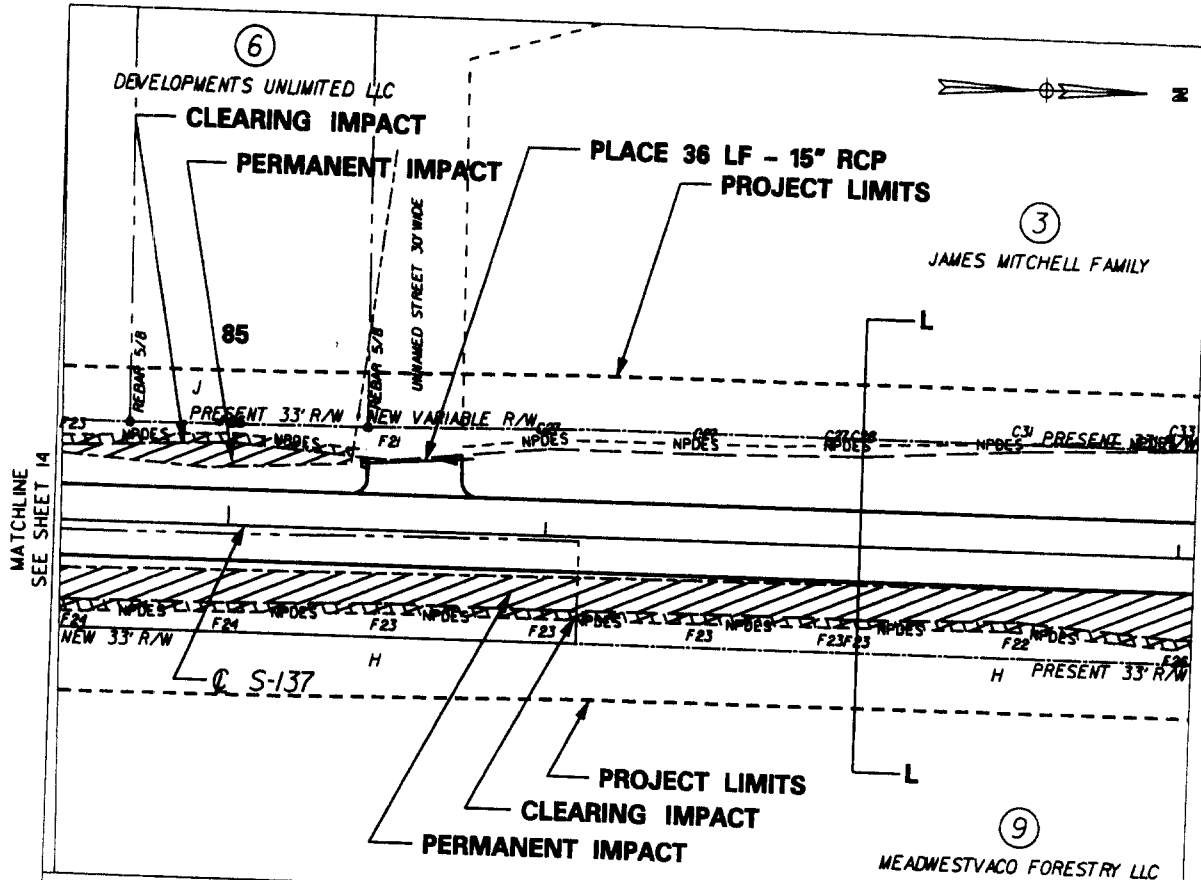

WETLAND J IMPACT - SHEET TOTAL CLEARING IMPACT = 267 SF (0.0061 AC) PERMANENT IMPACT = 471 SF (0.0108 AC)
WETLAND H IMPACT - SHEET TOTAL CLEARING IMPACT = 1028 SF (0.0236 AC) PERMANENT IMPACT = 3738 SF (0.0858 AC)

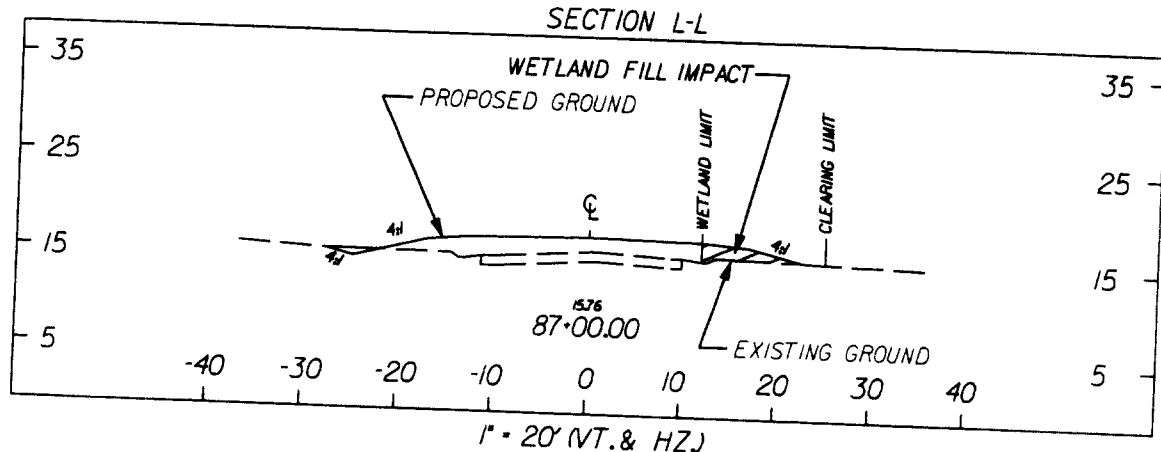

LEGEND

- WETLANDS LIMITS
- WETLANDS FILL IMPACT (TEMPORARY BETWEEN TOE OF SLOPE & NPDES)
- WETLANDS FILL IMPACT (PERMANENT)

TOTAL VOLUME OF IMPACT:
 WETLAND "J" SEE SHEET 14
 WETLAND "H" SEE SHEET 14

PIN 36090_SP01
WETLAND J, H
S-157 PARKERS FERRY ROAD
DORCHESTER COUNTY, SC
APPLICATION BY SCDOT
ELIGIBLE FOR FEDERAL FUNDS
DATE FEBRUARY 28, 2007
SHEET 15 OF 39

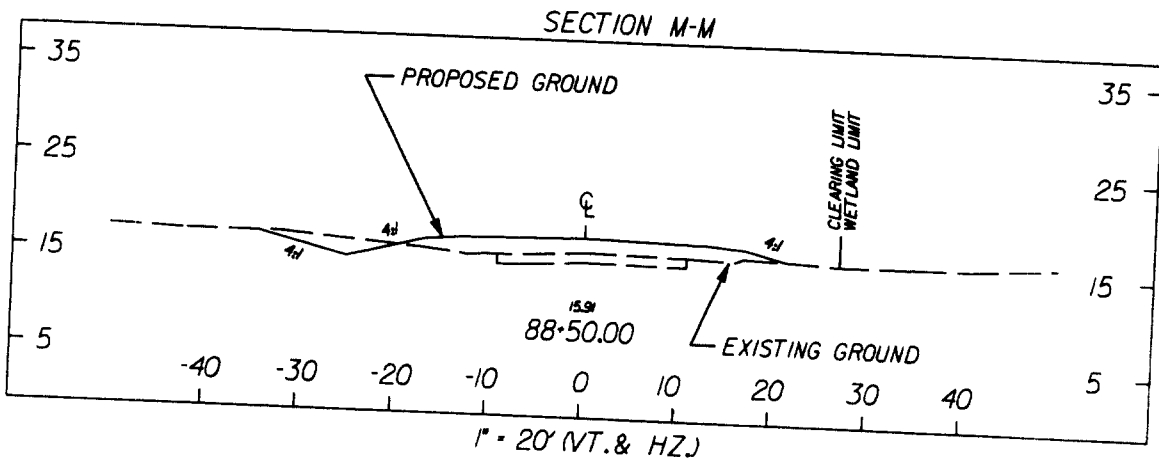
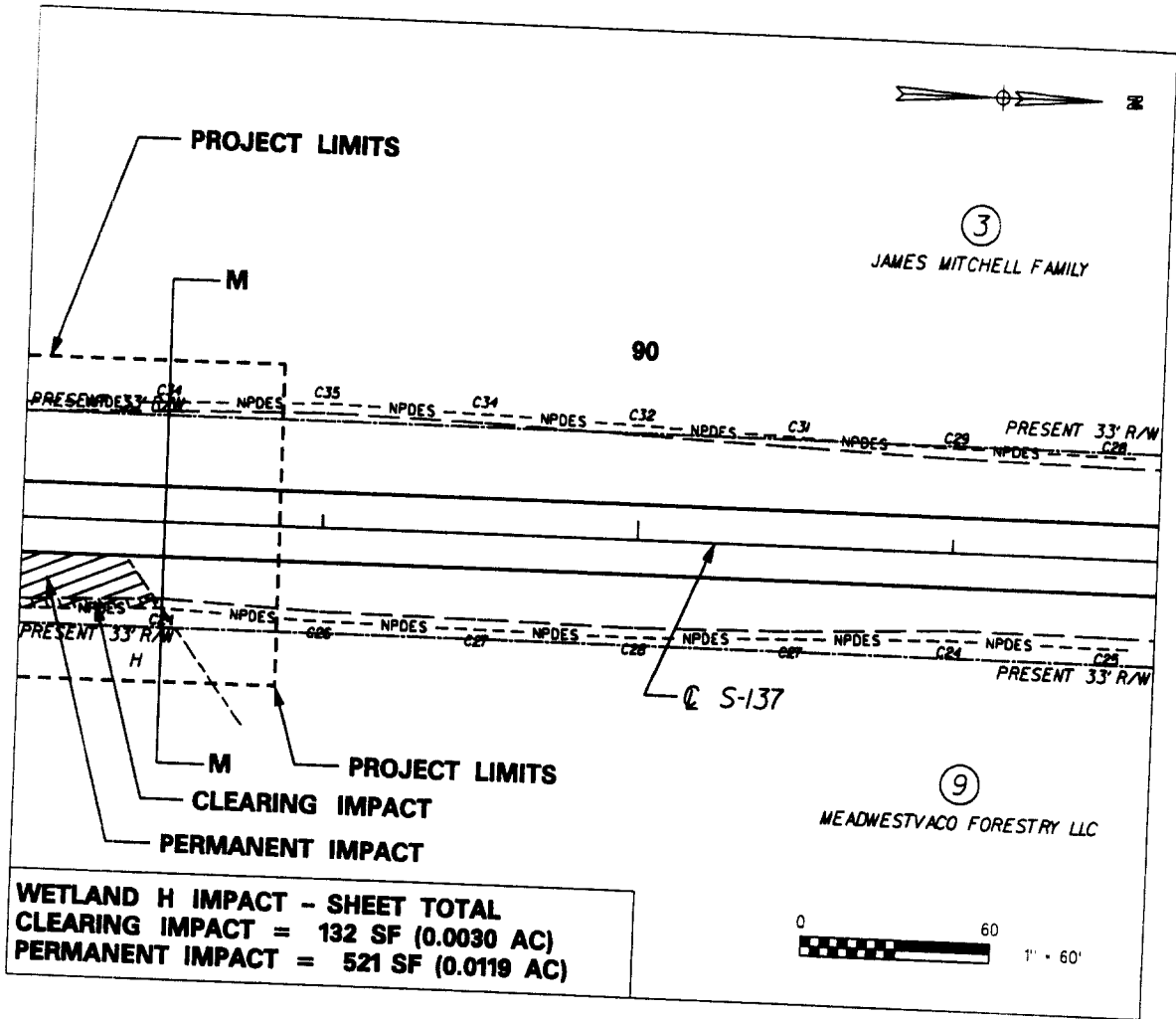

LEGEND

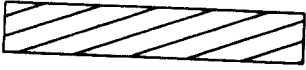
- WETLANDS LIMITS
-  WETLANDS FILL IMPACT (TEMPORARY BETWEEN TOE OF SLOPE & NPDES)
-  WETLANDS FILL IMPACT (PERMANENT)

TOTAL VOLUME OF IMPACT:
 WETLAND "H" SEE SHEET 14

PIN 36090_SP01
WETLAND H
S-137 PARKERS FERRY ROAD
DORCHESTER COUNTY, SC
APPLICATION BY SCDOT
ELIGIBLE FOR FEDERAL FUNDS
DATE FEBRUARY 28, 2007
SHEET 16 OF 39

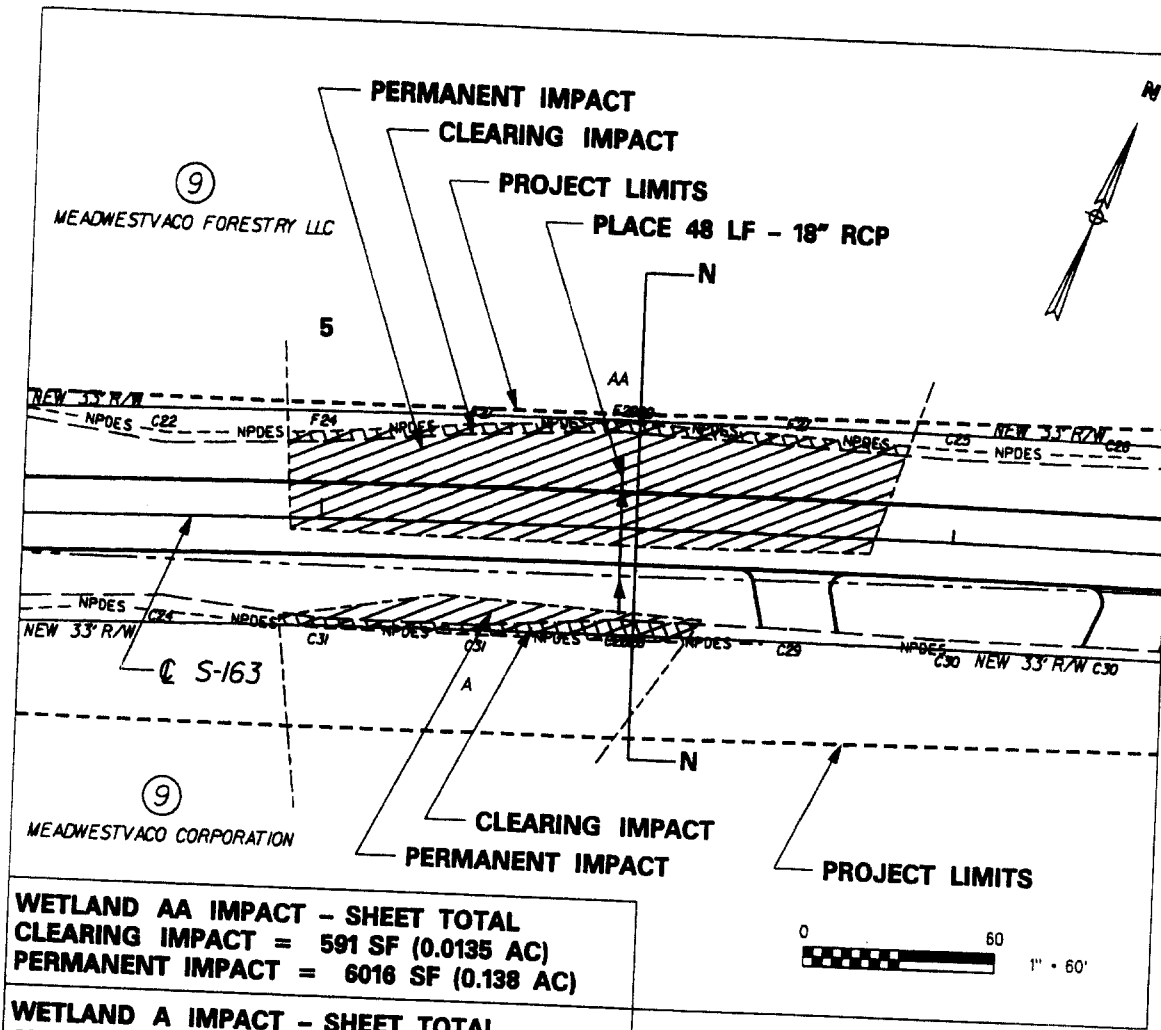

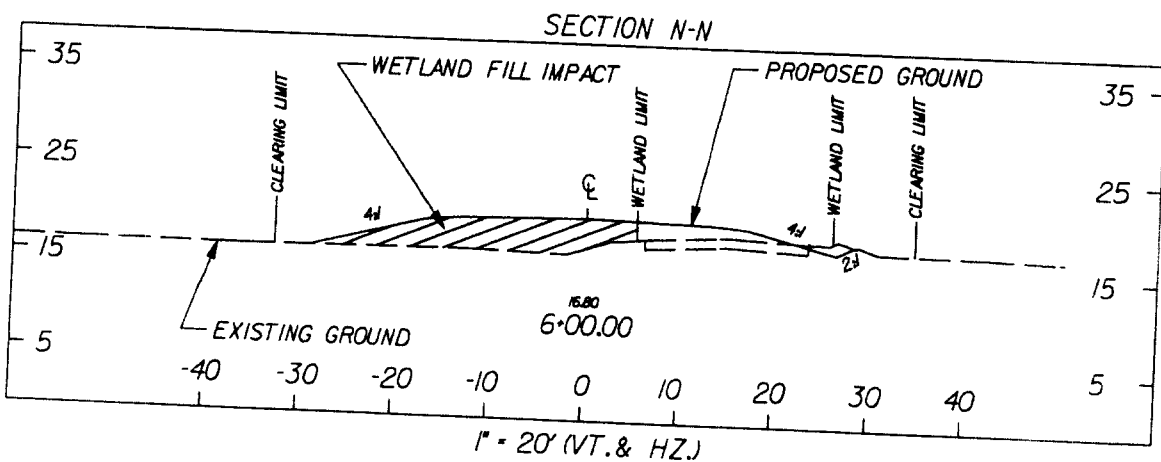

WETLAND AA IMPACT - SHEET TOTAL
 CLEARING IMPACT = 591 SF (0.0135 AC)
 PERMANENT IMPACT = 6016 SF (0.138 AC)

WETLAND A IMPACT - SHEET TOTAL
 CLEARING IMPACT = 542 SF (0.0124 AC)
 PERMANENT IMPACT = 613 SF (0.014 AC)



LEGEND

- WETLANDS LIMITS
-  WETLANDS FILL IMPACT (TEMPORARY BETWEEN TOE OF SLOPE & NPDES)
-  WETLANDS FILL IMPACT (PERMANENT)

TOTAL VOLUME OF IMPACT:
 WETLAND "AA" 469 CY
 WETLAND "A" 0 CY

PIN 36090_SP01
WETLAND A, AA
S-163 SUMMERS ROAD
DORCHESTER COUNTY, SC
APPLICATION BY SCDOT
ELIGIBLE FOR FEDERAL FUNDS
DATE FEBRUARY 28, 2007
SHEET 17 OF 39

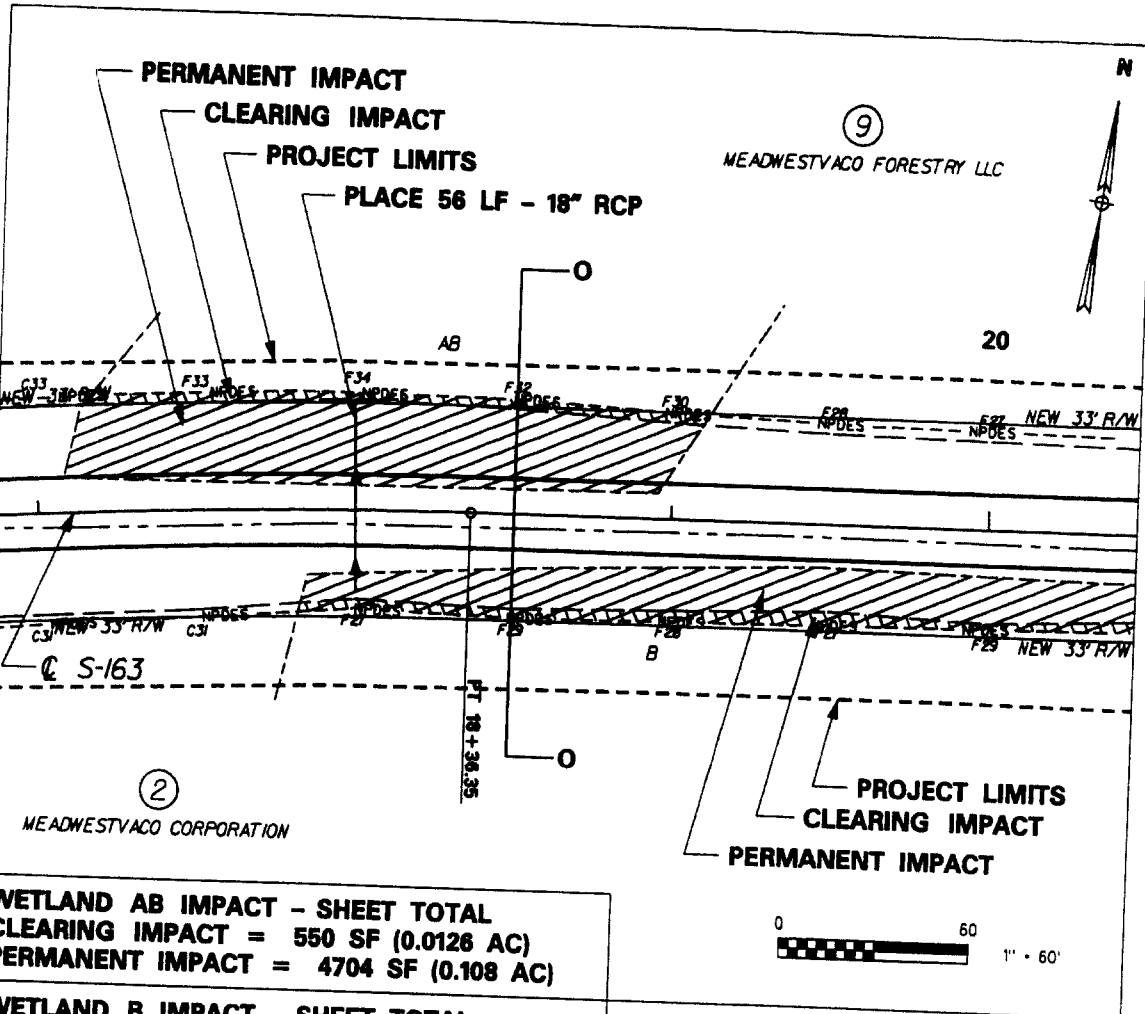

WETLAND AB IMPACT - SHEET TOTAL
CLEARING IMPACT = 550 SF (0.0126 AC)
PERMANENT IMPACT = 4704 SF (0.108 AC)

WETLAND B IMPACT - SHEET TOTAL
CLEARING IMPACT = 821 SF (0.0188 AC)
PERMANENT IMPACT = 3261 SF (0.075 AC)

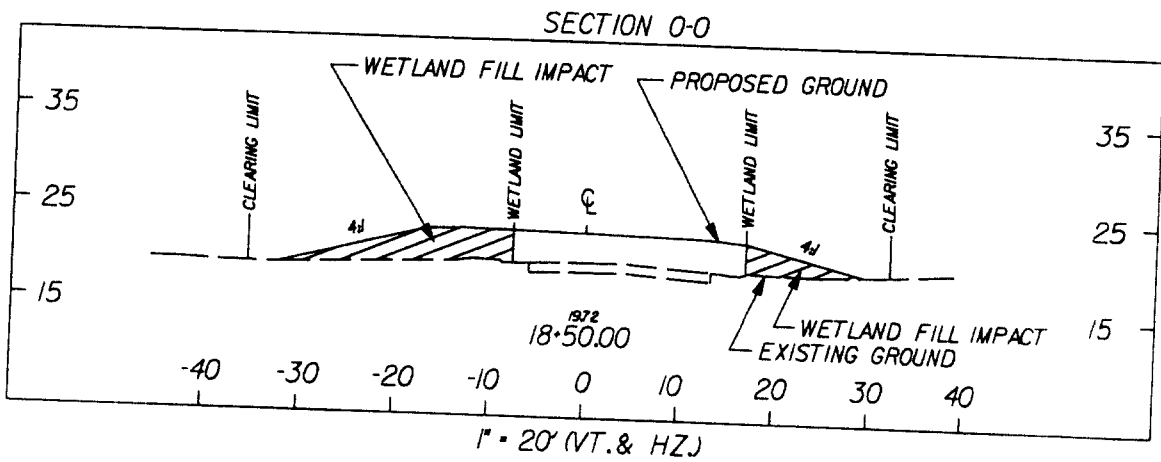

LEGEND

- WETLANDS LIMITS
- WETLANDS FILL IMPACT (TEMPORARY BETWEEN TOE OF SLOPE & NPDES)
- WETLANDS FILL IMPACT (PERMANENT)

TOTAL VOLUME OF IMPACT:
 WETLAND "AB" 427 CY
 WETLAND "B" 377 CY

PIN 36090_SP01
WETLAND AB, B
S-163 SUMMERS ROAD
DORCHESTER COUNTY, SC
APPLICATION BY SCDOT
ELIGIBLE FOR FEDERAL FUNDS
DATE FEBRUARY 28, 2007
SHEET 18 OF 39

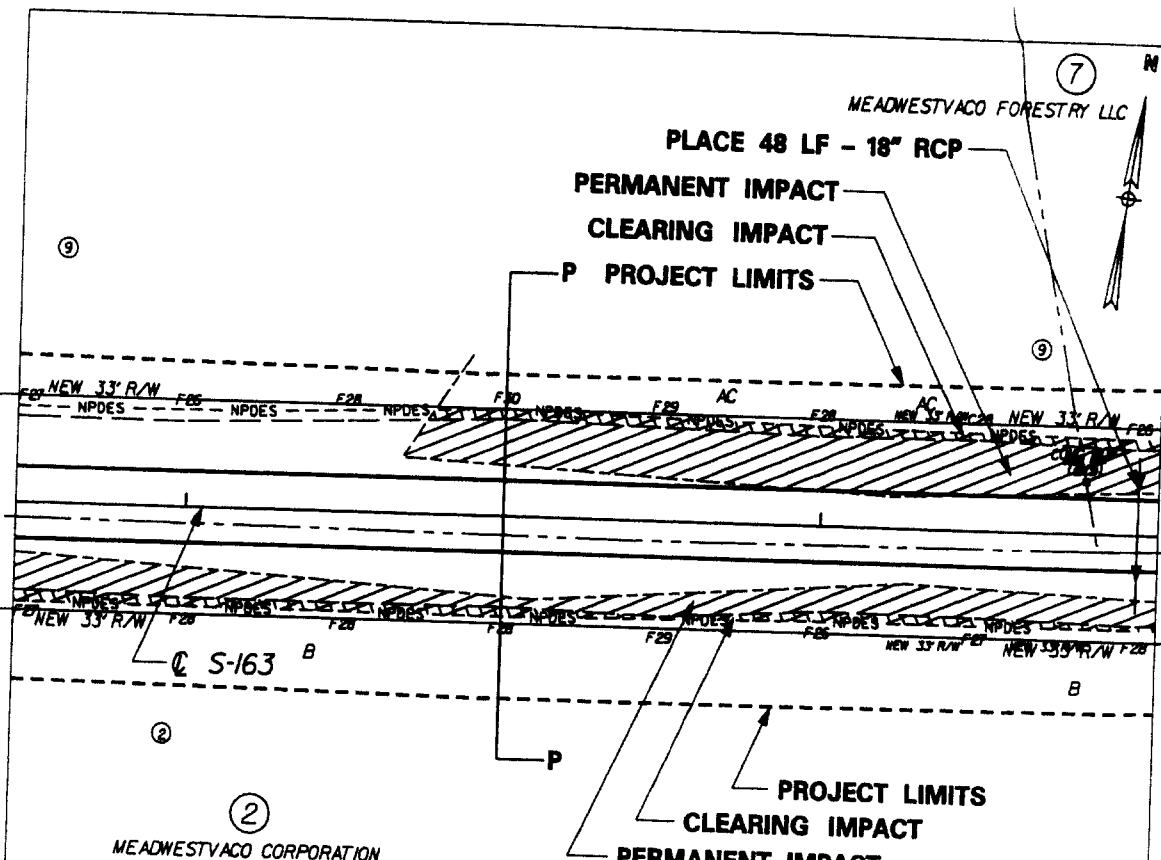

WETLAND AC IMPACT - SHEET TOTAL
CLEARING IMPACT = 650 SF (0.0149 AC)
PERMANENT IMPACT = 3619 SF (0.083 AC)

WETLAND B IMPACT - SHEET TOTAL
CLEARING IMPACT = 872 SF (0.02 AC)
PERMANENT IMPACT = 2711 SF (0.062 AC)

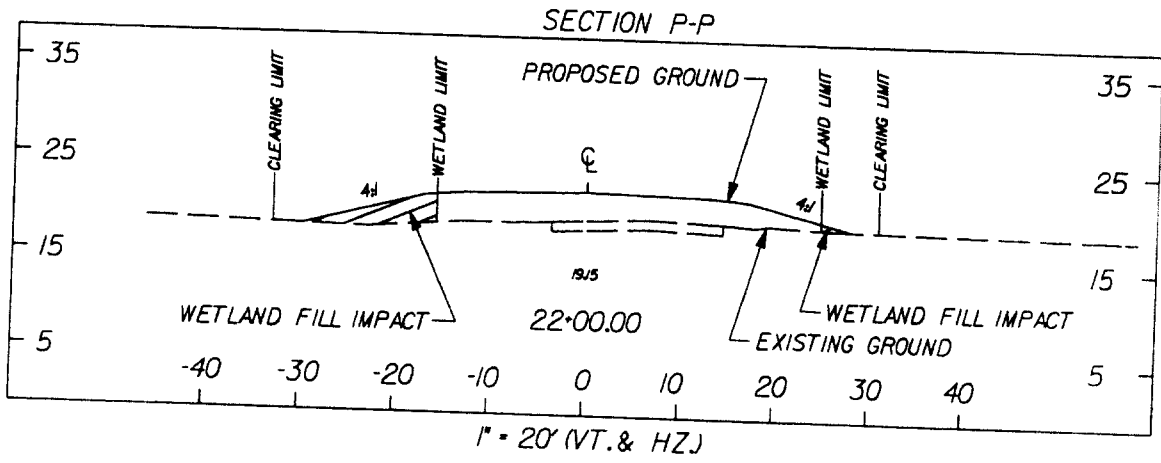

LEGEND

- WETLANDS LIMITS
- WETLANDS FILL IMPACT (TEMPORARY BETWEEN TOE OF SLOPE & NPDES)
- WETLANDS FILL IMPACT (PERMANENT)

TOTAL VOLUME OF IMPACT:
 WETLAND "AC" 434 CY
 WETLAND "B" SEE SHEET 18

PIN 36090_SP01
WETLAND AC, B
S-163 SUMMERS ROAD
DORCHESTER COUNTY, SC
APPLICATION BY SCDOT
ELIGIBLE FOR FEDERAL FUNDS
DATE FEBRUARY 28, 2007
SHEET 19 OF 39

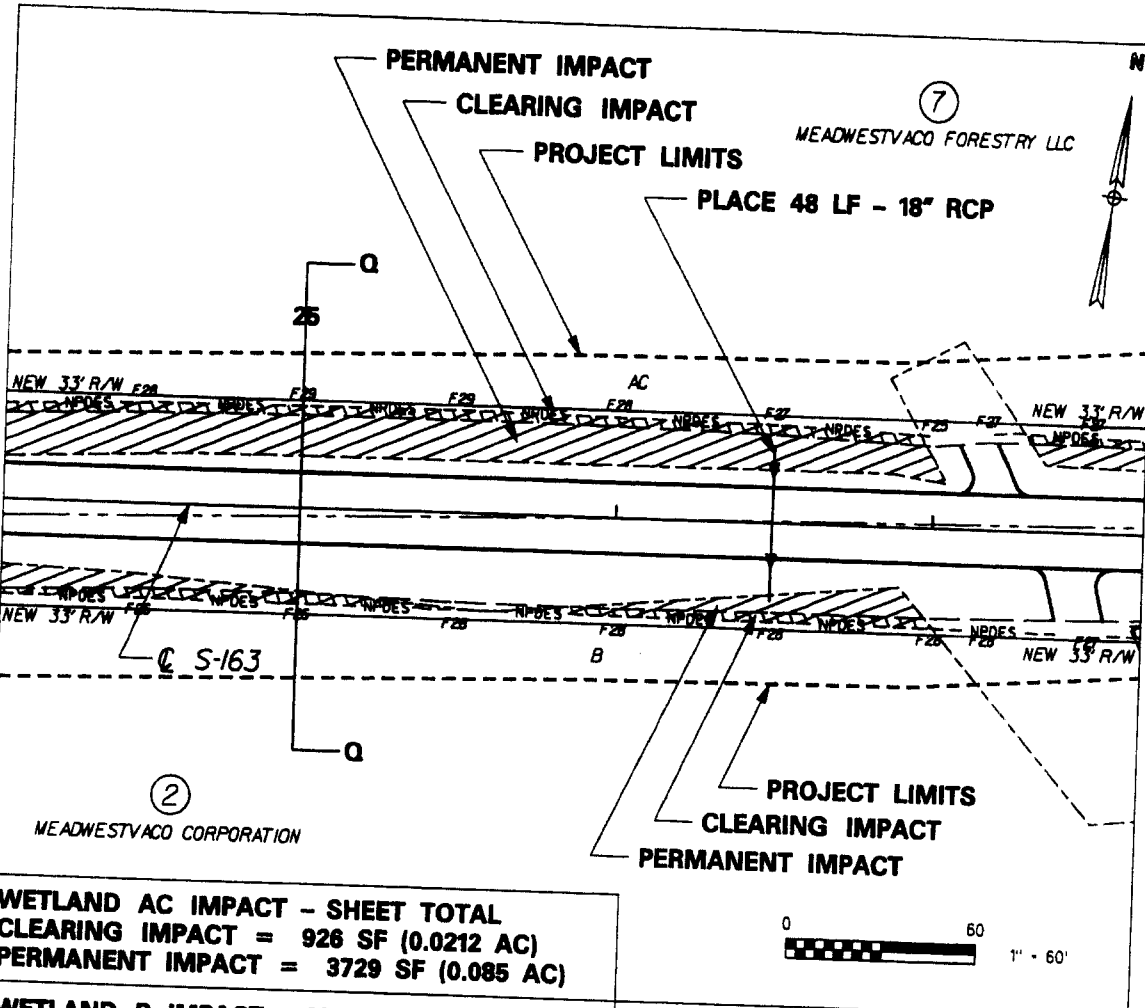

WETLAND AC IMPACT - SHEET TOTAL CLEARING IMPACT = 926 SF (0.0212 AC) PERMANENT IMPACT = 3729 SF (0.085 AC)
WETLAND B IMPACT - SHEET TOTAL CLEARING IMPACT = 711 SF (0.0163 AC) PERMANENT IMPACT = 918 SF (0.021 AC)

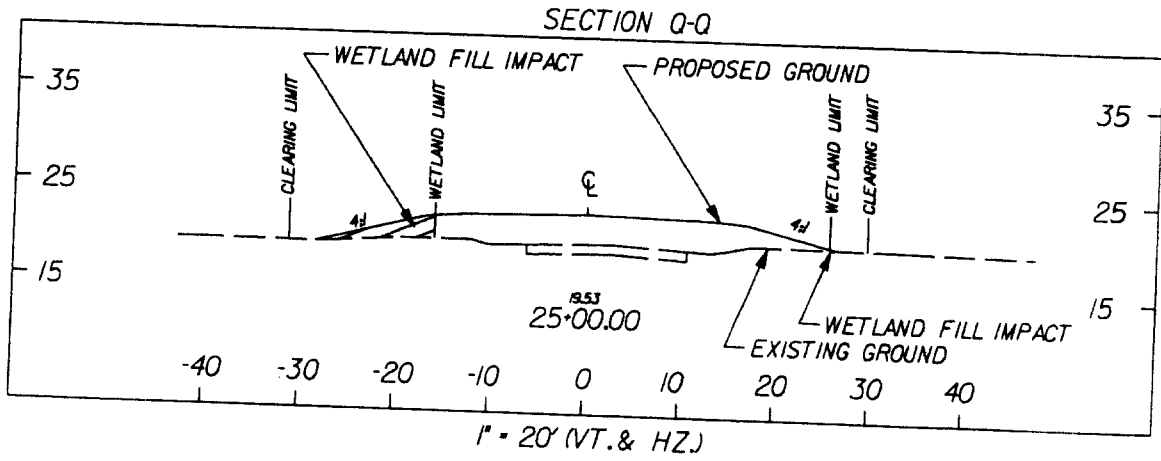
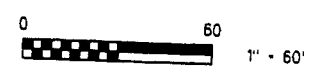

LEGEND

- WETLANDS LIMITS
- WETLANDS FILL IMPACT (TEMPORARY BETWEEN TOE OF SLOPE & NPDES)
- WETLANDS FILL IMPACT (PERMANENT)

TOTAL VOLUME OF IMPACT:
 WETLAND "AC" SEE SHEET 19
 WETLAND "B" SEE SHEET 18

PIN 36090_SP01
WETLAND AC, B
S-163 SUMMERS ROAD
DORCHESTER COUNTY, SC
APPLICATION BY SCDOT
ELIGIBLE FOR FEDERAL FUNDS
DATE FEBRUARY 28, 2007
SHEET 20 OF 39

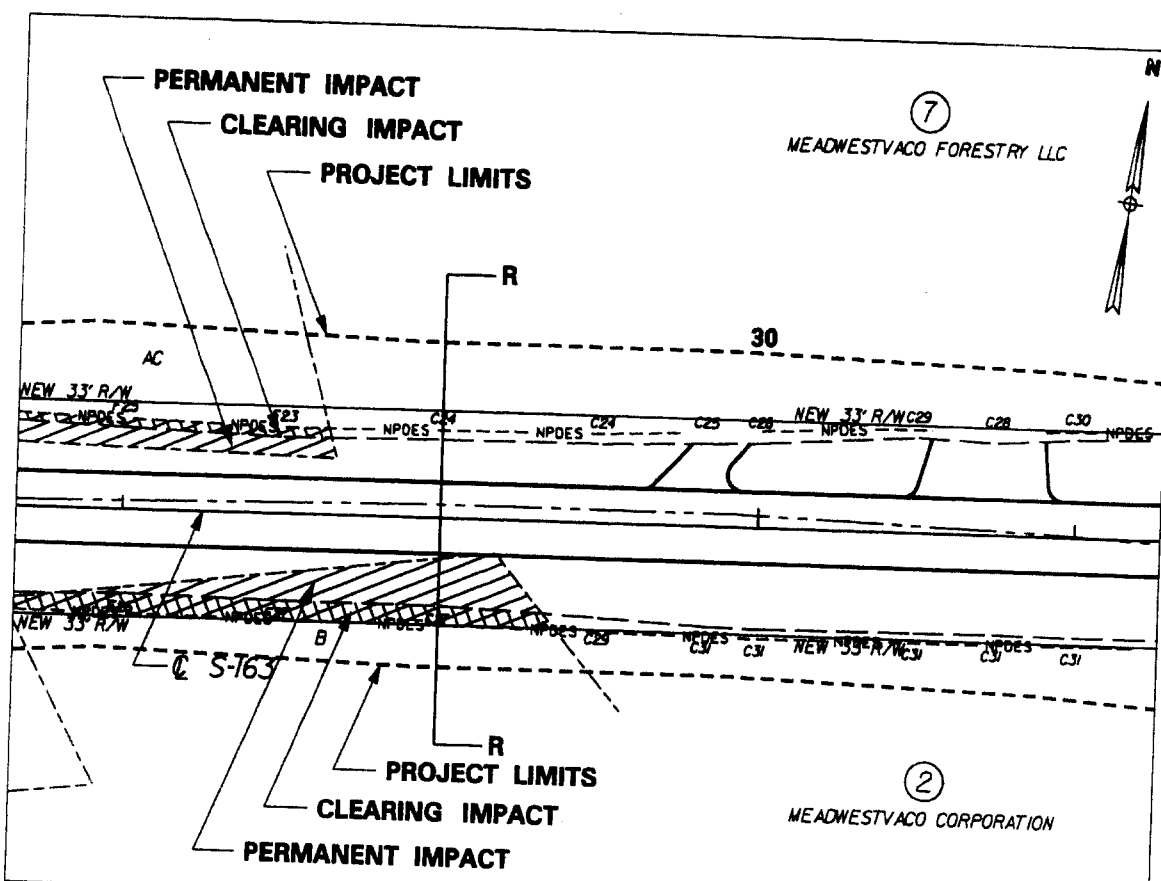

WETLAND AC IMPACT - SHEET TOTAL
CLEARING IMPACT = 271 SF (0.0062 AC)
PERMANENT IMPACT = 605 SF (0.0138 AC)

WETLAND B IMPACT - SHEET TOTAL
CLEARING IMPACT = 973 SF (0.0223 AC)
PERMANENT IMPACT = 1272 SF (0.029 AC)

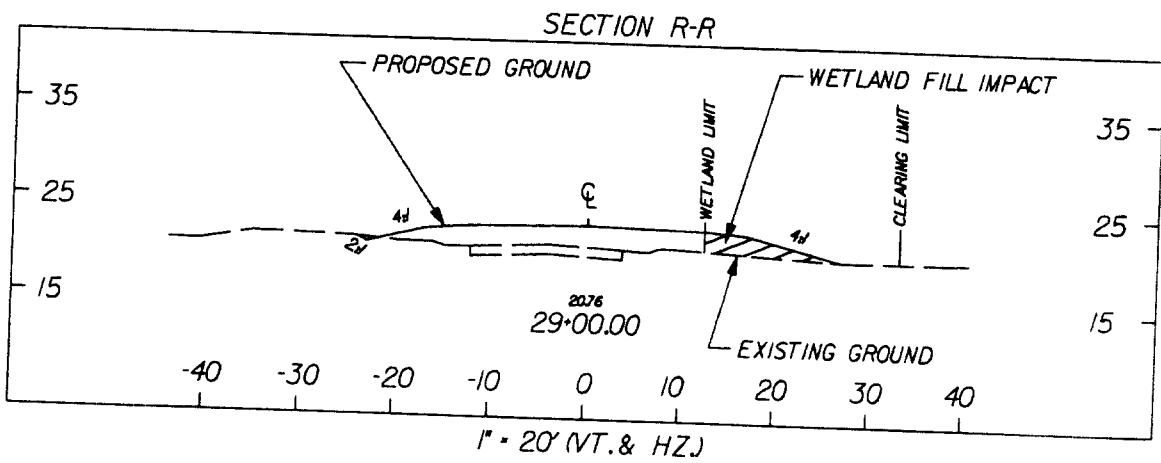

LEGEND

- WETLANDS LIMITS
- WETLANDS FILL IMPACT (TEMPORARY BETWEEN TOE OF SLOPE & NPDES)
- WETLANDS FILL IMPACT (PERMANENT)

TOTAL VOLUME OF IMPACT:
 WETLAND "AC" SEE SHEET 19
 WETLAND "B" SEE SHEET 18

PIN 36090_SP01
WETLAND AC, B
S-163 SUMMERS ROAD
DORCHESTER COUNTY, SC
APPLICATION BY SCDOT
ELIGIBLE FOR FEDERAL FUNDS
DATE FEBRUARY 28, 2007
SHEET 21 OF 39

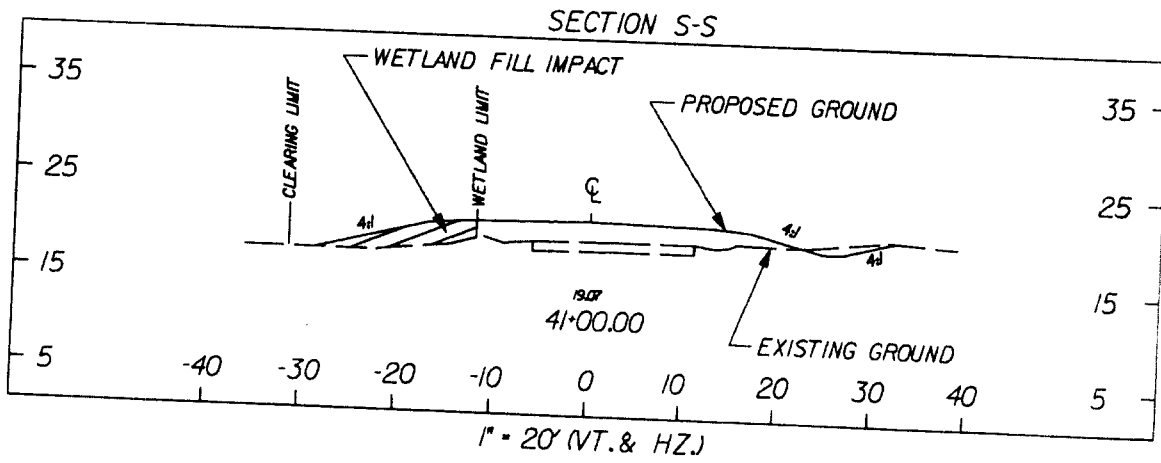
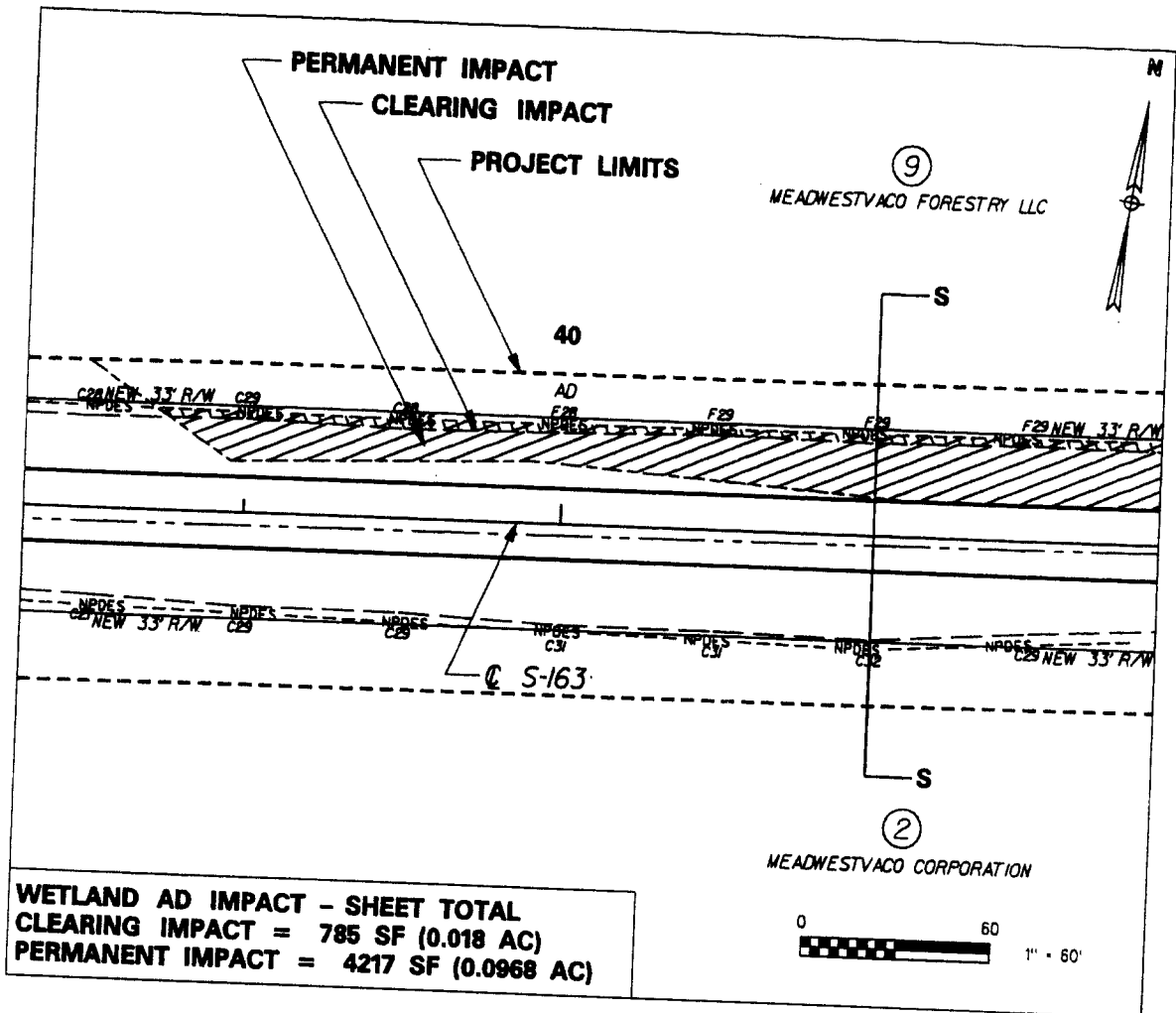

LEGEND

- WETLANDS LIMITS
- WETLANDS FILL IMPACT (TEMPORARY BETWEEN TOE OF SLOPE & NPDES)
- WETLANDS FILL IMPACT (PERMANENT)

TOTAL VOLUME OF IMPACT:
 WETLAND "AD" 4693 CY

PIN 36090_SP01
WETLAND AD
S-163 SUMMERS ROAD
DORCHESTER COUNTY, SC
APPLICATION BY SCDOT
ELIGIBLE FOR FEDERAL FUNDS
DATE FEBRUARY 28, 2007
SHEET 22 OF 39

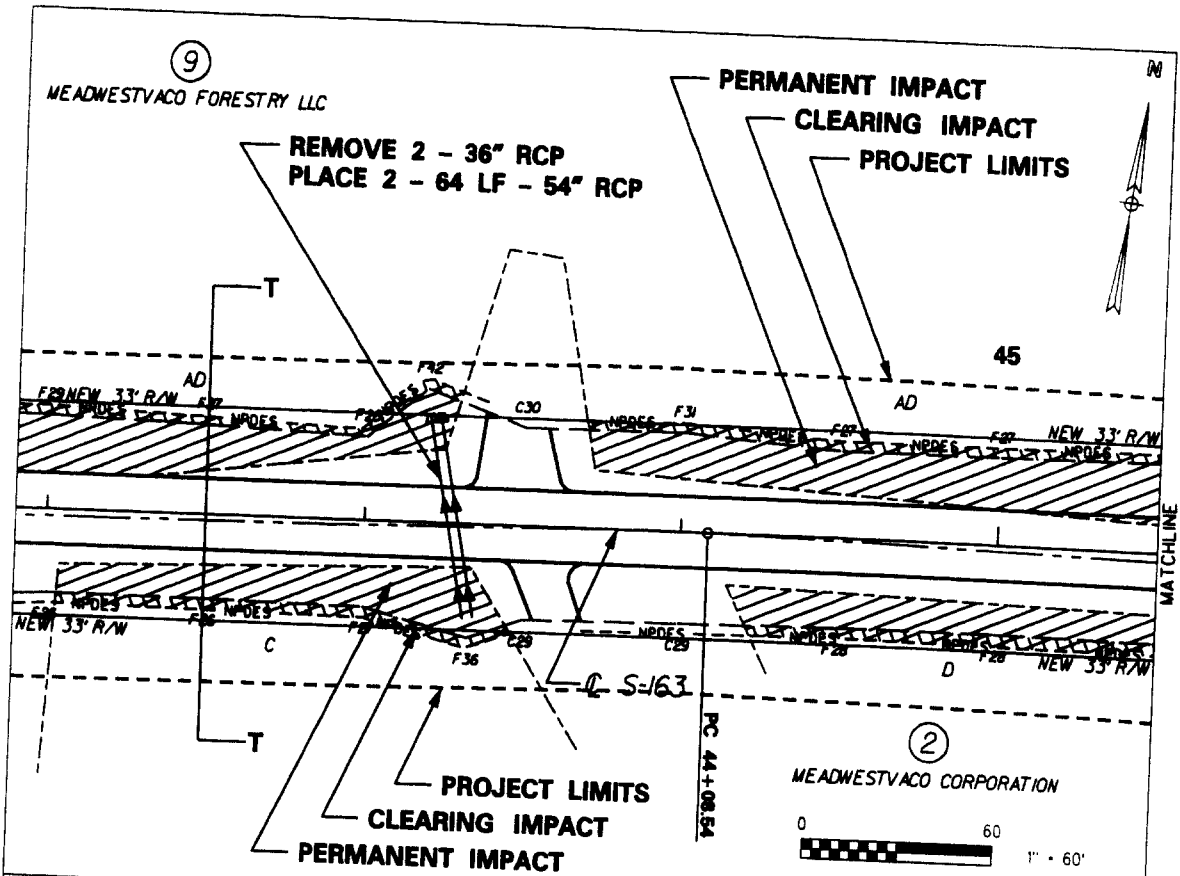

WETLAND AD IMPACT - SHEET TOTAL
CLEARING IMPACT = 939 SF (0.0215 AC)
PERMANENT IMPACT = 4556 SF (0.1046 AC)

WETLAND C IMPACT - SHEET TOTAL
CLEARING IMPACT = 447 SF (0.0102 AC)
PERMANENT IMPACT = 1729 SF (0.0396 AC)

WETLAND D IMPACT - SHEET TOTAL
CLEARING IMPACT = 435 SF (0.0099 AC)
PERMANENT IMPACT = 1346 SF (0.0309 AC)

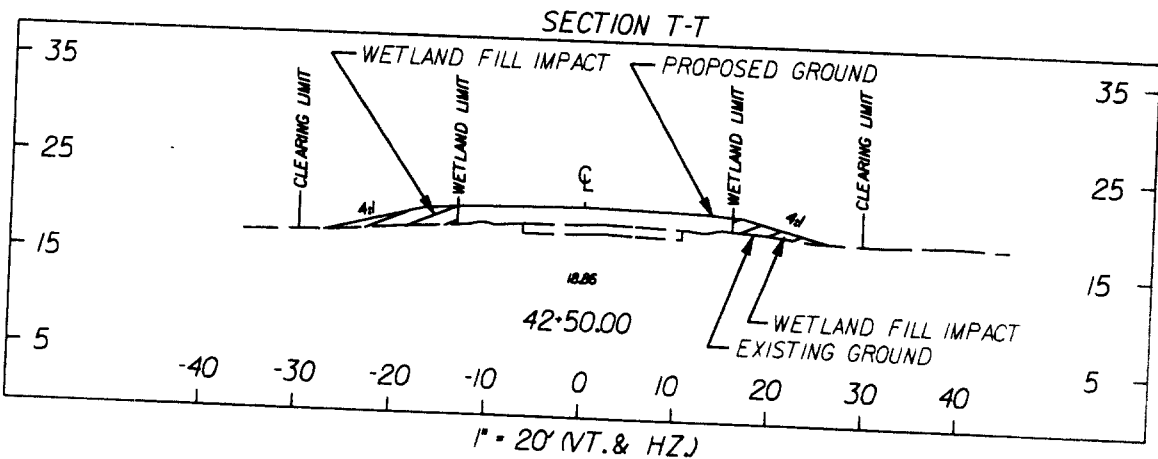

LEGEND

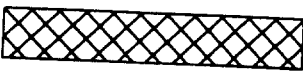
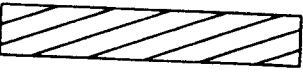
- WETLANDS LIMITS
-  WETLANDS FILL IMPACT (TEMPORARY BETWEEN TOE OF SLOPE & NPDES)
-  WETLANDS FILL IMPACT (PERMANENT)

TOTAL VOLUME OF IMPACT:
 WETLAND 'AD' SEE SHEET 22
 WETLAND 'C' 58 CY
 WETLAND 'D' 362 CY

PIN 36090_SP01
WETLAND C, D, AD
S-163 SUMMERS ROAD
DORCHESTER COUNTY, SC
APPLICATION BY SCDOT
ELIGIBLE FOR FEDERAL FUNDS
DATE FEBRUARY 28, 2007
SHEET 23 OF 39

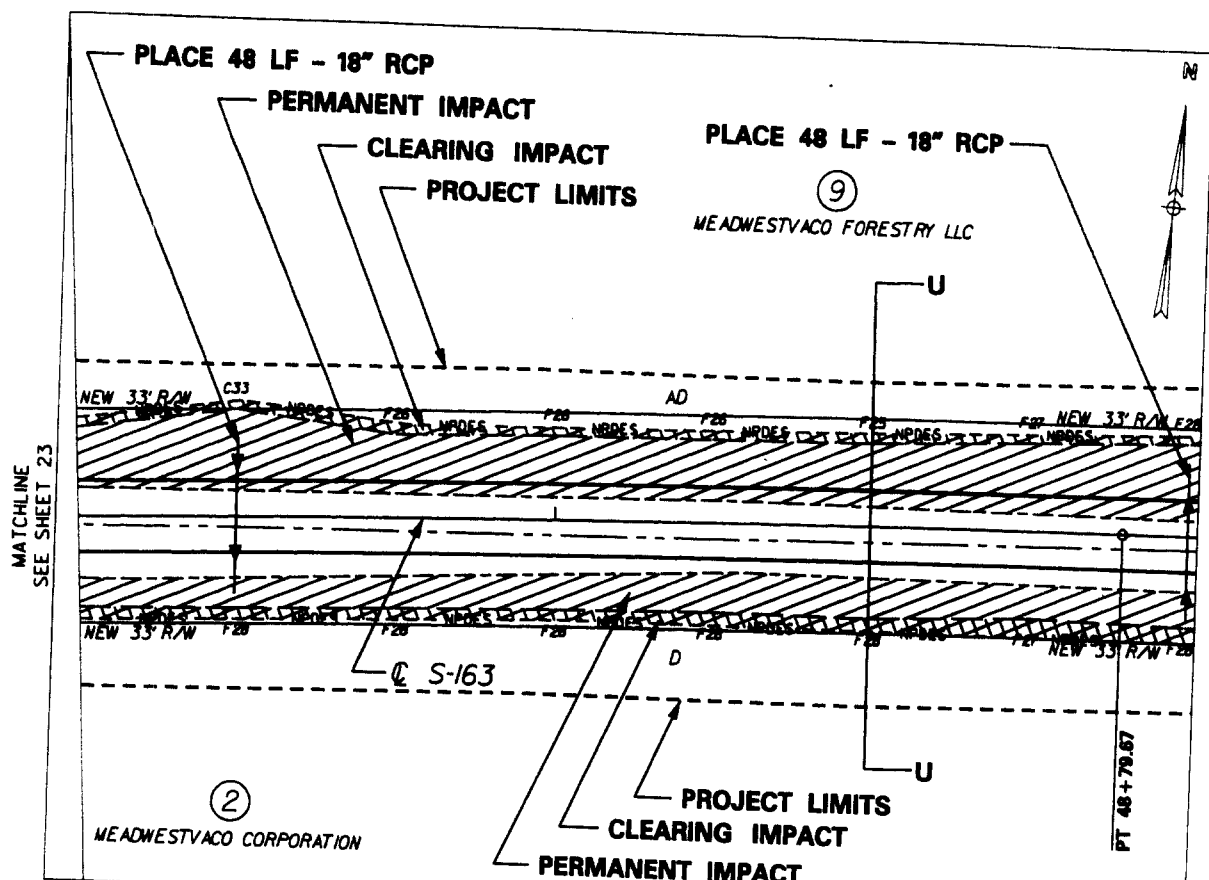

WETLAND AD IMPACT - SHEET TOTAL
 CLEARING IMPACT = 1011 SF (0.0232 AC)
 PERMANENT IMPACT = 7245 SF (0.1663 AC)

WETLAND D IMPACT - SHEET TOTAL
 CLEARING IMPACT = 1386 SF (0.0318 AC)
 PERMANENT IMPACT = 3776 SF (0.0867 AC)

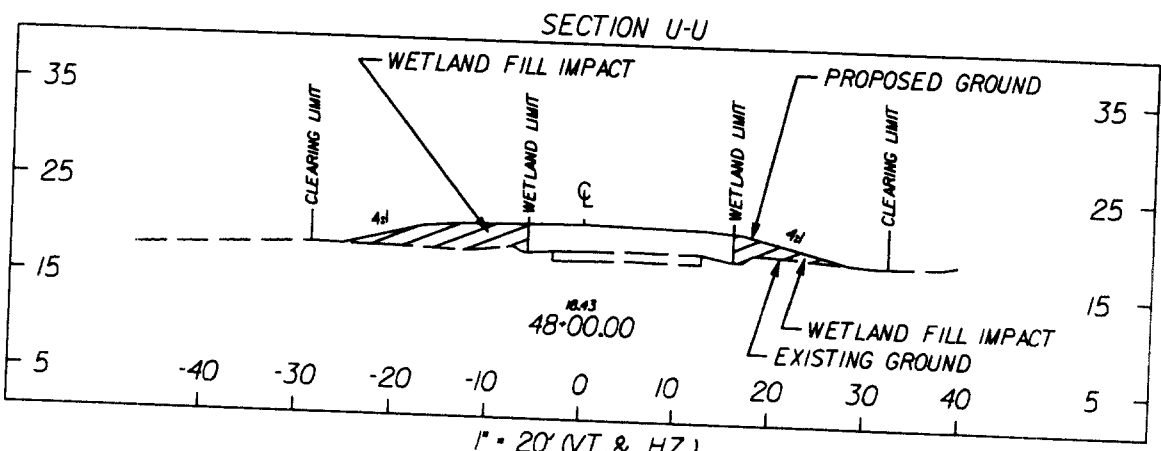

LEGEND

- WETLANDS LIMITS
- WETLANDS FILL IMPACT (TEMPORARY BETWEEN TOE OF SLOPE & NPDES)
- WETLANDS FILL IMPACT (PERMANENT)

TOTAL VOLUME OF IMPACT:
 WETLAND 'AD' SEE SHEET 22
 WETLAND 'D' SEE SHEET 23

PIN 36090_SP01
WETLAND AD, D
S-163 SUMMERS ROAD
DORCHESTER COUNTY, SC
APPLICATION BY SCDOT
ELIGIBLE FOR FEDERAL FUNDS
DATE FEBRUARY 28, 2007
SHEET 24 OF 39

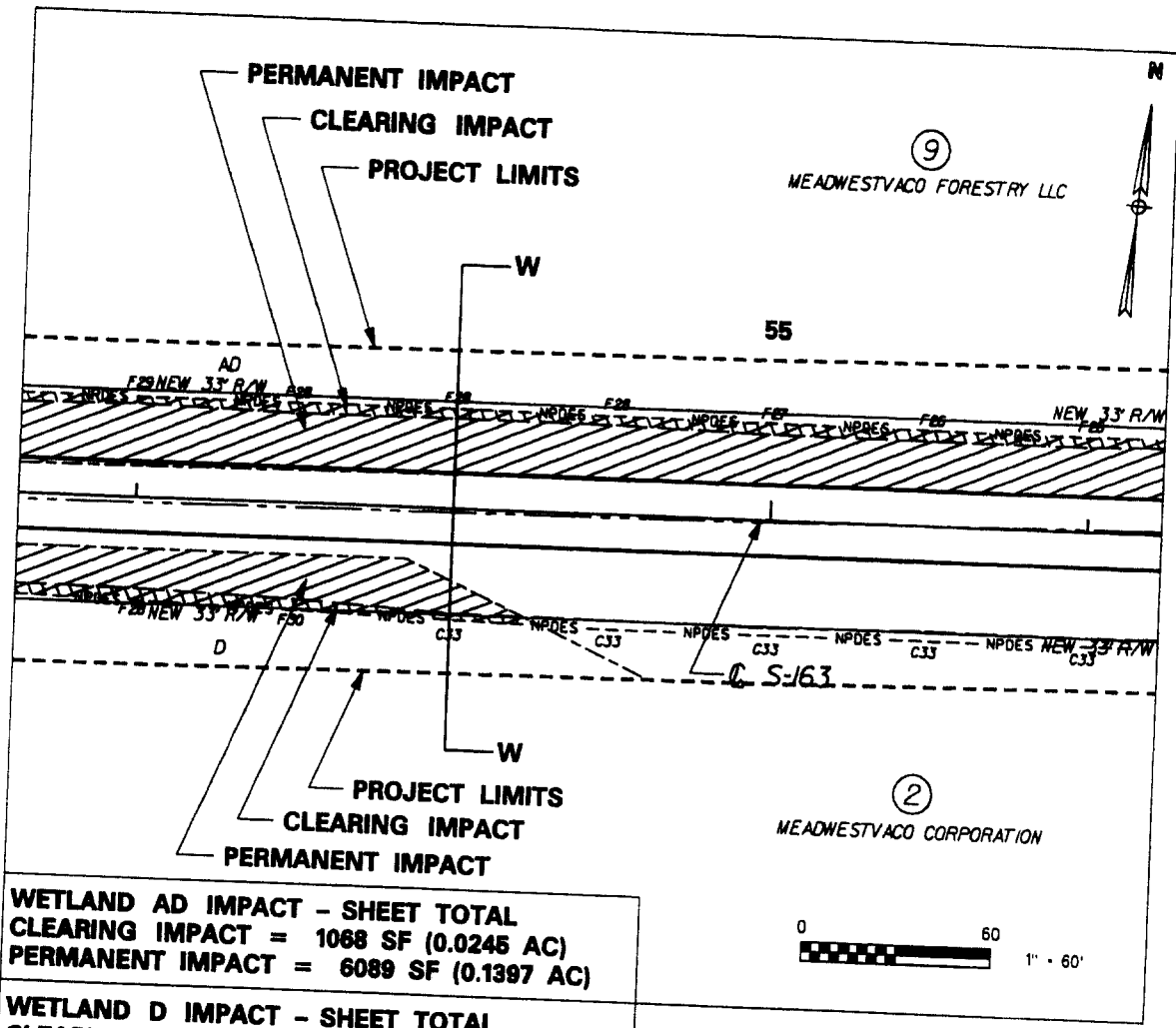

WETLAND AD IMPACT - SHEET TOTAL
 CLEARING IMPACT = 1088 SF (0.0245 AC)
 PERMANENT IMPACT = 6089 SF (0.1397 AC)

WETLAND D IMPACT - SHEET TOTAL
 CLEARING IMPACT = 507 SF (0.0116 AC)
 PERMANENT IMPACT = 1925 SF (0.0442 AC)

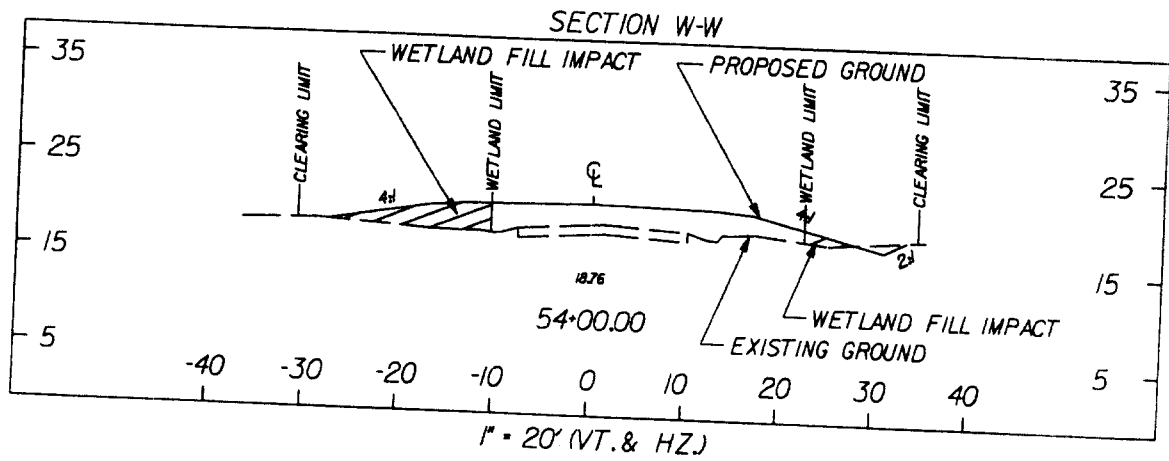

LEGEND

- WETLANDS LIMITS
- WETLANDS FILL IMPACT (TEMPORARY BETWEEN TOE OF SLOPE & NPDES)
- WETLANDS FILL IMPACT (PERMANENT)

TOTAL VOLUME OF IMPACT:
 WETLAND 'AD' SEE SHEET 22
 WETLAND 'D' SEE SHEET 23

PIN 36090_SP01
WETLAND AD, D
S-163 SUMMERS ROAD
DORCHESTER COUNTY, SC
APPLICATION BY SCDOT
ELIGIBLE FOR FEDERAL FUNDS
DATE FEBRUARY 28, 2007
SHEET 26 OF 39

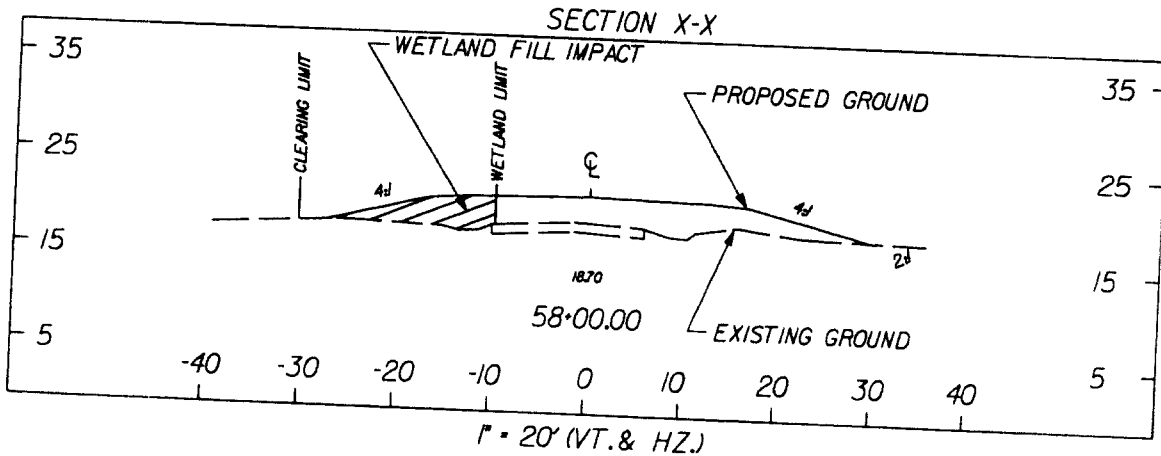
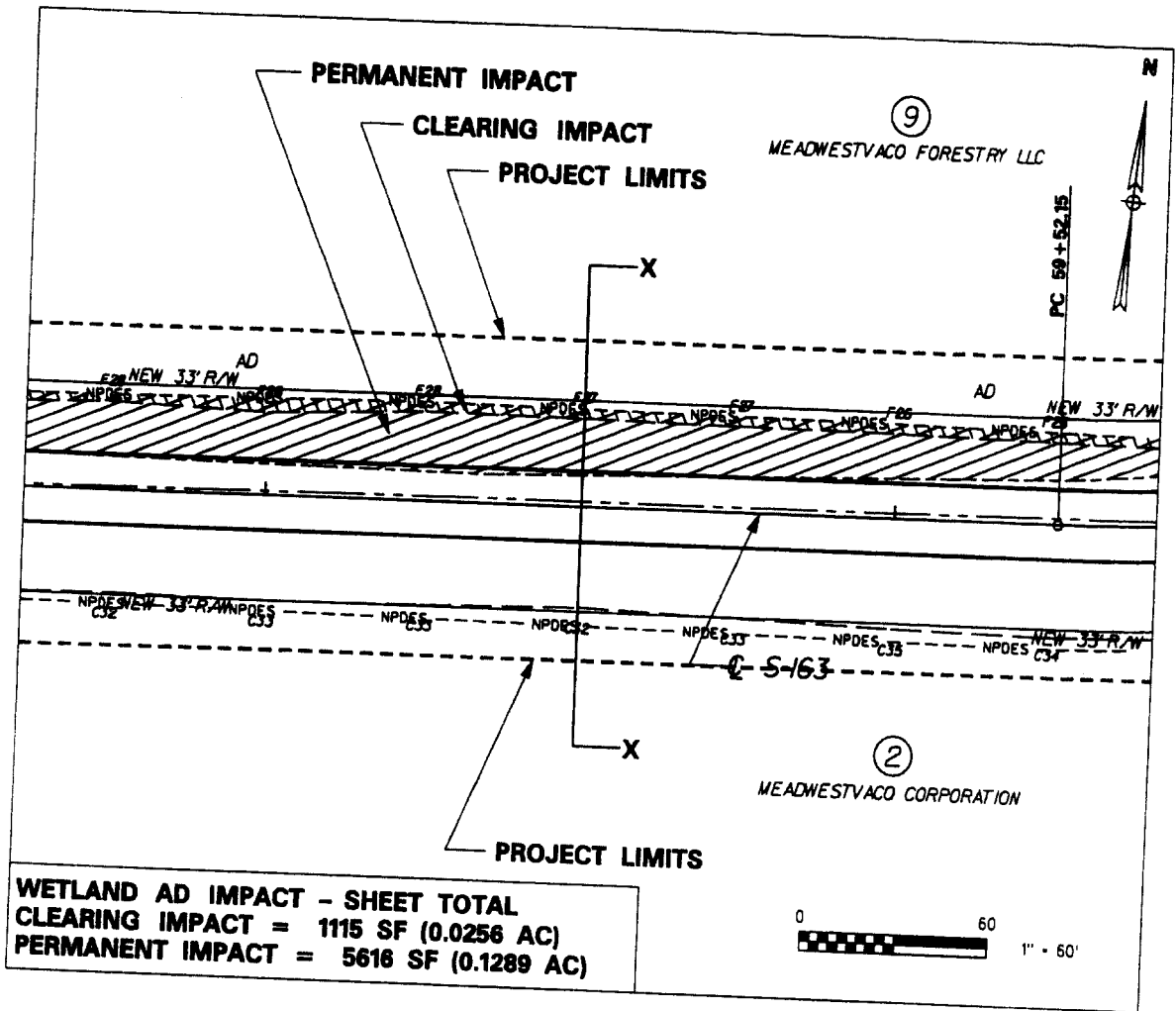

LEGEND

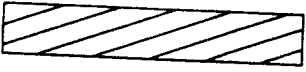
- WETLANDS LIMITS
-  WETLANDS FILL IMPACT (TEMPORARY BETWEEN TOE OF SLOPE & NPDES)
-  WETLANDS FILL IMPACT (PERMANENT)

TOTAL VOLUME OF IMPACT:
 WETLAND "AD" SEE SHEET 22

PIN 36090_SP01
WETLAND AD
S-163 SUMMERS ROAD
DORCHESTER COUNTY, SC
APPLICATION BY SCDOT
ELIGIBLE FOR FEDERAL FUNDS
DATE FEBRUARY 28, 2007
SHEET 27 OF 39

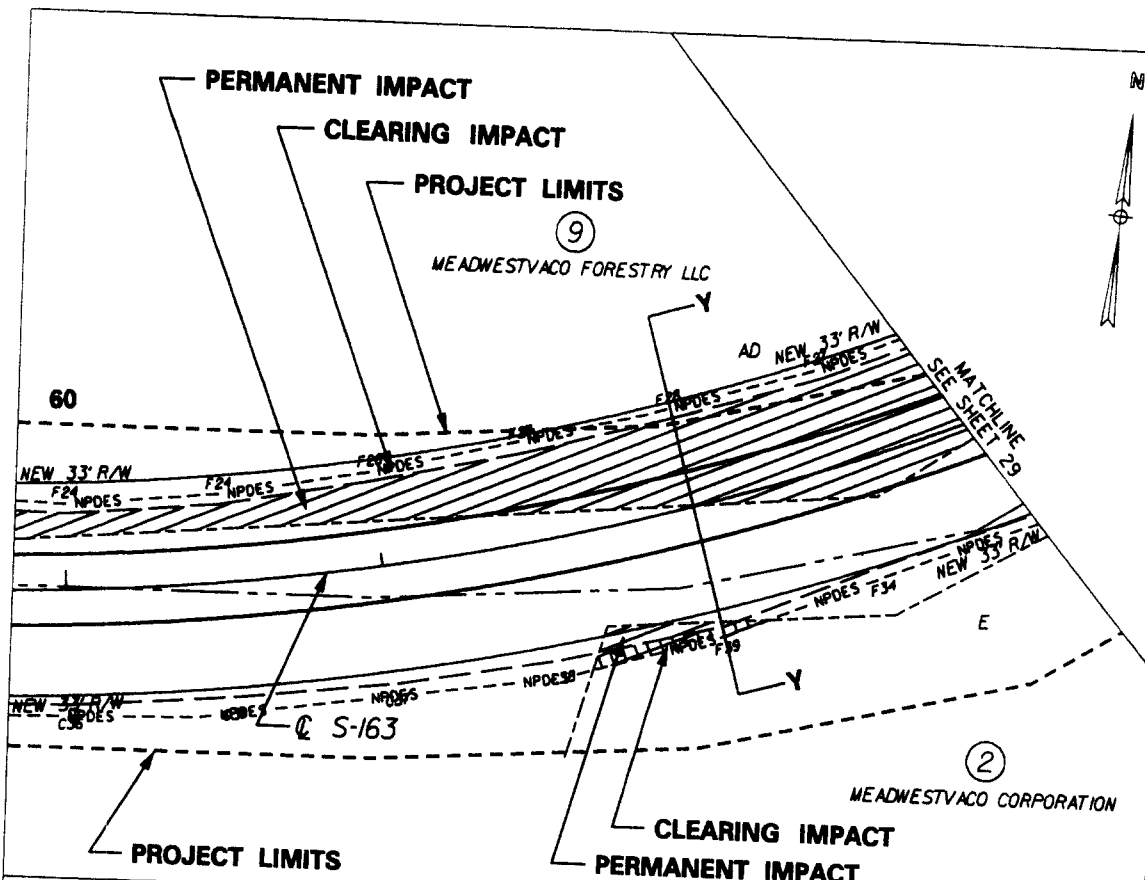

WETLAND AD IMPACT - SHEET TOTAL
CLEARING IMPACT = 917 SF (0.021 AC)
PERMANENT IMPACT = 5813 SF (0.1334 AC)

WETLAND E IMPACT - SHEET TOTAL
CLEARING IMPACT = 184 SF (0.0042 AC)
PERMANENT IMPACT = 189 SF (0.0043 AC)

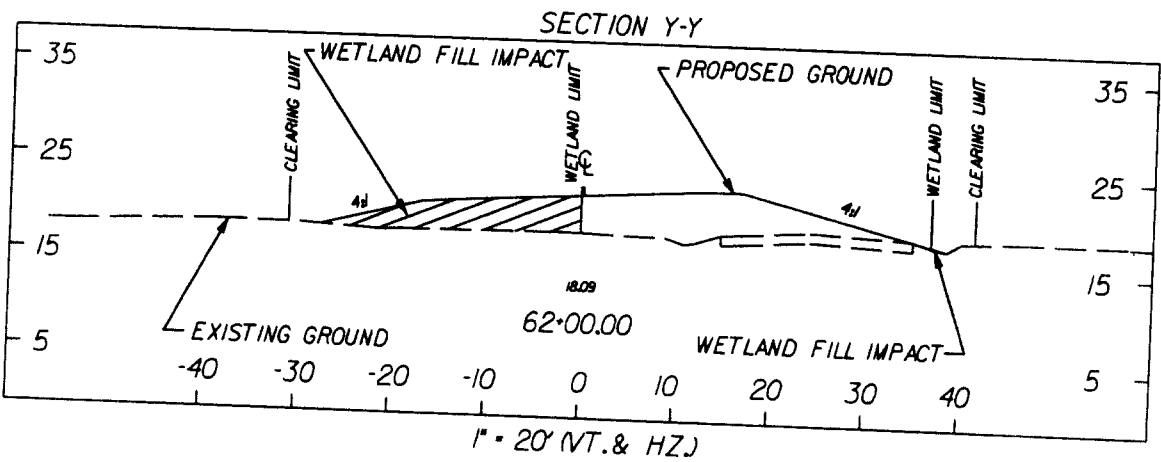

LEGEND

- WETLANDS LIMITS
- WETLANDS FILL IMPACT (TEMPORARY BETWEEN TOE OF SLOPE & NPDES)
- WETLANDS FILL IMPACT (PERMANENT)

TOTAL VOLUME OF IMPACT:
 WETLAND "AD" SEE SHEET 22
 WETLAND "E" 2997 CY

PIN 36090_SP01
WETLAND AD, E
S-163 SUMMERS ROAD
DORCHESTER COUNTY, SC
APPLICATION BY SCDOT
ELIGIBLE FOR FEDERAL FUNDS
DATE FEBRUARY 28, 2007
SHEET 28 OF 39

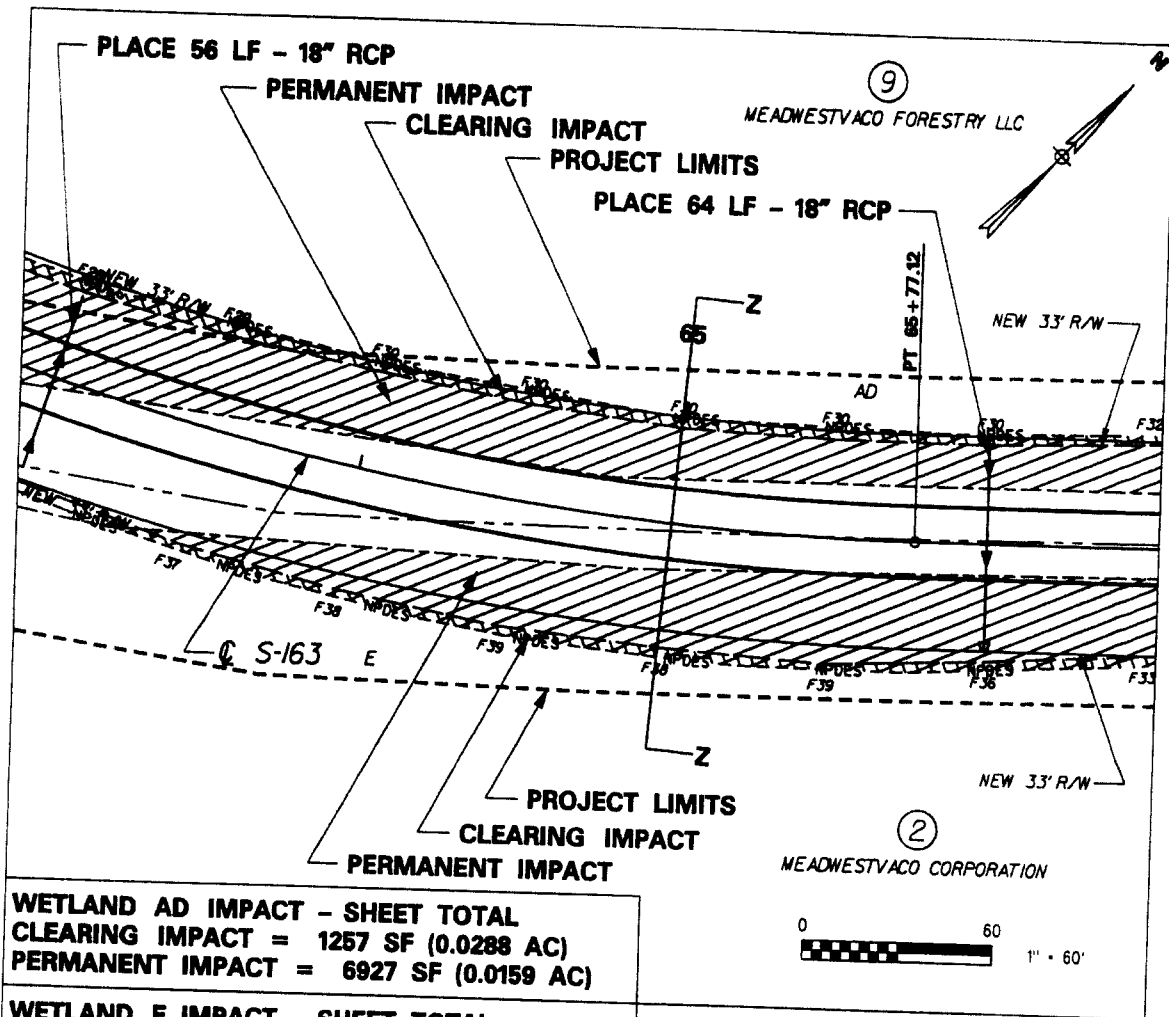

WETLAND AD IMPACT - SHEET TOTAL CLEARING IMPACT = 1257 SF (0.0288 AC) PERMANENT IMPACT = 6927 SF (0.0159 AC)
WETLAND E IMPACT - SHEET TOTAL CLEARING IMPACT = 888 SF (0.0203 AC) PERMANENT IMPACT = 6588 SF (0.151 AC)



SECTION Z-Z

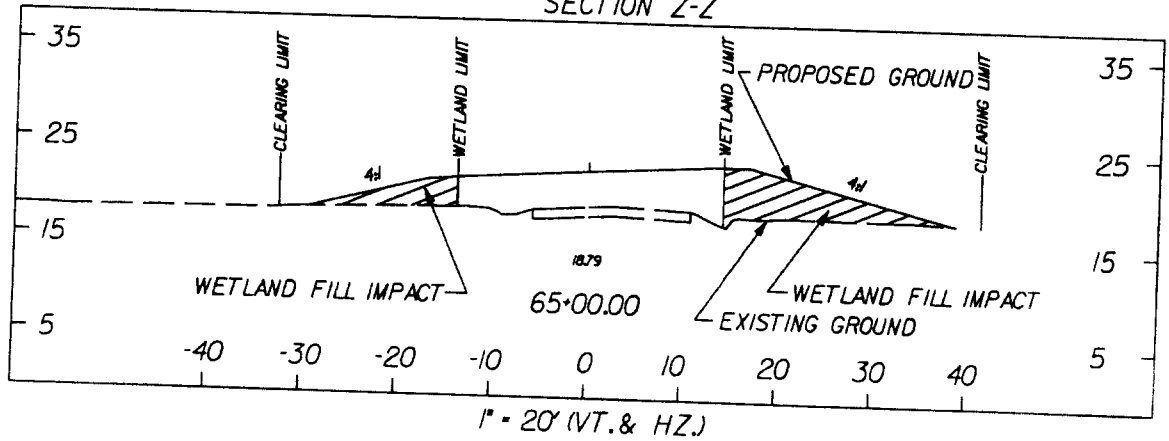

LEGEND

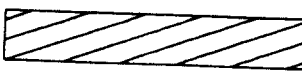
- WETLANDS LIMITS
-  WETLANDS FILL IMPACT (TEMPORARY BETWEEN TOE OF SLOPE & NPDES)
-  WETLANDS FILL IMPACT (PERMANENT)

TOTAL VOLUME OF IMPACT:
 WETLAND "AD" SEE SHEET 22
 WETLAND "E" SEE SHEET 28

PIN 36090_SP01
WETLAND AD, E
S-163 SUMMERS ROAD
DORCHESTER COUNTY, SC
APPLICATION BY SCDOT
ELIGIBLE FOR FEDERAL FUNDS
DATE FEBRUARY 28, 2007
SHEET 29 OF 39

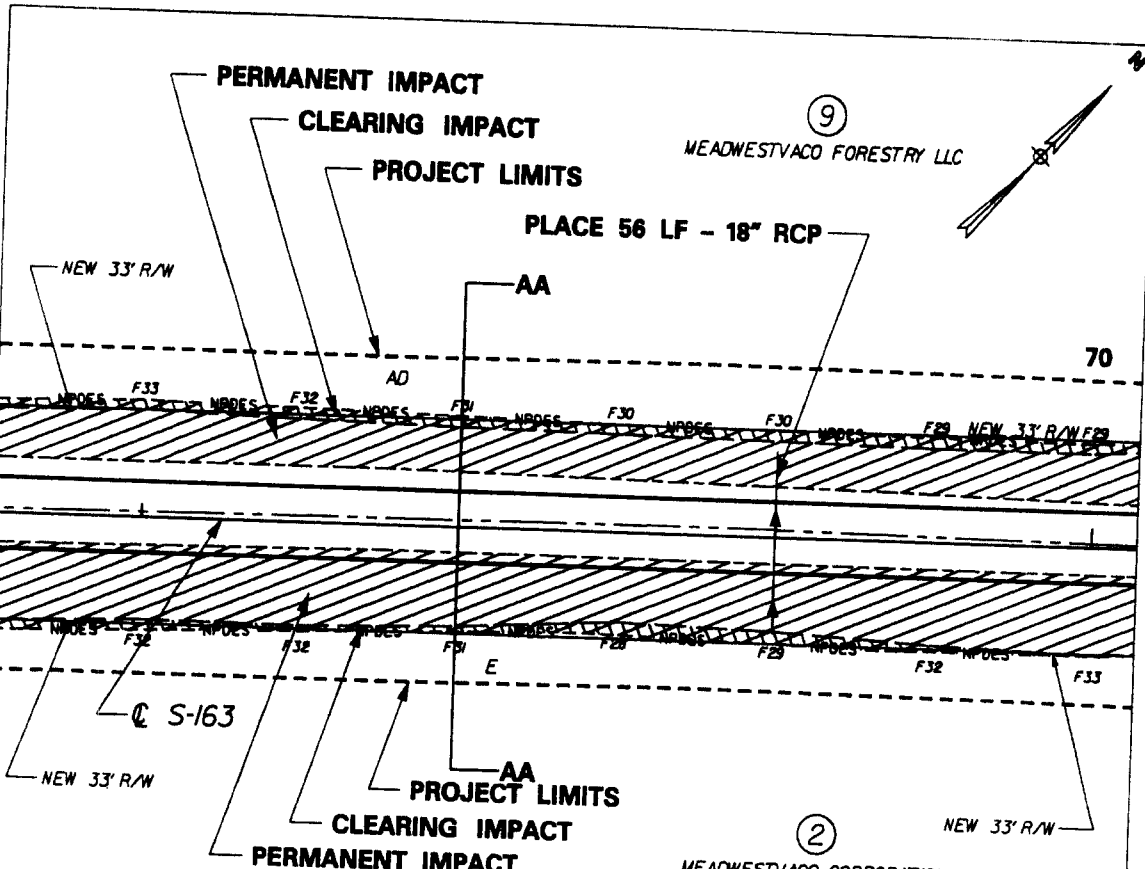

MEADWESTVACO FORESTRY LLC

MEADWESTVACO CORPORATION

WETLAND AD IMPACT - SHEET TOTAL
 CLEARING IMPACT = 1139 SF (0.0261 AC)
 PERMANENT IMPACT = 5175 SF (0.119 AC)

WETLAND E IMPACT - SHEET TOTAL
 CLEARING IMPACT = 902 SF (0.0207 AC)
 PERMANENT IMPACT = 8184 SF (0.1878 AC)

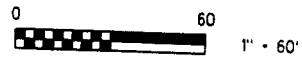

SECTION AA-AA

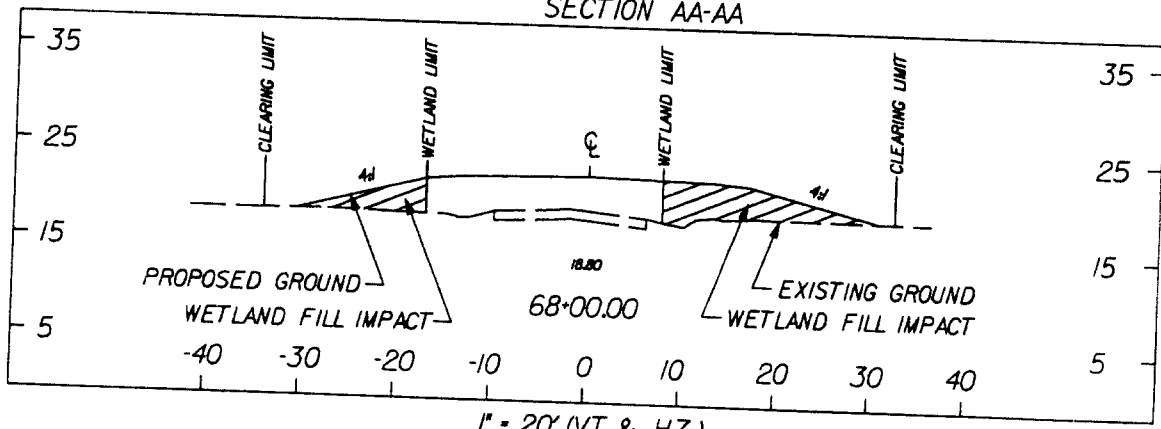

1" = 20' (VT. & HZ.)

LEGEND

- WETLANDS LIMITS
- WETLANDS FILL IMPACT (TEMPORARY BETWEEN TOE OF SLOPE & NPDES)
- WETLANDS FILL IMPACT (PERMANENT)

TOTAL VOLUME OF IMPACT:
 WETLAND 'AD' SEE SHEET 22
 WETLAND 'E' SEE SHEET 28

PIN 36090_SP01
WETLAND AD, E
S-163 SUMMERS ROAD
DORCHESTER COUNTY, SC
APPLICATION BY SCDOT
ELIGIBLE FOR FEDERAL FUNDS
DATE FEBRUARY 28, 2007
SHEET 30 OF 39

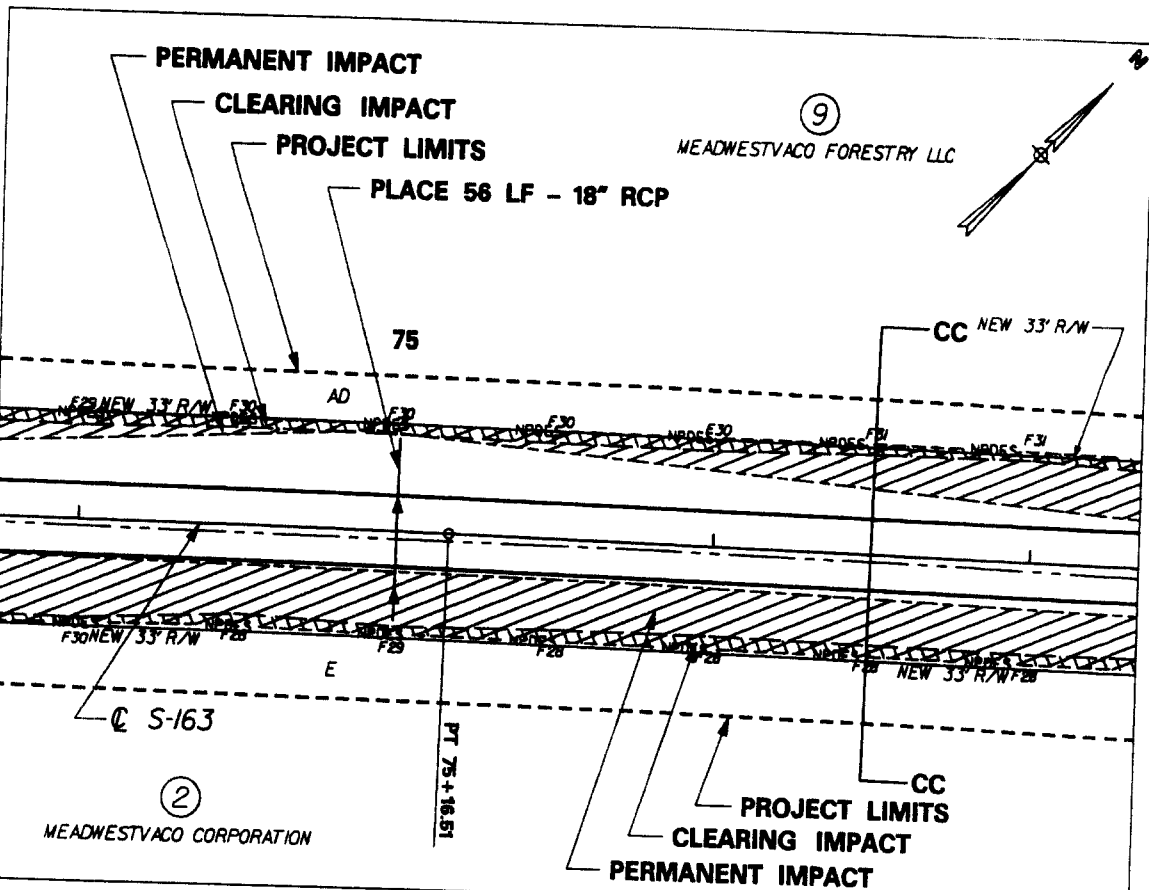

WETLAND AD IMPACT - SHEET TOTAL
CLEARING IMPACT = 1188 SF (0.0272 AC)
PERMANENT IMPACT = 2139 SF (0.049 AC)

WETLAND E IMPACT - SHEET TOTAL
CLEARING IMPACT = 1149 SF (0.0263 AC)
PERMANENT IMPACT = 5608 SF (0.1287 AC)



SECTION CC-CC

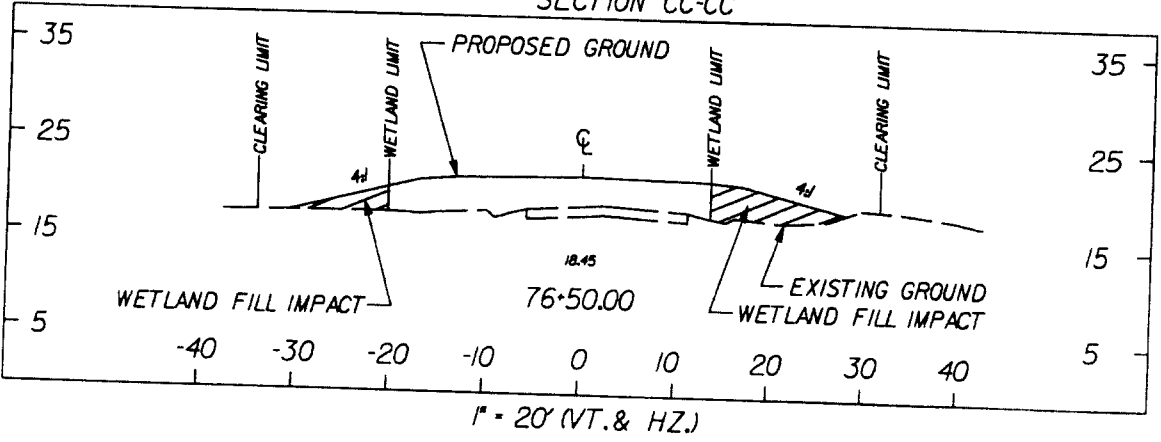

LEGEND

- WETLANDS LIMITS
- WETLANDS FILL IMPACT (TEMPORARY BETWEEN TOE OF SLOPE & NPDES)
- WETLANDS FILL IMPACT (PERMANENT)

TOTAL VOLUME OF IMPACT:
 WETLAND "AD" SEE SHEET 22
 WETLAND "E" SEE SHEET 28

PIN 36090_SP01
WETLAND AD, E
S-163 SUMMERS ROAD
DORCHESTER COUNTY, SC
APPLICATION BY SCDOT
ELIGIBLE FOR FEDERAL FUNDS
DATE FEBRUARY 28, 2007
SHEET 32 OF 39

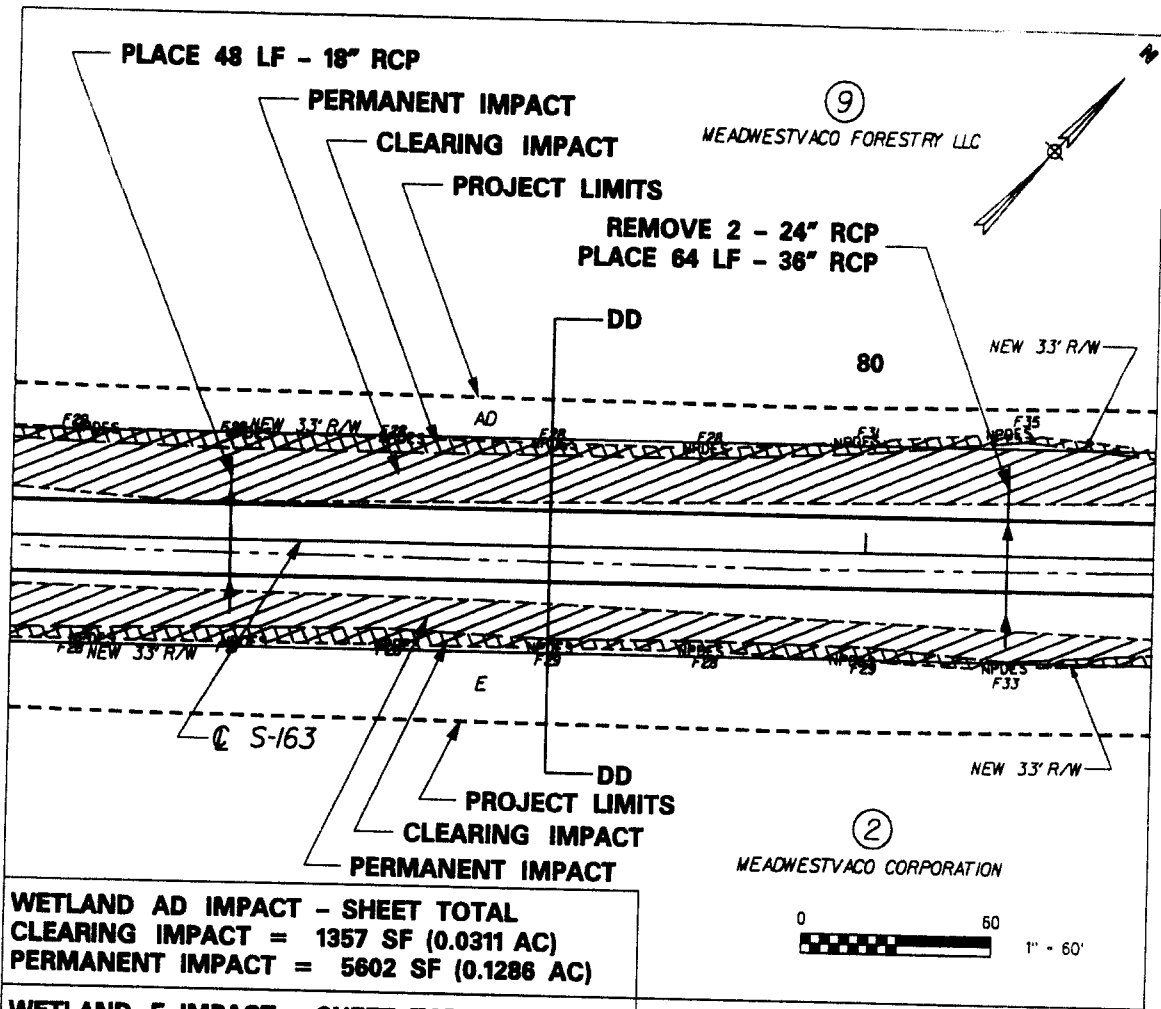

WETLAND AD IMPACT - SHEET TOTAL
 CLEARING IMPACT = 1357 SF (0.0311 AC)
 PERMANENT IMPACT = 5602 SF (0.1286 AC)

WETLAND E IMPACT - SHEET TOTAL
 CLEARING IMPACT = 1295 SF (0.0297 AC)
 PERMANENT IMPACT = 3502 SF (0.0803 AC)

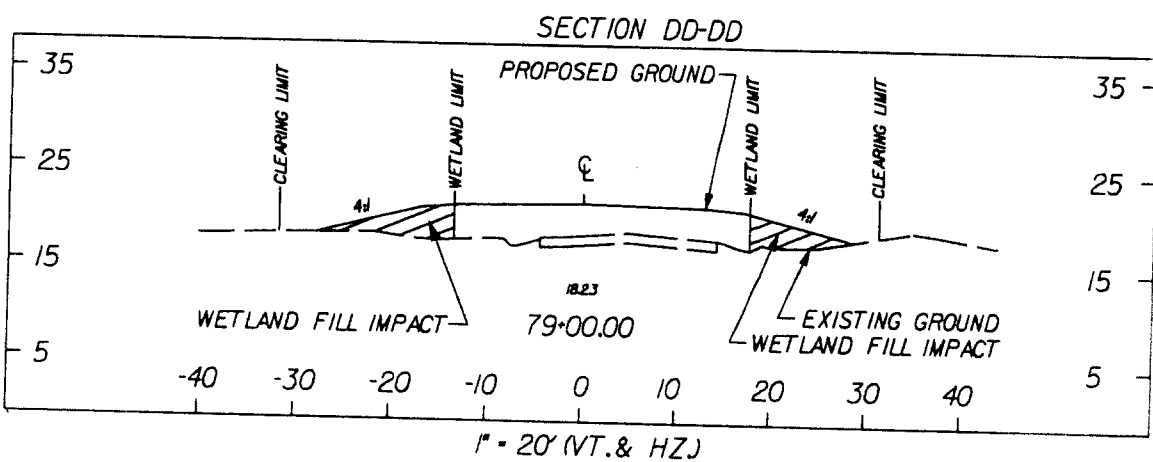

LEGEND

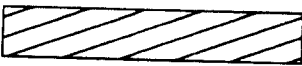
- WETLANDS LIMITS
-  WETLANDS FILL IMPACT (TEMPORARY BETWEEN TOE OF SLOPE & NPDES)
-  WETLANDS FILL IMPACT (PERMANENT)

TOTAL VOLUME OF IMPACT:
 WETLAND "AD" SEE SHEET 22
 WETLAND "E" SEE SHEET 28

PIN 36090_SP01
WETLAND AD, E
S-163 SUMMERS ROAD
DORCHESTER COUNTY, SC
APPLICATION BY SCDOT
ELIGIBLE FOR FEDERAL FUNDS
DATE FEBRUARY 28, 2007
SHEET 33 OF 39

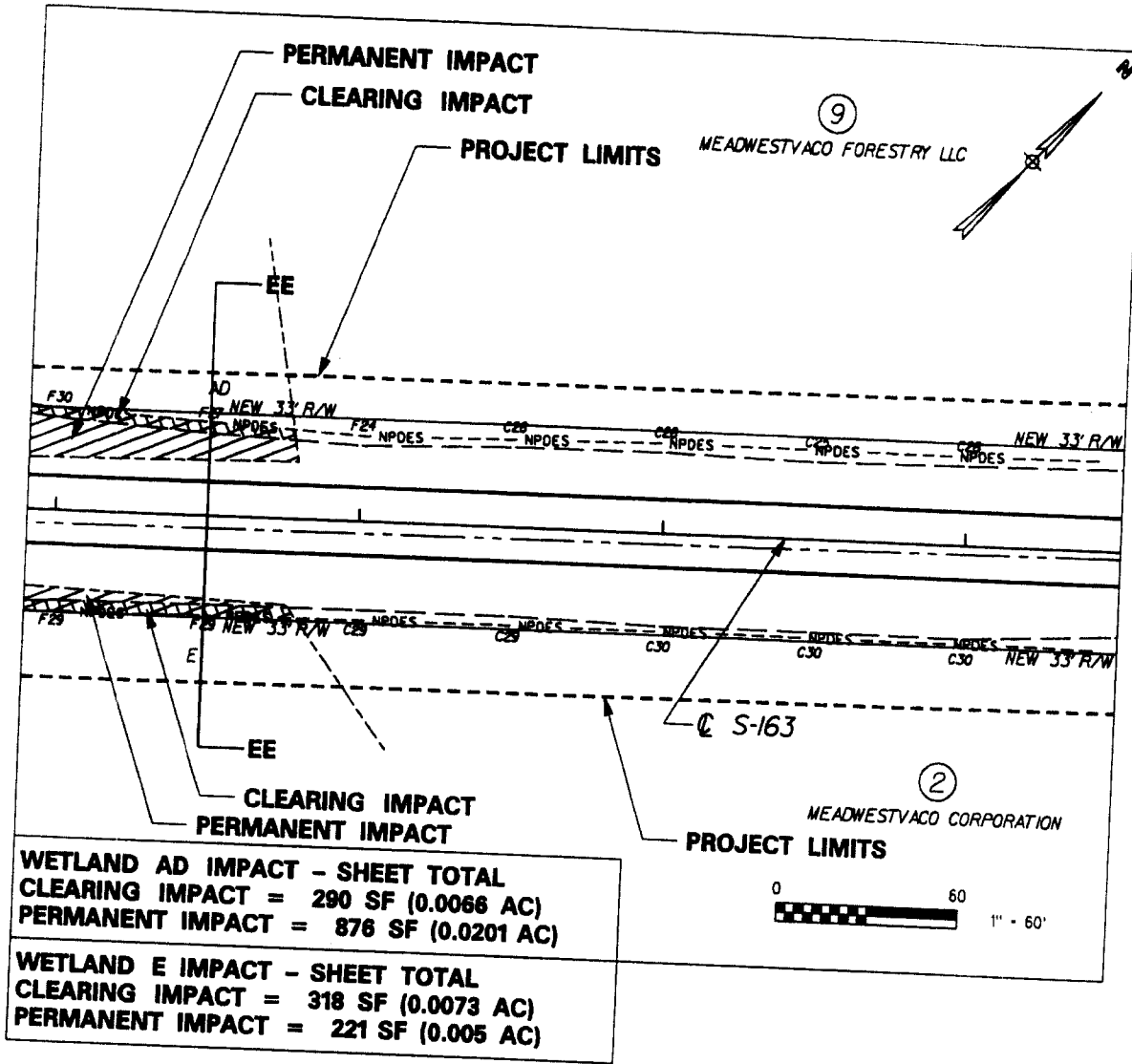

<p>WETLAND AD IMPACT - SHEET TOTAL CLEARING IMPACT = 290 SF (0.0066 AC) PERMANENT IMPACT = 876 SF (0.0201 AC)</p>
<p>WETLAND E IMPACT - SHEET TOTAL CLEARING IMPACT = 318 SF (0.0073 AC) PERMANENT IMPACT = 221 SF (0.005 AC)</p>

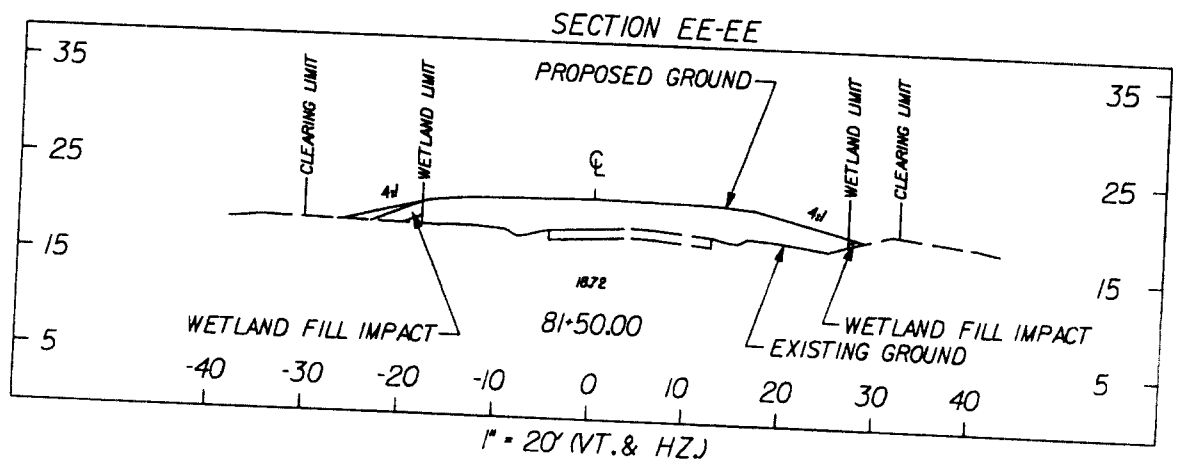

LEGEND

- WETLANDS LIMITS
-  WETLANDS FILL IMPACT (TEMPORARY BETWEEN TOE OF SLOPE & NPDES)
-  WETLANDS FILL IMPACT (PERMANENT)

TOTAL VOLUME OF IMPACT:
 WETLAND 'AD' SEE SHEET 22
 WETLAND 'E' SEE SHEET 28

PIN 36090_SP01
WETLAND AD, E
S-163 SUMMERS ROAD
DORCHESTER COUNTY, SC
APPLICATION BY SCDOT
ELIGIBLE FOR FEDERAL FUNDS
DATE FEBRUARY 28, 2007
SHEET 34 OF 39

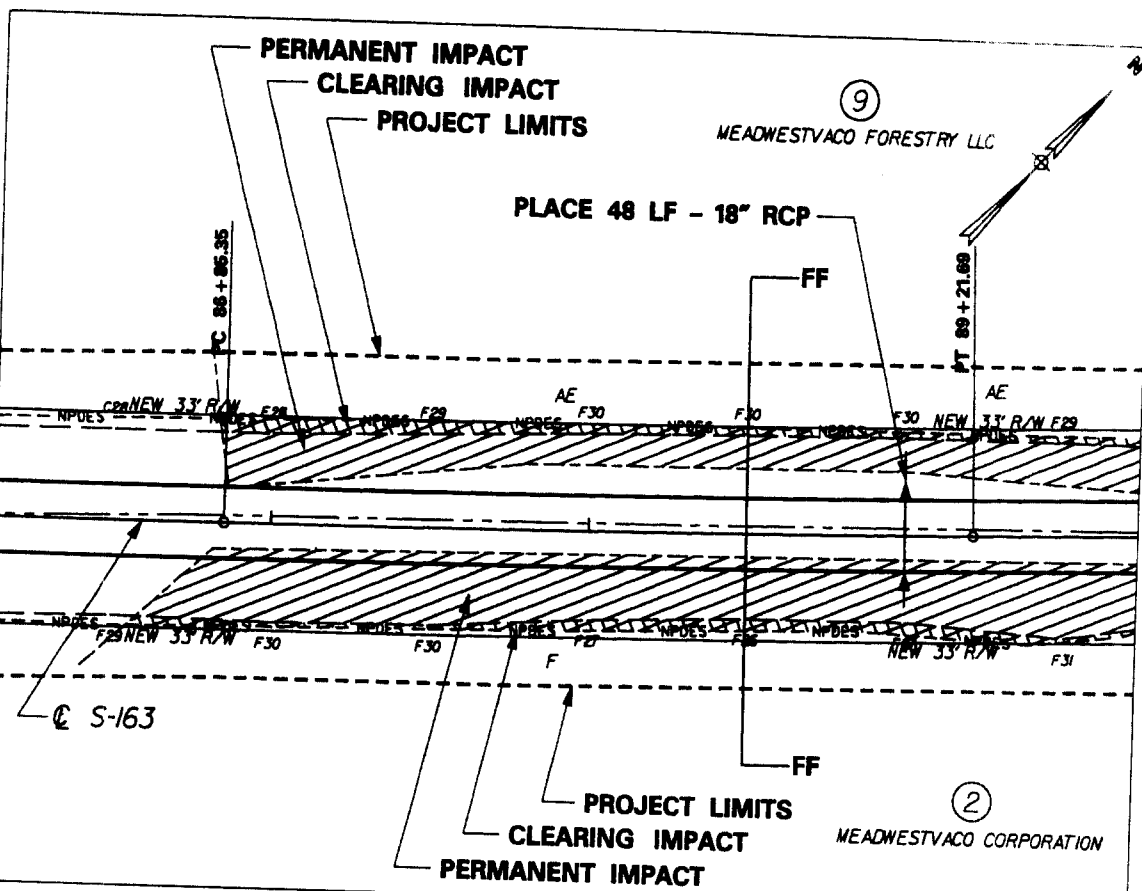

WETLAND AE IMPACT - SHEET TOTAL CLEARING IMPACT = 827 SF (0.0189 AC) PERMANENT IMPACT = 3331 SF (0.0764 AC)
WETLAND F IMPACT - SHEET TOTAL CLEARING IMPACT = 813 SF (0.0186 AC) PERMANENT IMPACT = 6368 SF (0.1461 AC)



SECTION FF-FF

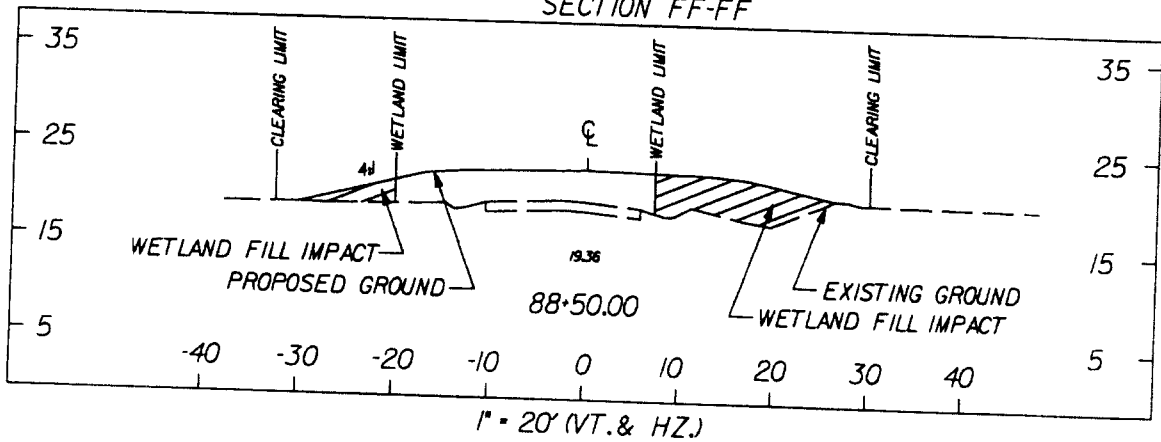

LEGEND

- WETLANDS LIMITS
- WETLANDS FILL IMPACT (TEMPORARY BETWEEN TOE OF SLOPE & NPDES)
- WETLANDS FILL IMPACT (PERMANENT)

TOTAL VOLUME OF IMPACT:
 WETLAND "AE" 153 CY
 WETLAND "F" 786 CY

PIN 36090_SP01
WETLAND AE, F
S-163 SUMMERS ROAD
DORCHESTER COUNTY, SC
APPLICATION BY SCDOT
ELIGIBLE FOR FEDERAL FUNDS
DATE FEBRUARY 28, 2007
SHEET 35 OF 39

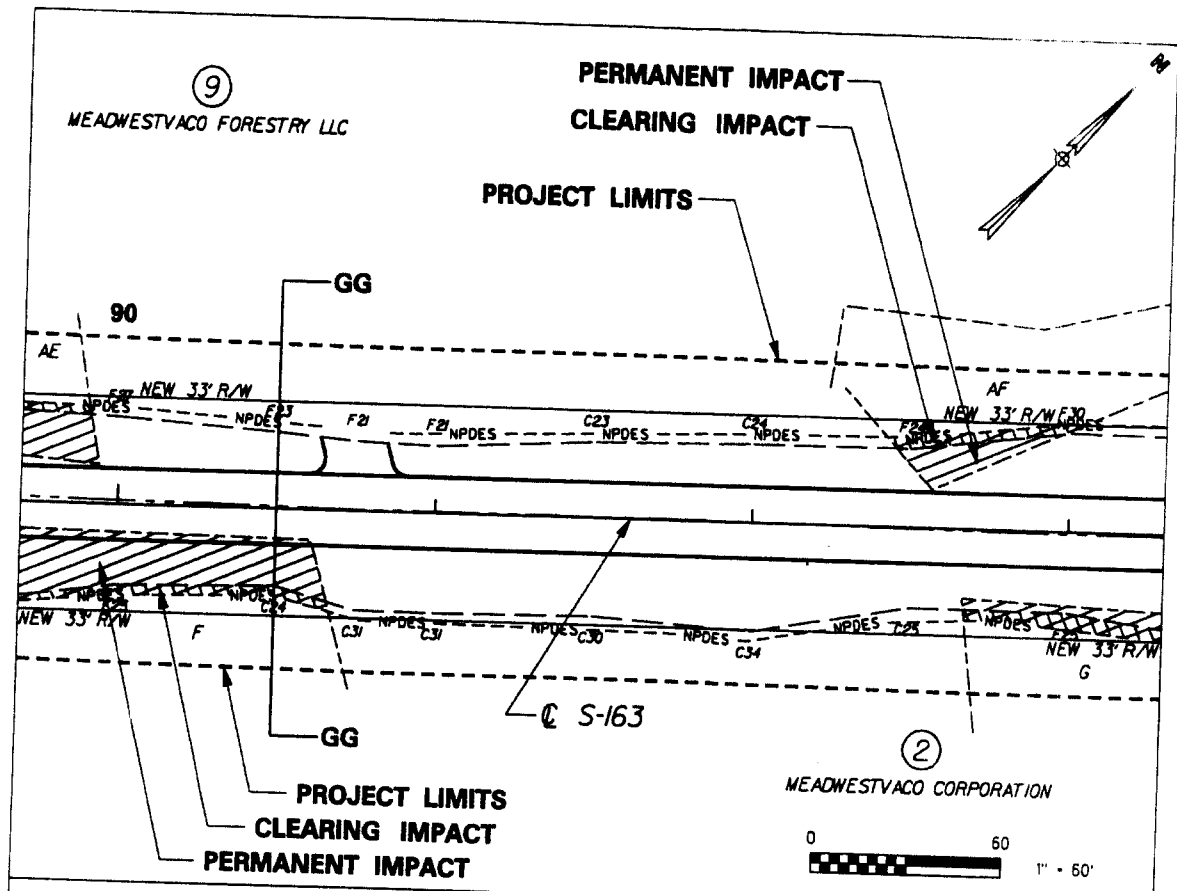

WETLAND AE IMPACT - SHEET TOTAL CLEARING IMPACT = 55 SF (0.0012 AC) PERMANENT IMPACT = 332 SF (0.0076 AC)	WETLAND AF IMPACT - SHEET TOTAL CLEARING IMPACT = 178 SF (0.004 AC) PERMANENT IMPACT = 344 SF (0.0079 AC)
WETLAND F IMPACT - SHEET TOTAL CLEARING IMPACT = 271 SF (0.0062 AC) PERMANENT IMPACT = 1553 SF (0.0356 AC)	WETLAND G IMPACT - SHEET TOTAL CLEARING IMPACT = 255 SF (0.0058 AC) PERMANENT IMPACT = 202 SF (0.0046 AC)

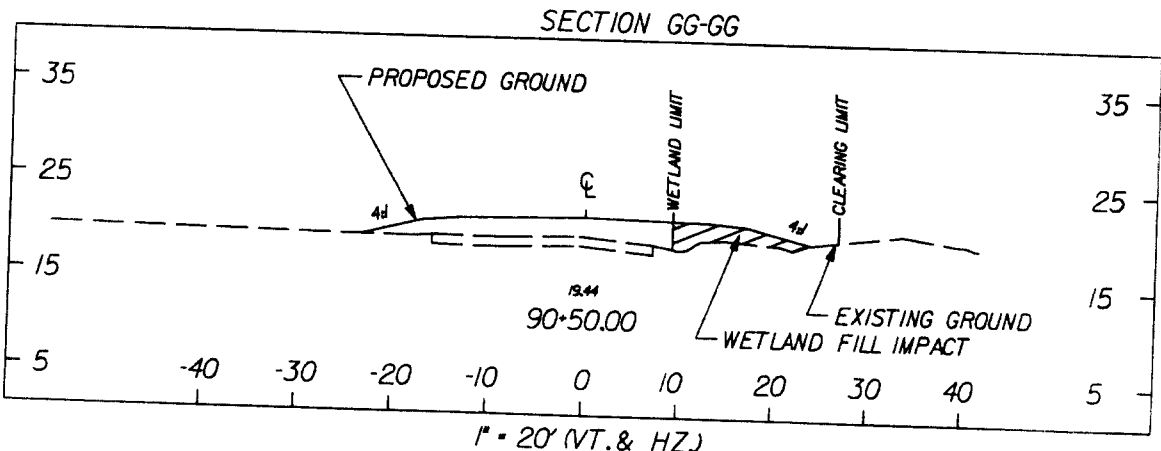

1" = 20' (VT. & HZ.)

LEGEND

- WETLANDS LIMITS
- WETLANDS FILL IMPACT (TEMPORARY BETWEEN TOE OF SLOPE & NPDES)
- WETLANDS FILL IMPACT (PERMANENT)

TOTAL VOLUME OF IMPACT:
 WETLAND "AE" SEE SHEET 35
 WETLAND "F" SEE SHEET 35
 WETLAND "AF" 1 CY
 WETLAND "G" 40 CY

PIN 36090_SP01
WETLAND AE, F, AF, G
S-163 SUMMERS ROAD
DORCHESTER COUNTY, SC
APPLICATION BY SCDOT
ELIGIBLE FOR FEDERAL FUNDS
DATE FEBRUARY 28, 2007
SHEET 36 OF 39

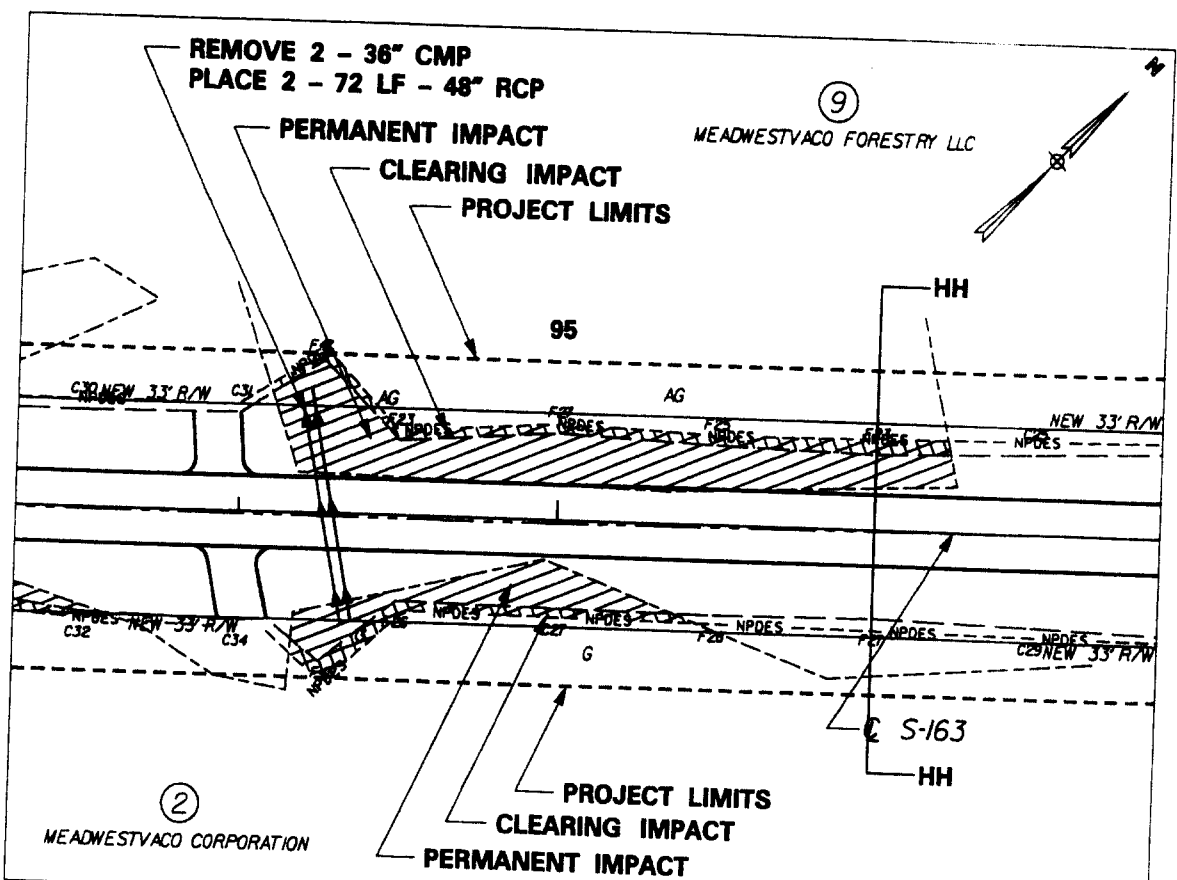

WETLAND AG IMPACT - SHEET TOTAL CLEARING IMPACT = 723 SF (0.0165 AC) PERMANENT IMPACT = 3237 SF (0.074 AC)
WETLAND G IMPACT - SHEET TOTAL CLEARING IMPACT = 537 SF (0.0123 AC) PERMANENT IMPACT = 1072 SF (0.024 AC)

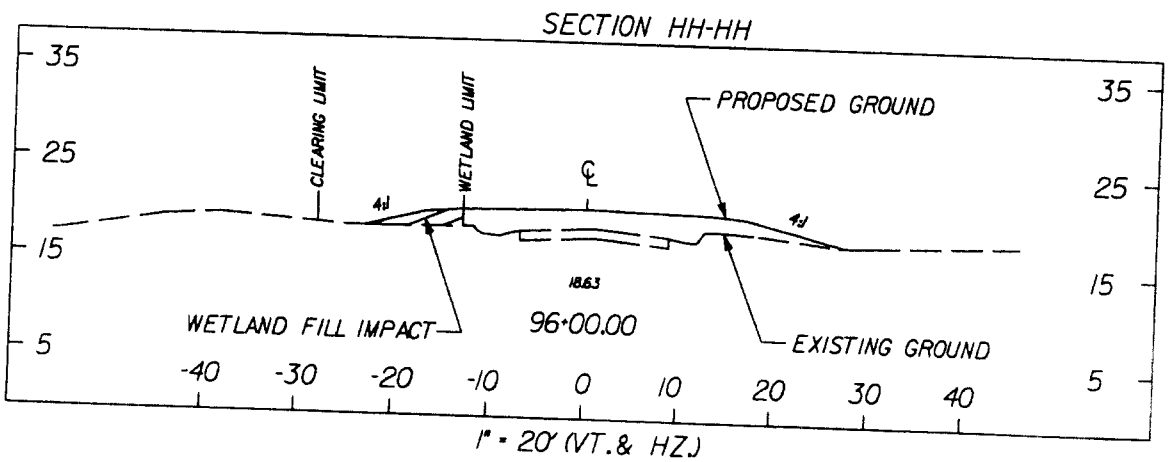

LEGEND

- WETLANDS LIMITS
- WETLANDS FILL IMPACT (TEMPORARY BETWEEN TOE OF SLOPE & NPDES)
- WETLANDS FILL IMPACT (PERMANENT)

TOTAL VOLUME OF IMPACT:
 WETLAND 'AG' 164 CY
 WETLAND 'G' SEE SHEET 37

PIN 36090_SP01
WETLAND AG, G
S-163 SUMMERS ROAD
DORCHESTER COUNTY, SC
APPLICATION BY SCDOT
ELIGIBLE FOR FEDERAL FUNDS
DATE FEBRUARY 28, 2007
SHEET 37 OF 39

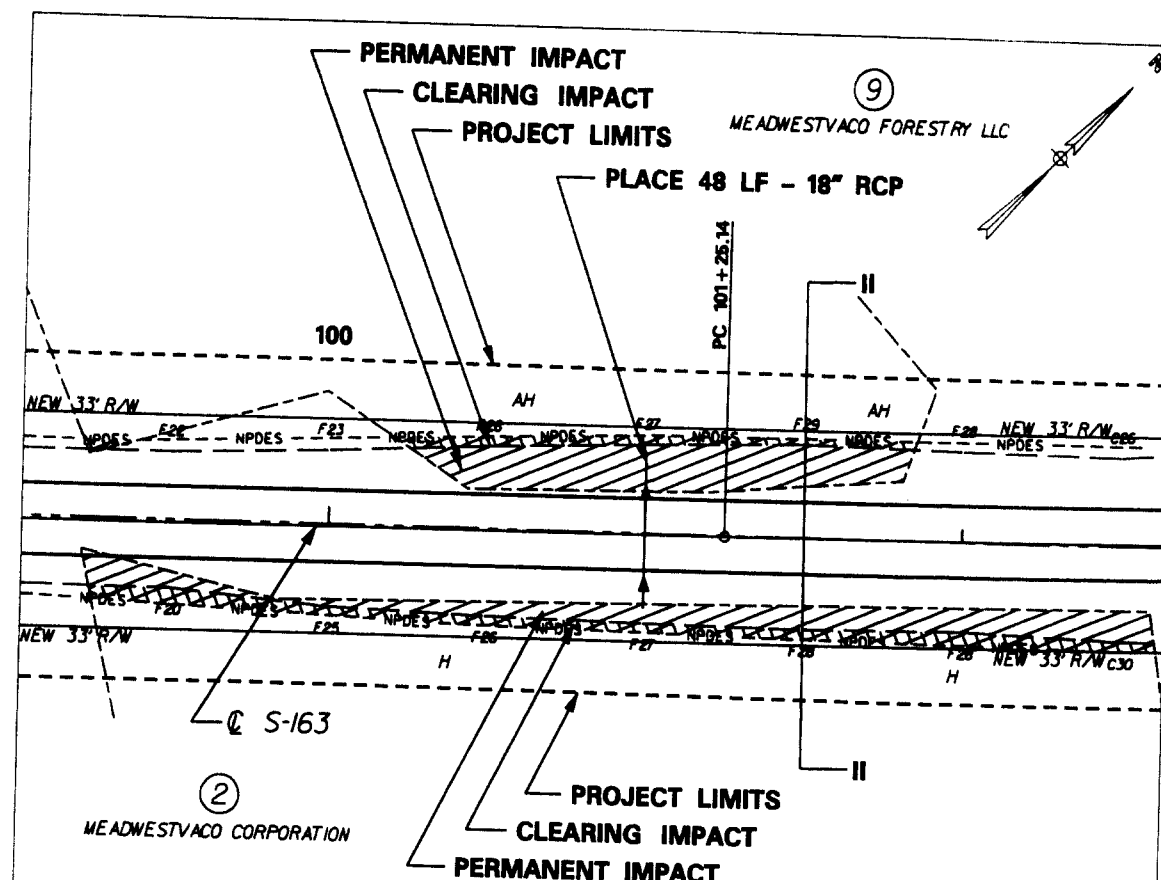

WETLAND AH IMPACT - SHEET TOTAL
CLEARING IMPACT = 475 SF (0.0109 AC)
PERMANENT IMPACT = 1959 SF (0.045 AC)

WETLAND H IMPACT - SHEET TOTAL
CLEARING IMPACT = 1107 SF (0.0254 AC)
PERMANENT IMPACT = 1979 SF (0.0454 AC)

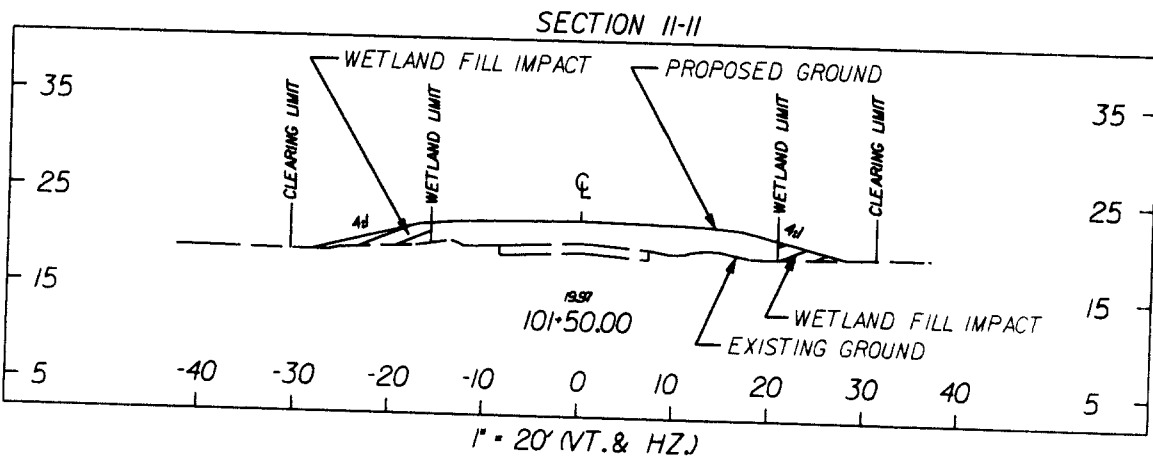

LEGEND

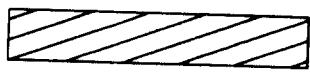
- WETLANDS LIMITS
-  WETLANDS FILL IMPACT (TEMPORARY BETWEEN TOE OF SLOPE & NPDES)
-  WETLANDS FILL IMPACT (PERMANENT)

TOTAL VOLUME OF IMPACT:
 WETLAND "AH" 95 CY
 WETLAND "H" 56 CY

PIN 36090_SP01
WETLAND "AH, H
S-163 SUMMERS ROAD
DORCHESTER COUNTY, SC
APPLICATION BY SCDOT
ELIGIBLE FOR FEDERAL FUNDS
DATE FEBRUARY 28, 2007
SHEET 38 OF 39

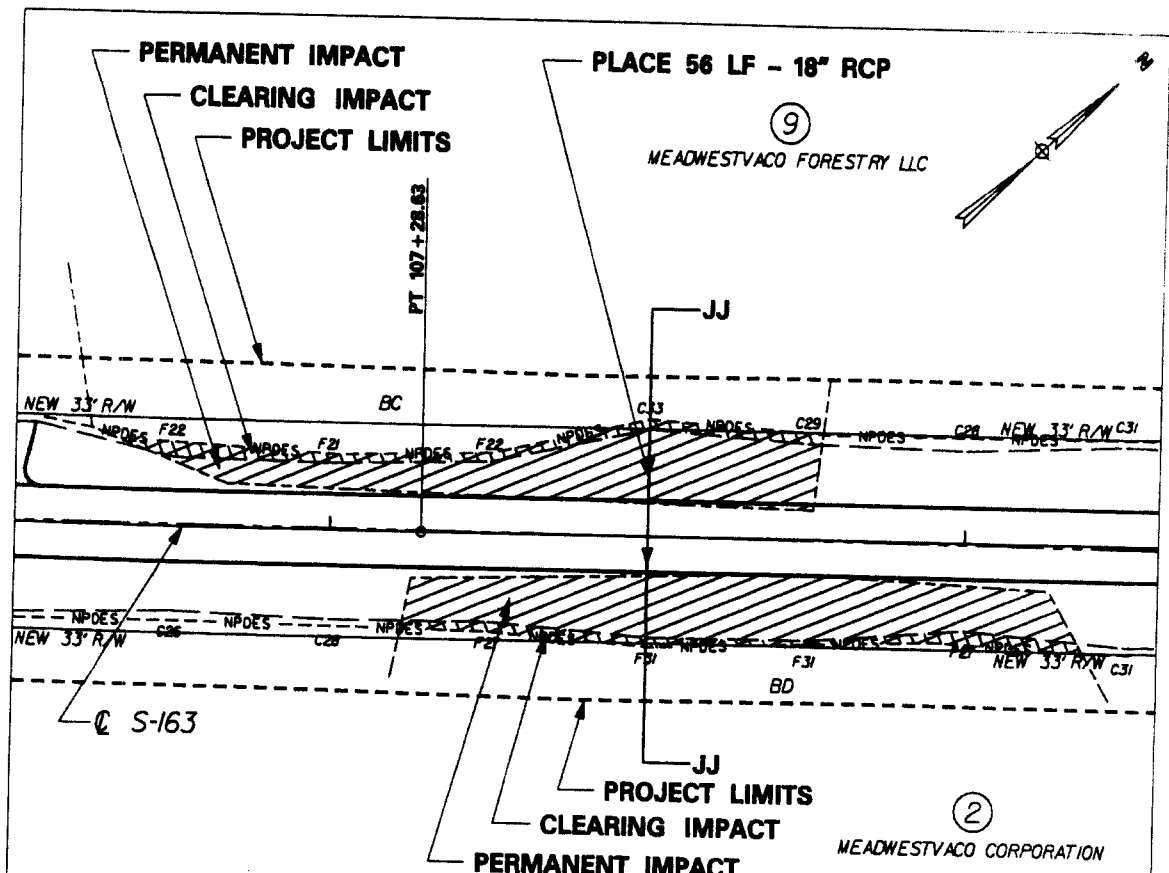

WETLAND BC IMPACT - SHEET TOTAL
CLEARING IMPACT = 704 SF (0.0161 AC)
PERMANENT IMPACT = 2760 SF (0.0633 AC)

WETLAND BD IMPACT - SHEET TOTAL
CLEARING IMPACT = 583 SF (0.0133 AC)
PERMANENT IMPACT = 3450 SF (0.079 AC)

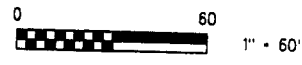

SECTION JJ-JJ

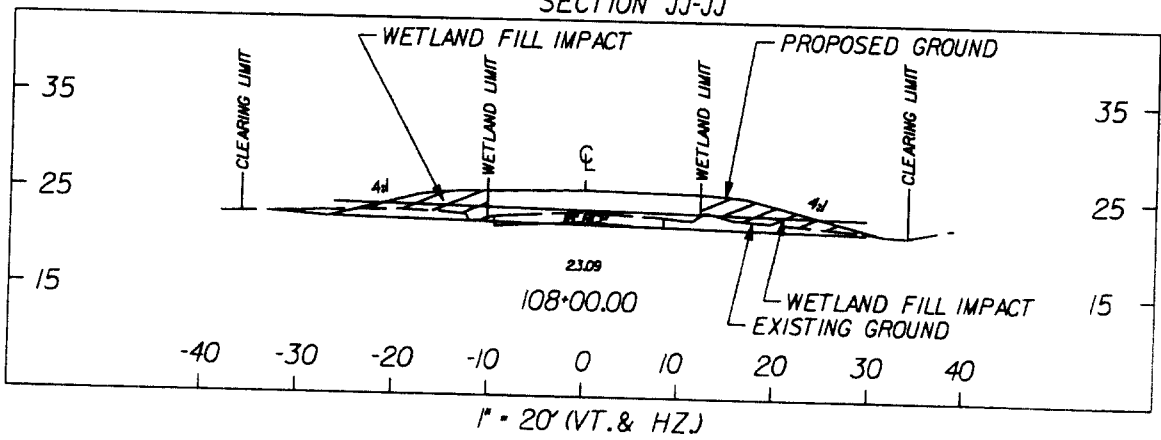

LEGEND

- WETLANDS LIMITS
- WETLANDS FILL IMPACT (TEMPORARY BETWEEN TOE OF SLOPE & NPDES)
- WETLANDS FILL IMPACT (PERMANENT)

TOTAL VOLUME OF IMPACT:
 WETLAND "BC" 123 CY
 WETLAND "BD" 177 CY

PIN 36090_SP01
WETLAND BC, BD
S-163 SUMMERS ROAD
DORCHESTER COUNTY, SC
APPLICATION BY SCDOT
ELIGIBLE FOR FEDERAL FUNDS
DATE FEBRUARY 28, 2007
SHEET 39 OF 39