

JOINT
PUBLIC NOTICE

CHARLESTON DISTRICT, CORPS OF ENGINEERS
69A Hagood Avenue
Charleston, South Carolina 29403-5107
and the

S.C. DEPARTMENT OF HEALTH AND ENVIRONMENTAL CONTROL
OFFICE OF OCEAN AND COASTAL RESOURCE MANAGEMENT
1362 McMillan Avenue, Suite 400
Charleston, South Carolina 29405

REGULATORY DIVISION
Refer to: SAC 2007-1237-DIR (Revised)

6 July 2007

This project was originally noticed pursuant only to Section 404 of the Clean Water Act (33 U.S.C. 1344). The Notice should have read:

Pursuant to Sections 401 and 404 of the Clean Water Act (33 U.S.C. 1344), and the South Carolina Coastal Zone Management Act (48-39-10 et seq.), an application has been submitted to the Department of the Army and the S.C. Department of Health and Environmental Control by

SOUTH CAROLINA DEPARTMENT OF TRANSPORTATION
POST OFFICE BOX 191
COLUMBIA, SOUTH CAROLINA 29202-0191

for a permit to place fill material in wetlands adjacent and contiguous to

SCOTTS CREEK AND FISHBURNE CREEK

at locations of S-163 (Summers Road) between SC 61 and S-84 in Dorchester County, South Carolina (Latitude 32.9242° N, Longitude 80.2911° W).

In order to give all interested parties an opportunity to express their views

NOTICE

is hereby given that written statements regarding the proposed work will be received by both of the above mentioned offices until

12 O'CLOCK NOON, MONDAY, 6 AUGUST 2007

from those interested in the activity and whose interests may be affected by the proposed work.

If there are any questions concerning this public notice, please contact Richard Darden at 843-329-8044 or toll free at 1-866-329-8187.

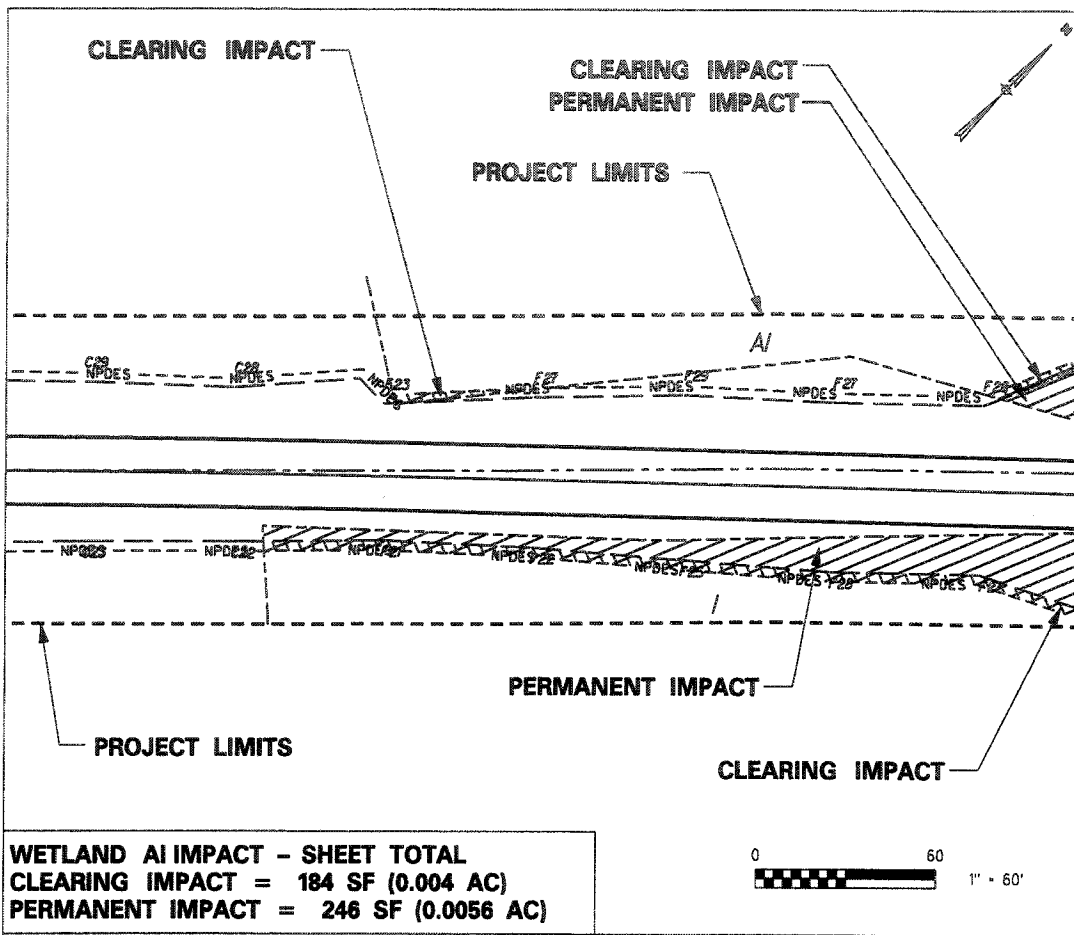

WETLAND AI IMPACT - SHEET TOTAL
CLEARING IMPACT = 184 SF (0.004 AC)
PERMANENT IMPACT = 246 SF (0.0056 AC)

WETLAND I IMPACT - SHEET TOTAL
CLEARING IMPACT = 827 SF (0.0189 AC)
PERMANENT IMPACT = 2314 SF (0.0531 AC)

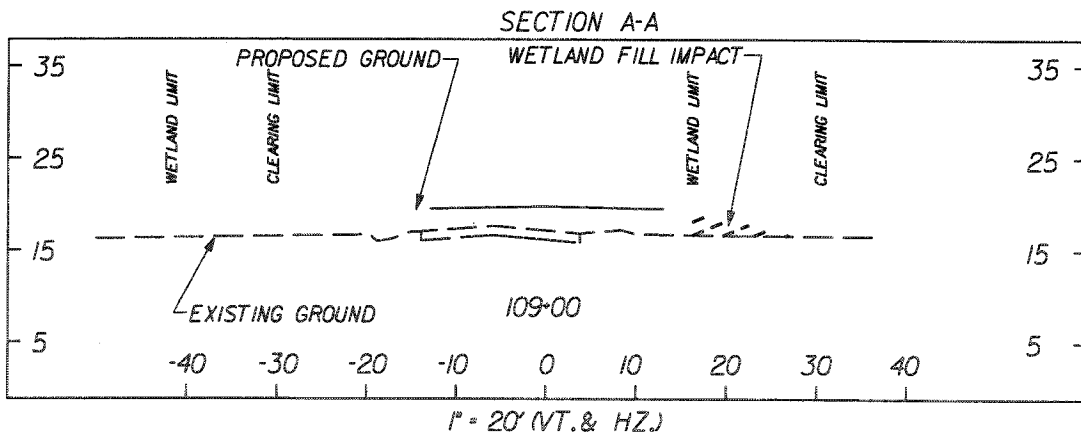

LEGEND

- WETLANDS LIMITS
- WETLANDS FILL IMPACT (TEMPORARY BETWEEN TOE OF SLOPE & NPDES)
- WETLANDS FILL IMPACT (PERMANENT)

TOTAL VOLUME OF IMPACT:
 WETLAND "I" 159 CY
 WETLAND "AI" SEE SHEET 5

PIN 36089_SP01
WETLAND AI, I
S-163 SUMMERS ROAD
DORCHESTER COUNTY, SC
APPLICATION BY SCDOT
ELIGIBLE FOR FEDERAL FUNDS
DATE FEBRUARY 16, 2007
SHEET 4 OF 47

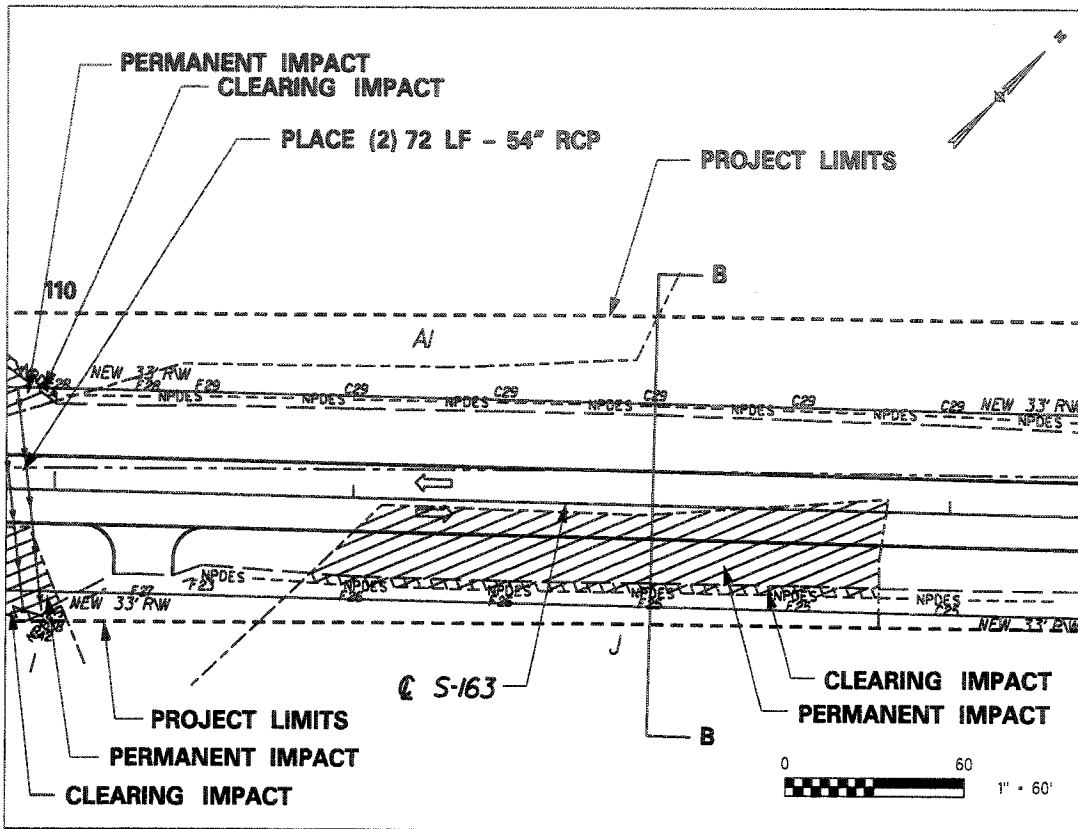



WETLAND AI IMPACT - SHEET TOTAL
 CLEARING IMPACT=69 SF (0.0015 AC)
 PERMANENT IMPACT=128 SF (0.0029 AC)

WETLAND I IMPACT - SHEET TOTAL
 CLEARING IMPACT=63 SF (0.0014 AC)
 PERMANENT IMPACT=358 SF (0.0082 AC)

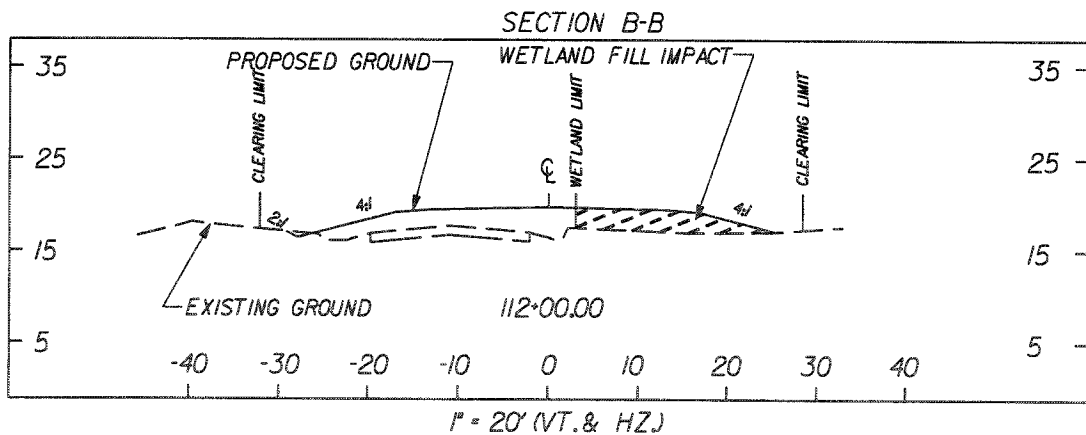
WETLAND J IMPACT - SHEET TOTAL
 CLEARING IMPACT = 578 SF (0.0132 AC)
 PERMANENT IMPACT = 4337 SF (0.0995 AC)



LEGEND

- WETLANDS LIMITS
-  WETLANDS FILL IMPACT (TEMPORARY BETWEEN TOE OF SLOPE & NPDES)
-  WETLANDS FILL IMPACT (PERMANENT)

TOTAL VOLUME OF IMPACT:
 WETLAND "AI" 27 CY
 WETLAND "J" 296 CY
 WETLAND "I" SEE SHEET 4

PIN 36089_SP01
 WETLAND AI, I, J
 S-163 SUMMERS ROAD
 DORCHESTER COUNTY, SC
 APPLICATION BY SCDOT
 ELIGIBLE FOR FEDERAL FUNDS
 DATE FEBRUARY 16, 2007
 SHEET 5 OF 47

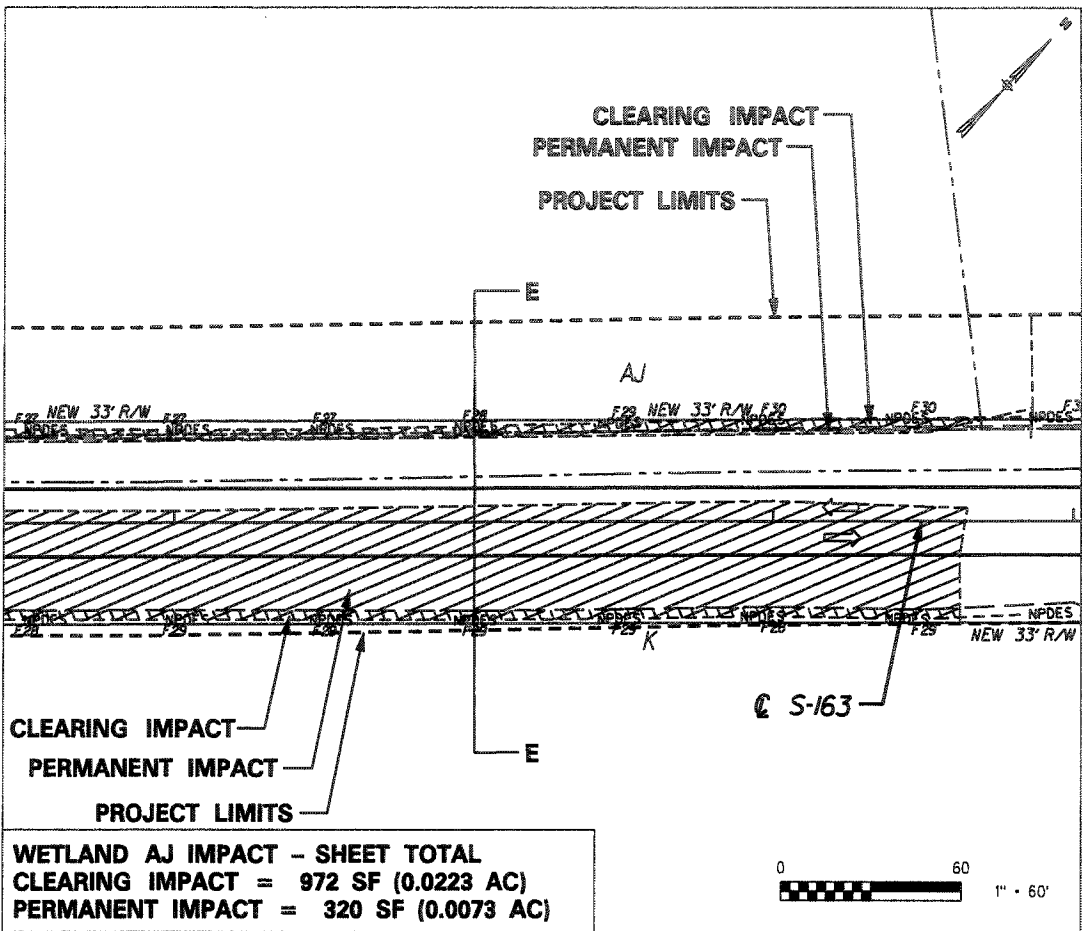

SECTION E-E

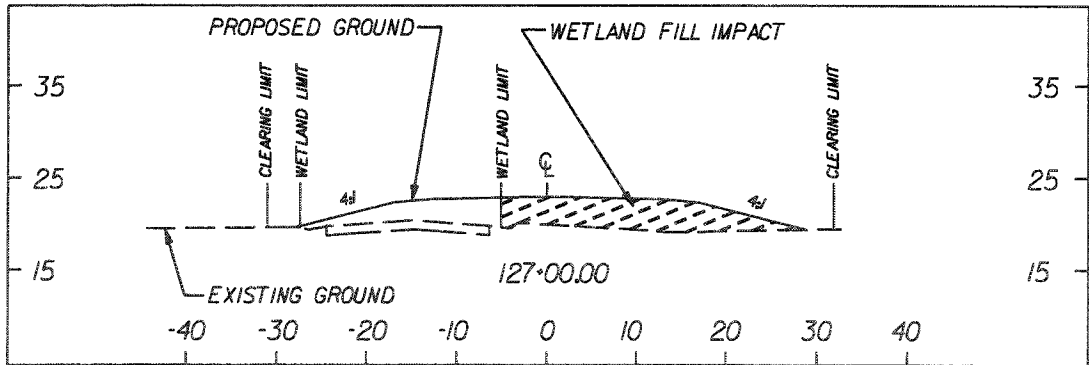

LEGEND

- WETLANDS LIMITS
- WETLANDS FILL IMPACT (TEMPORARY BETWEEN TOE OF SLOPE & NPDES)
- WETLANDS FILL IMPACT (PERMANENT)

TOTAL VOLUME OF IMPACT:
 WETLAND "AJ" SEE SHEET 6
 WETLAND "K" SEE SHEET 6

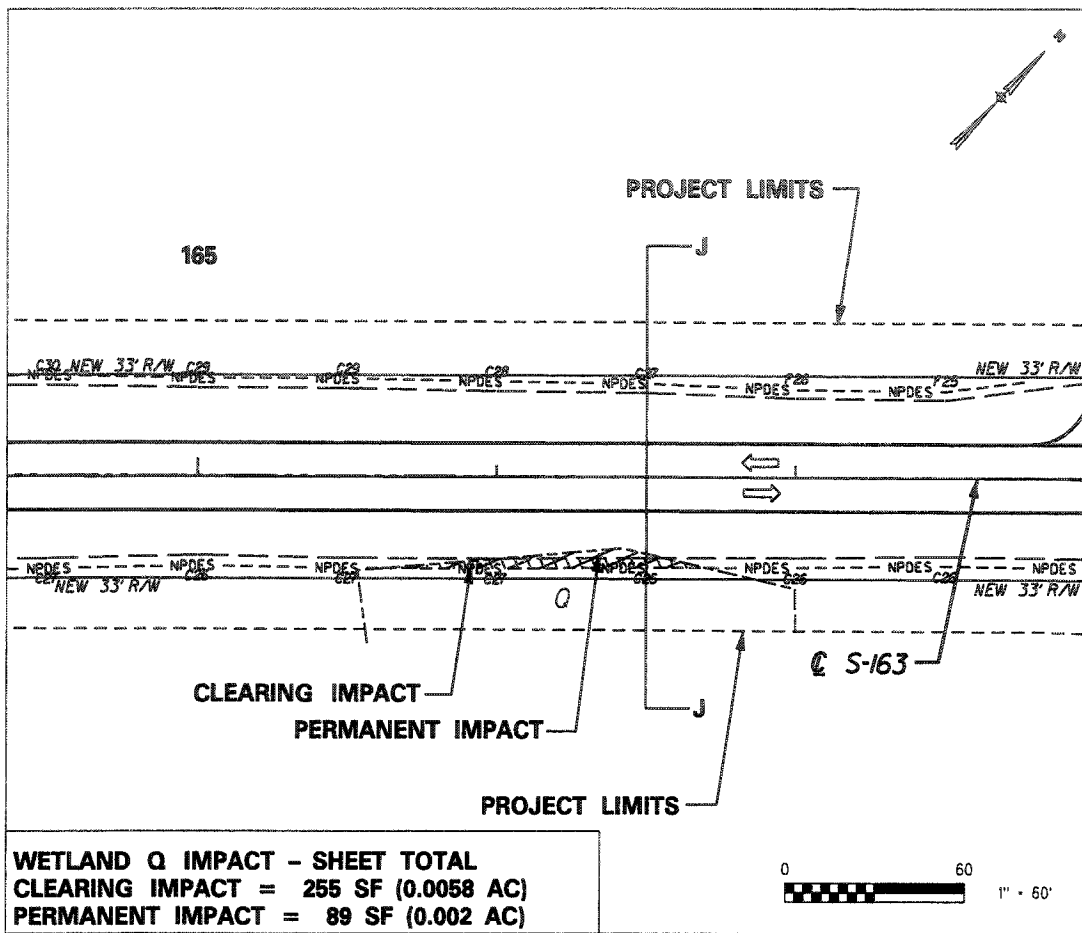

PIN 36089_SP01
WETLAND AJ, K
S-163 SUMMERS ROAD
DORCHESTER COUNTY, SC
APPLICATION BY SCDOT
ELIGIBLE FOR FEDERAL FUNDS
DATE FEBRUARY 16, 2007
SHEET 8 OF 47

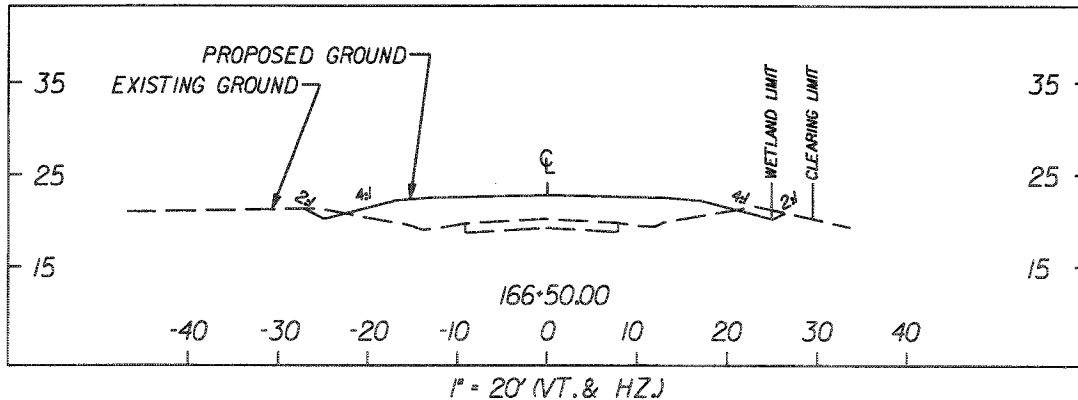

SECTION J-J



LEGEND

- WETLANDS LIMITS
-  WETLANDS FILL IMPACT (TEMPORARY BETWEEN TOE OF SLOPE & NPDES)
-  WETLANDS FILL IMPACT (PERMANENT)

TOTAL VOLUME OF IMPACT:
 WETLAND "Q" 0 CY FILL, 1 CY CUT

PIN 36089_SP01
 WETLAND Q
 S-163 SUMMERS ROAD
 DORCHESTER COUNTY, SC
 APPLICATION BY SCDOT
 ELIGIBLE FOR FEDERAL FUNDS
 DATE FEBRUARY 16, 2007
 SHEET 13 OF 47

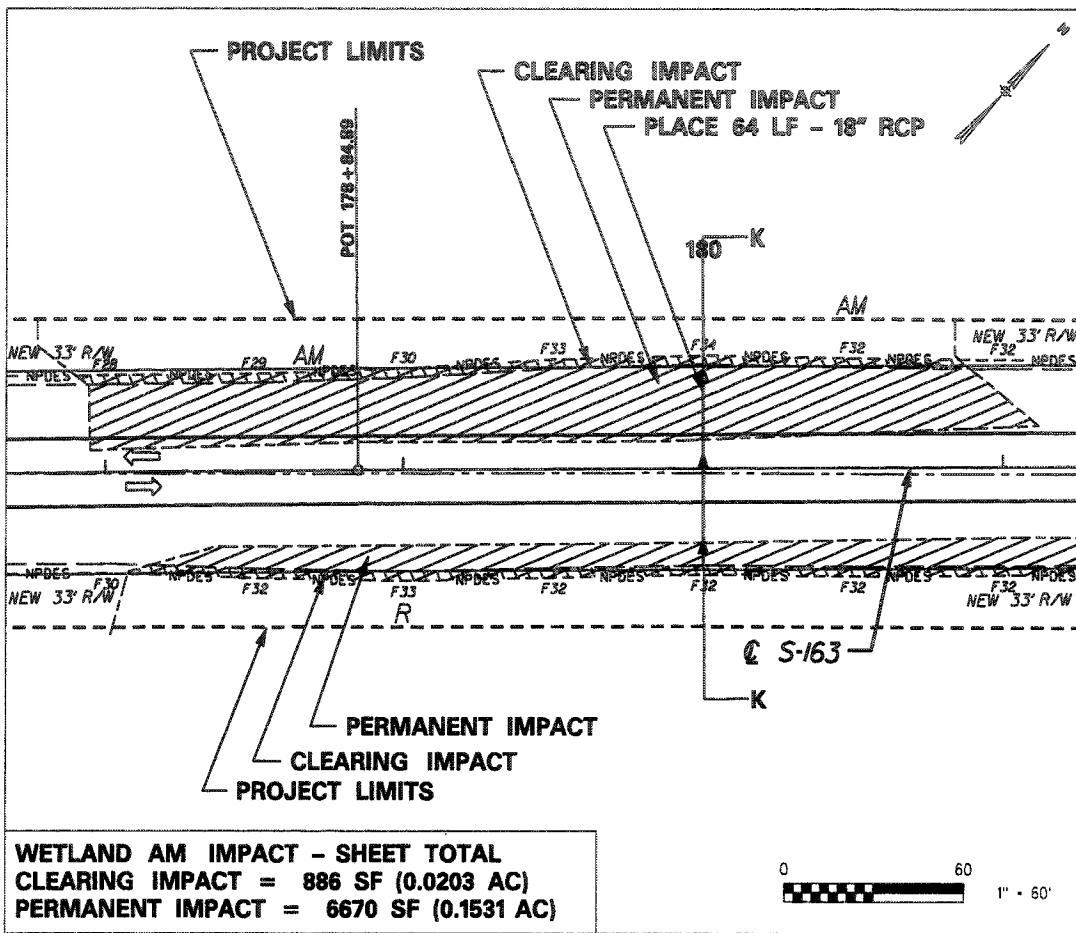

SECTION K-K

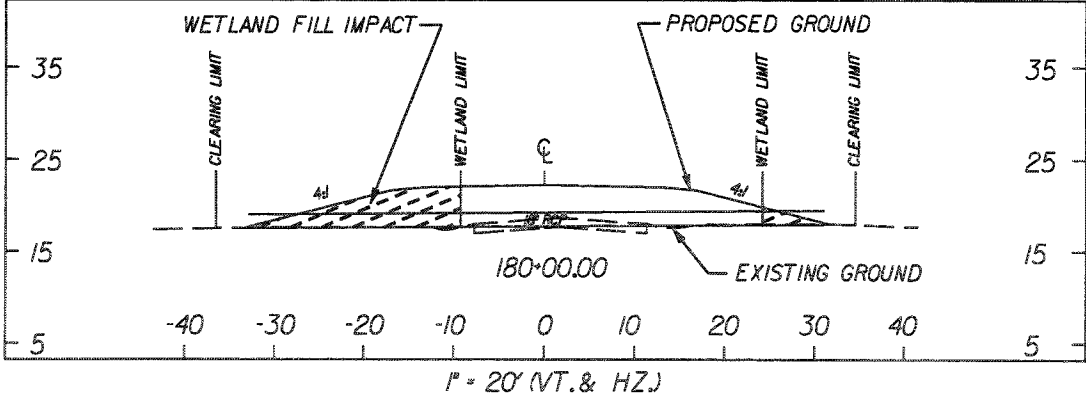

LEGEND

- WETLANDS LIMITS
- WETLANDS FILL IMPACT (TEMPORARY BETWEEN TOE OF SLOPE & NPDES)
- WETLANDS FILL IMPACT (PERMANENT)

TOTAL VOLUME OF IMPACT:
 WETLAND "AM" 657 CY
 WETLAND "R" 160 CY

PIN 36089_SP01
 WETLAND AM, R
 S-163 SUMMERS ROAD
 DORCHESTER COUNTY, SC
 APPLICATION BY SCDOT
 ELIGIBLE FOR FEDERAL FUNDS
 DATE FEBRUARY 16, 2007
 SHEET 14 OF 47

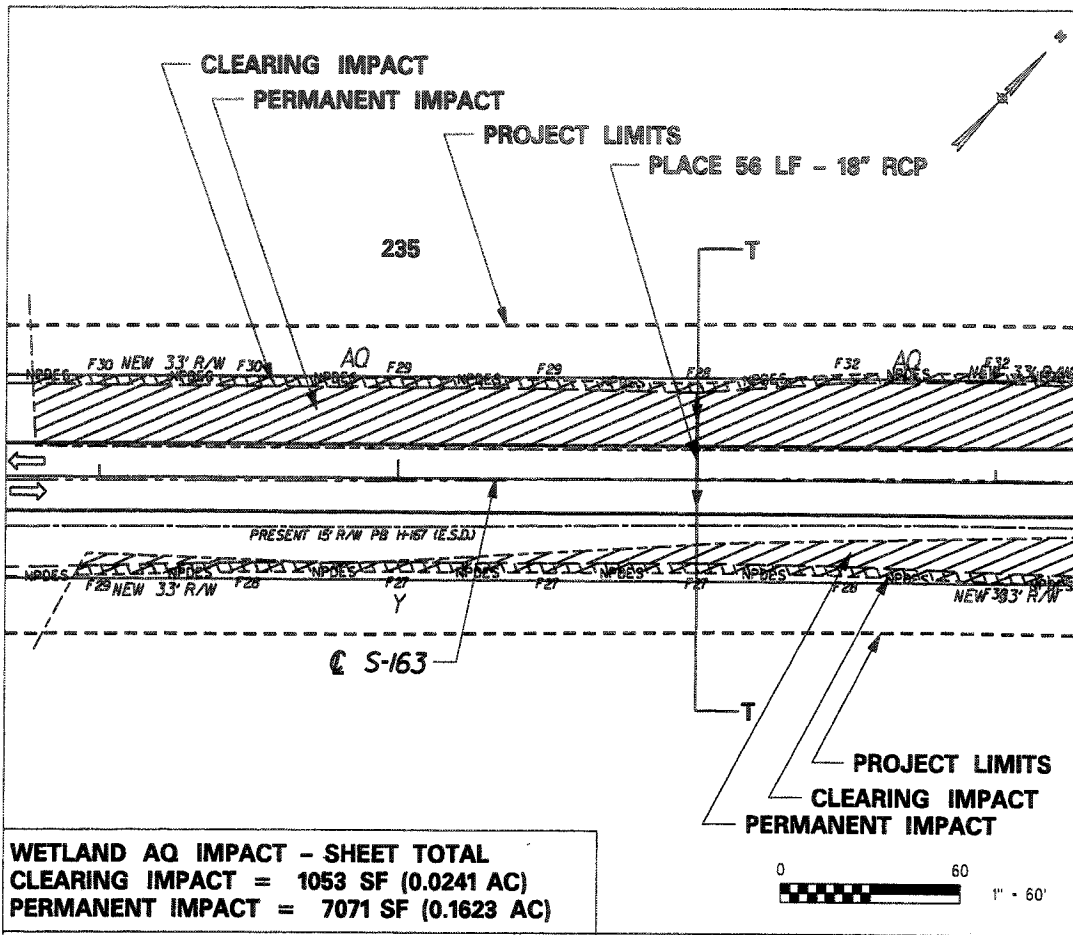

WETLAND AQ IMPACT - SHEET TOTAL
CLEARING IMPACT = 1053 SF (0.0241 AC)
PERMANENT IMPACT = 7071 SF (0.1623 AC)

WETLAND Y IMPACT - SHEET TOTAL
CLEARING IMPACT = 1005 SF (0.023 AC)
PERMANENT IMPACT = 1687 SF (0.0387 AC)

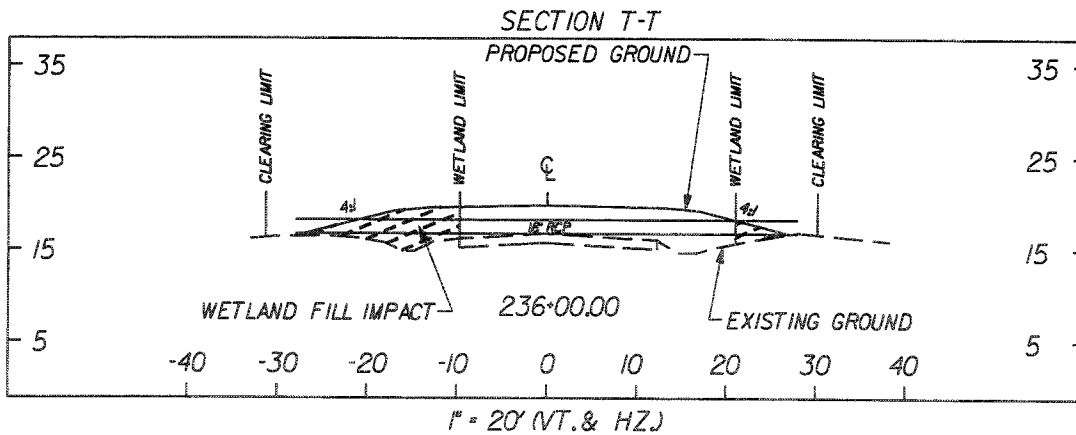

LEGEND

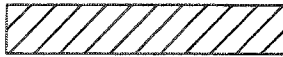
- WETLANDS LIMITS
-  WETLANDS FILL IMPACT (TEMPORARY BETWEEN TOE OF SLOPE & NPDES)
-  WETLANDS FILL IMPACT (PERMANENT)

TOTAL VOLUME OF IMPACT:
 WETLAND "AQ" 1925 CY
 WETLAND "Y" 1138 CY

PIN 36089_SP01
 WETLAND AQ, Y
 S-163 SUMMERS ROAD
 DORCHESTER COUNTY, SC
 APPLICATION BY SCDOT
 ELIGIBLE FOR FEDERAL FUNDS
 DATE FEBRUARY 16, 2007
 SHEET 23 OF 47

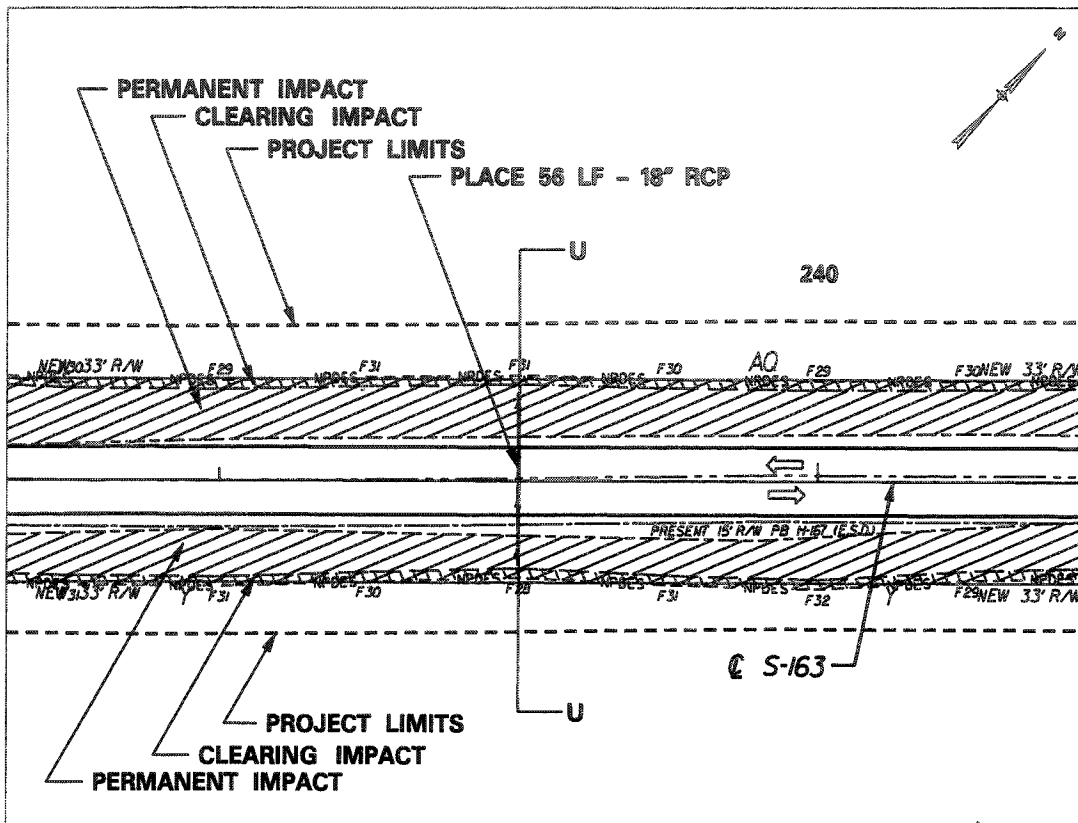

WETLAND AQ IMPACT - SHEET TOTAL
CLEARING IMPACT = 1080 SF (0.0248 AC)
PERMANENT IMPACT = 5782 SF (0.1327 AC)



WETLAND Y IMPACT - SHEET TOTAL
CLEARING IMPACT = 1081 SF (0.0248 AC)
PERMANENT IMPACT = 4754 SF (0.1091 AC)

SECTION U-U

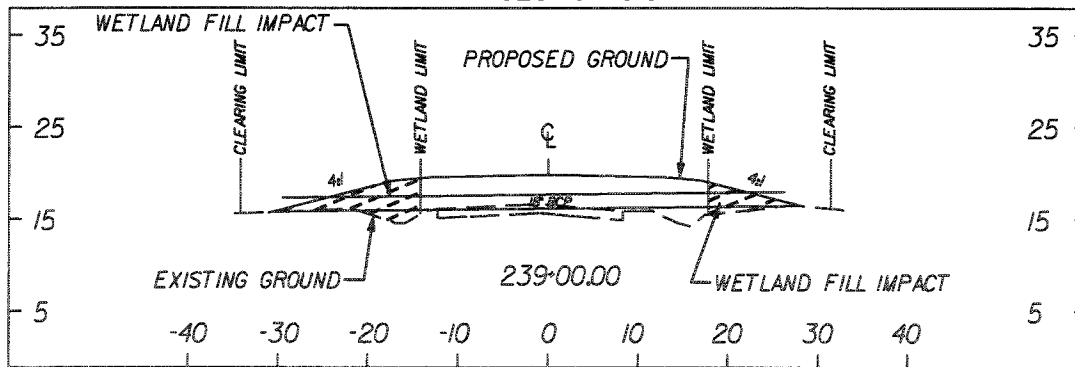

1" = 20' (VT. & HZ.)

LEGEND

- WETLANDS LIMITS
- WETLANDS FILL IMPACT (TEMPORARY BETWEEN TOE OF SLOPE & NPDES)
- WETLANDS FILL IMPACT (PERMANENT)

TOTAL VOLUME OF IMPACT:
 WETLAND "AQ" SEE SHEET 23
 WETLAND "Y" SEE SHEET 23

PIN 36089_SP01
WETLAND AQ, Y
S-163 SUMMERS ROAD
DORCHESTER COUNTY, SC
APPLICATION BY SCDOT
ELIGIBLE FOR FEDERAL FUNDS
DATE FEBRUARY 16, 2007
SHEET 24 OF 47

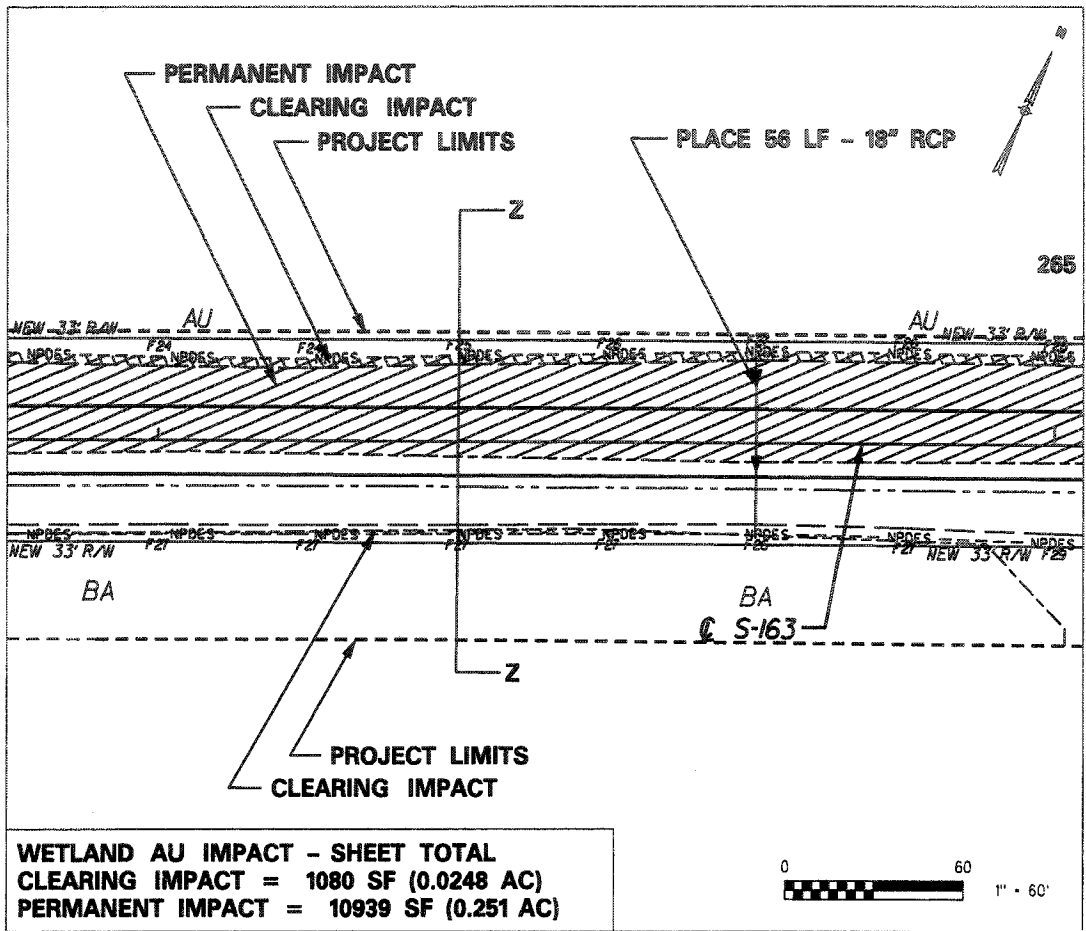

WETLAND AU IMPACT - SHEET TOTAL
 CLEARING IMPACT = 1080 SF (0.0248 AC)
 PERMANENT IMPACT = 10939 SF (0.251 AC)

WETLAND BA IMPACT - SHEET TOTAL
 CLEARING IMPACT = 197 SF (0.0045 AC)
 PERMANENT IMPACT = 0 SF (0.00 AC)

SECTION Z-Z

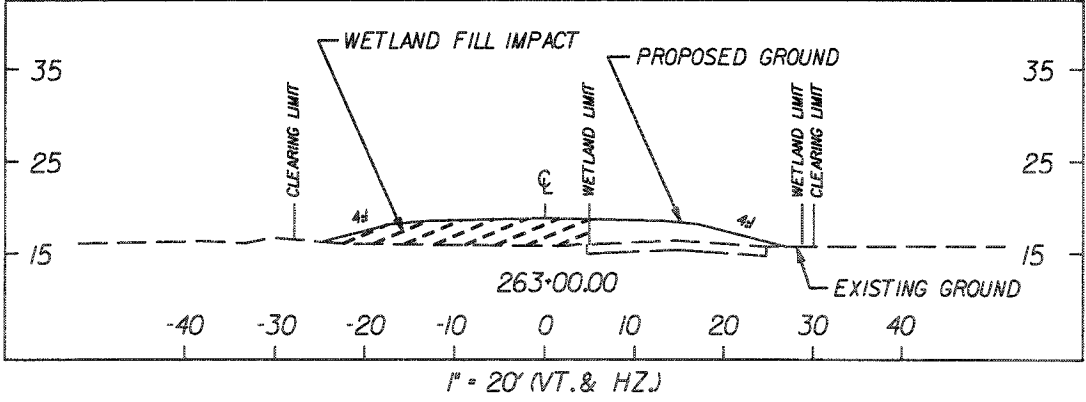

LEGEND

- WETLANDS LIMITS
- WETLANDS FILL IMPACT (TEMPORARY BETWEEN TOE OF SLOPE & NPDES)
- WETLANDS FILL IMPACT (PERMANENT)

TOTAL VOLUME OF IMPACT:
 WETLAND "AU" SEE SHEET 28
 WETLAND "BA" SEE SHEET 28

PIN 36089_SP01
 WETLAND AU, BA
 S-163 SUMMERS ROAD
 DORCHESTER COUNTY, SC
 APPLICATION BY SCDOT
 ELIGIBLE FOR FEDERAL FUNDS
 DATE FEBRUARY 16, 2007
 SHEET 29 OF 47

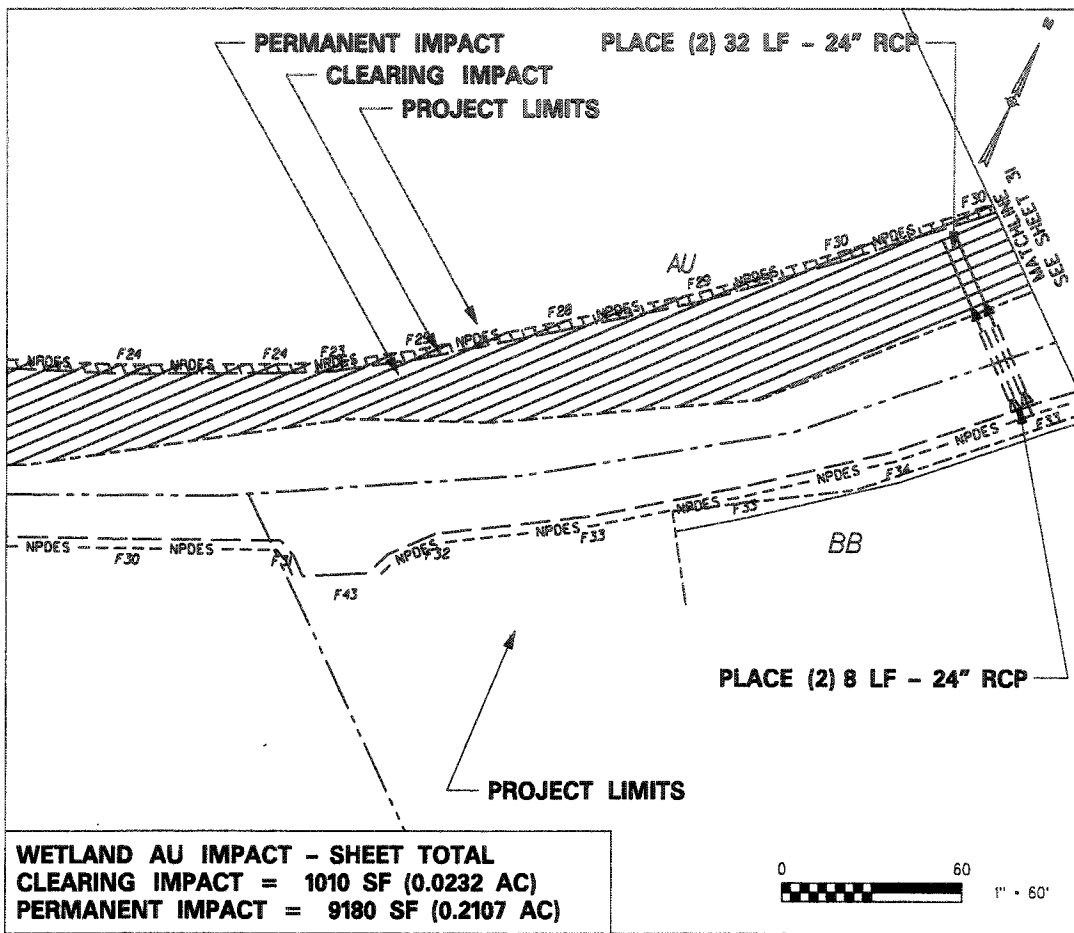

WETLAND AU IMPACT - SHEET TOTAL CLEARING IMPACT = 1010 SF (0.0232 AC) PERMANENT IMPACT = 9180 SF (0.2107 AC)
WETLAND BB IMPACT - SHEET TOTAL CLEARING IMPACT = 0 SF (0.00 AC) PERMANENT IMPACT = 0 SF (0.00 AC)

SECTION AA-AA

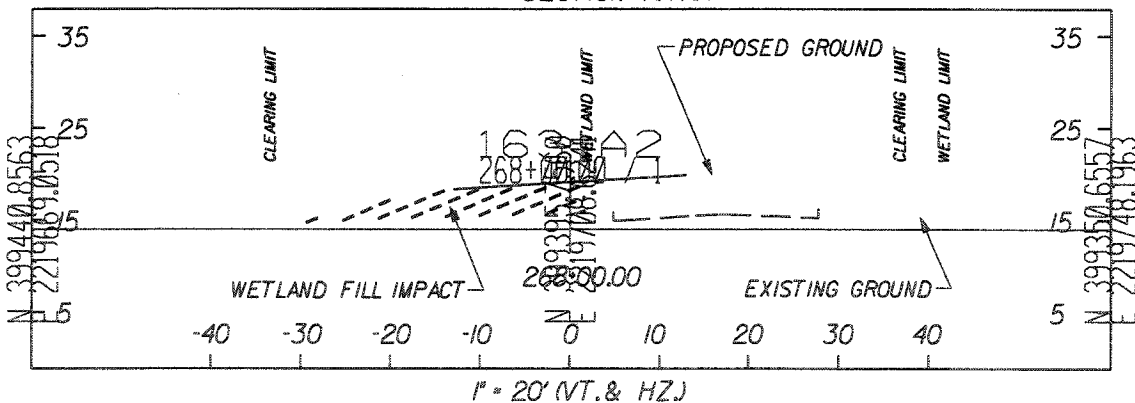

LEGEND

- WETLANDS LIMITS
- WETLANDS FILL IMPACT (TEMPORARY BETWEEN TOE OF SLOPE & NPDES)
- WETLANDS FILL IMPACT (PERMANENT)

TOTAL VOLUME OF IMPACT:
 WETLAND "AU" SEE SHEET 28
 WETLAND "BB" 0 CY

PIN 36089_SP01
 WETLAND AU, BB
 S-163 SUMMERS ROAD
 DORCHESTER COUNTY, SC
 APPLICATION BY SCDOT
 ELIGIBLE FOR FEDERAL FUNDS
 DATE FEBRUARY 16, 2007
 SHEET 30 OF 47

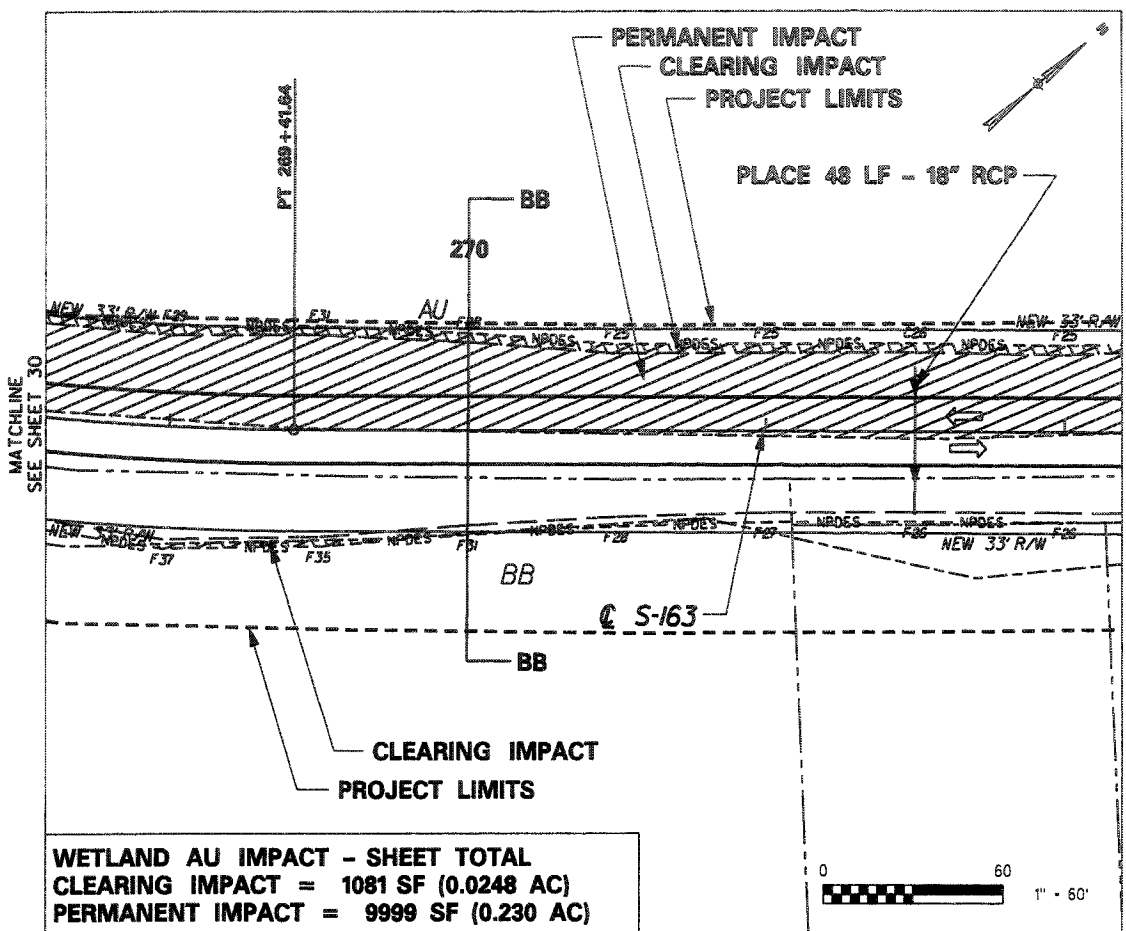

WETLAND AU IMPACT - SHEET TOTAL CLEARING IMPACT = 1081 SF (0.0248 AC) PERMANENT IMPACT = 9999 SF (0.230 AC)
WETLAND BB IMPACT - SHEET TOTAL CLEARING IMPACT = 204 SF (0.0046 AC) PERMANENT IMPACT = 0 SF (0.00 AC)



SECTION BB-BB

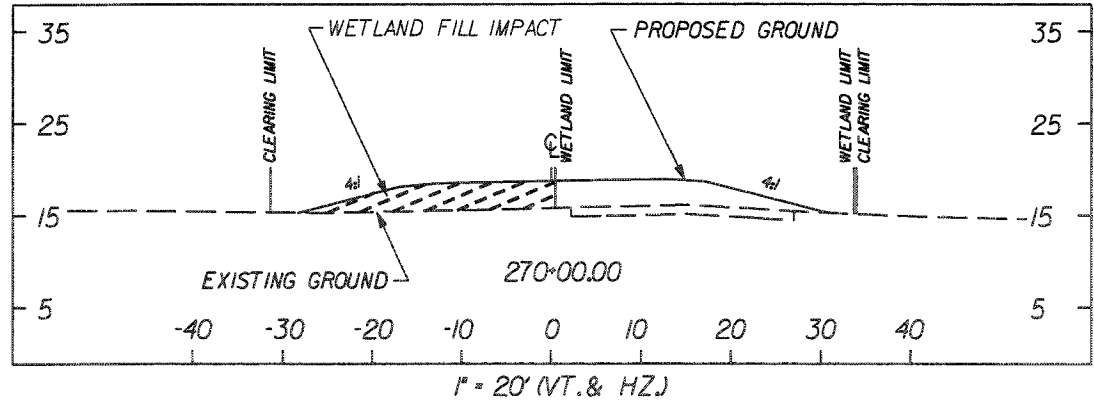

LEGEND

- WETLANDS LIMITS
- WETLANDS FILL IMPACT (TEMPORARY BETWEEN TOE OF SLOPE & NPDES)
- WETLANDS FILL IMPACT (PERMANENT)

TOTAL VOLUME OF IMPACT:
 WETLAND "AU" SEE SHEET 28
 WETLAND "BB" 0 CY

PIN 36089_SP01
 WETLAND AU, BB
 S-163 SUMMERS ROAD
 DORCHESTER COUNTY, SC
 APPLICATION BY SCDOT
 ELIGIBLE FOR FEDERAL FUNDS
 DATE FEBRUARY 16, 2007
 SHEET 31 OF 47

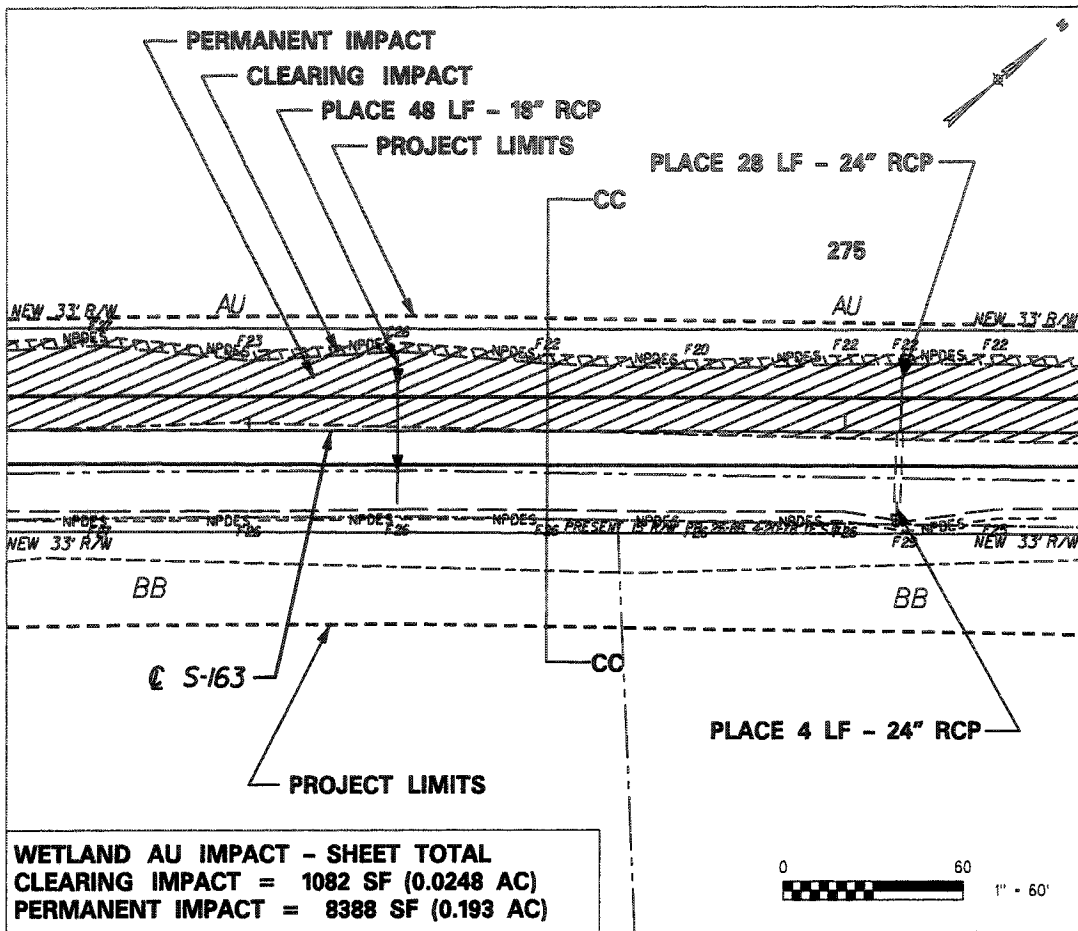

WETLAND AU IMPACT - SHEET TOTAL CLEARING IMPACT = 1082 SF (0.0248 AC) PERMANENT IMPACT = 8388 SF (0.193 AC)
WETLAND BB IMPACT - SHEET TOTAL CLEARING IMPACT = 0 SF (0.00 AC) PERMANENT IMPACT = 0 SF (0.00 AC)

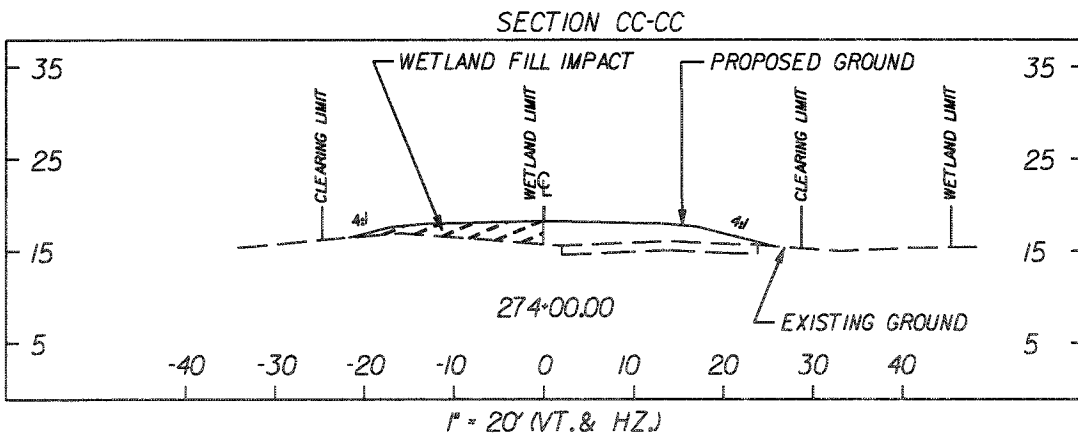

LEGEND

- WETLANDS LIMITS
- WETLANDS FILL IMPACT (TEMPORARY BETWEEN TOE OF SLOPE & NPDES)
- WETLANDS FILL IMPACT (PERMANENT)

TOTAL VOLUME OF IMPACT:
WETLAND "AU" SEE SHEET 28
WETLAND "BB" 0 CY

PIN 36089_SP01
WETLAND AU, BB
S-163 SUMMERS ROAD
DORCHESTER COUNTY, SC
APPLICATION BY SCDOT
ELIGIBLE FOR FEDERAL FUNDS
DATE FEBRUARY 16, 2007
SHEET 32 OF 47

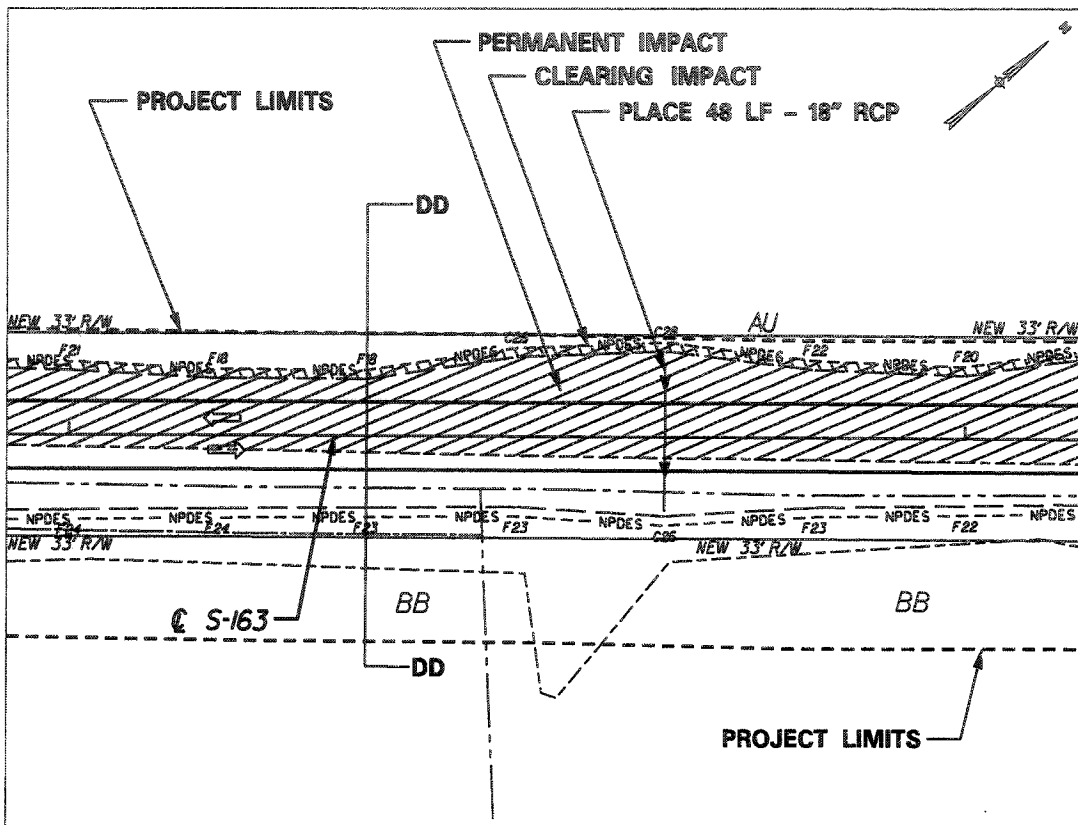

WETLAND AU IMPACT - SHEET TOTAL
 CLEARING IMPACT = 1084 SF (0.0248 AC)
 PERMANENT IMPACT = 10176 SF (0.234 AC)

WETLAND BB IMPACT - SHEET TOTAL
 CLEARING IMPACT = 0 SF (0.00 AC)
 PERMANENT IMPACT = 0 SF (0.00 AC)



SECTION DD-DD

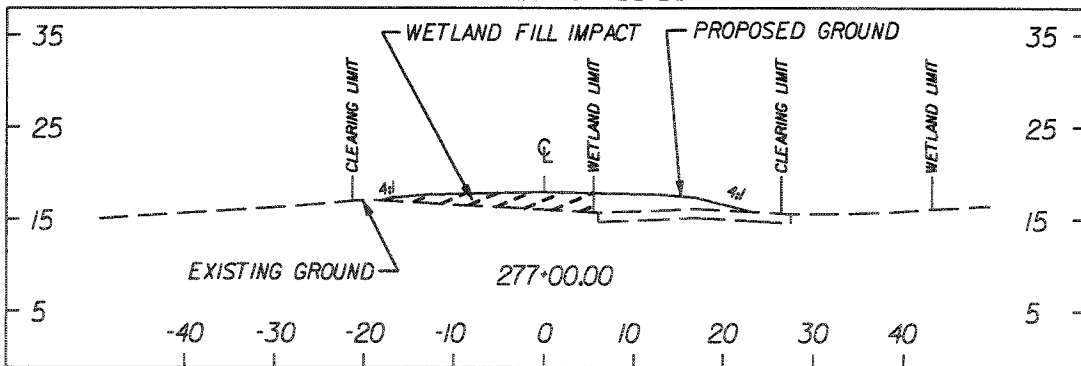

1" = 20' (VT. & HZ.)

LEGEND

- WETLANDS LIMITS
- WETLANDS FILL IMPACT (TEMPORARY BETWEEN TOE OF SLOPE & NPDES)
- WETLANDS FILL IMPACT (PERMANENT)

TOTAL VOLUME OF IMPACT:
 WETLAND "AU" SEE SHEET 28
 WETLAND "BB" 0 CY

PIN 36089_SP01
 WETLAND AU, BB
 S-163 SUMMERS ROAD
 DORCHESTER COUNTY, SC
 APPLICATION BY SCDOT
 ELIGIBLE FOR FEDERAL FUNDS
 DATE FEBRUARY 16, 2007
 SHEET 33 OF 47

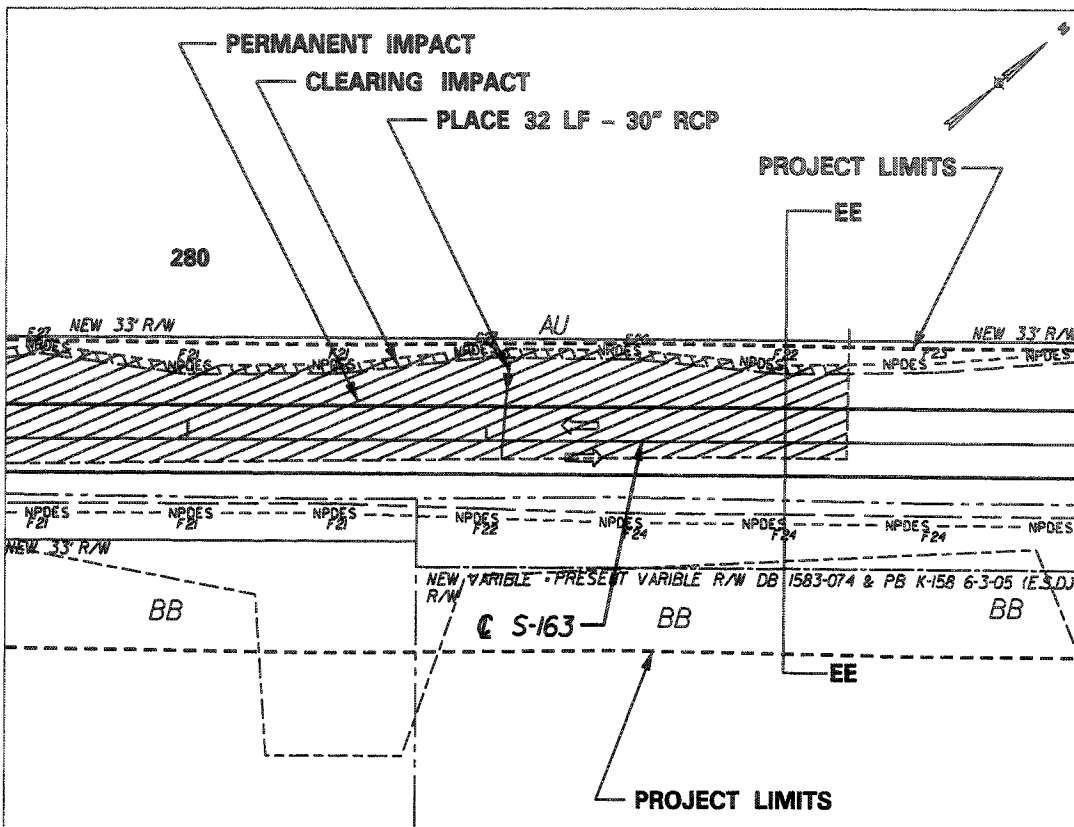

<p>WETLAND AU IMPACT - SHEET TOTAL CLEARING IMPACT = 850 SF (0.0195 AC) PERMANENT IMPACT = 8602 SF (0.197 AC)</p>
<p>WETLAND BB IMPACT - SHEET TOTAL CLEARING IMPACT = 0 SF (0.00 AC) PERMANENT IMPACT = 0 SF (0.00 AC)</p>

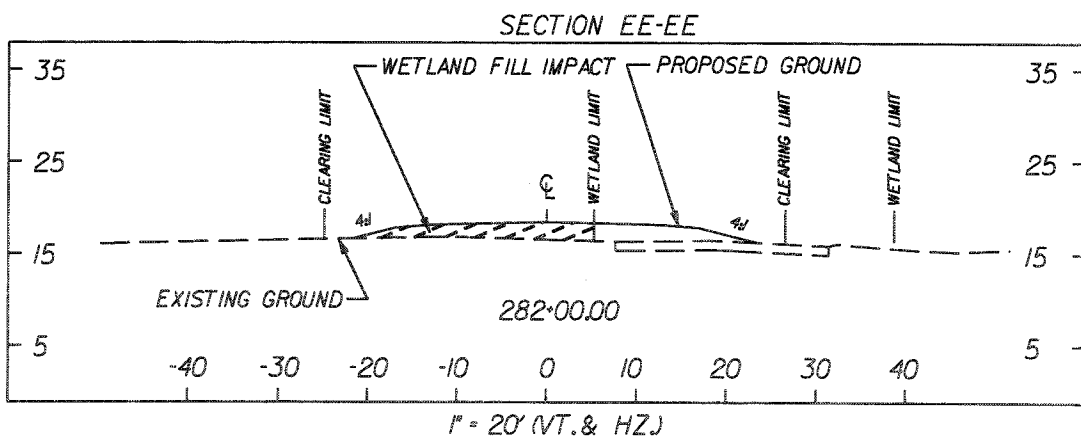

1" = 20' (VT. & HZ)

LEGEND

- WETLANDS LIMITS
- WETLANDS FILL IMPACT (TEMPORARY BETWEEN TOE OF SLOPE & NPDES)
- WETLANDS FILL IMPACT (PERMANENT)

TOTAL VOLUME OF IMPACT:
 WETLAND "AU" SEE SHEET 28
 WETLAND "BB" 0 CY

PIN 36089_SP01
WETLAND AU, BB
S-163 SUMMERS ROAD
DORCHESTER COUNTY, SC
APPLICATION BY SCDOT
ELIGIBLE FOR FEDERAL FUNDS
DATE FEBRUARY 16, 2007
SHEET 34 OF 47

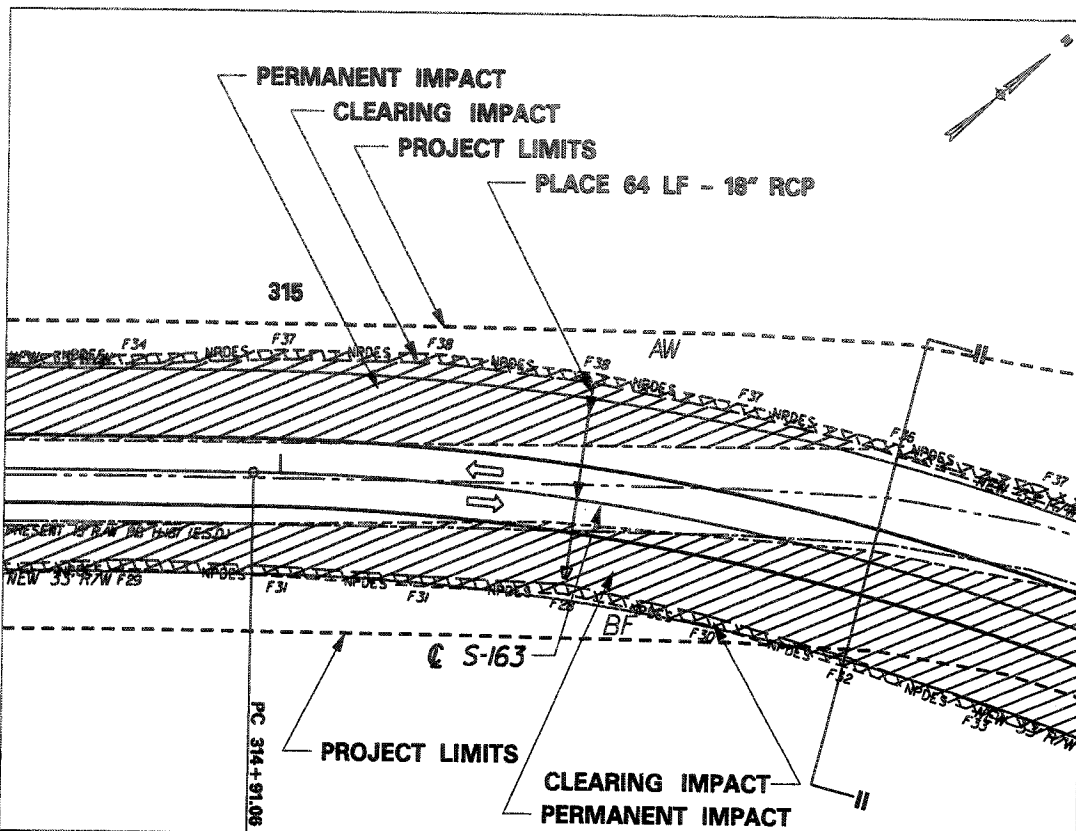

WETLAND AW IMPACT - SHEET TOTAL CLEARING IMPACT = 1095 SF (0.025 AC) PERMANENT IMPACT = 6112 SF (0.14 AC)
WETLAND BF IMPACT - SHEET TOTAL CLEARING IMPACT = 1101 SF (0.0252 AC) PERMANENT IMPACT = 8534 SF (0.196 AC)



SECTION II-II

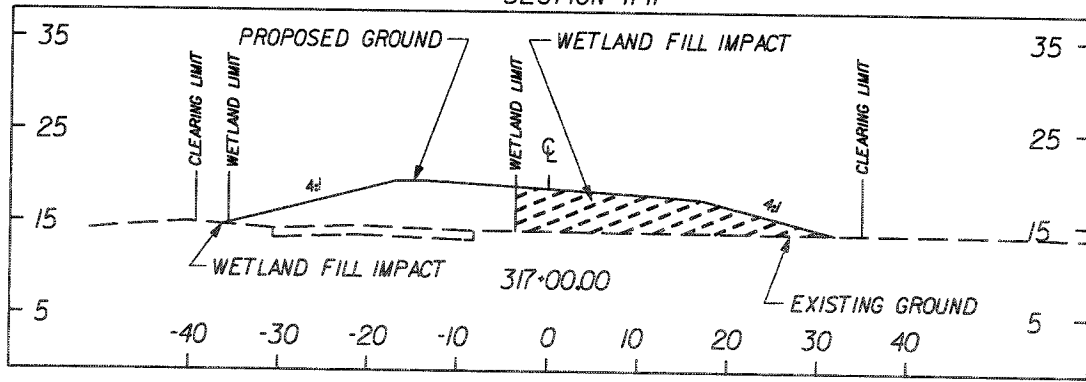

1" = 20' (VT. & HZ)

LEGEND

- WETLANDS LIMITS
- WETLANDS FILL IMPACT (TEMPORARY BETWEEN TOE OF SLOPE & NPDES)
- WETLANDS FILL IMPACT (PERMANENT)

TOTAL VOLUME OF IMPACT:
 WETLAND "AW" SEE SHEET 36
 WETLAND "BF" SEE SHEET 36

PIN 36089_SP01
WETLAND AW, BF
S-163 SUMMERS ROAD
DORCHESTER COUNTY, SC
APPLICATION BY SCDOT
ELIGIBLE FOR FEDERAL FUNDS
DATE FEBRUARY 16, 2007
SHEET 38 OF 47

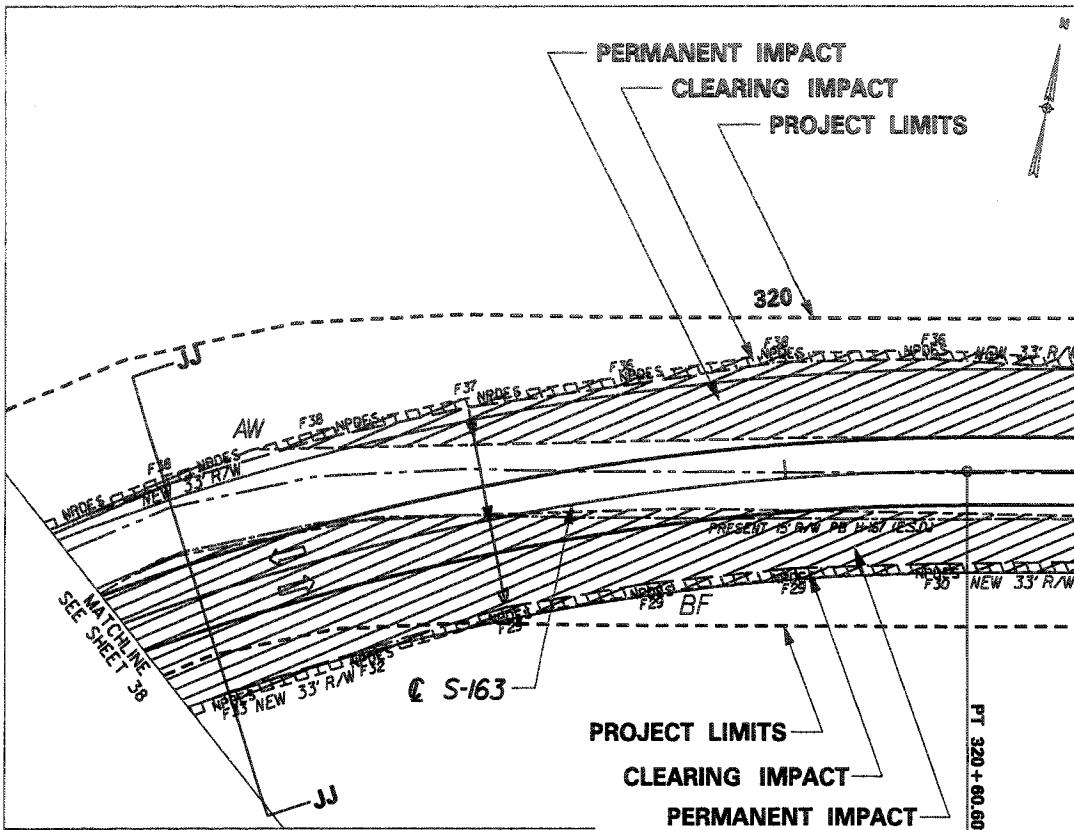

WETLAND AW IMPACT - SHEET TOTAL
 CLEARING IMPACT = 999 SF (0.0229 AC)
 PERMANENT IMPACT = 4824 SF (0.1107 AC)

WETLAND BF IMPACT - SHEET TOTAL
 CLEARING IMPACT = 909 SF (0.0209 AC)
 PERMANENT IMPACT = 9149 SF (0.21 AC)

SECTION JJ-JJ

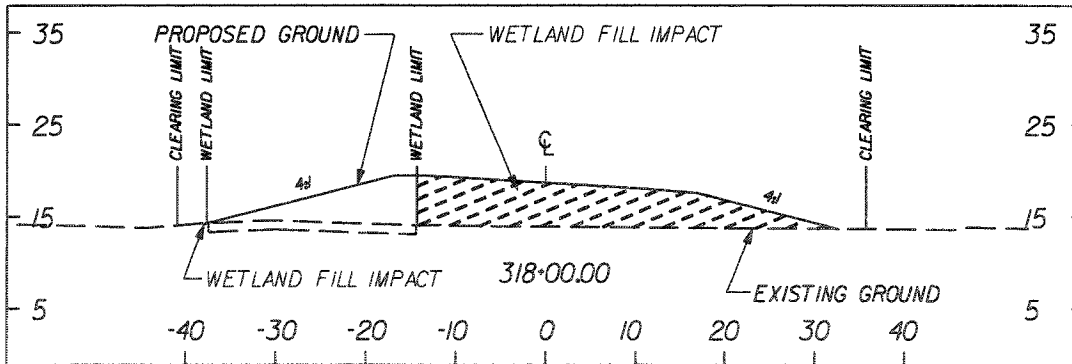

1" = 20' (VT. & HZ)

LEGEND

- WETLANDS LIMITS
- WETLANDS FILL IMPACT (TEMPORARY BETWEEN TOE OF SLOPE & NPDES)
- WETLANDS FILL IMPACT (PERMANENT)

TOTAL VOLUME OF IMPACT:
 WETLAND "AW" SEE SHEET 36
 WETLAND "BF" SEE SHEET 36

PIN 36089_SP01
 WETLAND "AW, BF"
 S-163 SUMMERS ROAD
 DORCHESTER COUNTY, SC
 APPLICATION BY SCDOT
 ELIGIBLE FOR FEDERAL FUNDS
 DATE FEBRUARY 16, 2007
 SHEET 39 OF 47