

JOINT
PUBLIC NOTICE

CHARLESTON DISTRICT, CORPS OF ENGINEERS
69A Hagood Avenue
Charleston, South Carolina 29403-5107
and the
S.C. DEPARTMENT OF HEALTH AND ENVIRONMENTAL CONTROL
OFFICE OF OCEAN AND COASTAL RESOURCE MANAGEMENT
1362 McMillan Avenue, Suite 400
Charleston, South Carolina 29405

REGULATORY DIVISION

Refer to: P/N # SAC 2007-385-2IV

March 23, 2007

Pursuant to Section 10 of the Rivers and Harbors Act of 1899 (33 U.S.C. 403), Sections 401 and 404 of the Clean Water Act (33 U.S.C. 1344), and the South Carolina Coastal Zone Management Act (48-39-10 et seq.) an application has been submitted to the Department of the Army and the S.C. Department of Health and Environmental Control by

THE HAVEN PROPERTIES, LLC
C/O ALEXANDRIA ZIMAR, P.E.
1000 OAKCREST DRIVE
CHARLESTON, SC 29412

for a permit to construct a community dock, boat ramp, and groundout dock in

ABBAPOOLA CREEK

located adjacent to Legareville road, northeast of the intersection of Legareville Road and Daniel Fludd Road in Johns Island, Charleston County, South Carolina (Latitude: 32.66067; Longitude: -80.04769)

In order to give all interested parties an opportunity to express their views

NOTICE

is hereby given that written statements regarding the proposed work will be received by both of the above mentioned offices until

12 O'CLOCK NOON, MONDAY, APRIL 23, 2007

from those interested in the activity and whose interests may be affected by the proposed work.

The proposed work consists of the construction of a 4' x 50' timber fixed pier walkway extending from highland to a 10' x 15' covered fixed pier head. A 10' x 60' floating dock will be constructed on the east side of the pier head and will be accessed by a 3' x 35' foot aluminum gangway. Also to be constructed is a community boat ramp that will be 75' x 12' with a 75' x 8' ground out dock placed on the east side of the ramp, directly adjacent to the boat ramp. The purpose of the project is for private recreational community use.

NOTE: Plans depicting the work described in this notice are available and will be provided, upon receipt of a written request, to anyone that is interested in obtaining a copy of the plans for the specific project. The request must identify the project of interest by public notice number and a self-addressed stamped envelope must also be provided for

mailing the drawings to you. Your request for drawings should be addressed to the

**U.S. Army Corps of Engineers
ATTN: REGULATORY DIVISION
69A Hagood Avenue
Charleston, South Carolina 29403-5107**

The District Engineer has concluded that the discharges associated with this project, both direct and indirect, should be reviewed by the South Carolina Department of Health and Environmental Control in accordance with provisions of Section 401 of the Clean Water Act. As such, this notice constitutes a request, on behalf of the applicant, for certification that this project will comply with applicable effluent limitations and water quality standards. The work shown on this application must also be certified as consistent with applicable provisions the Coastal Zone Management Program (15 CFR 930). The District Engineer will not process this application to a conclusion until such certifications are received. The applicant is hereby advised that supplemental information may be required by the State to facilitate the review.

This notice initiates the Essential Fish Habitat (EFH) consultation requirements of the Magnuson-Stevens Fishery Conservation and Management Act. Implementation of the proposed project would impact 0.042 acres (.024 acres of shading and .018 acres of direct impact from fill/excavating) of estuarine substrates and emergent wetlands utilized by various life stages of species comprising the red drum, shrimp, and snapper-grouper management complexes. Our initial determination is that the proposed action would not have a substantial individual or cumulative adverse impact on EFH or fisheries managed by the South Atlantic Fishery Management Council and the National Marine Fisheries Service (NMFS). Our final determination relative to project impacts and the need for mitigation measures is subject to review by and coordination with the NMFS.

The District Engineer has consulted the most recently available information and has determined that the project will have no effect on any Federally endangered, threatened, or proposed species and will not result in the destruction or adverse modification of designated or proposed critical habitat. This public notice serves as a request to the U.S. Fish and Wildlife Service and the National Marine Fisheries Service for any additional information they may have on whether any listed or proposed endangered or threatened species or designated or proposed critical habitat may be present in the area which would be affected by the activity, pursuant to Section 7(c) of the Endangered Species Act of 1973 (as amended).

Pursuant to Section 106 of the National Historic Preservation Act (NHPA), this public notice also constitutes a request to Indian Tribes to notify the District Engineer of any historic properties of religious and cultural significance to them that may be affected by the proposed undertaking.

In accordance with the NHPA, the District Engineer has also consulted the latest published version of the National Register of Historic Places for the presence or absence of registered properties, or properties listed as being eligible for inclusion therein, and this worksite is not included as a registered property or property listed as being eligible for inclusion in the Register. To insure that other cultural resources that the District Engineer is not aware of are not overlooked, this public notice also serves as a request to the State Historic Preservation Office to provide any information it may have with regard to historic and cultural resources.

Any person may request, in writing, within the comment period specified in this notice, that a public hearing be held to consider this application. Requests for a public hearing shall state, with particularity, the reasons for holding a public hearing.

The decision whether to issue a permit will be based on an evaluation of the probable impact including cumulative impacts of the activity on the public interest and will include application of the guidelines promulgated by the Administrator, Environmental Protection Agency (EPA), under authority of Section 404(b) of the Clean Water Act and, as appropriate, the criteria established under authority of Section 102 of the Marine Protection, Research and Sanctuaries Act of 1972, as amended. That decision will reflect the national concern for both protection and utilization of important resources. The benefit which reasonably may be expected to accrue from the project must be balanced against its reasonably foreseeable detriments. All factors which may be relevant to the project will be considered including the cumulative effects thereof; among those are conservation, economics, aesthetics, general environmental concerns, wetlands, historic properties, fish and wildlife values, flood hazards, flood plain values, land use, navigation, shoreline erosion and accretion, recreation, water supply and conservation, water quality, energy needs, safety, food and fiber production and, in general, the needs and welfare of the people. A permit will be granted unless the District Engineer determines that it would be contrary to the public interest. In cases of conflicting property rights, the Corps of Engineers cannot undertake to adjudicate rival claims.

The Corps of Engineers is soliciting comments from the public; Federal, state, and local agencies and officials; Indian Tribes; and other interested parties in order to consider and evaluate the impacts of this activity. Any comments received will be considered by the Corps of Engineers to determine whether to issue, modify, condition or deny a permit for this project. To make this decision, comments are used to assess impacts on endangered species, historic properties, water quality, general environmental effects, and the other public interest factors listed above. Comments are used in the preparation of an Environmental Assessment and/or an Environmental Impact Statement pursuant to the National Environmental Policy Act. Comments are also used to determine the need for a public hearing and to determine the overall public interest of the activity.

If there are any questions concerning this public notice, please contact Robert Vega at 843-329-8044 or toll free at 1-866-329-8187.

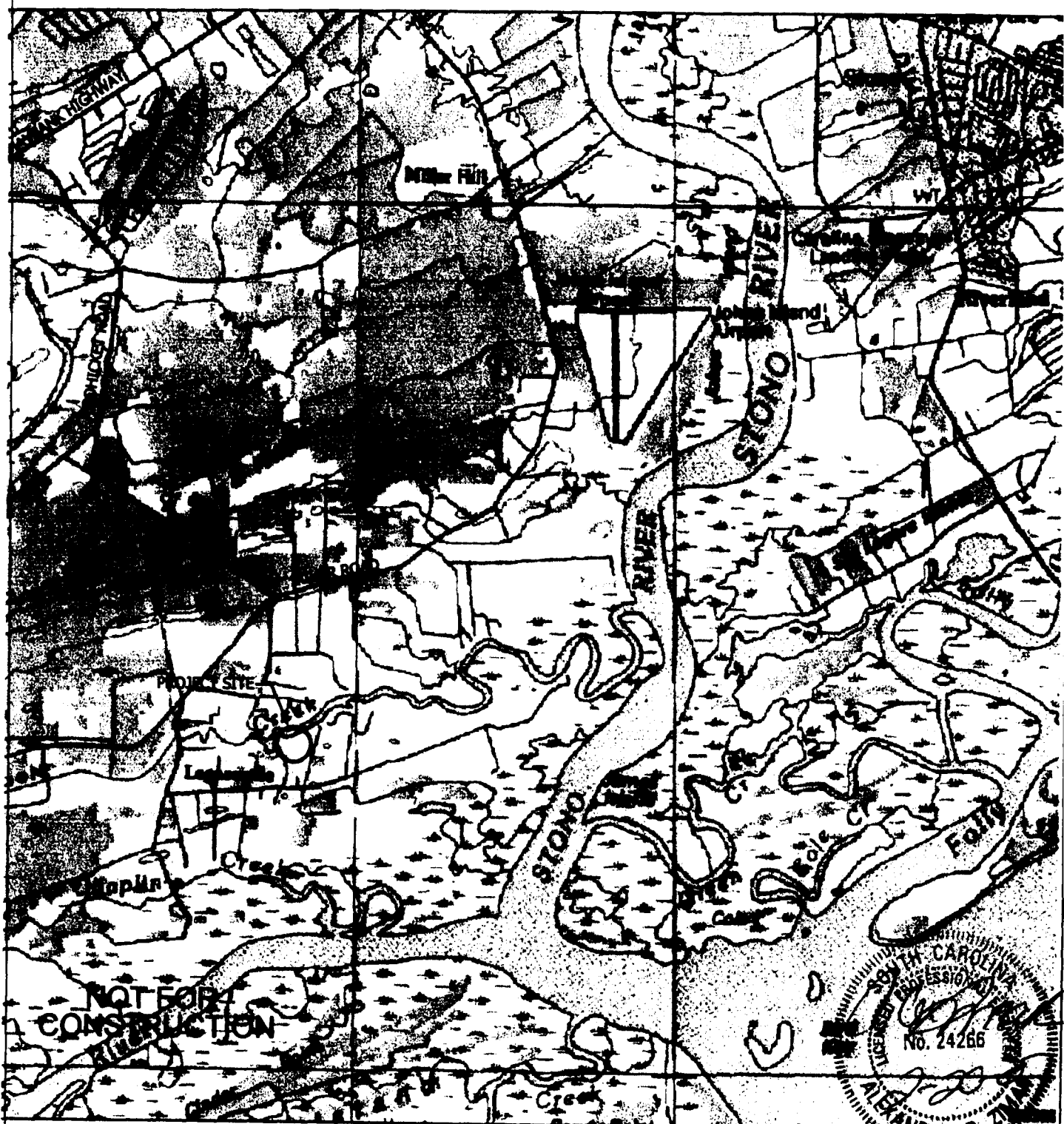

SAC 2007-385-2IV

THE HAVEN ON
ABBAPPOLLA CREEK

QUAD SHEET

PROPOSED
COMMUNITY DOCK
& BOAT RAMP

APPLICANT: THE HAVEN PROPERTIES, LLC
 AGENT: ALEXANDRIA ZIMAR, P.E.
 DATE: FEBRUARY 19, 2007
 TMS #: 273-00-00-065
 BODY OF WATER: ABBAPPOLLA CREEK
 LOCATION: JOHN'S ISLAND, CHARLESTON COUNTY, SC
 SCALE: NOT TO SCALE

GRAPHIC SCALE



(IN FEET)

1 inch = 200 ft.



Pending NWP
SAC # 2006-3G15-2NY

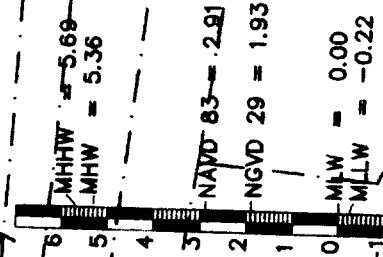

DATUM
RELATIONSHIPS

MHW = 5.69

MHW = 5.36

NAVD 83 = 2.91

NGVD 29 = 1.93

MLW = 0.00

MLLW = -0.22

NOT FOR
CONSTRUCTION

OWNER: THE HAVEN PROPERTIES, LLC SCALE: 1"=200'

AGENT: ALEXANDRIA ZIMAR, PE

TMS # 273-00-00-085

BODY OF WATER: ABBAPOOLA CREEK

LOCATION: LEGAREVILLE ROAD

JOHN'S ISLAND, CHARLESTON COUNTY, SC

DATE: FEBRUARY 19, 2007

THE HAVEN
COMMUNITY DOCK &
BOAT RAMP
PERMIT APPLICATION

PROJECT AREA
& UPLAND DEVELOPMENT

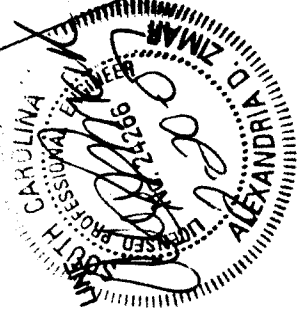

SAC 2002
CONSTRUCTION
IT-3-2

DATE: FEBRUARY 19, 2002
 LOCATION: LOT 9, WEST END OF WALTERS FORD ROAD, CHARLESTON COUNTY, SOUTH CAROLINA
 PROJECT: THE HAVEN PROPERTIES, L.P.
 CLIENT: WALTERS FORD ROAD COMMUNITY ASSOCIATION
 AGENT: ALEXANDRIA D. ZIMAR, P.E.
 SCALE: 1"=80'

PERMIT APPLICATION
COMMUNITY DOCK & BOAT RAMP

EXISTING CONDITIONS

EXTENDED PROPERTY LINE

EXTENDED PROPERTY LINE

ABBAPOLLA CREEK
 261.2'
 241.2'

GRAPHIC SCALE
 1 inch = 80 feet
 (IN FEET)

RELATIONS
 DATUM
 0 MLW = -0.00
 1 NGVD 29 = 1.93
 2 NAVD 83 = 2.91
 3 MHHW = 5.36
 4 MHW = 5.69

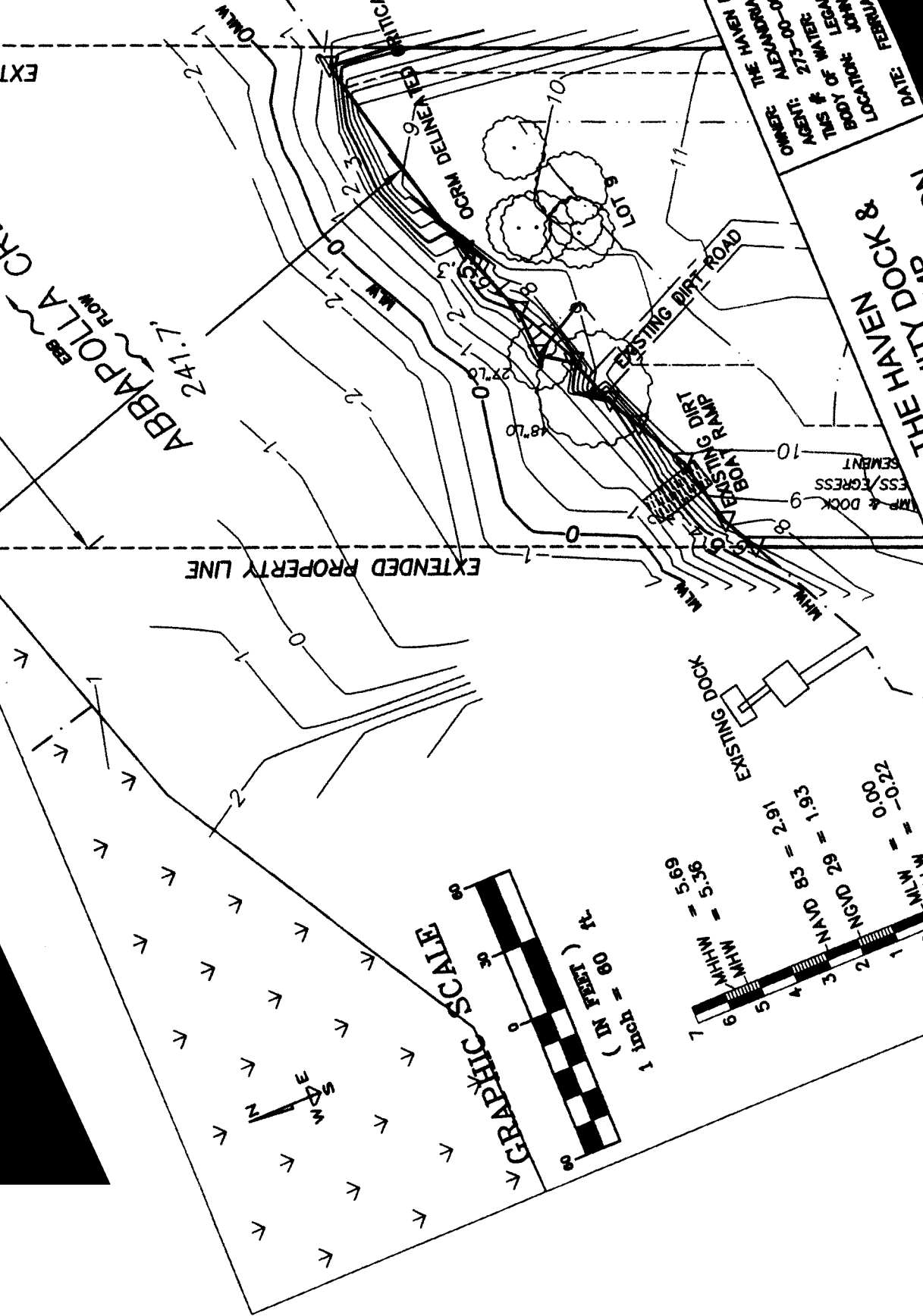

**NOTIFICATION
CONSTRUCTION**
SAC 2007-385-21

DATE: 2-8-10
 LOCATION: THE HAVEN & ZIMMERMAN CREEK
 PROJECT: COMMUNITY DOCK & RAMM PIER
 OWNER: THE HAVEN & ZIMMERMAN CREEK
 ENGINEER: [Signature]
 COUNTY: CHESTER COUNTY, PA
 PAGE: 4 OF 4

**PERMIT APPLICATION
COMMUNITY DOCK &
BOAT RAMM PIER**

PROPOSED CONDITIONS

EXTENDED PROPERTY LINE

EXTENDED PROPERTY LINE

ABBAPOLLA CREEK
 241.7'
 261.2'

MLW TO MLW = 118.8'

SEE PG 5 & 8 FOR DETAIL
 COMMUNITY DOCK PIER
 SEE PG 5 & 8 FOR DETAIL
 COMMUNITY DOCK PIER
 SEE PG 5 & 8 FOR DETAIL

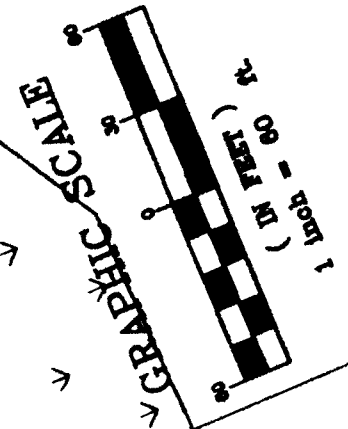
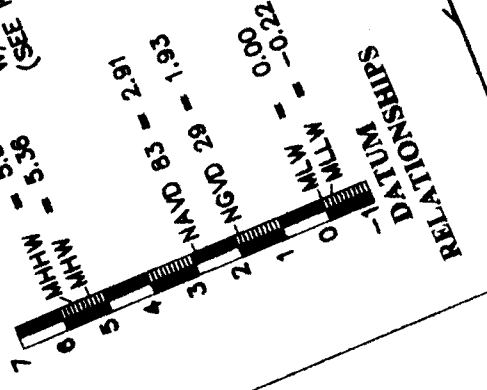

SEE PGS 4-7 FOR DETAIL & DIMENSION

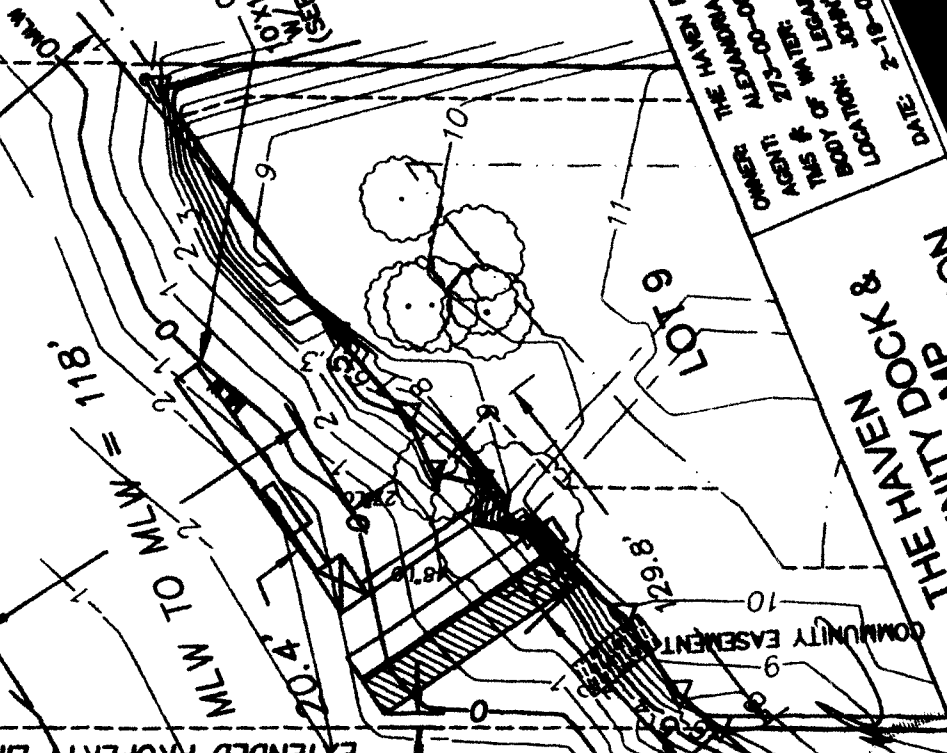

SEE PG 8 & 11 FOR DETAIL
 COMMUNITY DOCK PIER
 SEE PG 8 & 11 FOR DETAIL

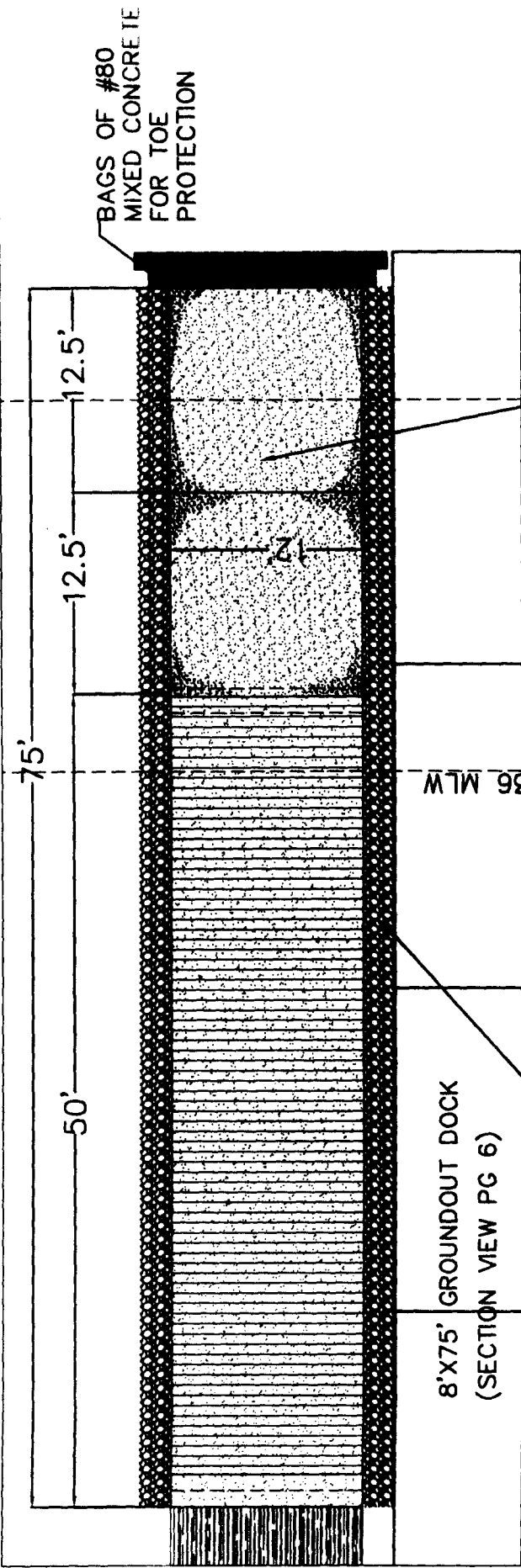

BAGS OF #80 MIXED CONCRETE FOR TOE PROTECTION

8'X75' GROUNDOUT DOCK (SECTION VIEW PG 6)

#57 BEDDING STONE 2.0' WIDE BY 1.0' THICK FOR FULL LENGTH OF RAMP ALONG BOTH SIDES

EITHER SITE-CAST OR PRECAST PANELS, PLACED EITHER BY CRANE OR BY SLIDING POSITION OVER PLYWOOD FROM POURED CONCRETE RAMP

APPROX EXISTING GRADE

TOP OF BANK = 9.0 MLW

APPROX SLOPE OF RAMP = 13%

MHW = 5.36 MLW



GRAPHIC SCALE



NOT FOR CONSTRUCTION

SAC 2007-385-2IV

OWNER: THE HAVEN PROPERTIES, LLC SCALE: 1"=10'

AGENT: ALEXANDRIA ZMAR, PE

TMS #: 273-00-00-065

BODY OF WATER: ABBAPOOLA CREEK

LOCATION: LEGAREVILLE ROAD

JOHN'S ISLAND, CHARLESTON COUNTY, SC

DATE: FEBRUARY 19, 2007

THE HAVEN COMMUNITY DOCK & BOAT RAMP PERMIT APPLICATION

BOAT RAMP & GROUNDOUT DOCK

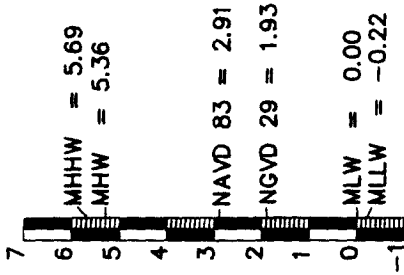

DATUM RELATIONSHIPS

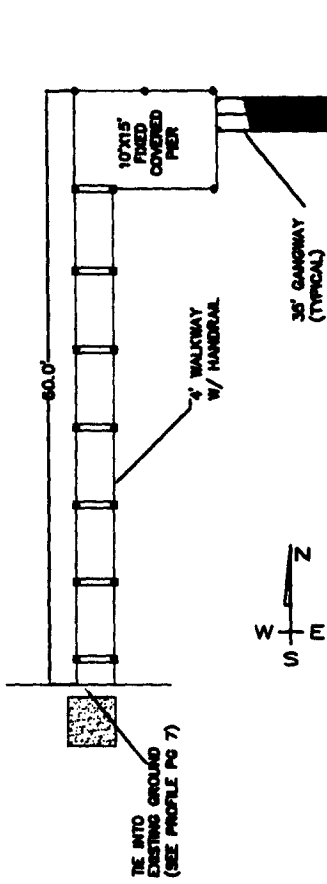

COMMUNITY DOCK DETAIL PLAN VIEW SECTION

1"=20'

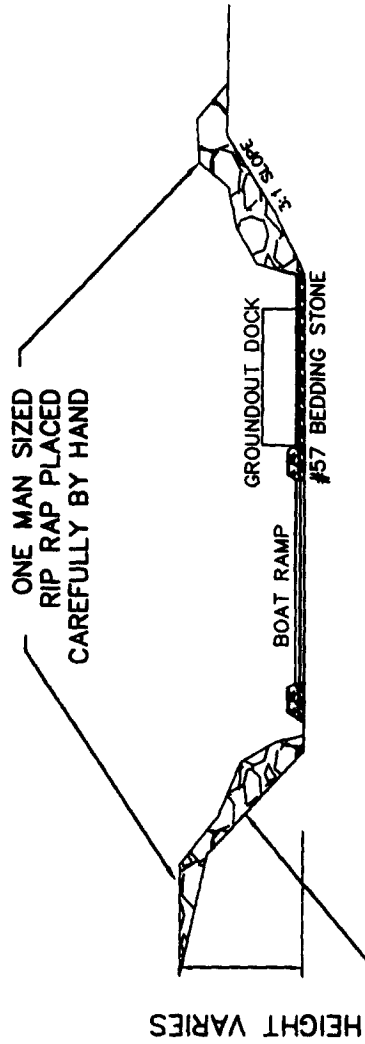

TYPICAL RAMP EXCAVATED SECTION

NTS

NOT FOR CONSTRUCTION
SAC 2007-385-21V

OWNER: THE HAVEN PROPERTIES, LLC SCALE: VARIES
 AGENT: ALEXANDRIA ZMAR, PE
 TMS #: 273-00-00-085
 BODY OF WATER: ABBAPPOOLA CREEK
 LOCATION: LEGAREVILLE ROAD
 JOHN'S ISLAND, CHARLESTON COUNTY, SC
 DATE: FEBRUARY 19, 2007

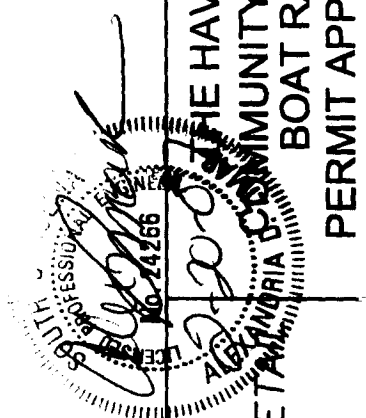

THE HAVEN COMMUNITY DOCK & BOAT RAMP PERMIT APPLICATION

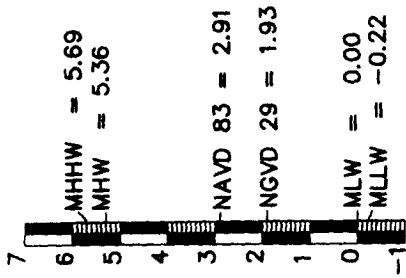

6 MHHW = 5.69
 5 MHW = 5.36

3 NAVD 83 = 2.91
 2 NGVD 29 = 1.93

0 MLW = 0.00
 -1 MLLW = -0.22

**DATUM
 RELATIONSHIPS**

GRAPHIC SCALE

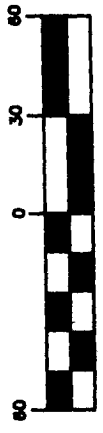

(IN FEET)
 1 inch = 60 ft.

COMMUNITY DOCK PROFILE

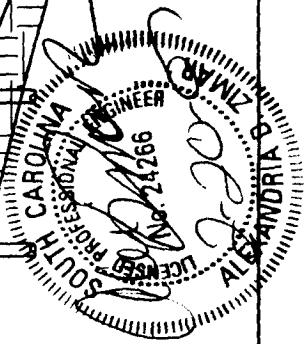
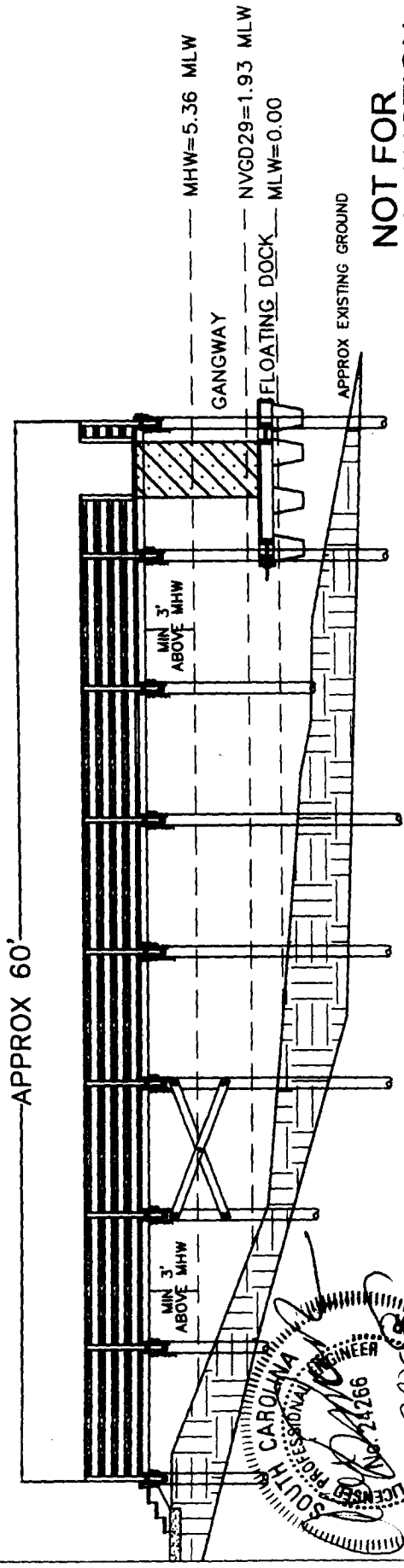

**NOT FOR
 SAC 2007-3852IV CONSTRUCTION**

OWNER: THE HAVEN PROPERTIES, LLC SCALE: 1"=60'
 AGENT: ALEXANDRIA ZIMAR, PE
 TMS # 273-00-00-085
 BODY OF WATER: ABBAPOOLA CREEK
 LOCATION: LEGAREVILLE ROAD
 JOHN'S ISLAND, CHARLESTON COUNTY, SC
 DATE: FEBRUARY 19, 2007

**THE HAVEN
 COMMUNITY DOCK &
 BOAT RAMP
 PERMIT APPLICATION**

COMMUNITY DOCK PROFILE