

JOINT
PUBLIC NOTICE

CHARLESTON DISTRICT, CORPS OF ENGINEERS
69A Hagood Avenue
Charleston, South Carolina 29403-5107

and

THE S.C. DEPARTMENT OF HEALTH AND ENVIRONMENTAL CONTROL
Office of Environmental Quality Control
Water Quality Certification and Wetlands Programs Section
2600 Bull Street
Columbia, South Carolina 29201

REGULATORY DIVISION

Refer to: P/N # 2007-201-61J

February 16, 2007

Pursuant to Sections 401 and 404 of the Clean Water Act (33 U.S.C. 1341), an application has been submitted to the Department of the Army and the South Carolina Department of Health and Environmental Control by

The South Carolina Department of Agriculture
P.O. Box 11280
1200 Senate Street
Columbia, SC 29211

for a permit to place fill material in freshwater wetlands contiguous to

Reeder Point Branch

on property located between Bluff Road, Pineview Drive and Longwood Road, south of the City of Columbia, Richland County, South Carolina. (Latitude 33.937816 Longitude -80.942955)

In order to give all interested parties an opportunity to express their views

NOTICE

is hereby given that written statements regarding the proposed work will be received by both of the above mentioned offices until

12 O'CLOCK NOON, MONDAY, MARCH 19, 2007

from those interested in the activity and whose interests may be affected by the proposed work.

The applicant proposes to place fill in jurisdictional areas to facilitate the construction of the proposed new State Farmers Market. In detail, the applicant proposes to fill 4.04 acres of wetland and 0.26 acres of ditch, clear 0.35 acres of wetland and shade 0.23 acres of wetlands associated with Reeder Point Branch. The proposed fill will facilitate the installation of roadways, buildings and other facilities to necessary to complete the new State Farmers Market complex and South Carolina Department of Agriculture Food Safety Laboratory. To compensate for the unavoidable loss of wetlands associated with the proposed project, the applicant proposes to preserve a total of 37.01 acres of on site wetlands, which will be enhanced by the establishment of 11 acres of upland buffers. The applicant also proposes to complete any remaining mitigation responsibilities through purchasing any additional required mitigation credits through an established bank.

February 16, 2007

NOTE: Plans depicting the work described in this notice are available and will be provided, upon receipt of a written request, to anyone that is interested in obtaining a copy of the plans for the specific project. The request must identify the project of interest by public notice number and a self-addressed stamped envelope must also be provided for mailing the drawings to you. Your request for drawings should be addressed to the

**U.S. Army Corps of Engineers
ATTN: REGULATORY DIVISION
69A Hagood Avenue
Charleston, South Carolina 29403-5107**

The District Engineer has concluded that the discharges associated with this project, both direct and indirect, should be reviewed by the South Carolina Department of Health and Environmental Control in accordance with provisions of Section 401 of the Clean Water Act. As such, this notice constitutes a request, on behalf of the applicant, for certification that this project will comply with applicable effluent limitations and water quality standards. The District Engineer will not process this application to a conclusion until such certification is received. The applicant is hereby advised that supplemental information may be required by the State to facilitate the review. Persons wishing to comment or object to Water Quality Certification must submit all comments in writing to the S.C. Department of Health and Environmental Control at the above address within thirty (30) days of the date of this notice.

This notice initiates the Essential Fish Habitat (EFH) consultation requirements of the Magnuson-Stevens Fishery Conservation and Management Act. Implementation of the proposed project would impact 4.88 acres of jurisdictional wetlands located well inland of estuarine substrates and emergent wetlands utilized by various life stages of species comprising the red drum, shrimp, and snapper-grouper management complexes. Our initial determination is that the proposed action would not have a substantial individual or cumulative adverse impact on EFH or fisheries managed by the South Atlantic Fishery Management Council and the National Marine Fisheries Service (NMFS). Our final determination relative to project impacts and the need for mitigation measures is subject to review by and coordination with the NMFS.

The District Engineer has consulted the most recently available information and has made no determination of effect on any Federally endangered, threatened, or proposed species. This public notice serves as a request to the U.S. Fish and Wildlife Service and the National Marine Fisheries Service for any additional information they may have on whether any Federally listed or proposed to be listed endangered or threatened species and/or designated or proposed critical habitat may be present in the area which would be affected by the activity, pursuant to Section 7(c) of the Endangered Species Act of 1973 (as amended).

Pursuant to Section 106 of the National Historic Preservation Act (NHPA), this public notice also constitutes a request to Indian Tribes to notify the District Engineer of any historic properties of religious and cultural significance to them that may be affected by the proposed undertaking.

In accordance with the NHPA, the District Engineer has also consulted the latest published version of the National Register of Historic Places for the presence or absence of registered properties, or properties listed as being eligible for inclusion therein, and this worksite is not included as a registered property or property listed as being eligible for inclusion in the Register. To insure that other cultural resources that the District Engineer is not aware of are not overlooked, this public notice also serves as a request to the State Historic Preservation Office to provide any information it may have with regard to historic and cultural resources.

Any person may request, in writing, within the comment period specified in this notice, that a public hearing be held to consider this application. Requests for a public hearing shall state, with particularity, the reasons for holding a public hearing.

The decision whether to issue a permit will be based on an evaluation of the probable impact including cumulative impacts of the activity on the public interest and will include application of the guidelines promulgated by the Administrator, Environmental Protection Agency (EPA), under authority of Section 404(b) of the Clean Water Act and, as appropriate, the criteria established under authority of Section 102 of the Marine Protection,

Research and Sanctuaries Act of 1972, as amended. That decision will reflect the national concern for both protection and utilization of important resources. The benefit which reasonably may be expected to accrue from the project must be balanced against its reasonably foreseeable detriments. All factors which may be relevant to the project will be considered including the cumulative effects thereof; among those are conservation, economics, aesthetics, general environmental concerns, wetlands, historic properties, fish and wildlife values, flood hazards, flood plain values, land use, navigation, shoreline erosion and accretion, recreation, water supply and conservation, water quality, energy needs, safety, food and fiber production and, in general, the needs and welfare of the people. A permit will be granted unless the District Engineer determines that it would be contrary to the public interest. In cases of conflicting property rights, the Corps of Engineers cannot undertake to adjudicate rival claims.

The Corps of Engineers is soliciting comments from the public; Federal, state, and local agencies and officials; Indian Tribes; and other interested parties in order to consider and evaluate the impacts of this activity. Any comments received will be considered by the Corps of Engineers to determine whether to issue, modify, condition or deny a permit for this project. To make this decision, comments are used to assess impacts on endangered species, historic properties, water quality, general environmental effects, and the other public interest factors listed above. Comments are used in the preparation of an Environmental Assessment and/or an Environmental Impact Statement pursuant to the National Environmental Policy Act. Comments are also used to determine the need for a public hearing and to determine the overall public interest of the activity.

If there are any questions concerning this public notice, please contact Colt Bowles at 803-253-3400.

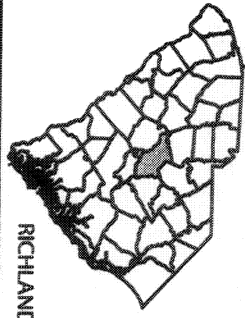
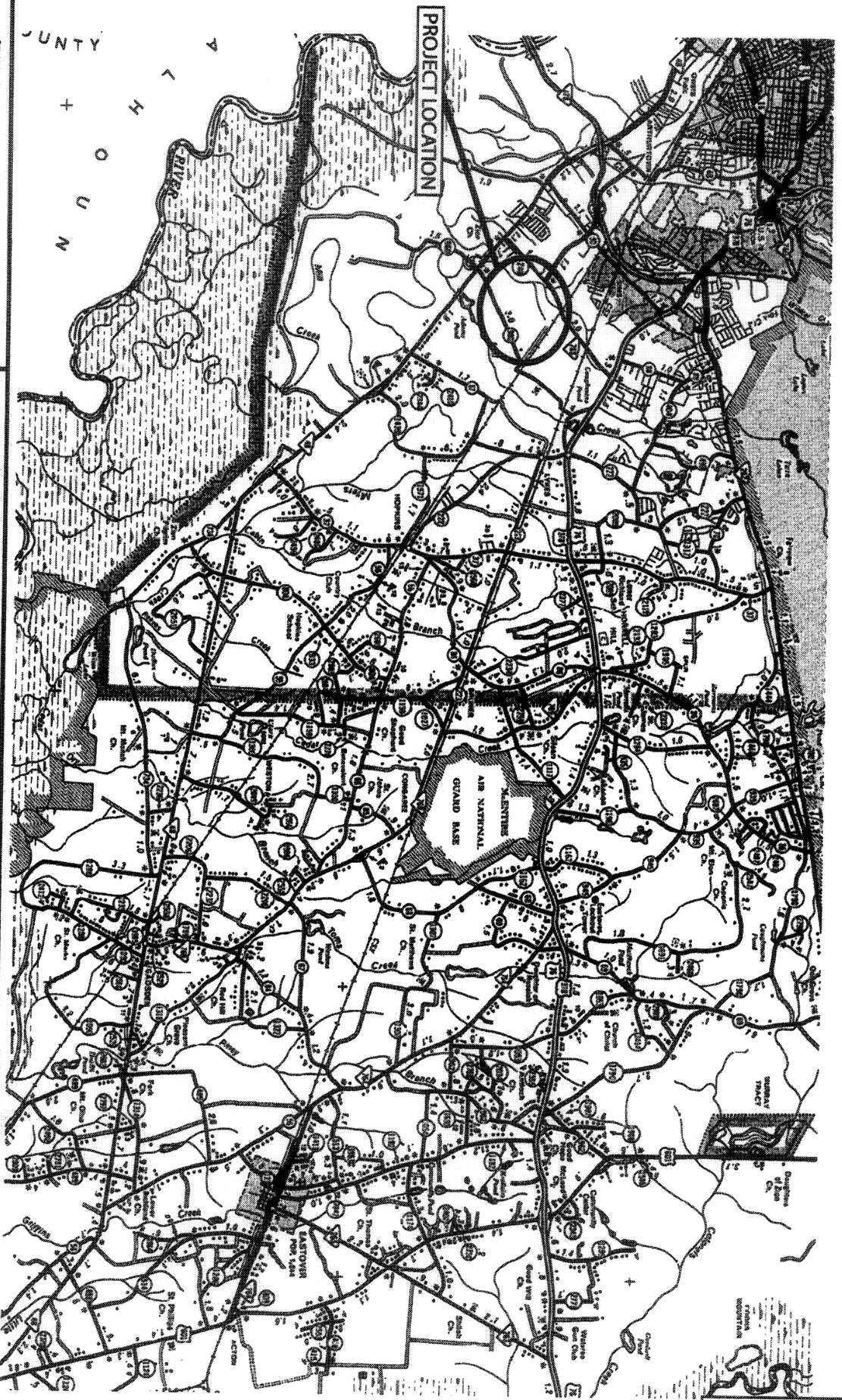

RICHLAND COUNTY, SC

FARMERS MARKET TRACT

PROPOSED DEVELOPMENT
INDIVIDUAL PERMIT PACKAGE LOCATION MAP

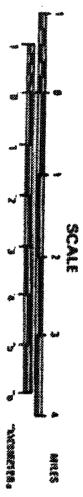

RICHLAND COUNTY, SOUTH CAROLINA
33°56'13" N, 80°56'46" W
APPLICATION BY RICHLAND COUNTY
PROPOSED COMMERCIAL DEVELOPMENT
DATE: 1/24/07 SHEET NO. 1 OF 33
2007-201 615

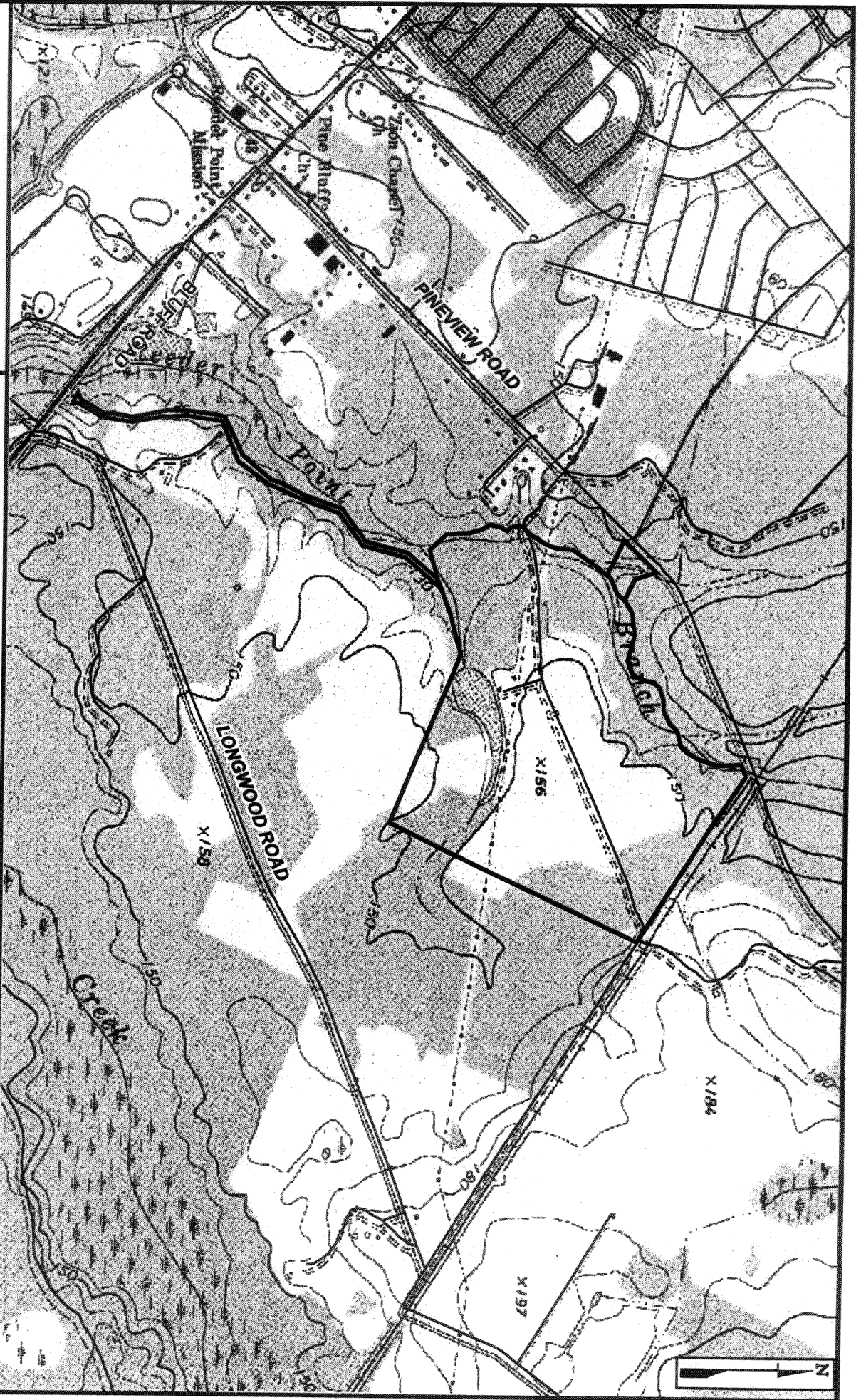

FARMERS MARKET SITE

PROPOSED DEVELOPMENT
 USGS TOPOGRAPHIC MAP - FORT JACKSON SOUTH QUADRANGLE

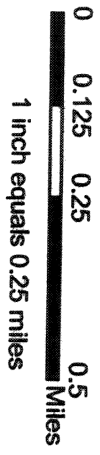

RICHLAND COUNTY, SOUTH CAROLINA
 33°56' 13" N, 80°56' 46" W
 APPLICATION BY SOUTH CAROLINA
 DEPARTMENT OF AGRICULTURE
 PROPOSED PUBLIC/PRIVATE DEVELOPMENT
 DATE: 1/24/07 SHEET NO. 2 OF 33
2007-201-615

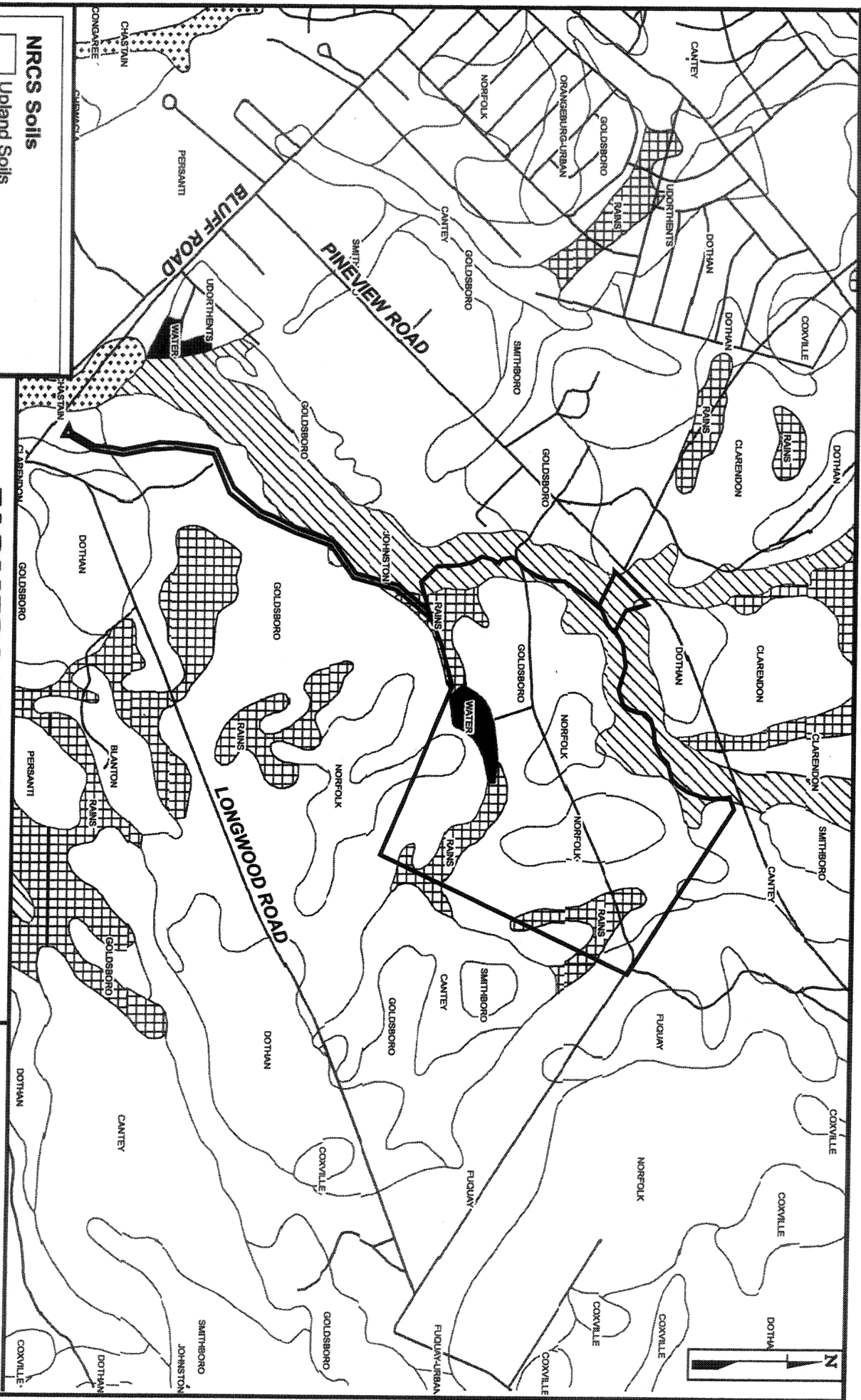

- NRCS Soils**
- Upland Soils
 - Hydric Soil Unit Name**
 - RAINS, SANDY LOAM,
 - CHASTAIN, SILTY CLAY LOAM,
 - JOHNSTON, LOAM,
 - Water

FARMERS MARKET SITE
 PROPOSED DEVELOPMENT
 NRCS SOILS MAP - FORT JACKSON SOUTH QUADRANGLE

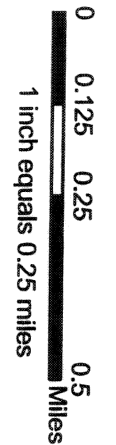

RICHLAND COUNTY, SOUTH CAROLINA
 33°56' 13" N, 80°56' 46" W
 APPLICATION BY SOUTH CAROLINA
 DEPARTMENT OF AGRICULTURE
 PROPOSED PUBLIC/PRIVATE DEVELOPMENT
 DATE: 1/24/07 SHEET NO. 3 OF 33
2007-201-615

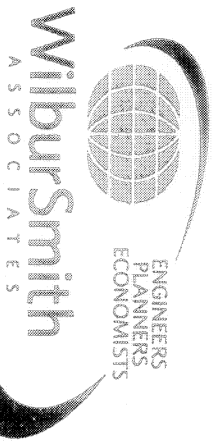

ENGINEERS
PLANNERS
ECONOMISTS

WilburSmith
ASSOCIATES

FARMERS MARKET SITE

PROPOSED DEVELOPMENT

1999 DOQQ AERIAL PHOTOGRAPHY - FORT JACKSON SOUTH QUADRANGLE



1 inch equals 0.25 miles

RICHLAND COUNTY, SOUTH CAROLINA

33°56' 13" N, 80°56' 46" W

APPLICATION BY SOUTH CAROLINA

DEPARTMENT OF AGRICULTURE

PROPOSED PUBLIC/PRIVATE DEVELOPMENT

DATE: 1/24/07 SHEET NO. 5 OF 23

2007-201-615

CLEARING IMPACT = 0.35 AC.
 FILL IMPACT = 3.5 AC.
 BACKFILL AND BEDDING = 0.54 AC.
 DITCH FILL = 0.26 AC./ 2022 LF
 NO STREAM IMPACTS
 SHADING IMPACT = 0.23 AC./ 110LF

WETLAND AREAS

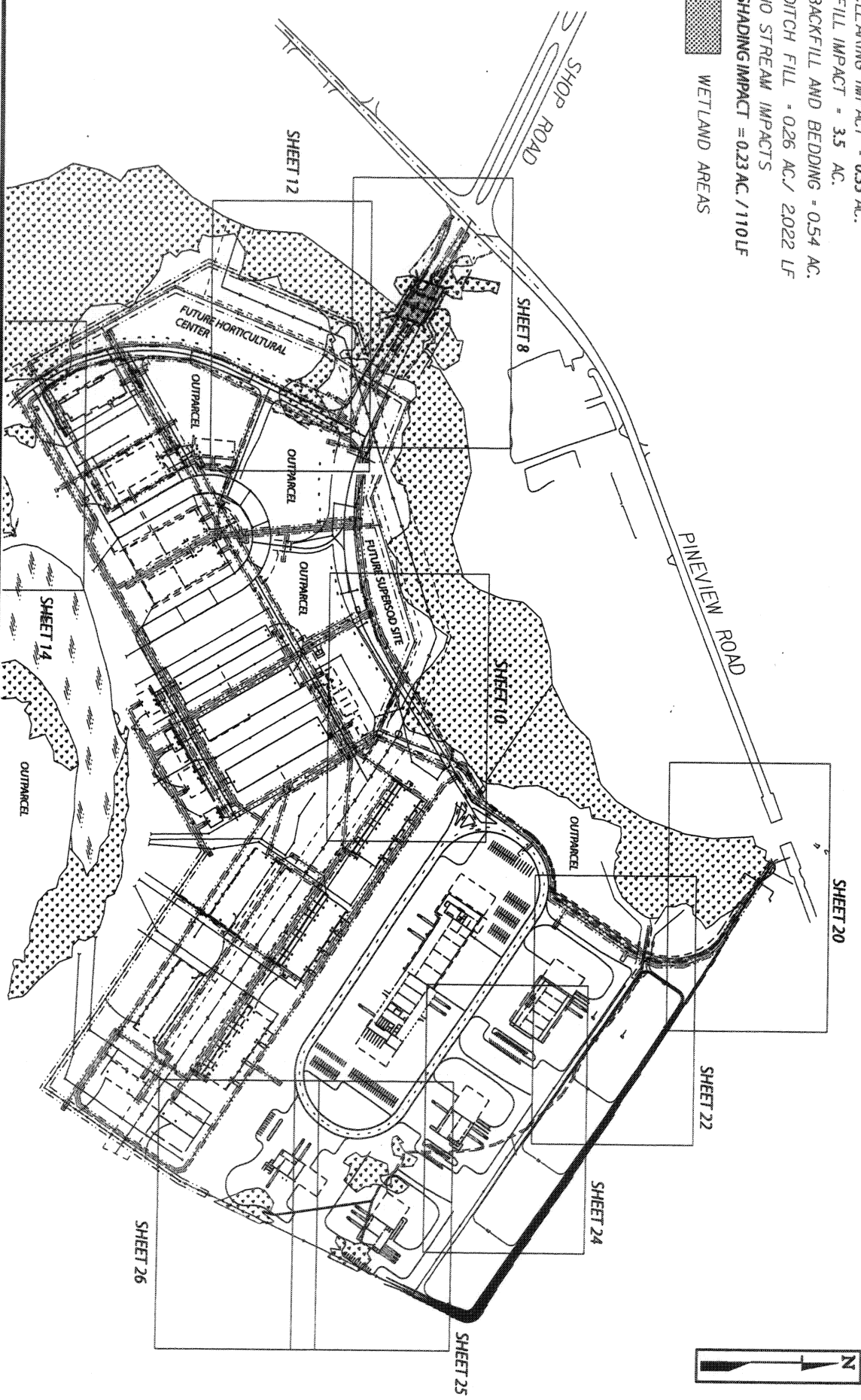

FARMERS MARKET SITE
 PROPOSED DEVELOPMENT
 PERMIT PACKAGE



RICHLAND COUNTY, SOUTH CAROLINA
 33° 56' 13" N, 80° 56' 46" W
 APPLICATION BY SOUTH CAROLINA
 DEPARTMENT OF AGRICULTURE
 PROPOSED PUBLIC/PRIVATE DEVELOPMENT
 DATE: 1/24/07 SHEET NO. 6 OF 33
 2007-201-615

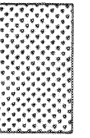

WETLAND AREAS

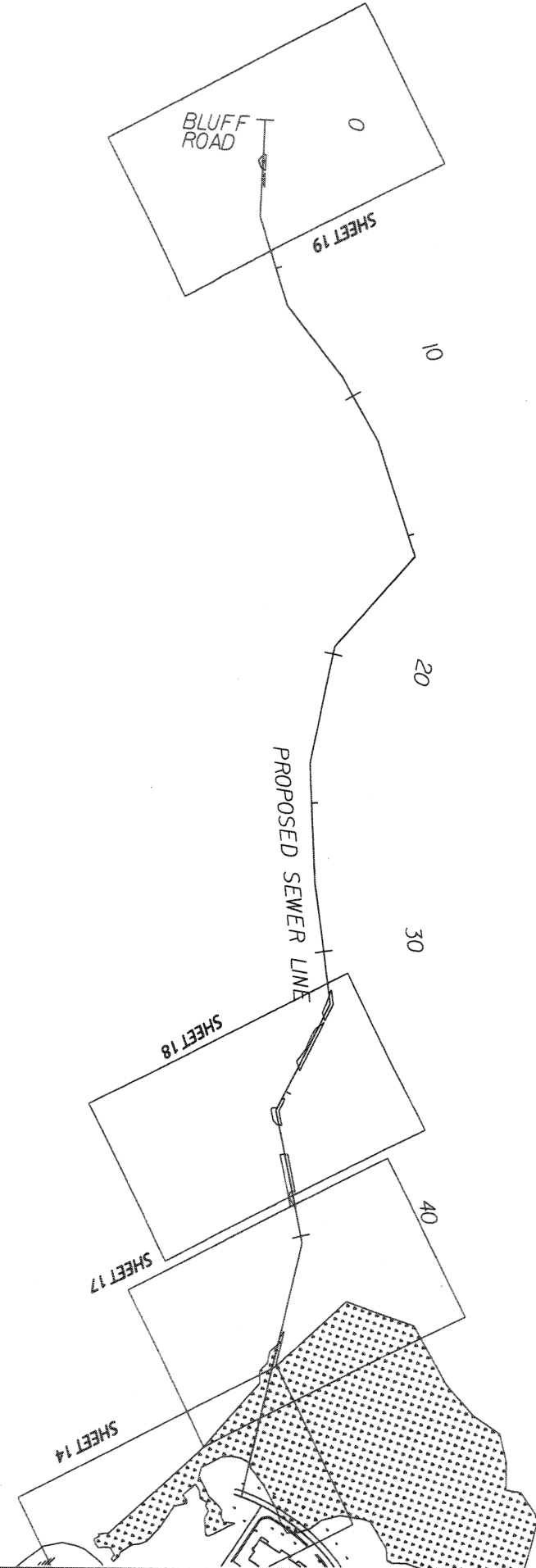
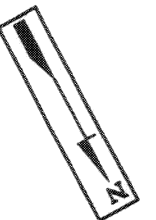

WilburSmith
ASSOCIATES

ENGINEERS
PLANNERS
ECONOMISTS

FARMERS MARKET SITE

PROPOSED DEVELOPMENT
PERMIT PACKAGE

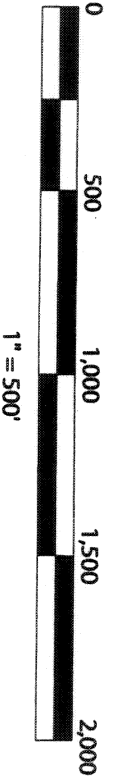

RICHLAND COUNTY, SOUTH CAROLINA
 33° 56' 13" N, 80° 56' 46" W
 APPLICATION BY SOUTH CAROLINA
 DEPARTMENT OF AGRICULTURE
 PROPOSED PUBLIC/PRIVATE DEVELOPMENT
 DATE: 1/24/07 SHEET NO. 7 OF 33
2007-201-611



- Wetlands - JURISDICTIONAL BOUNDARY DELINEATION LINE
- 000 ACRES OF BACKFILL AND BEDDING IMPACT
- CLEARING IMPACT - 019 AC.
- FILL IMPACT - 1.04 AC.
- SHADING IMPACT - 0.23 AC./110 LF STREAM

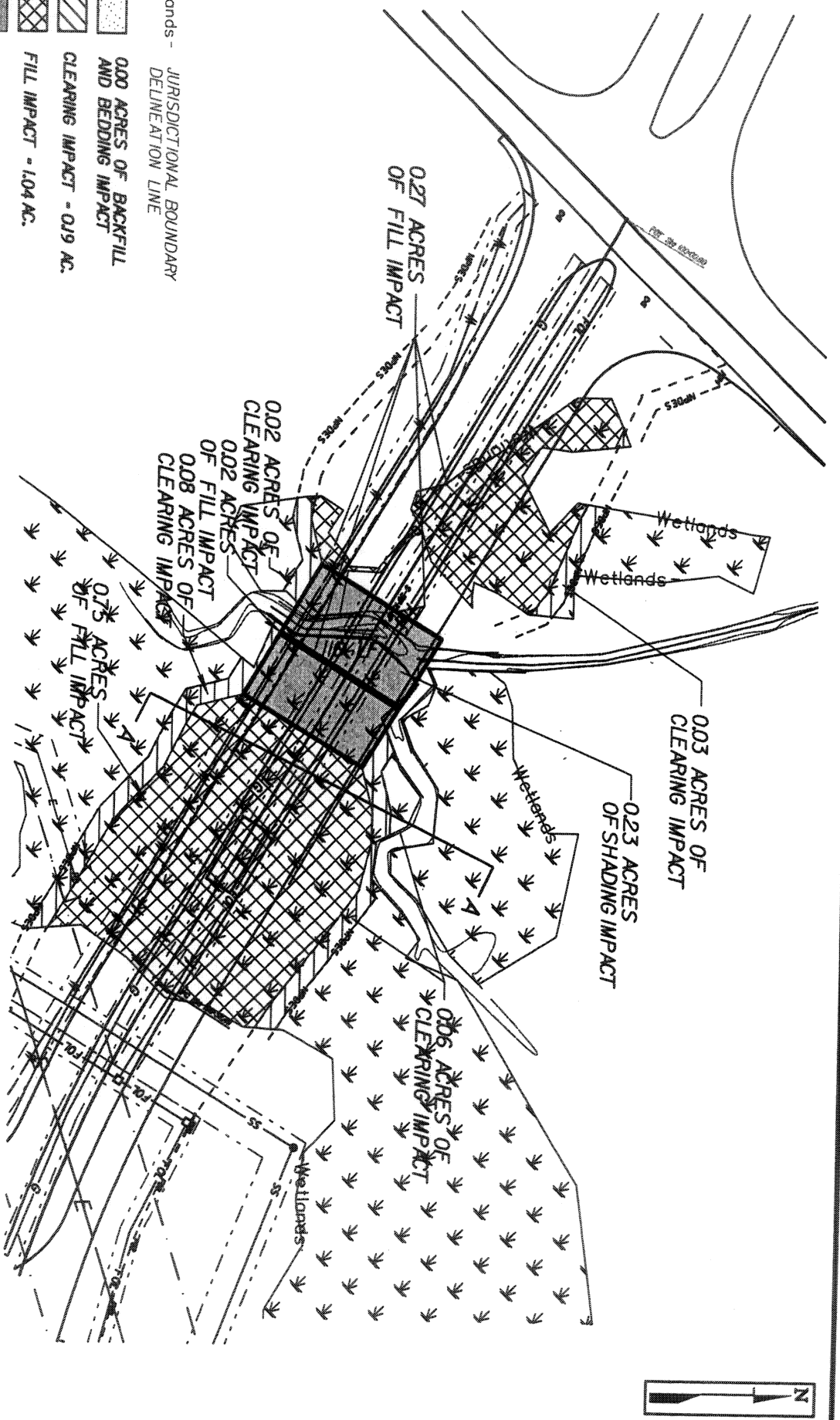



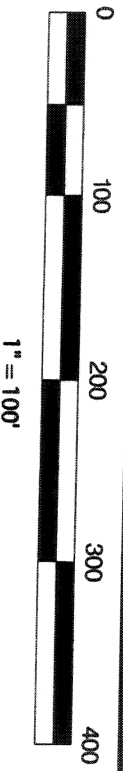

FARMERS MARKET SITE

PROPOSED DEVELOPMENT
PERMIT PACKAGE

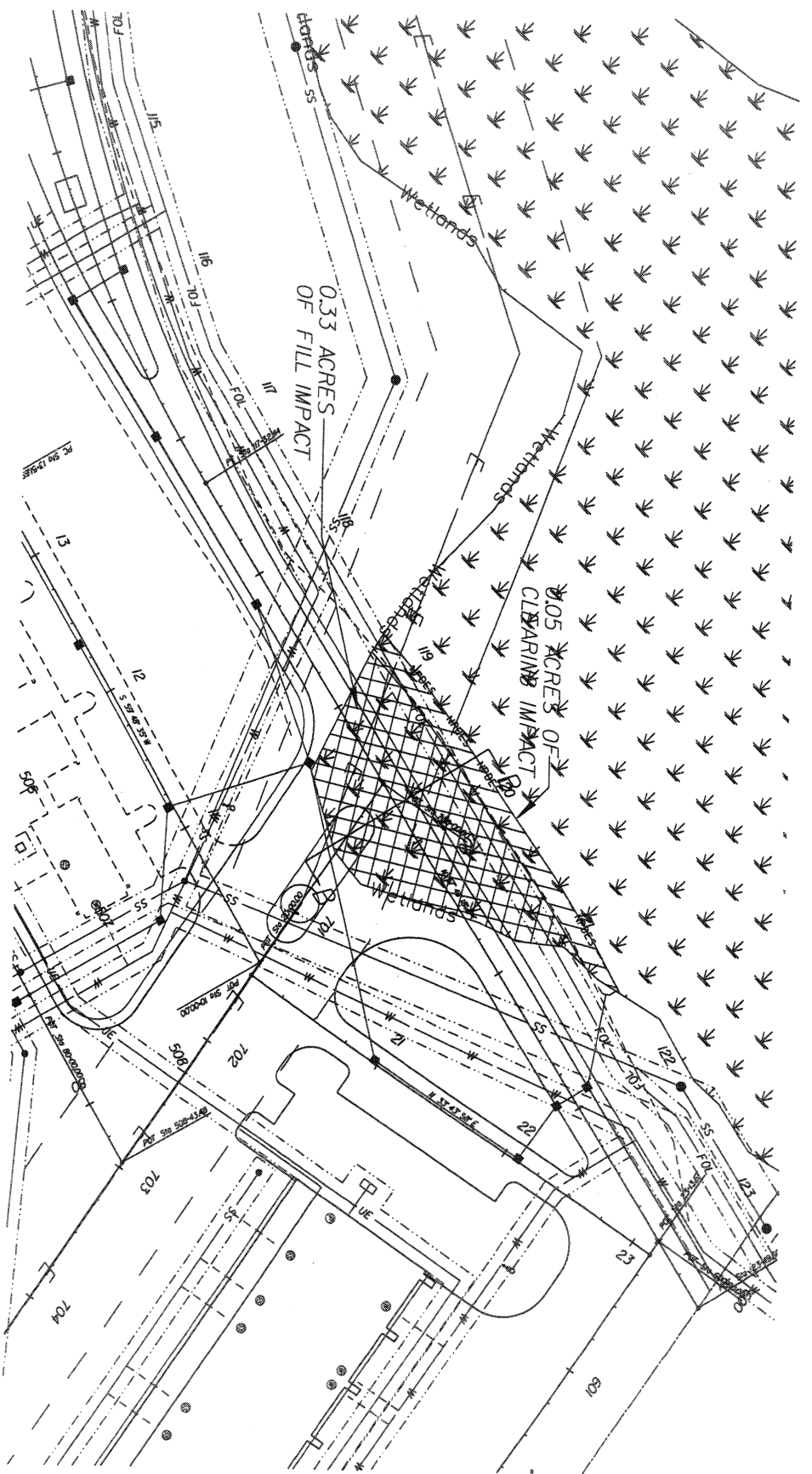

RICHLAND COUNTY, SOUTH CAROLINA
 33°56' 13" N, 80°56' 46" W
 APPLICATION BY SOUTH CAROLINA
 DEPARTMENT OF AGRICULTURE
 PROPOSED PUBLIC/PRIVATE DEVELOPMENT
 DATE: 1/24/07 SHEET NO. 8 OF 33
 2007-201-615

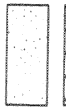

-  CLEARING IMPACT = 0.05 AC.
-  0.00 ACRES OF BACKFILL AND BEDDING IMPACT
-  Wetlands - JURISDICTIONAL BOUNDARY DELINEATION LINE
-  FILL IMPACT = 0.33 AC.

FARMERS MARKET SITE
 PROPOSED DEVELOPMENT
 PERMIT PACKAGE

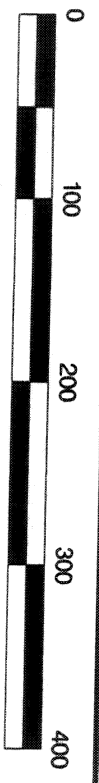

RICHLAND COUNTY, SOUTH CAROLINA
 33° 56' 13" N, 80° 56' 46" W
 APPLICATION BY SOUTH CAROLINA
 DEPARTMENT OF AGRICULTURE
 PROPOSED PUBLIC/PRIVATE DEVELOPMENT
 DATE: 1/24/07 SHEET NO. 10 OF 33

2007-201-615





FARMERS MARKET SITE
 PROPOSED DEVELOPMENT
 PERMIT PACKAGE

PROFILE AND CROSS SECTION

RICHLAND COUNTY, SOUTH CAROLINA
 33°56'13" N, 80°56'46" W
 APPLICATION BY SOUTH CAROLINA
 DEPARTMENT OF AGRICULTURE
 PROPOSED PUBLIC/PRIVATE DEVELOPMENT
 DATE: 1/24/07 SHEET NO. 11 OF 33
 2007-201-615

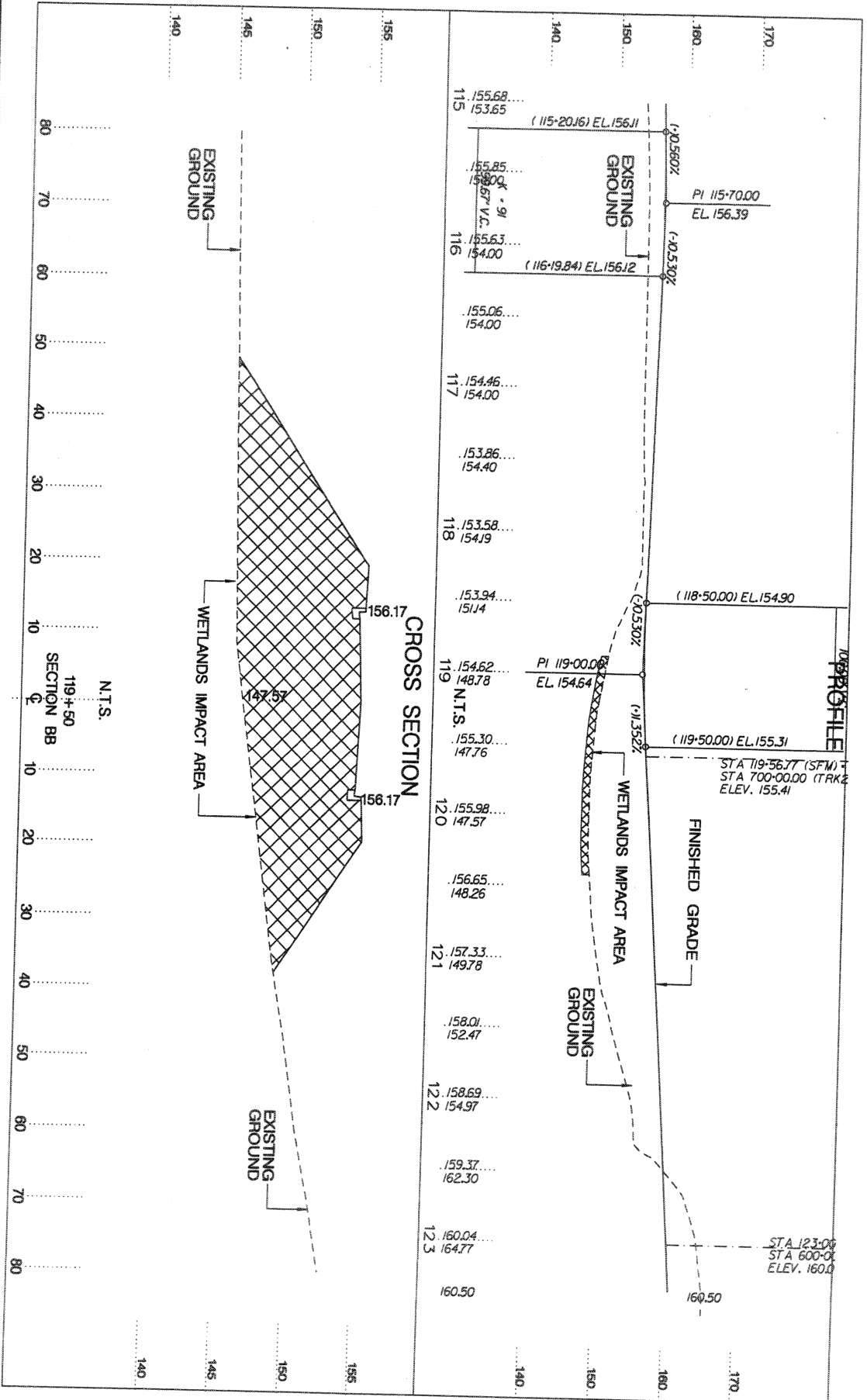



ENGINEERS
PLANNERS
ECONOMISTS

FARMERS MARKET SITE

PROPOSED DEVELOPMENT
PERMIT PACKAGE



PROFILE AND CROSS SECTION

RICHLAND COUNTY, SOUTH CAROLINA
33°56'13" N, 80°56'46" W
APPLICATION BY SOUTH CAROLINA
DEPARTMENT OF AGRICULTURE
PROPOSED PUBLIC/PRIVATE DEVELOPMENT
DATE: 1/24/07 SHEET NO. 13 OF 25

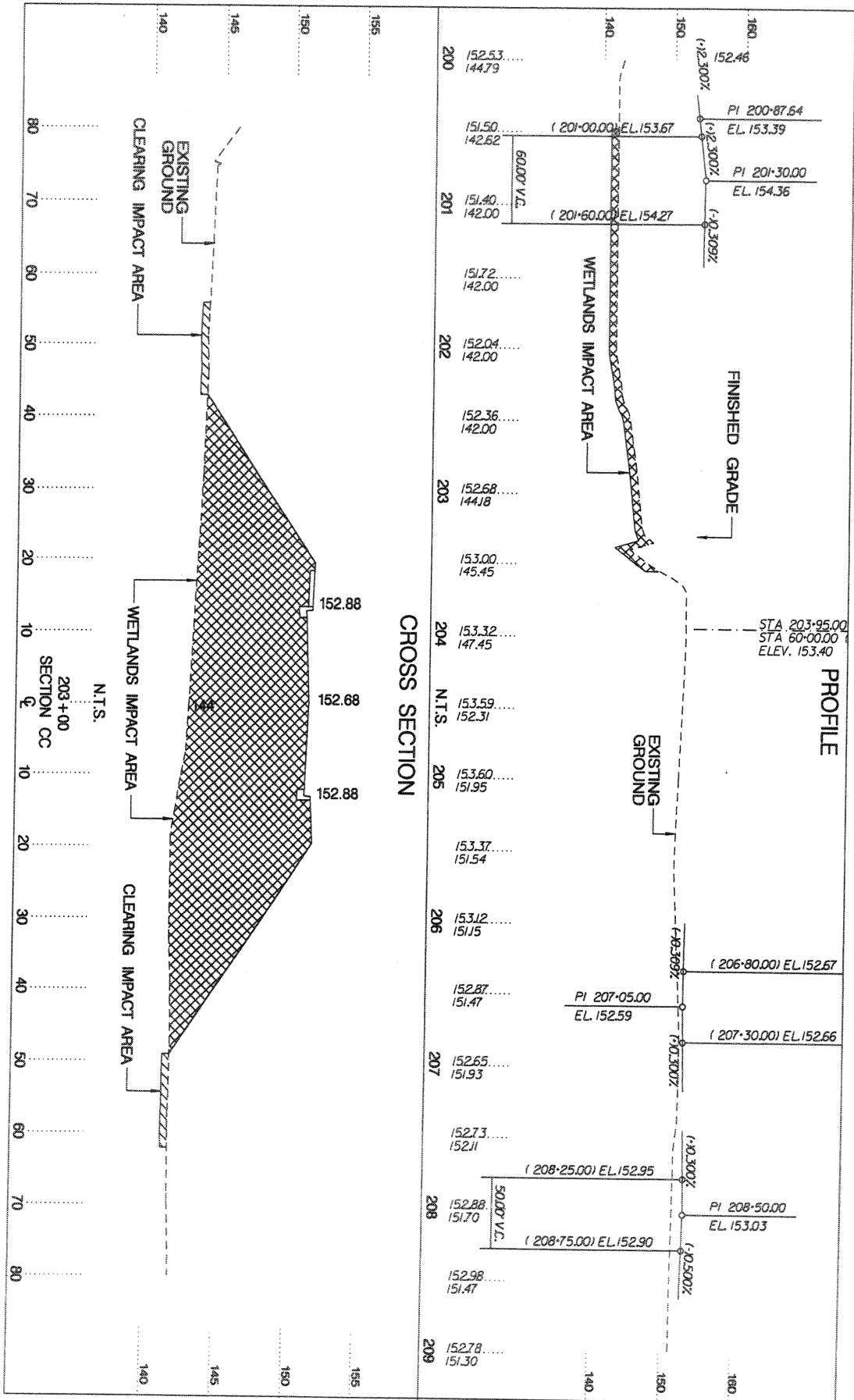
2007-201-615

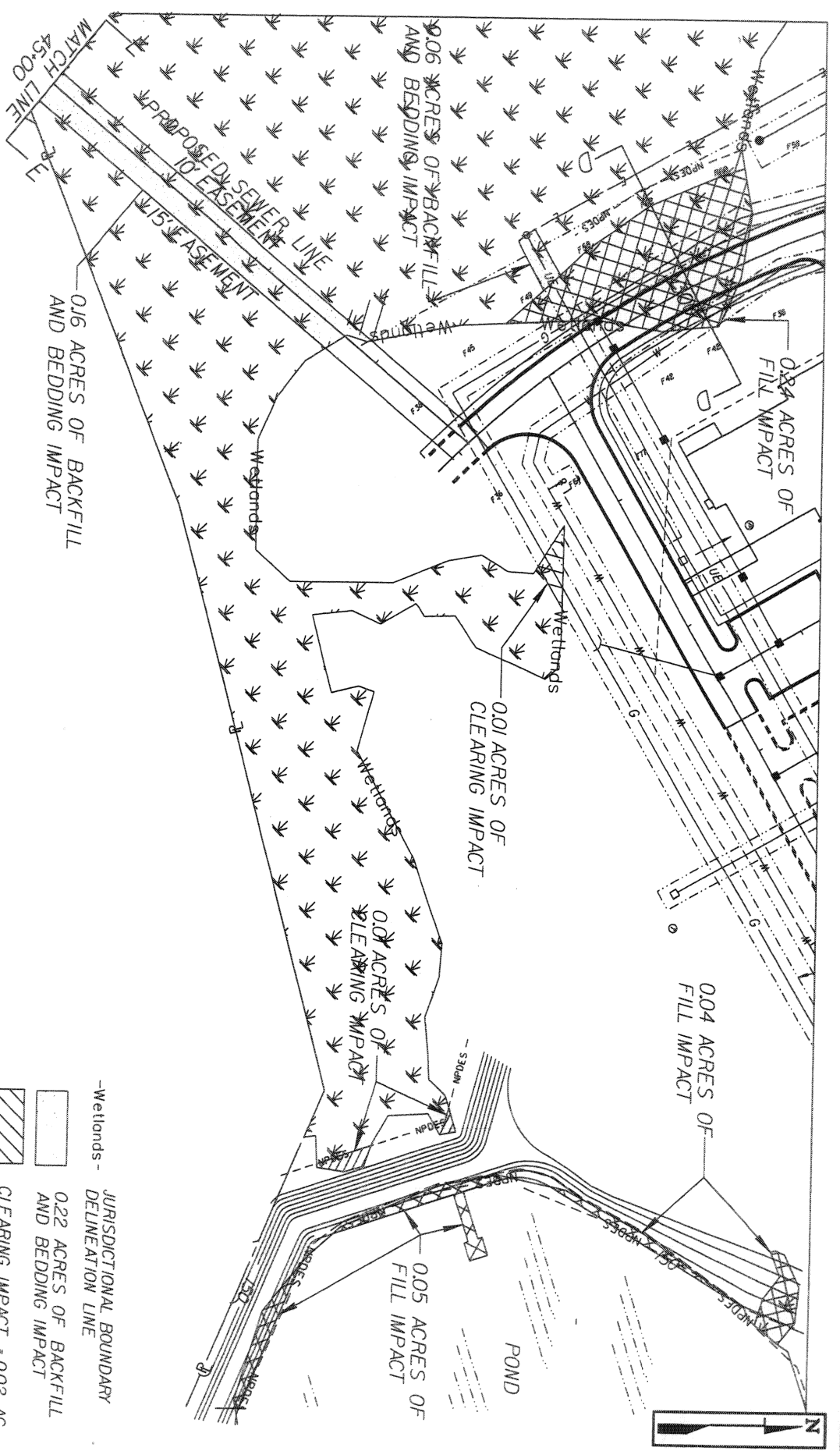

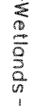

-  -Wetlands - JURISDICTIONAL BOUNDARY DELINEATION LINE
-  0.22 ACRES OF BACKFILL AND BEDDING IMPACT
-  CLEARING IMPACT - 0.02 AC.
-  FILL IMPACT - 0.33 AC.

FARMERS MARKET SITE
PROPOSED DEVELOPMENT
PERMIT PACKAGE

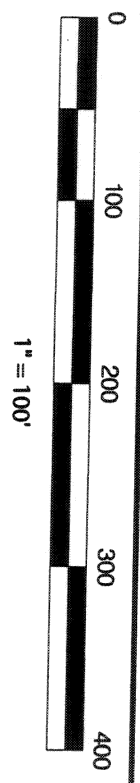

RICHLAND COUNTY, SOUTH CAROLINA
33°56'13" N, 80°56'46" W
APPLICATION BY SOUTH CAROLINA
DEPARTMENT OF AGRICULTURE
PROPOSED PUBLIC/PRIVATE DEVELOPMENT
DATE: 1/24/07 SHEET NO. 14 OF 33
2007-201-615



FARMERS MARKET SITE

PROPOSED DEVELOPMENT
PERMIT PACKAGE

PROFILE AND CROSS SECTION

RICHLAND COUNTY, SOUTH CAROLINA
33° 56' 13" N, 80° 56' 46" W
APPLICATION BY SOUTH CAROLINA
DEPARTMENT OF AGRICULTURE
PROPOSED PUBLIC/PRIVATE DEVELOPMENT
DATE: 1/24/07 SHEET NO. 15 OF 22
2007-201-615

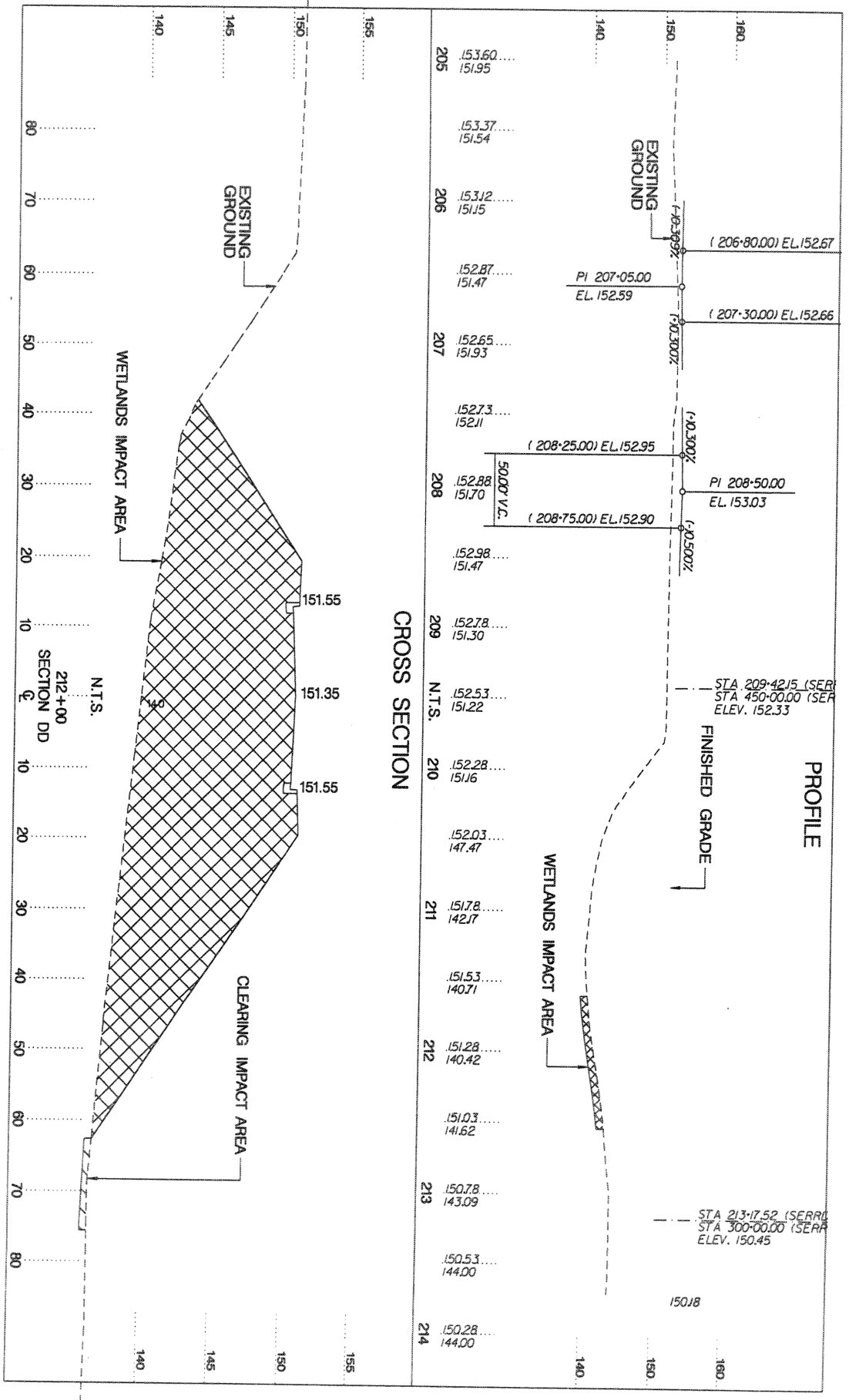



FARMERS MARKET SITE

PROPOSED DEVELOPMENT
PERMIT PACKAGE

PROFILE AND CROSS SECTION

RICHLAND COUNTY, SOUTH CAROLINA
33° 56' 13" N, 80° 56' 46" W
APPLICATION BY SOUTH CAROLINA
DEPARTMENT OF AGRICULTURE
PROPOSED PUBLIC/PRIVATE DEVELOPMENT
DATE: 1/24/07 SHEET NO. 16 OF 33
2007-201-615

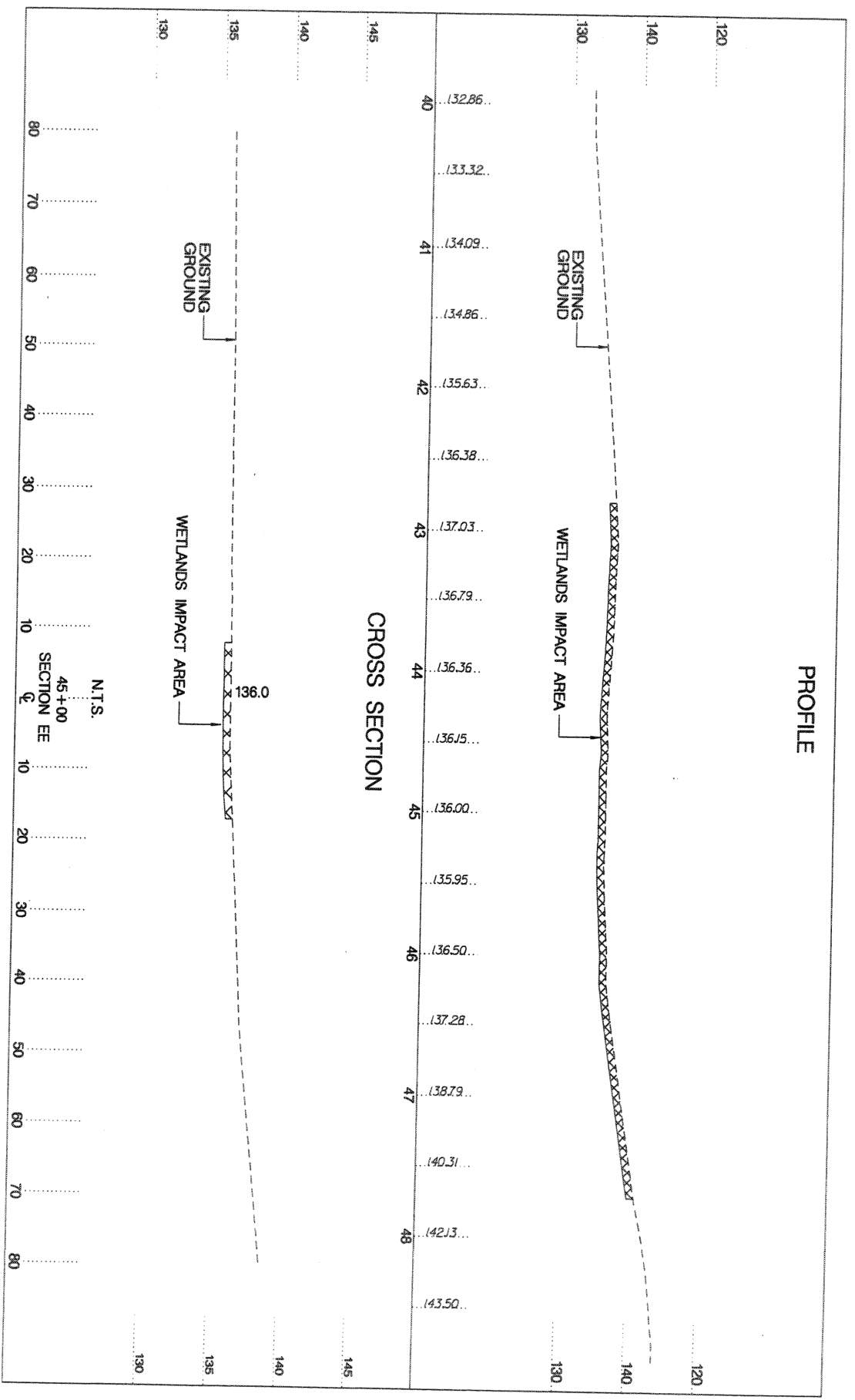

-Wetlands -
 JURISDICTIONAL BOUNDARY
 DELINEATION LINE
 CLEARING IMPACT = 0.00 AC.
 BACKFILL AND BEDDING IMPACT = 0.09 AC.
 FILL IMPACT = 0.00 AC.

WilburSmith
 ASSOCIATES
 ENGINEERS
 PLANNERS
 ECONOMISTS

FARMERS MARKET SITE
 PROPOSED DEVELOPMENT
 PERMIT PACKAGE

0 100 200 300 400
 1" = 100'

RICHLAND COUNTY, SOUTH CAROLINA
 33°56'13" N, 80°56'46" W
 APPLICATION BY SOUTH CAROLINA
 DEPARTMENT OF AGRICULTURE
 PROPOSED PUBLIC/PRIVATE DEVELOPMENT
 DATE: 1/24/07 SHEET NO. 17 OF 33
2007-201-617

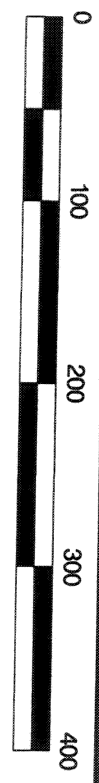
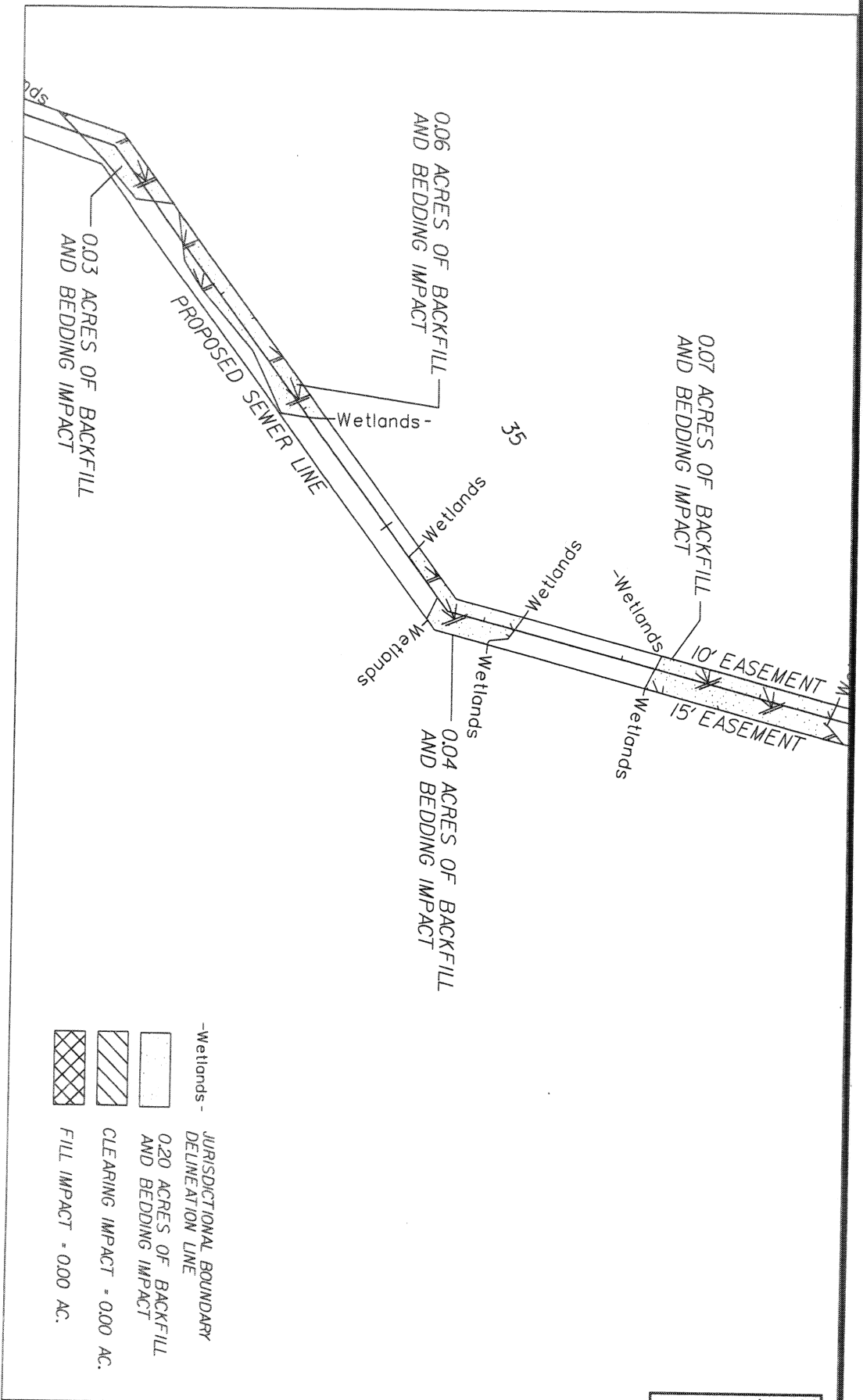



FARMERS MARKET SITE
 PROPOSED DEVELOPMENT
 PERMIT PACKAGE

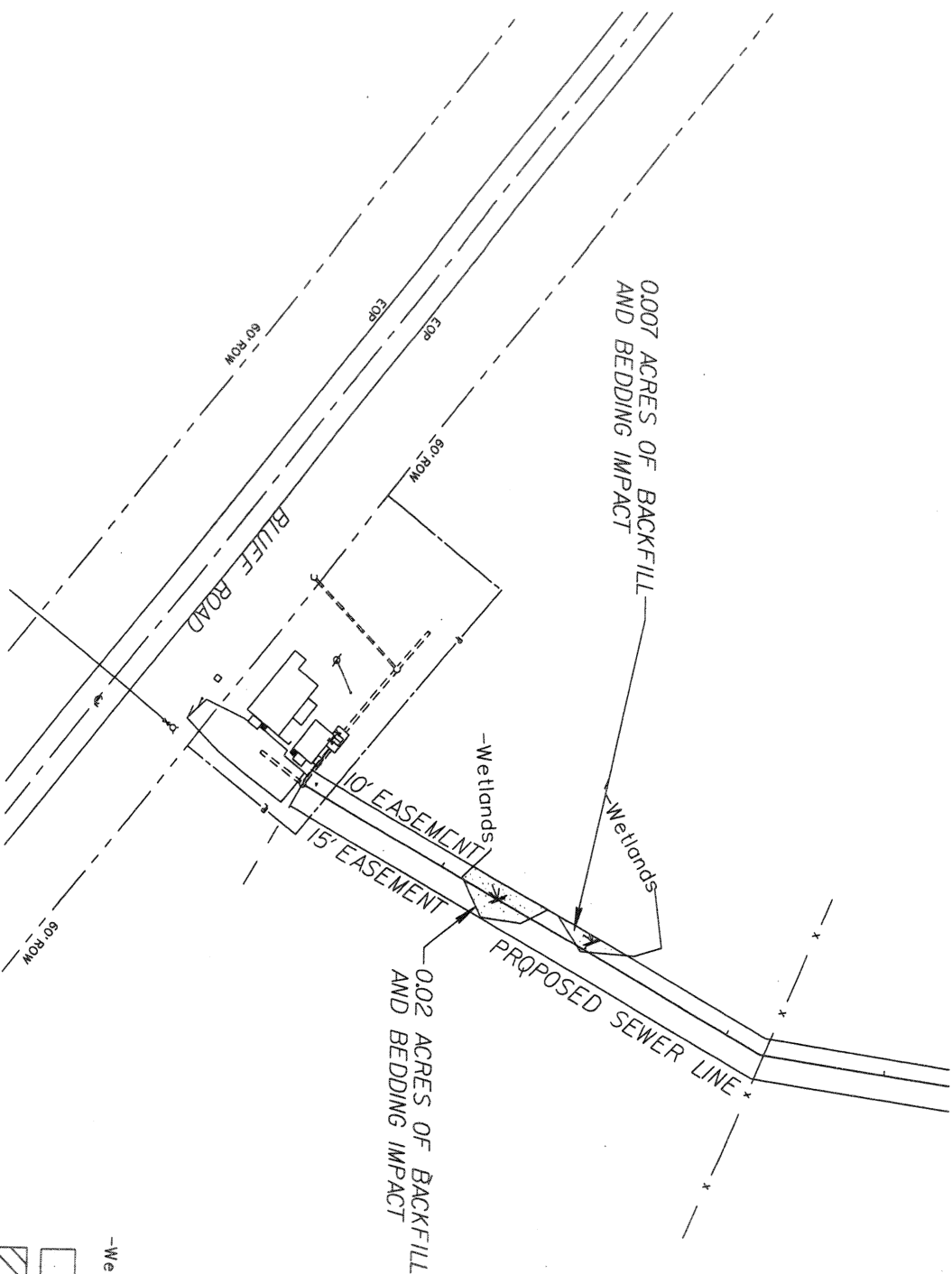

RICHLAND COUNTY, SOUTH CAROLINA
 33°56' 13" N, 80°56' 46" W
 APPLICATION BY SOUTH CAROLINA
 DEPARTMENT OF AGRICULTURE
 PROPOSED PUBLIC/PRIVATE DEVELOPMENT
 DATE: 1/24/07 SHEET NO. 18 OF 35
 2007-201-615



- Wetlands - JURISDICTIONAL BOUNDARY DELINEATION LINE
-  0.03 ACRES OF BACKFILL AND BEDDING IMPACT
-  CLEARING IMPACT = 0.00 AC.
-  FILL IMPACT = 0.00 AC.

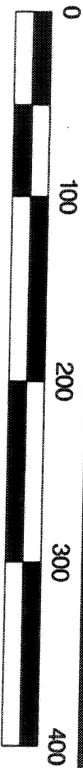







FARMERS MARKET SITE
 PROPOSED DEVELOPMENT
 PERMIT PACKAGE



RICHLAND COUNTY, SOUTH CAROLINA
 33°56' 13" N, 80°56' 46" W
 APPLICATION BY SOUTH CAROLINA
 DEPARTMENT OF AGRICULTURE
 PROPOSED PUBLIC/Private DEVELOPMENT
 DATE: 1/24/07 SHEET NO. 19 OF 23
 2007-201-615



-  -Wetlands-
-  JURISDICTIONAL BOUNDARY
-  DELINEATION LINE
-  000 ACRES OF BACKFILL AND BEDDING IMPACT
-  CLEARING IMPACT = 0.06 AC.
-  FILL IMPACT = 0.10 AC.

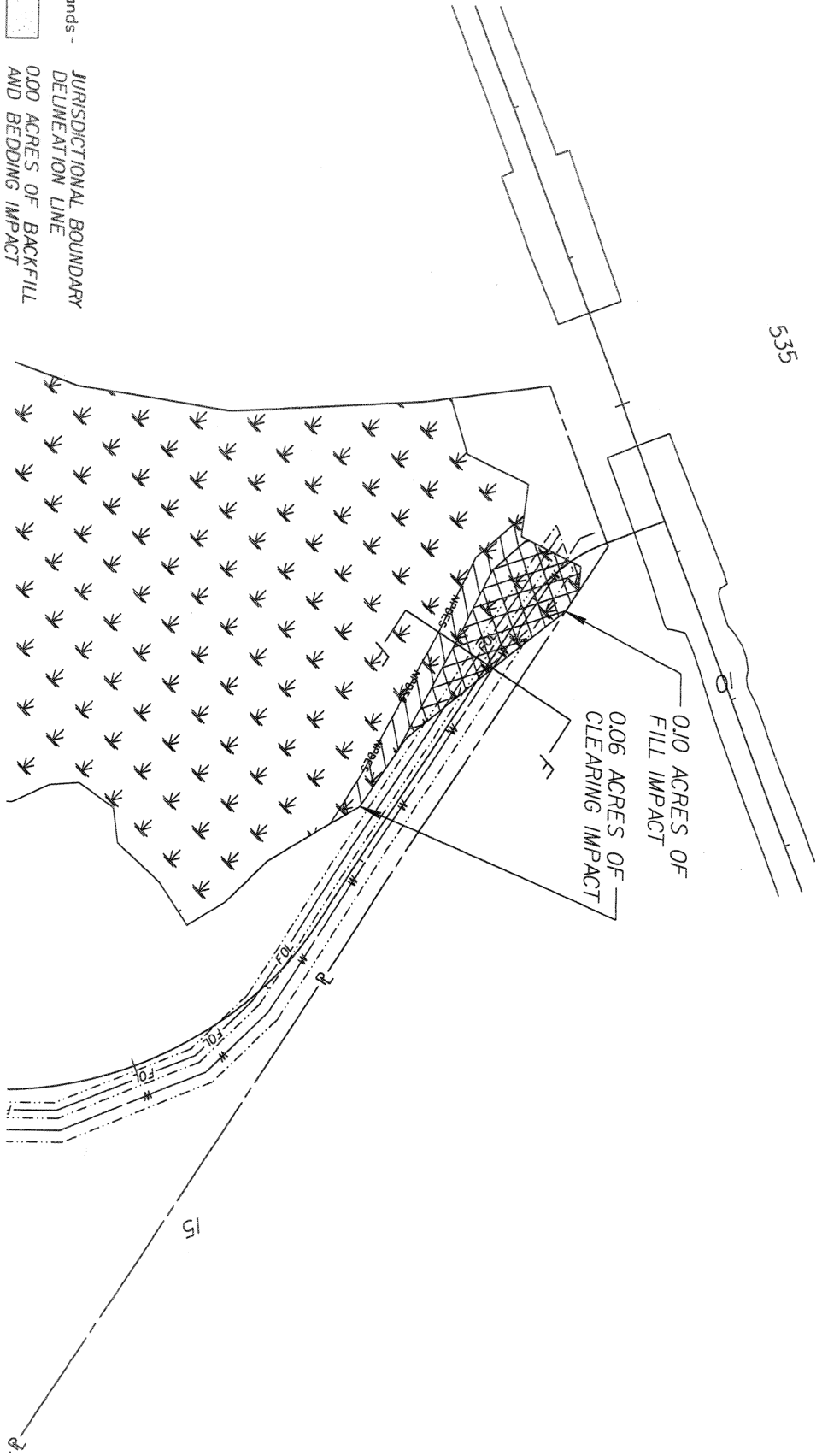

FARMERS MARKET SITE
 PROPOSED DEVELOPMENT
 PERMIT PACKAGE

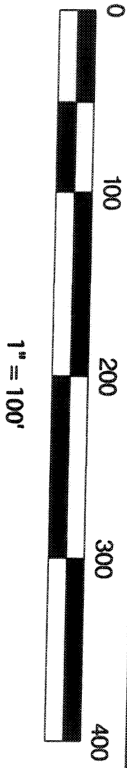

RICHLAND COUNTY, SOUTH CAROLINA
 33°56'13" N, 80°56'46" W
 APPLICATION BY SOUTH CAROLINA
 DEPARTMENT OF AGRICULTURE
 PROPOSED PUBLIC/PRIVATE DEVELOPMENT
 DATE: 1/24/07 SHEET NO. 20 OF 33
 2007-201-610

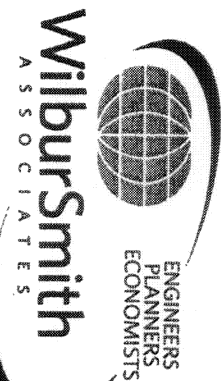

FARMERS MARKET SITE

PROPOSED DEVELOPMENT
PERMIT PACKAGE

PROFILE AND CROSS SECTION

RICHLAND COUNTY, SOUTH CAROLINA
33° 56' 13" N, 80° 56' 46" W
APPLICATION BY SOUTH CAROLINA
DEPARTMENT OF AGRICULTURE
PROPOSED PUBLIC/PRIVATE DEVELOPMENT
DATE: 1/24/07 SHEET NO. 21 OF 32
2007-201-615

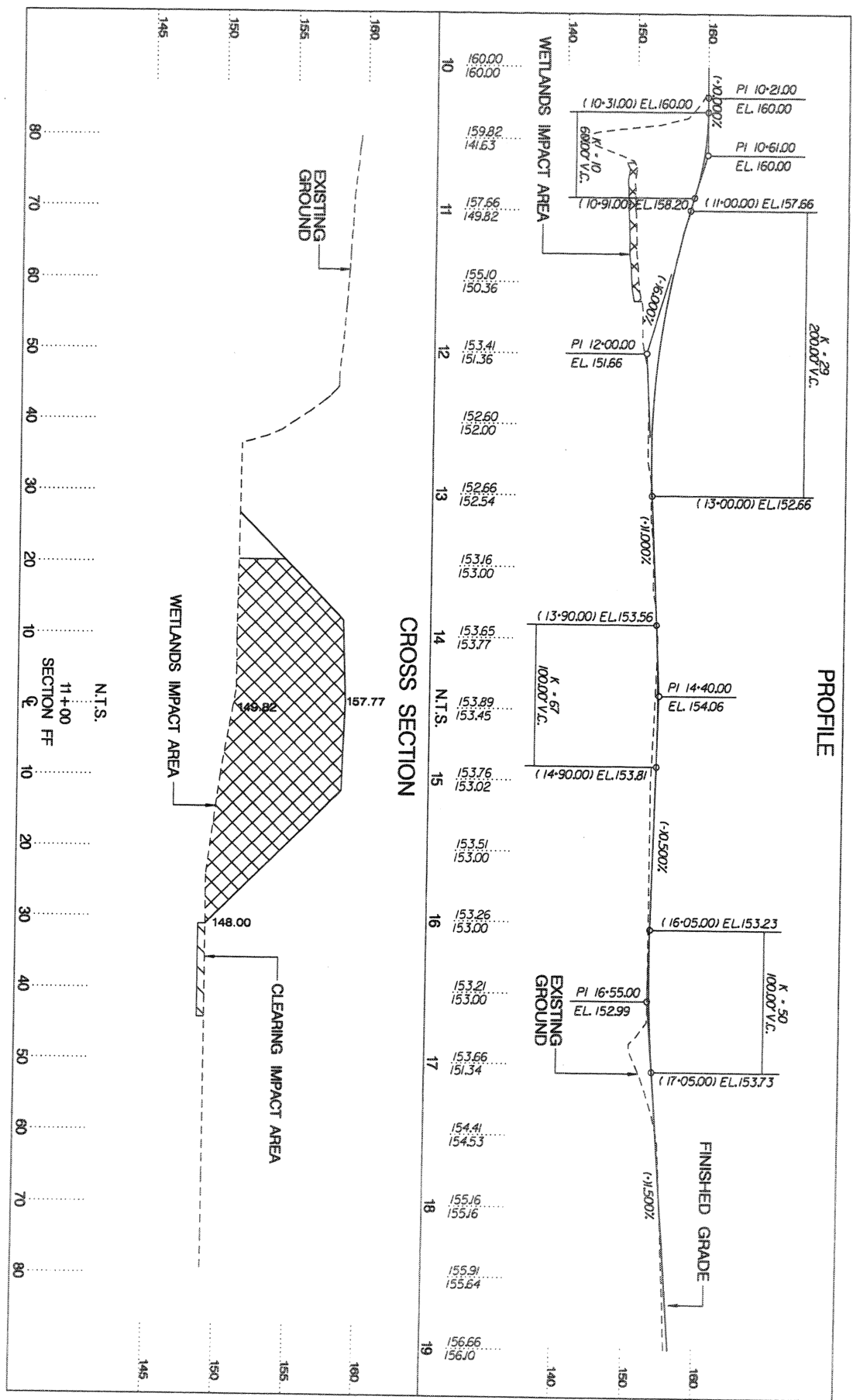

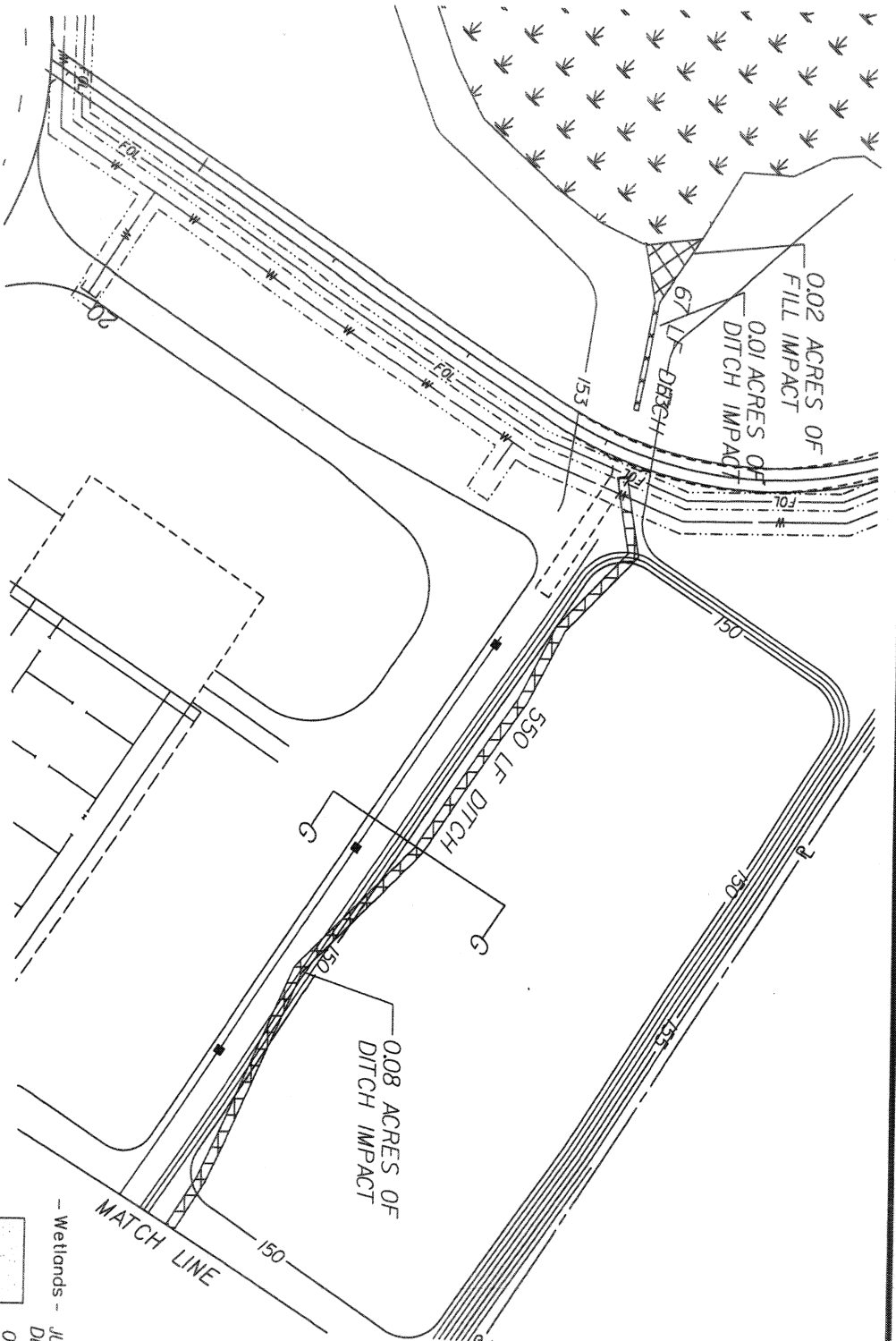

- Wetlands - JURISDICTIONAL BOUNDARY DELINEATION LINE
- 000 ACRES OF BACKFILL AND BEDDING IMPACT
- CLEARING IMPACT - 000 AC.
- FILL IMPACT - 002 AC.
- DITCH IMPACT - 009 AC./67 LF

FARMERS MARKET SITE

PROPOSED DEVELOPMENT
PERMIT PACKAGE

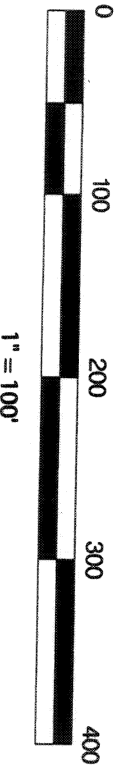

RICHLAND COUNTY, SOUTH CAROLINA
 33°56'13" N, 80°56'46" W
 APPLICATION BY SOUTH CAROLINA
 DEPARTMENT OF AGRICULTURE
 PROPOSED PUBLIC/Private DEVELOPMENT
 DATE: 1/24/07 SHEET NO. 22 OF 33

2007-201-615



PROFILE

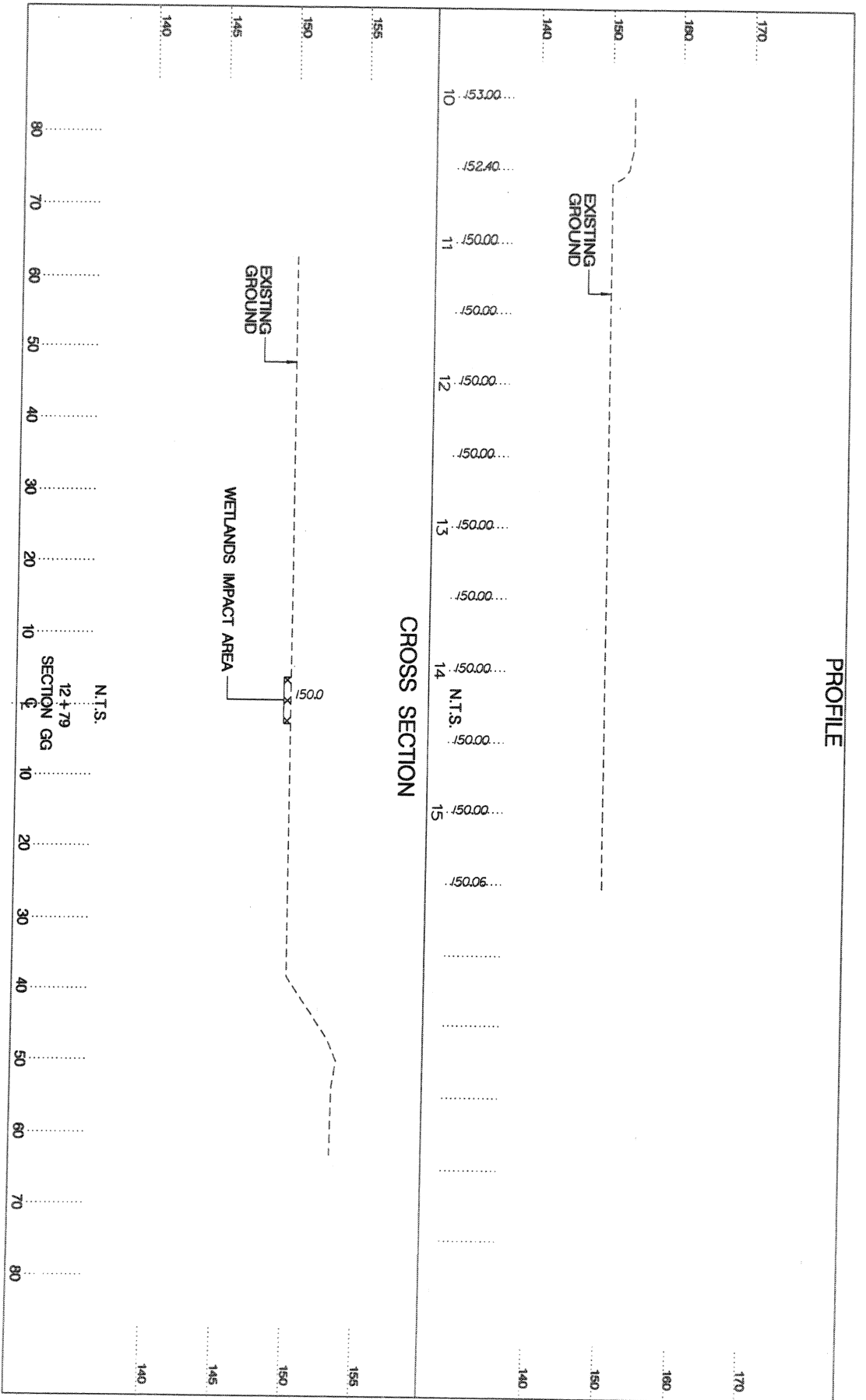

FARMERS MARKET SITE
 PROPOSED DEVELOPMENT
 PERMIT PACKAGE

PROFILE AND CROSS SECTION

RICHLAND COUNTY, SOUTH CAROLINA
 33°56' 13" N, 80°56' 46" W
 APPLICATION BY SOUTH CAROLINA
 DEPARTMENT OF AGRICULTURE
 PROPOSED PUBLIC/PRIVATE DEVELOPMENT
 DATE: 1/24/07 SHEET NO. 23 OF 32
 2007-201-613

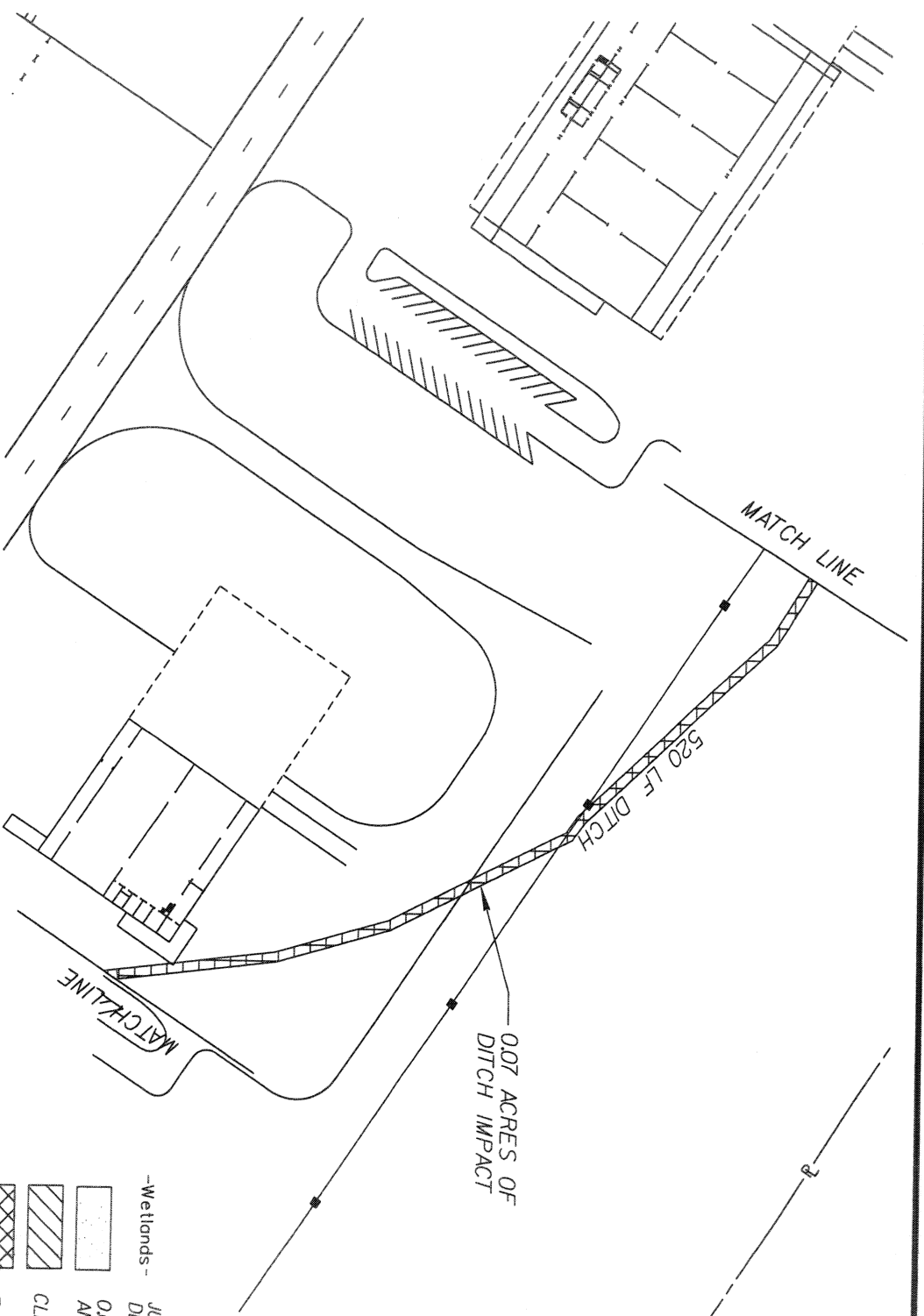

- Wetlands-
- JURISDICTIONAL BOUNDARY DELINEATION LINE
- 000 ACRES OF BACKFILL AND BEDDING IMPACT
- CLEARING IMPACT - 0.00 AC.
- FILL IMPACT - 0.00 AC.
- DITCH IMPACT - 0.07 AC./520 LF



FARMERS MARKET SITE
 PROPOSED DEVELOPMENT
 PERMIT PACKAGE

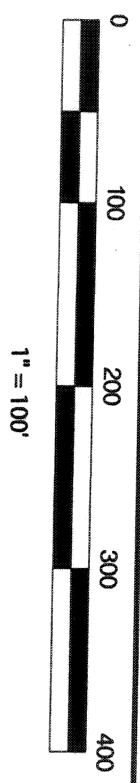

RICHLAND COUNTY, SOUTH CAROLINA
 33°56' 13" N, 80°56' 46" W
 APPLICATION BY SOUTH CAROLINA
 DEPARTMENT OF AGRICULTURE
 PROPOSED PUBLIC/PRIVATE DEVELOPMENT
 DATE: 1/24/07 SHEET NO. 24 OF 33
 2007-20-615



FARMERS MARKET SITE

PROPOSED DEVELOPMENT
PERMIT PACKAGE

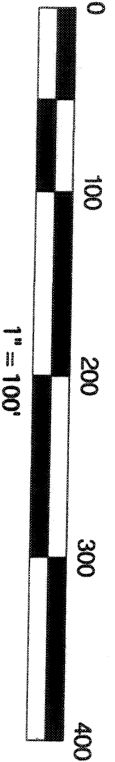

- Wetlands-
- JURISDICTIONAL BOUNDARY DELINEATION LINE
- 0.00 ACRES OF BACKFILL AND BEDDING IMPACT
- CLEARING IMPACT = 0.00 AC.
- FILL IMPACT = 0.80AC.
- DITCH IMPACT = 0.08 AC./754 LF

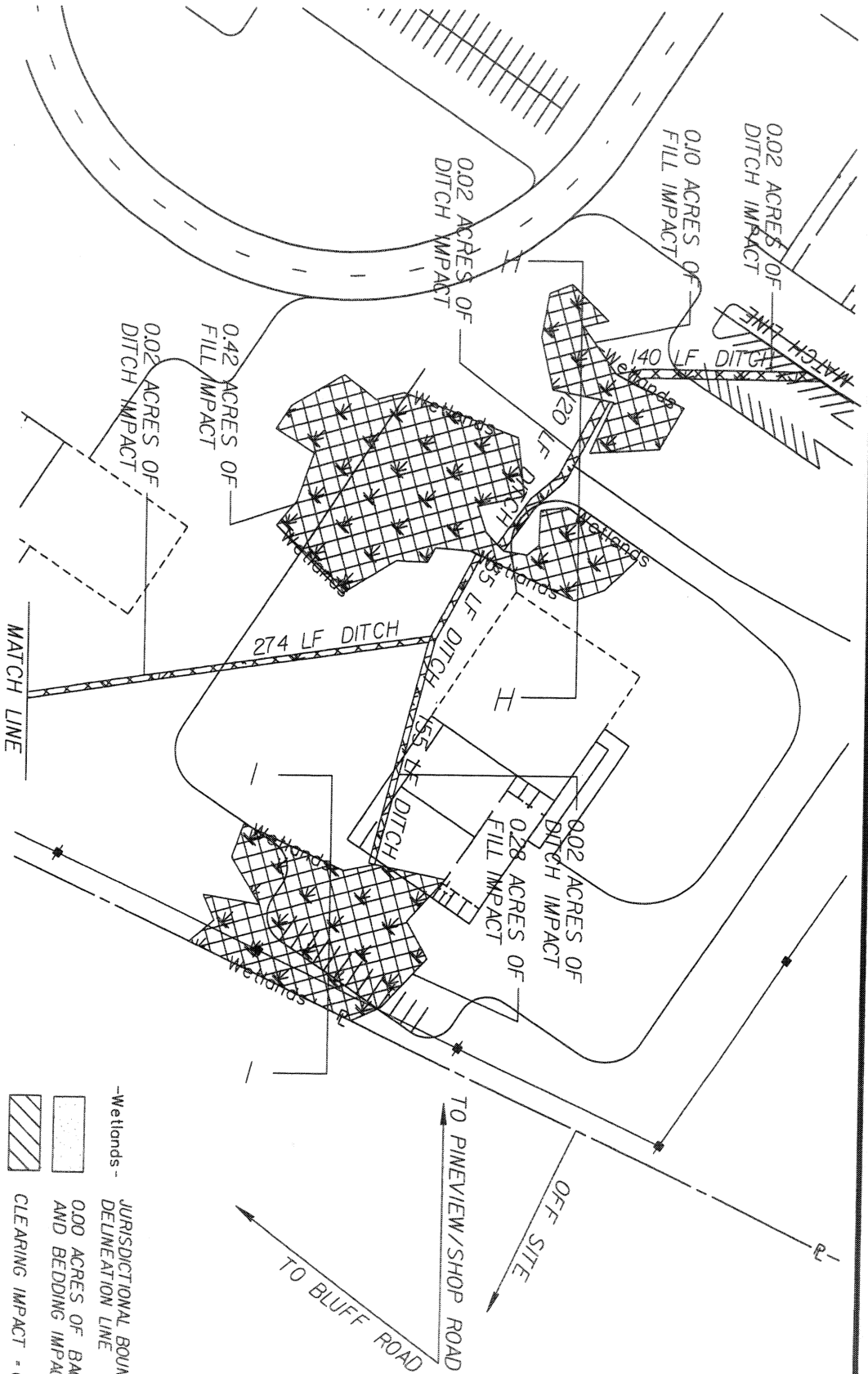

RICHLAND COUNTY, SOUTH CAROLINA
 33°56' 13" N, 80°56' 46" W
 APPLICATION BY SOUTH CAROLINA
 DEPARTMENT OF AGRICULTURE
 PROPOSED PUBLIC/Private DEVELOPMENT
 DATE: 1/24/07 SHEET NO. 25 OF 33

2007-201-615

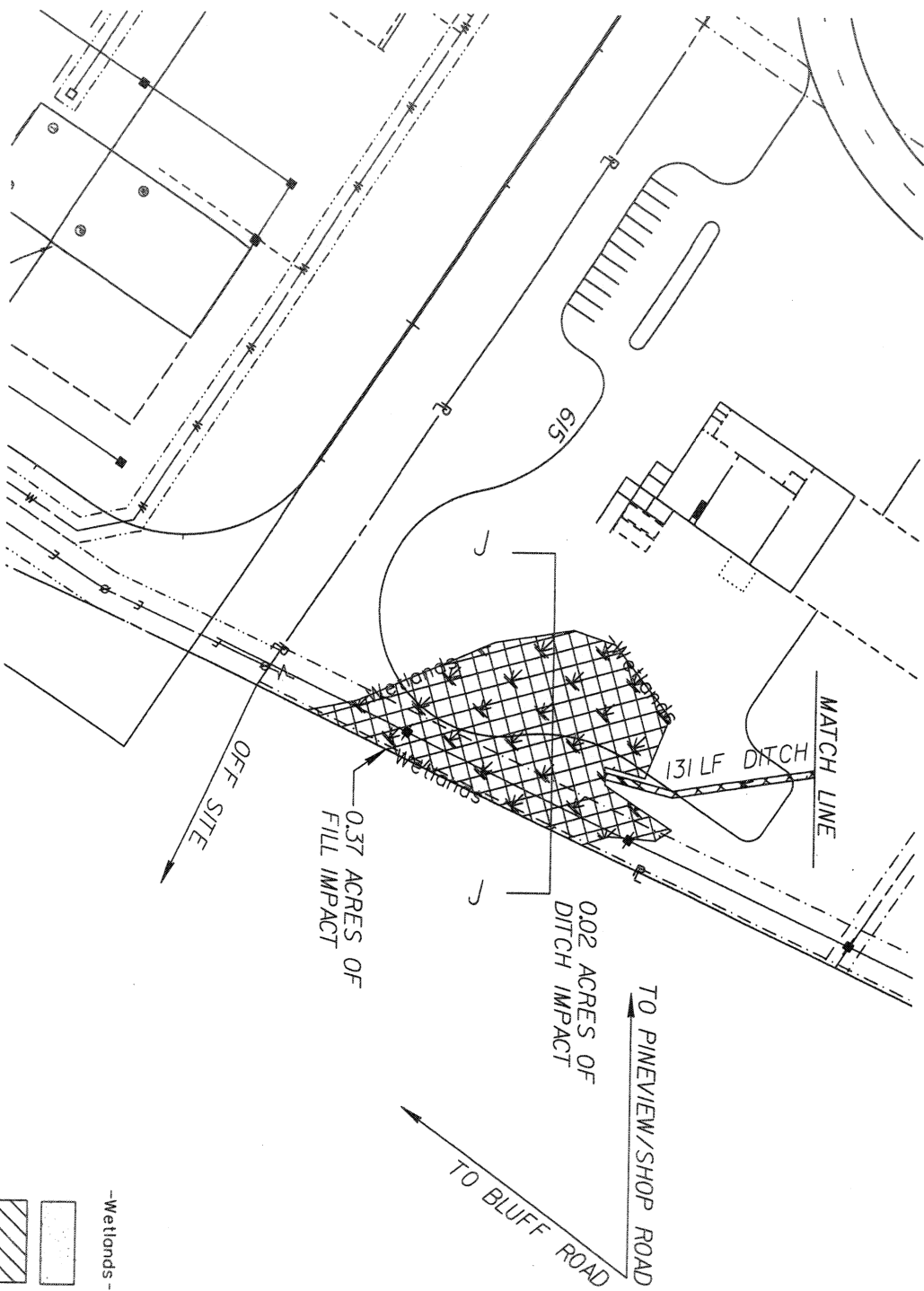

- Wetlands - JURISDICTIONAL BOUNDARY DELINEATION LINE
- 0.00 ACRES OF BACKFILL AND BEDDING IMPACT
- CLEARING IMPACT - 0.00 AC.
- FILL IMPACT - 0.37 AC.
- DITCH IMPACT - 0.02 AC./131 LF



FARMERS MARKET SITE
 PROPOSED DEVELOPMENT
 PERMIT PACKAGE

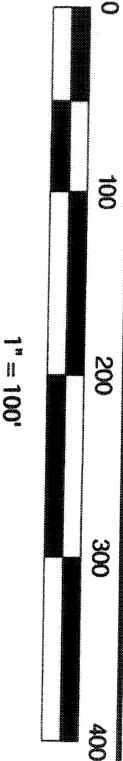

RICHLAND COUNTY, SOUTH CAROLINA
 33°56' 13" N, 80°56' 46" W
 APPLICATION BY SOUTH CAROLINA
 DEPARTMENT OF AGRICULTURE
 PROPOSED PUBLIC/PRIVATE DEVELOPMENT
 DATE: 1/24/07 SHEET NO. 26 OF 33
 2007-201-615

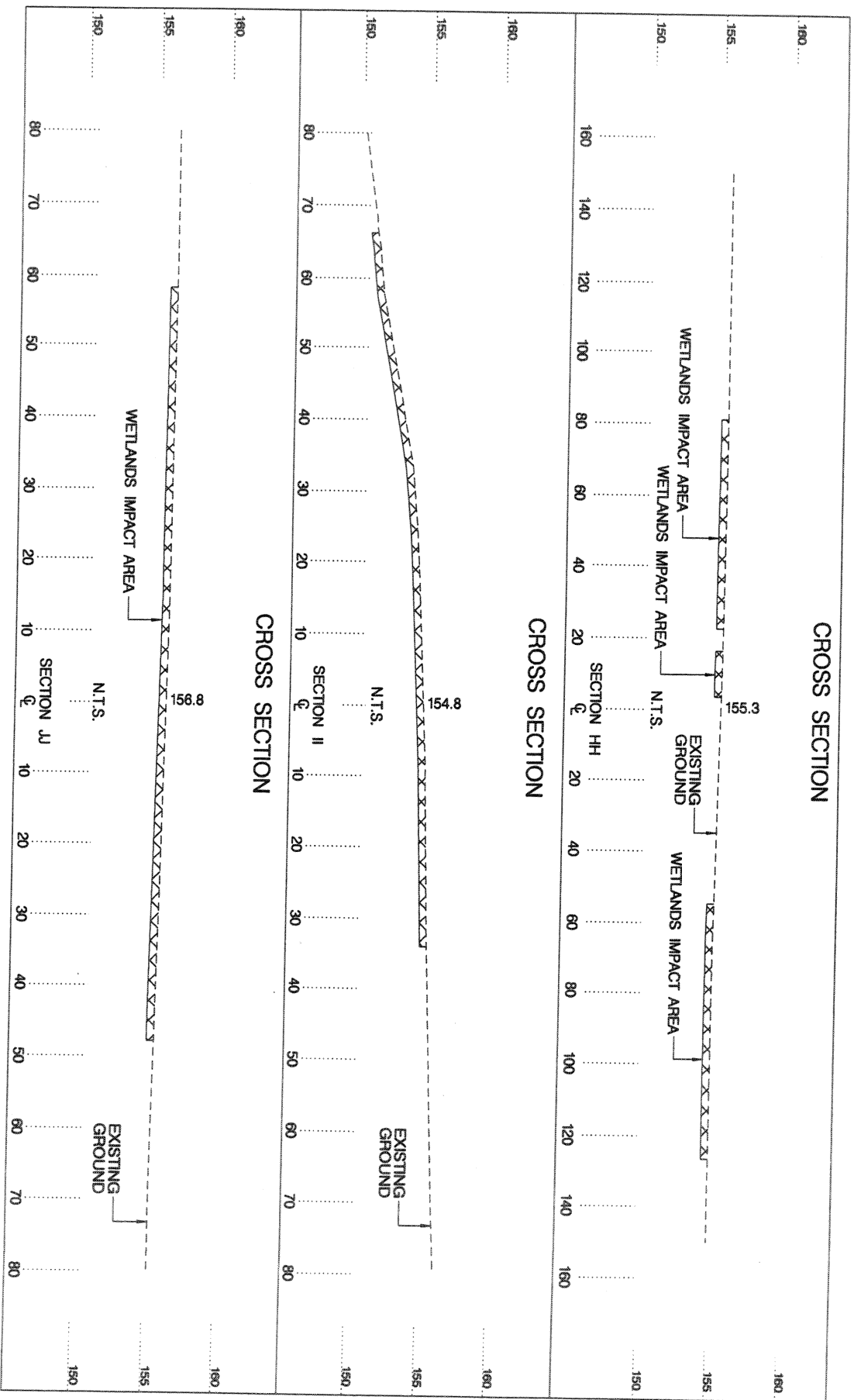
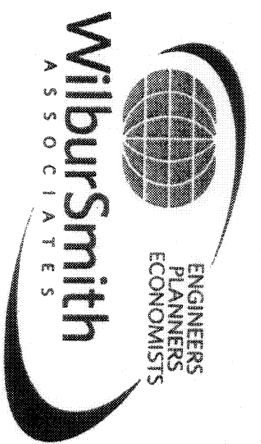

FARMERS MARKET SITE
 PROPOSED DEVELOPMENT
 PERMIT PACKAGE

CROSS SECTIONS

RICHLAND COUNTY, SOUTH CAROLINA
 33°56'13" N, 80°56'46" W
 APPLICATION BY SOUTH CAROLINA
 DEPARTMENT OF AGRICULTURE
 PROPOSED PUBLIC/PRIVATE DEVELOPMENT
 DATE: 1/24/07 SHEET NO. 27 OF 32
2007-201-61J



FARMERS MARKET SITE

PROPOSED DEVELOPMENT - MITIGATION PACKAGE



2007-201-615

RICHLAND COUNTY, SOUTH CAROLINA
33° 56' 13" N, 80° 56' 46" W
APPLICATION BY SOUTH CAROLINA
DEPARTMENT OF AGRICULTURE
PROPOSED PUBLIC/PRIVATE DEVELOPMENT
DATE: 1/24/07 SHEET NO. 29 OF 35

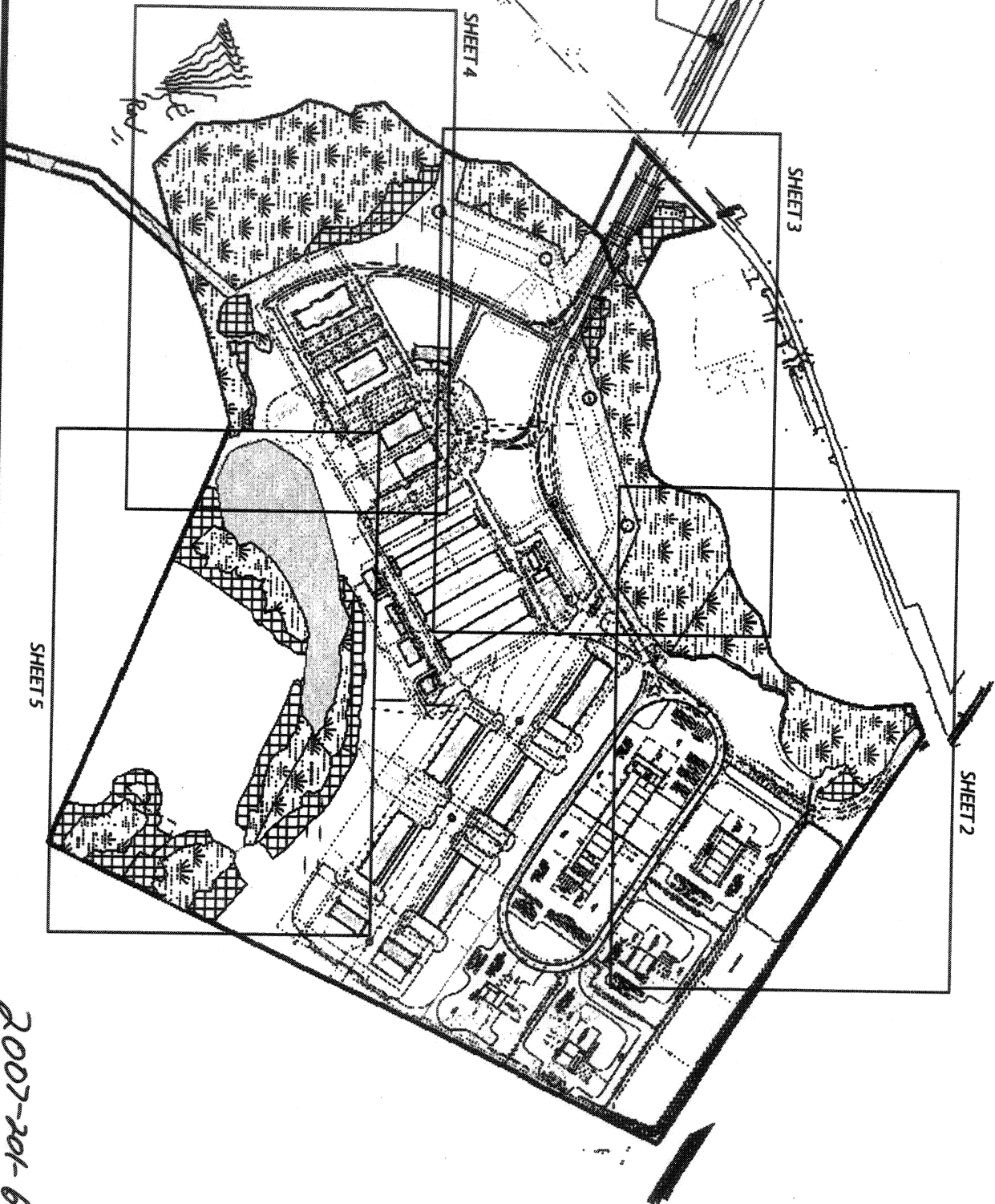

2007-201-613

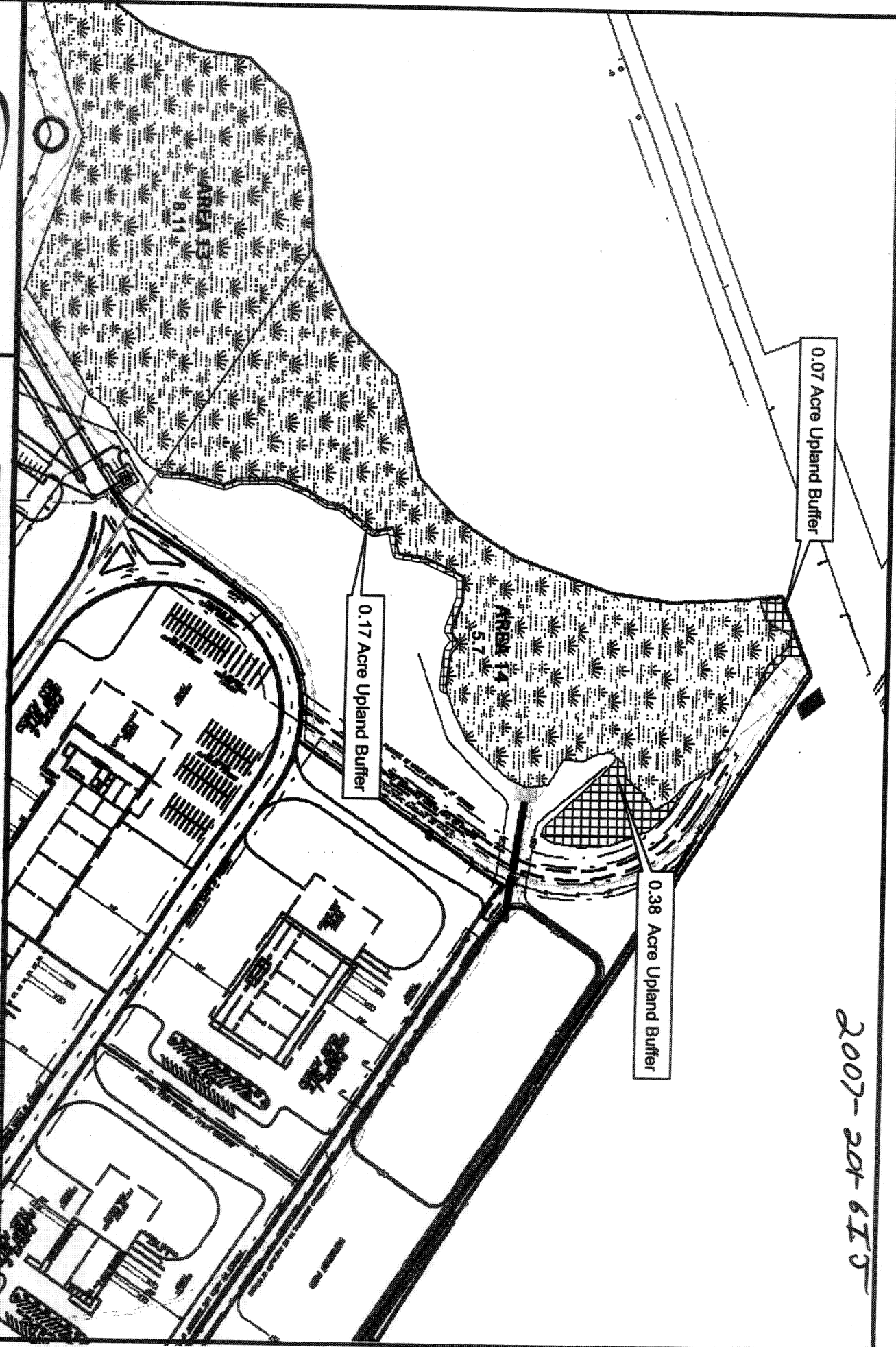

0.07 Acre Upland Buffer

0.17 Acre Upland Buffer

0.38 Acre Upland Buffer

AREA 13
8.11

AREA 14
5.7



FARMERS MARKET SITE

PROPOSED DEVELOPMENT - MITIGATION PACKAGE



RICHLAND COUNTY, SOUTH CAROLINA
33° 56' 13" N, 80° 56' 46" W
APPLICATION BY SOUTH CAROLINA
DEPARTMENT OF AGRICULTURE
PROPOSED PUBLIC/PRIVATE DEVELOPMENT
DATE: 1/24/07 SHEET NO. 19 OF 23

2007-20-613

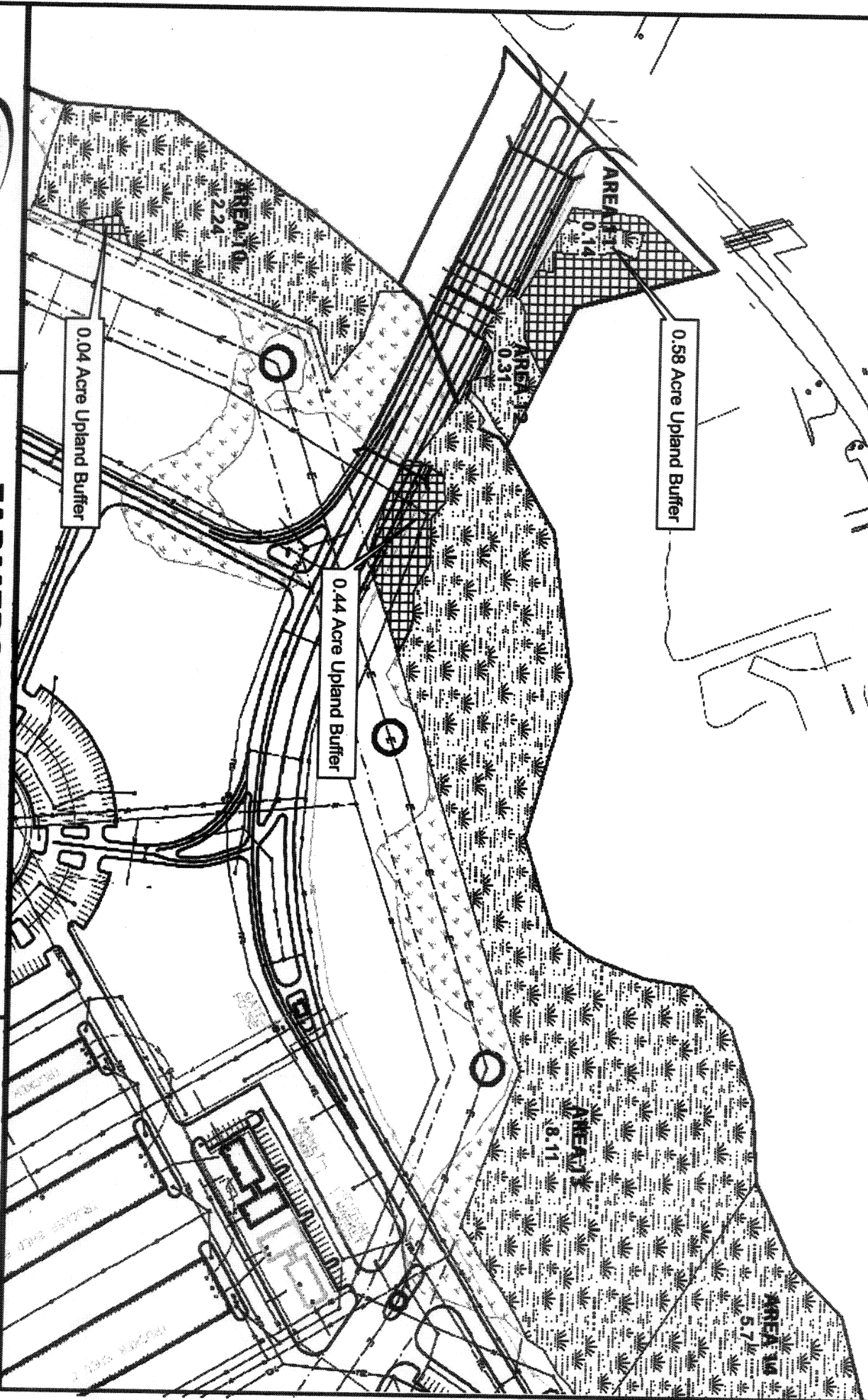

0.58 Acre Upland Buffer

0.44 Acre Upland Buffer

0.04 Acre Upland Buffer

FARMERS MARKET SITE
 PROPOSED DEVELOPMENT - MITIGATION PACKAGE



RICHLAND COUNTY, SOUTH CAROLINA
 33° 56' 13" N, 80° 56' 46" W
 APPLICATION BY SOUTH CAROLINA
 DEPARTMENT OF AGRICULTURE
 PROPOSED PUBLIC/PRIVATE DEVELOPMENT
 DATE: 1/24/07 SHEET NO. 30 OF 33

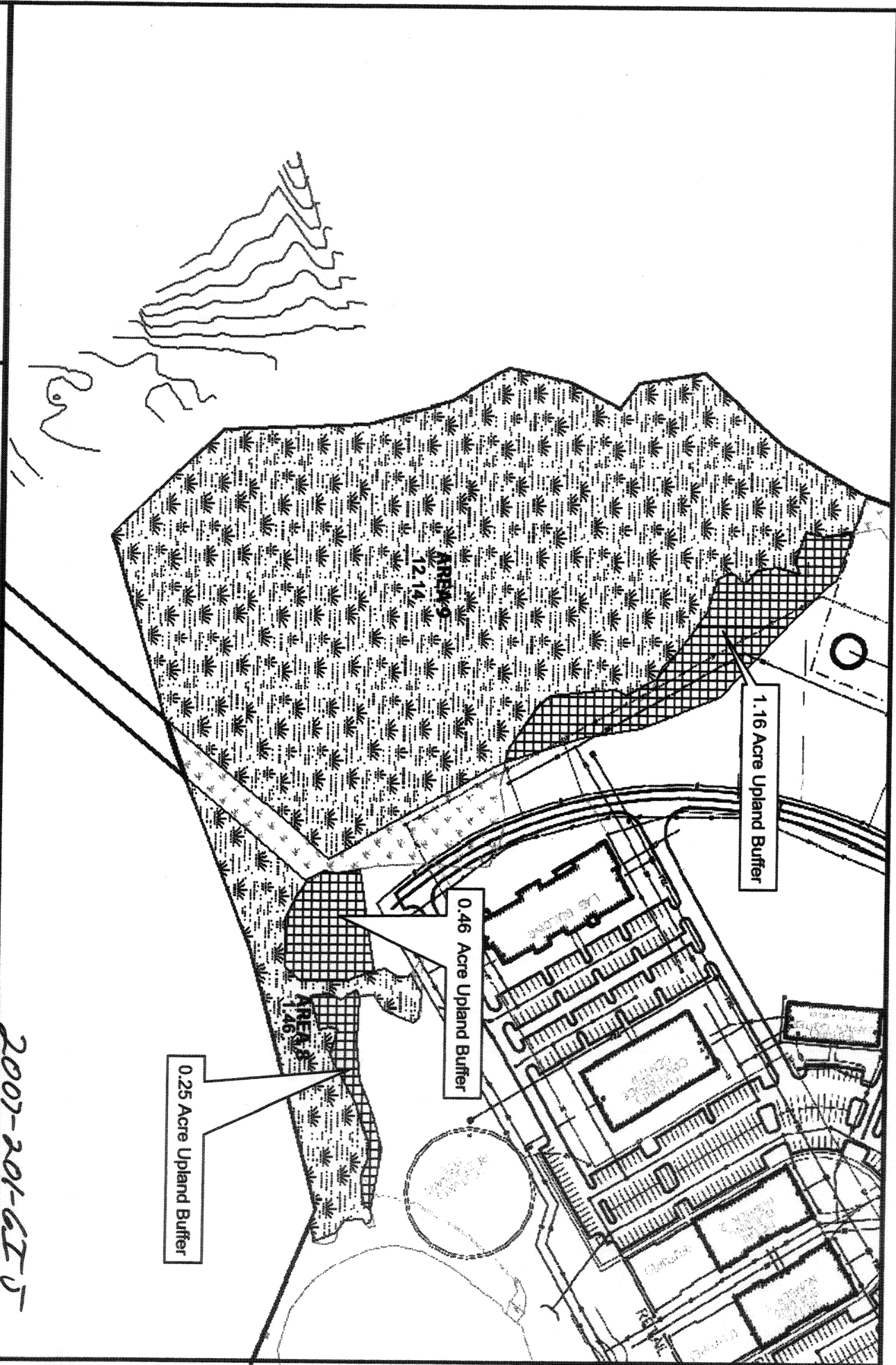

FARMERS MARKET SITE
 PROPOSED DEVELOPMENT - MITIGATION PACKAGE



2007-201-GT-5

RICHLAND COUNTY, SOUTH CAROLINA
 33° 56' 13" N, 80° 56' 46" W
 APPLICATION BY SOUTH CAROLINA
 DEPARTMENT OF AGRICULTURE
 PROPOSED PUBLIC/PRIVATE DEVELOPMENT
 DATE: 1/24/07 SHEET NO. 31 OF 33

2007-20-615

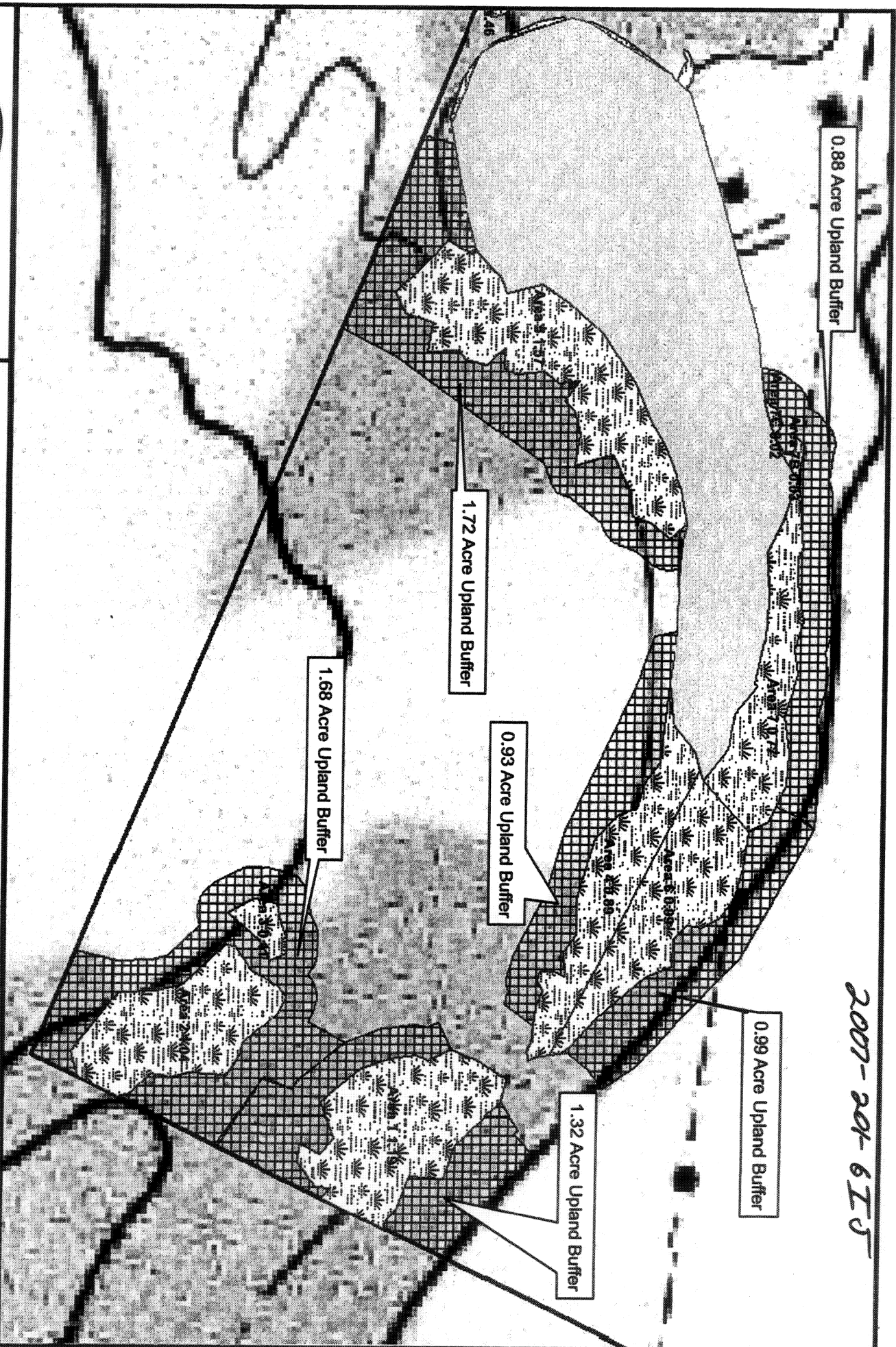

0.88 Acre Upland Buffer

1.72 Acre Upland Buffer

0.93 Acre Upland Buffer

1.68 Acre Upland Buffer

1.32 Acre Upland Buffer

0.99 Acre Upland Buffer



FARMERS MARKET SITE
PROPOSED DEVELOPMENT - MITIGATION PACKAGE

0 100 200 400 Feet

1 inch equals 200 feet

RICHLAND COUNTY, SOUTH CAROLINA
33° 56' 13" N, 80° 56' 46" W
APPLICATION BY SOUTH CAROLINA
DEPARTMENT OF AGRICULTURE
PROPOSED PUBLIC/PRIVATE DEVELOPMENT
DATE: 1/24/07 SHEET NO. 32 OF 33

2007-201-615

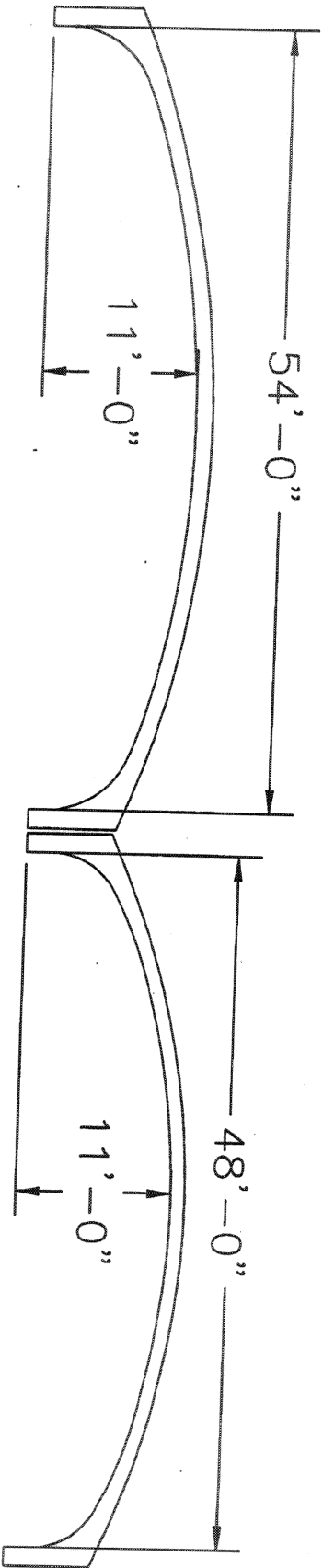

FARMERS MARKET SITE

PROPOSED DEVELOPMENT
PERMIT PACKAGE

BRIDGE SPANS

RICHLAND COUNTY, SOUTH CAROLINA
33° 56' 13" N, 80° 56' 46" W
APPLICATION BY SOUTH CAROLINA
DEPARTMENT OF AGRICULTURE
PROPOSED PUBLIC/PRIVATE DEVELOPMENT
DATE: 1/24/07 SHEET NO. 33 OF 33