

GENERAL INFORMATION

The Government property line is currently monumented in its permanent location, except in isolated cases where land exchanges, acquisitions or disposals would alter the property line location. Permanent survey markers are located at all property corners except where they have been destroyed by construction or vandalism. The maintenance survey effort accomplished around the lake involves replacing missing property corners, and periodically repainting the red lines on the reference trees. The red marked reference trees aid both project personnel and adjacent land owners in locating the property line on long tangents where neither property corner marking the end of the tangent can be easily viewed. **A source of misunderstanding concerning the Government property line occurs when one assumes that the painted line reference trees are the exact property line.** Witness trees are located within 3 to 4 from the actual property lines in most instances. These trees are painted to alert the observer that a property line is nearby. There are also signs placed on some painted trees stating United States Army Engineer District, Mobile — Boundary Line Nearby or United States Army Engineer District, Mobile — Easement Line. If activities require knowing exactly where the line is, the Operations Manager's Office may be contacted, and a Park Ranger can meet with the person(s) on site, or a private registered land surveyor should be contracted. Since these painted trees are not on the exact property line, remarking may give the appearance to an adjacent property owner that the line has been moved when, in fact, it may only indicate that a different tree was painted.

INTRODUCTION

Carters Lake is managed by the U.S. Army Corps of Engineers as a part of the Mobile District within the Corps South Atlantic Division. The authorized purposes of Carters are: flood control, hydroelectric power generation, natural resource management and recreation. Carters Lake is comprised of 5,000 acres of fee owned land and 3,220 acres of water. Carters Lake is a popular lake resulting in an ever increasing demand each year on its resources by the public. The popularity of Carters Lake is growing and good management is necessary to protect the environment and provide quality recreational opportunities for present and future generations. The U.S. Army Corps of Engineers manages the project to ensure that there is a balance between the recreation user, the environment, and the conservation of the projects resources. The entire Carters Lake project is encompassed within marked boundary lines which identify the approximate location where the government property line is located.

The U.S. Army Corps of Engineers requests the assistance of adjacent private property owners in preventing encroachments on public land around Carters Lake. To assist in identifying public land at Carters, an extensive boundary maintenance program exists which includes the brushing out and periodic painting of the boundary line.

QUESTIONS

If you have questions about the location of the boundary line and/or information relating to the Government's fee or easement boundaries, contact the Carters Lake Office: (706) 334-2248. A field appointment with a Corps Ranger can be scheduled to answer any questions you may have concerning private property and Government property boundary lines.



US Army Corps
of Engineers
South Atlantic Division

For more information, please contact:

U.S. Army Corps of Engineers
Carters Project
P.O. Box 96
Oakman, GA 30732
Phone (706) 334-2248
<http://carters.sam.usace.army.mil/>

May 2005



US Army Corps
of Engineers
Mobile District

Carters Lake

BOUNDARY LINE MARKINGS AND PERMITTED USES OF PUBLIC LAND

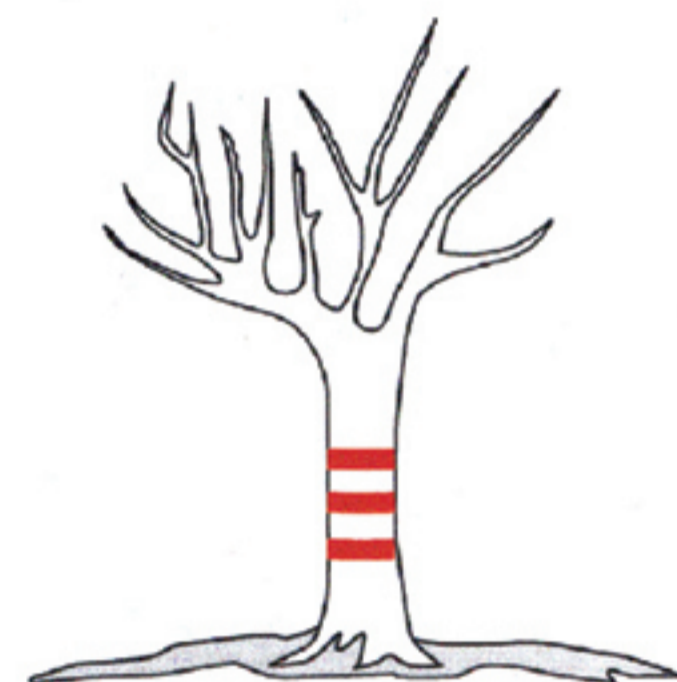
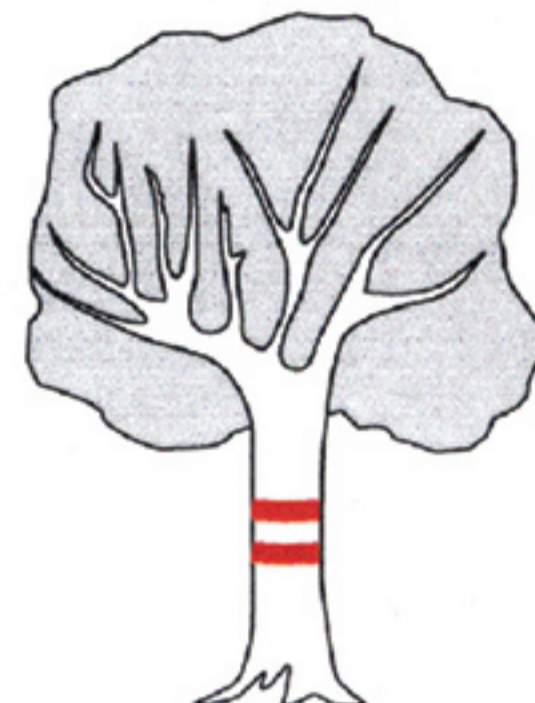

BOUNDARY LINE WITNESS MARKINGS

Painting the boundary line actually means painting witness trees near the line. At Carters Lake, red paint is used to mark witness trees along the fee boundary. Drawings 1 and 2 illustrate the different types of markings you can see around Carters Lake and describe their meanings.

1. CORNER WITNESS TREE

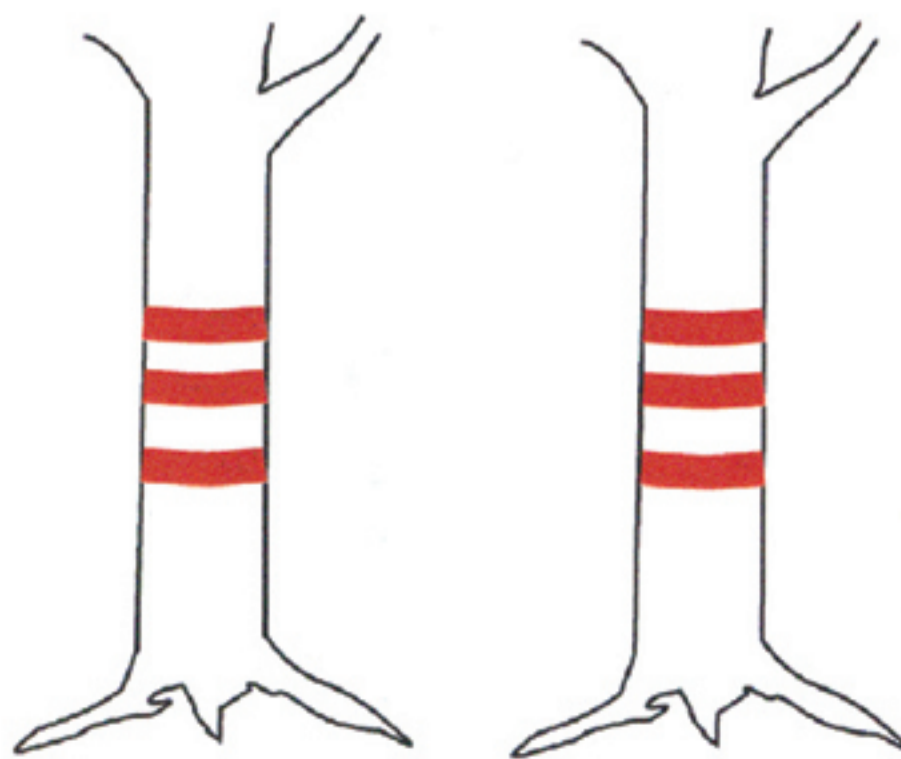
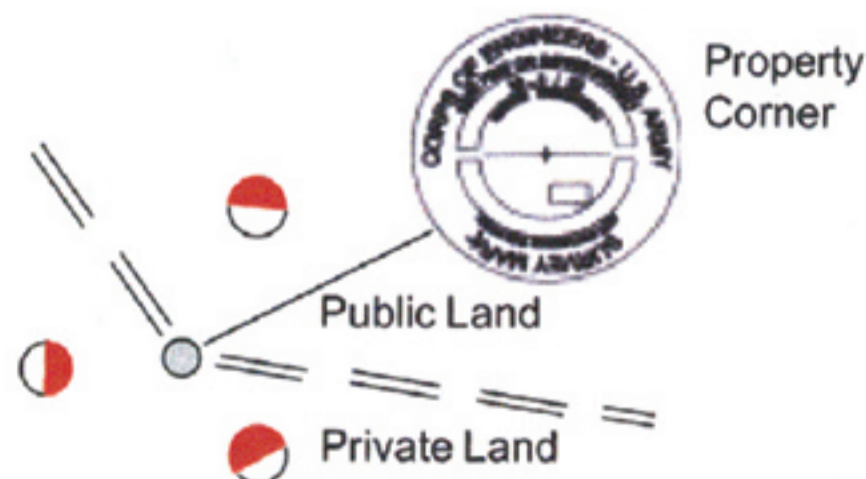

Front View

Side View

Tree is painted with three horizontal lines that encircle the trunk.

2. LINE WITNESS TREE (example)

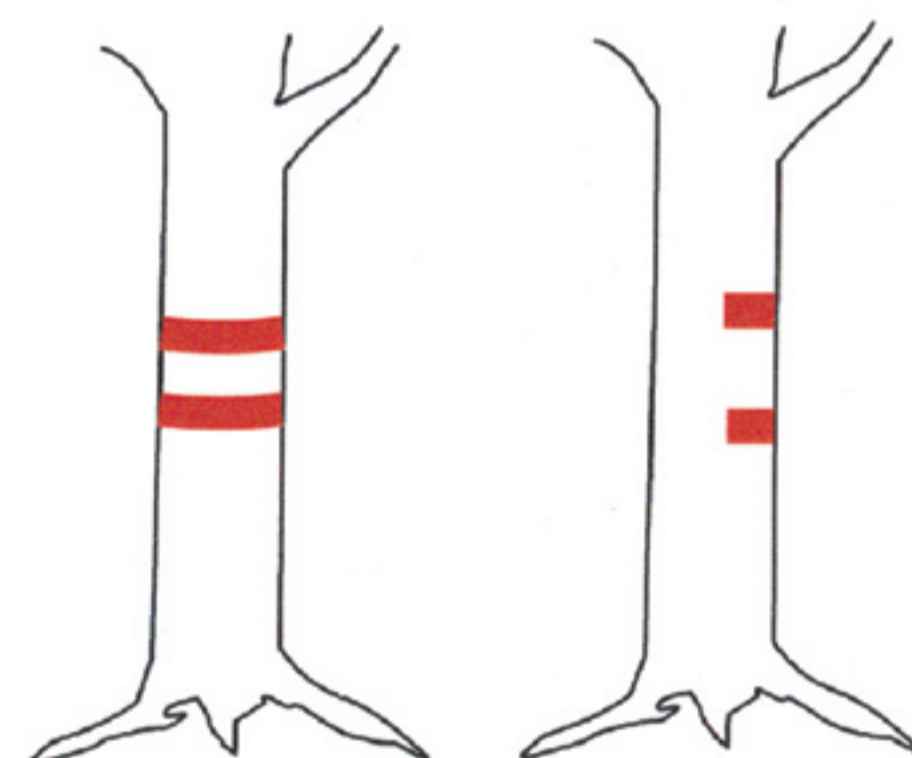

Front View

Side View

The most common witness tree has two horizontal lines that face the boundary line.

PERMITTED PRIVATE USE

Carters Lake does not authorize or permit any private boat docks or structures along its entire sixty-two miles of shoreline. The cutting of vegetative growth, trees, or parts of trees without written permission by the Site Manager or the destruction, injury, defacement or any alteration of public of public lands is a violation of Title 36, Part 327, US Code of Regulation.