

FEMA-1549-DR, Alabama

Imagery Derived Assessment - Washington, AL as of 9/19/2004

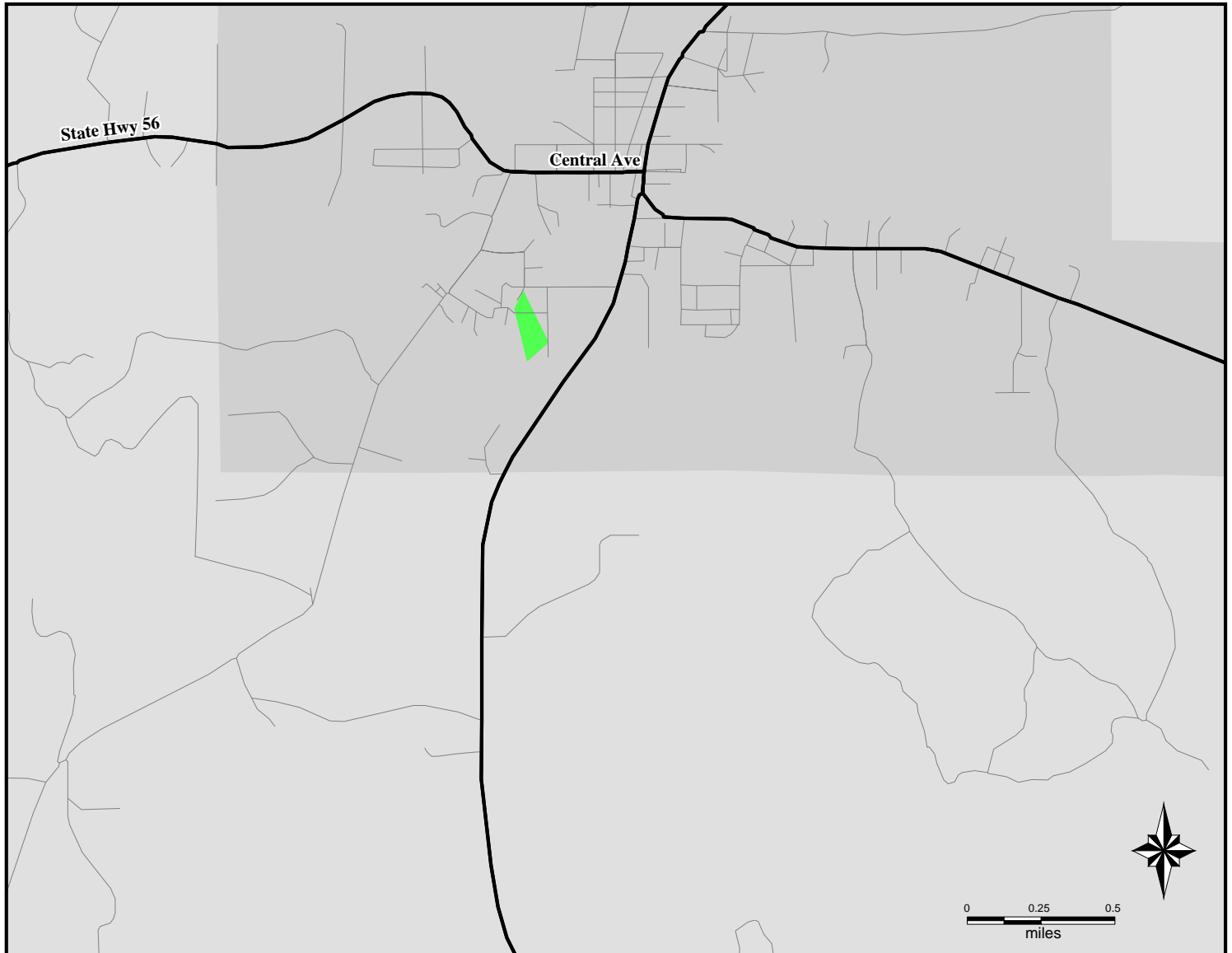

Location Map



Legend

Limited Damage

Estimated Number in Damage Area:

Population:

Housing Units:

LD: 2

LD: 1

LIMITED DAMAGE: Generally superficial damage to solid structures (e.g., loss of tiles or roof shingles); some mobile homes and light structures are damaged or displaced.

MODERATE DAMAGE: Solid structures sustain exterior damage (e.g., missing roofs or roof segments); some mobile homes and light structures are destroyed, many are damaged or displaced.

EXTENSIVE DAMAGE: Some solid structures are destroyed; most sustain exterior and interior damage (e.g., roofs missing, interior walls exposed), most mobile homes and light structures are destroyed.

CATASTROPHIC DAMAGE: Most solid and all light or mobile structures destroyed.



FEMA

ITS Mapping and Analysis Center

Washington, DC

9/20/2004 -- 03:30:01 EDT