



# How to Make a FIRMeTte Using Map Search

<http://msc.fema.gov>

**Map Search allows users to view and select a flood map panel geographically. A specific flood map panel or an area of interest can be located by typing in a street address or by using the interactive map. Follow the steps below:**

**Step 1: Click Map Search.**

**Step 2: Select the product you wish to view or order. (Public Flood Map for this example)**

**Step 3: Click Address, type in the address of interest and press the Go button.**

Map Item ID	Description	Effective Date	Show LOMC	View	Buy
245208030D	PRINCE GEORGES CO*	03/06/1996			

**Step 4: A new window will appear with the results. Click the Buy box to order the product or click the View or Create a FIRMeTte.**

**Step 5: A new window will appear displaying the image. Click the Make a FIRMeTte button.\***

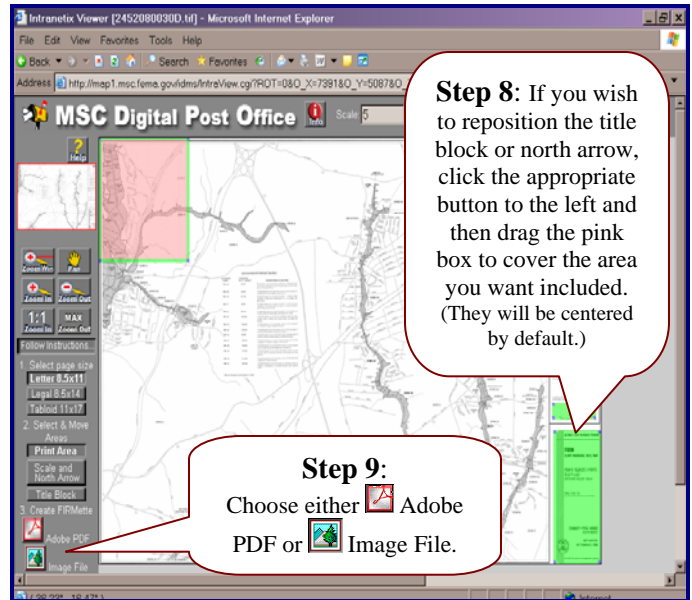
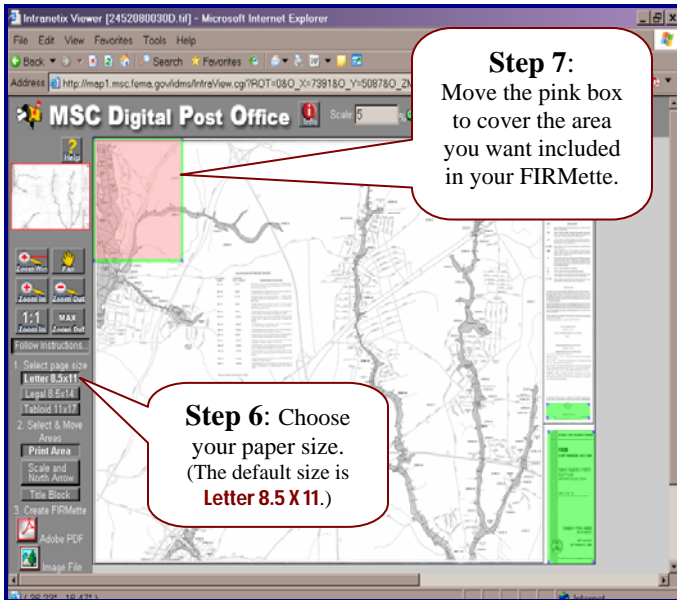

\* Note: If you have used the Zoom In feature, then click the MAX Zoom Out button before you click "Make a FIRMette" button.

