



DVH 0111

DATE OF REGISTRATION/PUBLICATION

Nov. 14, 2002

Month Day Year

DO NOT WRITE ABOVE THIS LINE. IF YOU NEED MORE SPACE, USE A SEPARATE CONTINUATION SHEET. (Form D-VH/CON)

**1** Please give the make and model of the vessel that embodies the design.

265 Cruiser

**TITLE**

**2 (a)** What is the type or style of the design for which registration is sought?

Cuddy Cabin

**DESIGN (b)** Provide a brief general statement setting forth the salient features of the design.

Overall appearance including deck layout, hull configuration and shape.

Check here if this is a single design.

Check here if registering more than one design. Use Form D-VH/CON for additional designs.

**(c)** If this design is derived from an earlier design, describe how that design has been revised, adapted, or rearranged.

N/A

**3** Provide the name and address of the designer(s). The name of the employer may be given instead of the designer(s) if, (1) the design was made within the regular scope of employment of the designer(s) and (2) the individual authorship of the design is difficult or impossible to ascribe.

Please check here if those conditions are satisfied and you are providing the employer's name.

Name: Monterey: Seabring Marine, Inc. Name: Designed by Monterey design team including Anthony Kalil, Jeff & Chuddy Marshall, with the help of Marine Concepts' designers & engineers.  
 Address: 1579 SW 18th Street Address: Williston, FL 32696

**4** If the owner is different from the designer(s) or employer named above, provide the name and address of the owner:

Name: Above

Address:

**OWNER, IF NOT DESIGNER(S)**

**5 (a)** Was an application for registration of this design identified in an application filed in a foreign country that extends to designs of owners who are citizens of the United States, or to persons filing applications in the United States, similar protection to that afforded in 17 U.S.C. chapter 13? **(b)** If yes, identify the country and date of application:

Yes  No

Country: \_\_\_\_\_

Date of application: \_\_\_\_\_

Serial No: \_\_\_\_\_

**6** Was this design made public before the date of application?  Yes  No

If yes, on what date? August 21 2002  
 Month Day Year

**DATE MADE PUBLIC**

DO NOT WRITE HERE OFFICE USE ONLY

APPLICATION RECEIVED SEP 24 2002  
 DESIGN COPIES RECEIVED SEP 24 2002  
 FUNDS RECEIVED NOV 08 2002



DVH 0111

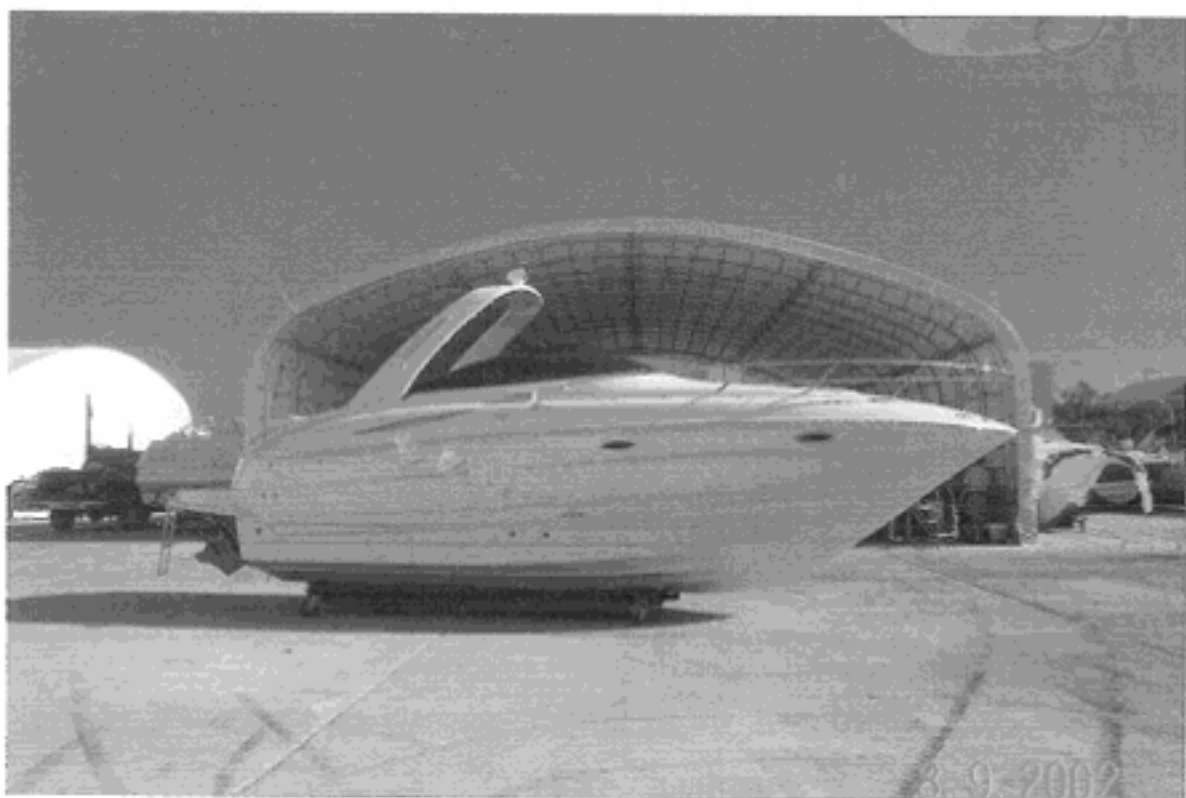



LIBRARY OF CONGRESS  
SEP 24 2002  
CR. 0111.1111

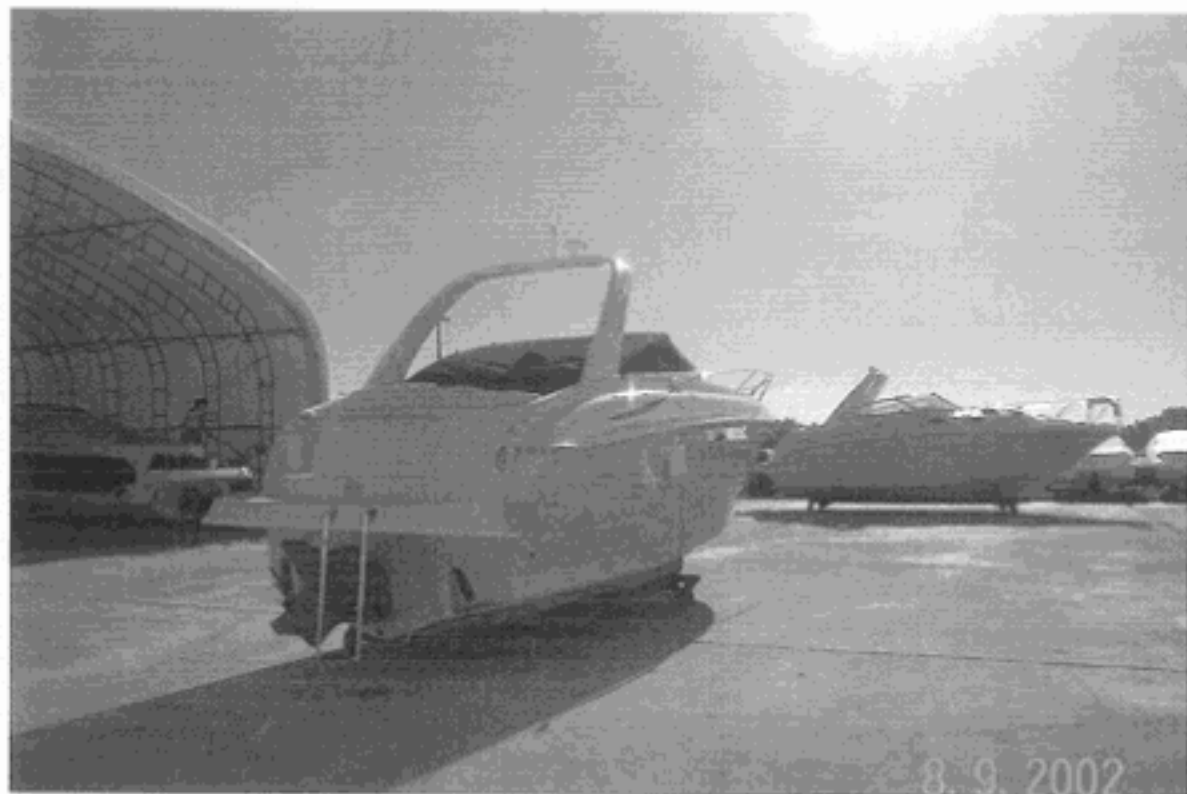

# Monterey 265 Cruiser

DVH 0111

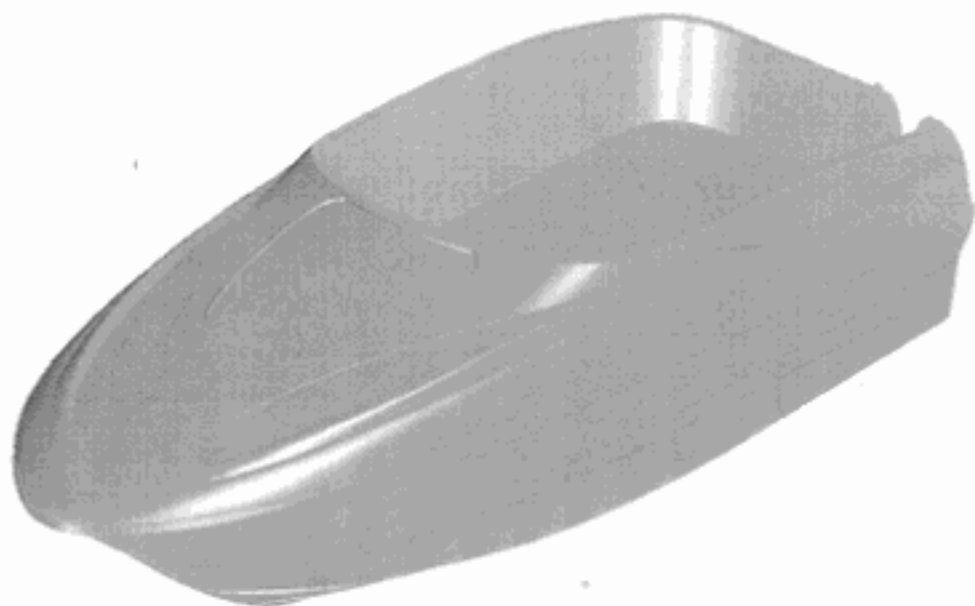
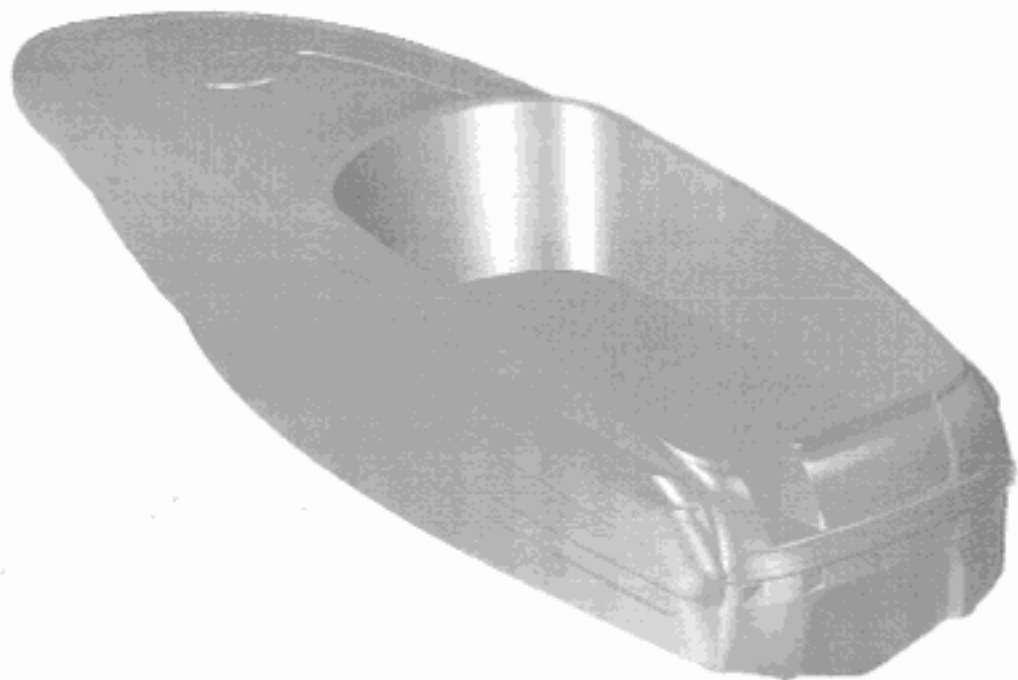

# Monterey 265 Cruiser

DVH 0111

