



REGISTRATION NUMBER

DVH 0014/4

DATE OF REGISTRATION/PUBLICATION

May 19, 2000

CONTINUATION SHEET RECEIVED

Mar. 7, 2000

DO NOT WRITE ABOVE THIS LINE. FOR COPYRIGHT OFFICE USE ONLY.

Check here, if using for multiple designs: Fill in Space A **ONLY** with new information regarding additional designs. All other information must be identical to the information on the corresponding Form D-VH. Use an additional Form D-VH/CON for each design included in the registration.
Design 4 of 4 designs.

Check here, if you are using the continuation sheet for supplemental information regarding the original design.

Identification
of
Application

IDENTIFICATION OF CONTINUATION SHEET: This is a continuation of the application for copyright registration on Form D-VH. Identify the title of the work as it appears in **Space 1** (i.e., make and model of the vessel) of Form D-VH:

TH192 / 194 / 220 / 224 Lowe Tahiti Deck Boat

A

(2a) What is the type or style of the design for which registration is sought?

aluminum all-welded deck boat

Continuation of
Space 2

(2b) Provide a brief general statement setting forth the salient features of the design.

19' hull with variable deadrise from 10° at transom to 15° at front of running surface with 6" variable chine; deck layout differs from design 1 of 4, design 2 of 4, and design 3 of 4, as shown.

(2c) If this design is derived from an earlier design, explain how that design has been revised, adapted, or rearranged.

n/a

TH192 (Y2K)

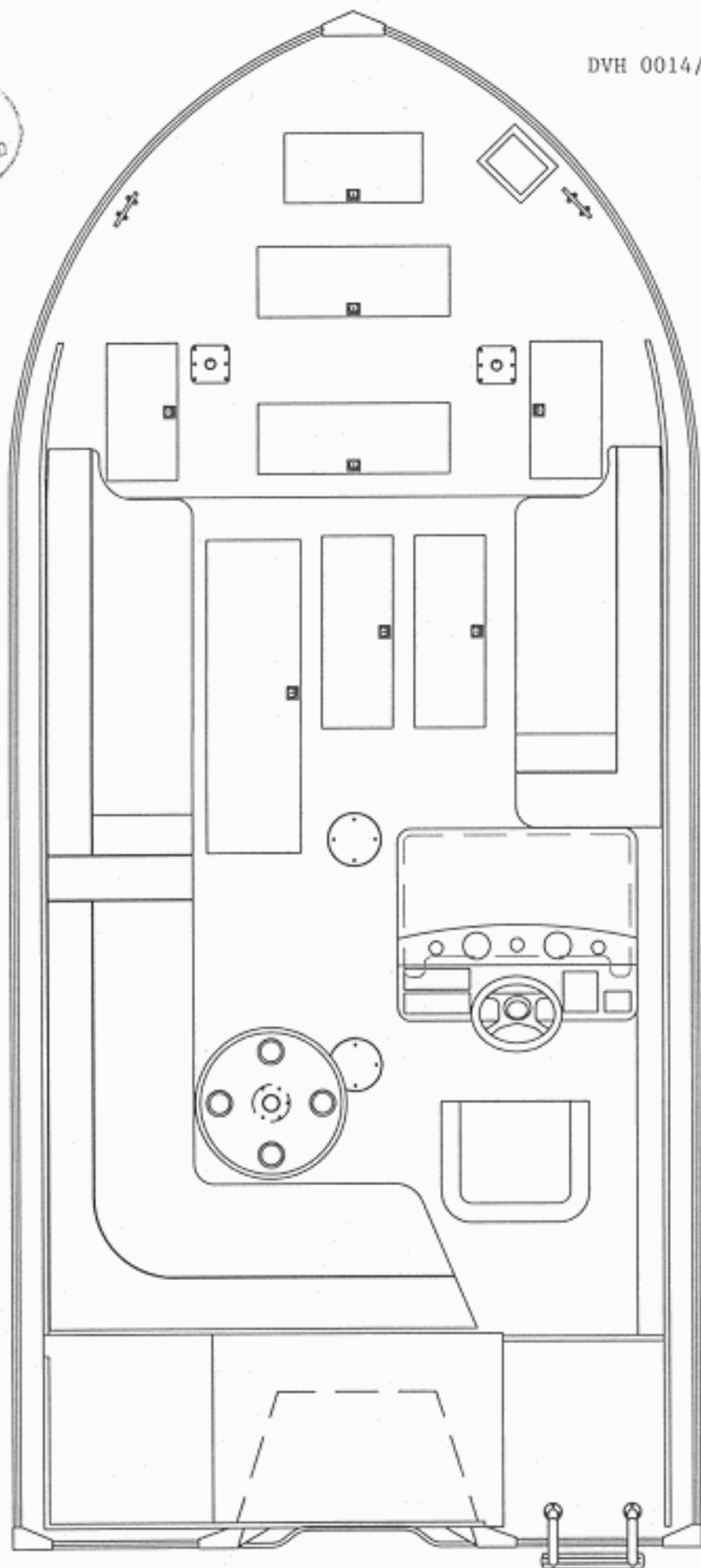

LIBRARY OF CONGRESS
MAR 07 2000
COPYRIGHT OFFICE