

2009 Kentucky Fruit and Vegetable Conference and Trade Show

JANUARY 5-6, 2009

Monday and Tuesday

Kentucky State Horticulture Society
153rd Annual Meeting

Kentucky Vegetable Growers Association
38th Annual Meeting

Kentucky Farmers' Market Association
3rd Annual Meeting

The Kentucky Grape and Wine Short Course

*In cooperation with:
University of Kentucky
College of Agriculture
Kentucky State University
Kentucky Department of Agriculture*

Meeting Place:
Embassy Suites Hotel
1801 Newtown Pike
Lexington, Kentucky 40511
(859) 455-5000
FAX (859) 455-5122
Reservations: 800-EMBASSY

Dear Kentucky Fruit and Vegetable Grower:

The 2009 Fruit and Vegetable Conference and Trade Show will again be at the Embassy Suites Hotel, Lexington, KY, Monday and Tuesday, January 5 and 6, 2009. Highlights of this year's meeting will be a pre-conference Excel Spread Sheet Training, a Pesticide Certification Training and sessions on Farmers' Markets, Commercial Fruit and Vegetable Production, Small Fruit Production, Organic Farming and Gardening, the Grape and Wine Short Course, Winemaking, Marketing, Cucurbit Production and Greenhouse Management.

Special out-of-state speakers include: Dr. Robert Klein, Extension Cropping Systems Specialist, West Central Research & Extension Center, North Platte, NE; Dr. Ron Morse, Vegetable Crops Research, Virginia Tech, Blacksburg, VA; Dr. Ric Weinzierl, Extension Entomologist, University of Illinois, Urbana, IL; Dr. Maurus Brown, Viticulturist, Ohio State University South Centers, Piketon, OH; Dr. Joe Masabni, Extension Vegetable Specialist, Texas A & M University, College Station, TX; Dr. Annette Wszelaki, Commercial Vegetable Production Specialist, Department of Plant and Soil Science, University of Tennessee, Knoxville, TN; Tammy Algood, Extension Food Marketing Specialist, University of Tennessee, Nashville, TN; George Killgore, Extension Director, University of Tennessee Extension - Davidson County, Nashville, TN; and Dr. Dave Lockwood, Extension Fruit Specialist, University of Tennessee, Knoxville, TN.

The KVS will have an optional Celebration of Kentucky Wines featuring Kentucky wines prior to the banquet. Dr. Gary Palmer, Assistant Director for Agriculture and Natural Resources, UK College of Agriculture, Lexington, KY will speak on the College of Agriculture Vision for the Future and we will be entertained by the Pickin Time Bluegrass Band at the banquet.

We will have a Trading Post bulletin board to sell used equipment. If you are looking for equipment buyers, bring along a description containing your name, phone number and the equipment price.

PLEASE make your room reservations directly with the hotel. Our block of rooms will be held until Jan. 1, 2009. **Be sure to let the hotel know that you will be staying for the Kentucky Fruit and Vegetable Conference** to obtain our special suite room rate (they are all suites) of \$109.00. This includes an evening managers reception with drinks and a full cooked-to-order breakfast daily. We encourage growers to stay at Embassy Suites Hotel to support meeting overhead expenses.

The \$30 meeting registration fee includes a year's membership in the KVGA or KSHS and entrance into the Grape & Wine Short Course. Membership in the KVGA also allows growers to use pesticides that have received 24c registrations for Kentucky. Please see the registration form to become a member of the Kentucky Vineyard Society and to sign up for the meal functions and the Celebration of Kentucky Wines.

The enclosed registration form enables you to register in advance so your tickets and name tags will be ready for you when you arrive at the meeting. NOTE: WE STRONGLY URGE YOU TO PRE-REGISTER. BANQUET AND LUNCHEON TICKETS CAN ONLY BE PURCHASED BY ADVANCE REGISTRATION. NAME BADGES WILL BE REQUIRED TO ENTER MEETING ROOMS. PRE-REGISTRATION FORMS NEED TO BE IN OUR HANDS BY FRIDAY DECEMBER 19, 2008. If you would like to serve on the KVGA or KSHS boards of directors or would like to nominate another member, please designate this on your registration sheet.

If circumstances are such that you cannot attend the meeting, please complete and return the form to Ms. Mary Ann Kelley, Research & Education Center, P.O. Box 469, Princeton, KY 42445 to continue your association membership.

Sincerely,

Robert Stone, President
KY Vegetable Growers Association

Maurice Fegenbush, President
KY State Horticultural Society

**KENTUCKY STATE HORTICULTURAL
SOCIETY OFFICERS**

President: Maurice Fegenbush, Bloomfield

Vice-Presidents: Ray Armstrong, Shepherdsville
Jeremy Hinton, Hodgenville
Tim McClure, Frankfort
Cal Blake, Lexington
Kevan Evans, Georgetown
Linda Ison, Crestwood
Billy Reid, Owensboro
Don Haney, Nancy
Paul Tokosh, Pleasureville
Bill Jackson, Bowling Green
Julie Lovell, Hopkinsville
Jim Moore, Bowling Green

President Elect: Larry Ayres, Owenton

Secretary: Doug Archbold, Lexington

Treasurer: Cindy Peake, Mt. Sterling

Advisors: Rick Durham, Lexington
Ed Fackler, New Salisbury, IN
Kirk Pomper, Frankfort
John Strang, Lexington

**KENTUCKY VEGETABLE GROWERS
ASSOCIATION OFFICERS**

President: Robert Stone, Paris

Vice-President: Butch Case, Cynthiana

Secretary: Beth Wilson, Nancy

Treasurer: Jim Kirby, Winchester

Directors: Larry Snell, Elizabethtown
Kevin Trunnel, Utica
Joel Wilson, Nancy
John Bell, Georgetown
Judi Blake, Lexington
Bill Holleran, Jr., Lexington
Brent Lackey, Somerset
Zeldon Angel, Winchester
Annette Meyer-Heisdorffer, Owensboro
C. A. Pantle, Jr., Owensboro
Linda McMaine, Salvisa

Advisors: Tim Coolong, Lexington
Terry Jones, Quicksand
Mac Stone, Frankfort
John Strang, Lexington

**KENTUCKY VINEYARD SOCIETY
ASSOCIATION OFFICERS**

President: Chuck Smith, New Castle

Vice-President: Zane Burton, Somerset

Secretary: Chad Peach, Frankfort

Treasurer: Harkey Edwards, Lexington

Executive Asst: Patachia Fisher, Stanford

Directors: Jim Hatchett, Springfield
Bob Karsner, Willisburg
Bruce Kunze, Utica
Lowell Land, Richmond
Dave Loney, Mays Lick
Ed Singleton, Waynesburg
Dennis Walter, Melbourne

Advisors: Chris Smigell, Lexington

Meeting Outline

Sunday, January 4

Room

4:00-6:00 p.m.	Pre-conference Excel Spread Sheet Training	Coldstream 2
6:00-8:00 p.m.	Preconference Reception and Kentucky Farmers' Market Association Annual Meeting	Coldstream 4 & 5
7:00-9:00 p.m.	Exhibitor Set-up	
7:30-9:30 p.m.	Preconference Fruit Round Table Discussion	Bourbon

Monday, January 5

8:00 a.m.	Exhibits Open	
8:50 a.m.	<u>Concurrent Sessions</u>	
	KSHS-KVGA Joint Session	Coldstream 3
	Pesticide Certification Training.....	Bourbon
10:30 a.m.	Break	
Noon	Exhibitors & Growers Luncheon	Coldstream 1 & 2
1:30 p.m.	<u>Concurrent Sessions</u>	
	Winemaking	Coldstream 1 & 2
	Vegetable Production	Coldstream 3
	Farmers' Markets	Coldstream 4
	Commercial Tree Fruit Production	Coldstream 5
2:30 p.m.	Break	
5:15 p.m.	Exhibits Close	
5:30 p.m.	Celebration of Kentucky Wines	Coldstream 1 & 2
6:30 p.m.	Banquet	Coldstream 3

Tuesday, January 6

8:00 a.m.	Exhibits Open	
8:30 a.m.	<u>Concurrent Sessions</u>	
	Grape & Wine Short Course	Coldstream 1 & 2
	Vegetable Production	Coldstream 3
	Marketing	Coldstream 4
	Tree Fruit	Coldstream 5
	Small Fruit Production	Bourbon
10:00 a.m.	Break	
11:40 a.m.	Lunch on Your Own	
1:30 p.m.	<u>Concurrent Sessions</u>	
	Grape & Wine Short Course	Coldstream 1 & 2
	Cucurbit Production	Coldstream 3
	Organic Farming and Gardening.....	Coldstream 4
	Greenhouse Management	Coldstream 5
2:30 p.m.	Break	
3:00 p.m.	Exhibit Hall Closes	

All Times Are Eastern Standard Time

SUNDAY, JANUARY 4

- 4:00 - 6:00 p.m. **PRECONFERENCE EXCEL SPREADSHEET TRAINING**
Coldstream 2 Room, Nathan Routt, Conducting Training
- 6:00 p.m. **PRECONFERENCE RECEPTION AND KENTUCKY FARMERS'
MARKET ASSOCIATION ANNUAL MEETING**
Coldstream 5 Room, Janet Eaton, Presiding
- 7:00-10:00 p.m. **Exhibitor Set-up -- Pre-Function Area & Lower Atrium**
- 7:30-9:00 p.m. **PRECONFERENCE FRUIT ROUND TABLE DISCUSSION**
Bourbon Room, John Strang, Presiding

MONDAY, JANUARY 5

- 8:00 a.m. Exhibits Open, Pre-Function & Lower Atrium Areas
- 8:00 a.m. Registration, Pre-Function area outside meeting rooms
Meeting registration plus one-year membership in either the Kentucky Vegetable Growers Association or Kentucky State Horticultural Society is \$30.00. Please see the registration form for Kentucky Vineyard Society registration.

(1) KSHS - KVGA JOINT SESSION

Coldstream 3 Room

Maurice Fegenbush, Presiding

- 8:50 a.m. Welcome - Robert Stone
- 9:00 a.m. Horticulture Council Update
- *Dewayne Ingram, Tim Coolong & John Strang*
- 9:15 a.m. Kentucky Department of Agriculture Produce
Marketing Update - *Mac Stone*
- 9:30 a.m. Innovative Uses of Cover Crops for Production
of Vegetable and Fruit Crops - *Ron Morse*
- 10:30 a.m. Cider/Coffee Break and Visit Exhibits
Pre-Function and Lower Atrium Areas
- 11:00 a.m. Product Liability Insurance for Roadside and
Farmers' Markets - *Shirley West*
- 11:15 a.m. Improving Pesticide Efficacy While Managing
Boom Sprayer Spray Drift - *Robert Klein*
- 11:45 a.m. Acquiring H2A Workers - *Rick Alexander*

(2) PESTICIDE CERTIFICATION TRAINING FOR PRIVATE APPLICATORS

Bourbon Room

Lee Townsend, Presiding

- 9:00 a.m. Pesticide Certification Training
(Participants will obtain a private
applicator license) - *Lee Townsend*
- 9:30 a.m. Continued
- 10:00 a.m. Continued
- 10:30 a.m. Cider/Coffee Break and Visit Exhibits
- Pre-Function and Lower Atrium Areas
- 11:00 a.m. Continued

10:00 a.m. **KENTUCKY GRAPE & WINE COUNCIL MEETING** - Georgetown Room

12:00 noon **EXHIBITORS AND GROWERS LUNCHEON** - Coldstream 1 & 2 Rooms

12:00 noon. **KVGA AND KSHS BOARD MEETINGS**

Kentucky State Horticultural Society - Paris Room

Kentucky Vegetable Growers Association - Georgetown Room

Board members should pick up their lunch at the buffet in Coldstream 1 & 2 and then meet in the designated room at the top of the stairs located over the meeting rooms.

CONCURRENT SESSIONS

Concurrent sessions will enable participants to attend topics of interest in different sessions.

MONDAY AFTERNOON, JANUARY 5

(3) WINEMAKING

*Coldstream 1 & 2 Rooms
Patsy Wilson, Presiding*

- 1:30 p.m. Key Steps in Making Wine
- *Tom Cottrell*
- 2:00 p.m. Red Grape and Berry Wines
- *Tom Cottrell*
- 2:30-3:10 Cider/Coffee Break and Visit Exhibits
- Pre-Function and Lower Atrium Areas
- 3:10 p.m. UPC Codes Clarified
- *Steve Arens*
- 3:40 p.m. Samples of Kentucky Varietal Wines
- *Tom Cottrell*

(4) VEGETABLE PRODUCTION

*Coldstream 3 Room
Bonnie Sigmon, Presiding*

- 1:30 p.m. Sweet Corn Diseases
- *Kenny Seebold*
- 2:00 p.m. Vegetable Cultivar Trial Results
[Staked Tomatoes, Onions, Specialty Peppers,
Specialty Melons and Romaine Lettuce]
- *Amy Poston, Crystal Sparks, Chris Smigell
and Dave Spalding*
- 2:30-3:10 Cider/Coffee Break and Visit Exhibits
- Pre-Function and Lower Atrium Areas
- 3:10 p.m. Pumpkin Variety Trial Results
- *Annette Wszelaki*
- 3:40 p.m. Boom Sprayer Calibration and Nozzle Tip
Selection - *Robert Klein*
- 4:10 p.m. Continued

MONDAY EVENING, JANUARY 7

5:15 p.m. **Exhibits Close**

5:30 p.m. **CELEBRATION OF KENTUCKY WINES**
Featuring the Evaluation of Commercial Kentucky Products
- *Coldstream 1 & 2 Rooms*
Sponsored by the KVS (The cost is \$10.00 for the tasting.)

6:30 p.m. **BANQUET**, Coldstream 3 Room
Maurice Fegenbush, Presiding

Speaker: *The College of Agriculture Extension Vision for the Future.*

Gary Palmer, Assistant Director for Agriculture and Natural Resources, Cooperative Extension Service, U.K. College of Agriculture

Entertainment: *Pickin Time Bluegrass Band*
Pam and Wes Maynard and John Mattingly

CONCURRENT SESSIONS

Concurrent sessions will enable participants to attend topics of interest in different sessions.

MONDAY AFTERNOON, JANUARY 5

(5) FARMERS' MARKETS

*Coldstream 4 Room
Janet Eaton, Presiding*

- 1:30 p.m. EBT & Debit Technology
- *Janet Eaton*
- 2:00 p.m. Wildlife Control - Racoons, Deer and Birds
- *Tom Barnes*
- 2:30-3:10 Cider/Coffee Break and Visit Exhibits
- Pre-Function and Lower Atrium Areas
(Questions about Farmers' Markets for
Extension Agents - *Jessica Hinkle*)
- 3:10 p.m. Innovative Equipment for Small Farmers
- *John Wilhoit*
- 3:40 p.m. Starting a New Farmers' Market
- *Sarah Fritschner, Russ Meredith,
and Bob Callander*
- 4:10 p.m. Successful Promotion of a Farmers' Market
- *Sarah Fritschner, Russ Meredith,
and Bob Callander*

(6) COMMERCIAL TREE FRUIT PRODUCTION

*Coldstream 5 Room
Dwight Wolfe, Presiding*

- 1:30 p.m. Improving Pesticide Efficacy while Managing
Boom Sprayer Spray Drift (Continued)
- *Robert Klein*
- 2:00 p.m. Peach Variety Evaluations
- *Joe Masabni*
- 2:30-3:10 Cider/Coffee Break and Visit Exhibits
- Pre-Function and Lower Atrium Areas
- 3:10 p.m. Preplant Fertilizer Recommendations for Tree
Fruit and Grapes - *Dave Lockwood*
- 3:40 p.m. Pheromone Trapping and Phenology models
for Tree Fruit Insects
- *Rick Weinzierl*
- 4:10 p.m. Tree Fruit Flowering
- *John Strang*

MONDAY EVENING, JANUARY 7

- 5:15 p.m. **Exhibits Close**

Concurrent Sessions

Concurrent sessions will enable participants to attend topics of interest in different sessions.

TUESDAY MORNING, JANUARY 6

8:00 a.m. Exhibits Open, Lobby

8:00 a.m. Registration -- Pre-function area outside meeting rooms.

(7) GRAPE & WINE SHORT COURSE

Coldstream 1 & 2 Rooms

Chuck Smith, Presiding

- 8:55 a.m. Welcome Address
- *Chuck Smith*
- 9:00 a.m. Ohio Grape Industry Overview
- *Maurus Brown*
- 9:30 a.m. Grape Production Issues (Question and Answer Session)
- *Jim Hatchett, Cathy Edwards, Rick Bessin, Chris Smigell*
- 10:00-10:40 Cider/Coffee Break and Visit Exhibits
- Pre-Function and Lower Atrium Areas
- 10:40 a.m. Starting a Vineyard
- *Brandon O'Daniel*
- 11:10 a.m. Site Preparation and Varieties for Difficult Sites - *Maurus Brown*
- 11:40 a.m. LUNCH ON YOUR OWN

(8) VEGETABLE PRODUCTION

Coldstream 3 Room

Adam Watson, Presiding

- 8:30 a.m. Grower Vegetable Demonstration Plot Results - *Nathan Howard, Nathan Howell, Bonnie Sigmon and Dave Spalding*
- 9:00 a.m. KVGA Annual Business Meeting + Building a One-Pass Sprayer and Plastic Layer - Video
- 9:30 a.m. Pepper Herbicide Trials
- *Joe Masabni*
- 10:00-10:40 Cider/Coffee Break and Visit Exhibits
- Pre-Function and Lower Atrium Areas
- 10:40 a.m. Asparagus Production from Seed
- *Terry Jones*
- 11:10 a.m. Irrigation Management
- *Tim Coolong*
- 11:40 a.m. LUNCH ON YOUR OWN

TUESDAY AFTERNOON, JANUARY 6

(12) GRAPE AND WINE SHORT COURSE

Coldstream 1 & 2 Rooms

Chris Smigell, Presiding

- 1:30 p.m. Fungicides, Leaf Removal and Gibberellic Acid as it Relates to Botrytis Fruit Rot - *Maurus Brown*
- 2:00 p.m. Developing a Relationship between Growers and Wineries (Question & Answer session)
Dominique Brousseau, Jim Wight, Bruce Kunze, Tim Woods, Zane Burton
- 2:30-3:10 Cider/Coffee Break
- Pre-Function and Lower Atrium Areas
- 3:10 p.m. Evaluating IPM Strategies for Controlling Japanese and Green June Beetles in Grapes
- *Derrick Hammons*
- 3:40 p.m. Understanding Powdery Mildew
- *Chris Smigell*
- 4:10 p.m. State of the Industry
- *Mac Stone and Dennis Walter*

(13) CUCURBIT PRODUCTION

Coldstream 3 Room

Brandon Bell, Presiding

- 1:30 p.m. Growing Giant Record Setting Pumpkins
- *George Kilgore*
- 2:00 p.m. Pumpkin Production, A Growers and Agents' Perspective
- *Brandon Bell*
- 2:30-3:10 Cider/Coffee Break
- Pre-Function and Lower Atrium Areas
- 3:10 p.m. Cucurbit Disease Control
- *Kenny Seebold*
- 3:40 p.m. Cucurbit Insect Control
- *Ric Bessin*
- 4:10 p.m. Ornamental Gourd Production
- *Terry Jones*

Concurrent Sessions

Concurrent sessions will enable participants to attend topics of interest in different sessions.

TUESDAY MORNING, JANUARY 6

8:00 a.m. Exhibits Open, Lobby

8:00 a.m. Registration -- Pre-function area outside meeting rooms.

(9) MARKETING

Coldstream 4 Room

Julia Rollins, Presiding

(10) TREE FRUIT

Coldstream 5 Room

Vaden Fenton, Presiding

(11) SMALL FRUIT PRODUCTION

Bourbon Room

Amanda Sears, Presiding

8:30 a.m.	Color Marketing - <i>Tammy Algood</i>	8:30 a.m.	Constructing a Low Cost Herbicide Sprayer (video) and Tree Fruit Spray Guide Update - <i>Ric Bessin and John Strang</i>	8:30 a.m.	Bird Control and Acid Injection to Control Soil pH in Blueberries - <i>Dave Lockwood</i>
9:00 a.m.	Loans and Cost Share Programs - <i>Michael Judge and Kristen Branscum</i>	9:00 a.m.	A Summary of Pawpaw Regional Variety Trials - <i>Kirk Pomper</i>	9:00 a.m.	Strawberry and Blueberry Variety Trial Results - <i>John Strang</i>
9:30 a.m.	Kentucky Food Consumer Panel - <i>Sara Williamson</i>	9:30 a.m.	Modes of Action and Effectiveness of Tree Fruit Insecticides - <i>Rick Weinzierl</i>	9:30 a.m.	Merchandising Techniques that Work and Those that Don't - <i>Tammy Algood</i>
10:00 a.m.	Cider/Coffee Break & Visit Exhibits - Pre-Function and Lower Atrium Areas	10:00 a.m.	Cider/Coffee Break & Visit Exhibits - Pre-Function and Lower Atrium Areas	10:00 a.m.	Cider/Coffee Break & Visit Exhibits - Pre-Function and Lower Atrium Areas
10:40 a.m.	Cooking at Farm Markets - <i>Tammy Algood</i>	10:40 a.m.	Managing Resistant Codling Moth and Oriental Fruit Moth - * <i>Rick Weinzierl</i>	10:40 a.m.	High and Low Tunnel Strawberry Production - <i>Joe Masabni</i>
11:10 a.m.	Mechanization and Marketing Innovations Contest - <i>John Wilhoit and Terry Jones</i>	11:10 a.m.	KSHS Annual Business Meeting	11:10 a.m.	New Arkansas Blackberry Production Characteristics - <i>Kirk Pomper</i>
11:40 a.m.	LUNCH ON YOUR OWN	11:40 a.m.	LUNCH ON YOUR OWN	11:40 a.m.	LUNCH ON YOUR OWN

(14) ORGANIC FARMING AND GARDENING

Coldstream 4 Room

Michael Fitzgerald, Presiding

(15) GREENHOUSE MANAGEMENT

Coldstream 5 Room

Rebecca Schnelle, Presiding

1:30 p.m.	Equipment for Small-Scale Organic Conservation Vegetable Farming - <i>Ron Morse</i>	1:30 p.m.	High Tunnel Production - <i>Tim Coolong</i>
2:00 p.m.	(Continued) - <i>Ron Morse</i>	2:00 p.m.	Basic Transplant Production - <i>Rebecca Schnelle</i>
2:30-3:10 p.m.	Cider/Coffee Break - Pre-Function and Lower Atrium Areas	2:30-3:10 p.m.	Cider/Coffee Break - Pre-Function and Lower Atrium Areas
3:10 p.m.	Increasing Beneficial Insects and Native Pollinators through Farmscaping - <i>Annette Wszelaki</i>	3:10 p.m.	Fertilizer Injectors - <i>Steve Berberich</i>
3:40 p.m.	Energy in Organic Agriculture - <i>Mike Bomford</i>	3:40 p.m.	Greenhouse Climate Control - <i>Rebecca Schnelle</i>
4:10 p.m.	Sequencing Produce for a CSA and Raspberry Variety Trials - <i>Ben Abell and Dereck Law</i>	4:10 p.m.	Greenhouse Insect Control - <i>Ric Bessin</i>

WHO'S WHO

Ben Abell, Horticulturist, Department of Horticulture, University of Kentucky, Lexington, KY

Rick Alexander, Executive Director, Ag Work Force Management, Commodity Growers Coop, Lexington, KY

Tammy Algood, Food Marketing Specialist, University of Tennessee Extension, Nashville, TN

Steve Arens, Senior Director, GS1 US Lawrenceville, NJ

Dr. Tom Barnes, Extension Wildlife Specialist, Department of Forestry, University of Kentucky, Lexington, KY

Brandon Bell, Metcalfe County Extension Agent for Agriculture and Natural Resources, Edmonton, KY

Stephen Berberich, Floriculture Extension Associate, Department of Horticulture, University of Kentucky, Lexington, KY

Dr. Ric Bessin, Extension Entomologist, Department of Entomology, University of Kentucky, Lexington, KY

Dr. Michael Bomford, Organic Project Leader, Atwood Research Facility, Kentucky State University, Frankfort, KY

Kristen Branscum, Division Director, Division of Value Added Plant Production, Kentucky Department of Agriculture, Frankfort, KY

Dominique Brousseau, Winemaker, Chateau du Vieux Corbeau, Danville, KY

Maurus Brown, Viticulturist, Ohio State University South Centers, Piquette, OH

Zane Burton, Grower, Sinking Valley Vineyard & Nursery, Somerset, KY

Bob Callander, Heart of St. Matthews Farmers' Market, Louisville, KY

Dr. Tim Coolong, Extension Vegetable Specialist, Department of Horticulture, University of Kentucky, Lexington, KY

Dr. Tom Cottrell, Extension Enologist, Department of Horticulture, University of Kentucky, Lexington, KY

Janet Eaton, Kentucky Dept. of Agriculture, Division of Markets, Frankfort, KY

Cathy Edwards, Jonco Farm, Inc, Lexington, KY

Maurice Fegenbush, President, Kentucky State Horticultural Society, Fegenbush Farms, Bloomfield, KY

Vaden Fenton, Extension Associate, Vegetable and Fruit Crops, Department of Horticulture, University of Kentucky, Research & Education Center, Princeton, KY

Michael Fitzgerald, Organic Program Coordinator, Division of Value Added Plant Production, Kentucky Department of Agriculture, Frankfort, KY

Sarah Fritschner, Norton Commons Farmers' Market, Louisville, KY

Derrick Hammons, Graduate Student, Department of Entomology, University of Kentucky, Lexington, KY

Jim Hatchett, Grower, Simple Pleasures Vineyard, Springfield, KY

Jessica Hinkle, Policies and Procedures Coordinator, Kentucky Department of Agriculture, Frankfort, KY

Nathan Howard, Extension Associate, Vegetable Crops, Daviess County Extension Office, Owensboro, KY

Nathan Howell, Extension Associate, Vegetable Crops, Hart County Extension Office, Munfordville, KY

Dr. Dewayne Ingram, Chair, Department of Horticulture, University of Kentucky, Lexington, KY

Dr. Terry Jones, Extension Horticulturist, Department of Horticulture, University of Kentucky, Robinson Station, Jackson, KY

Dr. Michael Judge, Director of Operations, Governors Office of Agricultural Policy, Frankfort, KY

George Killgore, Extension Director, University of Tennessee Extension, Davidson County, Nashville, TN

Dr. Robert Klein, Professor and Extension Cropping Systems Specialist, West Central Research & Extension Center, North Platte, NE

Bruce Kunze, Grower, Utica, KY

Derek Law, Research Support Staff, Department of Horticulture, University of Kentucky, Lexington, KY

Dr. Dave Lockwood, Extension Fruit Specialist, Department of Plant and Soil Science, University of Tennessee, Knoxville, TN

Dr. Joe Masabni, Vegetable Extension Specialist, Texas A & M University, College Station, TX

Russ Meredith, Heart of St. Matthews Farmers' Market, Louisville, KY

Dr. Ronald Morse, Vegetable Crops Research, Department of Horticulture, Virginia Tech, Blacksburg, VA

Brandon O'Daniel, Graduate Student, Department of Horticulture, University of Kentucky, Lexington, KY

WHO'S WHO

Dr. Gary Palmer, Assistant Director for Agriculture and Natural Resources, Cooperative Extension Service, College of Agriculture, University of Kentucky, Lexington, KY

Dr. Kirk Pomper, Principal Investigator of Horticulture, Curator, USDA-National Clonal Germplasm Repository for Pawpaw, Atwood Research Facility, Kentucky State University, Frankfort, KY

Amy Poston, Research Analyst, University of Kentucky, Lexington, KY

Julia Rollins, Lawrence County Extension Agent for Agriculture and Natural Resources, Louisa, KY

Nathan Routt, Business Development Specialist, Kentucky Center for Ag. and Rural Development (KCARD), Department of Agricultural Economics, University of Kentucky, Lexington, KY

Dr. Rebecca Schnelle, Extension Floriculturist, Department of Horticulture, University of Kentucky, Lexington, KY

Amanda Sears, Madison County Extension Agent for Horticulture, Richmond, KY

Dr. Kenny Seebold, Extension Plant Pathologist, Department of Plant Pathology, University of Kentucky, Lexington, KY

Bonnie Sigmon, Extension Associate, Vegetable Production, Laurel County Extension Office, London, KY

Chris Smigell, Small Fruit and Vegetable Extension Associate, University of Kentucky, Lexington, KY

Chuck Smith, President Kentucky Vineyard Society, Smith Berry Winery, New Castle, KY

Dave Spalding, Vegetable Extension Associate, Dept. of Horticulture, University of Kentucky, Lexington, KY

Crystal Sparks, Horticultural Technician, Department of Horticulture, University of Kentucky, Robinson Station, Jackson, KY

Mac Stone, Executive Director, Office of Marketing and Product Promotion, Kentucky Department of Agriculture, Frankfort, KY

Robert Stone, President Kentucky Vegetable Growers Association, Paris, KY

Dr. John Strang, Extension Fruit and Vegetable Specialist, Department of Horticulture, University of Kentucky, Lexington, KY

Dr. Lee Townsend, Extension Entomologist, Department of Entomology, University of Kentucky, Lexington, KY

Dennis Walter, Chair KGWC, Grower, Stone Brook Winery, Camp Springs, KY

Adam Watson, Bourbon County Extension Agent for Horticulture, Paris, KY

Dr. Rick Weinzierl, Extension Tree Fruit Entomologist, Department of Crop Sciences, University of Illinois, Urbana, IL

Shirley West, Director of Underwriting Services, Kentucky Farm Bureau Insurance Co., Louisville, KY

Jim Wight, Grower, Wight-Meyer Vineyard & Winery, Shepherdsville, KY

Dr. John Wilhoit, Extension Specialty Crop Mechanization Specialist, Department of Biosystems and Agricultural Engineering, University of Kentucky, Lexington, KY

Sara Williamson, Graduate Student, Department of Agricultural Economics, University of Kentucky, Lexington, KY

Patsy Wilson, Graduate Student, Department of Horticulture, University of Kentucky, Lexington, KY

Dwight Wolfe, Research Specialist, Department of Horticulture, University of Kentucky, Research & Education Center, Princeton, KY

Dr. Tim Woods, Agricultural Economics Extension Specialist, Department of Agricultural Economics, University of Kentucky, Lexington, KY

Dr. Annette Wszelaki, Commercial Vegetable Production Specialist, Plant Sciences Department, University of Tennessee, Knoxville, TN

Exhibitors

All American Containers

Attn: Roberta Parmelee
1111 Leader Rd.
Geneva, NY 14456
phone: 315-585-6045
e-mail: rparmelee@allamericancon-
tainers.com

Arystalife Science

5901 Redbank Road
Galena, Ohio 43021
phone: 614-895-9334
e-mail: vairb@earthlink.net

Bunton Seed Company

939 E. Jefferson St.
Louisville, KY 40206
phone: 502-584-0136
e-mail: pam@buntonseed.com

Carolina Wine Supply Inc.

5356 Old Plantation Circle
Winston Salem, NC 27104
phone: 336-677-6831
e-mail: angie@carolinawinesupply.
com

Clifton Seed Company

P.O. Box 206
Faison, NC 28341
phone: 910-260-0252
e-mail: edr@cliftonseed.com

Continental Industries

P.O. Box 865
Shepherdsville, KY 40165
phone: 502-543-2600
email: jchamilton@windstream.net

Creech Services

4100 Heraldry Court
Lexington, KY 40513
phone: 859-608-0846
e-mail: keith@creechservices.com

Criveller Company

6935 Oakwood Dr.
Niagara Falls, ON L2E655
phone: 905-357-2930
e-mail: dmacoretta@criveller.com

Crop Production Services

6803 North Henderson Ford Rd.
Mooresville, IN 46158
phone: 317-831-2559
e-mail: john.phillips@uap.com

Deerfield Supplies

2825 Stringtown Rd.
Elkton, KY 42220
phone: 270-265-2425

Dillman Farm, Inc.

4955 West State Road 45
Bloomington, IN 47403
phone: 812-825-5525
e-mail: carydillman@dillmanfarm.com

Earth Tools, Inc.

1525 Kays Branch
Owenton, KY 40359
phone: 502-484-3988

Fairview Produce Auction, Inc.

955 Britmart Rd.
Elkton, KY 42220
phone: 270-887-0053

Governor's Office of Ag. Policy

404 Ann Street
Frankfort, KY 40601
phone: 502-564-4627
e-mail: angelag.blank@ky.gov

Indiana Berry & Plant Co.

5218 W. 500 S
Huntingburg, IN 47542
phone: 812-683-3055
e-mail: inberry@psci.net

Kentucky Department of Agriculture

100 Fair Oajks, 5th Flr.
Frankfort, KY 40601
502-564-4983

Seedway, LLC

7520 Ruggles Ferry Pike
Knoxville, TN 37924
phone: 865-548-7333
e-mail: kbhosey@gmail.com

Siegers Seed Company

2272 Mt. Vernon Rd.
Sharon, TN 38255
phone: 731-431-6730
e-mail: jim_elam@siegers.com

Spec Trellising Co.

39 Indian Drive
P.O. Box 2204
Ivyland, PA 18974
phone: 1-800-237-4594
e-mail: info@spectrellising.com

Stokes Seeds

13265 Howe Road
Fishers, IN 46038
phone: 317-578-7906
e-mail: kwagner@stokeseeds.com

USDA, Farm Service Agency

771 Corporate Dr., Suite 100
Lexington, KY 40503
phone: 859-224-7624
e-mail: winnie.breeding@ky.usda.gov

Wabash Valley Progressive Viticulture

8902 South 625 West
Rosedale, IN 47874
phone: 765-548-0676
e-mail: ditzlera@aol.com

Literature Table

Krohne Plant Farms, Inc.

65295 CR 342
Hartford, MI 49057
phone: 269-424-5423
Website: www.kroneplantfarms.com

Nourse Farms, Inc.

41 River Road
South Deerfield, MA 01373
phone: 413-665-2658
e-mail: info@noursefamrs.com

Putnam Plastics/Farm Products

255 So. Alex Road
W. Carrollton, OH 45449
phone: 800-457-3099
e-mail: packaging@putnamfarm.com

2nd Floor

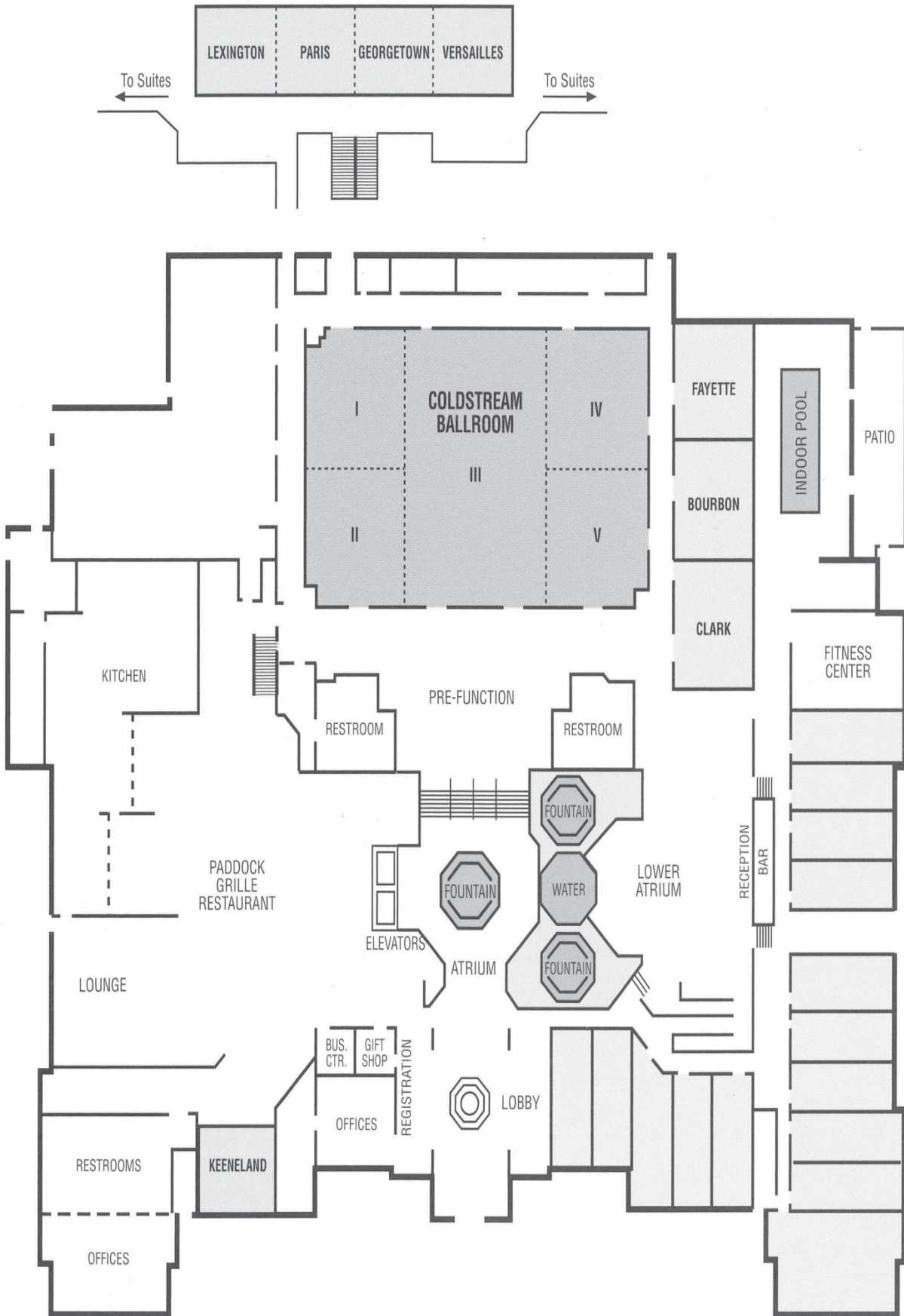

Kentucky State Horticultural Society
UK Research & Education Center
PO Box 469
Princeton KY 42445-0469

DIRECTIONS

From I-75/64: Take Exit 115 then right on to Newtown Pike. Turn right onto Aristides Blvd. at the UK Coldstream Research Campus. Hotel is on the right.
From Blue Grass Airport: Exit left on to Man O'War Blvd. to Versailles Rd. Turn right onto Versailles Rd. Take Rt. 4 New Circle Rd. north to Newtown Pike Exit North. Turn left onto Aristides Blvd. at the UK Coldstream Research Campus. Hotel is on the right.

