

## OFFICE OF THE INDEPENDENT COUNSEL

Date of transcription 2/10/98

DEBRA ANNE SCHIFF, white, female, date of birth [REDACTED], Social Security Account Number [REDACTED], place of birth Hollywood, California, home address [REDACTED], [REDACTED], home telephone number [REDACTED], cellular phone number [REDACTED], White House pager extension [REDACTED], work telephone number [REDACTED] was apprised of the official identity of the interviewing Agents and the nature of the interview. SCHIFF was interviewed at suite 300, Thomas Jefferson Street, Northwest, Washington, DC, the offices of CARY M. FELDMAN, SCHIFF's attorney. FELDMAN was present during the interview. SCHIFF provided the following information:

SCHIFF worked for Air Advantage during the 1992 Presidential campaign as a broker. From March of 1992 until November of 1992, SCHIFF logged more than three million miles in air travel. SCHIFF flew twenty to twenty-five days out of each month during the campaign.

SCHIFF advised that she first met MONICA LEWINSKY sometime in 1995, prior to LEWINSKY working at the White House. SCHIFF attended two parties where LEWINSKY's mother and aunt were present. One was at LEWINSKY's aunt's house in Warrenton, Virginia and the other was at a restaurant. SCHIFF advised that WALTER KAYE, a gentleman SCHIFF first met at the White House in 1994 and befriended immediately, invited SCHIFF to the parties. SCHIFF believes that MONICA LEWINSKY may have been present at one of these parties. SCHIFF described LEWINSKY's family as friendly but aggressive. LEWINSKY's mother may have said something to SCHIFF about MONICA LEWINSKY wanting to work at the White House.

SCHIFF had nothing to do with LEWINSKY obtaining her White House internship. SCHIFF has assisted one person, COURTNEY MONIE, SCHIFF's minister's daughter, obtain a White House internship.

SCHIFF advised she thought LEWINSKY was too aggressive as an intern. SCHIFF advised that most interns were shy and reserved. LEWINSKY dressed provocatively, wearing low-cut dresses and very short skirts. SCHIFF saw LEWINSKY with President WILLIAM JEFFERSON CLINTON on one occasion. SCHIFF

Investigation on 2/10/98 at Washington, DC File # 29D-OIC-LR-35063

by SA [REDACTED]  
SA [REDACTED] Date dictated 2/10/98

29D-OIC-LR-35063

Continuation of OIC-302 of DEBRA SCHIFF , On 2/10/98 , Page 2

recalls that LEWINSKY had only been working at the White House for a week or two and SCHIFF was at BETTY CURRIE's desk. SCHIFF recalls CLINTON saying "hi" to LEWINSKY, but does not think CLINTON knew who LEWINSKY was. SCHIFF does not recall working during the federal government shut-down of 1995.

SCHIFF advised she talked with EVELYN LIEBERMAN about LEWINSKY's inappropriate attire and LIEBERMAN advised she would look into it. SCHIFF advised that she may have had conversations with LIEBERMAN about other interns and staff members' attire, but those dealt mostly with people wearing jeans or t-shirts in the White House. SCHIFF has no specific recollection of another person in the White House dressing so provocatively that SCHIFF had to advise LIEBERMANN about.

SCHIFF was shocked when the LEWINSKY matter first hit the newspapers. SCHIFF never heard about a relationship between CLINTON and LEWINSKY. SCHIFF never cleared LEWINSKY into the White House. SCHIFF only recalls LEWINSKY visiting the White House on one occasion after LEWINSKY left employ there. SCHIFF recalls LEWINSKY attending a function in the Roosevelt Room or the South Lawn with her boss from the Pentagon.

SCHIFF advised it is not unusual for people to come to the West Wing and not go through SCHIFF. SCHIFF is not familiar with LEWINSKY's relationship with BETTY CURRIE.

SCHIFF has no idea how LEWINSKY got her job at the Pentagon.

SCHIFF was notified of her federal grand jury subpoena by CHERYL MILLS of the White House Counsel's office.

SCHIFF drew a sketch of the West Wing of the White House, concentrating on her immediate work area. The sketch is attached to this FD-302 and incorporated by reference. SCHIFF advised that there is a fax machine in the closet near her desk. SCHIFF advised that the closet is used as an office by intern CAROLINE SELF. SCHIFF advised that, on occasion, BETTY CURRIE uses that fax machine. SCHIFF advised that NANCY HERNREICH has a fax machine at her desk, but will not let anyone use it.

SCHIFF advised that SYLVIA MATTHEWS has a fax machine

29D-OIC-LR-35063

Continuation of OIC-302 of DEBRA SCHIFF . On 2/10/98 . Page 3

in her area and it is used by most people in the West Wing. SCHIFF does not know if JOHN PODESTA ever used the fax machine in SCHIFF's area.

SCHIFF was shown document "828-DC-00000012," a faxed copy of LEWINSKY's resume. This document is attached to this FD-302 and incorporated by reference. SCHIFF advised she has never seen the resume before in her life. SCHIFF also advised that she was mad that someone had faxed the resume from the fax machine in her area.

SCHIFF advised that BETTY CURRIE is her closest friend at the White House. SCHIFF is also friends with HEATHER MARABOUT, HEATHER NEW and STEPHANIE STREET.

SCHIFF advised she knows VERNON JORDAN, but is not a social acquaintance.

Monica S. Lewinsky

~~\_\_\_\_\_~~  
~~\_\_\_\_\_~~  
~~\_\_\_\_\_~~ (W) 703.697.9812

U14

**Education:**

Lewis and Clark College Portland, Oregon  
 Bachelor of Science in Psychology May 1995

**Experience:**

Department of Defense The Pentagon Washington, D.C.  
*Confidential Assistant to the Assistant Secretary of Defense for Public Affairs*  
 April 1996 - present

Serve as principal assistant to the Assistant Secretary of Defense (ASD) for Public Affairs in support of his dual role as both Department of Defense spokesman and head of Department of Defense Public Affairs. Assist in preparing the ASD for bi-weekly press briefings. Interact with the national print and broadcast media on the ASD's behalf. Provide the ASD with timely updates of current media stories. Act as liaison with the offices of the Secretary, the White House, other Cabinet Secretaries and the National Security Council. Provide support to the Secretary of Defense and Assistant Secretary on frequent international travel which includes a contingent of traveling media. Handle the ASD's daily schedule and correspondence.

The White House Washington, D.C.

*Staff Assistant to Director of Legislative Affairs Correspondence*, November 1995 - April 1996  
 Wrote drafts and correspondence for Staff Secretary's approval and ultimately the President's signature, which often required research of various Administration issues and policies. Coordinated mass mailings to Congress for the President and other Senior Administration officials. Processed and vetted all incoming mail to the President from Congress. Trained and supervised new interns on White House procedure and preparation of White House correspondence.

The White House Washington, D.C.

*Summer Intern Office of the Chief of Staff*, July - November 1995  
 Drafted form letters and individual responses for the Chief of Staff's signature. Acted as a liaison for Chief of Staff's office to other White House offices, Cabinet agencies, and Congressional offices. Updated office manual. Supervised and coordinated intern and volunteer staff.

Metropolitan Public Defenders Portland, Oregon

*Alternatives Staff*, February - May 1995

Implemented new psychology expert reference techniques. Assisted attorneys in finding viable alternatives to prison for their clients. Directed clients in successful search for support, shelter, food and transportation. Updated files on resource materials.

Southeast Mental Health Network (Practicum) Portland, Oregon

*Socialization Staff Assistant*, January - June 1994

Assisted staff in teaching socialization skills to mentally ill clients to ease their integration back into society. Updated clients' confidential reports. Coordinated fund raising to benefit extra-curricular theatre activities.

**Additional Information:**

828-DC-00000012

- TS-SCI Clearance: Current
- Proficient in Macintosh for Microsoft Word 6.0, WordPerfect for Windows 5.2, Quorum, and Infosys.

3527

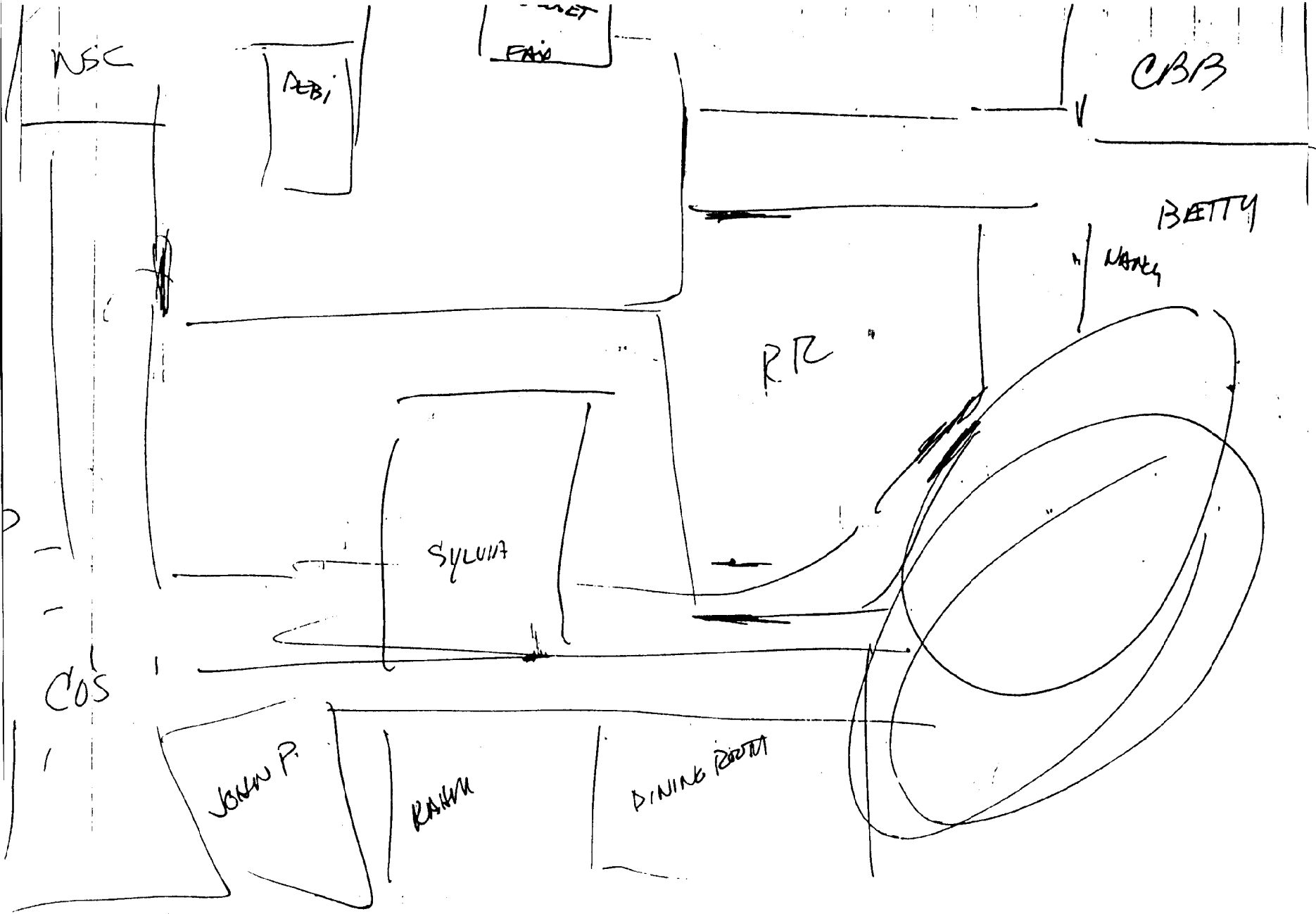

Das 2/10/98

