



REGISTRATION NUMBER

DVH 0053

DATE OF REGISTRATION/PUBLICATION

Apr. 19, 2001

Month Day Year

DO NOT WRITE ABOVE THIS LINE. IF YOU NEED MORE SPACE, USE A SEPARATE CONTINUATION SHEET. (Form D-VH/CON)

1

Please give the make and model of the vessel that embodies the design.

SEA RAY 190 BOW RIDER/CLOSED BOW

TITLE

2

(a) What is the type or style of the design for which registration is sought?

SPORT BOAT HULL, DECK AND COCKPIT

DESIGN (b)

Provide a brief general statement setting forth the salient features of the design.

CONSOLES, SEATING ARRANGEMENTS, SUN DECK, HULL DESIGN

Check here if this is a single design.

Check here if registering more than one design. Use Form D-VH/CON for additional designs.

(c) If this design is derived from an earlier design, describe how that design has been revised, adapted, or rearranged.

NEW MODEL, IMPROVED AND REVISED FEATURES, ADDED DESIGNS, UNIQUE STYLING.

3

Provide the name and address of the designer(s). The name of the employer may be given instead of the designer(s) if, (1) the design was made within the regular scope of employment of the designer(s) and (2) the individual authorship of the design is difficult or impossible to ascribe.

Please check here if those conditions are satisfied and you are providing the employer's name.

DESIGNER(S)

SEA RAY BOATS

Name: A DIVISION OF BRUNSWICK CORPORATION Name:

Address: 2600 SEA RAY BOULEVARD

Address:

KNOXVILLE, TN 37914

4

If the owner is different from the designer(s) or employer named above, provide the name and address of the owner:

Name: N/A

Address:

OWNER, IF NOT DESIGNER(S)

5

(a) Was an application for registration of this design identified in an application filed in a foreign country that extends to designs of owners who are citizens of the United States, or to persons filing applications in the United States, similar protection to that afforded in 17 U.S.C. chapter 13?

Yes No

(b) If yes, identify the country and date of application:

Country:

Date of application:

Serial No:

PRIORITY CLAIM

6

Was this design made public before the date of application? Yes No

If yes, on what date? MAY 31, 1999

Month Day Year

DATE MADE PUBLIC

DO NOT WRITE HERE OFFICE USE ONLY

APPLICATION RECEIVED

APR 02 2001

DESIGN COPIES RECEIVED

APR 02 2001

FUNDS RECEIVED

4/2/01

APR 09 2001



01/18/01

2000 Model Year 190CB
Sea Ray Boats, Inc.



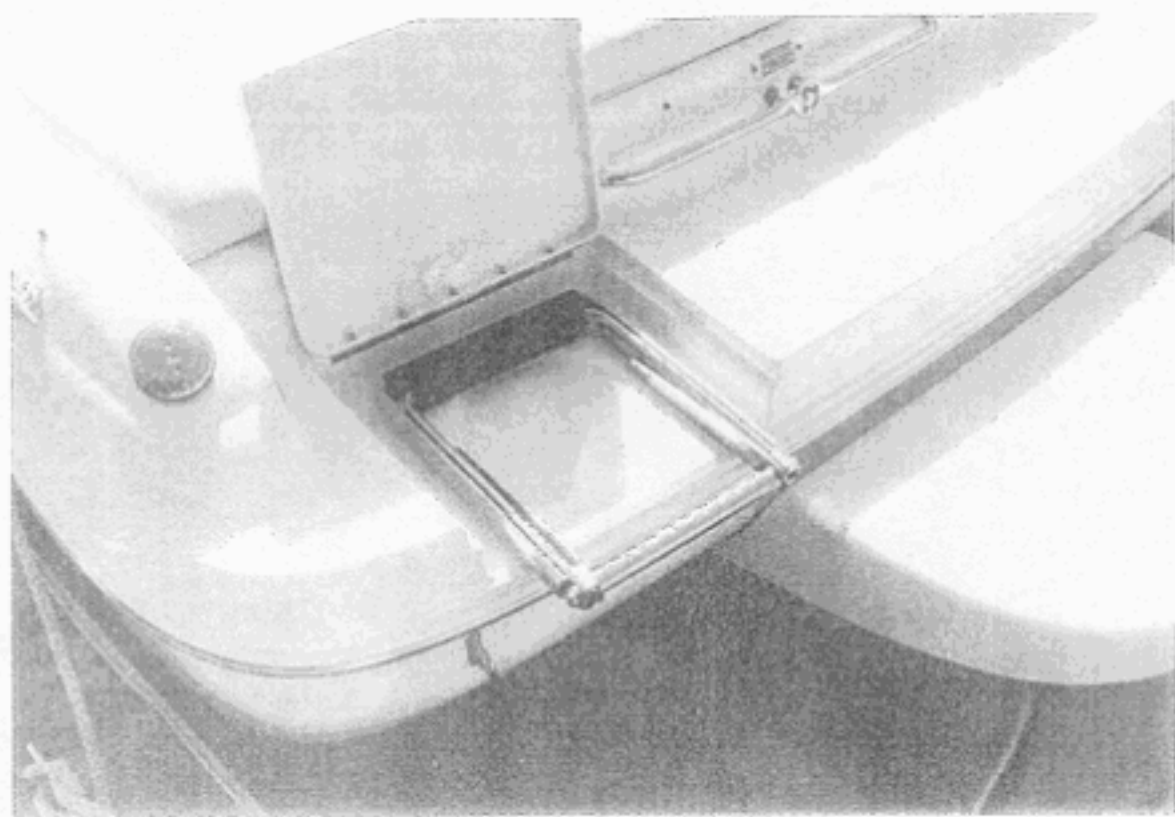
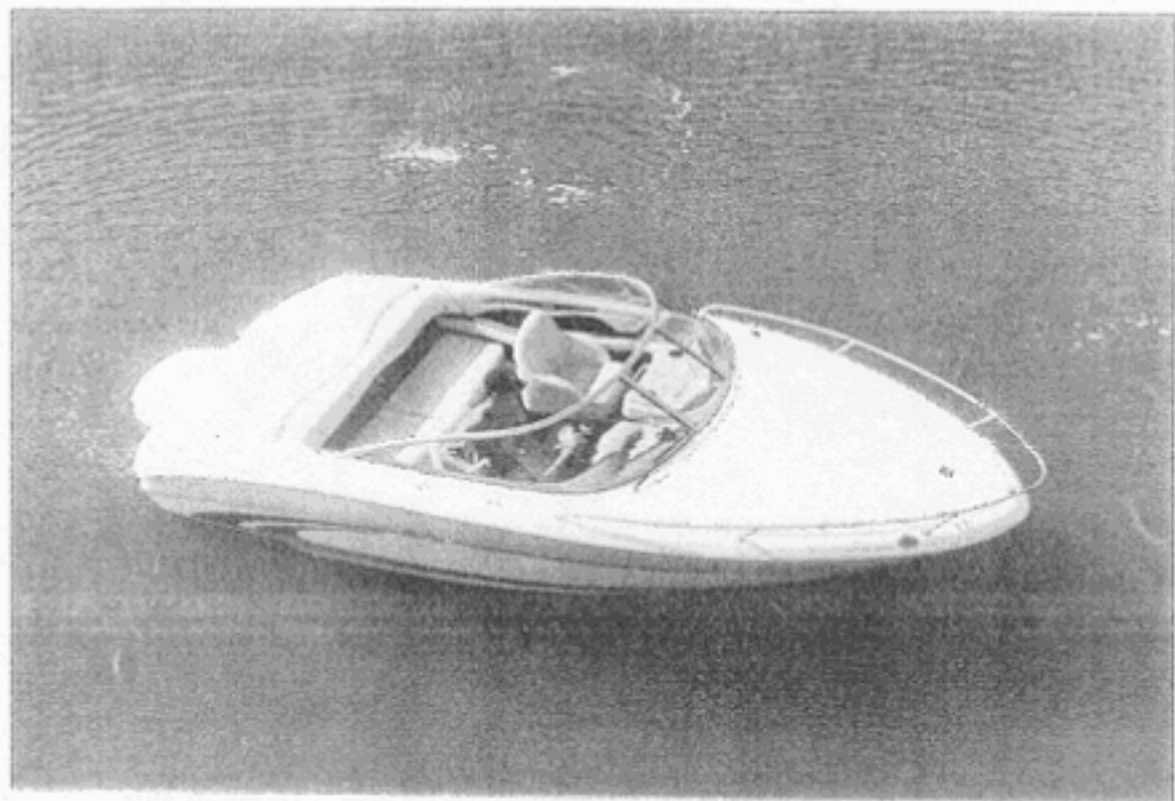

01/18/01

2000 Model Year 190CB
Sea Ray Boats, Inc.



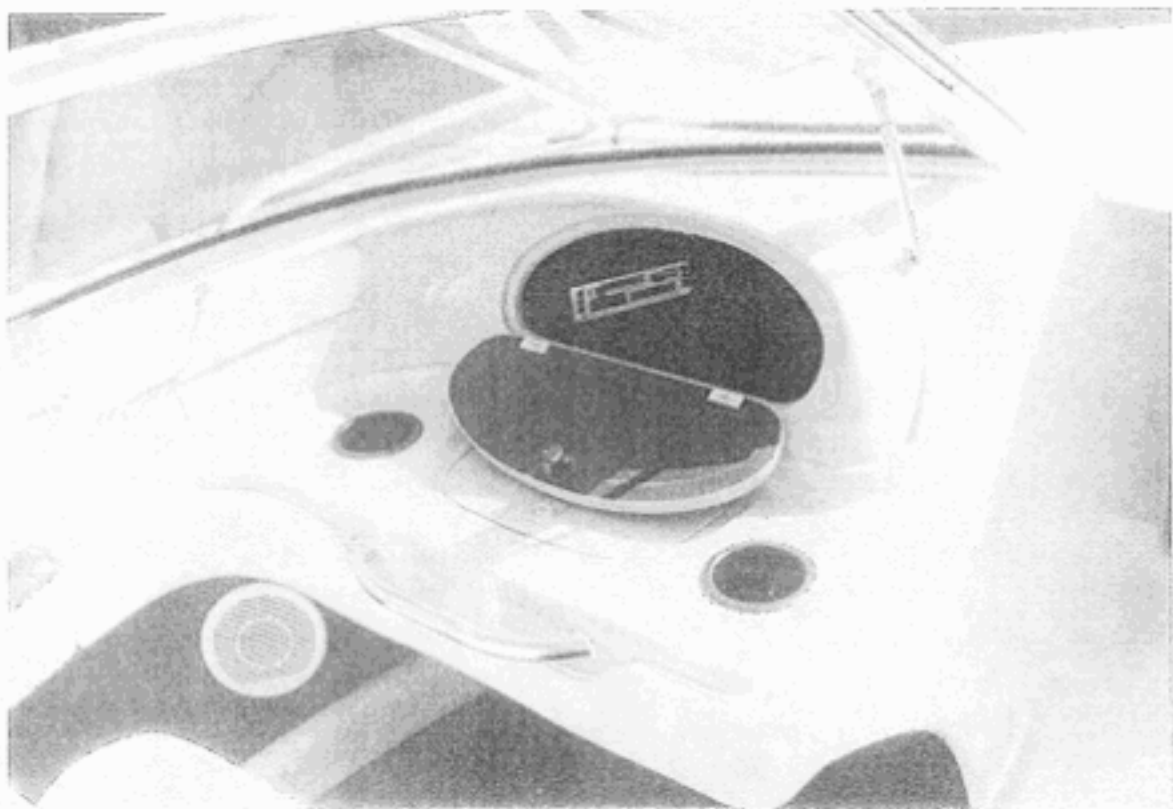
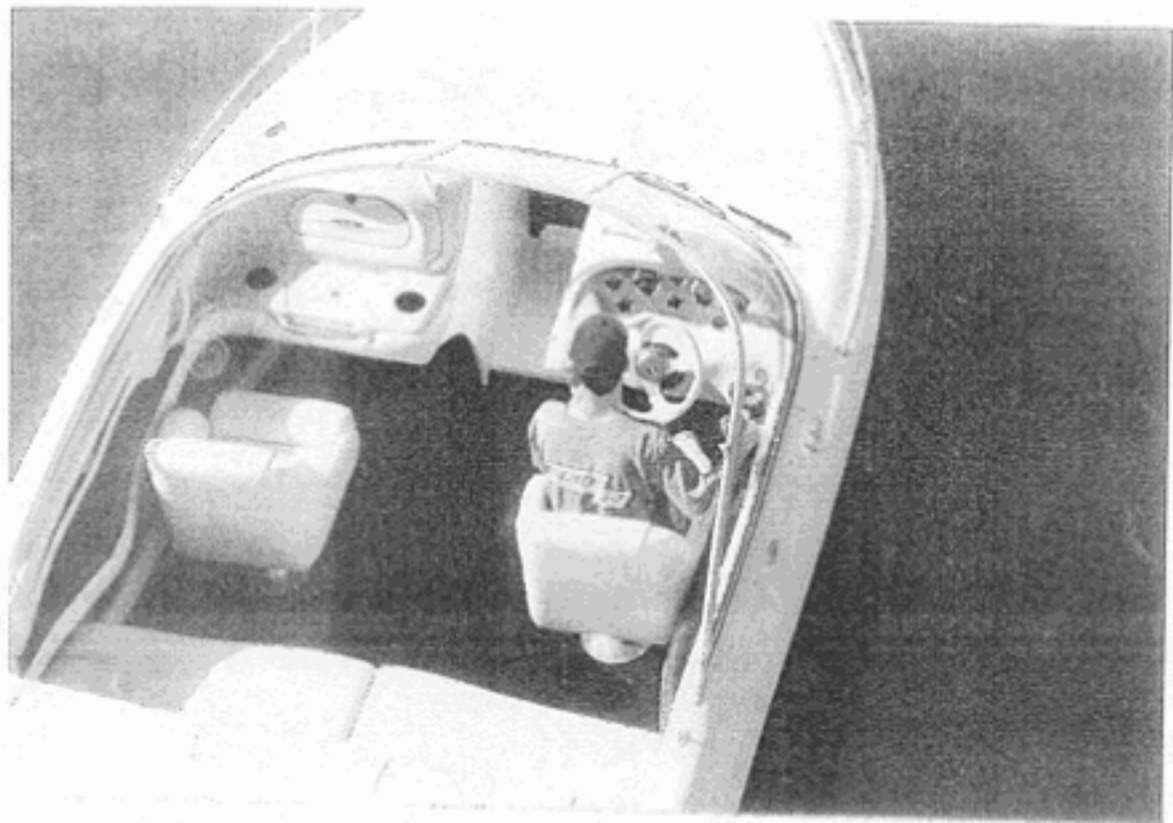

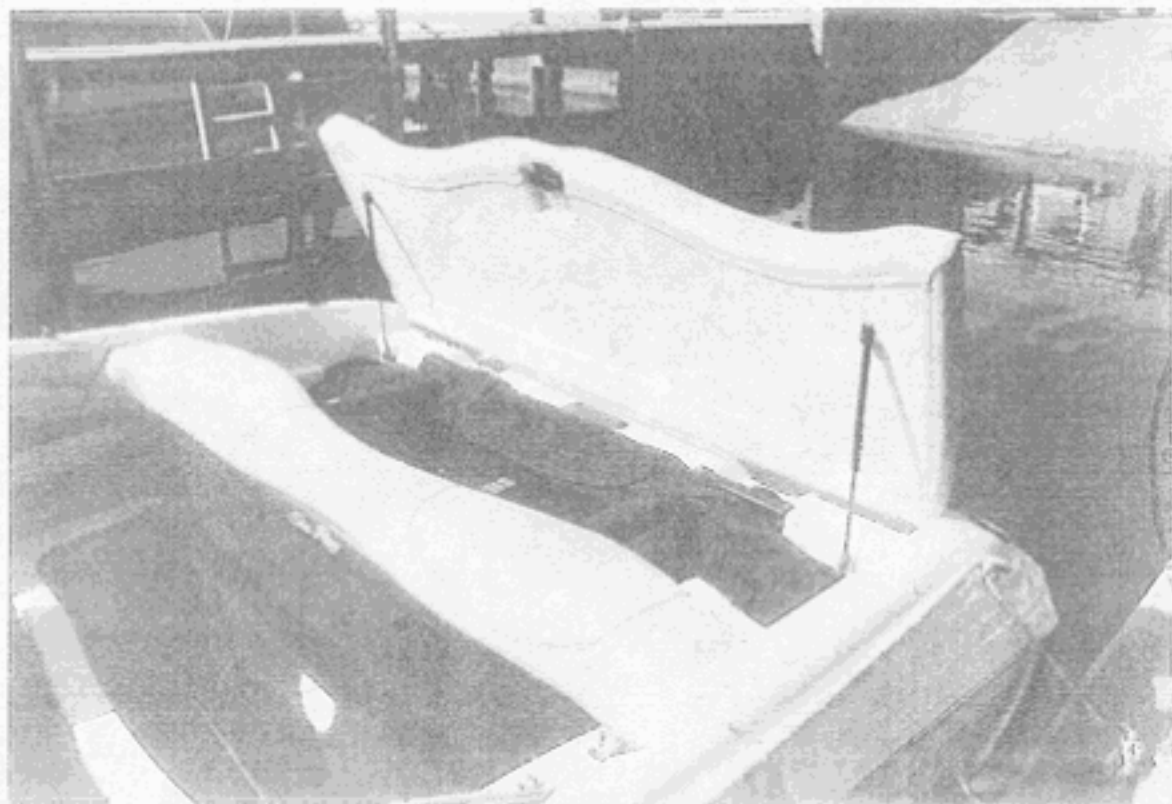
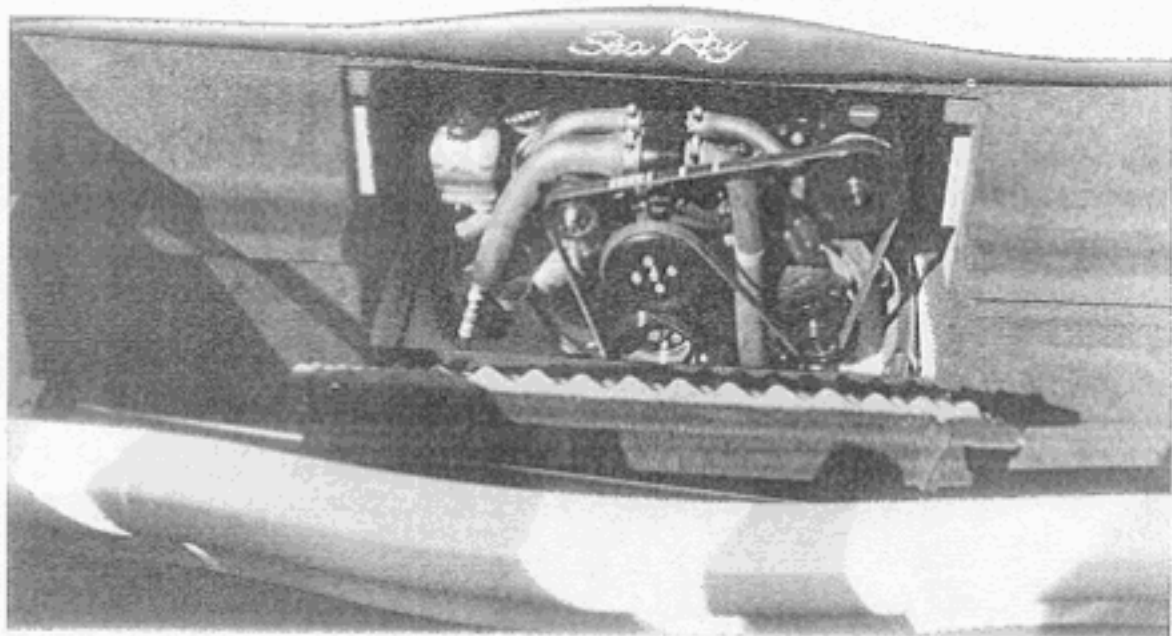

THIS DRAWING IS THE PROPERTY OF SEA RAY BOATS, INC., PALM BEACH, FLORIDA. ALL RIGHTS ARE RESERVED. THIS DRAWING AND INFORMATION CONTAINED HEREIN IS NOT TO BE COPIED OR REPRODUCED IN ANY MANNER WITHOUT THE WRITTEN PERMISSION OF SEA RAY BOATS, INC.

REVISED BY

DATE

ECN NO.

CURRENT ECN NO.

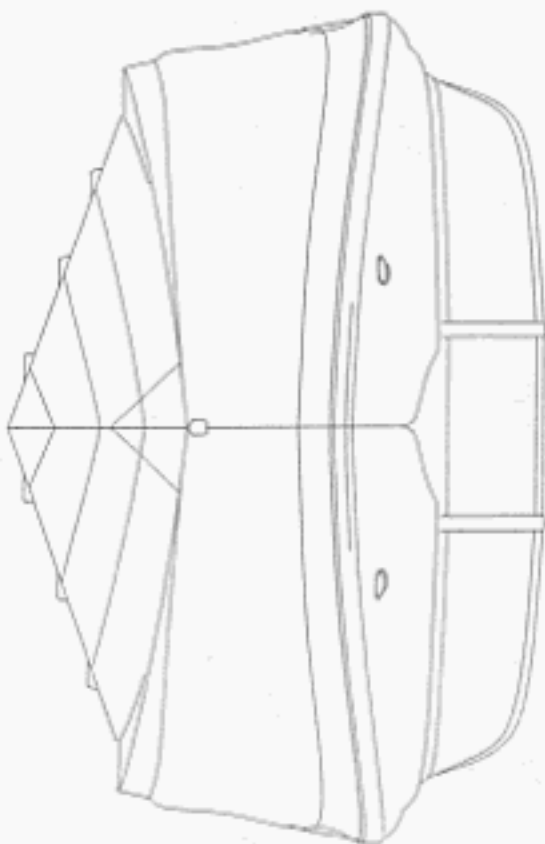
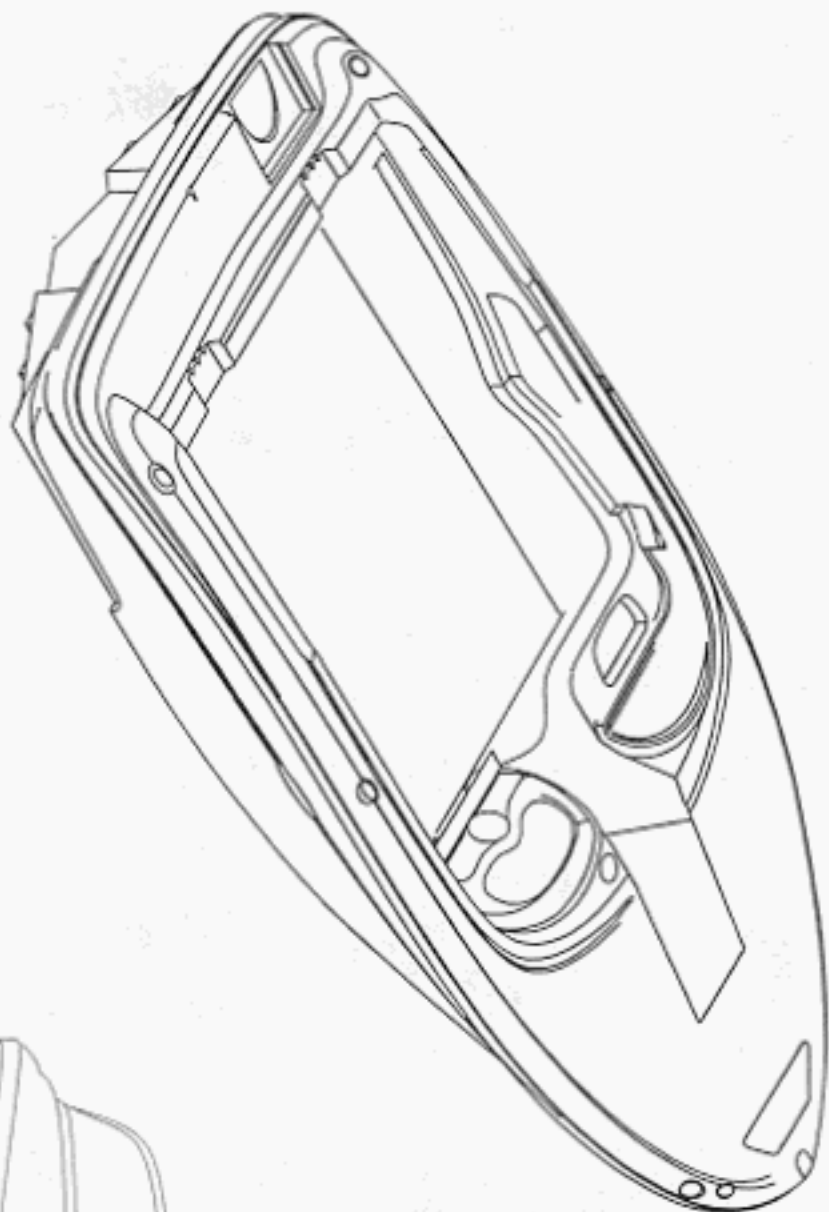

DRAW TITLE COPYRIGHT DRAWINGS

DRAWING NO./DATE

PLANT APPROVAL BY

PLANT START NO.

DRAWN BY/ DATE

APPROVED BY/ DATE

PLANT ECN NO.

CAD FILE 19CDB02090.00MS

MODEL 190 CB

DRAWN BY/ DATE DRAWN R. BROOKER 02-01

PATIAL RELEASE ECN NO. DRAWING NO.

02-090 0 of 31



PRODUCT DEVELOPMENT & ENGINEERING

THIS DRAWING IS THE PROPERTY OF SEA RAY BOATS, INC., P.O. BOX 1000, MERIDETH PLAZA, FLORENCE, AL. ALL RIGHTS ARE RESERVED. THIS DRAWING AND INFORMATION CONTAINED HEREIN IS NOT TO BE COPIED OR DISCLOSED TO OTHERS WITHOUT THE WRITTEN PERMISSION OF SEA RAY BOATS, INC.

DVH 0053

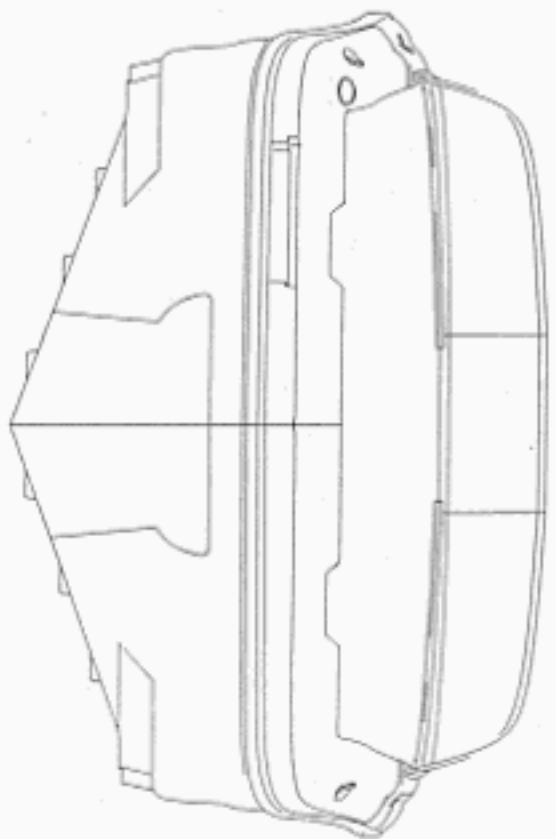
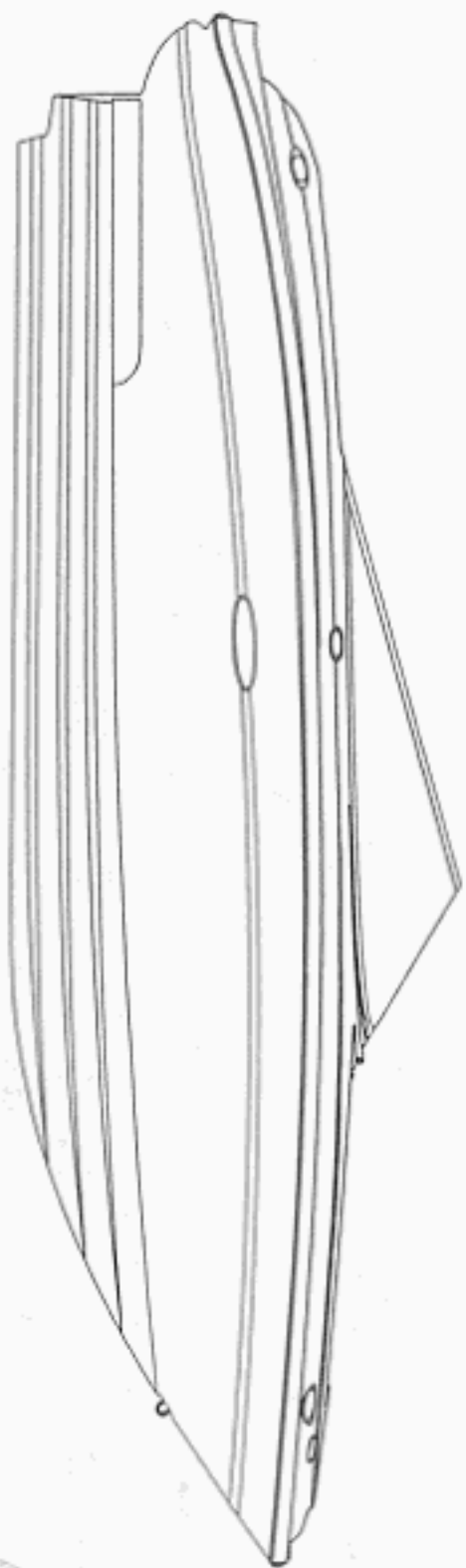

COPYRIGHT OFFICE
 APR 2 2001
 LIBRARY OF CONGRESS

REVISED BY	DATE	ECN NO.	CURRENT ECN NO.

Sea Ray

PRODUCT DEVELOPMENT & ENGINEERING

ONE TITLE COPYRIGHT DRAWINGS

PLANT REV. NO./DATE	DESIGNED BY/DATE	MODEL	190 CB
PLANT APPROVAL BY	APPROVED BY/DATE	DRAWN BY/DATE	R. BROMER 04-8-01
PLANT START NO.	PLANT ECN NO.	CAD FILE	19cb02090.dwg

INITIAL RELEASE ECN NO. DRAWING NO. 02-090 (2 of 3)

THIS DRAWING IS THE PROPERTY OF SEA RAY BOATS, INC., POLE, NOTES, MERRITT ISLAND, FLORIDA. ALL RIGHTS ARE RESERVED. THIS DRAWING AND INFORMATION CONTAINED HEREIN MAY NOT BE COPIED OR REPRODUCED IN ANY MANNER WITHOUT THE WRITTEN PERMISSION OF SEA RAY BOATS, INC.

DVH 0053

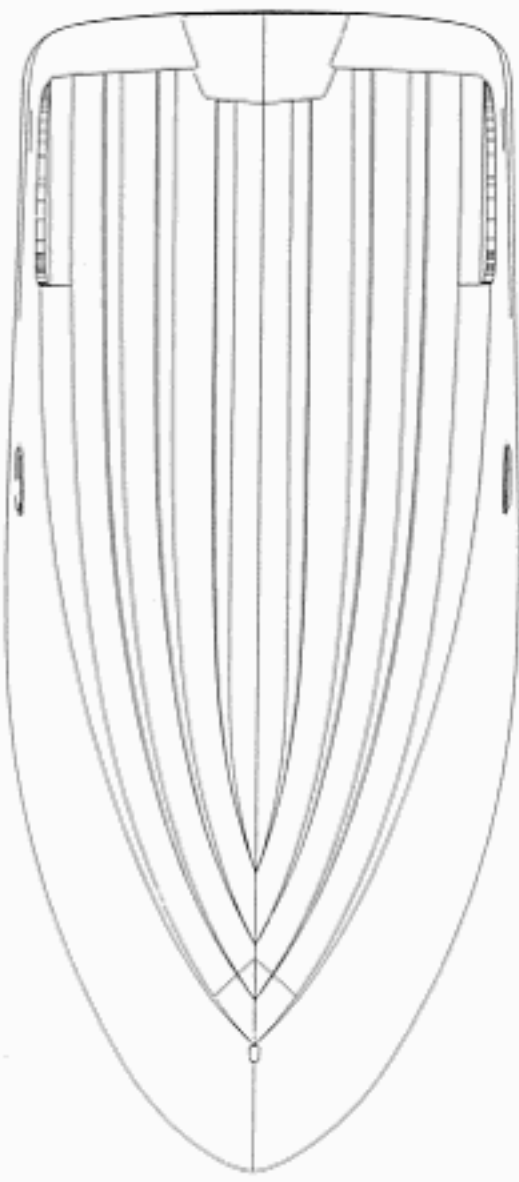
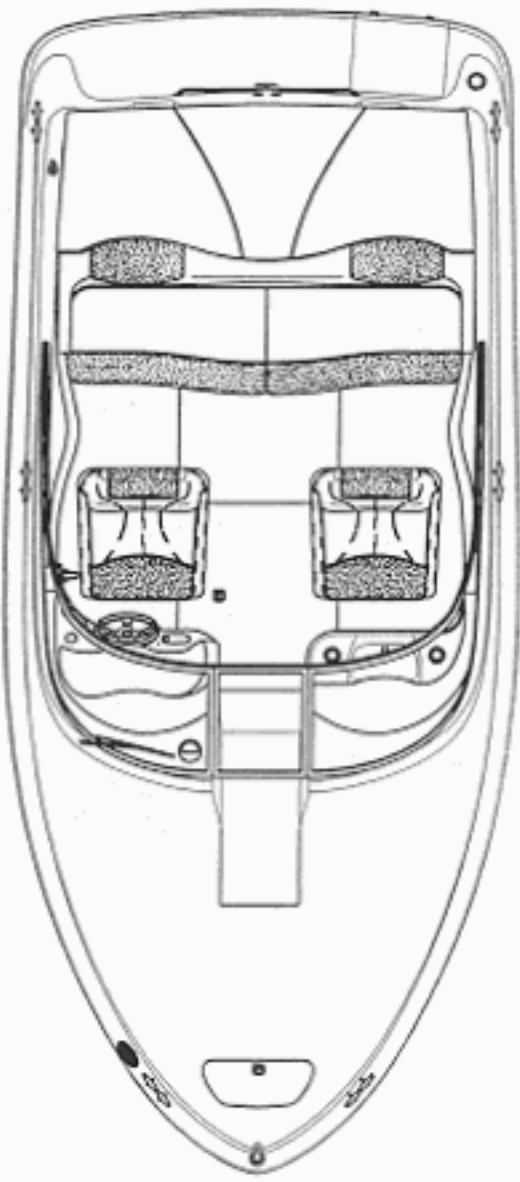

REVISED BY

DATE

ECN REV. NO.

CURRENT ECN NO.



BNG TITLE COPYRIGHT DRAWINGS
 PART NO. / DATE
 PLANT APPROVAL BY
 PLANT START NO. / PLANT ECC NO.

MODEL 190 CB
 DRAWN BY: R. BROWER
 DATE DRAWN: 01-18-01
 INITIAL RELEASE ECN NO. / DRAWING NO.