

# ***Figures***

BLASLAND, BOUCK & LEE, INC.  
*engineers & scientists*

---

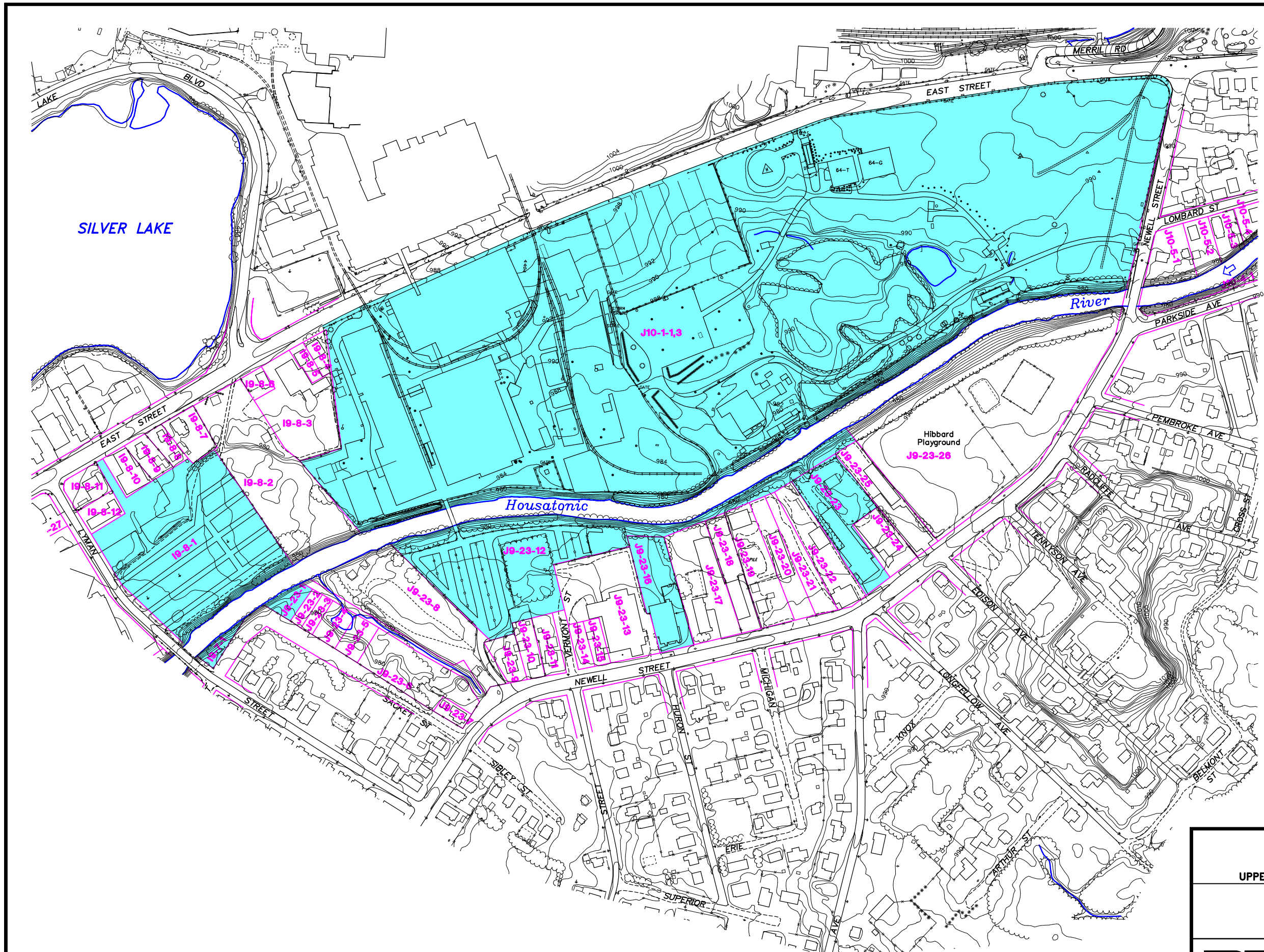

**LEGEND**

- EDGE OF WATER
- PAVED ROADWAY
- UNPAVED ROADWAY OR TRAIL
- VEGETATION
- PROPERTY BOUNDARY
- 17-1-3 PROPERTY ID
- GE-OWNED PROPERTY

- NOTES:**
1. THE BASE MAP FEATURES WERE PHOTOGRAMMETRICALLY MAPPED FROM APRIL 1990 AERIAL PHOTOGRAPHS.
  2. TAX ASSESSORS' PARCEL IDENTIFICATION NUMBERS AND BOUNDARY INFORMATION OBTAINED FROM CITY OF PITTSFIELD'S TAX ASSESSORS' OFFICE AND IS CURRENT THROUGH SEPTEMBER 5, 1997.

**DRAFT**

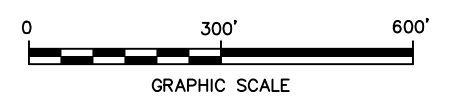

GENERAL ELECTRIC COMPANY  
PITTSFIELD, MASSACHUSETTS

**REMOVAL ACTION WORK PLAN—  
UPPER 1/2-MILE REACH OF HOUSATONIC RIVER**

**SITE PLAN**

**BBL** BLASLAND, BOUCK & LEE, INC.  
engineers & scientists

FIGURE  
**1-1**

X: 20197x01,20197x02  
L: on=\*,off=\*,re=\*,\*255,\*flood  
P: STD=PCP/BL  
5/19/99 SYR-54-YCC RLP NES  
20197030/WRK-PLN/20197g01.dwg

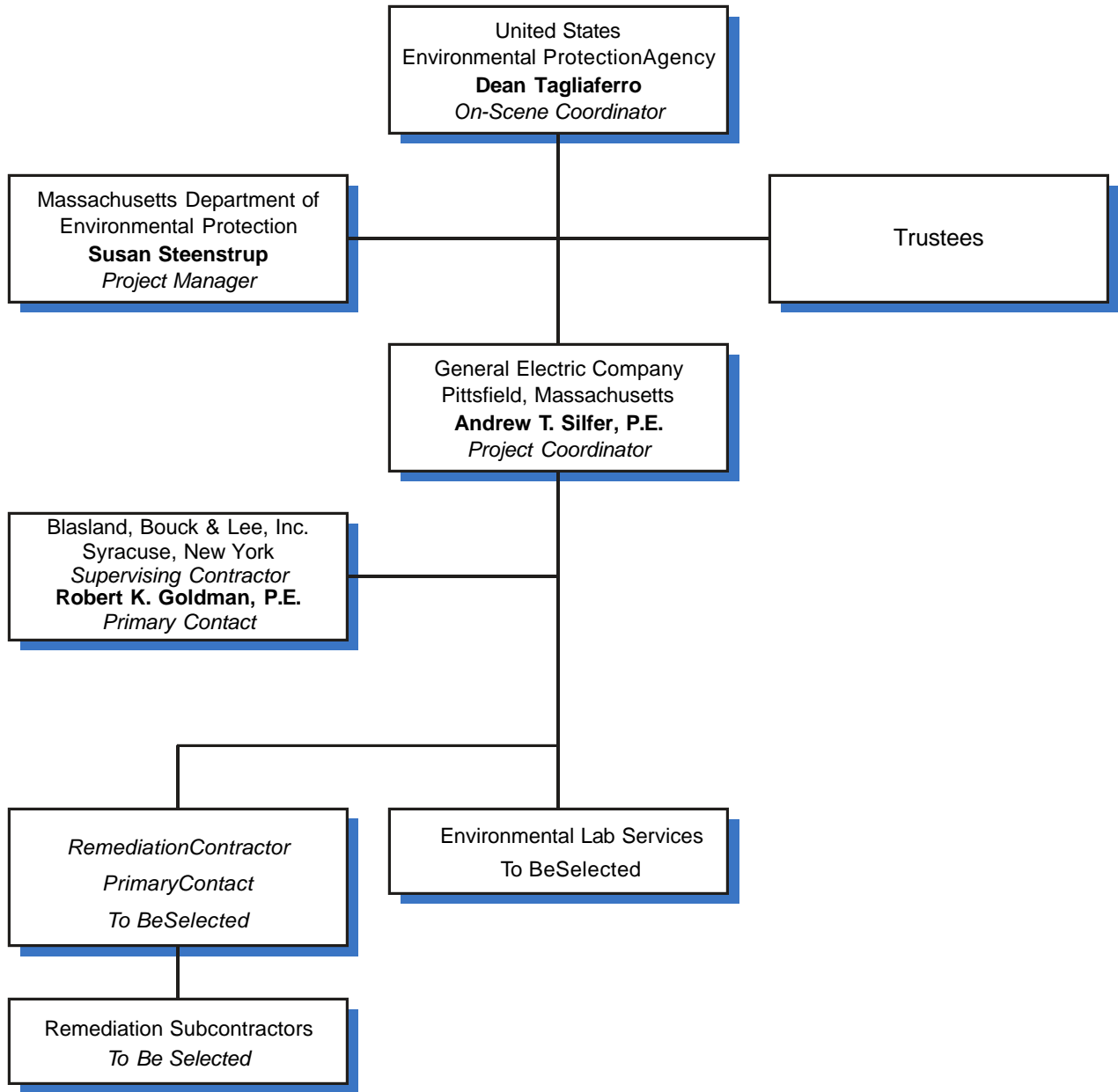

GENERAL ELECTRIC COMPANY  
PITTSFIELD, MASSACHUSETTS  
REMOVAL ACTION WORK PLAN -  
UPPER 1/2-MILE REACH OF HOUSATONIC RIVER

**PROJECT ORGANIZATION**



BLASLAND, BOUCK & LEE, INC.  
engineers & scientists

FIGURE  
**3-1**

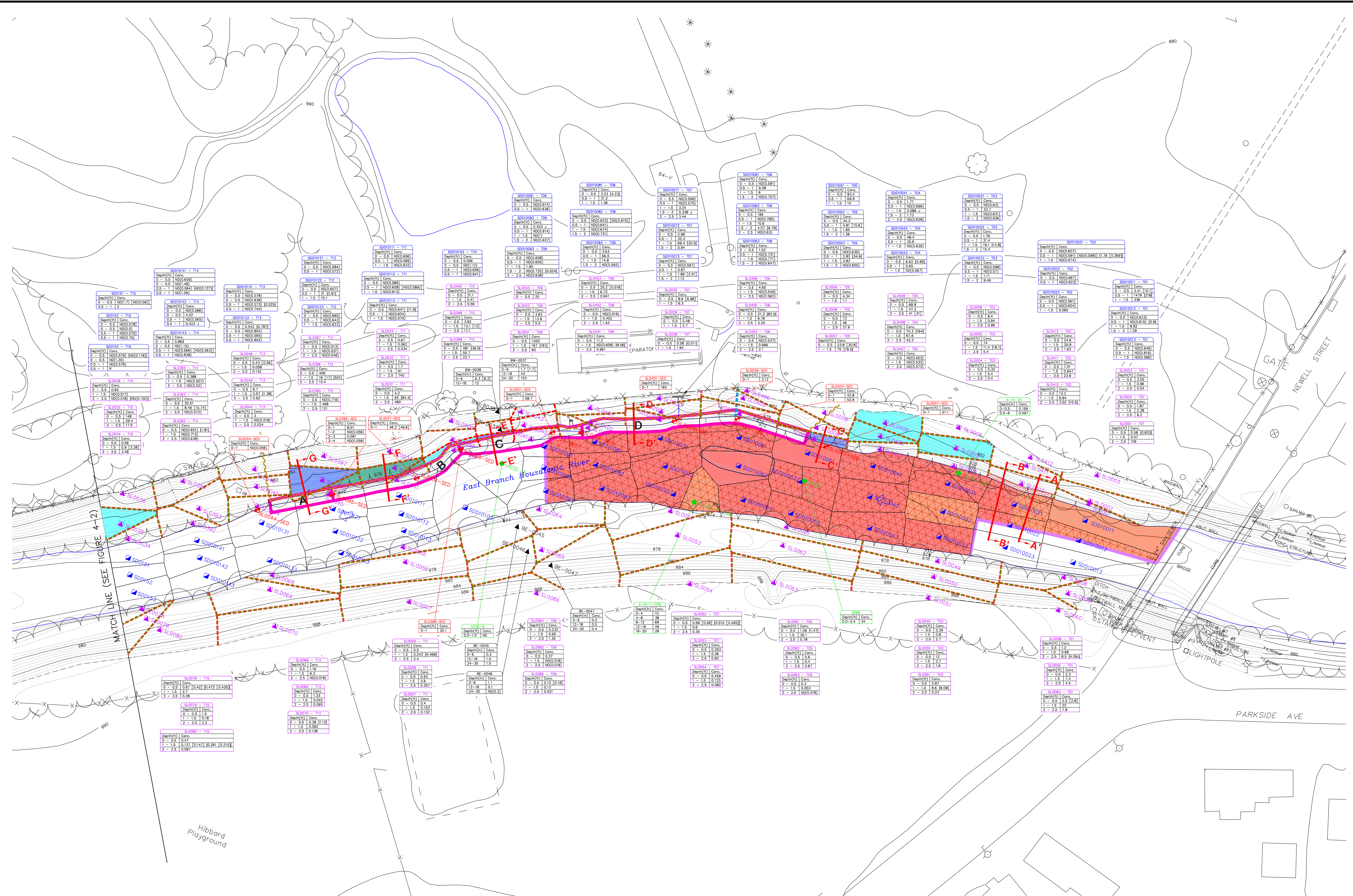

LEGEND:

- 1.5 FEET SEDIMENT REMOVAL DEPTH
- 2 FEET SEDIMENT REMOVAL DEPTH
- 2.5 FEET SEDIMENT REMOVAL DEPTH
- ADDITIONAL EXCAVATION TO OCCUR IN CONJUNCTION WITH EAST ST. AREA 2 SOURCE CONTROL ACTIVITIES (REFER TO TABLE FOR EXCAVATION ELEVATIONS)
- 1 FOOT BANK SOIL REMOVAL DEPTH
- 2 FEET BANK SOIL REMOVAL DEPTH
- 3 FEET BANK SOIL REMOVAL DEPTH
- NON-TSCA/NON-RCRA SOIL/SEDIMENT POLYGON
- AREA SUBJECT TO BANK STABILIZATION ACTIVITIES
- EPA BANK SAMPLE LOCATION (AUGUST - SEPTEMBER 1998) /PCB DATA (IN ppm)
- OTHER BANK SAMPLE LOCATION/PCB DATA (IN ppm)
- EPA SEDIMENT SAMPLE LOCATION (AUGUST - OCTOBER 1998)/PCB DATA (IN ppm)
- OTHER SEDIMENT SAMPLE LOCATION/PCB DATA (IN ppm)
- SOURCE CONTROL RELATED SAMPLE LOCATION (APRIL 1999)/ PCB DATA (IN ppm)
- CONTAINMENT BARRIER LOCATION
- 0'-1' BANK SOIL POLYGON
- 1'-3' BANK SOIL POLYGON
- TOP OF BANK
- BANK SOIL AREA BOUNDARY
- CAP AND ARMOR TIE-IN BUFFER
- SECTION LOCATION

NOTES:

1. MAPPING IS BEST AVAILABLE INFORMATION AS OF 12/10/98 BASED ON MAPPING PROVIDED BY LOCKWOOD MAPPING, INC. PREPARED FROM 1990 AERIAL PHOTOGRAPHY; DATA PROVIDED BY GENERAL ELECTRIC; AND BLASLAND AND BOUCK, P.C. CONSTRUCTION PLANS. RIVERBANK AND RIVER BED TOPOGRAPHIC INFORMATION PROVIDED BBL FROM OCTOBER 12-23, 1998 FIELD SURVEY.
2. COORDINATE GRID BASED ON 1927 STATE PLAN COORDINATES.
3. ELEVATION DATUM REFERENCED TO NGVD 1929.
4. BANK SOIL POLYGONS SL0153, SL0166, SL0187, SL0233, SL0093, SL0466 AND SL0475 ARE REMOVED BASED ON THE APPENDIX IX+3 EVALUATION.

NOTES: - CONT'D

5. NON-TSCA/NON-RCRA CLASSIFICATION FOR SOIL/SEDIMENT TO BE REMOVED BASED ON:
  - A. THE AVERAGE PCB CONCENTRATION DETECTED WITHIN THE REMOVAL DEPTH INTERVAL OF A POLYGON IS LESS THAN 50PPM (NON-TSCA); AND
  - B. THE MAXIMUM POSSIBLE TCLP EXTRACT CONCENTRATION OF EACH APPENDIX IX+3 CONSTITUENT DETECTED WITHIN THE REMOVAL DEPTH INTERVAL OF A POLYGON (CALCULATED BY DIVIDING THE TOTAL CONSTITUENT CONCENTRATION BY A DILUTION FACTOR OF 20) IS LESS THAN ITS RESPECTIVE RCRA TOXICITY CHARACTERISTIC REGULATORY LEVEL (I.E., IT IS NON-RCRA). BASED ON THIS EVALUATION, NON-TSCA POLYGON SOILS/SEDIMENTS CLASSIFIED AS RCRA ARE: SL0153 AND SL0181; (SOILS); AND SD0481 AND SD0312 (SEDIMENTS).

SECTION	ELEVATION OF FINAL EXCAVATION
<b>A</b>	<b>969.5</b>
<b>B</b>	<b>969.0</b>
<b>C</b>	<b>968.0</b>
<b>D</b>	<b>967.5</b>

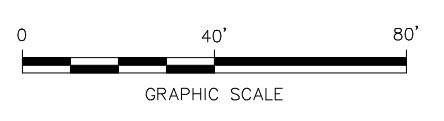

**GENERAL ELECTRIC COMPANY  
PITTSFIELD, MASSACHUSETTS  
REMOVAL ACTION WORK PLAN -  
UPPER 1/2-MILE REACH OF HOUSATONIC RIVER**

**SEDIMENT AND BANK SOIL SAMPLE LOCATIONS,  
PCB RESULTS AND PROPOSED REMOVAL AREAS  
SECTION 1**

X 20197X1A.DWG, 20197X1B.DWG, 20197X02.DWG, 20197X03.DWG, 20197X06.DWG, 20197X07.DWG  
L: ON=+ OFF=REF+  
P: STD DLPCP  
6/25/99 SYR-54-NES YCC MAD  
20197030/B15A.DWG

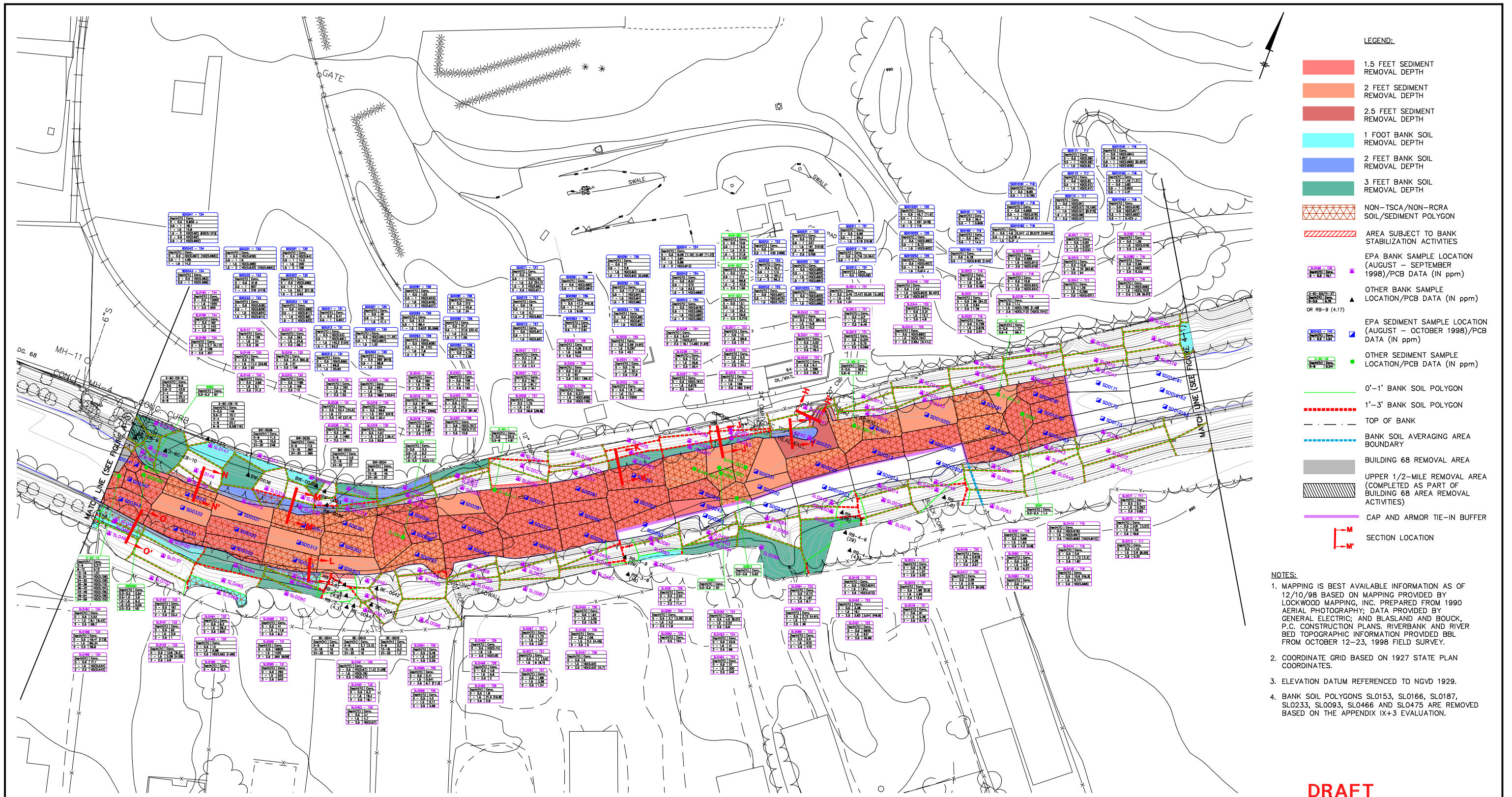

**LEGEND:**

- 1.5 FEET SEDIMENT REMOVAL DEPTH
- 2 FEET SEDIMENT REMOVAL DEPTH
- 2.5 FEET SEDIMENT REMOVAL DEPTH
- 1 FOOT BANK SOIL REMOVAL DEPTH
- 2 FEET BANK SOIL REMOVAL DEPTH
- 3 FEET BANK SOIL REMOVAL DEPTH
- NON-TSCA/NON-RCRA SOIL/SEDIMENT POLYGON
- AREA SUBJECT TO BANK STABILIZATION ACTIVITIES
- EPA BANK SAMPLE LOCATION (AUGUST - SEPTEMBER 1998)/PCB DATA (IN ppm)
- OTHER BANK SAMPLE LOCATION/PCB DATA (IN ppm) OR RB-9 (4.17)
- EPA SEDIMENT SAMPLE LOCATION (AUGUST - OCTOBER 1998)/PCB DATA (IN ppm)
- OTHER SEDIMENT SAMPLE LOCATION/PCB DATA (IN ppm)
- 0'-1' BANK SOIL POLYGON
- 1'-3' BANK SOIL POLYGON
- TOP OF BANK
- BANK SOIL AVERAGING AREA BOUNDARY
- BUILDING 68 REMOVAL AREA
- UPPER 1/2-MILE REMOVAL AREA (COMPLETED AS PART OF BUILDING 68 AREA REMOVAL ACTIVITIES)
- CAP AND ARMOR TIE-IN BUFFER
- SECTION LOCATION

**NOTES:**

1. MAPPING IS BEST AVAILABLE INFORMATION AS OF 12/10/98 BASED ON MAPPING PROVIDED BY LOCKWOOD MAPPING, INC. PREPARED FROM 1990 AERIAL PHOTOGRAPHY; DATA PROVIDED BY GENERAL ELECTRIC; AND BLASLAND AND BOUCK, P.C. CONSTRUCTION PLANS. RIVERBANK AND RIVER BED TOPOGRAPHIC INFORMATION PROVIDED BBL FROM OCTOBER 12-23, 1998 FIELD SURVEY.
2. COORDINATE GRID BASED ON 1927 STATE PLAN COORDINATES.
3. ELEVATION DATUM REFERENCED TO NGVD 1929.
4. BANK SOIL POLYGONS SL0153, SL0166, SL0187, SL0233, SL0093, SL0466 AND SL0475 ARE REMOVED BASED ON THE APPENDIX IX+3 EVALUATION.

**NOTES: - CONT'D**

5. NON-TSCA/NON-RCRA CLASSIFICATION FOR SOIL/SEDIMENT TO BE REMOVED BASED ON:
  - A. THE AVERAGE PCB CONCENTRATION DETECTED WITHIN THE REMOVAL DEPTH INTERVAL OF A POLYGON IS LESS THAN 50PPM (NON-TSCA); AND
  - B. THE MAXIMUM POSSIBLE TCLP EXTRACT CONCENTRATION OF EACH APPENDIX IX+3 CONSTITUENT DETECTED WITHIN THE REMOVAL DEPTH INTERVAL OF A POLYGON (CALCULATED BY DIVIDING THE TOTAL CONSTITUENT CONCENTRATION BY A DILUTION FACTOR OF 20) IS LESS THAN ITS RESPECTIVE RCRA TOXICITY CHARACTERISTIC REGULATORY LEVEL (I.E., IT IS NON-RCRA). BASED ON THIS EVALUATION, NON-TSCA POLYGON SOILS/SEDIMENTS CLASSIFIED AS RCRA ARE: SL0153 AND SL0181; (SOILS); AND SD0481 AND SD0312 (SEDIMENTS).

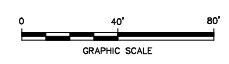

X: 20197X1A.DWG, 20197X1B.DWG, 20197X02.DWG, 20197X03.DWG, 20197X06.DWG, 20197X07.DWG  
 L: ON= OFF=REF=  
 P: STD DL\_PCP  
 6/25/99 SYR-54-NES DMW MAD  
 20197030/B14A.DWG

**DRAFT**

**GENERAL ELECTRIC COMPANY  
 PITTSFIELD, MASSACHUSETTS  
 REMOVAL ACTION WORK PLAN -  
 UPPER 1/2-MILE REACH OF HOUSATONIC RIVER**

**SEDIMENT AND BANK SOIL SAMPLE LOCATIONS,  
 PCB RESULTS AND PROPOSED REMOVAL AREAS  
 SECTION 2**

**BBL** BLASLAND, BOUCK & LEE, INC.  
*engineers & scientists*

**FIGURE  
 4-2**

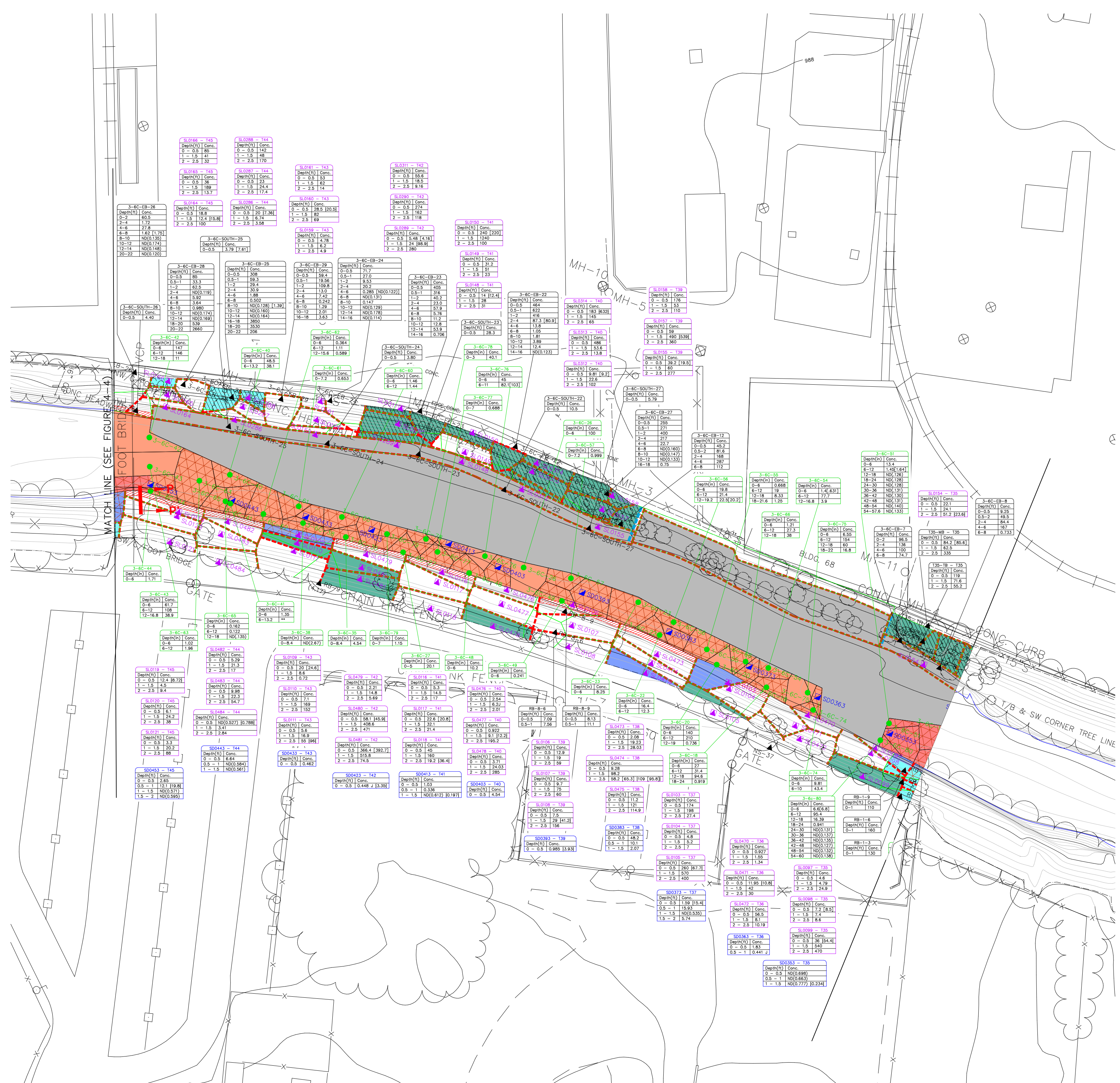

- LEGEND:**
- 1.5 FEET SEDIMENT REMOVAL DEPTH
  - 2 FEET SEDIMENT REMOVAL DEPTH
  - 2.5 FEET SEDIMENT REMOVAL DEPTH
  - 1 FOOT BANK SOIL REMOVAL DEPTH
  - 2 FEET BANK SOIL REMOVAL DEPTH
  - 3 FEET BANK SOIL REMOVAL DEPTH
  - NON-TSCA/NON-RCRA SOIL/SEDIMENT POLYGON
  - AREA SUBJECT TO BANK STABILIZATION ACTIVITIES
  - EPA BANK SAMPLE LOCATION (AUGUST – SEPTEMBER 1998) /PCB DATA (IN ppm)
  - OTHER BANK SAMPLE LOCATION/PCB DATA (IN ppm) OR RB-9 (4.17)
  - EPA SEDIMENT SAMPLE LOCATION (AUGUST – OCTOBER 1998)/PCB DATA (IN ppm)
  - OTHER SEDIMENT SAMPLE LOCATION/PCB DATA (IN ppm)
  - 0'-1' BANK SOIL POLYGON
  - 1'-3' BANK SOIL POLYGON
  - TOP OF BANK
  - BUILDING 68 REMOVAL AREA
  - UPPER 1/2-MILE REMOVAL AREA (COMPLETED AS PART OF BUILDING 68 AREA REMOVAL ACTIVITIES)
  - SECTION LOCATION

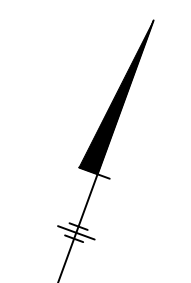

- NOTES:**
1. MAPPING IS BEST AVAILABLE INFORMATION AS OF 12/10/98 BASED ON MAPPING PROVIDED BY LOCKWOOD MAPPING, INC. PREPARED FROM 1990 AERIAL PHOTOGRAPHY; DATA PROVIDED BY GENERAL ELECTRIC; AND BLASLAND AND BOUCK, P.C. CONSTRUCTION PLANS, RIVERBANK AND RIVER BED TOPOGRAPHIC INFORMATION PROVIDED BBL FROM OCTOBER 12-23, 1998 FIELD SURVEY.
  2. COORDINATE GRID BASED ON 1927 STATE PLAN COORDINATES.
  3. ELEVATION DATUM REFERENCED TO NGVD 1929.
  4. BANK SOIL POLYGONS SLO153, SLO166, SLO187, SLO233, SLO093, SLO466 AND SLO475 ARE REMOVED BASED ON THE APPENDIX IX+3 EVALUATION.

- NOTES: - CONT'D**
5. NON-TSCA/NON-RCRA CLASSIFICATION FOR SOIL/SEDIMENT TO BE REMOVED BASED ON:
    - A. THE AVERAGE PCB CONCENTRATION DETECTED WITHIN THE REMOVAL DEPTH INTERVAL OF A POLYGON IS LESS THAN 50PPM (NON-TSCA); AND
    - B. THE MAXIMUM POSSIBLE TCLP EXTRACT CONCENTRATION OF EACH APPENDIX IX+3 CONSTITUENT DETECTED WITHIN THE REMOVAL DEPTH INTERVAL OF A POLYGON (CALCULATED BY DIVIDING THE TOTAL CONSTITUENT CONCENTRATION BY A DILUTION FACTOR OF 20) IS LESS THAN ITS RESPECTIVE RCRA TOXICITY CHARACTERISTIC REGULATORY LEVEL (I.E., IT IS NON-RCRA). BASED ON THIS EVALUATION, NON-TSCA POLYGON SOILS/SEDIMENTS CLASSIFIED AS RCRA ARE: SLO153 AND SLO181; (SOILS); AND SD0481 AND SD0312 (SEDIMENTS).

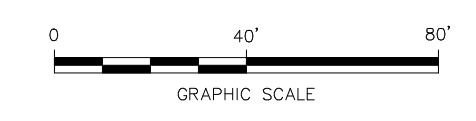

**GENERAL ELECTRIC COMPANY  
PITTSFIELD, MASSACHUSETTS  
REMOVAL ACTION WORK PLAN -  
UPPER 1/2-MILE REACH OF HOUSATONIC RIVER**

**SEDIMENT AND BANK SOIL SAMPLE LOCATIONS,  
PCB RESULTS AND PROPOSED REMOVAL AREAS  
SECTION 3**

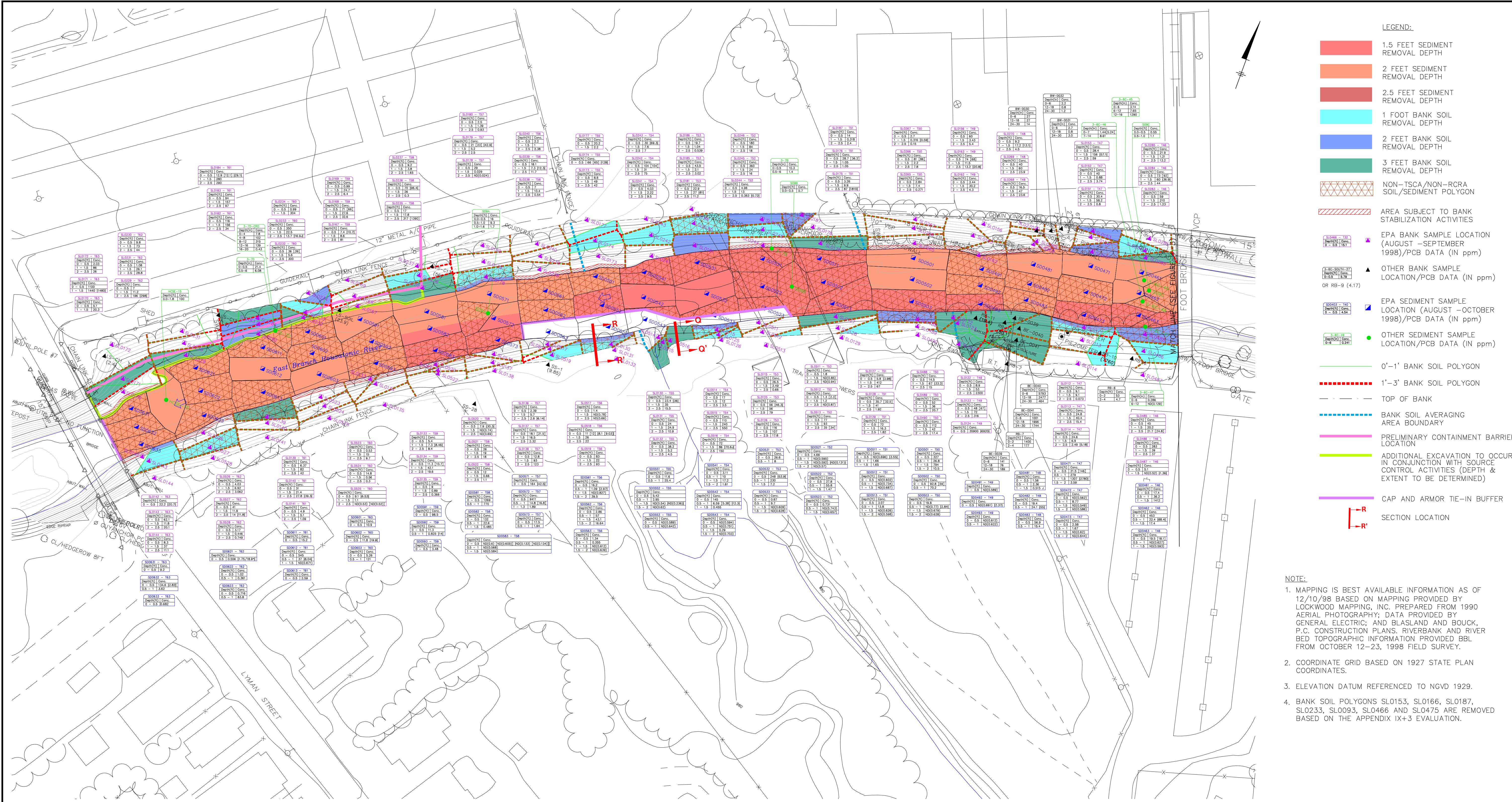

- LEGEND:**
- 1.5 FEET SEDIMENT REMOVAL DEPTH
  - 2 FEET SEDIMENT REMOVAL DEPTH
  - 2.5 FEET SEDIMENT REMOVAL DEPTH
  - 1 FOOT BANK SOIL REMOVAL DEPTH
  - 2 FEET BANK SOIL REMOVAL DEPTH
  - 3 FEET BANK SOIL REMOVAL DEPTH
  - NON-TSCA/NON-RCRA SOIL/SEDIMENT POLYGON
  - AREA SUBJECT TO BANK STABILIZATION ACTIVITIES
  - EPA BANK SAMPLE LOCATION (AUGUST –SEPTEMBER 1998)/PCB DATA (IN ppm)
  - OTHER BANK SAMPLE LOCATION/PCB DATA (IN ppm) OR RB-9 (4.17)
  - EPA SEDIMENT SAMPLE LOCATION (AUGUST –OCTOBER 1998)/PCB DATA (IN ppm)
  - OTHER SEDIMENT SAMPLE LOCATION/PCB DATA (IN ppm)
  - 0'-1' BANK SOIL POLYGON
  - 1'-3' BANK SOIL POLYGON
  - TOP OF BANK
  - BANK SOIL AVERAGING AREA BOUNDARY
  - PRELIMINARY CONTAINMENT BARRIER LOCATION
  - ADDITIONAL EXCAVATION TO OCCUR IN CONJUNCTION WITH SOURCE CONTROL ACTIVITIES (DEPTH & EXTENT TO BE DETERMINED)
  - CAP AND ARMOR TIE-IN BUFFER
  - SECTION LOCATION

- NOTE:**
1. MAPPING IS BEST AVAILABLE INFORMATION AS OF 12/10/98 BASED ON MAPPING PROVIDED BY LOCKWOOD MAPPING, INC. PREPARED FROM 1990 AERIAL PHOTOGRAPHY; DATA PROVIDED BY GENERAL ELECTRIC; AND BLASLAND AND BOUCK, P.C. CONSTRUCTION PLANS, RIVERBANK AND RIVER BED TOPOGRAPHIC INFORMATION PROVIDED BBL FROM OCTOBER 12-23, 1998 FIELD SURVEY.
  2. COORDINATE GRID BASED ON 1927 STATE PLAN COORDINATES.
  3. ELEVATION DATUM REFERENCED TO NGVD 1929.
  4. BANK SOIL POLYGONS SLO153, SLO166, SLO187, SLO233, SLO093, SLO466 AND SLO475 ARE REMOVED BASED ON THE APPENDIX IX+3 EVALUATION.

- NOTES: - CONT'D**
5. NON-TSCA/NON-RCRA CLASSIFICATION FOR SOIL/SEDIMENT TO BE REMOVED BASED ON:
    - A. THE AVERAGE PCB CONCENTRATION DETECTED WITHIN THE REMOVAL DEPTH INTERVAL OF A POLYGON IS LESS THAN 50PPM (NON-TSCA); AND
    - B. THE MAXIMUM POSSIBLE TCLP EXTRACT CONCENTRATION OF EACH APPENDIX IX+3 CONSTITUENT DETECTED WITHIN THE REMOVAL DEPTH INTERVAL OF A POLYGON (CALCULATED BY DIVIDING THE TOTAL CONSTITUENT CONCENTRATION BY A DILUTION FACTOR OF 20) IS LESS THAN ITS RESPECTIVE RCRA TOXICITY CHARACTERISTIC REGULATORY LEVEL (I.E., IT IS NON-RCRA). BASED ON THIS EVALUATION, NON-TSCA POLYGON SOILS/SEDIMENTS CLASSIFIED AS RCRA ARE: SLO153 AND SLO181; (SOILS); AND SD0481 AND SD0312 (SEDIMENTS).

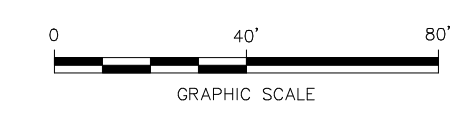

**GENERAL ELECTRIC COMPANY  
PITTSFIELD, MASSACHUSETTS  
REMOVAL ACTION WORK PLAN -  
UPPER 1/2-MILE REACH OF HOUSATONIC RIVER**

**SEDIMENT AND BANK SOIL SAMPLE LOCATIONS,  
PCB RESULTS AND PROPOSED REMOVAL AREAS  
SECTION 4**

BLASLAND, BOUCK & LEE, INC.  
*engineers & scientists*

**FIGURE  
4-4**

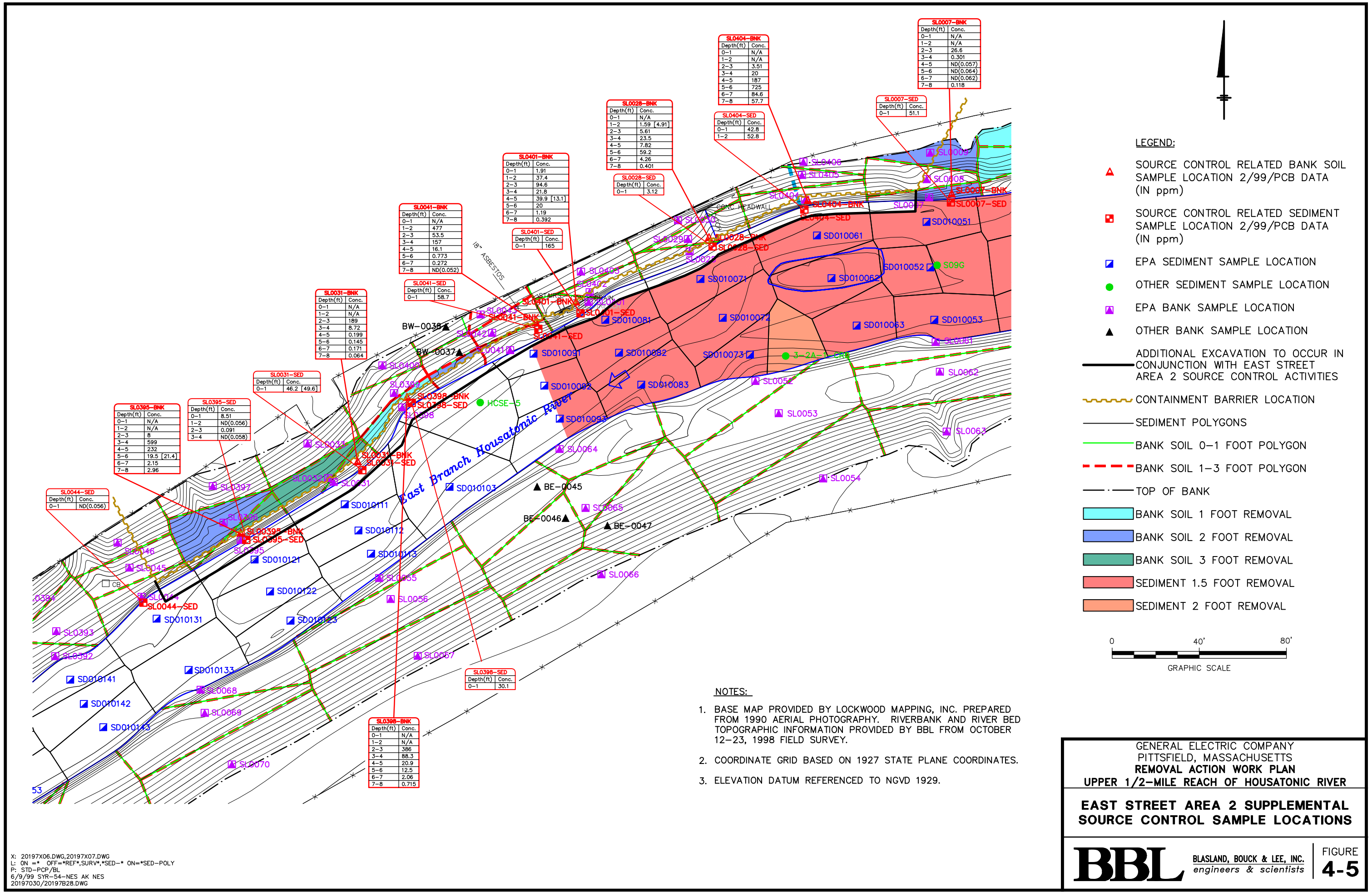

- LEGEND:**
- ▲ SOURCE CONTROL RELATED BANK SOIL SAMPLE LOCATION 2/99/PCB DATA (IN ppm)
  - SOURCE CONTROL RELATED SEDIMENT SAMPLE LOCATION 2/99/PCB DATA (IN ppm)
  - EPA SEDIMENT SAMPLE LOCATION
  - OTHER SEDIMENT SAMPLE LOCATION
  - ▲ EPA BANK SAMPLE LOCATION
  - ▲ OTHER BANK SAMPLE LOCATION

- ADDITIONAL EXCAVATION TO OCCUR IN CONJUNCTION WITH EAST STREET AREA 2 SOURCE CONTROL ACTIVITIES
- CONTAINMENT BARRIER LOCATION
- SEDIMENT POLYGONS
- BANK SOIL 0-1 FOOT POLYGON
- BANK SOIL 1-3 FOOT POLYGON
- TOP OF BANK
- BANK SOIL 1 FOOT REMOVAL
- BANK SOIL 2 FOOT REMOVAL
- BANK SOIL 3 FOOT REMOVAL
- SEDIMENT 1.5 FOOT REMOVAL
- SEDIMENT 2 FOOT REMOVAL

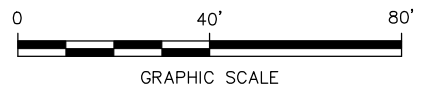

- NOTES:**
1. BASE MAP PROVIDED BY LOCKWOOD MAPPING, INC. PREPARED FROM 1990 AERIAL PHOTOGRAPHY. RIVERBANK AND RIVER BED TOPOGRAPHIC INFORMATION PROVIDED BY BBL FROM OCTOBER 12-23, 1998 FIELD SURVEY.
  2. COORDINATE GRID BASED ON 1927 STATE PLANE COORDINATES.
  3. ELEVATION DATUM REFERENCED TO NGVD 1929.

GENERAL ELECTRIC COMPANY  
 PITTSFIELD, MASSACHUSETTS  
**REMOVAL ACTION WORK PLAN**  
 UPPER 1/2-MILE REACH OF HOUSATONIC RIVER  
**EAST STREET AREA 2 SUPPLEMENTAL  
 SOURCE CONTROL SAMPLE LOCATIONS**

X: 20197X06.DWG,20197X07.DWG  
 L: ON =\* OFF=\*REF\*,SURV\*,\*SED=\* ON=\*SED-POLY  
 P: STD-PCF/BL  
 6/9/99 SYR-54-NES AK NES  
 20197030/20197B28.DWG



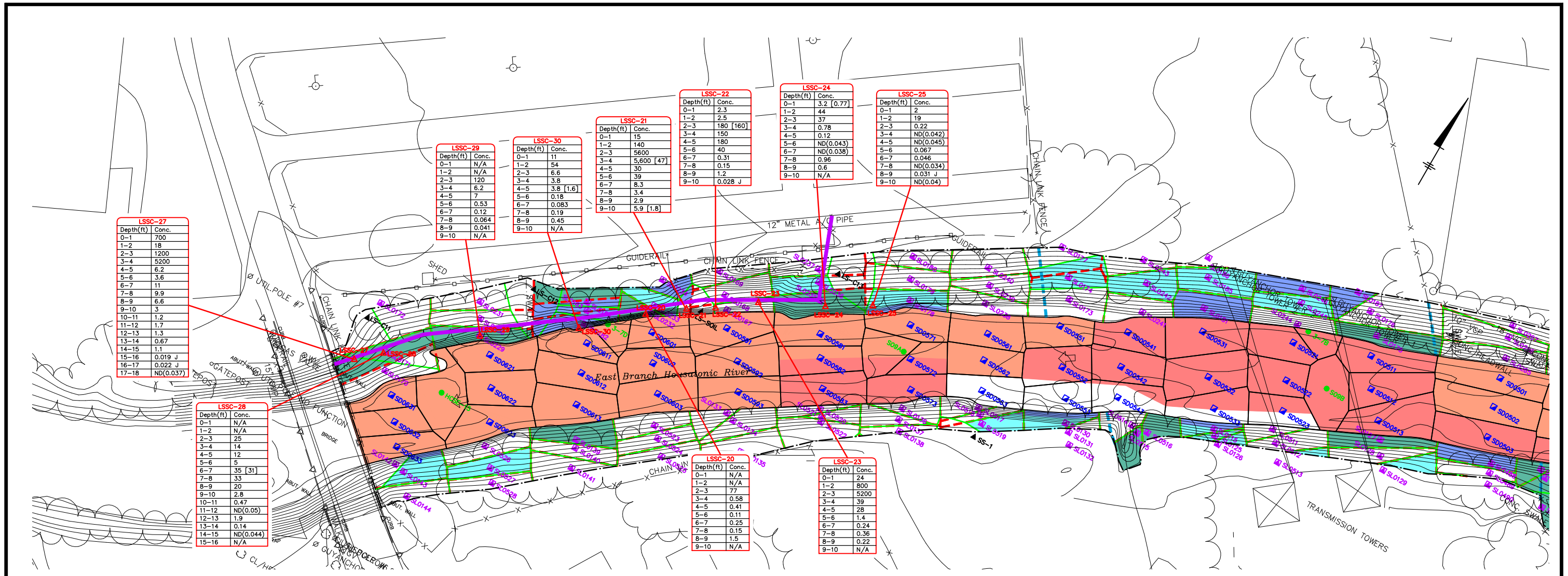

Depth(ft)	Conc.
0-1	700
1-2	18
2-3	1200
3-4	5200
4-5	6.2
5-6	3.6
6-7	11
7-8	9.9
8-9	6.6
9-10	3
10-11	1.2
11-12	1.7
12-13	1.3
13-14	0.67
14-15	1.1
15-16	0.019 J
16-17	0.022 J
17-18	ND(0.037)

Depth(ft)	Conc.
0-1	N/A
1-2	N/A
2-3	25
3-4	14
4-5	12
5-6	5
6-7	35 [31]
7-8	33
8-9	20
9-10	2.8
10-11	0.47
11-12	ND(0.05)
12-13	1.9
13-14	0.14
14-15	ND(0.044)
15-16	N/A

Depth(ft)	Conc.
0-1	N/A
1-2	N/A
2-3	120
3-4	6.2
4-5	7
5-6	0.53
6-7	0.12
7-8	0.064
8-9	0.041
9-10	N/A

Depth(ft)	Conc.
0-1	11
1-2	54
2-3	6.6
3-4	3.8
4-5	3.8 [1.6]
5-6	0.18
6-7	0.083
7-8	0.19
8-9	0.45
9-10	N/A

Depth(ft)	Conc.
0-1	15
1-2	140
2-3	5600 [47]
3-4	30
4-5	180
5-6	40
6-7	0.31
7-8	0.15
8-9	1.2
9-10	0.028 J

Depth(ft)	Conc.
0-1	2.3
1-2	2.5
2-3	180 [160]
3-4	150
4-5	180
5-6	40
6-7	0.31
7-8	0.15
8-9	1.2
9-10	0.028 J

Depth(ft)	Conc.
0-1	3.2 [0.77]
1-2	44
2-3	37
3-4	0.78
4-5	0.12
5-6	ND(0.043)
6-7	ND(0.038)
7-8	0.96
8-9	0.6
9-10	N/A

Depth(ft)	Conc.
0-1	2
1-2	19
2-3	0.22
3-4	ND(0.042)
4-5	ND(0.045)
5-6	0.067
6-7	0.046
7-8	ND(0.034)
8-9	0.031 J
9-10	ND(0.04)

Depth(ft)	Conc.
0-1	N/A
1-2	N/A
2-3	77
3-4	0.58
4-5	0.41
5-6	0.11
6-7	0.25
7-8	0.15
8-9	1.5
9-10	N/A

Depth(ft)	Conc.
0-1	24
1-2	800
2-3	5200
3-4	39
4-5	28
5-6	1.4
6-7	0.24
7-8	0.36
8-9	0.22
9-10	N/A

- LEGEND:**
- ▲ SOURCE CONTROL RELATED BANK SOIL SAMPLE LOCATION 4/99/PCB DATA (IN ppm)
  - EPA SEDIMENT SAMPLE LOCATION
  - OTHER SEDIMENT SAMPLE LOCATION
  - EPA BANK SAMPLE LOCATION
  - ▲ OTHER BANK SAMPLE LOCATION
  - PRELIMINARY CONTAINMENT BARRIER LOCATION
  - SEDIMENT POLYGONS
  - BANK SOIL 0-1 FOOT POLYGON
  - BANK SOIL 1-3 FOOT POLYGON
  - TOP OF BANK

- BANK SOIL 1 FOOT REMOVAL
- BANK SOIL 2 FOOT REMOVAL
- BANK SOIL 3 FOOT REMOVAL
- SEDIMENT 1.5 FOOT REMOVAL
- SEDIMENT 2 FOOT REMOVAL

- NOTES:**
- MAPPING IS BEST AVAILABLE INFORMATION AS OF 12/10/98 BASED ON MAPPING PROVIDED BY LOCKWOOD MAPPING, INC. PREPARED FROM 1990 AERIAL PHOTOGRAPHY; DATA PROVIDED BY GENERAL ELECTRIC; AND BLASLAND AND BOUCK ENGINEERS, PC. CONSTRUCTION PLANS. RIVERBANK AND RIVER BED TOPOGRAPHIC INFORMATION PROVIDED BY BBL FROM OCTOBER 12-23, 1998 FIELD SURVEY.
  - COORDINATE GRID BASED ON 1927 STATE PLANE COORDINATES.
  - ELEVATION DATUM REFERENCED TO NGVD 1929.

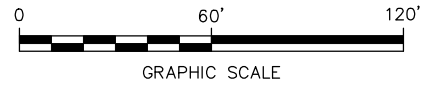

GENERAL ELECTRIC COMPANY  
PITTSFIELD, MASSACHUSETTS  
**REMOVAL ACTION WORK PLAN**  
UPPER 1/2-MILE REACH OF HOUSATONIC RIVER





**LYMAN STREET PARKING LOT**  
**SOURCE CONTROL SAMPLE LOCATIONS**

**BBL** BLASLAND, BOUCK & LEE, INC.  
engineers & scientists

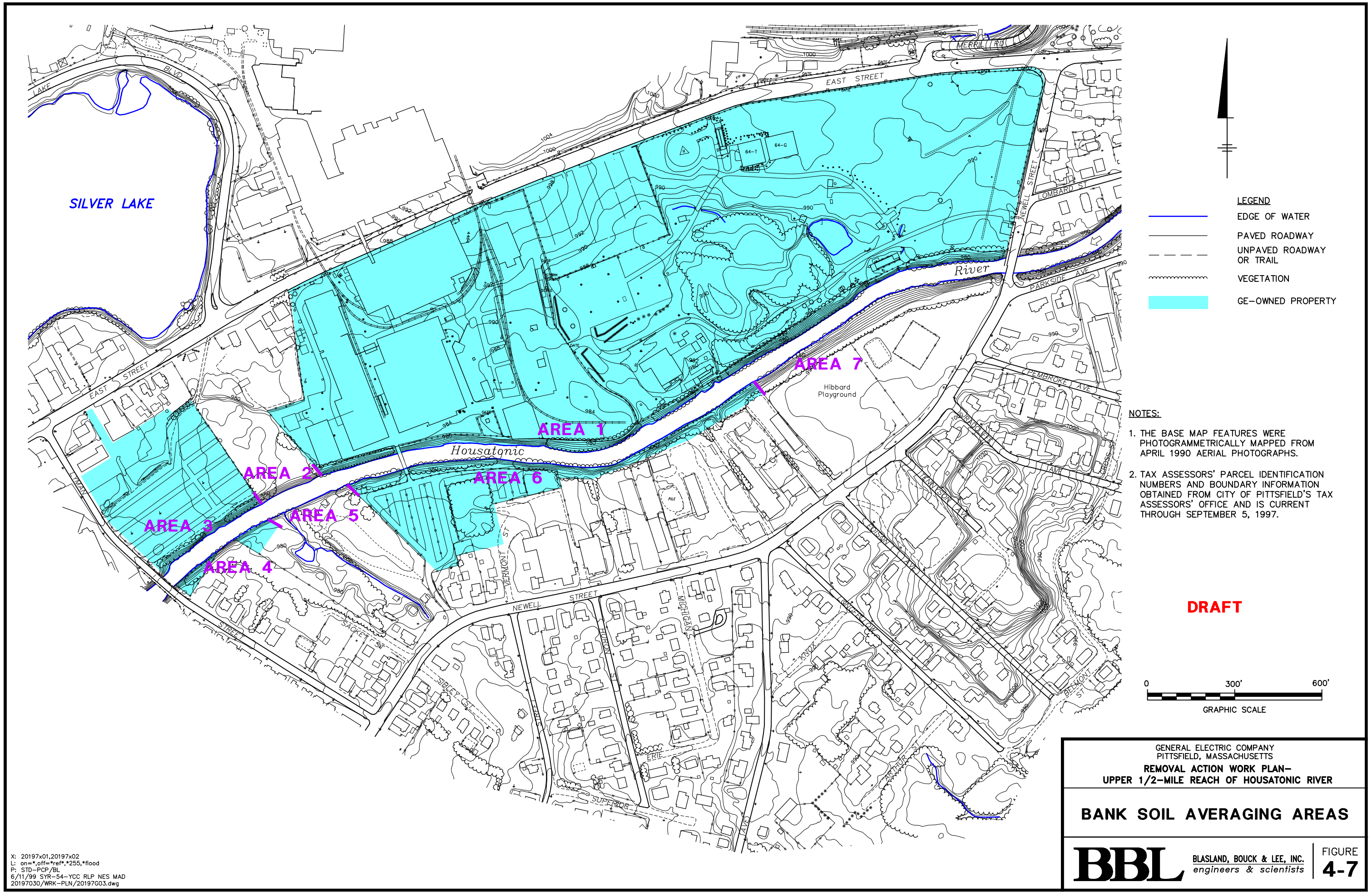
FIGURE  
**4-6**

X: 20197X06.DWG,20197X07.DWG  
L: ON=\* OFF=\*REF\*,SURV\*,\*SED-\* ON=\*SED-POLY  
P: STD-PCF/BL  
6/9/99 SYR-54-RLP JMS NES  
20197030/20197B29.DWG



- LEGEND**
-  EDGE OF WATER
  -  PAVED ROADWAY
  -  UNPAVED ROADWAY OR TRAIL
  -  VEGETATION
  -  GE-OWNED PROPERTY

- NOTES:**
1. THE BASE MAP FEATURES WERE PHOTOGRAMMETRICALLY MAPPED FROM APRIL 1990 AERIAL PHOTOGRAPHS.
  2. TAX ASSESSORS' PARCEL IDENTIFICATION NUMBERS AND BOUNDARY INFORMATION OBTAINED FROM CITY OF PITTSFIELD'S TAX ASSESSORS' OFFICE AND IS CURRENT THROUGH SEPTEMBER 5, 1997.

**DRAFT**

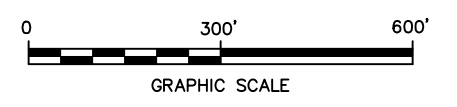

GENERAL ELECTRIC COMPANY  
PITTSFIELD, MASSACHUSETTS

**REMOVAL ACTION WORK PLAN—  
UPPER 1/2-MILE REACH OF HOUSATONIC RIVER**

---

**BANK SOIL AVERAGING AREAS**

---

**BBL** BLASLAND, BOUCK & LEE, INC.  
engineers & scientists

**FIGURE  
4-7**

X: 20197x01,20197x02  
L: on=\*off=\*ref\*,\*255,\*flood  
P: STD=PCP/BL  
6/11/99 SYR-54-YCC RLP NES MAD  
20197030/WRK-PLN/20197G03.dwg