



Corporate Environmental Programs  
General Electric Company  
100 Woodlawn Avenue, Pittsfield, MA 01201

*Transmitted Via Federal Express*

June 29, 2001

Bryan Olson  
EPA Project Coordinator  
U.S. Environmental Protection Agency  
EPA New England  
One Congress Street, Suite 1100  
Boston, Massachusetts 02114-2023

**Re: GE-Pittsfield/Housatonic River Site  
Newell Street Area I (GECD440)  
Supplement to Pre-Design Investigation Report**

Dear Mr. Olson:

At your request, General Electric's consultants have prepared a set of two figures showing all soil PCB data at Newell Street Area I that will be used (subject to data validation/assessment) in the response action evaluations for this area. Copies of these figures are enclosed as a supplement to GE's *Pre-Design Investigation Report for Newell Street Area I Removal Action* (Pre-Design Report), which was submitted to EPA on May 15, 2001. The PCB data shown on these figures include the results from GE's recent pre-design soil investigations, the prior GE soil sampling results that are considered usable for conducting response action evaluations (as described in the Pre-Design Report), and the results that have been transmitted to GE by EPA from EPA's soil sampling at this area.

As you also requested, we are sending copies of these figures to the owners of the non-GE-owned properties at Newell Street Area I, and we are informing those owners that we have extended until July 31, 2001, the date by which they must notify us of their final decision as to whether they will agree to execute and record a Grant of Environmental Restriction and Easement (ERE) on their properties (except for the City of Pittsfield, which has agreed in the Consent Decree to execute EREs on its properties at the Site subject to that Decree). Correspondingly, consistent with the discussions that you and I have had, GE proposes to extend until 21 days after that date -- i.e., until August 21, 2001 -- the deadline for GE to provide final notification to EPA and the Massachusetts Department of Environmental Protection (MDEP) as to which non-GE property owners at Newell Street Area I have agreed to EREs.

Given this change in the schedule, GE also proposes a revision to the schedule for submission of the Conceptual Removal Action/Removal Design (RD/RA) Work Plan for Newell Street Area I. In the Pre-Design Report, GE proposed to submit that Work Plan within six months after the later of either (a) the final notification regarding EREs or (b) EPA's approval of the Pre-Design Report. As discussed above, at EPA's request, GE has extended the time for property owners to advise GE of their final decision regarding EREs, and has thus proposed a corresponding extension in the deadline for GE to provide the final ERE notification to EPA and MDEP. However, GE has also determined that during that extended period, GE can begin some of the preparatory work for developing a Conceptual RD/RA Work Plan. Accordingly, GE now proposes to submit the Conceptual RD/RA Work Plan for Newell Street Area I within five months after the later of either: (a) the new August 21, 2001 deadline for the final ERE notification to EPA and MDEP; or (b) EPA's approval of the Pre-Design Report (as supplemented with

the enclosed figures). This revised schedule will put the due date for the Conceptual RD/RA Work Plan at approximately the same time as originally proposed, and thus will involve no significant additional delay resulting from the extension of the ERE notification date. In addition, GE continues to anticipate that it will submit by July 16, 2001, the data validation/assessment report on the Newell Street Area I sampling data, as stated in the Pre-Design Report.

Please call me if you have any questions about the enclosed figures or the proposed revised schedule.

Very truly yours,



Richard Gates  
Remediation Project Manager

Enclosures

U:\MEG01\3921199.doc

cc: Tim Conway, EPA  
Holly Inglis, EPA  
Michael Nalipinski, EPA  
K.C. Mitkevicius, USACE  
Dawn Veilleux, Weston  
J. Lyn Cutler, MDEP (2 copies)  
Robert Bell, MDEP (cover letter only)  
Thomas Angus, MDEP (cover letter only)  
Alan Weinberg, MDEP (cover letter only)  
Susan Keydel, MDEP  
Nancy E. Harper, MA AG  
Charles Fredette, CDEP  
Field Supervisor, US F&WS  
Kenneth Finkelstein, NOAA  
Dale Young, MA EOE  
Mayor Gerald Doyle, City of Pittsfield  
Director, PED  
Pittsfield Department of Health

Michael Carroll, GE  
Andrew Silber, GE  
Rod McLaren, GE  
James Nuss, BBL  
James Bieke, Shea & Gardner  
Samuel Gutter, Sidley, Austin, Brown & Wood  
Teresa Bowers, Gradient  
Affected Property Owner - 187 Newell Street  
Affected Property Owner - 203 Newell Street  
Affected Property Owner - 217 Newell Street  
Affected Property Owner - 221, 229, 230 Newell Street  
Affected Property Owner - 247/249 Newell Street  
Affected Property Owner - 269 Newell Street  
Affected Property Owner - 273 Newell Street  
Cristóbal Bonifaz, Esq.  
Public Information Repositories  
GE Internal Repository

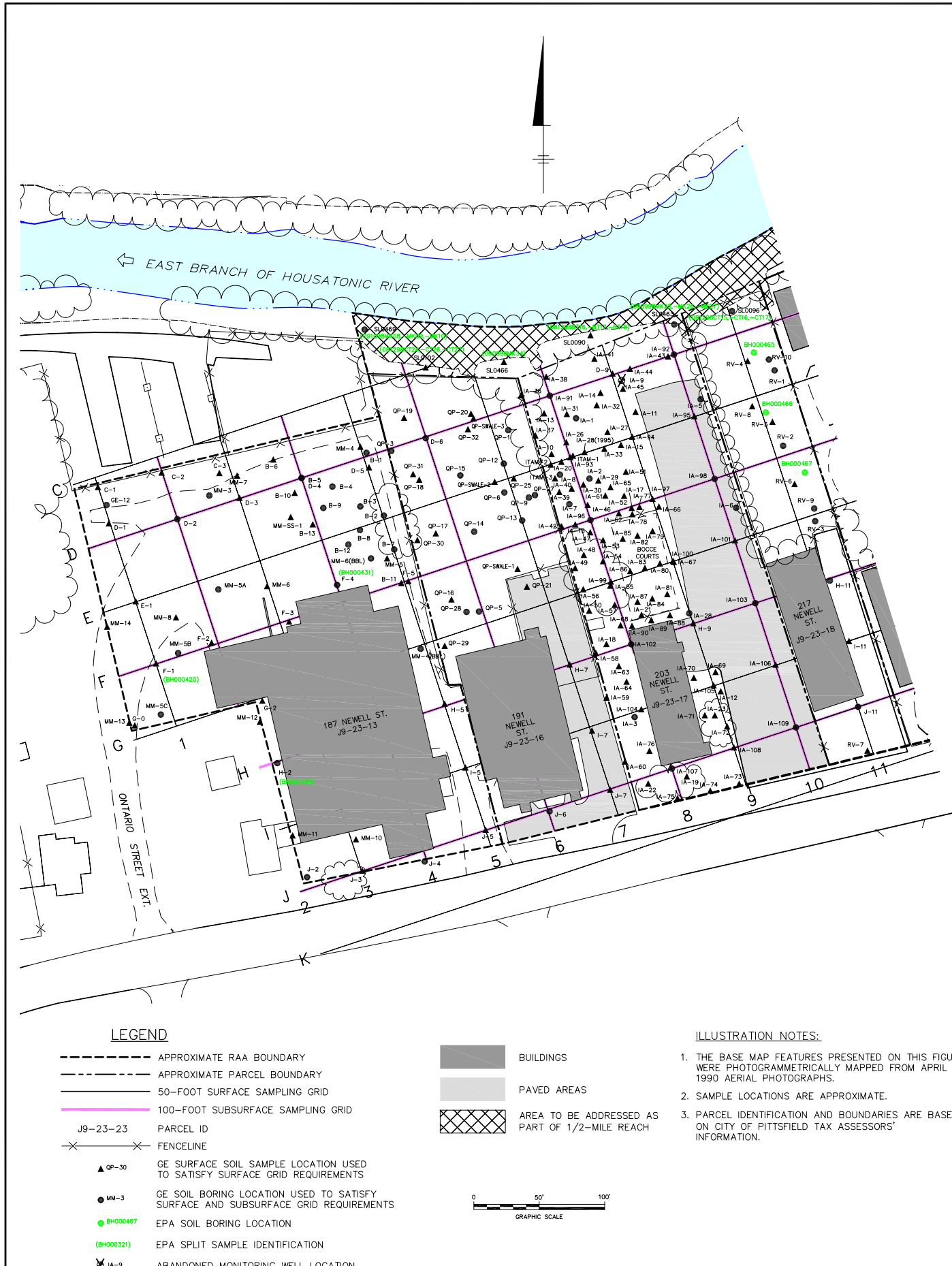

Sample Name	Date	Depth Interval (ft)	Data Usage Type	Total PCBs
<b>Housatonic River Bank (Parcel J9-23-12)</b>				
SLO 090	8/12/98	0-0.5	Grid Char.	250
SLO 090	8/12/98	1-1.5	Supplemental	520
SLO 090	8/12/98	2-2.25	Supplemental	540
SLO 102	8/12/98	0-0.5	Grid Char.	13.6 (9.37)
SLO 102	8/12/98	1-1.5	Supplemental	84
SLO 102	8/12/98	2-2.5	Supplemental	3.9
SLO 469	9/9/98	0-0.5	Grid Char.	15.1
SLO 469	9/10/98	0-0.5	Supplemental	71.1
SLO 469	9/10/98	1-1.5	Supplemental	ND (0.534)
SLO 469	9/10/98	2-2.5	Supplemental	ND (0.542)
<b>187 Newell St. (Parcel J9-23-13)</b>				
B-1	6/21/93	5-7	Supplemental	224
B-2	6/21/93	0-0.5	Grid Char.	6.5
B-3	9/14/93	10-12	Supplemental	2,300
B-4	9/14/93	10-12	Supplemental	2,100
B-5	9/14/93	0-0.5	Grid Char.	0.90
B-6	6/21/93	0-0.5	Supplemental	3.6
B-7	6/21/93	0-0.5	Supplemental	240
B-8	6/21/93	0-0.5	Supplemental	2.5
B-9	9/15/93	8-10	Supplemental	1,100
B-10	9/15/93	0-0.5	Supplemental	3,469.9
B-11	9/15/93	10-12	Supplemental	2,400
B-12	9/15/93	0-0.5	Supplemental	0.60
B-13	9/15/93	10-12	Supplemental	830
B-14	6/21/93	0-0.5	Supplemental	22
B-15	6/21/93	0-0.5	Supplemental	250
B-16	9/15/93	0-0.5	Supplemental	1,110
B-17	9/15/93	0-0.5	Supplemental	150
B-18	9/15/93	0-0.5	Supplemental	2.2
B-19	9/15/93	0-0.5	Supplemental	1,110
B-20	9/15/93	0-0.5	Supplemental	1,110
C-1	3/2/01	0-1	Grid Char.	2.4
C-2	3/2/01	0-1	Grid Char.	1.6
C-3	3/2/01	0-1	Grid Char.	3.5
D-1	3/2/01	0-1	Grid Char.	0.26
D-2	3/2/01	0-1	Grid Char.	0.72
D-3	3/2/01	10-15	Grid Char.	ND(0.039)
D-4	3/2/01	0-1	Grid Char.	0.091
D-5	3/2/01	1-3	Grid Char.	480
D-6	3/2/01	3-6	Grid Char.	245
D-7	3/2/01	10-15	Grid Char.	0.25
E-1	3/2/01	0-1	Grid Char.	0.47
E-2	3/2/01	0-1	Grid Char.	0.25
F-1	3/2/01	0-1	Grid Char.	2.0
F-2	3/2/01	0-1	Grid Char.	0.13
F-3	3/2/01	0-1	Grid Char.	0.1
F-4	3/2/01	1-3	Grid Char.	ND(0.034)
F-5	3/2/01	3-6	Grid Char.	ND(0.037)
F-6	3/2/01	6-10	Grid Char.	ND(0.037)
F-7	3/2/01	10-15	Grid Char.	ND(0.039)
F-8	3/2/01	0-1	Grid Char.	15.5
F-9	3/2/01	0-1	Grid Char.	0.06
GE-12	12/11/91	0-2	Grid Char.	ND(0.05)
GE-12	12/11/91	2-4	Grid Char.	ND(0.05)
GE-12	12/11/91	4-6	Grid Char.	0.06
GE-12	12/11/91	6-8	Grid Char.	ND(0.05)
GE-12	12/11/91	8-10	Grid Char.	ND(0.05)
H-1	3/8/01	0-1	Grid Char.	0.90
H-2	3/8/01	1-3	Grid Char.	ND(0.041)
H-3	3/8/01	3-6	Grid Char.	ND(0.041)
H-4	3/8/01	6-10	Grid Char.	ND(0.039)
H-5	3/8/01	10-15	Grid Char.	ND(0.036)
H-6	3/2/01	0-1	Grid Char.	6.3
H-7	3/2/01	0-1	Grid Char.	0.4
J-1	3/7/01	0-1	Grid Char.	0.44
J-2	3/7/01	1-3	Grid Char.	ND(0.041)
J-3	3/7/01	3-6	Grid Char.	ND(0.036)
J-4	3/7/01	6-10	Grid Char.	ND(0.037)
J-5	3/7/01	10-15	Grid Char.	ND(0.037)
J-6	3/7/01	0-1	Grid Char.	0.26
MM-1	5/4/88	0-2	Supplemental	0.24
MM-2	5/4/88	2-4	Supplemental	0.36
MM-3	5/4/88	4-6	Supplemental	ND(0.05)
MM-4	5/4/88	6-8	Supplemental	0.12
MM-5	5/4/88	8-10	Supplemental	0.10
MM-6	5/4/88	0-0.5	Supplemental	1.7
MM-7	5/4/88	0-0.5	Supplemental	0.66
MM-8	5/8/91	0-0.5	Grid Char.	1.7
MM-9	5/8/91	0-0.5	Grid Char.	1.7
MM-10	5/8/91	0-0.5	Grid Char.	1.7
MM-11	5/8/91	0-0.5	Grid Char.	1.7
MM-12	6/21/93	0-0.5	Grid Char.	0.50
MM-13	6/21/93	0-0.5	Grid Char.	1.5
MM-14	6/21/93	0-0.5	Grid Char.	1.5
MM-4(BBL)	2/25/97	0-2	Supplemental	1.2
MM-4(BBL)	2/25/97	2-4	Supplemental	ND(0.034)
MM-4(BBL)	2/25/97	4-6	Supplemental	ND(0.035)
MM-4(BBL)	2/25/97	6-8	Supplemental	0.037
MM-4(BBL)	2/25/97	8-10	Supplemental	0.036
MM-4(BBL)	2/25/97	10-12	Supplemental	ND(0.039)
MM-4(BBL)	2/25/97	12-14	Supplemental	ND(0.040)
MM-4(BBL)	2/25/97	14-16	Supplemental	ND(0.038)
MM-5A	2/25/97	0-0.5	Supplemental	0.45
MM-5A	2/25/97	0.5-2	Supplemental	ND(0.035)
MM-5A	2/25/97	2-4	Supplemental	ND(0.034)
MM-5A	2/25/97	4-6	Supplemental	ND(0.035)
MM-5A	2/25/97	6-8	Supplemental	ND(0.040)
MM-5A	2/25/97	8-10	Supplemental	ND(0.039)
MM-5B	2/25/97	0-0.5	Supplemental	1.5
MM-5B	2/25/97	0.5-2	Supplemental	1.2
MM-5B	2/25/97	2-4	Grid Char.	ND(0.036)
MM-5B	2/25/97	4-6	Grid Char.	ND(0.037)
MM-5B	2/25/97	6-8	Grid Char.	0.064
MM-5B	2/25/97	8-10	Grid Char.	0.092
MM-5B	2/25/97	10-12	Grid Char.	ND(0.036)
MM-5B	2/25/97	12-14	Grid Char.	ND(0.039)
MM-5B	2/25/97	14-16	Grid Char.	ND(0.039)
MM-5B	2/25/97	16-18	Supplemental	ND(0.039)
MM-5C	2/25/97	0-0.5	Grid Char.	3.8
MM-5C	2/25/97	0.5-2	Supplemental	2.2
MM-5C	2/25/97	2-4	Supplemental	8.6
MM-5C	2/25/97	4-6	Supplemental	1.8
MM-5C	2/25/97	6-8	Supplemental	2.6
MM-5C	2/25/97	8-10	Supplemental	0.21 (0.44)
MM-5C	2/25/97	10-12	Supplemental	1.0
MM-5C	2/25/97	12-14	Supplemental	0.40
MM-5C	2/25/97	14-16	Supplemental	0.18
MM-6(BBL)	2/25/97	0-0.5	Supplemental	0.69
MM-6(BBL)	2/25/97	0.5-2	Supplemental	0.77
MM-6(BBL)	2/25/97	2-4	Supplemental	1.9
MM-6(BBL)	2/25/97	4-6	Supplemental	2.1
MM-6(BBL)	2/25/97	6-8	Supplemental	0.54
MM-6(BBL)	2/25/97	8-10	Supplemental	0.36
MM-6(BBL)	2/25/97	10-12	Supplemental	0.17
MM-6(BBL)	2/25/97	12-14	Supplemental	0.2
MM-6(BBL)	2/25/97	14-16	Supplemental	ND(0.039)
MM-SS-1	2/26/97	0-0.5	Grid Char.	1.0
BH000420	3/2/01	0-1	Grid Char.	0.1(0.19)
BH000431	3/7/01	1-3	Grid Char.	0.047
BH000434	3/8/01	1-3	Grid Char.	0.17
<b>191 Newell St. (Parcel J9-23-16)</b>				
D-6	1/24/01	0-1	Grid Char.	1180
H-7	1/23/01	0-1	Grid Char.	1.8
I-7	1/23/01	0-1	Grid Char.	0.82
J-6	1/23/01	0-1	Grid Char.	0.096
J-6	1/23/01	1-3	Grid Char.	ND(0.036)
J-6	1/23/01	3-6	Grid Char.	ND(0.035)
J-6	1/23/01	6-10	Grid Char.	ND(0.034)
J-6	1/23/01	10-15	Grid Char.	ND(0.036)
J-7	1/23/01	0-1	Grid Char.	ND(0.038)
J-7	1/23/01	0-1	Grid Char.	ND(0.039)

Sample Name	Date	Depth Interval (ft)	Data Usage Type	Total PCBs
<b>203 Newell St. (Parcel J9-23-17) CONTINUED</b>				
IA-1	5/7/87	10-14	Supplemental	ND(0.05)
QP-3	5/7/87	2-4	Grid Char.	360
QP-3	5/7/87	4-6	Grid Char.	110
QP-3	5/7/87	6-8	Grid Char.	84
QP-3	5/7/87	8-10	Grid Char.	130
QP-3	5/7/87	10-12	Grid Char.	6.5
QP-3	5/7/87	12-14	Grid Char.	0.05
QP-5	5/7/87	14-18	Grid Char.	0.29
QP-5	5/7/87	0-2	Grid Char.	ND(0.05)
QP-5	5/7/87	2-4	Supplemental	0.06
QP-5	5/7/87	4-6	Supplemental	410
QP-5	5/7/87	6-8	Supplemental	240
QP-5	5/7/87	8-10	Supplemental	55
QP-5	5/7/87	10-12	Supplemental	0.07
QP-5	5/7/87	12-14	Supplemental	ND(0.05)
QP-6	5/7/87	10-14	Supplemental	0.66
QP-6	5/7/87	6-8	Supplemental	850
QP-9	5/8/87	2-4	Supplemental	120,000
QP-9	5/8/87	4-6	Supplemental	290,000
QP-9	5/8/87	6-8	Supplemental	61
QP-9	5/8/87	8-10	Supplemental	33
QP-9	5/8/87	10-12	Supplemental	60
QP-9	5/8/87	12-14	Supplemental	0.34
QP-12	5/4/87	0-2	Supplemental	350
QP-12	5/4/87	2-4	Supplemental	100
QP-12	5/4/87	4-6	Supplemental	150
QP-12	5/4/87	6-8	Supplemental	300
QP-12	5/4/87	8-10	Supplemental	140
QP-12	5/4/87	10-12	Supplemental	1.70
QP-12	5/4/87	12-14	Supplemental	0.28
QP-13	5/4/87	0-2	Grid Char.	2.9
QP-13	5/4/87	2-4	Supplemental	2.4
QP-13	5/4/87	4-6	Supplemental	ND (0.036)
QP-13	5/4/87	6-8	Supplemental	210
QP-13	5/4/87	10-12	Supplemental	1.4
QP-13	5/4/87	12-14	Supplemental	0.81
QP-14	5/4/87	0-2	Grid Char.	36
QP-14	5/4/87	2-4	Grid Char.	330
QP-14	5/4/87	4-6	Grid Char.	260
QP-14	5/4/87	6-8	Grid Char.	520
QP-14	5/4/87	8-10	Grid Char.	380
QP-14	5/4/87	10-12	Grid Char.	280
QP-14	5/4/87	12-14	Grid Char.	12
QP-15	5/4/87	0-2	Grid Char.	80
QP-15	5/4/87	2-4	Supplemental	290
QP-15	5/4/87	4-6	Supplemental	ND (0.036)
QP-15	5/4/87	6-8	Supplemental	0.19
QP-15	5/4/87	8-10	Supplemental	690
QP-15	5/4/87	10-12	Supplemental	110
QP-15	5/4/87	12-14	Supplemental	0.98
QP-16	5/4/88	0-0.5	Supplemental	2.0
QP-17	5/4/88	0-0.5	Supplemental	4.6
QP-17	5/4/88	0-0.5	Supplemental	110
QP-17	5/4/88	0-0.5	Supplemental	280
QP-17	5/4/88	0-0.5	Supplemental	0.86 (0.13)
QP-20	5/4/88	0-0.5	Supplemental	280
QP-21	12/1/81	0-1	Grid Char.	28
QP-21	12/1/81	1-3	Grid Char.	280
QP-21	12/1/81	3-6	Grid Char.	29,900
QP-27	2/26/97	0-0.5	Supplemental	29,900
QP-27	2/26/97	0-0.5	Supplemental	44
QP-28	2/26/97	0-0.5	Supplemental	6.8
QP-28	2/26/97	0-0.5	Supplemental	16
QP-28	2/26/97	0-0.5	Supplemental	400 (310)
QP-28	2/26/97	0-0.5	Supplemental	198
QP-28	2/26/97	0-0.5	Supplemental	140
QP-28	2/26/97	0-0.5	Supplemental	85

Sample Name	Date	Depth Interval (ft)	Data Usage Type	Total PCBs
Housatonic River Bank (Parcel J9-23-12)				
B-16	2/13/01	1-3	Grid Char.	16.1
B-16	2/13/01	1-3	Grid Char.	21.0
B-16	2/13/01	3-6	Grid Char.	14.3
B-16	2/13/01	6-10	Grid Char.	0.0(0.036)
B-16	2/13/01	10-15	Grid Char.	ND(0.041)
B-18	2/12/01	0-1	Grid Char.	116 [7.6]
B-18	2/12/01	1-3	Grid Char.	11.3
B-18	2/12/01	3-6	Grid Char.	0.123
B-18	2/12/01	6-10	Grid Char.	ND(0.039)
B-18	2/12/01	10-15	Grid Char.	ND(0.040)
C-12	2/9/01	0-1	Grid Char.	6.2
CB-5	12/10/91	0-0.5	Supplemental 1	
SLO 076	8/17/98	0-0.5	Grid Char.	1.1
SLO 076	8/17/98	0-0.5	Supplemental 0.38	
SLO 076	8/17/98	2-2.5	Supplemental 0.118	
SLO 086	8/17/98	0-0.5	Supplemental 5.9	
SLO 086	8/17/98	1-1.5	Supplemental 4.0	
SLO 086	8/17/98	2-2.5	Supplemental 4.70	
SLO 087	8/12/98	0-0.5	Grid Char.	1.68
SLO 087	8/12/98	1-1.5	Supplemental 3.28	
SLO 087	8/12/98	2-2.5	Supplemental 1.24	
SLO 093	8/12/98	0-0.5	Grid Char.	104
SLO 451	9/9/98	0-0.5	Supplemental "5.625"	
SLO 451	9/9/98	1-1.5	Supplemental 6.3	
SLO 451	9/9/98	2-2.5	Supplemental 35.86	
SLO 457	9/9/98	0-0.5	Grid Char.	6
SLO 457	9/9/98	1-1.5	Supplemental ND (0.52)	
SLO 457	9/9/98	2-2.5	Supplemental ND (0.52) [0.7]	
SLO457	2/13/01	1-3	Grid Char.	560
SLO457	2/13/01	3-6	Grid Char.	560
SLO457	2/13/01	6-10	Grid Char.	2.70
SLO457	2/13/01	10-15	Grid Char.	9.2
221-230 Newell St. (Parcel J9-23-19)				
D-12	3/14/01	0-1	Grid Char.	0.63
D-13	3/14/01	1-3	Grid Char.	80
D-13	3/14/01	3-6	Grid Char.	510
D-13	3/14/01	6-10	Grid Char.	8.1
D-13	3/14/01	10-15	Grid Char.	0.51
D-14	3/9/01	1-3	Grid Char.	7.4
D-14	3/9/01	3-6	Grid Char.	100
D-14	3/9/01	6-10	Grid Char.	180
D-14	3/9/01	10-15	Grid Char.	32
D-15	3/13/01	0-1	Grid Char.	2.3
E-13	3/13/01	0-1	Grid Char.	0.50
F-13	3/13/01	0-1	Grid Char.	7.2
F-14	3/14/01	0-1	Grid Char.	4.7
F-14	3/14/01	1-3	Grid Char.	6.5
F-14	3/14/01	3-6	Grid Char.	1000
F-14	3/14/01	6-10	Grid Char.	40
F-14	3/14/01	10-15	Grid Char.	4700
G-13	3/14/01	0-1	Grid Char.	0.18
H-12	3/15/01	0-1	Grid Char.	12.8
H-12	3/15/01	10-15	Grid Char.	ND(0.042) [ND(0.040)]
H-13	3/13/01	0-1	Grid Char.	0.28
H-14	3/13/01	0-1	Grid Char.	0.15
H-14	3/13/01	1-3	Grid Char.	0.072
H-14	3/13/01	3-6	Grid Char.	0.31
H-14	3/13/01	6-10	Grid Char.	ND(0.036)
H-14	3/13/01	10-15	Grid Char.	ND(0.039)
I-13	3/9/01	0-1	Grid Char.	0.81
I-16	3/9/01	0-1	Grid Char.	0.11
J-12	3/9/01	0-1	Grid Char.	ND(0.036)
J-12	3/9/01	1-3	Grid Char.	ND(0.037)
J-12	3/9/01	3-6	Grid Char.	ND(0.041)
J-12	3/9/01	6-10	Grid Char.	0.70
J-12	3/9/01	10-15	Grid Char.	0.070
J-14	3/12/01	1-3	Grid Char.	0.12
J-14	3/12/01	3-6	Grid Char.	0.63
J-14	3/12/01	6-10	Grid Char.	ND(0.037)
J-14	3/12/01	10-15	Grid Char.	ND(0.041)
J-15	3/12/01	0-1	Grid Char.	9.0
J-16	3/12/01	1-3	Grid Char.	9.0
J-16	3/12/01	3-6	Grid Char.	4.7
J-16	3/12/01	6-10	Grid Char.	ND(0.041)
J-16	3/12/01	10-15	Grid Char.	ND(0.041)
K-12	3/9/01	0-1	Grid Char.	0.066 [0.065]
K-14	3/9/01	0-1	Grid Char.	0.12
NI-BH000441	3/9/01	0-1	Grid Char.	1601
NI-BH000444	3/12/01	1-3	Grid Char.	1.91 [0.19J]
NI-BH000453	3/14/01	3-6	Grid Char.	220
NI-BH000454	3/14/01	6-10	Grid Char.	410
NI-BH000464	4/4/01	0-1	Supplemental 13.3	
NI-BH000464	4/4/01	1-3	Supplemental 0.28 J	
NI-BH000464	4/4/01	6-15	Supplemental 122 J	
NI-BH000471	4/6/01	0-1	Supplemental 1.98 J	
NI-BH000471	4/6/01	3-6	Supplemental 30 J	
NI-BH000471	4/6/01	6-15	Supplemental 33 J [15 J]	
NI-BH000472	4/6/01	1-3	Supplemental ND(0.017)	
NI-BH000472	4/6/01	3-6	Supplemental 10.3 J [11 J]	
NI-BH000472	4/6/01	6-15	Supplemental 62 J	
NI-0T000014	4/6/01	0-4	Soil File 1.05 [1.05 J]	
NI-0T000015	4/6/01	0-2	Soil File 0.66 J	
SZ-4	7/10/87	0-2	Grid Char.	1.1
SZ-4	7/10/87	2-4	Grid Char.	6.4
SZ-4	7/10/87	4-6	Grid Char.	320
SZ-4	7/10/87	6-8	Grid Char.	21
SZ-4	7/10/87	8-12	Grid Char.	430
SZ-4	7/10/87	12-14	Grid Char.	20
SZ-5	7/10/87	6-8	Supplemental 10	
SZ-6	7/14/87	0-2	Supplemental ND(0.05)	
SZ-7	7/14/87	12-16	Supplemental ND(0.05)	
SZ-8	5/9/88	0-0.5	Supplemental 0.87	
SZ-9	5/9/88	0-0.5	Grid Char.	0.21
SZ-10	5/9/88	0-0.5	Grid Char.	2.4
SZ-11	5/9/88	0-0.5	Grid Char.	0.10
SZ-12	5/9/88	0-0.5	Grid Char.	0.16
SZ-13	5/9/88	0-0.5	Grid Char.	0.44
SZ-14	5/9/88	0-0.5	Grid Char.	0.28
SZ-15	5/9/88	0-0.5	Supplemental 4.3	
SZ-16	5/9/88	0-0.5	Grid Char.	0.68
SZ-17	5/9/88	0-0.5	Grid Char.	1.1
SZ-18	5/9/88	0-0.5	Grid Char.	0.44
SZ-19	3/16/89	0-0.5	Grid Char.	0.65
SZ-20	3/16/89	0-0.5	Grid Char.	0.49
SZ-21	5/8/91	0-0.5	Supplemental 1.4	
SZ-22	5/8/91	0-0.5	Grid Char.	0.21
SZ-25	5/8/91	0-0.5	Grid Char.	0.68
SZ-26	5/8/91	0-0.5	Supplemental 0.18	
SZ-27	2/26/97	0-0.5	Grid Char.	1.8
SZ-28	2/26/97	0-0.5	Grid Char.	0.46
SZ-29	2/25/97	0-0.5	Grid Char.	11
SZ-29	2/25/97	0.5-2	Supplemental 2.38	
SZ-29	2/25/97	2-4	Supplemental 41 [120]	
SZ-29	2/25/97	4-6	Supplemental 1.1	
SZ-29	2/25/97	6-8	Supplemental 0.13	
SZ-29	2/25/97	8-10	Supplemental 0.13	
SZ-29	2/25/97	10-12	Supplemental ND(0.037)	
SZ-29	2/25/97	12-14	Supplemental 0.041	
SZ-30	2/24/97	0-0.5	Supplemental 16	
SZ-30	2/24/97	0.5-2	Supplemental 2.6	
SZ-30	2/24/97	2-4	Supplemental ND(0.035)	
SZ-30	2/24/97	4-6	Supplemental 42	
SZ-30	2/24/97	6-8	Supplemental 22	
SZ-30	2/24/97	8-10	Supplemental 17	
SZ-30	2/24/97	10-12	Supplemental 54	
SZ-30	2/24/97	12-14	Supplemental 28 [9.7]	
SZ-30	2/24/97	14-16	Supplemental 20	

Sample Name	Date	Depth Interval (ft)	Data Usage Type	Total PCBs
221-230 Newell St. (Parcel J9-23-22)				
F-16	1/30/01	1-3	Grid Char.	94
F-16	1/30/01	3-6	Grid Char.	145
F-16	1/30/01	6-10	Grid Char.	32
F-16	1/30/01	10-15	Grid Char.	ND(0.035)
DD-N	11/15/90	0-0.5	Supplemental 91	
DD-S	11/15/90	0-0.5	Supplemental 7.3	
DP-2	10/5/90	0-0.5	Supplemental 20	
F-16	1/30/01	1-3	Grid Char.	560
F-16	1/30/01	3-6	Grid Char.	1470 [1470]
F-16	1/30/01	6-10	Grid Char.	51
F-16	1/30/01	10-15	Grid Char.	33
H-16	1/29/01	0-1	Grid Char.	2.8
H-16	1/29/01	1-3	Grid Char.	49
H-16	1/29/01	3-6	Grid Char.	15
H-16	1/29/01	6-10	Grid Char.	ND(0.037)
H-16	1/29/01	10-15	Grid Char.	ND(0.041)
H-17	1/29/01	0-1	Grid Char.	570
J-17	1/24/01	0-1	Grid Char.	0.89
J-18	1/24/01	0-1	Grid Char.	5.8
J-18	1/24/01	1-3	Grid Char.	94
J-18	1/24/01	3-6	Grid Char.	3530
J-18	1/24/01	6-10	Grid Char.	8.0
J-18	1/24/01	10-15	Grid Char.	0.29
K-17	1/24/01	0-1	Grid Char.	0.060
K-18	1/24/01	0-1	Grid Char.	33.6
M9-1	7/9/87	0-1	Supplemental 140	
M9-1	7/9/87	2-4	Supplemental 37	
M9-1	7/9/87	4-6	Supplemental 380	
M9-1	7/9/87	6-8	Supplemental 0.48	
M9-1	7/9/87	8-10	Supplemental 12	
M9-1	7/9/87	10-12	Supplemental 3.3	
M9-3	5/10/88	0-0.5	Grid Char.	91
M9-4	5/10/88	0-0.5	Supplemental 23	
M9-5	5/10/88	0-0.5	Supplemental 65	
M9-6	3/16/89	0-0.5	Supplemental 44	
M9-7	3/16/89	0-0.5	Supplemental 97	
M9-8	3/16/89	0-0.5	Supplemental 3.6	
M9-9	3/16/89	0-0.5	Grid Char.	14
M9-10	3/16/89	0-0.5	Grid Char.	7.4
M9-11	3/16/89	0-0.5	Grid Char.	12
M9-3E1	10/5/90	0-0.5	Supplemental 12	
M9-3E2	10/5/90	0-0.5	Supplemental 42	
M9-3E3	10/5/90	0-0.5	Supplemental 23	
M9-3E4	10/5/90	0-0.5	Supplemental 19	
M9-3E5	10/5/90	0-0.5	Supplemental 9.3	
M9-3E6	10/5/90	0-0.5	Supplemental 7.3	
M9-3E7	10/5/90	0-0.5	Supplemental 17	
M9-3E8	10/5/90	0-0.5	Supplemental 0.11	
M9-4E1	10/5/90	0-0.5	Supplemental 39.2	
M9-4E2	10/5/90	0-0.5	Supplemental 81	
M9-4E3	10/5/90	0-0.5	Supplemental 145	
M9-4E4	10/5/90	0-0.5	Supplemental 12	
M9-4E5	10/5/90	0-0.5	Supplemental 14	
M9-4E6	10/5/90	0-0.5	Supplemental 5.2	
M9-4E7	10/5/90	0-0.5	Supplemental 7.7	
M9-4E8	10/5/90	0-0.5	Supplemental 3.4	
M9-5E1	10/5/90	0-0.5	Supplemental 7.4	
M9-5E2	10/5/90	0-0.5	Supplemental 43	
M9-5E3	10/5/90	0-0.5	Grid Char.	3.1
M9-5E4	10/5/90	0-0.5	Supplemental 13	
M9-5E5	10/5/90	0-0.5	Supplemental 32	
M9-5E6	10/5/90	0-0.5	Supplemental 47	
M9-5E7	10/5/90	0-0.5	Supplemental 19	
M9-5E8	10/5/90	0-0.5	Supplemental 44	
M9-5E9	10/5/90	0-0.5	Supplemental 12	
M9-5E10	10/5/90	0-0.5	Supplemental 208	
M9-5E11	10/5/90	0-0.5	Supplemental 27	
M9-5E12	10/5/90	0-0.5	Supplemental 66	
M9-5E13	10/5/90	0-0.5	Supplemental 19	
M9-5E14	10/5/90	0-0.5	Supplemental 16	
M9-5E15	10/5/90	0-0.5	Supplemental 11	
M9-5E16	10/5/90	0-0.5	Supplemental 28	
M9-5E17	10/5/90	0-0.5	Supplemental 15	
M9-5E18	10/5/90	0-0.5	Supplemental 220	
M9-5E19	10/5/90	0-0.5	Supplemental 19	
M9-P1	5/9/91	0-0.5	Grid Char.	170
M9-P2	5/9/91	0-0.5	Supplemental 220	
M9-P3	1/24/01	3-6	Grid Char.	1300
NI-BH000314	1/30/01	3-6	Grid Char.	820
NI-BH000321	1/30/01	3-6	Grid Char.	0.233
NI-BH000322	1/30/01	3-6	Grid Char.	89
NI-BH000323	1/30/01	0-1	Grid Char.	3.6
SP-1 (N&W)	11/15/90	0-0.5	Supplemental 3.3	
SP-2 (E&S)	11/15/90	0-0.5	Supplemental 5.7	
SP-3 (W&E)	11/15/90	0-0.5	Supplemental 4.6	
SP-4 (E&S)	11/15/90	0-0.5	Supplemental 0.56	
SLO 093	8/12/98	0-0.5	Grid Char.	104
261 Newell St. (Parcel J9-23-23)				
C-17	1/31/01	0-1	Grid Char.	500
C-18	1/31/01	0-1	Grid Char.	10.4
C-18	1/31/01	10-15	Grid Char.	27
D-17	1/31/01	0-1	Grid Char.	89
D-18	1/31/01	0-1	Grid Char.	5.8
D-18	1/31/01	10-15	Grid Char.	60
D-19	2/1/01	0-1	Grid Char.	81
E-19	2/1/01	0-1	Grid Char.	20.8
F-18	1/31/01	0-1	Grid Char.	43
F-18	1/31/01	1-3	Grid Char.	16.4
F-18	1/31/01	3-6	Grid Char.	610
F-18	1/3			