



GF - 211-111
2.6
297110

Copyright © 2002 General Electric Company
All rights reserved. Printed in the U.S.A.



SDMS DocID

249932

Transmitted via Overnight Delivery

July 16, 2002

Mr. Bryan Olson
EPA Project Coordinator
U.S. Environmental Protection Agency
EPA New England
One Congress Street, Suite 1100
Boston, Massachusetts 02114-2023

**Re: GE-Pittsfield/Housatonic River Site
Lyman Street Area (GECD430)
Pre-Design Investigation Work Plan
Supplemental Information Letter**

Dear Mr. Olson:

In March 2002, the General Electric Company (GE) submitted to the U.S. Environmental Protection Agency (EPA) a document entitled *Pre-Design Investigation Work Plan for the Lyman Street Area Removal Action* (PDI Work Plan). That document was prepared in accordance with the Consent Decree (CD) for the GE-Pittsfield/Housatonic River Site and the accompanying *Statement of Work for Removal Actions Outside the River* (SOW). Subsequently, in a letter dated July 2, 2002, EPA provided conditional approval of the PDI Work Plan and required, among other things, that GE prepare (for EPA review and approval) a supplemental information letter to address items requiring clarification and/or additional proposals. This letter provides the required information. In addition, based on the contents of the EPA conditional approval letter, this supplemental information letter includes updated/revised tables and figures from the PDI Work Plan.

The March 2002 PDI Work Plan, as modified by EPA's conditional approval letter and this supplemental information letter, describes the scope of pre-design soil investigations for the Lyman Street Area. Additional clarifications/proposals (beyond those described in the EPA conditional approval letter) are presented below. In addition, GE's proposed schedule for the initiation and performance of the pre-design activities is presented below.

Additional Pre-Design Clarifications/Proposals

1. As required in Condition No. 2 of the EPA conditional approval letter, to supplement the 25 existing pesticide/herbicide sample results for this area, the collection of an additional 20 pesticide/herbicide samples is proposed. The proposed samples are distributed within the Lyman Street Area as shown on Table 4 and Figure 4 through Figure 8.

2. GE has revised Figure 1 through Figure 8 to reflect the updated ownership and boundaries for certain parcels included in the Lyman Street Area (i.e., Parcels I9-4-201, I9-4-202, and I9-4-203). As stated in EPA's conditional approval letter, since Parcels I9-4-202 and I9-4-25 are contiguous and under common ownership, they will be sampled and evaluated as a single property. In fact, new Parcel I9-4-203 is also contiguous with Parcel I9-4-25, is under common ownership with that parcel (and Parcel I9-4-202), and is used by the owner as part of the same overall property. In these circumstances, it does not make sense to evaluate this small parcel separately from the rest of the property. Accordingly, GE proposes to sample and evaluate Parcel I9-4-203 as part of the same single property with Parcels I9-4-25 and I9-4-202. This proposal will also ensure that there will be a sufficient number of Appendix IX+3 samples at the relevant depth increments at the overall property and thus will avoid the need to shift some additional Appendix IX+3 samples from other parcels onto Parcel I9-4-203.

It should also be noted that Figure 1 depicts a recreational area along the southern boundary of the western side of the Lyman Street Area, consistent with the area designated as recreational in the SOW. However, the portion of this area on Parcels I9-4-25 and I9-4-203 is subject to modification based on discussions with EPA, in light of the reconfiguration of property boundaries, as well as the activities planned by EPA for this area as part of the 1½ Mile Reach Removal Action.

3. The figures and tables have been revised further to incorporate several other conditions in EPA's conditional approval letter. Specifically, Tables 1 and 2 and Figure 2 have been updated to include additional sampling data provided by EPA; Table 1 has been revised to change the proposed data usage for certain existing PCB sample results (including changing the samples previously designated as "Potential Supplemental" to "Supplemental"); Tables 3 and 4 and Figure 3 have been modified to incorporate additional subsurface PCB sampling in a particular area within Parcel I9-4-201 (as discussed below); and Table 4 and Figures 4 through 8 have been revised to reflect the modifications to the proposed Appendix IX+3 soil investigations specified in EPA's letter.
4. As required by Condition 10 of EPA's conditional approval letter, Parcel I9-4-202 has been subdivided for sampling purposes by identifying an area within the western portion of that parcel that will be subject to a different sampling approach for PCBs. The subject area is shown on Figure 3. For sampling within this area, EPA's conditional approval letter states that GE shall follow the protocols for residential sampling of PCBs in Former Oxbow Areas. However, in discussions between GE and EPA, EPA has clarified that: (a) this condition requires the advancement of soil borings and collection of subsurface samples on a 50-foot grid (instead of a 100-foot grid as at the remainder of the Lyman Street Area), but does not require any more dense surface soil sampling; and (b) samples from these borings should be collected for PCB analysis from depth increments of 0 to 1 foot, 1 to 3 feet, 3 to 6 feet, 6 to 10 feet, and 10 to 15 feet. Consequently, within the specific area of Parcel I9-4-201 identified on Figure 3, GE will conduct soil sampling for PCBs in accordance with that approach, as reflected in Tables 3 and 4 and Figure 3.

Schedule

Within 15 days of receipt of EPA approval of this letter, GE will, to the extent practicable, initiate pre-design investigations in areas where EPA will be conducting activities related to the 1½ Mile Reach Removal Action. In addition, GE proposes to complete the pre-design investigations for the Lyman

Street Area and submit a Pre-Design Investigation Report within 9 months of receipt of EPA approval of this letter.

Please call Dick Gates or me with any questions.

Sincerely,



Andrew T. Silfer, P.E.
GE Project Coordinator

V:\GE_Pittsfield-LymanSt Rpts Supplem ltr\03122415.doc
Attachments

cc:

Tim Conway, EPA
Holly Inglis, EPA
Michael Nalipinski, EPA
K.C. Mitkevicius, USACE
Dawn Jamros, Weston
Susan Steenstrup, MDEP (2 copies)
Alan Weinberg, MDEP (cover letter only)
Robert Bell, MDEP (cover letter only)
Thomas Angus, MDEP (cover letter only)
Susan Keydel, MDEP
Nancy E. Harper, MA AG
Dale Young, MA EOE
Mayor Sara Hathaway, City of Pittsfield
Pittsfield Department of Health
Thomas Hickey, PEDDA

Jeffrey Bernstein, Bernstein, Cushner & Kimmel
Theresa Bowers, Gradient
Michael Carroll, GE (cover letter only)
Richard Gates, GE
Rod McLaren, Esq., GE (cover letter only)
James Nuss, BBL
James Bieke, Esq., Shea & Gardner
Western Massachusetts Electric Company
(Owner of Parcel I9-8-2)
Property Owner - Parcel I9-4-14 & -19
Property Owner - Parcels I9-4-25, -202, & -203
Property Owner - Parcel I9-4-201
Public Information Repositories
GE Internal Repository

TABLES

TABLE 1

GENERAL ELECTRIC COMPANY - PITTSFIELD, MASSACHUSETTS

SUPPLEMENTAL PRE-DESIGN INVESTIGATION WORK PLAN FOR
THE LYMAN STREET AREA REMOVAL ACTION

EXISTING SOIL PCB DATA AND PROPOSED USAGE

Data Source	Sample Location	Sample ID	Depth Interval	Date Collected	Available Documentation (See Note 2)	Proposed Data Usage
C	B-1	ROB1B0002	0-2	11/21/91	Complete Laboratory Data Package	Grid Characterization
C	B-1	ROB1B0204	2-4	11/21/91	Complete Laboratory Data Package	Grid Characterization
C	B-1	ROB1B0406	4-6	11/21/91	Complete Laboratory Data Package	Grid Characterization
C	B-1	ROB-DPP1	4-6	11/21/91	Complete Laboratory Data Package	Grid Characterization
C	B-1	ROB1B0608	6-8	11/21/91	Complete Laboratory Data Package	Grid Characterization
C	B-1	ROB1B0810	8-10	11/21/91	Complete Laboratory Data Package	Grid Characterization
C	B-1	ROB1B1012	10-12	11/21/91	Complete Laboratory Data Package	Grid Characterization
C	B-1	ROB1B1214	12-14	11/21/91	Complete Laboratory Data Package	Grid Characterization
C	B-1	ROB1B1416	14-16	11/21/91	Complete Laboratory Data Package	Grid Characterization
C	B-1	ROB1B1618	16-18	11/21/91	See Note 5	Rejected (Depth)
C	B-1	B-1	0-0.5	10/95	None	Supplemental (Note 3)
C	B-2	ROB2B0002	0-2	11/22/91	Complete Laboratory Data Package	Grid Characterization
C	B-2	ROB2B0204	2-4	11/22/91	Complete Laboratory Data Package	Supplemental (Note 4)
C	B-2	ROB2B0406	4-6	11/22/91	Complete Laboratory Data Package	Supplemental (Note 4)
C	B-2	ROB2B0608	6-8	11/22/91	Complete Laboratory Data Package	Supplemental (Note 4)
C	B-2	ROB2B0810	8-10	11/22/91	Complete Laboratory Data Package	Supplemental (Note 4)
C	B-2	ROB2B1012	10-12	11/22/91	Complete Laboratory Data Package	Supplemental (Note 4)
C	B-2	ROB-DPP2	10-12	11/22/91	Complete Laboratory Data Package	Supplemental (Note 4)
C	B-2	ROB2B1214	12-14	11/22/91	Complete Laboratory Data Package	Supplemental (Note 4)
C	B-2	ROB2B1416	14-16	11/22/91	Complete Laboratory Data Package	Supplemental (Note 4)
C	B-2	ROB2B1618	16-18	11/22/91	See Note 5	Rejected (Depth)
C	B-2	B-2	0-0.5	10/95	None	Supplemental (Note 3)
B	E-1	E-1	0-0.33	4/91	None	Supplemental (Note 3)
B	E-1	ROE1B0002	0-2	3/26/91	Complete Laboratory Data Package	Supplemental (Note 4)
B	E-1	ROE1B0204	2-4	3/26/91	Complete Laboratory Data Package	Supplemental (Note 4)
B	E-1	ROE1B0406	4-6	3/26/91	Complete Laboratory Data Package	Supplemental (Note 4)
B	E-1	ROE1B0608	6-8	3/26/91	Complete Laboratory Data Package	Supplemental (Note 4)
B	E-1	ROE1B0810	8-10	3/26/91	Complete Laboratory Data Package	Supplemental (Note 4)
B	E-1	ROE1B1012	10-12	3/26/91	Complete Laboratory Data Package	Supplemental (Note 4)
B	E-1	ROE1B1214	12-14	3/26/91	Complete Laboratory Data Package	Supplemental (Note 4)
B	E-1	ROE1B1416	14-16	3/26/91	Complete Laboratory Data Package	Supplemental (Note 4)
B	E-1	ROE1B1618	16-18	3/26/91	See Note 5	Rejected (Depth)
B	E-1	ROE1B1820	18-20	3/26/91	See Note 5	Rejected (Depth)
B	E-1	ROE1B2022	20-22	3/26/91	See Note 5	Rejected (Depth)
B	E-1	ROE1B2224	22-24	3/26/91	See Note 5	Rejected (Depth)
B	E-2	E-2	0-0.33	4/91	None	Supplemental (Note 3)
B	E-2	ROE2B0002	0-2	3/25/91	Complete Laboratory Data Package	Grid Characterization
B	E-2	ROE2B0204	2-4	3/25/91	Complete Laboratory Data Package	Grid Characterization
B	E-2	ROE2B0406	4-6	3/25/91	Complete Laboratory Data Package	Grid Characterization
B	E-2	ROE2B0608	6-8	3/25/91	Complete Laboratory Data Package	Grid Characterization
B	E-2	ROE2B0810	8-10	3/25/91	Complete Laboratory Data Package	Grid Characterization
B	E-2	ROE2B1012	10-12	3/25/91	Complete Laboratory Data Package	Grid Characterization
B	E-2	ROE2B1214	12-14	3/25/91	Complete Laboratory Data Package	Grid Characterization
B	E-2	ROE2B1416	14-16	3/25/91	Complete Laboratory Data Package	Grid Characterization
B	E-2	ROE2B1618	16-18	3/25/91	See Note 5	Rejected (Depth)
B	E-2	ROE2B1820	18-20	3/25/91	See Note 5	Rejected (Depth)
B	E-2	ROE2B2022	20-22	3/25/91	See Note 5	Rejected (Depth)
B	E-3	OE3B0002	0-2	8/9/95	Complete Laboratory Data Package	Grid Characterization
B	E-3	OE3B0204	2-4	8/9/95	Complete Laboratory Data Package	Grid Characterization
B	E-3	OE3B0406	4-6	8/9/95	Complete Laboratory Data Package	Grid Characterization

TABLE 1

GENERAL ELECTRIC COMPANY - PITTSFIELD, MASSACHUSETTS

SUPPLEMENTAL PRE-DESIGN INVESTIGATION WORK PLAN FOR
THE LYMAN STREET AREA REMOVAL ACTION

EXISTING SOIL PCB DATA AND PROPOSED USAGE

Data Source	Sample Location	Sample ID	Depth Interval	Date Collected	Available Documentation (See Note 2)	Proposed Data Usage
B	E-3	OE3B0608	6-8	8/9/95	Complete Laboratory Data Package	Grid Characterization
B	E-3	OE3B1012	10-12	8/9/95	Complete Laboratory Data Package	Grid Characterization
B	E-3	OE3BDUP	10-12	8/9/95	Complete Laboratory Data Package	Grid Characterization
B	E-3	OE3B1214	12-14	8/9/95	Complete Laboratory Data Package	Grid Characterization
B	E-3	OE3B1416	14-16	8/9/95	Complete Laboratory Data Package	Grid Characterization
B	E-3	OE3B1618	16-18	8/9/95	See Note 5	Rejected (Depth)
B	E-3	OE3B2022	20-22	8/9/95	See Note 5	Rejected (Depth)
B	E-4	OE4B0002	0-2	8/9/95	Complete Laboratory Data Package	Grid Characterization
B	E-4	OE4B0204	2-4	8/9/95	Complete Laboratory Data Package	Grid Characterization
B	E-4	OE4B0406	4-6	8/9/95	Complete Laboratory Data Package	Grid Characterization
B	E-4	OE4B0608	6-8	8/9/95	Complete Laboratory Data Package	Grid Characterization
B	E-4	OE4B0810	8-10	8/9/95	Complete Laboratory Data Package	Grid Characterization
B	E-4	OE4B1012	10-12	8/9/95	Complete Laboratory Data Package	Grid Characterization
B	E-4	OE4B1214	12-14	8/9/95	Complete Laboratory Data Package	Grid Characterization
B	E-4	OE4B1416	14-16	8/9/95	Complete Laboratory Data Package	Grid Characterization
B	E-4	OE4B1618	16-18	8/9/95	See Note 5	Rejected (Depth)
B	E-4	OE4B1820	18-20	8/9/95	See Note 5	Rejected (Depth)
B	E-4	OE4B2022	20-22	8/9/95	See Note 5	Rejected (Depth)
B	E-5	OE5B0002	0-2	8/10/95	Complete Laboratory Data Package	Grid Characterization
B	E-5	OE5B0204	2-4	8/10/95	Complete Laboratory Data Package	Grid Characterization
B	E-5	OE5B0406	4-6	8/10/95	Complete Laboratory Data Package	Grid Characterization
B	E-5	OE5B0608	6-8	8/10/95	Complete Laboratory Data Package	Grid Characterization
B	E-5	OE5B0810	8-10	8/10/95	Complete Laboratory Data Package	Grid Characterization
B	E-5	OE5B1012	10-12	8/10/95	Complete Laboratory Data Package	Grid Characterization
B	E-5	OE5B1214	12-14	8/10/95	Complete Laboratory Data Package	Grid Characterization
B	E-5	OE5B1416	14-16	8/10/95	Complete Laboratory Data Package	Grid Characterization
B	E-5	OE5BDUP	14-16	8/10/95	Complete Laboratory Data Package	Grid Characterization
B	E-5	OE5B1618	16-18	8/10/95	See Note 5	Rejected (Depth)
B	E-6	OE6B0002	0-2	8/16/95	Complete Laboratory Data Package	Grid Characterization
B	E-6	OE6B0204	2-4	8/16/95	Complete Laboratory Data Package	Supplemental (Note 4)
B	E-6	OE6BDUP	2-4	8/16/95	Complete Laboratory Data Package	Supplemental (Note 4)
B	E-6	OE6B0406	4-6	8/16/95	Complete Laboratory Data Package	Supplemental (Note 4)
B	E-6	OE6B0608	6-8	8/16/95	Complete Laboratory Data Package	Supplemental (Note 4)
B	E-6	OE6B0810	8-10	8/16/95	Complete Laboratory Data Package	Supplemental (Note 4)
B	E-7	OE-7B0002	0-2	8/7/95	Complete Laboratory Data Package	Grid Characterization
B	E-7	OE-7B0204	2-4	8/7/95	Complete Laboratory Data Package	Supplemental (Note 4)
B	E-7	OE-7B0406	4-6	8/7/95	Complete Laboratory Data Package	Supplemental (Note 4)
B	E-7	OE-7B0608	6-8	8/7/95	Complete Laboratory Data Package	Supplemental (Note 4)
B	E-7	OE-7B0810	8-10	8/7/95	Complete Laboratory Data Package	Supplemental (Note 4)
B	E-7	OE-7B1012	10-12	8/7/95	Complete Laboratory Data Package	Supplemental (Note 4)
B	E-7	OE-7B1214	12-14	8/7/95	Complete Laboratory Data Package	Supplemental (Note 4)
B	E-7	OE-7B1416	14-16	8/7/95	Complete Laboratory Data Package	Supplemental (Note 4)
H	E-7	OE-7B1618	16-18	8/7/95	See Note 5	Rejected (Depth)
H	E-7	OE-7B1820	18-20	8/7/95	See Note 5	Rejected (Depth)
H	E-8	E-8	18-20	8/9/95	See Note 5	Rejected (Depth)
I	GB-A **	OB-BI1000555-0-0000	0-1	1/2/02	Received from EPA	Supplemental (Note 4)
I	GB-A **	OB-BI1000555-0-0010	1-3	1/2/02	Received from EPA	Supplemental (Note 4)
I	GB-A **	OB-BI1000555-0-0030	3-6	1/2/02	Received from EPA	Supplemental (Note 4)
I	GB-A **	OB-BI1000555-0-0060	6-10	1/2/02	Received from EPA	Supplemental (Note 4)
I	GB-A **	OB-BI1000555-0-0100	10-15	1/2/02	Received from EPA	Supplemental (Note 4)

TABLE I

GENERAL ELECTRIC COMPANY - PITTSFIELD, MASSACHUSETTS

SUPPLEMENTAL PRE-DESIGN INVESTIGATION WORK PLAN FOR
THE LYMAN STREET AREA REMOVAL ACTION

EXISTING SOIL PCB DATA AND PROPOSED USAGE

Data Source	Sample Location	Sample ID	Depth Interval	Date Collected	Available Documentation (See Note 2)	Proposed Data Usage
I	GB-A **	OB-BH000555-0-0120	12-14	1/2/02	Received from EPA	Supplemental (Note 4)
I	GB-A **	OB-BH000555-0-0180	18-20	1/2/02	Received from EPA	Supplemental (Note 4)
I	GB-C **	OB-BH000557-0-0000	0-1	1/2/02	Received from EPA	Supplemental (Note 4)
I	GB-C **	OB-BH000557-0-0010	1-3	1/2/02	Received from EPA	Supplemental (Note 4)
I	GB-C **	OB-BH000557-0-0030	3-6	1/2/02	Received from EPA	Supplemental (Note 4)
I	GB-C **	OB-BH000557-0-0060	6-10	1/2/02	Received from EPA	Supplemental (Note 4)
I	GB-C **	OB-BH000557-0-0100	10-15	1/2/02	Received from EPA	Supplemental (Note 4)
I	GB-C **	OB-BH000557-0-0350	35-37	1/2/02	Received from EPA	Supplemental (Note 4)
I	GB-E **	OB-BH000559-0-0000	0-1	1/2/02	Received from EPA	Supplemental (Note 4)
I	GB-E **	OB-BH000559-0-0010	1-3	1/2/02	Received from EPA	Supplemental (Note 4)
I	GB-E **	OB-BH000559-0-0030	3-6	1/2/02	Received from EPA	Supplemental (Note 4)
I	GB-E **	OB-BH000559-0-0060	6-10	1/2/02	Received from EPA	Supplemental (Note 4)
I	GB-E **	OB-BH000559-0-0100	10-15	1/2/02	Received from EPA	Supplemental (Note 4)
I	GB-E **	OB-BH000559-0-0300	30-32	1/2/02	Received from EPA	Supplemental (Note 4)
F	H2-RB010661-0-0000	H2-RB010661-0-0000	0-0.5	11/24/1998	Received from EPA	Supplemental (Note 4)
F	H2-RB010661-0-0000	H2-RB010661-0-0010	1-1.5	11/24/1998	Received from EPA	Supplemental (Note 4)
F	H2-RB010661-0-0000	H2-RB010661-0-0020	2-2.5	11/24/1998	Received from EPA	Supplemental (Note 4)
F	H2-RB010681-0-0000	H2-RB010681-0-0000	0-0.5	11/24/1998	Received from EPA	Supplemental (Note 4)
F	H2-RB010681-0-0000	H2-RB010681-0-0010	1-1.5	11/24/1998	Received from EPA	Supplemental (Note 4)
F	H2-RB010681-0-0000	H2-RB010681-0-0020	2-2.5	11/24/1998	Received from EPA	Supplemental (Note 4)
F	H2-RB010703-0-0020	H2-RB010703-0-0000	0-0.5	11/24/1998	Received from EPA	Grid Characterization
F	H2-RB010703-0-0020	H2-RB010703-0-0010	1-1.5	11/24/1998	Received from EPA	Supplemental (Note 4)
F	H2-RB010703-0-0020	H2-RB010703-0-0020	2-2.5	11/24/1998	Received from EPA	Supplemental (Note 4)
F	H2-RB010721-0-0000	H2-RB010721-0-0000	0-0.5	11/23/1998	Received from EPA	Grid Characterization
F	H2-RB010721-0-0000	H2-RB010721-0-0010	1-1.5	11/23/1998	Received from EPA	Supplemental (Note 4)
F	H2-RB010721-0-0000	H2-RB010721-0-0020	2-2.5	11/23/1998	Received from EPA	Supplemental (Note 4)
F	H2-RB010741-0-0020	H2-RB010741-0-0000	0-0.5	11/23/1998	Received from EPA	Supplemental (Note 4)
F	H2-RB010741-0-0020	H2-RB010741-0-0010	1-1.5	11/23/1998	Received from EPA	Supplemental (Note 4)
F	H2-RB010741-0-0020	H2-RB010741-0-0020	2-2.5	11/23/1998	Received from EPA	Supplemental (Note 4)
F	H2-RB010741-0-0020	H2-RB010741-1-0020	2-2.5	11/23/1998	Received from EPA	Supplemental (Note 4)
F	H2-RB010761-0-0000	H2-RB010761-0-0000	0-0.5	11/23/1998	Received from EPA	Grid Characterization
F	H2-RB010781-0-0000	H2-RB010781-0-0000	0-0.5	11/23/1998	Received from EPA	Grid Characterization
F	H2-RB010781-0-0000	H2-RB010781-0-0010	1-1.5	11/23/1998	Received from EPA	Supplemental (Note 4)
F	H2-RB010781-0-0000	H2-RB010781-0-0020	2-2.5	11/23/1998	Received from EPA	Supplemental (Note 4)
F	H2-RB010801-0-0000	H2-RB010801-0-0000	0-0.5	11/20/1998	Received from EPA	Grid Characterization
F	H2-RB010801-0-0000	H2-RB010801-0-0010	1-1.5	11/20/1998	Received from EPA	Supplemental (Note 4)
F	H2-RB010801-0-0000	H2-RB010801-0-0020	2-2.5	11/20/1998	Received from EPA	Supplemental (Note 4)
F	H2-RB010821-0-0020	H2-RB010821-0-0000	0-0.5	11/20/1998	Received from EPA	Grid Characterization
F	H2-RB010821-0-0020	H2-RB010821-0-0010	1-1.5	11/20/1998	Received from EPA	Supplemental (Note 4)
F	H2-RB010821-0-0020	H2-RB010821-0-0020	2-2.5	11/20/1998	Received from EPA	Supplemental (Note 4)
F	H2-RB010841-0-0000	H2-RB010841-0-0000	0-0.5	11/20/1998	Received from EPA	Grid Characterization
F	H2-RB010841-0-0000	H2-RB010841-1-0000	0-0.5	11/20/1998	Received from EPA	Grid Characterization
F	H2-RB010841-0-0000	H2-RB010841-0-0010	1-1.5	11/20/1998	Received from EPA	Grid Characterization
F	H2-RB010841-0-0000	H2-RB010841-0-0020	2-2.5	11/20/1998	Received from EPA	Grid Characterization
F	H2-RB010861-0-0020	H2-RB010861-0-0000	0-0.5	11/20/1998	Received from EPA	Grid Characterization
F	H2-RB010861-0-0020	H2-RB010861-0-0010	1-1.5	11/20/1998	Received from EPA	Supplemental (Note 4)
F	H2-RB010861-0-0020	H2-RB010861-0-0020	2-2.5	11/20/1998	Received from EPA	Supplemental (Note 4)
C	19-4-14A	19-4-14A	0-0.5	8-92	None	Supplemental (Note 3)
C	19-4-14B	19-4-14B	0-0.5	8-92	None	Supplemental (Note 3)
C	19-4-14C	19-4-14C	0-0.5	8-92	None	Supplemental (Note 3)

TABLE 1

GENERAL ELECTRIC COMPANY - PITTSFIELD, MASSACHUSETTS

SUPPLEMENTAL PRE-DESIGN INVESTIGATION WORK PLAN FOR
THE LYMAN STREET AREA REMOVAL ACTION

EXISTING SOIL PCB DATA AND PROPOSED USAGE

Data Source	Sample Location	Sample ID	Depth Interval	Date Collected	Available Documentation (See Note 2)	Proposed Data Usage
C	19-4-14D	19-4-14D	0-0.5	1/5/93	Form 1	Grid Characterization
C	19-4-14D	19-4-14D	0.5-1	1/5/93	Form 1	Grid Characterization
C	19-4-14E	19-4-14E	0-0.5	1/5/93	Form 1	Grid Characterization
C	19-4-14E	19-4-14E	0.5-1	1/5/93	Form 1	Grid Characterization
B	LS-2	LS-2	0-4	8/24/89	See Note 5	Rejected (Depth)
B	LS-2	LS-2	4-8	8/24/89	None	Supplemental (Note 3)
B	LS-2	LS-2	8-12	8/24/89	None	Supplemental (Note 3)
B	LS-2	LS-2	18-22	8/24/89	See Note 5	Rejected (Depth)
B	LS-4	LS-4	0-6	8/26/89	See Note 5	Rejected (Depth)
B	LS-4	LS-4	6-12	8/26/89	None	Supplemental (Note 3)
B	LS-4	LS-4	12-18	8/26/89	None	Supplemental (Note 3)
B	LS-4	LS-4	18-22	8/26/89	See Note 5	Rejected (Depth)
B	LS-7	LS-7	0-2	9/14/90	None	Supplemental (Note 3)
B	LS-7	LS-7	2-4	9/14/90	None	Supplemental (Note 3)
B	LS-7	LS-7	4-6	9/14/90	None	Supplemental (Note 3)
B	LS-7	LS-7	6-8	9/14/90	None	Supplemental (Note 3)
B	LS-7	LS-7	8-10	9/14/90	None	Supplemental (Note 3)
B	LS-7	LS-7	10-12	9/14/90	None	Supplemental (Note 3)
B	LS-7	LS-7	12-14	9/14/90	None	Supplemental (Note 3)
H	LS-7	LS-7	14-16	9/14/90	None	Supplemental (Note 3)
H	LS-7	LS-7	16-18	9/14/90	See Note 5	Rejected (Depth)
B	LS-8	LS-8	0-2	9/14/90	None	Supplemental (Note 3)
H	LS-8	LS-8	2-4	9/14/90	None	Supplemental (Note 3)
B	LS-8	LS-8	4-6	9/14/90	None	Supplemental (Note 3)
B	LS-8	LS-8	6-8	9/14/90	None	Supplemental (Note 3)
B	LS-8	LS-8	8-10	9/14/90	None	Supplemental (Note 3)
B	LS-8	LS-8	10-12	9/14/90	None	Supplemental (Note 3)
B	LS-8	LS-8	12-14	9/14/90	None	Supplemental (Note 3)
B	LS-8	LS-8	14-16	9/14/90	None	Supplemental (Note 3)
B	LS-8	LS-8	16-18	9/14/90	See Note 5	Rejected (Depth)
B	LS-8	LS-8	18-20	9/14/90	See Note 5	Rejected (Depth)
B	LS-8	LS-8	20-22	9/14/90	See Note 5	Rejected (Depth)
H	LS-8	LS-8	22-24	9/14/90	See Note 5	Rejected (Depth)
B	LS-9	LS-9	0-2	9/14/90	None	Supplemental (Note 3)
H	LS-9	LS-9	2-4	9/14/90	None	Supplemental (Note 3)
B	LS-9	LS-9	4-6	9/14/90	None	Supplemental (Note 3)
B	LS-9	LS-9	6-8	9/14/90	None	Supplemental (Note 3)
B	LS-9	LS-9	8-10	9/14/90	None	Supplemental (Note 3)
B	LS-9	LS-9	10-12	9/14/90	None	Supplemental (Note 3)
B	LS-9	LS-9	12-14	9/14/90	None	Supplemental (Note 3)
B	LS-9	LS-9	14-16	9/14/90	None	Supplemental (Note 3)
B	LS-9	LS-9	16-18	9/14/90	See Note 5	Rejected (Depth)
B	LS-9	LS-9	18-20	9/14/90	See Note 5	Rejected (Depth)
B	LS-10	LS-10	0-2	9/14/90	None	Supplemental (Note 3)
H	LS-10	LS-10	2-4	9/14/90	None	Supplemental (Note 3)
B	LS-10	LS-10	4-6	9/14/90	None	Supplemental (Note 3)
H	LS-10	LS-10	6-8	9/14/90	None	Supplemental (Note 3)
H	LS-10	LS-10	8-10	9/14/90	None	Supplemental (Note 3)
B	LS-10	LS-10	10-12	9/14/90	None	Supplemental (Note 3)
B	LS-10	LS-10	12-14	9/14/90	None	Supplemental (Note 3)

TABLE 1

GENERAL ELECTRIC COMPANY - PITTSFIELD, MASSACHUSETTS

SUPPLEMENTAL PRE-DESIGN INVESTIGATION WORK PLAN FOR
THE LYMAN STREET AREA REMOVAL ACTION

EXISTING SOIL PCB DATA AND PROPOSED USAGE

Data Source	Sample Location	Sample ID	Depth Interval	Date Collected	Available Documentation (See Note 2)	Proposed Data Usage
B	LS-10	LS-10	14-16	9/14/90	None	Supplemental (Note 3)
B	LS-10	LS-10	16-18	9/14/90	See Note 5	Rejected (Depth)
B	LS-10	LS-10	18-20	9/14/90	See Note 5	Rejected (Depth)
B	LS-10	LS-10	20-22	9/14/90	See Note 5	Rejected (Depth)
B	LS-10	LS-10	22-24	9/14/90	See Note 5	Rejected (Depth)
B	LS-11	LS-11	0-2	9/14/90	None	Supplemental (Note 3)
B	LS-11	LS-11	2-4	9/14/90	None	Supplemental (Note 3)
B	LS-11	LS-11	4-6	9/14/90	None	Supplemental (Note 3)
B	LS-11	LS-11	6-8	9/14/90	None	Supplemental (Note 3)
B	LS-11	LS-11	8-10	9/14/90	None	Supplemental (Note 3)
B	LS-11	LS-11	10-12	9/14/90	None	Supplemental (Note 3)
B	LS-11	LS-11	12-14	9/14/90	None	Supplemental (Note 3)
B	LS-11	LS-11	14-16	9/14/90	None	Supplemental (Note 3)
B	LS-11	LS-11	16-18	9/14/90	See Note 5	Rejected (Depth)
B	LS-11	LS-11	18-20	9/14/90	See Note 5	Rejected (Depth)
B	LS-11	LS-11	20-22	9/14/90	See Note 5	Rejected (Depth)
B	LS-11	LS-11	22-24	9/14/90	See Note 5	Rejected (Depth)
B	LS-12	LS-12	2-4	9/14/90	None	Supplemental (Note 3)
B	LS-12	LS-12	6-8	9/14/90	None	Supplemental (Note 3)
B	LS-12	LS-12	10-12	9/14/90	None	Supplemental (Note 3)
B	LS-12	LS-12	14-16	9/14/90	None	Supplemental (Note 3)
B	LS-12	LS-12	18-20	9/14/90	See Note 5	Rejected (Depth)
B	LS-12	LS-12	24-26	9/14/90	See Note 5	Rejected (Depth)
B	LS-13	LS-13	2-4	9/14/90	None	Supplemental (Note 3)
B	LS-13	LS-13	6-8	9/14/90	None	Supplemental (Note 3)
B	LS-13	LS-13	10-12	9/14/90	None	Supplemental (Note 3)
B	LS-13	LS-13	14-16	9/14/90	None	Supplemental (Note 3)
B	LS-13	LS-13	18-20	9/14/90	See Note 5	Rejected (Depth)
B	LS-13	LS-13	22-24	9/14/90	See Note 5	Rejected (Depth)
B	LS-26	L26B0002	0-2	8/10/95	Complete Laboratory Data Package	Grid Characterization
B	LS-26	L26B1012	10-12	8/11/95	None	Supplemental (Note 3)
B	LS-27	L27B0002	0-2	8/11/95	Complete Laboratory Data Package	Grid Characterization
B	LS-27	L27B0204	2-4	8/11/95	Complete Laboratory Data Package	Grid Characterization
B	LS-27	L27B0406	4-6	8/11/95	Complete Laboratory Data Package	Grid Characterization
B	LS-27	L27B0810	8-10	8/11/95	Complete Laboratory Data Package	Grid Characterization
B	LS-27	L27B1012	10-12	8/11/95	Complete Laboratory Data Package	Grid Characterization
B	LS-27	L27B1214	12-14	8/11/95	Complete Laboratory Data Package	Grid Characterization
B	LS-27	L27B1416	14-16	8/11/95	Complete Laboratory Data Package	Grid Characterization
B	LS-27	L27B1618	16-18	8/11/95	See Note 5	Rejected (Depth)
B	LS-27	L27B1820	18-20	8/11/95	See Note 5	Rejected (Depth)
B	LS-28	L28B0002	0-2	8/14/95	Complete Laboratory Data Package	Grid Characterization
B	LS-28	L28B0204	2-4	8/14/95	Complete Laboratory Data Package	Supplemental (Note 4)
B	LS-28	L28B0406	4-6	8/14/95	Complete Laboratory Data Package	Supplemental (Note 4)
B	LS-28	L28B0608	6-8	8/14/95	Complete Laboratory Data Package	Supplemental (Note 4)
B	LS-28	L28B0810	8-10	8/14/95	Complete Laboratory Data Package	Supplemental (Note 4)
B	LS-28	L28B1012	10-12	8/14/95	Complete Laboratory Data Package	Supplemental (Note 4)
B	LS-28	L28B1214	12-14	8/14/95	Complete Laboratory Data Package	Supplemental (Note 4)
B	LS-28	L28B1416	14-16	8/14/95	Complete Laboratory Data Package	Supplemental (Note 4)
B	LS-28	L28B1618	16-18	8/14/95	See Note 5	Rejected (Depth)
B	LS-28	L28B1820	18-20	8/14/95	See Note 5	Rejected (Depth)

TABLE 1

GENERAL ELECTRIC COMPANY - PITTSFIELD, MASSACHUSETTS

SUPPLEMENTAL PRE-DESIGN INVESTIGATION WORK PLAN FOR
THE LYMAN STREET AREA REMOVAL ACTION

EXISTING SOIL PCB DATA AND PROPOSED USAGE

Data Source	Sample Location	Sample ID	Depth Interval	Date Collected	Available Documentation (See Note 2)	Proposed Data Usage
B	LS-28	L28BDUP	18-20	8/14/95	See Note 5	Rejected (Depth)
B	LS-28	L28B2022	20-22	8/14/95	See Note 5	Rejected (Depth)
B	LS-28	L28B2224	22-24	8/14/95	See Note 5	Rejected (Depth)
B	LS-29	L29B0002	0-2	8/8/95	Complete Laboratory Data Package	Grid Characterization
B	LS-29	L29B1012	10-12	8/8/95	None	Supplemental (Note 3)
B	LS-29	L29B3032	30-32	8/8/95	See Note 5	Rejected (Depth)
B	LS-29	L29B3234	32-34	8/8/95	See Note 5	Rejected (Depth)
B	LS-30	L30B0002	0-2	8/14/95	Complete Laboratory Data Package	Grid Characterization
B	LS-30	L30B1012	10-12	8/14/95	Complete Laboratory Data Package	Grid Characterization
B	LS-30	L30B1214	12-14	8/14/95	Complete Laboratory Data Package	Grid Characterization
B	LS-30	L30B1416	14-16	8/14/95	Complete Laboratory Data Package	Grid Characterization
B	LS-30	L30B1618	16-18	8/14/95	See Note 5	Rejected (Depth)
B	LS-30	L30B1820	18-20	8/14/95	See Note 5	Rejected (Depth)
B	LS-31	L31B0002	0-2	8/15/95	Complete Laboratory Data Package	Grid Characterization
B	LS-31	L31B1012	10-12	8/15/95	Complete Laboratory Data Package	Grid Characterization
B	LS-31	L31B1214	12-14	8/15/95	Complete Laboratory Data Package	Grid Characterization
B	LS-31	L31B1416	14-16	8/15/95	Complete Laboratory Data Package	Grid Characterization
B	LS-31	L31B1618	16-18	8/15/95	See Note 5	Rejected (Depth)
B	LS-31	L31B1820	18-20	8/15/95	See Note 5	Rejected (Depth)
B	LS-32	GEP-LS-32	2-4	10/12/94	None	Supplemental (Note 3)
B	LS-33	GEP-LS-33	0-2	10/12/94	Complete Laboratory Data Package	Grid Characterization
B	LS-33	GEP-LS-33	2-4	10/12/94	Complete Laboratory Data Package	Supplemental (Note 4)
B	LS-33	GEP-LS-33	4-6	10/12/94	Complete Laboratory Data Package	Supplemental (Note 4)
B	LS-33	GEP-LS-33	6-8	10/12/94	Complete Laboratory Data Package	Supplemental (Note 4)
B	LS-33	GEP-LS-33	8-10	10/12/94	Complete Laboratory Data Package	Supplemental (Note 4)
B	LS-33	GEP-LS-33	10-12	10/12/94	Complete Laboratory Data Package	Supplemental (Note 4)
B	LS-33	GEP-LS-33	12-14	10/12/94	Complete Laboratory Data Package	Supplemental (Note 4)
B	LS-33	GEP-LS-33	14-16	10/12/94	Complete Laboratory Data Package	Supplemental (Note 4)
B	LS-33	GEP-LS-33	16-18	10/12/94	See Note 5	Rejected (Depth)
B	LS-34	L34B0002	0-2	12/14/95	Complete Laboratory Data Package	Grid Characterization
B	LS-34	L34B-DUP	0-2	12/14/95	Complete Laboratory Data Package	Grid Characterization
B	LS-34	L34B0204	2-4	12/14/95	Complete Laboratory Data Package	Grid Characterization
B	LS-34	L34B0406	4-6	12/14/95	Complete Laboratory Data Package	Grid Characterization
B	LS-34	L34B0608	6-8	12/14/95	Complete Laboratory Data Package	Grid Characterization
B	LS-34	L34B0810	8-10	12/14/95	Complete Laboratory Data Package	Grid Characterization
B	LS-34	L34B1012	10-12	12/14/95	Complete Laboratory Data Package	Grid Characterization
B	LS-34	L34B1214	12-14	12/14/95	Complete Laboratory Data Package	Grid Characterization
B	LS-34	L34B1416	14-16	12/14/95	Complete Laboratory Data Package	Grid Characterization
B	LS-34	L34B1618	16-18	12/14/95	See Note 5	Rejected (Depth)
B	LS-34	L34B1820	18-20	12/14/95	See Note 5	Rejected (Depth)
B	LS-34	L34B2022	20-22	12/14/95	See Note 5	Rejected (Depth)
B	LS-34	L34B2224	22-24	12/14/95	See Note 5	Rejected (Depth)
B	LS-34	L34B2426	24-26	12/14/95	See Note 5	Rejected (Depth)
B	LS-35	L35B0002	0-2	8/15/95	Complete Laboratory Data Package	Grid Characterization
B	LS-35	L35BDUP	0-2	8/15/95	Complete Laboratory Data Package	Grid Characterization
B	LS-35	L35B1214	12-14	8/15/95	None	Supplemental (Note 3)
B	LS-36	L36B0002	0-2	8/7/95	Complete Laboratory Data Package	Grid Characterization
B	LS-36	L36B0204	2-4	8/7/95	Complete Laboratory Data Package	Grid Characterization
B	LS-36	L36B0406	4-6	8/7/95	Complete Laboratory Data Package	Grid Characterization
B	LS-36	L36BDUP	4-6	8/7/95	Complete Laboratory Data Package	Grid Characterization

TABLE 1

GENERAL ELECTRIC COMPANY - PITTSFIELD, MASSACHUSETTS

SUPPLEMENTAL PRE-DESIGN INVESTIGATION WORK PLAN FOR
THE LYMAN STREET AREA REMOVAL ACTIONEXISTING SOIL PCB DATA AND PROPOSED USAGE

Data Source	Sample Location	Sample ID	Depth Interval	Date Collected	Available Documentation (See Note 2)	Proposed Data Usage
B	LS-36	L36B0608	6-8	8/7/95	Complete Laboratory Data Package	Grid Characterization
B	LS-36	L36B0810	8-10	8/7/95	Complete Laboratory Data Package	Grid Characterization
B	LS-36	L36B1012	10-12	8/7/95	Complete Laboratory Data Package	Grid Characterization
B	LS-36	L36B1214	12-14	8/7/95	Complete Laboratory Data Package	Grid Characterization
B	LS-36	L36B1416	14-16	8/7/95	Complete Laboratory Data Package	Grid Characterization
B	LS-36	L36B1618	16-18	8/7/95	See Note 5	Rejected (Depth)
B	LS-36	L36B1820	18-20	8/7/95	See Note 5	Rejected (Depth)
B	LS-36	L36B2022	20-22	8/7/95	See Note 5	Rejected (Depth)
H	LS-36	L36B2224	22-24	8/7/95	See Note 5	Rejected (Depth)
B	LS-36	L36B2426	24-26	8/7/95	See Note 5	Rejected (Depth)
H	LS-36	L36B2628	26-28	8/7/95	See Note 5	Rejected (Depth)
H	LS-36	L36B2830	28-30	8/7/95	See Note 5	Rejected (Depth)
B	LS-37	L37B0002	0-2	8/8/95	Complete Laboratory Data Package	Supplemental (Note 4)
B	LS-37	L37B0204	2-4	8/8/95	Complete Laboratory Data Package	Supplemental (Note 4)
B	LS-37	L37B0406	4-6	8/8/95	Complete Laboratory Data Package	Supplemental (Note 4)
B	LS-37	L37B0608	6-8	8/8/95	Complete Laboratory Data Package	Supplemental (Note 4)
B	LS-37	L37BD1P	6-8	8/8/95	Complete Laboratory Data Package	Supplemental (Note 4)
B	LS-37	L37B0810	8-10	8/8/95	Complete Laboratory Data Package	Supplemental (Note 4)
B	LS-37	L37B1012	10-12	8/8/95	Complete Laboratory Data Package	Supplemental (Note 4)
B	LS-37	L37B1214	12-14	8/8/95	Complete Laboratory Data Package	Supplemental (Note 4)
B	LS-37	L37B1416	14-16	8/8/95	Complete Laboratory Data Package	Supplemental (Note 4)
B	LS-37	L37B1618	16-18	8/8/95	See Note 5	Rejected (Depth)
B	LS-37	L37B1820	18-20	8/8/95	See Note 5	Rejected (Depth)
B	LS-37	L37B2022	20-22	8/8/95	See Note 5	Rejected (Depth)
B	LS-37	L37B2224	22-24	8/8/95	See Note 5	Rejected (Depth)
B	LS-38	L38B0002	0-2	8/14/95	Complete Laboratory Data Package	Supplemental (Note 4)
B	LS-38	L38B0204	2-4	8/14/95	Complete Laboratory Data Package	Supplemental (Note 4)
B	LS-38	L38B0406	4-6	8/14/95	Complete Laboratory Data Package	Supplemental (Note 4)
B	LS-38	L38B0608	6-8	8/14/95	Complete Laboratory Data Package	Supplemental (Note 4)
B	LS-38	L38B1214	12-14	8/14/95	Complete Laboratory Data Package	Supplemental (Note 4)
B	LS-38	L38B1416	14-16	8/14/95	Complete Laboratory Data Package	Supplemental (Note 4)
B	LS-38	L38B1618	16-18	8/14/95	See Note 5	Rejected (Depth)
B	LS-38	L38B1820	18-20	8/14/95	See Note 5	Rejected (Depth)
B	LS-38	L38B2224	22-24	8/14/95	See Note 5	Rejected (Depth)
B	LS-39	L39B0002	0-2	8/10/95	Complete Laboratory Data Package	Grid Characterization
B	LS-39	L39B0204	2-4	8/10/95	Complete Laboratory Data Package	Grid Characterization
B	LS-39	L39B0406	4-6	8/10/95	Complete Laboratory Data Package	Grid Characterization
B	LS-39	L39B0608	6-8	8/10/95	Complete Laboratory Data Package	Grid Characterization
B	LS-39	L39B0810	8-10	8/10/95	Complete Laboratory Data Package	Grid Characterization
B	LS-39	L39B1012	10-12	8/10/95	Complete Laboratory Data Package	Grid Characterization
B	LS-39	L39B1214	12-14	8/10/95	Complete Laboratory Data Package	Grid Characterization
H	LS-40	L40B0002	0-2	8/10/95	Complete Laboratory Data Package	Grid Characterization
B	LS-40	L40B0204	2-4	8/10/95	Complete Laboratory Data Package	Grid Characterization
B	LS-40	L40B0406	4-6	8/10/95	Complete Laboratory Data Package	Grid Characterization
B	LS-40	L40B0608	6-8	8/10/95	Complete Laboratory Data Package	Grid Characterization
B	LS-40	L40B0810	8-10	8/10/95	Complete Laboratory Data Package	Grid Characterization
B	LS-40	L40B1012	10-12	8/10/95	Complete Laboratory Data Package	Grid Characterization
B	LS-41	L41B1012	10-12	12/13/95	Complete Laboratory Data Package	Supplemental (Note 4)
B	LS-41	L41B1214	12-14	12/13/95	Complete Laboratory Data Package	Supplemental (Note 4)
B	LS-41	L41B1416	14-16	12/13/95	Complete Laboratory Data Package	Supplemental (Note 4)

TABLE 1

GENERAL ELECTRIC COMPANY - PITTSFIELD, MASSACHUSETTS

SUPPLEMENTAL PRE-DESIGN INVESTIGATION WORK PLAN FOR
THE LYMAN STREET AREA REMOVAL ACTION

EXISTING SOIL PCB DATA AND PROPOSED USAGE

Data Source	Sample Location	Sample ID	Depth Interval	Date Collected	Available Documentation (See Note 2)	Proposed Data Usage
B	LS-41	L41B1618	16-18	12/13/95	See Note 5	Rejected (Depth)
B	LS-41	L41B1820	18-20	12/13/95	See Note 5	Rejected (Depth)
B	LS-42	L42B0002	0-2	4/23/96	Complete Laboratory Data Package	Grid Characterization
B	LS-42	L42B0204	2-4	4/23/96	Complete Laboratory Data Package	Grid Characterization
B	LS-42	L42B0406	4-6	4/23/96	Complete Laboratory Data Package	Grid Characterization
B	LS-42	L42B0608	6-8	4/23/96	Complete Laboratory Data Package	Grid Characterization
B	LS-42	L42B0810	8-10	4/23/96	Complete Laboratory Data Package	Grid Characterization
B	LS-42	L42B1012	10-12	4/23/96	Complete Laboratory Data Package	Grid Characterization
B	LS-42	L42B1214	12-14	4/23/96	Complete Laboratory Data Package	Grid Characterization
B	LS-42	L42B1416	14-16	4/23/96	Complete Laboratory Data Package	Grid Characterization
B	LS-42	L42B1618	16-18	4/23/96	See Note 5	Rejected (Depth)
B	LS-42	L42B1820	18-20	4/23/96	See Note 5	Rejected (Depth)
B	LS-42	L42B-DUP	18-20	4/23/96	See Note 5	Rejected (Depth)
B	LS-42	L42B2022	20-22	4/23/96	See Note 5	Rejected (Depth)
B	LS-42	L42B2224	22-24	4/23/96	See Note 5	Rejected (Depth)
B	LS-43	L43B0002	0-2	4/24/96	Complete Laboratory Data Package	Grid Characterization
B	LS-43	L43B0204	2-4	4/24/96	Complete Laboratory Data Package	Grid Characterization
B	LS-43	L43B0406	4-6	4/24/96	Complete Laboratory Data Package	Grid Characterization
B	LS-43	L43B0810	8-10	4/24/96	Complete Laboratory Data Package	Grid Characterization
B	LS-43	L43B1012	10-12	4/24/96	Complete Laboratory Data Package	Grid Characterization
B	LS-43	L43B1214	12-14	4/24/96	Complete Laboratory Data Package	Grid Characterization
B	LS-43	L43B1416	14-16	4/24/96	Complete Laboratory Data Package	Grid Characterization
B	LS-43	L43B1618	16-18	4/24/96	See Note 5	Rejected (Depth)
B	LS-43	L43B1820	18-20	4/24/96	See Note 5	Rejected (Depth)
B	LS-43	L43B2022	20-22	4/24/96	See Note 5	Rejected (Depth)
B	LS-43	L43B2224	22-24	4/24/96	See Note 5	Rejected (Depth)
B	LS-43	L43B-DUP	24-26	4/24/96	See Note 5	Rejected (Depth)
B	LS-44	L44B0002	0-2	4/24/96	Complete Laboratory Data Package	Grid Characterization
B	LS-44	L44B0204	2-4	4/24/96	Complete Laboratory Data Package	Grid Characterization
B	LS-44	L44B0406	4-6	4/24/96	Complete Laboratory Data Package	Grid Characterization
B	LS-44	L44B0608	6-8	4/24/96	Complete Laboratory Data Package	Grid Characterization
B	LS-44	L44B0810	8-10	4/24/96	Complete Laboratory Data Package	Grid Characterization
B	LS-44	L44B1012	10-12	4/24/96	Complete Laboratory Data Package	Grid Characterization
B	LS-44	L44B1214	12-14	4/24/96	Complete Laboratory Data Package	Grid Characterization
B	LS-44	L44B1416	14-16	4/24/96	Complete Laboratory Data Package	Grid Characterization
B	LS-44	L44B1618	16-18	4/24/96	See Note 5	Rejected (Depth)
B	LS-44	L44B1820	18-20	4/24/96	See Note 5	Rejected (Depth)
B	LS-44	L44B2022	20-22	4/24/96	See Note 5	Rejected (Depth)
B	LS-44	L44B2224	22-24	4/24/96	See Note 5	Rejected (Depth)
B	LS-44	L44B2426	24-26	4/24/96	See Note 5	Rejected (Depth)
B	LS-45	L45B0002	0-2	4/25/96	Complete Laboratory Data Package	Grid Characterization
B	LS-45	L45B0204	2-4	4/25/96	Complete Laboratory Data Package	Grid Characterization
B	LS-45	L45B0406	4-6	4/25/96	Complete Laboratory Data Package	Grid Characterization
B	LS-45	L45B0608	6-8	4/25/96	Complete Laboratory Data Package	Grid Characterization
B	LS-45	L45B0810	8-10	4/25/96	Complete Laboratory Data Package	Grid Characterization
B	LS-45	L45B1012	10-12	4/25/96	Complete Laboratory Data Package	Grid Characterization
B	LS-45	L45B1214	12-14	4/25/96	Complete Laboratory Data Package	Grid Characterization
B	LS-45	L45B-DUP	12-14	4/25/96	Complete Laboratory Data Package	Grid Characterization
B	LS-45	L45B1416	14-16	4/25/96	Complete Laboratory Data Package	Grid Characterization
B	LS-45	L45B1618	16-18	4/25/96	See Note 5	Rejected (Depth)

TABLE 1

GENERAL ELECTRIC COMPANY - PITTSFIELD, MASSACHUSETTS

SUPPLEMENTAL PRE-DESIGN INVESTIGATION WORK PLAN FOR
THE LYMAN STREET AREA REMOVAL ACTION

EXISTING SOIL PCB DATA AND PROPOSED USAGE

Data Source	Sample Location	Sample ID	Depth Interval	Date Collected	Available Documentation (See Note 2)	Proposed Data Usage
B	LS-45	L45B1820	18-20	4/25/96	See Note 5	Rejected (Depth)
B	LS-45	L45B2022	20-22	4/25/96	See Note 5	Rejected (Depth)
B	LS-45	L45B2224	22-24	4/25/96	See Note 5	Rejected (Depth)
B	LS-45	L45B2426	24-26	4/25/96	See Note 5	Rejected (Depth)
B	LS-45	L45B2628	26-28	4/25/96	See Note 5	Rejected (Depth)
B	LS-45	L45B2830	28-30	4/25/96	See Note 5	Rejected (Depth)
B	LS-45	L45B3032	30-32	4/25/96	See Note 5	Rejected (Depth)
B	LS-C11	LS-C-11	0-0.5	8/30/95	Complete Laboratory Data Package	Supplemental (Note 4)
B	LS-C12	LS-C-12	0-0.5	8/30/95	Complete Laboratory Data Package	Supplemental (Note 4)
B	LS-C13	LS-C-13	0-0.5	8/30/95	Complete Laboratory Data Package	Supplemental (Note 4)
B	LS-C14	LS-C-14	0-0.5	8/30/95	Complete Laboratory Data Package	Grid Characterization
B	LS-C15	LS-C-15	0-0.5	8/30/95	Complete Laboratory Data Package	Supplemental (Note 4)
B	LS-C16	LS-C-16	0-0.5	8/30/95	Complete Laboratory Data Package	Grid Characterization
B	LS-C16	LS-C-16 DUP	0-0.5	8/30/95	Complete Laboratory Data Package	Supplemental (Note 4)
B	LS-C17	LS-C-17	0-0.5	8/30/95	Complete Laboratory Data Package	Grid Characterization
B	LS-C18	LS-C-18	0-0.5	8/30/95	Complete Laboratory Data Package	Grid Characterization
B	LS-C19	LS-C-19	0-0.5	8/30/95	Complete Laboratory Data Package	Grid Characterization
B	LS-C19	LS-DUP-2	0-0.5	8/30/95	Complete Laboratory Data Package	Supplemental (Note 4)
B	LS-GWP-1	LS-GWP-1	0-1.75	11/21/94	None	Supplemental (Note 3)
B	LS-GWP-1	LS-GWP-1	1.75-3.5	11/21/94	None	Supplemental (Note 3)
B	LS-GWP-2	LS-GWP-2	0-1.75	11/21/94	None	Supplemental (Note 3)
B	LS-GWP-2	LS-GWP-2	1.75-3.5	11/21/94	None	Supplemental (Note 3)
B	LS-GWP-3	LS-GWP-3	0-1.75	11/21/94	None	Supplemental (Note 3)
B	LS-GWP-3	LS-GWP-3	1.75-3.5	11/21/94	None	Supplemental (Note 3)
B	LS-GWP-4	LS-GWP-4	0-1.75	11/21/94	None	Supplemental (Note 3)
B	LS-GWP-4	LS-GWP-4	1.75-3.5	11/21/94	None	Supplemental (Note 3)
B	LS-GWP-5	LS-GWP-5	0-1.75	11/21/94	None	Supplemental (Note 3)
B	LS-GWP-5	LS-GWP-5	1.75-3.5	11/21/94	None	Supplemental (Note 3)
B	LS-GWP-6	LS-GWP-6	0-0.5	12/16/94	Complete Laboratory Data Package	Supplemental (Note 4)
B	LS-GWP-7	LS-GWP-7	0-0.5	12/16/94	Complete Laboratory Data Package	Grid Characterization
B	LS-GWP-8	LS-GWP-8	0-0.5	12/16/94	Complete Laboratory Data Package	Supplemental (Note 4)
B	LS-GWP-9	LS-GWP-9	0-0.5	12/16/94	Complete Laboratory Data Package	Supplemental (Note 4)
B	LS-GWP-10	LS-GWP-10	0-0.5	12/16/94	Complete Laboratory Data Package	Supplemental (Note 4)
B	LS-GWP-11	LS-GWP-11	0-0.5	12/16/94	Complete Laboratory Data Package	Supplemental (Note 4)
B	LS-GWP-12	LS-GWP-12	0-0.5	12/16/94	Complete Laboratory Data Package	Supplemental (Note 4)
B	LS-GWP-13	LS-GWP-13	0-0.5	12/16/94	Complete Laboratory Data Package	Grid Characterization
B	LS-GWP-13	LS-GWP-DUP	0-0.5	12/16/94	Complete Laboratory Data Package	Grid Characterization
B	LS-GWP-14	LS-GWP-14	0-0.5	12/16/94	Complete Laboratory Data Package	Supplemental (Note 4)
B	LS-GWP-15	LS-GWP-15	0-0.5	12/16/94	Complete Laboratory Data Package	Supplemental (Note 4)
B	LS-GWP-16	LS-GWP-16	0-0.5	12/16/94	Complete Laboratory Data Package	Supplemental (Note 4)
B	LS-GWP-17	LS-GWP-17	0-0.5	2/21/95	Complete Laboratory Data Package	Grid Characterization
B	LS-GWP-18	LS-GWP-18	0-0.5	2/21/95	Complete Laboratory Data Package	Grid Characterization
B	LS-GWP-19	LS-GWP-19	0-0.5	2/21/95	Complete Laboratory Data Package	Supplemental (Note 4)
B	LS-GWP-20	LS-GWP-20	0-0.5	2/21/95	Complete Laboratory Data Package	Grid Characterization
B	LS-GWP-21	LS-GWP-21	0-0.5	2/21/95	Complete Laboratory Data Package	Grid Characterization
B	LS-GWP-22	LS-GWP-22	0-0.5	2/21/95	Complete Laboratory Data Package	Grid Characterization
B	LS-GWP-23	LS-GWP-23	0-0.5	2/21/95	Complete Laboratory Data Package	Grid Characterization
B	LS-GWP-24	LS-GWP-24	0-0.5	2/21/95	Complete Laboratory Data Package	Supplemental (Note 4)
B	LS-GWP-25	LS-GWP-25	0-0.5	2/21/95	Complete Laboratory Data Package	Grid Characterization
B	LS-GWP-26	LS-GWP-26	0-0.5	2/21/95	Complete Laboratory Data Package	Grid Characterization

TABLE 1

GENERAL ELECTRIC COMPANY - PITTSFIELD, MASSACHUSETTS

SUPPLEMENTAL PRE-DESIGN INVESTIGATION WORK PLAN FOR
THE LYMAN STREET AREA REMOVAL ACTION

EXISTING SOIL PCB DATA AND PROPOSED USAGE

Data Source	Sample Location	Sample ID	Depth Interval	Date Collected	Available Documentation (See Note 2)	Proposed Data Usage
B	LS-GWP-27	LS-GWP-27	0-0.5	2/21/95	Complete Laboratory Data Package	Grid Characterization
B	LS-GWP-28	LS-GWP-28	0-0.5	2/21/95	Complete Laboratory Data Package	Grid Characterization
B	LS-GWP-29	LS-GWP-29	0-0.5	2/21/95	Complete Laboratory Data Package	Supplemental (Note 4)
B	LS-GWP-30	LS-GWP-30	0-0.5	2/21/95	Complete Laboratory Data Package	Grid Characterization
B	LS-GWP-31	LS-GWP-31	0-0.5	2/21/95	None	Supplemental (Note 3)
B	LS-GWP-33	LS-GWP-33	0-0.5	8/30/95	Complete Laboratory Data Package	Supplemental (Note 4)
B	LS-GWP-34	LS-GWP-34	0-0.5	8/30/95	Complete Laboratory Data Package	Grid Characterization
B	LS-GWP-34	LS-GWP-DUP	0-0.5	2/21/95	Complete Laboratory Data Package	Grid Characterization
B	LS-PL-SS-C1	LS-PL-SS-C1	0-0.3	4/20/92	None	Supplemental (Note 3)
B	LS-PL-SS-C2	LS-PL-SS-C2	0-0.3	4/20/92	None	Supplemental (Note 3)
B	LS-PL-SS-C3	LS-PL-SS-C3	0-0.3	4/20/92	None	Supplemental (Note 3)
B	LS-PL-SS-C4	LS-PL-SS-C4	0-0.3	4/20/92	None	Supplemental (Note 3)
B	LS-PL-SS-C5	LS-PL-SS-C5	0-0.3	4/20/92	None	Supplemental (Note 3)
B	LS-PL-SS-C6	LS-PL-SS-C6	0-0.3	4/20/92	None	Supplemental (Note 3)
B	LS-PL-SS-C7	LS-PL-SS-C7	0-0.3	4/20/92	None	Supplemental (Note 3)
B	LS-PL-SS-C8	LS-PL-SS-C8	0-0.3	4/20/92	None	Supplemental (Note 3)
B	LS-PL-SS-C9	LS-PL-SS-C9	0-0.3	4/20/92	None	Supplemental (Note 3)
B	LS-PL-SS-C10	LS-PL-SS-C10	0-0.3	4/20/92	None	Supplemental (Note 3)
H	LSSC-01	LSSC-01-CS01	0-1	1/4/99	Complete Laboratory Data Package	Supplemental (Note 4)
H	LSSC-01	LSSC-01-CS0103	1-3	1/4/99	Complete Laboratory Data Package	Supplemental (Note 4)
H	LSSC-01	LSSC-01-CS0306	3-6	1/4/99	Complete Laboratory Data Package	Supplemental (Note 4)
H	LSSC-01	LSSC-01-CS0610	6-10	1/4/99	Complete Laboratory Data Package	Supplemental (Note 4)
H	LSSC-01	LSSC-01-CS1015	10-15	1/4/99	Complete Laboratory Data Package	Supplemental (Note 4)
H	LSSC-01	LSSC-01-CS3236	32-36	1/4/99	See Note 5	Rejected (Depth)
H	LSSC-02	LSSC-02-CS01	0-1	12/21/98	Complete Laboratory Data Package	Grid Characterization
H	LSSC-02	LSSC-02-CS0103	1-3	12/21/98	Complete Laboratory Data Package	Supplemental (Note 4)
H	LSSC-02	LSSC-02-CS0306	3-6	12/21/98	Complete Laboratory Data Package	Supplemental (Note 4)
H	LSSC-02	LSSC-02-CS0610	6-10	12/21/98	Complete Laboratory Data Package	Supplemental (Note 4)
H	LSSC-02	LSSC-02-CS1015	10-15	12/21/98	Complete Laboratory Data Package	Supplemental (Note 4)
H	LSSC-02	LSSC-02-CS2830	28-30	12/21/98	See Note 5	Rejected (Depth)
H	LSSC-04	LSSC-04-CS01	0-1	12/14/98	Complete Laboratory Data Package	Grid Characterization
H	LSSC-04	LSSC-04-CS0103	1-3	12/14/98	Complete Laboratory Data Package	Supplemental (Note 4)
H	LSSC-04	LSSC-04-CS0306	3-6	12/14/98	Complete Laboratory Data Package	Supplemental (Note 4)
H	LSSC-04	LSSC-04-CS0610	6-10	12/14/98	Complete Laboratory Data Package	Supplemental (Note 4)
H	LSSC-04	LSSC-04-CS1015	10-15	12/14/98	Complete Laboratory Data Package	Supplemental (Note 4)
H	LSSC-04	LSSC-04-CS2022	20-22	12/14/98	See Note 5	Rejected (Depth)
H	LSSC-06	LSSC-06-CS01	0-1	12/15/98	Complete Laboratory Data Package	Grid Characterization
H	LSSC-06	LSSC-06-CS0103	1-3	12/15/98	Complete Laboratory Data Package	Grid Characterization
H	LSSC-06	LSSC-06-CS0306	3-6	12/15/98	Complete Laboratory Data Package	Grid Characterization
H	LSSC-06	LSSC-06-CS0610	6-10	12/15/98	Complete Laboratory Data Package	Grid Characterization
H	LSSC-06	LSSC-06-CS1015	10-15	12/15/98	Complete Laboratory Data Package	Grid Characterization
H	LSSC-06	LSSC-06-CS1719	17-19	12/15/98	See Note 5	Rejected (Depth)
H	LSSC-07	LSSC-07-CS01	0-1	12/18/98	Complete Laboratory Data Package	Grid Characterization
H	LSSC-07	LSSC-07-CS0103	1-3	12/18/98	Complete Laboratory Data Package	Supplemental (Note 4)
H	LSSC-07	LSSC-07-CS0306	3-6	12/18/98	Complete Laboratory Data Package	Supplemental (Note 4)
H	LSSC-07	LSSC-07-CS0610	6-10	12/18/98	Complete Laboratory Data Package	Supplemental (Note 4)
H	LSSC-07	LSSC-07-CS1015	10-15	12/18/98	Complete Laboratory Data Package	Supplemental (Note 4)
H	LSSC-07	LSSC-07-CS2426	24-26	12/18/98	See Note 5	Rejected (Depth)
H	LSSC-07	LSSC-07-CS2628	26-28	12/18/98	See Note 5	Rejected (Depth)
H	LSSC-08	LSSC-08-CS0.5	0-0.5	12/16/98	Complete Laboratory Data Package	Grid Characterization

TABLE 1

GENERAL ELECTRIC COMPANY - PITTSFIELD, MASSACHUSETTS

SUPPLEMENTAL PRE-DESIGN INVESTIGATION WORK PLAN FOR
THE LYMAN STREET AREA REMOVAL ACTION

EXISTING SOIL PCB DATA AND PROPOSED USAGE

Data Source	Sample Location	Sample ID	Depth Interval	Date Collected	Available Documentation (See Note 2)	Proposed Data Usage
H	LSSC-08	LSSC-08-CS01	0-1	12/16/98	Complete Laboratory Data Package	Grid Characterization
H	LSSC-08	LSSC-08-CS0103	1-3	12/16/98	Complete Laboratory Data Package	Supplemental (Note 4)
H	LSSC-08	LSSC-08-CS0306	3-6	12/16/98	Complete Laboratory Data Package	Supplemental (Note 4)
H	LSSC-08	LSSC-08-CS0610	6-10	12/16/98	Complete Laboratory Data Package	Supplemental (Note 4)
H	LSSC-08	LSSC-08-CS1015	10-15	12/16/98	Complete Laboratory Data Package	Supplemental (Note 4)
H	LSSC-08	LSSC-08-CS2123	21-23	12/17/98	See Note 5	Rejected (Depth)
H	LSSC-08	LSSC-08-CS2324	23-24	12/17/98	See Note 5	Rejected (Depth)
H	LSSC-09	LSSC-09-CS01	0-1	12/16/98	Complete Laboratory Data Package	Grid Characterization
H	LSSC-09	LSSC-09-CS0103	1-3	12/16/98	Complete Laboratory Data Package	Grid Characterization
H	LSSC-09	LSSC-09-CS0306	3-6	12/16/98	Complete Laboratory Data Package	Grid Characterization
H	LSSC-09	LSSC-09-CS0610	6-10	12/16/98	Complete Laboratory Data Package	Grid Characterization
H	LSSC-09	LSSC-09-CS1015	10-15	12/16/98	Complete Laboratory Data Package	Grid Characterization
H	LSSC-09	LSSC-09-CS1719	17-19	12/16/98	See Note 5	Rejected (Depth)
H	LSSC-10	LSSC-10-CS0103	1-3	12/23/98	Complete Laboratory Data Package	Supplemental (Note 4)
H	LSSC-10	LSSC-10-CS0306	3-6	12/23/98	Complete Laboratory Data Package	Supplemental (Note 4)
H	LSSC-11	LSSC-11-CS01	0-1	12/29/98	Complete Laboratory Data Package	Grid Characterization
H	LSSC-11	LSSC-11-CS0103	1-3	12/29/98	Complete Laboratory Data Package	Grid Characterization
H	LSSC-11	LSSC-11-CS0306	3-6	12/29/98	Complete Laboratory Data Package	Grid Characterization
H	LSSC-11	LSSC-11-CS0610	6-10	12/29/98	Complete Laboratory Data Package	Grid Characterization
H	LSSC-11	LSSC-11-CS1015	10-15	12/29/98	Complete Laboratory Data Package	Grid Characterization
H	LSSC-11	LSSC-11-CS1517	15-17	12/29/98	See Note 5	Rejected (Depth)
A	LSSC-16f	LSSC-16-CS01	0-1	3/3/99	Complete Laboratory Data Package	Supplemental (Note 4)
A	LSSC-16f	LSSC-16-CS0103	1-3	3/3/99	Complete Laboratory Data Package	Supplemental (Note 4)
A	LSSC-16f	LSSC-16-CS0306	3-6	3/3/99	Complete Laboratory Data Package	Supplemental (Note 4)
A	LSSC-16f	LSSC-16-CS0610	6-10	3/3/99	Complete Laboratory Data Package	Supplemental (Note 4)
A	LSSC-16f	LSSC-16-CS0610 DUP	6-10	3/3/99	Complete Laboratory Data Package	Supplemental (Note 4)
A	LSSC-16f	LSSC-16-CS1015	10-15	3/3/99	Complete Laboratory Data Package	Supplemental (Note 4)
A	LSSC-16f	LSSC-16-CS2527	25-27	3/3/99	See Note 5	Rejected (Depth)
A	LSSC-16f	LSSC-16-CS2729	27-29	3/3/99	See Note 5	Rejected (Depth)
A	LSSC-17	LSSC-17-CS01	0-1	3/5/99	Complete Laboratory Data Package	Supplemental (Note 4)
A	LSSC-17	LSSC-17-CS0103	1-3	3/5/99	Complete Laboratory Data Package	Supplemental (Note 4)
A	LSSC-17	LSSC-17-CS0306	3-6	3/5/99	Complete Laboratory Data Package	Supplemental (Note 4)
A	LSSC-17	LSSC-17-CS0610	6-10	3/5/99	Complete Laboratory Data Package	Supplemental (Note 4)
A	LSSC-17	LSSC-17-CS1015	10-15	3/5/99	Complete Laboratory Data Package	Supplemental (Note 4)
A	LSSC-17	LSSC-17-CS2325	23-25	3/5/99	See Note 5	Rejected (Depth)
A	LSSC-17	LSSC-17-CS2527	25-27	3/5/99	See Note 5	Rejected (Depth)
A	LSSC-18	LSSC-18-CS01	0-1	3/29/99	Complete Laboratory Data Package	Grid Characterization
A	LSSC-18	LSSC-18-CS0103	1-3	3/29/99	Complete Laboratory Data Package	Supplemental (Note 4)
A	LSSC-18	LSSC-18-CS0306	3-6	3/29/99	Complete Laboratory Data Package	Supplemental (Note 4)
A	LSSC-18	LSSC-18-CS0610	6-10	3/29/99	Complete Laboratory Data Package	Supplemental (Note 4)
A	LSSC-18	LSSC-18-CS1015	10-15	3/29/99	Complete Laboratory Data Package	Supplemental (Note 4)
A	LSSC-19	LSSC-19-CS01	0-1	3/30/99	Complete Laboratory Data Package	Grid Characterization
A	LSSC-19	LSSC-19-CS0103	1-3	3/30/99	Complete Laboratory Data Package	Supplemental (Note 4)
A	LSSC-19	LSSC-19-CS0306	3-6	3/30/99	Complete Laboratory Data Package	Supplemental (Note 4)
A	LSSC-19	LSSC-19-CS0610	6-10	3/30/99	Complete Laboratory Data Package	Supplemental (Note 4)
A	LSSC-19	LSSC-19-CS1015	10-15	3/30/99	Complete Laboratory Data Package	Supplemental (Note 4)
A	LSSC-19	LSSC-19-CS1015 DUP	10-15	3/30/99	Complete Laboratory Data Package	Supplemental (Note 4)
A	LSSC-19	LSSC-19-CS2022	20-22	3/30/99	See Note 5	Rejected (Depth)
E	LSSC-31	LSSC-31-CS01	0-1	7/28/99	Complete Laboratory Data Package	Grid Characterization
E	LSSC-31	LSSC-31-CS0103	1-3	7/28/99	Complete Laboratory Data Package	Grid Characterization

TABLE 1

GENERAL ELECTRIC COMPANY - PITTSFIELD, MASSACHUSETTS

SUPPLEMENTAL PRE-DESIGN INVESTIGATION WORK PLAN FOR
THE LYMAN STREET AREA REMOVAL ACTION

EXISTING SOIL PCB DATA AND PROPOSED USAGE

Data Source	Sample Location	Sample ID	Depth Interval	Date Collected	Available Documentation (See Note 2)	Proposed Data Usage
E	LSSC-31	LSSC-31-CS0306	3-6	7/28/99	Complete Laboratory Data Package	Grid Characterization
E	LSSC-31	LSSC-31-CS0610	6-10	7/28/99	Complete Laboratory Data Package	Grid Characterization
E	LSSC-31	LSSC-31-CS1015	10-15	7/28/99	Complete Laboratory Data Package	Grid Characterization
E	LSSC-31	LSSC-31-SS368	36-38	7/28/99	See Note 5	Rejected (Depth)
F	LSSC-32	LSSC-32-SS18	34-36	7/29/99	See Note 5	Rejected (Depth)
F	LSSC-33	LSSC-33-SS2830	28-30	7/30/99	See Note 5	Rejected (Depth)
F	LSSC-34I	LSSC-34I-CS2428	24-28	7/29/99	See Note 5	Rejected (Depth)
I	OT000011	H2-OT000011-0-0000	0-0.5	1/2/02	Received from EPA	Supplemental (Note 4)
I	OT000012	H2-OT000012-0-0000	0-0.5	1/2/02	Received from EPA	Supplemental (Note 4)
I	OT000013	H2-OT000013-0-0000	0-0.5	1/2/02	Received from EPA	Supplemental (Note 4)
G	SL0169	081898BT08	0-0.5	8/18/1998	Received from EPA	Grid Characterization
G	SL0169	081898BT09	1-1.5	8/18/1998	Received from EPA	Supplemental (Note 4)
G	SL0169	081898BT10	2-2.5	8/18/1998	Received from EPA	Supplemental (Note 4)
G	SL0172	081898BT15	0-0.5	8/18/1998	Received from EPA	Supplemental (Note 4)
G	SL0172	081898BT16	1-1.5	8/18/1998	Received from EPA	Supplemental (Note 4)
G	SL0172	081898BT17	2-2.5	8/18/1998	Received from EPA	Supplemental (Note 4)
G	SL0177	081898BT23	0-0.5	8/18/1998	Received from EPA	Grid Characterization
G	SL0177	081898BT24	1-1.5	8/18/1998	Received from EPA	Supplemental (Note 4)
G	SL0180	081898CT08	0-0.5	8/18/1998	Received from EPA	Grid Characterization
G	SL0180	081898CT09	1-1.5	8/18/1998	Received from EPA	Grid Characterization
G	SL0180	081898CT10	2-2.5	8/18/1998	Received from EPA	Grid Characterization
G	SL0184	081898CT18	0-0.5	8/18/1998	Received from EPA	Supplemental (Note 4)
G	SL0184	081898CT19	1-1.5	8/18/1998	Received from EPA	Supplemental (Note 4)
G	SL0184	081898CT20	2-2.5	8/18/1998	Received from EPA	Supplemental (Note 4)
G	SL0186	081898CT27	0-0.5	8/18/1998	Received from EPA	Grid Characterization
G	SL0186	081898CT28	1-1.5	8/18/1998	Received from EPA	Supplemental (Note 4)
G	SL0186	081898CT29	2-2.5	8/18/1998	Received from EPA	Supplemental (Note 4)
G	SL0187	081898CT37	0-0.5	8/18/1998	Received from EPA	Supplemental (Note 4)
G	SL0187	081898CT38	1-1.5	8/18/1998	Received from EPA	Supplemental (Note 4)
G	SL0187	081898CT39	2-2.5	8/18/1998	Received from EPA	Supplemental (Note 4)
G	SL0231	082198BT07	0-0.5	8/21/1998	Received from EPA	Grid Characterization
G	SL0231	082198BT08	1-1.5	8/21/1998	Received from EPA	Supplemental (Note 4)
G	SL0231	082198BT09	2-2.5	8/21/1998	Received from EPA	Supplemental (Note 4)
G	SL0234	082198BT17	0-0.5	8/21/1998	Received from EPA	Supplemental (Note 4)
G	SL0234	082198BT18	1-1.5	8/21/1998	Received from EPA	Supplemental (Note 4)
G	SL0237	082498MS09	0-0.5	8/24/1998	Received from EPA	Supplemental (Note 4)
G	SL0237	082498MS10	1-1.5	8/24/1998	Received from EPA	Supplemental (Note 4)
G	SL0237	082498MS11	2-2.5	8/24/1998	Received from EPA	Supplemental (Note 4)
G	SL0240	082498MS18	0-0.5	8/24/1998	Received from EPA	Supplemental (Note 4)
G	SL0240	082498MS19	1-1.5	8/24/1998	Received from EPA	Supplemental (Note 4)
G	SL0240	082498MS20	2-2.5	8/24/1998	Received from EPA	Supplemental (Note 4)
G	SL0243	082498MS28	0-0.5	8/24/1998	Received from EPA	Grid Characterization
G	SL0243	082498MS29	1-1.5	8/24/1998	Received from EPA	Supplemental (Note 4)
G	SL0243	082498MS30	2-2.5	8/24/1998	Received from EPA	Supplemental (Note 4)
G	SL0246	082598MS07	0-0.5	8/25/1998	Received from EPA	Supplemental (Note 4)
G	SL0246	082598MS08	1-1.5	8/25/1998	Received from EPA	Supplemental (Note 4)
G	SL0246	082598MS09	2-2.5	8/25/1998	Received from EPA	Supplemental (Note 4)

TABLE 1
GENERAL ELECTRIC COMPANY - PITTSFIELD, MASSACHUSETTS
SUPPLEMENTAL PRE-DESIGN INVESTIGATION WORK PLAN FOR
THE LYMAN STREET AREA REMOVAL ACTION
EXISTING SOIL PCB DATA AND PROPOSED USAGE

NOTES:

1. This table lists all existing PCB soil samples that Blasland, Bouck & Lee (BBL) and General Electric (GE) have on record for the Lyman Street Area. Included in this list are soil samples that are proposed to be used to satisfy grid-based and supplemental sampling.
2. None = No laboratory documentation available; data located only in prior data summary table(s) and/or report figure(s).
3. Supplemental (Note 3) = Data will be used for supplemental purposes only due to no available laboratory documentation.
4. Supplemental (Note 4) = Data will be used for supplemental purposes only due to no grid nodes within the vicinity of this data (i.e., within 25 feet for 50-foot grid nodes, or within 50 feet for 100-foot grid nodes).
5. Rejected (Depth) = Result was rejected because the depth of the sample collected is overly large or outside the scope of this project. Therefore, a laboratory data package search was not conducted.
6. ** = Analytical data not included in Appendix A because it is not yet available.
7. Data Source Legend
 - A = Source Control Investigation Addendum Report Upper Reach Housatonic River (First ½ Mile); June 1999.
 - B = MCP Supplemental Phase II/RCRA Facility Investigation Report for Lyman Street USEPA Area 5A Site; June 1996.
 - C = MCP Phase I and Interim Phase II Report for Former Housatonic River Oxbow Areas A, B, C, J, and K; February 1996.
 - E = July/August 1999 Additional Source Control Investigations, Lyman Street Site, September 1999.
 - F = Final Addendum to the Engineering Evaluation/Cost Analysis for the Upper Reach of the Housatonic River; October 2000.
 - G = Removal Action Work Plan - Upper 1.2-Mile Reach of Housatonic River, August 1999
 - H = Appendix E to Consent Decree, Volume III, Annex 2 to Statement of Work for Removal Actions Outside the River, Documentation Related to Source Control Activities; October 1999.
 - I = Information received from the EPA.

TABLE 2

GENERAL ELECTRIC COMPANY - PITTSFIELD, MASSACHUSETTS

SUPPLEMENTAL PRE-DESIGN INVESTIGATION WORK PLAN FOR
THE LYMAN STREET AREA REMOVAL ACTION

EXISTING SOIL APPENDIX IX+3 DATA AND PROPOSED USAGE

Data Source	Sample Location	Sample ID	Depth Interval	Date Collected	Analyte Group					Available Documentation (See Notes 4 & 5)	Proposed Data Usage (See Note 6)
					VOCs	SVOCs	PCDDs/ PCDFs	Inorganics	Pest/Herb *		
C	B-1	ROB1B0406	4-6	11/21/91	X	X	X		X	Complete Laboratory Data Package (Inorganics)	Appendix IX Characterization
C	B-1	ROB-DPA1	4-6	11/21/91	X	X	X		X	Complete Laboratory Data Package (Inorganics)	Appendix IX Characterization
C	B-2	ROB2B0002	0-2	11/21/91	X	X	X		X	Complete Laboratory Data Package (Inorganics)	Appendix IX Characterization
B	E-1	ROE1B1012	10-12	3/26/91	X	X	X	X	X	Form 1 (Inorganics)	To Be Determined
B	E-1	ROE1B1012	10-12	11/3/91						Form 1	To Be Determined
B	E-1	ROE1B2022	20-22	11/3/91	X	X				See Note 7	Rejected (Depth)
B	E-2	ROE2B0810	8-10	3/25/91	X	X		X	X	Form 1	To Be Determined
B	E-2	ROE2B1416	14-16	3/25/91	X					Form 1	To Be Determined
B	E-2	ROE2B1618	16-18	3/25/91	X					See Note 7	Rejected (Depth)
B	E-2	ROE2B1820	18-20	3/25/91	X					See Note 7	Rejected (Depth)
B	E-3	OE3B0002	0-2	8/9/95	X	X	X	X	X	Complete Laboratory Data Package (Herbicides)	Appendix IX Characterization
B	E-4	OE4B0002	0-2	8/9/95	X	X	X	X	X	Complete Laboratory Data Package (Herbicides)	Appendix IX Characterization
B	E-5	OE5B0608	6-8	8/10/95	X	X	X	X	X	Complete Laboratory Data Package (Herbicides)	Appendix IX Characterization
B	E-6	OE6B0002	0-2	8/16/95	X	X	X	X	X	Complete Laboratory Data Package (Herbicides)	Appendix IX Characterization
B	E-7	OE-7B0406	4-6	8/7/95	X	X	X	X	X	Complete Laboratory Data Package (Herbicides)	Appendix IX Characterization
B	E-8	OE8B1820	18-20	8/9/95	X	X	X	X	X	See Note 7	Rejected (Depth)
I	GB-A **	OB-BH000555-0-0100	10-15	1/2/02		X	X		X	Received from EPA	Appendix IX Characterization
I	GB-A **	OB-BH000555-0-0120	12-14	1/2/02	X					Received from EPA	Appendix IX Characterization
I	GB-C **	OB-BH000557-0-0060	6-10	1/2/02	X	X	X	X		Received from EPA	Appendix IX Characterization
I	GB-E **	OB-BH000559-0-0060	6-10	1/2/02	X	X	X	X		Received from EPA	Appendix IX Characterization
F	H2-RB010661-0-0000	H2-RB010661-0-0020	2-2.5	11/24/1998	X	X	X	X	X	Received from EPA	Appendix IX Characterization
F	H2-RB010761-0-0000	H2-RB010761-0-0000	0-0.5	11/23/1998	X	X	X	X	X	Received from EPA	Appendix IX Characterization
F	H2-RB010841-0-0000	H2-RB010841-0-0010	2-2.5	11/20/1998	X	X	X	X	X	Received from EPA	Appendix IX Characterization
B	LS-2	LS-2	0-4	8/24/89	X	X				See Note 7	Rejected (Depth)
B	LS-2	LS-2	4-8	8/24/89	X	X				See Note 7	Rejected (Depth)
B	LS-2	LS-2	8-12	8/24/89	X	X				See Note 7	Rejected (Depth)
B	LS-2	LS-2	18-22	8/24/89	X	X				See Note 7	Rejected (Depth)
B	LS-4	LS-4	0-6	8/26/89	X	X				None	To Be Determined
B	LS-4	LS-4	6-12	8/26/89	X	X				None	To Be Determined
B	LS-4	LS-4	12-18	8/26/89	X	X				See Note 7	Rejected (Depth)
B	LS-4	LS-4	18-22	8/26/89	X	X				See Note 7	Rejected (Depth)
B	LS-7	LS-7	14-16	9/14/90	X	X	X	X	X	None	To Be Determined
B	LS-8	LS-8	16-18	9/17/90	X	X	X	X	X	See Note 7	Rejected (Depth)
B	LS-8	LS-8	20-22	9/17/90	X					See Note 7	Rejected (Depth)
B	LS-8	LS-8	22-24	9/17/90	X					See Note 7	Rejected (Depth)
B	LS-9	LS-9	14-16	9/17/90	X	X	X	X	X	None	To Be Determined
B	LS-9	LS-9	16-18	9/17/90	X					See Note 7	Rejected (Depth)
B	LS-10	LS-10	10-12	9/19/90	X	X	X	X	X	None	To Be Determined
B	LS-11	LS-11	8-10	9/18/90	X					None	To Be Determined
B	LS-11	LS-11	10-12	9/18/90	X	X	X	X	X	None	To Be Determined
B	LS-11	LS-11	12-14	9/18/90	X					None	To Be Determined
B	LS-11	LS-11	14-16	9/18/90	X					None	To Be Determined
B	LS-11	LS-11	16-18	9/18/90	X					See Note 7	Rejected (Depth)
B	LS-12	LS-12	20-22	9/20/90	X					See Note 7	Rejected (Depth)
B	LS-26	L26B1012	10-12	8/10/95	X	X	X	X	X	Complete Laboratory Data Package (Herbicides)	Appendix IX Characterization
B	LS-27	L27B0204	2-4	8/11/95	X	X	X	X	X	Complete Laboratory Data Package (Herbicides)	Appendix IX Characterization
B	LS-28	L28B1012	10-12	8/14/95	X	X	X	X	X	Complete Laboratory Data Package (Herbicides)	Appendix IX Characterization
B	LS-29	L29B1012	10-12	8/8/95	X	X	X	X	X	Complete Laboratory Data Package (Herbicides)	Appendix IX Characterization
B	LS-30	L30B1416	14-16	8/14/95	X	X	X	X	X	Complete Laboratory Data Package (Herbicides)	Appendix IX Characterization
B	LS-31	L31B1820	18-20	8/15/95	X	X	X	X	X	See Note 7	Rejected (Depth)

TABLE 2

GENERAL ELECTRIC COMPANY - PITTSFIELD, MASSACHUSETTS

SUPPLEMENTAL PRE-DESIGN INVESTIGATION WORK PLAN FOR
THE LYMAN STREET AREA REMOVAL ACTION

EXISTING SOIL APPENDIX IX+3 DATA AND PROPOSED USAGE

Data Source	Sample Location	Sample ID	Depth Interval	Date Collected	Analyte Group					Available Documentation (See Notes 4 & 5)	Proposed Data Usage (See Note 6)
					VOCs	SVOCs	PCDDs/ PCDFs	Inorganics	Pest/Herb *		
B	LS-32	LS3224	2-4	10-12-94	X	X	X	X	X	Complete Laboratory Data Package	Appendix IX Characterization
B	LS-32	LS3268	6-8	10-12-94	X					Complete Laboratory Data Package	Appendix IX Characterization
B	LS-32	LS321012	10-12	10-12-94	X					None	To Be Determined
B	LS-32	LS321214	12-14	10-12-94	X					None	To Be Determined
B	LS-32	LS321416	14-16	10-12-94	X					None	To Be Determined
B	LS-32	LS321618	16-18	10-12-94	X					See Note 7	Rejected (Depth)
B	LS-33	LS3368	6-8	10-12-94	X					Complete Laboratory Data Package	Appendix IX Characterization
B	LS-33	LS331416	14-16	10-12-94	X					Complete Laboratory Data Package	Appendix IX Characterization
B	LS-33	LS331618	16-18	10-12-94	X	X	X	X	X	See Note 7	Rejected (Depth)
B	LS-34	L34B2224	22-24	12-14-95	X	X	X	X	X	See Note 7	Rejected (Depth)
B	LS-35	L35B1214	12-14	8-15-95	X	X	X	X	X	Complete Laboratory Data Package (Inorganics and Herbicides)	Appendix IX Characterization
B	LS-36	L36B1618	16-18	8-7-95	X	X	X	X	X	See Note 7	Rejected (Depth)
B	LS-37	L37B0608	6-8	8-8-95	X	X	X	X	X	Complete Laboratory Data Package (Herbicides)	Appendix IX Characterization
B	LS-38	L38B1618	16-18	8-14-95	X	X	X	X	X	See Note 7	Rejected (Depth)
B	LS-39	L39B1012	10-12	8-10-95	X	X	X	X	X	Complete Laboratory Data Package (Herbicides)	Appendix IX Characterization
B	LS-40	L40B1012	10-12	8-10-95	X	X	X	X	X	Complete Laboratory Data Package (Herbicides)	Appendix IX Characterization
B	LS-42	L42B2022	20-22	4-23-96	X	X	X	X	X	See Note 7	Rejected (Depth)
B	LS-43	L43B2224	22-24	4-24-96	X	X	X	X	X	See Note 7	Rejected (Depth)
B	LS-44	L44B2224	22-24	4-24-96	X	X	X	X	X	See Note 7	Rejected (Depth)
B	LS-45	L45B1012	10-12	4-25-96	X	X	X	X	X	None	To Be Determined
B	LS-C-18	LS-C-18	0-0.5	8-30-95	X	X	X	X	X	Complete Laboratory Data Package (Herbicides)	Appendix IX Characterization
B	LS-GWP-33	LS-GWP-33	0-0.5	8-30-95	X	X	X	X	X	Complete Laboratory Data Package (Herbicides)	Appendix IX Characterization
B	LS-GWP-34	LS-GWP-34	0-0.5	8-30-95	X	X	X	X	X	Complete Laboratory Data Package (Herbicides)	Appendix IX Characterization
B	LS-GWP-34	LS-GWP-34 DUP	0-0.5	8-30-95	X	X	X	X	X	Complete Laboratory Data Package (Herbicides)	Appendix IX Characterization
H	LSSC-01	LSSC-01-SS05	6-8	1-4-99	X					Complete Laboratory Data Package	To Be Determined
H	LSSC-01	LSSC-01-CS0610	6-10	1-4-99				X		Complete Laboratory Data Package	To Be Determined
H	LSSC-01	LSSC-01-CS0610 D	6-10	1-4-99		X	X	X		Complete Laboratory Data Package	To Be Determined
H	LSSC-02	LSSC-02-CS1015	10-15	12-21-98		X	X	X		Complete Laboratory Data Package	Appendix IX Characterization
H	LSSC-02	LSSC-02-SS08	12-14	12-21-98	X					Complete Laboratory Data Package	Appendix IX Characterization
H	LSSC-03	LSSC-03-SS06	6-8	12-16-98	X					Complete Laboratory Data Package	Appendix IX Characterization
H	LSSC-04	LSSC-04-CS0610	6-10	12-14-98	X	X	X	X		Complete Laboratory Data Package	Appendix IX Characterization
H	LSSC-06	LSSC-06-CS1015	10-15	12-15-98		X	X	X		Complete Laboratory Data Package	Appendix IX Characterization
H	LSSC-06	LSSC-06-CS1015 D	10-15	12-15-98		X		X		Complete Laboratory Data Package	Appendix IX Characterization
H	LSSC-06	LSSC-06-SS09	14-15	12-15-98	X					Complete Laboratory Data Package	Appendix IX Characterization
H	LSSC-07	LSSC-07-CS1015	10-15	12-18-98		X	X	X		Complete Laboratory Data Package	Appendix IX Characterization
H	LSSC-07	LSSC-07-CS2426	24-26	12-18-98		X	X	X		See Note 7	Rejected (Depth)
H	LSSC-07	LSSC-07-SS08	12-14	12-18-98	X					Complete Laboratory Data Package	Appendix IX Characterization
H	LSSC-07	LSSC-07-SS15	24-26	12-18-98	X					See Note 7	Rejected (Depth)
H	LSSC-08	LSSC-08-CS1015	10-15	12-16-98		X	X	X		Complete Laboratory Data Package	Appendix IX Characterization
H	LSSC-08	LSSC-08-CS1015 D	10-15	12-16-98		X				Complete Laboratory Data Package	Appendix IX Characterization
H	LSSC-08	LSSC-08-CS2123	21-23	12-17-98		X	X	X		See Note 7	Rejected (Depth)
H	LSSC-08	LSSC-08-SS09	14-15	12-17-98	X					Complete Laboratory Data Package	Appendix IX Characterization
H	LSSC-08	LSSC-08-SS15	23-24	12-18-98	X					See Note 7	Rejected (Depth)
H	LSSC-09	LSSC-09-CS1015	10-15	12-16-98		X	X	X		Complete Laboratory Data Package	Appendix IX Characterization
H	LSSC-09	LSSC-09-SS08	12-14	12-16-98	X					Complete Laboratory Data Package	Appendix IX Characterization
H	LSSC-10	LSSC-10-CS1015	10-15	12-16-98		X	X	X		Complete Laboratory Data Package	Appendix IX Characterization
H	LSSC-10	LSSC-10-SS09	14-15	12-23-98	X					Complete Laboratory Data Package	Appendix IX Characterization
H	LSSC-11	LSSC-11-CS1015	10-15	12-29-98		X	X	X		Complete Laboratory Data Package	Appendix IX Characterization
H	LSSC-11	LSSC-11-CS1517	15-17	12-29-98		X	X	X		See Note 7	Rejected (Depth)
H	LSSC-11	LSSC-11-SS08	12-14	12-29-98	X					Complete Laboratory Data Package	Appendix IX Characterization

TABLE 2

GENERAL ELECTRIC COMPANY - PITTSFIELD, MASSACHUSETTS
 SUPPLEMENTAL PRE-DESIGN INVESTIGATION WORK PLAN FOR
 THE LYMAN STREET AREA REMOVAL ACTION
 EXISTING SOIL APPENDIX IX+3 DATA AND PROPOSED USAGE

Data Source	Sample Location	Sample ID	Depth Interval	Date Collected	Analyte Group					Available Documentation (See Notes 4 & 5)	Proposed Data Usage (See Note 6)
					VOCs	SVOCs	PCDDs/ PCDFs	Inorganics	Pest/Herb *		
H	LSSC-11	LSSC-11-SS10	15-17	12/29/98	X					See Note 7	Rejected (Depth)
A	LSSC-16I	LSSC-16-CS1015	10-15	12/29/98	X	X	X	X		Complete Laboratory Data Package	Appendix IX Characterization
A	LSSC-16I	LSSC-16-CS1015 D	10-15	12/29/98				X		Complete Laboratory Data Package	Appendix IX Characterization
A	LSSC-16I	LSSC-16-CS2527	25-27	12/18/98	X	X	X	X		See Note 7	Rejected (Depth)
A	LSSC-16I	LSSC-16-SS08	12-14	12/29/98	X					Complete Laboratory Data Package	Appendix IX Characterization
A	LSSC-17	LSSC-17-SS07	10-12	12/29/98	X					Complete Laboratory Data Package	Appendix IX Characterization
A	LSSC-17	LSSC-17-CS1015	10-15	12/29/98	X	X	X	X		Complete Laboratory Data Package	Appendix IX Characterization
A	LSSC-17	LSSC-17-CS1015 D	10-15	12/29/98		X	X	X		Complete Laboratory Data Package	Appendix IX Characterization
A	LSSC-17	LSSC-17-CS2325	23-25	12/18/98	X	X	X	X		See Note 7	Rejected (Depth)
A	LSSC-17	LSSC-17-SS14	23-25	12/29/98	X					See Note 7	Rejected (Depth)
A	LSSC-18	LSSC-18-CS1015	10-15	12/29/98		X	X	X		Complete Laboratory Data Package	Appendix IX Characterization
A	LSSC-18	LSSC-18-SS08	12-14	12/29/98	X					Complete Laboratory Data Package	Appendix IX Characterization
A	LSSC-19	LSSC-19-CS1015	10-15	12/29/98		X	X	X		Complete Laboratory Data Package	Appendix IX Characterization
A	LSSC-19	LSSC-19-SS07	10-12	12/29/98	X					Complete Laboratory Data Package	Appendix IX Characterization
E	LSSC-31	LSSC-31-SS04	5-6	7/27/99	X					Complete Laboratory Data Package	Appendix IX Characterization
E	LSSC-31	LSSC-31-CS0610	6-10	7/27/99		X	X	X		Complete Laboratory Data Package	Appendix IX Characterization
E	LSSC-34I	LSSC-34I-SS13	24-26	7/29/99	X					See Note 7	Rejected (Depth)
E	LSSC-34I	LSSC-34I-CS2428	24-28	7/29/99		X	X	X		See Note 7	Rejected (Depth)
G	SL0187	081898CT37	0-0.5	8/18/1998	X	X	X	X	X	Received from EPA	Appendix IX Characterization
G	SL0243	082498MS29	1-1.5	8-24/1998	X	X	X	X	X	Received from EPA	Appendix IX Characterization

NOTES:

- This table lists all existing soil samples analyzed for some or all Appendix IX+3 constituents and corresponding parameter groups that Blasland, Bouck & Lee (BBL) and General Electric (GE) have on record for the Lyman Street Area.
- * - certain samples represented in this column were analyzed for various organochloride pesticide/herbicide analytes, while others were analyzed for various organophosphorus pesticide analytes.
- X - analyses were performed for that parameter group.
- Exceptions are in parentheses and indicate specific parameter groups for the sample with no data package or Form 1 on file.
- None - No laboratory documentation available; data located only in prior data summary table(s) and/or report figure(s).
- Parameter groups documented as having a complete data package available will be utilized for Appendix IX characterization.
- Rejected (Depth) - Result was rejected because the depth from which the sample was collected is overly large or outside the scope of this project. Therefore, a laboratory data package search was not conducted.
- ** - Analytical data not included in Appendix A because it is not yet available.
- Data Source Legend:
 A - Source Control Investigation Addendum Report Upper Reach Housatonic River (First 1/2 Mile); June 1999.
 B - MCP Supplemental Phase II/RCA Facility Investigation Report for Lyman Street/USEPA Area 5A Site; June 1996.
 C - MCP Phase I and Interm Phase II Report for Former Housatonic River Oxbow Areas A, B, C, J, and K; February 1996.
 E - July/August 1999 Additional Source Control Investigations, Lyman Street Site; September 1999.
 F - Final Addendum to the Engineering Evaluation/Cost Analysis for the Upper Reach of the Housatonic River; October 2000.
 G - Removal Action Work Plan - Upper 1/2-Mile Reach of Housatonic River; August 1999.
 H - Appendix E to Consent Decree, Volume III, Annex 2 to Statement of Work for Removal Actions Outside the River, Documentation Related to Source Control Activities; October 1999.
 I - Information received from the EPA.

TABLE 3
 GENERAL ELECTRIC COMPANY - PITTSFIELD, MASSACHUSETTS
 SUPPLEMENTAL PRE-DESIGN INVESTIGATION WORK PLAN FOR
 THE LYMAN STREET AREA REMOVAL ACTION

SUMMARY OF PROPOSED GRID CHARACTERIZATION OF PCBs

GRID COORDINATE	SAMPLE TYPE	DEPTH INCREMENT				
		0-1 ft	1-3 ft	3-6 ft	6-10 ft	10-15 ft
ZZ28	EXISTING: PROPOSED:	-- RAA12-ZZ28	-- RAA12-ZZ28	-- RAA12-ZZ28	-- RAA12-ZZ28	-- RAA12-ZZ28
A26	EXISTING: PROPOSED:	-- RAA12-A26				
A27	EXISTING: PROPOSED:	E-7 --				
A28	EXISTING: PROPOSED:	-- RAA12-A28				
B25	EXISTING: PROPOSED:	-- RAA12-B25				
B26	EXISTING: PROPOSED:	-- RAA12-B26	-- RAA12-B26	-- RAA12-B26	-- RAA12-B26	-- RAA12-B26
B27	EXISTING: PROPOSED:	LS-GWP-34 --				
B28	EXISTING: PROPOSED:	-- RAA12-B28	-- RAA12-B28	-- RAA12-B28	-- RAA12-B28	-- RAA12-B28
B29	EXISTING: PROPOSED:	-- RAA12-B29				
C26	EXISTING: PROPOSED:	-- RAA12-C26				
C27	EXISTING: PROPOSED:	-- RAA12-C27				
C28	EXISTING: PROPOSED:	LS-GWP-30 --				
C29	EXISTING: PROPOSED:	E-6 --				
C30	EXISTING: PROPOSED:	LS-GWP-28 --				
D27	EXISTING: PROPOSED:	-- RAA12-D27				
D28	EXISTING: PROPOSED:	-- RAA12-D28	-- RAA12-D28	-- RAA12-D28	-- RAA12-D28	-- RAA12-D28
D29	EXISTING: PROPOSED:	LS-GWP-27 --				
D30	EXISTING: PROPOSED:	-- RAA12-D30	-- RAA12-D30	-- RAA12-D30	-- RAA12-D30	-- RAA12-D30
E25	EXISTING: PROPOSED:	-- RAA12-E25				
E26	EXISTING: PROPOSED:	LS-C17 --				
E27	EXISTING: PROPOSED:	LS-GWP-26 --				
E28	EXISTING: PROPOSED:	-- RAA12-E28				
E29	EXISTING: PROPOSED:	-- RAA12-E29				
E30	EXISTING: PROPOSED:	-- RAA12-E30				
E31	EXISTING: PROPOSED:	LS-GWP-25 --				
F23	EXISTING: PROPOSED:	-- RAA12-F23				
F24	EXISTING: PROPOSED:	-- RAA12-F24	-- RAA12-F24	-- RAA12-F24	-- RAA12-F24	-- RAA12-F24
F25	EXISTING: PROPOSED:	LS-C19 --				
F26	EXISTING: PROPOSED:	-- RAA12-F26	-- RAA12-F26	-- RAA12-F26	-- RAA12-F26	-- RAA12-F26
F27	EXISTING: PROPOSED:	-- RAA12-F27				
F28	EXISTING: PROPOSED:	LS-GWP-23 --	-- RAA12-F28	-- RAA12-F28	-- RAA12-F28	-- RAA12-F28
F29	EXISTING: PROPOSED:	-- RAA12-F29				
F30	EXISTING: PROPOSED:	E-5 --	E-5 --	E-5 --	E-5 --	E-5 --
F31	EXISTING: PROPOSED:	-- RAA12-F31				
F32	EXISTING: PROPOSED:	LS-GWP-22 --	-- RAA12-F32	-- RAA12-F32	-- RAA12-F32	-- RAA12-F32

TABLE 3
 GENERAL ELECTRIC COMPANY - PITTSFIELD, MASSACHUSETTS
 SUPPLEMENTAL PRE-DESIGN INVESTIGATION WORK PLAN FOR
 THE LYMAN STREET AREA REMOVAL ACTION

SUMMARY OF PROPOSED GRID CHARACTERIZATION OF PCBs

GRID COORDINATE	SAMPLE TYPE	DEPTH INCREMENT				
		0-1 ft	1-3 ft	3-6 ft	6-10 ft	10-15 ft
G22	EXISTING: -- PROPOSED: RAA12-G22	--				
G23	EXISTING: -- PROPOSED: RAA12-G23	--				
G24	EXISTING: -- PROPOSED: RAA12-G24	--				
G25	EXISTING: -- PROPOSED: RAA12-G25	--				
G26	EXISTING: -- PROPOSED: RAA12-G26	--				
G27	EXISTING: -- PROPOSED: RAA12-G27	--				
G28	EXISTING: -- PROPOSED: RAA12-G28	--				
G29	EXISTING: -- PROPOSED: RAA12-G29	--				
G30	EXISTING: LS-GWP-21 PROPOSED: --	--				
G31	EXISTING: -- PROPOSED: RAA12-G31	--				
G32	EXISTING: -- PROPOSED: RAA12-G32	--				
G33	EXISTING: RAA4-P2 PROPOSED: --	--				
H21	EXISTING: -- PROPOSED: RAA12-H21	--				
H22	EXISTING: -- PROPOSED: RAA12-H22	--	RAA12-H22	RAA12-H22	RAA12-H22	RAA12-H22
H23	EXISTING: -- PROPOSED: RAA12-H23	--				
H24	EXISTING: LS-40 PROPOSED: --	LS-40	LS-40	LS-40	LS-40	RAA12-H24
H25	EXISTING: LS-C16 PROPOSED: --	--				
H26	EXISTING: -- PROPOSED: RAA12-H26	--	RAA12-H26	RAA12-H26	RAA12-H26	RAA12-H26
H27	EXISTING: LS-26 PROPOSED: --	--				
H28	EXISTING: -- PROPOSED: RAA12-H28	--	RAA12-H28	RAA12-H28	RAA12-H28	RAA12-H28
H29	EXISTING: LS-GWP-20 PROPOSED: --	--				
H30	EXISTING: E-2 PROPOSED: --	E-2	E-2	E-2	E-2	E-2
H31	EXISTING: LS-GWP-18 PROPOSED: --	--				
H32	EXISTING: -- PROPOSED: RAA12-H32	--	RAA12-H32	RAA12-H32	RAA12-H32	RAA12-H32
H33	EXISTING: -- PROPOSED: RAA12-H33	--				
H34	EXISTING: RAA4-Q3 PROPOSED: --	--	RAA4-Q3	RAA4-Q3	RAA12-H34	RAA12-H34
I13	EXISTING: -- PROPOSED: RAA12-I13	--				
I14	EXISTING: -- PROPOSED: RAA12-I14	--				
I20	EXISTING: -- PROPOSED: RAA12-I20	--				
I21	EXISTING: -- PROPOSED: RAA12-I21	--				
I22	EXISTING: -- PROPOSED: RAA12-I22	--				
I23	EXISTING: LS-C18 PROPOSED: --	--				
I24	EXISTING: -- PROPOSED: RAA12-I24	--				
I25	EXISTING: -- PROPOSED: RAA12-I25	--				
I26	EXISTING: -- PROPOSED: RAA12-I26	--				

TABLE 3
GENERAL ELECTRIC COMPANY - PITTSFIELD, MASSACHUSETTS
SUPPLEMENTAL PRE-DESIGN INVESTIGATION WORK PLAN FOR
THE LYMAN STREET AREA REMOVAL ACTION
SUMMARY OF PROPOSED GRID CHARACTERIZATION OF PCBs

GRID COORDINATE	SAMPLE TYPE	DEPTH INCREMENT				
		0-1 ft	1-3 ft	3-6 ft	6-10 ft	10-15 ft
I27	EXISTING: PROPOSED:	-- RAA12-I27				
I28	EXISTING: PROPOSED:	LS-29 --				
I29	EXISTING: PROPOSED:	-- RAA12-I29				
I30	EXISTING: PROPOSED:	LS-GWP-17 --				
I31	EXISTING: PROPOSED:	-- RAA12-I31				
I32	EXISTING: PROPOSED:	-- RAA12-I32				
I33	EXISTING: PROPOSED:	LS-GWP-13 --				
I34	EXISTING: PROPOSED:	-- RAA12-I34				
I35	EXISTING: PROPOSED:	RAA4-R4 --				
J11	EXISTING: PROPOSED:	-- RAA12-J11				
J12	EXISTING: PROPOSED:	-- RAA12-J12	-- RAA12-J12	-- RAA12-J12	-- RAA12-J12	-- RAA12-J12
J13	EXISTING: PROPOSED:	-- RAA12-J13				
J14	EXISTING: PROPOSED:	-- RAA12-J14	-- RAA12-J14	-- RAA12-J14	-- RAA12-J14	-- RAA12-J14
J15	EXISTING: PROPOSED:	-- RAA12-J15				
J16	EXISTING: PROPOSED:	-- RAA12-J16	-- RAA12-J16	-- RAA12-J16	-- RAA12-J16	-- RAA12-J16
J17	EXISTING: PROPOSED:	-- RAA12-J17				
J18	EXISTING: PROPOSED:	-- RAA12-J18	-- RAA12-J18	-- RAA12-J18	-- RAA12-J18	-- RAA12-J18
J19	EXISTING: PROPOSED:	-- RAA12-J19				
J20	EXISTING: PROPOSED:	LS-39 --	LS-39 --	LS-39 --	LS-39 --	LS-39 --
J21	EXISTING: PROPOSED:	-- RAA12-J21				
J22	EXISTING: PROPOSED:	-- RAA12-J22	-- RAA12-J22	-- RAA12-J22	-- RAA12-J22	-- RAA12-J22
J23	EXISTING: PROPOSED:	-- RAA12-J23				
J24	EXISTING: PROPOSED:	LS-27 --	LS-27 --	LS-27 --	LS-27 --	LS-27 --
J25	EXISTING: PROPOSED:	-- RAA12-J25				
J26	EXISTING: PROPOSED:	-- RAA12-J26	-- RAA12-J26	-- RAA12-J26	-- RAA12-J26	-- RAA12-J26
J27	EXISTING: PROPOSED:	-- RAA12-J27				
J28	EXISTING: PROPOSED:	-- RAA12-J28	-- RAA12-J28	-- RAA12-J28	-- RAA12-J28	-- RAA12-J28
J29	EXISTING: PROPOSED:	-- RAA12-J29				
J30	EXISTING: PROPOSED:	LS-36 --	LS-36 --	LS-36 --	LS-36 --	LS-36 --
J31	EXISTING: PROPOSED:	LS-GWP-7 --				
J32	EXISTING: PROPOSED:	E-3 --	E-3 --	E-3 --	E-3 --	E-3 --
J33	EXISTING: PROPOSED:	SL0186 --				
J34	EXISTING: PROPOSED:	E-4 --	E-4 --	E-4 --	E-4 --	E-4 --
K9	EXISTING: PROPOSED:	-- RAA12-K9				
K10	EXISTING: PROPOSED:	-- RAA12-K10				

TABLE 3
 GENERAL ELECTRIC COMPANY - PITTSFIELD, MASSACHUSETTS
 SUPPLEMENTAL PRE-DESIGN INVESTIGATION WORK PLAN FOR
 THE LYMAN STREET AREA REMOVAL ACTION

SUMMARY OF PROPOSED GRID CHARACTERIZATION OF PCBs

GRID COORDINATE	SAMPLE TYPE	DEPTH INCREMENT				
		0-1 ft	1-3 ft	3-6 ft	6-10 ft	10-15 ft
K11	EXISTING: PROPOSED:	-- RAA12-K11				
K12	EXISTING: PROPOSED:	-- RAA12-K12				
K14	EXISTING: PROPOSED:	-- RAA12-K14				
K15	EXISTING: PROPOSED:	-- RAA12-K15				
K16	EXISTING: PROPOSED:	-- RAA12-K16				
K17	EXISTING: PROPOSED:	-- RAA12-K17				
K18	EXISTING: PROPOSED:	-- RAA12-K18				
K19	EXISTING: PROPOSED:	-- RAA12-K19				
K20	EXISTING: PROPOSED:	-- RAA12-K20				
K21	EXISTING: PROPOSED:	LS-C14 --				
K22	EXISTING: PROPOSED:	-- RAA12-K22				
K23	EXISTING: PROPOSED:	-- RAA12-K23				
K24	EXISTING: PROPOSED:	-- RAA12-K24				
K25	EXISTING: PROPOSED:	-- RAA12-K25				
K26	EXISTING: PROPOSED:	-- RAA12-K26				
K27	EXISTING: PROPOSED:	LSSC-04 --				
K28	EXISTING: PROPOSED:	-- RAA12-K28				
K29	EXISTING: PROPOSED:	-- RAA12-K29				
K30	EXISTING: PROPOSED:	LSSC-02 --				
K31	EXISTING: PROPOSED:	SL0177 --				
K32	EXISTING: PROPOSED:	SL0243 --				
L7	EXISTING: PROPOSED:	-- RAA12-L7				
L8	EXISTING: PROPOSED:	-- RAA12-L8	-- RAA12-L8	-- RAA12-L8	-- RAA12-L8	-- RAA12-L8
L9	EXISTING: PROPOSED:	-- RAA12-L9				
L10	EXISTING: PROPOSED:	-- RAA12-L10	-- RAA12-L10	-- RAA12-L10	-- RAA12-L10	-- RAA12-L10
L11	EXISTING: PROPOSED:	-- RAA12-L11				
L12	EXISTING: PROPOSED:	-- RAA12-L12	-- RAA12-L12	-- RAA12-L12	-- RAA12-L12	-- RAA12-L12
L13	EXISTING: PROPOSED:	-- RAA12-L13				
L14	EXISTING: PROPOSED:	-- RAA12-L14	-- RAA12-L14	-- RAA12-L14	-- RAA12-L14	-- RAA12-L14
L15	EXISTING: PROPOSED:	-- RAA12-L15				
L16	EXISTING: PROPOSED:	-- RAA12-L16	-- RAA12-L16	-- RAA12-L16	-- RAA12-L16	-- RAA12-L16
L17	EXISTING: PROPOSED:	-- RAA12-L17				
L18	EXISTING: PROPOSED:	-- RAA12-L18	-- RAA12-L18	-- RAA12-L18	-- RAA12-L18	-- RAA12-L18
L19	EXISTING: PROPOSED:	-- RAA12-L19				
L20	EXISTING: PROPOSED:	-- RAA12-L20	-- RAA12-L20	-- RAA12-L20	-- RAA12-L20	-- RAA12-L20

TABLE 3
 GENERAL ELECTRIC COMPANY - PITTSFIELD, MASSACHUSETTS
 SUPPLEMENTAL PRE-DESIGN INVESTIGATION WORK PLAN FOR
 THE LYMAN STREET AREA REMOVAL ACTION

SUMMARY OF PROPOSED GRID CHARACTERIZATION OF PCBs

GRID COORDINATE	SAMPLE TYPE	DEPTH INCREMENT				
		0-1 ft	1-3 ft	3-6 ft	6-10 ft	10-15 ft
L21	EXISTING: PROPOSED:	LS-28 --				
L22	EXISTING: PROPOSED:	-- RAA12-L22	-- RAA12-L22	-- RAA12-L22	-- RAA12-L22	-- RAA12-L22
L23	EXISTING: PROPOSED:	LSSC-19 --				
L24	EXISTING: PROPOSED:	LS-30 --	LS-30 --	-- RAA12-L24	-- RAA12-L24	LS-30 --
L25	EXISTING: PROPOSED:	-- RAA12-L25				
L26	EXISTING: PROPOSED:	LS-31 --	LS-31 --	-- RAA12-L26	-- RAA12-L26	LS-31 --
L27	EXISTING: PROPOSED:	-- RAA12-L27				
L28	EXISTING: PROPOSED:	-- RAA12-L28	-- RAA12-L28	-- RAA12-L28	-- RAA12-L28	-- RAA12-L28
L29	EXISTING: PROPOSED:	LSSC-18 --				
L30	EXISTING: PROPOSED:	SL0180 --	SL0180 --	-- RAA12-L30	-- RAA12-L30	-- RAA12-L30
M7	EXISTING: PROPOSED:	-- RAA12-M7				
M8	EXISTING: PROPOSED:	-- RAA12-M8				
M9	EXISTING: PROPOSED:	-- RAA12-M9				
M10	EXISTING: PROPOSED:	-- RAA12-M10				
M11	EXISTING: PROPOSED:	-- RAA12-M11				
M12	EXISTING: PROPOSED:	-- RAA12-M12				
M13	EXISTING: PROPOSED:	-- RAA12-M13				
M14	EXISTING: PROPOSED:	-- RAA12-M14				
M15	EXISTING: PROPOSED:	-- RAA12-M15				
M16	EXISTING: PROPOSED:	-- RAA12-M16				
M17	EXISTING: PROPOSED:	-- RAA12-M17				
M19	EXISTING: PROPOSED:	-- RAA12-M19				
M20	EXISTING: PROPOSED:	-- RAA12-M20	-- RAA12-M20	-- RAA12-M20	-- RAA12-M20	-- RAA12-M20
M21	EXISTING: PROPOSED:	-- RAA12-M21				
M22	EXISTING: PROPOSED:	-- RAA12-M22				
M23	EXISTING: PROPOSED:	-- RAA12-M23				
M24	EXISTING: PROPOSED:	-- RAA12-M24				
M25	EXISTING: PROPOSED:	-- RAA12-M25				
M26	EXISTING: PROPOSED:	-- RAA12-M26				
M27	EXISTING: PROPOSED:	-- RAA12-M27				
M28	EXISTING: PROPOSED:	SL0169 --				
N4	EXISTING: PROPOSED:	-- RAA12-N4	-- RAA12-N4	-- RAA12-N4	-- RAA12-N4	-- RAA12-N4
N5	EXISTING: PROPOSED:	-- RAA12-N5				
N7	EXISTING: PROPOSED:	-- RAA12-N7				
N8	EXISTING: PROPOSED:	-- RAA12-N8	-- RAA12-N8	-- RAA12-N8	-- RAA12-N8	-- RAA12-N8

TABLE 3
GENERAL ELECTRIC COMPANY - PITTSFIELD, MASSACHUSETTS
SUPPLEMENTAL PRE-DESIGN INVESTIGATION WORK PLAN FOR
THE LYMAN STREET AREA REMOVAL ACTION

SUMMARY OF PROPOSED GRID CHARACTERIZATION OF PCBs

GRID COORDINATE	SAMPLE TYPE	DEPTH INCREMENT				
		0-1 ft	1-3 ft	3-6 ft	6-10 ft	10-15 ft
O23	EXISTING: PROPOSED:	-- RAA12-O23				
O24	EXISTING: PROPOSED:	LS-33 --				
O25	EXISTING: PROPOSED:	SL0231 --				
P3	EXISTING: PROPOSED:	-- RAA12-P3				
P4	EXISTING: PROPOSED:	-- RAA12-P4	-- RAA12-P4	-- RAA12-P4	-- RAA12-P4	-- RAA12-P4
P5	EXISTING: PROPOSED:	-- RAA12-P5				
P6	EXISTING: PROPOSED:	-- RAA12-P6	-- RAA12-P6	-- RAA12-P6	-- RAA12-P6	-- RAA12-P6
P8	EXISTING: PROPOSED:	-- RAA12-P8	-- RAA12-P8	-- RAA12-P8	-- RAA12-P8	-- RAA12-P8
P9	EXISTING: PROPOSED:	-- RAA12-P9				
P12	EXISTING: PROPOSED:	-- RAA12-P12	-- RAA12-P12	-- RAA12-P12	-- RAA12-P12	-- RAA12-P12
P13	EXISTING: PROPOSED:	-- RAA12-P13	-- RAA12-P13	-- RAA12-P13	-- RAA12-P13	-- RAA12-P13
P14	EXISTING: PROPOSED:	-- RAA12-P14	-- RAA12-P14	-- RAA12-P14	-- RAA12-P14	-- RAA12-P14
P15	EXISTING: PROPOSED:	-- RAA12-P15	-- RAA12-P15	-- RAA12-P15	-- RAA12-P15	-- RAA12-P15
P21	EXISTING: PROPOSED:	-- RAA12-P21				
P22	EXISTING: PROPOSED:	LS-43 --	LS-43 --	LS-43 --	LS-43 --	LS-43 --
P23	EXISTING: PROPOSED:	-- RAA12-P23				
P24	EXISTING: PROPOSED:	LSSC-11 --	LSSC-11 --	LSSC-11 --	LSSC-11 --	LSSC-11 --
Q3	EXISTING: PROPOSED:	-- RAA12-Q3				
Q4	EXISTING: PROPOSED:	-- RAA12-Q4				
Q5	EXISTING: PROPOSED:	-- RAA12-Q5				
Q6	EXISTING: PROPOSED:	-- RAA12-Q6				
Q7	EXISTING: PROPOSED:	-- RAA12-Q7				
Q8	EXISTING: PROPOSED:	-- RAA12-Q8				
Q11	EXISTING: PROPOSED:	-- RAA12-Q11				
Q12	EXISTING: PROPOSED:	-- RAA12-Q12				
Q13	EXISTING: PROPOSED:	-- RAA12-Q13	-- RAA12-Q13	-- RAA12-Q13	-- RAA12-Q13	-- RAA12-Q13
Q20	EXISTING: PROPOSED:	-- RAA12-Q20				
Q21	EXISTING: PROPOSED:	-- RAA12-Q21				
Q22	EXISTING: PROPOSED:	-- RAA12-Q22				
Q23	EXISTING: PROPOSED:	LSSC-08 --				
Q24	EXISTING: PROPOSED:	-- RAA12-Q24				
R3	EXISTING: PROPOSED:	-- RAA12-R3				
R4	EXISTING: PROPOSED:	-- RAA12-R4	-- RAA12-R4	-- RAA12-R4	-- RAA12-R4	-- RAA12-R4
R5	EXISTING: PROPOSED:	-- RAA12-R5				
R7	EXISTING: PROPOSED:	-- RAA12-R7				

TABLE 3
 GENERAL ELECTRIC COMPANY - PITTSFIELD, MASSACHUSETTS
 SUPPLEMENTAL PRE-DESIGN INVESTIGATION WORK PLAN FOR
 THE LYMAN STREET AREA REMOVAL ACTION

SUMMARY OF PROPOSED GRID CHARACTERIZATION OF PCBs

GRID COORDINATE	SAMPLE TYPE	DEPTH INCREMENT				
		0-1 ft	1-3 ft	3-6 ft	6-10 ft	10-15 ft
R8	EXISTING: PROPOSED:	-- RAA12-R8	-- RAA12-R8	-- RAA12-R8	-- RAA12-R8	-- RAA12-R8
R9	EXISTING: PROPOSED:	-- RAA12-R9				
R10	EXISTING: PROPOSED:	-- RAA12-R10	-- RAA12-R10	-- RAA12-R10	-- RAA12-R10	-- RAA12-R10
R11	EXISTING: PROPOSED:	-- RAA12-R11				
R12	EXISTING: PROPOSED:	-- RAA12-R12	-- RAA12-R12	-- RAA12-R12	-- RAA12-R12	-- RAA12-R12
R13	EXISTING: PROPOSED:	-- RAA12-R13	-- RAA12-R13	-- RAA12-R13	-- RAA12-R13	-- RAA12-R13
R16	EXISTING: PROPOSED:	-- LSSC-31	-- LSSC-31	-- LSSC-31	-- LSSC-31	-- LSSC-31
R17	EXISTING: PROPOSED:	-- RAA12-R17				
R18	EXISTING: PROPOSED:	-- RAA12-R18	-- RAA12-R18	-- RAA12-R18	-- RAA12-R18	-- RAA12-R18
R19	EXISTING: PROPOSED:	-- RAA12-R19				
R20	EXISTING: PROPOSED:	-- LS-45	-- LS-45	-- LS-45	-- LS-45	-- LS-45
R21	EXISTING: PROPOSED:	-- RAA12-R21				
R22	EXISTING: PROPOSED:	-- LS-44	-- LS-44	-- LS-44	-- LS-44	-- LS-44
S3	EXISTING: PROPOSED:	-- RAA12-S3				
S4	EXISTING: PROPOSED:	-- RAA12-S4				
S5	EXISTING: PROPOSED:	-- RAA12-S5				
S6	EXISTING: PROPOSED:	-- RAA12-S6				
S7	EXISTING: PROPOSED:	-- RAA12-S7				
S8	EXISTING: PROPOSED:	-- RAA12-S8				
S9	EXISTING: PROPOSED:	-- RAA12-S9				
S10	EXISTING: PROPOSED:	-- RAA12-S10				
S11	EXISTING: PROPOSED:	-- RAA12-S11				
S12	EXISTING: PROPOSED:	-- RAA12-S12				
S13	EXISTING: PROPOSED:	-- RAA12-S13	-- RAA12-S13	-- RAA12-S13	-- RAA12-S13	-- RAA12-S13
S14	EXISTING: PROPOSED:	-- RAA12-S14	-- RAA12-S14	-- RAA12-S14	-- RAA12-S14	-- RAA12-S14
S15	EXISTING: PROPOSED:	-- RAA12-S15	-- RAA12-S15	-- RAA12-S15	-- RAA12-S15	-- RAA12-S15
S16	EXISTING: PROPOSED:	-- RAA12-S16	-- RAA12-S16	-- RAA12-S16	-- RAA12-S16	-- RAA12-S16
S17	EXISTING: PROPOSED:	H2-RB010721-0-0000 --				
S18	EXISTING: PROPOSED:	-- RAA12-S18				
S19	EXISTING: PROPOSED:	H2-RB010703-0-0020 --				
T3	EXISTING: PROPOSED:	-- RAA12-T3				
T4	EXISTING: PROPOSED:	-- RAA12-T4	-- RAA12-T4	-- RAA12-T4	-- RAA12-T4	-- RAA12-T4
T5	EXISTING: PROPOSED:	-- RAA12-T5				
T6	EXISTING: PROPOSED:	-- RAA12-T6	-- RAA12-T6	-- RAA12-T6	-- RAA12-T6	-- RAA12-T6
T7	EXISTING: PROPOSED:	-- RAA12-T7				

TABLE 3
 GENERAL ELECTRIC COMPANY - PITTSFIELD, MASSACHUSETTS
 SUPPLEMENTAL PRE-DESIGN INVESTIGATION WORK PLAN FOR
 THE LYMAN STREET AREA REMOVAL ACTION

SUMMARY OF PROPOSED GRID CHARACTERIZATION OF PCBs

GRID COORDINATE	SAMPLE TYPE	DEPTH INCREMENT				
		0-1 ft	1-3 ft	3-6 ft	6-10 ft	10-15 ft
T8	EXISTING: PROPOSED:	-- RAA12-T8	-- RAA12-T8	-- RAA12-T8	-- RAA12-T8	-- RAA12-T8
T9	EXISTING: PROPOSED:	B-2 --				
T10	EXISTING: PROPOSED:	-- RAA12-T10	-- RAA12-T10	-- RAA12-T10	-- RAA12-T10	-- RAA12-T10
T11	EXISTING: PROPOSED:	H2-RB010781-0-0000 --				
T12	EXISTING: PROPOSED:	B-1 --	B-1 --	B-1 --	B-1 --	B-1 --
T13	EXISTING: PROPOSED:	H2-RB010761-0-0000 --				
U1	EXISTING: PROPOSED:	-- RAA12-U1				
U2	EXISTING: PROPOSED:	-- RAA12-U2				
U3	EXISTING: PROPOSED:	-- RAA12-U3				
U4	EXISTING: PROPOSED:	-- RAA12-U4				
U5	EXISTING: PROPOSED:	-- RAA12-U5				
U6	EXISTING: PROPOSED:	-- RAA12-U6				
U7	EXISTING: PROPOSED:	-- RAA12-U7				
U8	EXISTING: PROPOSED:	-- RAA12-U8				
U9	EXISTING: PROPOSED:	H2-RB010801-0-0000 --				
V1	EXISTING: PROPOSED:	-- RAA12-V1				
V2	EXISTING: PROPOSED:	-- RAA12-V2	-- RAA12-V2	-- RAA12-V2	-- RAA12-V2	-- RAA12-V2
V3	EXISTING: PROPOSED:	-- RAA12-V3				
V4	EXISTING: PROPOSED:	-- RAA12-V4	-- RAA12-V4	-- RAA12-V4	-- RAA12-V4	-- RAA12-V4
V5	EXISTING: PROPOSED:	-- RAA12-V5				
V6	EXISTING: PROPOSED:	-- RAA12-V6	-- RAA12-V6	-- RAA12-V6	-- RAA12-V6	-- RAA12-V6
V7	EXISTING: PROPOSED:	H2-RB010821-0-0020 --				
W1	EXISTING: PROPOSED:	-- RAA12-W1				
W2	EXISTING: PROPOSED:	-- RAA12-W2				
W3	EXISTING: PROPOSED:	-- RAA12-W3				
W4	EXISTING: PROPOSED:	-- RAA12-W4				
W5	EXISTING: PROPOSED:	-- RAA12-W5				
W6	EXISTING: PROPOSED:	-- RAA12-W6				
X2	EXISTING: PROPOSED:	-- RAA12-X2	-- RAA12-X2	-- RAA12-X2	-- RAA12-X2	-- RAA12-X2
X3	EXISTING: PROPOSED:	-- RAA12-X3				
X4	EXISTING: PROPOSED:	I9-4-14E --	-- RAA12-X4	-- RAA12-X4	-- RAA12-X4	-- RAA12-X4
X5	EXISTING: PROPOSED:	-- RAA12-X5				
X6	EXISTING: PROPOSED:	RB-010841-0-0000 --	RB-010841-0-0000 --	-- RAA12-X6	-- RAA12-X6	-- RAA12-X6
Y2	EXISTING: PROPOSED:	-- RAA12-Y2				
Y3	EXISTING: PROPOSED:	-- RAA12-Y3				

TABLE 3

GENERAL ELECTRIC COMPANY - PITTSFIELD, MASSACHUSETTS
 SUPPLEMENTAL PRE-DESIGN INVESTIGATION WORK PLAN FOR
 THE LYMAN STREET AREA REMOVAL ACTION

SUMMARY OF PROPOSED GRID CHARACTERIZATION OF PCBs

GRID COORDINATE	SAMPLE TYPE	DEPTH INCREMENT				
		0-1 ft	1-3 ft	3-6 ft	6-10 ft	10-15 ft
Y4	EXISTING: PROPOSED:	-- RAA12-Y4				
Y5	EXISTING: PROPOSED:	19-4-14D --				
Z3	EXISTING: PROPOSED:	-- RAA12-Z3				
Z4	EXISTING: PROPOSED:	-- RAA12-Z4	-- RAA12-Z4	-- RAA12-Z4	-- RAA12-Z4	-- RAA12-Z4
Z5	EXISTING: PROPOSED:	H2-RB010861-0-0020 --				
AA4	EXISTING: PROPOSED:	-- RAA12-AA4				

NOTES:

1. This table defines the soil sampling locations which will be utilized to satisfy grid-based sampling requirements for PCBs for the Lyman Street Area pre-design investigation.
2. Other existing soil data will not be utilized in support of the pre-design sampling requirements, but may be used in the design of the Removal Action (as discussed in the text).
3. Shaded depth increments indicate that soil sampling is not required
4. Existing samples are assumed to represent a grid node if they are located less than 50 feet from 100-foot grid nodes or less than 25 feet from 50-foot grid nodes.
5. Existing sample depths are assumed to satisfy the depth interval requirements (i.e., either 0 to 1, 1 to 3, 3 to 6, 6 to 10, or 10 to 15 feet) if the existing depth(s) constitute at least 50% of the depth requirement. For example, existing data for 10- to 12-foot and 12- to 14-foot depths will satisfy the 10- to 15-foot requirements at a node, existing data for 10- to 12-foot and 12- to 14-foot depths will satisfy the 10- to 15-foot requirements at a node, but existing data for the 10- to 12-foot depth alone will not.
6. This table does not include all existing soil PCB samples collected at Lyman Street Area. Refer to Table 1 for a complete list of all existing soil PCB samples.

TABLE 4

GENERAL ELECTRIC COMPANY - PITTSFIELD, MASSACHUSETTS

SUPPLEMENTAL PRE-DESIGN INVESTIGATION WORK PLAN FOR
THE LYMAN STREET AREA REMOVAL ACTION

PROPOSED SOIL SAMPLING LOCATIONS, DEPTHS, AND PARAMETERS

SAMPLE ID	GRID COORDINATE	SAMPLE DEPTH	ANALYSES					
			PCBs	VOCs	SVOCs	INORGANICS	PCDDs/PCDFs	Pest/Herb
RAA12-ZZ28	ZZ28	0-1 ft	X	--	--	--	--	--
		1-3 ft	X	--	--	--	--	--
		3-6 ft	X	--	--	--	--	--
		6-10 ft	X	--	--	--	--	--
		10-15 ft	X	--	--	--	--	--
RAA12-A26	A26	0-1 ft	X	--	--	--	--	
RAA12-A28	A28	0-1 ft	X	X	X	X	X	
RAA12-B25	B25	0-1 ft	X	--	--	--	--	
RAA12-B26	B26	0-1 ft	X	X	X	X	X	--
		1-3 ft	X	X	X	X	X	--
		3-6 ft	X	--	--	--	--	--
		6-10 ft	X	X	X	X	X	--
		10-15 ft	X	--	--	--	--	--
RAA12-B28	B28	0-1 ft	X	--	--	--	--	--
		1-3 ft	X	--	--	--	--	--
		3-6 ft	X	--	--	--	--	--
		6-10 ft	X	--	--	--	--	--
		10-15 ft	X	--	--	--	--	--
RAA12-B29	B29	0-1 ft	X	--	--	--	--	
RAA12-C26	C26	0-1 ft	X	--	--	--	--	
RAA12-C27	C27	0-1 ft	X	X	X	X	X	
RAA12-D27	D27	0-1 ft	X	--	--	--	--	
RAA12-D28	D28	0-1 ft	X	X	X	X	X	--
		1-3 ft	X	--	--	--	--	--
		3-6 ft	X	X	X	X	X	--
		6-10 ft	X	--	--	--	--	--
		10-15 ft	X	X	X	X	X	X
RAA12-D30	D30	0-1 ft	X	X	X	X	X	--
		1-3 ft	X	--	--	--	--	--
		3-6 ft	X	--	--	--	--	--
		6-10 ft	X	X	X	X	X	--
		10-15 ft	X	--	--	--	--	--
RAA12-E25	E25	0-1 ft	X	--	--	--	--	
RAA12-E28	E28	0-1 ft	X	--	--	--	--	
RAA12-E29	E29	0-1 ft	X	X	X	X	X	
RAA12-E30	E30	0-1 ft	X	--	--	--	--	
RAA12-F23	F23	0-1 ft	X	--	--	--	--	
RAA12-F24	F24	0-1 ft	X	X	X	X	X	--
		1-3 ft	X	--	--	--	--	--
		3-6 ft	X	X	X	X	X	--
		6-10 ft	X	--	--	--	--	--
		10-15 ft	X	--	--	--	--	--
RAA12-F26	F26	0-1 ft	X	--	--	--	--	--
		1-3 ft	X	X	X	X	X	--
		3-6 ft	X	--	--	--	--	--
		6-10 ft	X	--	--	--	--	--
		10-15 ft	X	--	--	--	--	--
RAA12-F27	F27	0-1 ft	X	--	--	--	--	
RAA12-F28	F28	0-1 ft	--	X	X	X	X	--
		1-3 ft	X	X	X	X	X	--
		3-6 ft	X	--	--	--	--	--
		6-10 ft	X	--	--	--	--	--
		10-15 ft	X	X	X	X	X	--
RAA12-F29	F29	0-1 ft	X	--	--	--	--	
RAA12-F31	F31	0-1 ft	X	--	--	--	--	
RAA12-F32	F32	0-1 ft	--	X	X	X	X	--
		1-3 ft	X	--	--	--	--	--
		3-6 ft	X	--	--	--	--	--
		6-10 ft	X	--	--	--	--	--
		10-15 ft	X	--	--	--	--	--
RAA12-G22	G22	0-1 ft	X	--	--	--	--	
RAA12-G23	G23	0-1 ft	X	--	--	--	--	
RAA12-G24	G24	0-1 ft	X	--	--	--	--	
RAA12-G25	G25	0-1 ft	X	X	X	X	X	
RAA12-G26	G26	0-1 ft	X	--	--	--	--	
RAA12-G27	G27	0-1 ft	X	X	X	X	X	
RAA12-G28	G28	0-1 ft	X	--	--	--	--	
RAA12-G29	G29	0-1 ft	X	X	X	X	X	
RAA12-G31	G31	0-1 ft	X	X	X	X	X	--
		3-6 ft	--	X	X	X	X	--
RAA12-G32	G32	0-1 ft	X	--	--	--	--	
RAA12-H21	H21	0-1 ft	X	--	--	--	--	

TABLE 4

GENERAL ELECTRIC COMPANY - PITTSFIELD, MASSACHUSETTS

SUPPLEMENTAL PRE-DESIGN INVESTIGATION WORK PLAN FOR
THE LYMAN STREET AREA REMOVAL ACTION

PROPOSED SOIL SAMPLING LOCATIONS, DEPTHS, AND PARAMETERS

SAMPLE ID	GRID COORDINATE	SAMPLE DEPTH	ANALYSES					
			PCBs	VOCs	SVOCs	INORGANICS	PCDDs/PCDFs	Pest/Herb
RAA12-H22	H22	0-1 ft	X	X	X	X	X	--
		1-3 ft	X	X	X	X	X	--
		3-6 ft	X	--	--	--	--	--
		6-10 ft	X	--	--	--	--	--
		10-15 ft	X	--	--	--	--	--
RAA12-H23	H23	0-1 ft	X	--	--	--	--	--
RAA12-H24	H24	0-1 ft	--	X	X	X	X	--
		10-15 ft	X	--	--	--	--	--
RAA12-H26	H26	0-1 ft	X	X	X	X	X	--
		1-3 ft	X	--	--	--	--	--
		3-6 ft	X	--	--	--	--	--
		6-10 ft	X	--	--	--	--	--
		10-15 ft	X	--	--	--	--	--
RAA12-H28	H28	0-1 ft	X	--	--	--	--	--
		1-3 ft	X	--	--	--	--	--
		3-6 ft	X	X	X	X	X	--
		6-10 ft	X	--	X	X	X	--
		10-15 ft	X	--	--	--	--	--
RAA12-H30	H30	0-1 ft	--	X	X	X	X	--
		6-10 ft	--	X	X	X	X	--
RAA12-H32	H32	0-1 ft	X	X	X	X	X	--
		1-3 ft	X	X	X	X	X	--
		3-6 ft	X	--	--	--	--	--
		6-10 ft	X	X	X	X	X	--
		10-15 ft	X	X	X	X	X	--
RAA12-H33	H33	0-1 ft	X	--	--	--	--	--
RAA12-H34	H34	6-10 ft	X	--	--	--	--	--
		10-15 ft	X	--	--	--	--	--
RAA12-H13	H13	0-1 ft	X	--	--	--	--	--
RAA12-H14	H14	0-1 ft	X	--	--	--	--	--
RAA12-I20	I20	0-1 ft	X	--	--	--	--	--
RAA12-I21	I21	0-1 ft	X	--	--	--	--	--
RAA12-I22	I22	0-1 ft	X	--	--	--	--	--
RAA12-I24	I24	0-1 ft	X	--	--	--	--	--
RAA12-I25	I25	0-1 ft	X	--	--	--	--	--
RAA12-I26	I26	0-1 ft	X	--	--	--	--	--
RAA12-I27	I27	0-1 ft	X	--	--	--	--	--
RAA12-I29	I29	0-1 ft	X	--	--	--	--	--
RAA12-I31	I31	0-1 ft	X	X	X	X	X	--
RAA12-I32	I32	0-1 ft	X	--	--	--	--	--
		3-6 ft	--	X	X	X	X	--
RAA12-I34	I34	0-1 ft	X	X	X	X	X	--
RAA12-J11	J11	0-1 ft	X	--	--	--	--	--
RAA12-J12	J12	0-1 ft	X	X	X	X	X	--
		1-3 ft	X	--	--	--	--	--
		3-6 ft	X	--	--	--	--	--
		6-10 ft	X	--	--	--	--	--
		10-15 ft	X	--	--	--	--	--
RAA12-J13	J13	0-1 ft	X	--	--	--	--	--
RAA12-J14	J14	0-1 ft	X	X	X	X	X	X
		1-3 ft	X	X	X	X	X	--
		3-6 ft	X	--	--	--	--	--
		6-10 ft	X	X	X	X	X	X
		10-15 ft	X	--	--	--	--	--
RAA12-J15	J15	0-1 ft	X	--	--	--	--	--
RAA12-J16	J16	0-1 ft	X	X	X	X	X	--
		1-3 ft	X	--	--	--	--	--
		3-6 ft	X	--	--	--	--	--
		6-10 ft	X	--	--	--	--	--
		10-15 ft	X	--	--	--	--	--
RAA12-J17	J17	0-1 ft	X	X	X	X	X	--
RAA12-J18	J18	0-1 ft	X	--	--	--	--	--
		1-3 ft	X	--	--	--	--	--
		3-6 ft	X	--	--	--	--	--
		6-10 ft	X	--	--	--	--	--
		10-15 ft	X	--	--	--	--	--
RAA12-J19	J19	0-1 ft	X	--	--	--	--	--
RAA12-J21	J21	0-1 ft	X	--	--	--	--	--
RAA12-J22	J22	0-1 ft	X	--	--	--	--	--
		1-3 ft	X	--	--	--	--	--
		3-6 ft	X	X	X	X	X	--
		6-10 ft	X	X	X	X	X	--
		10-15 ft	X	--	--	--	--	--
RAA12-J23	J23	0-1 ft	X	--	--	--	--	--

TABLE 4

GENERAL ELECTRIC COMPANY - PITTSFIELD, MASSACHUSETTS

SUPPLEMENTAL PRE-DESIGN INVESTIGATION WORK PLAN FOR
THE LYMAN STREET AREA REMOVAL ACTION

PROPOSED SOIL SAMPLING LOCATIONS, DEPTHS, AND PARAMETERS

SAMPLE ID	GRID COORDINATE	SAMPLE DEPTH	ANALYSES					
			PCBs	VOCs	SVOCs	INORGANICS	PCDDs/PCDFs	Pest/Herb
RAA12-J25	J25	0-1 ft	X	X	X	X	X	--
RAA12-J26	J26	0-1 ft	X	--	--	--	--	--
		1-3 ft	X	--	--	--	--	
		3-6 ft	X	X	X	X	X	
		6-10 ft	X	--	--	--	--	
		10-15 ft	X	--	--	--	--	
RAA12-J27	J27	0-1 ft	X	X	X	X	X	
RAA12-J28	J28	0-1 ft	X	--	--	--	--	
		1-3 ft	X	X	X	X	X	
		3-6 ft	X	--	--	--	--	
		6-10 ft	X	--	--	--	--	
		10-15 ft	X	--	--	--	--	
RAA12-J29	J29	0-1 ft	X	--	--	--	--	
RAA12-J30	J30	0-1 ft	--	X	X	X	X	
RAA12-J31	J31	0-1 ft	--	X	X	X	X	
RAA12-K9	K9	0-1 ft	X	--	--	--	--	
RAA12-K10	K10	0-1 ft	X	--	--	--	--	
RAA12-K11	K11	0-1 ft	X	--	--	--	--	
RAA12-K12	K12	0-1 ft	X	--	--	--	--	
RAA12-K14	K14	0-1 ft	X	--	--	--	--	
RAA12-K15	K15	0-1 ft	X	X	X	X	X	
RAA12-K16	K16	0-1 ft	X	--	--	--	--	
RAA12-K17	K17	0-1 ft	X	--	--	--	--	
RAA12-K18	K18	0-1 ft	X	--	--	--	--	
RAA12-K19	K19	0-1 ft	X	--	--	--	--	
RAA12-K20	K20	0-1 ft	X	X	X	X	X	
		1-3 ft	--	X	X	X	X	
RAA12-K22	K22	0-1 ft	X	X	X	X	X	
RAA12-K23	K23	0-1 ft	X	--	--	--	--	
RAA12-K24	K24	0-1 ft	X	--	--	--	--	
RAA12-K25	K25	0-1 ft	X	--	--	--	--	
RAA12-K26	K26	0-1 ft	X	--	--	--	--	
RAA12-K28	K28	0-1 ft	X	--	--	--	--	
RAA12-K29	K29	0-1 ft	X	--	--	--	--	
RAA12-L7	L7	0-1 ft	X	--	--	--	--	
RAA12-L8	L8	0-1 ft	X	X	X	X	X	
		1-3 ft	X	--	--	--	--	
		3-6 ft	X	--	--	--	--	
		6-10 ft	X	--	--	--	--	
		10-15 ft	X	--	--	--	--	
RAA12-L9	L9	0-1 ft	X	--	--	--	--	
RAA12-L10	L10	0-1 ft	X	X	X	X	X	
		1-3 ft	X	--	--	--	--	
		3-6 ft	X	X	X	X	X	
		6-10 ft	X	--	--	--	--	
		10-15 ft	X	--	--	--	--	
RAA12-L11	L11	0-1 ft	X	--	--	--	--	
RAA12-L12	L12	0-1 ft	X	X	X	X	X	
		1-3 ft	X	X	X	X	X	
		3-6 ft	X	--	--	--	--	
		6-10 ft	X	--	--	--	--	
		10-15 ft	X	--	--	--	--	
RAA12-L13	L13	0-1 ft	X	--	--	--	--	
RAA12-L14	L14	0-1 ft	X	X	X	X	X	
		1-3 ft	X	--	--	--	--	
		3-6 ft	X	--	--	--	--	
		6-10 ft	X	--	--	--	--	
		10-15 ft	X	--	--	--	--	
RAA12-L15	L15	0-1 ft	X	--	--	--	--	
RAA12-L16	L16	0-1 ft	X	X	X	X	X	
		1-3 ft	X	--	--	--	--	
		3-6 ft	X	X	X	X	X	
		6-10 ft	X	--	--	--	--	
		10-15 ft	X	--	--	--	--	
RAA12-L17	L17	0-1 ft	X	--	--	--	--	
RAA12-L18	L18	0-1 ft	X	X	X	X	X	
		1-3 ft	X	X	X	X	X	
		3-6 ft	X	--	--	--	--	
		6-10 ft	X	X	X	X	X	
		10-15 ft	X	--	--	--	--	
RAA12-L19	L19	0-1 ft	X	--	--	--	--	

TABLE 4

GENERAL ELECTRIC COMPANY - PITTSFIELD, MASSACHUSETTS

SUPPLEMENTAL PRE-DESIGN INVESTIGATION WORK PLAN FOR
THE LYMAN STREET AREA REMOVAL ACTION

PROPOSED SOIL SAMPLING LOCATIONS, DEPTHS, AND PARAMETERS

SAMPLE ID	GRID COORDINATE	SAMPLE DEPTH	ANALYSES					
			PCBs	VOCs	SVOCs	INORGANICS	PCDDs/PCDFs	Pest/Herb
RAA12-N12	N12	0-1 ft	X	X	X	X	X	--
		1-3 ft	X	--	--	--	--	--
		3-6 ft	X	--	--	--	--	--
		6-10 ft	X	X	X	X	X	--
		10-15 ft	X	--	--	--	--	--
RAA12-N13	N13	0-1 ft	X	--	--	--	--	--
RAA12-N14	N14	0-1 ft	X	X	X	X	X	--
		1-3 ft	X	--	--	--	--	--
		3-6 ft	X	--	--	--	--	--
		6-10 ft	X	--	--	--	--	--
		10-15 ft	X	--	--	--	--	--
RAA12-N15	N15	0-1 ft	X	--	--	--	--	--
RAA12-N16	N16	0-1 ft	X	--	--	--	--	--
		1-3 ft	X	X	X	X	X	--
		3-6 ft	X	--	--	--	--	--
		6-10 ft	X	X	X	X	X	--
		10-15 ft	X	--	X	X	X	X
RAA12-N17	N17	0-1 ft	X	X	X	X	X	--
RAA12-N18	N18	0-1 ft	X	--	--	--	--	--
		1-3 ft	X	--	--	--	--	--
		3-6 ft	X	X	X	X	X	--
		6-10 ft	X	--	--	--	--	--
		10-15 ft	X	--	--	--	--	--
RAA12-N19	N19	0-1 ft	X	--	--	--	--	--
RAA12-N21	N21	0-1 ft	X	--	--	--	--	--
RAA12-N23	N23	0-1 ft	X	X	X	X	X	--
RAA12-N25	N25	0-1 ft	X	X	X	X	X	--
RAA12-O2	O2	0-1 ft	X	--	--	--	--	--
RAA12-O3	O3	0-1 ft	X	--	--	--	--	--
RAA12-O4	O4	0-1 ft	X	--	--	--	--	--
RAA12-O5	O5	0-1 ft	X	--	--	--	--	--
RAA12-O6	O6	0-1 ft	X	--	--	--	--	--
RAA12-O8	O8	0-1 ft	X	--	--	--	--	--
RAA12-O9	O9	0-1 ft	X	--	--	--	--	--
RAA12-O11	O11	0-1 ft	X	--	--	--	--	--
RAA12-O12	O12	0-1 ft	X	--	--	--	--	--
		1-3 ft	X	--	--	--	--	--
		3-6 ft	X	--	--	--	--	--
		6-10 ft	X	--	--	--	--	--
		10-15 ft	X	--	--	--	--	--
RAA12-O13	O13	0-1 ft	X	--	--	--	--	--
		1-3 ft	X	--	--	--	--	--
		3-6 ft	X	--	--	--	--	--
		6-10 ft	X	--	--	--	--	--
		10-15 ft	X	--	--	--	--	--
RAA12-O14	O14	0-1 ft	X	--	--	--	--	--
		1-3 ft	X	--	--	--	--	--
		3-6 ft	X	--	--	--	--	--
		6-10 ft	X	--	--	--	--	--
		10-15 ft	X	--	--	--	--	--
RAA12-O15	O15	0-1 ft	X	--	--	--	--	--
		1-3 ft	X	--	--	--	--	--
		3-6 ft	X	--	--	--	--	--
		6-10 ft	X	--	--	--	--	--
		10-15 ft	X	--	--	--	--	--
RAA12-O16	O16	0-1 ft	X	X	X	X	X	--
RAA12-O17	O17	0-1 ft	X	--	--	--	--	--
RAA12-O22	O22	0-1 ft	X	--	--	--	--	--
RAA12-O23	O23	0-1 ft	X	--	--	--	--	--
RAA12-O24	O24	0-1 ft	--	X	X	X	X	--
		3-6 ft	--	X	X	X	X	X
RAA12-P3	P3	0-1 ft	X	--	--	--	--	--
RAA12-P4	P4	0-1 ft	X	X	X	X	X	--
		1-3 ft	X	X	X	X	X	X
		3-6 ft	X	--	--	--	--	--
		6-10 ft	X	X	X	X	X	--
		10-15 ft	X	X	X	X	X	X
RAA12-P5	P5	0-1 ft	X	--	--	--	--	--
RAA12-P6	P6	0-1 ft	X	X	X	X	X	--
		1-3 ft	X	--	--	--	--	--
		3-6 ft	X	X	X	X	X	--
		6-10 ft	X	--	--	--	--	--
		10-15 ft	X	--	--	--	--	--

TABLE 4

GENERAL ELECTRIC COMPANY - PITTSFIELD, MASSACHUSETTS
 SUPPLEMENTAL PRE-DESIGN INVESTIGATION WORK PLAN FOR
 THE LYMAN STREET AREA REMOVAL ACTION

PROPOSED SOIL SAMPLING LOCATIONS, DEPTHS, AND PARAMETERS

SAMPLE ID	GRID COORDINATE	SAMPLE DEPTH	ANALYSES					
			PCBs	VOCs	SVOCs	INORGANICS	PCDDs/PCDFs	Pest/Herb
RAA12-P8	P8	0-1 ft	X	X	X	X	X	--
		1-3 ft	X	--	--	--	--	--
		3-6 ft	X	X	X	X	X	--
		6-10 ft	X	--	--	--	--	--
		10-15 ft	X	--	--	--	--	--
RAA12-P9	P9	0-1 ft	X	--	--	--	--	--
RAA12-P12	P12	0-1 ft	X	--	--	--	--	--
		1-3 ft	X	--	--	--	--	--
		3-6 ft	X	X	X	X	X	--
		6-10 ft	X	--	--	--	--	--
		10-15 ft	X	--	--	--	--	--
RAA12-P13	P13	0-1 ft	X	--	--	--	--	--
		1-3 ft	X	--	--	--	--	--
		3-6 ft	X	--	--	--	--	--
		6-10 ft	X	--	--	--	--	--
		10-15 ft	X	--	--	--	--	--
RAA12-P14	P14	0-1 ft	X	--	--	--	--	--
		1-3 ft	X	--	--	--	--	--
		3-6 ft	X	--	--	--	--	--
		6-10 ft	X	--	--	--	--	--
		10-15 ft	X	--	--	--	--	--
RAA12-P15	P15	0-1 ft	X	--	--	--	--	--
		1-3 ft	X	--	--	--	--	--
		3-6 ft	X	--	--	--	--	--
		6-10 ft	X	--	--	--	--	--
		10-15 ft	X	--	--	--	--	--
RAA12-P21	P21	0-1 ft	X	X	X	X	X	--
RAA12-P23	P23	0-1 ft	X	--	--	--	--	--
RAA12-Q3	Q3	0-1 ft	X	--	--	--	--	--
RAA12-Q4	Q4	0-1 ft	X	--	--	--	--	--
RAA12-Q5	Q5	0-1 ft	X	X	X	X	X	--
RAA12-Q6	Q6	0-1 ft	X	--	--	--	--	--
RAA12-Q7	Q7	0-1 ft	X	--	--	--	--	--
RAA12-Q8	Q8	0-1 ft	X	--	--	--	--	--
RAA12-Q11	Q11	0-1 ft	X	--	--	--	--	--
RAA12-Q12	Q12	0-1 ft	X	X	X	X	X	--
RAA12-Q13	Q13	0-1 ft	X	X	X	X	X	--
		1-3 ft	X	--	--	--	--	--
		3-6 ft	X	--	--	--	--	--
		6-10 ft	X	--	--	--	--	--
		10-15 ft	X	--	--	--	--	--
RAA12-Q20	Q20	0-1 ft	X	--	--	--	--	--
RAA12-Q21	Q21	0-1 ft	X	X	X	X	X	--
RAA12-Q22	Q22	0-1 ft	X	X	X	X	X	--
RAA12-Q24	Q24	0-1 ft	X	--	--	--	--	--
RAA12-R3	R3	0-1 ft	X	--	--	--	--	--
RAA12-R4	R4	0-1 ft	X	X	X	X	X	--
		1-3 ft	X	--	--	--	--	--
		3-6 ft	X	--	--	--	--	--
		6-10 ft	X	--	--	--	--	--
		10-15 ft	X	--	--	--	--	--
RAA12-R5	R5	0-1 ft	X	--	--	--	--	--
RAA12-R7	R7	0-1 ft	X	--	--	--	--	--
RAA12-R8	R8	0-1 ft	X	X	X	X	X	--
		1-3 ft	X	X	X	X	X	--
		3-6 ft	X	--	--	--	--	--
		6-10 ft	X	X	X	X	X	X
		10-15 ft	X	--	--	--	--	--
RAA12-R9	R9	0-1 ft	X	--	--	--	--	--
RAA12-R10	R10	0-1 ft	X	X	X	X	X	--
		1-3 ft	X	--	--	--	--	--
		3-6 ft	X	--	--	--	--	--
		6-10 ft	X	--	--	--	--	--
		10-15 ft	X	--	--	--	--	--
RAA12-R11	R11	0-1 ft	X	--	--	--	--	--
RAA12-R12	R12	0-1 ft	X	--	--	--	--	--
		1-3 ft	X	X	X	X	X	--
		3-6 ft	X	--	--	--	--	--
		6-10 ft	X	X	X	X	X	--
		10-15 ft	X	X	X	X	X	X

TABLE 4

GENERAL ELECTRIC COMPANY - PITTSFIELD, MASSACHUSETTS

SUPPLEMENTAL PRE-DESIGN INVESTIGATION WORK PLAN FOR
THE LYMAN STREET AREA REMOVAL ACTION

PROPOSED SOIL SAMPLING LOCATIONS, DEPTHS, AND PARAMETERS

SAMPLE ID	GRID COORDINATE	SAMPLE DEPTH	ANALYSES					
			PCBs	VOCs	SVOCs	INORGANICS	PCDDs/PCDFs	Pest/Herb
RAA12-R13	R13	0-1 ft	X	X	X	X	X	X
		1-3 ft	X	--	--	--	--	--
		3-6 ft	X	--	--	--	--	--
		6-10 ft	X	--	--	--	--	--
		10-15 ft	X	--	--	--	--	--
RAA12-R16	R16	3-6 ft	--	--	X	X	X	X
		10-15 ft	--	X	X	X	X	--
RAA12-R17	R17	0-1 ft	X	X	X	X	X	--
RAA12-R18	R18	0-1 ft	X	X	X	X	X	X
		1-3 ft	X	X	X	X	X	--
		3-6 ft	X	--	--	--	--	--
		6-10 ft	X	X	X	X	X	X
		10-15 ft	X	--	--	--	--	--
RAA12-R19	R19	0-1 ft	X	X	X	X	X	--
RAA12-R21	R21	0-1 ft	X	--	--	--	--	--
		3-6 ft	--	X	X	X	X	--
RAA12-S3	S3	0-1 ft	X	--	--	--	--	--
RAA12-S4	S4	0-1 ft	X	--	--	--	--	--
RAA12-S5	S5	0-1 ft	X	--	--	--	--	--
RAA12-S6	S6	0-1 ft	X	X	X	X	X	--
RAA12-S7	S7	0-1 ft	X	X	X	X	X	--
RAA12-S8	S8	0-1 ft	X	--	--	X	--	--
RAA12-S9	S9	0-1 ft	X	X	X	X	X	--
RAA12-S10	S10	0-1 ft	X	--	--	--	--	--
RAA12-S11	S11	0-1 ft	X	--	X	X	X	--
RAA12-S12	S12	0-1 ft	X	--	--	--	--	--
RAA12-S13	S13	0-1 ft	X	--	--	--	--	--
		1-3 ft	X	--	--	--	--	--
		3-6 ft	X	--	--	--	--	--
		6-10 ft	X	--	--	--	--	--
		10-15 ft	X	--	--	--	--	--
RAA12-S14	S14	0-1 ft	X	X	X	X	X	--
		1-3 ft	X	--	--	--	--	--
		3-6 ft	X	X	X	X	X	--
		6-10 ft	X	--	--	--	--	--
		10-15 ft	X	--	--	--	--	--
RAA12-S15	S15	0-1 ft	X	--	--	--	--	--
		1-3 ft	X	--	--	--	--	--
		3-6 ft	X	--	--	--	--	--
		6-10 ft	X	--	--	--	--	--
		10-15 ft	X	--	--	--	--	--
RAA12-S16	S16	0-1 ft	X	--	--	--	--	--
		1-3 ft	X	--	--	--	--	--
		3-6 ft	X	--	--	--	--	--
		6-10 ft	X	--	--	--	--	--
		10-15 ft	X	--	--	--	--	--
RAA12-S18	S18	0-1 ft	X	--	--	--	--	--
RAA12-T3	T3	0-1 ft	X	--	--	--	--	--
RAA12-T4	T4	0-1 ft	X	X	X	X	X	X
		1-3 ft	X	--	--	--	--	--
		3-6 ft	X	X	X	X	X	X
		6-10 ft	X	--	--	--	--	--
		10-15 ft	X	--	--	--	--	--
RAA12-T5	T5	0-1 ft	X	--	--	--	--	--
RAA12-T6	T6	0-1 ft	X	X	X	X	X	X
		1-3 ft	X	X	X	X	X	--
		3-6 ft	X	--	--	--	--	--
		6-10 ft	X	X	X	X	X	--
		10-15 ft	X	--	--	--	--	--
RAA12-T7	T7	0-1 ft	X	--	--	--	--	--
RAA12-T8	T8	0-1 ft	X	--	--	--	--	--
		1-3 ft	X	--	--	--	--	--
		3-6 ft	X	--	--	--	--	--
		6-10 ft	X	--	--	--	--	--
		10-15 ft	X	--	--	--	--	--
RAA12-T9	T9	0-1 ft	--	X	X	X	X	X
		1-3 ft	--	X	X	X	X	--
		3-6 ft	--	X	X	X	X	--
		6-10 ft	--	X	X	X	X	--
		10-15 ft	--	X	X	X	X	--

TABLE 4

GENERAL ELECTRIC COMPANY - PITTSFIELD, MASSACHUSETTS
 SUPPLEMENTAL PRE-DESIGN INVESTIGATION WORK PLAN FOR
 THE LYMAN STREET AREA REMOVAL ACTION

PROPOSED SOIL SAMPLING LOCATIONS, DEPTHS, AND PARAMETERS

SAMPLE ID	GRID COORDINATE	SAMPLE DEPTH	ANALYSES					
			PCBs	VOCs	SVOCs	INORGANICS	PCDDs/PCDFs	Pest/Herb
RAA12-T10	T10	0-1 ft	X	--	--	--	--	--
		1-3 ft	X	--	--	--	--	--
		3-6 ft	X	--	--	--	--	--
		6-10 ft	X	--	--	--	--	--
		10-15 ft	X	--	--	--	--	--
RAA12-U1	U1	0-1 ft	X	--	--	--	--	
RAA12-U2	U2	0-1 ft	X	X	X	X	X	
RAA12-U3	U3	0-1 ft	X	X	X	X	X	
		3-6 ft	--	X	X	X	X	
RAA12-U4	U4	0-1 ft	X	--	--	--	--	
RAA12-U5	U5	0-1 ft	X	X	X	X	X	
RAA12-U6	U6	0-1 ft	X	--	--	--	--	
RAA12-U7	U7	0-1 ft	X	--	--	--	--	
RAA12-U8	U8	0-1 ft	X	X	X	X	X	
		1-3 ft	--	X	X	X	X	
		3-6 ft	--	X	X	X	X	
		6-10 ft	--	X	X	X	X	
		10-15 ft	--	X	X	X	X	
RAA12-V1	V1	0-1 ft	X	--	--	--	--	
RAA12-V2	V2	0-1 ft	X	X	X	X	X	
		1-3 ft	X	X	X	X	X	
		3-6 ft	X	--	--	--	--	
		6-10 ft	X	X	X	X	X	
		10-15 ft	X	--	--	--	--	
RAA12-V3	V3	0-1 ft	X	--	--	--	--	
RAA12-V4	V4	0-1 ft	X	X	X	X	X	
		1-3 ft	X	--	--	--	--	
		3-6 ft	X	--	--	--	--	
		6-10 ft	X	--	--	--	--	
		10-15 ft	X	--	--	--	--	
RAA12-V5	V5	0-1 ft	X	--	--	--	--	
RAA12-V6	V6	0-1 ft	X	--	--	--	--	
		1-3 ft	X	--	--	--	--	
		3-6 ft	X	X	X	X	X	
		6-10 ft	X	X	X	X	X	
		10-15 ft	X	X	X	X	X	
RAA12-W1	W1	0-1 ft	X	--	--	--	--	
RAA12-W2	W2	0-1 ft	X	--	--	--	--	
RAA12-W3	W3	0-1 ft	X	X	X	X	X	
RAA12-W4	W4	0-1 ft	X	--	--	--	--	
RAA12-W5	W5	0-1 ft	X	X	X	X	X	
RAA12-W6	W6	0-1 ft	X	X	X	X	X	
RAA12-X2	X2	0-1 ft	X	X	X	X	X	
		1-3 ft	X	--	--	--	--	
		3-6 ft	X	--	--	--	--	
		6-10 ft	X	--	--	--	--	
		10-15 ft	X	X	X	X	X	
RAA12-X3	X3	0-1 ft	X	--	--	--	--	
RAA12-X4	X4	0-1 ft	--	--	--	--	--	
		1-3 ft	X	--	--	--	--	
		3-6 ft	X	--	--	--	--	
		6-10 ft	X	--	--	--	--	
		10-15 ft	X	--	--	--	--	
RAA12-X5	X5	0-1 ft	X	--	--	--	--	
RAA12-X6	X6	3-6 ft	X	--	--	--	--	
		6-10 ft	X	--	--	--	--	
		10-15 ft	X	--	--	--	--	
RAA12-Y2	Y2	0-1 ft	X	--	--	--	--	
RAA12-Y3	Y3	0-1 ft	X	--	--	--	--	
RAA12-Y4	Y4	0-1 ft	X	X	X	X	X	
		1-3 ft	--	X	X	X	X	
RAA12-Z3	Z3	0-1 ft	X	X	X	X	X	
RAA12-Z4	Z4	0-1 ft	X	X	X	X	X	
		1-3 ft	X	X	X	X	X	
		3-6 ft	X	X	X	X	X	
		6-10 ft	X	X	X	X	X	
		10-15 ft	X	X	X	X	X	
RAA12-AA4	AA4	0-1 ft	X	--	--	--	--	

TABLE 4

GENERAL ELECTRIC COMPANY - PITTSFIELD, MASSACHUSETTS

SUPPLEMENTAL PRE-DESIGN INVESTIGATION WORK PLAN FOR
THE LYMAN STREET AREA REMOVAL ACTION

PROPOSED SOIL SAMPLING LOCATIONS, DEPTHS, AND PARAMETERS

NOTES:

1. This table identifies soil samples to be collected and the analyses to be performed as part of the pre-design investigation at Lyman Street Area.
2. The Appendix IX-3 sample intervals shown above may be modified in the field based on the results of photoionization detector (PID) readings and visual observations at the time of sample collection

FIGURES

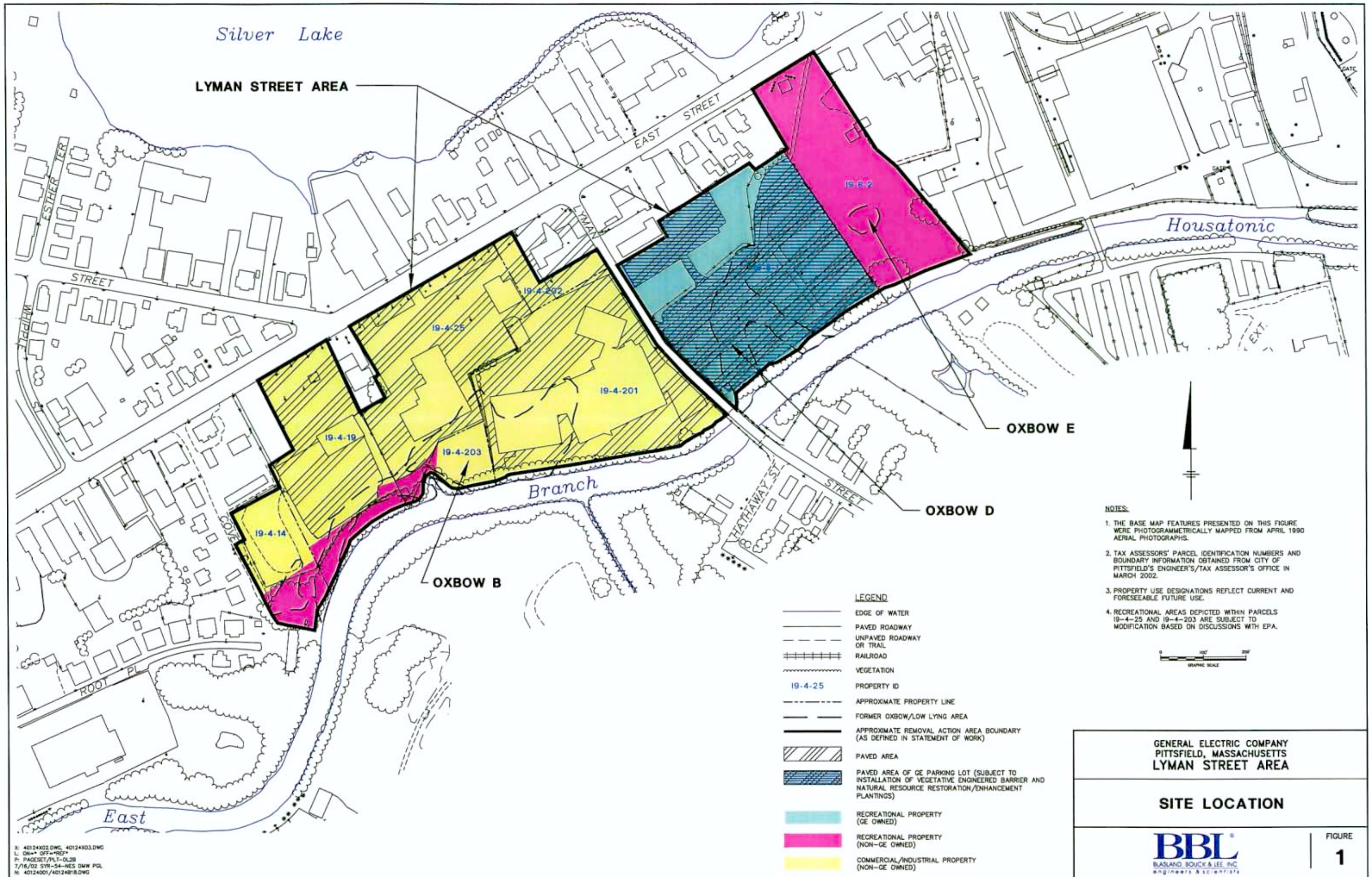



LEGEND

- APPROXIMATE REMOVAL ACTION AREA BOUNDARY
- FENCE
- PROPERTY LINE (APPROXIMATE)
- FORMER OXBOW/LOW LYING AREA
- ▲ LS-GWP-20 EXISTING SURFACE SOIL SAMPLE LOCATION (0- TO 1- FOOT SAMPLE DEPTH)
- E-2 EXISTING SOIL BORING LOCATION (1- FOOT OR GREATER SAMPLE DEPTH)
- ▲ SL0186 1/2-MILE BANK SOIL SAMPLES (EPA DATA)
- ▲ H2-RB010841-1-0000 1 1/2-MILE BANK SOIL SAMPLES (EPA DATA)
- ▲ RAA12-G27 PROPOSED SURFACE SOIL SAMPLE LOCATION
- RAA12-H26 PROPOSED SOIL BORING LOCATION
- 50-FOOT SAMPLING GRID
- 100-FOOT SAMPLING GRID
- BUILDING
- PAVED AREA
- AREA ADDRESSED AS PART OF 1/2-MILE REACH REMOVAL ACTION OR 1 1/2-MILE REACH REMOVAL ACTION
- APPROXIMATE UNDERGROUND WATER UTILITY LOCATION (TERMINUS NOT SHOWN)
- APPROXIMATE UNDERGROUND ELECTRIC UTILITY LOCATION
- APPROXIMATE UNDERGROUND TELEPHONE UTILITY LOCATION
- AREA OF PARCEL 19-4-201 SUBJECT TO SUPPLEMENTAL PCB SOIL INVESTIGATIONS (i.e., SOIL BORINGS ON 50-FT GRID)

- ### FIGURE NOTES:
- MAPPING IS BASED ON AERIAL PHOTOGRAPHS AND PHOTOGRAMMETRIC MAPPING BY LOCKWOOD MAPPING, INC. - FLOWN IN APRIL 1990; DATA PROVIDED BY GENERAL ELECTRIC COMPANY; AND BLASLAND, BOUCK & LEE, INC. (BBL) CONSTRUCTION PLANS, AND ON OBSERVATIONS DURING A SITE VISIT BY BBL PERSONNEL ON DECEMBER 3, 1997.
 - SITE BOUNDARY IS APPROXIMATE.
 - NOT ALL PHYSICAL FEATURES SHOWN.
 - APPROXIMATE 100-YEAR FLOODPLAIN BOUNDARY IS BASED ON FLOOD ELEVATIONS PUBLISHED BY THE FEDERAL EMERGENCY MANAGEMENT AGENCY: "FLOOD INSURANCE STUDY" - CITY OF PITTSFIELD, MASSACHUSETTS JANUARY 16, 1987; AND "FLOOD INSURANCE RATE MAP" - CITY OF PITTSFIELD, MASSACHUSETTS (PANELS 25037 0010C AND 25037 0020C), FEBRUARY 19, 1982, AND TWO-FOOT CONTOUR TOPOGRAPHIC MAPPING GENERATED PHOTOGRAMMETRICALLY IN 1990 AT A BASE SCALE OF 1:2,400.
- * PARCEL 19-4-25 AND 19-4-202 ARE UNDER COMMON OWNERSHIP AND WILL BE CONSIDERED AS A SINGLE PROPERTY DURING REMOVAL DESIGN/REMOVAL ACTION EVALUATIONS. SINCE PARCEL 19-4-203 IS ALSO CONTIGUOUS AND OWNED BY THE SAME OWNER AS THOSE PARCELS, GE IS PROPOSING TO CONSIDER THAT PARCEL AS PART OF THIS SAME SINGLE PROPERTY FOR EVALUATION PURPOSES.

SUMMARY OF BANK SOIL PCB SAMPLE RESULTS

(PPM DRY WT.; SAMPLE INCREMENTS IN FEET)

Location ID	0 - 0.5	1 - 1.5	2 - 2.5	3 - 3.5	4 - 4.5	5 - 5.5
H2-RB010703-0-0020	ND	ND	6.1	---	---	---
H2-RB010721-0-0000	2.8	2.9	5.1	---	---	---
H2-RB010761-0-0000	13.7	---	---	---	---	---
H2-RB010781-0-0000	21	54	9.9	---	---	---
H2-RB010801-0-0000	19	62	1.7	---	---	---
H2-RB010821-0-0000	144	15.2	0.93	---	---	---
H2-RB010841-0-0000	12	12	32	1.3	---	---
H2-RB010861-0-0000	18	12	2	20.5	---	---
SL0169	0.99	24.7	6.4	---	---	---
SL0177	20.2	2.2	---	---	---	---
SL0180	2.6	1.30	0.83	---	---	---
SL0186	19.7	1.04	0.539	---	---	---
SL0231	1.08	26.1	28.8	---	---	---
SL0243	30	7.8	7.0	---	---	---

SUMMARY OF SOIL SOURCE CONTROL PCB SAMPLE RESULTS

(PPM DRY WT.; SAMPLE INCREMENTS IN FEET)

Location ID	0 - 0.5	1 - 1.5	3 - 6	6 - 10	10 - 15	15 - 17	17 - 19	20 - 22	23 - 24	24 - 26	26 - 28	28 - 30	32 - 36	36 - 38
LS-02	54	0.89	0.6	1.17	0.25	---	---	---	---	---	---	---	---	---
LS-04	148	142	82	8.0	0.12	---	---	---	---	---	---	---	---	---
LS-06	1.4	99	3,600	2,500	4,300	370	---	---	---	---	---	---	---	---
LS-07	1.08	4.2	8.7	7.7	0.99	---	---	---	---	---	---	---	---	---
LS-08	11.1	11.7	2.9	1.94	0.58	---	---	---	---	---	---	---	---	---
LS-09	14	5,900	49,000	22,000	1,800	290	---	---	---	---	---	---	---	---
LS-11	1	7.2	0.33	0.29	160	---	---	---	---	---	---	---	---	---
LS-18	0.24	7.3	0.53	0.14	0.2	---	---	---	---	---	---	---	---	---
LS-19	0.42	18,000	1,800	270	810	680	---	---	---	---	---	---	---	---
LS-31	0.046	2.9	11.3	2.4	ND	---	---	---	---	---	---	---	---	0.057

SUMMARY OF SOIL BORING PCB SAMPLE RESULTS

(PPM DRY WT.; SAMPLE INCREMENTS IN FEET)

Location ID	0 - 0.33	0-0.5	0 - 2	2 - 4	4 - 6	6 - 8	8 - 10	10 - 12	12 - 14	14 - 16	16 - 18	18 - 20	20 - 22	22 - 24	24 - 26	26 - 28	28 - 30	30 - 32	32 - 34
B-1	---	14.8	15	23.1	11(ND)	6.2	ND	ND	ND	2.6	---	---	---	---	---	---	---	---	---
B-2	---	11.8	182	2.67	ND	0.73	0.090	17(1.81)	1.44	ND	0.59	---	---	---	---	---	---	---	---
E-3	ND	0.79	0.46	0.23	1.35	0.28	0.38	0.97	0.78	0.15	ND	ND	ND	ND	ND	ND	ND	ND	ND
E-4	---	2.2	7.7	15	2.4	0.07	0.084	0.18	0.063	ND	---	---	---	---	---	---	---	---	---
E-5	---	2.0	1.5	0.38	0.17	ND	---	---	---	---	---	---	---	---	---	---	---	---	---
E-6	---	2.4	ND	ND	ND	ND	---	---	---	---	---	---	---	---	---	---	---	---	---
E-6	---	4.2	0.96	0.82	1.23	0.38	0.60	---	---	---	---	---	---	---	---	---	---	---	---
E-7	---	0.33	ND	0.097	ND	ND	---	---	---	---	---	---	---	---	---	---	---	---	---
LS-26	---	1.97	---	---	---	---	---	---	---	---	---	---	---	---	---	---	---	---	---
LS-27	---	11	0.83	7.0	---	1.4	0.48	0.40	0.12	ND	---	---	---	---	---	---	---	---	---
LS-28	---	0.63	1.3	3.1	ND	3.6	0.25	ND	ND	ND	---	---	---	---	---	---	---	---	---
LS-29	---	28	---	---	---	---	---	---	---	---	---	---	---	---	---	---	---	---	---
LS-30	---	409	---	---	---	---	---	---	---	---	---	---	---	---	---	---	---	---	---
LS-31	---	890	---	---	---	---	---	---	---	---	---	---	---	---	---	---	---	---	---
LS-33	---	6	2.1	2.2	1.3	0.87	0.71	0.8	590	145	---	---	---	---	---	---	---	---	---
LS-34	---	0.73	0.32	0.27	0.53	0.43	0.061	ND	0.063	ND	0.055	0.41	1.700	33	---	---	---	---	---
LS-35	---	29	35	---	---	---	---	---	---	---	---	---	---	---	---	---	---	---	---
LS-36	---	5.6	0.10	ND	ND	ND	ND	ND	ND	ND	ND	ND	ND	ND	ND	ND	ND	ND	ND
LS-39	---	ND	ND	ND	ND	ND	ND	ND	ND	ND	ND	ND	ND	ND	ND	ND	ND	ND	ND
LS-40	---	ND	ND	ND	ND	ND	ND	ND	ND	ND	ND	ND	ND	ND	ND	ND	ND	ND	ND
LS-42	---	5.6	0.10	ND	ND	ND	ND	ND	ND	ND	ND	ND	ND	ND	ND	ND	ND	ND	ND
LS-43	---	0.54	0.58	1.1	---	0.094	ND	0.082	0.17	1.3	0.099	7.1	260	71	---	---	---	---	---
LS-44	---	3.6	22	0.13	0.67	5.0	ND	0.14	1.6	0.083	ND	0.3	0.072	ND	---	---	---	---	---
LS-45	---	2.3	26	8.3	1.1	0.61	0.092	0.08	ND	5.9	0.85	0.41	0.92	ND	0.68	0.14	0.063	ND	---

SUMMARY OF SURFACE SOIL PCB SAMPLE RESULTS

(PPM DRY WT.; SAMPLE INCREMENTS IN FEET)

Location ID	0 - 0.5	0.5 - 1
19-4-140	4.3	5.4
19-4-14E	3.5	6.7
LS-C-14	7.3	---
LS-C-16	0.14	0.14
LS-C-17	11.0	---
LS-C-18	ND	---
LS-C-19	0.14	---
LS-GWP-13	32	33
LS-GWP-17	53	---
LS-GWP-18	33	---
LS-GWP-20	21	---
LS-GWP-21	1.1	---
LS-GWP-22	32	---
LS-GWP-23	100	---
LS-GWP-25	4.2	---
LS-GWP-26	16	---
LS-GWP-27	5.2	---
LS-GWP-28	0.30	---
LS-GWP-30	2.3	---
LS-GWP-34	11.0	2.5
LS-GWP-7	35	---

- ### TABLE NOTES:
- = No sample collected.
 - ND = Not detected.
 - [0.32] = Duplicate analysis result shown in brackets.
 - J = Indicates an estimated value less than the Practical Quantitation Limit.

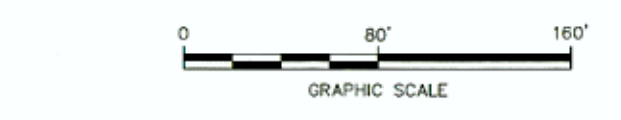

GENERAL ELECTRIC COMPANY
PITTSFIELD, MASSACHUSETTS
LYMAN STREET AREA

PROPOSED PCB CHARACTERIZATION LOCATIONS

BBL
BLASLAND, BOUCK & LEE, INC.
engineers & scientists



- LEGEND**
- APPROXIMATE REMOVAL ACTION AREA BOUNDARY
 - FENCE
 - - - PROPERTY LINE (APPROXIMATE)
 - FORMER OXBOW/LOW LYING AREA
 - ▲ LS-GWP-34 EXISTING SURFACE SOIL SAMPLE LOCATION
 - E-3 EXISTING SOIL BORING LOCATION
 - ▲ 9-0187 EXISTING 1/2-MILE BANK SOIL SAMPLES (EPA DATA)
 - ▲ 92-RB010781-0-0000 EXISTING 1/2-MILE BANK SOIL SAMPLES (EPA DATA)
 - ▲ RAA12-029 PROPOSED SURFACE SOIL SAMPLE LOCATION
 - RAA12-026 PROPOSED SOIL BORING LOCATION
 - BUILDING
 - PAVED AREA
 - ▨ AREA ADDRESSED AS PART OF 1/2-MILE REACH REMOVAL ACTION OR 1/2-MILE REACH REMOVAL ACTION

- FIGURE NOTES:**
1. MAPPING IS BASED ON AERIAL PHOTOGRAPHS AND PHOTOGRAMMETRIC MAPPING BY LOCKWOOD MAPPING, INC. - FLOWN IN APRIL 1990; DATA PROVIDED BY GENERAL ELECTRIC COMPANY, AND BLASLAND, BOUCK & LEE, INC. (BBL) CONSTRUCTION PLANS, AND ON OBSERVATIONS DURING A SITE VISIT BY BBL PERSONNEL ON DECEMBER 3, 1997.
 2. SITE BOUNDARY IS APPROXIMATE.
 3. NOT ALL PHYSICAL FEATURES SHOWN.
 4. APPROXIMATE 100-YEAR FLOODPLAIN BOUNDARY IS BASED ON FLOOD ELEVATIONS PUBLISHED BY THE FEDERAL EMERGENCY MANAGEMENT AGENCY, "FLOOD INSURANCE STUDY - CITY OF PITTSFIELD, MASSACHUSETTS" JANUARY 16, 1987, AND "FLOOD INSURANCE RATE MAP - CITY OF PITTSFIELD, MASSACHUSETTS" (PANELS 250037 0010C AND 25037 0020C), FEBRUARY 19, 1982, AND TWO-FOOT CONTOUR TOPOGRAPHIC MAPPING GENERATED PHOTOGRAMMETRICALLY IN 1990 AT A BASE SCALE OF 1:2,400.
 5. THE APPENDIX IX+3 CONSTITUENT GROUP WHERE DATA EXISTS OR IS PROPOSED FOR COLLECTION IS LOCATED IN PARENTHESES NEXT TO EACH SAMPLE LOCATION. THE CONSTITUENT GROUPS ARE:
 V = VOLATILE ORGANIC COMPOUNDS (VOCs)
 SV = SEMI-VOLATILE ORGANIC COMPOUNDS (SVOCs)
 D = POLYCHLORINATED DIBENZO-P-DIOXINS (PCDDs) AND POLYCHLORINATED DIBENZOFURANS (PCDFs)
 I = INORGANICS
 P = PESTICIDES AND HERBICIDES (PEST/HERB)
 - * PARCEL 19-4-25 AND 19-4-202 ARE UNDER COMMON OWNERSHIP AND WILL BE CONSIDERED AS A SINGLE PROPERTY DURING REMOVAL DESIGN/REMOVAL ACTION EVALUATIONS. SINCE PARCEL 19-4-203 IS ALSO CONTIGUOUS AND OWNED BY THE SAME OWNER AS THOSE PARCELS, GE IS PROPOSING TO CONSIDER THAT PARCEL AS PART OF THIS SAME SINGLE PROPERTY FOR EVALUATION PURPOSES.



GENERAL ELECTRIC COMPANY
 PITTSFIELD, MASSACHUSETTS
 LYMAN STREET AREA

EXISTING AND PROPOSED APPENDIX IX+3 SOIL SAMPLING LOCATIONS (0- TO 1-FOOT DEPTH INTERVAL)

BBL
 BLASLAND, BOUCK & LEE, INC.
 engineers & architects

FIGURE
4



- LEGEND**
- APPROXIMATE REMOVAL ACTION AREA BOUNDARY
 - FENCE
 - PROPERTY LINE (APPROXIMATE)
 - FORMER OXBOW/LOW LYING AREA
 - LS-27 EXISTING SOIL BORING LOCATION
 - RAA12-102 PROPOSED SOIL BORING LOCATION
 - △ H2-8010681-1-00001 1/2-MILE BANK SOIL SAMPLES (EPA DATA)
 - △ H2-8010681-1-00001 1/2-MILE BANK SOIL SAMPLES (EPA DATA)
 - BUILDING
 - PAVED AREA
 - ▨ AREA ADDRESSED AS PART OF 1/2-MILE REACH REMOVAL ACTION OR 1/2-MILE REACH REMOVAL ACTION

- FIGURE NOTES:**
1. MAPPING IS BASED ON AERIAL PHOTOGRAPHS AND PHOTOGRAMMETRIC MAPPING BY LOCKWOOD MAPPING, INC. - FLOWN IN APRIL 1990; DATA PROVIDED BY GENERAL ELECTRIC COMPANY AND BLASLAND, BOUCK & LEE, INC. (BBL) CONSTRUCTION PLANS, AND ON OBSERVATIONS DURING A SITE VISIT BY BBL PERSONNEL ON DECEMBER 3, 1997.
 2. SITE BOUNDARY IS APPROXIMATE.
 3. NOT ALL PHYSICAL FEATURES SHOWN.
 4. APPROXIMATE 100-YEAR FLOODPLAIN BOUNDARY IS BASED ON FLOOD ELEVATIONS PUBLISHED BY THE FEDERAL EMERGENCY MANAGEMENT AGENCY, "FLOOD INSURANCE STUDY - CITY OF PITTSFIELD, MASSACHUSETTS" JANUARY 16, 1987; AND "FLOOD INSURANCE RATE MAP - CITY OF PITTSFIELD, MASSACHUSETTS" PANELS 250037 001C AND 25037 0020C, FEBRUARY 18, 1982; AND TWO-FOOT CONTOUR TOPOGRAPHIC MAPPING GENERATED PHOTOGRAMMETRICALLY IN 1990 AT A BASE SCALE OF 1:2,400.
 5. THE APPENDIX IX+3 CONSTITUENT GROUP WHERE DATA EXISTS OR IS PROPOSED FOR COLLECTION IS LOCATED IN PARENTHESES NEXT TO EACH SAMPLE LOCATION. THE CONSTITUENT GROUPS ARE:
 V = VOLATILE ORGANIC COMPOUNDS (VOCs)
 S = SEMI-VOLATILE ORGANIC COMPOUNDS (SVOCs)
 P = POLYCHLORINATED DIBENZO-P-DIOXINS (PCDDs) AND POLYCHLORINATED DIBENZOFURANS (PCDFs)
 I = INORGANICS
 H = PESTICIDES AND HERBICIDES (PEST/HERB)
- * PARCEL 19-4-25 AND 19-4-202 ARE UNDER COMMON OWNERSHIP AND WILL BE CONSIDERED AS A SINGLE PROPERTY DURING REMOVAL DESIGN/REMOVAL ACTION EVALUATIONS SINCE PARCEL 19-4-203 IS ALSO CONTIGUOUS AND OWNED BY THE SAME OWNER AS THOSE PARCELS. GE IS PROPOSING TO CONSIDER THAT PARCEL AS PART OF THIS SAME SINGLE PROPERTY FOR EVALUATION PURPOSES.



GENERAL ELECTRIC COMPANY
 PITTSFIELD, MASSACHUSETTS
 LYMAN STREET AREA

EXISTING AND PROPOSED APPENDIX IX+3 SOIL SAMPLING LOCATIONS (1- TO 3-FOOT DEPTH INTERVAL)

BBL
 BLASLAND, BOUCK & LEE, INC.
 ENGINEERS & ARCHITECTS

FIGURE
5

X: 40124X01.DWG
 P: PAGESET/PLT-0428
 7/16/02 SYR-54-POL.DWG.POL
 N: 40124001/40124014.DWG





- LEGEND**
- APPROXIMATE REMOVAL ACTION AREA BOUNDARY
 - FENCE
 - PROPERTY LINE (APPROXIMATE)
 - FORMER OXBOW/LOW LYING AREA
 - E-5 EXISTING SOIL BORING LOCATION (1- FOOT OR GREATER SAMPLE DEPTH)
 - ▲ GE-C EXISTING 1 1/2-MILE BANK SOIL SAMPLE LOCATION (EPA DATA)
 - RAA12-### PROPOSED SOIL BORING LOCATION
 - BUILDING
 - PAVED AREA
 - ▨ AREA ADDRESSED AS PART OF 1/2-MILE REACH REMOVAL ACTION OR 1 1/2-MILE REACH REMOVAL ACTION

- FIGURE NOTES**
- 1 MAPPING IS BASED ON AERIAL PHOTOGRAPHS AND PHOTOGRAMMETRIC MAPPING BY LOCKWOOD MAPPING, INC. - FLOWN IN APRIL, 1990; DATA PROVIDED BY GENERAL ELECTRIC COMPANY AND BLAISLAND, BOUCK & LEE, INC. (BBL) CONSTRUCTION PLANS, AND ON OBSERVATIONS DURING A SITE VISIT BY BBL PERSONNEL ON DECEMBER 3, 1997.
 - 2 SITE BOUNDARY IS APPROXIMATE.
 - 3 NOT ALL PHYSICAL FEATURES SHOWN.
 - 4 APPROXIMATE 100-YEAR FLOODPLAIN BOUNDARY IS BASED ON FLOOD ELEVATIONS PUBLISHED BY THE FEDERAL EMERGENCY MANAGEMENT AGENCY, "FLOOD INSURANCE STUDY - CITY OF PITTSFIELD, MASSACHUSETTS" JANUARY 16, 1967, AND "FLOOD INSURANCE RATE MAP - CITY OF PITTSFIELD, MASSACHUSETTS" (PANELS 250037 8010C AND 25037 0020C), FEBRUARY 19, 1982, AND TWO-FOOT CONTOUR TOPOGRAPHIC MAPPING GENERATED PHOTOGRAMMETRICALLY IN 1990 AT A BASE SCALE OF 1:2,400.
 - 5 THE APPENDIX IX+3 CONSTITUENT GROUP WHERE DATA EXISTS OR IS PROPOSED FOR COLLECTION IS LOCATED IN PARENTHESES NEXT TO EACH SAMPLE LOCATION. THE CONSTITUENT GROUPS ARE:
 V = VOLATILE ORGANIC COMPOUNDS (VOCs)
 SV = SEMI-VOLATILE ORGANIC COMPOUNDS (SVOCs)
 D = POLYCHLORINATED DIBENZO-P-DIOXINS (PCDDs) AND POLYCHLORINATED DIBENZOFURANS (PCDFs)
 I = INORGANICS
 P = PESTICIDES AND HERBICIDES (PEST/HERB)
 - * PARCELS 19-4-25 AND 19-4-202 ARE UNDER COMMON OWNERSHIP AND WILL BE CONSIDERED AS A SINGLE PROPERTY DURING REMOVAL DESIGN/REMOVAL ACTION EVALUATIONS. SINCE PARCEL 19-4-203 IS ALSO CONTIGUOUS AND OWNED BY THE SAME OWNER AS THOSE PARCELS, GE IS PROPOSING TO CONSIDER THAT PARCEL AS PART OF THIS SAME SINGLE PROPERTY FOR EVALUATION PURPOSES.



**GENERAL ELECTRIC COMPANY
 PITTSFIELD, MASSACHUSETTS
 LYMAN STREET AREA**
**EXISTING AND PROPOSED APPENDIX
 IX+3 SOIL SAMPLING LOCATIONS
 (6- TO 10-FOOT DEPTH INTERVAL)**

FIGURE 7

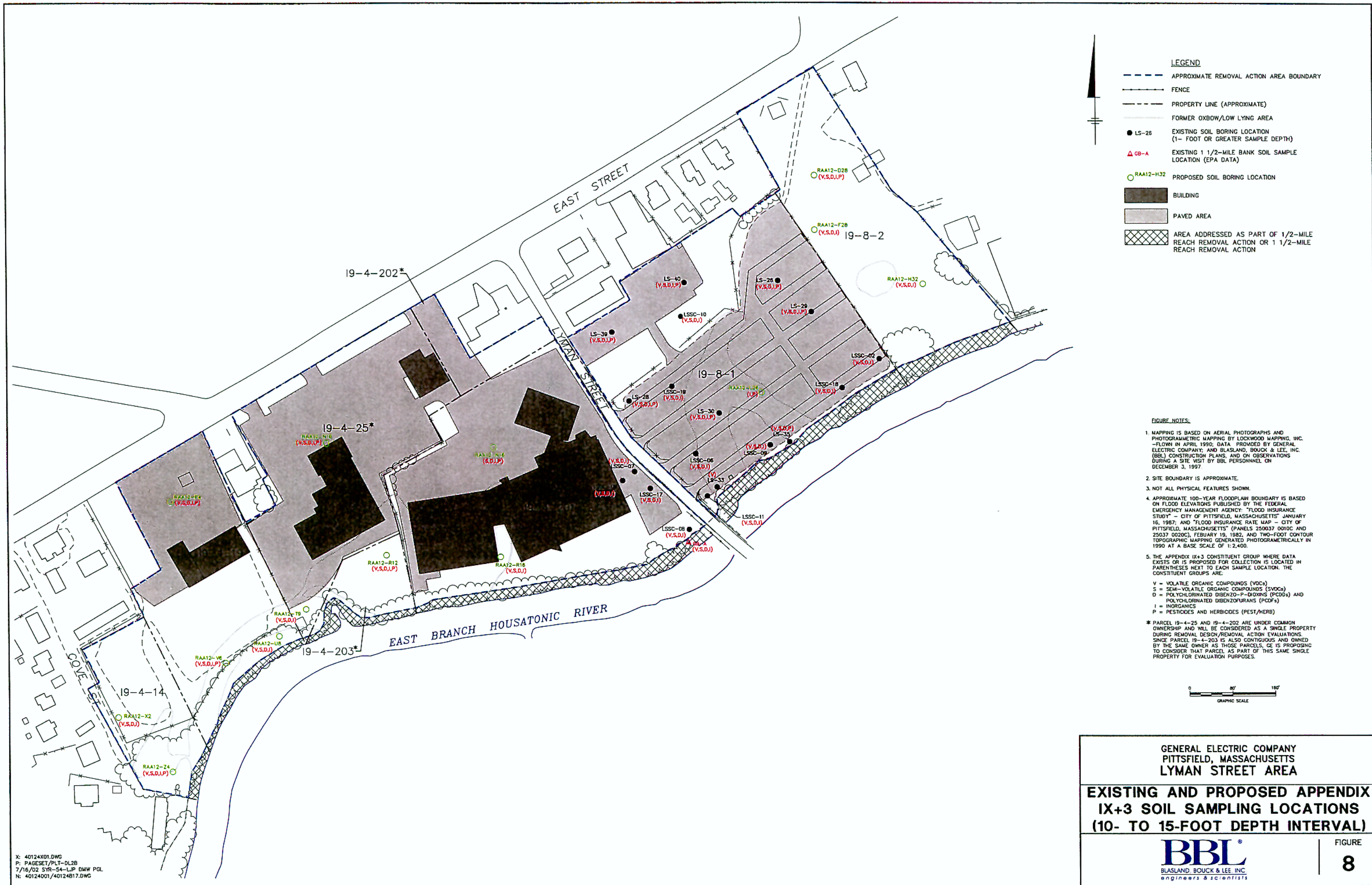

- LEGEND**
- APPROXIMATE REMOVAL ACTION AREA BOUNDARY
 - FENCE
 - PROPERTY LINE (APPROXIMATE)
 - FORMER OXBOW/LOW LYING AREA
 - LS-26 EXISTING SOIL BORING LOCATION (1- FOOT OR GREATER SAMPLE DEPTH)
 - ▲ GB-A EXISTING 1 1/2-MILE BANK SOIL SAMPLE LOCATION (EPA DATA)
 - RAA12-H32 PROPOSED SOIL BORING LOCATION
 - BUILDING
 - PAVED AREA
 - ▨ AREA ADDRESSED AS PART OF 1/2-MILE REACH REMOVAL ACTION OR 1 1/2-MILE REACH REMOVAL ACTION

- FIGURE NOTES:**
1. MAPPING IS BASED ON AERIAL PHOTOGRAPHS AND PHOTOGRAMMETRIC MAPPING BY LOCKWOOD MAPPING, INC. - FLOWN IN APRIL 1990; DATA PROVIDED BY GENERAL ELECTRIC COMPANY; AND BLASLAND, BOUCK & LEE, INC. (BBL) CONSTRUCTION PLANS, AND ON OBSERVATIONS DURING A SITE VISIT BY BBL PERSONNEL ON DECEMBER 3, 1997.
 2. SITE BOUNDARY IS APPROXIMATE.
 3. NOT ALL PHYSICAL FEATURES SHOWN.
 4. APPROXIMATE 100-YEAR FLOODPLAIN BOUNDARY IS BASED ON FLOOD ELEVATIONS PUBLISHED BY THE FEDERAL EMERGENCY MANAGEMENT AGENCY, "FLOOD INSURANCE STUDY" - CITY OF PITTSFIELD, MASSACHUSETTS JANUARY 16, 1987; AND "FLOOD INSURANCE RATE MAP - CITY OF PITTSFIELD, MASSACHUSETTS" (PANELS 250037 0010C AND 25037 0020C), FEBRUARY 19, 1982, AND TWO-FOOT CONTOUR TOPOGRAPHIC MAPPING GENERATED PHOTOGRAMMETRICALLY IN 1990 AT A BASE SCALE OF 1:2,400.
 5. THE APPENDIX IX+3 CONSTITUENT GROUP WHERE DATA EXISTS OR IS PROPOSED FOR COLLECTION IS LOCATED IN PARENTHESES NEXT TO EACH SAMPLE LOCATION. THE CONSTITUENT GROUPS ARE:
 - V = VOLATILE ORGANIC COMPOUNDS (VOCs)
 - S = SEMI-VOLATILE ORGANIC COMPOUNDS (SVOCs)
 - D = POLYCHLORINATED DIBENZO-P-DIOXINS (PCDDs) AND POLYCHLORINATED DIBENZOFURANS (PCDFs)
 - I = INORGANICS
 - P = PESTICIDES AND HERBICIDES (PEST/HERB)
- * PARCEL 19-4-25 AND 19-4-202 ARE UNDER COMMON OWNERSHIP AND WILL BE CONSIDERED AS A SINGLE PROPERTY DURING REMOVAL DESIGN/REMOVAL ACTION EVALUATIONS. SINCE PARCEL 19-4-203 IS ALSO CONTIGUOUS AND OWNED BY THE SAME OWNER AS THOSE PARCELS, GE IS PROPOSING TO CONSIDER THAT PARCEL AS PART OF THIS SAME SINGLE PROPERTY FOR EVALUATION PURPOSES.

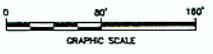

GENERAL ELECTRIC COMPANY
PITTSFIELD, MASSACHUSETTS
LYMAN STREET AREA

**EXISTING AND PROPOSED APPENDIX
IX+3 SOIL SAMPLING LOCATIONS
(10- TO 15-FOOT DEPTH INTERVAL)**



FIGURE
8

X: 40124X01.DWG
P: PAGESET/PLT-DL2B
7/16/02 SYR-S4-LJP DMW PCL
N: 40124001/40124817.DWG