



GE
159 Plastics Avenue
Pittsfield, MA 01201
USA

Transmitted via Overnight Courier

January 3, 2007

Mr. Dean Tagliaferro
EPA Project Coordinator
United States Environmental Protection Agency
c/o Weston Solutions, Inc.
10 Lyman Street
Pittsfield, MA 01201

**Re: GE-Pittsfield/Housatonic River Site
Former Oxbow Areas J and K (GECD420)
Summary of November 2006 Inspection Activities**

Dear Mr. Tagliaferro:

On November 1, 2006, the General Electric Company (GE) performed its first post-remediation inspection of the properties within Former Oxbow Areas J and K at which remediation activities have been performed. As shown on Figure 1, Former Oxbow Areas J and K include six commercial parcels (four of which have recreational areas within them), three recreational parcels, and two residential parcels. In accordance with GE's *Addendum to Final Removal Design/Removal Action Work Plan for Former Oxbow Areas J and K* (Final RD/RA Work Plan Addendum), which was submitted to EPA in April 2006 and conditionally approved by EPA on June 23, 2006, GE conducted remediation activities at all six of the commercial parcels (Parcels K10-13-1, K10-12-1, K10-11-1, K10-11-2, K10-11-3, and K10-11-5) and one residential property (Parcel K10-10-6). These remediation activities were completed in summer 2006. Vegetation restoration activities were subsequently conducted at these properties in accordance with the revised Vegetation Restoration Plan for Former Oxbow Areas J and K, provided in Attachment 2 to GE's October 5, 2006 Addendum to Supplemental Information Package.

The November 2006 inspection was performed for areas that were backfilled and restored during implementation of the remediation actions. This inspection was conducted in accordance with the Post-Removal Site Control Plan contained in Attachment E to GE's Final RD/RA Work Plan, as revised and set forth in Attachment G to the Final RD/RA Work Plan Addendum.

The November 2006 inspection consisted of visual observations of the backfilled/restored areas, focusing on the following: (a) erosion controls to verify their continued effectiveness until such time as vegetation is sufficiently established; (b) any areas where excessive settlement has occurred relative to the surrounding areas; (c) any drainage or growth problems due to possible over-compaction of backfill materials; and (d) other conditions that could jeopardize the completed remediation. The inspection also evaluated whether the vegetation that has been planted or seeded is growing as anticipated and providing the desired degree of erosion control.

To document the results of the November 2006 inspection, GE completed an Inspection Summary and Checklist for each property subject to inspection. Copies of the completed forms are provided in Attachment A. These forms will also be used in the future to continue to document such inspections and track the completion of identified maintenance activities.

In summary, as indicated on the attached forms, the November 1, 2006 inspection indicated the following observations requiring further action:

- Tree/shrub plantings at several properties (Parcels K10-11-5 and K10-10-6) remained to be installed later in November.
- Ruts and tracks resulting from recreational vehicles were observed on undeveloped Longview Terrace (adjacent to Parcel K10-12-1) and on Parcels K10-11-3 and K10-11-5. These ruts and tracks need to be repaired and re-seeded, and construction fencing should be placed in areas of Parcels K10-11-3 and K10-11-5 where ruts and tracks were observed to prevent access and allow adequate establishment of vegetation.
- Haybales placed along the swale on Parcel K10-11-2 have been left in place to decrease the potential for erosion. These haybales should be checked at the next inspection to determine if adequate vegetation has been established and whether removal of the haybales is necessary.

The remaining tree/shrub plantings were installed in November 2006. The condition of these trees and shrubs will be checked during the spring 2007 inspection to ensure that they are growing. The maintenance actions to address the observed ruts and tracks will be performed prior to the spring 2007 inspection. The haybales along the swale on Parcel K10-11-2 will be checked in May 2007.

In accordance with the above-referenced Post-Removal Site Control Plan, the backfilled/restored areas will be inspected approximately every 6 months for a period of two years. Future inspections are anticipated to occur in May and October of 2007 and 2008. Following each inspection, an inspection report will be prepared and submitted to EPA.

In addition, GE is currently developing a Final Completion Report for the Former Oxbows J and K Removal Action. GE anticipates scheduling a pre-certification inspection with EPA and the Massachusetts Department of Environmental Protection in the first part of 2007, and will thereafter submit the Final Completion Report to EPA. That report will include a final Post-Removal Site Control Plan for this area.

Please call me if you have any comments or questions.

Sincerely

Richard Gates/EGB

Richard W. Gates
Remediation Project Manager

Attachment

V:\GE_Pittsfield_CD_Former_Oxbow_Areas_J_and_K\Reports and Presentations\Inspections\007711324Ltr.doc

cc: Tim Conway, EPA
Holly Inglis, EPA
Rose Howell, EPA*
Linda Palmieri, Weston (2 copies)
K.C. Mitkevicius, USACE
Susan Steenstrup, MDEP (2 copies)
Anna Symington, MDEP*
Jane Rothchild, MDEP*
Nancy E. Harper, MA AG*
Dale Young, MA EOEA

Mayor James Ruberto, City of Pittsfield
Michael Carroll, GE*
Rod McLaren, GE*
Andrew Silfer, GE*
Peter Wojcik, GE*
James Nuss, ARCADIS BBL
James Bieke, Goodwin Procter LLP
Public Information Repositories
GE Internal Repository
** cover letter only*

Figure

SYR-85-DWM RCB LAF LAYER: ON=*, OFF=*REF*, |X01 MAP_NUM, |TEXT
 G:\GE_ACTIVE\N\20639008\NOV06\20639001.DWG SAVED:1/2/2007 3:35 PM
 LAYOUT:1 PAGESETUP:BL-PDF PENTABLE:PLTULLCTB PRINTED:1/2/2007 3:35 PM BY:LFORAKER
 PROJECTNAME: 20639001
 XREFS: IMAGES:

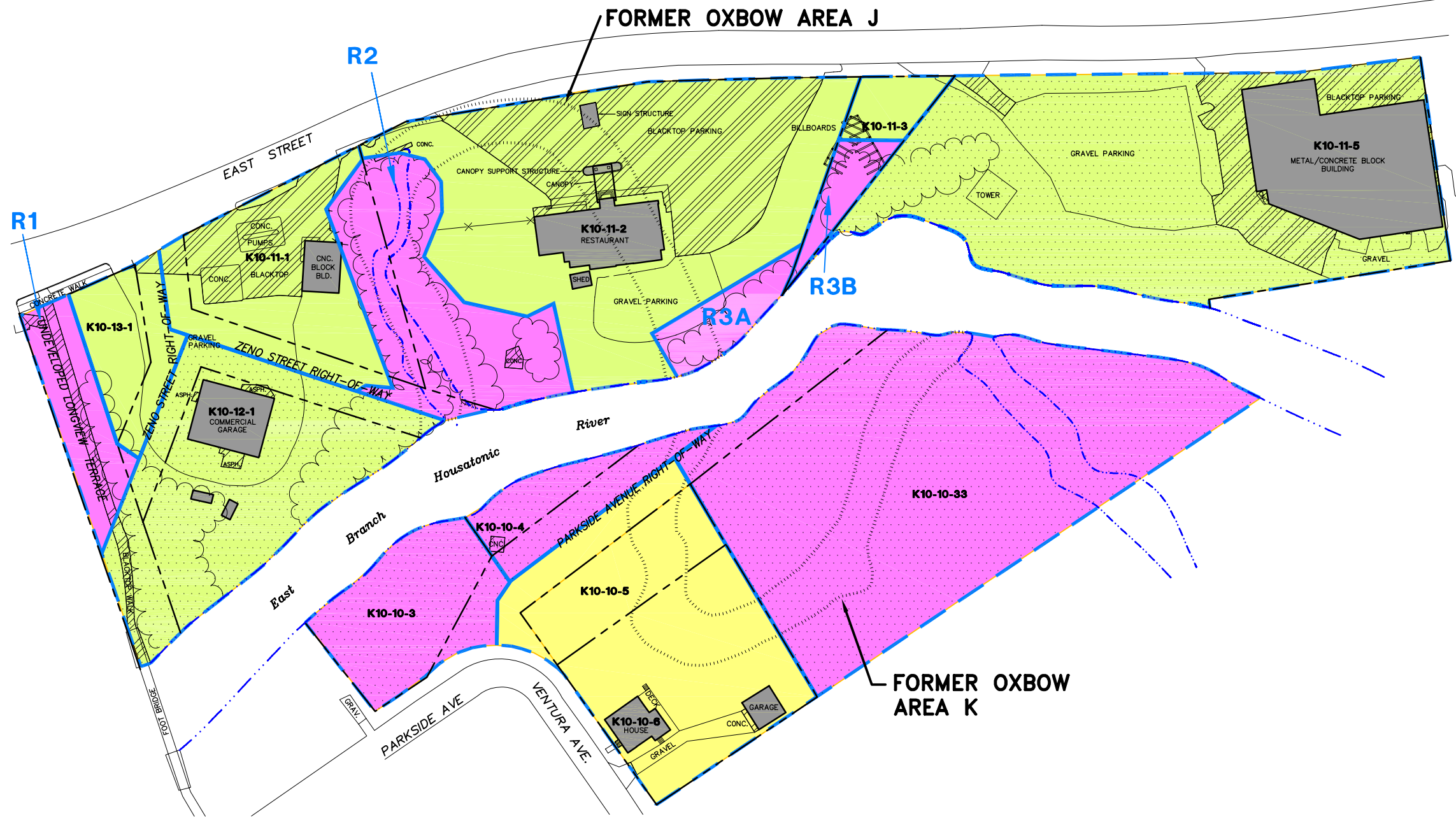

- LEGEND:**
- APPROXIMATE REMOVAL ACTION AREA BOUNDARY (EXCLUDING ACTUAL RIVERBANK AREAS)
 - RD/RA AVERAGING AREA BOUNDARY
 - PROPERTY LINE
 - K10-10-6** PROPERTY ID
 - R2** RECREATIONAL AREA ID
 - EDGE OF WATER
 - PAVED ROADWAY
 - VEGETATION
 - STREAMS WITH INTERMITTENT FLOW
 - FORMER OXBOW/LOW-LYING AREA
 - RECREATIONAL AREA (NON-GE-OWNED)
 - RECREATIONAL AREA PROPERTY (NON-GE-OWNED) EVALUATED UNDER RESIDENTIAL SCENARIO
 - COMMERCIAL PROPERTY (NON-GE-OWNED)
 - COMMERCIAL PROPERTY (NON-GE-OWNED) EVALUATED UNDER RESIDENTIAL SCENARIO
 - RESIDENTIAL PROPERTY
 - BUILDING OR PERMANENT STRUCTURE
 - PAVED AREA

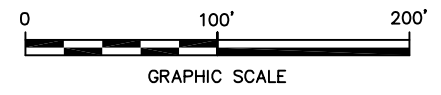

GENERAL ELECTRIC COMPANY
 PITTSFIELD, MASSACHUSETTS
NOVEMBER 2006 INSPECTION

SITE MAP

ARCADIS BBL
 infrastructure. environment. facilities

FIGURE
1

Attachment A

Completed Inspection Forms

INSPECTION SUMMARY AND CHECKLIST

FORMER OXBOW AREAS J AND K

PARCEL K10-12-1 / K10-11-1

I. GENERAL INFORMATION

Inspection Date: 11-1-06
Conducted By: Paolo Filippetti
Weather Conditions: Sunny - 55°F
Date of Last Inspection: ---

II. INSPECTION SUMMARY

1. Soil Backfill Areas *(Note any physical changes since last inspection; note evidence of excessive settlement, surface water ponding, burrows, vehicle ruts; excavation activities, unauthorized uses of areas, etc.)*

- All soil backfill areas are in good condition.
- All terrain vehicle (ATV) ruts/tracks have been observed on undeveloped Longview Terrace.

2. Vegetation Area *(Note any physical changes since last inspection; note general condition of vegetative cover (e.g., evidence of stressed/sparse cover) and other landscaping items (trees, shrubs, etc.)*

- Tree plantings on Parcel K10-12-1 / undeveloped Longview Terrace and Zeno Street right-of-way have been installed.
- Grass vegetation has been established.

3. Other Observations *(Confirm that repair/maintenance measures identified during prior inspection have been performed; note any other general observations, including parcel-specific restoration activities.)*

- None.

III. FOLLOW-UP MAINTENANCE AND REPAIR ACTIVITIES

- ATV ruts/tracks are to be fixed and seeded.

ATTACH ADDITIONAL INFORMATION AS APPROPRIATE

INSPECTION SUMMARY AND CHECKLIST

FORMER OXBOW AREAS J AND K

PARCEL K10-11-2

I. GENERAL INFORMATION

Inspection Date: 11-1-06
Conducted By: Paolo Filippetti
Weather Conditions: Sunny - 55°F
Date of Last Inspection: ---

II. INSPECTION SUMMARY

1. Soil Backfill Areas *(Note any physical changes since last inspection; note evidence of excessive settlement, surface water ponding, burrows, vehicle ruts; excavation activities, unauthorized uses of areas, etc.)*

- Soil backfill areas are in good condition.
- To decrease erosion potential along swale, hay bales have not been removed.

2. Vegetation Area *(Note any physical changes since last inspection; note general condition of vegetative cover (e.g., evidence of stressed/sparse cover) and other landscaping items (trees, shrubs, etc.)*

- All areas have established vegetative cover.
- Planting in planter east of entrance to Bobby Hudpuckers are in good condition.
- All plantings along bank of swale have been installed.

3. Other Observations *(Confirm that repair/maintenance measures identified during prior inspection have been performed; note any other general observations, including parcel-specific restoration activities.)*

- None.

III. FOLLOW-UP MAINTENANCE AND REPAIR ACTIVITIES

- Ensure bales along swale degrade and no erosion takes place in this general area.

ATTACH ADDITIONAL INFORMATION AS APPROPRIATE

INSPECTION SUMMARY AND CHECKLIST

FORMER OXBOW AREAS J AND K

PARCEL K10-11-3

I. GENERAL INFORMATION

Inspection Date: 11-1-06
Conducted By: Paolo Filippetti
Weather Conditions: Sunny - 55°F
Date of Last Inspection: ---

II. INSPECTION SUMMARY

1. Soil Backfill Areas *(Note any physical changes since last inspection; note evidence of excessive settlement, surface water ponding, burrows, vehicle ruts; excavation activities, unauthorized uses of areas, etc.)*

- No erosion in soil backfill areas.
- All terrain vehicle (ATV) ruts/tracks observed on top of ridge portion of parcel. Area is to be planted with tree planting this month.
- Bank excavations backfilled with rip-rap are in good condition and vegetation has begun to establish itself.

2. Vegetation Area *(Note any physical changes since last inspection; note general condition of vegetative cover (e.g., evidence of stressed/sparse cover) and other landscaping items (trees, shrubs, etc.)*

- Vegetation along bank of Housatonic River has begun to establish itself.
- All areas have established vegetation.
- As per Addendum to Supplemental Information Package drawing dated September 15, 2006, tree plantings are not to be installed.

3. Other Observations *(Confirm that repair/maintenance measures identified during prior inspection have been performed; note any other general observations, including parcel-specific restoration activities.)*

- None.

III. FOLLOW-UP MAINTENANCE AND REPAIR ACTIVITIES

- ATV ruts/tracks should be fixed and seeded.
- Plastic construction fence to be installed across ruts/tracks to prevent access.

ATTACH ADDITIONAL INFORMATION AS APPROPRIATE

INSPECTION SUMMARY AND CHECKLIST

FORMER OXBOW AREAS J AND K

PARCEL K10-10-6

I. GENERAL INFORMATION

Inspection Date: 11-1-06
Conducted By: Paolo Filippetti
Weather Conditions: Sunny - 55°F
Date of Last Inspection: ---

II. INSPECTION SUMMARY

1. Soil Backfill Areas *(Note any physical changes since last inspection; note evidence of excessive settlement, surface water ponding, burrows, vehicle ruts; excavation activities, unauthorized uses of areas, etc.)*

- Soil backfill areas are in good condition.

2. Vegetation Area *(Note any physical changes since last inspection; note general condition of vegetative cover (e.g., evidence of stressed/sparse cover) and other landscaping items (trees, shrubs, etc.)*

- All areas have vegetation "grass" established.

- Tree plantings to be installed during the month of November.

3. Other Observations *(Confirm that repair/maintenance measures identified during prior inspection have been performed; note any other general observations, including parcel-specific restoration activities.)*

- None.

III. FOLLOW-UP MAINTENANCE AND REPAIR ACTIVITIES

- None.

ATTACH ADDITIONAL INFORMATION AS APPROPRIATE

INSPECTION SUMMARY AND CHECKLIST

FORMER OXBOW AREAS J AND K

PARCEL K10-11-5

I. GENERAL INFORMATION

Inspection Date: 11-1-06
Conducted By: Paolo Filippetti
Weather Conditions: Sunny - 55°F
Date of Last Inspection: ---

II. INSPECTION SUMMARY

1. Soil Backfill Areas *(Note any physical changes since last inspection; note evidence of excessive settlement, surface water ponding, burrows, vehicle ruts; excavation activities, unauthorized uses of areas, etc.)*

- Areas are in good condition.

2. Vegetation Area *(Note any physical changes since last inspection; note general condition of vegetative cover (e.g., evidence of stressed/sparse cover) and other landscaping items (trees, shrubs, etc.)*

- All terrain vehicle (ATV) track observed along sewer ridge.
- Tree plantings are to be installed this month.
- All areas have vegetation / grass established on them.

3. Other Observations *(Confirm that repair/maintenance measures identified during prior inspection have been performed; note any other general observations, including parcel-specific restoration activities.)*

- None.

III. FOLLOW-UP MAINTENANCE AND REPAIR ACTIVITIES

- ATV tracks/ruts should be fixed and seeded.
- Plastic construction fence to be installed across ruts/tracks to prevent access.

ATTACH ADDITIONAL INFORMATION AS APPROPRIATE

INSPECTION SUMMARY AND CHECKLIST

FORMER OXBOW AREAS J AND K

PARCEL K10-13-1

I. GENERAL INFORMATION

Inspection Date: 11-1-06
Conducted By: Paolo Filippetti
Weather Conditions: Sunny - 55°F
Date of Last Inspection: ---

II. INSPECTION SUMMARY

1. Soil Backfill Areas (Note any physical changes since last inspection; note evidence of excessive settlement, surface water ponding, burrows, vehicle ruts; excavation activities, unauthorized uses of areas, etc.)

- Areas in good condition.

2. Vegetation Area (Note any physical changes since last inspection; note general condition of vegetative cover (e.g., evidence of stressed/sparse cover) and other landscaping items (trees, shrubs, etc.)

- Area in good condition.

3. Other Observations (Confirm that repair/maintenance measures identified during prior inspection have been performed; note any other general observations, including parcel-specific restoration activities.)

- None.

III. FOLLOW-UP MAINTENANCE AND REPAIR ACTIVITIES

- None.

ATTACH ADDITIONAL INFORMATION AS APPROPRIATE