

# Memorandum



TO: Dean Tagliaferro, USEPA  
K.C. Mitkevicius, CENAE

cc: Holly Inglis, USEPA

FROM: Tom Czelusniak

DATE: November 28, 2005

PROJECT: Pittsfield SSERC – TO4

W.O. NO.: 20124.001.098

SUBJECT: Work Plan – Surficial Soil Sampling at Allendale School  
**DCN GE-112805-ACZE**

---

This memorandum has been prepared to serve as a Work Plan for surficial soil sampling at Allendale School. EPA has requested that WESTON collect soil samples in order to assess PCB concentrations at depths of 0 to 3 inches at selected locations on the school grounds. This Work Plan includes descriptions of the following:

- Objectives
- Rationale for selection of sampling locations
- Field sampling procedures and description
- Laboratory analytical procedures

The activities described in this plan will be conducted in accordance with project-wide and area specific planning documents. These planning documents include the following:

- Project Field Sampling Plan
- Project Quality Assurance Project Plan and Addendum (QAPP)
- Project Health and Safety Plan (HASP)
- Site Specific Health and Safety Plan

## Objectives

The main objective of the proposed sampling is to assess PCB concentrations in surficial soils on portions of the Allendale School grounds remediated by GE in 1999.

## **Rationale for Selection of Sampling Locations**

Figure 1 depicts the final limits of the 1999 remediation. Figure 2 depicts the approximate locations of the nineteen proposed soil sample locations on the Allendale School property. Sample locations were selected to provide broad coverage of the remediated portions of the Allendale School playground. Final sample locations will be selected by EPA at the time of sampling.

## **Field Sampling and Analytical Procedures**

Soil sampling will be conducted using dedicated disposable and certified pre-cleaned plastic scoops and bowls. At each location, a disposable scoop will be used to collect an aliquot of soil from 0 to 3 inches below grade. The soil will be placed into a disposable bowl, homogenized, and placed into a certified pre-cleaned 4 ounce amber sample jar for submission to the laboratory. Following collection, each sample location will be marked with a 2" x 2" flush to grade wooden hub stake and surveyed by a licensed surveyor.

All soil samples will be analyzed at the EPA New England Regional Laboratory for PCBs in accordance with EPA Method 8082 with a reporting limit of 0.1 parts per million (ppm). QA/QC samples will be obtained in accordance with the requirements outlined in the project QAPP and Addendum and will consist of one field duplicate and one matrix spike/matrix spike duplicate.

Weston will prepare a final report summarizing sample results which will include a figure depicting final sample locations.

## **Schedule**

Sampling will be initiated as soon as practical. The sampling is expected to be completed in one work day.

Rev.	Date	Description
A	11/28/05	FINAL

Designed by:	DT	Checked by:	RJ	Reviewed by:	TC	Submitted by:	Chief, Arch. Section
Date:	11-28-05	Design file no.:		SPEC. No.:		File name:	11-28-05
DEPARTMENT OF THE ARMY CORPS OF ENGINEERS CONCORD, MASSACHUSETTS				WESTON ENGINEERS			

ALLENDALE SCHOOL SURFICIAL SAMPLING  
ENVIRONMENTAL REMEDIATION CONTRACT (SSERC)  
GE/AOUSATONIC RIVER SITE  
PITTSFIELD, MASSACHUSETTS  
ALLENDALE SCHOOL FINAL EXCAVATION  
DEPTHS AND REMOVAL LIMITS

Sheet  
reference  
number:  
**FIG. 1**

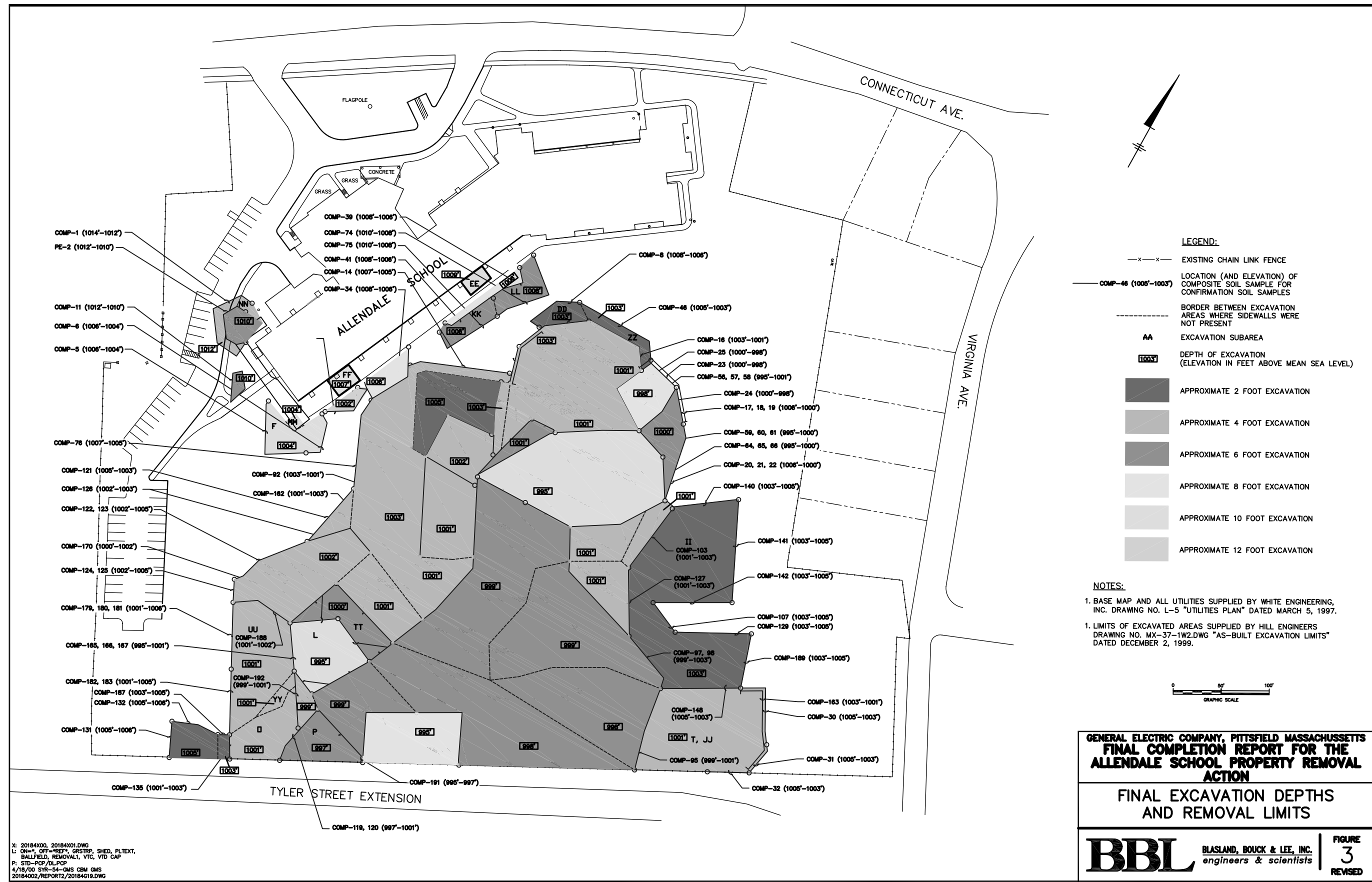

**LEGEND:**

- x-x- EXISTING CHAIN LINK FENCE
- COMP-46 (1005'-1003') LOCATION (AND ELEVATION) OF COMPOSITE SOIL SAMPLE FOR CONFIRMATION SOIL SAMPLES
- BORDER BETWEEN EXCAVATION AREAS WHERE SIDEWALLS WERE NOT PRESENT
- AA EXCAVATION SUBAREA
- [1003'] DEPTH OF EXCAVATION (ELEVATION IN FEET ABOVE MEAN SEA LEVEL)
- [Dark Gray Box] APPROXIMATE 2 FOOT EXCAVATION
- [Medium Gray Box] APPROXIMATE 4 FOOT EXCAVATION
- [Light Gray Box] APPROXIMATE 6 FOOT EXCAVATION
- [Very Light Gray Box] APPROXIMATE 8 FOOT EXCAVATION
- [White Box] APPROXIMATE 10 FOOT EXCAVATION
- [Lightest Gray Box] APPROXIMATE 12 FOOT EXCAVATION

**NOTES:**

- BASE MAP AND ALL UTILITIES SUPPLIED BY WHITE ENGINEERING, INC. DRAWING NO. L-5 "UTILITIES PLAN" DATED MARCH 5, 1997.
- LIMITS OF EXCAVATED AREAS SUPPLIED BY HILL ENGINEERS DRAWING NO. MX-37-1W2.DWG "AS-BUILT EXCAVATION LIMITS" DATED DECEMBER 2, 1999.

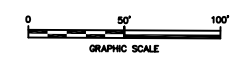

**GENERAL ELECTRIC COMPANY, PITTSFIELD MASSACHUSETTS  
FINAL COMPLETION REPORT FOR THE  
ALLENDALE SCHOOL PROPERTY REMOVAL  
ACTION**

**FINAL EXCAVATION DEPTHS  
AND REMOVAL LIMITS**

**BBL** BLASLAND, BOUCK & LEE, INC. | **FIGURE 3**  
engineers & scientists | **REVISED**

X: 20184X00, 20184X01.DWG  
L: ON=\*, OFF=REF\*, GRSTRP, SHED, PLTEXT,  
BALLFIELD, REMOVAL1, VTC, VTD CAP  
P: STD-PCP/DLPCP  
4/18/00 SYR-54-GMS CBM GMS  
20184002/REPORT2/20184619.DWG

