



GE
159 Plastics Avenue
Pittsfield, MA 01201
USA

Transmitted Via Overnight Delivery

May 9, 2008

Mr. Dean Tagliaferro
EPA Project Coordinator
U.S. Environmental Protection Agency, Region I
c/o Weston Solutions, Inc.
10 Lyman Street, Suite 2
Pittsfield, MA 01201

**Re: GE-Pittsfield/Housatonic River Site
Allendale School Property (GEC500)
Vegetative Planting Plan**

Dear Mr. Tagliaferro:

This letter is being provided to document my recent discussions with Mr. Richard Hull of EPA regarding the vegetative restoration of the area within which the General Electric Company (GE) performed supplemental soil removal activities at the Allendale School Property, as summarized in GE's March 18, 2008 *Supplemental Soil Removal Report*. As discussed with Mr. Hull and depicted on the attached figure, GE has agreed to undertake the following vegetative restoration activities:

- Plant a row of 12 shrubs at a spacing of approximately 5 feet on center along the western boundary of the supplemental soil removal area;
- Plant five clusters of four shrubs each (twenty shrubs total) at the specified locations within the supplemental soil removal area; and,
- Each row/cluster of shrubs will consist of 50% red osier dogwoods shrubs and 50% silky dogwood shrubs, with each shrub being a minimum of three feet in height.

Please call me with any questions or comments regarding this planting plan.

Sincerely,

A handwritten signature in cursive script that reads "Richard W. Gates" followed by a stylized initial "RWA".

Richard W. Gates
Remediation Project Manager

Attachment

cc: Holly Inglis, EPA
John Kilborn, EPA
Richard Hull, EPA
Rose Howell, EPA*
Susan Steenstrup, MDEP
Anna Symington, MDEP*
Jane Rothchild, MDEP
Linda Palmieri, Weston (2 copies)
Mayor James Ruberto, City of Pittsfield
Pittsfield Commissioner of Public Health
Dr. Philip Adamo, Board of Health Chairman
Morgan Williams, Principal, Allendale School
Tom Hickey, PEDAs
Michael Carroll, GE*
Rod McLaren, GE*
Andrew Silfer, GE*
James Nuss, ARCADIS
James Bieke, Goodwin Procter LLP
K.C. Mitkevicius, USACE
Chris Ferry, ASRC
Public Information Repositories
GE Internal Repository

** cover letter only*

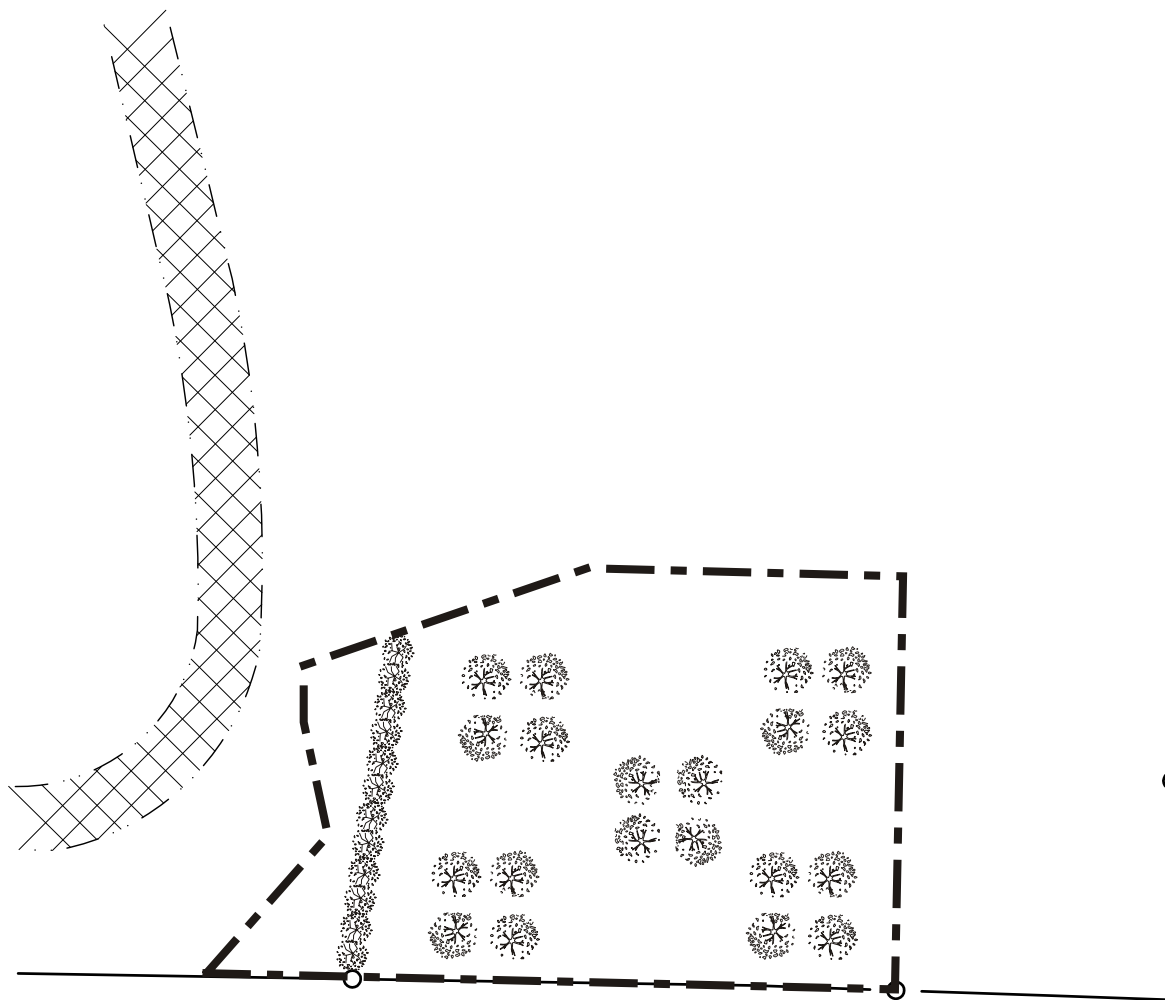

PROPOSED PLANTING PLAN

 5 CLUSTERS OF (4) SHRUBS

 1 ROW OF (12) SHRUBS ~5' ON CENTER

EACH ROW/CLUSTER OF SHRUBS TO BE 50% RED OSIER DOGWOOD AND 50% SILKY DOGWOOD EACH SHRUB WILL BE A MIN. OF 3 FT. IN HEIGHT

LEGEND:

 LIMITS OF PREVIOUS REMEDIATION

 FENCE

 TRACK

0 40

GRAPHIC SCALE:

NOTES:

1. AS BUILT CONDITIONS SHOWN AT ALLENDALE SCHOOL ARE AS OF NOVEMBER 11, 1999.
2. HORIZONTAL AND VERTICAL CONTROL SUPPLIED BY BLASLAND, BOUCK AND LEE.
3. RESTORATION PLAN PROVIDED BY WHITE ENGINEERING, INC. PLAN ENTITLED "SITE RESTORATION PLAN AT ALLENDALE SCHOOL" AND DATED 6-14-99.
4. PRE-1950 CONTOURS BASED ON UNTITLED AND UNDATED TOPOGRAPHIC MAPPING OF ALLENDALE SCHOOL PROPERTY. EXISTING AND FINISH 1951 CONTOURS BASED ON GRADING PLAN DATED 5/9/51, DRAWN BY S.W. HAYNES & ASSOCIATES.

REFERENCE: FIGURE BASED ON DRAWING C-102 PREPARED BY WESTON SOLUTIONS, INC. FOR EPA DATED 10/2/07.

GENERAL ELECTRIC COMPANY
 PITTSFIELD, MASSACHUSETTS

ALLENDALE SCHOOL PROPERTY

**VEGETATIVE PLANTING PLAN FOR
 SUPPLEMENTAL SOIL REMOVAL AREA**



FIGURE

1