



GE-Hausatonic  
2.2  
159245

*Evaluation of NAPL  
Recovery at Newell Street  
Area II (Part of Plant Site  
1 Groundwater  
Management Area)*

General Electric Company  
Pittsfield, Massachusetts

January 2001



Corporate Environmental Programs  
General Electric Company  
100 Woodlawn Avenue, Pittsfield, MA 01201

*Transmitted via Federal Express*

January 12, 2001

Ms. J. Lyn Cutler  
Section Chief, Special Projects  
Bureau of Waste Site Cleanup  
Department of Environmental Protection  
436 Dwight Street  
Springfield, Massachusetts 01103

Mr. Bryan Olson  
EPA Project Coordinator  
Office of Remediation and Restoration  
United States Environmental Protection Agency  
EPA New England  
One Congress Street, Suite 1100  
Boston, Massachusetts 02114-2023

**Re: GE-Pittsfield/Housatonic River Site  
Plant Site 1 Groundwater Management Area (Site Number GECD310)  
Evaluation of NAPL Recovery at Newell Street Area II**

Dear Ms. Cutler and Mr. Olson:

Enclosed is a report entitled *Evaluation of NAPL Recovery at Newell Street Area II (Part of Plant Site 1 Groundwater Management Area)*, prepared by Blasland, Bouck & Lee, Inc., on behalf of the General Electric Company. This document presents the results of Fall 2000 groundwater monitoring and NAPL recovery activities conducted at Newell Street Area II. Under the Consent Decree (CD) for the GE-Pittsfield/Housatonic River Site, this area has now become part of the Plant Site 1 Groundwater Management Area (GMA 1). In September 2000, GE submitted to EPA a *Baseline Monitoring Program Proposal for Plant Site 1 Groundwater Management Area* pursuant to the CD. Following EPA's approval of that proposal, future reports on groundwater monitoring and NAPL recovery activities at Newell Street Area II will be incorporated into the overall semi-annual NAPL monitoring reports to be submitted by GE for GMA 1.

Should you have any questions, please do not hesitate to call me at (413) 494-3177.

Sincerely,

John F. Novotny  
Manager - Facility and Brownfields Programs

NS/meg

Encl.

U:\MEG-01\141199 WPD

cc: R. Bell, Esq., DEP\*  
A. Weinberg, DEP\*  
S. Keydel, DEP\*  
M. Nalipinski, EPA\*  
T. Conway, Esq., EPA\*  
H. Inglis, EPA\*  
D. Tagliaferro, EPA\*  
K.C. Mitkevicius, USACE\*  
D. Veilleux, Weston\*  
J. Bieke, Esq., Shea & Gardner\*  
Mayor G.S. Doyle

M. Carroll, GE  
A. Silber, GE  
A. Thomas, Esq., GE\*  
J. Nuss, BBL\*  
Public Information Repositories\*  
GE Internal Repositories\*

\*w/enclosure

REPORT

---

*Evaluation of NAPL  
Recovery at Newell Street  
Area II (Part of Plant Site  
1 Groundwater  
Management Area)*

General Electric Company  
Pittsfield, Massachusetts

January 2001



6723 Towpath Road, P.O. Box 66  
Syracuse, New York, 13214-0066  
(315) 446-9120

# ***Table of Contents***

---

<b>Section 1.</b>	<b>Introduction .....</b>	<b>1-1</b>
<b>Section 2.</b>	<b>Background .....</b>	<b>2-1</b>
<b>Section 3.</b>	<b>Fall 2000 NAPL Monitoring and Recovery .....</b>	<b>3-1</b>
	3.1 General .....	3-1
	3.2 DNAPL Monitoring and Recovery .....	3-1
	3.2.1 DNAPL Monitoring .....	3-1
	3.2.2 DNAPL Recovery .....	3-1
	3.3 LNAPL Monitoring and Recovery .....	3-2
<b>Section 4.</b>	<b>Summary and Future Activities .....</b>	<b>4-1</b>
	4.1 Summary of Fall 2000 NAPL Monitoring and Recovery .....	4-1
	4.2 Future Activities .....	4-1

## **References**

## **Tables**

- Table 1- Groundwater Elevation and NAPL Thickness Data - Fall 2000
- Table 2 - Automated DNAPL Recovery Data - Fall 2000
- Table 3 - DNAPL Recovery Data - Fall 2000
- Table 4 - LNAPL Recovery Data - Fall 2000

## **Figures**

- Figure 1- Site Plan
- Figure 2- Extent of NAPL and Top of Till Elevation

## **Appendices**

- Appendix A -Summary of Automated DNAPL Recovery - Fall 2000
- Appendix B -Summary of Manual DNAPL Recovery - Fall 2000

# **1. Introduction**

---

This document describes and summarizes the results of non-aqueous-phase liquid (NAPL) monitoring and recovery conducted by the General Electric Company (GE) between July and December 2000 at the area in Pittsfield, Massachusetts designated as Newell Street Area II. In a letter dated March 17, 1999, the United States Environmental Protection Agency (EPA) requested that GE submit, within six months of the initiation of operation of a dense non-aqueous-phase liquid (DNAPL) recovery system at well N2SC-01I, and at six-month intervals thereafter, a report summarizing and evaluating the NAPL monitoring and recovery systems at Newell Street Area II. Active recovery at well N2SC-01I began on July 15, 1999, GE's initial summary report was submitted to EPA on January 14, 2000, and a second summary report was submitted to EPA on July 14, 2000 (covering the time period from January through June 2000). This document represents the third summary report and covers the time period of July through December 2000 (Fall 2000).

On October 27, 2000, a Consent Decree (CD) executed in 1999 by GE, EPA, Massachusetts Department of Environmental Protection (MDEP), and several other government entities was entered by the United States District Court for the District of Massachusetts. The CD governs (among other things) the performance of response actions to address polychlorinated biphenyls (PCBs) and other hazardous constituents in soils, sediment, and groundwater in several areas at and near Pittsfield that collectively comprise the GE-Pittsfield/Housatonic River Site, including Newell Street Area II.

Upon entry of the CD, Newell Street Area II became part of the Plant Site 1 Groundwater Management Area (GMA 1), as described in the *Statement of Work for Removal Actions Outside the River (SOW)*, which is Appendix E to the CD. In September 2000, GE had submitted to EPA a *Baseline Monitoring Program Proposal for Plant Site 1 Groundwater Management Area (GMA 1 Baseline Monitoring Proposal)*, which proposed the baseline groundwater monitoring activities to be conducted by GE at GMA 1 pursuant to the CD. That document also proposed certain modifications to the ongoing NAPL monitoring program for Newell Street Area II, as well as the NAPL monitoring programs at other areas within GMA 1. In addition, at EPA's suggestion, it proposed to consolidate the various annual and semi-annual NAPL monitoring reports (including the semi-annual Newell Street Area II NAPL monitoring/recovery summary report) into a single document to be submitted on a semi-annual basis for GMA 1. Since GE's GMA 1 Baseline Monitoring Proposal has not to date been approved by EPA, GE is submitting this NAPL monitoring/recovery summary report for Newell Street Area II separately, as previously required. Once the GMA 1 Baseline Monitoring Proposal has been approved, future reports on NAPL monitoring/recovery efforts at

---

Newell Street Area II will be included in the overall semi-annual NAPL monitoring reports for GMA 1, and further modifications, if any, to this NAPL monitoring program will be proposed in those reports.

## ***2. Background***

---

Newell Street Area II measures approximately 8 acres in size and is generally bounded by the Housatonic River to the north, Newell Street and residential property to the south, Sackett Street to the west, and a series of commercial/industrial and recreational properties, designated as Newell Street Area I, to the east. Approximately 3 acres of this area is composed of the GE-owned Newell Street Parking Lot, which is paved. The remaining GE-owned portions of this area are wooded. The non-GE-owned portions of this area consist of an undeveloped right-of-way for high tension electrical transmission lines, and undeveloped private, non-residential property. This area also includes former depression areas which were isolated from the adjacent Housatonic River in the early 1940s as part of rechannelization efforts performed by the City of Pittsfield, in conjunction with the United States Army Corps of Engineers. These areas are designated as Former Oxbow Areas F and G.

The nature, presence, and extent of light non-aqueous phase liquid (LNAPL) and DNAPL have been assessed during several past investigations, involving the installation of numerous soil borings and monitoring wells. Figure 1 provides a site plan and well location map, while Figure 2 shows those monitoring locations where LNAPL and DNAPL were observed at Newell Street Area II between July and December 2000.

Since March 1, 1999, GE has operated an automated DNAPL recovery system (System 1) involving wells NS-15, NS-30, and NS-32. Since July 15, 1999, GE has operated a second automated DNAPL recovery system (System 2) involving well N2SC-01I. Additional wells were connected into System 2 on June 30, 2000 (wells N2SC-02 and N2SC-03I) and on July 10, 2000 (well N2SC-14). DNAPL from these seven wells is recovered via automated pneumatic pumps and contained in either 55-gallon drums or 1,000-gallon steel tanks until it is transported for off-site disposal.

In addition to operating the automated DNAPL recovery systems, GE monitors wells NS-10 and NS-33 for LNAPL on a weekly basis and 30 other wells for DNAPL on a weekly, monthly, or quarterly basis. LNAPL accumulations greater than 0.25 feet in thickness and DNAPL accumulations greater than 0.5 feet in thickness are manually removed from the wells, as appropriate. Since 1998, approximately 2.9 gallons of LNAPL and over 25,000 gallons of DNAPL have been removed from this area as part of automated and manual recovery activities.

In GE's NAPL monitoring/recovery summary report for January-June 2000, GE proposed the installation of two new wells (N2SC-16 and N2SC-17) to further obtain additional information on till configuration and extent of DNAPL. EPA approved that proposal via letter on July 26, 2000, and GE completed the installation of these wells in August

---

2000. The monitoring wells were developed in early September 2000 and added to the ongoing weekly NAPL monitoring program. Following the observation of DNAPL in well N2SC-16 on September 18, 2000, the monitoring frequency in these two new wells was increased to approximately three times per week. On October 9, 2000, GE submitted a report to EPA which summarized the installation, development, and initial monitoring results for wells N2SC-16 and N2SC-17. This report was approved by EPA via letter to GE dated November 2, 2000.



## **3. Fall 2000 NAPL Monitoring and Recovery**

### **3.1 General**

This section provides a summary of the NAPL monitoring activities conducted by GE in Fall 2000, as well as an overview of active and manual NAPL recovery operations. Section 3.2 discusses DNAPL monitoring and recovery activities at several wells within Newell Street Area II. These wells are generally screened directly above a till layer, which acts as a confining layer to vertical migration of DNAPL. Top of till elevation contours are presented on Figure 2. In addition, some wells are screened to intercept shallower DNAPL which has been observed at portions of this area, typically associated with intermediate peat deposits. Additional graphics illustrating DNAPL recovery during Fall 2000 are presented in the Appendices. Section 3.3 discusses LNAPL monitoring and recovery activities at Newell Street Area II, which are generally limited to certain wells located along the southern portion of the area.

### **3.2 DNAPL Monitoring and Recovery**

#### **3.2.1 DNAPL Monitoring**

In addition to operating the automated DNAPL recovery systems, GE monitors 30 wells within Newell Street Area II for groundwater elevation and the presence of DNAPL on a weekly, monthly, or quarterly basis. The monitoring results for Fall 2000 are summarized in Table 1. DNAPL was observed at eight monitoring wells and seven recovery wells between July and December 2000 (see Figure 2). Maximum DNAPL thicknesses during this monitoring period ranged between approximately 0.1 feet and 0.8 feet at those monitoring wells where DNAPL was observed during one or more monitoring events (MW-1S, MW-1D, N2SC-03S, N2SC-08, N2SC-09S, N2SC-09I, N2SC-13I, and N2SC-16). DNAPL is also present in seven DNAPL recovery wells (NS-15, NS-30, NS-32, N2SC-01I, N2SC-02, N2SC-03I, and N2SC-14). However, due to the presence and operation of DNAPL removal pumps, DNAPL thickness data were not obtained from these wells during Fall 2000, with the exception of well N2SC-14, where a DNAPL thickness of 2.75 feet was measured on July 3, 2000 (prior to installation of the DNAPL removal pump).

#### **3.2.2 DNAPL Recovery**

GE has operated an automated DNAPL recovery system (System 1) within wells NS-15, NS-30, and NS-32 since March of 1999, and a second automated system (System 2) at wells N2SC-01I (since July of 1999), N2SC-02 and N2SC-03I (since June 30, 2000), and N2SC-14 (since July 10, 2000).

---

A monthly summary of DNAPL recovery volumes is presented in Table 2, and illustrated graphically in Appendix A. A total of approximately 264 gallons of DNAPL were recovered from System 1 during Fall 2000, while approximately 7,376 gallons were removed from System 2. These recovery volumes are somewhat different than those obtained during the prior six-month period between January and June 2000, when approximately 312 gallons of DNAPL were removed by System 1 and 4,734 gallons were removed by System 2. The decrease in DNAPL recovery in System 1 during this monitoring period may be attributed to several contributing factors, including possible decreases in DNAPL thickness and continuity and the saturation and permeability of the material around the recovery wells. The increase in DNAPL recovery noted in System 2 during this monitoring period is likely related to the addition of wells N2SC-02, N2SC-03I, and N2SC-14 to System 2.

As explained previously, in addition to operating the automated DNAPL recovery systems, GE monitors 30 wells for DNAPL on a weekly, monthly, or quarterly basis, and DNAPL accumulations greater than 0.5 feet in thickness are manually removed from the wells. Table 3 summarizes the results of the manual DNAPL recovery operations at individual locations for Fall 2000. Over three gallons of DNAPL were manually removed from a total of five wells during this period. The majority of this DNAPL was recovered from wells N2SC-08 (approximately 0.8 gallons) and N2SC-14 (1.8 gallons). Well N2SC-14 was added to the automated DNAPL removal program in early July 2000, as previously discussed. Small quantities of DNAPL were manually recovered from wells MW-1S (0.4 gallons), N2SC-09I (0.1 gallons), and N2SC-16 (0.3 gallons). A summary of DNAPL thicknesses and removal volumes from these five wells is contained in Appendix B.

Overall, approximately 7,380 gallons of DNAPL were removed from this area as part of active and manual recovery activities during Fall 2000. Since 1998, over 25,000 gallons of DNAPL have been recovered from this area.

### **3.3 LNAPL Monitoring and Recovery**

As explained previously, GE monitors NS-10 and NS-33 for LNAPL on a weekly basis. The Fall 2000 monitoring data for these wells are presented in Table 4. LNAPL was observed at well NS-10 during each monitoring event during Fall 2000, and was not observed at well NS-33.

---

Small quantities of LNAPL (between 0.06 and 0.24 gallons) were recovered from monitoring well NS-10 on seven occasions during Fall 2000. A total of approximately one gallon of LNAPL was removed from this well. Since 1998, approximately three gallons of LNAPL have been recovered from Newell Street Area II.

## **4. Summary and Future Activities**

### **4.1 Summary of Fall 2000 NAPL Monitoring and Recovery**

GE has conducted several activities between July and December 2000 to address the occurrence of NAPL at Newell Street Area II. These activities include the operation of active DNAPL recovery systems, performance of manual NAPL monitoring and removal, and the installation of additional monitoring wells and active recovery systems. These efforts are summarized below:

1. Two automated DNAPL recovery systems are currently in operation and incorporate DNAPL removal from seven well locations (wells NS-15, NS-30, NS-32, N2SC-01I, N2SC-02, N2SC-03I, and N2SC-14).
2. A total of 30 wells were monitored for the presence of DNAPL on a regular basis during Fall 2000. DNAPL was observed in 15 of these wells during this monitoring period.
3. Two new monitoring wells (N2SC-16 and N2SC-17) were installed and added to the DNAPL monitoring program.
4. Approximately 7,380 gallons of DNAPL were recovered from during Fall 2000 as part of automated and manual recovery operations.
5. Approximately one gallon of LNAPL was recovered during Fall 2000. The extent of LNAPL was limited to one monitoring well (NS-10).

### **4.2 Future Activities**

Several modifications to the ongoing NAPL monitoring program in this area have been recently proposed in the GMA 1 Baseline Monitoring Proposal, submitted to EPA in September 2000. These modifications will be implemented following EPA approval of that Proposal. In addition, as discussed in Section 1, following EPA's approval of the GMA 1 Baseline Monitoring Proposal, future reports and evaluations regarding NAPL monitoring/recovery activities at Newell Street Area II will be included in the overall semi-annual monitoring reports to be submitted by GE for GMA 1. Each of these semi-annual reports will include the same general type of information that has previously been

---

provided in the various NAPL reports on specific areas within GMA 1 (including Newell Street Area II), such as written, tabular, and illustrative summaries of field activities, monitoring results, and NAPL recovery volumes, as well as proposals for any program modifications. In addition, the semi-annual reports will also serve as the forum for proposing future characterization activities for known/suspected NAPL areas, assessments of ongoing recovery systems and/or programs, and proposals to optimize NAPL recovery operations, as appropriate.

## References

---

- Blasland, Bouck & Lee, Inc., *Evaluation of NAPL Recovery at Newell Street Area II (Part of Plant Site 1 Groundwater Management Area)* (Syracuse, NY: July 2000).
- Blasland, Bouck & Lee, Inc., *Baseline Monitoring Program Proposal for Plant Site 1 Groundwater Management Area* (Syracuse, NY: September 2000).
- Blasland, Bouck & Lee, Inc., *Field Sampling Plan/Quality Assurance Project Plan* (Syracuse, NY: September 2000).
- General Electric Company, *DNAPL Recovery Data and Evaluation at Newell Street Area II - Plant Site 1 Groundwater Management Area* (Pittsfield, MA: letter report to USEPA dated January 14, 2000).
- General Electric Company, *DNAPL Investigation at Newell Street Area II - Plant Site 1 Groundwater Management Area* (Pittsfield, MA: letter to USEPA dated March 15, 2000).
- General Electric Company, *Newell Street Area II (DEP #1-1057; USEPA Area 5B); Proposal for Additional DNAPL Recovery Operations* (Pittsfield, MA: letter to USEPA dated March 30, 2000).
- General Electric Company, *Additional DNAPL Investigation at Newell Street Area II - Plant Site 1 Groundwater Management Area* (Pittsfield, MA: letter to USEPA dated May 19, 2000).
- General Electric Company, *GE-Pittsfield/Housatonic River Site; Plant Site 1 Groundwater Management Area (GECD310); Additional DNAPL Investigation at Newell Street Area II* (Pittsfield, MA: letter to USEPA dated June 5, 2000).
- General Electric Company, *Results of Monitoring Well Installation - Newell Street Area II* (Pittsfield, MA: letter to USEPA dated October 9, 2000).
- United States Environmental Protection Agency, Conditional Approval of GE's January 14, 2000 submittal entitled *DNAPL Recovery Data and Evaluation at Newell Street II Area - Plant Site 1 Groundwater Management Area; GE-Pittsfield/Housatonic River* (Boston, MA: letter to GE dated February 29, 2000).
- United States Environmental Protection Agency, Conditional Approval of GE's March 15, 2000 submittal regarding *DNAPL Investigation at the Newell Street II Site/GMA 1; GE-Pittsfield/Housatonic River* (Boston, MA: letter to GE dated March 27, 2000).
- United States Environmental Protection Agency, Conditional Approval of GE's March 30, 2000 submittal entitled *Newell Street II (DEP #1-1057; USEPA Area 5B) Proposal for Additional DNAPL Recovery Options GE-Pittsfield/Housatonic River Site* (Boston, MA: letter to GE dated April 5, 2000).
- United States Environmental Protection Agency, Conditional Approval of GE's May 19 and June 5, 2000 submittals regarding *Additional DNAPL Investigation at the Newell Street II Site/GMA 1; GE-Pittsfield/Housatonic River* (Boston, MA: letter to GE dated June 16, 2000).

## References

---

United States Environmental Protection Agency, Conditional Approval of GE's July 14, 2000 submittal entitled *Evaluation of NAPL Recovery at the Newell Street Area II (Part of Plant Site 1 Groundwater Management Area); GE-Pittsfield/Housatonic River* (Boston, MA: letter to GE dated July 26, 2000).

United States Environmental Protection Agency, Conditional Approval of GE's October 9, 2000 submittal entitled *Plant Site 1 Groundwater Management Area, Results of Monitoring Well Installation - Newell Street Area II; GE-Pittsfield/Housatonic River* (Boston, MA: letter to GE dated November 2, 2000).

# **Tables**

BLASLAND, BOUCK & LEE, INC.  
*engineers & scientists*

---



TABLE 1

GENERAL ELECTRIC COMPANY  
PITTSFIELD, MASSACHUSETTS

## NEWELL STREET AREA II

GROUNDWATER ELEVATION AND NAPL THICKNESS DATA - FALL 2000

Well ID	Date	Meas. Pt. Elevation (Feet AMSL)	Depth to Water (Feet below MP)	Depth to NAPL (Feet below MP)	NAPL Type	NAPL Thickness (Feet)	Groundwater Elevation (Feet AMSL)
MW-1S	7/3/00	986.60	13.46	24.85	DNAPL	0.42	973.14
MW-1S	7/10/00	986.60	13.87	24.81	DNAPL	0.46	972.73
MW-1S	7/17/00	986.60	12.42	24.70	DNAPL	0.57	974.18
MW-1S	7/24/00	986.60	14.09	25.18	DNAPL	0.09	972.51
MW-1S	7/31/00	986.60	13.55	25.06	DNAPL	0.21	973.05
MW-1S	8/7/00	986.60	13.72	25.00	DNAPL	0.28	972.88
MW-1S	8/14/00	986.60	12.93	25.09	DNAPL	0.18	973.67
MW-1S	8/21/00	986.60	13.64	24.97	DNAPL	0.30	972.96
MW-1S	8/28/00	986.60	14.05	24.94	DNAPL	0.33	972.55
MW-1S	9/5/00	986.60	13.34	24.90	DNAPL	0.37	973.26
MW-1S	9/11/00	986.60	14.22	24.89	DNAPL	0.38	972.38
MW-1S	9/18/00	986.60	13.49	24.88	DNAPL	0.39	973.11
MW-1S	9/25/00	986.60	13.97	24.90	DNAPL	0.37	972.63
MW-1S	10/2/00	986.60	14.33	24.85	DNAPL	0.40	972.27
MW-1S	10/9/00	986.60	13.93	24.80	DNAPL	0.45	972.67
MW-1S	10/17/00	986.60	14.31	24.65	DNAPL	0.62	972.29
MW-1S	10/23/00	986.60	14.02	24.90	DNAPL	0.36	972.58
MW-1S	10/30/00	986.60	14.19	24.78	DNAPL	0.49	972.41
MW-1S	11/6/00	986.60	14.41	24.70	DNAPL	0.56	972.19
MW-1S	11/13/00	986.60	14.11	25.10	DNAPL	0.17	972.49
MW-1S	11/20/00	986.60	14.30	25.01	DNAPL	0.26	972.30
MW-1S	11/27/00	986.60	14.33	24.95	DNAPL	0.32	972.27
MW-1S	12/4/00	986.60	14.50	24.98	DNAPL	0.24	972.10
MW-1S	12/11/00	986.60	14.37	24.84	DNAPL	0.44	972.23
MW-1S	12/18/00	986.60	11.21	24.75	DNAPL	0.53	975.39
MW-1S	12/26/00	986.60	13.73	25.12	DNAPL	0.15	972.87
MW-1D	7/3/00	987.20	14.03	—	None	0.00	973.17
MW-1D	7/10/00	987.20	14.40	39.12	DNAPL	0.26	972.80
MW-1D	7/17/00	987.20	12.94	39.02	DNAPL	0.36	974.26
MW-1D	7/24/00	987.20	14.51	39.25	DNAPL	0.13	972.69
MW-1D	7/31/00	987.20	14.10	39.14	DNAPL	0.24	973.10
MW-1D	8/7/00	987.20	14.29	39.36	DNAPL	0.01	972.91
MW-1D	8/14/00	987.20	18.41	39.04	DNAPL	0.34	968.79
MW-1D	8/21/00	987.20	14.21	39.19	DNAPL	0.19	972.99
MW-1D	8/28/00	987.20	14.61	39.02	DNAPL	0.36	972.59
MW-1D	9/5/00	987.20	13.86	39.04	DNAPL	0.34	973.34
MW-1D	9/11/00	987.20	14.72	38.95	DNAPL	0.42	972.48
MW-1D	9/18/00	987.20	13.98	38.92	DNAPL	0.44	973.22
MW-1D	9/25/00	987.20	14.48	38.98	DNAPL	0.39	972.72
MW-1D	10/2/00	987.20	14.84	39.05	DNAPL	0.32	972.36
MW-1D	10/9/00	987.20	14.44	39.02	DNAPL	0.35	972.76
MW-1D	10/17/00	987.20	14.81	38.99	DNAPL	0.35	972.39
MW-1D	10/23/00	987.20	14.54	39.04	DNAPL	0.32	972.66
MW-1D	10/30/00	987.20	14.72	—	None	0.00	972.48
MW-1D	11/6/00	987.20	14.93	38.95	DNAPL	0.40	972.27
MW-1D	11/13/00	987.20	14.63	39.02	DNAPL	0.34	972.57
MW-1D	11/20/00	987.20	14.81	38.89	DNAPL	0.47	972.39
MW-1D	11/27/00	987.20	14.75	38.90	DNAPL	0.45	972.45
MW-1D	12/4/00	987.20	15.02	38.97	DNAPL	0.39	972.18
MW-1D	12/11/00	987.20	14.88	38.91	DNAPL	0.44	972.32
MW-1D	12/18/00	987.20	11.71	38.90	DNAPL	0.46	975.49
MW-1D	12/26/00	987.20	14.26	39.00	DNAPL	0.35	972.94

TABLE 1

GENERAL ELECTRIC COMPANY  
PITTSFIELD, MASSACHUSETTS

## NEWELL STREET AREA II

## GROUNDWATER ELEVATION AND NAPL THICKNESS DATA - FALL 2000

Well ID	Date	Meas. Pt. Elevation (Feet AMSL)	Depth to Water (Feet below MP)	Depth to NAPL (Feet below MP)	NAPL Type	NAPL Thickness (Feet)	Groundwater Elevation (Feet AMSL)
NS-1	9/18/00	983.40	10.92	---	None	0.00	972.48
NS-1	12/4/00	983.40	11.76	---	None	0.00	971.64
NS-9	9/18/00	982.46	10.04	---	None	0.00	972.42
NS-9	12/4/00	982.46	10.95	---	None	0.00	971.51
NS-10	7/3/00	984.59	9.65	8.99	LNAPL	0.66	975.55
NS-10	7/10/00	984.59	9.60	9.56	LNAPL	0.04	975.03
NS-10	7/17/00	984.59	9.03	9.20	LNAPL	0.17	975.72
NS-10	7/24/00	984.59	10.08	9.88	LNAPL	0.20	974.70
NS-10	7/31/00	984.59	9.91	9.54	LNAPL	0.37	975.02
NS-10	8/7/00	984.59	9.7	9.54	LNAPL	0.16	975.04
NS-10	8/14/00	984.59	9.32	9.09	LNAPL	0.23	975.48
NS-10	8/21/00	984.59	9.61	9.46	LNAPL	0.15	975.12
NS-10	8/28/00	984.59	10.05	9.85	LNAPL	0.20	974.73
NS-10	9/5/00	984.59	9.53	9.32	LNAPL	0.21	975.26
NS-10	9/11/00	984.59	10.15	9.99	LNAPL	0.16	974.59
NS-10	9/18/00	984.59	9.72	9.5	LNAPL	0.22	975.07
NS-10	9/25/00	984.59	10.35	9.98	LNAPL	0.37	974.58
NS-10	10/2/00	984.59	10.51	10.37	LNAPL	0.14	974.21
NS-10	10/9/00	984.59	10.22	10.04	LNAPL	0.18	974.54
NS-10	10/17/00	984.59	10.65	10.49	LNAPL	0.16	974.09
NS-10	10/23/00	984.59	12.40	12.18	LNAPL	0.22	972.39
NS-10	10/30/00	984.59	10.84	10.47	LNAPL	0.37	974.09
NS-10	11/6/00	984.59	10.99	10.67	LNAPL	0.32	973.90
NS-10	11/13/00	984.59	10.49	10.28	LNAPL	0.21	974.30
NS-10	11/20/00	984.59	10.68	10.44	LNAPL	0.24	974.13
NS-10	11/27/00	984.59	10.79	10.59	LNAPL	0.20	973.99
NS-10	12/4/00	984.59	10.89	10.75	LNAPL	0.14	973.83
NS-10	12/11/00	984.59	11.35	10.88	LNAPL	0.47	973.68
NS-10	12/18/00	984.59	9.82	9.46	LNAPL	0.36	975.10
NS-10	12/26/00	984.59	9.70	9.57	LNAPL	0.13	975.01
NS-11	9/18/00	984.80	7.47	Obstructed @ 7.6'	None	0.00	977.33
NS-11	12/4/00	984.80	Obstructed @ 7.6'	---	None	0.00	NA
NS-16	9/18/00	984.46	9.67	---	None	0.00	974.79
NS-16	12/4/00	984.46	10.78	---	None	0.00	973.68
NS-17	9/18/00	984.64	13.18	---	None	0.00	971.46
NS-17	12/4/00	984.64	13.04	---	None	0.00	971.60
NS-18	9/18/00	985.20	9.79	---	None	0.00	975.41
NS-18	12/4/00	985.20	11.03	---	None	0.00	974.17
NS-19	9/18/00	985.72	10.67	---	None	0.00	975.05
NS-19	12/4/00	985.72	11.89	---	None	0.00	973.83
NS-20	9/18/00	985.29	6.24	---	None	0.00	979.05
NS-20	12/4/00	985.29	7.35	---	None	0.00	977.94
NS-21	9/18/00	983.39	10.79	---	None	0.00	972.60
NS-21	12/4/00	983.39	11.72	---	None	0.00	971.67
NS-23	9/18/00	987.42	11.51	---	None	0.00	975.91
NS-23	12/4/00	987.42	12.14	---	None	0.00	975.28
NS-31	7/3/00	986.05	13.88	---	None	0.00	972.17
NS-31	7/10/00	986.05	14.16	---	None	0.00	971.89
NS-31	7/17/00	986.05	12.58	---	None	0.00	973.47
NS-31	7/24/00	986.05	14.29	---	None	0.00	971.76
NS-31	7/31/00	986.05	13.64	---	None	0.00	972.41
NS-31	8/7/00	986.05	13.96	---	None	0.00	972.09

TABLE 1

GENERAL ELECTRIC COMPANY  
PITTSFIELD, MASSACHUSETTS

## NEWELL STREET AREA II

## GROUNDWATER ELEVATION AND NAPL THICKNESS DATA - FALL 2000

Well ID	Date	Meas. Pt. Elevation (Feet AMSL)	Depth to Water (Feet below MP)	Depth to NAPL (Feet below MP)	NAPL Type	NAPL Thickness (Feet)	Groundwater Elevation (Feet AMSL)
NS-31	8/14/00	986.05	13.04	---	None	0.00	973.01
NS-31	8/21/00	986.05	13.93	---	None	0.00	972.12
NS-31	8/28/00	986.05	14.31	---	None	0.00	971.74
NS-31	9/5/00	986.05	13.51	---	None	0.00	972.54
NS-31	9/11/00	986.05	14.38	---	None	0.00	971.67
NS-31	9/18/00	986.05	13.64	---	None	0.00	972.41
NS-31	9/25/00	986.05	14.04	---	None	0.00	972.01
NS-31	10/2/00	986.05	14.41	---	None	0.00	971.64
NS-31	10/9/00	986.05	13.93	---	None	0.00	972.12
NS-31	10/17/00	986.05	14.29	---	None	0.00	971.76
NS-31	10/23/00	986.05	14.02	---	None	0.00	972.03
NS-31	10/30/00	986.05	14.16	---	None	0.00	971.89
NS-31	11/6/00	986.05	14.39	---	None	0.00	971.66
NS-31	11/13/00	986.05	14.08	---	None	0.00	971.97
NS-31	11/20/00	986.05	14.27	---	None	0.00	971.78
NS-31	11/27/00	986.05	14.09	---	None	0.00	971.96
NS-31	12/4/00	986.05	14.45	---	None	0.00	971.60
NS-31	12/11/00	986.05	14.25	---	None	0.00	971.80
NS-31	12/18/00	986.05	10.45	---	None	0.00	975.60
NS-31	12/26/00	986.05	13.91	---	None	0.00	972.14
NS-33	7/3/00	987.21	11.36	---	None	0.00	975.85
NS-33	7/10/00	987.21	11.90	---	None	0.00	975.31
NS-33	7/17/00	987.21	11.43	---	None	0.00	975.78
NS-33	7/24/00	987.21	12.14	---	None	0.00	975.07
NS-33	7/31/00	987.21	11.93	---	None	0.00	975.28
NS-33	8/7/00	987.21	11.84	---	None	0.00	975.37
NS-33	8/14/00	987.21	11.48	---	None	0.00	975.73
NS-33	8/21/00	987.21	11.72	---	None	0.00	975.49
NS-33	8/28/00	987.21	12.19	---	None	0.00	975.02
NS-33	9/5/00	987.21	11.66	---	None	0.00	975.55
NS-33	9/11/00	987.21	12.38	---	None	0.00	974.83
NS-33	9/18/00	987.21	11.84	---	None	0.00	975.37
NS-33	9/25/00	987.21	12.34	---	None	0.00	974.87
NS-33	10/2/00	987.21	12.78	---	None	0.00	974.43
NS-33	10/9/00	987.21	12.42	---	None	0.00	974.79
NS-33	10/17/00	987.21	12.91	---	None	0.00	974.30
NS-33	10/23/00	987.21	12.54	---	None	0.00	974.67
NS-33	10/30/00	987.21	12.91	---	None	0.00	974.30
NS-33	11/6/00	987.21	13.14	---	None	0.00	974.07
NS-33	11/13/00	987.21	12.67	---	None	0.00	974.54
NS-33	11/20/00	987.21	12.86	---	None	0.00	974.35
NS-33	11/27/00	987.21	13.12	---	None	0.00	974.09
NS-33	12/4/00	987.21	13.15	---	None	0.00	974.06
NS-33	12/11/00	987.21	13.26	---	None	0.00	973.95
NS-33	12/18/00	987.21	12.05	---	None	0.00	975.16
NS-33	12/26/00	987.21	11.90	---	None	0.00	975.31
NS-34	7/3/00	986.81	14.26	---	None	0.00	972.55
NS-34	7/10/00	986.81	14.58	---	None	0.00	972.23
NS-34	7/17/00	986.81	13.09	---	None	0.00	973.72
NS-34	7/24/00	986.81	14.74	---	None	0.00	972.07
NS-34	7/31/00	986.81	14.16	---	None	0.00	972.65
NS-34	8/7/00	986.81	14.38	---	None	0.00	972.43

TABLE 1

GENERAL ELECTRIC COMPANY  
PITTSFIELD, MASSACHUSETTS

## NEWELL STREET AREA II

GROUNDWATER ELEVATION AND NAPL THICKNESS DATA - FALL 2000

Well ID	Date	Meas. Pt. Elevation (Feet AMSL)	Depth to Water (Feet below MP)	Depth to NAPL (Feet below MP)	NAPL Type	NAPL Thickness (Feet)	Groundwater Elevation (Feet AMSL)
NS-34	8/14/00	986.81	13.51	---	None	0.00	973.30
NS-34	8/21/00	986.81	14.37	---	None	0.00	972.44
NS-34	8/28/00	986.81	14.76	---	None	0.00	972.05
NS-34	9/5/00	986.81	14.00	---	None	0.00	972.81
NS-34	9/11/00	986.81	14.82	---	None	0.00	971.99
NS-34	9/18/00	986.81	14.09	---	None	0.00	972.72
NS-34	9/25/00	986.81	14.53	---	None	0.00	972.28
NS-34	10/2/00	986.81	14.92	---	None	0.00	971.89
NS-34	10/9/00	986.81	14.44	---	None	0.00	972.37
NS-34	10/17/00	986.81	14.83	---	None	0.00	971.98
NS-34	10/23/00	986.81	14.52	---	None	0.00	972.29
NS-34	10/30/00	986.81	14.69	---	None	0.00	972.12
NS-34	11/6/00	986.81	14.92	---	None	0.00	971.89
NS-34	11/13/00	986.81	14.60	---	None	0.00	972.21
NS-34	11/20/00	986.81	14.79	---	None	0.00	972.02
NS-34	11/27/00	986.81	14.66	---	None	0.00	972.15
NS-34	12/4/00	986.81	15.00	---	None	0.00	971.81
NS-34	12/11/00	986.81	14.81	---	None	0.00	972.00
NS-34	12/18/00	986.81	11.35	---	None	0.00	975.46
NS-34	12/26/00	986.81	14.35	---	None	0.00	972.46
NS-35	7/3/00	982.99	10.32	---	None	0.00	972.67
NS-35	7/10/00	982.99	10.69	---	None	0.00	972.30
NS-35	7/17/00	982.99	8.94	---	None	0.00	974.05
NS-35	7/24/00	982.99	10.84	---	None	0.00	972.15
NS-35	7/31/00	982.99	10.23	---	None	0.00	972.76
NS-35	8/7/00	982.99	10.15	---	None	0.00	972.84
NS-35	8/14/00	982.99	9.59	---	None	0.00	973.40
NS-35	8/21/00	982.99	10.14	---	None	0.00	972.85
NS-35	8/28/00	982.99	10.85	---	None	0.00	972.14
NS-35	9/5/00	982.99	10.07	---	None	0.00	972.92
NS-35	9/11/00	982.99	10.98	---	None	0.00	972.01
NS-35	9/18/00	982.99	10.21	---	None	0.00	972.78
NS-35	9/25/00	982.99	10.67	---	None	0.00	972.32
NS-35	10/2/00	982.99	11.03	---	None	0.00	971.96
NS-35	10/9/00	982.99	10.61	---	None	0.00	972.38
NS-35	10/17/00	982.99	10.96	---	None	0.00	972.03
NS-35	10/23/00	982.99	10.72	---	None	0.00	972.27
NS-35	10/30/00	982.99	10.84	---	None	0.00	972.15
NS-35	11/6/00	982.99	11.07	---	None	0.00	971.92
NS-35	11/13/00	982.99	10.75	---	None	0.00	972.24
NS-35	11/20/00	982.99	10.94	---	None	0.00	972.05
NS-35	11/27/00	982.99	10.81	---	None	0.00	972.18
NS-35	12/4/00	982.99	11.15	---	None	0.00	971.84
NS-35	12/11/00	982.99	10.98	---	None	0.00	972.01
NS-35	12/18/00	982.99	7.33	---	None	0.00	975.66
NS-35	12/26/00	982.99	10.46	---	None	0.00	972.53
NS-36	7/3/00	985.20	12.43	---	None	0.00	972.77
NS-36	7/10/00	985.20	12.83	---	None	0.00	972.37
NS-36	7/17/00	985.20	11.42	---	None	0.00	973.78
NS-36	7/24/00	985.20	13.02	---	None	0.00	972.18
NS-36	7/31/00	985.20	12.55	---	None	0.00	972.65
NS-36	8/7/00	985.20	12.65	---	None	0.00	972.55

TABLE 1

GENERAL ELECTRIC COMPANY  
PITTSFIELD, MASSACHUSETTS

## NEWELL STREET AREA II

## GROUNDWATER ELEVATION AND NAPL THICKNESS DATA - FALL 2000

Well ID	Date	Meas. Pt. Elevation (Feet AMSL)	Depth to Water (Feet below MP)	Depth to NAPL (Feet below MP)	NAPL Type	NAPL Thickness (Feet)	Groundwater Elevation (Feet AMSL)
NS-36	8/14/00	985.20	11.68	---	None	0.00	973.52
NS-36	8/21/00	985.20	12.62	---	None	0.00	972.58
NS-36	8/28/00	985.20	12.98	---	None	0.00	972.22
NS-36	9/5/00	985.20	12.23	---	None	0.00	972.97
NS-36	9/11/00	985.20	13.08	---	None	0.00	972.12
NS-36	9/18/00	985.20	12.31	---	None	0.00	972.89
NS-36	9/25/00	985.20	12.89	---	None	0.00	972.31
NS-36	10/2/00	985.20	13.16	---	None	0.00	972.04
NS-36	10/9/00	985.20	12.74	---	None	0.00	972.46
NS-36	10/17/00	985.20	13.13	---	None	0.00	972.07
NS-36	10/23/00	985.20	12.76	---	None	0.00	972.44
NS-36	10/30/00	985.20	12.97	---	None	0.00	972.23
NS-36	11/6/00	985.20	13.19	---	None	0.00	972.01
NS-36	11/13/00	985.20	12.83	---	None	0.00	972.37
NS-36	11/20/00	985.20	13.01	---	None	0.00	972.19
NS-36	11/27/00	985.20	13.07	---	None	0.00	972.13
NS-36	12/4/00	985.20	13.23	---	None	0.00	971.97
NS-36	12/11/00	985.20	13.14	---	None	0.00	972.06
NS-36	12/18/00	985.20	9.71	---	None	0.00	975.49
NS-36	12/26/00	985.20	12.55	---	None	0.00	972.65
NS-37	7/3/00	986.20	14.31	---	None	0.00	971.89
NS-37	7/10/00	986.20	14.52	---	None	0.00	971.68
NS-37	7/17/00	986.20	12.90	---	None	0.00	973.30
NS-37	7/24/00	986.20	14.67	---	None	0.00	971.53
NS-37	7/31/00	986.20	13.86	---	None	0.00	972.34
NS-37	8/7/00	986.20	14.27	---	None	0.00	971.93
NS-37	8/14/00	986.20	13.44	---	None	0.00	972.76
NS-37	8/21/00	986.20	14.42	---	None	0.00	971.78
NS-37	8/28/00	986.20	14.65	---	None	0.00	971.55
NS-37	9/5/00	986.20	13.99	---	None	0.00	972.21
NS-37	9/11/00	986.20	14.68	---	None	0.00	971.52
NS-37	9/18/00	986.20	14.04	---	None	0.00	972.16
NS-37	9/25/00	986.20	14.36	---	None	0.00	971.84
NS-37	10/2/00	986.20	14.70	---	None	0.00	971.50
NS-37	10/9/00	986.20	14.22	---	None	0.00	971.98
NS-37	10/17/00	986.20	14.57	---	None	0.00	971.63
NS-37	10/23/00	986.20	14.31	---	None	0.00	971.89
NS-37	10/30/00	986.20	14.38	---	None	0.00	971.82
NS-37	11/6/00	986.20	14.61	---	None	0.00	971.59
NS-37	11/13/00	986.20	14.36	---	None	0.00	971.84
NS-37	11/20/00	986.20	14.58	---	None	0.00	971.62
NS-37	11/27/00	986.20	14.29	---	None	0.00	971.91
NS-37	12/4/00	986.20	14.77	---	None	0.00	971.43
NS-37	12/11/00	986.20	14.55	---	None	0.00	971.65
NS-37	12/18/00	986.20	10.56	---	None	0.00	975.64
NS-37	12/26/00	986.20	14.29	---	None	0.00	971.91
N2SC-03S	7/3/00	985.18	9.14	---	None	0.00	976.04
N2SC-03S	7/10/00	985.18	9.39	---	None	0.00	975.79
N2SC-03S	7/17/00	985.18	9.15	---	None	0.00	976.03
N2SC-03S	7/24/00	985.18	8.89	---	None	0.00	976.29
N2SC-03S	7/31/00	985.18	9.86	---	None	0.00	975.32
N2SC-03S	8/7/00	985.18	9.85	---	None	0.00	975.33

TABLE 1

GENERAL ELECTRIC COMPANY  
PITTSFIELD, MASSACHUSETTS

## NEWELL STREET AREA II

## GROUNDWATER ELEVATION AND NAPL THICKNESS DATA - FALL 2000

Well ID	Date	Meas. Pt. Elevation (Feet AMSL)	Depth to Water (Feet below MP)	Depth to NAPL (Feet below MP)	NAPL Type	NAPL Thickness (Feet)	Groundwater Elevation (Feet AMSL)
N2SC-03S	8/14/00	985.18	9.47	---	None	0.00	975.71
N2SC-03S	8/21/00	985.18	9.52	---	None	0.00	975.66
N2SC-03S	8/28/00	985.18	9.86	---	None	0.00	975.32
N2SC-03S	9/5/00	985.18	9.89	---	None	0.00	975.29
N2SC-03S	9/11/00	985.18	10.14	---	None	0.00	975.04
N2SC-03S	9/18/00	985.18	9.75	---	None	0.00	975.43
N2SC-03S	9/25/00	985.18	9.89	---	None	0.00	975.29
N2SC-03S	10/2/00	985.18	10.09	---	None	0.00	975.09
N2SC-03S	10/9/00	985.18	10.18	---	None	0.00	975.00
N2SC-03S	10/17/00	985.18	10.49	---	None	0.00	974.69
N2SC-03S	10/23/00	985.18	10.43	---	None	0.00	974.75
N2SC-03S	10/30/00	985.18	10.41	---	None	0.00	974.77
N2SC-03S	11/6/00	985.18	10.64	---	None	0.00	974.54
N2SC-03S	11/13/00	985.18	10.66	---	None	0.00	974.52
N2SC-03S	11/20/00	985.18	10.43	21.44	DNAPL	0.08	974.75
N2SC-03S	11/27/00	985.18	10.45	21.52	DNAPL	0.02	974.73
N2SC-03S	12/4/00	985.18	10.69	21.50	DNAPL	0.01	974.49
N2SC-03S	12/11/00	985.18	10.71	---	None	0.00	974.47
N2SC-03S	12/18/00	985.18	9.16	---	None	0.00	976.02
N2SC-03S	12/26/00	985.18	9.39	---	None	0.00	975.79
N2SC-07	7/3/00	984.61	12.61	---	None	0.00	972.00
N2SC-07	8/7/00	984.61	12.41	---	None	0.00	972.20
N2SC-07	11/6/00	984.61	13.02	---	None	0.00	971.59
N2SC-08	7/3/00	986.07	11.88	---	None	0.00	974.19
N2SC-08	7/10/00	986.07	12.37	42.51	DNAPL	0.08	973.70
N2SC-08	7/17/00	986.07	11.39	42.51	DNAPL	0.08	974.68
N2SC-08	7/24/00	986.07	12.62	41.79	DNAPL	0.80	973.45
N2SC-08	7/31/00	986.07	12.30	---	None	0.00	973.77
N2SC-08	8/7/00	986.07	12.37	---	None	0.00	973.70
N2SC-08	8/14/00	986.07	11.70	41.82	DNAPL	0.47	974.37
N2SC-08	8/21/00	986.07	12.28	---	None	0.00	973.79
N2SC-08	8/28/00	986.07	12.68	---	None	0.00	973.39
N2SC-08	9/5/00	986.07	12.04	41.91	DNAPL	0.68	974.03
N2SC-08	9/11/00	986.07	12.86	42.55	DNAPL	0.02	973.21
N2SC-08	9/18/00	986.07	12.21	42.45	DNAPL	0.12	973.86
N2SC-08	9/25/00	986.07	11.92	41.16	DNAPL	0.40	974.15
N2SC-08	10/2/00	986.07	13.02	42.10	DNAPL	0.77	973.05
N2SC-08	10/9/00	986.07	12.66	42.25	DNAPL	0.22	973.41
N2SC-08	10/17/00	986.07	13.07	42.41	DNAPL	0.20	973.00
N2SC-08	10/23/00	986.07	12.76	42.30	DNAPL	0.27	973.31
N2SC-08	10/30/00	986.07	12.98	41.89	DNAPL	0.69	973.09
N2SC-08	11/6/00	986.07	13.18	42.39	DNAPL	0.18	972.89
N2SC-08	11/13/00	986.07	12.88	42.02	DNAPL	0.56	973.19
N2SC-08	11/20/00	986.07	13.05	42.33	DNAPL	0.24	973.02
N2SC-08	11/27/00	986.07	13.14	42.02	DNAPL	0.55	972.93
N2SC-08	12/4/00	986.07	13.29	42.40	DNAPL	0.19	972.78
N2SC-08	12/11/00	986.07	13.23	42.26	DNAPL	0.34	972.84
N2SC-08	12/18/00	986.07	10.94	41.72	DNAPL	0.75	975.13
N2SC-08	12/26/00	986.07	12.35	42.28	DNAPL	0.28	973.72
N2SC-09S	7/3/00	987.84	10.12	---	None	0.00	977.72
N2SC-09S	7/10/00	987.84	10.58	---	None	0.00	977.26
N2SC-09S	7/17/00	987.84	9.99	---	None	0.00	977.85

TABLE 1

GENERAL ELECTRIC COMPANY  
PITTSFIELD, MASSACHUSETTS

## NEWELL STREET AREA II

GROUNDWATER ELEVATION AND NAPL THICKNESS DATA - FALL 2000

Well ID	Date	Meas. Pt. Elevation (Feet AMSL)	Depth to Water (Feet below MP)	Depth to NAPL (Feet below MP)	NAPL Type	NAPL Thickness (Feet)	Groundwater Elevation (Feet AMSL)
N2SC-09S	7/24/00	987.84	10.84	18.22	DNAPL	0.02	977.00
N2SC-09S	7/31/00	987.84	10.79	—	None	0.00	977.05
N2SC-09S	8/7/00	987.84	10.42	18.11	DNAPL	0.13	977.42
N2SC-09S	8/14/00	987.84	9.84	18.22	DNAPL	0.02	978.00
N2SC-09S	8/21/00	987.84	10.17	—	None	0.00	977.67
N2SC-09S	8/28/00	987.84	10.90	18.10	DNAPL	0.14	976.94
N2SC-09S	9/5/00	987.84	10.61	18.09	DNAPL	0.15	977.23
N2SC-09S	9/11/00	987.84	12.79	18.11	DNAPL	0.13	975.05
N2SC-09S	9/18/00	987.84	10.39	18.20	DNAPL	0.04	977.45
N2SC-09S	9/25/00	987.84	11.20	18.14	DNAPL	0.10	976.64
N2SC-09S	10/2/00	987.84	13.44	—	None	0.00	974.40
N2SC-09S	10/9/00	987.84	12.92	18.10	DNAPL	0.14	974.92
N2SC-09S	10/17/00	987.84	13.89	18.11	DNAPL	0.16	973.95
N2SC-09S	10/23/00	987.84	13.13	18.12	DNAPL	0.12	974.71
N2SC-09S	10/30/00	987.84	13.51	18.03	DNAPL	0.25	974.33
N2SC-09S	11/6/00	987.84	13.98	18.04	DNAPL	0.19	973.86
N2SC-09S	11/13/00	987.84	13.56	18.02	DNAPL	0.22	974.28
N2SC-09S	11/20/00	987.84	13.34	17.99	DNAPL	0.24	974.50
N2SC-09S	11/27/00	987.84	13.64	17.97	DNAPL	0.27	974.20
N2SC-09S	12/4/00	987.84	13.91	18.02	DNAPL	0.23	973.93
N2SC-09S	12/11/00	987.84	14.06	18.00	DNAPL	0.24	973.78
N2SC-09S	12/18/00	987.84	10.07	18.00	DNAPL	0.25	977.77
N2SC-09S	12/26/00	987.84	11.22	17.99	DNAPL	0.24	976.62
N2SC-09I	7/3/00	987.77	13.59	43.11	DNAPL	0.41	974.18
N2SC-09I	7/10/00	987.77	14.07	43.36	DNAPL	0.15	973.70
N2SC-09I	7/17/00	987.77	13.07	—	None	0.00	974.70
N2SC-09I	7/24/00	987.77	14.29	43.09	DNAPL	0.42	973.48
N2SC-09I	7/31/00	987.77	13.98	43.18	DNAPL	0.32	973.79
N2SC-09I	8/7/00	987.77	13.99	43.09	DNAPL	0.43	973.78
N2SC-09I	8/14/00	987.77	13.37	43.09	DNAPL	0.43	974.40
N2SC-09I	8/21/00	987.77	13.90	43.18	DNAPL	0.34	973.87
N2SC-09I	8/28/00	987.77	14.34	43.06	DNAPL	0.46	973.43
N2SC-09I	9/5/00	987.77	13.71	43.05	DNAPL	0.47	974.06
N2SC-09I	9/11/00	987.77	14.54	43.12	DNAPL	0.40	973.23
N2SC-09I	9/18/00	987.77	13.89	42.94	DNAPL	0.58	973.88
N2SC-09I	9/25/00	987.77	14.34	43.44	DNAPL	0.08	973.43
N2SC-09I	10/2/00	987.77	14.69	43.43	DNAPL	0.09	973.08
N2SC-09I	10/9/00	987.77	14.34	—	None	0.00	973.43
N2SC-09I	10/17/00	987.77	14.75	43.35	DNAPL	0.17	973.02
N2SC-09I	10/23/00	987.77	14.46	43.40	DNAPL	0.11	973.31
N2SC-09I	10/30/00	987.77	14.67	43.33	DNAPL	0.17	973.10
N2SC-09I	11/6/00	987.77	14.87	43.31	DNAPL	0.19	972.90
N2SC-09I	11/13/00	987.77	14.59	43.56	DNAPL	0.22	973.18
N2SC-09I	11/20/00	987.77	14.75	43.26	DNAPL	0.30	973.02
N2SC-09I	11/27/00	987.77	14.80	43.25	DNAPL	0.26	972.97
N2SC-09I	12/4/00	987.77	14.97	43.24	DNAPL	0.27	972.80
N2SC-09I	12/11/00	987.77	14.92	43.21	DNAPL	0.30	972.85
N2SC-09I	12/18/00	987.77	12.54	43.19	DNAPL	0.31	975.23
N2SC-09I	12/26/00	987.77	14.05	43.27	DNAPL	0.22	973.72
N2SC-11	7/3/00	988.05	12.25	—	None	0.00	975.80
N2SC-11	8/7/00	988.05	12.73	—	None	0.00	975.32
N2SC-11	11/6/00	988.05	9.70	Obstructed @ 9.89'	None	0.00	978.35

TABLE 1

GENERAL ELECTRIC COMPANY  
PITTSFIELD, MASSACHUSETTS

## NEWELL STREET AREA II

GROUNDWATER ELEVATION AND NAPL THICKNESS DATA - FALL 2000

Well ID	Date	Meas. Pt. Elevation (Feet AMSL)	Depth to Water (Feet below MP)	Depth to NAPL (Feet below MP)	NAPL Type	NAPL Thickness (Feet)	Groundwater Elevation (Feet AMSL)
N2SC-12	7/3/00	988.05	10.28	—	None	0.00	977.77
N2SC-12	8/7/00	987.26	10.87	—	None	0.00	976.39
N2SC-12	11/6/00	987.26	11.52	—	None	0.00	975.74
N2SC-13I	7/3/00	984.75	10.77	40.85	DNAPL	0.16	973.98
N2SC-13I	7/10/00	984.75	11.23	40.67	DNAPL	0.34	973.52
N2SC-13I	7/17/00	984.75	10.18	40.65	DNAPL	0.36	974.57
N2SC-13I	7/24/00	984.75	11.45	40.75	DNAPL	0.26	973.30
N2SC-13I	7/31/00	984.75	11.09	40.96	DNAPL	0.05	973.66
N2SC-13I	8/7/00	984.75	11.14	40.85	DNAPL	0.16	973.61
N2SC-13I	8/14/00	984.75	10.45	40.66	DNAPL	0.35	974.30
N2SC-13I	8/21/00	984.75	11.04	40.99	DNAPL	0.03	973.71
N2SC-13I	8/28/00	984.75	11.49	40.75	DNAPL	0.26	973.26
N2SC-13I	9/5/00	984.75	10.84	40.75	DNAPL	0.26	973.91
N2SC-13I	9/11/00	984.75	11.68	40.80	DNAPL	0.21	973.07
N2SC-13I	9/18/00	984.75	10.96	40.78	DNAPL	0.23	973.79
N2SC-13I	9/25/00	984.75	11.44	40.74	DNAPL	0.27	973.31
N2SC-13I	10/2/00	984.75	11.81	40.80	DNAPL	0.21	972.94
N2SC-13I	10/9/00	984.75	11.45	40.78	DNAPL	0.23	973.30
N2SC-13I	10/17/00	984.75	11.86	40.67	DNAPL	0.36	972.89
N2SC-13I	10/23/00	984.75	11.52	40.80	DNAPL	0.21	973.23
N2SC-13I	10/30/00	984.75	11.76	40.71	DNAPL	0.30	972.99
N2SC-13I	11/6/00	984.75	11.97	40.86	DNAPL	0.15	972.78
N2SC-13I	11/13/00	984.75	11.69	40.84	DNAPL	0.17	973.06
N2SC-13I	11/20/00	984.75	11.84	40.64	DNAPL	0.37	972.91
N2SC-13I	11/27/00	984.75	11.91	40.58	DNAPL	0.43	972.84
N2SC-13I	12/4/00	984.75	12.08	40.68	DNAPL	0.34	972.67
N2SC-13I	12/11/00	984.75	12.00	40.68	DNAPL	0.32	972.75
N2SC-13I	12/18/00	984.75	9.49	40.60	DNAPL	0.42	975.26
N2SC-13I	12/26/00	984.75	11.20	40.73	DNAPL	0.29	973.55
N2SC-13S	7/3/00	983.10	8.28	—	None	0.00	974.82
N2SC-13S	7/10/00	983.10	8.68	—	None	0.00	974.42
N2SC-13S	7/17/00	983.10	8.47	—	None	0.00	974.63
N2SC-13S	7/24/00	983.10	9.28	—	None	0.00	973.82
N2SC-13S	7/31/00	983.10	9.42	—	None	0.00	973.68
N2SC-13S	8/7/00	983.10	9.25	—	None	0.00	973.85
N2SC-13S	8/14/00	983.10	8.87	—	None	0.00	974.23
N2SC-13S	8/21/00	983.10	9.02	—	None	0.00	974.08
N2SC-13S	8/28/00	983.10	9.54	—	None	0.00	973.56
N2SC-13S	9/5/00	983.10	9.14	—	None	0.00	973.96
N2SC-13S	9/11/00	983.10	9.74	—	None	0.00	973.36
N2SC-13S	9/18/00	983.10	9.11	—	None	0.00	973.99
N2SC-13S	9/25/00	983.10	9.66	—	None	0.00	973.44
N2SC-13S	10/2/00	983.10	9.99	—	None	0.00	973.11
N2SC-13S	10/9/00	983.10	8.92	—	None	0.00	974.18
N2SC-13S	10/17/00	983.10	10.16	—	None	0.00	972.94
N2SC-13S	10/23/00	983.10	10.16	—	None	0.00	972.94
N2SC-13S	10/30/00	983.10	10.23	—	None	0.00	972.87
N2SC-13S	11/6/00	983.10	10.46	—	None	0.00	972.64
N2SC-13S	11/13/00	983.10	10.43	—	None	0.00	972.67
N2SC-13S	11/20/00	983.10	10.26	—	None	0.00	972.84
N2SC-13S	11/27/00	983.10	10.38	—	None	0.00	972.72
N2SC-13S	12/4/00	983.10	10.51	—	None	0.00	972.59



TABLE 1

GENERAL ELECTRIC COMPANY  
PITTSFIELD, MASSACHUSETTS

## NEWELL STREET AREA II

## GROUNDWATER ELEVATION AND NAPL THICKNESS DATA - FALL 2000

Well ID	Date	Meas. Pt. Elevation (Feet AMSL)	Depth to Water (Feet below MP)	Depth to NAPL (Feet below MP)	NAPL Type	NAPL Thickness (Feet)	Groundwater Elevation (Feet AMSL)
N2SC-13S	12/11/00	983.10	10.56	---	None	0.00	972.54
N2SC-13S	12/18/00	983.10	9.17	---	None	0.00	973.93
N2SC-13S	12/26/00	983.10	9.60	---	None	0.00	973.50
N2SC-14	7/3/00	983.40	12.67	35.80	DNAPL	2.75	970.73
N2SC-15	7/3/00	985.58	11.31	---	None	0.00	974.27
N2SC-15	7/10/00	985.58	11.95	---	None	0.00	973.63
N2SC-15	7/17/00	985.58	10.93	---	None	0.00	974.65
N2SC-15	7/24/00	985.58	12.14	---	None	0.00	973.44
N2SC-15	7/31/00	985.58	11.84	---	None	0.00	973.74
N2SC-15	8/7/00	985.58	11.90	---	None	0.00	973.68
N2SC-15	8/14/00	985.58	11.19	---	None	0.00	974.39
N2SC-15	8/21/00	985.58	11.79	---	None	0.00	973.79
N2SC-15	8/28/00	985.58	12.19	---	None	0.00	973.39
N2SC-15	9/5/00	985.58	11.56	---	None	0.00	974.02
N2SC-15	9/11/00	985.58	12.37	---	None	0.00	973.21
N2SC-15	9/18/00	985.58	11.68	---	None	0.00	973.90
N2SC-15	9/25/00	985.58	12.18	---	None	0.00	973.40
N2SC-15	10/2/00	985.58	12.56	---	None	0.00	973.02
N2SC-15	10/9/00	985.58	12.21	---	None	0.00	973.37
N2SC-15	10/17/00	985.58	12.31	---	None	0.00	973.27
N2SC-15	10/23/00	985.58	12.31	---	None	0.00	973.27
N2SC-15	10/30/00	985.58	12.52	---	None	0.00	973.06
N2SC-15	11/6/00	985.58	12.70	---	None	0.00	972.88
N2SC-15	11/13/00	985.58	12.40	---	None	0.00	973.18
N2SC-15	11/20/00	985.58	12.58	---	None	0.00	973.00
N2SC-15	11/27/00	985.58	12.65	---	None	0.00	972.93
N2SC-15	12/4/00	985.58	12.82	---	None	0.00	972.76
N2SC-15	12/11/00	985.58	12.77	---	None	0.00	972.81
N2SC-15	12/18/00	985.58	10.35	---	None	0.00	975.23
N2SC-15	12/26/00	985.58	11.91	---	None	0.00	973.67
N2SC-16	9/8/00	985.62	13.22	---	None	0.00	972.40
N2SC-16	9/18/00	985.62	12.70	41.73	DNAPL	0.18	972.92
N2SC-16	9/20/00	985.62	12.91	41.90	DNAPL	0.01	972.71
N2SC-16	9/22/00	985.62	12.99	41.69	DNAPL	0.24	972.63
N2SC-16	9/25/00	985.62	13.17	41.64	DNAPL	0.27	972.45
N2SC-16	9/27/00	985.62	12.25	41.55	DNAPL	0.35	973.37
N2SC-16	9/29/00	985.62	13.37	41.58	DNAPL	0.31	972.25
N2SC-16	10/2/00	985.62	13.54	41.54	DNAPL	0.36	972.08
N2SC-16	10/4/00	985.62	13.51	41.49	DNAPL	0.40	972.11
N2SC-16	10/30/00	985.62	13.31	41.66	DNAPL	0.24	972.31
N2SC-16	11/2/00	985.62	13.47	41.63	DNAPL	0.26	972.15
N2SC-16	11/3/00	985.62	13.48	41.62	DNAPL	0.27	972.14
N2SC-16	11/6/00	985.62	13.54	41.57	DNAPL	0.35	972.08
N2SC-16	11/9/00	985.62	12.84	41.55	DNAPL	0.35	972.78
N2SC-16	11/10/00	985.62	13.24	41.45	DNAPL	0.45	972.38
N2SC-16	11/13/00	985.62	13.23	41.39	DNAPL	0.51	972.39
N2SC-16	11/16/00	985.62	12.88	41.66	DNAPL	0.24	972.74
N2SC-16	11/17/00	985.62	13.07	41.65	DNAPL	0.25	972.55
N2SC-16	11/20/00	985.62	13.43	41.50	DNAPL	0.40	972.19
N2SC-16	11/22/00	985.62	13.46	41.45	DNAPL	0.45	972.16
N2SC-16	11/27/00	985.62	13.26	41.37	DNAPL	0.53	972.36
N2SC-16	12/1/00	985.62	13.38	41.76	DNAPL	0.14	972.24

TABLE 1

GENERAL ELECTRIC COMPANY  
PITTSFIELD, MASSACHUSETTS

## NEWELL STREET AREA II

GROUNDWATER ELEVATION AND NAPL THICKNESS DATA - FALL 2000

Well ID	Date	Meas. Pt. Elevation (Feet AMSL)	Depth to Water (Feet below MP)	Depth to NAPL (Feet below MP)	NAPL Type	NAPL Thickness (Feet)	Groundwater Elevation (Feet AMSL)
N2SC-16	12/4/00	985.62	13.61	41.79	DNAPL	0.09	972.01
N2SC-16	12/7/00	985.62	13.41	41.68	DNAPL	0.20	972.21
N2SC-16	12/8/00	985.62	13.42	41.87	DNAPL	0.03	972.20
N2SC-16	12/11/00	985.62	13.40	41.64	DNAPL	0.25	972.22
N2SC-16	12/14/00	985.62	13.62	41.59	DNAPL	0.31	972.00
N2SC-16	12/15/00	985.62	13.66	41.56	DNAPL	0.35	971.96
N2SC-16	12/18/00	985.62	9.80	41.56	DNAPL	0.34	975.82
N2SC-16	12/20/00	985.62	7.59	41.62	DNAPL	0.27	978.03
N2SC-16	12/21/00	985.62	12.01	41.51	DNAPL	0.38	973.61
N2SC-16	12/26/00	985.62	12.93	41.56	DNAPL	0.34	972.69
N2SC-16	12/28/00	985.62	13.09	41.48	DNAPL	0.41	972.53
N2SC-16	12/29/00	985.62	13.20	41.48	DNAPL	0.41	972.42
N2SC-17	9/11/00	984.73	12.83	---	None	0.00	971.90
N2SC-17	9/18/00	984.73	12.09	---	None	0.00	972.64
N2SC-17	9/25/00	984.73	12.49	---	None	0.00	972.24
N2SC-17	9/27/00	984.73	12.59	---	None	0.00	972.14
N2SC-17	9/29/00	984.73	12.71	---	None	0.00	972.02
N2SC-17	10/2/00	984.73	12.86	---	None	0.00	971.87
N2SC-17	10/4/00	984.73	12.84	---	None	0.00	971.89
N2SC-17	10/30/00	984.73	12.62	---	None	0.00	972.11
N2SC-17	11/2/00	984.73	12.79	---	None	0.00	971.94
N2SC-17	11/3/00	984.73	12.78	---	None	0.00	971.95
N2SC-17	11/6/00	984.73	12.85	---	None	0.00	971.88
N2SC-17	11/9/00	984.73	12.18	---	None	0.00	972.55
N2SC-17	11/10/00	984.73	12.48	---	None	0.00	972.25
N2SC-17	11/13/00	984.73	12.55	---	None	0.00	972.18
N2SC-17	11/16/00	984.73	12.18	---	None	0.00	972.55
N2SC-17	11/17/00	984.73	12.38	---	None	0.00	972.35
N2SC-17	11/20/00	984.73	12.75	---	None	0.00	971.98
N2SC-17	11/22/00	984.73	12.77	---	None	0.00	971.96
N2SC-17	11/27/00	984.73	12.53	---	None	0.00	972.20
N2SC-17	12/1/00	984.73	12.67	---	None	0.00	972.06
N2SC-17	12/4/00	984.73	13.94	---	None	0.00	970.79
N2SC-17	12/7/00	984.73	12.69	---	None	0.00	972.04
N2SC-17	12/8/00	984.73	12.71	---	None	0.00	972.02
N2SC-17	12/11/00	984.73	12.70	---	None	0.00	972.03
N2SC-17	12/14/00	984.73	12.94	---	None	0.00	971.79
N2SC-17	12/15/00	984.73	12.99	---	None	0.00	971.74
N2SC-17	12/18/00	984.73	8.99	---	None	0.00	975.74
N2SC-17	12/20/00	984.73	11.07	---	None	0.00	973.66
N2SC-17	12/21/00	984.73	11.49	---	None	0.00	973.24
N2SC-17	12/26/00	984.73	12.31	---	None	0.00	972.42
N2SC-17	12/28/00	984.73	12.54	---	None	0.00	972.19
N2SC-17	12/29/00	984.73	12.63	---	None	0.00	972.10

## Notes:

- NAPL: Non-Aqueous Phase Liquid  
LNAPL: Light Non-Aqueous Phase Liquid  
DNAPL: Dense Non-Aqueous Phase Liquid
- : No measurable NAPL was observed during the monitoring event.
- NA: Not Applicable.
- AMSL: Above Mean Sea Level
- Water table elevations for wells containing LNAPL were computed as follows:  
Groundwater Elevation = Measuring Point Elevation - Depth to Water + (LNAPL Thickness x Specific Density of LNAPL).  
Specific Density of LNAPL estimated at 0.93.

TABLE 2

GENERAL ELECTRIC COMPANY  
PITTSFIELD, MASSACHUSETTS

NEWELL STREET AREA II

AUTOMATED DNAPL RECOVERY DATA - FALL 2000

Date	Total Gallons Recovered
<b>System 1</b>	
July 2000	28
August 2000	87
September 2000	28.3
October 2000	84.7
November 2000	28
December 2000	7.9
<b>SYSTEM TOTAL</b>	<b>263.9</b>

<b>System 2</b>	
July 2000	583
August 2000	2,770
September 2000	550
October 2000	1,200
November 2000	891
December 2000	1,118
<b>SYSTEM TOTAL</b>	<b>7,112</b>

<b>TOTAL AUTOMATED RECOVERY</b>	<b>7,376</b>
---------------------------------	--------------

Notes:

1. System 1 consists of wells NS-15, NS-30 and NS-32.  
Active recovery in this system was initiated on March 1, 1999.
2. System 2 consists of well N2SC-1I, N2SC-2, N2SC-3I, and N2SC-14.  
Active recovery in this system was initiated on July 15, 1999 at well N2SC-1I; on June 30, 2000 at wells N2SC-2, N2SC-3I, and on July 10, 2000 at well N2SC-14.

TABLE 3

GENERAL ELECTRIC COMPANY  
PITTSFIELD, MASSACHUSETTS

## NEWELL STREET AREA II

## MANUAL DNAPL RECOVERY DATA - FALL 2000

Well ID	Date	Depth to Water	Depth to DNAPL	DNAPL Thickness (Feet)	DNAPL Removed (Liters)	DNAPL Removed (Gallons)
MW-1S	7/17/00	12.42	24.70	0.57	0.34	0.090
MW-1S	10/17/00	14.31	24.65	0.62	0.40	0.106
MW-1S	11/6/00	14.41	24.70	0.56	0.35	0.092
MW-1S	12/18/00	11.21	24.75	0.53	0.33	0.087
MW-1S	TOTAL DNAPL REMOVAL:				1.42	0.375
MW-1D	TOTAL DNAPL REMOVAL:				0.00	0.000
NS-1	TOTAL DNAPL REMOVAL:				0.00	0.000
NS-9	TOTAL DNAPL REMOVAL:				0.00	0.000
NS-11	TOTAL DNAPL REMOVAL:				0.00	0.000
NS-16	TOTAL DNAPL REMOVAL:				0.00	0.000
NS-17	TOTAL DNAPL REMOVAL:				0.00	0.000
NS-18	TOTAL DNAPL REMOVAL:				0.00	0.000
NS-19	TOTAL DNAPL REMOVAL:				0.00	0.000
NS-20	TOTAL DNAPL REMOVAL:				0.00	0.000
NS-21	TOTAL DNAPL REMOVAL:				0.00	0.000
NS-23	TOTAL DNAPL REMOVAL:				0.00	0.000
NS-31	TOTAL DNAPL REMOVAL:				0.00	0.000
NS-34	TOTAL DNAPL REMOVAL:				0.00	0.000
NS-35	TOTAL DNAPL REMOVAL:				0.00	0.000
NS-36	TOTAL DNAPL REMOVAL:				0.00	0.000
NS-37	TOTAL DNAPL REMOVAL:				0.00	0.000
N2SC-03S	TOTAL DNAPL REMOVAL:				0.00	0.000
N2SC-07	TOTAL DNAPL REMOVAL:				0.00	0.000
N2SC-08	7/24/00	12.62	41.79	0.80	0.55	0.145
N2SC-08	8/14/00	11.70	41.82	0.77	0.47	0.124
N2SC-08	9/5/00	12.04	41.91	0.68	0.45	0.119
N2SC-08	10/30/00	12.98	41.89	0.69	0.43	0.114
N2SC-08	11/13/00	12.88	42.02	0.56	0.35	0.092
N2SC-08	11/27/00	13.14	42.02	0.55	0.34	0.090
N2SC-08	12/18/00	10.94	41.72	0.75	0.46	0.122
N2SC-08	TOTAL DNAPL REMOVAL:				3.05	0.806
N2SC-09S	TOTAL DNAPL REMOVAL:				0.00	0.000
N2SC-09I	9/18/00	13.89	42.94	0.58	0.38	0.100
N2SC-09I	TOTAL DNAPL REMOVAL:				0.38	0.100
N2SC-11	TOTAL DNAPL REMOVAL:				0.00	0.000
N2SC-12	TOTAL DNAPL REMOVAL:				0.00	0.000
N2SC-13I	TOTAL DNAPL REMOVAL:				0.00	0.000
N2SC-13S	TOTAL DNAPL REMOVAL:				0.00	0.000
N2SC-14	7/3/00	12.67	35.80	2.75	6.70	1.770
N2SC-14	TOTAL DNAPL REMOVAL:				6.70	1.770
N2SC-15	TOTAL DNAPL REMOVAL:				0.00	0.000
N2SC-16	11/13/00	13.23	41.39	0.51	0.63	0.166
N2SC-16	11/27/00	13.26	41.37	0.53	0.66	0.174
N2SC-16	TOTAL DNAPL REMOVAL:				1.29	0.341
N2SC-17	TOTAL DNAPL REMOVAL:				0.00	0.000

## Notes:

1. DNAPL: Dense Non-Aqueous Phase Liquid

TABLE 4

GENERAL ELECTRIC COMPANY  
PITTSFIELD, MASSACHUSETTS

NEWELL STREET AREA II

MANUAL LNAPL RECOVERY DATA - FALL 2000

Well ID	Date	Depth to Water	Depth to LNAPL	LNAPL Thickness (Feet)	LNAPL Removed (Liters)	LNAPL Removed (Gallons)
NS-10	7/3/00	9.65	8.99	0.66	0.40	0.106
NS-10	7/31/00	9.91	9.54	0.37	0.93	0.244
NS-10	9/25/00	10.35	9.98	0.37	0.85	0.225
NS-10	10/30/00	10.84	10.47	0.37	0.23	0.061
NS-10	11/6/00	10.99	10.67	0.32	0.40	0.104
NS-10	12/11/00	11.35	10.88	0.47	0.58	0.153
NS-10	12/18/00	9.82	9.46	0.36	0.89	0.235
NS-10	TOTAL LNAPL REMOVAL:				4.27	1.128
NS-33	TOTAL LNAPL REMOVAL:				0.00	0.000

Notes:

1. LNAPL: Light Non-Aqueous Phase Liquid

BLASLAND, BOUCK & LEE, INC.  
*engineers & scientists*

---

## ***Figures***

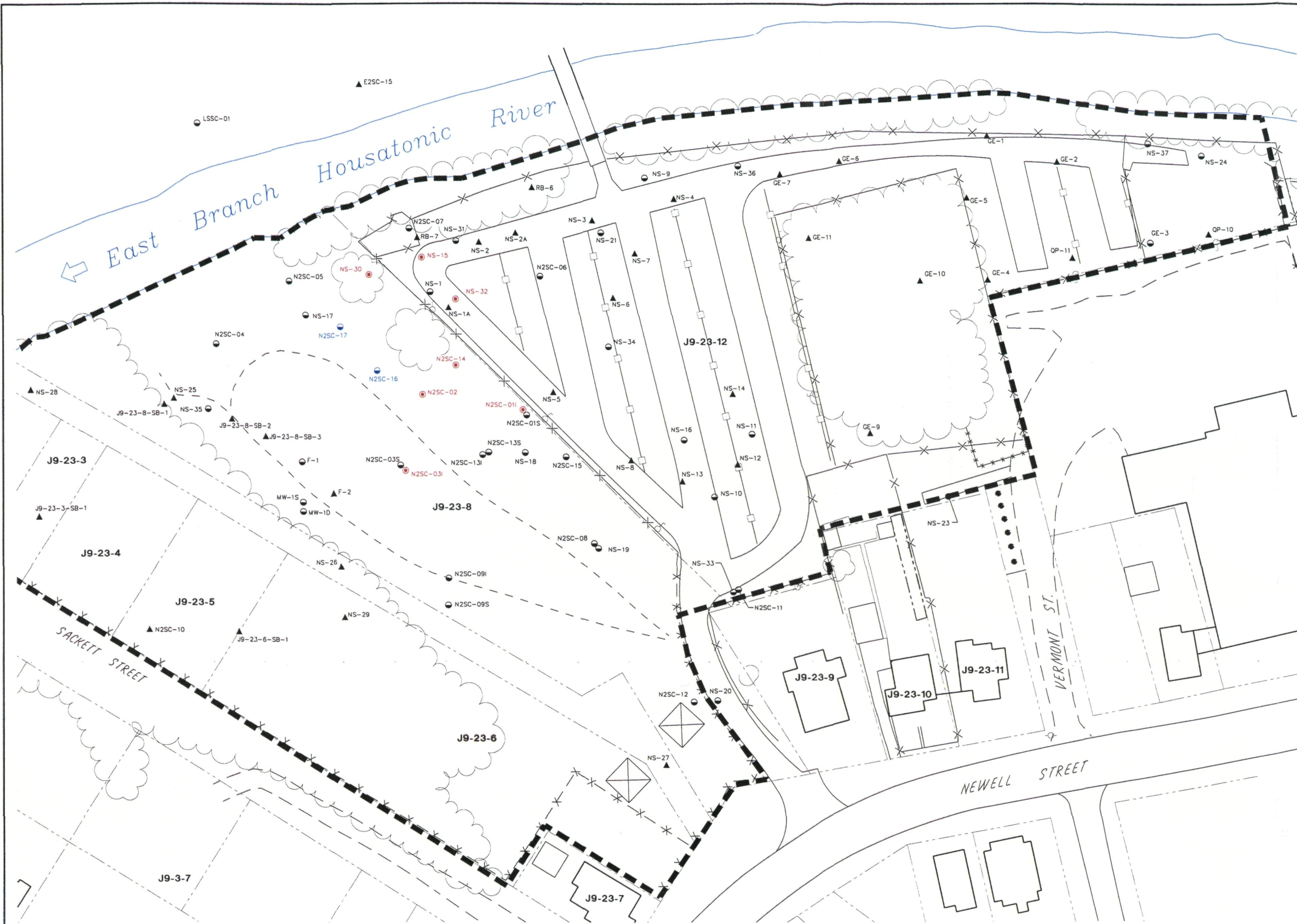

**LEGEND**

- J9-23-12 PARCEL NUMBER
- x-x- APPROXIMATE EXISTING FENCE LOCATION
- - - APPROXIMATE PARCEL BOUNDARY
- - - - - REMOVAL ACTION AREA BOUNDARY
- ▲ NS-2A SOIL BORING LOCATION
- NS-1 MONITORING WELL
- NS-32 ACTIVE NAPL REMOVAL
- NS-16 MONITORING WELL INSTALLED IN AUGUST 2000

- NOTES:**
1. THE BASE MAP FEATURES PRESENTED ON THIS FIGURE WERE PHOTOGRAMMETRICALLY MAPPED FROM APRIL 1990 AERIAL PHOTOGRAPHS.
  2. SAMPLING LOCATIONS HAVE BEEN SURVEYED TO KNOWN PHYSICAL FEATURES BY BLASLAND, BOUCK & LEE, INC. AND HILL ENGINEERS, ARCHITECTS, PLANNERS, INC. SAMPLING LOCATIONS SHOWN ON THIS MAPPING ARE APPROXIMATE. HOWEVER SURVEY DATA ARE AVAILABLE TO IDENTIFY PRECISE SAMPLING LOCATIONS.
  3. LIMITS OF BUILDINGS, PROPERTY BOUNDARIES, AND ROADS ARE APPROXIMATE.

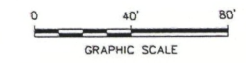

GENERAL ELECTRIC COMPANY  
PITTSFIELD, MASSACHUSETTS  
NEWELL STREET AREA II

**SITE PLAN**

**BBL** BLASLAND, BOUCK & LEE, INC.  
engineers & scientists

FIGURE  
**1**



**LEGEND**

- J9-23-12 PARCEL NUMBER
- x — x — APPROXIMATE EXISTING FENCE LOCATION
- - - - - APPROXIMATE PARCEL BOUNDARY
- - - - - REMOVAL ACTION AREA BOUNDARY
- ▲ NS-2A SOIL BORING LOCATION
- NS-1 MONITORING WELL
- NS-32 ACTIVE NAPL REMOVAL
- DNAPL OBSERVED IN WELL DURING FALL 2000 MONITORING
- LNAPL OBSERVED IN WELL DURING FALL 2000 MONITORING
- 948.1 TOP OF TILL ELEVATION (FEET ABOVE MEAN SEA LEVEL)
- 948 ——— TOP OF TILL ELEVATION CONTOUR (FEET ABOVE MEAN SEA LEVEL), DASHED WHERE INFERRED

- NOTES:**
1. THE BASE MAP FEATURES PRESENTED ON THIS FIGURE WERE PHOTOGRAMMETRICALLY MAPPED FROM APRIL 1990 AERIAL PHOTOGRAPHS.
  2. SAMPLING LOCATIONS HAVE BEEN SURVEYED TO KNOWN PHYSICAL FEATURES BY BLASLAND, BOUCK & LEE, INC. AND HILL ENGINEERS, ARCHITECTS, PLANNERS, INC. SAMPLING LOCATIONS SHOWN ON THIS MAPPING ARE APPROXIMATE. HOWEVER SURVEY DATA ARE AVAILABLE TO IDENTIFY PRECISE SAMPLING LOCATIONS.
  3. LIMITS OF BUILDINGS, PROPERTY BOUNDARIES, AND ROADS ARE APPROXIMATE.

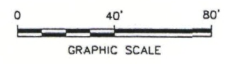

GENERAL ELECTRIC COMPANY  
PITTSFIELD, MASSACHUSETTS  
NEWELL STREET AREA II

**EXTENT OF NAPL AND  
TOP OF TILL ELEVATION**

**BBL** BLASLAND, BOUCK & LEE, INC.  
engineers & scientists

FIGURE  
**2**

X: 20183X01  
P: STD/DL/D2BL  
L: ON= OFF= REF=  
1/9/01 SYR-54-DMW RCA DMW  
20183001/20183T01.DWG



# ***Appendix A***

BLASLAND, BOUCK & LEE, INC.  
*engineers & scientists*

---

## ***Summary of Automated DNAPL Recovery - Fall 2000***

APPENDIX A  
GENERAL ELECTRIC COMPANY - PITTSFIELD, MASSACHUSETTS  
NEWELL STREET AREA II  
SUMMARY OF AUTOMATED DNAPL RECOVERY - FALL 2000  
SYSTEM 1 (WELLS NS-15, NS-30, & NS-32)

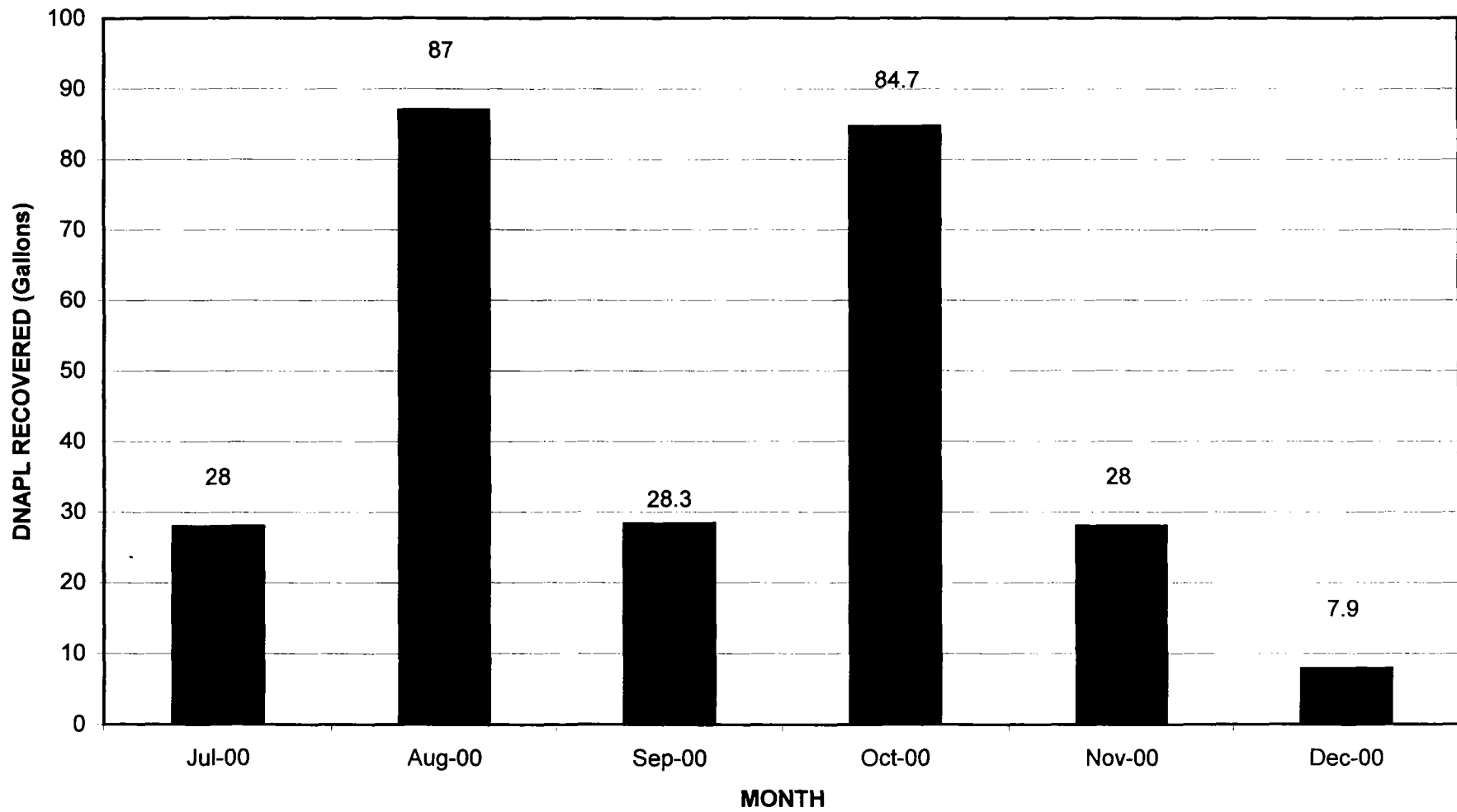

APPENDIX A  
GENERAL ELECTRIC COMPANY - PITTSFIELD, MASSACHUSETTS  
NEWELL STREET AREA II  
SUMMARY OF AUTOMATED DNAPL RECOVERY - FALL 2000  
SYSTEM 2 (WELLS N2SC-01I, N2SC-02, N2SC-03I & N2SC-14 )

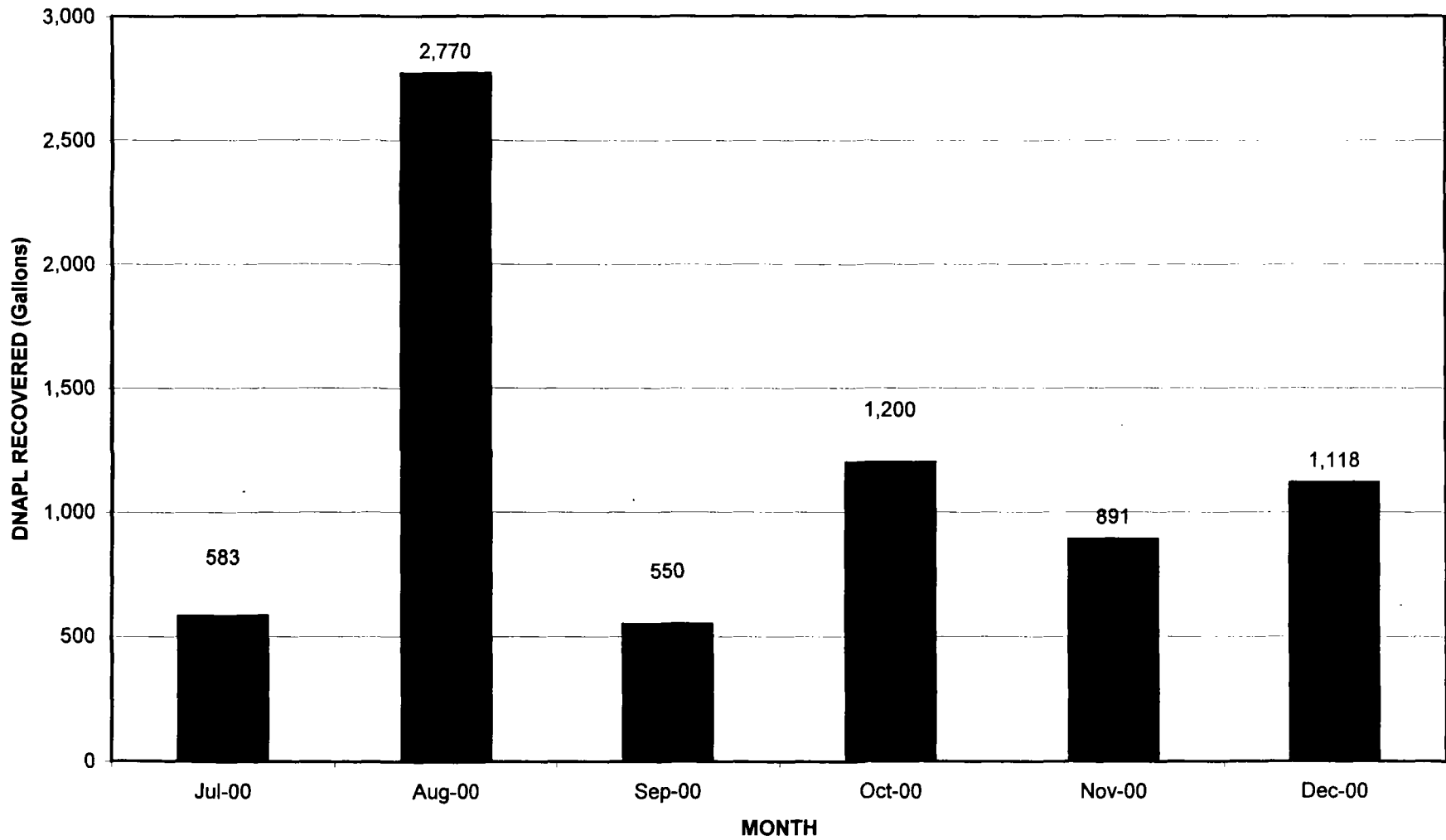

# ***Appendix B***

BLASLAND, BOUCK & LEE, INC.  
*engineers & scientists*

---

## ***Summary of Manual DNAPL Recovery - Fall 2000***

**APPENDIX B  
 GENERAL ELECTRIC COMPANY - PITTSFIELD, MASSACHUSETTS  
 NEWELL STREET AREA II  
 SUMMARY OF MANUAL DNAPL RECOVERY - FALL 2000  
 WELL MW-1(S)**

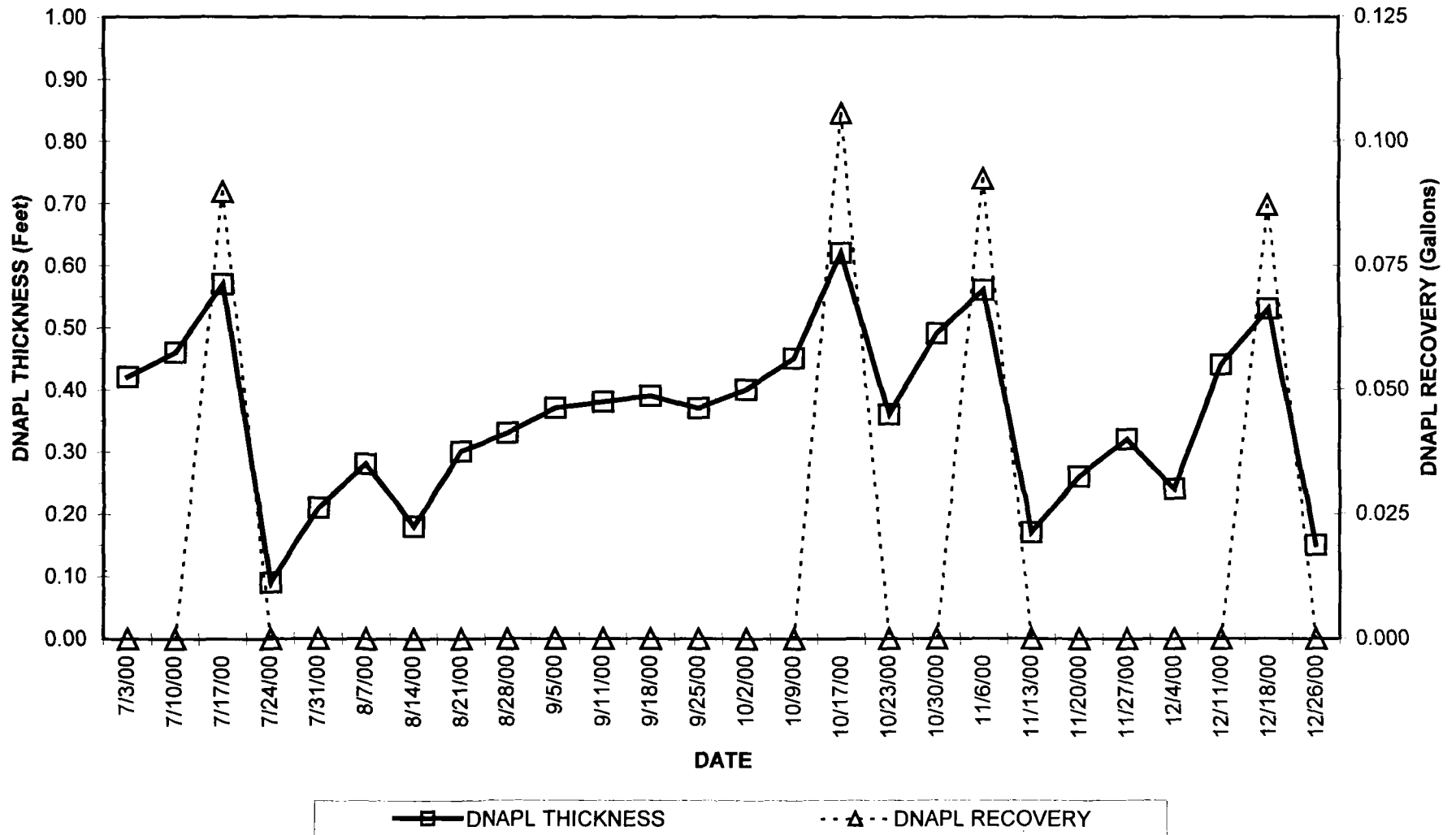

**APPENDIX B**  
**GENERAL ELECTRIC COMPANY - PITTSFIELD, MASSACHUSETTS**  
**NEWELL STREET AREA II**  
**SUMMARY OF MANUAL DNAPL RECOVERY - FALL 2000**  
**WELL N2SC-08**

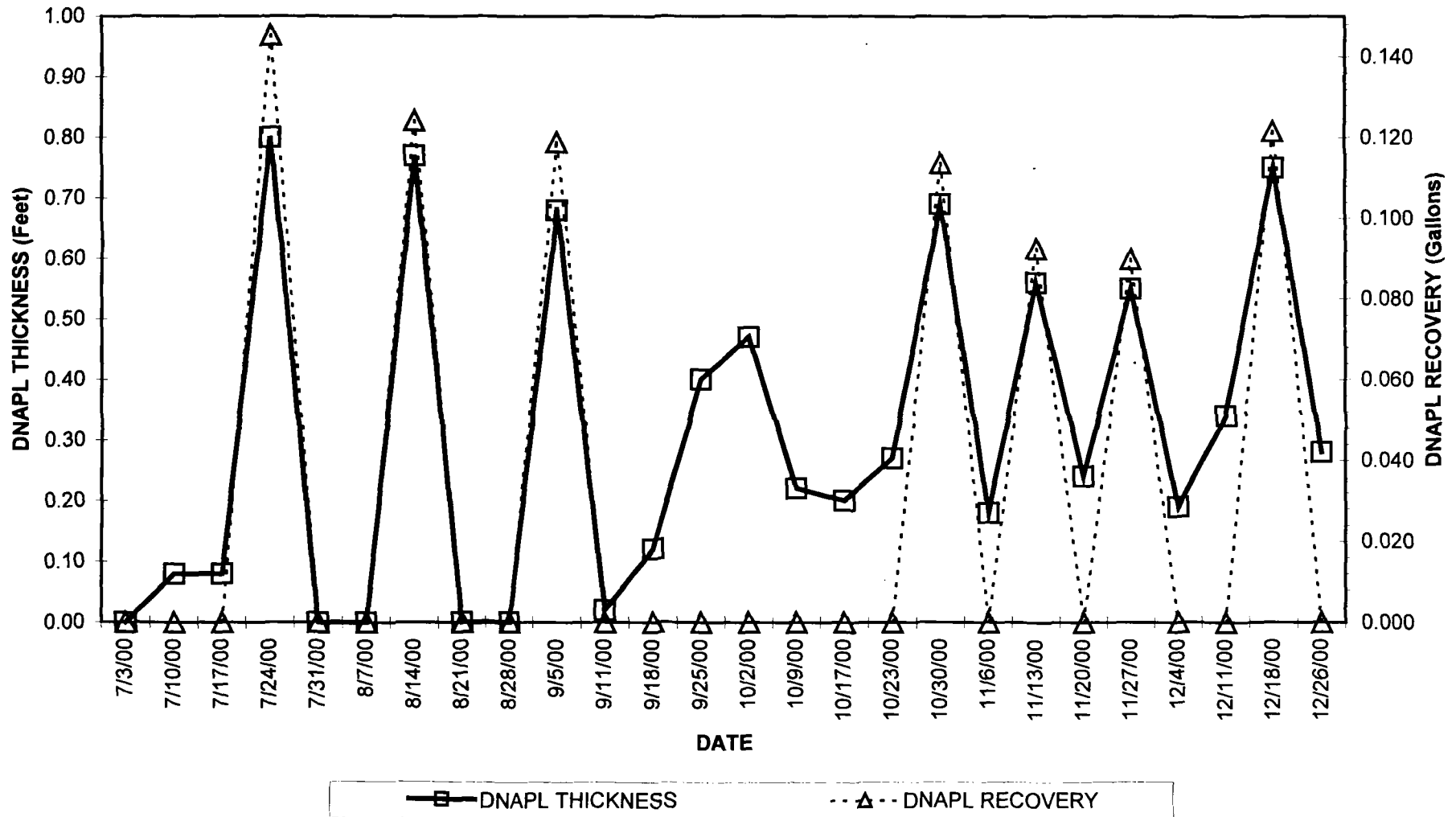

**APPENDIX B  
 GENERAL ELECTRIC COMPANY - PITTSFIELD, MASSACHUSETTS  
 NEWELL STREET AREA II  
 SUMMARY OF MANUAL DNAPL RECOVERY - FALL 2000  
 WELL N2SC-09I**

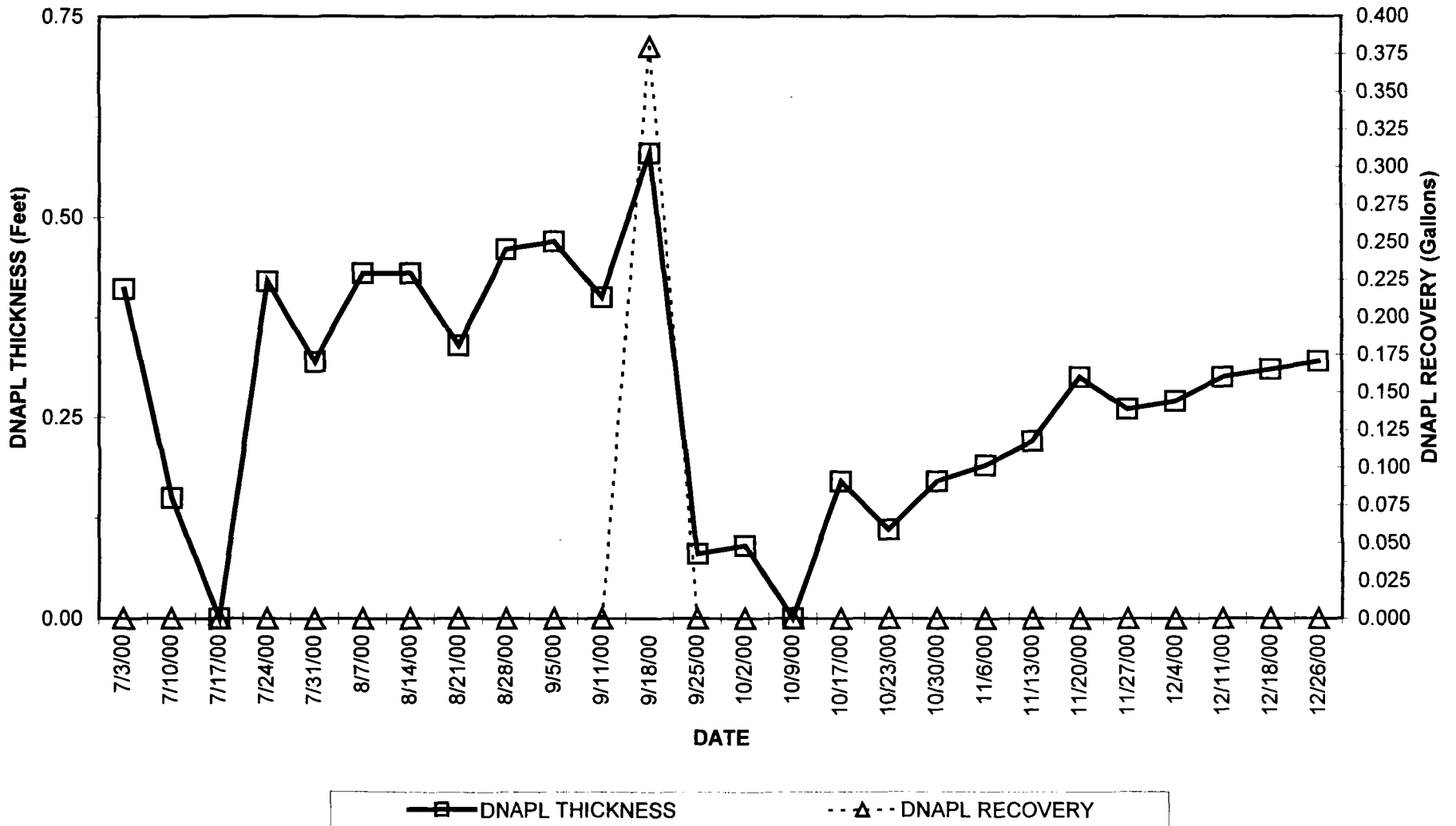

**APPENDIX B**  
**GENERAL ELECTRIC COMPANY - PITTSFIELD, MASSACHUSETTS**  
**NEWELL STREET AREA II**  
**SUMMARY OF MANUAL DNAPL RECOVERY - FALL 2000**  
**WELL N2SC-16**

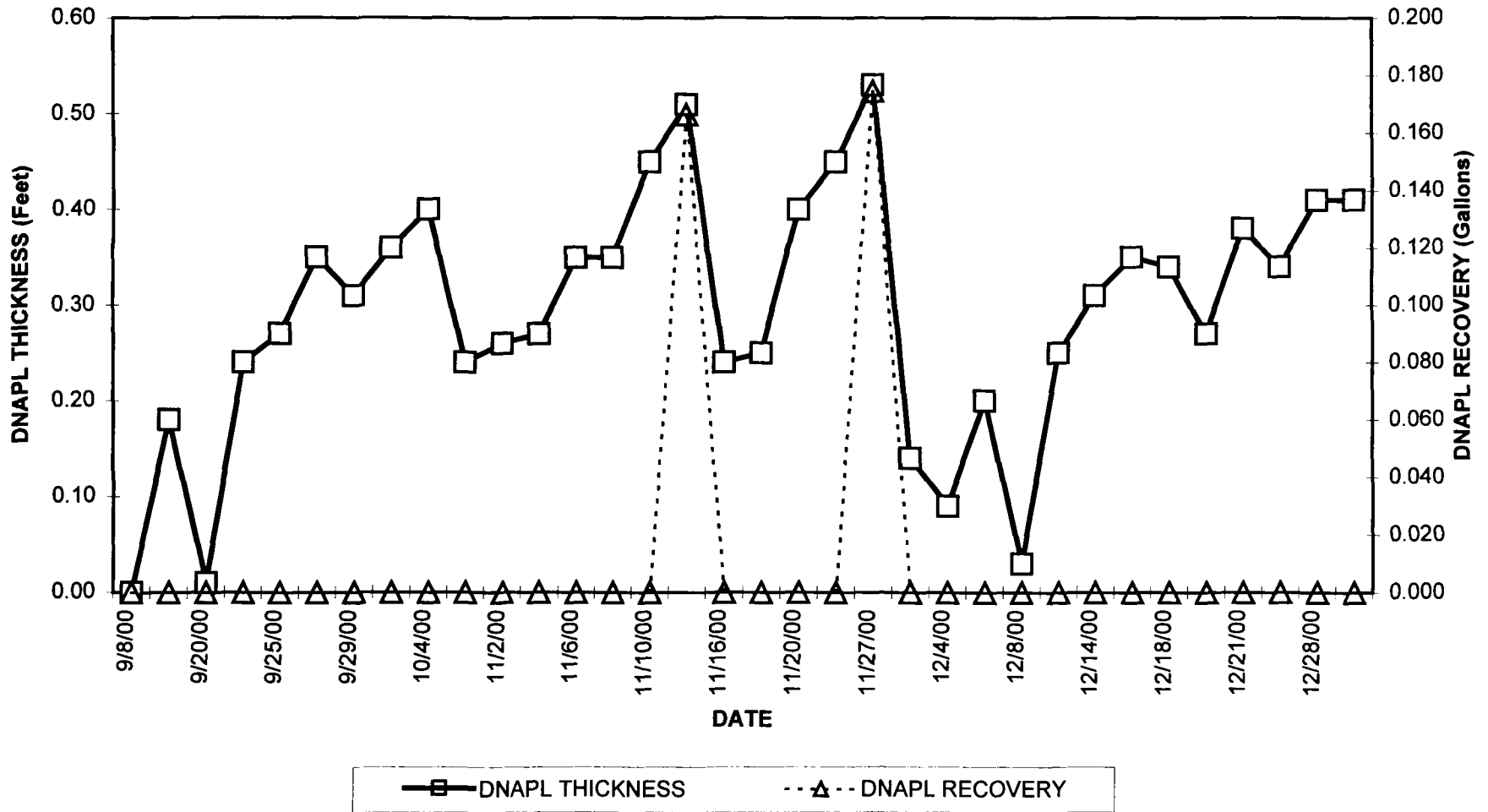



...

