



07-0009

Corporate Environmental Programs
General Electric Company
100 Woodlawn Ave. Pittsfield, MA 01201

SDMS 157090

February 18, 1999

Mr. Bryan Olson
Mr. Dean Tagliaferro
Site Evaluation and Response Section
U.S. Environmental Protection Agency
One Congress Street
Boston, MA 02114-2023

Mr. Alan Weinberg
Bureau of Waste Site Cleanup
Department of Environmental Protection
436 Dwight Street
Springfield, MA 01103

**Re: Source Control Investigation Report
Upper Reach of Housatonic River (First 1/2 Mile)**

Dear Mr. Olson, Mr. Tagliaferro and Mr. Weinberg:

Last week a document entitled *Source Control Investigation Report Upper Reach of Housatonic River (First 1/2 Mile)* was transmitted to you. That document, which was prepared by HSI GeoTrans (on behalf of GE), indicated that DNAPL was present in well N2SC-07, located at the Newell Street Area II site. The document further indicated that GE would begin daily monitoring of that well and remove any DNAPL that was present.

This monitoring, which began on February 8, has not detected the presence of DNAPL in the well. The monitoring has been done utilizing an oil/water interface probe and a bailer. In addition, a peristaltic pump with downhole tubing was utilized in an attempt to remove any potential DNAPL. At this point, only silt with a trace of a sheen has been removed from the well. More than one foot of silt was removed during redevelopment of the well on February 12. Apparently, the earlier indications of DNAPL with the oil/water interface probe were due to the presence of silt at the bottom of the well. Field personnel have also indicated that although the probe previously gave an indication of a separate phase fluid in the bottom of the well, no DNAPL was actually observed on the probe tip.

In light of these additional assessment activities, I have enclosed two figures which are revisions to Figures 3-3 and 3-6 that were contained in the previously referenced report. These revisions indicate that measurable DNAPL is not present in well N2SC-07. In addition, I have enclosed the analytical data sheets from the DNAPL sample that was collected from well LSSC-07, which was installed as part of the source control investigations at the Lyman Street site.

If you have any questions on this matter, feel free to contact me at 413-494-3952.

Messrs. Olson, Tagliaferro and Weinberg
February 18, 1999
Page 2

Yours truly,

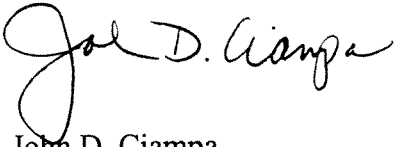

John D. Ciampa
Remediation Project Manager

cc: S. Acree, EPA
R. Bell, Esquire, DEP
G.A. Bibler, Esquire, Goodwin, Procter & Hoar
J.R. Bieke, Esquire, Shea & Gardner
J. Bridge, HSI GeoTrans
R. Child, DEP
S.M. Cooke, Esquire, McDermott, Will & Emery
M. Nalipinski, EPA
J.M. Nuss, Blasland, Bouck & Lee
Pittsfield Conservation Commission
Pittsfield Health Department
A.T. Silber, GE
A.J. Thomas, Esquire, GE
D. Veilleux, Roy F. Weston
J. Ziegler, DEP
Public Information Repositories
ECL I-P-IV(A)(1)

Summary of DNAPL Analyses, Lyman Street Site.

<i>Analysis</i>	<i>Location</i>	<i>Sample Name</i>	<i>Compound</i>	<i>Result</i>	<i>Qual</i>	<i>Units</i>
PCBs	LSSC-07	#A0260	Aroclor 1254	260000		mg/kg
			Total PCBs	260000		mg/kg
VOC	LSSC-07	#A0260	Carbon tetrachloride	78000		mg/kg
			Methylene chloride	3400		mg/kg
			Trichloroethene	20000		mg/kg
			Xylenes (total)	10000		mg/kg
SVOC	LSSC-07	#A0260	1,2,4,5-Tetrachlorobenzene	530	J	mg/kg
			1,2,4-Trichlorobenzene	30000		mg/kg
			1,2-Dichlorobenzene	370	J	mg/kg
			1,4-Dichlorobenzene	520	J	mg/kg
			2-Methylnaphthalene	150	J	mg/kg
Metals	LSSC-07	#A0260	Barium	3.3	B	mg/kg
			Chromium	0.52	B	mg/kg
			Copper	1.3	B	mg/kg
			Lead	7		mg/kg
			Mercury	0.74		mg/kg
			Selenium	0.23	B	mg/kg
			Silver	0.051	B	mg/kg
			Tin	2.6	B	mg/kg
			Zinc	0.96	B	mg/kg
		#A0260 DUP	Antimony	0.13	,	mg/kg
			Barium	3.8	'	mg/kg
			Chromium	0.55		mg/kg
			Copper	1.6		mg/kg

Summary of DNAPL Analyses, Lyman Street Site.

<i>Analysis</i>	<i>Location</i>	<i>Sample Name</i>	<i>Compound</i>	<i>Result</i>	<i>Qual</i>	<i>Units</i>
			Lead	7.8		mg/kg
			Mercury	0.8		mg/kg
			Silver	0.094		mg/kg
			Tin	2.8		mg/kg
			Zinc	0.96		mg/kg

Qualifier

- a Matrix spike percent recovery outside of QC limits. For Dioxins: See narrative.*
- B For organics, compound found in method blank. For metals: Result is between MDL and RL*
- D Compound quantified using a secondary dilution.*
- E Result exceeds calibration range.*
- J For organics, result is between MDL and RL.*

Summary of DNAPL Dioxins and Furans, Lyman Street Site.

<i>Location</i>	<i>Sample Name</i>	<i>Compound</i>	<i>Result</i>	<i>Qual</i>	<i>Units</i>
LSSC-07	A0260	1,2,3,4,6,7,8-HpCDD	0.18		ug/kg
		1,2,3,4,6,7,8-HpCDF	0.34	E	ug/kg
		1,2,3,4,7,8,9-HpCDF	0.26	E	ug/kg
		1,2,3,4,7,8-HxCDD	0.012		ug/kg
		1,2,3,4,7,8-HxCDF	0.77	E	ug/kg
		1,2,3,6,7,8-HxCDD	0.011	s	ug/kg
		1,2,3,6,7,8-HxCDF	0.31	E	ug/kg
		1,2,3,7,8,9-HxCDD	0.0098	s	ug/kg
		1,2,3,7,8,9-HxCDF	0.17		ug/kg
		1,2,3,7,8-PeCDF	0.024		ug/kg
		2,3,4,6,7,8-HxCDF	0.15		ug/kg
		2,3,4,7,8-PeCDF	0.086		ug/kg
		HpCDDs (total)	0.28		ug/kg
		HpCDFs (total)	1.1		ug/kg
		HxCDDs (total)	0.15		ug/kg
		HxCDFs (total)	2.3		ug/kg
		OCDD	1.5	E	ug/kg
		OCDF	0.66	E	ug/kg
		PeCDDs (total)	0.072	a	ug/kg
		PeCDFs (total)	0.7		ug/kg
		TCDDs (total)	0.047	a	ug/kg
		TCDFs (total)	0.26		ug/kg

Qualifier

- a* Matrix spike percent recovery outside of QC limits. For Dioxins: See narrative.
- E* Result exceeds calibration range.
- s* Result detected is below the lowest standard and above zero.

NORTH
D

SOUTH
D'

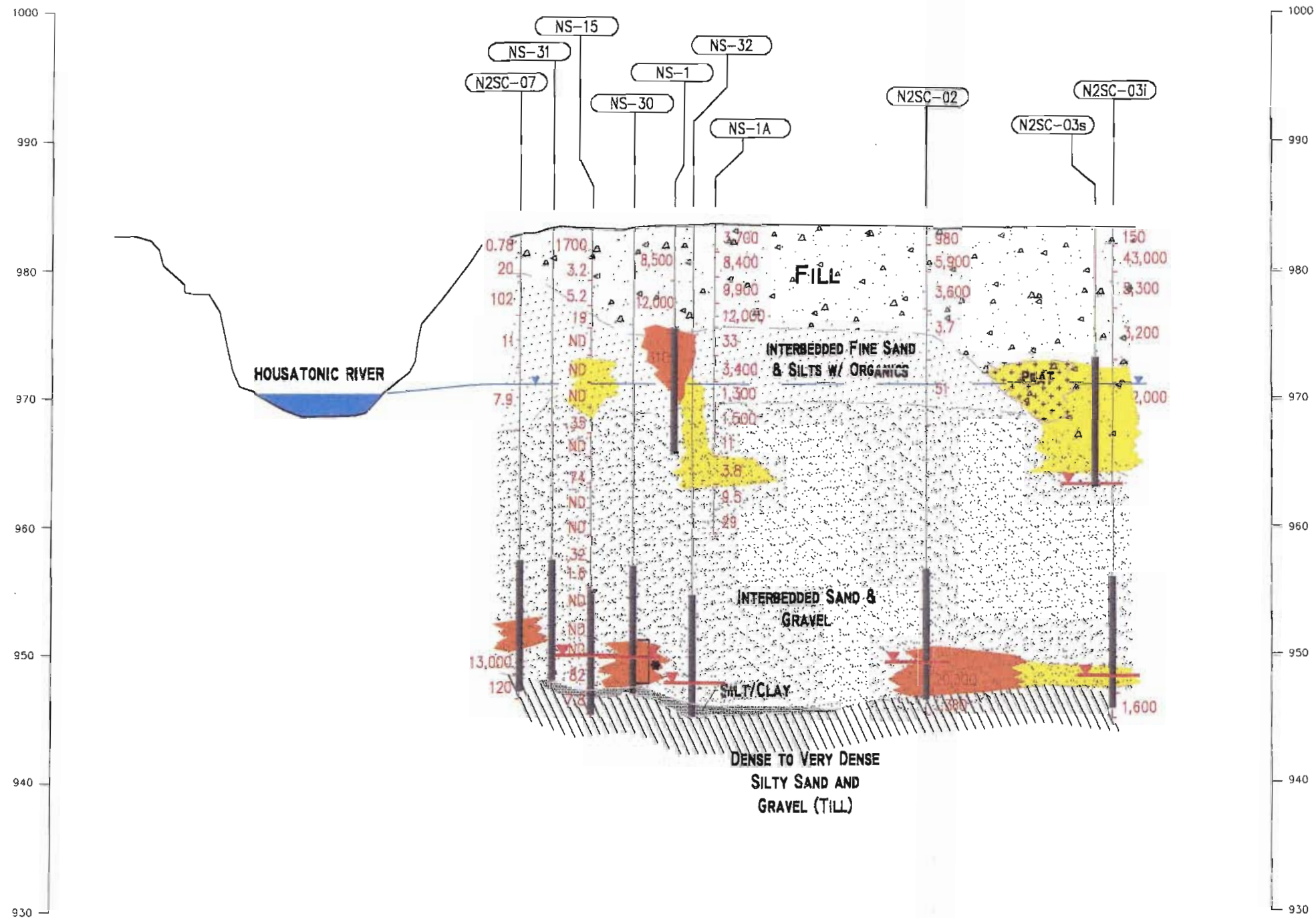

EXPLANATION

- E2SC-10 WELL OR BORING DESIGNATION
- GROUND SURFACE
- ND TOTAL PCB CONCENTRATION IN SOIL (PPM) AND SOIL SAMPLE INTERVAL
- WELL SCREEN
- WATER TABLE (DASHED WHERE INFERRED)
- LNAPL OBSERVED IN WELL
- APPROXIMATE DNAPL LEVEL

- * NAPL OBSERVED IN SOIL
- ND NOT DETECTED
- P ANALYTE WAS DETECTED IN THE SAMPLE CONCENTRATION IS ESTIMATED DUE TO LABORATORY QA CONCERNS

- FAINT STAINING
- STAINED AND SHEEN

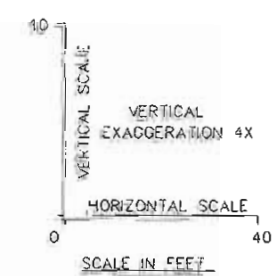
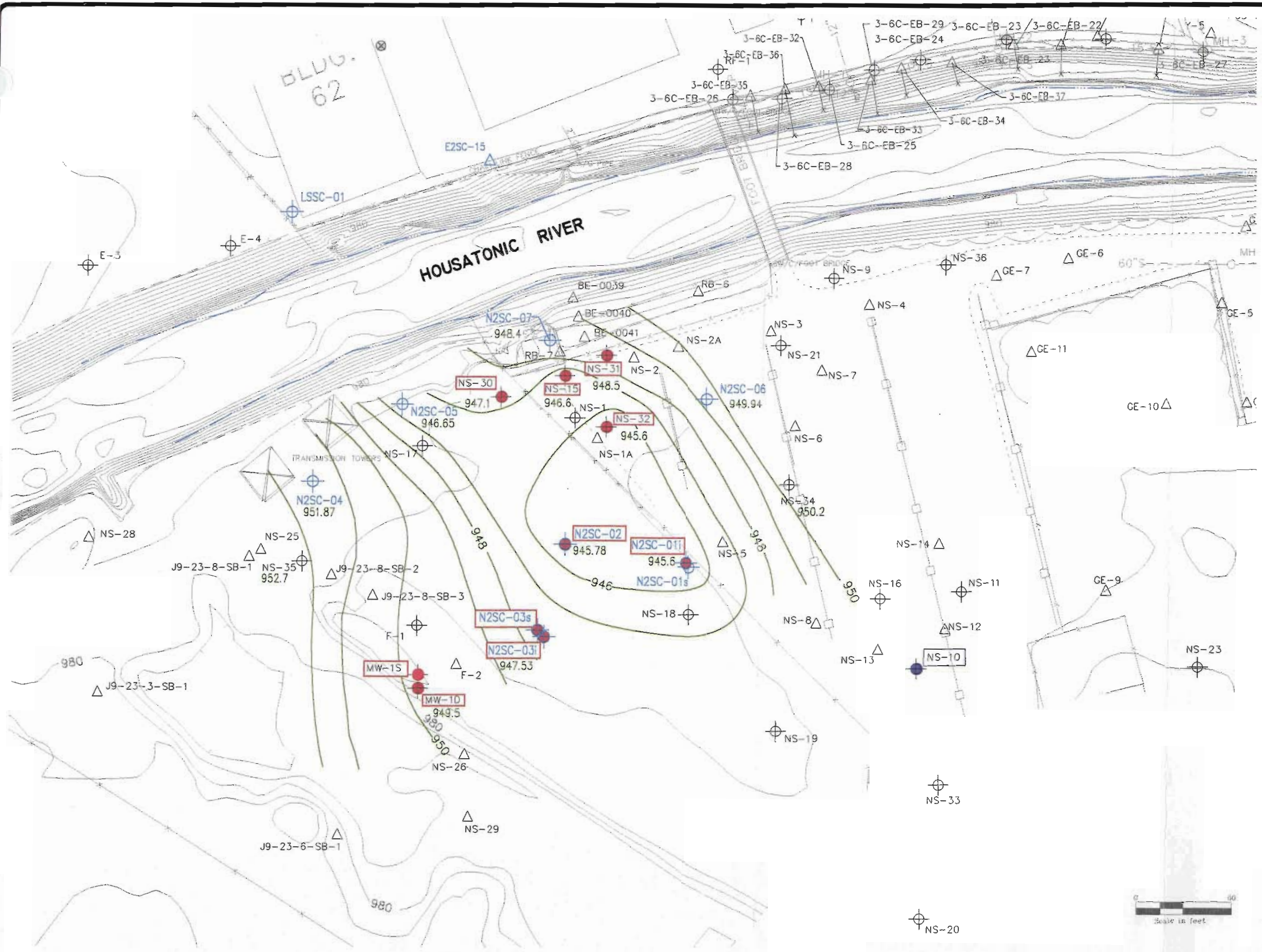

Figure 3-3 Cross-Section D-D', Newell Street Area II

REVISED 2/12/99





EXPLANATION

	ES2-1	PREVIOUSLY INSTALLED MONITORING WELL
	64X(W)	PREVIOUSLY INSTALLED OIL RECOVERY CAISSON
	RW-1(X)	PREVIOUSLY INSTALLED PUMPING WELL
	X-11	PREVIOUSLY INSTALLED SOIL BORING
	E2SC-1	SOURCE CONTROL MONITORING WELL
	E2SC-15	SOURCE CONTROL BORING
	961.2	TOP OF TILL ELEVATION
	946	TOP OF TILL CONTOUR 1 FOOT INTERVAL
		MEASURABLE DNAPL IN WELL
		MEASURABLE LNAPL IN WELL

REVISED 2/12/99

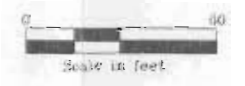

Figure 3-6 Extent of DNAPL & LNAPL , Newell Street Area II

