

---

## LIST OF FIGURES

---

### Title

- 1-1 Locations of Operable Units (OUs)
- 2.1-1 Housatonic River Sediment Sampling Locations West of Newell Street Bridge
- 2.1-2 Housatonic River Sediment Sampling Locations East of Newell Street Bridge
- 3.3.1-1 East Street Area 1 USEPA Area 3 SWMU Locations
- 3.3.1-2 Locations of Miscellaneous Investigations
- 3.3.1-3 Extent of PCBs in Surface Soil, East Street Area 1/US EPA Area 3
- 3.3.1-4 Pipelines Retained for Phase III Analysis
- 3.3.1-5 Summary of Select Groundwater Data
- 3.3.1-6 Oil Plume Map—October 1983
- 3.3.1-7 Locations of Remaining Oil Occurrences—October 1997
- 3.3.2-1 Site Layout and Potential Contaminant Source Areas
- 3.3.2-2 Extent of PCBs in Surface Soil, East Street Area 2/USEPA Area 4
- 3.3.2-3 Oil Plume Map—October 1997
- 3.3.2-4 Oil Plume Map—April 1997, East Street Area 2
- 3.3.2-5 DNAPL Measurements, East Street Area 2
- 3.3.2-6 Building 68 DNAPL Area Cross Section
- 3.3.2-7 Housatonic River Outfalls
- 3.3.2-8 Monitoring Well and Soil Sampling Locations, East Street Area 2—1996
- 3.3.2-9 Interpreted Groundwater Contour Map, East Street Area 2—1996
- 3.3.2-10 Groundwater Flow Simulation—East Street Area 2 Recovery System—1997
- 3.3.2-11 Riverbank Area Groundwater Elevation Contour Map—6/4,5/97
- 3.3.2-12 Interpreted Contour Map Top of Till—East Street Area 2
- 3.3.3-1 Hill 78 Area Potential Source Areas
- 3.3.3-2 Pipelines Retained for Phase III Analysis
- 3.3.3-3 Summary of Select Groundwater Data
- 3.3.3-4 Extent of PCBs in Surface Soil, Hill 78 Area/USEPA Area 2
- 3.3.4-1 Unkamet Brook Location Map, Unkamet Brook Area/USEPA Area 1

---

## LIST OF FIGURES (Continued)



---

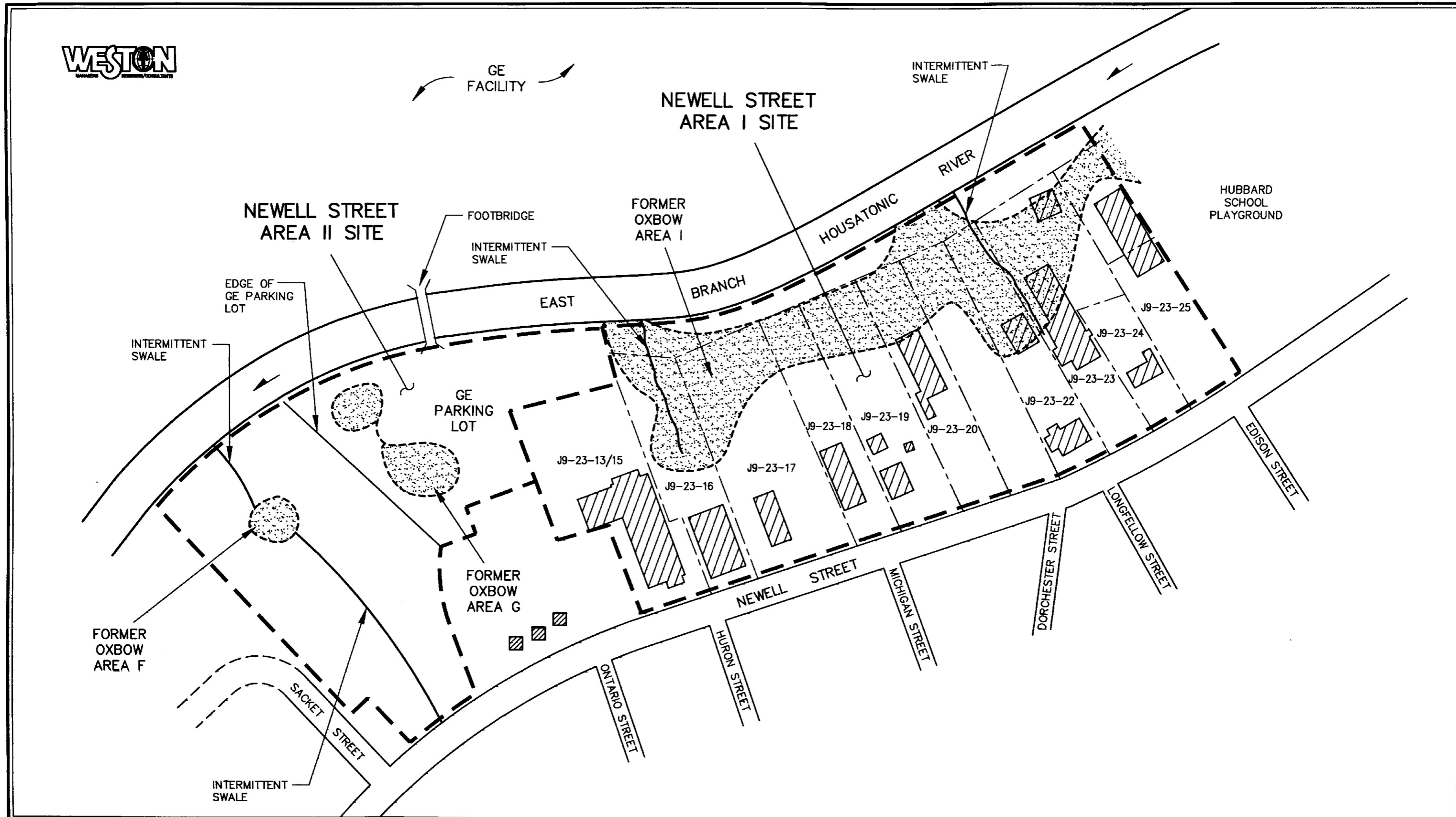

### Section

- 3.3.4-2 Extent of PCBs in Surface Soil, Unkamet Brook Area
- 3.3.5-1 LNAPL/DNAPL Extent
- 3.3.5-2 Interpretive Top of Silt Elevation Contours
- 3.3.5-3 Extent of PCBs in Surface Soil, Lyman Street Area
- 3.3.5-4 Interpretive Groundwater Elevation Contours—January 1998
- 3.5-1 Summary of Horizontal Extent of PCBs in Soil at Allendale School
- 3.6-1 Facility Drainage
- 3.6-2 Additional Municipal Sewer Outfalls into Silver Lake
- 3.6-3 Summary of Silver Lake Sediment Sampling Locations and PCB Data
- 3.6-4 Silver Lake Floodplain Soil Sampling Locations and PCB Results
- 3.6-5 Location of Monitoring Wells Near Silver Lake
- [3.7-1 Location Plan for Newell Street Area I and Area II](#)
- [3.7-2 Limit of Approximate 10-Year Floodplain for Newell Street Area I and II](#)
- [3.7-3 Newell Street Area NAPL Well Location Map](#)
- 3.8-1 Sampling Locations for Oxbow Areas A, B, and C
- 3.8-2 Soil PCB Data for Oxbow Areas A, B, and C
- 3.8-3 Sampling Locations for Oxbow Areas J and K
- 3.8-4 Soil PCB Data for Oxbow Areas J and K
- 5-1 Identified Contaminant Source Areas



**LEGEND**

-  FORMER OXBOW AREA
-  SITE BOUNDARY

- J9-23-13/15 MAP-BLOCK-LOT NUMBER
-  PROPERTY BOUNDARY
-  FLOW DIRECTION



NOT TO SCALE

Drawing based on figures from Final Hazard Ranking System Package (Revision 1), by Roy F. Weston, Inc., dated 28 Aug. 1987.

Source Area Characterization Report  
Pittsfield/Housatonic River Site  
Pittsfield, Massachusetts

**FIGURE 3.7-1  
LOCATION PLAN  
FOR NEWELL STREET  
AREA I AND AREA II**

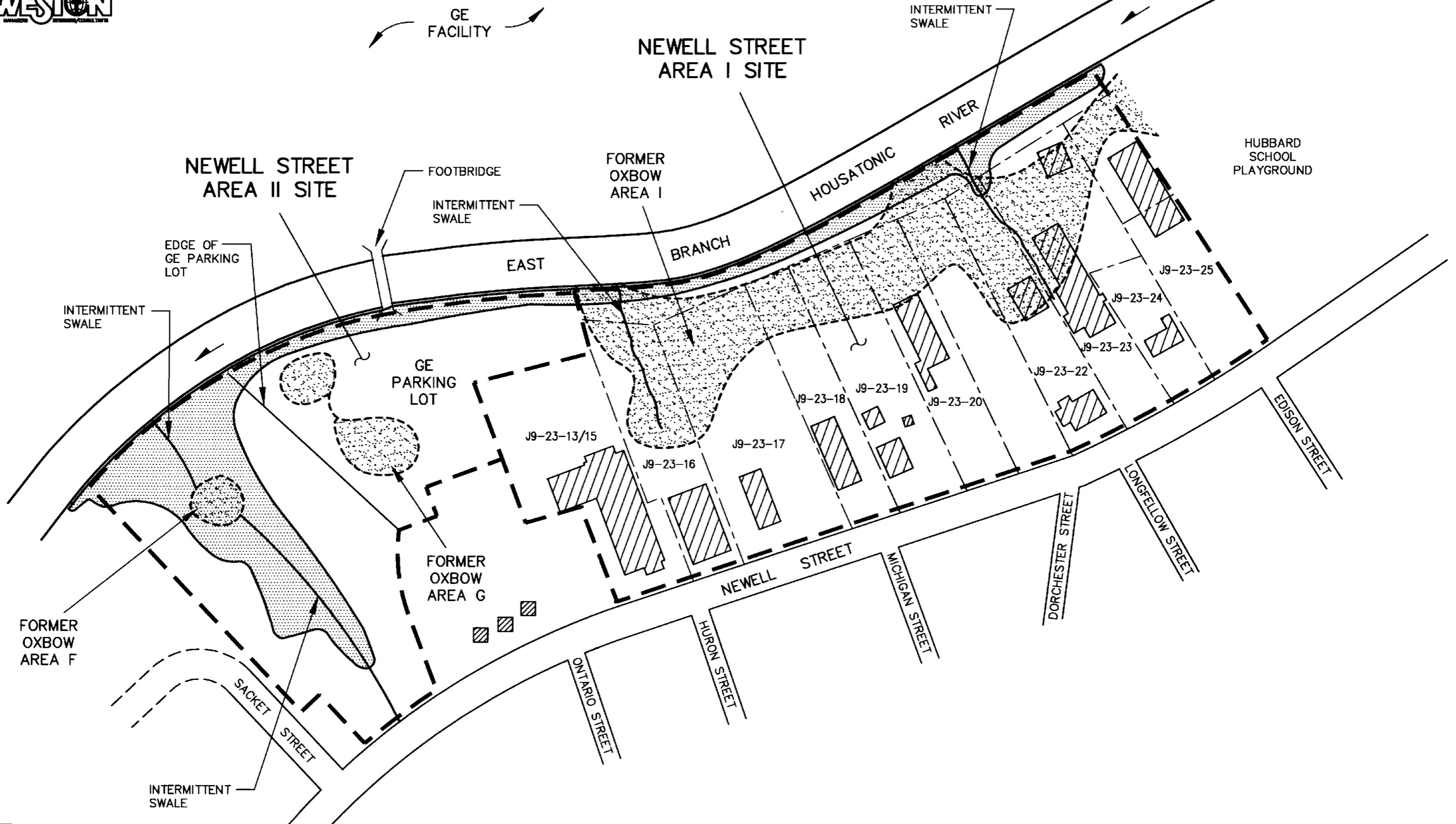

**LEGEND**

- FORMER OXBOW AREA
- PROPERTY BOUNDARY
- SITE BOUNDARY
- FLOW DIRECTION
- J9-23-13/15 MAP-BLOCK-LOT NUMBER
- LIMITS OF APPROXIMATE 10-YEAR FLOODPLAIN WHERE SURFICIAL SOIL IS EXPOSED



NOT TO SCALE

Drawing based on figures from Final Hazard Ranking System Package (Revision 1), by Roy F. Weston, Inc., dated 28 Aug. 1997.

Source Area Characterization Report  
 Pittsfield/Housatonic River Site  
 Pittsfield, Massachusetts

**FIGURE 3.7-2**  
**LIMIT OF APPROXIMATE 10-YEAR FLOODPLAIN FOR NEWELL STREET AREA I & AREA II**

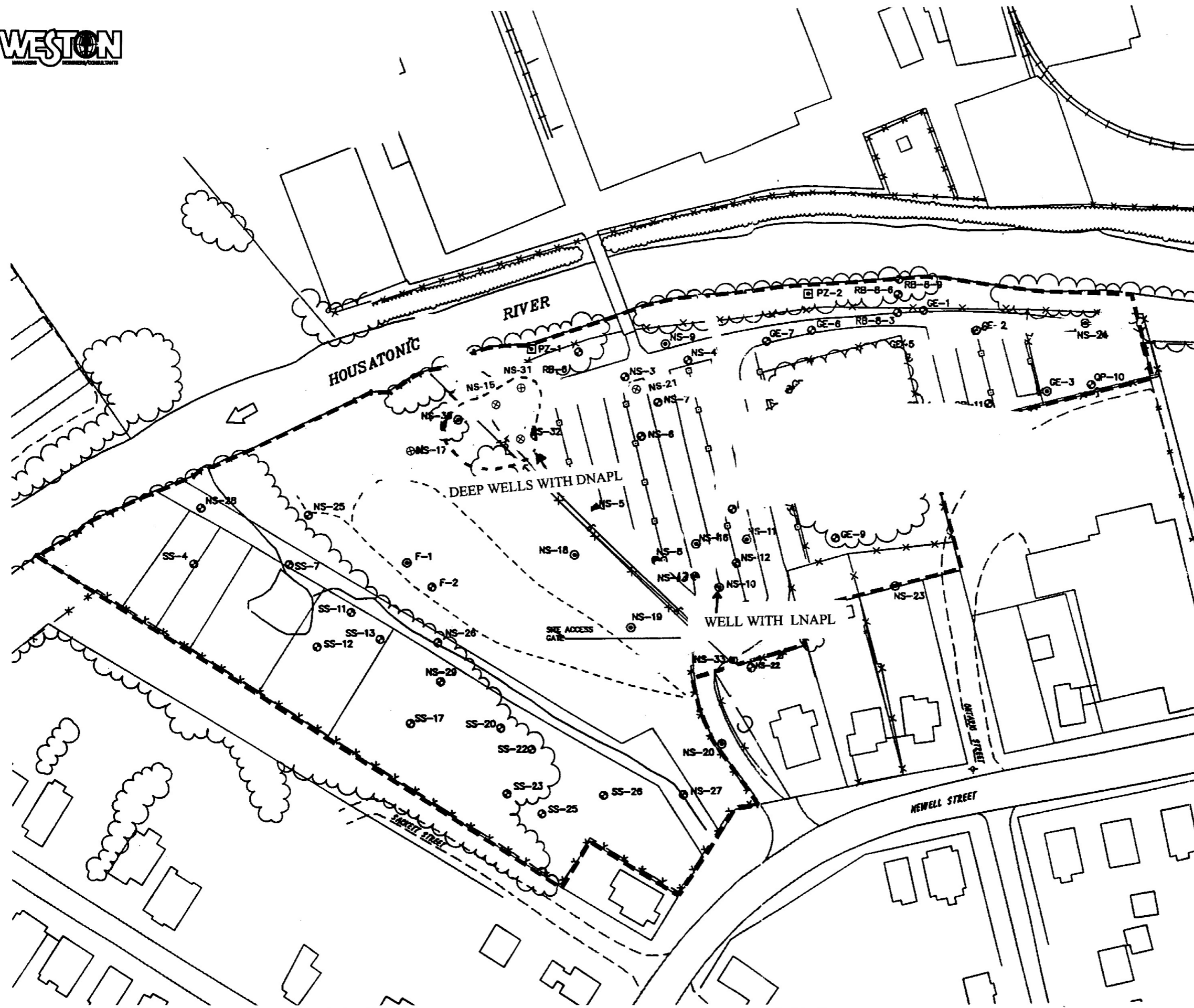

**LEGEND**

- ⊙ GE-3 MONITORING WELL
- ⊠ PZ-1 PIEZOMETER
- ⊙ NS-2A SOIL BORING
- A — A' CROSS SECTION LOCATION
- - - - - APPROXIMATE SITE BOUNDARY
- · - · - APPROXIMATE EXISTING FENCE LOCATION
- — — — — APPROXIMATE PARCEL BOUNDARY

**NOTES:**

1. THE BASE MAP FEATURES PRESENTED ON THIS FIGURE WERE PHOTOGRAMMETRICALLY MAPPED FROM APRIL 1990 AERIAL PHOTOGRAPHS.
2. ALL SAMPLING LOCATIONS ARE APPROXIMATE.

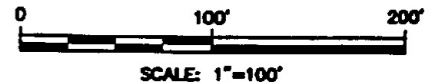

Map produced by WESTON adapted from Blasland, Bouck & Lee, Inc.

Source Area Characterization Report  
Pittsfield/Housatonic River Site  
Pittsfield, Massachusetts  
**FIGURE 3.7-3**  
**NEWELL STREET AREA**  
**NAPL WELL LOCATION MAP**